

**M
S
-
G
N**

0

0

2

7

6

LOT NO. 39

Field Notes.

of the survey of the

Justice Mining Claim

Situate in Pima mining district

County of Pima and in Sec. 21, Tp. 8 S

Range 12 E, of the Gila and Salt River Meridian.

Claimed by J. D. Leake & A. J. House

Survey executed by L. D. Chilson D. S.

Under instructions dated May 18 1881

Survey commenced May 23 1881

Survey completed May 23 1881

PRELIMINARY OATHS

FOR SURVEYS OF MINING CLAIMS AND MILL SITES.

WE, Homer E Sager and Leurett F Fries

do solemnly swear that we will faithfully execute the duties of Chain Carriers; that we will level the chain upon uneven ground, and plumb the tally pins, whether by sticking or dropping the same; that we will report the true distance to all notable objects, and the true length of all lines that we assist in measuring, to the best of our skill and ability.

Homer E Sager
Leurett F Fries

SWORN to and subscribed before me, this twentieth day
of May 1881

I. D. Chilson

Notary Public

I, Grannell Shinn

do solemnly swear that I will well and truly perform the duties of Axman and
Flagman according to instructions given me,
and to the best of my skill and ability.

Grannell Shinn

SWORN to and subscribed before me this 20th day
of May, 1881

I. D. Chilson

Notary Public

PRELIMINARY OATHS

FOR SURVEYS OF MINING CLAIMS AND MILL SITES.

WE, Homer E. Sager and Leurett F. Fries

do solemnly swear that we will faithfully execute the duties of Chain Carriers; that we will level the chain upon uneven ground, and plumb the tally pins, whether by sticking or dropping the same; that we will report the true distance to all notable objects, and the true length of all lines that we assist in measuring, to the best of our skill and ability.

Homer E. Sager
Leurett F. Fries

SWORN to and subscribed before me, this twentieth day
of May, 1881

I. D. Chilson

Notary Public

I, Grassill Shinn

do solemnly swear that I will well and truly perform the duties of Assessor and

Flaxman according to instructions given me,

and to the best of my skill and ability.

Grassill Shinn

SWORN to and subscribed before me this 20th day
of May, 1881

I. D. Chilson

Notary Public



Field Notes

Official Survey of the Justice Silver Mine
Pima Mining District, Pima County Arizona;
Surveyed May 23rd 1881

Magnetic Variation

The same as ascertained by observation on Palavis
January 27th 1881 Survey of the Esperanza Mine.

V. 13° 11' E.

Begin at the original location Monument the
center of the North end of claim wherean the Notice
of location is posted. Set an Azasquite post 4^{1/2} dia, 4^{1/2}
high marked J. N. E. C. M. in some mound of Stones
3^{1/2} high, from which the most southerly point
of a large granite rock permanent in place bears
S. 47° 15' W. 13^{1/2} dist; U. S. Mineral Monument N^o 1 bears
S. 73° 30' W. 59 33^{1/2} dist;

The center monument-northeasterly end of the Es-
peranza Claim, ^{Lot No. 37} bears S. 55° W. 44 26^{1/2} dist; Thence,

S. 86° E. 300 feet monument of stones; set a Mesquite post
4^{1/2} dia, 4^{1/2} high 1^{1/2} in the ground, marked J. N.
E. C. in same mound of stones 3^{1/2} high for N. E.
Cor. of the Claim; Thence,

S. 4° W. 1390 feet monument of stones; set a Mesquite post
3^{1/2} dia, 4^{1/2} high 1^{1/2} in the ground marked J.
S. E. C. in same mound of stones ^{3/2^{1/2} high} for S. E. Cor. of the
claim; Thence

N. 80° W. 300 feet intersect the original center monument at
the S. end of Claim; set an Ocote post 3^{1/2} dia, 4^{1/2}
high marked J. S. E. C. M. in some mound of stones
3^{1/2} high on side of hill sloping South. end of claim.

600 feet monument of stones; set an Ocote post
3^{1/2} dia, 3^{1/2} high 1^{1/2} in the ground marked J.
S. W. C. in same mound of stones 2^{1/2} high for
the S. W. Cor. of the Claim; Thence,

N. 4° E. 1390 feet monument of stones; set a Mesquite
post 4^{1/2} dia, 3^{1/2} high marked J. N. W. C. in same
mound of stones 2^{1/2} high for the N. W. Cor.
of the Claim; Thence,

S. 86° E. 300 feet the Initial Monument the place of beginning;
Containing 18. 143 Acres.

POOR QUALITY

The following pages are scanned at the best possible quality setting. The original pages are of poor quality and this is the best possible reproduction.

4

"Improvements"

On this claim consists of Shafts and open cuts as follows viz:

From center monument at South end of claim;
an open cut 4 ft wide, 5 ft deep, 8 ft long, bears
N. 8° W. 530 ft dist,;

A Shaft 5 ft by 6 ft in size, 8 feet deep, bears
N. 11° 15' W. 550 ft dist,;

From Initial monument North end of claim.
Shaft No 1 is 5 feet by 7 feet in size, 33 ft
deep, bears S. 1° 45' W. 378 ft dist,;

Shaft No 2 is 5 ft by 6 ft in size, 10 feet deep,
with open cut 4 ft wide 5 ft deep, 23 ft long
bears S. 00° 45' E. 538 ft dist,

There are probably 60 tons or more, of ore
lying at the different dumps.

All of said improvements I am informed, have
been made at the expense of present claimants,
and must have cost more than five hun-
dred dollars.

I. D. Hillson

U. S. Deputy M. Sur.

FINAL OATHS FOR SURVEYS OF MINING CLAIMS ~~AND~~ MILL SITES.

A LIST of the names of individuals employed to assist in running, measuring, or marking the lines and corners described in the foregoing field-notes of the survey of the Justice Silver Mining Claim located in Pima Mining District, Pima County, Arizona, showing the respective capacities in which they acted.

Homer B. Sager Chainman.
Leverett F. Fries Chainman.
Granvill Shinn Axeman.
H Flagman.

Justice Silver Mining Claim
WE hereby certify that we assisted Lorenza D. Chillson U. S. Deputy Surveyor, in surveying the Justice Silver Mining Claim claimed by J. B. Lake and A. A. House located in Pima Mining District, Pima County, and in Township No _____ Range No _____ of the Gila and Salt River base and meridian, Arizona, and that said Survey has been in all respects, to the best of our knowledge and belief, well and faithfully executed, and the boundary monuments planted according to the instructions furnished by the Surveyor General.

H. B. Sager Chainman.
Leverett F. Fries Chainman.
Granvill Shinn Axeman.
H Flagman.

SWORN TO AND SUBSCRIBED before me this 23rd day of May 1881

L. D. Chillson
Notary Public

I, L. D. Chillson U. S. Deputy Surveyor, do solemnly swear that, in pursuance of instructions from John Wasson, U. S. Surveyor-General for Arizona, bearing date the 18th day of May 1881, I have well, faithfully and truly, in my own proper person, and in strict conformity with the instructions furnished by the Surveyor-General and the laws of the United States, surveyed all those portions of Mineral Land known as the Justice Mining Claim claimed by J. B. Lake and A. A. House located in Pima Mining District, Pima County, Arizona, as are represented in the foregoing field-notes as having been surveyed under my directions; and do further solemnly swear that all the corners of said surveys have been established and perpetuated in strict accordance with the instructions furnished me, and that the foregoing are the true and original field notes of such surveys.

L. D. Chillson Deputy Surveyor.

SWORN TO AND SUBSCRIBED before me this 31st day of May 1881

William J. Osborn
Notary Public

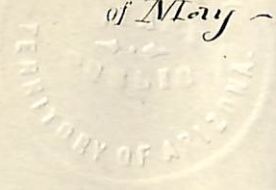

AFFIDAVIT OF FIVE HUNDRED DOLLARS IMPROVEMENTS.

We, W. E. Sager and Leurell-F. Fries
of lawful age, being first duly sworn according to law, depose and say that we are acquainted with
the Justice Silver Mining Claim
~~mining claim~~, situate in Pima
Mining District, Pima County, Arizona
Territory, for which J. B. Lake and A. A. Hause
have made application for survey prior to application for patent under the provisions of the Act of
Congress approved May 10, 1872, and that the labor done and improvements made thereon by the
applicants and their grantors exceed Five Hundred Dollars in value, and further that we are
not personally interested in said mine.

W. E. Sager
Leurell-F. Fries

TERRITORY OF ARIZONA, }
County of Pima } SS.

SWORN AND SUBSCRIBED before me this 23rd
day of May 1881

J. D. Chilson
Notary Public

J M C Elliott May 31st 1879 at
8 a.m.

W Carpenter Receiver

By W J. Moberg Deputy

For the purpose of more fully comply-
ing with the requirements of
Sec 2324 Revised Statutes United States
regarding the location and recording
of claims, and also for the purpose
of correcting an error in the record
regarding the name of claim the fore-
going notice of location is hereby
amended as follows viz: Beginning

J M L Elliott May 31st 1879 at
8 a.m.

W Carpenter Recorder

By W J. Mabry Deputy

For the purpose of more fully comply-
ing with the requirements of
Sec 2324 Revised Statutes United States
regarding the location and recording
of claims, and also for the purpose
of correcting an error in the record
regarding the name of claim the fore-
going notice of location is hereby
amended as follows viz: Beginning
at the initial monument wherein
this notice is posted, situate at the
northern end of claim, from which
the U.S. Mineral Monument No 1 bears
S 73° 30' W 5933 feet dist. and running
from thence as herein before noted;
and shall be known as the Justice
Mining claim

J J Seake Assessor

Amended May 20th 1881.

Filed and recorded at request of A A
Howe May 24th 1881. at 9:45 a.m.

Chas R Drake

County Recorder

TERRITORY OF ARIZONA, } ss.

County of Pima.

I, *Chas. R. Drake*, County Recorder in and for the County of Pima, do hereby certify that the above and foregoing is a full true and correct copy of the Amended Location Notice of the Justice Mine

as appears of Record now in my Office in Book *P*, Pages *635 & 636*

IN WITNESS WHEREOF, I have hereunto set my hand and affixed my official seal, at my office in Tucson this *1* day of *June* A. D. 188*1*

Chas R Drake

County Recorder,



Scale 1" = 600 feet

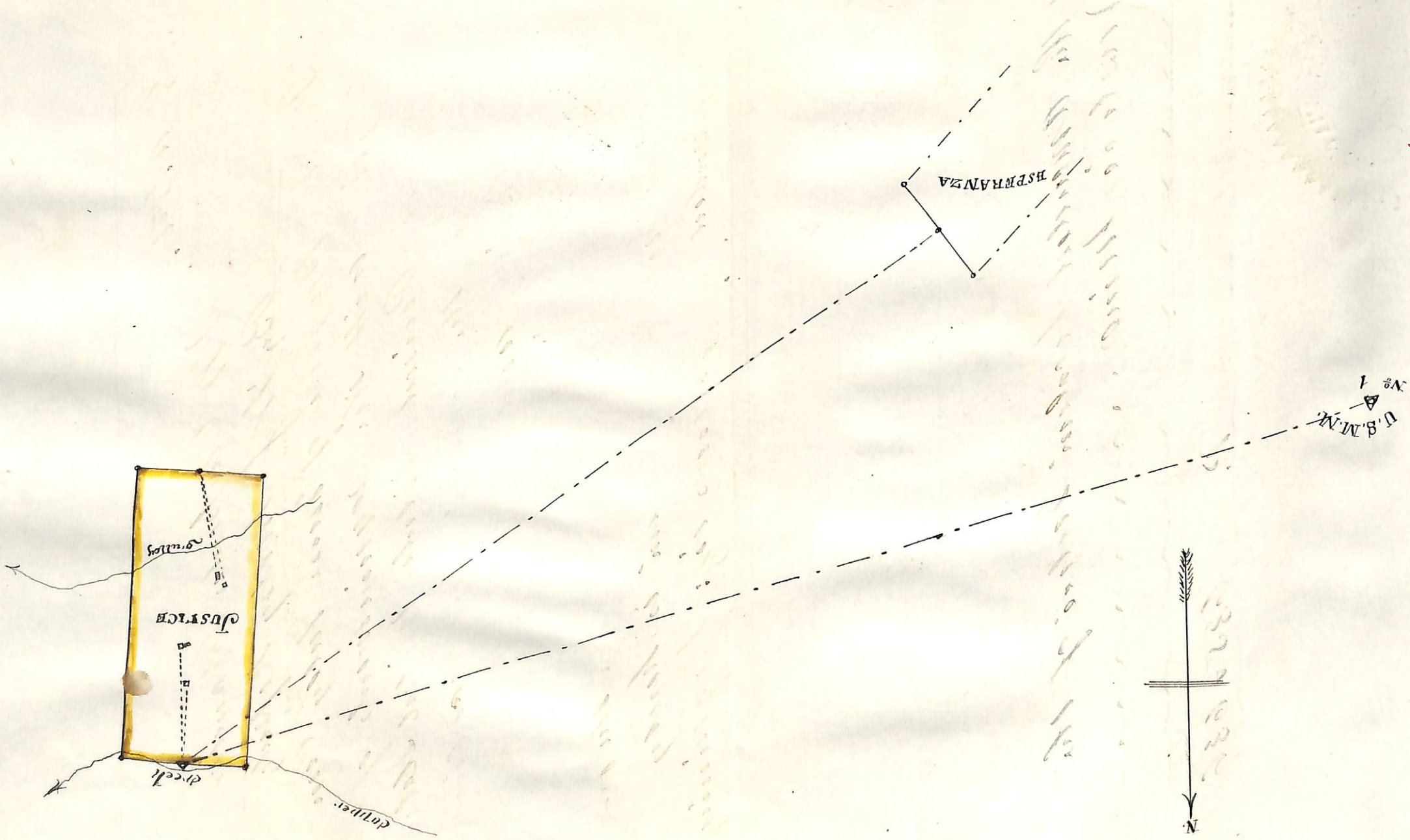

8

9

Certified Copy of the
Amended Notice of the Justice Mine

"Justice"

Justice Mine Notice of Location - Notice is hereby given that the undersigned has located and claimed 1500 feet along the course of this lead or lode of mineral bearing quartz and 300 feet on each side of the middle of said vein or all the ground lying between the Trussey lode on the North-west and Dixey on South-East & commencing at Copper Union and running south 1500 feet, the same being properly monumented at the end of the claim. All a shaft sunk 5 feet deep on vein situated in Prima Dist. Prima County and in South-East end of the County and about $1\frac{1}{2}$ miles East of the old mine located by Green Peak & Company. There being a copy of this notice posted on the claim located April 15th 1879 and shall be known as the Justice Mine

D. J. Edwards

J. M. C. Elliott

Filed and recorded at request of

U. S. Surveyor General's Office.

Tucson, Arizona,

June 13th 1881

The foregoing field notes of the survey of the Justice
Mining Claim situate in
the Pima Mining District Pima
County, Arizona, claimed by J. B. Lease
and A. A. House ;
survey executed by L. D. Chillson Deputy
Surveyor, under instructions from this office, having been critically examined
and the necessary corrections and alterations made, the said field notes and
the survey they describe are hereby approved.

John Mason

Surveyor General.