

MS -

0

0

2

7

2

LOT NO. 39

*Survey No 272*  
*Field Notes*

of the survey of the

*Silver Crown*

*Mining Claim*

Situate in *Papago* mining district,

County of *Pima* and in Sec. *1*, Tp *18 S*

Range *10 E*, of the Gila and Salt River Meridian.

Arizona.

Claimed by *George L. Field et al.*

Survey executed by *John W. Sturz* D. S.

Under instructions dated *October 4<sup>th</sup>* 1881

Survey commenced *October 6<sup>th</sup>* 1881

Survey completed *October 7<sup>th</sup>* 1881

# PRELIMINARY OATHS

FOR SURVEYS OF MINING CLAIMS AND MILL SITES.

WE, *R. Fraser* and *Chas. Taylor*

do solemnly swear that we will faithfully execute the duties of Chain Carriers; that we will level the chain upon uneven ground, and plumb the tally pins, whether by sticking or dropping the same; that we will report the true distance to all notable objects, and the true length of all lines that we assist in measuring, to the best of our skill and ability.

*R. Fraser*  
*Chas Taylor*

SWORN to and subscribed before me, this *5<sup>th</sup>* day

of *October*, 1881

*William J. Khan*  
Notary Public, Pima Co., A.T.

I, .....

do solemnly swear that I will well and truly perform the duties of .....

..... according to instructions given me,

and to the best of my skill and ability.

SWORN to and subscribed before me this *teenth* day

of *October*, 1881.

*William J. Khan*  
Notary Public, Pima Co., A.T.

Field Notes  
 of Survey of "Silver Crown" Mining  
 claim, in the Papago Mining Distr.  
 Pima Co, A. T.

claimed by Geo. L. Field, W. L. Skinner,  
 R. Frazer, W. Morgan and J. C. Handy.

surveyed under instructions from the Sur-  
 veyor G. dated Oct 4<sup>th</sup> 1881, by  
 Survey commenced Oct 6<sup>th</sup> } J. H. Sturz  
 " finished <sup>1881</sup> Oct 7<sup>th</sup> } Dep. W. L. Sher.

Also containing field notes of location of  
U. S. Mt. Mont. N. 1 Papago District.  
 erected by the same official, Oct. 6. 1881.

4

Sierritas

2

Location of U. S. Mint Mont. No. 4, Papago District,

In compliance with instructions from the Sur. G. of Arizona, dated Oct 4. 1881, to survey the "Silver Crown" Mining claim, situated in the Papago Mining distr, Sierritas mountains, Pima Co. - and not finding any corner or monument of a U. S. survey - I the undersigned Dep. Mt. Sur. proceed, Oct 6<sup>th</sup> 1881 - to erect a U. S. Mint Monument.

I go on the top of a prominent hill on the "Silver Crown" claim, where I plant a mesquite post, 4 x 4' 8 feet long, one foot in rocky ground, and surround it with a mound of rock, 4 feet high and 5 feet diameter at base, I mark said post: <sup>U. S. M. M.</sup> n. 4. P. D.

From this Monument, variation by Polaris being  $N 12^{\circ} 37' E$ . - I take following bearings:

to Silver Crown Southeast corner:

$S 72^{\circ} 15' E$ , 558 ft

to Cerro Colorado

$S 4^{\circ} E$  -

to Coyote Butte (North of Northern of Baboquivari Range)

$N 44^{\circ} 34' W$  -

# Survey of "Silver Crown" Mining claim.

Being under instructions from the Suror.  
Gt. of Arizona, dated Oct 4<sup>th</sup> 1881. - to survey  
the "Silver Crown" Mining claim, in the  
Papago M<sup>n</sup>. Distr, Sierra Mountains,  
Pima Co, ~~Footstep~~ Range -

I, the undersigned Dep. Mt. Suror., Oct  
6<sup>th</sup> 1881. - proceed to the Initial Monument  
of said claim. I find there the location  
notice, and I set there a mesquit post  
4'x4' and 4 feet long and build around it  
a mound of rock 2 1/2 feet high. This post  
I mark S.C.I.M. Var<sup>n</sup> by Polaris N 12° 37' E.  
centre of Main Shaft of "Silver Crown" bears  
S 36 1/2° E, 43 ft

from S.C.I.M. Run N 60 1/2° E  
210 ft cross a dry wash

300 ft to Northeast corner of "Silver Crown" -  
when I set a mesquite post, 4 1/2 feet long  
4'x4' on rock - and surround it by a  
mound of rock 2 1/2 ft. high. I mark the  
post S.C. NE.

Mesquit tree, 8 in. diam. bears  
S 53° E. - 15 ft. I mark it B.T. S.C. NE

from S.C. NE Run  
S 29 1/2° E

110 ft cross former dry wash  
1500 ft to Southeast corner of "Silver Crown" claim  
where I set a mesquit post 4 1/2 feet long,  
4'x4', and marked S.C. S.E. one foot in the  
ground and build around it a mound of  
rock 2 1/2 foot high. U.S. M. M N. P. D bears  
N 72 1/4° 538 ft

Thence Run  
S 60 1/2° W

300 ft. to South Center Mon<sup>t</sup>. of "Silver Crown"  
claim - here I set a post, of mesquit, 4" x  
4" & 4 1/2 feet long, marked S.C. S. C., one  
foot in rocky ground, and build around it  
a mound of rock 2 1/2 feet high.

Thence

Thence Iron

S 60 1/2 W

300 ft to Southwest corner of 'Silver Crown' claim, where I set a mesquit post 4" x 4" 4 feet long, marked S C SW, on rocky ground, and surround it by a mound of rock 2 1/2 feet high.

Thence Iron

N 29 1/2 W

1350 ft cross a gulch

1500 ft to Northwest corner of 'Silver Crown' where I set a mesquit post, 4" x 4" 4 feet long, marked S C. NW., 1 1/2 feet in the ground and surround it by a monument of rock 2 1/2 feet high from here

A Mesquit tree, 6 in diam. bears S 54° E 30 ft

A mesquit tree 10 in. diam " N 20° E 64 ft

I mark each BT. S C. NW.

from S C NW Iron

N 60 1/2° E

300 ft to Initial Monument S C. I.M., thus closing the survey of the 'Silver Crown' claim.

The Area contained within these boundaries is of 20 <sup>66</sup>/<sub>100</sub> Acres.

Improvements on this claim.

These consist of

- 1) Main shaft, 6' x 5', 48 feet deep.
- 2) One Incline from said shaft 4' x 5' and 10 feet deep
- 3) One crosscut towards ledge from bottom of shaft, 25 ft long, 4 1/2' x 6'.
- 4) One incline shaft on ledge 10' long 4' x 5'.

All of which work I consider to exceed the value of \$500, and I find it to be executed by the applicants and their grantors.

General Description

The 'Silver Crown' Mining claim is located in the Sierritas, a low range of hills in the

Papago Mining Distr, Pima Co., about 30 miles S. W from Tucson and about 2 miles S. W. of Boggs's Mine, northward it joins on to the Bentley n<sup>o</sup>. 2.

The ledge is between talose slate and limestone, and its strike is S 30° East, its dip about 66° N. East.

Its ore is carbonate and sulphide of lead containing silver, and some copper. — the matrix is quartz - several feet wide.

The surrounding hills contain some mesquit timber - water appears scarce but sinking is liable to produce considerable.

Tucson, Oct 10<sup>th</sup> 1881. — J. H. Sturz U.S. Dep. Min. Surveyor.



FINAL OATHS FOR SURVEYS OF MINING CLAIMS & MILL SITES.

A LIST of the names of individuals employed to assist in running, measuring, or marking the lines and corners described in the foregoing field-notes of the survey of the Silver Crown Mining Claim located in the Papago Mining District, Pima County, Arizona, showing the respective capacities in which they acted.

R. Fraser Chainman.  
Ch. Taylor Chainman.  
Axeman.  
Flagman.

WE hereby certify that we assisted J. H. Sturz U. S. Deputy Surveyor, in surveying the "Silver Crown" Mining claim claimed by Geo. L. Field, W. Skinner, R. Fraser, W. Morgan & J. C. Handy located in Papago Mining District, Pima County, and in Township No. Range No. of the Gila and Salt River base and meridian, Arizona, and that said Survey has been in all respects, to the best of our knowledge and belief, well and faithfully executed, and the boundary monuments planted according to the instructions furnished by the Surveyor General.

R. Fraser Chainman.  
Ch. Taylor Chainman.  
Axeman.  
Flagman.

SWORN TO AND SUBSCRIBED before me this tenth day of October 1881.

William J. Ashburn  
Notary Public, Pima Co., A.T.

I, John H. Sturz U. S. Deputy Surveyor, do solemnly swear that, in pursuance of instructions from the U. S. Surveyor-General for Arizona, bearing date the 4th day of October 1881, I have well, faithfully and truly, in my own proper person, and in strict conformity with the instructions furnished by the Surveyor-General and the laws of the United States, surveyed all those portions of the "Silver Crown" Mining claim claimed by Geo. L. Field, W. Skinner, R. Fraser, W. Morgan and J. C. Handy located in Papago Mining District, Pima County, Arizona, as are represented in the foregoing field-notes as having been surveyed under my directions; and I do further solemnly swear that all the corners of said surveys have been established and perpetuated in strict accordance with the instructions furnished me, and that the foregoing are the true and original field notes of such surveys.

John H. Sturz Deputy Surveyor.

SWORN TO AND SUBSCRIBED before me this tenth day of October 1881.

William J. Ashburn  
Notary Public, Pima Co., A.T.



AFFIDAVIT OF FIVE HUNDRED DOLLARS IMPROVEMENTS.

We, Charles Taylor and Edward Miller  
of lawful age, being first duly sworn according to law, depose and say that we are acquainted with the  
Silver - Crown  
\_\_\_\_\_ mining claim, situate in Papago  
\_\_\_\_\_ Mining District, Pima County, Arizona  
Territory, for which Geo. L. Field, W. Skinner and R. Frazer, W. Morgan & J. C. Handy  
have made application for survey prior to application for patent under the provisions of the Act of  
Congress approved May 10, 1872, and that the labor done and improvements made thereon by the appli-  
cants and their grantors exceed Five Hundred Dollars in value, and further that we are not per-  
sonally interested in said mine.

Edward Miller  
C. Taylor

TERRITORY OF ARIZONA,  
County of Pima } SS.



SWORN AND SUBSCRIBED before me, this teenth  
day of October 1881.

William G. Ham  
Notary Public, Pima Co. A. T.

Silver Crown.

Location Notice. - Notice is hereby given, That the undersigned, in compliance with the requirements of the Mining Act of Congress, approved May 10, 1872, have this day located and claimed 1500 hundred linear feet along the course of this lead, lode or vein of mineral bearing quartz, and 300 feet in width on each side of the middle of said lead, lode or vein, situate in the Papago Mining District, County of Pima Arizona, and more particularly described as follows, to wit: Commencing at this monument of stones, being the center of the North west end of claim, and upon which this notice is posted; thence 300 feet to a monument of stones; thence 1500 feet to a monument of stones; thence 300 feet to a monument of stones, being the center of South east end of claim; thence 300 feet to a monument of stones; thence 1500 feet to a monument of stones; thence 300 feet to place of beginning. This claim is situated about 35 miles S. W. from Tucson in the Sierrita mountain and about 2 miles S. W. of Pogan's mine - and shall be known as the Silver Crown mine. - Located May 6<sup>th</sup> 1881

W. Skinner

R. Frazer

E. Fields

W. Morgan

J. C. Handy

Filed and recorded at request of  
J. C. Handy May 25<sup>th</sup> A. D. 1881, at

9 A. M.

Chas. R. Drake,  
County Recorder.

TERRITORY OF ARIZONA, } ss.

County of Pima.

I, Chas. R. Drake, County Recorder in and for the County of Pima, do hereby certify that the above and foregoing is a full true and correct copy

*of Location Notice of the Silver Crown Mine*

as appears of Record now in my Office in Book *P Records of Mines* Pages *643 + 644*.

IN WITNESS WHEREOF, I have hereunto set my hand and affixed my official seal, at my office in Tucson this *23<sup>rd</sup>* day of *September* A. D. 1881.



*Chas. R. Drake*

County Recorder,

*By Anthony Coenen*  
Deputy

Bentley No. 2

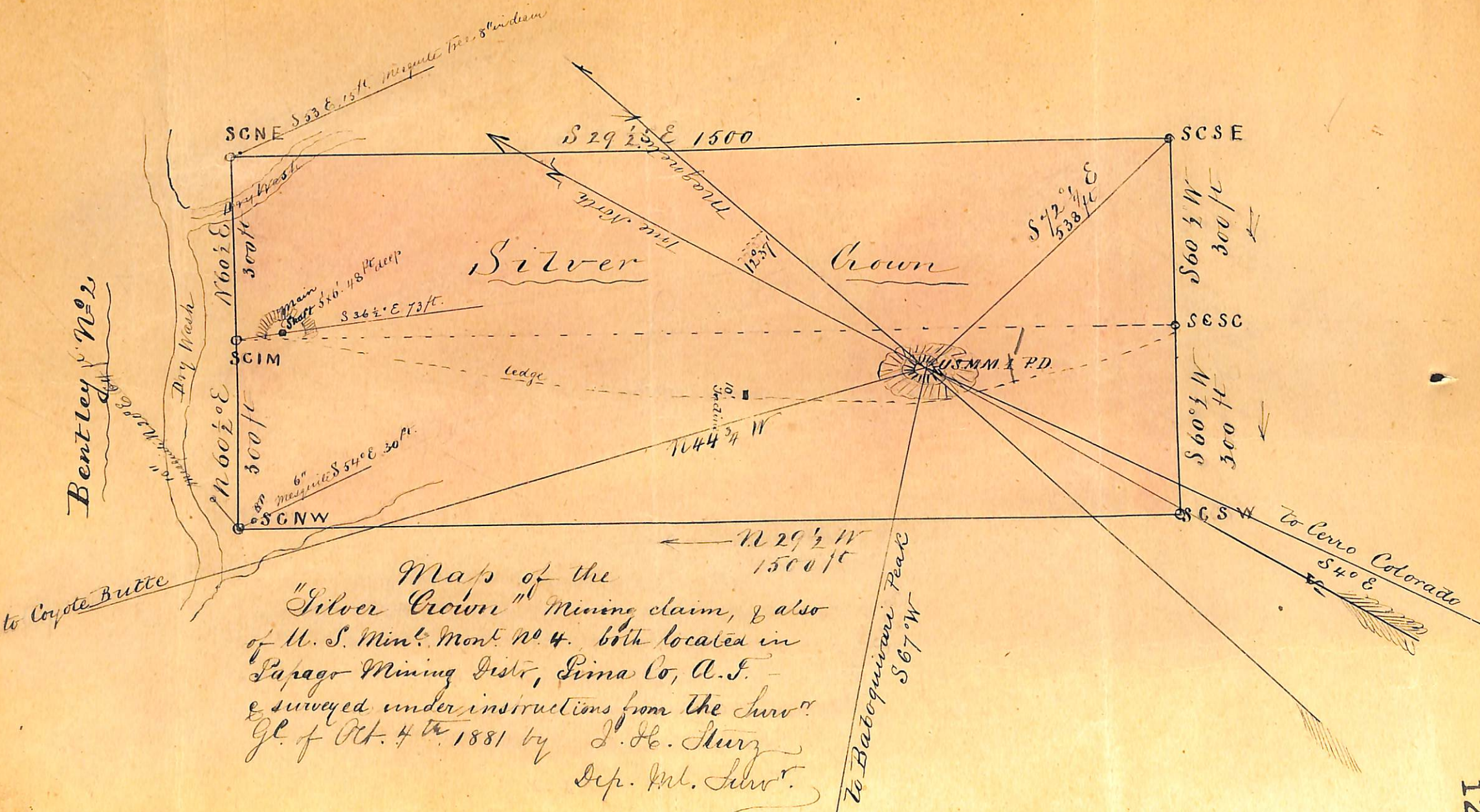

Map of the  
 "Silver Crown" Mining claim, & also  
 of U. S. Mint. Mont. No. 4. both located in  
 Papago Mining Distr, Pima Co, A.T.  
 & surveyed under instructions from the Suror  
 G. of Oct. 4<sup>th</sup> 1881 by J. H. Sturz  
 Dep. Int. Suror.

U. S. Surveyor General's Office.

Tucson, Arizona, *October 22<sup>nd</sup>* 188*1*

The foregoing field notes of the survey of the "*Silver  
Crown*" Mining Claim situate in  
the *La Paga* Mining District, *Pima*  
County, Arizona, claimed by *Geo. L. Field et al.*  
survey executed by *John H. Sturz* Deputy  
Surveyor, under instructions from this office, having been critically examined  
and the necessary corrections and alterations made, the said field notes and  
the survey they describe are hereby approved.

*John Messon.*

Surveyor General.

UNITED STATES DEPARTMENT OF THE INTERIOR 9605 (956)  
BUREAU OF LAND MANAGEMENT M.S. 272  
ARIZONA STATE OFFICE

---

NOTICE OF CANCELLATION OF MINERAL SURVEY

The Silver Crown lode, Mineral Survey No. 272, located in section 1, Township 18 South, Range 10 East, Gila and Salt River Meridian, Arizona, is hereby canceled.

This claim has not been filed with the Arizona State Office, Bureau of Land Management, in accordance with Section 314, 90 STAT. 2769, (43 U.S.C. 1744).

This cancellation was necessitated to clear the record.

The Mineral Survey Plat should be noted as follows:

"Silver Crown lode, M.S. 272, was canceled March 23, 2004, by memo 9605 (956) M.S. 272, which is now a part of the original field notes."

March 23, 2004  
Date

  
Chief Cadastral Surveyor of Arizona