

MS.

0

0

5

2

1

LOT NO. 49

SURVEY NO. 521

Field Notes

of the survey of the

Little Monarch

Mining Claim

Situate in Cababi mining district.

County of Pima and in Sec _____, Tp 16 S

Range 4 F, of the Gila and Salt River Meridian.

ARIZONA.

Claimed by The Cababi Con Mining Company

Survey executed by Solon M. Allis U.S. D. S.

Under instructions dated July 11 1883

Survey commenced " 16 1883

Survey completed " 16 1883

PRELIMINARY OATHS

FOR SURVEYS OF MINING CLAIMS AND MILL SITES.

WE, John T. McDonald and Edward J. Williams
do solemnly swear that we will faithfully execute the duties of Chain Carriers: that we will level the chain upon uneven ground, and plumb the tally pins, whether by sticking or dropping the same; that we will report the true distance to all notable objects, and the true length of all lines that we assist in measuring, to the best of our skill and ability.

J. T. McDonald
Edward J. Williams

SWORN to and subscribed before me, this 14th day

of July, 1883

Solomon W. Ellis
Notary Public, Pinalco A. T.

I, John Moore

do solemnly swear that I will well and truly perform the duties of Flagman
according to instructions given me,
and to the best of my skill and ability.

John Moore

SWORN to and subscribed before me this 14th day

of July, 1883

Solomon W. Ellis
Notary Public,
Pinalco A. T.

Field Notes of the Survey of the

LITTLE MONARCH.

Mining Claim.

Cabati Mining District.

Pima Co A. I.

Claimed by the Cabati Co. M. Co.

Surveyed July 16th 1883
by Order of

Surveyor General J. W. Robbins
Date of July 11, 1883

Solon M. Allen ^{By} U. S. Dep. Miner. Sur.

Survey of the Little Monarch
Mining Claim Catavi Mining District
Pima Co U.S.

Commencing at Initial Monument at
S.E. end of claim where I found a
Location Notice placed - I set an Ironwood
post 4x4" sq 5ft long marked L.M. N^o 1
set 2 ft in the ground and built a
monument of stones 2 1/2 ft high around it
From which U.S. Mineral Monument N^o 4
Catavi Mining Dist bears S. 91°30' E Dist 1700 ft
Var 13° 04' E

By Observation on Polaris.
This is also the S.W. Cor of the Littlefield
M.C. A Rock marked L.M. N^o 1
bears N 77° 34' E Dist 6 ft -

Thence Iron S 24° 04' W
Var 13° 04' E

Feet
300

Along S.E. end boundary of claim
to S.E. Cor where I set an Ironwood
post 4x4" sq 5ft long marked L.M. N^o 11.
2 ft in the ground and built a
monument of stones 2 1/2 ft high
around it. From which U.S. Mineral
Monument N^o 4 bears S 40° 34' E
A Palo Verde Tree 4" Dia bears N 77° 26' W
Dist 4 ft - marked L.M. N^o 11.

Thence Iron N 65° 56' W
Var 13° 04' E

740 Along S.W. Boundary line of claim
to Gulch running South -

752 to Road " S.W. to Well -

1502 In S.W. Cor of claim where I set an
Ironwood post 4x4" sq 5ft long marked
L.M. N^o 111. 2 ft in the ground and
built a monument of stones 2 1/2 ft high
around it - from which U.S. Mineral
Monument N^o 4 bears S 52° 56' E.

A Palo Verde Tree 6" Dia marked L.M. N^o 111
bears N 89° 43' E Dist 13 ft. Old cor

Feet Survey of the Little Monarch
Mining Claim Babobi Mining Dist
Pima Co A.T.

Monument bears. N 65° 56' W Dist 25 ft
Thence Iron

N 24° 04' E
Var 13° 04' E

3111 Along N.W. End boundary of claim
In Middle Monument of same where
I set an Iron wood post 4x4" sq 5 ft
long marked L.M. N° IV. 2 ft in the
ground and built a monument of
stones 2 1/2 ft high around it.
From which U.S. Mineral Monument
N° 4 bears. N 47° 45' E
A Rock marked L.M. N° IV. bears
S 47° 34' W Dist 10 ft. The old Center Mon
bears N 65° 56' W Dist 20 ft.
This claim therefore located 90 ft long
I cut off this excess and placed monuments
accordingly.

Thence Iron

N 24° 04' E
Var 13° 04' E

97 Continuation of N.W. End line,
To N.W. Cor of claim, This also
the S.W. cor of the Petaluka M.C. Lot No 48.
When I set a Mesquit post 4x4" sq
5 ft long marked L.M. N° V. set 2 ft
in the ground and built a monument
of stones 2 1/2 ft high around it.

From which U.S. Mineral Mon
N° 4 bears. S 45° 48' E

Old Cor Monument bears. N 65° 56' W Dist
10 ft. A Rock marked L.M. N° V.
bears. S 6° 34' W. Dist 6 ft.

Thence I ran

S 65° 56' E
Var 13° 04' E

460 Along N.E. side boundary of claim this
also the S.E. side line of the Petaluka M.C. Lot No 48

Yest Survey of the Little Monarch Mining
Claim Cababi Mining Dist Pima Co A.T.

to Gulch running S.E.
 720 To Road running S to Well.
 810 To a point opp Shaft 40 ft Rt of line
 835 " " " " 25 " " "
 North End of cut 30 ft long 10 ft Rt
 (or South) of above shaft -
 850 10 ft opp Shaft 10 ft Rt of line -
 1500 To N.E. cor of claim this also S.E.
 Cor Petank, M. B. ^{Lot No. 48} when I set an
 Ironwood post 4x4" sq 5 ft long marked
 LMN=VI, 2 ft in the ground. and built
 a monument of stones 2 1/2 ft high
 around it. From which
 U.S Mineral Monument N=4
 bears S 28° 52' E
 Shaft bears N 79° 46' W Dist 420 ft
 Thence I ran

S 24° 04' W
 Var 13° 04' E
 7 Along S.E. End boundary of claim
 97 to place of beginning.
 This claim contains 13.67 acres.

General Description

This claim lies about 2 1/4 miles S.W. of
 the Sta Picocho Mine Cababi Mining Dist
 Pima Co A.T. Mostly in a hollow between
 two hills one of which is found the U.S.
 Min Mon N=4 Cababi Mining Dist
 Established by L D Children March 10th.

I hereby certify that the improvements
 made by claimants and their grantors consist of
 shaft N=1 - 5x7 - 4 ft deep

- " N=2 - 5x7 - 4 " "
- " N=3 - 5x7 - 32 " "
- " N=4 - 5x7 12 " "

One cut 30 ft long 3x4 ft the whole
 costing more than the required \$500.

Solim M. Allen
 U.S. Deputy Mineral Surveyor.

FINAL OATHS FOR SURVEYS OF MINING CLAIMS & MILL SITES.

A LIST of names of individuals employed to assist in running, measuring, or marking the lines and corners described in the foregoing field-notes of the survey of The Little Menarch Mining Claims located in Catobi Mining district, Pima County, Arizona, showing the respective capacities in which they acted.

Edward J. Williams Chainman.
John J. McDonald Chainman.
John Moore Axeman.
John Moore Flagman.

WE hereby certify that we assisted Solon W. Allen U. S. Deputy Surveyor, in surveying The Little Menarch Mining Claims claimed by The Catobi Cons Mining Co. located in Catobi Mining District, Pima County, and in township No. _____ Range No. _____ of the Gila and Salt River base and meridian, Arizona, and that said Survey has been in all respects, to the best of our knowledge and belief, well and faithfully executed, and the boundary monuments placed according to the instructions furnished by the Surveyor General.

Edward J. Williams Chainman.
John J. McDonald Chainman.
John Moore Axeman.
John Moore Flagman.

SWORN TO AND SUBSCRIBED before me this 18th day of July 1883.

Solon W. Allen
Notary Public Pima Co. A. T.

I, Solon W. Allen U. S. Deputy Surveyor, do solemnly swear that, in pursuance of instructions from the U. S. Surveyor-General for Arizona, bearing date the 11th day of July 1883, I have well, faithfully and truly, in my own proper person, and in strict conformity with the instructions furnished by the Surveyor-General and the laws of the United States, surveyed all those portions of The Little Menarch Mining Claim claimed by The Catobi Cons Mining Co. located in Catobi Mining District, Pima County, Arizona, as are represented in the foregoing field-notes as having been surveyed under my directions; and I do further solemnly swear that all the corners of said surveys have been established and perpetuated in strict accordance with the instructions furnished me, and that the foregoing are the true and original field notes of such surveys.

Solon W. Allen Deputy Surveyor.

SWORN TO AND SUBSCRIBED before me this 26th day of July 1883.

Anthony Coenen
Notary Public
Pima Co. A. T.



AFFIDAVIT OF FIVE HUNDRED DOLLARS IMPROVEMENTS.

We, John Moore and Edward J. Williams

of lawful age, being first duly sworn according to law, depose and say that we are acquainted with the

Little Monarch mining claim, situated in

Cababi Mining District, Pima County, Arizona

Territory, for which The Cababi Lumber and Mining Co

has made application for survey prior to application for patent under the provisions of the Act of Congress approved May 10, 1872, and that the labor done and improvements made thereon by the applicants and their grantors exceed Five Hundred Dollars in value, and further that we are not personally interested in said mine.

John Moore
Edward J. Williams

TERRITORY OF ARIZONA,
County of Pima } SS.

SWORN to and subscribed before me, this 18th day

of July 1883

Solom M. Allen

Little Monarch.

Location Notice. - Notice is hereby given, That the undersigned, in compliance with the requirements of the Mining Act of Congress, approved May 10, 1872, has this day relocated and claimed 1500 hundred linear feet along the course of this lead, lode or vein of mineral bearing quartz and 300 feet in width on each side of the middle of said lead, lode or vein, situate in the Carbabi Mining District, County of Pima, Arizona, and more particularly described as follows, to-wit: Commencing at this monument of stones, being the center of the Easterly end of claim and upon which this notice is posted; thence Southerly (300) three hundred feet to a monument of stones; thence Westerly (1500) fifteen hundred feet to a monument of stones; thence Northerly (300) three hundred feet to a monument of stones, being the center of Westerly end of claim; thence Northerly (50) fifty feet to a monument of stones; along Southerly line and joining Petanke's claim; thence Easterly (1500) fifteen hundred feet to a monument of stones; thence Southerly (50) fifty feet to place of beginning.

This claim is parallel to the Petanke on the South and about 400 yard from the old Picacho mine, and is a relocation of the same property heretofore located by P. J. Dowling, H. W. Littlefield, R. L. Wood and Frank Williams, by the undersigned now the owner of the same by purchase, to correct errors made in former location. - First Location January 21, 1868

10

recorded in Book S. of mining claims, Pima County
Arizona, Page 349, and shall be known as the
Little Monarch Mine. Relocated Jan'y 24, 1883.
H. W. Littlefield

Witness John Moore

Filed and recorded at request of John Moore
Feb'y 1st A.D. 1883, at 4 P.M.

Chas R Drake
County Recorder.

Book Q Records of Mines, Pages 500 & 501.

Notice is hereby given that the undersigned to correct
manifest errors in the above notice of location
and to better comply with the law relative
to describing locus of claims, does hereby
Amend said notice of location as follows:

The distance from initial monument at the South
East End of the Claim to the N.E. corner and to
side line of Petancke claim is 97 ft. and also
At N.W. End of claim the distance from middle
monument of claim to N.W. cor of claim and
side line of Petancke is 97 ft.

This claim lies parallel and along the
South side of the Petancke claim, and lies about
3/4 of a mile SW of the old Picacho Mine
instead of 1000 yards =

Amended
at Cababi July 13, 1883.

The Cababi Consolidated Mining Company
By Chas R Drake Agent.

Chas R Drake

July 25th
A. D. 1883

T. R. Coe of Mine

Book
Pages 310 311 & 312.

Chas R Drake

County Recorder

U. S. Surveyor General's Office,

Tucson, Arizona, Aug 2^d 1883

The foregoing field notes of the survey of the Little Monarch
 Mining Claim situate in
 the Coabati Mining District, Pima
 County, Arizona, claimed by The Coabati Iron Mining
Co.
 survey executed by Solan M. Allis Deputy
 Surveyor, under instructions from this office, having been critically examined
 and the necessary corrections and alterations made, the said field notes and
 the survey they describe are hereby approved.

J. W. Robinson
 Surveyor General.

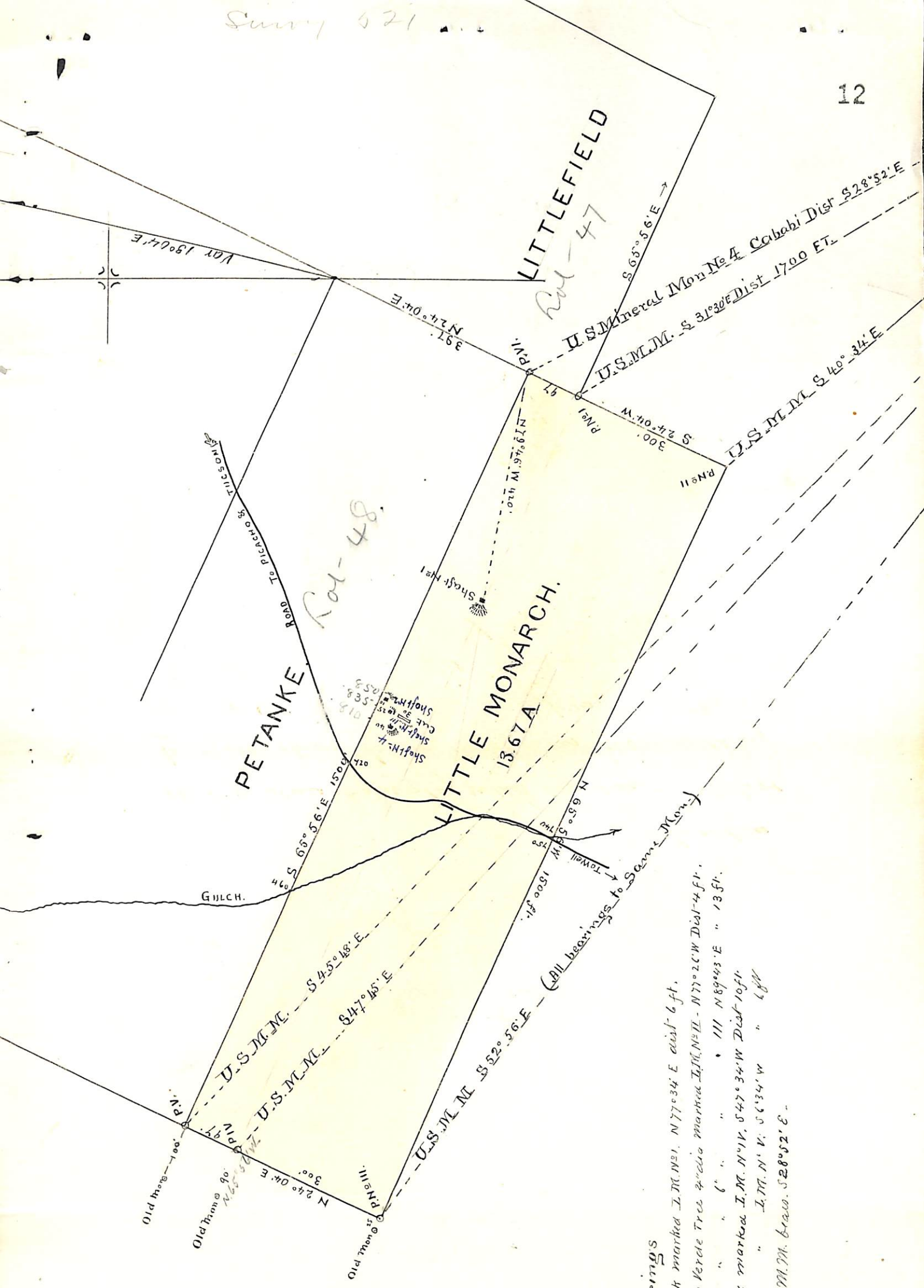

- Bearings
- From Post No 1. to Rock marked I.M. No 1. N 77° 34' E dist 6 ft.
 - " " " Palo Verde Tree 4" dia marked I.M. No 2. N 77° 20' W Dist 4 ft.
 - " " " Palo " " " " " " III. N 89° 43' E " 13 ft.
 - " " " Rock marked I.M. No 1. S 47° 34' W Dist 10 ft.
 - " " " " " " " " I.M. No 1. S 61° 34' W " 4 ft.
 - " " " " " " " " U.S.M.M. base. S 28° 52' E.

LITTLEFIELD
Pet-47

PETANKE
Pet-48

LITTLE MONARCH
13.67 A

U.S.M.M. S 68° 56' E
U.S.M.M. S 31° 30' E Dist 1700 FT.
U.S.M.M. S 40° 34' E

Shaft No 1
Shaft No 2
Shaft No 3
Shaft No 4
Shaft No 5
Shaft No 6
Shaft No 7
Shaft No 8
Shaft No 9
Shaft No 10

Vox 180° 44' E

N 24° 04' E
391. PM I.

S 24° 04' W
300. PM II.

U.S.M.M. S 40° 34' E

GULCH.

Old Mon 100' P.V.
Old Mon 80' P.V.
Old Mon 75' P.V.

U.S.M.M. S 45° 48' E
U.S.M.M. S 47° 45' E

U.S.M.M. S 68° 56' E
U.S.M.M. S 62° 56' E

(All bearings to Same Mon.)