

M
S
-

0

0

6

1

4

LOT NO. 56

SURVEY NO. 614

Field Notes

of the Survey of the

"Rucker"

Mining Claim

Situate in Warren Mining District.

County of Cochise and in Sec. approx, T^p. 23S

Range 24E, of the Gila and Salt River Meridian.

ARIZONA.

Claimed by W. H. Martin

Survey executed by J. H. Hoadley U.S. D. S.

Under instructions dated January 30 1884

Survey commenced Febry 2 1884

Survey completed Febry 11 1884

3-222-4
123-
14-1243-10-3 parts
18 12 x 3 14 - parts

Survey of Rucker Mining

PRELIMINARY OATHS

FOR SURVEYS OF MINING CLAIMS AND MILL SITES.

WE, H. C. Stillman and John H. Blair
do solemnly swear that we will faithfully execute the duties of Chain Carriers: that we will level the chain upon uneven ground, and plumb the tally pins, whether by sticking or dropping the same; that we will report the true distance to all notable objects, and the true length of all lines that we assist in measuring, to the best of our skill and ability.

H. C. Stillman
J. H. Blair

SWORN to and subscribed before me, this 2nd day
of February 1884.

Sol Lippenberg
Notary Public.

I, _____
do solemnly swear that I will well and truly perform the duties of _____
_____ according to instructions given me,
to the best of my skill and ability.

SWORN to and subscribed before me, this _____ day
of _____ 188 _____

Field Notes of the Survey
of the Rucker Mining Claims,
Warren Mining District,
Cochise Co
Arizona

To the Hon. Royal A. Johnson
U. S. Surv. Gen. A. T.,
Tucson

Sir

I received instructions
from you to make a survey
of the Rucker Mining Claim
said instructions dated Jan. 30th
1884, and in compliance there-
with I send you the
accompanying Field Notes,
Plat, and affidavits.

Field Notes.

On the night of the 9th
of Feb. 1884., I took the Western
Elongation of the North Star,
by which I make the Variation
at this place to be
12° 5' E

The instrument used by me
in this work was a Transit and
the courses were taken "Magnetic"
and reduced to the True Meridian
The readings were taken at
both ends of each line and
were found to correspond.

The Rucker Mining Claim was located in Aug 1877; and in the months of Sept or October 1880. was surveyed by Chas. Ackley at which time small posts (2"x4") were placed in the monuments.

The survey followed the original location, and the amended location notice was based upon the survey. This was followed by me as closely as possible.

At the Initial Monument of the Rucker Mining Claim, said Monument situated in the W. End Centre of said Claim, I placed in the ground a post 4"x4", 5 feet long and surrounded it with a monument of stones - said post being marked

R.M.I. I.M.,

From which post the

U. S. M. M. N^o 1

Bears

S. 61° 55' W.

Var. 12° 5' E.

to said Monument - This does not exactly correspond with the Amended Location Notice, - But, as this point is well established and the discrepancy is in the notice itself I adopted it as right.

From this Initial Monument -

N. 58° 40' W

Var. 12° 5' E

To Boundary Tree - an oak 14 inches in diameter marked

R.M.I. I.M. B.T.

8
16. 80
16. 48

10. 55

Field Notes of the Survey of the Rucker Mining Claim

Thence up the S slope of the hill
 to N. 24°. 25'. E S slope of the
 hill Var. 12°. 5'. E.
 225 cross small dry gulch and
 300 to N. W. Corner of the Claim
 and post 4" x 4" 5 feet long, set
 in the ground and surrounded
 by a monument of stones and
 Marked

B. M. II.

This corresponds with the stake
 of the Relocation Notice

From said Monument
 S. 45°. 50'. W.

Var. 12°. 5'. E.
 44. to Boundary Tree, an Oak
 10 inches diameter Marked

B. M. II. B. I.

and, also

N. 26°. 30'. E.

Var. 12°. 5'. E.
 42 to Second Boundary Tree, an Oak
 7 inches diameter, Marked
 B. M. II. B. I.

Thence along the S slope of the
 hill

S. 79°. 30'. E.

Var. 12°. 5'. E.

60 to dry gulch
 350 to Summit on line
 570 leave summit on line and descend
 E. slope

955 to centre gulch
 1060 to Summit point on line
 1130 to centre Creek (Alum Creek)

1140 Cross wood road and ascend
 W. slope of hill

1367 to N E Corner of Claim and
 post 4 x 4" set in the ground
 at the Ackley survey Monument
 said post being Marked

R.M. III.

It being also on the site of the original monument of the claim

From this Monument
S. 7° E

Var. 12° 5' E.

27 to Boundary Tree - an Oak 4 inches in diameter marked

R.M. III, B.T.

There are no other trees or prominent rocks in the vicinity

Thence along the W. slope of hill

S. 24° 25' W.

Var. 12° 5' E.

117 to Summit - on line and descending S.W. slope

292 to E. End Centre of the claim and post 4x4, 5 feet long set in the ground and surrounded with a monument of stone and marked

R.M. IV.

From this monument

S. 80° E.

Var 12° 5' E

4 to the Achley stake and monument and

N. 22° E.

Var. 12° 5' E.

162 to Boundary Tree, an Oak 4 1/2 inches diameter marked

R.M. IV, B.T.

There are no other trees or prominent rocks in the vicinity

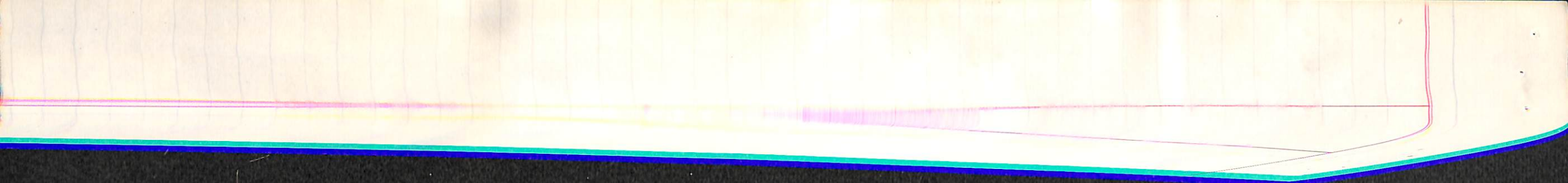

Field Notes of the Survey of the Rucker Mining Claim

- Thence descending the S. W. Slope
of the hill
S. 24° 25' W.
Var. 12° 5' E.
- 291 to the S. E. Corner of the claim
and first 4' x 4" 5 feet long
set in the ground and surround-
-ed by a monument of stone
and marked
B. M. V.
- From which Monument
S. 80° 30' E
Var. 12.5 E
- 13 to the Original Monument and
stake of the Ackley Survey
and
S. 6° 55' E.
Var 12° 5' E
- 16 to Boundary Tree - an Oak
7 inches in diameter, marked
R. M. V. B. T
and also
N. 62° 25' W
Var. 12° 5' E.
- 24 to second Boundary Tree - an Oak
12 inches diameter, marked
R. M. V. B. T.
- Thence up the Valley of the
Mule Pass Creek
N 80° 12' W.
- 46 to Alum Creek Bottom
11 6 leave Alum Creek Bottom
13 1 Cross Wood Road
33 6 Cross Bold Iron Crossings
67 1 Cross Bold Iron Crossings
96 0 Centre of Mule Pass creek
10 2 6 Centre of Road
13 7 1.3 to S. W. Corner of Claim
and first 4' x 4" 5 feet long set
in the ground and surrounded

with a monument of stone
and marked

B.M. VI.

From which Monument
S. 24°. 25' W.

Var. 12°. 5' E.

29 to the Ackley Monument and
stake

and

N. 69°. 55' W.

Var. 12°. 5' E.

82.2 to the S E corner of the
Copper Queen Mining Claim Lot no 87

and

S. 55°. 35' E.

Var. 12°. 5' E.

584.3 To N.W. Corner of the ^{Sec 27⁰ 53} Holbrook
Mining Claim. There are no trees
in the vicinity
Thence descending N. E. Slope of
hill

N. 24°. 25' E

210 to Centre of Var 12.5 E

210 to Centre of Road and Mule
Pass Creek and up South
slope of hill

300 to the Initial Monument and
place of Beginning

Containing

18 ²/₁₀₀ Acres.

Improvements and Workings

From the Initial Monument
Marked

B.M. I. I.M.

N. 44°. 55' E

Var. 12.5. E.

17 to shaft No 1. Said shaft being
4 x 6 and 42 feet deep

9
7

Field Notes of the Survey of the Rucka Mining Claim

And

N. 51°. 15'. E.
Var. 12°. 5'. E.

70 to shaft N^o 2, said shaft being
4x6, and 5 feet deep

And

S. 45° E
Var. 12°. 15'. E.

88 to shaft N^o 3. said shaft being
4x6 and reported as being 50 feet
deep with a drift running
northerly from the same -
Being filled with water to
within 14 feet of the surface
it is impossible to measure or
to determine the course of the
drift -

All these workings
were made by the grantors
of the present owner - and
I estimate the amount
expended upon them exceeds
in value five hundred dollars
(\$500⁰⁰)

From post marked
R. M. VI.

N. 84. 25. E
Var. 12. 5. E

172 to S. W. Corner of an Ocatilla
house, size about - 12x14 - and said
to have been erected by the
former owners of the claim

There are no other workings
or improvements upon the claim

Field Notes of the Survey of the Rucker Mining Claim

Description of the Claim

It is Bounded as follows
 On the N. side by Vacant
 U. S. land - or unknown claims
 and owners

On the E. End by unknown
 claims and owners - and the
 Dividend Mining Claim

On the S. Side by the
 Dividend and Wedge Mining
 claims and

On the W. End by the
 Copper Ore, and the Iron
 Monster Mining claims

It is situated to the E.
 of the town of Bisbee - in the
 valley and on the slopes of
 the hills through which runs
 Mule Pass Creek: - by far
 the larger portion being to
 the N. of said creek

The country rock North of
 Mule Pass Creek is Porphyry
 and on the south Limestone

Iron droppings (in place)
 are found in almost all
 parts of the claim to the
 North of the creek. Samples
 of which are sent to you marked
 Rucker No 1

While those from the workings are
 marked Rucker No 2

Survey Commenced Feb 2^d 1884.

" Completed Feb 11th 1884.

All of which is respectfully submitted

J. H. Hoadley

Bisbee Mar 11/84

U. S. Dept. Min. Surv

FINAL OATHS FOR SURVEYS OF MINING CLAIMS & MILL SITES.

A LIST of the names of individuals employed to assist in running, measuring, or marking the lines and corners described in the foregoing field-notes of the survey of Rucker Mining Claim located in Warren Mining District, Cochise County, Arizona, showing the respective capacities in which they acted.

A. C. Stillman Chainman.
John W. Blair Chainman.
Axeman.
Flagman.

WE hereby certify that we assisted J. H. Hoadley U. S. Deputy Surveyor, in surveying the Rucker Mining Claim claimed by W. H. Martin located in Warren Mining District, Cochise County, and in Township No. _____ Range No. _____ of the Gila and Salt River base and meridian, Arizona, and that said survey has been in all respects, to the best of our knowledge and belief, well and faithfully executed, and the boundary monuments planted according to the instructions furnished by the Surveyor General.

A. C. Stillman Chainman.
J. W. Blair Chainman.
Axeman.
Flagman.

SWORN TO AND SUBSCRIBED before me this 11th day of February 1884.

Sol. Sonnenberg
Notary Public.

I, J. H. Hoadley U. S. Deputy Surveyor, do solemnly swear that, in pursuance of instructions from the U. S. Surveyor-General for Arizona, bearing date the 30 day of January 1884, I have well, faithfully and truly, in my own proper person, and in strict conformity with the instructions furnished by the Surveyor-General and the laws of the United States, surveyed all those portions of the Rucker Mining Claim claimed by W. H. Martin located in Warren Mining District, Cochise County, Arizona, as are represented in the foregoing field-notes as having been surveyed under my directions; and I do further solemnly swear that all the corners of said surveys have been established and perpetuated in strict accordance with the instructions furnished me, and that the foregoing are the true and original field notes of such surveys.

J. H. Hoadley Deputy Surveyor.

SWORN TO AND SUBSCRIBED before me this 11th day of February 1884.

Sol. Sonnenberg
Notary Public.



LOCATION NOTICE.

NOTICE IS HEREBY GIVEN, that the undersigned, in compliance with the requirements of the Mining Act of Congress, approved May 10th, 1872,..... have this day located and claim fifteen hundred linear feet along the course of this lead, lode or vein of mineral bearing quartz, and three hundred feet in width on each side of the middle of said lead, lode or vein, ^{together with all its dips, offsets and angles} situate in the Warren Mining District, County of Cochise Territory of Arizona, and more particularly described as follows, to-wit,

COMMENCING at this monument of stones, being the center of the West End of claim, and upon which this notice is posted, from which monument the U. S. Mineral Monument No. 1 bears S. 69° 30' W. Twenty (20) feet thence South Westerly three hundred feet to a monument of stones; thence Easterly fifteen hundred feet to a monument of stones; thence North Easterly three hundred feet to a monument of stones, being the center of the East end of claim; thence North Easterly three hundred feet to a monument of stones; thence Westerly fifteen hundred feet to a monument of stones; thence South Westerly three hundred feet to the place of beginning.

THIS CLAIM was originally located on the second day of August 1877 by John A. Rucker, John Quinn & T. D. Byrns and Recorded in the Records of Pima County (in which County Warren Mining District was at such time situated) in Book 13 page 695 on the 29th day of August 1877 and called the Rucker Mine. This present location covers the same ground as the location of Aug. 2, 1877 and is made for the purpose of more clearly defining the boundary lines

and shall be known as the _____ Mine.

Located 188

The West end center of this claim is situated about 200 ft Easterly from the East end center of the Copper Queen Mining Claim and about 400 ft North Easterly of the N.E. corner of the Atlanta Mining claim; the S.W. corner is situated about 80 ft North Easterly from the S.E. corner of the Copper Queen Mining Claim and about 190 ft Easterly from the N.E. corner of the Atlanta Mining claim.

This claim shall be known as the Rucker Mine.

Located January 18th 1884

W. H. Martin

Recorder's Office,

TOMBSTONE, Cochise Co., A. T.

Filed and recorded at request of

Ben Williams

Jan 19 A. D. 1884

at 11 30 A. M.

Book 4 Rec of Minn

Pages 325

W. Jones

County Recorder.

LOCATION NOTICE.

NOTICE IS HEREBY GIVEN, that the undersigned, in compliance with the requirements of the Mining Act of Congress, approved May 10th, 1872,..... have this day located and claim fifteen hundred linear feet along the course of this lead, lode or vein of mineral bearing quartz, and three hundred feet in width on each side of the middle of said lead, lode or vein, ^{together with all its dips, offsets and angles} situate in the Warren Mining District, County of Cochise Territory of Arizona, and more particularly described as follows, to-wit,

COMMENCING at this monument of stones, being the center of the West End of claim, and upon which this notice is posted, from which monument the U. S. Mineral monument No. 1 bears S. 69° 30' W. twenty (20) feet thence South West three hundred feet to a monument of stones; thence Easterly fifteen hundred feet to a monument of stones; thence North Easterly three hundred feet to a monument of stones, being the center of the East end of claim; thence North Easterly three hundred feet to a monument of stones; thence Westerly fifteen hundred feet to a monument of stones; thence South West three hundred feet to the place of beginning.

THIS CLAIM was originally located on the second day of August 1877 by John A. Rucker, John Dumas & T. D. Byrns and Recorded in the Records of Pima County (in which County Warren Mining District was at such time situated) in Book 13 page 695 on the 29th day of August 1877 and called the Rucker Mine. This present location covers the same ground as the location of Aug. 2, 1877 and is made for the purpose of more clearly defining the boundary lines and shall be known as the _____ Mine.

Located 188

The West end center of this claim is situated about 200 ft Easterly from the East end center of the Copper Dumas Mining Claim and about 400 ft North Easterly of the N.E. corner of the Atlanta Mining claim; the S.W. corner is situated about 80 ft South Easterly from the S.E. corner of the Copper Dumas Mining Claim and about 190 ft Easterly from the N.E. corner of the Atlanta Mining claim.

This claim shall be known as the Rucker Mine

Located January 18th 1884

W. H. Martin

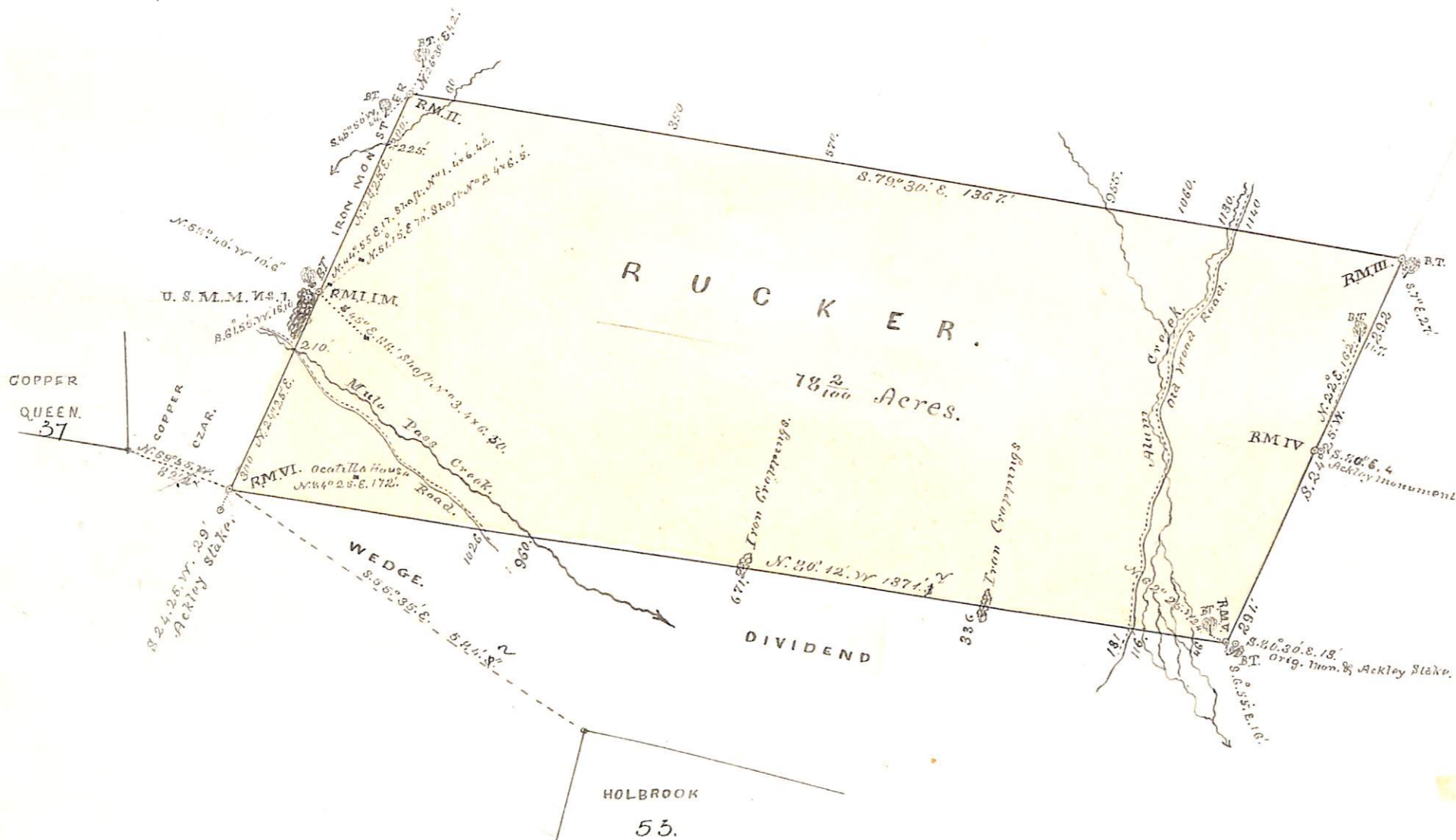

THE
RUCKER MINING CLAIM

Warren Mining District,
 Cochise Co.,
 Ariz.

March 11th 1884.

J. H. Moadley,
 US Dept. Min. Surv.

U. S. Surveyor General's Office.

Tucson, Arizona, March 21st 1884

The foregoing field notes of the survey of the Rucker
 Mining Claim situate in
 the Marion Mining District, Cochise
 County, Arizona, claimed by W. H. Martin

survey executed by J. A. Hoadley Deputy
 Surveyor, under instructions from this office, having been critically examined
 and the necessary corrections and alterations made, the said field notes and
 the survey they describe are hereby approved.

Royal A. Johnson
 Surveyor General.