

M
S
-

0

0

6

3

0

LOT NO. 40

SURVEY NO. 630

Field Notes

of the Survey of the

Flores

Mining Claim

Situate in Yavapai Mining District.

County of MoHAVE and in Sec. 7, T_p 22 N.

Range 17 W., of the Gila and Salt River Meridian.

ARIZONA.

Claimed by W. C. Parsons.

Survey executed by O. F. Kuencer. D. S.

Under instructions dated April 24th 1884

Survey commenced May 5th 1884

Survey completed " 6th 1884

PRELIMINARY OATHS,

FOR SURVEYS OF MINING CLAIMS AND MILL-SITES.

WE, Geo Daugherty and H. H. Partridge

do solemnly swear that we will faithfully execute the duties of Chain Carriers; that we will level the chain upon uneven ground, and plumb the tally pins, whether by sticking or dropping the same; that we will report the true distance to all notable objects, and the true length of all lines that we assist in measuring, to the best of our skill and ability.

Geo Daugherty
H. H. Partridge

SWORN to and subscribed before me, this 5th day

of May ad. 1884

John H. MacKenzie
Clerk Dist Court Mohave County Arizona

I, O. F. Knences U. S. Deputy m. Surveyor

do solemnly swear that I will well and truly perform the duties of U. S. Deputy

General Surveyor according to instructions given me,

to the best of my skill and ability.

O. F. Knences U. S.
Deputy m. Surveyor

SWORN to and subscribed before, me this fifth day

of May 1884

John H. MacKenzie
Clerk District Court
Mohave County Arizona Terr

Field Notes
 of Survey.
 Flores Mining Claim
 in the
 Wallacepai Mining District
 County of Mohave
 Territory of Arizona
 Claimed by
 W. C. Parsons
 Surveyed by
 O. F. Kneives U.S. Deputy
 Mineral Surveyor
 of date of May 5th and 6th 1884

- Description of Survey. -

Beginning at the initial
 men. mentioned in the
 location notice, and marking
 the centre of claim on
 middle of vein, where I set
 a post 5 ft. long $3\frac{1}{2}$ by $2\frac{1}{2}$
 in. dia. 1 ft. in the ground,
 and surrounded the same
 with a mound of stones;
 Post marked:

F. I. M. 1.

Large Granite boulder, marked:

F. I. M. 1. B. P. bear

N. $54^{\circ} 20' E$

76 ft.

Main shaft, 100 ft. deep on Flores
 mine, bears: S $25^{\circ} 40' E$. 169.5 ft.

Mouth of Tunnel, on Flores
 mine, 650 feet long, bears
 N $25^{\circ} 40' W$. 91 feet.

And southern end of an open
 end, on Flores mine, 50 feet
 long and ten {10} feet deep at
 North end of end bears:

N $27^{\circ} 50' W$. 280 feet.

Feet.

Thence:
N. 64° 20' E.
Var. 14° 20' E

295.⁵ To loc. mon. where I set
a post 3 ft. long, 3 1/2 by 2 1/2
ins. dia. 1 ft in the ground.
and surrounded same with
mound of stones;
Post marked: F. 2.
A granite stone 8 ins. wide
16 ins. long, 1 ft in the ground,
marked: F. 2. B.P. bears
N 1° 10' W. 113 ft.

Thence:
N. 25° 40' W
Var. 14° 20' E

175 To Ravine, bears N. and S.

750 To loc. mon. where I set
a post 3 ft. long, 3 1/2 by 2 1/2
ins. dia. 1 ft in ground, and
surrounded the same with
a mound of stones.
Post marked: F. 3.
Large Granite boulders, 2 feet in
ground marked F. 3 B.P.
Bears N. 18° 25' E 110 ft.
Location. mon. on Washington
mining claim
bear N. 81° 10' E 455 ft.

Thence:
S 64° 20' W
Var. 14° 20' E

595.⁵ To loc. mon. where I set a
post 3 ft. long, 3 1/2 by 2 1/2 ins. dia.
1 ft in ground, and surrounded
same, with mound of stones
Post marked: F. 4.

Feet

Large granite stone in place
marked "F. 4. B.P."
bears $N 21^{\circ} 18' W$. 72 ft.

Thence:

 $S 25^{\circ} 40' E$.Var. $14^{\circ} 20' E$

565 To wagon road, bears N.W. and S.E.
687 To Ravine, bears N.W. and S.E.
1500 To loc. mon. where I set a

post 3 ft. long, $3\frac{1}{2}$ by $2\frac{1}{2}$ ins.
dia. 1 ft in ground and sur-
rounded same with mound
of stones. Post marked: F. 5.

Granite boulder marked: F. 5. B.P.
bears: $N 84^{\circ} 05' E$. 170 ft.

Large Pine tree on top of highest
peak, south of town of Cerbat
bears: $S 31^{\circ} 30' E$.

Thence:

 $N 64^{\circ} 20' E$ Var. $14^{\circ} 20' E$.

595 To loc. mon. where I set a post
3 ft. long $3\frac{1}{2}$ by $2\frac{1}{2}$ ins. dia. 1 ft.
in ground, and surrounded same
with mound of stones. Post
marked: F. 6.

Large Granite stone in place
marked F. 6. B.P.

bears $S 4^{\circ} 20' W$. 46 feet.

Cor. to sec. 6, 7, 5 and 8,

Tp. 22. N. R. 17 W

bears $N 23^{\circ} 55' E$. 2876 ft

South East corner of Cerbat mining
Claim, surveyed for a patent
Oct 18th and 19th 1880.

bears $N 15^{\circ} 45' E$. 1395 ft.

Thence:

 $N 25^{\circ} 40' W$

Feet

Var. $14^{\circ}20'$ E.
750 To loc. mon and post marked
F. 2.

Area.

Total Area of claim $20 \frac{50}{100}$ acres.

Location.

This claim is located in Section
7. T_p. 22 N. R. 17 W

Improvements.

made upon this claim by
claimant and grantors consist
of shaft, 6 by 7 ft, 100 ft deep,
 $S25^{\circ}40'$ E. 169⁵ ft. from post
marked F. I. M. 1.

A Tunnel 350 ft. long, the mouth
of which bears $N25^{\circ}40'$ W. 91 ft
from Post marked F. I. M. 1.

An open cut, 50 ft. long, 10 ft. deep,
 $N.27^{\circ}50'$ W. 280 ft from Post marked
F. I. M. 1.

And I hereby certify that the
value of said improvements
exceeds the sum of five hundred
dollars.

No other improvements were
made upon the mine by anybody
else.

The corner monuments on east
side of centre of vein, were found
295⁵ feet from centre of vein, by the
locators, which accounts for the
discrepancy between this field
notes and notice of location
Instruments used: a theodolite
and Brightly Transit and
Steel chain.

Variation taken from the
North Star.

Mineral Park O. J

May 10th 1884

O. J. Knences

Depty. U. S. Mineral
Surveyor.

FINAL OATHS FOR SURVEYS OF MINING CLAIMS & MILL SITES.

A LIST of the names of individuals employed to assist in running, measuring, or marking the lines and corners described in the foregoing field-notes of the survey of the Flores mine

located in Wallapai Mining District, Mohave County, Arizona, showing the respective capacities in which they acted.

Henry H. Partridge Chainman.
George Dougherty Chainman.
Axeman.
Flagman.

WE hereby certify that we assisted Otto F. Kuencer U. S. Deputy Surveyor, in surveying the Flores mine

claimed by W. C. Parsons located in the Wallapai Mining District, Mohave County, and in Township No. Range No. of the Gila and Salt River base and meridian, Arizona, and that said Survey has been in all respects, to the best of our knowledge and belief, well and faithfully executed, and the boundary monuments planted according to the instructions furnished by the Surveyor General.

Henry H. Partridge Chainman.
George Dougherty Chainman.
Axeman.
Flagman.

SWORN TO AND SUBSCRIBED before me this eight day of May 1884

John N. MacKenzie
Clerk 3^d Jud^l Dist Court
Mohave County Arizona Territory

I, Otto F. Kuencer U. S. Deputy Surveyor, do solemnly swear that, in pursuance of instructions from the U. S. Surveyor-General for Arizona, bearing date the 24th day of April 1884, I have well, faithfully and truly, in my own proper person, and in strict conformity with the instructions furnished by the Surveyor-General and the laws of the United States, surveyed all those portions of the Flores mining claim

claimed by W. C. Parsons located in Wallapai Mining District, Mohave County, Arizona, as are represented in the foregoing field-notes as having been surveyed under my directions; and I do further solemnly swear that all the corners of said surveys have been established and perpetuated in strict accordance with the instructions furnished me, and that the foregoing are the true and original field notes of such surveys.

O. F. Kuencer Deputy Surveyor.

SWORN TO AND SUBSCRIBED before me this eight day of May 1884

John N. MacKenzie
Clerk 3^d Jud^l Dist Court
Mohave County, Arizona Territory



AFFIDAVIT OF FIVE HUNDRED DOLLARS IMPROVEMENTS.

We, *William G. Blakely* and *Henry Raymond*,

of lawful age, being first duly sworn according to law, depose and say that we are acquainted with the

Flores mining claim, situated in *the Wallapai* Mining District, *Mohave* County, Arizona Territory, for which *W. C. Parsons* ~~is~~

has made application for survey prior to application for patent under the provisions of the Act of Congress approved May 10, 1872, and that the labor done and improvements made thereon by the applicant and his grantors exceed Five Hundred Dollars in value, and further that we are not personally interested in said mine.

Wm G. Blakely
Henry Raymond

TERRITORY OF ARIZONA,
County of *Mohave* } SS.

SWORN to and subscribed before me, this *Eight* day
of *May* 188*4*

John K. Mackenzie
clerk 3^d Jud^t Dist Court
Mohave County, Arizona Terr

The undersigned hereby claims fifteen hundred (1500) feet along the course of this vein or lode and three hundred 300 feet on each side of the middle of the vein at the surface for mining purposes, together with all the rights and privileges conferred by the mining act of may 10th 1872.

Said claim is situated about one mile westerly from the town of berbat, and about one half ($\frac{1}{2}$) mile Easterly from the Ranch known as "Smiths milk Ranch", it being immediately North of the road leading from said town to said ranch, and near what is known as "Morans Furnace".

Said claim shall be known as the "Flores" and is particularly described as follows, to wit:

Commencing at this notice which is posted on a monument four feet high near the discovery shaft - running thence Easterly three hundred feet to a monument of stones four feet high, thence Northerly parallel with the vein Seven hundred

and fifty feet to a monument of stones
four feet high, thence westerly crossing ¹¹
the vein at right angles six hundred feet
to a monument of stones four feet high,
thence southerly parallel with the vein
fifteen hundred feet to a monument
of stones four feet high, thence Easterly
crossing the vein at right angles six
hundred feet to a monument of stones,
thence northerly parallel with the vein
seven hundred and fifty feet to the
second monument mentioned in this
Notice.

Concepsion Gross 1500 feet

Dated on the ground in Wallapai
Mining District, Mohave County, Arizona
Territory, February 7th A.D. 1879.

Witness Wm G. Blakely

Recorded at the request of Charles
Gross March 25th A.D. 1879 at 10 A.M.

Baldwell Wright
County Recorder

Recorded in Book D. pages 462
& 463 Mining Records of Mohave County,
Arizona, Territory

Charles Gross and Concepcion Gross
To W. C. Parsons

Date March 27th 1884

Consideration One thousand dollars.

Acknowledged by Concepcion Gross
March 27th 1884 and by Charles Gross
April 12th 1884.

Recorded April 12th 1884 at 9 P. M.

+ + + + +

Grant bargain sell remise release
and forever quietclaim unto the
said party of the second part and
to his heirs and assigns: All the
right title and interest of in and to
that certain mining claim of quartz
rock, situate lying and being about
one mile westerly from the town of
Leebat, and about one half mile
easterly from the ranch known as
Smith's milk ranch and being im-
mediately north of the road leading
from said town to said ranch,
and near what is known as Moran
Furnace, and called the Flores
mine, in Wallapai mining district
Mohave county Arizona Territory

13

Said mining claim being fifty¹³
hundred feet in length and
six hundred feet in width and
was located by Concepcion Gross
on the 7th day of February 1879
and is recorded in Book D, page
462 & 463 Mining Records of
Mohave County. + + + +
+ + + + + + + +
+ + + + + + + +

Acknowledgment of Concepcion Gross
a married woman, taken accord-
ing to law before J. K. Mackenzie, Clerk
of 3rd Dist. Court Arizona Territory
+ + + + + + + +

Acknowledgment of Chas. Gross,
by witness John M. Murphy taken
according to law by J. K. Mackenzie
Clerk of above named Court.
+ + + + + + + +

Recorded in Book 8, pages 47 & 48
Mining Records of Mohave County
Arizona Territory.

U. S. Surveyor General's Office.

Tucson, Arizona, May 29 - 1881.

The foregoing field notes of the survey of the Flores
Mining claim situate in
 the Wallapai Mining District, Mohave
 County, Arizona, claimed by W. C. Parsons

survey executed by O. F. Kueucer Deputy
 Surveyor, under instructions from this office, having been critically examined
 and the necessary corrections and alterations made, the said field notes and
 the survey they describe are hereby approved.

Royal A. Johnson
 Surveyor General.

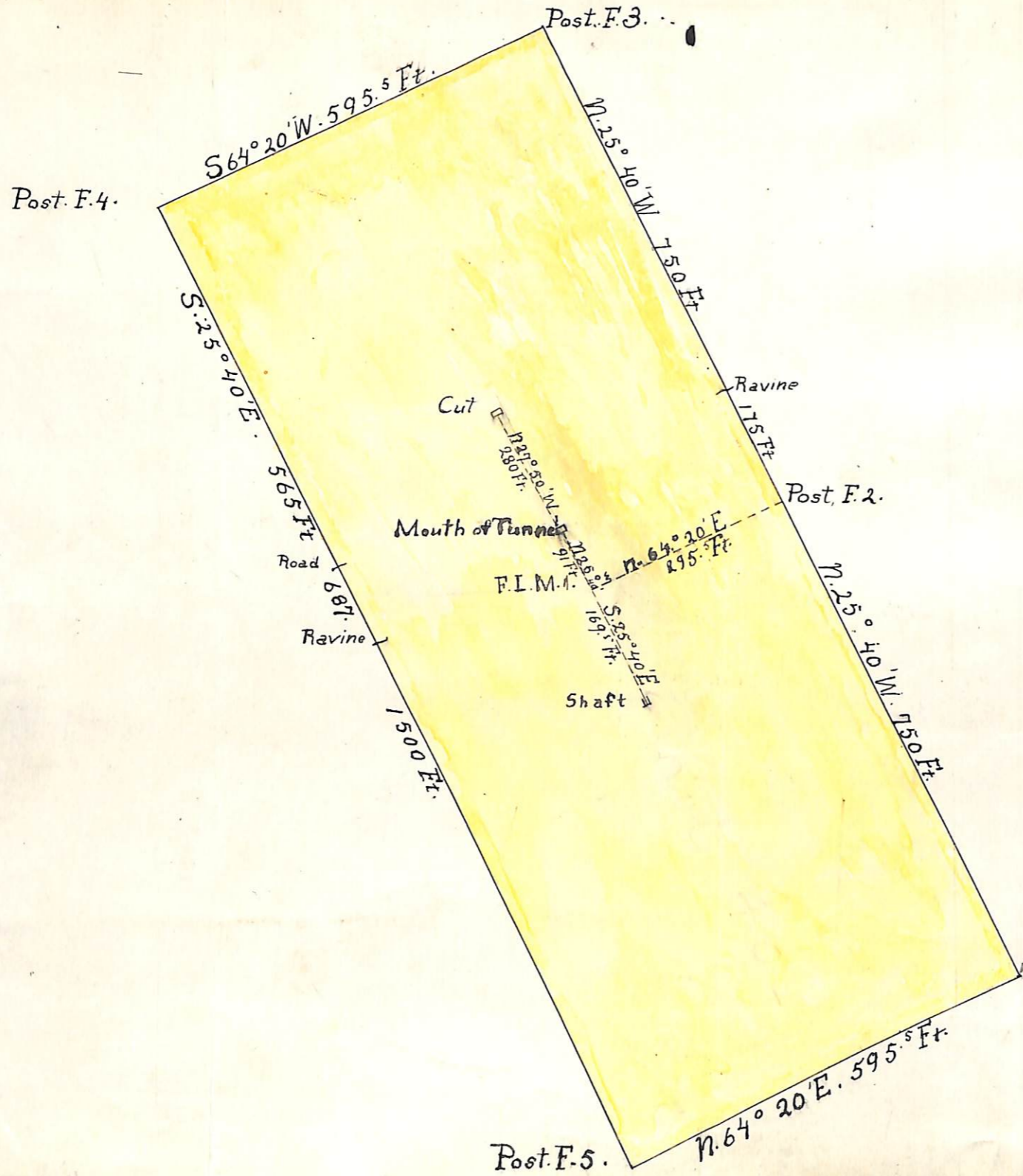

S.E. cor. Cerbat Mine.

PLAT

of the

FLORES

MINING CLAIM

Situate in Wataapai Mining District

Mohave County

Sec. 7; T₂₂; NR 17. W. G. and S. R. M.

Arizona.

Claimed by W. C. Parsons.

Surveyed by O. F. Kuencer, U. S. Deputy S.

May 5 and 6. 1884.

Containing 20 ⁵⁰/₁₀₀ Acres

Scale 200 Ft. to an inch.

Variation, 14° 20' E