

MS -

0

0

7

5

4



LOT NO. 46

SURVEY NO. 754

Field Notes

of the survey of the

California.

Mining Claim

Situate in Oro Blanco Mining district

County of Pima and in Sec. 11E, Tp. 23S 47S

Range 11E 76E, of the Gila and Salt River Meridian.

ARIZONA.

Claimed by S.S. Arnold Trustee.

The Oro Blanco Silver Mining Co.

Survey executed by A. W. Untchank D. S.

Under instructions dated December 31st 1885

Survey commenced January 4th 1886

Survey completed January 5th 1886



2

PRELIMINARY OATHS,

FOR SURVEYS OF MINING CLAIMS AND MILL-SITES.

WE, George Gilolo and Pedro Noriega

do solemnly swear that we will faithfully execute the duties of Chain Carriers; that we will level the chain upon uneven ground, and plumb the tally pins, whether by sticking or dropping the same; that we will report the true distance to all notable objects, and the true length of all lines that we assist in measuring, to the best of our skill and ability.

George Gilolo  
Pedro Noriega

SWORN to and subscribed before me, this Seventh day  
of January 1886

J. E. Curry  
Notary Public  
Pima Co  
A. T.

I, A. W. Muthank

do solemnly swear that I will well and truly perform the duties of U. S.

Dep. Min. Sur. according to instructions given me,

to the best of my skill and ability.

A. W. Muthank  
U. S. Dep. Min. Sur.

SWORN to and subscribed before, me this Seventh day  
of January 1886

J. E. Curry  
Notary Public  
Pima Co  
A. T.



feet-

# Field Notes of The Survey of The

3

California Mining Claim in  
The Oro Blanco Mining District  
Pima County, Arizona.

Claimed by The Oro  
The Oro Blanco S. M. Co.  
Surveyed by A. W. Unthank U.S.  
Deputy Mineral Surveyor, under  
instruction from the Surveyor  
General, of date Dec. 31<sup>st</sup> 1885

Survey Commenced Jan. 4<sup>th</sup> 1886  
" Completed " 5<sup>th</sup> 1886

## Description of Survey

Beginning at ~~The~~ Initial mon.  
~~being on the centre of ledge~~  
mentioned in location notice and  
marking the southern end centre  
of claim, where I set a walnut post  
4 ft. long 4 ins. dia. and surrounded  
same with mound of stones.

Post marked C. M. No. 1

Thence S 89° 48' E.

var. 12° 21' E. ~~from~~

300. To centre of California gulch  
bears S 21° 40' E.

300 To loc. mon. in centre of California  
gulch, where I set a walnut post  
4 ft. long 4 ins. dia. and surrounded  
same with mound of stones. Post  
marked C. M. No. 2 Willow tree  
14 ins. dia. marked C. M. No. 2 B. J.  
bears N 78° 30' E. 19.7 feet Oak tree  
7 ins. dia. marked C. M. No. 2 B. J.  
bears S 82° 50' W. 50 feet.

Thence N. 00° 12' E.

var. 12° 21' E. ~~from~~

475 To centre of California gulch  
bears S 31° 20' W.

1425 To loc. mon. where I set a walnut post  
4 ft. long 4 ins. dia. and surrounded  
same with mound of stones.  
Post marked C. M. No. 3



feet

300 Thence N. 89° 48' W.  
var. 12° 21' E,  
To loc. mon. for northern end centre  
of claim, where I set a walnut post  
4 ft. long 4 ins. dia. and surrounded  
same with mound of stones.

Post marked C. M. No. 4  
U. S. Mineral Monument No. 5  
bears S. 52° 23' W. 159 feet  
Thence N. 89° 48' W.

300 var. 12° 21' E,  
To loc. mon. where I set a walnut  
post 4 ft. long 4 ins. dia. and surrounded  
same with mound of stones  
Post marked C. M. No. 5

Thence S. 00° 12' W.  
var.

1425 To loc. mon. where I set a walnut  
post 4 ft. long 4 ins. dia. and surrounded  
same with mound of stones,

Post marked C. M. No. 6  
Thence S. 89° 48' E,  
var. 12° 21' E,

300 To mon. and post C. M. No. 1  
to place of beginning  
area

Total area of claim 19.63 acres

This claim is located on unsurveyed  
land in Oro Blanco Mining  
District - Pima County  
Arizona

Improvements  
made upon this claim by claimants  
or grantors consist of a shaft 4' x 7'  
100 ft. deep N. 6° 00' W. 81 ft. from Post  
C. M. No. 1 a shaft 4' x 6' 35 ft. deep  
N. 4° 00' W. 555 ft. from Post C. M.  
No. 1

And I hereby certify that the value  
of the improvements exceeds the sum  
of five hundred dollars



feet

There have been no improvements made by other parties on this claim

Instruments used a Keller & Brightly Transit and steel chain

Bar, and courses taken from a true meridian, which was established from observations on Polaris.

A. W. Anthony  
U. S. Deputy Mineral Surveyor

Gueson A. T. Jan. 12<sup>th</sup> 1886



AFFIDAVIT OF FIVE HUNDRED DOLLARS IMPROVEMENTS.

We, George Gilolo and J. B. McClenahan  
of lawful age, being first duly sworn according to law, depose and say that we are acquainted with the

California mining claim, situate in Arro Blanco  
Mining District, Pima County, Arizona  
Territory, for which S. S. Arnold Vice President Arro Blanco

S. M. Co has made application for survey prior to application for patent under the provisions of the Act of  
Congress approved May 10, 1872, and that the labor done and improvements made thereon by the appli-  
cant and grantor exceed Five Hundred Dollars in value, and further that we are not per-  
sonally interested in said mine.

George Gilolo  
J. B. McClenahan

TERRITORY OF ARIZONA,

County of \_\_\_\_\_

SS.

SWORN AND SUBSCRIBED before me, this twelfth  
day of January 1886.

J. E. Curry  
Notary Public  
Pima County  
AZ



FINAL OATHS FOR SURVEYS OF MINING CLAIMS AND MILL SITES.

A LIST of names of individuals employed to assist in running, measuring, or marking the lines and corners described in the foregoing field-notes of the survey of California mine.

located in Oro Blanco Mining district Pima County, Arizona, showing the respective capacities in which they acted.

George Gilolo Chainman  
Dedro Kriega Chainman  
 Axeman.  
 Flagman.

WE hereby certify that we assisted A. W. Unthank U. S. Deputy Surveyor, in surveying The California mine

claimed by Oro Blanco S. M. Co. located in Oro Blanco Mining District Pima County, and in township No. Range No. of the Gila and Salt River base and meridian, Arizona, and that said survey has been in all respects, to the best of our knowledge and belief, well and faithfully executed, and the boundary monuments planted according to the instructions furnished by the Surveyor General.

George Gilolo Chainman.  
Dedro Kriega Chainman.  
 Axeman.  
 Flagman.

SWORN TO AND SUBSCRIBED before me this Seventh day of January 1886

G. Phillips  
 Justice of the Peace  
 Precinct No 8

I, A. W. Unthank U. S. Deputy Surveyor, do solemnly swear that, in pursuance of instructions from the U. S. Surveyor-General for Arizona, bearing date the 31<sup>st</sup> day of Dec. 1885, I have well, faithfully and truly, in my own proper person, and in strict conformity with the instructions furnished by the Surveyor-General and the laws of the United States, surveyed all those portions California mine

claimed by S. S. Arnold Trustee located in Oro Blanco Mining District, Pima County, Arizona, as are represented in the foregoing field-notes as having been surveyed under my directions; and I do further solemnly swear that all the corners of said surveys have been established and perpetuated in strict accordance with the instructions furnished me, and that the foregoing are the true and original field-notes of such surveys,

A. W. Unthank Deputy Surveyor.

SWORN TO AND SUBSCRIBED before me this Seventh day of January 1886

G. Phillips  
 Justice of the Peace  
 Precinct No 8



# California Mine

## Location Notice

California Mine. Notice of Location Notice is hereby given that in pursuance of an Act of Congress dated May 10<sup>th</sup> 1872 the undersigned have this day located and claimed one claim of fifteen hundred feet (Linear) on this vein or lode of Mineral bearing ore and three hundred feet in width on each side thereof. Situated and described as follows to wit, Commencing at a Monument of Stones on the ledge on the Southerly end of Claim thence running easterly 300 feet to a monument of Stone thence running at right angles Northerly and parallel with the ledge fifteen hundred feet to Monument of Stones thence at right angles Westerly and crossing the ledge six hundred feet to a monument of Stones thence at right angles Southerly fifteen hundred feet to a Monument of Stones, thence at right angles easterly three hundred feet to place of beginning. This claim is about three quarters of a mile South east of the old town of Oro Blanco and is on the west side of the creek that runs east of the town. This Claim shall be known as the "California - Oro Blanco District Pima Co Arizona Territory Oct 18<sup>th</sup> 1877

{ A. H. Smith  
 B. A. Haraszthy



I hereby certify that the above notice is recorded in Book "A" of Mining records of Oro Blanco Dist Pima County A. T. on Page 27. Recorded Dec 20 1877

J. M. Kirkpatrick Recorder  
Filed and recorded at request of  
B. A. Haraszthy Dec 13 1878 at 11<sup>30</sup> A.M.  
S. W. Carpenter County Recorder  
By W. A. McDermott Deputy

County Recorder  
Book "D" Records of Mines Pages 472 & 473

Territory of Arizona }  
County of Pima }

O A. B. Sampson  
County Recorder in and for the County of  
Pima do hereby Certify that the above is  
a true Copy of the Location Notice  
of the "California" Mine of Oro Blanco  
District Pima County Arizona Territory.

In Witness Whereof I have  
herewith set my hand and  
affixed my official Seal  
This 19<sup>th</sup> day of January 1886  
A. B. Sampson

County Recorder

By Anthony Coenen  
Deputy





of  
**CALIFORNIA MINING CLAIM**

ORO BLANCO MINING DISTRICT  
PIMA COUNTY ARIZONA  
SURVEYED BY A.W. UNTHANK  
U.S. DEPUTY MINERAL SURVEYOR

JAN. 5<sup>th</sup> 1886

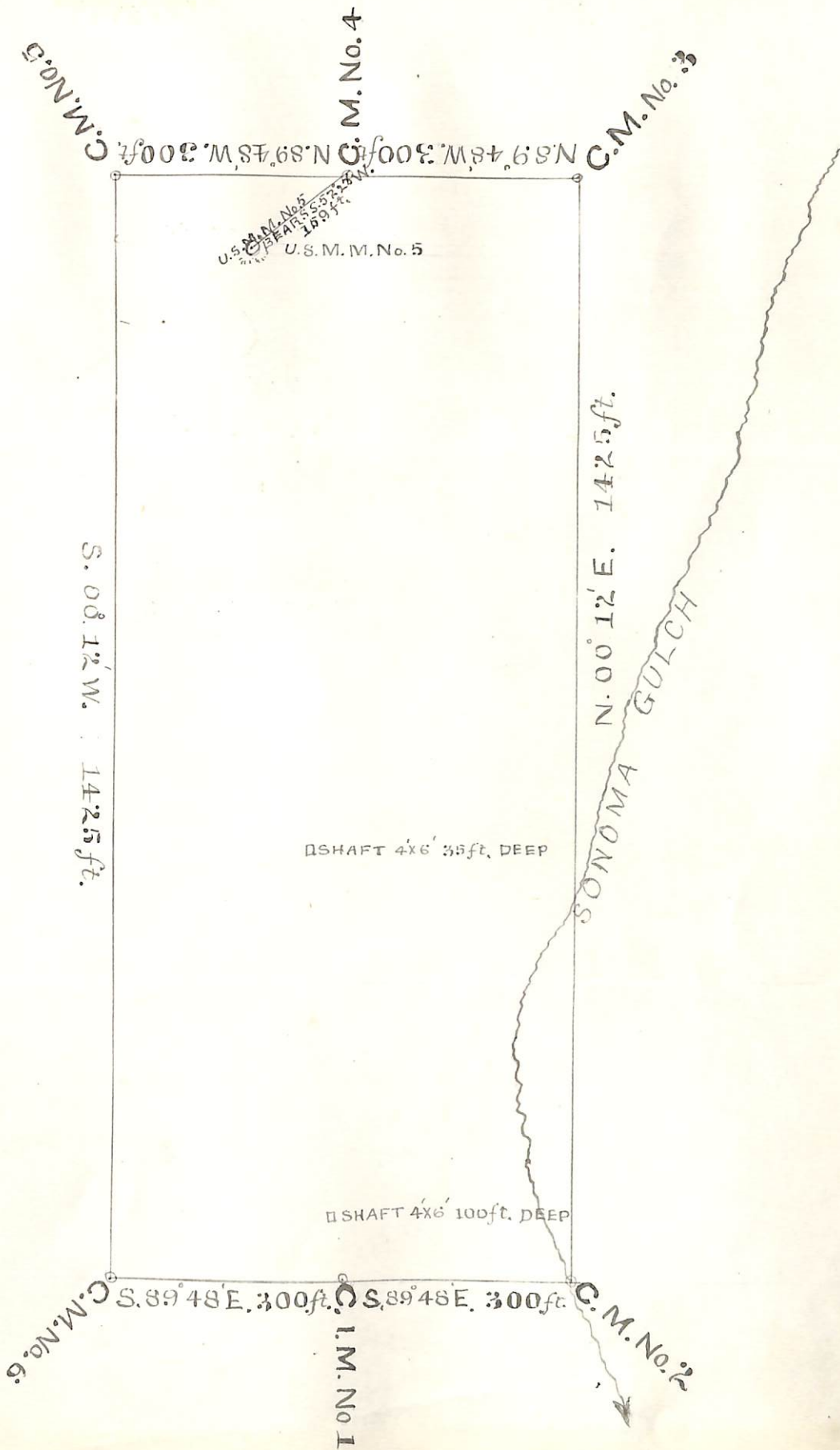



U. S. Surveyor General's Office  
Tucson Arizona  
January 23<sup>rd</sup> 1886.

The forgoing filed notes  
of the Survey of the  
California Mining  
claims situate in the  
Oro Blanco Mining  
District Pima County  
Arizona claimed by  
The Oro Blanco Silver Mining Co  
Survey executed by  
A. W. Vanthauk Deputy  
Mineral Surveyor  
under instructions from  
this office having been  
critically examined  
and the necessary  
alterations and  
corrections made, the  
said filed notes and  
the Survey they describe  
are hereby approved.

John Wise  
Surveyor General.