

MS
-

0

0

8

1

1

LOT NO. 196

SURVEY NO. 811

1139

FIELD NOTES

of the survey of the

Rattlesnake

Mining claim

Situate in Tombstone mining district,

County of Cochise and in Sec 14, Tp 20 S

Range NNE, of the Gila and Salt River Meridian.

ARIZONA.

Claimed by Waternole Mining Company

of Chicago

Survey executed by H. G. Howe D. S.

Under instructions dated March 29th 1887

Survey commenced April 1st 1887

Survey completed April 20th 1887

PRELIMINARY OATHS,

FOR SURVEYS OF MINING CLAIMS AND MILL-SITES.

WE, K. L. Hart, and Jas. H. Hart,

do solemnly swear that we will faithfully execute the duties of Chain Carriers; that we will level the chain upon uneven ground, and plumb the tally pins, whether by sticking or dropping the same; that we will report the true distance to all notable objects, and the true length of all lines that we assist in measuring, to the best of our skill and ability.

K. L. Hart

Jas. H. Hart

Sworn to and subscribed before me this 8th day
of March, 1887.

B. A. Fieser

Clk Dist Court

I, _____

do solemnly swear that I will well and truly perform the duties of _____
_____ according to instructions given me,
to the best of my skill and ability.

Sworn to and subscribed before me this _____ day
of _____, 188 .

Field Notes
of survey of the

Rattlesnake Mining Claim
in the Tombstone Mining District
Cochise County, Arizona.

Claimed by,
Watersale Mining Company of
Chicago.

Surveyed by A. G. Howe, U.S. Deputy
Mineral Surveyor, under in-
structions from the Surveyor
General of date March 29th/87

Survey commenced April 1st/87
Survey completed. April 20th/87

Description of Survey.

5. Beginning at the Initial Mon.,
mentioned in Supplemental loca-
tion notice, and marking the
westerly end center of claim, where
I set post 5 1/2 ft. long 4 in. sgr. 1 ft.
in ground, and surround with
mound of earth and stone,
Post marked I.M. RATTLESNAKE M.C.
No. 1.

Thence $N 6^{\circ} 48' E$

$N 11^{\circ} 48' E$

5. Intersect east side line Emerald M.C.
lot No 157. $S 23^{\circ} 15' W$ 96.5 ft. from
point for Post No 7. (remains of mon.
only)

70 Road 6's S.S.W. & N.N.E.

106.5 Intersect N.E. end line Emerald M.C.

- Feet. N65° 28' W 28.7 ft. from N.E. cor, and point for Post No 7.
- 166.62 Intersect S.E. cor Grand Dipper M.C. lot No 148. S 78° 18' E 261. ft. from G.D. M.C. No 6. This point comes in Road brs E & W.
- 239.7 To loc. mon. and Post G.D. M.C. No 4, where I set post 5 1/2 ft. long 4 ins. sgr. 1 ft. in ground. on S. side of post G.D. M.C. No 4, and rebuild mound of stone around them.
Post marked R.S. M.C. No 2.
Thence N 78° 15' E
Var 11° 43' E
- 133.2 Intersect S.E. side line G.D. M.C. Lot 148 S 35° 47' W 9.3 ft. from Post G.D. M.C. No 3.
- 444.5 Road and wash, brs N.E. & S.W.
- 614.8 To a 4 in post marked B.H. M.C. No 6. From which point described in Supplemental Loc. brs. N 89° 20' W 60 ft.
Thence S 89° 20' E
Var 11° 43' E
- 489.8 Along South line Bunker Hill M.C. To loc mon. where I set post 5 1/2 ft. long 4 ins. sgr. 1 ft. in ground and surround by mound of stone.
Post marked R.S. M.C. No 3.
Thence S 1° 29' W
Var 11° 43' E
- 148. To loc mon. where I set post 5 1/2 ft. long 4 ins. sgr. and surround by mound of stone.
Post marked R.S. M.C. No 4.
U.S. M.M. No 6 brs S 25° 35' W. 2708. ft.
1/4 sec cor bet. Sec 13 & 18. East boundary T. 20. S. R. 22. E. brs N 88° 07' E 10 239 ft.
Thence S 1° 29' W.
Var 11° 43' E
- 256.4 To loc. mon. where I set post 5 1/2 ft. long 4 ins sgr. 1 ft. in ground and surround by mound of stone.
Post marked R.S. M.C. No 5.
Thence S 80° 56' W.
Var 11° 43' E

Feet.

110. Wash drains northerly
 329 Old Road N.W. & S.E.
 600. Wash drains N.W.
 1129.6 To loc. mon. where I set post 5 1/2 ft.
 long 4 ins sq. 1 ft in ground & surround
 ed by mound of earth & stone
 Post marked R.S. M.C. No 6.
 Thence $N1^{\circ}29'E$
 $var 11^{\circ}43'E$
 224.7 To post No 1 and place of beginning.

Area.

Total area of claim	11.752 acres
Less conflict not claimed with Emerald M.C. Lot No 157.	
Surveyed	.031 acres
Net area.	11.721 Acres

Location.

This claim is located in Tombstone mining District Cochise County, Arizona and about 3/4 of a mile south of the Grand Central mine, and 1/2 a mile north of Military Hill and is bounded on the north by the Onyx and Bunker Hill mining claims, upon the east by the Mammoth mining claim, and upon the west by the Emerald and Grand Dipper mining claims.

Improvements.

Made upon this claim by claimants or grantors, consist of the following. At Post No 4, east end center, R.S. M.C. No. 4. $S 74^{\circ}16' W$ 200 ft. A shaft, 4' x 6', 200 ft. deep with levels and cross cuts, $S 75^{\circ}24' W$ 382 ft. a shaft, 6' x 6', 15 ft. deep, $S 75^{\circ}24' W$ 400 ft. east end, and 485. west end open cut, 4 x 5 ft. on ledge.

S 75° 30' W 552. ft. Shaft. 5x6' 12 ft. deep.

And I hereby certify that the value of said improvements exceeds the sum of five hundred dollars.

There have been no improvements made by other parties upon this claim.

Instruments used a Young's improved Solar Transit, and steel tape.

Bar and courses taken by use of solar apparatus.

A. G. Howe U.S.
Deputy Mineral Surveyor.

Tombstone Arizona
April 28th 1887.

AFFIDAVIT OF FIVE HUNDRED DOLLARS IMPROVEMENTS.

WE, D. B. Shankland and K. L. Hart,

of lawful age, being first duly sworn according to law, depose and say that we are acquainted with the Rattle Snake,

mining claim, situated in

Tombstone, Mining District, Cochise County, Arizona

Territory, for which the Watervale Mining Co. of Chicago, Ill.
by B. S. Goffman agt, and

has made application for survey prior to application for patent under the provisions of the act of Congress approved May 10, 1872, and that the labor done and improvements made thereon by the applicant s and their grantor s exceed Five Hundred Dollars in value, and further that we are not personally interested in said mine.

D. B. Shankland
K. L. Hart

TERRITORY OF ARIZONA, } ss.

County of Cochise

SWORN to and subscribed before me this 29 day

of April, 188 7.

B. A. Fuesco

clerk Dist Court

FINAL OATHS FOR SURVEYS OF MINING CLAIMS AND MILL SITES.

A list of names of individuals employed to assist in running, measuring or marking the lines and corners described in the foregoing field-notes of the survey of

The Rattlesnake Mining Claim
located in *Tombstone* Mining District, *Cochise*,
County, Arizona, showing the respective capacities in which they acted.

K. L. Hart, Chainman.
Jas. H. Hart, Chainman.
Axeman.
Flagman.

We hereby certify that we assisted *A. G. Howe*

U. S. Deputy Surveyor, in surveying *The Rattlesnake Mining Claim*
claimed by *Watersale Mining Company of Chicago*
located in *Tombstone* Mining District, *Cochise* County,
and in Township No. *20 S*, Range No. *22 E* of the Gila and Salt River base and meridian,
Arizona, and that said survey has been in all respects, to the best of my knowledge and belief, well and faithfully
executed, and the boundary monuments planted according to the instructions furnished by the Surveyor General.

K. L. Hart, Chainman.
Jas. H. Hart, Chainman.
Axeman.
Flagman.

SWORN to and subscribed before me this *29th* day
of *April*, 1887.
B. A. Frescas
Clerk Dist Court

I, *A. G. Howe* U. S. Deputy Surveyor, do solemnly swear that, in pursuance
of instructions from the U. S. Surveyor General for Arizona, bearing date the *29th* day of
March, 1887, I have well, faithfully and truly, in my own proper person, and in strict
conformity with the instructions furnished by the Surveyor General and the laws of the United States, surveyed all
those portions

The Rattlesnake Mining Claim
claimed by *The Watersale Mining Company of Chicago*
located in *Tombstone* Mining District, *Cochise* County,
Arizona, as are represented in the foregoing field-notes as having been surveyed under my instructions; and I do
further solemnly swear that all the corners of said surveys have been established and perpetuated in strict accordance
with the instructions furnished me, and that the foregoing are the true and original field-notes of such surveys.

A. G. Howe Deputy Surveyor.

SWORN to and subscribed before me this *29th* day
of *April*, 1887.
B. A. Frescas
Clerk Dist Court



Location Notice, Rattlesnake Mine,

Notice, we the undersigned claim for mining purposes fifteen hundred (1500 feet) lineal feet along this mineral ledge lode or deposit, commencing at this monument of stone and running in a North Easterly direction to a Stone monument, with (300 feet) three hundred feet on each side of the ledge for mining purposes, Together with all the dips angles and spurs appertaining or belonging to the same, and all the ores and metals therein contained, claiming all the rights and privileges conferred by the mining laws of the United States. This mine is situated in Pima County and Territory of Arizona, and Tombstone Mining District, in the central part of the Tombstone mountains, adjoining the North Star Mine on the South West, and extending in a North Easterly direction along the right hand side of a prominent Gulch leading in a North Easterly direction, and adjoining the mine known as the Mammoth mine on the North East.

This mine shall be known as the Rattlesnake Mine, Located on the ground this the 12th day of May A.D. 1878.

TERRITORY OF ARIZONA.

County of Cochise

} ss.

W. S. Bradley

I. ~~A. T. JONES~~, County Recorder in and for the County of Cochise, do hereby

certify that the above and foregoing is a full, true and correct copy of the location
Notice of the *Little Snake Mine*,

as appears of record now in my office in Book 3, Page 745.

Transcribed Records of Mines,

In Witness Whereof, I have herunto set my hand and affixed

my official seal, at my office, in Tombstone, this

16th day of *March*, A. D. 1887

W. S. Bradley,

County Recorder

To Mr. Bullard - 750 feet.
John D. Bullard. 750 feet.

Filed and recorded at request of G. W. Bullard,
May 18th A.D. 1878 at 2 o'clock P.M.

J. W. Carpenter,

County Recorder,

Supplemental Notice of Location.
Rattlesnake Mine.

Notice: The undersigned present owners of the mine located and known as the Rattlesnake Mine, situated in the Tombstone Mining District, Cochise County, Territory of Arizona, located on the 12th day of May 1878.

A copy of said notice of Location was filed for record May 18th 1878, a record of which is made in Book 3 Page 745 Transcribed Records of Mines, Cochise County. To which reference is hereby made. Being desirous of obtaining a patent for said mine, and as a preliminary step thereto wishing to have an official survey made thereof by a Deputy United States Mineral Surveyor, and more definitely to describe said claim with reference to an established mineral monument, do now make this notice to be placed upon said mine, and recorded, that a complete description of said claim with reference to said monument may be of record.

The said Rattlesnake Mining Claim is described as follows: Commencing at this post in monument of stone, Post marked W. C. R. being the west center end of claim. Thence N 6° 44' E 239.7 feet

to the N.W. cor of claim a post in monument of stone post marked N.W. Cor R. - Thence N $77^{\circ} 52'$ E 548 feet to the S.W. cor of Bunker Hill a 2x4 inch stake in monument of stone. Thence S $89^{\circ} 20'$ E 550 feet to the N.E. cor of claim, which is also the N.W. cor Mammoth M.C. Thence S $1^{\circ} 29'$ W. 148 feet to a 4x4 in post marked R.E.C. which is also the west center of Mammoth from which U.S. M.M. No 6 bears S. $25^{\circ} 35'$ W. 2708 feet distant, Thence S $1^{\circ} 29'$ W 256.4 ft. to the S.E. Cor. of claim a 4x4 in post marked R.S.E. Cor, which point is also the S.W. Cor. of the Mammoth M.C. Thence S. $80^{\circ} 56'$ W 1129.6 ft to the S.W. Cor of claim a 4x4 in post in monument of stone, post marked R.S.W.C. thence N $1^{\circ} 29'$ E. 224.7 ft to the place of beginning.

This claim is bounded upon the North by the Topaz and Bunker Hill, upon the East by the Mammoth and upon the West by the Emerald M.C. Lot No 157 and the Grand Dipper M.C. with which it conflicts. This claim is situated $\frac{1}{2}$ a mile North of Military Hill and $\frac{3}{4}$ of a mile South of the Grand Central mine. #

This notice is placed upon the claim this 24th day of March 1887.

This notice is made without waiver of any rights under the original location

I hereby certify that this corresponds with the records of my office. W. J. Bradley County Recorder.

TERRITORY OF ARIZONA, }
County of Cochise } ss.

W. G. Bralley,

I. ~~A. T. JONES~~, County Recorder in and for the County of Cochise, do hereby certify that the above and foregoing is a full, true and correct copy of a *supplemental* *Deed* *Notice of the Public* *State* *mine*.

as appears of record now in my office in Book *8*, Page *599* *to* *600*.

In Witness Whereof, I have hereunto set my hand and affixed my official seal, at my office, in Tombstone, this *24th* day of *March*, A. D. 1887.
W. G. Bralley,
County Recorder

By A. S. Hoffman,
Agent Waterfall Mining Company of Chicago,

Filed and recorded March 24th A. D. 1887.

W. F. Bailey,
County Recorder,

PLAT
of the

RATTLESNAKE MINING CLAIM
TOMBSTONE MINING DISTRICT
COCHISE COUNTY ARIZONA

Containing 11,752 acres.
Conflict with Emerald = .031 acres
Scale 200 ft = 1 inch.
Var 11° 43' E

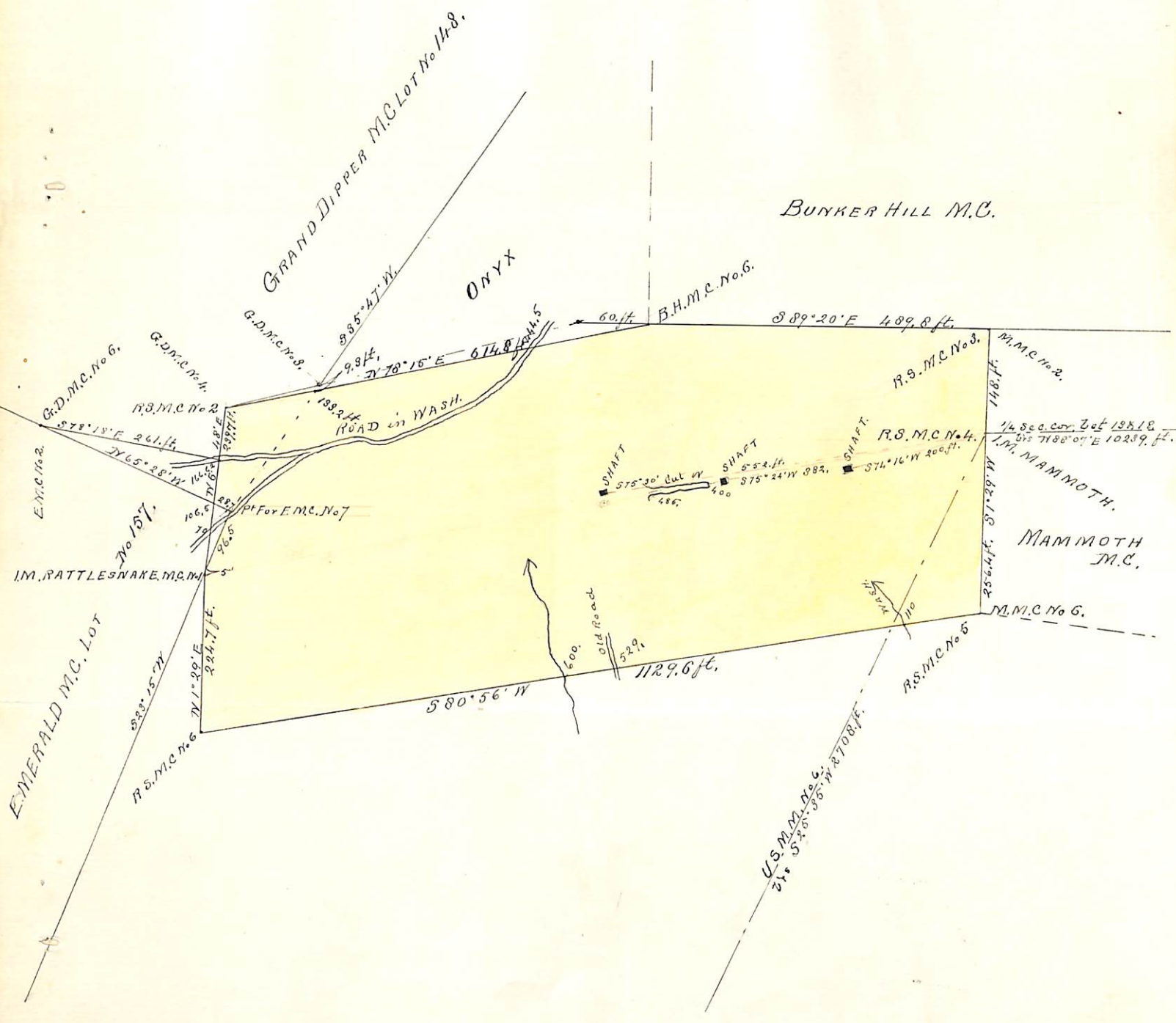

U. S. Surveyor-General's Office.

Tucson, Arizona, May 28th 1887.

The foregoing Field Notes of the survey of the
Rattlesnake, mining claim
 situate in the Loubstone mining district,
 County, Arizona, claimed by Waterhole mining
Company of Chicago
 survey executed by H. G. Howe Deputy
 Surveyor, under instructions from this office, having been critically
 examined and the necessary corrections and alterations made, the said
 Field Notes and the survey they describe are hereby approved.

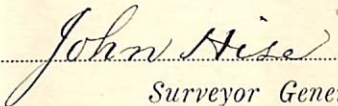
 Surveyor General.