

**MS**

**00822**

LOT NO. 37

SURVEY NO. 822

**FIELD NOTES**

of the survey of the

Goldew Gate

Mining claim

Situate in Lost Basin mining district,

County of Mohave and in Sec \_\_\_\_\_, Tp 30 N

Range \_\_\_\_\_ 17 W, of the Gila and Salt River Meridian.

ARIZONA.

Claimed by Ferdinand Luthy

Survey executed by O J Kuenen D. S.

Under instructions dated June 18<sup>th</sup> 1886,Survey commenced May 23<sup>rd</sup> 1887Survey completed May 25<sup>th</sup> 1887

# PRELIMINARY OATHS.

FOR SURVEYS OF MINING CLAIMS AND MILL-SITES.

WE, Thomas Wolf and C. F. Fraye  
do solemnly swear that we will faithfully execute the duties of Chain Carriers; that we will level the chain upon uneven ground, and plumb the tally pins, whether by sticking or dropping the same; that we will report the true distance to all notable objects, and the true length of all lines that we assist in measuring, to the best of our skill and ability.

Thomas Wolf  
C. F. Fraye

SWORN to and subscribed before me this 23<sup>d</sup> day  
of May, 1887.

H. Bucksbauer  
clerk district Court  
H. J. Brother  
Deputy.

I, \_\_\_\_\_  
do solemnly swear that I will well and truly perform the duties of \_\_\_\_\_  
\_\_\_\_\_ according to instructions given me,  
to the best of my skill and ability.

SWORN to and subscribed before me this 23<sup>d</sup> day  
of May, 1887.

H. Bucksbauer  
clerk of District Court  
H. J. Brother  
Deputy.

Field Notes  
of the Survey  
of the

Golden Gate Mining Claim  
in the

Last Basin Mining Dist.

Mohave County

Arizona Territory

claimed by

Ferdinand Inche.

Feet

Field Notes

of the survey of the Golden Gate mining claim in the "Foot Basin Mining District, Mohave County, Arizona

Claimed by Ferdinand Luby,

Surveyed by O. F. Krancey, U. S. Deputy Mineral Surveyor, under instructions from the Surveyor General of date June 18<sup>th</sup> 1886

Survey commenced May 23<sup>rd</sup> 1887  
" completed May 25<sup>th</sup> 1887

Description of survey.

Beginning at the initial mon. mentioned in location notice, where I set a post, 4x4 ins. 4 ft long, 1 1/2 ft in the ground and surrounded same with mound of stones, post marked: J. D. m. G. G. m. C.

Granite rock in place, marked J. m. G. G. m. C. B.P. bears N 73° 40' W. 516 feet.

Thence N 11° 05' E.

Var. 14° 20' E.

160 to loc. monument, where I set a post 4x4 ins. 4 ft long, 1 1/2 ft in the ground and surrounded same with mound of stones post marked G. G. m. C. B.P.

Large boulder, 2x2x7 ft, marked G. G. m. C. B.P. N 60° 25' W. 586 ft.

Thence N 78° 55' W

Var. 14° 20' E

300 to loc. mon. where I set a post 4x4 ins. 4 ft long, 1 1/2 ft in the ground, and surrounded same

Fair

with mound of stones;  
Post marked G. G. 97<sup>o</sup> II  
Pyramid shaped rock, 2 ft  
at base and 3 ft high,  
marked G. G. 97<sup>o</sup> II B.P. bears  
N 22° 25' W. 453 ft.

U.S. min. Mon. 97<sup>o</sup> I bears  
S 45° 05' W. 706 ft

Thence S 11° 05' W.

Var. 14° 20' E

607 To trail  
1500 to loc. mon. where I set  
a post 4 x 4 ins. 4 ft long,  
1 1/2 ft in the ground, and  
surrounded same with  
mound of stones, post marked  
G. G. 97<sup>o</sup> III

Large rock on south side  
of main wash, marked G. G.  
B.P. 97<sup>o</sup> III bears S 70° 40' W.  
1075 ft.

Highest peak east of salt  
springs bears N 65° 45' W.

Thence S 78° 55' E.

Var. 14° 20' E.

410 To wash bears N.E. & S.W.

600 to loc. mon. where I set a  
post 4 x 4 ins. 4 ft. long, 1 1/2 ft.  
in the ground and surrounded  
same with mound of stones  
post marked, G. G. 97<sup>o</sup> IV.

Rock in place, marked  
G. G. B.P. 97<sup>o</sup> IV bears S 89°  
10' E. 421 ft.

Extreme point of black table  
mountain on west side of  
Wallahei wash, bears S 53° 40' W.

Thence N 11° 05' E

Var. 14° 20' E

900 To trail, bears E and W.

1500 to loc. mon. where I set a  
post 4 x 4 ins. 4 ft. long 1 1/2 ft  
in the ground and surrounded

Same with mound of Stone  
 Post marked G. P. No 1  
 Granite Boulder marked G. P.  
 B.P. No 1 bears  $S 41^{\circ} 25' E. 423 ft.$   
 Thence  $N 78^{\circ} 55' W.$   
 Var.  $14^{\circ} 20' E.$

300 To post marked G. P. No 1

Area

Total Area of claim 20.86 acres

Location

This claim being situated on unurveyed land, is connected with U. S. Min. Mon. No 1. Lost Basin Mining District

Improvements

made upon this claim by claimants or grantors, consist of discovery shaft  $4 \times 8 ft.$ , 150 ft deep, bears  $S 11^{\circ} 05' W. 188.5 ft$  from Initial Mon.

Working tunnel  $4 \times 7\frac{1}{2} ft.$  300 ft long, bears  $S 22^{\circ} E.$  64.5 ft from post I.

And I hereby certify, that the value of said improvements, exceeds the sum of five hundred dollars.

There have been no improvements made by other parties on this claim.

Instruments used a Heller and Brightley Transit and Steel chain

Var. Taken from the North Star

Courses taken by Vernier Readings

O. F. Kincaid  
U. S. Deputy Min. Surveyor  
Kingman June 11<sup>th</sup> 1887



AFFIDAVIT OF FIVE HUNDRED DOLLARS IMPROVEMENTS.

We, J. Cunningham and S. Thompson  
of lawful age, being first duly sworn according to law, depose and say that we are acquainted with the  
Golden Gate mining claim  
mining claim, situated in Lost Basin  
Mining District, Mohave County, Arizona  
Territory, for which J. Luby and \_\_\_\_\_  
has made application for survey prior to application for patent under the provisions of the Act of  
Congress approved May 10, 1872, and that the labor done and improvements made thereon by the appli-  
cant — and his grantors — exceed Five Hundred Dollars in value, and further that we are not per-  
sonally interested in said mine.

James Cunningham  
S. Thompson

TERRITORY OF ARIZONA,  
County of Mohave } SS.

SWORN to and subscribed before me, this 25 day  
of May 1887

H. Buckbarn  
Clerk of District Court  
H. J. Butler,  
Deputy.

FINAL OATHS FOR SURVEYS OF MINING CLAIMS AND MILL SITES.

A LIST of names of individuals employed to assist in running, measuring, or marking the lines and corners described in the foregoing field-notes of the survey of the Golden Gate mining claim located in Foot Basin Mining district Mohave County, Arizona, showing the respective capacities in which they acted.

Thomas Wolfe Chairman  
C. F. Frazer Chainman  
Axeman.  
Flagman.

WE hereby certify that we assisted O. F. Knencer U. S. Deputy Surveyor, in surveying the Golden Gate mining claim claimed by Ferdinand Antky located in Foot Basin Mining District Mohave County, and in township No. — Range No. — of the Gila and Salt River base and meridian, Arizona, and that said survey has been in all respects, to the best of our knowledge and belief, well and faithfully executed, and the boundary monuments planted according to the instructions furnished by the Surveyor General.

Thomas Wolfe Chairman.  
C. F. Frazer Chainman.  
Axeman.  
Flagman.

SWORN TO AND SUBSCRIBED before me this 25 day of May 1887

H. Buckshammer  
Clerk of District Court  
H. J. Butler  
Deputy

I, O. F. Knencer U. S. Deputy Surveyor, do solemnly swear that, in pursuance of instructions from the U. S. Surveyor-General for Arizona, bearing date the 10<sup>th</sup> day of June 1886, I have well, faithfully and truly, in my own proper person, and in strict conformity with the instructions furnished by the Surveyor-General and the laws of the United States, surveyed all those portions of the Golden Gate mining claim claimed by Ferdinand Antky located in Foot Basin Mining District, Mohave County, Arizona, as are represented in the foregoing field-notes as having been surveyed under my directions; and I do further solemnly swear that all the corners of said surveys have been established and perpetuated in strict accordance with the instructions furnished me, and that the foregoing are the true and original field-notes of such surveys,

O. F. Knencer Deputy Surveyor.

SWORN TO AND SUBSCRIBED before me this 25 day of May 1887

H. Buckshammer  
Clerk of District Court  
H. J. Butler  
Deputy



Golden Gate —

Notice of Location

Know all men by these presents: that I the undersigned have this day located fifteen hundred (1500) linear feet of this vein or lode bearing precious metals, with all dips, spurs, angles and variations, with surface ground three hundred (300) feet on each side of the centre of vein, with all mineral deposits, contained therein, and all timber growing within the limits of said claim and all water and water privileges thereon or appurtenant thereto, under and according to the provisions of the mining laws of the United States, under which it is located.

This claim commences at this monument and notice placed upon the ledge and runs one hundred and sixty feet in a northerly direction and thirteen hundred and forty feet in a southerly direction along the ledge. The exterior boundaries are as follows, viz: Commencing at a monument of stone on west boundary line, distant three hundred (300) feet in a westerly direction from discovery monument; thence in a northerly direction parallel with the ledge one hundred and sixty feet to monument of stone at N.W. corner of claim; thence in an easterly direction at right angles across the ledge six hundred (600) feet to monument of stones at N.E. corner of claim; thence in a southerly direction parallel with the ledge fifteen hundred (1500) feet to monument of stone at S.E. corner of claim; thence at right angles across the

ledge in a westerly direction six hundred (600)<sup>11</sup> feet  
to monument of stones at S.W. corner of claim;  
thence in a northerly direction parallel with the  
ledge thirteen hundred and forty feet to mon-  
ument on west boundary and place of beg-  
inning.

This ledge may be more generally described as  
situated on the west side of the Eastern range  
of Ucallapai Valley, opposite Gold Basin District,  
about eight miles from the Colorado River and  
about ten miles from Pattersons Well, commonly  
called Lost Basin, in Mining  
District, Mohave County, Arizona Territory, and  
shall be known as the Golden Gate mining claim.  
Dated on the ground this 15<sup>th</sup> day of January 1882  
John Kreiner

Filed for record February 13<sup>th</sup> A.D. 1882 at 9 A.M.  
and recorded at the request of John Kreiner, Februa-  
ry 16<sup>th</sup> A.D. 1882 at 3.30 P.M.

John K. Mackenzie  
County Recorder

Territory of Arizona } se.  
County of Mohave }

I, H. Bucksbaum  
County Recorder of the County of Mohave,  
Territory of Arizona, do hereby certify that  
the foregoing is a true, full and correct  
copy of the record of the Golden Gate  
Mining Claim as the same appears of  
record Book F. page 168 Mining Records

In Witness Whereof I have hereunto  
set my hand and affixed my official  
seal this 21<sup>st</sup> day of May A.D. 1886  
H. Bucksbaum  
County Recorder

Golden Gate  
Mining claim

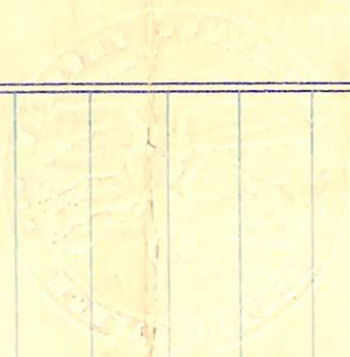

# PLAT

of the

## Golden Gate

Mining Claim

Claimed by J. Luthy

Contains 20<sup>66</sup> Acres

Situate in *Fort Basin* Mining District

Mohave Co. Arizona

Surveyed by O. F. Huencer. U.S. Deputy Surveyor  
May 23-24-25. 1887.

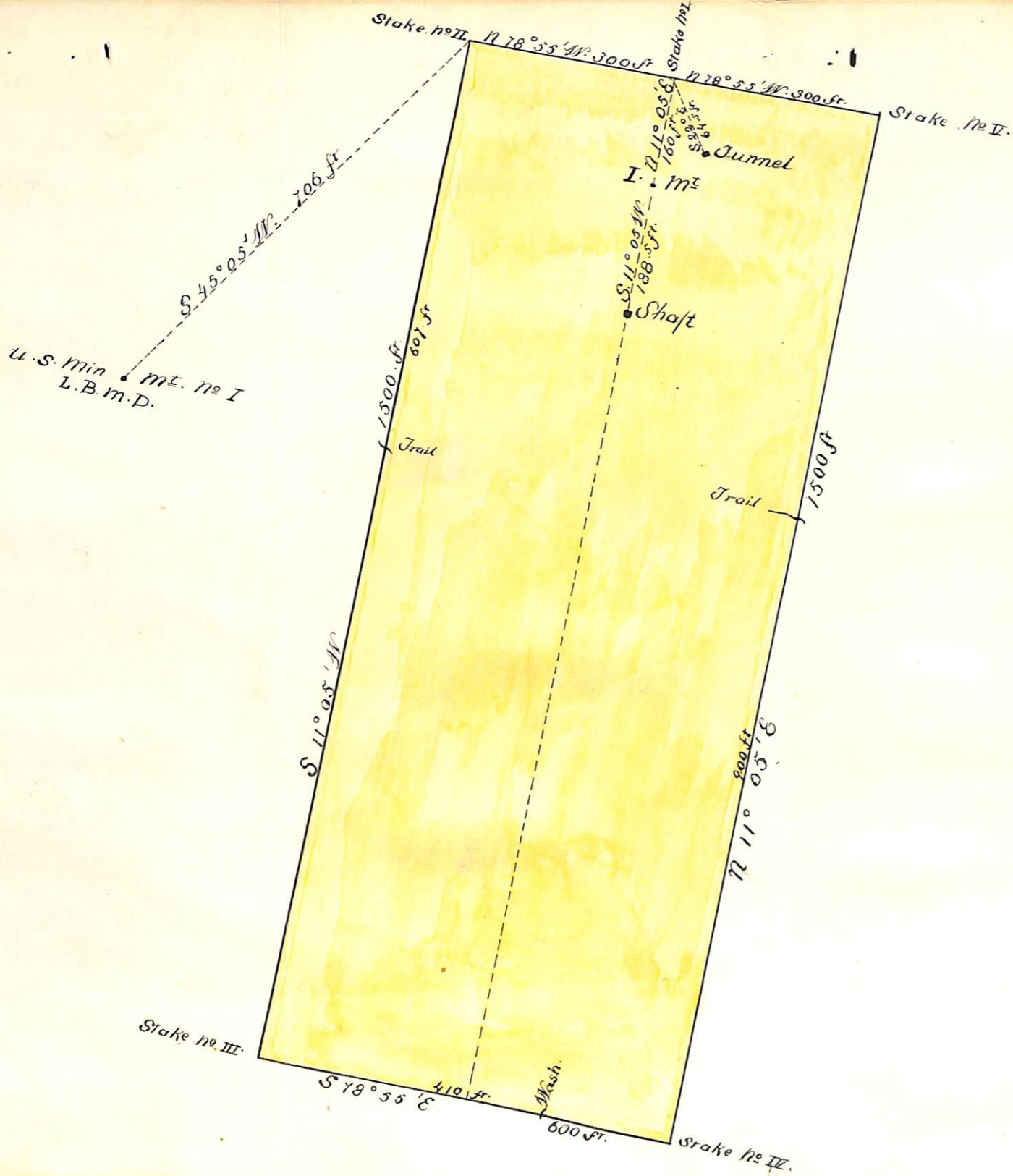
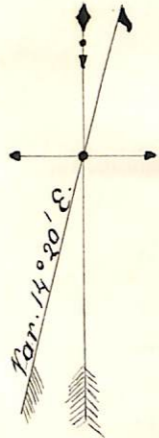

U. S. Surveyor-General's Office.

Tucson, Arizona, *Sept 29<sup>th</sup>* 1887.

The foregoing Field Notes of the survey of the  
*Golden Gate Mining claim*  
 situate in the *Lock Basin* mining district, *Mohave*  
 County, Arizona, claimed by *J. L. Lacey,*

survey executed by *O. H. Krummer* Deputy  
 Surveyor, under instructions from this office, having been critically  
 examined and the necessary corrections and alterations made, the said  
 Field Notes and the survey they describe are hereby approved.

*John Hise*  
 Surveyor General.