

MS.

00851

(4-683.)

Mineral Survey No. 851

Lot No. 44

Gila Land District.

FIELD NOTES

OF THE SURVEY OF THE MINING CLAIM OF

Joseph Hoefler

KNOWN AS THE

Contention Mining Claim

Turquoise Mining District,

Cochise County, Arizona

Section _____, Township 198, Range 23E

Surveyed under instructions dated Aug 10th, 1888,

by H. G. Howe,
U. S. Deputy Mineral Surveyor.

Claim located December 12th, 1879.

Survey commenced Aug 25th, 1888.

Survey completed Aug 27th, 1888.

PRELIMINARY OATHS,

FOR SURVEYS OF MINING CLAIMS AND MILL-SITES.

We, Peter Bute and

do solemnly swear that ^I ~~we~~ will faithfully execute the duties of Chain Carriers; that ^I ~~we~~ will level the chain upon uneven ground, and plumb the tally pins, whether by sticking or dropping the same; that ^I ~~we~~ will report the true distance to all notable objects, and the true length of all lines that ^I ~~we~~ assist in measuring, to the best of ^{my} ~~our~~ skill and ability.

Peter Bute

SWORN to and subscribed before me, this 24th day
of August 1888

J.W.C. Easton
Notary Public

I,

do solemnly swear that I will well and truly perform the duties of
..... according to instructions given me,
to the best of my skill and ability.

SWORN to and subscribed before, me this day
of 188.....

Field Notes.

of Survey of the
Contention Mining Claim in the
Turquoise Mining District,
Cochise (formerly Pima) County
Arizona Territory.

Claimed by
Joseph Hoefler

Surveyed by A. G. Howe U. S. Deputy
Mineral Surveyor under instructions
of date August 10th 1888.

Survey commenced August 25th /88
Survey completed August 27th /88

Description of Survey.

Feet. Commencing at the Initial mon.
mentioned in location, a mon.
of stones, and find copy of location
notice in same, where I set post
5ft. long 4 in. sq. and surround
by mound of stone.

Post marked I. M. Contention M. C
No 1.

From which U. S. M. M. No 1. bears $S 74^{\circ} 46' W$

Thence $N 82^{\circ} 39' E$

Var $11^{\circ} 30' East.$

422. To mon. of stone built upon croppings
which point is also the initial
mon. of 1st Easterley Extension Con-
tention (notice in mon.)

where I set Post 5ft. long, 4 in. sq.
18 ins in ground by side of ledge
and surround by mound of
earth and stone.

Post marked C. M. C. No 2.

Thence $N 11^{\circ} 01' W$

Var $11^{\circ} 30' East.$

Feet.

53. Wash drains easterly.

291.5 To mon. and N.E. cor, where I set Post 5ft. long 4in. sgr. 18 ins in ground and surround by mound of earths and stone.

Post marked C.M.C. No 3.

A Hackberry 16ins. diameter marked

B.T. C. No. 3. bears $S 37^{\circ} E$ 21 ft.

Thence $S 60^{\circ} 33' W$

Var $11^{\circ} 30'$ east.

Ascending easterly slope of hill.

1397.4 To mon. of stone, the N.W. cor, where I set Post 5ft. long 4 in. sgr. 6 ins in ground and surround by a mound of stone.

Post marked C.M.C. No 4.

From which U.S. M.M. No 1. bears

$N 20^{\circ} 45' W$ 108 ft.

Thence $S 11^{\circ} 01' E$.

Var $11^{\circ} 30'$ east.

263. To mon. of stone and westerly center end of claim. where I set Post. 5ft. long. 4 in. sgr. and surround by mound of stone. (impossible to set in ground)

Post marked C.M.C. No. 5.

Thence $S 17^{\circ} 06' E$

Var. $11^{\circ} 30'$ east.

79.6 Intersect N. end, line Hidden

Treasure. M.C. lot No 43. $N 71^{\circ} 08' E$

67.8 ft from Post marked H.T.M.C. No 2,

and $S 71^{\circ} 08' W$ 82.2 ft. from Post H.T.M.C. No 3.

278.6 To mon. of stone the S.W. cor. where where I set Post. 5ft. long. 4 in. sgr.

and surround by mound of stone. (impossible to set in ground)

Post marked C.M.C. No. 6,

Thence $N 62^{\circ} 35' E$

Var $11^{\circ} 30'$ east.

Feet. NOTE.

This line in the Official Survey of the Hidden Treasure M.C. Lot 43. is described as $N 72^{\circ} E$.

106.3 Intersect easterly side line Hidden Treasure M.C. Lot 43. $S 24^{\circ} 12' E$ 184.6 ft. from Post H.T. M.C. No. 3.

360. Leave sag between low hills and descend N, easterly slope of Ridge.

1355. To point for cor. where I set Post 5 ft. long. 4 in. sq. 18 ins in ground and surround by mound of earth and stone.

Post marked C.M.C. No. 7.

The old mon bears $S 11^{\circ} 01' E$ 4 ft. dist. Thence $N 11^{\circ} 01' W$.

Var. $11^{\circ} 30'$ East

300. To Post No. 2 and place of beginning Survey of Exterior lines of claim!

Area.

Total area of claim 17.31 acres

This area includes the conflict with the Hidden Treasure amounting to .415 acres, and described in Official Notes of Hidden Treasure as .43 acres, and relinquished to the contention claim.

Net area 17.31 acres,

Location.

This claim is located in the Turquoise mining District, Cochise County, Arizona Territory, and is bounded upon the East by the 1st Easterly Extension Contention mining claim and on the S.W.

cor. by the Hidden Treasure M.C.
Lot No 43, with which it conflicts.

Improvements.

made upon this claim by claimants
or grantors consist of.

A Shaft 4x6 ft, over 100 ft. deep, $S 87^{\circ} E$
195 ft. from Post C.M.C No 5

Croppings, $N 77^{\circ} E$ 103 ft. from Post
C.M.C. No 5.

Incline Shaft 4x6 ft, 12 ft. deep, $S 66^{\circ} 36' W$
251 ft. from Post. C.M.C No 2.

And I hereby certify that the value
of said improvements exceeds in
value the sum of five hundred
dollars.

There have been no improvements
made by other parties upon this
claim.

Instruments used a young's
improved Solar Transit and
Steel tape.

Bar. and courses taken by use
of solar apparatus.

A. G. Howe U.S Deputy
Mineral Surveyor.

Tombstone Ariz.
Sept 6th 1888.

FINAL OATHS FOR SURVEYS OF MINING CLAIMS AND MILL SITES.

A LIST of names of individuals employed to assist in running, measuring or marking the lines and corners described in the foregoing field-notes of the survey of

The Contention Mining Claim, located in the Turquoise Mining District, Cochise County, Arizona, showing the respective capacities in which they acted.

Peter Butte, Chairman. Chainman. Axeman. Flagman.

I hereby certify that I assisted A. G. Howe U. S. Deputy Surveyor, in surveying the Contention Mining Claim, claimed by Joseph Hoefler, located in Turquoise Mining District, Cochise County, and in Township No Range No of the Gila and Salt River base and meridian, Arizona, and that said survey has been in all respects, to the best of my knowledge and belief, well and faithfully executed, and the boundary monuments planted according to the instructions furnished by the Surveyor-General.

Peter Butte, Chairman. Chainman. Axeman. Flagman.

SWORN TO AND SUBSCRIBED before me this 5th day of September 1888

J. W. C. Easton, Notary Public

I, A. G. Howe, U. S. Deputy Surveyor, do solemnly swear that, in pursuance of instructions from the U. S. Surveyor General for Arizona, bearing date the 10th day of August 1888, I have well, faithfully and truly, in my own proper person, and in strict conformity with the instructions furnished by the Surveyor-General and the laws of the United States, surveyed all those portions of the Contention Mining Claim, claimed by Joseph Hoefler, located in Turquoise Mining District, Cochise County, Arizona, as are represented in the foregoing field-notes as having been surveyed under my instructions; and I do further solemnly swear that all the corners of said surveys have been established and perpetuated in strict accordance with the instructions furnished me, and that the foregoing are the true and original field-notes of such surveys.

A. G. Howe - Deputy Surveyor.

SWORN TO AND SUBSCRIBED before me this 6th day of September 1888

J. W. C. Easton, Notary Public



"Contention"

Notice of Location, Notice is hereby given that the undersigned in compliance with an Act of Congress, approved May 10, 1872 has this day located and claims fifteen hundred linear feet along the course of this lead, lode or vein of mineral bearing quartz with all dips spurs and angles thereto together with (300) three hundred feet on each side of the center of said lead, lode or vein, situated in Turquoise Mining District, Pima County Arizona and more particularly described as follows, to wit: Commencing at this monument of stones on which this notice is posted, and running five hundred feet Easterly to a monument of stones, being the Easterly end center, thence three hundred feet Northerly to a monument of stones, thence fifteen hundred Westerly to a monument of stones, thence three hundred feet Southerly to a monument of stones being the Westerly end center, thence three hundred feet Southerly to a monument of stones, thence fifteen hundred feet Easterly to a monument of stones, thence three hundred feet Northerly to the Eastern end center,

This claim is situated about 600 feet Northerly from the "Draoon Mine" and

10 ~~4~~

shall be known as the Contention mine,
Dated on the ground this 12th day of
December 1879.

M. C. James. 750 feet.

Jas Hoefles. 375 feet.

S. O. Fredricks. 375 feet.

Filed and recorded at request of Safford Hudson
and Co, Febr'y 7th A.D. 1880 at 10.12 A.M.

S. W. Carpenter, County Recorder,

By W. P. Rand. Deputy.

TERRITORY OF ARIZONA. }
 County of Cochise } ss.

W. F. Bradley

I. ~~A. T. JONES~~ County Recorder in and for the County of Cochise, do hereby certify that the above and foregoing is a full, true and correct copy of a Location Notice of the Contention mine. Turquoise Mining District

as appears of record now in my office in Book 2, Page 15
 of Transcribed Records from Pima County, A.T.

In Witness Whereof, I have hereunto set my hand and affixed my official seal, at my office, in Tombstone, this

7th day of August, A. D. 1888

W. F. Bradley

County Recorder

PLAT
 of SURVEY of THE
 CONTENTION MINING CLAIM
 TURQUOISE MINING DISTRICT
 COCHISE COUNTY
 ARIZONA
 Containing 17.31 Acres.
 Var 11°30' East
 Scale 200. # = 1 inch.

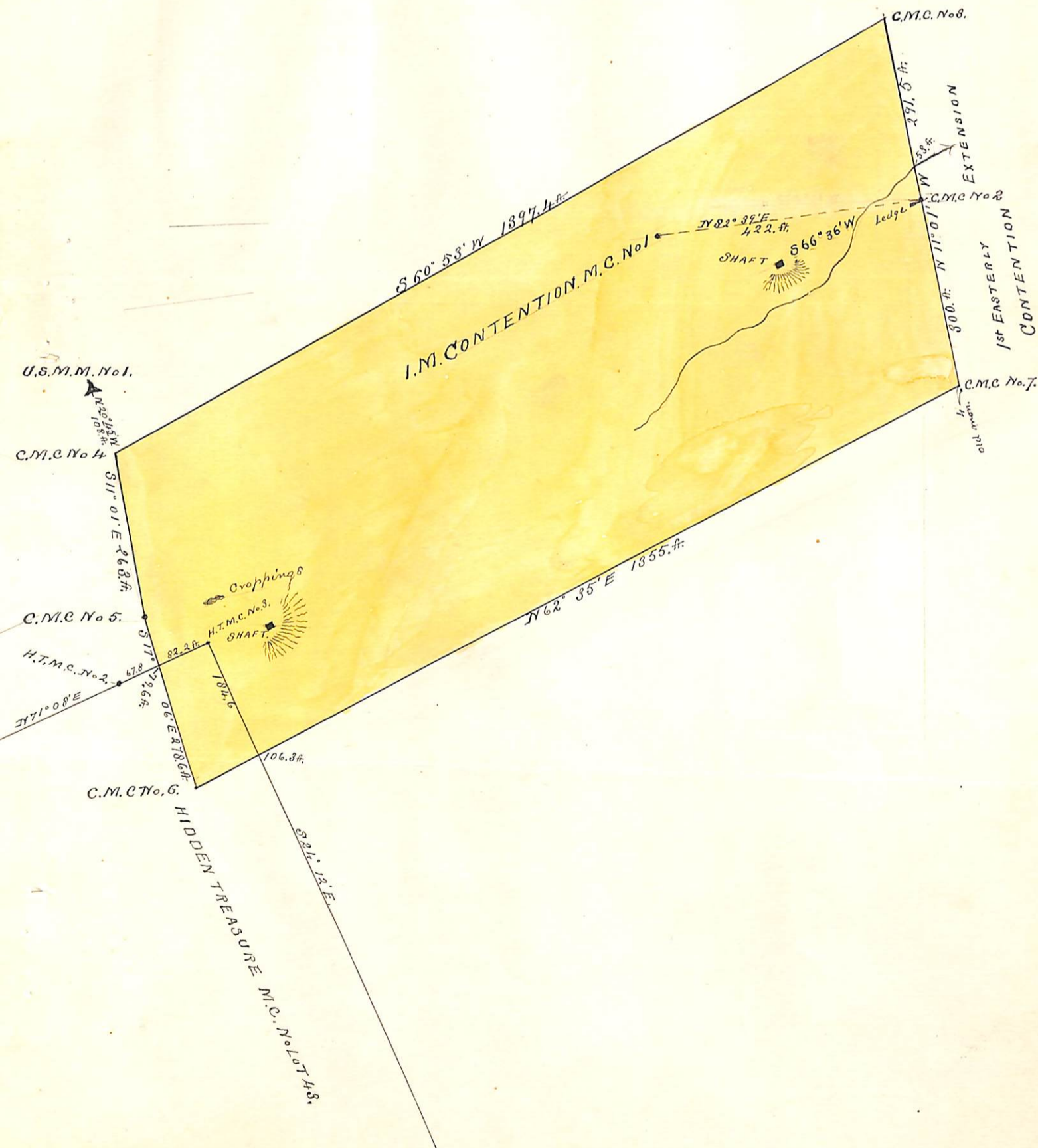

U. S. Surveyor-General's Office.

Tucson, Arizona, September 20th 1888.

The foregoing Field Notes of the survey of the

Contention Mining Claim
situate in the Turquoise mining district, Cochise
County, Arizona, claimed by

Joseph Hoefler,
survey executed by H. G. Howe, Deputy

Surveyor, under instructions from this office, having been critically
examined and the necessary corrections and alterations made, the said
Field Notes and the survey they describe are hereby approved.

John Wise
Surveyor General.