

M
S
.

0

0

8

6

3

(4-683.)

Mineral Survey No. 863

1

Lot No. 67

Gila

Land District.

FIELD NOTES

OF THE SURVEY OF THE MINING CLAIM OF

Copper Queen Con. Mining Company

KNOWN AS THE

Best Piece Mining Claim

Warren

Mining District,

Cochise

County,

Arizona Ter.

Section _____, Township 238, Range 14E

Surveyed under instructions dated Sept. 25th, 1888

by H.G. Howe,

U. S. Deputy Mineral Surveyor.

Claim located Sept. 10th —, 1884

Survey commenced Oct. 10th, 1888

Survey completed Oct. 10th —, 1888

PRELIMINARY OATHS,

FOR SURVEYS OF MINING CLAIMS AND MILL-SITES.

We, C. W. Marks, and C. G. Convis;

do solemnly swear that we will faithfully execute the duties of Chain Carriers; that we will level the chain upon uneven ground, and plumb the tally pins, whether by sticking or dropping the same; that we will report the true distance to all notable objects, and the true lengths of all lines that we assist in measuring, to the best of our skill and ability.

C. W. Marks
C. G. Convis

SWORN to and subscribed before me, this 8th day
of October 1888.

A. B. Finin
Notary Public

I, _____

do solemnly swear that I will well and truly perform the duties of _____

_____ according to instructions given me,

to the best of my skill and ability.

SWORN to and subscribed before me, this _____ day

of _____ 188_____

Field Notes
of the Survey of the

Best Piece Mining claim in the
Warren mining District Cochise
County Arizona.

Claimed by
Copper Queen consolidated mining
company.

Surveyed by A. G. Howe U.S. Deputy
Mineral Surveyor under instruc-
tions from the Surveyor General
of date September 26th 1888.

Survey commenced Oct 10th 1888.
Survey completed Oct 10th 1888.

Description of Survey.

Feet. Beginning at the Initial mon-
ument mentioned in the loca-
tion notice and marking the
south westerly center end of claim
which point is on the north easterly
side line of the Baxter M.C. Lot. 52.
a mon of stone where I set Post
3 ft. long 4 in. sq. and surround by
monument of stone.

Post marked V.M. Best Piece M.C. No. 1.
Thence N 32° 0' W

N 11° 35' East.

131.5 a 4 in Post marked G.M.C. No 4.

167.5 a 4 in Post marked G.M.C. No 3.

211. To the N.W. cor of claim, where I
find 4 in Post in mon. marked
W.C. & M.C. No 2, and on south face of Post
B.P.M.C. No 2.

Feet Thence $577^{\circ} 20' E$

Var $11^{\circ} 35' East$

32. Iron pin cor Goddard
287. point for cor. parallel end line
where I set post 3ft long 4in sgr. and
surround by monument of stone.
Post marked B.P.M.C. No 3.

From which U.S. M.M. No 1 bears $N 22^{\circ} 59' W$
1283.3 ft.

The N.W cor Cogswell and original
location mon bears $577^{\circ} 20' E$ 338 ft.
Thence $532^{\circ} E$

Var $11^{\circ} 35' East$

80.5 To intersection west line lookout M.C.
and Post marked G.M.C. No 5. where I
set post 3ft. long. 4in sgr on west side
of other post and rebuild monument
of stone around them.

Post marked B.P.M.C. No 4.

From which a 4 in Post G.M.C. No 6, bears
 $N 17^{\circ} 20' E$ 16.5 ft

Thence $517^{\circ} 14' W$

Var $11^{\circ} 35' East$.

270. To SE. cor. Baxter M.C. Lot. No 52, which
is also a cor of Best Piece M.C. where
I set Post 4in sgr. 3ft. long. by side of
Baxter post. and rebuild monument
around them.

Post marked B.P.M.C. No 5.

Thence $N 32^{\circ} 0' W$.

Var $11^{\circ} 35' East$.

120. wash drains easterly.

247. To post no. 1. and place of beginning.

Area

Total area of claim 1287 acres.

Less conflict not claimed

Goddard M.C. Lot No 63.

.357

Net area, 930 acres

Location.

This claim is located in the Warren Mining District Cochise County Arizona, and is a fractional claim, bounded upon the South west by the Baxter M.C. Lot 52 upon the North by the Holbrook M.C. Lot No 53 and the Goddard, M.C. Lot No 63 and upon the South East by the Lookout Mining claim.

Improvements.

Made upon this claim by claim ants or grantors consist of a Shaft 4x6 ft. over 70 ft. deep, N59°20'E 73. ft. from post I.M. Best Piece, which is built upon croppings.

and I hereby certify that the value of said improvements exceeds in value the sum of five hundred dollars.

There have been no improvements made by other parties upon this claim.

Instruments used a Young's improved Solar Transit and Steel tape.

The var. and courses taken by use of Solar apparatus, Transit carefully adjusted and var. checked by observation of Polaris.

A. G. Howe.

U. S. Deputy Mineral Surveyor.

Tombstone Oct 30th /88

" Nov 9th /88

AFFIDAVIT OF FIVE HUNDRED DOLLARS IMPROVEMENTS.

WE, J. W. Howell and S. W. Lawson,
of lawful age, being first duly sworn according to law, depose and say that we are acquainted with
the development work upon the
Best Piece mining claim, situated in the
Warren Mining District, Cochise County, Arizona
Territory, for which the Copper Queen Consolidated Mining Co.
have made application for survey prior to application for patent under the provisions of the act
of Congress approved May 10, 1872, and that the labor done and improvements made thereon by
the applicant and their grantors exceed Five Hundred Dollars in value, and further that
we are not personally interested in said mine.

J. W. Howell
S. W. Lawson

TERRITORY OF ARIZONA. }
County of Cochise, } ss.

SWORN to and subscribed before me this 13th day
of October, 1888.

A. C. Perrin
Notary Public

FINAL OATHS FOR SURVEYS OF MINING CLAIMS AND MILL SITES.

A LIST of names of individuals employed to assist in running, measuring or marking the lines and corners described in the foregoing field-notes of the survey of Best Piece Mining Claim located in Warren Mining District, Cochise County, Arizona, showing the respective capacities in which they acted.

C. W. Marks Chainman.
C. G. Corvis Chainman.
Axeman.
Flagman.

WE hereby certify that we assisted A. C. Howe U. S. Deputy Surveyor, in surveying The Best Piece Mining Claim claimed by Copper Queen Consol. Mining Company located in Warren Mining District, Cochise County, and in Township No. Range No. of the Gila and Salt River base and meridian, Arizona, and that said survey has been in all respects, to the best of my knowledge and belief, well and faithfully executed, and the boundary monuments planted according to the instructions furnished by the Surveyor-General.

C. W. Marks Chainman.
C. G. Corvis Chainman.
Axeman.
Flagman.

SWORN TO AND SUBSCRIBED before me this 13th day of October 1888

A. C. Perrin
Notary Public

I, A. C. Howe U. S. Deputy Surveyor, do solemnly swear that, in pursuance of instructions from the U. S. Surveyor General for Arizona, bearing date the 25th day of Sept 1888, I have well, faithfully and truly, in my own proper person, and in strict conformity with the instructions furnished by the Surveyor-General and the laws of the United States, surveyed all those portions of the Best Piece Mining Claim claimed by Copper Queen consolidated Mining Company located in Warren Mining District, Cochise County, Arizona, as are represented in the foregoing field-notes as having been surveyed under my instructions; and I do further solemnly swear that all the corners of said surveys have been established and perpetuated in strict accordance with the instructions furnished me, and that the foregoing are the true and original field-notes of such surveys.

A. C. Howe Deputy Surveyor.

SWORN TO AND SUBSCRIBED before me this 30th day of October 1888

J. W. Easter
Notary Public



Re-location Notice.

Notice is hereby given that the undersigned in compliance with the requirements of the Mining Act of Congress approved May 10th 1872, has this day relocated and claim fifteen hundred linear feet along the course of this lead lode of vein of mineral bearing rock and three hundred feet in width on each side of the middle of said lead lode or vein of mineral situated in The Warren Mining District, County of Cochise, Territory of Arizona and more particularly described as follows, to wit; Commencing at this monument of stones it being on the North East line of the Baxter claim and West end center of this mining claim, thence North Westerly along the North East line of the Baxter mining claim to its intersection with the West side line of the Holbrook mining claim as shown by the patents of said mines, thence East along the South side line of the Holbrook Mining claim three hundred feet to a monument of stones, it being the North East end center of the claim, thence Easterly following the said line three hundred feet or less to the North west corner of the Cogswell mine, thence Southerly to the South East corner of the Baxter mining claim as shown by their survey and patent, thence following the

North East side line of the Baxter Mining claim⁹ to
the place of beginning. This claim shall be known
as the Best Piece and is a re-location of the
Least Piece, and is relocated on the ground that
the first location is dated as having been originally
located on the second day of March A.D. 1884,
when in fact it was not. Dated on the ground
this 10th day of September A.D. 1884. Locator,
James Hopkins.

Filed and recorded at request of Joe Russell
Dec 1st 1884 at 9. A.M.

A. J. Jones County Recorder
By B. A. Fickas. Deputy.

Certified Copy of
Best Piece
Location Notice.

TERRITORY OF ARIZONA, }
County of Cochise } ss.

10

I. A. T. JONES, County Recorder in and for the County of Cochise, do hereby certify that the above and foregoing is a full, true and correct copy of *The Location Notice of the Best Piece Mining Claim. Warren Mining Claim, Cochise County A.T.* as appears of record now in my office in Book *8*, Page *196*.
Record of Mines

In Witness Whereof, I have hereunto set my hand and affixed my official seal, at my office, in Tombstone, this

29th day of *February*, A. D. 188*8*

W. F. Bradley
County Recorder

PLAT
Of the

BEST PIECE MINING CLAIM
WARREN MINING DISTRICT
COCHISE COUNTY ARIZONA.

Containing 93 ACRES.

Scale 200 ft = 1 inch,

Var 11° 35' East.

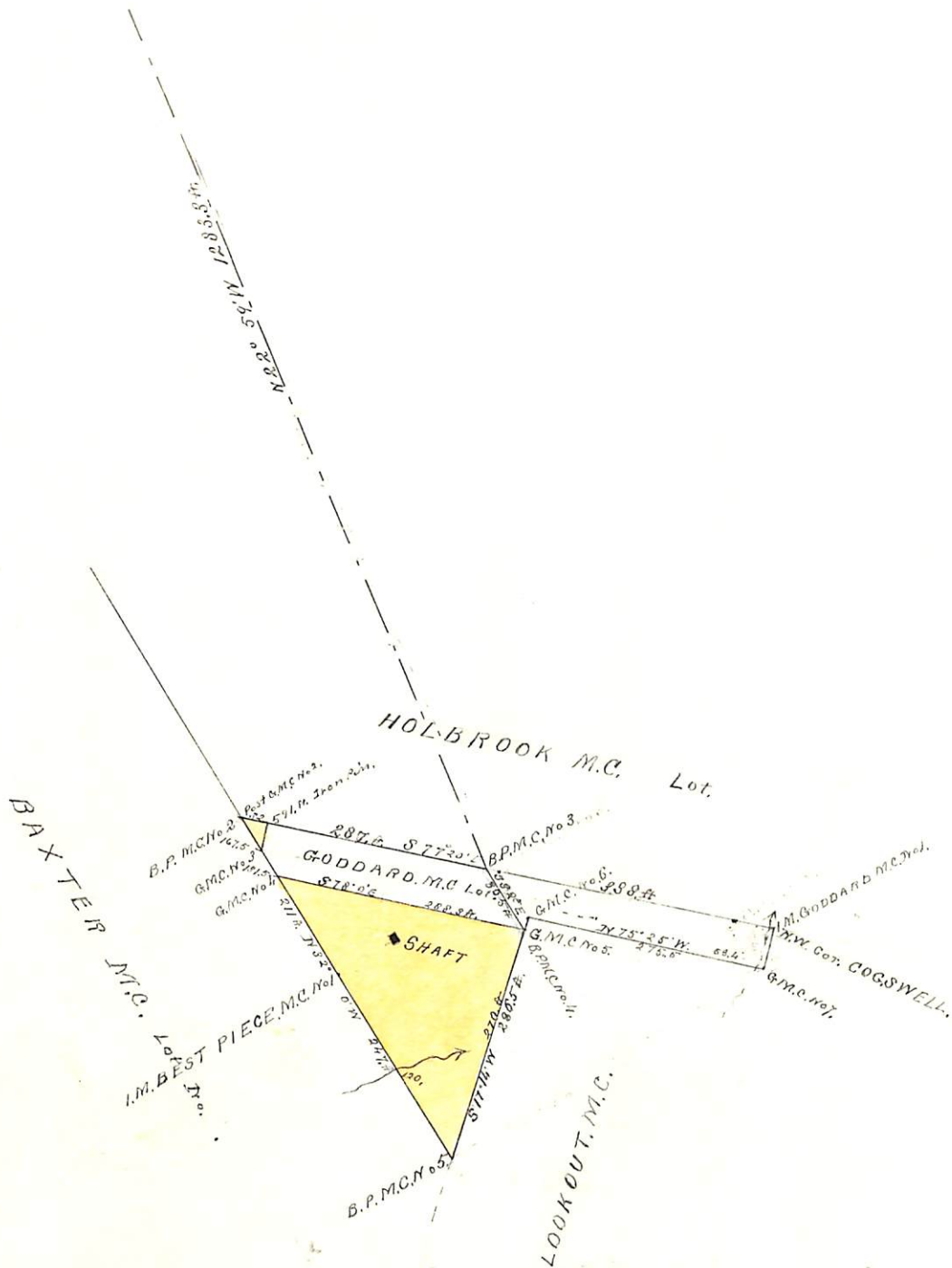

(4-687.)

Surveyor General's Certificate of Approval of Field Notes and Survey of Mining Claim.

Department of the Interior,

Office of U. S. Surveyor General,

Tucson, A.T.

Jan'y. 15th, 1889.

I, U. S. Surveyor General for *Arizona*,

do hereby certify that the foregoing and hereto attached Field Notes and Return of the

Survey of the Mining Claim of *Copper Queen Consolidated Mining Company*

....., known as the

Best Piece Mining Claim

situate in *Warren* mining district,

Cochise County, *Arizona Ter.*

in Section, Township No., Range No.

....., designated as Survey No. *863*.

executed by *R.H. Howe*, U. S. Deputy Mineral

Surveyor, *Oct. 10th*, 1888, under my instructions dated

Sept. 25th, 1888, have been critically examined and the

necessary corrections and explanations made, and the said Field Notes and Return, and

the Survey they describe, are hereby approved. A true copy of the copy of the location

certificate filed by the applicant for survey is included in the field notes.

John Hise

U. S. Surveyor General for *Arizona*.

o 6-1c2