

**M  
S  
-**

**0**

**0**

**8**

**8**

**4**

(4-683.)

Mineral Survey No. 884

Lot No. 40

GILA Land District.

# FIELD NOTES

OF THE SURVEY OF THE MINING CLAIM OF  
THE RHODE ISLAND COMPANY

KNOWN AS THE  
PROVIDENCE

CALIFORNIA Mining District.

COCHISE County, ARIZONA

Section \_\_\_\_\_, Township 17 S \_\_\_\_\_, Range 31 E.

Surveyed under instructions dated MAY 6TH., 18 89,

by H.G. HOWE,  
U. S. Deputy Mineral Surveyor.

Claim located Jan'y 17th \_\_\_\_\_, 18 87.

Survey commenced June 1st. \_\_\_\_\_, 18 89.

Survey completed June 3rd. \_\_\_\_\_, 18 89.

# PRELIMINARY OATHS OF ASSISTANTS IN SURVEY OF MINING CLAIM.

WE, O. J. Hands and G. R. Montgomery,  
do solemnly swear that we will well and faithfully execute the duties of chain carriers;  
that we will level the chain upon even and uneven ground and plumb the tally-pins,  
either by sticking or dropping the same; that we will report the true distance to all  
notable objects, and the true length of all lines that we assist in measuring, to the best  
of our skill and ability, and in accordance with instructions given us, in the survey of  
the Mining Claim of  
The Rhode Island Company, known as the  
Providence.  
situate in California mining district,  
Cochise County, Arizona,  
in Section \_\_\_\_\_, Township No. \_\_\_\_\_, Range No. \_\_\_\_\_.

O. J. Hands, Chainman.

G. R. Montgomery, Chainman.

Subscribed and sworn to by the above-named persons before  
me this 1st day of June, 1889.

H. G. Howe  
Notary Public.

I, Shos Blair, do solemnly swear that I will well and  
truly perform the duties of axeman, in the establishment of corners and other duties,  
according to instructions given me and to the best of my skill and ability, in the survey  
of the Mining Claim of  
The Rhode Island Company,  
known as the Providence,  
more fully described in the preceding affidavit.

Shos Blair, Axeman.

Subscribed and sworn to by the said Shos Blair  
before me this 1st day of  
June, 1889.

H. G. Howe  
Notary Public.

I, \_\_\_\_\_, do solemnly swear that I will  
well and truly perform the duties of flagman, in the establishment of corners and other  
duties, according to instructions given me and to the best of my skill and ability, in the  
survey of the Mining Claim of \_\_\_\_\_  
known as the \_\_\_\_\_,  
more fully described in the preceding affidavit.

\_\_\_\_\_, Flagman.

Subscribed and sworn to by the said \_\_\_\_\_  
before me this \_\_\_\_\_ day of  
\_\_\_\_\_, 18 \_\_\_\_\_.

Field Notes.  
of the Survey of the

Providence Mining Claim  
in the California Mining  
District Cochise County  
Arizona.

Claimed by  
The Rhode Island Company.  
D. A. Miller Attorney.

Surveyed by H. G. Howe U. S.  
Deputy Mineral Surveyor  
under instructions from  
the Surveyor General of  
date May 6<sup>th</sup> 1889

Survey commenced June 1<sup>st</sup> 1889  
Survey completed June 3<sup>rd</sup> 1889

Beginning at the east center  
end of claim described in the  
notice of location, where I find  
a 3x4 in post in mon of stone,  
post marked with lead pencil.  
East center Providence, on one  
side and on other west center  
Newport mine, where I set a  
Cedar Post 5 ft. long 4x6 ins 6 ins.  
in ground and surround by  
a monument of stone.  
Post marked on west face,  
I. M. P. M. C. No 1. and upon East face  
I. M. N. M. C. No 1.

Note All the posts are marked letters  
cut with a marking Iron.  
U. S. M. M. No 1 bears N 82° 0' W 10690 ft.  
Cor to sec's 20, 21, 28 & 29. T. 17. S. R. 31. E. G. 4 S  
R. Mer. S 55° 47' W. 6168 ft.

Feet. The S.E. cor Ophir M.C. a 4 in post,  
marked O.M.C. No. V. bears  $574^{\circ} 38' W$   
3599 ft.

Thence  $N 30^{\circ} E$ ,

Var  $12^{\circ} 13' East$ .

286. To old mon and 2x4 in stake, on  
North slope of mountain, which  
point is also the N.W. cor. of the  
Newport mining claim, where  
I set Pine Post 5 ft. long. 4x6 ins.  
6 ins in ground and surround  
by monument of earth and  
stone.

Post marked on west face  
P.M.C. No. II.

Thence  $N 77^{\circ} 24' W$ .

Var  $12^{\circ} 13' East$ .

1396. To mon. of stone the N.W. cor.  
where I set Cedar Post 5 ft. long  
5x5 ins. 1 ft in ground and  
surround by monument of  
stone.

Post marked P.M.C. No. III.

Thence  $S 30^{\circ} 0' W$

Var  $12^{\circ} 13' East$ .

150. Top of divide and descend South  
Slope of mountain.

300. To the West center mon. and stake  
described in Notice of location as  
place of beginning, where I set  
Cedar Post 5 ft. long 4x4 ins. 6 ins in  
ground and surround by mon-  
ument of stones.

Post marked P.M.C. No IV.

Post O.M.C. No. V. (Ophir M.C. S.E. cor) bears  
 $559^{\circ} 20' W$ .

Thence  $S 30^{\circ} 0' W$

Var  $12^{\circ} 13' East$ .

Continuing down South slope of  
mountain.

Feet.

300. To monument of stone the S.W. cor. where I set Cedar Post 5 ft. long 6x6 ins. 6 ins. in ground and surround by monument of earth and stone. Post marked P.M.C. No. V. Thence  $577^{\circ} 57' E$

Var  $12^{\circ} 13' East,$

1400. Along the South slope of mountain To remains of mon. stake removed, which point is also the S.W. cor. of the Newport mining claim where I set Cedar Post 5 ft. long 5x5 ins 6 ins in ground and surround by monument of stone.

Post marked on west face P.M.C. No. VI. Thence  $N 30^{\circ} 0' E$

Var  $12^{\circ} 13' East,$

Up almost perpendicular Bluff and steep mountain.

300. To Post No. 1. and place of beginning Survey of exterior lines.

The location notice describes this claim as 1500 ft in length but by carefully running the center line I find it but 1400 ft in length.

Area.

Total area of claim 18.14 acres

Location.

This claim is located in the California mining District in Cochise County Arizona about  $\frac{3}{4}$  of a mile North of Silver Creek, and  $\frac{1}{4}$  of a mile East of Quartz Hill Peak. and upon what is known as Grand Royal Mountain.

And is bounded upon the East by the Newport mining claim

## Improvements.

made upon this claim by claimants or grantors consist of  
 A Tunnel 4x7 ft. about 300 ft. long  
 (Runs easterly.) Face of Tunnel  
 bears  $N 79^{\circ} 10' W$  445 ft. from Post No. 1.  
 A Shaft 4x6 ft. over 100 ft. deep, with  
 drifts over 80 ft. in length, bears  
 $N 68^{\circ} 10' W$  275 ft. from post No. 1.

Note, This Shaft connects with the  
 Tunnel described above.

An open cut or Quarry about 30x60 ft.  
 and averages 8 ft. deep. Center of  
 bears  $N 68^{\circ} W$  305 ft. from Post No. 1.  
 Croppings show,  $N 77^{\circ} 57' W$  163 ft.  
 from Post No. 1.

And I hereby certify that the  
 value of said improvements  
 exceeds the value of five hundred  
 dollars.

There have been no improvements  
 made by other parties upon this  
 claim.

Instruments used a young's impro-  
 ved Solar Transit and Steel Tape.

var. and courses taken by use of Solar  
 apparatus

The variation tested by observation of  
 Polaris.

H. G. Howe U. S. Deputy  
 Mineral Surveyor.

Tombstone Ariz.

June 11<sup>th</sup> / 87

AFFIDAVIT OF FIVE HUNDRED DOLLARS IMPROVEMENTS.



We, *G. R. Montgomery* and *E. J. Hands*,  
of lawful age, being first duly sworn according to law, depose and say that we are acquainted with the  
*Providence*. —

mining claim, situated in *California*  
Mining District, *Cochise* County, Arizona  
Territory, for which *The Rhode Island Company*,  
has made application for survey prior to application for patent under the provisions of the Act of  
Congress approved May 10, 1872, and that the labor done and improvements made thereon by the appli-  
cant and their grantors exceed Five Hundred Dollars in value, and further that we are not per-  
sonally interested in said mine.

*G. R. Montgomery*  
*E. J. Hands*



TERRITORY OF ARIZONA,  
County of *Cochise* } SS.

SWORN to and subscribed before me, this *3rd* day  
of *June* 188*9*

*A. G. Howe*  
Notary Public.



# FINAL OATHS FOR SURVEYS.

## LIST OF NAMES.

A list of the names of the individuals employed by A. G. Howe  
 United States Deputy Mineral Surveyor, to assist in running, measuring, and marking the lines  
 corners and boundaries described in the foregoing field notes of the survey of the mining claim  
 of The Rhode Island Company  
 known as the Providence  
 and showing the respective capacities in which they acted.

- E. J. Hands, Chainman.
- G. R. Montgomery, Chainman.
- Thos Blair, Axman.
- ....., Flagman.

## FINAL OATHS OF ASSISTANTS.

We, E. J. Hands G. R. Montgomery  
 and Thos Blair, do solemnly swear that we assisted  
A. G. Howe, United States Deputy Mineral Surveyor, in marking the corners and  
 surveying the boundaries of the mining claim of

The Rhode Island Company  
 known as the Providence, represented

in the foregoing field notes as having been surveyed by said deputy mineral surveyor and under  
 his direction; and that said survey has been in all respects, to the best of our knowledge and  
 belief, faithfully and correctly executed, and the corner and boundary monuments established  
 according to law and the instructions furnished by the United States Surveyor-General for

Arizona.

- E. J. Hands, Chainman.
- G. R. Montgomery, Chainman.
- Thos Blair, Axman.
- ....., Flagman.

Subscribed and sworn to by the above-named persons before me

this 3rd day of June, 1889.

A. G. Howe  
 Notary Public.

FINAL OATH OF U. S. DEPUTY MINERAL SURVEYOR.

I, H. G. Howe, U. S. Deputy Mineral Surveyor, do solemnly swear that, in pursuance of instructions received from the United States Surveyor General for Arizona, dated May 6<sup>th</sup>, 1889, I have, in strict conformity to the laws of the United States, the official regulations and instructions thereunder, and the instructions of said Surveyor General, faithfully and correctly executed the survey of the Mining Claim of The Rhode Island Company, known as the Providence, situate in California Mining District, Cochise County, Arizona in Section \_\_\_\_\_ Township No. \_\_\_\_\_ Range No. \_\_\_\_\_ and designated as Survey No. 884, as represented in the foregoing field notes, which accurately show the boundaries of said mining claim as distinctly marked by monuments on the ground, and described in the attached copy of the location certificate, which was received by me from the Surveyor General with said instructions, and that all the corners of said survey have been established and perpetuated in strict accordance with the law, official regulations and instructions thereunder; and I do further solemnly swear that the foregoing are the true and original field notes of said survey and my report therein, and that the labor expended and improvements made upon said mining claim by claimant or their grantors are as therein fully stated, and that the character, extent, location and itemized value thereof are specified therein with particularity and full detail, and that no portion of said labor or improvements so credited to this claim has been included in the estimate of expenditures upon any other claim.

H. G. Howe,  
U. S. Deputy Mineral Surveyor.

Subscribed and sworn to by the said H. G. Howe,  
U. S. Deputy Mineral Surveyor, before me Yusuf Daily  
Clerk Dist Court this 12<sup>th</sup>  
day of June, 1889.

Yusuf Daily  
Clerk Dist Court Ariz.

For Sale at UNION NEWS DEPOT AND STATIONERY STORE, Grand Hotel Block, Tombstone, A. T.

# LOCATION NOTICE.

NOTICE IS HEREBY GIVEN, that the undersigned, in compliance with the requirements of the Mining Act of Congress, approved May 10th, 1872, have this day located and claim fifteen hundred linear feet along the course of this lead, lode or vein of mineral bearing quartz, and three hundred hundred feet in width on each side of the middle of said lead, lode or vein, situate in the California Mining District, County of Cochise County Arizona, and more particularly described as follows, to-wit.

COMMENCING at <sup>a</sup> ~~the~~ monument of stones, being the center of the \_\_\_\_\_ Western end of claim, and upon which this notice is posted, which is about 1200 ft Western from where this notice is posted, thence North 300 feet to a monument of stones; thence East 1500 feet to a monument of stones; thence South 300 feet to a monument of stones; being the center of the East end of claim; thence South 300 feet to a monument of stones; thence West 1500 feet to a monument of stones; thence North 300 feet to the place of beginning.

THIS CLAIM is situated about two and one half miles East from the U.S. Mineral monument No 1.

The claim herein located is situated on Grand Royal Mountain three fourths of a mile north of Silver Creek, about one fourth mile east of Quarry Hill Peak and shall be known as the Providence Mine.

Located Jan 17<sup>th</sup> A. D. 1887

J. B. Bishop  
John T. Porter  
William Minto

D. A. H. ...

LOCATION NOTICE

Recorder's Office,  
TOMBSTONE, Cochise Co., A. T.

Filed and recorded at request of

J. A. Miller,

May 4<sup>th</sup>

A. D. 1889

at

345

P. M.

Book 12 Records of Mines,

Pages 47

W. J. Bradley

County Recorder.

PLAT  
 of the  
 PROVIDENCE MINING CLAIM  
 CALIFORNIA MINING DISTRICT  
 COCHISE COUNTY ARIZONA.

Containing 18.14 Acres.  
 Var. 12° 13' East.  
 Scale 200 ft = 1 inch.

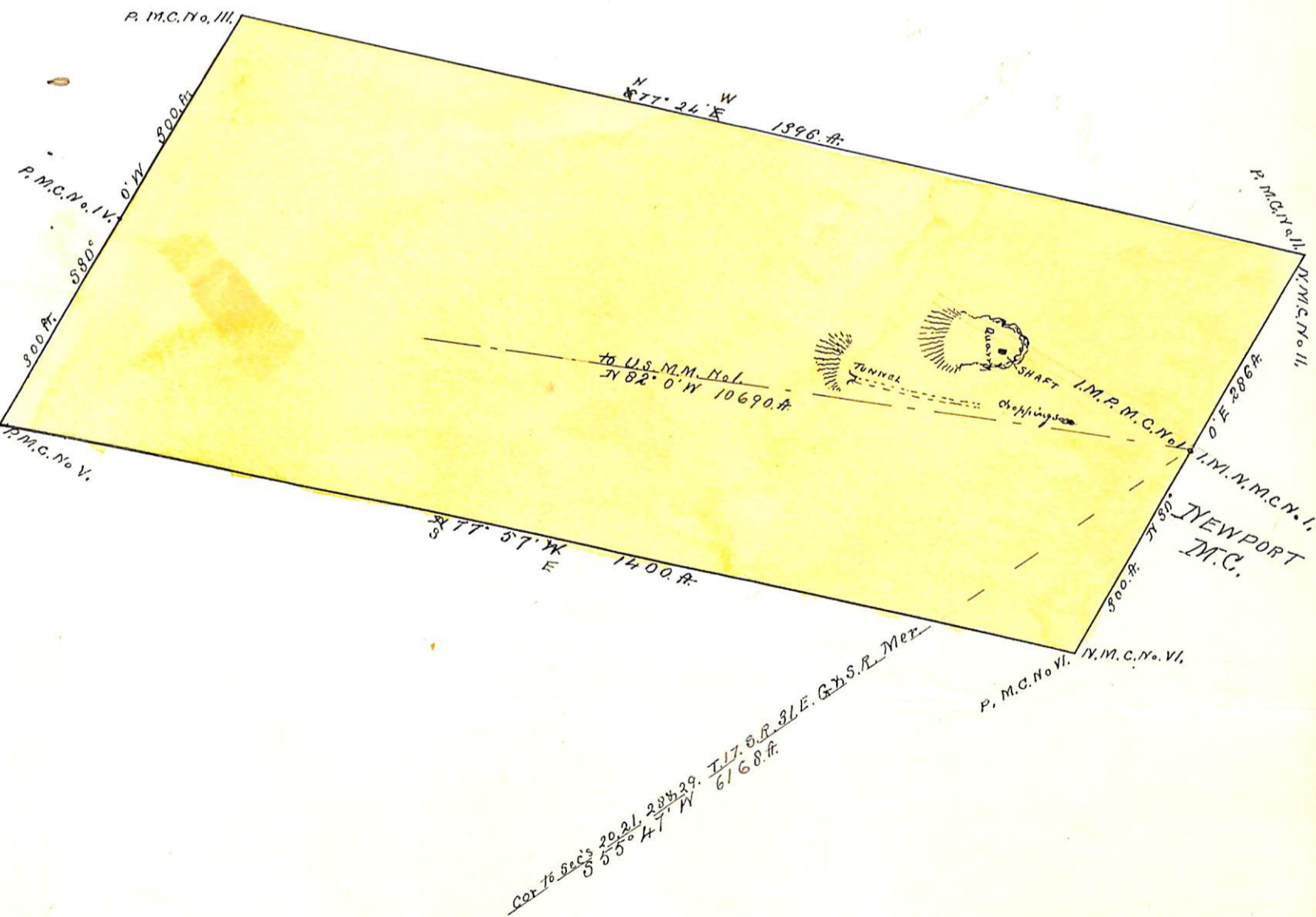

(4-687.)

# Surveyor General's Certificate of Approval of Field Notes and Survey of Mining Claim.

Department of the Interior,

Office of U. S. Surveyor General,

Tucson Arizona

July 9<sup>th</sup> 1889.

I, U. S. Surveyor General for Arizona,

do hereby certify that the foregoing and hereto attached Field Notes and Return of the Survey of the Mining Claim of

The Rhode Island Co.,

known as the

Providence,

situate in California mining district,

Cochise County, Arizona.

in Section \_\_\_\_\_, Township No. \_\_\_\_\_, Range No. \_\_\_\_\_

designated as Survey No. 884.

executed by H. G. Howe, U. S. Deputy Mineral

Surveyor, June 3<sup>rd</sup> 1889, under my instructions dated

May 6<sup>th</sup> 1889, have been critically examined and the

necessary corrections and explanations made, and the said Field Notes and Return, and

the Survey they describe, are hereby approved. A true copy of the copy of the location

certificate filed by the applicant for survey is included in the field notes.

John Wise  
Arizona.

U. S. Surveyor General for