

57

88

88

00

00

. MS

(4-683.)

Mineral Survey No. 885Lot No. 41Gila

Land District.

FIELD NOTES

OF THE SURVEY OF THE MINING CLAIM OF

Rhode Island Company

KNOWN AS THE

NewportCalifornia

Mining District,

Cochise

County,

ArizonaSection —, Township 17 S, Range — 31 ESurveyed under instructions dated May 6th, 1889,by A. G. Stawell,

U. S. Deputy Mineral Surveyor.

Claim located January 17th, 1887.Survey commenced June 1st, 1889.Survey completed June 3rd, 1889.

PRELIMINARY OATHS OF ASSISTANTS IN SURVEY OF MINING CLAIM.

WE, E. J. Hands and G. R. Montgomery,
do solemnly swear that we will well and faithfully execute the duties of chain carriers;
that we will level the chain upon even and uneven ground and plumb the tally-pins,
either by sticking or dropping the same; that we will report the true distance to all
notable objects, and the true length of all lines that we assist in measuring, to the best
of our skill and ability, and in accordance with instructions given us, in the survey of
the Mining Claim of The Rhode Island Company
_____, known as the
Newport
situate in California _____ mining district,
Cochise County, Arizona _____,
in Section _____, Township No. _____, Range No. _____.

E. J. Hands _____, Chainman.
G. R. Montgomery _____, Chainman.

Subscribed and sworn to by the above-named persons before
me this 1st day of June, 1889.

A. G. Howe

Notary Public.

I, Thos Blain _____, do solemnly swear that I will well and
truly perform the duties of axeman, in the establishment of corners and other duties,
according to instructions given me and to the best of my skill and ability, in the survey
of the Mining Claim of The Rhode Island Company

known as the Newport _____,
more fully described in the preceding affidavit.

Thos Blain _____, Axeman.

Subscribed and sworn to by the said Thos Blain
_____ before me this 1st day of
June _____, 1889.

A. G. Howe

Notary Public.

I, _____, do solemnly swear that I will
well and truly perform the duties of flagman, in the establishment of corners and other
duties, according to instructions given me and to the best of my skill and ability, in the
survey of the Mining Claim of _____

known as the _____,
more fully described in the preceding affidavit.

_____, Flagman.

Subscribed and sworn to by the said _____
_____ before me this _____ day of
_____, 18 _____.

Field Notes.
 of the Survey of the
 Newport Mining Claim in the
 California Mining District
 Cochise County Arizona.

Claimed by,
 The Rhode Island Company
 D.A. Miller Attorney.

Surveyed by H.G. Howe U.S.
 Deputy Mineral Surveyor under
 instructions from the Surveyor
 General of date May 6th 1889

Survey commenced June 1st 1889.
 Survey completed June 3rd 1889.

Beginning at the west end center
 monument described in the
 Notice of location, which point is
 also the east center of the Providence
 M.C. a cedar Post 5 ft. long 4x6 ins in
 monument of stones.

Post marked on east face I.M. N.M.C.
 No. 1. and upon the west face I.M. P.M.C.
 No. 1.

Note All Posts are marked letters cut in
 with marking Iron.

U.S. M.M. No. 1. bears $N 82^{\circ} 0' W$ 10690. ft.
 Cor to Sec's 20, 21, 28 & 29. T. 17. S. R. 31. E. G. & S.
 R. Meridian. bears $S 55^{\circ} 47' W$ 6168. ft.
 The S.E. cor. Ophir M.C. a 4x4 in Post. in
 mon. marked O.M.C. No. V. bears $S 74^{\circ} 38' W$
 3599. ft.

Thence $N 30^{\circ} 0' E$

bear $12^{\circ} 13' East$.

286. To old mon and 2x4 in stake on
 North Slope of mountain. which point

Feet. is also the N.E. cor. Providence M.C. where I set Post (Pine) 5ft. long. 4x6 ins. 6 ins in ground and surround by monument of stone.
 Post marked on east face N.M.C. No. II. and upon the west face P.M.C. No. II.
 Thence $560^{\circ} 18' E$

Var $12^{\circ} 13' East.$

Along North slope of mountain

1248. To Old mon. of stones. where I set Pine Post 5ft. long. 4x4 ins 6 ins in ground and surround by monument of stones.

Post marked N.M.C. No. III.

Thence $530^{\circ} 0' W.$

Var $12^{\circ} 13' East.$

300. To east center end mon. situated on top of divide. this point is described in the location as the place of commencing, where I set Pine Post 5ft. long 5x5 ins. 6 ins in ground and surround by monument of earth and stone.

Post marked N.M.C. No. IV.

Thence $530^{\circ} 0' W.$

Var $12^{\circ} 13' East.$

Down South slope of mountain

300. To S.E. cor. remains of mon. where I set Cedar Post 5ft. long. 5x5 in. and surround by monument of stones.

Post marked N.M.C. No. V.

Thence $N59^{\circ} 39' W.$

Var $12^{\circ} 13' East.$

Along South Slope of Mountain

1248 To the S.W. cor. which is also the S.E. cor Providence M.C. where I set Cedar Post 5ft. long. 5x5 ins. 6 ins in ground and surround by monument of stone.

Sheet. Post marked on east face N.M.C. No. VI.
and on west face P.M.C. No. VI.

Thence $N 30^{\circ} 0' E$

Var $12^{\circ} 13' East.$

300. up almost perpendicular Bluff.
To Post No. 1. and place of beginning
Survey of exterior lines.

The location Notice describes this
claim as being 1500 ft. in length. by
carefully running the center
line I find it 1348 ft. in length.

Area.

Total area of claim 16.98 acres.

Location.

This claim is located in the
California Mining District, in
Cochise County Arizona, about
 $\frac{3}{4}$ ths of a mile north of Silver Creek
and $\frac{1}{4}$ of a mile east of Quartz
Hill Peak, upon what is known
as Grand Royal Mountain,
and is bounded upon the west
by the Providence Mining Claim.

Improvements.

made upon this claim by claim-
ants or grantors, consist of.

A Shaft 4×6 ft. 51 ft deep. $N 66^{\circ} 25' W$
210 ft. from Post, N.M.C. No. IV.

A Shaft 4×6 ft. 15 ft. deep. $N 56^{\circ} 30' W$
396 ft. from Post, N.M.C. No. IV.

Croppings show $N 59^{\circ} 40' W$ 500 ft.,
from Post N.M.C. No. IV.

And I hereby certify that the value
of said improvements exceeds in
value the sum of five hundred
dollars.

There have been no improvements

made by other parties upon this claim.

Instruments used a Young's Improved Solar Transit and Steel Tape

Bar and Courses taken by use of the Solar apparatus

The variation tested by observation of Polaris.

H. G. Howe U.S. Deputy
Mineral Surveyor.

Tombstone June 12th 1899

AFFIDAVIT OF FIVE HUNDRED DOLLARS IMPROVEMENTS.

We, *G. R. Montgomery*, and *E. J. Hands*,
of lawful age, being first duly sworn according to law, depose and say that we are acquainted with the
Newport —
mining claim, situated in *the California*
Mining District, *Cochise* County, Arizona
Territory, for which *The Rhode Island Company* —
has made application for survey prior to application for patent under the provisions of the Act of
Congress approved May 10, 1872, and that the labor done and improvements made thereon by the appli-
cants and their grantors exceed Five Hundred Dollars in value, and further that we are not per-
sonally interested in said mine.

G. R. Montgomery
E. J. Hands

TERRITORY OF ARIZONA,
County of *Cochise* } SS.

SWORN to and subscribed before me, this *3rd* day
of *June*, 188*9*
A. G. Howe
Notary Public.

FINAL OATHS FOR SURVEYS. ⁸

LIST OF NAMES.

A list of the names of the individuals employed by H. G. Howe
 United States Deputy Mineral Surveyor, to assist in running, measuring, and marking the lines
 corners and boundaries described in the foregoing field notes of the survey of the mining claim
 of The Rhode Island Company.
 known as the Newport.
 and showing the respective capacities in which they acted.

E. J. Hands , Chairman.
G. R. Montgomery , Chairman.
Thos Blair , Axman.
 , Flagman.

FINAL OATHS OF ASSISTANTS.

We, E. J. Hands, G. R. Montgomery and Thos Blair
 and _____, do solemnly swear that we assisted
H. G. Howe , United States Deputy Mineral Surveyor, in marking the corners and
 surveying the boundaries of the mining claim of
The Rhode Island Company.
 known as the
Newport Mining Claim , represented
 in the foregoing field notes as having been surveyed by said deputy mineral surveyor and under
 his direction; and that said survey has been in all respects, to the best of our knowledge and
 belief, faithfully and correctly executed, and the corner and boundary monuments established
 according to law and the instructions furnished by the United States Surveyor-General for
Arizona.

E. J. Hands , Chairman.
G. R. Montgomery , Chairman.
Thos Blair , Axman .
 , Flagman.

Subscribed and sworn to by the above-named persons before me
 this 3rd day of June, 1887.

H. G. Howe.

Notary Public.

FINAL OATH OF U. S. DEPUTY MINERAL SURVEYOR.

I, H. G. Howe, U. S. Deputy Mineral Surveyor, do solemnly swear that, in pursuance of instructions received from the United States Surveyor General for Arizona, dated May 6th, 1889, I have, in strict conformity to the laws of the United States, the official regulations and instructions thereunder, and the instructions of said Surveyor General, faithfully and correctly executed the survey of the Mining Claim of The Rhode Island Company, known as the Newport, situate in California Mining District, Cochise County, Arizona in Section _____ Township No. _____ Range No. _____ and designated as Survey No. _____, as represented in the foregoing field notes, which accurately show the boundaries of said mining claim as distinctly marked by monuments on the ground, and described in the attached copy of the location certificate, which was received by me from the Surveyor General with said instructions, and that all the corners of said survey have been established and perpetuated in strict accordance with the law, official regulations and instructions thereunder; and I do further solemnly swear that the foregoing are the true and original field notes of said survey and my report therein, and that the labor expended and improvements made upon said mining claim by claimant or their grantors are as therein fully stated, and that the character, extent, location and itemized value thereof are specified therein with particularity and full detail, and that no portion of said labor or improvements so credited to this claim has been included in the estimate of expenditures upon any other claim.

H. G. Howe,
U. S. Deputy Mineral Surveyor.

Subscribed and sworn to by the said H. G. Howe,
U. S. Deputy Mineral Surveyor, before me Geo N Daily
Clerk Dist Court this 12th
day of June, 1889.

Geo N Daily
Clerk Dist Court N. T.

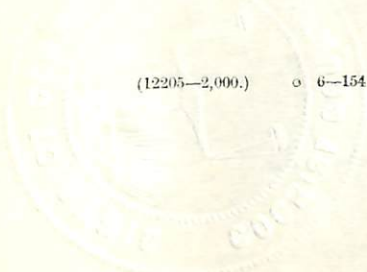

Location Notice,

10

Notice is hereby given, that the undersigned, in compliance with the requirements of the Mining Act of Congress, approved May 10th 1872. have this day located and claim fifteen hundred linear feet along the course of this lead, lode or vein of mineral bearing quartz, and three hundred feet in width on each side of the middle of said lead, lode or vein, situated in the California Mining District, County of Cochise, Arizona, and more particularly described as follows; to wit: Commencing at this monument of stones, being the center of the Easterly end of claim, which is about 300 feet from where this notice is posted, thence Southerly 300 feet to a monument of stones; thence Westerly 1500 feet to a monument of stones; thence Northerly 200 feet to a monument of stones; being the center of the Westerly end of claim; thence Northerly 200 feet to a monument of stones; thence Easterly 1500 feet to a monument of stones; thence Southerly 200 feet to the place of beginning. This claim is situated about two and three fourths miles Easterly from the U.S. Mineral Monument No 1. The claim herein located is situated on Grand Royal Mountain, three fourths of a mile north of Silver Creek and about one half mile East of Quartz Hill Peak, and shall be known

TERRITORY OF ARIZONA, }
County of Cochise } ss.

W. F. Bradley,

I. ~~A. T. JONES~~, County Recorder in and for the County of Cochise, do hereby

certify that the above and foregoing is a full, true and correct copy of of the
original Location Notice of the Newport Mine
in California Mining District.

as appears of record now in my office in Book 11..., Page 417.

Record of Mines,

In Witness Whereof, I have hereunto set my hand and affixed
my official seal, at my office, in Tombstone, this

11th day of June, A. D. 1888.

W. F. Bradley,

County Recorder

as the "Newport" Mine, Located Jan. 17th A.D.,
1887,

William Minto,

D.A. Miller,

J.B. Bishop,

John S. Porter.

Filed and recorded at request of Wells Fargo Express
December 31st A.D., 1887, at 3¹⁵ P.M.

W.F. Bradley,

County Recorder,

PLAT
 of the
 NEWPORT MINING CLAIM in the
 CALIFORNIA MINING DISTRICT
 COCHISE COUNTY ARIZONA

Containing 16.98 Acres.

Var: 12° 13' East

Scale 200ft = 1 inch

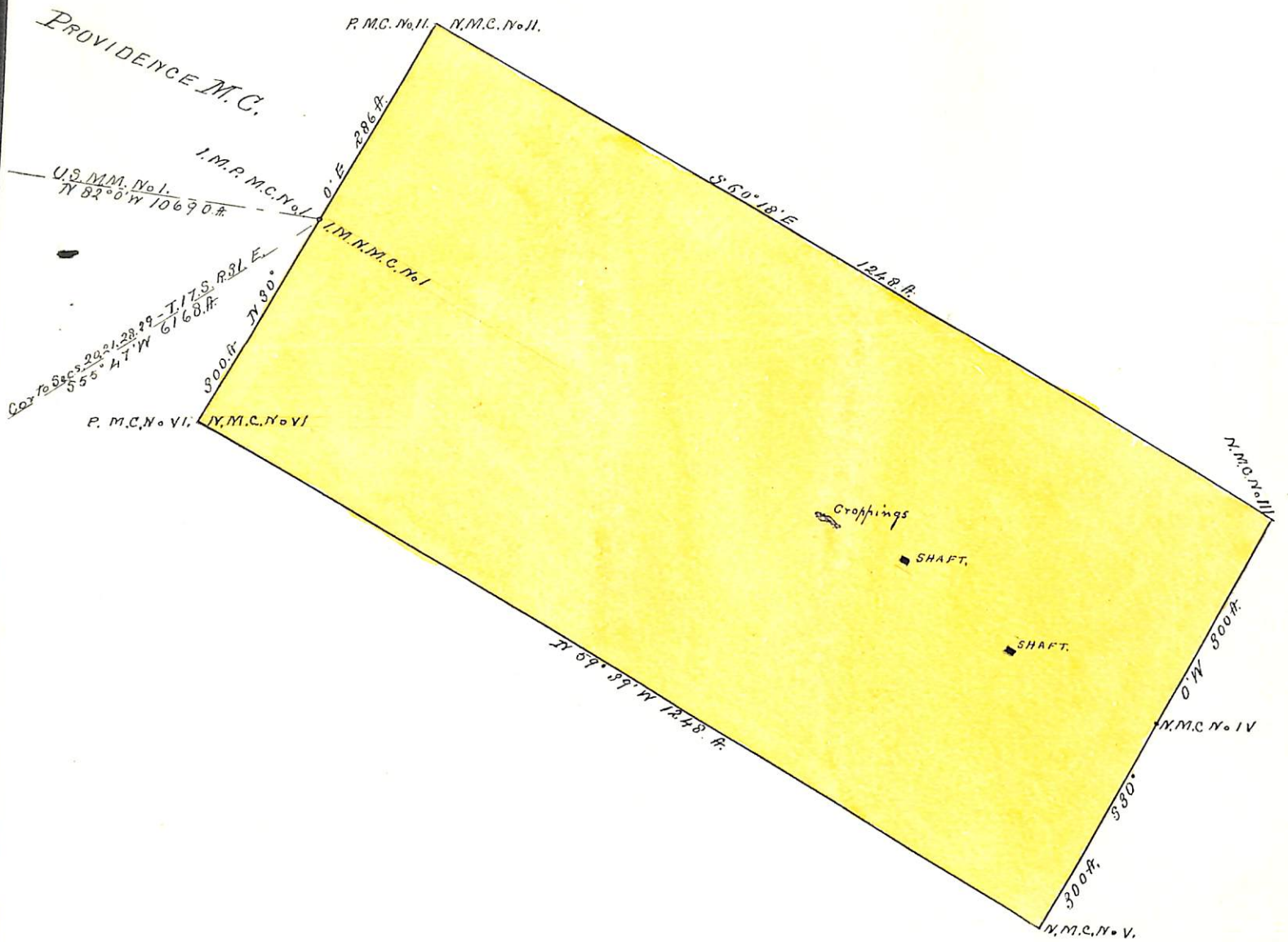

(4-687.)

Surveyor General's Certificate of Approval of Field Notes and Survey of Mining Claim.

Department of the Interior,

Office of U. S. Surveyor General,

Tucson Arizona

July 9th, 1889.

I, U. S. Surveyor General for *Arizona*,

do hereby certify that the foregoing and hereto attached Field Notes and Return of the Survey of the Mining Claim of

Rhode Island Company

, known as the

Newport

situate in *California* mining district,

Cochise County, *Arizona*

in Section *—*, Township No. *—*, Range No. *—*

, designated as Survey No. *—*

executed by *H. G. Howe*, U. S. Deputy Mineral

Surveyor, *June 3rd*, 1889, under my instructions dated

May 6th, 1889, have been critically examined and the

necessary corrections and explanations made, and the said Field Notes and Return, and

the Survey they describe, are hereby approved. A true copy of the copy of the location

certificate filed by the applicant for survey is included in the field notes.

John Hise
Arizona

U. S. Surveyor General for

o 6-102