

**M
S**

0

0

9

0

3

(4-683.)

Mineral Survey No. 903.

Lot No. 43.

Prescott

Land District.

FIELD NOTES

OF THE SURVEY OF THE MINING CLAIM OF

William G. Dodge and D. Wittis
James

KNOWN AS THE

Copper World
Cedar Valley

Mining District,

Hohave County, Arizona

Section _____, Township 17 N, Range 16 W

Surveyed under instructions dated October 7th, 1889
by J. B. Foster
U. S. Deputy Mineral Surveyor.

Claim located January 1st, 18 86.
Survey commenced October 17th, 18 89.
Survey completed October 17th, 18 89.

PRELIMINARY OATHS OF ASSISTANTS IN SURVEY OF MINING CLAIM.

10

WE, A. J. Shrope and Ole Ingebreton,
do solemnly swear that we will well and faithfully execute the duties of chain carriers;
that we will level the chain upon even and uneven ground and plumb the tally-pins,
either by sticking or dropping the same; that we will report the true distance to all
notable objects, and the true length of all lines that we assist in measuring, to the best
of our skill and ability, and in accordance with instructions given us, in the survey of
the Mining Claim of Wm E Dodge and D. Willis James
....., known as the
Copper World
situate in Cedar Valley mining district,
El Mohave County, Arizona,
in Section, Township No., Range No.

CB Foster

A. J. Shrope, Chainman.
Ole Ingebreton, Chainman.

Subscribed and sworn to by the above-named persons before
me this 16 day of October, 1889.

C. B. Foster
Notary Public

I, T. McMahon, do solemnly swear that I will well and
truly perform the duties of axeman, in the establishment of corners and other duties,
according to instructions given me and to the best of my skill and ability, in the survey
of the Mining Claim of D. Willis James and
William E. Dodge
known as the Copper World,
more fully described in the preceding affidavit.

CB Foster

T. McMahon, Axeman.

Subscribed and sworn to by the said T. McMahon
before me this 16 day of
October, 1889.

C. B. Foster
Notary Public

I,, do solemnly swear that I will
well and truly perform the duties of flagman, in the establishment of corners and other
duties, according to instructions given me and to the best of my skill and ability, in the
survey of the Mining Claim of,
.....
known as the,
more fully described in the preceding affidavit.

....., Flagman.

Subscribed and sworn to by the said,
before me this day of
....., 18

Field Notes
 of the survey of the
 Copper World Mining Claim
 in Cedar Valley Mining District
 Mohave County, Arizona
 Claimed by

William E Dodge and S Willis James

Surveyed by C. B. Foster, U.S. Deputy
 Mineral Surveyor under instructions
 from the Surveyor General of
 date Oct 4th 1889.

Survey commenced Oct 17, 1889
 Survey completed Oct 17, 1889.

Feet
 Description of Survey
 Beginning at the Initial Mon.
 Mentioned in location notice and
 marking the westerly end center
 of claim where I mark a + at
 point of corner and on N. side
 of + I mark L.M.C.W. No 1 on
 top of granite boulder 8 ft long
 by 4 ft high by 4 ft thick. and on
 S. side of marks build mound
 of stones.

U.S. Min. Mon No 2 brs S 51° 24' ^W 9205 ft. ✓
 Thence N 39° W

300 Va 15° East
 To point where I set a slate stone
 20x14x4 ins 1 ft in ground and
 surrounded same with mound
 of stones. Stone marked CW No 2
 orig loc ~~2100~~ brs S 50° W 610 ft.
 Thence N 31° E

1170 Va 15° East
 To point where I set a sand stone
 24x12x10 ins 1 ft in ground and

1170 Trail brs N and S

Feet

Surrounded same with mound of stones. Stone marked C.W. No. 3. original loc mon brs N.E. 42 ft.

Thence S 39° E

Va 15° East

300 To easterly end center of claim where I set a sand stone 20 x 12 x 10 ins 1 ft in ground and surrounded same with mound of stones Stone marked C.W. No. 4.

Burch's peak brs S 34° E. original loc mon brs N 51° E 38 ft.

Thence S 39° E (same course)

Va 15° East

222 Trail brs N.E. and S.W.

300 To point where I mark + and under + C.W. No. 5. on N face of granite ledge 20 ft long E + W by 12 wide by 4 ft high and on top of ledge above marks build mound of stones.

original loc. mon not found.

Thence S 51° W

Va 15° East

1500 To loc mon where I mark + and under + C.W. No. 6. on W face of granite boulder 8 ft. long by 4 ft high by 4 ft wide and on top of boulder build mound of stones.

Thence N 39° W

Va 15° East

52 To trail brs N.E. and S.W.

300 To mon and + S.M.C.W. No. 1. place of beginning.

Area

Net area of claim 20.66 acres.

Location

This claim is located along a ridge west of the summit of the

Aualpai Mountains sides
on unsurveyed land.

Improvements
made upon this claim by
Claimants or grantors consist
of a cut 20 ft long by 3 ft wide by 4 ft
deep. $N 54^{\circ} E$ 700 ft. from Mon.
I. M. C. W. No. 1.

A Shaft 8' x 8' 25 ft deep $N 53^{\circ} E$
750 ft from Mon I. M. C. W. No. 1.

A Tunnel 6' x 4' 30 ft deep $N 52^{\circ} E$
810 ft. from Mon I. M. C. W. No. 1.

A Tunnel 6' x 4' 25 ft deep $N 50^{\circ} E$
950 ft. from Mon I. M. C. W. No. 1.

A Shaft 6' x 4' 60 deep $N 51^{\circ} E$
1000 ft. from Mon I. M. C. W. No. 1.

A Tunnel 6' x 4' 40 deep $N 51^{\circ} E$
1200 ft from Mon I. M. C. W. No. 1.

And I hereby certify that the
value of said improvements
exceeds the sum of five hundred
dollars.

There have been no improvements
made by other parties on this
claim

Instruments used a Gurley
Transit and 50 ft steel chain.

Var and Courses determined by
observation of Polaris.

C. B. Foster

U. S. Deputy Mineral Surveyor.

October 17th 1889.

AFFIDAVIT OF FIVE HUNDRED DOLLARS IMPROVEMENTS.

WE, *A. J. Shrope* and *T. M. Mahon*

of lawful age, being first duly sworn according to law, depose and say that we are acquainted with the "*Copper World*"

mining claim, situated in *Cedar Valley*

Mining District, *Mohave* County, Arizona

Territory, for which *William E. Dodge* and *O. Willis James* have made application for survey prior to application for patent under the provisions of the Act of Congress approved May 10, 1872, and that the labor done and improvements made thereon by the applicants and their grantors exceed Five Hundred Dollars in value, and further that we are not personally interested in said mine.

A. J. Shrope
T. M. Mahon

TERRITORY OF ARIZONA,
County of *Mohave* } SS.

M. Foster

SWORN to and subscribed before me, this *19th* day

of *October* 188*9*.

C. B. Foster
Notary Public

FINAL OATHS FOR SURVEYS.

LIST OF NAMES.

A list of the names of the individuals employed by C. B. Foster
 United States Deputy Mineral Surveyor, to assist in running, measuring, and marking the lines
 corners and boundaries described in the foregoing field notes of the survey of the mining claim
 of William E. Dodge and D. Willis James
 known as the Copper World
 and showing the respective capacities in which they acted.

A. J. Shrope , Chairman.
Ole Ingelbreton , Chairman.
T. W. Mahon , Axman.
 , Flagman.

FINAL OATHS OF ASSISTANTS.

We, A. J. Shrope, Ole Ingelbreton
 and T. W. Mahon , do solemnly swear that we assisted C. B.
Foster , United States Deputy Mineral Surveyor, in marking the corners and
 surveying the boundaries of the mining claim of William E. Dodge
 and D. Willis James
 known as the "Copper-
World" , represented

in the foregoing field notes as having been surveyed by said deputy mineral surveyor and under
 his direction; and that said survey has been in all respects, to the best of our knowledge and
 belief, faithfully and correctly executed, and the corner and boundary monuments established
 according to law and the instructions furnished by the United States Surveyor-General for
Arizona

W. B. Foster

A. J. Shrope , Chairman.
Ole Ingelbreton , Chairman.
T. W. Mahon , Axman .
 , Flagman.

Subscribed and sworn to by the above-named persons before me
 this 19 day of October, 1889

C. B. Foster
 Notary Public

FINAL OATH OF U. S. DEPUTY MINERAL SURVEYOR.

I, C. B. Foster, U. S. Deputy Mineral Surveyor, do solemnly swear that, in pursuance of instructions received from the United States Surveyor General for Arizona, dated Oct 7, 1889, I have, in strict conformity to the laws of the United States, the official regulations and instructions thereunder, and the instructions of said Surveyor General, faithfully and correctly executed the survey of the Mining Claim of Mr. C. Dodge and D. Willis James, known as the Copper World, situate in Cedar Valley Mining District, Mohave County, Arizona, in Section Township No. Range No. and designated as Survey No. 903, as represented in the foregoing field notes, which accurately show the boundaries of said mining claim as distinctly marked by monuments on the ground, and described in the attached copy of the location certificate, which was received by me from the Surveyor General with said instructions, and that all the corners of said survey have been established and perpetuated in strict accordance with the law, official regulations and instructions thereunder; and I do further solemnly swear that the foregoing are the true and original field notes of said survey and my report therein, and that the labor expended and improvements made upon said mining claim by claimants or their grantors are as therein fully stated, and that the character, extent, location and itemized value thereof are specified therein with particularity and full detail, and that no portion of said labor or improvements so credited to this claim has been included in the estimate of expenditures upon any other claim.

C. B. Foster
U. S. Deputy Mineral Surveyor.

Subscribed and sworn to by the said C. B. Foster,
U. S. Deputy Mineral Surveyor, before me
A Notary Public this 25th
day of October, 1889.

J. J. Hawkins
Notary Public

Copper World

Cedar Valley

Notice of Location January 1st 1886.

We the undersigned this day locate 1500 ft fifteen hundred linear feet on this ledge. We expect to hold and work the same according to the mining laws of the United States. More particularly described as follows to wit.

Com
 This notice is placed on our initial monument which is placed at west center end of claim. Line running thence three hundred feet in a northerly direction to a monument of stone; thence fifteen hundred feet in an Easterly direction parallel with the vein to a monument of stone; thence six hundred feet at right angles across the vein in a southerly direction to a monument of stone; thence fifteen hundred feet parallel with the vein in a westerly direction to a monument of stone; thence three hundred feet in a northerly direction to the place of beginning. Said claim is situated in Cedar Valley mining district Mohave County Arizona Territory and has been formerly known as the Pacific Copper mine, and is located about fourteen miles from Yucca station on A.P.R. Road in an Easterly direction and about three miles in an Easterly direction from McKenzie's Spring; Said claim shall be known as the Copper World Located

John Riley

A. J. Shrop

Joseph Prick

J. A. Butler

I hereby Certify that the annexed or within notice

10
was filed for record in the office of the District
Recorder of the Cedar Valley Mining District.
Mohave County Territory of Arizona, January 24th
A.D. 1886 at 10 o'clock P.M. at request of J. N.
Stephenson of Mineral Park, and that the same
is duly recorded in the Mining Records of Said
Mining District in Book 2 page 161

John Falvey
District Mining Recorder Cedar Valley Mining
District.

Recorded at the request of J. N. Stephenson
Febry 2d A.D. 1886 at 45 minutes past 11 o'clock
A.M.

A. Bucksbaum
County Recorder

Territory of Arizona }
County of Mohave } 3rd Sec.

J. E. J. Godman County
Recorder in and for Mohave County Arizona
Territory do hereby Certify that the above and
going is a full, true and correct copy of
the Location notice of the Copper World
Mining Claim, as the same appears of record
in Book 2 page 380 Mining records of
Mohave County Arizona Territory.

In Witness whereof I have hereunto set
my hand and affixed my official seal this
4th day of September A.D. 1889

E. J. Godman
County Recorder



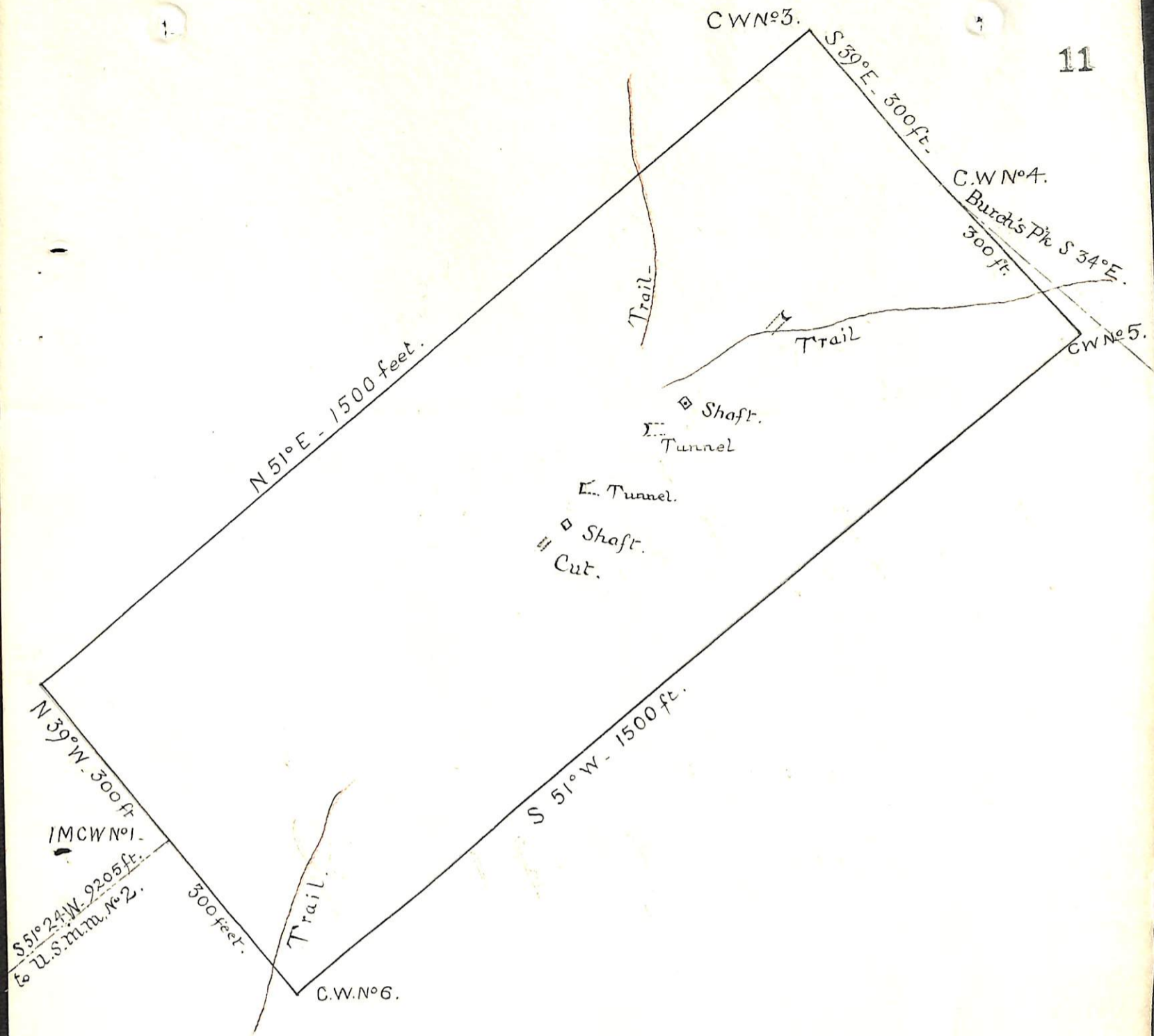

PLAT OF THE COPPER WORLD MINING CLAIM,
 Cedar Valley Mining District,
 Mohave County, Arizona.

Claimed by Wm. E. Dodge & D. Willis James

SURVEYED BY

C. B. FOSTER, U.S.D.S.

Oct. 17, 1889.

Contains $20\frac{66}{100}$ Acres.

Scale 200 feet to 1 inch. Var 15° E.

(4-687.)

Surveyor General's Certificate of Approval of Field Notes and Survey of Mining Claim.

Department of the Interior,

Office of U. S. Surveyor General,

Tucson, Arizona
November 4th, 1889

I, U. S. Surveyor General for

Arizona

do hereby certify that the foregoing and hereto attached Field Notes and Return of the

Survey of the Mining Claim of

William E. Dodge
and D. Willis James.

_____ known as the

Copper World,

situate in _____ mining district,

Leadville Valley

Hohave County, *Arizona*

in Section _____, Township No. _____, Range No. _____

and designated as Survey No. *903.*

executed by *C. B. Foster*, U. S. Deputy Mineral

Surveyor, *October 17th, 1889*, under my instructions dated

October 7th, 1889, have been critically examined and the

necessary corrections and explanations made, and the said Field Notes and Return, and

the Survey they describe, are hereby approved. A true copy of the copy of the location

certificate filed by the applicant for survey is included in the field notes.

Amal Johnson
Arizona

U. S. Surveyor General for