

MS

0

0

9

3

1



(4-683.)

Mineral Survey No. 931.

Lot No. 38. A.

Gila

Land District.

FIELD NOTES

OF THE SURVEY OF THE MINING CLAIM OF

James H. Sevis

and John A. Duncan

KNOWN AS THE

"Virginia"

Sevis

Mining District,

Coconino

County,

Arizona.

Section

Township

13 S

Range

28 E

Surveyed under instructions dated

June 10, 1890.

by

H. G. Frowe

U. S. Deputy Mineral Surveyor

Claim located

February 9<sup>th</sup>, 1884.

Survey commenced

June 12<sup>th</sup>, 1890.

Survey completed

June 13<sup>th</sup>, 1890.



# PRELIMINARY OATHS OF ASSISTANTS IN SURVEY OF MINING CLAIM.

WE, Michael Kinchella and Henry Bowman,  
do solemnly swear that we will well and faithfully execute the duties of chain carriers;  
that we will level the chain upon even and uneven ground and plumb the tally-pins,  
either by sticking or dropping the same; that we will report the true distance to all  
notable objects, and the true length of all lines that we assist in measuring, to the best  
of our skill and ability, and in accordance with instructions given us, in the survey of  
the Mining Claim of James H. Jervis and  
John A. Duncan, known as the  
Virginia Mining Claim,  
situate in the Jervis mining district,  
Cochise County, Arizona,  
in Section \_\_\_\_\_, Township No. \_\_\_\_\_, Range No. \_\_\_\_\_.

M. E. Kinchella, Chainman.  
Henry Bowman, Chainman.

Subscribed and sworn to by the above-named persons before  
me this 12<sup>th</sup> day of June, 1890.

H. C. Howe  
Notary Public

I, \_\_\_\_\_, do solemnly swear that I will well and  
truly perform the duties of axeman, in the establishment of corners and other duties,  
according to instructions given me and to the best of my skill and ability, in the survey  
of the Mining Claim of \_\_\_\_\_

known as the \_\_\_\_\_,  
more fully described in the preceding affidavit.

\_\_\_\_\_, *Axeman.*

Subscribed and sworn to by the said \_\_\_\_\_  
before me this \_\_\_\_\_ day of  
\_\_\_\_\_, 18 \_\_\_\_\_.

I, \_\_\_\_\_, do solemnly swear that I will  
well and truly perform the duties of flagman, in the establishment of corners and other  
duties, according to instructions given me and to the best of my skill and ability, in the  
survey of the Mining Claim of \_\_\_\_\_

known as the \_\_\_\_\_,  
more fully described in the preceding affidavit.

\_\_\_\_\_, *Flagman.*

Subscribed and sworn to by the said \_\_\_\_\_  
before me this \_\_\_\_\_ day of  
\_\_\_\_\_, 18 \_\_\_\_\_.



Field notes  
of the Survey of the  
Virginia mining claim  
in the Texas mining District  
Cochise County Arizona

Claimed by.

James B. Tevis and John A. Duncan

Surveyed by W. L. Howe U. S. Deputy  
Mineral Surveyor, under instructions  
from the Surveyor General. of date  
June 10<sup>th</sup> 1890

Survey commenced June 12<sup>th</sup> 1890

Survey completed June 13<sup>th</sup> 1890

Description of Survey

Beginning at the initial mon.  
mentioned in location notice  
and marking the north westerly center  
end of claim a monument of stone  
built upon the croppings of ledge  
which point is also the S. E. center of  
the felt mining claim. where I set  
juniper post 5 ft long 4 1/2 ins square  
on croppings and surrounded by  
monument of stone 5 ft at base  
and 3 ft high.

Post marked I. M. V. M. C. no 1

no bearing trees near

From which U. S. M. M. no 1 T. D. bears  
S 17° 50' E 990 ft.

The initial mon. Virginia mill site bears  
N 10° 24' E 6425 ft.

Thence N 56° 20' E

Dist. 11° 30' East

Feet

Down very steep

300

To N. E. cor, ~~where~~ There being no mon or stake, I establish a cor.  
I set juniper  
post 5 ft long 4 1/2 ins sq on solid  
rock and surrounded by monument  
of stone 4 1/2 ft at base & 3 ft high

Post marked V. M. C. no 2



no bearing trees near  
Thence S 23° 25' East

Var 11° 30' East

Tree

Along north Easterly slope of Hill

845

Center of device supporting  
Automatic Tramway, from mine to  
mill.

1500

To the South Easterly cor. ~~near~~ as des-  
cribed in location notice

which is also the N. Easterly cor. of the  
There being no more I establish a cor. and  
State of Missouri M. C. ~~where~~ set

Juniper Post 5 ft long 4 1/2 ins sq. 6 ins  
in ground and surrounded by  
monument of stone 4 1/2 ft at base  
and 3 ft high. to mark the cor.

Post marked Y. M. C. No. 3.

From which an oak 12 ins diam.

blazed and marked B. T. Y. M. C. No. 3  
bears South 23 ft.

The N. Easterly trunk of a double oak  
11 ins diam. Blazed and marked

B. T. Y. M. C. No. 3 bears N 10° 0' W. 7 1/2 ft.

The westerly center and initial mon.

State of Iowa M. C. bears S 63° 10' E.

41 ft. dist.

Thence S 56° 20' W.

Var 11° 30' East

Ascending to top of hill

300

To the South Easterly center of claim

477.5 Intersect westerly side line Silver Chief M.C.  
S 17° 55' E 161 ft. from original N.W. cor. a mon of stone.

See slip X

no other trees near  
as described in location notice.

600

To the S. W. cor. ~~near~~ which is also the

N. W. Cor. State of Missouri Mining Claim  
I establish a cor. and

where set Juniper post 5 ft long



no bearing trees near  
thence S 23° 25' East

Var 11° 30' East

Tree  
8115 Along north Easterly slope of Hill  
Center of device supporting  
Automatic Tramway, from mill to  
mill.

1500 To the South Easterly cor. ~~where~~ as des-  
cribed in location notice  
which is also the N. Easterly cor. of the  
State of Missouri M. C. ~~where~~ set  
Juniper Post 5 ft long 1 1/2 ins sq. 6 ins  
in ground and surrounded by  
monument of stone 1 1/2 ft at base  
and 3 ft high. to mark the cor.

Post marked Y. M. C. no 3

From which an oak 12 ins diam.  
blazed and marked B. T. Y. M. C. no 3  
bears South 23 ft.

The N. Easterly trunk of a double oak  
11 ins diam. Blazed and marked  
B. T. Y. M. C. no 3 bears N 10° 0' W. 7 1/2 ft.

The Westerly center and Initial mon.  
State of Iowa M. C. bears S 63° 10' E.  
41 ft. dist.

Thence S 56° 20' W.

Var 11° 30' East

Ascending to top of hill

300 To the South Easterly center of claim  
which is also the Initial mon of  
the State of Missouri Mining Claim  
a monument of stone.  
where I set Juniper Post 5 ft long  
1 1/2 ins square on solid ground and  
surrounded by monument of stone  
1 1/2 ft at base and 3 ft high

Post marked Y. M. C. no 4

From which an oak 12 ins diam.

blazed and marked B. T. Y. M. C. no 4 bears  
N 36° E. 4 ft dist.

See slip X  
no other trees near  
as described in location notice.

600 To the S. W. cor. ~~where~~ which is also the  
N. W. cor. State of Missouri Mining Claim  
I establish a cor. and  
where I set Juniper post 5 ft long

477.5 Intersect wetherly side line Silver Chief M.C.  
S17°55'E 161. ft. from. original N.W. cor. a mon of stone.



4 ins square on solid ground and surrounded by a monument of stone 4 1/2 ft at base & 3 ft high.

Post marked Y. M. C. no 5

The initial <sup>Silver Chief a mon of stone,</sup> mon. bears N 70° 7' W 193 ft.

No bearing trees near

Thence N 23° 25' W.

Var 11° 30' East

Feet Along the top of hill

158.2 Intersect N. westerly end, line of Silver

Chief mine, bears S 56° 30' W. 137 ft. from old cor. <sup>has describe d. in location notice. There being no mon I establish one</sup>

1500 To N. W. Cor. ~~mon. where~~ and set Juniper

post 5 ft long 4 ins sq on solid stone and surrounded by monument of stone 5 ft at base and 4 ft high

Post marked Y. M. C. no 6

From which a Juniper 16 ins diam.

blazed marked B. T. Y. M. C. no 6 bears

S. 86° 0' W. 12 ft.

No other trees near

Thence N 56° 20' E

Var 11° 30' East

142 Top of Hill bears N. N. W and S. S. E.

272 Point of bluff 30 ft high, almost perpendicular.

300 To Post no 1 and place of beginning the survey of Exterior lines

Area

Total area of claim 20.33 acres

The conflict with the Silver Chief of .460 acres is claimed in this application.

Location

This claim is located in Lewis Mining District Cochise County Arizona, about 2 miles north of Dos Cabezas Peak, and upon the ridge south of Lewis Gulch and is bounded upon the South west by the ~~land~~ <sup>Silver Chief and</sup> Silver Queen, upon the north west by the J. M. C. and South East by the State of Missouri M. C.



## Improvements

Made upon this claim by claimants  
or grantors, consists of an Incline  
Shaft 4 x 6 and 100 ft deep with drifts  
N. W. & S. E. bears  $S 38^{\circ} 45' E$  445 ft from  
Post 1 N. V. M. C. No. 1.

Main working shaft 8 x 12 10 ft deep  
(just commenced sinking) bears  $S 29^{\circ} 10' E$   
830 ft from Post 1 N. V. M. C. No. 1.

A cut 8 x 8 ft 10 ft deep bears  
 $N 22^{\circ} 20' W$  439 ft from Post V. M. C. No. 4

A cut 8 x 8 ft 3 ft deep bears  
 $N 26^{\circ} 10' W$  365 ft from Post V. M. C. No. 4

And I hereby certify that the  
value of said improvements exceed  
in value the sum of five hundred  
dollars.

There have been no improvements  
made by other parties upon this  
claim

Instruments used a Youngs improved  
Solar Transit & Steel Tape  
Bar and course taken by use of  
the Solar apparatus

A. G. Howe  
U. S. Deputy Mineral Surveyor.

July 21<sup>st</sup> 1890.



### Affidavit of Five Hundred Dollars Improvements.

We, Michael Kinchella and Henry Bowman.

of lawful age, being first duly sworn according to law, depose and say: that we are acquainted with the

Virginia mining claim, situated in

the Sevis Mining District, Cochise County,

Arizona Territory, for which

James A. Sevis and John A. Duncan,

have made application for survey prior to application for patent under the provisions of the Act of

Congress, approved May 10, 1872; and that the labor done and improvements made thereon by the

applicants and this grantors exceed Five Hundred Dollars in value, and further that we are not

personally interested in said mine.

M. E. Kinchella

Henry Bowman

TERRITORY OF ARIZONA,  
County of Cochise } ss.

SWORN to and subscribed before me, this 20<sup>th</sup> day

of June 1890.

Scott White, J.P.  
Precinct No. 7.



# FINAL OATHS FOR SURVEYS.

## LIST OF NAMES.

A list of the names of the individuals employed by H. G. Howe,  
 United States Deputy Mineral Surveyor, to assist in running, measuring, and marking the lines  
 corners and boundaries described in the foregoing field notes of the survey of the mining claim  
 of James H. Lewis and John A. Duncan  
 known as the Virginia mining claim,  
 and showing the respective capacities in which they acted.

Michael Kinchella, Chainman.  
Henry Bowman, Chainman.  
 \_\_\_\_\_, Axman.  
 \_\_\_\_\_, Flagman.

## FINAL OATHS OF ASSISTANTS.

We, Michael Kinchella and  
 and Henry Bowman, do solemnly swear that we assisted  
H. G. Howe, United States Deputy Mineral Surveyor, in marking the corners and  
 surveying the boundaries of the mining claim of  
James H. Lewis and John A. Duncan,  
 known as the  
Virginia mining claim, represented  
 in the foregoing field notes as having been surveyed by said deputy mineral surveyor and under  
 his direction; and that said survey has been in all respects, to the best of our knowledge and  
 belief, faithfully and correctly executed, and the corner and boundary monuments established  
 according to law and the instructions furnished by the United States Surveyor-General for  
Arizona.

M. E. Kinchella, Chainman.  
Henry Bowman, Chainman.  
 \_\_\_\_\_, Axman.  
 \_\_\_\_\_, Flagman.

Subscribed and sworn to by the above-named persons before me  
 this 20th day of June, 1890.

Scott White  
Recorder



(4-686.)

FINAL OATH OF U. S. DEPUTY MINERAL SURVEYOR.

I, H. G. Howe, U. S. Deputy Mineral Surveyor, do solemnly swear that, in pursuance of instructions received from the United States Surveyor General for Arizona Territory, dated June 10<sup>th</sup>, 1890, I have, in strict conformity to the laws of the United States, the official regulations and instructions thereunder, and the instructions of said Surveyor General, faithfully and correctly executed the survey of the Mining Claim of James A. Lewis and John A. Duncan, known as the Virginia Mining Claim, situate in the Lewis Mining District, Cochise County, Arizona, in Section \_\_\_\_\_, Township No. \_\_\_\_\_, Range No. \_\_\_\_\_, and designated as Survey No. 931, as represented in the foregoing field notes, which accurately show the boundaries of said mining claim as distinctly marked by monuments on the ground, and described in the attached copy of the location certificate, which was received by me from the Surveyor General with said instructions, and that all the corners of said survey have been established and perpetuated in strict accordance with the law, official regulations and instructions thereunder; and I do further solemnly swear that the foregoing are the true and original field notes of said survey and my report therein, and that the labor expended and improvements made upon said mining claim by claimants or their grantors are as therein fully stated, and that the character, extent, location and itemized value thereof are specified therein with particularity and full detail, and that no portion of said labor or improvements so credited to this claim has been included in the estimate of expenditures upon any other claim.

H. G. Howe,  
U. S. Deputy Mineral Surveyor.

Subscribed and sworn to by the said H. G. Howe,  
U. S. Deputy Mineral Surveyor, before me Chas. G. Johnston  
Notary Public this 21<sup>st</sup>  
day of July, 1890.

Chas. G. Johnston  
Notary Public



## Notice of Location.

Notice is hereby given that the undersigned in compliance with the requirements of the Mining Act of Congress approved May 10, 1872 have this day located and claim 1500 linear feet along the course of this lead lode or vein of mineral bearing quartz and 300 feet from the middle of said lode or vein situate in Tavis Mining District, Coconino Co. Arizona and described as follows, to wit;

Commencing at this monument of stones being the center of the North west end and upon which this notice is posted, thence Easterly 300 feet to a monument of stones, thence Southeasterly 1500 feet to a monument of stones, thence Westerly 300 feet to a monument of stones being the center of South east end of claim, thence Westerly 300 feet to a monument of stones, thence No. West 1500 feet to a monument of stones, thence Easterly 300 feet to place beginning. This claim was formerly known as The Ohio, is situated on the South side of Lewis Gulch and about 3 miles North of Dos Cabezas peaks, and



Shall be known as Virginia Mine. <sup>11</sup>  
Located Feb. 9<sup>th</sup> 1884,

Locator M.E. Kincaid.  
Filed and recorded at request of  
J.H. Tevis Feb. 25, 1884, at 9 A.M.  
A.T. Jones.  
County Recorder.

TERRITORY OF ARIZONA, }  
County of Cochise. } ss.

I, W. F. Bradley, County Recorder in and for the County of Cochise, do  
hereby certify that the above and foregoing is a full, true and correct copy of, The  
Location notice of the Virginia Mine in Tevis Ing Dist. Cochise  
Co. Ariz. as appears of record now in my office in Book 7, Page 520 Records of Mines

In witness whereof, I have hereunto set my hand and affixed  
my official seal, at my office, in Tombstone, this  
9<sup>th</sup> day of June, A. D. 1896  
W. F. Bradley  
County Recorder.





PLAT  
OF THE

VIRGINIA MINING CLAIM

TEVIS MINING DISTRICT

COCHISE Co. Ariz.

Area = 20.33 Acres.

Var 11° 30' East.

Scale 200ft = 1inch.

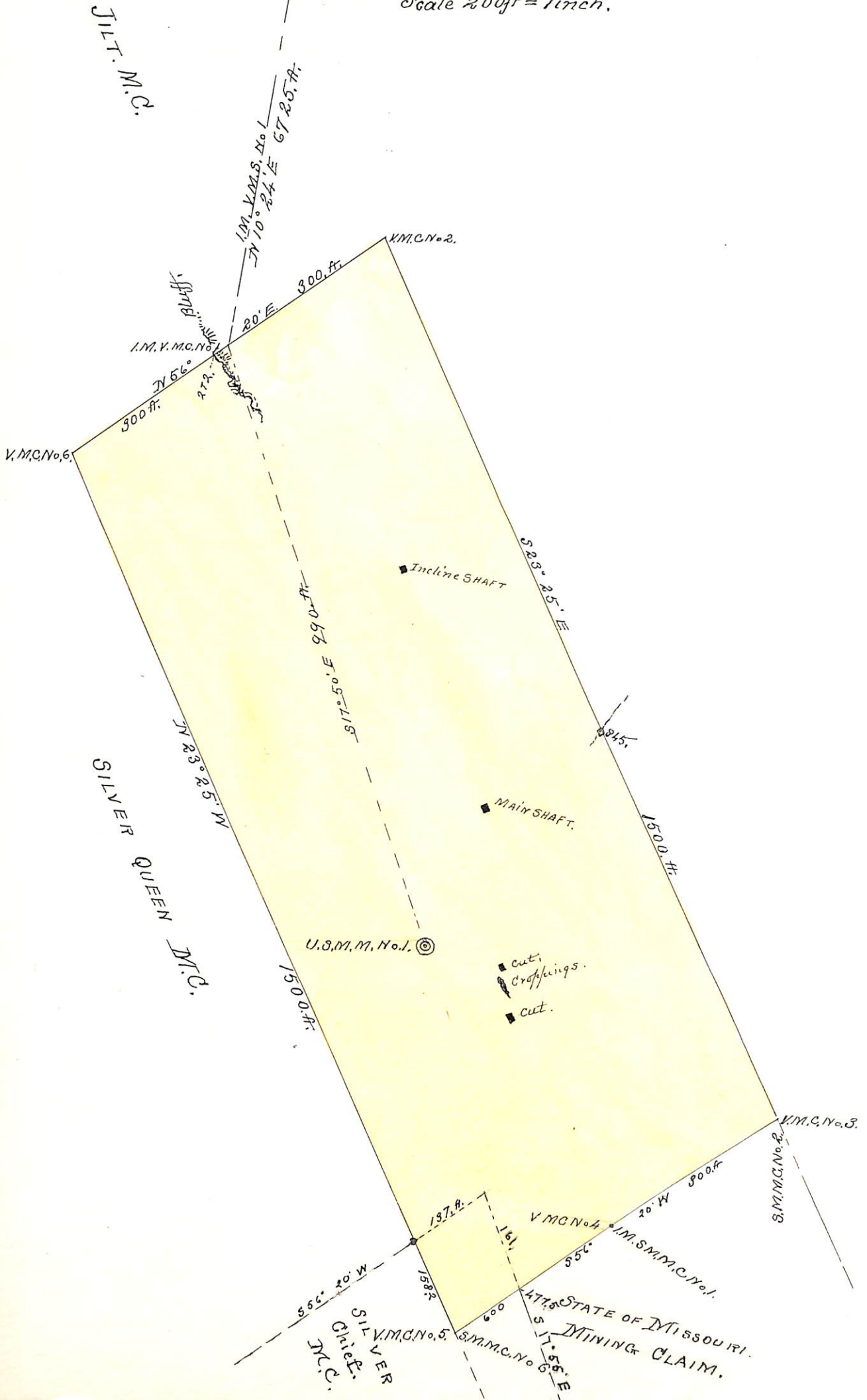



# **POOR QUALITY**

**The following pages are scanned at the best possible quality setting. The original pages are of poor quality and this is the best possible reproduction.**



(4-687.)

# Surveyor General's Certificate of Approval of Field Notes and Survey of Mining Claim.

Department of the Interior,

Office of U. S. Surveyor General,

Tucson, Arizona.

October 31, 1890.

I, U. S. Surveyor General for Arizona,

do hereby certify that the foregoing and hereto attached Field Notes and Return of the

Survey of the Mining Claim of

James H. Davis, and  
John A. Durcan.

known as the

Virginia,

situate in Devis mining district,

Coconino County, Arizona,

in Section \_\_\_\_\_, Township No. \_\_\_\_\_, Range No. \_\_\_\_\_

and \_\_\_\_\_, designated as Survey No. 931

executed by H. G. Howe, U. S. Deputy Mineral

Surveyor, June 12-13, 1890, under my instructions dated

June 10, 1890, have been critically examined and the

necessary corrections and explanations made, and the said Field Notes and Return, and

the Survey they describe, are hereby approved. A true copy of the copy of the location

certificate filed by the applicant for survey is included in the field notes.

Royal Johnson  
U. S. Surveyor General for Arizona

o 6-102