

MS.

0

0

9

4

8

(4-683.)

Mineral Survey No. 948

Lot No. 38

Gila Land District.

FIELD NOTES

OF THE SURVEY OF THE MINING CLAIM OF

The Gold Mountain Gold and Silver Mining and Reduction Company.

KNOWN AS THE

"St George Mine"

Greenlee Gold Mountain, Mining District,

Graham County, Arizona

Section _____, Township 4S, Range 29E

Surveyed under instructions dated December 3, 1890.

by George J. Roskrutz
U. S. Deputy Mineral Surveyor.

Claim located February 5th, 1887.

Survey commenced December 12, 1890.

Survey completed December 12, 1890.

PRELIMINARY OATHS OF ASSISTANTS IN SURVEY OF MINING CLAIM.

J. A. S. Hickey and _____,
do solemnly swear that ~~we~~ ^{we} will well and faithfully execute the duties of chain carriers; that ~~we~~ ^{we} will level the chain upon even and uneven ground and plumb the tally-pins, either by sticking or dropping the same; that ~~we~~ ^{we} will report the true distance to all notable objects, and the true length of all lines that ~~we~~ ^{we} assist in measuring, to the best of ~~our~~ ^{my} skill and ability, and in accordance with instructions given ~~us~~ ^{me}, in the survey of the Mining Claim of *The Gold Mountain, Gold & Silver Mining and Reduction Company*, known as the *St. George mine*, situate in *Greenlee Gold Mountain* mining district, *Graham* County, *Arizona*, in Section _____, Township No. _____, Range No. _____.

Artemas S. Dickey, Chainman.
_____, Chainman.

Subscribed and sworn to by the above-named persons before me this *12th* day of *Dec^r*, 18*90*

George J. Roskrige
Notary Public

I, _____, do solemnly swear that I will well and truly perform the duties of axeman, in the establishment of corners and other duties, according to instructions given me and to the best of my skill and ability, in the survey of the Mining Claim of _____

known as the _____,
more fully described in the preceding affidavit.

_____, Axeman.

Subscribed and sworn to by the said _____
before me this _____ day of _____, 18 _____.

I, _____, do solemnly swear that I will well and truly perform the duties of flagman, in the establishment of corners and other duties, according to instructions given me and to the best of my skill and ability, in the survey of the Mining Claim of _____

known as the _____,
more fully described in the preceding affidavit.

_____, Flagman.

Subscribed and sworn to by the said _____
before me this _____ day of _____, 18 _____.

F I E L D N O T E S
 of the Survey of the
 "St George Mine" Mining Claim.
 in the

Greenlee Gold Mountain Mining District, Graham County.

A R I Z O N A .

Claimed by The Gold Mountain Gold and Silver Mining and Reduction Company.

Surveyed by George J, Roskruge, U.S. Deputy Mineral Surveyor, under instructions from the Surveyor General of Date December 3rd, 1890.

Survey commenced, December 12th, 1890.

Survey completed, December, 12th. 1890.

Feet.

Description of Survey.

Beginning at the Initial monument mentioned in location notice and marking the Southerly end centre of claim, where I set a post 4x4 ins, 4 feet long, 1 1/2 feet in ground, and surrounded same with a mound of stones, Post marked St G, l.M.No, 1.

Main shaft on the "Whale" Mining Claim bears N, 60° W. 27 feet.

Shaft on the "St George" Mine, bears N. 35° W. 23 feet.

Cedar tree 15 inches dia, and marked St G. l.M.No. 1. B. T. bears S. 31° W. 40 feet.

Cedar 15 ins, dia, and marked StG. l.M.No, 1. B. T. bears S, 45° 30' E. 70 feet.

Thence S. 44° 30' E.

Var, 12° 30', East.

300. To location monument where I set a post 4x4 ins, 4 ft. long 1 1/2 feet in ground and surrounded same with a mound of stones, Post marked St, G, No, 2.

U.S. Min, Mon, No, 1. Greenlee Gold Mountain Mining Dist,

Feet. bears N.8° 15' W.69feet distant.
 Juniper tree 6ins dia,bears N. 16° W.18 feet distant,
 Oak tree 4 ins dia, bears N.36° E. 6 feet distant.
 Thence N.36° 15' E.
 Var,12° 30' East.
 Over rough broken ground.

1242. To location monument where I set a post 4x4 ins 4 feet
 long,1 1/2 feet in ground and surrounded same with a
 mound of stones. Post marked StG,No,3.
 Juniper tree 10 ins,dia, and marked StG,No,3.B.T.
 bears S.62° E.30 feet distant.
 Juniper tree 8 ins,dia,and marked St G,No,3.B.T.bears
 N.72° E.32 feet distant.
 Thence N.44° 30' W.
 Var,12° 30' East.
 Decending towards the North.

300. To location monument for Northerly end centre of claim
 where I set a post 4x4 ins 4 feet long 1 1/2 ft,in the
 ground and surrounded the same with a mound of stones,
 Post marked,St G.No.4.
 Piñon pine tree 6 ins,dia and marked St,G.No,4,B.T.
 bears N.42° E.18 feet.
 An oak 8 ins dia,and marked St,G.No.4.B.T.bears N.44°
 W.51 feet distant.
 Thence N,44° 30',W.(same course)
 Var,12° 30',East.

300. To location monument where I set a post 4x4 ins,4 ft,
 long 1 1/2 ft, in ground and surrounded same with a
 mound of stones.Post marked,St,G,No,5.
 Thence S.36° 15',W.
 Var 12° 30',East.
 Decending towards rocky ravine.

feet.
120. To centre of rocky ravine bears North West and South East and commence ascending, line runs up and along steep hill side sloping towards the North.

1242. To location monument where I set a post 4x4 inches 4 feet long, 1 1/2 ft, in the ground and surrounded same with a mound of stones. Post marked ST, G. No, 6.
 Juniper tree 10 ins, dia, bears S. 70°, W. 85 feet dist. *and marked St. G. No. 6. B.T.*
 Juniper tree 14 ins, dia, bears S. 79°, W. 127 feet dist. *and marked St. G. No. 6. B.T.*
 Thence S. 44 30, E.
 Var, 12° 30' East.

Line ascending to centre monument.

300. To monument and post, St, G. l.M. No, 1. place of beginning.

A R E A .

Total area of claim.....16,89 acres.

Location.

This claim is located on Mount Saint George, between the Dorsey and Sycamore Gulches. on unsurveyed land in the Greenlee Gold Mountain Mining District, Graham County, Arizona. about 6 miles Northerly from the Town of Clifton.

Improvements.

made upon this claim by the claimants or their grantors consist of a shaft 5 x 6, 12 feet deep, N. 35° W. 23 feet from Post St G, l.M. No, 1.

A shaft 4 x 6, 12 feet deep, N, 43° 30', E. 220 feet from Post St G. l.M. No, 1.

A shaft 4 x 6, 10 feet deep, N. 36° 15' E. 840 feet from Post St G, l.M. No, 1.

A Road has been built by the Gold Mountain Gold and Silver Mining and Reduction Company from the Francisco River to the Dorsey Gulch, a distance of about four miles, at a cost of \$2000, 00. and is now within a half

mile of the claim, an incline will be built from the mine to the end of the road for the transporting of the ores to the Mill, This road has been built for the express purpose of the development of the "St George Mine" Mining Claim and the "Merrimac Mine" Mining claim both owned and worked by the above Mining Company. And I hereby certify that the value of said improvements exceeds the sum of Five hundred dollars.

There have been no improvements made by other parties on this claim.

Instruments used a "Young and Sons" Transit and steel tape.

Var, and courses taken by use of Solar apparatus.

George J. Roskrug
 U.S. Deputy Mineral Surveyor.

Tucson A, T. December, 19th, 1890.

Affidavit of Five Hundred Dollars Improvements.



We, Ira A. Townsend and Joseph F. Smart

of lawful age, being first duly sworn according to law, depose and say: that we are acquainted with the "Saint George" mine mining claim, situated in Greenlee Gold Mountain Mining District, Graham County, Arizona Territory, for which The Gold Mountain Gold and Silver Mining and Reduction Company have made application for survey prior to application for patent under the provisions of the Act of Congress, approved May 10, 1872; and that the labor done and improvements made thereon by the applicant S. and their grantor S. exceed Five Hundred Dollars in value, and further that we are not personally interested in said mine.

Ira A. Townsend,

Joseph F. Smart

TERRITORY OF ARIZONA,
County of Graham } ss.

SWORN to and subscribed before me, this 20th day of December 1890.

P. M. Thurmond
Notary Public

~~my commission expires on the 25 day of November 1891~~



FINAL OATHS FOR SURVEYS.

LIST OF NAMES.

A list of the names of the individuals employed by George Roskrug
 United States Deputy Mineral Surveyor, to assist in running, measuring, and marking the lines
 corners and boundaries described in the foregoing field notes of the survey of the mining claim
 of The Gold Mountain Gold and Silver Mining & Reduction Co
 known as the St. George Mine
 and showing the respective capacities in which they acted.

A. S. Hickey, Chainman.
 _____, ~~Chainman~~
 _____, ~~Asman~~
 _____, ~~Flagman~~

FINAL OATHS OF ASSISTANTS.

We A. S. Hickey
 and _____, do solemnly swear that we assisted George J. Roskrug,
 United States Deputy Mineral Surveyor, in marking the corners and
 surveying the boundaries of the mining claim of The Gold Mountain
 Gold and Silver Mining and Reduction
 Company, known as the St. George
 Mine, represented
 in the foregoing field notes as having been surveyed by said deputy mineral surveyor and under
 his direction; and that said survey has been in all respects, to the best of ~~our~~ ^{my} knowledge and
 belief, faithfully and correctly executed, and the corner and boundary monuments established
 according to law and the instructions furnished by the United States Surveyor-General for
Arizona

Artemas S. Hiky, Chainman.
 _____, ~~Chainman~~
 _____, ~~Asman~~
 _____, ~~Flagman~~

Subscribed and sworn to by the above-named persons before me
 this 16th day of Dec^r, 1890



George J. Roskrug
 Notary Public

FINAL OATH OF U. S. DEPUTY MINERAL SURVEYOR.

I, George J. Roskrige, U. S. Deputy Mineral Surveyor, do solemnly swear that, in pursuance of instructions received from the United States Surveyor General for Arizona, dated December 3rd, 1890, I have, in strict conformity to the laws of the United States, the official regulations and instructions thereunder, and the instructions of said Surveyor General, faithfully and correctly executed the survey of the Mining Claim of The Gold Mountain, Gold and Silver Mining and Reduction Company, known as the "St. George Mine", situate in Greenlee Gold Mountain Mining District, Graham County, Arizona, in Section _____, Township No. _____, Range No. _____ and designated as Survey No. 948, as represented in the foregoing field notes, which accurately show the boundaries of said mining claim as distinctly marked by monuments on the ground, and described in the attached copy of the location certificate, which was received by me from the Surveyor General with said instructions, and that all the corners of said survey have been established and perpetuated in strict accordance with the law, official regulations and instructions thereunder; and I do further solemnly swear that the foregoing are the true and original field notes of said survey and my report therein, and that the labor expended and improvements made upon said mining claim by claimant or their grantors are as therein fully stated, and that the character, extent, location and itemized value thereof are specified therein with particularity and full detail, and that no portion of said labor or improvements so credited to this claim has been included in the estimate of expenditures upon any other claim.

George J. Roskrige
U. S. Deputy Mineral Surveyor.

Subscribed and sworn to by the said George J. Roskrige
U. S. Deputy Mineral Surveyor, before me A. A. Bernand
Notary Public in & for Pima Co. Ariz 19th
day of December, 1890.

A. A. Bernand
Notary Public

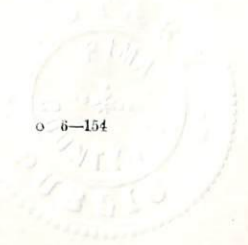

Notice of Location

Notice is hereby given that the undersigned
 in compliance with the requirements of the
 Mining Act of Congress approved May 10
 1872 have this day located 4d claim 1500
 linear feet along the course of this lead
 lode or vein of mineral bearing quartz
 together with 300 feet in width on each
 side of the middle of said lead lode or vein
 situate in Grant's Mining District
 County of Graham Arizona and more
 particularly described as follows to wit
 Commencing at this monument of stones
 being the center of the SW end of claim and
 upon which this notice is posted
 thence SE 300 feet to a monument of stones
 thence NE 1500 feet to a monument of stones
 thence NW 300 feet to a monument of stones
 being the center of the North East end of claim
 thence NW 300 feet to a monument of stones
 thence SW 1500 feet to a monument of stones
 thence SE 300 feet to place of beginning
 This claim is situated at the head of Dowsy
 Gulch and joins the Tornado on the South
 West end and is about 1 and 1/2 miles West
 of the Frisco River and shall be known as
 the St George Mining
 Located July 5th 1887 } S P Truitt
 Wm M Williams
 Locators
 Filed and recorded March 1st 1887 at
 9 o'clock AM at the request of S P Truitt

Michilena
Co Recorder

Territory of Arizona
County of Graham
Office of Recorder

I hereby certify that
the above and foregoing is a true and
correct copy of the Location Notice
of the St George Mine as recorded in
Book H Records of Mines Page 3114 of
this office

Witness my hand
and official seal this
19th day of March 1890
E. Loto Co Recorder
By Fred McNewell
Deputy



Certified Copy
St George Mine

Map

of the "St. George Mine" Mining Claim in

the Greenlee Gold Mountain Mining District

Graham County, Arizona. Claimed by The Gold

Mountain Gold and Silver Mining & Reduction Co.

Surveyed by U.S. Dep. Min. Sur. George J. Roskruege,

12th Dec^r 1890.

Scale 200 feet to 1 inch.

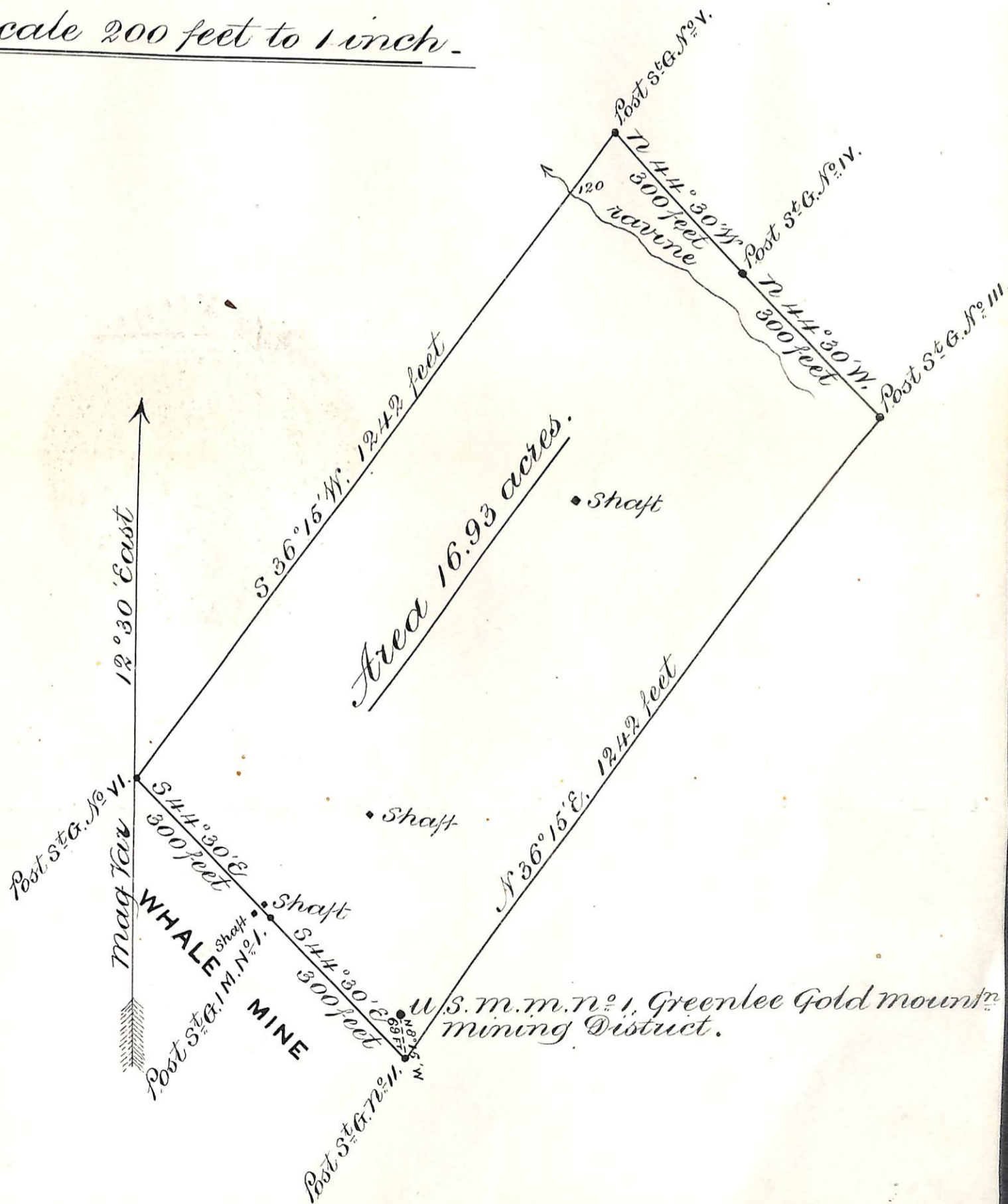

(4-687.)

Surveyor General's Certificate of Approval of Field Notes and Survey of Mining Claim.

Department of the Interior,

Office of U. S. Surveyor General,

Tucson Arizona

January 7th, 1891.

I, U. S. Surveyor General for *Arizona*,

do hereby certify that the foregoing and hereto attached Field Notes and Return of the

Survey of the Mining Claim of *The Gold Mountain*
Gold and Silver Mining and
Reduction Company, known as the
"St George Mine",

situate in *Greenlee Gold Mountain* mining district,
Graham County, *Arizona*,

in Section _____, Township No. _____, Range No. _____

and _____, designated as Survey No. *948*

executed by *Geo. J. Roskrige*, U. S. Deputy Mineral

Surveyor, *December 12*, 18*90*, under my instructions dated

December 3, 18*90*, have been critically examined and the

necessary corrections and explanations made, and the said Field Notes and Return, and

the Survey they describe, are hereby approved. A true copy of the copy of the location

certificate filed by the applicant for survey is included in the field notes.

Rupert Johnson

U. S. Surveyor General for *Arizona*

o 6-162

UNITED STATES DEPARTMENT OF THE INTERIOR 9605 (956)
BUREAU OF LAND MANAGEMENT M.S. 948
ARIZONA STATE OFFICE

NOTICE OF CANCELLATION OF MINERAL SURVEY

The St George Mine lode, Mineral Survey No. 948, located in section 25, Township 3 South, Range 29 East, Gila and Salt River Meridian, Arizona, is hereby canceled.

This claim has not been filed with the Arizona State Office, Bureau of Land Management, in accordance with Section 314, 90 STAT. 2769, (43 U.S.C. 1744).

This cancellation was necessitated to clear the record.

The Mineral Survey Plat should be noted as follows:

"St George Mine lode, M.S. 948, was canceled April 20, 2009, by memo 9605 (956) M.S. 948, which is now a part of the original field notes."

April 20, 2009
Date

Stephen K. Hansen
Chief Cadastral Surveyor of Arizona