

7
9

0

0

9

5

5

224
768

(4-683.)

Mineral Survey No. 955

Lot No. 47.

Prescott Land District.

FIELD NOTES

OF THE SURVEY OF THE MINING CLAIM OF

The Vulcan Powder Company

KNOWN AS THE

"Summit"

Wattapai Mining District,

Hohave County, Arizona

Section 32, Township 23 N., Range 17 West

Surveyed under instructions dated Nov 25, 1890.

by O. F. Kuencer,
U. S. Deputy Mineral Surveyor

Claim located January 1st, 1889.

Survey commenced December 22, 1890.

Survey completed December 27, 1890.

Feet.

Field Notes
 of the Survey of the
Summit Mining Claim
 in the Wallapai Mining Dist.
 Mohave County
 Arizona.

Claimed by the "Unicom
 Powder Company."
 Surveyed by O. F. Knesel,
 U. S. Deputy Mineral Surveyor,
 under instructions from the
 Surveyor General of date
 Nov 25 - 1890

Survey commenced Dec 22 - 1890
 Survey completed Dec. 27 - 1890

Description of Survey.

Beginning at the initial
 mon. mentioned in location
 notice, and placed at the center
 of the edge of the northside of
 a shaft, 6 x 4', 40 feet deep, on
 the Dorris mining claim,
 unsurveyed - the south
 extension of the Summit
 mining claim, owned by
 Robert Gray, of Stockton Nye,
 Mohave County, Arizona
 Territory - and marking the
 South end center of Summit
 mining claim, and North
 end center of Dorris mining
 claim; where I set a post,
 4 ft. long, 4 ins. dia., 1/2 ft. in
 ground, and surrounded
 same with mound of stones;
 Post marked: S. I. M.
 Cor. to Secs. 4-5-32 and W
 Tp. 23 N. R. 17 W. bears S. 39° 15' E
 3994 feet.

Thence N. 55° 30' E.

Var. 14° 20' E.

300. To loc. mon. on S.E. cor. of Summit mining claim and N.E. cor. of Boris mining claim; where I set a post 4 ft. long, 4 ins dia, 1 1/2 feet in ground, and surrounded same with mound of stones; Post marked S. No. 4.

West face of upper S.W. cor. of pyrite rock, 2 x 2 x 3 ft. marked: S. No. 1. B.R. bears: N. 32° 35' E. 122 ft.

Thence N. 34° 30' W

Var. 14° 20' E.

250. To top of hill.

485. To centre of gulch, bears N.E. and S.W.

612. To Summit

1500. To loc. mon. on N.E. cor. of claim, where I set a post, 4 ft. long, 4 ins. dia., 1 1/2 ft. in ground and surrounded same with mound of stones; Post marked S. No. 2.

Pine tree, 6 ins. dia. marked S. No. 2. B.T. bears N. 25° E. 130 ft.

Monument at S.E. cor. of "Butchartown" mining claim, surrounded, the North extension of "Summit" mining claim, and claimed by "John K. Mackenzie" of Kingman Arizona, - bears N. 55° 30' E. 50 ft.

Thence: S. 55° 30' W.

Var. 14° 20' E.

250 To small cut on "Butchartown" mining claim, and initial location monument of said claim.

Feet.

290. To top of bluff.
 550. To S.W. cor. of Butchertown "mining claim."
 600. To loc. mon. on N.W. cor. of claim, where I set a post 4 ft. long, 4 ins. dia., 1½ ft. in ground, and surrounded same with mound of stones; Post marked: S. N^o 3.
 Post is set against the east face of a granite rock 3 x 3 x 4 ft., marked: S. N^o 3. B.R.

Thence S. 34° 30' E.

Var. 14° 20' E.

520. To Trail, bears S 40° E and leading to Layne Springs.
 1500. To loc. mon. on S.W. cor. of "Summit" and N.W. cor. of "Dorris" mining claim; where I set a post, 4 ft. long, 4 ins. dia., 1½ ft. in ground and surrounded same with mound of stones; Post marked: S. N^o 4.
 Syenite rock 6 x 3 x 15 ft. marked: S. N^o 4. B.R. bears S. 8° 40' E. 160 ft.

Top of white cliff on highest peak SE. of Layne Springs, bears S. 40° 25' E.

Thence N. 55° 30' E.

Var. 14° 20' E.

- 300 To monument and post S.I.M. and place of beginning.

Area.

Total area of claim
 20.66 acres.

Location.

This claim is located in Sec. 32. Tp. 23 N. R. 17. W. Gila and Salt River Base and Meridian.

Improvements.

made upon this claim by claimant and grantors, consist of a shaft 5' x 8' 200 ft. deep, with levels, drifts etc., N. 34° 30' W. 58 ft. from Post S.I.M.

A shaft 4' x 7' 15 ft. deep, N. 34° 30' W. 70 ft. from Post S.I.M.

A shaft 4' x 7' 12 ft. deep, N. 34° 30' W. 210 ft. from Post S.I.M.

A shaft 5' x 8' 100 ft. deep, N. 34° 30' W. 759 ft. from post S.I.M.

Mouth of open cut, 4' x 5' wide, 24 ft. long, 14 feet high in face, and leading to tunnel 4' x 6' 9 ft. long, N. 33° 55' W. 1273 ft. from post S.I.M.

And I hereby certify that the value of said improvements, exceeds the sum of One Hundred dollars.

There have been no improvements made by other parties, then the claimant or grantor, upon the "Summit" mining claim.

The Survey and location of Summit mining claim are identical, it having been laid out with an instrument at the time of location.

The location monument of "Butcherstown" mining claim, located by John K. Mackenzie, was placed N. 55° 30' E. 50 feet, from the North end centre of Summit mining claim, by the Locator, because the vein, near said North end line apparently splits, or probably faults. The crestreak lying farther up the hill, or to the North East.

Instruments used, a "Noller and Brightley" Transit, with solar attachment and steel chain.

Cor. and corners taken by solar apparatus and Vernier readings.

O. F. Kuencer,
 U.S. Deputy Min.
 Surveyor
 Kingman A.T.
 Jan'y 15 - 1891.

Affidavit of Five Hundred Dollars Improvements.

We, J. M. Boland and John K. Mackenzie

of lawful age, being first duly sworn according to law, depose and say: that we are acquainted with the

Summit mining claim, situated in

Wallapai Mining District, Mohave County,

Arizona Territory, for which The Vulcan Powder

Company

has made application for survey prior to application for patent under the provisions of the Act of Congress, approved May 10, 1872; and that the labor done and improvements made thereon by the applicant and his grantor exceed Five Hundred Dollars in value, and further that we are not personally interested in said mine.

J. M. Boland

John K. Mackenzie

TERRITORY OF ARIZONA,
County of Mohave } ss.

SWORN to and subscribed before me, this 15th day

of Jan'y 1891

E. J. Godman
County Recorder



FINAL OATHS FOR SURVEYS.

LIST OF NAMES.

A list of the names of the individuals employed by O. F. Knencer
 United States Deputy Mineral Surveyor, to assist in running, measuring, and marking the lines
 corners and boundaries described in the foregoing field notes of the survey of the mining claim
 of The Vulcan Powder Company
 known as the Summit mine
 and showing the respective capacities in which they acted.

Peter Caffrey, Chairman.
Geo. Dougherty, Chairman.
 _____, Assman.
Robert Gray, Flagman.

FINAL OATHS OF ASSISTANTS.

We, Peter Caffrey & Geo. Dougherty
 and Robert Gray, do solemnly swear that we assisted O. F. Knencer,
 United States Deputy Mineral Surveyor, in marking the corners and
 surveying the boundaries of the mining claim of The Vulcan Powder Company, a corporation of the City and County of San Francisco,
 known as the Summit Mining Claim, represented
 in the foregoing field notes as having been surveyed by said deputy mineral surveyor and under
 his direction; and that said survey has been in all respects, to the best of our knowledge and
 belief, faithfully and correctly executed, and the corner and boundary monuments established
 according to law and the instructions furnished by the United States Surveyor-General for
Arizona.

Peter Caffrey, Chairman.
George Dougherty, Chairman.
Robert Gray, Assman.
 _____, Flagman.

Subscribed and sworn to by the above-named persons before me

this 27th day of December, 1880

C. J. Goodman
 County Recorder

By O. F. Knencer
 Deputy

(4-686.)

FINAL OATH OF U. S. DEPUTY MINERAL SURVEYOR.

I, O. F. Kuencer, U. S. Deputy Mineral Surveyor, do solemnly swear that, in pursuance of instructions received from the United States Surveyor General for Arizona Territory, dated November 25, 1890 I have, in strict conformity to the laws of the United States, the official regulations and instructions thereunder, and the instructions of said Surveyor General, faithfully and correctly executed the survey of the Mining Claim of The Union Powder Company, known as the "Summit" mining claim, situate in Walcapai Mining District, Mohave County, Arizona, in Section 32, Township No. 23. N., Range No. 17. W. and designated as Survey No. 955, as represented in the foregoing field notes, which accurately show the boundaries of said mining claim as distinctly marked by monuments on the ground, and described in the attached copy of the location certificate, which was received by me from the Surveyor General with said instructions, and that all the corners of said survey have been established and perpetuated in strict accordance with the law, official regulations and instructions thereunder; and I do further solemnly swear that the foregoing are the true and original field notes of said survey and my report therein, and that the labor expended and improvements made upon said mining claim by claimant or his grantors are as therein fully stated, and that the character, extent, location and itemized value thereof are specified therein with particularity and full detail, and that no portion of said labor or improvements so credited to this claim has been included in the estimate of expenditures upon any other claim.

O. F. Kuencer
U. S. Deputy Mineral Surveyor.

Subscribed and sworn to by the said O. F. Kuencer,
U. S. Deputy Mineral Surveyor, before me County Recorder in and
for Mohave County this 15th
day of January, 1891.

E. J. Goddard
County Recorder

The Summit

Notice of Location

Know all men by these presents That I the undersigned, have this day located fifteen hundred (500) linear feet of this vein or lode, bearing precious metals, with all dips, spurs, angles and variations, with surface ground three hundred (300) feet on each side of the Centre of Vein, with all mineral deposits contained therein and all timber growing within the limits of said Claim, and all water and water privileges thereon or appurtenant thereto, under and according to the provisions of the United States mining laws, under which it is located. This Claim Commences at this monument and notice placed upon the ledge, and runs fifteen hundred (500) feet in a northerly direction along the ledge. The Exterior boundaries are as follows to wit: Commencing at this monument and notice and running three hundred (300) feet in an Easterly direction to monument of stone at S. E. Corner of Claim, thence in a northerly direction parallel with the ledge fifteen hundred (500) feet to monument of stone at N. E. Corner of Claim, thence at right angles across the ledge in a westerly direction six hundred (600) feet to monument of stone at N. W. Corner of Claim, thence parallel with the ledge in a southerly direction fifteen hundred, 1500, feet to monument of stone at S. W. Corner of Claim, thence at right angles across the ledge in an Easterly direction three hundred 300, feet to monument upon the ledge and place of beginning. This ledge may be more generally described as situated being located in Wallapai Mining District about one half mile East of Payne Spring and formerly known as the Cincinnati mine, I locate the Claim because the assessment has not been done for two

years past In Mohave County Arizona Territory ¹²
shall be known as the Summit Mining Claim. Dated on
the ground, this first day of Jan 1889
Wm H Hardy

Recorded at the request of W H Hardy Jan 1st 1889
at 4:25 PM

E J Godman
County Recorder

Territory of Arizona }
County of Mohave } 10

I, E J Godman County Recorder
in and for Mohave County, Arizona Territory, do hereby
Certify that the above and foregoing, is a full, true and
Correct Copy of the location notice of the Summit
Mining Claim, as the same appears of record in my
office in Book A Page 371 Mining Records of Mohave
County Arizona Territory.

In Witness whereof I have hereunto set my hand
and affixed my official seal this 13th day of November
A D 1890

E J Godman
County Recorder

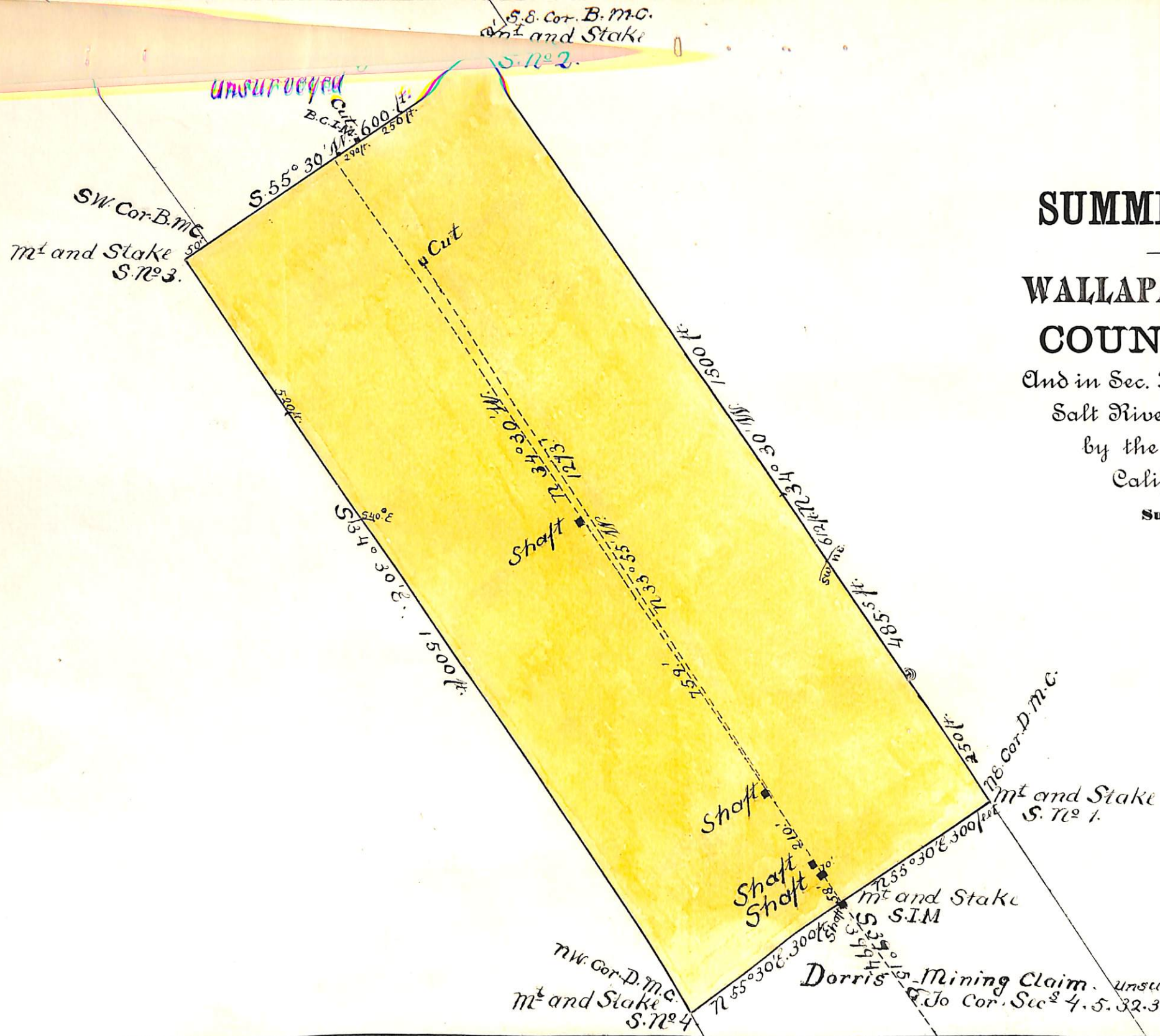

PLAT
 —OF THE—
SUMMIT MINING CLAIM,
 —SITUATED IN—
WALLAPAI MINING DISTRICT,
COUNTY OF MOHAVE,
 And in Sec. 32, T^p. 23, N. R. 17 W. Gila and
 Salt River Meridian, Arizona. Claimed
 by the Vulcan Powder Company, of
 California.

Surveyed by O. F. Kuencer, U. S Deputy
 Surveyor, Dec. 22, 23 and 27, 1890. Con-
 taining 20.66 acres. Scale—200 feet
 to an inch.

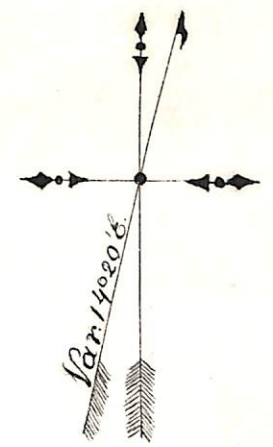

Certified Copy of the notice of
location of the Summit mine

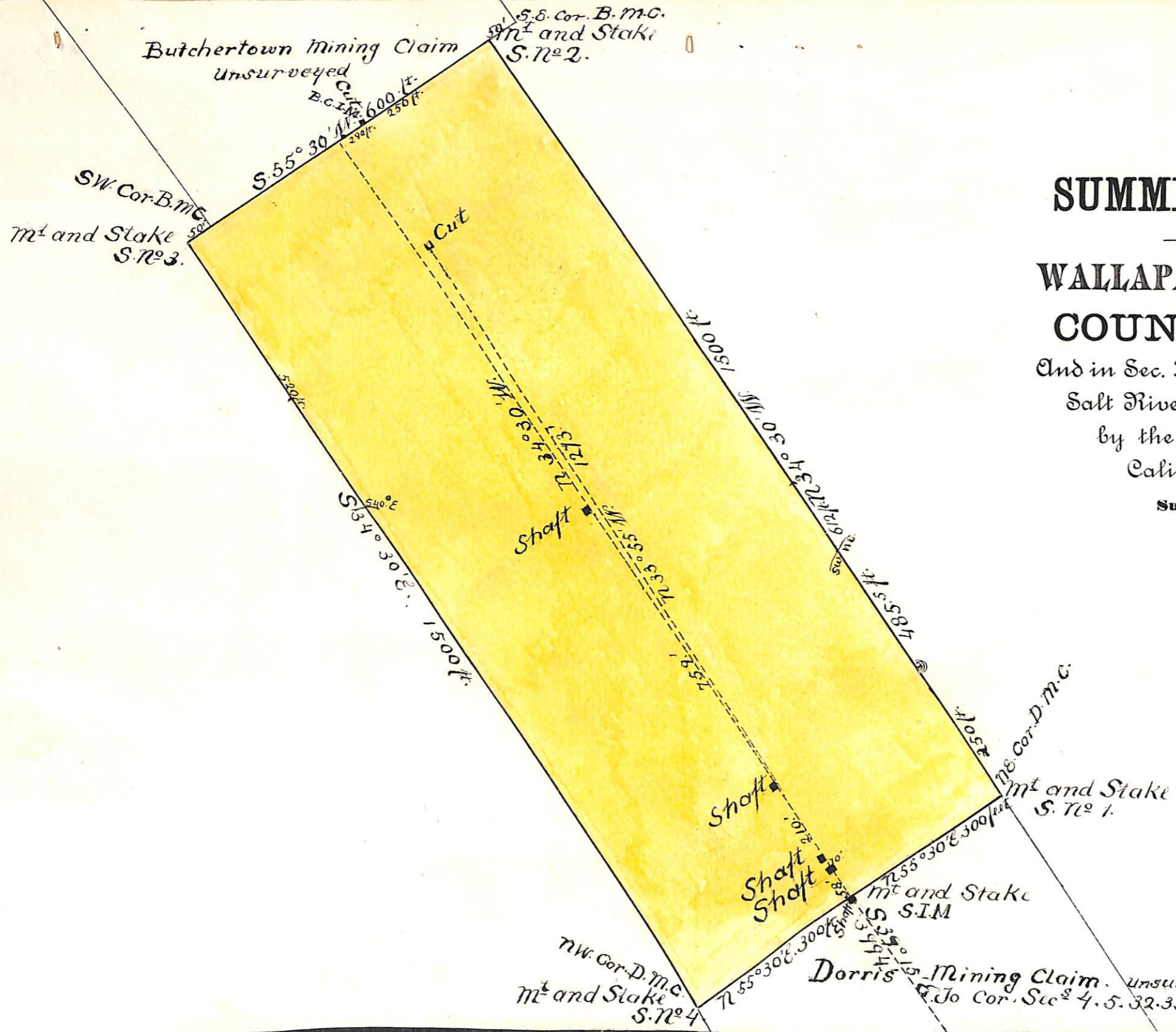

PLAT
—OF THE—
SUMMIT MINING CLAIM,
—SITUATED IN—
WALLAPAI MINING DISTRICT,
COUNTY OF MOHAVE,
And in Sec. 32, Twp. 23, N. R. 17 W. Gila and
Salt River Meridian, Arizona. Claimed
by the Vulcan Powder Company, of
California.

Surveyed by O. F. Kuencer, U. S Deputy
Surveyor, Dec. 22, 23 and 27, 1890. Con-
taining 20.66 acres. Scale—200 feet
to an inch.

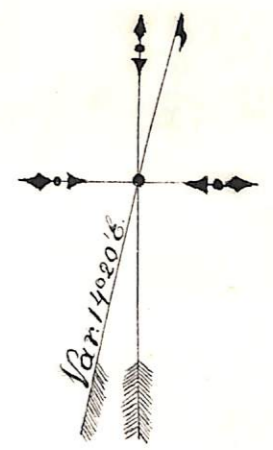

(4-687.)

Surveyor General's Certificate of Approval of Field Notes and Survey of Mining Claim.

Department of the Interior,

Office of U. S. Surveyor General,

Tucson, Arizona.

March 10, 1891.

I, U. S. Surveyor General for

Arizona

do hereby certify that the foregoing and hereto attached Field Notes and Return of the

Survey of the Mining Claim of

The Tucson Powder Company

"Summit", known as the

situate in Maricopa mining district,

Maricopa County, Arizona,

in Section 32, Township No. 23 N., Range No. 17. West.

and designated as Survey No. 955.

executed by O. F. Kuencer, U. S. Deputy Mineral

Surveyor, December 25/27, 1890, under my instructions dated

November 25, 1890, have been critically examined and the

necessary corrections and explanations made, and the said Field Notes and Return, and

the Survey they describe, are hereby approved. A true copy of the copy of the location

certificate filed by the applicant for survey is included in the field notes.

Samuel Johnson
Arizona

U. S. Surveyor General for

0 6 - 102