

**M
S
-**

0

0

9

7

2

(4-683.)

Mineral Survey No. 972

Lot No. 77

Gila

Land District.

FIELD NOTES

OF THE SURVEY OF THE MINING CLAIM OF

D. Willis James and H. E. Dodge

KNOWN AS THE

Neptune

Warren

Mining District,

Cochise

County,

Arizona

Section

Township

Range

Surveyed under instructions dated May 23rd, 1891,

by

H. G. Howe

U. S. Deputy Mineral Surveyor.

Claim located December 5th, 1877.

Survey commenced July 2nd, 1891.

Survey completed July 22nd, 1891.

o 6-160

PRELIMINARY OATHS OF ASSISTANTS IN SURVEY OF MINING CLAIM.

WE, S. B. Whittum and _____,
do solemnly swear that we will well and faithfully execute the duties of chain carriers;
that we will level the chain upon even and uneven ground and plumb the tally-pins,
either by sticking or dropping the same; that we will report the true distance to all
notable objects, and the true length of all lines that we assist in measuring, to the best
of our skill and ability, and in accordance with instructions given us, in the survey of
the Mining Claim of D. Willis James and
W. E. Dodge, known as the
Neptune Mine,
situate in the Warren mining district,
Cochise County, Arizona,
in Section _____, Township No. _____, Range No. _____.

S. B. Whittum, Chainman.
_____, Chainman.

Subscribed and sworn to by the above-named persons before
me this 2nd day of July, 1891

S. B. Penin
Notary Public

I, George Douglas, do solemnly swear that I will well and
truly perform the duties of axeman, in the establishment of corners and other duties,
according to instructions given me and to the best of my skill and ability, in the survey
of the Mining Claim of D. Willis James and
W. E. Dodge
known as the Neptune Mine,
more fully described in the preceding affidavit.

George Douglas, Axeman.

Subscribed and sworn to by the said George
Douglas before me this 2nd day of
July, 1891.

S. B. Penin
Notary Public

I, _____, do solemnly swear that I will
well and truly perform the duties of flagman, in the establishment of corners and other
duties, according to instructions given me and to the best of my skill and ability, in the
survey of the Mining Claim of _____
known as the _____,
more fully described in the preceding affidavit.

_____, Flagman.

Subscribed and sworn to by the said _____
before me this _____ day of
_____, 18 _____.

Field Notes
of the Survey of the
Neptune Mine Mining Claims
in the Warren Mining District
Cochise County Arizona Territory

Claimed by

D. Willis James and W. E. Dodge

Surveyed by

H. C. Howe U.S. Deputy Mineral
Surveyor, under instructions
from the Surveyor General, of
date May 23rd 1891

Survey commenced July 2nd 1891.
Survey completed July 22nd 1891.

Description of Survey

Beginning at the Initial mon,
mentioned in location notice,
situated at the south easterly
center end of claim, which point
is also the westerly center end of
the Space Mine. a monument
of stone built upon crossings.
Where I set Post $4\frac{1}{2}$ ft. long 4 in. sq.,
and surrounds by a monument
of stones $4\frac{1}{2}$ ft. at base and 3 ft high.
Post marked upon east face, I.M.
Space M. M. C. No. 1. and upon the west
face I.M. Neptune M. M. C. No. 1.

From which an Oak Tree 12 in diam.
blazed and marked W. T. Neptune.
bears $S 55^{\circ} 0' E$ 48.4 ft.

U.S. M. M. No 4, bears $N 50^{\circ} 28' E$ 868.48 ft.

Thence $S 48^{\circ} 27' W$.

var $N 40' E$ East.

176.4 To a monument of stone, which
point is the S.W. cor. Space Mine,
and the S.E. cor. of the Neptune Mine.

Feet. where I set post $4\frac{1}{2}$ ft. long 4 in. sgr. in monument of stone and earth $4\frac{1}{2}$ ft at base and 3 ft. high.
 Post marked upon east face S.M.M.C No 6 and upon west face N.M.M.C No 2.
 Thence $N46^{\circ}40' W$.
 var $11^{\circ}40' East$.

504.6 Intersect easterly end line Silver Spray M.C. Lot No 71. $S47^{\circ}46' W$ 29 ft from post, S.S. M.C No 2.

1120. deep wash drains N.N.E.

1285.3 A 4 in post set in wash, marked S.S. M.C. No. 3.
 From which a 4 in. post S.S. M.C. No 2 bears $S48^{\circ}35' E$ 770. ft.
 This point is also the intersection of easterly side line Hayes Mine. bears $S25^{\circ}08' W$ and $N25^{\circ}08' E$

1354. To the S.W. cor. of claim, a monument of stone on northerly side of wash. where I set Post $4\frac{1}{2}$ ft. long, 4 in. sgr. and surround by a monument of stone and earth. $4\frac{1}{2}$ ft at base, and 3 ft. high.
 Post marked N.M. M.C. No. 3.
 Thence $N48^{\circ}27' E$
 var $11^{\circ}40' East$.

165. Intersect easterly side line Hayes Mine $S25^{\circ}08' W$ 331 ft from Post H.M.M.C. No 2, this intersection is also S.W. cor. Lookout Mine.

300. To a mon. of stone the westerly center end Neptune Mine where I set Post $4\frac{1}{2}$ ft. long, 4 in. sgr. in monument of stone $4\frac{1}{2}$ ft. at base and 3 ft. high.
 Post marked N.M. M.C No 4.

600. To the N.W. cor of claim, a mon. of stone where I set Post $4\frac{1}{2}$ ft. long, 4 in sgr. and surrounded by mon. of stone $4\frac{1}{2}$ ft. at base, 3 ft high
 Post marked N.M. M.C. No. 5.
 From which the S.E cor Baxter M.C.

Feet. and N.E. cor Hayes Mine bears
 N 86° 30' W 184.45 ft.
 Thence S 41° 12' E
 200 V 11° 40' E

235. Deep wash drains N. Easterly.
 262. A monument of stone on the south
 easterly side of wash. the S.E. cor. of
 Lookout Mine.

1110. Small wash drains easterly.
 1348.5 To the N.E. cor. mon. which is also
 the N.W. cor Space Mine, where I set
 post 4 1/2 ft. long. 4 in. sq. in monument
 of stone 4 1/2 ft at base and 3 ft. high.
 Post marked upon east face S.M.M.
 C. No. 2. and upon west face N.M.M.C
 No 6.

Thence S 48° 27' N
 200 V 11° 40' East.

294.4 To Post 1.M. Neptune M.M.C No 1. and place
 of beginning survey of exterior lines.

Area.

Total area of claim	16,574 acres
Less conflicts not claimed with Silver Spray M.C	
Lot No 71. of	.258 acres
and Hayes Mine of	.126 "
Net area	16,190 acres.

Location.

This claim is located in the
 Warren Mining District, Cochise
 County Arizona Territory. In the
 Mule pass Mountains about
 1/2 a mile S.W. of Iron Springs, and
 is bounded upon the South east
 by the Space Mine and upon the
 South west by the Silver Spray M.C
 Lot No 71. and upon the N. West. by

the Hayes Mine and the Lookout Mines
and upon the N East by the Lookout
and Boggswell Mines.

Improvements.

Made upon this claim by claim-
ants or grantors consist of

A shaft 4x6ft. 50ft. deep. bears North,
170. ft. from Post I.M. Neptune M.M.C. No. 1.

A Tunnel 4x7ft. 25ft long. (face of) bears
N 12° 40' W 320ft. from Post I.M. Neptune
M.M.C. No. 1.

A Shaft. 4x6ft. 60ft. deep, bears
N 66° 05' W 534ft. from Post N.M.M.C. No. 6.

A Tunnel 5x7ft. 30ft long with cross cut
to left of 20ft. (face of) bears S 32° 40' E
415 ft. from Post N.M.M.C. No 4.

And I hereby certify that the value
of said improvements exceeds in
value the sum of five hundred
dollars.

There have been no improvements
made by other parties on this
claim.

Instruments used a Youngs
improved Solar Transit and
Steel tape.

bearings and courses taken by use
of Solar apparatus.

A. C. Howe

U. S. Deputy Mineral Surveyor

Bisbee Sept. 23rd 91.

"Reptune Mine."

7

Mule Mountains, Mule Pass, Pima Co. A.T.
Dec 5th 1877, This notice certifies that we
do this day locate and claim, fifteen
hundred (1500) feet by 300 feet on each
side of mineral bearing quartz or on
on this vein or deposit in accordance
with the mining laws of the United States,
dated May 10th 1872, and described
as follows, Commencing at a monument
of stones erected by us on the North
Western terminus of the Ingham Mine,
owned by Warren Hamor and McKane,
running thence 300 feet North East to a
monument of stones, thence North West
1500 feet to a monument being the surface
lines of the Hayes Mine, thence 600
feet South West to a monument of stones,
thence 1500 feet South East to a monument
of stones, thence 300 feet North East to
place of beginning, This Mine to
be known as the Reptune Mine,
Located in Mule Mountains Mule
Pass, Warren District, Pima County,
A.T. and one half mile South West
from Iron Springs.
Witnesses.

Frank McKane, Hugh J. Jones,

Signed Joseph Herring,
George Warren,
Patrick Dyer,
Richard Troomey,

Filed and recorded at request of R. Troomey
December 21st A.D. 1877 at 3 o'clock P.M.

Sidney W. Carpenter.

TERRITORY OF ARIZONA, }
County of Cochise. } ss.

I, W. F. Bradley, County Recorder in and for the County of Cochise, do hereby certify that the above and foregoing is a full, true and correct copy of The Location notice of the Neptune Mine, Warren District as appears of record now in my office in Book 1, Page 153 of Mines Trans Records

In witness whereof, I have hereunto set my hand and affixed my official seal, at my office, in Tombstone, this 20th day of September, A. D. 1890

W. F. Bradley
County Recorder.



Neptune Mine.

PLAT
 of the
 NEPTUNE MINE MINING CLAIM
 WARREN MINING DISTRICT
 COCHISE COUNTY ARIZONA
 Containing 16.190 Acres net
 Var 11° 40' East
 Scale 200 ft = 1 inch.

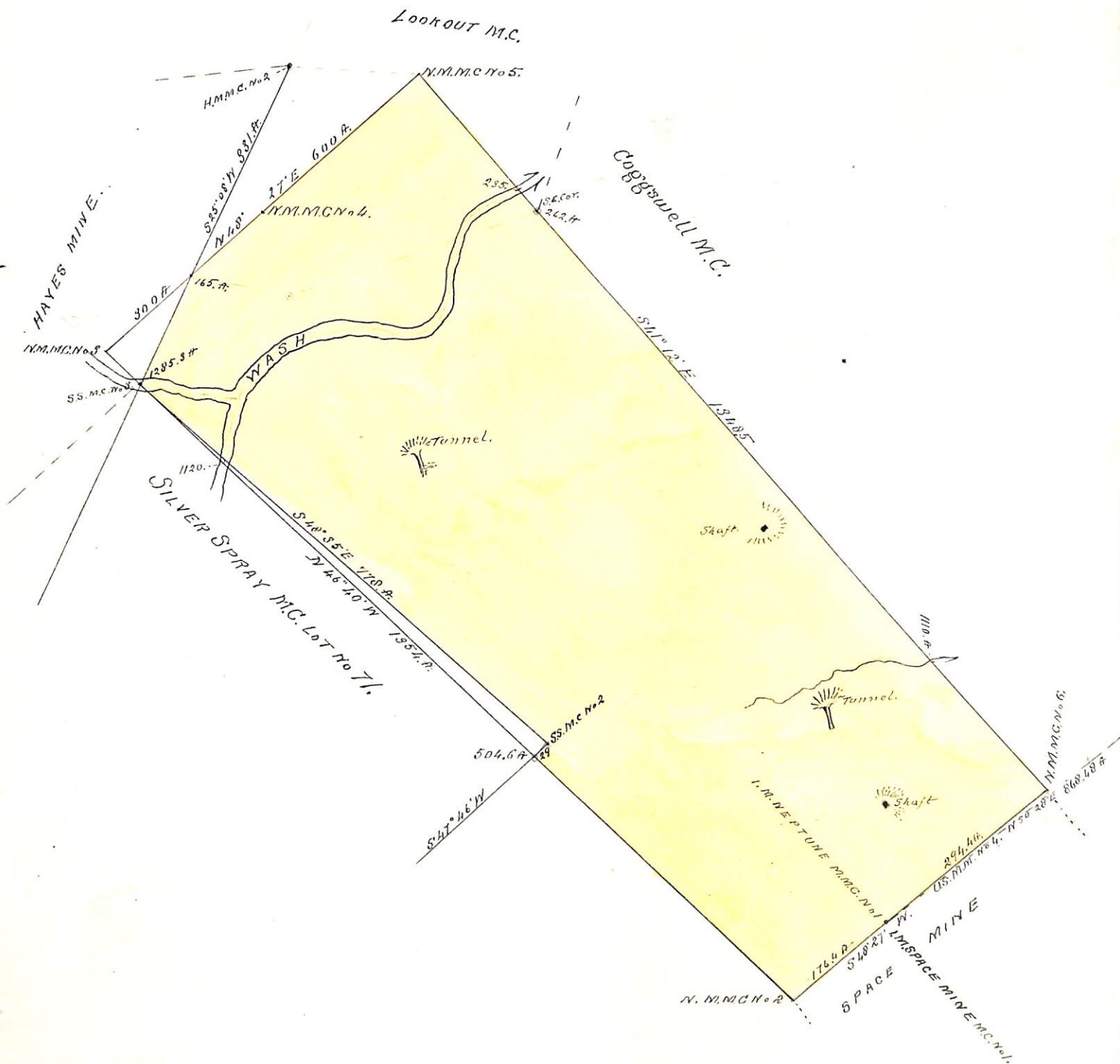

Affidavit of Five Hundred Dollars Improvements.

We, S. B. Whittum and George Douglas
of lawful age, being first duly sworn according to law, depose and say: that we are acquainted with the
Neptune Mine, mining claim, situated in
the Warren Mining District, Cochise County,
Arizona Territory, for which D. Willis James and
W. E. Dodge,
have made application for survey prior to application for patent under the provisions of the Act of
Congress, approved May 10, 1872; and that the labor done and improvements made thereon by the
applicants and their grantors exceed Five Hundred Dollars in value, and further that we are not
personally interested in said mine.

S. B. Whittum

George Douglas

TERRITORY OF ARIZONA,
County of Cochise } ss.

SWORN to and subscribed before me, this 22nd day
of July 1891

S. C. Ferrin
Notary Public



FINAL OATHS FOR SURVEYS.

LIST OF NAMES.

A list of the names of the individuals employed by A. C. Howe
 United States Deputy Mineral Surveyor, to assist in running, measuring, and marking the lines
 corners and boundaries described in the foregoing field notes of the survey of the mining claim
 of D. Willis James and W. E. Dodge
 known as the Neptune Mine Mining Claim.
 and showing the respective capacities in which they acted.

S. B. Whittum, Chairman.
 _____, Chairman.
George Douglas, Axman.
 _____, Flagman.

FINAL OATHS OF ASSISTANTS.

We, S. B. Whittum and George Douglas
 and _____, do solemnly swear that we assisted A. C.
Howe, United States Deputy Mineral Surveyor, in marking the corners and
 surveying the boundaries of the mining claim of
D. Willis James and W. E. Dodge,
 known as the
Neptune Mine, represented
 in the foregoing field notes as having been surveyed by said deputy mineral surveyor and under
 his direction; and that said survey has been in all respects, to the best of our knowledge and
 belief, faithfully and correctly executed, and the corner and boundary monuments established
 according to law and the instructions furnished by the United States Surveyor-General for
Arizona.

S. B. Whittum, Chairman.
 _____, Chairman.
George Douglas, Axman.
 _____, Flagman.

Subscribed and sworn to by the above-named persons before me
 this 22nd day of July, 1891.

S. C. Dennis
Notary Public



(4-686.)

FINAL OATH OF U. S. DEPUTY MINERAL SURVEYOR.

I, H. G. Howe, U. S. Deputy Mineral Surveyor, do solemnly swear that, in pursuance of instructions received from the United States Surveyor General for Arizona, dated May 23rd, 1891, I have, in strict conformity to the laws of the United States, the official regulations and instructions thereunder, and the instructions of said Surveyor General, faithfully and correctly executed the survey of the Mining Claim of D. Willis James and W. C. Dodge, known as the Neptune^{Mine} Mining Claims, situate in Warren Mining District, Cochise County, Arizona, in Section , Township No. , Range No. , and designated as Survey No. 972 Lot 77, as represented in the foregoing field notes, which accurately show the boundaries of said mining claim as distinctly marked by monuments on the ground, and described in the attached copy of the location certificate, which was received by me from the Surveyor General with said instructions, and that all the corners of said survey have been established and perpetuated in strict accordance with the law, official regulations and instructions thereunder; and I do further solemnly swear that the foregoing are the true and original field notes of said survey and my report therein, and that the labor expended and improvements made upon said mining claim by claimant or their grantors are as therein fully stated, and that the character, extent, location and itemized value thereof are specified therein with particularity and full detail, and that no portion of said labor or improvements so credited to this claim has been included in the estimate of expenditures upon any other claim.

H. G. Howe

U. S. Deputy Mineral Surveyor.

Subscribed and sworn to by the said H. G. Howe,

U. S. Deputy Mineral Surveyor, before me S. C. Perrin

a Notary Public this third

day of August, 1891.

S. C. Perrin

Notary Public

(12205-2,000.) O 6-154

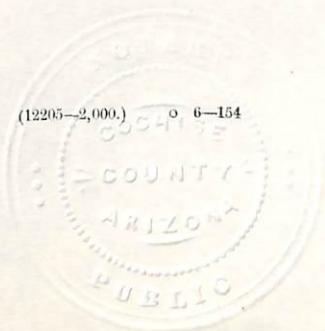

(4-687.)

Surveyor General's Certificate of Approval of Field Notes and Survey of Mining Claim.

Department of the Interior,

Office of U. S. Surveyor General,

Tucson Ariz.

March 5th, 1892.

I, U. S. Surveyor General for Arizona Territory,
do hereby certify that the foregoing and hereto attached Field Notes and Return of the
Survey of the Mining Claim of D. Willis James. and
H. E. Dodge

known as the
Hesperus Mining Claim,
situate in Maricopa mining district,
Cochise County, Arizona,
in Section _____, Township No. _____, Range No. _____

and _____, designated as Survey No. 972 Lot 77077
executed by H. G. Horn, U. S. Deputy Mineral
Surveyor, July 2nd to 22nd, 1891, under my instructions dated
May 23rd, 1891, have been critically examined and the
necessary corrections and explanations made, and the said Field Notes and Return, and
the Survey they describe, are hereby approved. A true copy of the copy of the location
certificate filed by the applicant for survey is included in the field notes.

Rapae & Johnson

U. S. Surveyor General for Arizona

o 6-162