

**M
S**

0

0

9

8

6

(4-683.)

Mineral Survey No. 986.

Lot No. 44.

Prescott Land District.

FIELD NOTES

OF THE SURVEY OF THE MINING CLAIM OF

The Yuma Copper and Silver Mining Company

KNOWN AS THE

"Copper King"

Haverman Mining District,

Maricopa County, Arizona

Section _____, Township 8 N., Range 9 W.

Surveyed under instructions dated April 10th, 1891.

by Frank Nicholson

U. S. Deputy Mineral Surveyor.

Claim located April 17th, 1891

Survey commenced April 25th, 1891

Survey completed May 15th, 1891

PRELIMINARY OATHS OF ASSISTANTS IN SURVEY OF MINING CLAIM.

WE, Frank Obermiller and B. Matthews,
do solemnly swear that we will well and faithfully execute the duties of chain carriers;
that we will level the chain upon even and uneven ground and plumb the tally-pins,
either by sticking or dropping the same; that we will report the true distance to all
notable objects, and the true length of all lines that we assist in measuring, to the best
of our skill and ability, and in accordance with instructions given us, in the survey of
the Mining Claim of The Yuma Copper and Silver Mining Company, known as the
"Copper King"
situate in Maricopa mining district,
Maricopa County, Arizona
in Section _____, Township No. _____, Range No. _____

Frank Obermiller, Chainman.
B. Matthews, Chainman.

Subscribed and sworn to by the above-named persons before
me this 24th day of April, 1891.

Frank Nicholson
Notary Public.

I, Frank Straver, do solemnly swear that I will well and
truly perform the duties of axeman, in the establishment of corners and other duties,
according to instructions given me and to the best of my skill and ability, in the survey
of the Mining Claim of The Yuma Copper and Silver Mining Company
known as the "Copper King",
more fully described in the preceding affidavit.

Frank Straver, Axeman.

Subscribed and sworn to by the said Frank Straver
before me this 24th day of
April, 1891.

Frank Nicholson
Notary Public.

I, O. M. Smith, do solemnly swear that I will
well and truly perform the duties of flagman, in the establishment of corners and other
duties, according to instructions given me and to the best of my skill and ability, in the
survey of the Mining Claim of The Yuma Copper and Silver Mining Company
known as the "Copper King",
more fully described in the preceding affidavit.

O. M. Smith, Flagman.

Subscribed and sworn to by the said O. M. Smith
before me this 24th day of
April, 1891.

Frank Nicholson
Notary Public.



Feet

Field Notes
of the survey of the
Copper King Mining Claim
in the Harcuvar Mining District, Maricopa County,
Arizona.

Claimed by The Yuma Copper and Silver Mining Company.

Surveyed by Frank Nicholson, U.S. Deputy Mineral Surveyor under instructions from the Surveyor General, of date, April 10th. 1891.

Survey commenced, April 25th. 1891.

Survey completed, May 15th. 1891.

Description of Survey.

Beginning at initial mon. mentioned in loc. notice, and marking the northerly end centre of claim, where I set a post 4 ft. long, 4 ins. x 4 ins. in section, 1 1/2 ft. in ground and surrounded same with a mound of stones. Post marked C. K. J. M. No. 1

Thence S. 72° 57' W.

Var. 13° 3' E.

300 To loc. mon. where I set a post 4 ft. long, 4 ins. x 4 ins. in section, 1 1/2 ft. in ground, and surrounded same with a mound of stones. Post marked C. K. No. 2.

Thence S. 17° 3' E.

Var. 13° 3' E.

1500 To mon. and post marked P. No. 3, which post I marked C. K. No. 3.

U.S. Min. Mon. No. 1. Dis. S. 23° 3' E. 2195 ft.

Thence N. 72° 57' E.

Var. 13° 3' E.

300 To mon. and post marked P. No. 4 which post, I marked C. K. No. 4.

Thence N. 72° 57' E. (same course).

Var. 13° 3' E.

300 To mon. and post marked on one side, P. No. 5; on another side,

Feet.

T. No. 3; and on the third side, C. Q. No. 3. I marked this post on its fourth side, C. K. No. 5.

This post marks the N.E. cor. of the Paniter claim, the N.W. cor. of the Turk claim and the S.W. cor. of the Copper Queen claim.

Thence N. 17° 3' W.

Var. 13° 3' E.

1500 A mon. and post marked C. Q. No. 2, which post I marked C. K. no. 6.

Thence S. 72° 57' W.

Var. 13° 3' E.

300 A mon. and post marked C. K. S. M. No. 1, place of beginning.

This claim has a side-line in common with the Copper Queen claim and an end-line in common with the Paniter claim.

Area.

Total Area of Claim 20.66 acres

No conflict

Nett area Claimed 20.66 "

Location.

This claim is located on unsurveyed land on the S.E. slope of the Hancuwa Mountains, 37 miles N.W. of Tulture; 10 miles N. of Cullen's Wells and 10 miles W. of the Black Hawk Mountains.

Improvements

Made on this claim by claimant consist of disc. shaft 6 ft. x 8 ft. and 12 ft. deep, S. 17° 3' E. from Post C. K. S. M. No. 1, 750 ft.

Besides work above mentioned, claimant has erected a 50-ton Copper Smelting plant with office, boarding house,

and engineer's cottage, aggregating in cost, \$25,000⁰⁰ and has constructed a 3-inch, standard, wrought iron pipe line 7 1/2 miles long to convey the water from the Haucuar Mountains to said smelting works at a cost of \$32,000⁰⁰.

These works were erected for the purpose of treating the ore from this and 32 other claims belonging to claimant.

And thereby certify that the value of the improvements on this claim exceeds the sum of five hundred dollars.

No improvements have been made by other parties on this claim.

Instruments used, an improved Blattner and Adam mountain transit and metallic tape.

Var. found by observation of the polar star when on meridian; also by azimuth of North Star.

Frank Nicholson,
U.S. Deputy Mineral Surveyor.

Haucuar, Ariz.,
May 15 - 1891.

Affidavit of Five Hundred Dollars Improvements.

We, Jos L Obermuller and John Harvey
of lawful age, being first duly sworn according to law, depose and say: that we are acquainted with the
"Copper King" mining claim, situated in
Narcewan Mining District, Maricopa County,
Arizona Territory, for which The Yuma Copper and Silver
Mining Company
has made application for survey prior to application for patent under the provisions of the Act of
Congress, approved May 10, 1872; and that the labor done and improvements made thereon by the
applicant and J grantor X exceed Five Hundred Dollars in value, and further that we are not
personally interested in said mine.

Jos. L. Obermuller
John Harvey

TERRITORY OF ARIZONA,
County of Maricopa } ss.

SWORN to and subscribed before me, this 15th day
of May 1891

Frank Nicholson
Notary Public.



FINAL OATHS FOR SURVEYS.

LIST OF NAMES.

A list of the names of the individuals employed by Frank Nicholson
 United States Deputy Mineral Surveyor, to assist in running, measuring, and marking the lines
 corners and boundaries described in the foregoing field notes of the survey of the mining claim
 of Thelsuma Copper and Silver Mining Company
 known as the "Copper King"
 and showing the respective capacities in which they acted.

Frank Obermüller, Chairman.
B. Matthews, Chainman.
Frank Strauer, Axman.
M. Smith, Flagman.

FINAL OATHS OF ASSISTANTS.

We, Frank Obermüller, B. Matthews, Frank Strauer
 and M. Smith, do solemnly swear that we assisted Frank
Nicholson, United States Deputy Mineral Surveyor, in marking the corners and
 surveying the boundaries of the mining claim of Thelsuma Copper and
Silver Mining Company
 known as the "Copper King"
 represented
 in the foregoing field notes as having been surveyed by said deputy mineral surveyor and under
 his direction; and that said survey has been in all respects, to the best of our knowledge and
 belief, faithfully and correctly executed, and the corner and boundary monuments established
 according to law and the instructions furnished by the United States Surveyor-General for
Arizona.

Frank Obermüller, Chairman.
B. Matthews, Chainman.
Frank Strauer, Axman.
M. Smith, Flagman.

Subscribed and sworn to by the above-named persons before me
 this 15th day of May, 1891.

Frank Nicholson,
Notary Public.



FINAL OATH OF U. S. DEPUTY MINERAL SURVEYOR.

I, Frank Nicholson, U. S. Deputy Mineral Surveyor, do solemnly swear that, in pursuance of instructions received from the United States Surveyor General for Arizona, dated April 10th, 1891, I have, in strict conformity to the laws of the United States, the official regulations and instructions thereunder, and the instructions of said Surveyor General, faithfully and correctly executed the survey of the Mining Claim of The Yuma Copper and Silver Mining Company, known as the "Copper King", situate in Maricopa Mining District, Maricopa County, Arizona, in Section _____, Township No. _____, Range No. _____, and designated as Survey No. 986. Lot No 44, as represented in the foregoing field notes, which accurately show the boundaries of said mining claim as distinctly marked by monuments on the ground, and described in the attached copy of the location certificate, which was received by me from the Surveyor General with said instructions, and that all the corners of said survey have been established and perpetuated in strict accordance with the law, official regulations and instructions thereunder; and I do further solemnly swear that the foregoing are the true and original field notes of said survey and my report therein, and that the labor expended and improvements made upon said mining claim by claimant or its grantors are as therein fully stated, and that the character, extent, location and itemized value thereof are specified therein with particularity and full detail, and that no portion of said labor or improvements so credited to this claim has been included in the estimate of expenditures upon any other claim.

Frank Nicholson,
U. S. Deputy Mineral Surveyor.

Subscribed and sworn to by the said Frank Nicholson
U. S. Deputy Mineral Surveyor, before me _____
this 15th
day of May, 1891.

E. J. Bennett
Notary Public

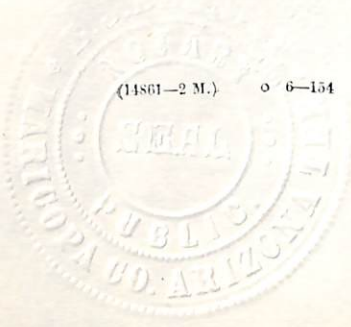

Notice of Location

Notice is hereby given that the undersigned having complied with the requirements of Chapter Six of Title Thirtytwo and all amendments thereto of the Revised Statutes of the United States and the local customs laws and regulations have located fifteen hundred linear feet by six hundred feet wide in the Copper King quartz vein situated in Haveras Mining District, County of Maricopa Arizona Territory. This claim commences at this monument and notice and runs 300 feet in a southerly direction to a monument of stone marked No - corner, thence 1500 feet in a southeasterly direction to a monument of stone marked No - corner, thence 640 feet in a northeasterly direction to a monument of stone marked No - corner, thence 1500 feet in a northerly direction to a monument of stone marked No - corner, thence 300 feet in a southerly direction to the place of beginning.

Dated on the ground this 17th day of April 1890

J. H. Leibold
Witness

The Yuma Copper Silver Mining Co
Locator

This claim runs parallel to the Copper Queen on the Northeast side & has a side line in common with said Copper Queen claim

Filed and recorded at request of E. H. Prang Jun. 2. 1890 at 10 o'clock A.M.

New Orleans, County Recorder
By Eugene Graham, Deputy Recorder

TERRITORY OF ARIZONA, }
County of Maricopa. } ss

I, New Orleans, County Recorder in and for the County and Territory aforesaid, hereby certify that I have compared the foregoing copy with the original Notice of Location filed and recorded in my office on the 2nd day of June 1890 in Book No. 5 of Mining Claims at Page 107 and that the same is a full true and correct copy of such original and of the whole thereof.

Witness my hand and seal of office this 17th day of March 1891 New Orleans

County Recorder.

PLAT
of the survey of the
COPPER KING
Mining Claim

in the Harcuwar Mining District,
Maricopa County, Arizona.

Claimed by The Yuma Copper and Silver Mining Company.

Surveyed by
Frank Nicholson,
U.S. Deputy Mineral Surveyor,
or, under instructions from
the Surveyor General, of date,
April 10th., 1891.

Scale 1 in. = 200 ft.
Variation 13° 3' E.

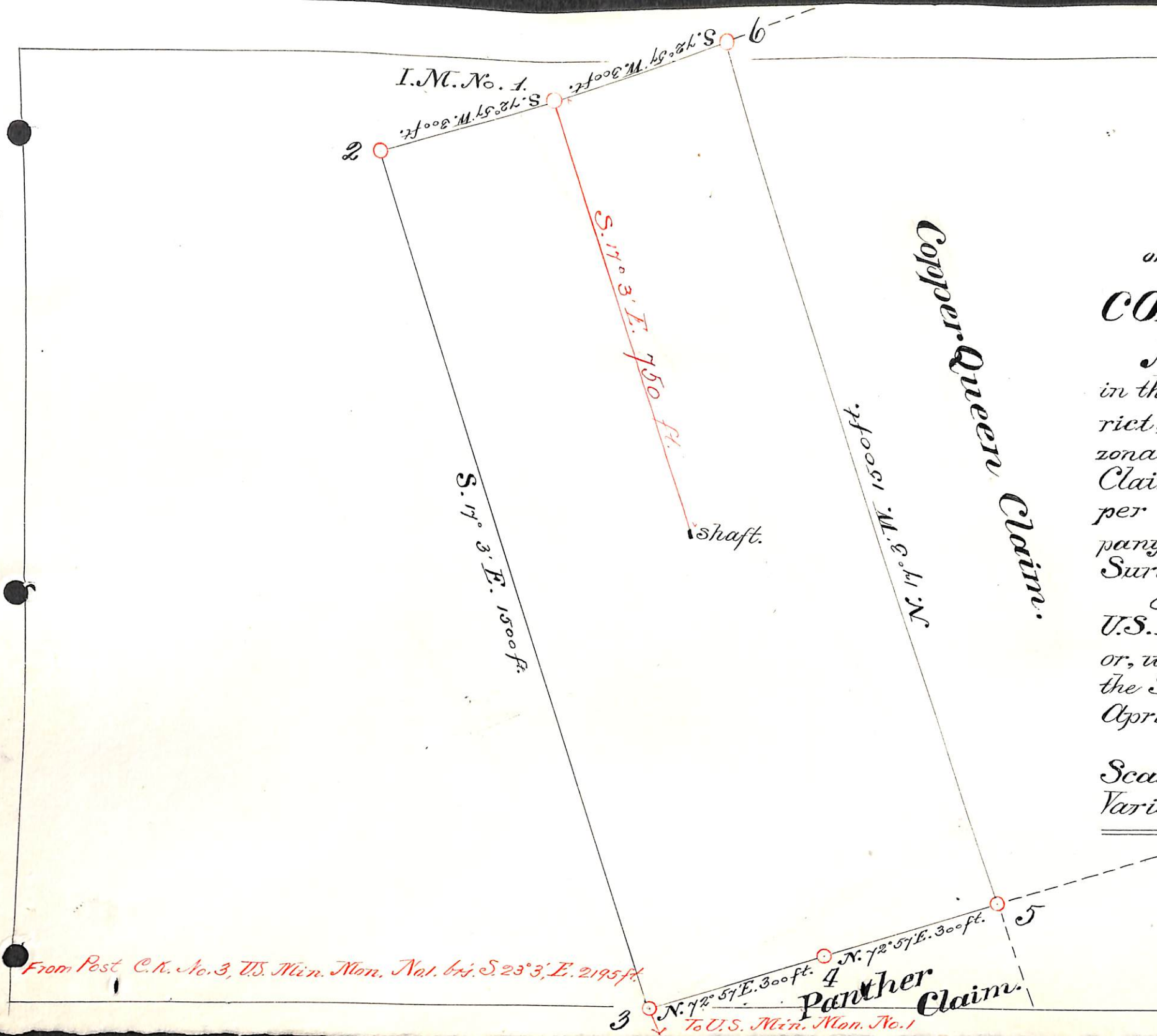

(4-687.)

Surveyor General's Certificate of Approval of Field Notes and Survey of Mining Claim.

Department of the Interior,

Office of U. S. Surveyor General,

Tucson, Arizona

December 30th, 1891.

I, U. S. Surveyor General for

Arizona Territory,

do hereby certify that the foregoing and hereto attached Field Notes and Return of the

Survey of the Mining Claim of

The Yuma Copper and Silver Mining Company

known as the "Copper King"

situate in

Harcuran

mining district,

Maricopa County, Arizona

in Section, Township No., Range No.

and designated as Survey No. 986. Lot No 44.

executed by Frank Nicholson, U. S. Deputy Mineral

Surveyor,

April 25th to May 13th, 1891, under my instructions dated

April 10th, 1891,

have been critically examined and the necessary corrections and explanations made, and the said Field Notes and Return, and

the Survey they describe, are hereby approved. A true copy of the copy of the location

certificate filed by the applicant for survey is included in the field notes.

Raphael Johnson
U. S. Surveyor General for Arizona

o 6-102

UNITED STATES DEPARTMENT OF THE INTERIOR 9605 (956)
BUREAU OF LAND MANAGEMENT M.S. 986
ARIZONA STATE OFFICE

NOTICE OF CANCELLATION OF MINERAL SURVEY

The Copper King lode, Mineral Survey No. 986, located in sections 3 and 10, Township 8 North, Range 10 West, Gila and Salt River Meridian, Arizona, is hereby canceled.

This claim has not been filed with the Arizona State Office, Bureau of Land Management, in accordance with Section 314, 90 STAT. 2769, (43 U.S.C. 1744).

This cancellation was necessitated to clear the record.

The Mineral Survey Plat should be noted as follows:

"Copper King lode, M.S. 986, was canceled April 22, 2002, by memo 9605 (956) M.S. 986, which is now a part of the original field notes."

April 22, 2002
Date



Chief Cadastral Surveyor of Arizona