

MS

0

0

9

9

8

(4-683.)

Mineral Survey No. 998.

Lot No. 56.

Brescott Land District.

FIELD NOTES

OF THE SURVEY OF THE MINING CLAIM OF

The Yuma Copper & Silver Mining Company

KNOWN AS THE

"Vulture"

Harcuwar Mining District,

Maricopa County, Arizona

Section _____, Township 8N, Range 9W

Surveyed under instructions dated April 10th, 1891,

by Frank Nicholson
U. S. Deputy Mineral Surveyor.

Claim located November 25th, 1886.

Survey commenced April 30th, 1891.

Survey completed May 15th, 1891.

PRELIMINARY OATHS OF ASSISTANTS IN SURVEY OF MINING CLAIM.

WE, *Frank Obermüller* and *B. Matthews*, do solemnly swear that we will well and faithfully execute the duties of chain carriers; that we will level the chain upon even and uneven ground and plumb the tally-pins, either by sticking or dropping the same; that we will report the true distance to all notable objects, and the true length of all lines that we assist in measuring, to the best of our skill and ability, and in accordance with instructions given us, in the survey of the Mining Claim of *The Yuma Copper and Silver Mining Company*, known as the "*Vulture*" situate in *Marcuwar* mining district, *Mariopa* County, *Arizona*, in Section _____, Township No. _____, Range No. _____.

Frank Obermüller, Chainman.
B. Matthews, Chainman.

Subscribed and sworn to by the above-named persons before me this *24th* day of *April*, 1891.

Frank Nicholson,
 Notary Public.

I, *Frank Strauer*, do solemnly swear that I will well and truly perform the duties of axeman, in the establishment of corners and other duties, according to instructions given me and to the best of my skill and ability, in the survey of the Mining Claim of *The Yuma Copper and Silver Mining Company*, known as the "*Vulture*", more fully described in the preceding affidavit.

Frank Strauer, Axeman.

Subscribed and sworn to by the said *Frank Strauer* before me this *24th* day of *April*, 1891.

Frank Nicholson,
 Notary Public.

I, *O. M. Smith*, do solemnly swear that I will well and truly perform the duties of flagman, in the establishment of corners and other duties, according to instructions given me and to the best of my skill and ability, in the survey of the Mining Claim of *The Yuma Copper and Silver Mining Company*, known as the "*Vulture*", more fully described in the preceding affidavit.

O. M. Smith, Flagman.

Subscribed and sworn to by the said *O. M. Smith* before me this *24th* day of *April*, 1891.

Frank Nicholson,
 Notary Public.



Feet

Field Notes

of the survey of the
Vulture Mining Claim
in the Maricopa Mining District, Maricopa
County, Arizona.

Claimed by The Yuma Copper and
Silver Mining Company.

Surveyed by Frank Nicholson,
U.S. Deputy Mineral Surveyor,
under instructions from the Surveyor
General, of date, April 10, 1891.

Survey Commenced April 30, 1891

Survey Completed May 15, 1891.

Description of Survey.

Beginning at the initial mon. men-
tioned in location notice, and
marking the Easterly end centre
of claim, where I set a post
4 ft. long, and 4 ins. x 4 ins. in
section, 1 1/2 ft. in ground and
surrounded same with a mound
of stones. Post marked V. D. M. No. 1.

U.S. Min. Mon. No. 1, bis N. 20° 0' E. 7375 ft.

Hence S. 16° 58' E.

Var. 13° 3' E.

300

In loc. mon. where I set a
post 4 ft. long and 4 ins. x 4 ins.
in section, 1 1/2 ft. in ground and
surrounded same with a mound
of stones. Post marked V. No. 2.

Hence S. 73° 2' W.

Var. 13° 3' E.

1500

In loc. mon. where I set
a post 4 ft. long and 4 ins.
x 4 ins. in section, 1 1/2 ft. in
ground and surrounded same
with a mound of stones. Post
marked V. No. 3.

Hence N. 16° 58' W.

Var. 13° 3' E.

300

In loc. mon. for Westerly
end centre of claim where

Feet

I set a post, 4 ft. long, and 4 ins. x 4 ins. in section, 1 1/2 ft. in ground and surrounded same with a mound of stones. Post marked V. No. 4.

Hence N. 16° 58' W. (same course).

Var. 13° 3' E.

236

To ledge of rock bis E. and W.

300

To mon. and post marked B. No. 5, which post I marked V. No. 5.

Hence N. 73° 2' E.

Var. 13° 3' E.

1500

To mon. and post marked B. No. 6 which post I marked V. No. 6.

Hence S. 16° 58' E.

Var. 13° 3' E.

300

To mon. and post marked V. I. cl. No. 1. place of beginning.

The Vulture claim and the Brooklyn claim have a side-line in common.

Area.

Total area of claim 20.66 acres.

No conflict

Nett area Claimed 20.66 "

Location.

This claim is located on unsurveyed land on the S.E. slope of the Harcuwar Mountains, 9 miles N. of Queen's Wells, 11 miles W. of Black Hawk Mountains and 38 miles W. of Vulture.

Improvements

made upon this claim by claimant consist of disc. shaft 5' x 8', 12 ft. deep, S. 73° 2' W. 145 ft. from Post V. I. cl. No. 1 and shaft 5' x 8', 23 ft. deep, S. 73° 2' W. ^{200ft.} from Post V. I. cl. No. 1, and

open cut 8 ft. wide, 4 ft. deep and 50 ft. long connecting the two shafts.

And I hereby certify that the value of said improvements exceeds the sum of five hundred dollars.

There have been no improvements made by other parties on this claim.

Instruments used, an improved Reaume and Adams mountain transit and metallic tape.

Var. found by observation of the polar star when on meridian: also by azimuth of North Star. Results agreed within one minute.

Frank Nicholson,
U.S. Deputy Mineral Surveyor.
Hacumar, Ariz.
May 15 - 1891.

Affidavit of Five Hundred Dollars Improvements.

We, Jos L Obermuller and John Harvey

of lawful age, being first duly sworn according to law, depose and say: that we are acquainted with the

"Tucture" mining claim, situated in

Harcewar Mining District, Maricopa County,

Arizona Territory, for which The Yuusa Copper and Silver

Mining Company

has made application for survey prior to application for patent under the provisions of the Act of

Congress, approved May 10, 1872; and that the labor done and improvements made thereon by the

applicant and its grantor exceed Five Hundred Dollars in value, and further that we are not

personally interested in said mine.

Jos L Obermuller

John Harvey

TERRITORY OF ARIZONA,
County of Maricopa } ss.

SWORN to and subscribed before me, this 15th day

of May 1891

Frank Nicholson,
Notary Public.



FINAL OATHS FOR SURVEYS.

LIST OF NAMES.

A list of the names of the individuals employed by *Frank Nicholson* United States Deputy Mineral Surveyor, to assist in running, measuring, and marking the lines corners and boundaries described in the foregoing field notes of the survey of the mining claim of *The Yuma Copper and Silver Mining Company* known as the "*Vulture*" and showing the respective capacities in which they acted.

Frank Obermiller, Chairman.
B. Matthews, Chairman.
Frank Straver, Axman.
O. M. Smith, Flagman.

FINAL OATHS OF ASSISTANTS.

We, *Frank Obermiller, B. Matthews, Frank Straver* and *O. M. Smith*, do solemnly swear that we assisted *Frank Nicholson*, United States Deputy Mineral Surveyor, in marking the corners and surveying the boundaries of the mining claim of *The Yuma Copper and Silver Mining Company*, known as the "*Vulture*", represented in the foregoing field notes as having been surveyed by said deputy mineral surveyor and under his direction; and that said survey has been in all respects, to the best of our knowledge and belief, faithfully and correctly executed, and the corner and boundary monuments established according to law and the instructions furnished by the United States Surveyor-General for *Arizona*.

Frank Obermiller, Chairman.
B. Matthews, Chairman.
Frank Straver, Axman.
O. M. Smith, Flagman.

Subscribed and sworn to by the above-named persons before me this *15th* day of *May*, 189*1*.

Frank Nicholson,
 Notary Public.



(4-686.)

FINAL OATH OF U. S. DEPUTY MINERAL SURVEYOR.

I, Frank Nicholson, U. S. Deputy Mineral Surveyor, do solemnly swear that, in pursuance of instructions received from the United States Surveyor General for Arizona, dated April 10, 1891, I have, in strict conformity to the laws of the United States, the official regulations and instructions thereunder, and the instructions of said Surveyor General, faithfully and correctly executed the survey of the Mining Claim of Thelma Copper and Silver Mining Company, known as the "Vulture", situate in Maricopa Mining District, Maricopa County, Arizona, in ~~Section~~ Township No. Range No. and designated as Survey No. 998. Lot No 56, as represented in the foregoing field notes, which accurately show the boundaries of said mining claim as distinctly marked by monuments on the ground, and described in the attached copy of the location certificate, which was received by me from the Surveyor General with said instructions, and that all the corners of said survey have been established and perpetuated in strict accordance with the law, official regulations and instructions thereunder; and I do further solemnly swear that the foregoing are the true and original field notes of said survey and my report therein, and that the labor expended and improvements made upon said mining claim by claimant or its grantors are as therein fully stated, and that the character, extent, location and itemized value thereof are specified therein with particularity and full detail, and that no portion of said labor or improvements so credited to this claim has been included in the estimate of expenditures upon any other claim.

Frank Nicholson,
U. S. Deputy Mineral Surveyor.

Subscribed and sworn to by the said Frank Nicholson,
U. S. Deputy Mineral Surveyor, before me
this 15th
day of May, 1891.

E. J. Bennett
Notary Public

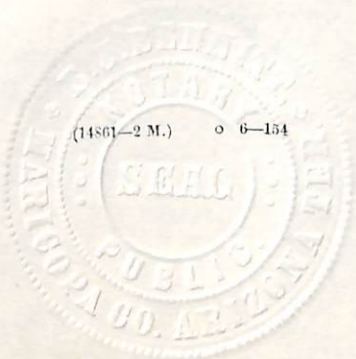

Notice of Location
 Of the Full and Mining Claim
 On the Quartz Ledge, Containing
 Copper and Silver. And located
 as a Quartz Mine.

The undersigned, claim for
 Mining purposes Fifteen Hundred
 (1500) Feet on this Quartz Ledge,
 in length along the ledge or
 vein, and Three Hundred
 (300) Feet on each side of the
 middle of the vein at the sur-
 face, together with all dips,
 spurs and angles, and all
 valuable mineral deposits
 contained therein, and all
 timber growing within the limits
 of said claim, and all water
 and water privileges thereon
 or appurtenant thereto, under
 and according to the provisions
 of An Act of Congress, approved
 May 10th 1872, entitled "An Act
 to Promote the Development of
 the Mining Resources of the
 United States" and all Acts
 amendatory thereto, and the
 laws of the Territory of Arizona.
 This claim commences at this
 notice, which is posted in a
 Monument of Stone in a con-
 spicuous place on the ledge

at the South East End boundary of the claim, and running thence Three Hundred (300) Feet in a Westernly direction to a Monument of Stone and a Stake marked ~~South~~ West End corner; thence Fifteen Hundred (1500) Feet in a ~~North~~ Westernly direction to a Monument of Stone and a Stake marked South West corner; thence Three Hundred (300) Feet in a Southernly direction to a Monument of Stone and a Stake marked North West Center Monument boundary; thence Three Hundred (300) Feet in a Southernly direction to a Monument of Stone and a Stake marked corner; thence Fifteen Hundred (1500) Feet in a North West direction to a Monument of Stone and a Stake marked corner; thence Three Hundred (300) Feet in a Southernly direction to the place of beginning.

This claim may be more generally described as situated in the Warcurar Mountains, Yuma County, Arizona Territory.

about 12 miles North of Cullens Wells, 10 miles West of the Black Hawk Mountains and 12 miles South of Water Creek and this claim shall be known as the Vulture Mine, and shall be known as the claim and the water on the ground this 25th day of November A.D. 1886.

Regius W. L. Carl
Charles W Nugent
Carrie A. Sumpkins
Ida Hazard
Witnesses

Recorded at the request of Jas. Gaudolfo Dec. 8, 86, at 10 A.M.

Jos J. Stein
Co. Recorder

Territory of Arizona }
County of Yuma } ss

I, J. L. Redondo County Recorder in and for the County of Yuma said Territory do here by certify that the within is a true and correct copy of the "Vulture" Mine as the same appears of record in the records of my office in Book "E" of Mines at pages 215 and 216

Witness my hand and official seal this 14th day of March A.D. 1891
J. L. Redondo
County Recorder

Brooklyn Mining Claim
 N. 73° 2' E., 1500 ft.

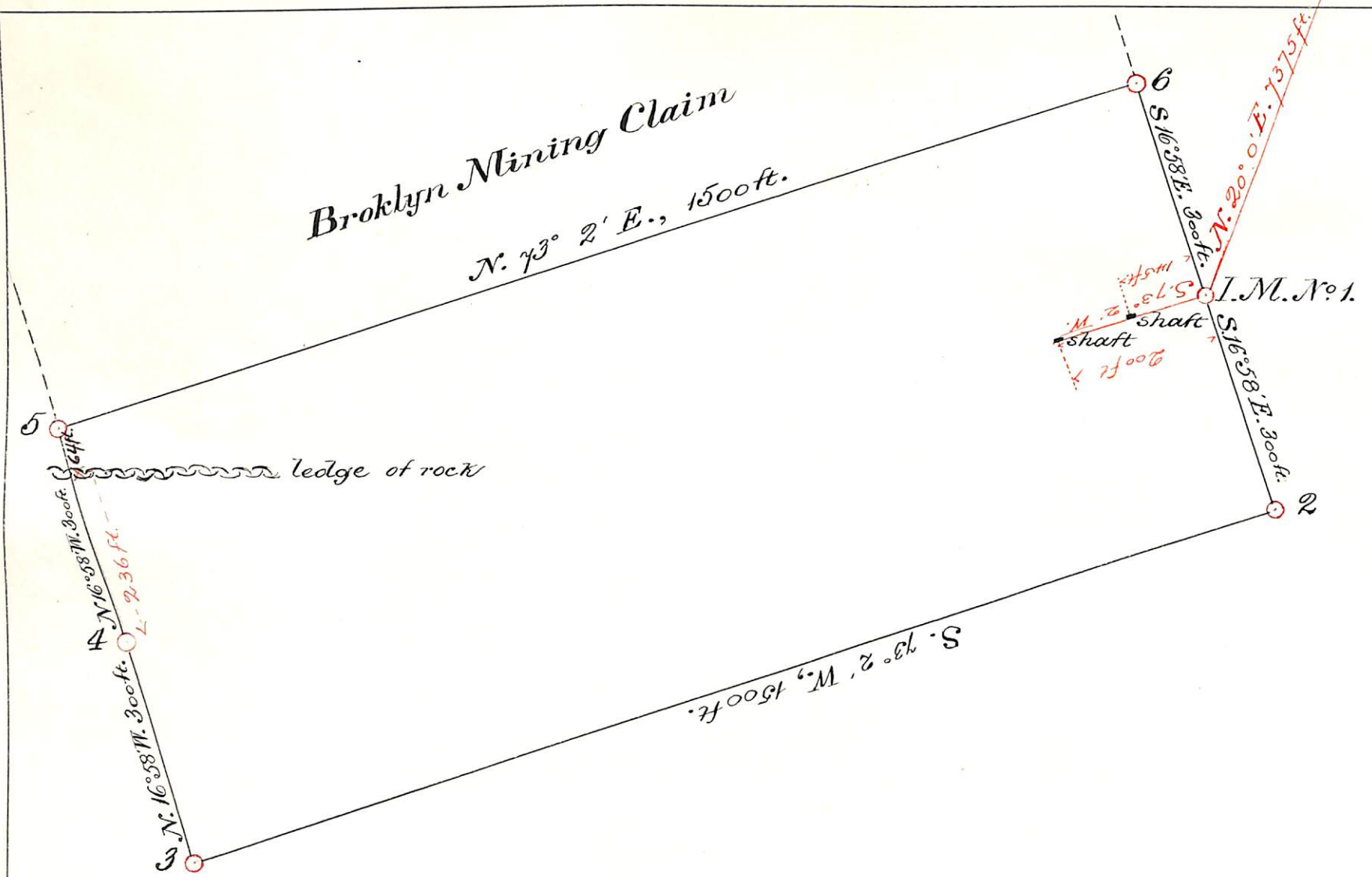

PLAT
 of the survey of the
VULTURE
 Mining Claim
 in the Harcuvar Mining Dis-
 trict, Maricopa County, Ar-
 izona.

Claimed by The Tuma
 Copper and Silver Min-
 ing Company.
 Surveyed by
 Frank Nicholson,
 U.S. Deputy Mineral Sur-
 veyor, under instructions from
 the Surveyor General, of date,
 April 10th., 1891.

Scale 1 in. = 200 ft.
 Variation 13° 3' E.

(4-687.)

Surveyor General's Certificate of Approval of Field Notes and Survey of Mining Claim.

Department of the Interior,

Office of U. S. Surveyor General,

Tucson, Arizona

December 30th, 1891.

I, U. S. Surveyor General for

Arizona Territory

do hereby certify that the foregoing and hereto attached Field Notes and Return of the

Survey of the Mining Claim of

The Yuma Copper and Silver Mining Company

, known as the

"Vulture"

situate in Harcuvar mining district,

Maricopa County, Arizona

in Section _____, Township No. _____, Range No. _____

and _____, designated as Survey No. 998. Lot No 56.

executed by Frank Nicholson, U. S. Deputy Mineral

Surveyor, April 30th to May 15th, 1891, under my instructions dated

April 10th, 1891, have been critically examined and the

necessary corrections and explanations made, and the said Field Notes and Return, and

the Survey they describe, are hereby approved. A true copy of the copy of the location

certificate filed by the applicant for survey is included in the field notes.

Pappas & Johnson
 Arizona

U. S. Surveyor General for

o 6-102

UNITED STATES DEPARTMENT OF THE INTERIOR 9605 (956)
BUREAU OF LAND MANAGEMENT M.S. 998
ARIZONA STATE OFFICE

NOTICE OF CANCELLATION OF MINERAL SURVEY

The Vulture lode, Mineral Survey No. 998, located in sections 15 and 22, Township 8 North, Range 10 West, Gila and Salt River Meridian, Arizona, is hereby canceled.

This claim has not been filed with the Arizona State Office, Bureau of Land Management, in accordance with Section 314, 90 STAT. 2769, (43 U.S.C. 1744).

This cancellation was necessitated to clear the record.

The Mineral Survey Plat should be noted as follows:

"Vulture lode, M.S. 998, was canceled April 22, 2002, by memo 9605 (956) M.S. 998, which is now a part of the original field notes."

April 22, 2002
Date



Chief Cadastral Surveyor of Arizona