

**M  
S  
-**

**0**

**1**

**0**

**3**

**9**



*6/2/92*

*20  
S.M.  
P.S.*

(4-683.)

Mineral Survey No. *1039.*

Lot No. \_\_\_\_\_

*Gila.* Land District.

FIELD NOTES

OF THE SURVEY OF THE MINING CLAIM OF

*Aravaipa Mining Company*  
*John F. Blandy Atty.*

KNOWN AS THE

*Silver Bell, Mammoth Chief, Keedy and*  
*Connection Lodes, situate in Aravaipa Mining District,*

*Graham.* County, *Arizona.*

Section \_\_\_\_\_, Township *5 South*, Range *20 East*

Surveyed under instructions dated *June 11<sup>th</sup>*, 1892

by *H. C. Howe.*

U. S. Deputy Mineral Surveyor.

Claim located *Jan 1<sup>st</sup> 1889* *Jan 1<sup>st</sup> 1890* *Dec 12<sup>th</sup> 1890* *Feb 11<sup>th</sup> 1891*

Survey commenced *July 7<sup>th</sup>*, 1892.

Survey completed *July 11<sup>th</sup>*, 1892.

*Silver Bell* located *Jan 1<sup>st</sup> 1889.*

*Mammoth Chief*, located *Jan 1<sup>st</sup> 1890.*

*Keedy* .. *Feb. 11<sup>th</sup> 1891.*

*Connection* .. *Dec. 12<sup>th</sup> 1890.*

Address of Claimant.

*Aravaipa.*

*Graham County,*  
*Arizona.*

5462 b-3 m



# PRELIMINARY OATHS OF ASSISTANTS IN SURVEY OF MINING CLAIM.

WE, W. H. Moore and \_\_\_\_\_,  
do solemnly swear that we will well and faithfully execute the duties of chain carriers; that we will level the chain upon even and uneven ground and plumb the tally-pins, either by sticking or dropping the same; that we will report the true distance to all notable objects, and the true length of all lines that we assist in measuring, to the best of our skill and ability, and in accordance with instructions given us, in the survey of the Mining Claim of Aravaipa Mining Company, known as the Silver Bell, Mammoth, Chief, Keedy and Connection Lodes situate in Aravaipa mining district, Graham County, Arizona, in Section \_\_\_\_\_, Township No. \_\_\_\_\_, Range No. \_\_\_\_\_.

W. H. Moore, Chainman.  
\_\_\_\_\_, Chainman.

Subscribed and sworn to by the above-named persons before me this 7<sup>th</sup> day of July, 1892.

H. G. Howe  
Notary Public.

I, \_\_\_\_\_, do solemnly swear that I will well and truly perform the duties of axeman, in the establishment of corners and other duties, according to instructions given me and to the best of my skill and ability, in the survey of the Mining Claim of \_\_\_\_\_

known as the \_\_\_\_\_, more fully described in the preceding affidavit.

\_\_\_\_\_, Axeman.

Subscribed and sworn to by the said \_\_\_\_\_ before me this \_\_\_\_\_ day of \_\_\_\_\_, 18 \_\_\_\_\_.

I, Alvan W. Howe, do solemnly swear that I will well and truly perform the duties of flagman, in the establishment of corners and other duties, according to instructions given me and to the best of my skill and ability, in the survey of the Mining Claim of Aravaipa Mining Company, known as the Silver Bell, Mammoth, Chief, Keedy and Connection Lodes more fully described in the preceding affidavit.

Alvan W. Howe, Flagman.

Subscribed and sworn to by the said Alvan before me this 7<sup>th</sup> day of

July, 1892

H. G. Howe  
Notary Public.

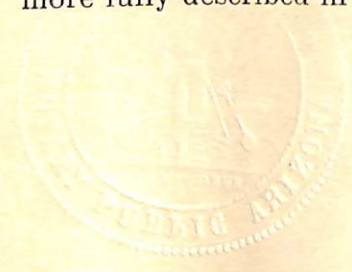
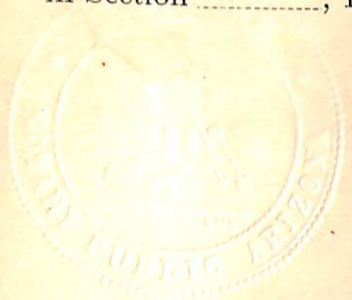



Feet.

## Survey No 1039.

## Silver Bell Lode.

Beginning at cor No. 1.

A pine post 4 in, sqr. 5 ft. long, in mound of stone, marked  $\frac{1}{1039}$ .The U.S.L.M. No. 1. bears  $367^{\circ}54'E$  3337 ft.  
And cor No. 1. ARIZONA LODE Survey No 1038.  
bears  $S 53^{\circ}02' W$  2773 ft.Thence  $S 71^{\circ}13'E$ Var  $12^{\circ}35'$  East.

1170. To wash drains south westerly.

1500. To cor. No. 2.

A pine post 4 in sqr. 5 ft. long. in mound of stones,  
marked  $\frac{2}{1039}$ .Thence  $S 27^{\circ}0' W$ .Var  $12^{\circ}35'$  East.

600. To cor. No. 3.

A pine post 4 in, sqr. 5 ft. long. in mound of stone,  
marked  $\frac{3}{1039}$ .Thence  $N 71^{\circ}13' W$ .Var  $12^{\circ}35'$  East.

530. To wash drains south westerly,

1500. To cor. No. 4.

A pine post 4 in, sqr. 5 ft. long. in mound of stones,  
marked  $\frac{4}{1039}$ .Thence  $N 27^{\circ}0' E$ Var  $12^{\circ}35'$  East.

300. To wash drains S.W.

600. To cor. No. 1. and place of beginning.

## Mammoth Chief Lode.

Beginning at cor No. 5.

A pine post. 4 in, sqr. 5 ft. long. in mound of stones,  
marked  $\frac{5}{1039}$ .

Identical with cor. No. 1. Silver Bell Lode.

Thence  $N 65^{\circ}26' W$ .Var  $12^{\circ}35'$  East.

20. To wash drains S.S.W.

Feet.  
1243.

To cor. Tr. 6.

Apine post 4 in. sq. 5 ft. long. in mound of stones,  
marked 6/1039.

Thence  $S 27^{\circ} 0' W$

Var  $12^{\circ} 35'$  East.

600. To cor. Tr. 7.

Apine post 4 in. sq. 5 ft. long. in mound of stone,  
marked 7/1039.

Thence  $S 65^{\circ} 26' E$

Var  $12^{\circ} 35'$  East.

130. Intersect line 17-18, Survey Tr. 1038, Thanks-  
giving lode,  $S 81^{\circ} 0' W$  25 ft. from cor. Tr. 18.

156. Intersect line 18-19, Thanksgiving lode  $S 9^{\circ} 08' E$   
7 ft. from cor. Tr. 18.

260. Intersect line 14-15, Keedy lode,  $S 62^{\circ} 08' E$ ,  
300 ft. from cor. Tr. 15.

752. Intersect. line 15-16, Keedy lode,  $S 27^{\circ} 52' E$ , 390 ft.  
from cor. Tr. 15.

1110. To wash drains S.W.

1248. To cor. Tr. 8.

Apine post 4 in. sq. 5 ft. long. in mound of stones  
marked 8/1039.

Identical with cor. Tr. 4, Silver Bell lode.

Thence  $N 27^{\circ} 0' E$

Var  $12^{\circ} 35'$  East.

300. To wash drains S.W.

600. To cor. Tr. 5. and place of beginning.

### Connection Lode.

Beginning at cor. Tr. 9.

Apine post 4 in. sq. 5 ft. long in mound of stones,  
marked 9/1039.

The cor. Tr. 1, Silver Bell lode bears  $N 12^{\circ} 19' W$   
2081 ft.

Thence  $N 38^{\circ} 10' W$ .

Var  $12^{\circ} 35'$  East.

1220. To cor. Tr. 10.

Apine post 4 in. sq. 5 ft. long. in mound of stones.  
marked 10/1039.

Identical with S.E. cor. Keedy lode.



Thence  $S 62^{\circ} 08' W$   
 Var  $12^{\circ} 35' East.$

600. To cor. Tro 11.  
 Apine post 4 in. sq. 5 ft. long in mound of stones,  
 marked  $11/1039.$   
 Identical with S.W. cor. Keedy lode.  
 Thence  $S 38^{\circ} 10' E.$   
 Var  $12^{\circ} 35' East.$

1220. To cor. Tro. 12.  
 Apine post 4 in. sq. 5 ft. long in mound of stones,  
 marked  $12/1039.$   
 Thence  $N 62^{\circ} 08' E$   
 Var  $12^{\circ} 35' East.$

600. To cor. Tro. 9. and place of beginning.

Keedy lode.  
 Beginning with cor. Tro. 13.  
 Apine post 4 in. sq. 5 ft. long in mound of stones,  
 marked  $13/1039.$   
 Identical with cor. Tro 11. Connection lode.  
 Thence  $N 26^{\circ} 01' W$   
 Var  $12^{\circ} 35' East.$

290. To wash drains south westerly.

684. Intersect line 18-19. Thanksgiving lode survey  
 No 1038.  $S 9^{\circ} 08' E$  675.8 ft. from cor. Tro. 18.

1285.7 To cor. Tro 14.  
 Apine post 4 in. sq. 5 ft. long in mound of stones,  
 marked  $14/1039.$   
 Thence  $N 62^{\circ} 08' E$   
 Var  $12^{\circ} 35' East.$

169.2 Intersect line 18-19. Thanksgiving lode.  $S 9^{\circ} 08' E$   
 93.5 ft. from cor. Tro. 18.

260. Intersect. line 7-8. Mammoth Chief lode.  
 $S 65^{\circ} 26' E$  260. ft. from cor. Tro. 7.

560. To cor Tro 15.  
 Apine post 4 in. sq. 5 ft. long in mound of stone  
 marked  $15/1039.$   
 Thence  $S 27^{\circ} 52' E$   
 Var  $12^{\circ} 35' East.$

390. Intersect line 7-8. Mammoth Chief lode.



700.  $S65^{\circ}26'E$  752. ft. from cor Tro. 7.  
 To wash drains. S.W.  
 1235. To cor Tro. 16.  
 A pine post 4 in. diam. 5 ft. long. in mound of stone,  
 marked  $\frac{16}{1039}$ .  
 Identical with cor. Tro. 10. Connection Code,  
 Thence  $S62^{\circ}08'W$   
 Var  $12^{\circ}35'$  East.  
 600. To cor. Tro 13. and place of beginning.

### Area.

Total Area Silver Bell lode	20,449 Acres
Total area Mammoth Chief lode	17,105 "
conflict with the Keedy lode <sup>(claimed)</sup>	1,342 acres
conflict with the Thanksgiving lode Survey Tro 1038 <sup>(claimed)</sup>	1,002 "
Net area	<del>15,761</del>
Total area Connection Code	16,533 Acres
Total area Keedy lode	16,444 "
Less conflicts with the Mammoth Chief lode	1,342 Acres
And the Thanksgiving lode Survey Tro 1038	1,069 .. 2,411
Net area	14,033 Acres.
Net Area Silver Bell lode,	20,449 Acres
Net area Mammoth Chief lode,	17,103 "
Net area Connection lode,	16,533 "
Net area Keedy lode	14,033 "
Net area of lode claim	68,118 "

### Location.

This group of claims are situated  
 in the S.W. Cor. T. 5.S.R. 20.E. Gila  
 and Salt River Meridian.  
 (Township unsurveyed)  
 In the Aravaipa mining district  
 Graham, County, Arizona.



Expenditure of five hundred dollars

I certify that the value of the labor and improvements upon this claim, placed thereon by claimant and its grantors, is not less than five hundred dollars, and that said improvements consist of,

Tunnel No. 1. (Discovery) of Silver Bell Lode, of 4x7 ft. 74 ft. long in rock. The face of, bears from Cor. No. 4, N 61° 40' E 315 ft.

Value of Tunnel \$1110.00

Tunnel No. 2. 4x7 ft. 50 ft. long in rock bears, from Cor. No. 4, N 62° 0' E 205 ft.

Value of Tunnel \$750.00

The discovery Shaft of the Mammoth Chief. Lode 4x6 ft. 12 ft. deep in rock bears from Cor. No. 5, N 86° 0' W 800 ft.

Value of Shaft. \$120.00

Shaft No. 2. 4x6 ft. 10 ft. deep in rock bears, from Cor. No. 5, S 84° 20' W 560 ft.

Value of Shaft. \$100.00

The discovery Tunnel Connection Lode 4x7 ft. 30 ft. long in rock, face of, bears from Cor. No. 11, S 62° 36' E 730 ft.

Value of Tunnel \$450.00

The discovery Tunnel Heedy Lode 4x7 ft. 132 ft. long in rock, bears from Cor. No. 13 N 14° 18' E 440 ft.

Value of Tunnel \$1980.00



*Instrument.*

The Survey was made with a  
young and Sons Mountain Transit.  
No 5585, with Smiths Solar attachment.

The courses were deflected from the  
true meridian as determined by  
solar observations.

The distances were measured  
with a 100ft steel tape.

A. G. Howe  
U.S. Deputy Mineral Surveyor.

Tombstone.

Sept 17<sup>th</sup> 92



# Affidavit of Five Hundred Dollars Improvements.



We, W. H. Moore and H. J. Firth

of lawful age, being first duly sworn according to law, depose and say: that we are acquainted with the

Silver Bell Mammoth Chief Keedy's Connection, <sup>Lode</sup> mining claims situated in Aravaipa Mining District, Graham County, Arizona Territory, for which Aravaipa Mining Company

John A. Blandy Atty.

has made application for survey prior to application for patent under the provisions of the Act of Congress, approved May 10, 1872; and that the labor done and improvements made thereon by the applicant and their grantors exceed Five Hundred Dollars in value, and further that we are not personally interested in said mine.

W. H. Moore  
H. J. Firth

TERRITORY OF ARIZONA,  
County of Graham } ss.

SWORN to and subscribed before me, this 18<sup>th</sup> day  
of July - - 1892

A. G. Howe  
Notary Public.





# FINAL OATHS FOR SURVEYS.

## LIST OF NAMES.

A list of the names of the individuals employed by H. G. Howe  
 United States Deputy Mineral Surveyor, to assist in running, measuring, and marking the lines  
 corners and boundaries described in the foregoing field notes of the survey of the mining claim  
 of Aravaipa Mining Company  
 known as the Silver Bell, Mammoth Chief, Keedy and Connection  
Lodes and showing the respective capacities in which they acted.

W. H. Moore, Chairman.  
 \_\_\_\_\_, Chairman.  
 \_\_\_\_\_, Assman.  
Alvan W. Howe, Flagman.

## FINAL OATHS OF ASSISTANTS.

We, W. H. Moore  
 and Alvan W. Howe, do solemnly swear that we assisted \_\_\_\_\_  
H. G. Howe, United States Deputy Mineral Surveyor, in marking the corners and  
 surveying the boundaries of the mining claim of Aravaipa Mining Company  
John A. Blandy Atty.  
 \_\_\_\_\_, known as the Silver Bell,  
Mammoth Chief, Keedy and Connection Lodes, represented  
 in the foregoing field notes as having been surveyed by said deputy mineral surveyor and under  
 his direction; and that said survey has been in all respects, to the best of our knowledge and  
 belief, faithfully and correctly executed, and the corner and boundary monuments established  
 according to law and the instructions furnished by the United States Surveyor-General for  
Arizona.

W. H. Moore, Chairman.  
 \_\_\_\_\_, Chairman.  
 \_\_\_\_\_, Assman.  
Alvan W. Howe, Flagman.

Subscribed and sworn to by the above-named persons before me  
 this 18th day of July, 1892.

H. G. Howe  
 Notary Public.



(4-686.)

FINAL OATH OF U. S. DEPUTY MINERAL SURVEYOR.

I, H. G. Howe, U. S. Deputy Mineral Surveyor, do solemnly swear that, in pursuance of instructions received from the United States Surveyor General for Arizona, dated June 11<sup>th</sup>, 1892, I have, in strict conformity to the laws of the United States, the official regulations and instructions thereunder, and the instructions of said Surveyor General, faithfully and correctly executed the survey of the Mining Claim of Aravaipa Mining Company.

John F. Blandy Atty -, known as the Silver Bell, Mammoth Chief Keedy 2<sup>nd</sup> Connection, <sup>lodes</sup> situate in Aravaipa Mining District, Graham County, Arizona, in Section \_\_\_\_\_, Township No. \_\_\_\_\_, Range No. \_\_\_\_\_

and designated as Survey No. 1039, as represented in the foregoing field notes, which accurately show the boundaries of said mining claim as distinctly marked by monuments on the ground, and described in the attached copy of the location certificate, which was received by me from the Surveyor General with said instructions, and that all the corners of said survey have been established and perpetuated in strict accordance with the law, official regulations and instructions thereunder; and I do further solemnly swear that the foregoing are the true and original field notes of said survey and my report therein, and that the labor expended and improvements made upon said mining claim by claimant or their grantors are as therein fully stated, and that the character, extent, location and itemized value thereof are specified therein with particularity and full detail, and that no portion of said labor or improvements so credited to this claim has been included in the estimate of expenditures upon any other claim.

H. G. Howe

U. S. Deputy Mineral Surveyor.

Subscribed and sworn to by the said

L. G. Howe

U. S. Deputy Mineral Surveyor, before me

James Reilly

a Notary Public

this

17<sup>th</sup>

day of

August

1892.

James Reilly  
Notary Public

0 0-164



NOTICE OF LOCATION

Notice is hereby given that the undersigned in compliance with the requirements of the Mining Act of Congress approved May 10th, 1872 has this day located and claim 1500 linear feet along the course of this lead, lode or vein of mineral bearing quartz with 300 feet in width on each side of the middle of said lead, lode or vein. Situate in the Aravaipa Mining District, County of Graham, Arizona and more particularly described as follows to-wit:

Commencing at this mon. of stones being the center of the Northerly end of claim, and upon which this notice is posted, thence Easterly 300 feet to a mon. of stones thence Southerly 1500 feet to a mon. of stones, thence Westerly 300 feet to a mon. of stones, being the center of the Southerly end of claim, thence Westerly 300 feet to a mon. of stones, thence Northerly 1500 feet to a mon. of stones, thence Easterly 300 feet to the place of beginning. This claim is about one mile Northerly from Box Canon and the old Buford Smelters, and is the South extension of the Sand Carbonate Mine and has heretofore been known as the Forest Girl and shall hereafter be known as the Silver Bell Mine.

Located Jan. 1st, 1889.

Witness Charles L. White.)

John P. Han. Locator

1889 at 9 o'clock A.M.

Recorded at request of Howard Dunlap Jan. 10th

Eduardo Soto

Co. Recorder.

By Ben. M. Crawford Deputy.

Territory of Arizona

County of Graham.

ss

I, H. J. Dowdle, County Recorder in and for Graham County Arizona do hereby certify that the above and foregoing is a full true and correct copy of the Silver Bell Mine as the same appears of Record in my office in Book 6, Page 20, Record of Mines. In witness whereof I have hereunto set my hand and affixed my official seal at Solomonville Graham County Arizona. On this 7th, day of May 1892.

H. J. Dowdle

County Recorder

Graham County Arizona Territory

*Records Seal*



Notice is hereby given that the undersigned in compliance with the requirements of the Mining Act of Congress approved May 10-th, 1872 has this day located and claim fifteen hundred linear feet along the course of this lead, lode or vein of mineral bearing quartz and 300 feet in width on each side of the middle of said lead, lode or vein situate in the Aravaipa Mining District County of Graham Arizona and more particularly described as follows to-wit:  
 Commencing at this monument of stones, being the center of the South-erly end of the claim and upon which this notice is posted, Thence North-easterly 300 feet to a monument of stones, thence North-westerly 1500 feet to a monument of stones, thence South-westerly 300 to a monument of stones being the center of the North-westerly end of claim, Thence South-westerly 300 feet to a monument of stones, thence South-easterly 1500 feet to a monument of stones, thence North-easterly 300 feet to place of beginning, and shall be known as the Mamoth Chief Mine. Located Jan. 1-st, 1890.

John P. Han Locator.

Witnesses

Chas. Cunningham }  
 Howard Dunlap. }

Recorded at 2 P.M. Jan. 6-th, 1890 request

of Howard Dunlap.

E. Soto

County Recorder.

By Fred M. Newell Deputy.

Territory of Arizona }  
 County of Graham } ss

I, H.J. Dowdle, County Recorder in and for said County & Territory do hereby certify that the foregoing is a full true & correct copy of the Mamoth Chief Mine as appears of record in my office in Book 6 Pages 270 & 271 Records of Mines.

In witness whereof I have hereunto set my hand and affixed my official seal at Solomonville Arizona, this 7-th day of May 1892.

H.J. Dowdle

County Recorder.

*Recorder's Seal*



NOTICE OF LOCATION

Notice is hereby given that the undersigned in compliance with the requirements of the Mining Act of Congress approved May 10-th, 1872 have this day located and claims fifteen hundred linear feet along the course of this of this lead, lode or vein of mineral bearing quartz and three hundred feet in width on each side of the middle of said lead, lode or vein Situate in the Aravaipa Mining District County of Graham T. of Arizona and more particularly described as follows to-wit Commencing at this monument of stones being the center of the South-eastern end of claim and upon which this notice is posted, thence South-westerly three hundred feet to a monument of stones, Thence North-westerly fifteen hundred feet to a monument of stones, Thence North-easterly three hundred feet to a monument of stones, being the center of the North-westerly end of claim, Thence North<sup>n</sup>-easterly three hundred feet to a monument of stones, thence South-easterly fifteen hundred feet to a monument of stones, Thence Southwesterly three hundred feet to the place of beginning. This claim joins the Thanksgiving Mine on the Eastern side and shall be known as the Kedy Mine.

Located by Aravaipa Mining Company  
Geo. N. Adams

Supt.

Located Feb'y 11-th, 1891.  
Witness N.P. McCallum

Recorded at the request of Chas. M. Renaud Feb'y. 20-th, 1891 at 1, P.M.  
H. J. Dowdle

County Recorder.

Territory of Arizona }  
County of Graham } ss

I, H. J. Dowdle, County Recorder in and for said County do hereby certify that the foregoing is a full true and correct copy of the Kedy Mine as appears of record in my office in Book 7 Page 62 Records of Mines.

In witness whereof I have hereunto set my hand & affixed my official seal at Solomonville, Arizona Territory on this 7-th, day of May 1892.

H. J. Dowdle

County Recorder.

*Recorded  
Duc*



NOTICE OF LOCATION

Notice is hereby given that the undersigned in compliance with the requirements of the Mining Act of Congress approved May 10-th, 1872 has this day located and claim fifteen hundred linear feet along the course of this lead lode or vein of mineral bearing quartz and three hundred feet in width on each side of the middle of said lead lode or vein situate in the Aravaipa Mining District County of Graham Ter. of Arizona and more particularly described as follows to-wit:

Commencing at this monument of stones being the center of the South end of the claim and upon which this notice is posted thence Easterly three hundred feet to a monument of stones thence Northerly fifteen hundred feet to a monument of stones thence Westerly ~~thirteen~~ three hundred feet to a monument of stones being the center of the North end of claim thence Westerly ~~thirteen~~ three hundred feet to a monument of stones thence Southerly fifteen hundred feet to a monument of stones thence Easterly three hundred feet to the place of beginning.

This claim is the Northern extension of the No Name Mine and joins the Silver Bell Mine on the South-western side and shall be known as the Connection Mine.

Located December 12, 1890.  
Located by Aravaipa Mining Co.  
Geo. N. Adams Supt.

Witness

N. P. McCallum

Recorded at request of C. M. Renard Dec. 15 1890

at 2 P. M.

E. Soto Recorder

by Fred M. Newell

Deputy

Territory of Arizona }  
County of Graham } ss

I H. J. Dawdle County Recorder in and for the County of Graham do hereby certify, that the above and foregoing is a full true and correct copy of the Connection Mine as the same appears of Record in my office, in Book 6, Pages 417 & 418 Record of Mines. In witness whereof I hereunto set my hand and affixed my official seal, at Solomonville, This the 7-th, day of May 1890.

H. J. Dawdle

County Recorder.

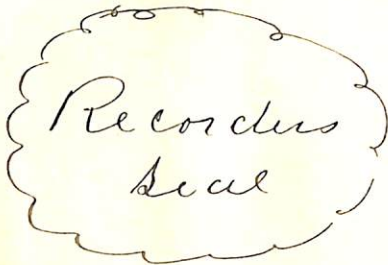



MINERAL SURVEY No. 1039.  
 GILA LAND DISTRICT.  
 ARAYAIPA MINING DISTRICT.  
 ARIZONA

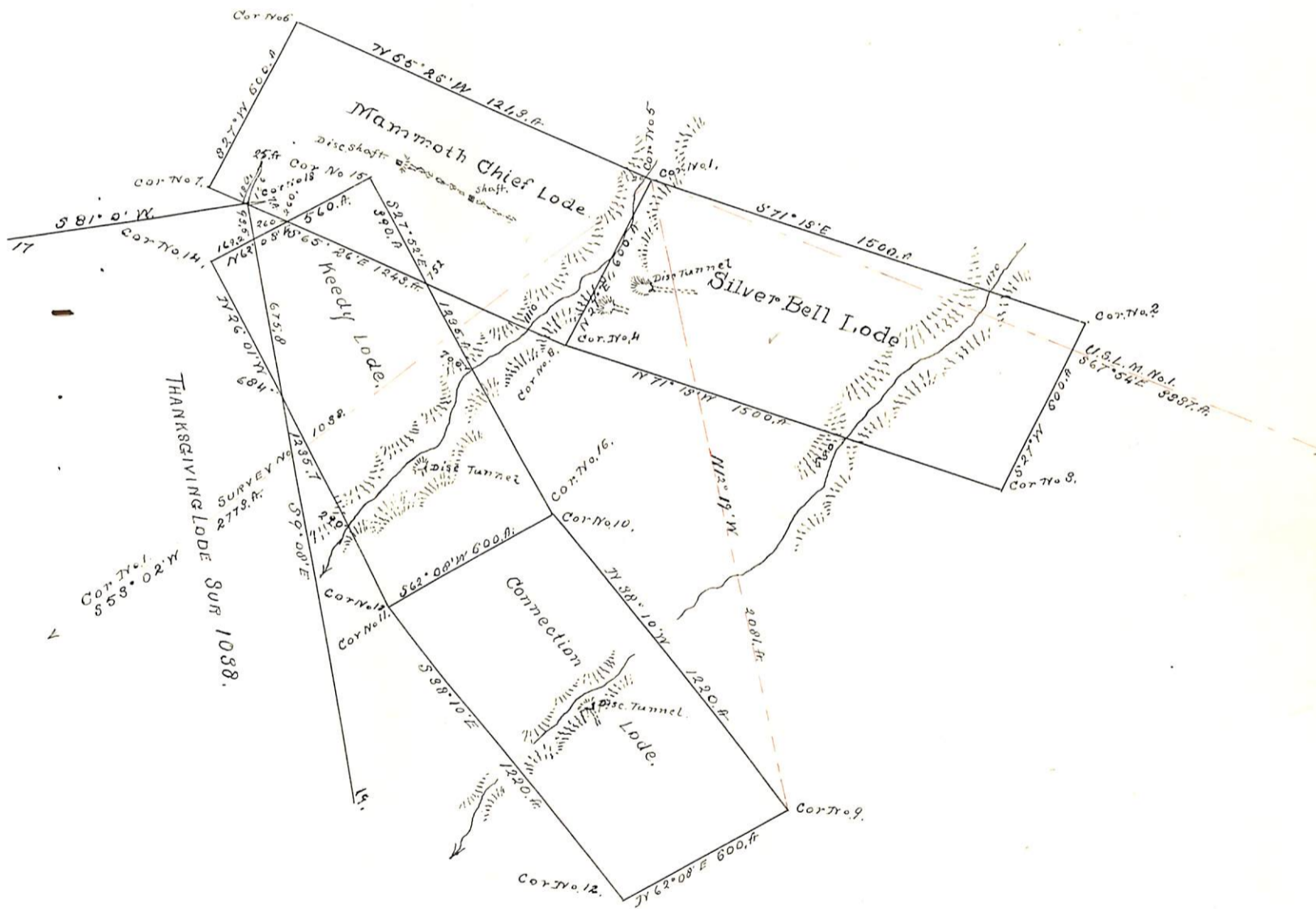

SURVEYED JULY 7-11, 1892.

By H. G. Howe.

U.S. Dep. MIN. SURVEYOR.

Scale 500 ft = 1 inch.



(4-687.)

# Surveyor General's Certificate of Approval of Field Notes and Survey of Mining Claim.

Department of the Interior,

Office of U. S. Surveyor General,

Tucson, Arizona

October 02<sup>th</sup>, 1892

I, U. S. Surveyor General for

District of Arizona,

do hereby certify that the foregoing and hereto attached Field Notes and Return of the

Survey of the Mining Claim of

Aravaipa Mining Company

, known as the

"Silver Bell" Mammoth Chief" Keedy" and "Connecticut" Lodes

situate in Aravaipa mining district,

Graham County, Arizona,

in Section \_\_\_\_\_, Township No. \_\_\_\_\_, Range No. \_\_\_\_\_

and \_\_\_\_\_, designated as Survey No. 1039

executed by H. G. Howe, U. S. Deputy Mineral

Surveyor, July 7<sup>th</sup> to 11<sup>th</sup>, 1892, under my instructions dated

June 11<sup>th</sup>, 1892, have been critically examined and the

necessary corrections and explanations made, and the said Field Notes and Return, and

the Survey they describe, are hereby approved. A true copy of the copy of the location

certificate filed by the applicant for survey is included in the field notes. \_\_\_\_\_

Raphael Johnson  
U. S. Surveyor General for Arizona

o 6-1r2