

MS

01065

(4-683.)

Mineral Survey No. 1065

Lot No. _____

Gila

Land District.

FIELD NOTES

OF THE SURVEY OF THE MINING CLAIM OF

L Gardner and J. W. Howell

Ben Williams Agent.

KNOWN AS THE

Harrison

Warren

Mining District,

Cochise

County,

Arizona

Section _____, Township _____, Range _____

Surveyed under instructions dated August 20th, 1892

by H. C. Howe,

U. S. Deputy Mineral Surveyor.

Claim located January 18th, 1889.

Survey commenced Sept 3rd, 1892

Survey completed Sept 7th, 1892

o 6-160

Address of claimant,

Bisbee,

Cochise County

Arizona.

Handwritten initials

PRELIMINARY OATHS OF ASSISTANTS IN SURVEY OF MINING CLAIM.

WE, F. J. Bailey and R. S. Hunt,
do solemnly swear that we will well and faithfully execute the duties of chain carriers;
that we will level the chain upon even and uneven ground and plumb the tally-pins,
either by sticking or dropping the same; that we will report the true distance to all
notable objects, and the true length of all lines that we assist in measuring, to the best
of our skill and ability, and in accordance with instructions given us, in the survey of
the Mining Claim of L Gardner and J. W. Howell
Ben Williams Agent;, known as the
Harrison,
situate in Warren, mining district,
Cochise County, Arizona,
in Section _____, Township No. _____, Range No. _____.

F. J. Bailey, Chainman.
R. S. Hunt, Chainman.

Subscribed and sworn to by the above-named persons before
me this 3rd day of Sept, 1892

A. C. Perrin
Notary Public

I, _____, do solemnly swear that I will well and
truly perform the duties of axeman, in the establishment of corners and other duties,
according to instructions given me and to the best of my skill and ability, in the survey
of the Mining Claim of _____

known as the _____,
more fully described in the preceding affidavit.

_____, Axeman.

Subscribed and sworn to by the said _____
_____ before me this _____ day of
_____, 18 _____.

I, _____, do solemnly swear that I will
well and truly perform the duties of flagman, in the establishment of corners and other
duties, according to instructions given me and to the best of my skill and ability, in the
survey of the Mining Claim of _____

known as the _____,
more fully described in the preceding affidavit.

_____, Flagman.

Subscribed and sworn to by the said _____
_____ before me this _____ day of
_____, 18 _____.

- Feet. Survey No 1065,
Harrison Lode,
Beginning at cor. No. 1.
Identical with location cor which is
also the S.E. cor. Sacramento Lode,
Apine post 4ft. long 4 in. sqr. 6 ins in ground
in mound of stone, marked N.W. Face,
2/1062, S. Lode, and S.W. Face 1/1065, H. Lode.
Thence $N 64^{\circ} 47' W$
var $11^{\circ} 40' East$.
- 1195.7 To cor. No. 2,
Identical with location cor, which is also
the S.W. cor. Sacramento, and S.E. cor. Frank
Coppwell, lodes,
Apine post 4ft. long 4 ins. sqr. 6 ins in ground in
mound of stone, marked N.W. Face 4/1048,
F.C. Lode, and N.E. Face 1/1062, S. Lode, and
S. Face 2/1065, H. Lode,
From which U.S.L.M. No. 4, bears $S 73^{\circ} 08' E$
 $893.3 ft$.
Thence $N 78^{\circ} 32' W$
var $11^{\circ} 40' East$.
164. To cor. No. 3,
Apine post 4ft. long 4 in. sqr. 6 ins in ground
in mound of stone, marked 3/1065, H.
Lode,
From which original cor. bears $N 78^{\circ} 32' W$
 $6.3 ft$. built upon crossings,
Thence $S 27^{\circ} 02' W$.
var $11^{\circ} 40' East$.
- 4.2 To cor. No. 4,
Apine post 4ft. long 4 ins sqr. 6 ins in ground,
in mound of stone, marked 4/1065, H. Lode,
From which original location cor.
on crossings bears $N 41^{\circ} 12' W$ 6.4 ft.
Thence $S 41^{\circ} 12' E$
var $11^{\circ} 40' East$.
- 858.4 To cor. No. 5,
Identical with location mon, which is
also a cor. of Neptune and Space lodes,

Fets. Apine post 5ft. long 4 in. sq. 1ft in ground
in mound of stone, marked West Face
N.M.M.C. No. 6, and East Face S.M.M.C. No. 2. and
North face, 5/1065 H. Lode.

Thence $539^{\circ} 35' E$

var $11^{\circ} 40' East$.

8145 To cor. No. 6.

Identical with location mon which is
also a cor. of the Space and Gardner lodes,
Apine post 5ft. long 4 in. sq. 6ft in ground
in mound of stones, marked West Face
S.M.M.C. No. 3, and East Face G.M.M.C. No. 2,
and North Face 6/1065, H. Lode,

Thence $556^{\circ} 56' E$

var $11^{\circ} 40' East$.

484. To cor. No. 7.

Identical with location cor. which is
also the S.W. cor. Ophir.

Apine post 4ft. long 4 in. sq. 6 in. in ground
in mound of stone marked NE Face
1/1068, O. Lode and N.W. Face 7/1065, H. Lode

Thence $7427^{\circ} 02' E$

var $11^{\circ} 40' East$.

188. To old location mon.

488. To cor. Tra. 1. and place of beginning.

Area.

Total area Harrison Lode 13.355 Acres. ✓

Location

This claim is located in Warren
Mining District Cochise County,
Arizona, about $\frac{3}{4}$ of a mile south
east of Bisbee,

And is bounded upon the North by
the Sacramento and Frank Cogswell
Lodes, South by the Neptune,

Space, and Gardner lodes and East
by the Ophir Lode,

Expenditure of Five Hundred Dollars.
 Certify that the value of the labor
 and improvements upon this
 claim, placed thereon by the
 claimant and its grantors, is
 not less than five hundred dol-
 -lars and that said improve-
 ments consist of.

Discovery cut 4ft wide 12ft deep and
 25ft. long, which bears from cor. Tr. 7.
 N 29° 50' W 550. ft.

value of cut \$300.-

A Tunnel 4ft. x 7ft. 90ft. long, with
 winze 4x4ft. 20ft. deep, the face of
 bears from cor. Tr. 7. N 11° 0' W 487. ft.

value of Tunnel \$1760.

Instrument.

The survey was made with a Young
 & Sons' mountain Transit No. 5585,
 with Smith's solar attachment.
 The courses were deflected from
 the true meridian as determined
 by solar observations.

The distances were measured
 with a 100ft steel tape.

See Note.

H. L. Howe.

U. S. Deputy Mineral Surveyor.

Beisee Oct 5th / 96.

Note:-

In running line 5 to 6. I find that this Post
 when set was set 5ft too far down the side hill,
 giving a difference of 20' from the official
 notes of the Space official Survey:-

Affidavit of Five Hundred Dollars Improvements.

We, F. J. Bailey and R. S. Hunt,
 of lawful age, being first duly sworn according to law, depose and say: that we are acquainted with the
Harrison mining claim, situated in
Warren Mining District, Cochise County,
 Arizona Territory, for which L. Gardner and J. W. Howell
by Ben Williams Agent.
 have made application for survey prior to application for patent under the provisions of the Act of
 Congress, approved May 10, 1872; and that the labor done and improvements made thereon by the
 applicants and their grantors exceed Five Hundred Dollars in value, and further that we are not
 personally interested in said mine.

F. J. Bailey
R. S. Hunt

TERRITORY OF ARIZONA,
 County of Santa Cruz } ss.

SWORN to and subscribed before me, this 10th day
 of September 1892

A. C. Penin
 Notary Public



FINAL OATHS FOR SURVEYS.

LIST OF NAMES.

A list of the names of the individuals employed by A. C. Howe
 United States Deputy Mineral Surveyor, to assist in running, measuring, and marking the lines
 corners and boundaries described in the foregoing field notes of the survey of the mining claim
 of L Gardner and J. W. Howell, Ben Williams Agent.
 known as the Harrison.
 and showing the respective capacities in which they acted.

F. J. Bailey. , Chainman.
R. S. Hunt. , Chainman.
 , Axman.
 , Flagman.

FINAL OATHS OF ASSISTANTS.

We, F. J. Bailey and R. S. Hunt
 and L Gardner and J. W. Howell, do solemnly swear that we assisted Ben Williams Agent.
A. C. Howe, United States Deputy Mineral Surveyor, in marking the corners and
 surveying the boundaries of the mining claim of L Gardner and J. W. Howell
Ben Williams Agent.
 known as the Harrison., represented
 in the foregoing field notes as having been surveyed by said deputy mineral surveyor and under
 his direction; and that said survey has been in all respects, to the best of our knowledge and
 belief, faithfully and correctly executed, and the corner and boundary monuments established
 according to law and the instructions furnished by the United States Surveyor-General for
Arizona.

F. J. Bailey , Chainman.
R. S. Hunt , Chainman.
 , Axman
 , Flagman.

Subscribed and sworn to by the above-named persons before me
 this 10th day of September, 18 92

S. C. Perin
Notary Public



(4-686.)

FINAL OATH OF U. S. DEPUTY MINERAL SURVEYOR.

I, H. G. Howe, U. S. Deputy Mineral Surveyor, do solemnly swear that, in pursuance of instructions received from the United States Surveyor General for Arizona, dated August 20th, 1892, I have, in strict conformity to the laws of the United States, the official regulations and instructions thereunder, and the instructions of said Surveyor General, faithfully and correctly executed the survey of the Mining Claim of L Gardner and J. W. Howell, known as the Ben Williams Agent, Harrison, situate in Warren Mining District, Cochise County, Arizona, in Section _____, Township No. _____, Range No. _____, and designated as Survey No. 1065, as represented in the foregoing field notes, which accurately show the boundaries of said mining claim as distinctly marked by monuments on the ground, and described in the attached copy of the location certificate, which was received by me from the Surveyor General with said instructions, and that all the corners of said survey have been established and perpetuated in strict accordance with the law, official regulations and instructions thereunder; and I do further solemnly swear that the foregoing are the true and original field notes of said survey and my report therein, and that the labor expended and improvements made upon said mining claim by claimant or their grantors are as therein fully stated, and that the character, extent, location and itemized value thereof are specified therein with particularity and full detail, and that no portion of said labor or improvements so credited to this claim has been included in the estimate of expenditures upon any other claim.

H. G. Howe
 U. S. Deputy Mineral Surveyor.

Subscribed and sworn to by the said M. G. Yerger
 U. S. Deputy Mineral Surveyor, before me S. C. Pennic
Notary Public this 14th
 day of September, 1892

S. C. Pennic
Notary Public

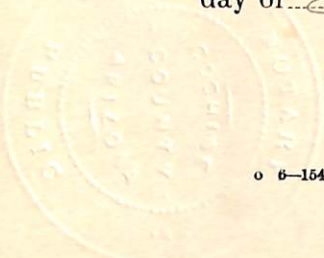

M.S. No 1065.

LOCATION NOTICE

Notice is hereby given, that the undersigned, in compliance with the requirements of the Mining Act of Congress, approved May 10-th, 1872, have this day located and claim Fifteen hundred linear feet along the course of this lead, lode or vein of mineral bearing quartz, and Three hundred feet ^{in width} on each side of the middle of said lead, lode or vein, situated in the Warren Mining District, County of Cochise Arizona, and more particularly described as follows, to-wit:

Commencing at this monument of stones; being the centre of the South east end of claim, and upon which this notice is posted, thence North easterly 300 feet to a monument of stones; thence North westerly 1500 feet to a monument of stones; thence South westerly 300 feet to a monument of stones; being the center of the North west end of claim; thence South westerly 300 feet to a monument of stones; thence South easterly 1500 feet to a monument of stones; thence North easterly 300 feet to the place of beginning.

This claim is situated about three quarters of a mile South East of Bisbee, & lies between the claims known as the Gardner & the Sacramento, and shall be known as the Harrison Mine.

Located January 18-th 1889.

Witness

J.W.Howell

A.L.Gattrell

L.Gardner

Filed and recorded at request of A.L.Brooks, January 21-st A.D. 1889, at 9 A.M.

W.F.Bradley

County Recorder

Territory of Arizona)
County of Cochise) ss

I, W.F.Bradley, County Recorder in and for the County of Cochise, do hereby certify that the above and foregoing is a full, true and correct copy of the Harrison Mining Location, Warren Mining District, Arizona, as appears of record now in my office in Book 11, Page 617, Record of Mines.

In witness whereof, I have hereunto set my hand and affixed my official seal, at my office, in Tombstone, this 9-th day of January, A.D. 1891.

W.F.Bradley

(SEAL)

County Recorder.

SURVEY No 1065.
GILA LAND DISTRICT

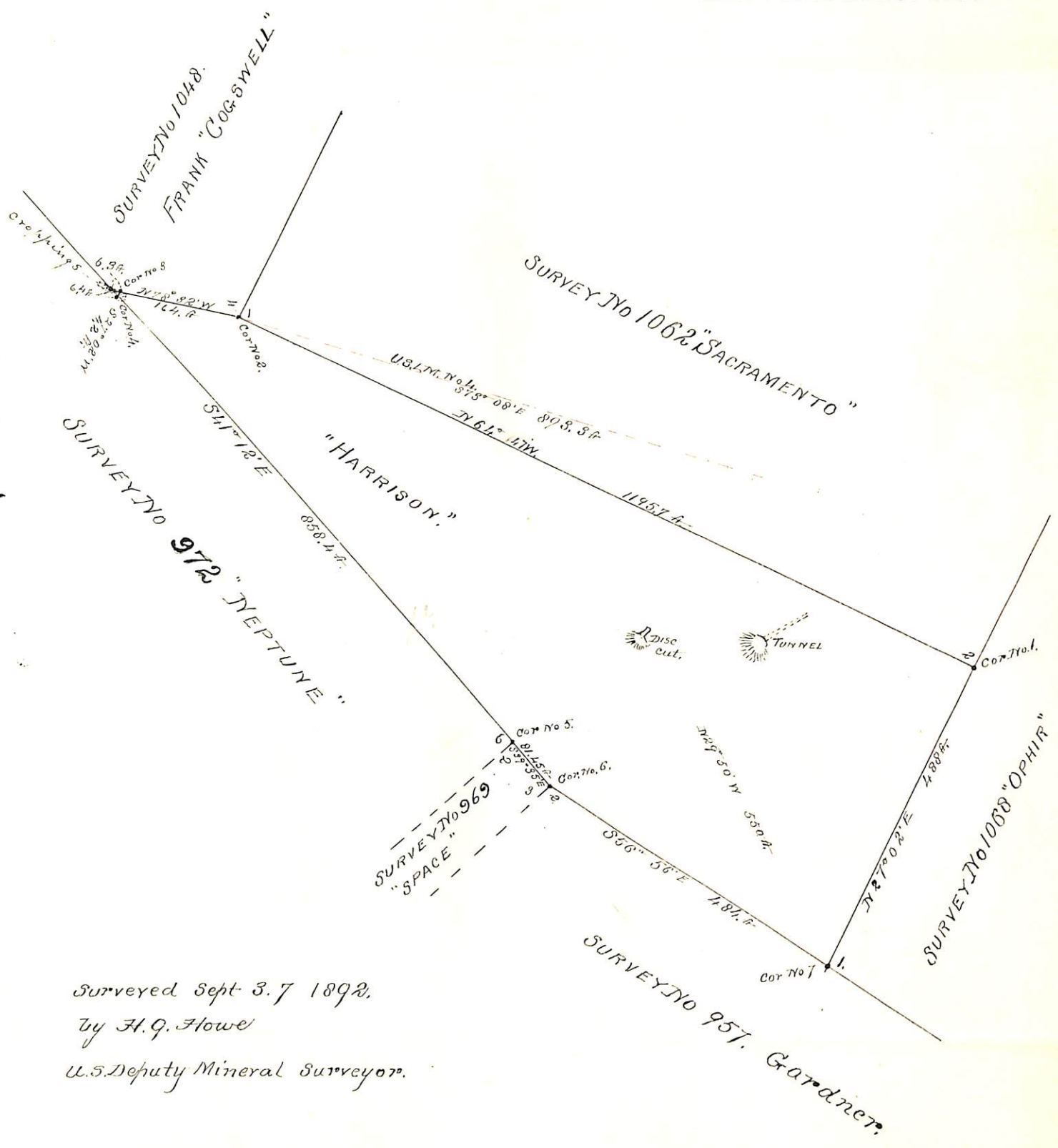

Surveyed Sept 3. 7 1892.
by H. G. Howe
U.S. Deputy Mineral Surveyor.

(4-687.)

Surveyor General's Certificate of Approval of Field Notes and Survey of Mining Claim.

Department of the Interior,

Office of U. S. Surveyor General,

Tucson, Arizona

December 29, 1892

I, U. S. Surveyor General for

District of Arizona,

do hereby certify that the foregoing and hereto attached Field Notes and Return of the Survey of the Mining Claim of

L. Gardner and
J. W. Howell

_____ known as the

"Harrison"

situate in

Warren

_____ mining district,

Coconino _____ County, Arizona _____

in Section _____, Township No. _____, Range No. _____

and _____, designated as Survey No. 1065.

executed by

H. G. Howe

_____ U. S. Deputy Mineral

Surveyor, Sept 3rd to 7th, 1892, under my instructions dated

August 20th, 1892, have been critically examined and the

necessary corrections and explanations made, and the said Field Notes and Return, and

the Survey they describe, are hereby approved. A true copy of the copy of the location

certificate filed by the applicant for survey is included in the field notes. _____

Russell Johnson
Arizona

U. S. Surveyor General for

o 6-1c2