

MS -

0

1

1

9

0



(4-683.)

Mineral Survey No. 1190

Lot No. \_\_\_\_\_

Prescott

Land District.

### FIELD NOTES

OF THE SURVEY OF THE MINING CLAIM OF

The Congress Gold Company

KNOWN AS THE

Ohio

Martinez

Mining District,

Yavapai

County,

Arizona

Section \_\_\_\_\_, Township 10 N, Range 6 W

Surveyed under instructions dated Sept. 25, 1895

by J. J. Fisher,

U. S. Deputy Mineral Surveyor.

Claim located January 1<sup>st</sup>, 1892

Survey commenced Oct 8<sup>th</sup>, 1895.

Survey completed Oct 9<sup>th</sup>, 1895.

o 6-160

Address.

J. C. Martin  
Attorney for Company  
Prescott Ariz.



# PRELIMINARY OATHS OF ASSISTANTS IN SURVEY OF MINING CLAIM.

WE, Richard Babo and Ford Hickey,  
do solemnly swear that we will well and faithfully execute the duties of chain carriers;  
that we will level the chain upon even and uneven ground and plumb the tally-pins,  
either by sticking or dropping the same; that we will report the true distance to all  
notable objects, and the true length of all lines that we assist in measuring, to the best  
of our skill and ability, and in accordance with instructions given us, in the survey of  
the Mining Claim of The Congress Gold Company  
....., known as the  
Ohio  
situate in Martinez mining district,  
Yavapai County, Arizona Territory,  
in Section \_\_\_\_\_, Township No. \_\_\_\_\_, Range No. \_\_\_\_\_.

Richard Babo, Chainman.  
Ford Hickey, Chainman.

Subscribed and sworn to by the above-named persons before  
me this 7<sup>th</sup> day of October, 1895.

A. N. Gage, Notary Public

I, Richard Babo, do solemnly swear that I will well and  
truly perform the duties of axeman, in the establishment of corners and other duties,  
according to instructions given me and to the best of my skill and ability, in the survey  
of the Mining Claim of The Congress Gold Company  
.....  
known as the Ohio,  
more fully described in the preceding affidavit.

Richard Babo, Axeman.

Subscribed and sworn to by the said Richard Babo  
before me this 7<sup>th</sup> day of  
October, 1895.

A. N. Gage, Notary Public

I, Ford Hickey, do solemnly swear that I will  
well and truly perform the duties of flagman, in the establishment of corners and other  
duties, according to instructions given me and to the best of my skill and ability, in the  
survey of the Mining Claim of The Congress Gold Company  
.....  
known as the Ohio,  
more fully described in the preceding affidavit.

Ford Hickey, Flagman.

Subscribed and sworn to by the said Ford Hickey  
before me this 7<sup>th</sup> day of  
October, 1895.

A. N. Gage, Notary Public



# Survey No 1190

## Ohio Lode

Beginning at Initial mon. at east  
center end of claim.

A pine post 4" x 4" x 5' long set in ground  
and surrounded by mon. of stones,  
post marked J.M. Ohio. M.C. No 1-1190  
A + on granite rock in place, marked  
B.R. J.M. O.M.C. No 1-1190 <sup>true</sup> N 3° 18' W 62 ft.

Thence N 16° 36' E

Var. 14° 20' E

300 To O.M.C. No 2. Identical with loc.  
A pine post 4" x 4" x 5' long, set in ground  
and surrounded by mon. of stones.  
post marked O.M.C. No 2-1190, same  
post marked R.L. M.C. No 6-1192.  
A + on granite rock in place, marked O.M.C. No 2-1190. B.R.  
bears S 55° 10' E 45'

Thence N 75° 15' W

Var. 14° 20' E

Along the south side line of Rich Quartz  
396 To Congress Gulch, course N. and S.  
910 To wagon road, course N. and S.  
1500 To O.M.C. No 3. Identical with loc.  
A pine post 4" x 4" x 5' long, set in ground  
and surrounded by mon. of stones.  
post marked O.M.C. No 3-1190, same  
post marked R.L. M.C. No 5-1192  
A granite rock in place, marked B.R.  
O.M.C. No 3-1190 bears N 24° 37' W 163 feet  
U.S. M.M. No 1-M.D. bears N 20° 06' W  
3306.2 feet.

Thence S 16° 36' W

Var. 14° 20' E

300 To O.M.C. No 4, Identical with loc.  
A pine post 4" x 4" x 5' long, set in ground  
and surrounded by mon. of stone, post  
marked O.M.C. No. 4-1190.



# Survey No 1190

Feet

## Ohio Lode

600 A + on granite rock in place, marked  
B.R.O.M.C. No 4-1190 bears S 50° E 45 feet.  
Same course to O.M.C. No 5. Identical  
with location.

A pine post 4" x 4" x 5' long, set in ground  
and surrounded by mon. of stones, post  
marked O.M.C. No 5-1190, same post  
marked G.E.M.C. No 3.-1191-

A + on granite rock in place, marked  
O.M.C. No 5-1190 bears N 0° 12' W 111 feet.

Thence S 75° 15' E

Var. 14° 20' E

600 To wagon road, course N. and S.

88.8 To Congress Gulch, course N. and S.

1500 To O.M.C. No 6. Identical with loc.

A pine post 4" x 4" x 5' long, set in ground  
and surrounded by mon. of stones, post  
marked O.M.C. No 6-1190.

A + on granite rock in place, marked  
B.R.O.M.C. No 6-1190 bears S 70° 10' W 17 feet.

Thence N 16° 36' E

Var. 14° 20' E

300 To J.M.O.M.C. No 1-1190. The place of  
beginning survey of exterior boundaries.

Area

containing

20.65+ acres

## Location

This claim is located on unswayed  
land in Martinez Mining District  
Yavapai County, Arizona Territory.



5

Survey No 1190  
Ohio Lode

Expenditure of Five Hundred Dollars

I certify that the value of the labor and improvements upon this claim, placed thereon by the claimant and its grantors is not less than five hundred dollars, and that said improvements consist of.

A discovery shaft 5' x 7' feet, 60 feet deep, in rock, timbered, which bears from O.M.C. No 2-1190 S 70° 41' W 536 feet

Value \$600.00

Instrument

The survey was made with a Gurley solar transit. The courses were deflected from the true meridian as determined by solar observations. The distances were measured with a 100 foot steel chain.

Pennock Oct 17-1895

J. J. Fisher  
U.S. Dep. Min. Surveyor.



# FINAL OATHS FOR SURVEYS.

## LIST OF NAMES.

A list of the names of the individuals employed by J. J. Fisher  
 United States Deputy Mineral Surveyor, to assist in running, measuring, and marking the lines  
 corners and boundaries described in the foregoing field notes of the survey of the mining claim  
 of The Congress Gold Company  
 known as the Ohio  
 and showing the respective capacities in which they acted.

Richard Babb, Chainman.  
Jrd. Hickey, Chainman.  
Richard Babb, Axman.  
Jrd. Hickey, Flagman.

## FINAL OATHS OF ASSISTANTS.

We, Richard Babb  
 and Jrd. Hickey, do solemnly swear that we assisted J. J. Fisher  
Fisher, United States Deputy Mineral Surveyor, in marking the corners and  
 surveying the boundaries of the mining claim of The Congress Gold Company  
Ohio, known as the Ohio, represented  
 in the foregoing field notes as having been surveyed by said deputy mineral surveyor and under  
 his direction; and that said survey has been in all respects, to the best of our knowledge and  
 belief, faithfully and correctly executed, and the corner and boundary monuments established  
 according to law and the instructions furnished by the United States Surveyor-General for  
Arizona.

Richard Babb, Chainman.  
Jrd. Hickey, Chainman.  
Richard Babb, Axman.  
Jrd. Hickey, Flagman.

Subscribed and sworn to by the above-named persons before me  
 this 11<sup>th</sup> day of October, 1895.

A. N. Gage  
 Notary Public.



FINAL OATH OF U. S. DEPUTY MINERAL SURVEYOR.

I, J. J. Fisher, U. S. Deputy Mineral Surveyor, do solemnly swear that, in pursuance of instructions received from the United States Surveyor General for Arizona, dated Sept. 25<sup>th</sup>, 1895, I have, in strict conformity to the laws of the United States, the official regulations and instructions thereunder, and the instructions of said Surveyor General, faithfully and correctly executed the survey of the Mining Claim of The Congress Gold Company, known as the Ohio, situate in Martinez Mining District, Yavapai County, Arizona, in Section \_\_\_\_\_, Township No. \_\_\_\_\_, Range No. \_\_\_\_\_, and designated as Survey No. 1190, as represented in the foregoing field notes, which accurately show the boundaries of said mining claim as distinctly marked by monuments on the ground, and described in the attached copy of the location certificate, which was received by me from the Surveyor General with said instructions, and that all the corners of said survey have been established and perpetuated in strict accordance with the law, official regulations and instructions thereunder; and I do further solemnly swear that the foregoing are the true and original field notes of said survey and my report therein, and that the labor expended and improvements made upon said mining claim by claimant or its grantors are as therein fully stated, and that the character, extent, location and itemized value thereof are specified therein with particularity and full detail, and that no portion of said labor or improvements so credited to this claim has been included in the estimate of expenditures upon any other claim.

J. J. Fisher  
U. S. Deputy Mineral Surveyor.

Subscribed and sworn to by the said J. J. Fisher  
U. S. Deputy Mineral Surveyor, before me A. O. Ross  
Register U.S. Land Office this 10<sup>th</sup>  
day of October, 1895.

A. O. Ross  
Register  
J. Priscott



# Affidavit of Five Hundred Dollars Improvements.

We Richard Babb and Ind. Hickey

of lawful age, being first duly sworn according to law, depose and say: that we are acquainted with the Ohio mining claim, situated in

Martinez Mining district, Yavapai County,

Arizona Territory, for which The Congress Gold Company

has made application for survey prior to application for patent under the provisions of the Act of Congress, approved May 10, 1872; and that the labor done and improvements made thereon by the applicant and its grantor exceed Five Hundred Dollars in value, and further that we are not personally interested in said mine.

Richard Babb  
Ind. Hickey

TERRITORY OF ARIZONA,  
County of Yavapai } ss.

SWORN to and subscribed before me, this  
11<sup>th</sup> day of October 1895

A. N. Gager  
Notary Public.





OHIO.

NOTICE OF LOCATION.

KNOW ALL MEN BY THESE PRESENTS:--

That we the undersigned have this day located fifteen hundred (1500) feet in length by six hundred (600) feet in width of this horizontal ore deposit, bearing precious metals, with all dips, spurs, angles and variations, and all Mineral Deposits contained therein, and all timber growing within the limits of this claim, and all Water and Water Privileges thereon or appurtenant thereto, under and according to the provisions of the United States Mining Laws, under which it is located.

The Exterior boundaries of this claim are as follows;--

COMMENCING at this monument and notice placed in the East end of claim, and runs thence Three Hundred (300) feet in a northerly direction, to monument at N.E. corner; thence in a westerly direction parallel with the ledge Fifteen Hundred (1,500) feet to monument at N.W. corner; thence at right angles across the ledge in a southerly direction Six Hundred (600) feet to monument at S.W. corner; thence parallel with the ledge in an easterly direction fifteen hundred (1500) feet to monument at S.E. corner; thence at right angles across the ledge in a Northerly direction three hundred (300) feet to place of beginning.

This ledge may be more generally described as situated South of and adjacent to the Rich Quartz Mining Claim in Martinez Mining District, Yavapai County, Arizona Territory, and shall be known as the O H I O Mining Claim.

DATED on the ground this first day of January 1892.

Witness,  
Geo. W. Vickers,

F. M. MURPHY.

P. L. KASTNER.

Recorded at request of A. W. Edwards, Jan., 2<sup>d</sup> A. D. 1892, at 9, 10 o'clock A. M. in Book 33 of Mines pages 102 & 103, Records of Yavapai County Arizona. By F. A. Tritle, Jr., (L. S.) Charles H. Akers, Deputy. County Recorder.

#####

TERRITORY OF ARIZONA, §  
§ ss;  
County of Yavapai. §

I, F. A. Tritle, County Recorder in and for said County and Custodian of the Records thereof, do hereby certify, that I have compared the above and foregoing with and that the same is a full, true and correct copy of the Notice of Location of the OHIO Mining Claim, as the same appears of record in Book 33 of Mines, pages 102-103, Records of Yavapai County Arizona.

IN WITNESS WHEREOF, I have hereunto set my hand and affixed my Official Seal this 20<sup>th</sup> day of September, A. D. 1895.

By F. A. Tritle  
Deputy.

F. A. Tritle  
County Recorder .

#####



(4-687.)

# Surveyor General's Certificate of Approval of Field Notes and Survey of Mining Claim.

Department of the Interior,

Office of U. S. Surveyor General,

Tucson, Arizona

January 11", 1896

I, U. S. Surveyor General for

District of Arizona

do hereby certify that the foregoing and hereto attached Field Notes and Return of the

Survey of the Mining Claim of

The Congress Lumber

Company

\_\_\_\_\_ , known as the

Ohio

situate in

Martinez

\_\_\_\_\_ mining district,

Yavapai

County,

Arizona

in Section \_\_\_\_\_,

Township No. \_\_\_\_\_,

Range No. \_\_\_\_\_

\_\_\_\_\_ , designated as Survey No. 1190

executed by

J. J. Fisher

\_\_\_\_\_ , U. S. Deputy Mineral

Surveyor,

Oct. 8-9"

\_\_\_\_\_ , 1895,

under my instructions dated

Sept. 25"

\_\_\_\_\_ , 1895,

have been critically examined and the

necessary corrections and explanations made, and the said Field Notes and Return, and

the Survey they describe, are hereby approved. A true copy of the copy of the location

certificate filed by the applicant for survey is included in the field notes.

Levi H. Manning

U. S. Surveyor General for

Arizona



Survey No 1190  
 Prescott Land District

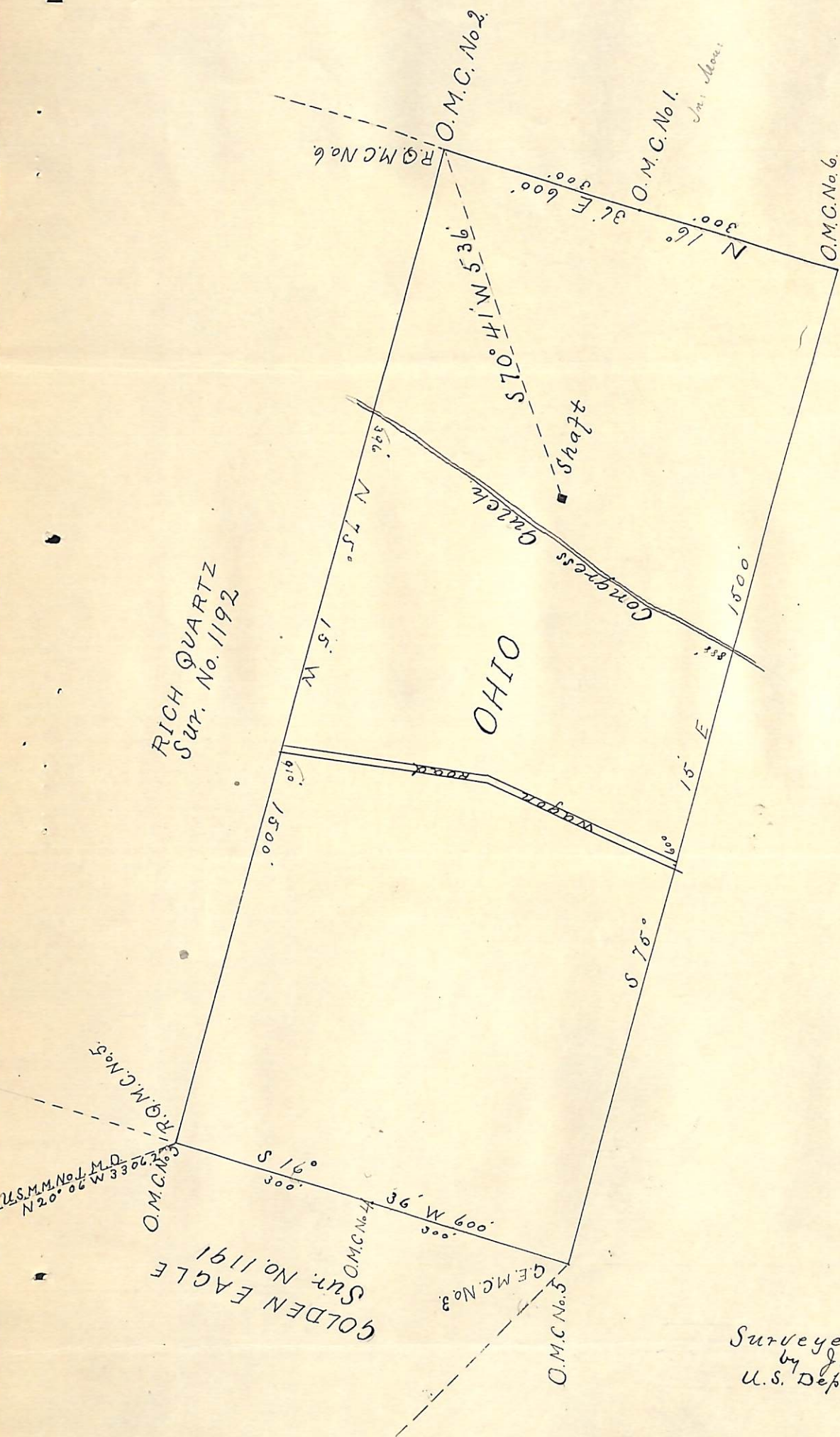

Surveyed Oct. 8 and 9 - 1895  
 by J. J. Fisher  
 U.S. Dep. Min. Surveyor.