

MS

0

1

1

9

5

(4-683.)

Mineral Survey No. 1195

Lot No. _____

Prescott

Land District.

FIELD NOTES

OF THE SURVEY OF THE MINING CLAIM OF

McCabe Mining Company

KNOWN AS THE

Gladstone Fracture

Big Bay

Mining District,

Yavapai

County,

Arizona Territory

Section _____

Township _____

Range _____

Surveyed under instructions dated Oct. 25th, 1895,

by J. J. Fisher,
U. S. Deputy Mineral Surveyor.

Claim located Sept. 26th, 1894

Survey commenced Dec. 5th, 1895.

Survey completed Dec 5th, 1895.

o 6-160

Address

Ed. W. Mills

Att. in fact for

McCabe Mining Company

Prescott

Arizona

14128 b-2500

Read over

PRELIMINARY OATHS OF ASSISTANTS IN SURVEY OF MINING CLAIM.

We, J. J. Coleman and _____,
do solemnly swear that we will well and faithfully execute the duties of chain carriers;
that we will level the chain upon even and uneven ground and plumb the tally-pins,
either by sticking or dropping the same; that we will report the true distance to all
notable objects, and the true length of all lines that we assist in measuring, to the best
of our skill and ability, and in accordance with instructions given us, in the survey of
the Mining Claim of the McLeate Mining Company
_____, known as the
Gladstone Fracture
situate in Big Bay mining district,
Yavapai County, Arizona
in Section _____, Township No. _____, Range No. _____.

J. J. Coleman, Chainman.
_____, Chainman.

Subscribed and sworn to by the above-named persons before
me this 5th day of December, 1895.

Edwin G. Wager
Notary Public

I, _____, do solemnly swear that I will well and
truly perform the duties of axeman, in the establishment of corners and other duties,
according to instructions given me and to the best of my skill and ability, in the survey
of the Mining Claim of _____

known as the _____,
more fully described in the preceding affidavit.

_____, Axeman.

Subscribed and sworn to by the said _____
_____ before me this _____ day of
_____, 18 _____.

I, J. J. Coleman, do solemnly swear that I will
well and truly perform the duties of flagman, in the establishment of corners and other
duties, according to instructions given me and to the best of my skill and ability, in the
survey of the Mining Claim of the McLeate Mining Company

known as the Gladstone Fracture,
more fully described in the preceding affidavit.

J. J. Coleman, Flagman.

Subscribed and sworn to by the said J. J. Coleman
_____ before me this 5th day of
December, 1895.

Edwin G. Wager
Notary Public



3

Survey No 1195

Feet

Gladstone Fraction Lode

Beginning at Northwest Corner
Identical with location corner.

Which is the point of intersection of line
2-3 of Gladstone, Survey No 1159 with
line 3-4. Sink to Rise, Survey No 813.

There is set a pine post 4" x 4" x 5' long in
ground and surrounded by moss of stones,
post marked G.F. No 1-1195.

A + on Cyanide rock in place, marked
B.B. G.F. No 1-1195 bears S 29° 15' W 114.5

Thence N 65° E

Var. 14° E

491

Along line 3-4 of survey No 813
to Cor. No 2. Identical with location
corner, and also with Cor. No 4 of
Survey No 813. A pine post 4" x 4" x 5'
long set in ground and surrounded
by moss of stones, post marked
G.F. No 2-1195

U.S. M.M. No 1 bears N 37° 52' E 9346.9

Thence S 37° 35' E

Var. 14° E

100

To Cor No 3. Identical with location
corner.

A pine post 4" x 4" x 5' long set in ground
and surrounded by moss of stones,
post marked G.F. No 3-1195.

A + on porphyry rock in place,
marked B.B. G.F. No 3-1195 bears
S 21° 25' E 70 feet

Survey No 1195

Feet

Thence S 65° W
Var. 14° E

491

To Cor. No 4. the point of intersection with line 2-3 of Survey No 1159. Identical with location monument A pine post 4" x 4" x 5' long, set in ground and surrounded by mon. of stones, post marked G. F. No 4-1195.

A + on porphyry rock in place marked B. B. G. F. No 4-1195 bears S 2° 35' E 36.5 feet, Cor. No 2; Survey No 1159 Gladstone lode bears S 37° 30' E 100 feet.

Thence N 37° 30' W

Var. 14° E

100

To Cor. No 1- the place of beginning survey of exterior boundaries.

Containing 1.1 acres

Location

This claim is located on unswamped land, in Big Bay Mining District Yavapai Co. Arizona.

Expenditure of Five Hundred Dollars I certify that the value of the labor and improvements done for the development of this claim, done by the claimant and its grantors, is not less than five hundred dollars and said improvements consist of:

Two levels run from the working shaft of the sink to Rise, The McLeave Mining Co claimants. The upper or 150 foot level runs to the forks of the Gladstone vein. The lower or 330 foot level has not yet reached the South Fork of the

Survey No 1195

Gluckstone vein. Sunk levels are 340 feet in length from where they leave the main levels on the Sink to Rise.

Value \$3400.00

A level on Gluckstone Fracture 4 x 6 x 12' in length on the south fork of Gluckstone vein, which is a continuation of the 158 foot level leading to working shaft on Sink to Rise.

Value \$120.00

Instrument

The survey was made with a Gurley Solar Transit, the courses were deflected from the true meridian as determined by solar observations. The distances were measured with a 100 foot steel chain.

J. J. Fisher
U.S. Dep. Min. Surveyor

Prescott Dec. 6th 1895.

FINAL OATHS FOR SURVEYS.

LIST OF NAMES.

A list of the names of the individuals employed by J. J. Fisher
 United States Deputy Mineral Surveyor, to assist in running, measuring, and marking the lines
 corners and boundaries described in the foregoing field notes of the survey of the mining claim
 of The McCabe Mining Company
 known as the Gladstone Fraction
 and showing the respective capacities in which they acted.

J. J. Coleman, Chainman.
 _____, Chainman.
 _____, Axman.
J. J. Coleman, Flagman.

FINAL OATHS OF ASSISTANTS.

I, J. J. Coleman
 and _____, do solemnly swear that we assisted J. J. Fisher
 _____, United States Deputy Mineral Surveyor, in marking the corners and
 surveying the boundaries of the mining claim of The McCabe Mining Co
 _____, known as the _____,
Gladstone Fraction, represented
 in the foregoing field notes as having been surveyed by said deputy mineral surveyor and under
 his direction; and that said survey has been in all respects, to the best of our knowledge and
 belief, faithfully and correctly executed, and the corner and boundary monuments established
 according to law and the instructions furnished by the United States Surveyor-General for
Arizona

J. J. Coleman, Chainman.
 _____, Chainman.
 _____, Axman .
J. J. Coleman, Flagman.

Subscribed and sworn to by the above-named persons before me
 this 5th day of December, 1896.

Edwin G. Wager
 Notary Public



FINAL OATH OF U. S. DEPUTY MINERAL SURVEYOR.

I, J. J. Fisher, U. S. Deputy Mineral Surveyor, do solemnly swear that, in pursuance of instructions received from the United States Surveyor General for Arizona, dated Oct. 25th, 1895, I have, in strict conformity to the laws of the United States, the official regulations and instructions thereunder, and the instructions of said Surveyor General, faithfully and correctly executed the survey of the Mining Claim of The McCabe Mining Company, known as the Gladstone Fraction, situate in Big Bay Mining District, Yavapai County, Arizona, in Section _____, Township No. _____, Range No. _____, and designated as Survey No. 1195, as represented in the foregoing field notes, which accurately show the boundaries of said mining claim as distinctly marked by monuments on the ground, and described in the attached copy of the location certificate, which was received by me from the Surveyor General with said instructions, and that all the corners of said survey have been established and perpetuated in strict accordance with the law, official regulations and instructions thereunder; and I do further solemnly swear that the foregoing are the true and original field notes of said survey and my report therein, and that the labor expended and improvements made upon said mining claim by claimant or its grantors are as therein fully stated, and that the character, extent, location and itemized value thereof are specified therein with particularity and full detail, and that no portion of said labor or improvements so credited to this claim has been included in the estimate of expenditures upon any other claim.

J. J. Fisher
U. S. Deputy Mineral Surveyor.

Subscribed and sworn to by the said J. J. Fisher
U. S. Deputy Mineral Surveyor, before me A. D. Rax
US Land Officer this 7th
day of December, 1895.

A. D. Rax
Register

Affidavit of Five Hundred Dollars Improvements.

We J. J. Coleman and W. T. Hall

of lawful age, being first duly sworn according to law, depose and say: that we are acquainted with the Gludstone Fraction mining claim, situated in

Big Bay Mining district, Yavapai County, Arizona Territory, for which The McCabe Mining Company

has made application for survey prior to application for patent under the provisions of the Act of Congress, approved May 10, 1872; and that the labor done and improvements made thereon by the applicant and its grantor exceed Five Hundred Dollars in value, and further that we are not personally interested in said mine.

J. J. Coleman
W. T. Hall

TERRITORY OF ARIZONA,
County of Yavapai } ss.



SWORN to and subscribed before me, this 5th day of December 1895

Edwin G. Weger
Notary Public

"GLADSTONE FRACTION"

NOTICE OF LOCATION.

We the undersigned have this day located and claimed in compliance with the Mining Acts of Congress approved May 10"1872, and all subsequent Acts, fifteen hundred linear feet on the Gladstone Fraction together with 50 feet on each side of center, where this notice is placed.

This claim being situated on the south side of Galena Gulch and joins the Gladstone on the North end line, and runs parallel with the Sink to Rise. The Exterior boundaries are as follows.

Beginning at this Monument and Notice, thence N.37° 20'W. 50 feet to the intersection of the North end line of the Gladstone with the south side line of the Sink to Rise; thence N.65° E. 1500 feet or less to the N. E. corner of Sink to Rise; thence S.37° 20' E. 100 feet to N.E. corner; thence S.65° W. 1500 feet or less to the S.E. corner of claim; thence N.37° 20'W. 50 feet to place of beginning. This claim is about 300 feet south-east of the McCabe Quartz Mill in Big Bug Mining District, Yavapai County Arizona, and is known as the GLADSTONE FRACTION.

Dated on the ground this 26"day of Sept, 1894.

MC. CABE MINING CO.
By J. Fisher, Agent.

Recorded at request of Ed W. Wells, May 10" A.D. 1895, at 1,25 o'clock P.M. in Book 42 of Mines, pages 33-34, Records of Yavapai County Arizona.

By H.R. Tritle, (Seal.) F.A. Tritle,
Deputy. County Recorder.

TERRITORY OF ARIZONA, §
§ss;
County of Yavapai. §

I, F.A. Tritle, County Recorder in and for said County and Custodian of the Records thereof, do hereby certify, that I have compared the above and foregoing with and that the same is a full, true and correct copy of the Notice of Location of the Gladstone Fraction Mining Claim as the same appears of record in Book 42 of Mines pages 33-34, Records of Yavapai County Arizona.

Given under my hand and Seal of Office this 22"day of October 1895.

*By F. A. Tritle Jr
Deputy.*

F. A. Tritle
County Recorder.

Survey No 1195
Prescott Land District

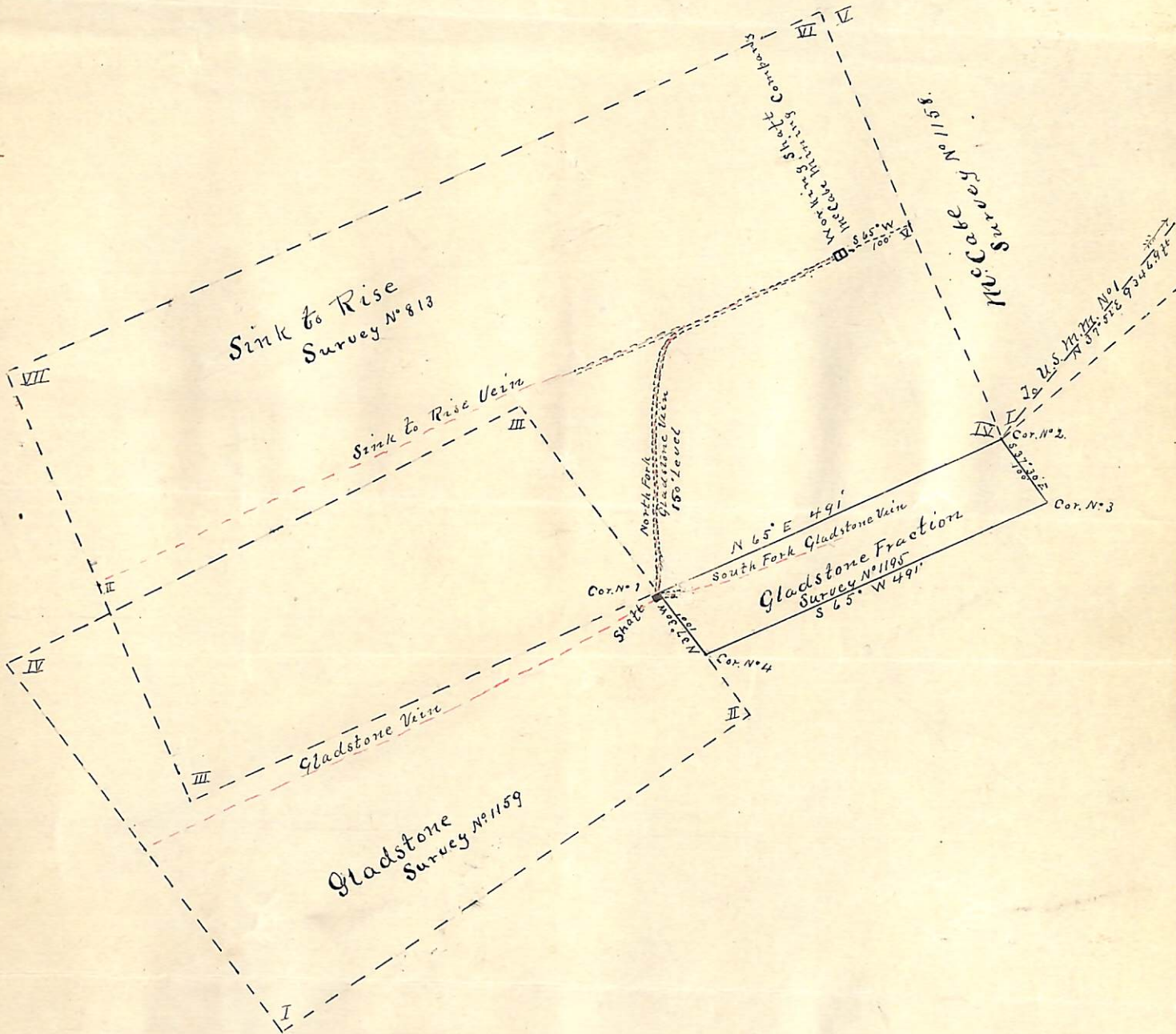

Surveyed Dec. 5th 1895
by J. J. Fisher
U.S. Dep. Min. Surveyor

(4-687.)

Surveyor General's Certificate of Approval of Field Notes and Survey of Mining Claim.

Department of the Interior,

Office of U. S. Surveyor General,

Tucson, Arizona

April 8, 1896

I, U. S. Surveyor General for District of Arizona,
do hereby certify that the foregoing and hereto attached Field Notes and Return of the
Survey of the Mining Claim of the McCabe Mining
Company

_____ , known as the
Gladstone Fraction

situate in Big Ory mining district,
Yavapai County, Arizona

in Section _____, Township No. _____, Range No. _____
_____, designated as Survey No. 1195

executed by J. J. Fisher, U. S. Deputy Mineral
Surveyor, Dec. 5, 1895, under my instructions dated
Oct. 25, 1895, have been critically examined and the

necessary corrections and explanations made, and the said Field Notes and Return, and
the Survey they describe, are hereby approved. A true copy of the copy of the location
certificate filed by the applicant for survey is included in the field notes.

George J. Roskrige

U. S. Surveyor General for Arizona

0 6 - 1 c 2

UNITED STATES DEPARTMENT OF THE INTERIOR 9605 (956)
BUREAU OF LAND MANAGEMENT M.S. 1195
ARIZONA STATE OFFICE

NOTICE OF CANCELLATION OF MINERAL SURVEY

The GLADSTONE FRACTION lode, Mineral Survey No. 1195, located in sections 29 and 30, Township 13 North, Range 1 East, Gila and Salt River Meridian, Arizona, is hereby canceled.

This claim has not been filed with the Arizona State Office, Bureau of Land Management, in accordance with Section 314, 90 STAT. 2769, (43 U.S.C. 1744).

This cancellation was necessitated to clear the record.

The Mineral Survey Plat should be noted as follows:

"GLADSTONE FRACTION lode, M.S. 1195, was canceled October 16, 2008, by memo 9605 (956) M.S. 1195, which is now a part of the original field notes."

October 16, 2008
Date

Stephen K. Hansen
Chief Cadastral Surveyor of Arizona