

**M
S
-**

0

1

2

1

2

MINERAL SURVEY NO. 1212

Claims	M & B Des. Page No.	Imps. Page No.	Loc. Notices Page No.
Bitter Creek	6	9	4
Conglomerate	2	8	2
Iron Carbonate	4	9	3
March	1	8	1

(4-683.)

Mineral Survey No. 1212

Lot No. _____

Prescott

Land District.

FIELD NOTES

OF THE SURVEY OF THE MINING CLAIM OF

G. W. Hull,

KNOWN AS THE

March, Conglomerate, Iron carbonate and
Bitter Creek, Verde

Mining District,

Yavapai County, Arizona

Section _____, Township 16 N, Range 2 E

Surveyed under instructions dated Feb. 18th, 1896

by J. J. Fisher
U. S. Deputy Mineral Surveyor.

Claim located Jan 1st 1892 and March 8th, 1894

Survey commenced April 15th, 1896

Survey completed April 17th, 1896

o 6-160

Address of claimant
G. W. Hull
Jerome
Yavapai Co.
Arizona

PRELIMINARY OATHS OF ASSISTANTS IN SURVEY OF MINING CLAIM.

WE, Frank Covanough and Frank Rickenbaugh, do solemnly swear that we will well and faithfully execute the duties of chain carriers; that we will level the chain upon even and uneven ground and plumb the tally-pins, either by sticking or dropping the same; that we will report the true distance to all notable objects, and the true length of all lines that we assist in measuring, to the best of our skill and ability, and in accordance with instructions given us, in the survey of the Mining Claim of G. W. Hull

known as the Conglomerate, Iron Carbonate, Bitter Creek and March situate in Verde mining district, in Section Jacupai County, Arizona, Township No. _____, Range No. _____



Frank Covanough, Chainman.
Frank Rickenbaugh, Chainman.

Subscribed and sworn to by the above-named persons before me this 15 day of April, 1896.

Geo. S. Porter, Jr.
Notary Public

I, Frank Covanough, do solemnly swear that I will well and truly perform the duties of axeman, in the establishment of corners and other duties, according to instructions given me and to the best of my skill and ability, in the survey of the Mining Claim of G. W. Hull

known as the Conglomerate, Iron Carbonate, Bitter Creek and March, more fully described in the preceding affidavit.



Frank Covanough, Axeman.

Subscribed and sworn to by the said Frank Covanough before me this 15 day of April, 1896.

Geo. S. Porter, Jr.
Notary Public

I, Frank Rickenbaugh, do solemnly swear that I will well and truly perform the duties of flagman, in the establishment of corners and other duties, according to instructions given me and to the best of my skill and ability, in the survey of the Mining Claim of G. W. Hull

known as the Conglomerate, Iron Carbonate, Bitter Creek & March, more fully described in the preceding affidavit.



Frank Rickenbaugh, Flagman.

Subscribed and sworn to by the said Frank Rickenbaugh before me this 15 day of April, 1896.

Geo. S. Porter, Jr.
Notary Public

Survey No. 1212

March Lode

Feet

Beginning at S.W. cor. of claim, identical with S.W. cor. of the location, which is also cor. No. 2. of Survey No. 1051. Main Lode
A slate stone $5 \times 12 \times 24$, set 12" in ground and surrounded by row of stones, stone marked M. No. 1-1212, A + on granite rock in place, marked B.B. M. No. 1-1212 brs. $S 46^{\circ} 15' 4 15$ feet. San Francisco Peak brs. $N 32^{\circ} 12' E$. U.S. M.M. No. 1, V.D. brs. $S 52^{\circ} 10' 4 3051.3$

Thence $N 37^{\circ} W$

Var. $14^{\circ} 55' E$

- 870 To Billee Creek course East, width 20 feet.
930 To cor. No. 1, Survey No. 590, Hermit Lode
1024 To Gulch course East, width 20 feet.
1500 To cor. No. 2

A lava stone $8 \times 12 \times 18$, set 10" in ground and surrounded by row of stones, stone marked M. No. 2-1212,

A + on lava rock in place, marked B.B. M. No. 2-1212 bears $S 5^{\circ} 45' E$, cor. No. 2 is identical with north west corner of the loc.

Thence $N 40^{\circ} 35' E$

Var. $10^{\circ} 45' E$

- 600 To cor. No. 3. Identical with north east cor. of the location.

A lava rock $8 \times 15 \times 18$, set 10" in ground and surrounded by row of stones, stone marked M. No. 3-1212.

A + on lava rock in place, marked B.B. M. No. 3-1212, brs. $N 13^{\circ} 20' E$ 32 ft. Bill Williams Mt. brs. $N 7^{\circ} 55' W$

Thence $S 37^{\circ} E$

Var. $15^{\circ} 15' E$

- 1250 To Billee Creek, course East width 25 feet.

Survey No 1212

Maine Lode

Feet
1500 To box No 4. Identical with south East
cer. of the location
A slate stone 4" x 12" x 18", set 10" in ground
and surrounded by mow. of stones.
Stone marked M-No. 4-1212.
A + on granite rock in place, marked
B.B. M. No. 4-1212 brs. N 51° 45' W 45 feet.

Thence S 40° 35' W
Var. 14° 5' E

160 To Cer. No 1. Survey No 1051, Maine Lode
600 To Cer. No 1. the place of beginning
survey of exterior boundaries.

Conglomerate Lode Survey No 1212.

Beginning at S.W. Corner identical
with S.W. cer. of the location, box No 5.
The corner point being the point of inter-
section of line 2-3 of survey No 1076 A
Flouride Lode. with line 1-6 of survey
No 1051 Maine Lode. at N 42° 19' E 280.2 from Cer. No 3-1076 A
A porphyry stone 8" x 8" x 24", set 12" in ground and
surrounded by mow. of stones, stone
marked C, No. 5-1212
A + on granite rock in place, marked
B.B. C. No 5-1212 brs. N 43° 45' W 12 feet
U.S. M. M. No 1. V.D. brs. S 71° W 35 47.3 ft.

Thence N 32° 5' W
Var 14° E

550 To Guelch. course East width 5 feet.
1240 To Cer. No 6 along line 1-6 of
Survey No 1051. which is also cer. No 1
of Survey No 1051.
A granite stone 6" x 10" x 18", set 10" in ground
and surrounded by mow. of stones

Conglomerate Lode

Feet

Survey No 1217

Stone marked C. No 6-1212.
A+ on granite-rock in place, marked
B.B. C. No 6-1212. Trs N 10° 45' W 48 feet
No loc. mon. at this point.

Thence N 40° 35' E
Var. 14° 5' E

160 To cor. No 7. which is also cor No 4
of this survey. No loc. mon. at this point.
A slate stone 4x12x18, set 10" in ground and
surrounded by mon. of stones, stone
marked C. No 7-1212, same stone marked
M. No 4-1212 of this survey.

Thence N 37° W
Var. 14° 5' E

250 To Bitten Creek, course East width 25 feet.
260 To cor. No 8.

A granite stone 6x8x20, set 10" in ground
and surrounded by mon. of stones, stone
marked C. No 8-1212.
A+ on Lard boulder in place, marked B.B.
C. No 8-1212. Trs. N 51° 40' W 15 ft.
Orig loc. mon. Trs S 42° 19' W 130 ft.

Thence N 42° 19' E
Var. 14° 5' E

340 To cor. No 9. Identical with loc. mon.
A granite rock 6x8x30, set 10" in ground
and surrounded by mon. of stones, stone
marked C. No 9-1212
A+ on granite rock in place, marked
B.B. C. No 9-1212 Trs, S 82° 25' W 35 feet

Thence S 36° 44' E
Var 16° E

515 To Bitten Creek, course East width 25 feet.
1265 To Gulch, course East width 10 feet.

Conglomerate Lode
Survey No 1212

Feet

1482.6 To Cor. No 10. Identical with S.E. cor. of the location, at intersection of line 2-3 Sw. No 1076 A at S 42° 19' W 491 feet from Cor. No 2-1076 A. A granite stone 6 x 10 x 30" set 12" in ground and surrounded by a mon. of stones, stone marked C. No 10-1212. A + on granite rock in place, marked B.R. C No 10-1212 br. S 12° 55' E 18 feet.

Hence S 42° 19' W
Var. 13° 35' E

600 To cor. No 5, the place of beginning survey of exterior boundaries.

Iron Carbonate Lode

Beginning at Cor. No 11. Identical with S.W. cor. of the location, which is also cor No 10 of this survey. A granite stone 6 x 10 x 30", set 12" in ground and surrounded by mon. of stones, stone marked I.C. No 11-1212, same stone marked on opposite side C. No 10-1212

Hence N 36° 44' W
Var. 13° 35' E

217.6 To gulch, course East, width 10 feet.

967.6 To Bitten Creek, course East, width 25 feet.

1482.6 To Cor. No 12, Identical with N.W. cor. of the location

A granite stone 6 x 8 x 30, set 18" in ground and surrounded by mon. of stones, stone marked I.C. No 12-1212, same stone marked on opposite side C. No 9-1212

A + on granite rock in place, marked

Iron Carbonate Lode
 Survey No 1212.

Feet

B.R.I.C. No 12-1212 brs. N 0° 8' E 21 feet

Thence N 42° 19' E
 Var. 16° E

600 To cor. No 13. Identical with N.W. cor. of the loc.

A granite-stone 8" x 14" x 18", set 12" in ground and surrounded by mon. of stones. Stone marked I.C. No 13-1212.

A + on Lava rock in place, marked B.R.I.C. No 13-1212 brs. S 49° 10' W 32 feet

Thence S 34° 5' E
 Var. 19° 10' E

1497.2 To cor. No 14.

Orig. loc. corner bears S 34° 5' E 50 feet

A granite-stone 5" x 12" x 30", set 18" in ground and surrounded by mon. of stones.

Stone marked I.C. No 14-1212

A + on granite boulder 3' x 4' x 3.5' above ground, marked B.R.I.C. No 14-1212 brs. S 84° 30' W 45 feet

U.S.M.M. No 1, V.D. brs. S 64° 12' W 4572.2

Thence S 42° 19' W
 Var. 14° E

39 To cor. No 2. Survey No 1076 A.

Fleming Lode.

48 To Bitter Creek, course East, width 25'

210 To Guelch course North East, width 15'

530 To cor. No 11. the place of beginning survey of exterior boundaries.

8

Billie Creek Lodge
Survey No 1212

Foot

Beginning at Cor. No 15, which is also
Cor. No 14 of this survey. Orig. loc. mon.
bes. S $34^{\circ} 5'$ E 50 feet

A granite stone $5 \times 12 \times 30$, set 18" in
ground and surrounded by mon. of
stones, stone marked B.C. No 15-1212 and
on opposite side I.C. No 14-1212

A + on granite rock in place marked
B.R. B.C. No 15-1212 bes. N $46^{\circ} 30'$ W 36 feet.

Thence N $34^{\circ} 5'$ W
Var 14° E

1497.2 To Cor. No 16, Identical with S.W. cor. of
the location.

A granite stone $8 \times 14 \times 18$ set 12" in
ground and surrounded by mon. of
stones, stone marked B.C. No 16-1212.

Same stone marked on opposite side
I.C. No 13-1212.

A + on lava rock in place, marked
B.R. B.C. No 16-1212 bes. N $69^{\circ} 19'$ W 34 feet.

Thence N $42^{\circ} 19'$ E
Var. $19^{\circ} 10'$ E

600 To Cor. No 17. Identical with N.E.
corner of the location

A granite stone $8 \times 12 \times 20$, set 12" in
ground and surrounded by a mon.
of stones, stone marked B.C. No 17-1212

A + on a granite rock in place,
marked B.R. B.C. No 17-1212 bes.
S $64^{\circ} 25'$ W 31 feet.

Bitter Creek Lode

Feet

Survey No 1212.
55' 8"

Thence S 26° 55' E ✓
Var. 14° 50' E ✓

1556.4

To cor. No 18. The intersection of the +
west side line of the Verde lode,
unsurveyed.

Orig. A.C. cor. by N 42° 19' E 200 feet
A granite stone 6" x 15" x 30" set 15" in ground
and surrounded by mon. of stones.
Stone marked B.C. No 18-1212
A + on granite rock in place, marked
B.B. B.C. No 18-1212 by N 88° 5' W 14 feet.

Thence S 42° 19' W
Var. 14° E

400

To cor. No 15. To place of beginning
survey of exterior boundaries.

Area.

March Lode	20.18 acres.
Conglomerate Lode	17.09 acres.
Iron carbonate lode	18.87 acres.
Bitter Creek	<u>16.70 acres</u>
Total area	72.84 acres

Location

This claim is located on unsurveyed
land in Verde Mining District
Yavapai County, Arizona.

Survey No 1212

Expenditure of Five Hundred Dollars

I certify that the value of the labor and improvements upon this claim, placed thereon by the claimant and his grantors, is not less than five hundred dollars, and that said improvements consist of

March Lode

Tunnel No 1. which bears from cor. No 4.
 S 70° 35' W 550 feet, 4 x 6 feet 50 feet long
 in rock, Curve of tunnel S 72° W
 Value \$500.00

Tunnel No 2. which bears from cor. No 4
 N 58° 21' W 455 feet, 4 x 6 feet 100 feet
 long in rock, Curve of tunnel N 23° 30' E
 Value \$1000.00

Open Cut No 1. which bears from cor. No 4.
 N 86° 16' W 460, 5 x 18 feet and 8 feet face
 in rock and earth
 Value \$50.00

Open Cut No 2, which bears from cor. No 4
 N 74° 19' W 600 feet, 4 x 20 feet and 8 feet
 face, in rock and earth
 Value 50.00

Conglomerate Lode

Tunnel No 1 which bears from cor. No 5
 N 30° W 353 feet, 4 x 6 feet 67 feet long
 20 feet of which is on the Conglomerate
 lode. An approach 30 feet long, 4 feet wide
 and 12 feet face, Curve of tunnel S 50° W
 Value \$350.00

Survey No 1212

Conglomerate lode

Tunnel No 2, which bears from Cor No 10
 N $75^{\circ} 14' W$ 475 feet. 4x6 feet 35 feet long
 in rock. Approach to tunnel 4x10 feet
 10 feet face. A grade at mouth of the
 approach 15 x 35 feet, 6 feet face.
 Course of tunnel N $50^{\circ} 55' W$
 Value \$650.00

Iron Carbonate lode

Open cut, which bears from Cor. No 11-
 N $34^{\circ} 37' E$ 260. 8x20 feet and 8 feet face
 Value \$150.00

Tunnel No 1, which bears from Cor No 14
 S $53^{\circ} 7' W$ 450 feet. 4x6 feet 10 feet long.
 Approach to tunnel 4x25 feet and
 15 feet face. Course of tunnel S $52^{\circ} E$
 Value \$250.00

Tunnel No 2, which bears from Cor No 14.
 S $81^{\circ} 30' W$ 560 feet, 4x6 feet and 50 feet long
 in rock. An approach to tunnel 6x15 feet
 and 12 feet face. Course of tunnel S $81^{\circ} 30' W$
 Value \$600.00

A shaft, which bears from Cor. No 14.
 S $68^{\circ} 15' W$ 120 feet. 8x8 feet and 10 feet deep
 in earth and rock
 Value \$100.00

Pitts Creek lode

Open cut No 1, which bears from Cor No 15
 N $37^{\circ} 46' E$ 250 feet, 6x8 feet, 5 feet face
 Value \$50.00

Survey No 12, 12

Open cut No 2, which bears from cor No 15
 N $21^{\circ} 20' E$ 345 feet, 4.5 feet deep, 4 feet
 wide and 33 feet long. Side cut 3 feet deep,
 12 feet wide and 12 feet long.

Value \$300.00

Open cut No 3, which bears from cor. No 15
 North 175 feet, 4 x 21 feet, 5.5 feet deep,
 side cut 10 feet long and 10 feet wide, 1.5 feet
 deep.

Value \$150.00

Instrument

The survey was made with a Gurley
 solar transit. The courses were
 deflected from the true meridian as
 determined by solar observations.
 The distances were measured with a
 100 foot steel chain.

J. J. Fisher
 U. S. Dep. Min. Surveyor.

Concord May 13th 1896

FINAL OATHS FOR SURVEYS.

LIST OF NAMES.

A list of the names of the individuals employed by J. J. Fisher
 United States Deputy Mineral Surveyor, to assist in running, measuring, and marking the lines
 corners and boundaries described in the foregoing field notes of the survey of the mining claim
 of G. W. Hull

known as the Complimentary, Iron Carbonate, Bitter Creek and Marsh,
 and showing the respective capacities in which they acted.

- Frank Cavanaugh, Chainman.
- Frank Rickenbaugh, Chainman.
- Frank Cavanaugh, Arman.
- Frank Rickenbaugh, Flagman.

FINAL OATHS OF ASSISTANTS.

We, Frank Cavanaugh
 and Frank Rickenbaugh, do solemnly swear that we assisted J. J. Fisher
Fisher, United States Deputy Mineral Surveyor, in marking the corners and
 surveying the boundaries of the mining claim of G. W. Hull

known as the Complimentary
Iron Carbonate, Bitter Creek and Marsh, represented
 in the foregoing field notes as having been surveyed by said deputy mineral surveyor and under
 his direction; and that said survey has been in all respects, to the best of our knowledge and
 belief, faithfully and correctly executed, and the corner and boundary monuments established
 according to law and the instructions furnished by the United States Surveyor-General for
Arizona.

- Frank Cavanaugh, Chainman.
- Frank Rickenbaugh, Chainman.
- Frank Cavanaugh, Arman.
- Frank Rickenbaugh, Flagman.

Subscribed and sworn to by the above-named persons before me
 this 21st day of April, 18 96

M. Clark
 Notary Public

(4-686.)

FINAL OATH OF U. S. DEPUTY MINERAL SURVEYOR.

I, J. J. Fisher, U. S. Deputy Mineral Surveyor, do solemnly swear that, in pursuance of instructions received from the United States Surveyor General for Arizona, dated Feb. 18th, 1896, I have, in strict conformity to the laws of the United States, the official regulations and instructions thereunder, and the instructions of said Surveyor General, faithfully and correctly executed the survey of the Mining Claim^s of G. W. Hull, known as the March Conglomerate, Iron Carbonate and Bitter Creek, situate in Verde Mining District, Yavapai County, Arizona, in Section _____, Township No. _____, Range No. _____, and designated as Survey No. 1212, as represented in the foregoing field notes, which accurately show the boundaries of said mining claim as distinctly marked by monuments on the ground, and described in the attached copy of the location certificate, which was received by me from the Surveyor General with said instructions, and that all the corners of said survey have been established and perpetuated in strict accordance with the law, official regulations and instructions thereunder; and I do further solemnly swear that the foregoing are the true and original field notes of said survey and my report therein, and that the labor expended and improvements made upon said mining claim by claimant or his grantors are as therein fully stated, and that the character, extent, location and itemized value thereof are specified therein with particularity and full detail, and that no portion of said labor or improvements so credited to this claim has been included in the estimate of expenditures upon any other claim.

J. J. Fisher
U. S. Deputy Mineral Surveyor.

Subscribed and sworn to by the said J. J. Fisher
U. S. Deputy Mineral Surveyor, before me W. Ross Register
this 14
day of May, 1896.

W. Ross Register

UNITED STATES LAND OFFICE,
PRESCOTT, ARIZ.

Affidavit of Five Hundred Dollars Improvements.

We Frank Cavanaugh and Frank Rickenbaugh
of lawful age, being first duly sworn according to law, depose and say: that we are acquainted
with the Conglomerate Iron Carbonate, Bitter Creek and ^{Marb} mining claims situated in
Perde Mining district, Yavapai County,
Arizona Territory, for which G. W. Hull

has made application for survey prior to application for patent under the provisions of the
Act of Congress, approved May 10, 1872; and that the labor done and improvements made thereon
by the applicant and his grantor exceed Five Hundred Dollars in value, and further
that we are not personally interested in said mine.

Frank Cavanaugh

Frank Rickenbaugh

TERRITORY OF ARIZONA,

County of Yavapai } ss.

SWORN to and subscribed before me, this

21 day of April 1896

McClack

Notary Public

March

This is to certify I, G. W. Hull, did take up and locate on the 8th day of March, A. D., 1894, the March Mining Claim, situated in Verde Mining District, Yavapai County, Arizona Territory, and joining maine and conglomerate mines, on the North end boundary. Commence at the Northwest corner end where the maine lode joins the Hermit location and running along the East line of the Hermit location to stone monument 1500 feet; thence 600 feet Eastwaly to stone monument N. E. corner; thence 1500 feet to the conglomerate mine S. E. corner; thence 600 Westwaly along the North line of the conglomerate Mine + Maine Mine to place of beginning. This discovery is in the Gulch on the conglomerate cement, containing gold, silver + copper, I claim all rights guaranteed by the U. S. Laws in holding said location. Together with all dips, spurs + angles + water rights belonging to the same.

G. W. Hull

Recorded at request of G. W. Hull, May 7th A. D., 1894, at 9 o'clock A. M., in Book 40 of Mines, pages 548-549, Records of Yavapai County, Arizona.

By M. O. Archibald
Deputy.

{Qual}

Aly. O. Brodie
County Recorder.

Territory of Arizona
County of Yavapai ss

J. F. Trille, County Recorder in and for said County and Territory, and Custodian of the Records thereof, do hereby certify that I have compared the

above and foregoing with, and the same is a full, true and correct copy of the notice of location of the March Mining Claim, as the same remains of record in the office of the County Recorder in Book 40 of Mines, pages 548-9, Records of Yavapai County, Arizona.

In witness whereof I have hereunto set my hand and affixed my official this 14th day of February A. D., 1896

F. A. Fittle
County Recorder.



Located Jan'y. 1st 1892, by G. W. Hull.



Situated in Verde Mining District, Yavapai Co., A.T., East side of Main Lode, & Town of Jerome, bounded as following. Commencing at the Northwestly line of the Florence Mine, at monument Southwest cor and running Northwly 600 feet to monument S. E. cor; thence 1500 feet Northwly to monument N. E. cor; thence 600 feet Westwly to monument N. W. cor; thence 1500 feet to place of beginning. I claim all rights guaranteed under the U. S. Laws in holding said location. The same being a cement & conglomerate deposit & mineral.

G. W. Hull

Recorded at request of G. W. Hull, Jan 8th A. D. 1892, at 9 o'clock A. M., in Book 33 of mines, pages 249, Records of Yavapai County, Arizona.

By F. A. Little Jr. ^(Seal)
Deputy,

Charles N. Akers
County Recorder.

Territory of Arizona  ss
County of Yavapai 

I, F. A. Little, County Recorder in and for said County and Territory, and Custodian of the records thereof, do hereby certify that I have compared the above and foregoing with, and the same is a full, true and correct copy of the notice of location of Conglomerate Mining Claim, as the same remains of record in the Office of the County Recorder, in Book 33 of Mines, page 249, Records of Yavapai County, Arizona.

In witness whereof I have hereunto set my hand and affixed my official seal this 14th day of Feby. A.D. 1896.
F. A. Little County Recorder

Located Jan'y. 1st 1892, by G. W. Null, situated in
 Verde Mining District, Yavapai Co., Ariz., & Eastern side
 of Conglomerate mine & Town of Jerome. Bounded as
 follows: Commencing at the S. E. cor of the Conglomerate
 Mine, being the S. W. cor & running along the line of the
 Florencia mine 600 feet to monument Southeast cor; thence
 1500 feet Northwily to monument N. E. cor; thence 600
 feet westerly to monument N. W. cor; thence 1500 feet Southwily
 to place of beginning. I claim all rights guaranteed
 under the U. S. Laws in holding said location, the same
 being a cement and conglomerate deposit and mineral.

G. W. Null.

Recorded at request of G. W. Null, Jan'y. 8th A. D., 1892, at
 9 o'clock A. M. in Book 33 of Mines, pages 249-250,

Records of Yavapai County, Arizona.

By F. A. Tuttle for Charles N. Akers
 Deputy, ~~Clerk~~ County Recorder.

Territory of Arizona
 County of Yavapai

I, F. A. Tuttle, County Recorder in and for said County
 and Territory, and Custodian of the Records thereof, do hereby
 certify that I have compared the above and foregoing with,
 and the same is a full, true and correct copy of the matter
 of location of the Iron Carbonate Mining claim as the
 same remains of Record in the office of the County Recorder
 in Book 33 of Mines, pages 249-250, Records of Yavapai
 County, Arizona.

In witness whereof, I have hereunto set my hand and af-
 fixed my official seal this 14th day of February, A.D. 1896.

F. A. Tuttle



Located Jan'y 1st 1892, by G. W. Hull, situated in Verde Mining District, Yavapai Co. A.T., and on the Easterly side of Iron Carbonate Mine, Easterly from Jerome, bounded as follows: Commencing at the S. E. corner of the Iron Carbonate Mine, being the South-west corner monument, and running 600 feet Easterly to monument; thence 1500 feet Northwesterly to monument; thence 600 feet Westwesterly to monument; thence 1500 feet to place of beginning. I claim all rights guaranteed under the U. S. Laws in holding said location. The same being a cement & conglomerate ^{deposit} of mineral.

G. W. Hull

Recorded at request of G. W. Hull, Jan 8th A. D., 1892, at 9 o'clock A. M., in Book 33 of Mines, page 250, Records of Yavapai County, Arizona.

By J. A. Tuttle Jr 
Deputy.

Charles N. Arers
County Recorder.

Territory of Arizona  ss
County of Yavapai 

J. A. Tuttle, County Recorder in and for said County and Territory, and Custodian of the Records thereof, do hereby certify that I have compared the above and foregoing with, and the same is a full, true and correct copy of the notice of location of the Bitter Creek Mining Claim, as the same remains of record in the office of the County Recorder, in Book 33 of Mines, page 450, Records of Yavapai County Arizona.

In witness whereof, I have hereunto set my hand and affixed my official seal this 14th day of February, A. D., 1896

Survey No 1212.
Prescott Land District

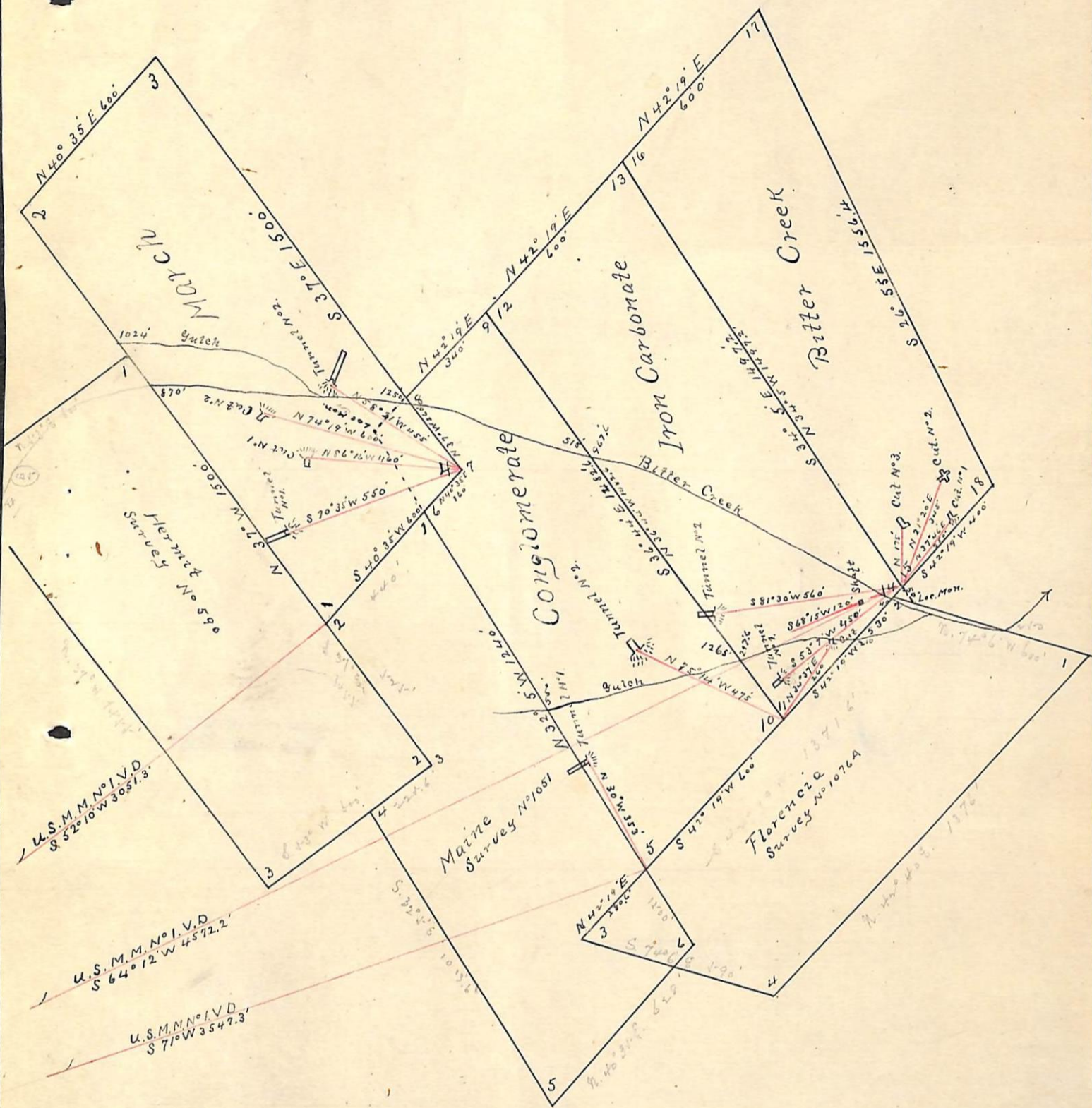

Surveyed April, 15, 16, 17, 1896
by J. J. Fisher
U.S. Dep. Min. Surveyor
Scale 400' to 1 inch

(4-687.)

Surveyor General's Certificate of Approval of Field Notes and Survey of Mining Claim.

Department of the Interior,

Office of U. S. Surveyor General,

Tucson Arizona

October 24th, 1896

I, U. S. Surveyor General for *Arizona*,

do hereby certify that the foregoing and hereto attached Field Notes and Return of the Survey of the Mining Claim of *G. W. Hull*.

....., known as the
March, Conglomerate, Pitts Creek, and Iron carbonate.
situate in *Verde* mining district,
Yavapai County, *Arizona*,
in Section, Township No., Range No.

....., designated as Survey No. *1212*

executed by *J. J. Fisher*, U. S. Deputy Mineral

Surveyor, *April 15-17th*, 1896, under my instructions dated

February 18th, 1896, have been critically examined and the

necessary corrections and explanations made, and the said Field Notes and Return, and

the Survey they describe, are hereby approved. A true copy of the copy of the location

certificate filed by the applicant for survey is included in the field notes.

George J. Roskrug

U. S. Surveyor General for *Arizona*.