

**M  
S  
-**

**0**

**1**

**2**

**7**

**4**

(4-683.)

Mineral Survey No. 1274

Lot No. ....

Gila

Land District.

FIELD NOTES

OF THE SURVEY OF THE MINING CLAIMS OF

Arthur Schwarzenbach

and by August Baron, his Atty in fact.

KNOWN AS THE

Lansom Way up <sup>and</sup> Boston and

~~State of Texas~~ Lodes. Huachuca Mountain Mining District,

Cochise County, Arizona Territory.

Section ..... Township 248, Range 20 E

Surveyed under instructions dated Dec 11<sup>th</sup>, 1897,

by Henry G. Howe  
U. S. Deputy Mineral Surveyor.

Claims located July 30<sup>th</sup> 97, Jan 1<sup>st</sup> 88, Jan 1<sup>st</sup> 92, Jan 1<sup>st</sup> 91, 1897.

Survey commenced December 15<sup>th</sup>, 1897.

Survey completed December 20<sup>th</sup>, 1897.

o 6-160

Address.

August Baron Atty.

Tombstone.

Cochise County.

Arizona.

# PRELIMINARY OATHS OF ASSISTANTS IN SURVEY OF MINING CLAIM.

WE, Charles Wright and J. W. Reaney,  
do solemnly swear that we will well and faithfully execute the duties of chain carriers;  
that we will level the chain upon even and uneven ground and plumb the tally-pins,  
either by sticking or dropping the same; that we will report the true distance to all  
notable objects, and the true length of all lines that we assist in measuring, to the best  
of our skill and ability, and in accordance with instructions given us, in the survey of  
the Mining Claims of Arthur Schwarzenbach, and  
by August Baron, his Atty in fact., known as the  
Johnson, Way Up, Boston, and State of Texas;  
situate in Huerfano Mountains mining district,  
Cochise County, Arizona;  
in Section \_\_\_\_\_, Township No. \_\_\_\_\_, Range No. \_\_\_\_\_.

Charles Wright, Chainman.  
J. W. Reaney, Chainman.

Subscribed and sworn to by the above-named persons before  
me this 14<sup>th</sup> day of December, 1897.



H. G. Howe,  
Notary Public,  
Commission Expires July 13<sup>th</sup> 1901

I, \_\_\_\_\_, do solemnly swear that I will well and  
truly perform the duties of axeman, in the establishment of corners and other duties,  
according to instructions given me and to the best of my skill and ability, in the survey  
of the Mining Claim of \_\_\_\_\_

known as the \_\_\_\_\_,  
more fully described in the preceding affidavit.

\_\_\_\_\_, Axeman.

Subscribed and sworn to by the said \_\_\_\_\_  
before me this \_\_\_\_\_ day of \_\_\_\_\_,  
\_\_\_\_\_, 18 \_\_\_\_\_.

I, \_\_\_\_\_, do solemnly swear that I will  
well and truly perform the duties of flagman, in the establishment of corners and other  
duties, according to instructions given me and to the best of my skill and ability, in the  
survey of the Mining Claim of \_\_\_\_\_

known as the \_\_\_\_\_,  
more fully described in the preceding affidavit.

\_\_\_\_\_, Flagman.

Subscribed and sworn to by the said \_\_\_\_\_  
before me this \_\_\_\_\_ day of \_\_\_\_\_,  
\_\_\_\_\_, 18 \_\_\_\_\_.

3

Survey No 1274.

Feet.

Way Up Lode.

Beginning at Cor. No. 1.

Identical with location Cor. Which is also Cor No. 1. of the Boston Lode, of this survey.

A Pine Stump surrounded by monument of Stone Stump hewed and scribed West face 1-1274. W.U.

U.S. L.M. No 1274. bears  $S 10^{\circ} 15' E$  253. ft.

No <sup>other</sup> bearings available.

Thence  $S 83^{\circ} 16' W$ .

Var  $12^{\circ} 20' E$ .

1500. To Cor. No. 2.

Identical with Cor. No. 2 of location

An Oak Post 5 ft. long 4 ins sqr. 18 inches in ground surrounded by monument of Stone. Scribed 2-1274. W.U.

No bearings available.

Thence  $S 7^{\circ} 30' E$

Var  $12^{\circ} 20' E$

300. Old location monument in line.

600. To Cor. No. 3.

Identical with Cor. No. 3. of location a Juniper Post 5 ft. long 4 ins. square 12 inches in ground surrounded by monument of Stone.

Scribed 3-1274 W.U. Cor. No. <sup>Samson Lode</sup> 1279. bears  $N 63^{\circ} 0' W$  246. ft.

No <sup>other</sup> bearings available.

Thence  $N 83^{\circ} 16' E$

Var  $12^{\circ} 20' E$

1500. To Cor. No. 4.

Identical with Cor. No. 4. of location which is also Cor. No. 4. of Boston Lode of this Survey.

An Oak post 4 1/2 ft. long 4 ins. sqr. 16 ins. in ground surrounded by monument of Stone scribed upon West face 4. 1274. W.U.

No bearings available.

Thence  $N 7^{\circ} 30' W$

Var  $12^{\circ} 20' E$

- 2  
4
- Feet,  
300. Old location mon, of Way Up, and Boston Lodes.  
600. To Cor. No. 1. The place of beginning.

Boston Lode.

Beginning at Cor. No. 1.  
Identical with Cor. No. 1. of location and with  
Cor. No. 1. of Way Up Lode of this Survey. A Pine  
Stamp scribed upon East face 1-1274. B.  
U.S. L.M. No 1274. bears  $S10^{\circ}15'E$  253. ft.  
No <sup>other</sup> bearings available.

Thence  $N82^{\circ}35'E$

Var  $12^{\circ}20'E$

1500. To Cor. No. 2.  
Identical with cor. No. 2. of the location,  
An Oak post  $4\frac{1}{2}$  ft. long 4 ins. square 18 inches  
in ground surrounded by mound of stone,  
scribed 2-1274. B.  
No bearings available.

Thence  $S7^{\circ}30'E$

Var  $12^{\circ}20'E$ .

300. Old location mon of stone,  
600. To Cor. No. 3.

Identical with Cor. No. 3. of location. An Oak  
Post 5 ft. long  $4\frac{1}{2}$  in. sq. 12 ins. in ground  
surrounded by mound of stone  
scribed 3-1274. B.  
No bearings available.

Thence  $S82^{\circ}35'W$

Var  $12^{\circ}20'E$

1500. To Cor. No. 4  
Identical with location Cor. and Cor. No. 4. of  
Way Up Lode. The East Face of Oak post  
scribed 4-1274. B.  
No bearings available.

Feet. Thence  $N 7^{\circ} 30' W$   
 Var  $12^{\circ} 20' E$   
 300. Old location mon. of Boston and Way Up Lodes.  
 600. To Cor. No. 1. The place of beginning.

Area:-  
 Way Up Lode 20.66  
 Boston Lode 20.66  
 Total Area:- 41.32 Acres

### Location.

These claims are located near the South East, end of the Huachuca Mountains, Cochise Co Arizona. The Way Up and Boston Lodes adjoining upon the Summit between Copper and Montezuma Cañons. <sup>m 19. unorganized.</sup>

These claims are upon unsurveyed ground, and would be in T. 24. S. R. 21 E. of 4<sup>th</sup> and S. R. Mer. when the surveys are extended. The nearest Township subdivided being T. 24. S. R. 25. E. The nearest Townships that the lines have been run being T. 20. S. R. 22. E. of 4<sup>th</sup> and S. R. Mer. The nearest organized Mining District being Hartford Mining District located at the head of Ramsey's Canon, just south of Camp Huachuca Military Reservation, and about ten miles distant. There are no adjoining claims:-

Expenditure of Five Hundred Dollars, I certify that the value of the labor and improvements upon these claims placed thereon by the claimant and his grantors, is not less than five hundred dollars, and that said improvements consist of:-

4  
6

The Discovery Tunnel No. 1. Way Up Lode.  
The mouth of bears  $S56^{\circ}25'W$  670. ft. from Cor. No. 1.  
line of tunnel  $N83^{\circ}0'E$ . is  $5 \times 7$  ft. 25 ft to face

Value. \$ 250.00

Tunnel No. 2. The mouth of which, bears  
 $S64^{\circ}0'W$  900. ft. from cor. No. 1, line of tunnel  
 $N83^{\circ}0'E$ .  $5 \times 7$  ft. 30 ft. to breast.

Value. \$ 300.00

Tunnel No. 3. The mouth of which, bears  
 $N50^{\circ}45'E$  280. ft. from cor. No. 3. line of Tunnel  
 $N80^{\circ}0'E$   $4 \times 7$  ft. and 20 ft. to face.

Value 200.00

The Discovery Shaft No. 1, upon Boston Lode.  
bears  $S10^{\circ}30'E$  294 ft. from cor. No. 1. This Shaft  
is sunk upon the northerly side of the  
bold out crop, at this point being over 20 ft.  
wide and extend westerly over 900. ft.  
to tunnel No 2 of the Way Up Lode, and  
extends easterly through shafts No 2<sup>nd</sup> and  
3. a distance of over six hundred feet  
from this shaft. This shaft is  $4 \times 6$  ft. 12 ft.  
deep.

Value \$ 100.00

Incline Shaft No 2. The mouth of which  
bears  $S63^{\circ}45'E$  540. ft. from cor. No. 1. course  
North. dip of incline  $70^{\circ}$  shaft  $4 \times 7$  ft. 30. ft.  
deep. in rock on lode.

Value. \$ 300.00

Incline Shaft. No 3. The mouth of which bears  
 $S68^{\circ}30'E$  626. ft. from cor. No. 1. course North. dip.  
of incline  $73^{\circ}$  shaft  $4 \times 6$  ft. 26 ft. deep sunk on lode.

Value \$ 250.00

The surface embraced by the Way Up claim ascends very rapidly from its westerly to its easterly end, which is the westerly end of the Boston lode which comes upon the divide between Copper and Montezuma Canyons. The westerly end of the Way Up - being about 500 feet lower than the easterly end, the easterly end of the Boston being about 250 ft. lower than the westerly end. The tunnels described and included in the estimate of expenditure upon the Way Up: continued in its present course will develop the ore bodies of the Way Up, and Boston claims at great depth, whereby by one system of workings these claims can be most advantageously developed.

Instrument

This survey was made with a Young and Sons Bright Mountain Transit with Solar Attachment. The courses were deflected from the true meridian as determined by direct Solar observations. The distances were measured with a 100 ft. Steel tape.

Henry G. Howe  
U. S. Deputy Mineral Surveyor

Tombstone  
January 28<sup>th</sup>/98.

and Feb 18<sup>th</sup>/98  
Bisbee March 14<sup>th</sup>/98



8

Field Notes of the establishment of a  
true meridian.

As per instructions of Dec 11<sup>th</sup>/97  
Upon the afternoon of Dec 15<sup>th</sup> 1897.  
I select a point 14ft. east of the S.E.  
cor. of the adobe house situated  
about  $\frac{1}{4}$  a mile south of Copper  
Canyon, where I drive a peg firmly  
in the ground, the center plainly  
marked, over which I set a young  
and sons light mountain Transit  
No 5585, with Smith's Solar attachment  
carefully adjusted for this latitude  
and hour of the day. At 500ft north  
of this I have another peg driven and  
mark the point cut by the vertical  
hair cut by the telescope.

At 1:36 A.M. I obtain an observation  
of Polaris at its greatest Western Elon-  
gation in accordance with the Manual  
of instructions and mark the point  
thus determined upon a peg driven  
in the ground at the north end of  
meridian.

Upon the morning of the 16<sup>th</sup> of Dec.  
at 8 A.M.

Ray of the Azimuth of Polaris  $1^{\circ} 27'$  to  
the east and mark the True Meri-  
dian thus determined, which falls  
upon the same peg set by me upon  
the afternoon of Dec 15<sup>th</sup>.

And I find the mean Magnetic  
declination to be  $12^{\circ} 20' E$

Establishment of U.S. L.M. No. 1274.

Field Notes of the establishment of U.S. L.M. No 1274, at the head of Copper, Montezuma, and Ash Canons.

I find upon examination of the location of the Samson, Wey, Up, Boston, and State of Texas Mining Claims, that I have received instructions to Survey under date of Dec 11<sup>th</sup>/97 that said claims lay upon both sides of the Huachuca Mountains and not in any established Mining District.

And no public Surveys or International monuments within the prescribed limits of two miles.

I go to the highest sharp point upon the divide at the head of Copper Canon to the South west, the Montezuma Canon to the east, and the Ash Canon to the North east, From this point the entire country for miles can be seen.

Upon this point I excavate the loose rocks to rock in place where I cut a X in the rock. No B.P. or B.T. available;

Over this X. I carefully adjust my solar transit and take the following bearings.

A Shaft. 4x6ft. 12ft. deep. bears

S 12° 0' E 41ft.

The South end of Standard Meridian bears,

S 41° 40' W

The South East cor. Samson lode bears,

S 76° 15' W.

The Highest Peak Huachuca Mts. bears

N 16° 36' W.

A Sharp peak in Cochise Stronghold, in Dragon Mts. bears N 25° 30' E

Tombstone bears. N 25° 0' E

Bowie Peak, bears. N 42° 30' E

College Peak bears N 87° 26' E

Nigger Head. a peak just south of old International Mon No 19.

bears.  $S 87^{\circ} 5' E$

Highest Peak San Jose Mts (in Mexico)

bears  $S 66^{\circ} 53' E$

Mouth of Ash Canon bears,

$N 72^{\circ} 24' E$ .

Having taken the above bearings,  
I remove my transit, and over  
the X. I set a post 8 ft. long 6 ins. sq. r.  
18 inches to bed rock, around which  
I build a monument of stone, six  
feet at base and four feet high.

Upon the east face of post near the  
top the following letters  $2\frac{1}{2}$  inches in  
height, and  $\frac{3}{16}$  inches deep, are cut.

U. S. L. M. No. 1274.

The top of post is carefully centered with  
tack.

Dec 15<sup>th</sup> and 16<sup>th</sup>/97

Henry G. Howe

U. S. Dep. Min'l Surveyor.

# FINAL OATHS FOR SURVEYS.

## LIST OF NAMES.

A list of the names of the individuals employed by Henry G. Howe.  
 United States Deputy Mineral Surveyor, to assist in running, measuring, and marking the lines  
 corners and boundaries described in the foregoing field notes of the survey of the mining claims  
 of Arthur Schwanzenbach, by August Baron, his Atty in fact.  
 known as the Lansdown, Way Up, Boston, and State of Texas  
 and showing the respective capacities in which they acted.

Charles Wright, Chairman.  
J. W. Reaney, Chairman.  
 \_\_\_\_\_, Axman.  
 \_\_\_\_\_, Flagman.

## FINAL OATHS OF ASSISTANTS.

We, Charles Wright and J. W. Reaney  
 and \_\_\_\_\_, do solemnly swear that we assisted H. G.  
Howe, United States Deputy Mineral Surveyor, in marking the corners and  
 surveying the boundaries of the mining claims of Arthur Schwanzenbach  
by August Baron, his Atty in fact.  
 \_\_\_\_\_, known as the Lansdown,  
Way Up, Boston, and State of Texas, Claims, represented  
 in the foregoing field notes as having been surveyed by said deputy mineral surveyor and under  
 his direction; and that said survey has been in all respects, to the best of our knowledge and  
 belief, faithfully and correctly executed, and the corner and boundary monuments established  
 according to law and the instructions furnished by the United States Surveyor-General for  
Arizona.

Charles Wright, Chairman.  
J. W. Reaney, Chairman.  
 \_\_\_\_\_, Axman.  
 \_\_\_\_\_, Flagman.

Subscribed and sworn to by the above-named persons before me  
 this 21<sup>st</sup> day of December, 1897.

H. G. Howe  
 Notary Public  
 Commission Expires July 13<sup>th</sup> 1901.

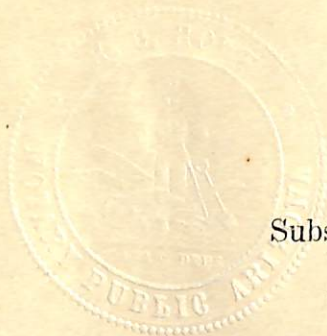

(4-686.)

FINAL OATH OF U. S. DEPUTY MINERAL SURVEYOR.

I, Henry G. Howe, U. S. Deputy Mineral Surveyor, do solemnly swear that, in pursuance of instructions received from the United States Surveyor General for Arizona, dated December 11<sup>th</sup>, 1897, I have, in strict conformity to the laws of the United States, the official regulations and instructions thereunder, and the instructions of said Surveyor General, faithfully and correctly executed the survey of the Mining Claims of Arthur Schwarzenbach and August Baron, his Ally in fact, known as the Samsom Way Up, Boston 2<sup>d</sup> State of Texas lodes, situate in Huachuca Mountains Mining District, Cochise County, Arizona, in Section \_\_\_\_\_, Township No. \_\_\_\_\_, Range No. \_\_\_\_\_, and designated as Survey No. 1274, as represented in the foregoing field notes, which accurately show the boundaries of said mining claim as distinctly marked by monuments on the ground, and described in the attached copy of the location certificate, which was received by me from the Surveyor General with said instructions, and that all the corners of said survey have been established and perpetuated in strict accordance with the law, official regulations and instructions thereunder; and I do further solemnly swear that the foregoing are the true and original field notes of said survey and my report therein, and that the labor expended and improvements made upon said mining claim by claimant or their grantors are as therein fully stated, and that the character, extent, location and itemized value thereof are specified therein with particularity and full detail, and that no portion of said labor or improvements so credited to this claim has been included in the estimate of expenditures upon any other claim.

Henry G. Howe.  
U. S. Deputy Mineral Surveyor.

Subscribed and sworn to by the said Henry G. Howe  
U. S. Deputy Mineral Surveyor, before me A. Notary  
Public this 29<sup>th</sup>  
day of January, 1898.

my Commission expires March 27<sup>th</sup> 1901  
James Reilly  
Notary Public

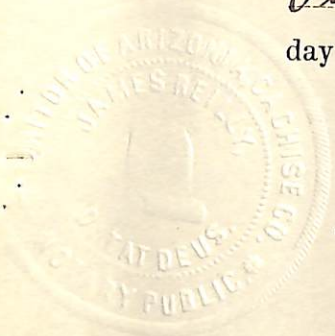

o 6-154

Affidavit of Five Hundred Dollars Improvements.

We J. W. Reaney and R. R. Fischer

of lawful age, being first duly sworn according to law, depose and say: that we are acquainted with the Gamson Way Up Boston State of Texas mining claim, situated in The Huachuca Mountains Mining district, Cochise County, Arizona Territory, for which Arthur Schwarzenbach and by August Baron his Atty in fact has made application for survey prior to application for patent under the provisions of the Act of Congress, approved May 10, 1872; and that the labor done and improvements made thereon by the applicant and his grantor exceed Five Hundred Dollars in value, and further that we are not personally interested in said mine.

J. W. Reaney  
R. R. Fischer

TERRITORY OF ARIZONA,  
County of Cochise } ss.

SWORN to and subscribed before me, this

27<sup>th</sup> day of December 1897

H. G. Howe  
Notary Public,

Commission Expires July 13<sup>th</sup> 1901.

## Location Notice.

Notice is hereby given, that the undersigned, in compliance with the requirements of the Mining Act of Congress, approved May 10<sup>th</sup>, 1872, have this day located and claim 1500 fifteen hundred linear feet along the course of this lead, lode or vein of mineral bearing quartz, and 300 three hundred feet in width on each side of the middle of said lead, lode or vein, situated in the Huachuca Mountains Mining District, County of Cochise Arizona, and more particularly described as follows, to-wit:

Commencing at this monument of stones, being the centre of the East end of claim, and upon which this notice is posted, thence Northerly 300 three hundred feet to a monument of stones; thence Westerly fifteen hundred feet to a monument of stones; thence Southerly three hundred feet to a monument of stones; being the center of the West end of claim; thence Southerly three hundred feet to a monument of stones; thence Easterly fifteen hundred feet to a monument of stones; thence Northerly three hundred feet to the place of beginning.

This Claim shall be known as the Way Up Mine situated in the Huachuca Mountains on the summit between Cooper Montezuma and Ash Canyons and part off it - formerly known as the Non Such Mine and shall be known as the Way Up Mine. Located January 1<sup>th</sup> 1888.

1 Witnesses

2 W. W. Simons

Wm Graff

August Barron

3 Filed and recorded at Request of August  
4 Barron January 6<sup>th</sup> A.D., 1888 at 9 A.M.

5 W. F. Bradley

6 County Recorder

7 Territory of Arizona }  
8 County of Cochise } ss.

9 I, M. J. Brown, County Recorder in and for  
10 The County of Cochise, Territory of Arizona,  
11 do hereby certify that the above and foregoing  
12 instrument - is a full, true and correct copy  
13 of the Location Notice of the "Way Up" mine,  
14 as appears of record in Book, 11, Record  
15 of Mines, page 442, of the Records of Cochise  
16 County, now in my office.

17 Given under my hand and Official  
18 Seal, this 9<sup>th</sup> day of December A.D. 1897.

19 M. J. Brown

20 County Recorder

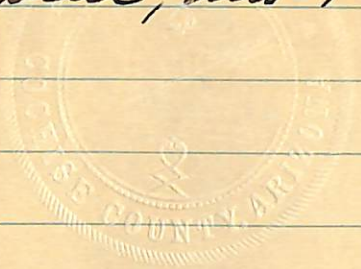



## Location Notice.

Notice Is Hereby Given that the undersigned, in compliance with the requirements of the Mining Act of Congress, approved May 10<sup>th</sup>, 1872, have this day located and claim 1500 linear feet along the course of this lead, lode or vein of mineral bearing quartz, and 300 feet in width on each side of the middle of said lead, lode or vein, situate in the Huachuca Mountains Mining District, County of Cochise, Arizona, and more particularly described as follows, to-wit:

Commencing at this monument of stones, being the center of the Westerly end of claim, and upon which this notice is posted; thence Southerly 300 feet to a monument of stones; thence Easterly 1500 feet to a monument of stones; thence Northerly 300 feet to a monument of stones, being the center of the Easterly end of claim; thence Northerly 300 feet to a monument of stones; thence Westerly 1500 feet to a monument of stones; thence Southerly 300 feet to the place of beginning.

This Claim is located in South end of the Huachuca Mountains on the Divide between Copper and Ash Canyons, joining the Way Up mine on end line also joining the New York Mine on side line and running parallel with the latter,

and shall be known as the Boston Mine.  
Located January 1<sup>st</sup> 1892

Witness

August Zeller.

Wm Graff.

Filed and Recorded at the request of August  
Zellar January 2<sup>nd</sup> A.D. 1892 at 1 P.M.

W. F. Bradley

County Recorder.

Territory of Arizona }  
County of Cochise } ss.

I, M. J. Brown, County Recorder in and for  
the County of Cochise, Territory of Arizona,  
do hereby certify that the above and forego-  
ing instrument is a full, true and correct  
copy of the Location Notice of the "Boston"  
mine, as appears of record in Book, 12,  
Record of Mines, page 403, of the Records of  
Cochise County, now in my office.

Given under my hand and Official Seal,  
this 9<sup>th</sup> day of December A.D. 1897.

M. J. Brown

County Recorder.

PLAT OF THE  
~~SAMSON, WAY-UP and BOSTON and STATE OF TEXAS~~ LODES  
 HUACHUCA MOUNTAINS.

Scale 600. ft = 1 inch.

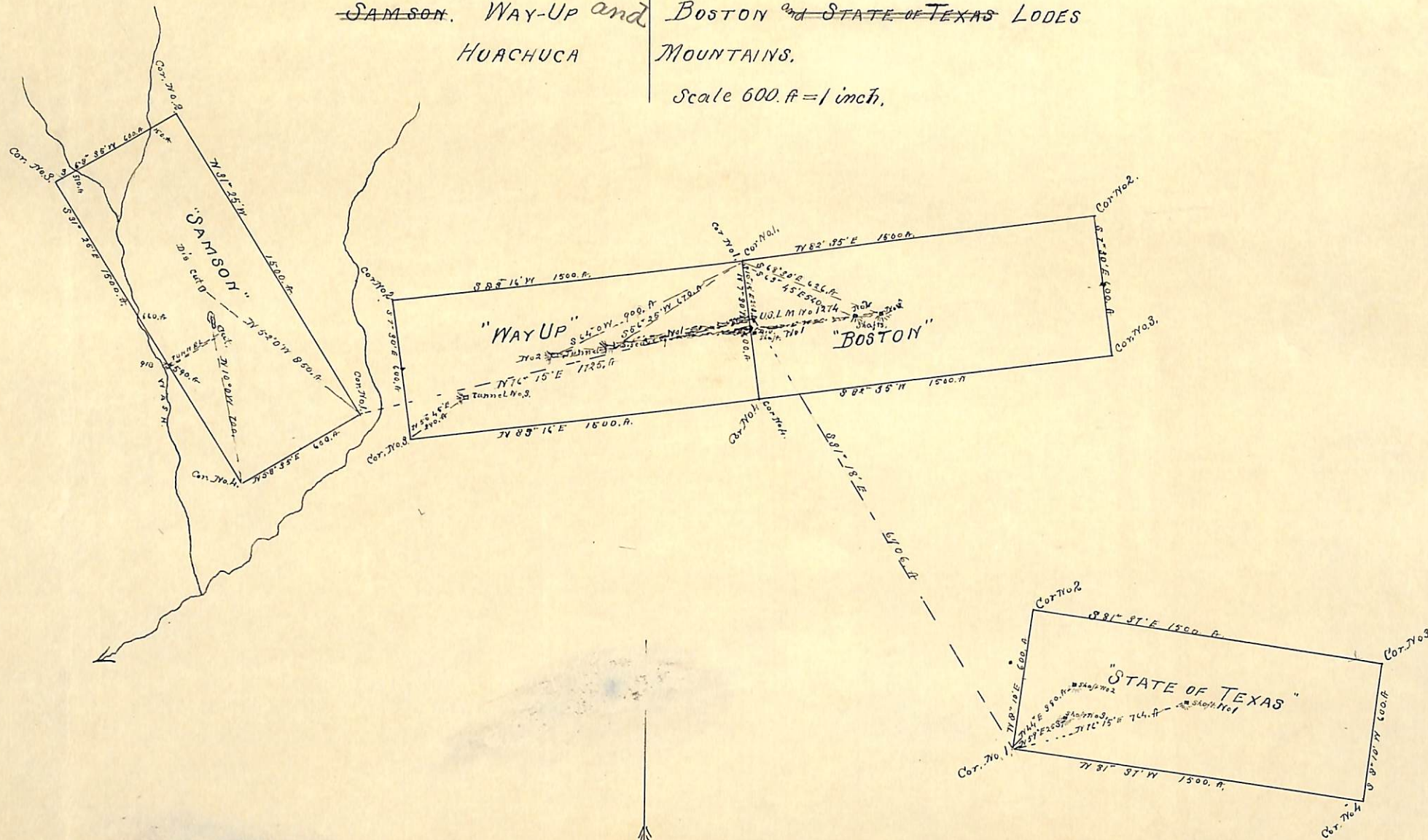

Var. 12° 20' E

Cor. No. 1. N 82° 35' E

S 88° 16' W



U.S.L.M. No. 1274.  
BOSTON LODGE

WAY UP LODGE.

S 82° 35' W

Cor. No. 2.

N 88° 16' E



(4-687.)

# Surveyor General's Certificate of Approval of Field Notes and Survey of Mining Claim.

Department of the Interior,

Office of U. S. Surveyor General,

Tucson, Arizona,

April 6<sup>th</sup>, 1898.

I, U. S. Surveyor General for District of Arizona,

do hereby certify that the foregoing and hereto attached Field Notes and Return of the Survey of the Mining Claim of Arthur Schwabgenbach,  
by August Baron, atty. in fact,

\_\_\_\_\_ , known as the

Way Up and Boston lodes,

situate in Huachuca mountains ~~mining district~~

Cochise County, Arizona,

in Section \_\_\_\_\_, Township No. \_\_\_\_\_, Range No. (unsurveyed)

\_\_\_\_\_, designated as Survey No. 1274

executed by Henry G. Howe, U. S. Deputy Mineral

Surveyor, December 15-20, 1897, under my instructions dated

December 11<sup>th</sup>, 1897, have been critically examined and the

necessary corrections and explanations made, and the said Field Notes and Return, and

the Survey they describe, are hereby approved. A true copy of the copy of the location

certificate filed by the applicant for survey is included in the field notes.

George Christ

U. S. Surveyor General for Arizona