

MS.

0

1

4

1

0

(4-683.)

# Mineral Survey No. 1410,

Lot No. \_\_\_\_\_

Gila Land District.

## FIELD NOTES

OF THE SURVEY OF THE MINING CLAIM OF

The Lowell and Arizona Mining Company, by F. C. Fenner,  
Attorney in Fact.

KNOWN AS THE

Lowell, Galena, Helen, Desplain, Auburn, Delmar, Boston, Minnesota, Dallas,  
Des Moines, Harrison, Higgins, Hanchett, Danville, & Delevin

Warren Mining District,

Cochise County, Arizona,

Approx.

Section \_\_\_\_\_, Township 23 S., Range 24 E. (Unsurv.)

Surveyed under instructions dated Sept. 26, 1899, 1

by James F. Trotter,  
U. S. Deputy Mineral Surveyor.

Claim located \_\_\_\_\_, 1

Survey commenced November 23rd, 1899

Survey completed December 10th, 1899

o 6-100

Claims	Located
Lowell	June 3, 1899,
Galena	Sept. 13, 1899,
Helen	" " "
Desplain	" " "
Auburn	" " "
Delmar	" " "
Boston	March 1, "
Minnesota	Sept. 13 "
Dallas	" " "
Des Moines	" " "
Harrison	" " "
Higgins	March 1, "

Claims	Located
Hanchett	March 1, 1899,
Danville	" " "
Delevin	" " "

Claimants address  
F. C. Fenner, Atty. in fact  
Lowell & Arizona C. M. & S. Co.  
Bisbee, Arizona.

# PRELIMINARY OATHS OF ASSISTANTS IN SURVEY OF MINING CLAIM.

WE, E. E. Carter and Geo McMillan

do solemnly swear that we will well and faithfully execute the duties of chain carriers; that we will level the chain upon even and uneven ground and plumb the tally-pins, either by sticking or dropping the same; that we will report the true distance to all notable objects, and the true length of all lines that we assist in measuring, to the best of our skill and ability, and in accordance with instructions given us, in the survey of the Mining Claim of The Lowell & Arizona Mining Co.

J.C. Fenner Atty in fact.  
situate in John Allen Lowell Graham Auburn Sulman Munsterlin Gaston Was Mains Idemson Sawville Hawchit Sullus Salwin J. J. Hughes mining district, Cochise County, Arizona in Section \_\_\_\_\_, Township No. \_\_\_\_\_, Range No. \_\_\_\_\_

E. E. Carter, Chainman.  
Geo McMillan, Chainman.

Subscribed and sworn to by the above-named persons before me this 28<sup>th</sup> day of November, 1899

S. K. Williams  
NOTARY PUBLIC.

I, \_\_\_\_\_, In and for Cochise County, Arizona Territory. (My Commission expires December 15th, A. D., 1901.) do solemnly swear that I will well and truly perform the duties of axeman, in the establishment of corners and other duties, according to instructions given me and to the best of my skill and ability, in the survey of the Mining Claim of \_\_\_\_\_

known as the \_\_\_\_\_, more fully described in the preceding affidavit. \_\_\_\_\_, Axeman.

Subscribed and sworn to by the said \_\_\_\_\_ before me this \_\_\_\_\_ day of \_\_\_\_\_, 18 \_\_\_\_\_

I, \_\_\_\_\_, do solemnly swear that I will well and truly perform the duties of flagman, in the establishment of corners and other duties, according to instructions given me and to the best of my skill and ability, in the survey of the Mining Claim of \_\_\_\_\_

known as the \_\_\_\_\_, more fully described in the preceding affidavit. \_\_\_\_\_, Flagman.

Subscribed and sworn to by the said \_\_\_\_\_ before me this \_\_\_\_\_ day of \_\_\_\_\_, 18 \_\_\_\_\_

Feet

## LOWELL LODGE.

Beginning at cor.No. 1, the N.W.cor., identical with cor.No. 4 S. 1120, a pine post 4" square, 4' above ground, surrounded by a mound of stones, scribed L.L,1410, identical with location;

Whence U.S.M.No.4 bears

N. 7°44' W. 2127.5 feet,

Whence a rock in place scribed L.L, B.R.1410 brs .

N. 12 deg. E. 84 feet;

Thence S. 73 deg. 4' E.

62 to the North end center, a 4" x 4" post 4' long,  
124 cor.No. 2 on line G-1 Galena road, 660.4 feet S.  
65 deg. 48' W. from cor. No. 1 Galena road, this corner sets in a small wash, (wash described in Galena notes). This corner is a pine post 4" sq. 12" in the ground, surrounded by a mound of stones, scribed 2 L,1410. It is identical with corner of location.

Whence a rock on bluff bears

N.60 deg.21'W.42.3 feet, scribed B.R.L.2,1410.

Thence S. 65 deg. 48' W.

275 to small wash, course N.65 deg. E.

301 to cor.No. 3, identical with corner of location, a pine post 4" sq. 4' long, set 12" in the ground, surrounded by a mound of stones, scribed L,<sup>3-</sup>1410.

Whence rock in place due W. 2' scribed 3 L.B.R. 1410.

Thence N. 73 deg. 4' W.

2.5 to cor.No. 4 a pine post 4" sq. 4' long, set 12" in the ground, surrounded by a mound of stones, scribed L. .4,1410.

whence the original location monument bears

N. 73 deg. 4' W. 64 feet, and is taken as a bearing monument. It is a pine post 4" sq.4' long, set 12" in the ground, and marked B.M.4 L.1410.

Feet

Thence N. 47 deg. 22' E.

225.5

to intersection of wash (small), course N. 65 deg. E.

251.5

to cor.No. 1, the place of beginning.

The ledge on this claim is very indistinct, but has the apparent direction of S. 45° deg. W. Can only be traced 10 feet S. 45 deg. W. from the discovery work.

No conflicts to be deducted from this claim.

(Table 32) Total area 0.307 acres.

(See table of areas at close.)

*Var. 12° E.*

-----

HIDDEN CLAIM.

Beginning at cor.No. 1, a pine post 4" sq. 4' long, set 12" in the ground, surrounded by a mound of stones, scribed 1 H. .1410; This corner is identical with corner of location;

Whence U.S.Mineral Monument No. 4 bears

N. 2 deg. 24' ~~W.~~ 2514 feet;

Whence a bearing stone bears

S. 12 deg. E. scribed X.B.S.1 H. .1410.

Thence S. 18 deg. 17' W.

84.95 to N.end center, also the intersection of line 1-4 Desplain Lode, 237.3 feet from cor.No. 4 of Desplain N. 77 deg. 44' W. from corner No. 4 Desplain Lode, also at intersection of line 4-5 Galena Lode, 248.3 feet N. 47 deg. 21' W. from cor.No. 4 Galena lode

169.9

to cor. No. 2, a pine post 4' long, 4" square, set 12" in the ground, surrounded by a mound of stones, scribed 2 H. .1410; identical with corner of location.

Feet	
	<p>Whence a bearing stone bears S. 20 deg. E. 201 feet, and marked 2 B.S. <del>H</del>-.1410;</p> <p>Thence N. 61 deg. 51' W.</p>
309	<p>to corner No. 3, a pine post 3' long, set 4" in the ground, 4" square surrounded by a mound of stones and scribed 3 H. .1410; identical with corner No. 1 of the Desplain Lode, a claim of this survey, and on E. end line senator No. 2, survey No. 1120;</p> <p>Whence a rock in place bears S. 11 deg. 1' E. 86.5 feet,</p> <p>Thence N. 18 deg. 17' E.</p>
84.95	to W. end center, a 4" sq. pine post
169.9	<p>to corner No. 4, a pine post 4' long, 4" square, set 12" in the ground, surrounded by a mound of earth and stones and scribed 4 H. .1410, identical with location</p> <p>This corner is identical with corner No. 5 Galena Lode, also with corner No. 3 senator Lode, survey No. 1120, and corner No. 2, senator No. 2, survey No. 1120;</p>
	<p>Thence S. 61 deg. 51' E.</p>
309	to corner No. 1, the place of beginning.
	<p>Mgn. Var. throughout this claim is 12 deg. E.</p> <p>As far as can be determined from present development the course of the lode is N. 61 deg. 51' W. 299.2 feet, and S. 61 deg. 51' E. 10 feet from the discovery shaft.</p> <p>The conflict with the Galena Lode and conflict with the Desplain Lode are not claimed by the Helen Lode.</p>

Sta.	Feet Dir.	Length	HELEN Lat.	LODE, Dep.	D.M.D.	Double area.
1/2 S.	18 deg. 17' W.	169.9	-161.24	-53.28	-53.28	+8590.87
2/3 N.	61 deg. 51' W.	309.0	+145.74	-272.40	-378.96	-55229.63
3/4 N.	18 deg. 17' E.	169.9	+161.24	+53.28	-598.08	-96434.42
4/1 S.	61 deg. 51' E.	309.0	-145.74	+272.40	-272.40	+39699.58

Area, 1.186 Acres.

HELEN- DESPLAIN'S CONFLICT.

Sta.	B.	Length	Lat.	Dep.	D.M.D.	2 Area.
1/2 S.	18 deg. 17' W.	84.95	- 80.66	- 26.65	- 26.65	+ 2149.59
2/3 N.	61 deg. 51' W.	309.00	+145.77	-272.40	-325.70	-47477.29
3/x S.	77 deg. 44' E.	306.00	- 65.11	+299.05	-299.05	+19471.15

x is the point of intersection of end lines.

Galena Lode and Desplain's Lode,

Area, .297 acres.

GALENA- HELEN CONFLICT.

Sta.	B.	Dis.	Lat.	Dep.	D.M.D.	2 area.
1/4 S.	18 deg. 17' W.	84.95	- 80.66	- 26.65	- 26.65	+2149.59
x/4 N.	47 deg. 21' W.	334.06	+226.03	-245.75	-299.05	-67713.89
4/1 S.	61 deg. 51' E.	309.	-145.77	+272.4	-272.4	+39707.75

x is the junction of the end lines of the Galena and Desplain .

Area, .297 acres.

Total area of Helen as surveyed	1.186	acres,
Less		
Helen- Desplain conflict	.297	"
Galena-Helen conflict	.297	.594
Net Area,	----- .592 "	

Feet

## GALENA LODGE.

Beginning at cor. No. 1, the N.E. Corner of the claim, and identical with corner of location, and with corner No. 9 Morning star Lode, survey No. 1331, a pine post 4" square, 3' long, set 12" in the ground, surrounded by a mound of stones and scribed G. 1-1410;

Whence U.S. Mineral Monument No. 4 bears  
N. 28 deg. 01' W. 2135 feet,

Whence the corner of a small house bears  
S. 56 deg. 51' W.

Whence the main road to the main shaft bears  
Due N. 12 feet;

Thence S. 47 deg. 21' E.

305.5 to a monument, being the Easterly center end, a pine post 4" square, set 12" in the ground, surrounded by a mound of stones

611 feet to corner No. 2, the S.E. corner of the claim, identical with corner of location, and with cor. No. 8 Morning star Lode, survey No. 1331, a pine post 4" square, 42" above the ground, surrounded by a mound of stones and scribed G. 2-1410;

Whence a bearing rock bears

S. 76 deg. 1' W. 123 feet scribed X B.R.G. .  
2-1410;

Thence S. 65 deg. 48' W.

454.3 to a monument, being identical with corner No. 1 of the Auburn Lode, a claim of this survey

961.8 to corner No. 3, identical with corner of location, a pine post 4" square, 4' long, set 12" in the ground, surrounded by a mound of stones, scribed G. 3-1410;

Whence a rock in place on bluff bears

N. 12 deg. E. 102 feet, scribed X.B.R.G. .  
3-1410;



Feet

Thence S. 52 deg. 28' W.

353.7 to monument No. 4, a monument identical with corner No. 5 of the Auburn Lode and at the point of intersection of line 3-4 Desplain Lode;  
S. 31 deg. 11 1/2' W. 132.73 feet from corner No. 4, Desplain Lode. *scribed G. 4-1410.*

Whence a bearing rock 12" x 24" on bluff bears  
S. 10 deg. 1'E. 82 feet, scribed X B.R.G.  
4-1410;

Thence N. 47 deg. 21' W.

246.3 to a monument, identical with the W. end center of this Lode and at the intersection of line 4-1 Desplain Lode, 257.3 feet, N. 77 deg. 44' W. from corner No. 4 Desplain Lode, also at the point of intersection of line 1-2 Helen Lode, 64.95 feet S. 18 deg. 17' W. from corner No. 1 Helen Lode

582.36 to corner No. 5 of this Lode, identical with corner of location; also identical with corner No. 4 of Helen Lode, identical with corner No. 3 Senator Lode 1120; a pine post 4" square, 4' long, set 12" in the ground, surrounded by a mound of stones and scribed G. 5-1410;

Whence a bearing rock at side of gulch bears  
S. 14 deg. 20' E. 201 feet, scribed X.B.R.G.L.  
5-1410;

Thence N. 47 deg. 50' E.

350 to corner No. 6, identical with corner of location and with corner No. 3 of the Lowell claim of this survey, a pine post 4" square, 4' long, set 12" in the ground, surrounded by a mound of stones and scribed G. 6-1410, also scribed L. 3-1410;

Thence N. 65 deg. 48' E.

26.0 to center of wash; course N. 65 deg. E.  
301.0 to center of a small wash, course N. 60 deg. E.  
961.8 to corner No. 1, the place of beginning.

Feet

Magnetic variation throughout this claim N.  
12 deg. E.

The ledge on this claim is very undetermined  
but has the general course of S. 65 deg. 48' W.  
for 950 feet from the E. end center and S. 52 deg.  
28' W. for 200 feet.

This ledge is 12" wide.

No conflicts to be deducted from this claim.

(See area table at close).

Net area Galena Lode 17.179 acres.

-----  
DESPPLAIN LOBE.

Beginning at corner No. 1, the N.W. corner of  
the lode, and identical with corner of location and  
with corner No. 3 of the Helen Lode of this survey,  
a pine post 4' long, set 12" in the ground, sur-  
rounded by a mound of stones and scribed D. .1-1410;

Whence a bearing stump bears

S. 12 deg. 10' W. 123 feet, scribed B.S.D. .  
1-1410;

Whence U.S. Mineral Monument No. 4 bears

N. 3 deg. 47' E. 2662 feet,

Thence S. 31 deg. 11 1/2' W.

229.42

to intersection line between Buckeye and Senator No.  
2 Lodes N. 64 deg. 30 1/2' W. 51.66 feet, from cor.  
No. 7 B. and Cor. No. 5 S. No. 2, Survey No. 1120,

757.5

to corner No. 2, identical with corner of location,  
and corner No. 2 Buckeye, survey No. 1120- S. 51  
deg. W. from Cor. No. 1 Buckeye Lode, Survey No.  
1120, and 2150 feet, a pine post 4' long, 4" square,  
set 12" in the ground, surrounded by a mound of  
stones scribed D. .2-1410;

Feet	<p>Whence a rock in place bears S. 10 deg. E. 11 1/2 feet, scribed B.M.D. . 2-1410;</p>
302.4	<p>Thence S. 77 deg. 44' E. to S. end center, identical with corner No. 1 of the Minnesota claim, a claim of this survey,</p>
563.3	<p>to corner No. 3, identical with corner of location, a pine post 4" square, 4' long, set 12" in the ground surrounded by a mound of stones, scribed D. . 5-1410;</p>
	<p>Thence due S. a bearing stump scribed X B.S. D. .3-1410, 121 feet,</p>
76.2	<p>Thence N. 51 deg. 11 1/2' E. to intersection of line 4-5 Minnesota Lode of this survey, S. 7 deg. 20' E., 91.25 feet from Cor. No. 5 Minnesota Lode,</p>
98.70	<p>to intersection of line 3-4 Auburn Lode, S. 10 deg. 7' E. 74.26 feet from W. end center Auburn Lode,</p>
217.0	<p>to intersection of line 1-4 Boston, 89.73 feet N. 70 deg. 29' E. from corner No. 1 Boston Lode of this survey,</p>
624.72	<p>to monument, being corner No. 5 Auburn-Lode, and Cor. No. 4 Galena Lode,</p>
757.5	<p>to corner No. 4, a pine post 4" square, 4' long, set 12" in the ground, surrounded by a mound of stones and scribed D. .4-1410;</p>
	<p>Whence a bearing rock on bluff bears S. 1 deg. E. 11 feet, scribed X.M.D. . 4-1410;</p>
257.3	<p>Thence N. 77 deg. 44' W. to point of intersection of line 4-5 Galena Lode, as described in Galena notes;</p>
563.3	<p>to corner No. 1, the place of beginning. Magnetic variation throughout this claim N.</p>

Feet

12 deg. E.

The ledge on this claim bears S. 31 deg. 11 1/2' W. from discovery shaft, and can only be traced for about 200 feet on the surface.

Conflict with Minnesota not claimed; conflict with Senator No. 2 and with Buckeye, two patented claims, patented under survey No. 1120, not claimed; conflict with Auburn Lode not claimed; conflict with Boston Lode not claimed; conflict with the Galena Lode not claimed.

Total area as surveyed (Table 2)-- 9.267 A.

Less area in conflict with Senator No. 2 (Table 4),	.098	
" " " " " Buckeye, (Table 3),	.691	
" " " " " Part Auburn, (Table 8),	.795	
" " " " " Boston & Auburn (Table 9),	.077	
" " " " " Galena, (Table 6),	.371	
" " " " " Boston only (Table 9),	.015	
" " " " " Minnesota (Table 10),	.522	2.569
Net area,		<u>6.698 A.</u>

AUBURN LODGE.

Beginning at cor. No. 1, a point on line 2-3 of the Galena Lode as described in Galena Notes, a pine post 4" square, 4' long, set 12" in the ground, surrounded by a mound of stones, identical with Cor. of location and being the N. E. Cor. of the claim, scribed A. 1-1410;

Whence U.S. Mineral Monument No. 4 bears N. 23 deg. 7' W. 2639 feet.

Feet	Whence a bearing rock 12" by 2' extending over a bluff bears
	S. 11 deg. E. 160 feet, scribed X.B.R.A. 1-1410;
	Thence S. 18 deg. 7' E.
225	to the E. end center, a pine post 4" square, 4' long set 12" in the ground, surrounded by a mound of stones,
550	to corner No. 2, identical with Cor. of location, a pine post 4" square, 4' long, set 12" in the ground, surrounded by a mound of stones, scribed A. .2-1410;
	Whence a bearing stone in a small wash bears
	S. 10 deg. W. 138 feet, scribed X.B.R.A. . 2-1410;
	Thence S. 71 deg. 33' W.
954	to intersection of line 3-4 Boston Lode, 125 feet S. 7 deg. 20' E. from Cor. No. 4 of Boston Lode
1257.1	to Cor. No. 3, identical with Cor. of location, and with Cor. No. 4 of Delmar Lode, a pine post 4' long, 4" square set 12" in the ground, surrounded by a mound of stones scribed A. .3-1410;
	Whence a prominent rock bears S. 64 deg. E. 163 feet scribed X.B.R.A. .3-1410;
	Thence N. 18 deg. 7' W.
33.67	to point of intersection of line 3-4 Desplain Lode 98.7 feet N. 31 deg. 11 1/2' E. from Cor. No. 3 of the Desplain Lode;
115.61	to W. end center, identical with Cor. No. 5 of the Minnesota Lode and Cor. No. 1 of the Boston Lode, both claims of this survey,
251.22	to Cor. No. 4, a pine post, identical with Cor. of location, 4" square, 4' long, set 12" in the ground, surrounded by a mound of stones, scribed A. .4-1410;
	Whence a bearing rock 12" by 18" bears

Feet

N. 1 deg. E. 183 feet scribed X.B.R.A. .4-1410,

Thence N. 50 deg. 58' E.

427.15 to Cor. No. 5, identical with Cor. No. 4 of the Galena Lode, identical with Cor. of location, more fully described in Galena Notes; *scribed 5-A-1410.*

Thence N. 52 deg. 28' E.

353.7 to Cor. No. 6, identical with Cor. No. 3 of Galena Lode described thereunder, and identical with Cor. of location; *scribed A-6-1410.*

Thence N. 65 deg. 48' E.

527.5 to Cor. No. 1, the place of beginning.

Magnetic variation throughout this claim, N. 12 deg. E.

The ledge on this claim S. 71 deg. 33' W. 1110 feet from discovery shaft.

Conflict with Boston Lode, hereinafter described not claimed in Auburn Lode. No other conflicts to be deducted.

(See table of area at close).

Total area as surveyed	(Table 11), -	12.474 A.
Less area in conflict with Boston Lode,	(Table 12), .843	<u>.843</u>
	Net Area,	11.631 A.

-----

DELMAR LODE.

Beginning at Cor. No. 1, identical with Cor. of location, identical with Cor. No. 2 of the Auburn Lode and described thereunder; *scribed D. 1-1410.*

Thence U.S. Mineral monument No. 4 bears N. 22 deg. 01' W. 3233 feet.

Thence S. 18 deg. 7' E.

Feet	
300	to E. end center, a pine post 4" square, 4' long; set 12" in the ground, surrounded by a mound of stones
600	to Cor. No. 2, identical with Cor. of location, a pine post 4" square 4' long, set 12" in the ground, surrounded by a mound of stones, scribed D. 2-1410; Whence a rock in place bears N. 61 deg. 11' E. 13 feet scribed B.P.D. 2- 1410; Thence S. 71 deg. 53' W.
14.21	to point of intersection of line 2-3 Harrison Lode of this survey, S. 28 deg. 48' E. 24.65 feet from Cor. No. 2, Harrison Lode
603.31	to point of intersection of line 1-4 of Harrison Lode, S. 28 deg. 48' E. 74.24 feet from Cor. No. 1, Harrison Lode of this survey,
1073.31	to point of intersection of line 3-4 Boston Lode of this survey, N. 7 deg. 20' E. 318.6 feet from Cor. No. 3, Boston Lode of this survey,
1192.41	to point of intersection of line 1-4 DesMoines Lode of this survey, S. 28 deg. 48' E. 124.91 feet from Cor. No. 1 DesMoines Lode of this survey
1257.1	to Cor. No. 3, identical with Cor. of location, a pine post 4" square 4' long, set 12" in the ground, surrounded by a mound of stones, scribed D. 3-1410; Whence a rock in place bears S. 23 deg. 11' E. scribed X.B.P.D. 3-1410; Thence N. 18 deg. 7' W.
300	to W. end center;
600	to corner No. 4, identical with Cor. of location, identical with Cor. No. 3 of the Auburn Claim and fully described thereunder; scribed A.D-1410. Thence N. 71 deg. 53' E
303.1	to point of intersection of line 3-4, Boston Lode of this survey, S. 7 deg. 20' E. 123 feet from Cor. No. 4, Boston Lode,

Feet  
1257.1

to Cor. No. 1, the place of beginning.

Magnetic variation throughout this Claim, N.  
12 deg. E.

The lode on this claim bears S. 71 deg. 33' W.  
100 feet from discovery shaft and is very undeter-  
mined.

Conflict with DesMoines and that part of the  
Boston Lode included in the DesMoines given to the  
DesMoines Lode.

Boston conflict, which is not included in the  
DesMoines conflict, given to this (Belmar) Lode

(See table of area at close).

Total area as surveyed,	(Table 13)-	17.315 A.
Less area in conflict with Harrison Lode,	(Table 14),	.658
" " " " " DesMoines "	(Table 15)	<u>1.319</u>
		1.977 A.
	Net Area,	15.338 A.

-----

BOSTON LODGE.

Beginning at Cor. No. 1, being the N.W. Cor. of  
the Claim, identical with Cor. of location, a pine  
post 4" square 4' long set 12" in the ground, sur-  
rounded by a mound of stones, scribed 1- .B. .1410;  
identical with Cor. No. 5 of the Minnesota Lode of  
this survey, which see for description and bearing  
monuments;

Whence U.S. Mineral Monument <sup>No 4.</sup> bears  
N. 28 1/2' W. 3290.4 feet.

Thence S. 7 deg. 20' E.

91.2 to point of intersection of line 3-4, Desplain Lode,



Feet	
	76.2 feet N. 31 deg. 11 1/2' E. from Cor. No. 3 of the Desplain Lode,
1060.7	to Cor. No. 2, identical with Cor. of location and with Cor. No. 4 of the Minnesota Lode, a claim of this survey, monument being fully described thereunder, <i>scribed B. 2-1410.</i>
	Thence N. 70 deg. 29' E.
78.4	to a monument, being Cor. No. 1 of the Dallas Lode, a claim of this survey,
322.9	to Cor. No. 3, identical with cor. of location and with Cor. No. 2 of the Dallas Lode of this survey, a pine post 4" square, 4' long, set 12" in the ground, surrounded by a mound of stones, scribed 3- .D .1410;
	Whence a prominent bearing stone on a bluff bears
	N. 12 deg. 28' E. 111 feet, scribed X.B.F.B.J. 3-1410;
	Thence N. 7 deg. 20' W.
318.6	to point of intersection of line 2-3 of the Delmar Lode, 103.79 feet N. 71 deg. 33' E. from Cor. No. 3 Delmar Lode
431	to point of intersection of line 1-2 of the DesMoines Lode, 163 feet, N. 76 deg. 13' E. from Cor. No. 1 of the DesMoines Lode,
937.6	to point of intersection of line 2-3, Delmar Lode, 303.1 feet N. 71 deg. 33' E. from Cor. No. 4, Delmar Lode,
1060.7	to Cor. No. 4, identical with Cor. of location, a pine post 4" square, 4' long, set 12" in the ground, surrounded by a mound of stones, scribed 4- .D . 1410;
	Whence a stump 8" in diameter, scribed X.B.S.B. 4-1410; bears
	S. 13 deg. 1' E. 182 feet,

Feet

233.17 Thence S. 70 deg. 29' W.  
to point of intersection of line 3-4, Desplain Lode  
217 feet N. 31 deg. 11.5' E. from Cor. No. 3, Desplain  
Lode,  
322.9 to Cor. No. 1, the place of beginning.

Magnetic variation throughout this claim,  
N. 12 deg. E.

The ledge on this claim has the apparent  
direction of N. 7 deg. 20' W. 110 feet from dis-  
covery shaft, and S. 7 deg. 20' W. 110 feet from  
discovery shaft,

The conflict with the Auburn Lode is claimed  
by the Boston Lode. The conflict with the Delmar  
Lode is not claimed by the Boston Lode. The con-  
flict with the DesMoines Lode is not claimed by the  
Boston Lode. The conflict with the DesMoines,  
Boston and Delmar Lodes is given to the DesMoines  
Lode. The conflict with the Desplain Lode is given  
to the Boston Lode.

(See table of area at close).

(20) Total area of Boston Lode, as surveyed,	7.686 A.
(17) Area in conflict with <sup>Less</sup> Delmar Lode, which includes part DesMoines Lode,	3.33
(19) Area in conflict with DesMoines (only)	.427
	<u>3.757 A.</u>
Net Area,	3.929

DALLAS LODE.

Beginning at Cor. No. 1, being the N.W. Cor.  
of the claim, a pine post 4" square, 4' long, set  
12" in the ground, surrounded by a mound of stones,  
scribed .D. .1-1410, identical with corner of lo-  
cation, and with Cor. No. 2, Bob & John,

Feet	
	<p>Whence U.S. Mineral Monument No. 4 bears N. 2 deg. 17' W. 4321.3 feet.</p> <p>Whence a bearing rock on bank of wash bears S. 12 deg. 1' W. 201 feet, scribed X.B.P.D. .1-1410;</p> <p>Thence N. 70 deg. 29' E.</p>
244.5	<p>to Cor. No. 2, identical with Cor. of location, also identical with Cor. No. 3 of the Boston Lode, and fully described thereunder; <i>scribed D-2-1410.</i></p> <p>Thence S. 28 deg. 48' E.</p>
858.3	<p>to a monument, being Cor. No. 4, of the DesMoines Lode,</p>
1326	<p>to Cor. No. 3, identical with Cor. of location, a pine post 4" square, 4' long, set 12" in the ground, surrounded by a mound of stones, scribed X.B.P.D. .3-1410;</p> <p>Whence a rock in place 12" square, bears S. 11 deg. 58' W. 206 feet scribed X.B.P.D. .3-1410;</p> <p>Thence S. 70 deg. 29' W.</p>
300	<p>to a monument, being the S. end center,</p>
600	<p>to Cor. No. 4, identical with Cor. of location, a pine post 4" square set 12" in the ground, surrounded by a mound of stones, scribed X.B.P.D. .4-1410;</p> <p>Whence a rock in place, 12" x 36", scribed X.B.P.D. .4-1410 bears N. 1 deg. 59' W. 113 feet.</p> <p>Thence N. 28 deg. 48' W.</p>
31	<p>to monument No. 5, identical with Cor. of location and with Cor. No. 2, John &amp; James Lode 1393, and No. 3 Bob &amp; John Claim, a pine post, 4" square, 4' long, set 12" in the ground, surrounded by a mound of stones, scribed X.B.P.D. .5-1410;</p> <p>Whence a high peak bears N. 24 deg. W.</p>

Feet	
	<p>Whence a second prominent peak in distant range bears</p> <p>S. 51 deg. 2' W.</p> <p>Thence N. 13 deg. W.</p>
1286.86	<p>to Cor. No. 1, the place of beginning.</p> <p>Magnetic variation throughout this claim, N. 12 deg. E.</p> <p>The ledge on this claim is traced 100 feet N. 13 deg. W. from discovery shaft.</p> <p>No conflicts to be deducted from this claim. (See table of area at close).</p> <p>(21) Net area of the Dallas Claim, - 12.81 Acres.</p> <p style="text-align: center;">-----</p> <p style="text-align: center;">MINNESOTA LODE.</p> <p>Beginning at Cor. No. 1, the N. W. Cor. of the claim, identical with Cor. of location, and the S. end center of the Desplain Lode, and Cor. No. 2 Annie survey No. 1021, a pine post 4" square, 4' long, set 12" in the ground, surrounded by a mound of stones, scribed N. .1-1410,</p> <p>Whence U.S. Mineral Monument No. 4 bears</p> <p>N. 5 deg. 21' E., 3394.5 feet,</p> <p>Whence a rock in place bears</p> <p>S. 28 deg. 41' W. 231 feet, scribed X.B.R.H.L. 1-1410;</p> <p>Thence S. 5 deg. 30' W.</p>
462	<p>to a small wash 3 x 4, course S. 12 deg. W.</p>
568.3	<p>to Cor. No. 2, a pine post 4" square, 4' long, set 12" in the ground, surrounded by a mound of stones, scribed N. .2-1410;</p> <p>Whence a rock in place bears</p> <p>N. 10 deg. W. 12 feet, scribed X.B.R.M. .3-1410;</p>

		Thence S. 9 deg. W.
594		to Cor. No. 3, identical with Cor. of location, and with Cor. No. 5, Triangle Sur. No. 1019, a pine post 4" square, 4' long, set 12" in the ground, surrounded by a mound of earth and stones, scribed M. 3-1410; Part of the South end line of Minnesota is identical with North end line of the Triangle;
		Thence a rock in place bears
		Due S. 31 feet, scribed M.B.R.M. 3-1410;
		Thence N. 70 deg. 29' E.
216.4		to Cor. No. 6 Bob & John, Sur. No. 1020, and Cor. No. 3 Triangle, Sur. 1019,
300		to S. end center
351		to wash 3 x 4, course due S.
600		to Cor. No. 4, identical with Cor. of location, also identical with Cor. No. 2 of the Boston Lode, a pine post 4" square, 4' long, set 12" in the ground, surrounded by a mound of stones, scribed M. 4-1410;
		Thence a rock in place bears
		S. 21 deg. 12' E. 167 feet, scribed X.B.R.M.L. 4-1410;
		Thence N. 7 deg. 20' W.
969.5		to point of intersection, N. 31 deg. 11 1/2' E. 76.2 feet from Cor. No. 3 of the Desplain Lode,
1060.7		to Cor. No. 5, identical with Cor. of location, also identical with Cor. No. 1 of the Boston Lode and with the W. end center of the Auburn Lode; <i>scribed M. 5-1410.</i>
		Thence a stone in place bears
		W. 111 feet, scribed M.B.R.M.L. 5-1410;
		Thence S. 70 deg. 29' W.
300		to Cor. No. 1, the place of beginning.
		Magnetic variation throughout this claim N. 12 deg. E.
		The ledge on this claim bears S. 5 deg. 30' W. and outcrops along the surface for 700 feet from

Feet

the discovery shaft.

The conflict with the Desplain claim is claimed by the Minnesota claim. ~~\_\_\_\_\_~~

~~\_\_\_\_\_~~

(See table of area at close).

(22) Total area of claim as surveyed, 10.463 Acres.  
Net area of Minnesota Lode, 10.463 Acres.

-----  
DANVILLE LODE.

Beginning at Cor. No. 1, being the N.E. Cor. of the claim, a pine post 4" sq. set 12" in the ground identical with cor. of location and with Cor. No. 3 of the Dallas Lode of this survey, and being fully described thereunder, scribed D. .1-1410;

Thence U.S. Mineral Monument No. 4 bears  
N. 10 deg. 57' W. 5497 feet;

Thence S. 38 deg. 48' E.

987.7 to a monument, being Cor. No. 3 of the Danville Lode,  
1469. to Cor. No. 2, identical with Cor. of location, and  
with Cor. No. 2, Alice survey No. 1393, a pine post  
4" square, 4' long, set 12" in the ground, surrounded  
by a mound of stones, and scribed D. .2-1410; also  
identical with the N.E. Cor. of the Alice Lode, an  
unsurveyed claim owned by the South Bisbee Co.

Thence a bearing stone bears

Due W. 201 feet, scribed N.B.R.D. .2-1410;

Thence S. 70 deg. 29' W.

85.49 to point of intersection of line between the Christ-  
mas '96 Lode, and the Alice Lode, owned by the  
South Bisbee Co., 475.1 <sup>ft.</sup> S. 18 deg. 33' E. from Cor.  
No. 3 of the Danville Lode, a claim of this survey,

Feet	
300	to S. end center, a pine post 4" square, set 12" in the ground, surrounded by a mound of stones, scribed D. 13-1410,
600	to Cor. No. 3, identical with Cor. of location and with Cor. No. 1 Alice Survey No. 1393 and identical with Cor. No. 3 John and James Survey No. 1393. a pine post 4" square, 4' long, set 12" in the ground, surrounded by a mound of stones, scribed D. 13-1410;  Thence a bearing rock bears N. 32 deg. 11' E. 91 feet, scribed N.E.S.D. 13-1410;  Thence N. 28 deg. 48' W.
1460	to Cor. No. 4, identical with Cor. of location, and also with Cor. No. 4 of the Dallas Lode and fully described thereunder; <i>scribed 4-D-1410.</i>  Thence N. 70 deg. 29' E.
300	to N. end center, being identical with the S. end center of the Dallas Lode, a pine post 4" square set 12" in the ground, surrounded by a mound of stones
600	to Cor. No. 1, the place of beginning.  Magnetic variation throughout this claim, N. 12 deg. E.  The ledge is traceable for 150 feet, from the discovery shaft, N. 23 deg. 48' E.  No conflicts to be deducted from this lode.  (See table of areas at close).
(23) Net area of lode,	19.96 Acres.

Feet

## HANCHETT LODE.

Beginning at Cor. No. 1, being the N.W. Cor. of the Lode, identical with Cor. of location, and Cor. No. 4 of the Harrison, a claim of this survey, a pine post 4" square, 4' long, set 12" in the ground, surrounded by a mound of stones, scribed H. .1-1410;

Whence U.S. Mineral Monument No. 4 bears

N. 16 deg. 42' W. 5044.5 feet;

Whence a rock 12 x 24" bears

N. 11 deg. 1' E. 66 feet, scribed K.B.R.H. 1-1410;

Thence S. 28 deg. 46' E.

1436.3 to Cor. No. 2, identical with Cor. of location, and Cor. No. 2 of the Danville, a claim of this survey, a pine post 4" square, 4' long, set 12" in the ground surrounded by a mound of stones, scribed H. .2-1410;

Whence a bearing rock, on side of small bluff, bears

South 81 deg. 20' W. 281 feet, scribed K.B.R. H. .2-1410;

Thence N. 76 deg. 13' E.

26 to Cor. No. 3, a pine post 4" square, 4' long, set in the ground 12", identical with Cor. of location, scribed H.L.3-1410;

Whence the original location monument bears

N. 76 deg. 13' E. 210 feet;

Whence a pine post 4" square 4' long, set 12" in the ground, surrounded by a mound of stones, bears

S. 6 1/2 feet, scribed B.P.H. .3-1410;

Thence N. 17 deg. 50' W.

1391 to Cor. No. 4, identical with Cor. of location, and also identical with S.E. Center of the Harrison Lode, a claim of this survey, a pine post 4" square, 4' long, set 12" in the ground, surrounded by a



Feet

mound of stones, scribed H. .4-1410;

Whence a bearing rock bears

N. 12 deg. 28' E. 14 feet, scribed X.B.R.H. .

4-1410;

Whence S. 76 deg. 13' W.

150 to N. E. center

300 to Cor. No. 1, the place of beginning.

Magnetic variation throughout this claim, N.

12 deg. 7'.

The vein on this lode bears South 23 deg. E.

on the surface, 1100 feet from the discovery shaft.

No conflicts to be deducted from this claim.

(See table of area at close).

(24) Net area of Manchett Lode, 5.25 Acres.

-----

HIGGINS LODGE.

Beginning at Cor. No. 1, the N.W. Cor. of the

lode, identical with Cor. of location, and on the

line 2-3 of the Harrison Lode of this survey, a

pine post 4" square, 4' long, set 12" in the ground,

surrounded by a mound of stones, scribed H. .1-1410;

Whence U.S. Mineral Monument No. 4 bears

N. 21 deg. 42' W. 3987 feet.

Whence a bearing rock 12 x 24" bears

N. 81 deg. 11' W. 61 feet, scribed X.B.R.H. .

1-1410;

Whence N. 71 deg. 30' E.

200 to N. E. Center

340 to Cor. No. 2, identical with Cor. of location,

a pine post 4" Sq. 4' long, set 12" in the ground,

surrounded by a mound of stones, scribed H. .2-1410;

Feet	<p>Whence a bearing rock 12" above ground bears N. 6 deg. 2' W. 91 feet, scribed H.B.P.H. . 2-1410;</p> <p>Thence S. 14 deg. 9' E. 54.4 to a monument at the point of intersection of the N. line of the Bengal Lode, S. 82 deg. 40' W. 91.1 feet from the N.W. Cor. of the said Bengal Lode, 516.6 to Cor. No. 3, a pine post surrounded by a mound of stones, said pine post being 4" sq. 4' long, set 12" in the ground, and scribed H. 3-1410;</p> <p>Whence a bearing stump 11" in diameter bears N. 18 deg. 36' W. 84 feet, scribed H.B.S.H. . 3-1410;</p> <p>Whence original location monument bears N. 81 deg. 50' W. 86 feet;</p> <p>Thence S. 71 deg. 30' W. 221.9 to Cor. No. 4, on N. side line of Bengal (unsurvey- ed), a pine post 4" sq., 4' long, set 12" in the ground, surrounded by a mound of stones, scribed H. 4-1410;</p> <p>Thence original location monument bears S. 71 deg. 30' W. 82 feet;</p> <p>Whence a rock in place at the edge of bluff bears N. 18 deg. 41' W. 16 feet, scribed B.P.V. . 4-1410;</p> <p>Thence S. 20 deg. 40' W. 523 to Cor. No. 1, the place of beginning.</p> <p>Magnetic variation throughout this claim, N. 10 deg. E.</p> <p>The ledge outcrops on this vein for 100 feet S. 26 deg. <sup>E</sup> 200 feet from the discovery shaft.</p> <p>Conflict with the Bengal Lode not claimed. (See table of area at close).</p>
------	---

Feet

(25) Total area of claim as surveyed,	3.229 Acres
(26) Conflict with Bengal Lode, <u>1.615</u>	"
Net area of Higgins Claim,	1.614 Acres

-----

DANVILLE LODGE.

Beginning at Cor. No. 1, being the N. W. Cor. of the Claim, identical with Cor. of location, a pine post 4" sq., 4' long, set 12" in the ground, surrounded by a mound of stones and scribed D. .1-1410;

Thence U.S. Mineral Monument No. 4 bears

N. 16 deg. 39' W. 5025.4 feet,

Thence a rock in place bears

S. 18 deg. 33' W. 213 feet, scribed N.E.R.D. .

1-1410;

Thence S. 28 deg. 48' W.

19.5 to a monument being Cor. No. 1 of the Manchett Lode of this survey,

1455.8 to Cor. No. 2, identical with Cor. of location, and with Cor. No. 2, Manchett lode, a claim of this survey, a pine post 4" sq. 4' long, set 12" in the ground, surrounded by a mound of stones, scribed D. .2-1410;

Thence S. 76 deg. 13' W.

300 to the S. end center, a pine post 4" sq. 4' long, set 12" in the ground, surrounded by a mound of stones,

600 to Cor. No. 3, being identical with Cor. of location, a pine post 4" sq. 4' long, set 12" in the ground, surrounded by a mound of stones, scribed D. .3-1410; identical with Cor. No. 1, Christmas '96 Survey No. 1393;

Feet

987.7 Thence N. 28 deg. 48' W.  
to a monument, being Cor. No. 1 of the *Delevin*  
Lode, a claim of this survey,

1455.8 to Cor. No. 4, identical with Cor. of location, also  
identical with Cor. No. 4 of the DesMoines Lode,  
a claim of this survey, a pine post 4" sq. 4' long,  
set 12" in the ground, surrounded by a mound of  
stones, scribed D. 4-1410;

Thence a rock in place 12" x 24" bears  
N. 86 deg. 22' E. 191 feet, scribed M.B.F.D. 4-1410;

Thence N. 76 deg. 13' E.  
300 to N. end center, a pine post 4" sq. 4' long, set  
12" in the ground, surrounded by a mound of stones,

500 to Cor. No. 1, the place of beginning.

Magnetic variation throughout this claim,  
N. 12 deg. E.

The ledge on this lode is traceable for 400  
feet from the discovery shaft, N. 28 deg. 48' W.

No conflicts to be deducted from this lode.  
(See table of area at close)

(Table 27) Net and Total area of lode, 19.34 Acres.

-----

DES MOINES LODE.

Beginning at Cor. No. 1, identical with Cor.  
of location, a pine post 4" sq., 4' long, set 12"  
in the ground, surrounded by a mound of stones, and  
scribed D.M. 1-1410;

Thence a stone in place bears

S. 64 deg. 11' E. 86 feet, scribed X.B.R.D.M.  
1-1410;

	<p>Whence U.S. Mineral Monument No. 4 bears N. 3 deg. 14' E. 3857 feet;</p> <p>Thence N. 76 deg. 13' E.</p>
163	to point of intersection of line 3-4, Boston Lode, 431 feet N. 7 deg. 30' E. from Cor. No. 3, Boston Lode,
300	to N. end center, a pine post 4" sq. 4' long, set 12" in the ground, surrounded by a mound of stones,
600	to Cor. No. 2, identical with Cor. of location and with Cor. No. 1 of the Harrison Lode of this survey, a pine post 4" sq. 4' long set 12" in the ground, surrounded by a mound of stones and scribed B.M. 2-1410;
	<p>Whence a bearing rock 24" sq. bears S. 10 deg. 22' E. 111 feet, scribed H.B.R.D.M. 2-1410;</p> <p>Thence S. 26 deg. 48' E.</p>
74.24	to a point on line 2-3 of the Pelmar Lode, S. 71 deg. 53' E. 303.31 <sup>feet</sup> from Cor. No. 2 of the Pelmar Lode,
1300	to Cor. No. 3, identical with Cor. of location, also identical with Cor. No. 1 of the Danville Lode and fully described thereunder; <i>scribed D.M. 3-1410.</i>
	<p>Thence <sup>S</sup> 76 deg. 13' E.</p>
300	to a monument being the S. end center of the claim and identical with the N. end center of the Dan- ville Lode, a claim of this survey;
600	to Cor. No. 4, identical with Cor. of location and with Cor. No. 4 of the Danville Lode, a claim of this survey and fully described thereunder; <i>scribed D.M. 4-1410.</i>
	Thence N. 26 deg. 48' W.
858.3	to a monument, being Cor. No. 2 of the Dallas Lode,
1175.1	to point of intersection of line 2-3 of the Pelmar Lode, 64.69 feet N. 71 deg. 53' E. from Cor. No. 3 of the Pelmar Lode,
1300	to Cor. No. 1, the place of beginning.

Feet	
	<p>Magnetic variation throughout this Lode, N. 12 deg. E.</p> <p>The ledge on this lode outcrops for 113 feet from the discovery shaft. Course, N. 26 deg. 48' W.</p> <p>No conflicts to be deducted from this lode. (See table of area at close).</p> <p>(20) Net area of this claim, 17.24 Acres.</p>
	-----
	HARRISON LODGE.
	<p>Beginning at Cor. No. 1, being the N.W. Cor. of the claim, identical with Cor. of location, also with Cor. No. 2 of the Pesicines Lode, a claim of this survey, and fully described thereunder, <i>scribed</i> <i>H-1-1410.</i></p> <p>Thence U.S. Mineral Monument No. 4 bears N. 11 deg. 12' W. 3793 feet</p> <p>Thence S. 76 deg. 13' W.</p>
500	to N. end center, a pine post 4" sq. 4' long, set 12" in the ground, surrounded by a mound of stones,
120	to Cor. No. 3, identical with Cor. of location, a pine post, 4" sq. 4' long, set 12" in the ground, surrounded by a mound of stones and scribed N.L. 2-1410;
	Thence a bearing rock 14" x 31" bears N. 21 deg. 11 1/2' E. 16 feet scribed U.S.M.M. 2-1410;
	Thence S. 26 deg. 46' W.
24.65	to point of intersection of line 2-3, Delmar Lode, S. 71 deg. 33' W. 14.21 feet from Cor. No. 3, Delmar Lode,
173.32	to a monument being Cor. No. 1 of the Higgins Lode, a claim of this survey
696.32	to intersection of the W. line of the Bengal Lode,

Feet	<p>(an unsurveyed claim), 617.5 feet N. 45' W. from Cor. No. 4 of the Hanchett Lode of this survey, to Cor. No. 3, identical with Cor. of location, a pine post 4" sq. 4' long, set 12" in the ground, surrounded by a mound of stones and scribed N. 3-1410;</p>
1319.5	<p>Thence N. 11 deg. 36' W. 201 feet, to a rock in place 2 feet sq. scribed N.B.R.H. 3-1410;</p>
300	<p>Thence S. 76 deg. 13' W. to N. end center, being identical with Cor. No. 4 of the Hanchett Lode, a claim of this survey;</p>
450	<p>to N.W. Cor. Mon. Hanchett Lode, a claim of this survey;</p>
600	<p>to Cor. No. 4 of the Harrison Lode, a pine post 4" sq. 4' long set 12" in the ground and surrounded by a mound of stones, scribed N. 4-1410, identical with Cor. No. 1, Hanchett Lode, a claim of this survey;</p>
	<p>Thence a bearing rock 12" x 31" scribed N.B.R. H. 4-1410 bears</p>
	<p>S. 10 deg. 21' W. 161 feet;</p>
	<p>Thence N. 28 deg. 46' W.</p>
19.5	<p>to a monument, being identical with Cor. No. 3 of the Des Moines Lode, a claim of this survey,</p>
1245.23	<p>to point of intersection of line 2-3, Pelmar Lode, S. 71 deg. 33' W. 503.51 feet from Cor. No. 2, Pelmar Lode,</p>
1319.5	<p>to Cor. No. 1, the place of beginning.</p>
	<p>Magnetic variation throughout this Lode is N. 12 deg. E.</p>
	<p>As far as can be determined from present developments, the vein on this lode is N. 28 deg. 46' W. 231 feet, and S. 28 deg. 46' E. 1088.5 feet from the discovery shaft.</p>

Feet

The conflict with the Delmar Lode is claimed by this, the Harrison Lode. The conflict with the Bengal is not claimed by this, the Harrison Lode.

(See table of area at close).

(29) Area of Lode as surveyed,	17.54 Acres
(30) Area Bengal-Harrison conflict, <u>2.70</u>	<u>      "      </u>
Net Area of Lode,	14.84 "

-----



## ADJOINING CLAIMS.

This group of claims is bounded as follows:  
North of the Galena, the Black Jack, unsurveyed, owned by the Copper Queen Mining Co.

East of the Galena, the Morning Star, Sur. No. 1331, owned by the Copper Queen Mining Co.

East of the Auburn, Balmar and part of the Harrison, the Del Norte Claim, unsurveyed, owned by Thomas Higgins.

East of the Higgins and part of the Harrison, the Bengal, unsurveyed, owned by Brophy & O'Hara.

East of Higgins and Harrison, the Bengal, unsurveyed, owned by Brophy & O'Hara.

East of the Hanchett, the Rathmoon, unsurveyed, owned by Brophy & O'Hara.

South of the Hanchett and Danville, the Christmas '96, Survey No. 1393, owned by the South Bisbee Co. (A small vacant strip intervenes between the Hanchett, Danville and the Christmas '96).

South of the Delevan, the Alice, Survey No. 1393, owned by the South Bisbee Co.

West of the Dallas and south of the Minnesota, the Bob & John, Survey No. 1020, owned by the South Bisbee Mining Co.

West of the Delevan, the John & James, a patented claim, survey No. 1393, owned by the South Bisbee Co.

West of the Minnesota, the Annie, Survey No. 1021, owned by the South Bisbee Co., touches Minnesota only at cor. No. 1 of Minnesota.

West of the Desplain, the Buckeye and the Senator No. 2, two patented claims, Survey No. 1120, owned by Costello.

North-west of Galena and Lowell, the Senator a patented claim, survey No. 1120, owned by C.Q.M.Co.

South of the Minnesota, the Triangle, Survey  
No. 1019.

-----  
CERTIFICATE OF \$500. WORTH OF WORK.

I, James W. Trotter, United States Deputy Mineral Surveyor for the Territory of Arizona, certify that the amount of work done by claimant or grantors, for the benefit of each claim of this group, viz. The Galena, the Lowell, the Helen, the Desplain, the Auburn, the Delmar, the Boston, the Minnesota, the Dallas, the Des Moines, the Harrison, the Delevan, the Deville, the Wanchett, and the Higgins, exceeds Five Hundred Dollars (\$500.); the work being described more explicitly as follows:

From corner No. 4, Galena Lode, the main shaft bears N. 36 deg. 11' E. 217 feet. This is a double compartment shaft, (at this date), 360 feet deep, with drifts and cross-cuts running in all directions from both the 200 and the 300 ft. level, there being 420 feet of drifts and cross-cuts on the 200 ft. level and 95 feet of drifts and cross-cuts on the 300 ft. level. The drifts, cuts, etc. show conclusively that they intend to develop the entire 15 claims herewith contained in this survey. Location of shaft, with reference to rail-road facilities, also with reference to fuel and water show further that the above named shaft is intended to develop the entire group of 15 claims.

Thirty Thousand dollars (\$30,000.) is a conservative estimate of the value of the work from this shaft, which is to be divided as follows:

1/15 to the Galena, 1/15 to the Lowell, 1/15 to the Helen, 1/15 to the Desplain, 1/15 to the

Auburn, 1/15 to the Delmar, 1/15 to the Boston,  
1/15 to the Minnesota, 1/15 to the Dallas, 1/15 to  
the Des Moines, 1/15 to the Harrison, 1/15 to the Dela-  
van, 1/15 to the Danville, 1/15 to the Hanchett, and  
1/15 to the Higgins. This work will hereafter be  
designated as the main shaft.

-----  
WORK ON THE CALIFIA LODE.

		Value.
	From the E. end center,	
Shaft #1	the discovery shaft, 6' x 4' x 10' bears S. 65 deg. 48' W. 52 feet,	\$100.
	From corner No. 3,	
Shaft #2	6' x 4' x 76' bears N. 28 deg. 12' E. 301 feet,	750.
	From corner No. 3,	
Shaft #3	6' x 4' x 10' bears N. 10 deg. 11' W. 101 feet,	100.
	From corner No. 3,	
Shaft #4	6' x 4' x 10' bears N. 68 deg. 21' W. 311 feet,	100.
	From the W. end center,	
Shaft #6	6' x 4' x 10' bears N. 12 deg. 13' E. 24 feet,	100.
	From corner No. 6,	
Tunnel #5	6' x 4' x 10' bears S. 46 deg. 1' W. 281 feet.	100.
	1/15 undivided interest of main shaft.	<u>2000.</u>
		\$3260.

-----  
WORK ON LOWELL LODE.

	From cor. No. 1,	
Shaft #1	6' x 4' x 10' bears S. 10 deg. E. 84 feet,	100.
	1/15 undivided interest of main shaft,	<u>2000.</u>
		\$2100.

-----

		Value.
WORK ON HELEN LOBB.		
From the south-easterly end center		
Shaft #1	discovery shaft, 10' x 4' x 10' bears N. 61 deg. 51' W. 10 feet,	\$100.
Shaft #2	6' x 4' x 10' bears N. 58 deg. 51' W. 18.5 feet	100.
	1/15 undivided interest in main shaft,	<u>2000.</u>
		\$2200.

-----		
WORK ON THE DECPAIN LOBB.		
From the N. end center		
Shaft #1	Discovery shaft 6' x 4' x 10' bears S. 31 deg. 11 1/2' W. 186 feet	100.
Tunnel #2	6' x 4' x 31' bears S. 28 deg. 10' W. 311 feet, course of tunnel S. 86 deg. E.	310.
	1/15 undivided interest of main shaft,	<u>2000.</u>
		\$2410.

-----		
WORK ON AUBURN LOBB.		
From the N. end center		
Shaft #1	discovery shaft 6' x 4' x 10' bears S. 71 deg. 53' W. 111 feet	100.
	From corner No. 2	
Shaft #2	6' x 4' x 10' bears S. 32 deg. 10' W. 801 feet	100.
	From corner No. 3	
shaft #3	6' x 4' x 10' bears N. 66 deg. 12' E. 214 feet	100.
	1/15 undivided interest of main shaft	<u>2000.</u>
		\$2300.

		Value.
WORK ON DENMAR LODGE.		
	From the N. end center	
shaft #1	discovery shaft 6' x 4' x 10' bears S. 71 deg. 33' W. 401 feet	\$100.
	From corner No. 3	
Tunnel #2	6' x 4' x 33', course N. 11 deg. W. bears N. 67 deg. 56' W. 515 feet	310.
	From the W. end center	
Shaft #3	6' x 4' x 10' bears S. 88 deg. 24' E. 416 feet	100.
	1/15 undivided interest of main shaft,	<u>2000.</u>
		\$2510.
-----		
WORK ON BOSTON LODGE.		
	From corner No. 4	
Shaft #1	Discovery shaft 6' x 4' x 10' bears due S. 801 ft.	100.
	From corner No. 4	
Shaft #2	6' x 4' x 10' bears S. 13 deg. 10' W. 167 feet	100.
	1/15 undivided interest of main shaft,	<u>2000.</u>
		2200.
-----		
WORK ON MINNESOTA LODGE.		
	From corner No. 5	
Tunnel #1	discovery tunnel 6' x 4' x 18' bears S. 5 deg. 32' W. 110 feet	180.
	From S. end center	
Shaft #2	6' x 4' x 10' bears N. 9 deg. 28' E. 400 feet	100.
	1/15 undivided interest of main shaft,	<u>2000.</u>
		\$2280.

WORK ON DALLAS LODE.		Value.
	From S. end center	
shaft #1	discovery shaft 6' x 4' x 10' bears N. 28 deg. 48' W. 12 feet	\$100.
	From corner No. 2	
Tunnel #2	6' x 4' x 28' bears S. 12 deg. 10' W. 111 feet	280.
	1/15 undivided interest of main shaft,	<u>2000.</u>
		\$2380.
-----		
WORK ON DESMOINES LODE.		
	From the S. end center	
shaft #1	discovery shaft 6' x 4' x 10' bears N. 28 deg. 48' W. 4.8 feet	100.
	From corner No. 2	
shaft #2	6' x 4' x 10' bears S. 21 deg. 11' E. 331 feet	100.
	1/15 undivided interest of main shaft,	<u>2000.</u>
		\$2200.
-----		
WORK ON HARRISON LODE.		
	From the N. end center	
shaft #1	discovery shaft 6' x 4' x 10' bears S. 28 deg. 48' E. 231 feet	100.
	From corner No. 4	
Tunnel #2	6' x 4' x 28' course due N. bears N. 62 deg. 22' E. 297 feet	280.
	1/15 undivided interest of main shaft,	<u>2000.</u>
		\$2380.

WORK ON DELEW/IN LODE.		Value.
	From the N. end center	
Shaft #1	discovery shaft 6' x 4' x 10' bears S. 28 deg. 48' E. 21 feet	\$100.
	From corner No. 2	
Tunnel #2	6' x 4' x 42' bears N. 38 deg. 1' W. 561 feet, course of tunnel S. 80 deg. E.	420.
	From corner No. 4	
shaft #3	6' x 4' x 10' bears S. 55 deg. 22' E. 611 feet	100.
	1/15 undivided interest of main shaft,	<u>2000.</u>
		\$2620.
-----		
WORK ON DANVILLE LODE.		
	From S. end center	
Shaft #1	discovery shaft 6' x 4' x 10' bears N. 28 deg. 48' W. 81 feet,	\$100.
shaft #2	6' x 4' x 10' bears N. 23 deg. 11' W. 301 feet	100.
	From corner No. 4	
Shaft #3	6' x 4' x 10' S. 52 deg. 31' E. 633.5 feet	100.
	1/15 undivided interest of main shaft,	<u>2000.</u>
		\$2300.
-----		
WORK ON HANCOCK LODE.		
	From N. end center	
shaft #1	discovery shaft 6' x 4' x 10' bears S. 20 deg. 44' E. 93 feet	100.
	1/15 undivided interest of main shaft,	<u>2000.</u>
		\$2100.

WORK ON HIGGINS LODE.

Value.

	From W. end center	
Shaft #1	discovery shaft 6' x 4' x 10' bears S. 31 deg. E. 47 feet	\$100.
Tunnel #2	6' x 4' x 6' bears S. 28 deg. <sup>E</sup> / <sub>1</sub> 29 feet, course W. 1/15 undivided interest of main shaft,	60. <u>2000.</u>
		\$2160.

A R E A S

Lowell Lode,-----	.307 Acres
Helen Lode,-----	.592 "
Galena Lode,-----	17.179 "
Desplain Lode,-----	6.698 "
Auburn Lode,-----	11.631 "
Delmar Lode,-----	15.338 "
Boston Lode,-----	5.929 "
Dallas Lode,-----	12.810 "
Minnesota Lode,-----	10.463 "
Delevan Lode,-----	19.960 "
Hanchett Lode,-----	3.250 "
Higgins Lode,-----	1.614 "
Darville Lode,-----	19.340 "
DesMoines Lode,-----	17.240 "
Harrison Lode,-----	14.840 "
Total Net Area Group,-----	157.191 "

This survey was made with a Jeller and Brightley Transit and the distances measured with one 300 foot steel tape and one 100 foot steel tape; The courses were deflected from the true meridian as determined by solar observations and checked by observations on Polaris.



These claims are situated in the Warren Mining District, Gila Land District, Cochise County, Territory of Arizona; Township, approximately, 23 South, Range 24 East, Gila and Salt River Base and meridian.

Signed and dated this 20th day of December, 1899.

*James F. Drotter*

U. S. Deputy Mineral Surveyor.

Bisbee, Arizona.

*Returned corrected*

*2/28-1900*

*J. F. D.*

# FINAL OATHS FOR SURVEYS.

## LIST OF NAMES.

A list of the names of the individuals employed by James F. Trotter  
 United States Deputy Mineral Surveyor, to assist in running, measuring, and marking the lines  
 corners and boundaries described in the foregoing field notes of the survey of the mining claim of  
Lowell, Arizona m & S Co.  
 known as the Galeana Hillen Lowell Joseph Auburn Fremont Minnesota Boston Geo. Mason Harrison Arnold Alameda Dallas Delavan & Higgins  
 and showing the respective capacities in which they acted.

E. E. Carter, Chairman.  
Geo. McMillan, Chairman.  
 \_\_\_\_\_, Axman.  
 \_\_\_\_\_, Flagman.

## FINAL OATHS OF ASSISTANTS.

We, E. E. Carter & Geo Mcmillan  
 and \_\_\_\_\_, do solemnly swear that we assisted James F. Trotter  
 \_\_\_\_\_, United States Deputy Mineral Surveyor, in marking the corners and  
 surveying the boundaries of the mining claim of herein named  
~~claims~~ \_\_\_\_\_  
 \_\_\_\_\_, known as the (above  
named) \_\_\_\_\_, represented  
 in the foregoing field notes as having been surveyed by said deputy mineral surveyor and under  
 his direction; and that said survey has been in all respects, to the best of our knowledge and  
 belief, faithfully and correctly executed, and the corner and boundary monuments established  
 according to law and the instructions furnished by the United States Surveyor-General for  
Arizona

E. E. Carter, Chairman.  
Geo Mcmillan, Chairman.  
 \_\_\_\_\_, Axman  
 \_\_\_\_\_, Flagman.

Subscribed and sworn to by the above-named persons before me  
 this 11<sup>th</sup> day of December, 18 99

J. H. Williams

NOTARY PUBLIC.  
 In and for Cochise County, Arizona Territory.  
 (My Commission expires December 15th, A. D., 1901.)

(4-686.)

FINAL OATH OF U. S. DEPUTY MINERAL SURVEYOR

I, James E. Trotter, U. S. Deputy Mineral Surveyor, do solemnly swear that, in pursuance of instructions received from the United States Surveyor General for \_\_\_\_\_, dated \_\_\_\_\_, 18\_\_\_\_, I have, in strict conformity to the laws of the United States, the official regulations and instructions thereunder, and the instructions of said Surveyor General, faithfully and correctly executed the survey of the Mining Claim of \_\_\_\_\_

*Dabney, Hatcher, Coward, Douglas, Auburn, Wilcox, Maricopa, Boston, or Maricopa, Harrison, Cornville, Hancock, Yuma, Pinal, Gila*

\_\_\_\_\_ , known as the \_\_\_\_\_ Mining District, situate in \_\_\_\_\_ County, \_\_\_\_\_, in Section \_\_\_\_\_, Township No. \_\_\_\_\_, Range No. \_\_\_\_\_

and designated as Survey No. \_\_\_\_\_, as represented in the foregoing field notes, which accurately show the boundaries of said mining claim as distinctly marked by monuments on the ground, and described in the attached copy of the location certificate, which was received by me from the Surveyor General with said instructions, and that all the corners of said survey have been established and perpetuated in strict accordance with the law, official regulations and instructions thereunder; and I do further solemnly swear that the foregoing are the true and original field notes of said survey and my report therein, and that the labor expended and improvements made upon said mining claim by claimant or \_\_\_\_\_ grantors are as therein fully stated, and that the character, extent, location and itemized value thereof are specified therein with particularity and full detail, and that no portion of said labor or improvements so credited to this claim has been included in the estimate of expenditures upon any other claim.

James E. Trotter  
U. S. Deputy Mineral Surveyor.

Subscribed and sworn to by the said James E. Trotter  
U. S. Deputy Mineral Surveyor, before me J. K. Williams  
a Notary Public this 11<sup>th</sup>  
day of December, 1899.

J. K. Williams  
NOTARY PUBLIC.  
In and for Cochise County, Arizona Territory.  
(My Commission expires December 15th, A. D., 1901.)

Affidavit of Five Hundred Dollars Improvements.

we, A. V. Lewis, and James Letson

of lawful age, being first duly sworn according to law, depose and say: that we are acquainted with the \_\_\_\_\_ mining claim, situate

in Warren Mining Mining district, Cochise County,

Arizona Territory, for which F. C. Dennis Atty in fact

for Lewell Arizona C M & S Co

has made application for survey prior to application for patent under the provisions of the Act of Congress, approved May 10, 1872; and that the labor done and improve-

ments made thereon by the applicant and ~~the~~ grantor exceed Five Hundred Dollars in value <sup>for each</sup> and further that we are not personally interested in said mine.

A. V. Lewis  
James Letson

TERRITORY OF ARIZONA, }  
County of Cochise } ss:

Sworn to and subscribed before me, this 1<sup>st</sup>  
day of December, 1899.

S. K. Williams  
NOTARY PUBLIC.  
In and for Cochise County, Arizona Territory.  
(My Commission expires December 15th, A. D., 1901.)

# Notice of Mining Location.

## LODE CLAIM.

Notice is hereby Given, That the undersigned, in compliance with the Mining Act of Congress, approved May 10th, 1872, and of the Laws of Arizona Territory, ha<sup>d</sup> this day located Three hundred feet along the course of this lead, lode or vein of mineral-bearing rock, being fifty feet in a northerly direction, and two hundred and fifty feet in a southerly direction, from the center of the Discovery Shaft, where this notice is posted, together with ~~three hundred~~ sixty five feet in width of the surface ground on each side of the middle of said lead, lode or vein, situate in the Warren Mining District Cochise County, Arizona Territory, and more particularly described as follows, to-wit:

Commencing at a monument of stones about fifty feet in a northerly direction from center of said Discovery Shaft, being the center end monument of the north end of claim; thence in a westerly direction sixty five feet to a monument of stones, the North west corner of the claim; thence in a southerly direction one hundred and fifty feet to a monument of stones, the center of the west side boundary line of claim; thence in same direction one hundred and fifty feet, to a monument of stones, the South west corner of claim; thence in an easterly direction sixty five feet, to a monument of stones, the center end monument of the south end of claim; thence in same direction sixty five feet, to a monument of stones, the South east corner of claim; thence in a northerly direction one hundred and fifty feet, to a monument of stones, the center of East side boundary line of claim; thence in same direction one hundred and fifty feet to a monument of stones, the North east corner of claim; thence in a westerly direction sixty five feet to place of beginning, the first-mentioned center end monument of claim.

This claim is situate about one mile south east of The Holbrook shaft owned by the Copper Queen Co and said claim is bounded on the west side by The Senator a patented claim and on the east side by a claim known as Galena and shall be known as the Lowell mine.

Located June 3<sup>rd</sup> 1899.

Lowell Arizona Copper Mining & Smelting Co  
per J. C. Dummer Attorney in fact



For diagram for locating Claim, and Law of Arizona, see other side of this Notice.



ADDITIONAL AND AMENDED LOCATION CERTIFICATE.

-----oOo-----

45

Territory of Arizona. )  
 County of Cochise. ) s. s.

KNOW ALL MEN BY THESE PRESENTS:, That the Lowell and Arizona Copper Mining and Smelting Company, the undersigned, has this 13<sup>th</sup> day of September 1899, amended, located and claimed, by right of the original discovery, and this additional and amended location certificate in compliance with the Mining Acts of Congress, approved May 10th 1872, and all subsequent Acts and the Legislative Laws of Arizona, and with local customs, laws and regulations, 1286 linear feet and horizontal measurement on the "Galena" lode, vein, ledge, or deposit, along the vein thereof, with all its dips, angles and variations, as allowed by law, together with 298 feet on each side of the middle of the said vein at the surface, so far as can be determined from present developments, and all veins, lodes, ledges or deposits and surface ground within the lines of said claim, about 46 feet running in a North easterly direction, from the center of the discovery shaft, and 1240 feet running in a South westerly direction from the center of the discovery shaft. Said discovery shaft being situated upon said lode, vein, ledge or deposit, and within the lines of said claim, in Warren Mining District, County of Cochise, Territory of Arizona, and described by metes and bounds as follows, to wit:

Beginning at the Easterly end center at a 4"x4" pine post, set in a mound of stones, on which this notice is posted, running thence S. 43° 13' E. 298 feet to a monument a 4"x4" pine post set in a mound of stones, this being the South east corner of the claim.

Thence S 65° 45' W., 936 feet to a monument a 4"x4" pine post set in a mound of stones.

Thence S 47° 50' W, 350 feet to a monument a 4"x4" pine post set in a mound of stones, this being the South west ~~xx~~ corner of the claim.

Thence North 43° 13' W 298 feet to a monument a 4"x4" pine post set in a mound of stones, this being the Westerly end center of the claim.

Thence N 43° 13' W 298 feet to a monument 2 4"x4" pine post set in a mound of stones, this being the North west corner of the claim, it being identical with patent monument 3-1120 Senator Lode.

Thence N. 47° 50' E. 350 feet to a monument a 4"x4" pine post set in a mound of stones.

Thence N. 65° 45' E, 936 feet to a monument a 4"x4" pine post set in a mound of stones; this being the North easterly corner of the claim.

Thence S 43° 13' E 298 feet to a monument a 4"x4" pine post set in a mound of stones, the place of beginning.

The above bearings refer to the true North Magnetic variation 11° 50' E.

This lode was originally located on the 3rd day of February 1879 by John F Bland, and was filed and recorded March 31st 1879, at the request of John F Bland, in book 4 page 67, Records of Mines. Transcribed records of Pima County Arizona. Refer to book F page 152 Pima County Records and this further additional and amended certificate of location is made without waiver of any previously acquired rights but for the purpose of correcting any errors in the original, location, description or record, and of taking in



and acquiring all forfeited or abandoned overlapping ground and of taking in any part of any overlapping claim which has been abandoned.

Posted on the ground this 13<sup>th</sup> day of September 1899.

Laurie & Arizona Copper Mining & Smelting Co

Per D. E. Jones Attorney in fact

Recorded at request of J. B. Jenner this 16<sup>th</sup> day of September 1899 at 9 o'clock A.M.

Book 15 Page 48-49

Haus Stare

County Recorder.



"Galena"

**Recorder's Office,  
TOMBSTONE, Cochise Co., A. T.**

Filed and recorded at request of  
*Geo. Tomner* .....

Sept. 16<sup>th</sup> ..... A. D. 1849

at *9 A* ..... M.

Book *15* Record of *M* .....

Pages *48 - 49* .....

*Frank Starr* .....

County Recorder.

ADDITIONAL AND AMENDED LOCATION CERTIFICATE.

-----oOo-----

Territory of Arizona.        )  
 County of Cochise.            ) s. s.

KNOW ALL MEN BY THESE PRESENTS: That the Lowell and Arizona Copper Mining and Smelting Company, the undersigned, has this 13<sup>th</sup> day of September 1899, amended, located and claimed, and by these presents does amend, locate and claim, byk the right of the original discovery and this additional and amended location certificate, in compliance with the Mining Acts of Congress, approved May 10th 1872, and all subsequent Acts, and the Legislative Laws of Arizona, and with local customs, laws and regulations, 350 linear feet and horizontal measurement on the "Helen" lode, vein, ledge or deposit along the vein hereof, with all its dips, spurs~~and~~, angles and variations as allowed by law, together with 100 feet on each side of the middle of the said vein at the surface, so far as can be determined from present developements, and all veins, lodes, ledges or deposits, and surface ground within the lines of said claim, 20 feet running easterly from center of discovery shaft, and 330 feet running westerly from center of discovery shaft; said discovery shaft being situate upon said lode, vein, ledge or deposit, and within the lines of said claim in Warren Mining District, County of Cochise, Territory of Arizona, described by metes and bounds as follows, to wit:

Beginning at the Easterly end center, at a 4"x4" pine post set in a mound of stones, on which this notice is posted, and running thence in a Southerly direction, 100 feet to a monument, a 4"x4" pine post set in a mound of

stones, this being the South east corner of the claim.

Thence in a Westerly direction 175 feet to a monument a 4"x4" pine post set in a mound of stones, this being the center side monument of the South side of the claim.

Thence in a Westerly direction 175 feet to a monument, a 4"x4" pine post set in a mound of stones, this being the South west corner of the claim.

Thence in a Northerly direction 100 feet to a monument a 4"x4" pine post, set in a mound of stones, this being the West end center of the claim.

Thence in a northerly direction 100 feet to a monument a 4"x4" pine post set in a mound of stones, this being the North west corner of the claim.

Thence in an Easterly direction 175 feet to a monument a 4"x4" pine post set in a mound of stones, this being the center of the North side of the claim.

Thence in an easterly direction 175 feet to a monument a 4"x4" pine post set in a mound of stones, this being the North east corner of the claim.

Thence in a Southerly direction 100 feet to a monument a 4"x4" pine post set in a mound of stones, the East end center of the claim, and the place of beginning.

This lode and claim is bounded on the West by Senator No. 2, a patented claim. On the South it is bounded by a claim known as the "Desplaines". On the North it is bounded by a claim known as the "Galena". Conflict with "Desplaines" and "Galena" not claimed. It is situated about seventeen hundred feet in a South westerly direction from a side track on the Arizona and South Eastern Rail Road, called South

Bisbee.

This lode was originally located by the Lowell and Arizona Copper Mining and Smelting Company on the 10th day of April 1899, and is recorded in Book 14 Records of Mines, at Page 796, in the office of the County Recorder at Tombstone, Cochise County, Territory of Arizona, and this further and additional and amended certificate of location, is made without waiver of any previously acquired rights, but for the purpose of correcting any errors in the original location, description or record, and of taking in and acquiring all forfeited or abandoned overlapping ground and of taking in any part of any overlapping claim which has been abandoned.

Posted on the ground this 13<sup>th</sup> day of September 1899.

Lowell & Arizona Copper Mining & Smelting Co

Per J. C. Fenner Attorney in fact

Recorded at the request of F. C. Fenner this 16<sup>th</sup> day of

September 1899 at 9 o'clock AM in Book 15 Page 45246

Franz Han

County Recorder.



"Helein"

Recorder's Office,

TOMBSTONE, Cochise Co., A. T.

Filed and recorded at request of

H. Jenner

Sept 16<sup>th</sup> A. D. 1899

at 4 A M.

Book N Record of M.

Pages 45 - 46

Frank Hare

County Recorder.

*[Faint, mostly illegible text, possibly bleed-through from the reverse side of the page]*

*[Vertical handwritten note on the right margin]*

Copy

# Notice of Mining Location.

## LODE CLAIM.

Notice is hereby Given, That the undersigned, in compliance with the Mining Act of Congress, approved May 10th, 1872, and of the Laws of Arizona Territory, ha... this day located Three hundred feet along the course of this lead, lode or vein of mineral-bearing rock, being forty feet in a North western direction, and two hundred and sixty feet in a South eastern direction, from the center of the Discovery <sup>tunnel</sup> Shaft, where this notice is posted, together with <sup>one</sup> ~~three~~ hundred feet in width of the surface ground on each side of the middle of said lead, lode or vein, situate in the Warren Mining District Cochise County, Arizona Territory, and more particularly described as follows, to-wit:

Commencing at a monument of stones about forty feet feet in a North western direction from center of said Discovery <sup>tunnel</sup> Shaft, being the center end monument of the North west end of claim; thence in a South western direction one hundred feet to a monument of stones, the Western corner of the claim; thence in a South eastern direction one hundred and fifty feet to a monument of stones, the center of South west side boundary line of claim; thence in same direction one hundred and fifty feet, to a monument of stones, the South eastern corner of claim; thence in a North eastern direction one hundred feet, to a monument of stones, the center end monument of the South eastern end of claim; thence in same direction one hundred feet, to a monument of stones, the Eastern corner of claim; thence in a North western direction one hundred and fifty feet, to a monument of stones, the center of North eastern side boundary line of claim; thence in same direction one hundred and fifty feet to a monument of stones, the North eastern corner of claim; thence in a South western direction one hundred feet to place of beginning, the first-mentioned center end monument of claim.

This claim is situate about sixteen hundred feet in a South western direction from a side track called South Bisbee on the Arizona and South eastern Rail Road and bounded on North West end by the "Senator" a patented claim

and shall be known as the Helen mine.

Located April 10th 1899.

Recorded April 12, 1899,  
Book 114, Records of  
mines, page 796-

Lowell & Arizona Copper, Mining & Smelting Co  
per J. C. Jenner Supt.

For diagram for locating Claim, and Law of Arizona, see other side of this Notice.



-----oOo-----

Territory of Arizona )  
County of Cochise ) s. s.

KNOW ALL MEN BY THESE PRESENTS: That the Lowell and Arizona Copper Mining and Smelting Co, the undersigned, has this 13<sup>th</sup> day of September 1899, amended, located and claimed, and by these presents does amend, locate and claim, by right of the original discovery, and this additional and amended location certificate, in compliance with the mining acts of Congress, approved May 10th 1872, and all subsequent acts and the Legislative Laws ~~and~~ of Arizona, and with local customs, laws and regulations, 800 linear feet and horizontal measurement on the "Desplain" lode, vein, ledge or deposit along the vein thereof with all its dips, angles and variations as allowed by law together with 300 feet on each side of the middle of the said vein at the surface, so far as can be determined from present developements, and all veins, lodes, ledges, or deposits and surface ground within the lines of said claim, 50 feet running northerly from center of discovery shaft and 750 feet running southerly from center of discovery shaft, being situate upon said lode, vein, ledge or deposit, and within the lines of said claim in Warren Mining District, County of Cochise, Territory of Arizona, described by metes and bounds as follows, to wit:

Beginning at the Northerly end center at a 4"x4" pine post set in a mound of stones, on which this notice is posted, running thence in a westerly direction three hundred feet to a monument, a 4"x4" pine post set in a mount of stones, this being the northwest corner of the claim.



Thence in a southerly direction about 800 feet to a monument a 4"x4" pine post set in a mound of stones, this being the south west corner of the claim.

Thence in an easterly direction 300 feet to a monument a 4"x4" pine post set in a mound of stones, this being the south end center of the claim.

Thence in an easterly direction 300 feet to a monument a 4"x4" pine post, set in a mound of stones, this being the south east corner of the claim.

Thence in a northerly direction 800 feet to a monument a 4"x4" pine post set in a mound of stones, this being the north east corner of the claim.

Thence in a westerly direction 300 feet to a monument 2 4"x4" pine post set in a mound of stones, the place of beginning.

This lode and claim is bounded on the west by the Senator No. 2, and the Buckeye, two patented claims.

On the South it is bounded by a claim known as the Minnesota, the conflict with the Minnesota not being claimed.

On the East it is bounded by a claim known as the Auburn, the conflict with the Auburn not being claimed.

It is bounded on the North end by a claim known as the Galena, the conflict with the Galena not being claimed.

This lode was originally located by Thomas Higgins on the 1st ~~of~~ day of ~~May~~ January 1890, and is recorded in book 12 Records of Mines at page 155 in the office of the County Recorder at Tombstone, Cochise County, Arizona Territory, and this further additional and amended certificate of location is made without waiver of any previously

---3---

acquired rights, but for the purpose of correcting any errors in the original location, description or record, and of taking in and acquiring all forfeited or abandoned overlapping ground, and of taking in any part of any overlapping claim which has been abandoned.

Posted on the ground this 13<sup>th</sup> day of Sept 1899

Sowell & Arizona Copper Mining & Smelting Co

Per J.C. Ginner Attorney in fact

Recorded at request of J.C. Ginner this 13<sup>th</sup> day of September A.D. 1899; at 1 o'clock P M., in Book 15 Records of Mines at Pages 37 and 38



Frank Stone  
County Recorder.

Temple

**Recorder's Office,  
TOMBSTONE, Cochise Co., A. T.**

*Filed and recorded at request of*

*Ed. Turner*.....

*Sept 13<sup>th</sup>* A. D. 18*99*.....

at *1 P*.....**M.**

Book *15* Records of *Mines*.....

Pages *37 and 38*.....

*Frank Hasty*.....

County Recorder,

-----oOo-----

Territory of Arizona        )  
 County of Cochise         ) s. s.

KNOW ALL MEN BY THESE PRESENTS:, That, The Lowell and Arizona Copper Mining and Smelting Company, the undersigned, has this 13<sup>th</sup> day of September 1899 amended located and claimed, and by these presents does amend, locate, and claim, by right of the original discovery, and this additional and amended location certificate, in compliance with the Mining Acts of Congress, approved May 10th ~~1872~~ 1872 and all subsequent Acts, and the Legislative Laws of Arizona, and with local customs, laws and regulations, 1220 linear feet and horizontal measurement on the "Auburn" lode, vein, and ledge or deposit, along the vein thereof with all its dips, angles and variations, as allowed by law, together with 300 feet on each side of the middle of the said vein at the surface, at the East end of the claim, and 135 feet on each side of the middle of the said vein at the surface on the West end of the claim so far as can be determined from present developments, and all veins, lodes, ledges or deposits, and surface ground within the lines of said claim. About 265 feet running Easterly from the center of the discovery shaft, and about 955 feet running westerly from the center of the discovery shaft, said discovery shaft being situate upon said lode, vein or deposit, and within the lines of said claim in Warren Mining District, County of Cochise, Territory of Arizona, and described by metes and bounds as follows, to wit:

Beginning at the Easterly end center at a 4"x4" pine

--2--

post set in a mound of stones, on which this notice is posted and running thence in a Northerly direction, about 300 feet to a point that intersects the side line of a claim called "Gallena" which is marked by a monument, a 4"x4" pine post set in a mound of stones; this being the North east corner of the claim.

Thence South  $65^{\circ} 45'$  West about 505 feet to a monument a 4"x4" pine post set in a mound of stones.

Thence South  $47^{\circ} 50'$  West 350 feet to a monument, a 4"x4" pine post, set in a mound of stones; this monument being identical with the South West corner of a claim known as the "Galena"

Thence South  $53^{\circ} 40'$  West 400 feet to a monument, a 4"x4" pine post set in a mound of stones; this monument marking the north west corner of the claim.

Thence in a Southerly direction about 138 feet to a monument, a 4"x4" pine post set in a mound of stones; this being the Westery end center of the claim.

Thence in a southerly direction about 138 feet to a monument, a 4"x4" pine post set in a mound of stones; this being the south west corner of the claim.

Thence in an easterly direction about 1250 feet to a monument, a 4"x4" pine post, set in a mound of stones; this being identical with the North East corner of the "Delmar" and the South East corner of the claim.

Thence in a Northerly direction about 300 feet to a monument, a 4"x4" pine post set in a mound of stones; this being the Easterly center end of the claim, and the place of beginning.

---3---

This lode and claim is bounded on the east by a claim known as the "Del Norte". On the west it is bounded by a claim known as the "Desplaines", and also by a claim known as the "Minnesota". On the North it is bounded by a claim known as the "Galena", also by a claim known as the "Desplaines". On the South it is bounded by three claims known as "Boston" "Minnesota" and "Delmar".

This lode and claim lies about 1300 feet in a westerly direction from the Arizona and South Eastern Rail Road, and about a mile and a half south east of the town of Bisbee, it being the same lode originally located by Thomas Higgins, on the 24th day of April 1888, and recorded in Book 11 Records of Mines, at Page 548 in the Office of the County Recorder at Tombstone, County of Cochise, Territory of Arizona, and this further additional and amended certificate of location is made without waiver of any previously acquired rights but for the purpose of correcting any errors in the original location, description or record, and of taking in and acquiring all forfeited or abandoned overlapping ground, and of taking in any part of any overlapping claims, which have been abandoned.

Posted on the ground this 13<sup>th</sup> day of September 1899.

Lowell & Arizona Copper Mining & Smelting Co

Per J. C. Amers Attorney in fact

Recorded at the request of W. Fenner  
 this 16<sup>th</sup> day of September 1899 at 9<sup>00</sup> M o'clock

in Book 15 Records of Mines at

Page 40-41-42.

*Frank Stare*

County Recorder.



"Auburn"

**Recorder's Office,  
TOMBSTONE, Cochise Co., A. T.**

Filed and recorded at request of  
*H. J. Fenner*  
Sept 16<sup>th</sup> A. D. 1894  
at *J. H. I.* M.  
Book *N Records of m*  
Pages *40-41-42*  
*Graus Hare*

County Recorder.



-----c0o-----

Territory of Arizona)  
County of Cochise ) s. s.

KNOW ALL MEN BY THESE PRESENTS: That, the Lowell and Arizona Copper Mining and Smelting Company, the undersigned, has this 13<sup>th</sup> day of September 1899, amended located and claimed and by these presents does amend, locate and claim, by right of the original discovery, and this additional and amended location certificate, in compliance with the Mining Acts of Congress, approved May 10th 1872, and all subsequent Acts, and the Legislative Laws of Arizona, and with local customs, laws and regulations 950 linear feet and horizontal measurement on the "Delmar" lode, vein, ledge or deposit, along the vein thereof with all its dips, angles, and variations, as allowed by law together with 300 feet on each side of the middle of the said vein at the surface so far as can be determined from present developments, and all veins, lodes, ledges, or deposits and surface ground within the lines of said claim. About 210 feet running Easterly from the center of the discovery shaft and about 740 feet running westerly from the center of the discovery shaft; said discovery shaft being situate upon said lode, vein, ledge or deposit, and within the lines of said claim in Warren Mining District, County of Cochise, Territory of Arizona, described by metes and bounds as follows, to wit:

Beginning at the Easterly end center, at a monument, **A** 4"x4" pine post set in a mound of stones, on which this notice is posted, and running thence in a Northerly direction 300 feet to a monument, a 4"x4" pine post, set in a mound of

---2---

stones, this being the North east corner of the claim.

Thence in a westerly direction, 950 feet to a monument, a 4"x4" pine post set in a mound of stones; this being the North West corner of the claim.

Thence in a Southerly direction 300 feet to a monument, a 4"x4" pine post, set in a mound of stones; the center of the west end of the claim.

Thence in a Southerly direction 300 feet to a monument, a 4"x4" pine post set in a mound of stones, this being the South west corner of the claim.

Thence in an Easterly direction 950 feet to a monument a 4"x4" pine post set in a mound of stones; this being the South ~~XXXX~~ East corner of the claim.

Thence in a Northerly direction 300 feet to a monument a 4"x4" Pine post set in a mound of stones, this being the center of the East end of the claim and the place of beginning.

This lode and claim is bounded on the North by a claim known as the "Auburn". Conflict with Auburn not claimed.

On the South it is bounded by two claims, called "DesMoines" and "Harrison". Conflict with Des Moines and Harrison not claimed. On the West end it is bounded by a claim known as the "Boston" and on the East end by a claim known as the "Del Morte".

This lode and claim is situated about 1400 feet in a Westerly direction from the Arizona and South Eastern Rail Road, and its East end lies about 500 feet to the West of the side line of the Hardscrabble, a patented claim, this

being the same lode originally located by Thomas Higgins, on the 1st day of January 1890, and recorded in Book 12 Records of Mines, at Page 154 in the office of the County Recorder at Tombstone County of Cochise, Territory of Arizona, and this further additional and amended certificate of location is made without waiver of any previously acquired rights, but for the purpose of correcting any errors in the original location description or record and of taking in and acquiring all forfeited or abandoned overlapping ground and of taking in any part of any overlapping claim, which has been abandoned.

Posted on the ground this 13<sup>th</sup> day of September 1899

Laurie Arizona Copper Mining & Smelting Co  
per J. C. Turner Attorney in fact

Recorded at the request of B. C. Deener  
this 16<sup>th</sup> day of September 1899 at 9<sup>th</sup> M o'clock  
in Book 15 Records of Mines Pages 112 and 113

Frank Stare  
County Recorder.



Delmar

**Recorder's Office,  
TOMBSTONE, Cochise Co., A. T.**

Filed and recorded at request of  
*G. L. Denner*  
.....  
*Sept 16<sup>th</sup>* A. D. 18*99*  
.....  
at *J. H.* ..... M.  
Book *W Records of M*  
.....  
Pages *112 and 113*  
.....  
*Frank Stare*  
.....

County Recorder.

ADDITIONAL AND AMENDED LOCATION CERTIFICATE.

62

-----oOo-----

Territory of Arizona        )  
 County of Cochise         ) s. s.

KNOW ALL MEN BY THESE PRESENTS: ~~That~~, The Lowell and Arizona Copper Mining and Smelting Co, the undersigned, has this 13<sup>th</sup> day of September 1899, amended, located and claimed, and by these presents does amend, locate and claim by right of the original discovery and this additional and amended location certificate, in compliance with the Mining Acts of Congress, approved May 10th 1872, and all subsequent Acts and the Legislative Laws of Arizona, and with local customs, laws and regulations 1500 linear feet and horizontal measurement on the "Dallas" lode, vein, ledge, or deposit, along the vein thereof, with all its dips, angles, and variations, as allowed by law, together with 300 feet on each side of the middle of the said vein at the surface, so far as can be determined from present developements, and all veins, lodes, ledges, or deposits, and surface ground within the lines of said claim, about 15 feet running South easterly from the center of the discovery shaft and about 1485 feet running North westerly from the center of the discovery shaft, being situate upon ~~xi~~ said lode, vein, ledge or deposit, and within the lines of said claim in Warren Mining District, County of Cochise, Territory of Arizona described by metes and bounds as follows, to wit:

Beginning at the Southerly end center at a 4"x4" pine post set in a mound of stones, on which this notice is posted, and running thence in an Easterly direction 300 feet

to a monument <sup>a</sup> 4"x4" pine post set in a mound of stones, this being the South east corner of the claim.

Thence in a Northerly direction 1500 feet to a monument ~~a~~ a 4"x4" pine post, set in a mound of stones, this being the North east corner of the claim.

Thence in a Westerly direction 300 feet to a monument a 4"x4" pine post set in a mound of stones, this being the Northerly center end of the claim and identical with the North east corner of the "Bob and John", a patented claim.

Thence in a Westerly direction 300 feet to a monument, a 4"x4" pine post set in a mound of stones, this being the North west corner of the claim.

Thence in a Southerly direction 1500 feet to a monument a 4"x4" pine post set in a mound of stones, this being the South west corner of the claim.

Thence in an easterly direction 300 feet to a monument a 4"x4" pine post set in a mound of stones, the South end center of the claim and the place of beginning.

This lode and claim is bounded on the West side by the "Bob and John", a patented claim, conflict not claimed.

On the South, it is bounded by a claim known as the "Delevin", being the South end line of the "Dallas"

On the East side it is bounded by two claims known as the "Danville" and the "Des Moines", conflict with these two claims is not claimed.

On the North it is bounded by a claim, known as the "Boston" conflict not claimed.

This lode and claim is situated about 1400 feet in a North easterly direction from a two compartment shaft which is

owned and operated by a company called the South Bisbee Copper Mining Townsite Improvement Company, it being the same lode originally located by Thomas Higgins on the 1st day of January 1890, and recorded in Book 12 Records of Mines at page 153 in the office of the County Recorder at Tombstone, County of Cochise, Territory of Arizona, and this further additional and amended certificate of location is made without waiver of any previously acquired rights but for the purpose of correcting any errors in the original location, description or record, and of taking in and acquiring all forfeited or abandoned overlapping ground, and of taking in and acquiring all forfeited or abandoned overlapping ground, and of taking in any part of any overlapping claim which has been abandoned.

Posted on the ground this 19<sup>th</sup> day of September 1899.

Lawrence E. Arizona Copper Mining & Smelting Co.

per J. C. Ammer Attorney in fact

Recorded at the request of J. C. Ammer this 16<sup>th</sup> day of September 1899 at 9 o'clock in

Book 15 Records of Mines Page 39 and 40

Fauschare  
County Recorder.



"Dallas"

**Recorder's Office,**  
TOMBSTONE, Cochise Co., A. T.

Filed and recorded at request of  
*J. O. Semmer*.....  
*Sept. 16<sup>th</sup>*..... A. D. 18*99*..  
at.....*9*.....*A*.....*M*..  
Book...*15 Record of Mines*..  
Pages...*39 and 40*.....  
*Drawn & are*.....

County Recorder.



-----oOo-----

Territory of Arizona. )  
 County of Cochise. ) s. s.

KNOW ALL MEN BY THESE PRESENTS:, That the Lowell and Arizona Copper Mining and Smelting Company, the undersigned, has this 13<sup>th</sup> day of September 1899, Amended, located and claimed and by these presents does amend locate and claim, by right of the original discovery, and this additional and amended location certificate, in compliance with the Mining Acts of Congress, approved May 10th 1872, and all subsequent Acts, and the Legislative Laws of Arizona, and with local customs, laws and regulations, 1500 linear feet and horizontal measurement on the "Des Moines" lode, vein, ledge, or deposit along the vein thereof, with all its dips, angles and variations, as allowed by law, together with 300 feet, on each side of the middle of the said vein, at the surface so far as can be determined from present developements, and all veins, lodes, ledges or deposits, and surface ground within the lines of said claim, about 20 feet running South easterly from the center of the discovery shaft and about 1480 feet running North ~~w~~esterly from the center of the discovery shaft, said discovery shaft being situate upon said lode, vein, ledge or deposit, and within the lines of said claim in Warren Mining District, County of Cochise, Territory of Arizona, described by metes and bounds as follows: to wit,

Beginning at the Southerly end center at a 4"x4" pine post set in a mound of stones, on which this notice is posted, and running thence in a Easterly direction 300 feet

--2--

to a monument a 4"x4" pine post set in a mound of stones. This being the Southeast corner of the claim.

Thence in a Northerly direction 1500 feet to a monument 4"x4" pine post set in a mound of stones. This being the North East corner of the claim,

Thence in a Westerly direction three hundred(300) feet to a monument 4"x4" pine post set in a mound of stones. This monument being the Northerly end center of the claim.

Thence in a Westerly direction 300 feet to a monument a 4"x4" pine post set in a mound of stones; this monument being at the North west corner of the claim.

Thence in a southerly direction 1500 feet to a monument 2 4"x4" pine post set in a mound of stones; this being the South west corner of the claim.

Thence in an easterly direction 300 feet to a monument a 4"x4" pine post set in a mound of stones, and the place of beginning.

This lode and claim is bounded on the West by a claim known as the "Dallas", and a claim known as the "Boston", conflict with the Boston not claimed. On the East it is bounded by a claim known as the "Harrison". On the South it is bounded by a claim known as the "Danville" and on the North by a claim known as the "Delmar", and it is situated about 1500 feet in a Westerly direction from the Arizona and South Eastern Rail Road. This being the same lode originally located by Thomas Higgins on the 1st day of January 1890 and recorded in Book 12 Records of Mines at page 152 in the office of the County Recorder at Tombstone,

County of Cochise, Territory of Arizona, and this further additional and amended certificate of location is made without waiver of any previously acquired rights, but for the purpose of correcting any errors in the original location description, or record, and of taking in and acquiring all forfeited or abandoned overlapping ground and of taking in any part of any overlapping claim which has been abandoned.

Posted on the ground this 13<sup>th</sup> day of September 1899.

Lawell & Arizona Copper Mining & Smelting Co

Per J. C. Jenner Attorney in fact

Recorded at the request of J. C. Jenner

this 16<sup>th</sup> day of September 1899 at 9 o'clock AM

in Book 15 Page. 43, 44 & 45

Frank Hare

County Recorder.



"  
Law Moines"  
"

---

13-1-1

**Recorder's Office,**  
TOMBSTONE, Cochise Co., A. T.

Filed and recorded at request of  
*H. Jenner*  
Sept 16<sup>th</sup> A. D. 1898  
at *A. A.* M.  
Book *Record of M.*  
Pages *43, 44 - 45*  
*Grant Sale*

County Recorder.

## ADDITIONAL AND AMENDED LOCATION CERTIFICATE.

-----oOo-----

Territory of Arizona        )  
 County of Cochise            ) s. s.

KNOW ALL MEN BY THESE PRESENTS: That, the Lowell and Arizona Copper Mining and Smelting Co, the undersigned, have this 13<sup>th</sup> day of September 1899, amended, located and claimed, and by thses presents does amend, locate, and claim by right of the original discovery, and this additional and amended location certificate, in compliance with the Mining Acts of Congress, approved May 10th 1872, and all subsequent Acts and the Legislative Laws of Arizona, and with local customs, laws and regulations, 1500 linear feet and horizontal measurement on the "Harrison" lode, vein, ledge, or deposit along the vein thereof, with all its dips, angles and variations as allowed by law together with 300 feet on each side of the middle of the said vein at the surface so far as can be determined from present developements, and all veins, lodes or deposits and surface ground within the lines of said claim, about 220 feet running in a South easterly direction, from the center of the discovery cut and about 1280 feet running North westerly from the center of the discovery cut, said discovery cut being situate upon said lode, vein, ledge, or deposit, and within the lines of said claim in Warren Mining District, County of Cochise, Territory of Arizona, described by metes and bounds as follows, to wit:

Beginning at the Southerly end centera 4"x4" pine post set in a mound of stones, on which this notice is posted, and running thence in an easterly direction 300 feet, to a

---2---

monument, a 4"x4" pine post set in a mound of stones; this being the South east corner of the claim.

Thence in a Northerly direction 1500 feet to a monument a 4"x4" pine ~~XXXX~~ post set in a mound of stones; this being the North east corner of the claim.

Thence in a westerly direction 300 feet to a monument a 4"x4" pine post set in a mound of stones; this being the North end center of the claim.

Thence in a Westerly direction 300 feet to a monument a 4"x4" pine post set in a mound of stones; this being the North west corner of the claim.

Thence in a Southerly direction 1500 feet to a monument a 4"x4" pine post set in a mound of stones; this being the South west corner of the claim.

Thence in an easterly direction 300 feet to a monument, a 4x4" pine post set in a mound of stones; this being the South end center of the claim and the place of beginning.

This lode and claim is bounded on the West by a claim known as the "Des Moines".

On the North it is bounded by a claim known as the "Delmar"

On the South it is bounded by a claim known as the "Hanchett".

On the East it is bounded by the "Del Norte", "Higgins" and "Nellie" claims, conflict with the "Nellie" not claimed.

This lode and claim is situated ~~in~~ about 1000 feet in a westerly direction from the Arizona & South Eastern Rail Road track, and about one mile and a half in a South easterly direction from a shaft known as the Holbrook, owned by the

---3---

Copper Queen Con. Mining Co.

This lode and claim is the same lode and claim originally located by Thomas Higgins on the 1st day of January 1890, and recorded in book 12 Records of Mines at page 156 in the office of the County Recorder at Tombstone, County of Cochise, Territory of Arizona, and this further additional and amended certificate of location is made without waiver of any previously acquired rights, but for the purpose of correcting any errors in the original location, description, or record, and of taking in, and acquiring all forfeited or abandoned overlapping ground and of taking in, any part of any overlapping claim which has been abandoned.

Posted on the ground this 13<sup>th</sup> day of September 1899.

Lowe & Arizona Copper Mining & Smelting Co  
 per J. C. Janner Attorney in fact

Recorded at the request of J. C. Janner this  
16<sup>th</sup> day of September 1899, at 9 o'clock  
9 M, in Book 15 Records of Mines Page 46-47-48

Grant Hare

County Recorder.



Harrison

**Recorder's Office,  
TOMBSTONE, Cochise Co., A. T.**

Filed and recorded at request of

*G. L. Fanner*.....

Sept 16<sup>th</sup> A. D. 1899.....

at *9 A*.....M.

Book *15* Record of *M*.....

Pages *46-47-48*.....

*Frank Hale*.....

County Recorder.



LOCATION NOTICE.

71

NOTICE IS HEREBY GIVEN that the undersigned, in compliance with the requirements of the Mining Act of Congress; Approved May 10th, 1872. Have this day located and claim 1500 linear feet along the course of this lead, lode or vein of mineral bearing quartz; And 300 feet in width on each side of the middle of said lead, lode or vein, Situate in the Warren Mining District, County of Cochise, Arizona. and more particularly described as follows To Wit:

COMMENCING at this monument of stones, being the centre of the North end of claim, and upon which this notice is posted, thence West 300 feet to a monument of stones; thence South 1500 feet to a monument of stones; thence East 300 feet to a monument of stones; Being the centre of the South end of claim; thence East 300 feet to a monument of stones; thence North 1500 feet to a monument of stones; thence West 300 feet to place of beginning.

THIS CLAIM is situated on the trail from the Black Jack to the Campbell group of Mines, its initial is in the saddle; It is bounded on the North by the Wisconsin, on the South by the Illinois and part of the Bob & John, on the East by the Malvern, on the West by the Annie. And shall be known as the Minnesota Mine. Located April 24th, 1888.

WITNESS. Dan O'Goale

Thos Higgins

Recorded June 22<sup>nd</sup> 9/12 1888  
Book 11 Records of mines  
Page 550.

NOTICE OF LOCATION.

72

10

NOTICE IS HEREBY GIVEN That the undersigned, in compliance with the requirements of the Mining Act of Congress, approved May 10th, 1872, have this day located and claim 1500 ~~xxx~~ linear feet along the course of this lead, lode or vein of mineral-bearing quartz, and 300 feet in width on each side of the middle of said lead, lode or vein, situate in the Warren Mining District, County of Cochise, Arizona. And more particularly described as follows, To Wit:

Commencing at this monument of stones, being the center of the North end of the claim, and upon which this notice is posted; thence West 300 feet to a monument of stones; thence South 1500 feet to a monument of stones; thence East 300 feet to a monument of stones, being the center of the South end of claim; thence East 300 feet to a monument of stones; thence North 1500 feet to a monument of stones; thence West 300 feet to place of beginning.

THIS CLAIM is continued from the south end of the Des Moines and terminates within a few hundred feet of the Rail Road where it crosses the gulch that leads from the Campbell group out into the valley, It is bounded on the West by the Delevin, Distance from Bisbee about a mile and a half, and shall be known as the Danville Mine.

LOCATED January 1st, 1890.

Witness.

Dan Goals

Thos Higgins

Recorded Feb. 25<sup>th</sup> A.D. 1890  
Book 12 Record of Minerals  
Page 158.

CH  
NOTICE OF LOCATION

NOTICE IS HEREBY GIVEN That the undersigned , in compliance with the requirements of the Mining Act of Congress, approved May 10th, 1872, has this day located and claim Fifteen hundred linear feet along the course of this lead, lode or vein of mineral-bearing quartz, and Three hundred feet in width on each side of the middle of said lead, lode or vein, situate in the Warren Mining District, County of Cochise, Arizona. And more particularly described as follows, To Wit:

Commencing at this monument of stones, being the centre of the North end of the claim, and upon which this notice is posted; Thence West 300 feet to a monument of stones; Thence South 1500 feet to a monument of stones; Thence East 300 feet to a monument of stones; being the centre of ~~the~~ the South end of claim; Thence East 300 feet to a monument of stones; Thence North 1500 feet to a monument of stones; Thence West 300 feet to place of beginning.

THIS CLAIM lies West of the Danville and East of the Campbell group of Mines. It is about 1500 feet South East of the Disowned (A patented Claim) and North of the Rail Road Culvert on the Campbell group gulch about 500 feet, distance from Bisbee about One and a half miles by trail,

And shall be known as the DELEVIN MINE. LOCATED January 1st, 1890.

Witness,

Don O'Soale

Thos Higgins

Recorded Feb'y 25<sup>th</sup> a.m. 1890  
Book 117 Records of Mines

Page 154.

COUNTY RECORDERS OFFICE,  
Tombstone, Arizona.

I, Frank Hare, County Recorder of Cochise  
County, Arizona, hereby certify that the foregoing is a true and cor-  
rect copy of the location notices of the following mining claims now  
on record in my office:

-----oOo-----

M I N N E S O T A.  
-----

Located by Thos. Higgins, in Warren Mining District, Cochise County,  
Arizona .

Recorded June 22, 1888,  
Book II, Records Mines,  
Page 550.

D A N V I L L E.  
-----

Located by Thos. Higgins, in Warren Mining District, Cochise County,  
Arizona.

Recorded February 25, 1890,  
Book 12, Record of Mines,  
Page 153.

D E L E V I N.  
-----

Located by Thos. Higgins, in Warren Mining District, Cochise County,  
Arizona.

Recorded February 25, 1890,  
Book 12, Records Mines,  
Page 154.

Given under my hand and seal of office, this 19<sup>th</sup> day of April  
A.D. 1899.

*Frank Hare*  
.....

County Recorder.



# Notice of Mining Location.

## LODE CLAIM.

Notice is hereby Given, That the undersigned, in compliance with the Mining Act of Congress, approved May 10th, 1872, and of the Laws of Arizona Territory, ha..... this day located One thousand..... feet along the course of this lead, lode or vein of mineral-bearing rock, being fifty..... feet in Southerly..... direction, and nine hundred and fifty..... feet in a northerly..... direction, from the center of the Discovery Shaft, where this notice is posted, together with ~~three~~ two hundred feet in width of the surface ground on each side of the middle of said lead, lode or vein, situate in the Warren..... Mining District Cochise..... County, Arizona Territory, and more particularly described as follows, to-wit:

Commencing at a monument of stones about fifty..... feet in a Southerly..... direction from center of said Discovery Shaft, being the center end monument of South..... end of claim; thence in an Easterly..... direction two hundred..... feet to a monument of stones, the South East..... corner of the claim; thence in a northerly..... direction six hundred..... feet to a monument of stones, the center of the Easterly..... side boundary line of claim; thence in same direction four hundred..... feet, to a monument of stones, the North east..... corner of claim; thence in Westerly..... direction two hundred..... feet, to a monument of stones, the center end monument of the northerly..... end of claim; thence in same direction two hundred..... feet, to a monument of stones, the North Westerly..... corner of claim; thence in a Southerly..... direction four hundred..... feet, to a monument of stones, the center of Westerly..... side boundary line of claim; thence in same direction six hundred..... feet to a monument of stones, the South Westerly..... corner of claim; thence in an Easterly..... direction two hundred..... feet to place of beginning, the first-mentioned center end monument of claim.

This claim is situate about six hundred feet in an easterly direction from the "Annie" a patented claim. It is bounded on the East side by a claim known as the "Delmar" and also by a claim known as the "Des Moines". It is bounded on the South end by a claim known as the "Galles" and shall be known as the Boston..... mine.

Located march 1<sup>st</sup> 1899.

Frank Hanchett



For diagram for locating Claim, and Law of Arizona, see other side of this Notice.

# An Act Concerning Mines.

*Be it Enacted by the Legislative Assembly of the Territory of Arizona:*

SECTION 1. Every notice of location of a mining claim shall contain: First, the name of the claim located; second, the name of the locator; third, the date of location; fourth, the number of feet in length of said claim and the number of feet claimed on each side of the center of the discovery shaft, lengthwise of the claim; fifth, the general course of the lode deposit of premises located; sixth, the locality of the claim with reference to some natural object, or permanent monument, as will identify the claim.

SEC. 2. All mining locations hereafter located, the certificate of location of which shall not contain: First, the name of the lode, or premises; second, the name of the locator, or locators; third, the date of location; fourth, the number of feet in length of said claim and the number of feet claimed on each side of the center of the discovery shaft, lengthwise of the claim; fifth, the general course of the lode, or premises, as near as may be; sixth, the locality of the claim with reference to some natural object, or permanent monument, as will identify the claim, shall be void.

SEC. 3. Before filing such location certificate with the County Recorder of the proper County, the discoverer shall locate his claim by: First, sinking a discovery shaft upon the premises so claimed, to a depth of at least ten feet from the lowest part of the rim of such shaft at the surface, and deeper if necessary, until there is shown by such work a lode deposit of mineral in place; second, by posting at the point of discovery, on the surface, a plain sign or notice substantially conforming to the location certificate; third, by marking such claim or premises on the ground, so that its boundaries can be readily traced.

Such surface boundaries shall be marked by **EIGHT** substantial **POSTS**, projecting at least **THREE FEET ABOVE THE SURFACE OF THE GROUND**, or by substantial **STONE MONUMENTS**, at least **THREE FEET HIGH**, to-wit: One at each corner of said claim, and one at the center of each end and side line thereof.

SEC. 4. Any open-cut, cross-cut, adit or tunnel which shall be made as above provided for, as a part of the location of a mining claim, and which shall be equal in amount of work to a shaft ten feet deep and four feet wide by six feet long, and which shall cut a lode or mineral in place at the depth of ten feet from the surface, shall be equivalent, as a discovery work, to a shaft sunk from the surface.

SEC. 5. The discoverer shall have ninety days from the date of discovering the lode and the posting of the notice thereon, to perform said discovery work thereon.

SEC. 6. If at any time the locator of any mining claim heretofore or hereafter located, or his assigns, shall learn that his original certificate was defective, or that the requirements of the law had not been complied with before filing, or shall be desirous of changing his surface boundaries, or of taking in any additional ground which is subject to location, or in case the original certificate was made prior to the passage of this law, and he shall be desirous of securing the benefits of this Act, such locator, or his assigns, may file an amended certificate of location subject to the provisions of this Act, regarding the making of new locations.

SEC. 7. The amount of assessment, or representation, work or improvements to be done or made during each year, after the completion of the location as heretofore provided, and the time for doing the same, shall be as provided by the laws of the United States.

SEC. 8. Within three months after the expiration of the period of time fixed for the performance of annual labor or the making of improvements upon any mining claim or premises, the person on whose behalf such work or improvement was made, or some person for him, knowing the facts, may make and record in the office of the County Recorder of the county wherein such claim is situate an affidavit in substance as follows:

TERRITORY OF ARIZONA,  
.....County, } ss.

.....being duly sworn deposes and says, that he is a citizen of the United States, and more than 21 years of age, and resides at ..... County, Arizona Territory, and is personally acquainted with the mining claim and premises located and known as ..... Mining District, County of ..... Arizona Territory, the notice of which premises is recorded in the office of the County Recorder of said county, in Book ..... of Records of Mines, at page .....; that between the ..... day of ..... A. D. 189....., and the ..... day of ..... A. D. 189....., at least ..... dollars worth of work and improvements were done and performed upon said premises or lode, not including the location work of said claim. Such work and improvements were made by and at the expense of ..... owners of said premises for the purpose of complying with the law of the United States pertaining to assessments or annual work, and (here name the miners or men who worked upon the claim in doing the work) were the men employed by said owner and who labored upon said premises, and who did said work and improvements, and said work so done upon said premises is described as follows, to-wit: (Here describe the work done.)

Subscribed and sworn to before me..... this ..... day of ..... 189.....

Notary Public.

SEC. 10. Such affidavit when so recorded shall be *prima facie* evidence of the performance of such labor or the making of such improvements, and said original affidavit after it has been recorded, or a certified copy of record of same, shall be received as evidence accordingly by all the Courts of this Territory.

SEC. 11. The relocation of forfeited or abandoned lode claims shall only be made by sinking a new discovery shaft and fixing new boundaries in the same manner and to same extent as is required in making a new location; or the locator may sink the original discovery shaft ten feet deeper than it was at date of commencement of such relocation, and shall erect new or make the old monuments the same as originally required. In either case a new location monument shall be erected, and the location certificate shall state if the whole or any part of the new location is located as abandoned property.

SEC. 12. This Act shall take effect and be in force from and after July 1st, 1895.  
SEC. 13. All Acts and parts of Acts in conflict with this Act are hereby repealed.

This diagram is to give locator a general idea of plan of location under the new law. The discovery shaft can be in the center of claim or any distance from either end desired. In the diagram it is placed 500 feet from one end and 1000 feet from the other. Commence description of claim at a center end monument, giving its distance and direction from center of Discovery Shaft; thence bound the claim in either direction. In description be careful to state locality of claim with reference to some natural object, or permanent monument, as will identify the claim.

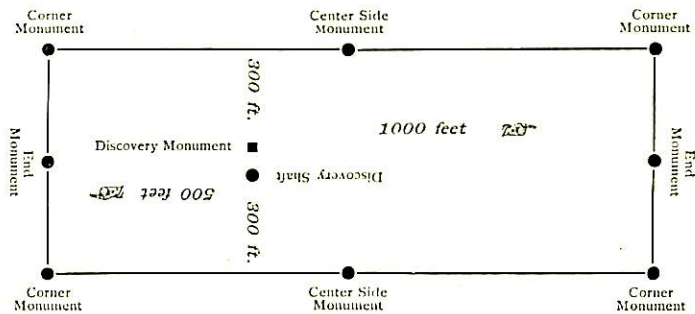

**Notice of Location.**  
LODE CLAIM.

Dated March 1st 1899

Filed and recorded at request of  
H. Timmer

at Apache 1899  
M.

Book 14 Records of Mines  
Pages 793  
Shawestane  
County Recorder.

By \_\_\_\_\_  
Deputy Recorder.

THE H. H. MERRILL CO., PRINTERS, PHOENIX, ARIZ.

I, Jerry A. ... County Recorder in and for the County and Territory of Apache County of ARIZONA, } ss.

do hereby certify that the within instrument was filed for record at ..... o'clock A.M. on this 12th day of March 1899, and duly recorded in Book No. 14 of Apache County, Arizona, at pages 793.

Witness my hand and official seal the day and year first above written.

Shawestane  
County Recorder

# Notice of Mining Location.

## LODE CLAIM.

Notice is hereby Given, That the undersigned, in compliance with the Mining Act of Congress, approved May 10th, 1872, and of the Laws of Arizona Territory, ha..... this day located Five hundred feet along the course of this lead, lode or vein of mineral-bearing rock, being about fourteen hundred feet in a Southerly direction, and one hundred feet in Northerly direction, from the center of the Discovery Shaft, where this notice is posted, together with ~~two~~ <sup>two</sup> hundred feet in width of the surface ground on each side of the middle of said lead, lode or vein, situate in the Warren Mining District Cochise County, Arizona Territory, and more particularly described as follows, to-wit:

Commencing at a monument of stones about one hundred feet in a Northerly direction from center of said Discovery Shaft, being the center end monument of the North end of claim; thence in a Westerly direction two hundred feet to a monument of stones, the North West corner of the claim; thence in a Southerly direction 750 feet to a monument of stones, the center of the West side boundary line of claim; thence in same direction 750 feet, to a monument of stones, the South West corner of claim; thence in Easterly direction two hundred feet, to a monument of stones, the center end monument of The South end of claim; thence in same direction two hundred feet, to a monument of stones, the South East corner of claim; thence in a Northerly direction 750 feet, to a monument of stones, the center of The East side boundary line of claim; thence in same direction 750 feet to a monument of stones, the North East corner of claim; thence in a Westerly direction two hundred feet to place of beginning, the first-mentioned center end monument of claim.

This claim is situate about 1500 feet in an easterly direction from the east side line of "Bob and John" a patented claim and is bounded on the North by a claim known as "Harrison" the South end line of the "Harrison" being the North end line of the "Hanchett

and shall be known as the Hanchett mine.

Located March 14 1899.

Franc Hanchett

Recorded April 12<sup>th</sup> 1899

Book 14. Records of mines. page 795.



For diagram for locating Claim, and Law of Arizona, see other side of this Notice.

I, Frank Hall County Recorder in and for the County and Territory aforesaid, do hereby certify that the within instrument was filed for record at 11 o'clock A.M., on this 17 day of April 1899, and duly recorded in Book No. 14 of Records of Mines, Cochise County, Arizona, at pages 795.

Witness my hand and official seal the day and year first above written.

Frank Hall  
County Recorder

**Notice of Location.**

LODE CLAIM.

11 Monchett

Dated March 1st 1899

Filed and recorded at request of

Ed. Tanner

April 17 1899  
at 11 A M.

Book 14 Records of Mines

Pages 795

Frank Hall  
County Recorder.

By  
Frank Hall  
Deputy Recorder.

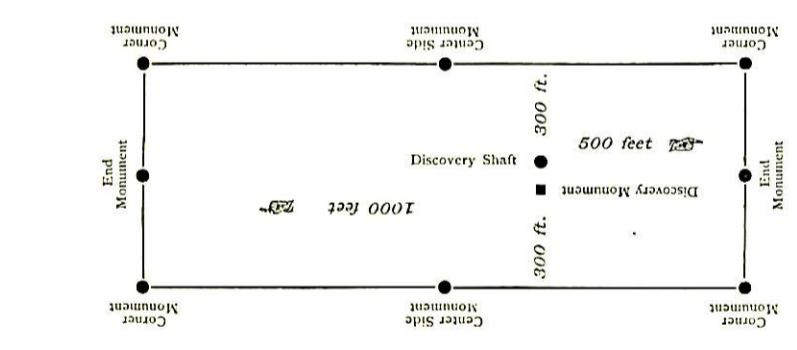

This diagram is to give location a general idea of plan of location under the new law. The discovery shaft can be in the center of claim or any distance from either end desired. In the diagram it is placed 500 feet from one end and 1000 feet from the other. Commence description of claim at a center end monument, giving its distance and direction from center of Discovery Shaft; thence bound the claim in either direction. In description be careful to state locality of claim with reference to some natural object, or permanent monument, as will identify the claim.

[REV.] Such affidavit when so recorded shall be prima facie evidence of the performance of such labor or the making of such improvements, and said original affidavit after it has been recorded, or certified copy of same, shall be received as evidence according to the provisions of this Act.

Sec. 10. Such affidavit when so recorded shall be prima facie evidence of the performance of such labor or the making of such improvements, and said original affidavit after it has been recorded, or certified copy of same, shall be received as evidence according to the provisions of this Act.

Sec. 11. The relocation of lode or abandoned lode claims shall only be made by sinking a new discovery shaft and fixing new boundaries in the same manner and to same extent as in making a new location; or the old monuments or the original discovery shaft ten feet deeper than it was at date of commencement of such relocation, and shall receive new or any part of the new location as originally required. In either case a new location monument shall be erected, and the location certificate shall state if the new location is located as abandoned property.

Sec. 12. This Act shall take effect and be in force from and after July 1st, 1893.

Sec. 13. All Acts and parts of Acts in conflict with this Act are hereby repealed.

being duly sworn deposes and says, that he is a citizen of the United States, and more than 21 years of age, and resides at \_\_\_\_\_, in \_\_\_\_\_ County, Arizona Territory, and is personally acquainted with the mining claim and premises located and known as \_\_\_\_\_, in \_\_\_\_\_ County, Arizona Territory, the location of which premises is recorded in the office of the County Recorder of said county in Book \_\_\_\_\_ of Records of Mines, at page \_\_\_\_\_, that on the \_\_\_\_\_ day of \_\_\_\_\_, A. D. 189\_\_\_\_, and between the \_\_\_\_\_ day of \_\_\_\_\_, A. D. 189\_\_\_\_, and the \_\_\_\_\_ day of \_\_\_\_\_, A. D. 189\_\_\_\_, at least \_\_\_\_\_, the location work and improvements were made by and at the expense of \_\_\_\_\_, owners of said premises for the purpose of complying with the laws of the United States pertaining to assessments or annual work, and their names the miners, and who did said work and improvements, and who did said work and improvements as follows: (Here describe the work done.)

Subscribed and sworn to before me \_\_\_\_\_ this \_\_\_\_\_ day of \_\_\_\_\_, 189\_\_\_\_.

Notary Public.

**An Act Concerning Mines.**

Be it Enacted by the Legislative Assembly of the Territory of Arizona:

Section 1. Every notice of location of a mining claim shall contain: First, the name of the claim located; second, the name of the locator; third, the date of location; fourth, the number of feet in length of said claim and the number of feet claimed on each side of the center of the claim; fifth, the general course of the claim; sixth, the locality of the claim with reference to some natural object, or permanent monument, as will identify the claim.

Section 2. All mining locations hereafter located, the certificate of location of which shall not contain: First, the name of the lode, or premises; second, the name of the locator, or locator's third, the date of location; fourth, the number of feet in length of said claim and the number of feet claimed on each side of the center of the claim; fifth, the general course of the claim; sixth, the locality of the claim with reference to some natural object, or permanent monument, or that the requirements of the law had been complied with before filing, or shall be deemed of changing the surface boundaries, or of taking in any additional ground which is subject to location, or in case the original certificate was made prior to the passage of this Act, regarding the making of new locations.

Section 3. The amount of assessment, or representation, work or improvements to be done or made during each year, after the completion of the location as herebefore provided, and the time for doing the same, shall be as provided by the laws of the United States.

Section 4. Within three months after the expiration of the period of time fixed for the performance of annual labor or the making of improvements upon any mining claim or premises, the person on whose behalf such work or improvement was made, or some person for him, knowing the facts, may make and record in the office of the County Recorder of the county wherein such claim is situate an affidavit in substance as follows:

TERRITORY OF ARIZONA,  
County, } ss.

being duly sworn deposes and says, that he is a citizen of the United States, and more than 21 years of age, and resides at \_\_\_\_\_, in \_\_\_\_\_ County, Arizona Territory, and is personally acquainted with the mining claim and premises located and known as \_\_\_\_\_, in \_\_\_\_\_ County, Arizona Territory, the location of which premises is recorded in the office of the County Recorder of said county in Book \_\_\_\_\_ of Records of Mines, at page \_\_\_\_\_, that on the \_\_\_\_\_ day of \_\_\_\_\_, A. D. 189\_\_\_\_, and between the \_\_\_\_\_ day of \_\_\_\_\_, A. D. 189\_\_\_\_, at least \_\_\_\_\_, the location work and improvements were made by and at the expense of \_\_\_\_\_, owners of said premises for the purpose of complying with the laws of the United States pertaining to assessments or annual work, and their names the miners, and who did said work and improvements, and who did said work and improvements as follows: (Here describe the work done.)

Subscribed and sworn to before me \_\_\_\_\_ this \_\_\_\_\_ day of \_\_\_\_\_, 189\_\_\_\_.

Notary Public.



# Notice of Mining Location.

## LODE CLAIM.

Notice is hereby Given, That the undersigned, in compliance with the Mining Act of Congress, approved May 10th, 1872, and of the Laws of Arizona Territory, has this day located Six Hundred feet along the course of this lead, lode or vein of mineral-bearing rock, being one hundred feet in a northerly direction, and Five hundred feet in a Southerly direction, from the center of the Discovery Shaft, where this notice is posted, together with two ~~three~~ hundred feet in width of the surface ground on each side of the middle of said lead, lode or vein, situate in the Warren Mining District Cochise County, Arizona Territory, and more particularly described as follows, to-wit:

Commencing at a monument of stones about one hundred feet in a northerly direction from center of said Discovery Shaft, being the center end monument of the north end of claim; thence in a westerly direction two hundred feet to a monument of stones, the north west corner of the claim; thence in a southerly direction three hundred feet to a monument of stones, the center of the west side boundary line of claim; thence in same direction three hundred feet, to a monument of stones, the South west corner of claim; thence in an easterly direction two hundred feet, to a monument of stones, the center end monument of the South end of claim; thence in same direction two hundred feet, to a monument of stones, the South east corner of claim; thence in a northerly direction three hundred feet, to a monument of stones, the center of the East side boundary line of claim; thence in same direction three hundred feet to a monument of stones, the north east corner of claim; thence in a westerly direction two hundred feet to place of beginning, the first-mentioned center end monument of claim.

This claim is situate about twenty two hundred feet in a Southerly direction from a side track called "South Bisbee" on the A. & S. E. R.R. a portion of its sideline on the East joins the "Harascrabble" a patented claim. It is bounded on the north by a claim known as the "Del Norte"

and shall be known as the Higgins mine.

Located March 12<sup>th</sup> 1899.

Recorded April 12<sup>th</sup> 1899.  
Book 14, Records of mines,  
page 794.

Frank Hanchett



For diagram for locating Claim, and Law of Arizona, see other side of this Notice.

County of Cochise } ss.

I, Frank Starr, County Recorder in and for the County and Territory aforesaid, do hereby certify that the within instrument was filed for record at 11 o'clock A.M., on this 12<sup>th</sup> day of April, 1899, and duly recorded in Book No. 14 of Records of Mines, Cochise County, Arizona, at pages 7-94.

Witness my hand and official seal the day and year first above written.

Frank Starr

County Recorder

Notice of Location.

LODE CLAIM.

"Argentine"

Dated March 1st 1899

Filed and recorded at request of

J. B. Jensen

April 12th 1899

at 11 a M.

Book 14 Records of M.

Pages 7-94

Frank Starr

County Recorder.

By

Deputy Recorder.

THE H. M. MCNEIL CO., PRINTERS, PHOENIX, ARIZ.

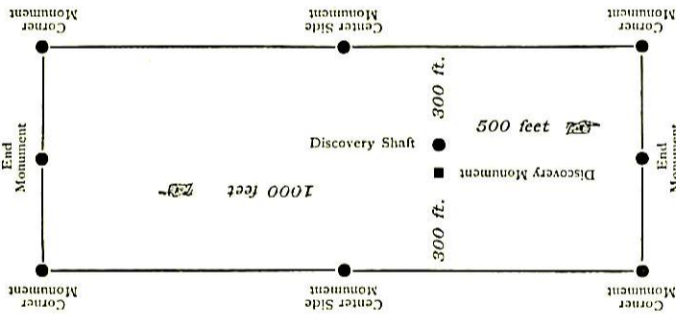

This diagram is to give locator a general idea of plan of location under the new law. The discovery shaft can be in the center of claim or any distance from either end desired. In the diagram it is placed 500 feet from one end and 1000 feet from the other. Commence description of claim at a center end monument, giving its distance and direction from center of Discovery Shaft; thence bound the claim in either direction. In description be careful to state locality of claim with reference to some natural object, or permanent monument, as will identify the claim.

Sec. 10. Such affidavit when so recorded shall be prima facie evidence of the performance of such labor or the making of such improvements, and said original affidavit after it has been recorded, or a certified copy of record of same, shall be received as evidence accordingly by all the Courts of this Territory.

Sec. 11. The relocation of forfeited or abandoned lode claims shall only be made by sliding a new discovery shaft and fixing new boundaries in the same manner and to same extent as in erecting a new location; or the locator may sink the original discovery shaft ten feet deeper than it was at date of commencement of such location, and shall erect new or make the old monuments the same as originally required. In either case a new location monument shall be erected, and the location certificate shall state if the new location is in force from and after July 1st, 1893.

Sec. 12. This Act shall take effect and be in force from and after July 1st, 1893.

Sec. 13. All acts and parts of acts in conflict with this Act are hereby repealed.

[SEAL]

Subscribed and sworn to before me..... this..... day of..... 189..... (Signature)

to-wit: (Here describe the work done.)  
 I, the undersigned, a Justice of the Peace, do hereby certify that the within instrument was filed for record in and for the County and Territory of Arizona, at page..... of the Records of Mines, at..... and duly recorded in Book No. .... of the Records of Mines, at pages..... of the Records of Mines, at..... and duly recorded in Book No. .... of the Records of Mines, at pages..... of the Records of Mines, at.....

and recorder as follows: (County, Arizona Territory, and is personally acquainted with the mining claim and premises located and known in..... Mining District, County of..... Arizona Territory, in Book..... of Records of Mines, at page.....; that notice of location of which premises is recorded in the office of the County Recorder of said county, in Book..... of Records of Mines, at page.....; that the amount of work and improvements were done and performed upon said premises or lode, not including the location work of said claim, such work and improvements were made by and at the expense of..... owners of said premises for the purpose of complying with the law of the United States pertaining to assessments of annual work, and who did said work and improvements, and said work so done upon said premises is described as follows:

Sec. 1. Every notice of location of a mining claim shall contain: First, the name of the claim located; second, the name of the locator; third, the date of location; fourth, the number of feet in length of said claim and the number of feet claimed on each side of the center of the discovery shaft, lengthwise of the claim; fifth, the date of the deposit of premises located; sixth, the locality of the claim with reference to some natural object, or permanent monument, as will identify the claim.

Sec. 2. All mining locations hereafter located, the certificate of location of which shall not contain: First, the name of the lode, or premises; second, the name of the locator, or locator; third, the date of location; fourth, the number of feet in length of the lode, or premises, as near as may be; fifth, the locality of the claim with reference to some natural object, or permanent monument, as will identify the claim; sixth, the name of the lode, or premises; seventh, the name of the locator, or locator; eighth, the number of feet in length of the lode, or premises, as near as may be; ninth, the locality of the claim with reference to some natural object, or permanent monument, as will identify the claim.

Sec. 3. Before filing such location certificate with the County Recorder of the proper County, the discoverer shall locate his claim by: First, sinking a discovery shaft upon the premises so claimed, to a depth of at least ten feet from the surface, and there shall at the surface, and deeper if necessary, until there is shown by certificate; third, by marking such claim or premises on the ground, so that its boundaries can be readily traced.

Sec. 4. If any line be marked on the ground, or on the surface, or on the face of a plain, sign or notice substantially conforming to the location requirements of the law had not been complied with before filing, or shall be dubious of changing his surface boundaries, or of taking in any additional ground which is subject to location, or in case the original certificate of location subject to the provisions of this Act, regarding the making of new locations, or his assignee, may file an amended certificate of location subject to the provisions of this Act, after the completion of the location as hereinafter provided, and the time for doing the same, shall be as provided by the laws of the United States.

Sec. 5. Within three months after the expiration of the period of time fixed for the performance for him, knowing the facts, may make and record in the office of the County Recorder of the county wherein such claim is situated an affidavit in substance as follows:

TERRITORY OF ARIZONA,  
 County, ss.

being duly sworn deposes and says, that he is a citizen of the United States, and more than 21 years of age, and resides in..... County, Arizona Territory, and is personally acquainted with the mining claim and premises located and known in..... Mining District, County of..... Arizona Territory, in Book..... of Records of Mines, at page.....; that notice of location of which premises is recorded in the office of the County Recorder of said county, in Book..... of Records of Mines, at page.....; that the amount of work and improvements were done and performed upon said premises or lode, not including the location work of said claim, such work and improvements were made by and at the expense of..... owners of said premises for the purpose of complying with the law of the United States pertaining to assessments of annual work, and who did said work and improvements, and said work so done upon said premises is described as follows:

to-wit: (Here describe the work done.)

Subscribed and sworn to before me..... this..... day of..... 189..... (Signature)

An Act Concerning Mines.

(4-687.)

# Surveyor General's Certificate of Approval of Field Notes and Survey of Mining Claim.

Department of the Interior,

Office of U. S. Surveyor General,

Tucson, Arizona.

June 5-1900, 18

I, U. S. Surveyor General for District of Arizona,

do hereby certify that the foregoing and hereto attached Field Notes and Return of the Survey of the Mining Claim of The Lowell + Arizona Copper Mining + Smelting Co.

situate in Yaleva, Helen, Lowell, DesPlain, Auburn, Selma, Minnesota, Boston, DeMunn, Harrison, Danville, Hancock, Dallas, DeLeon, Higgins, known as the Warren mining district,

Cochise County, Arizona,

in Section       , Township No.       , Range No. (unsurveyed)

designated as Survey No. 1410.

executed by James F. Trotter, U. S. Deputy Mineral

Surveyor, Nov. 23 - Dec. 10, 1899, under my instructions dated

Sept. 26, 1899, 18, have been critically examined and the

necessary corrections and explanations made, and the said Field Notes and Return, and

the Survey they describe, are hereby approved. A true copy of the copy of the location

certificate filed by the applicant for survey is included in the field notes.

George Christ

U. S. Surveyor General for Arizona

## Location Notice.

Notice is hereby given, that the undersigned, in compliance with the requirements of the mining Act of Congress, approved May 10, 1872 have this day located and claim fifteen hundred linear feet along the course of this lead, lode or vein of mineral bearing quartz, and three hundred feet in width on each side of the middle of said lead, lode or vein, situated in the Warren Mining District, County of Cochise, Arizona, and more particularly described as follows, to-wit: Commencing at this monument of stones, being the center of the North end of claim, and upon which this notice is posted; thence West three hundred feet to a monument of stones; thence South fifteen hundred feet to a monument of stones; thence East three hundred feet to a monument of stones, being the center of the South end of claim; thence East three hundred feet to a monument of stones; thence North fifteen hundred feet to a monument of stones; thence West three hundred feet to the place of beginning. This claim is bounded on the North by the Galena on the South by the Malvern, on the East by the Ormond, and on the West it runs diagonally by the side of the Galena. It is situated on the North end of the Mountain opposite the Mammoth and Black Jack a distance of about 700 ft., and shall be known as the Auburn Mine. Located 24th day of April 1888.

Witness: Dan O'Toole.

Thos Higgins.

Filed and recorded at the request of Thos Higgins, June 22nd A.D. 1888 at 9 A.M.

W.F. Bradley,

County Recorder.

Territory of Arizona, )  
                                  : ss  
County of Cochise.    )

I, Frank Hare, County recorder in and for said County, do hereby certify, that the attached instrument is a true and correct copy of the Location Notice of the Auburn Mine, Recorded in Book 11, Record of Mines, Page 548; as the same appears of record in my said office.

Witness my hand and seal of office, this the 28th day of September A.D. 1899.

*Frank Hare*

County Recorder.



Location Notice.

Notice is hereby given that the undersigned, in compliance with the requirements of the mining Act of Congress, approved May 10, 1872, has this day located and claim fifteen hundred linear feet along the course of this lead, lode or vein of mineral bearing quartz, and three hundred feet in width on each side of the middle of said lead, lode or vein, situate in the Warren Mining District, County of Cochise, Arizona, and more particularly described as follows, to-wit: Commencing at this monument of stones, being the center of the North end of claim, and upon which this notice is posted; thence West 300 feet to a monument of stones thence South 1500 feet to a monument of stones; thence East 300 feet to a monument of stones; being the center of the North end of claim; thence East 300 feet to a monument of stones; thence North 1500 feet to a monument of stones; thence West 300 feet to place of beginning. This claim is bounded on the North by the Snow Flake, on the South by the Des Moines on the West by the Auburn, and on the East by the Harrison. It lies S.E. of the Mammoth (a patented claim) about 1200 ft. and about one mile & a quarter S.E. of Bisbee, and shall be known as the Delmar Mine.

Located January 1st 1890.

Witness: Dan O'Toole.

Locator: Thos. Higgins.

Filed and recorded at the request of Thos Higgins, February 25th A.D. 1890 at 3:20 P.M.

W.F. Bradley, County Recorder.

Book 12, Record of Mines, Page 154.

Territory of Arizona; )

:ss

County of Cochise. )

I, Frank Hare, County Recorder in and for said County, do hereby certify, that the attached instrument is a true and correct copy of the Location Notice of the Delmar Mine, Recorded in Book 12, Record of Mines, Page 154; as the same appears of record in my said office.

Witness my hand and seal of office this the 28th day of  
September A.D. 1899.



*Frank Hare*  
County Recorder.

Territory of Arizona, )  
  :SS  
County of Cochise.     )

I, Frank Hare, County Recorder in and for said County, do hereby certify, that the attached instrument is a true and correct copy of the Location Notice of the Dallas Mine, Recorded in Book 12, Record of Mines, page 155; as the same appears of record in my said office.

Witness my hand and seal of office, this the 28th day of September A.D. 1899.



*Frank Hare*  
County Recorder.



Location Notice.

Notice is hereby given that the undersigned, in compliance with the requirement of the mining Act of Congress, approved May 10, 1872, has this day located and claim fifteen hundred linear feet along the course of this lead, lode or vein of mineral bearing quartz, and three hundred feet in width on each side of the middle of said lead, lode or vein, situate in the Warren Mining District, County of Cochise, Arizona, and more particularly described as follows, to-wit: Commencing at this monument of stones, being the center of the South end of claim, and upon which this notice is posted; thence East 300 feet to a monument of stones; thence North 1500 feet to a monument of stones; thence West 300 feet to a monument of stones; being the center of the North end of claim; thence West 300 feet to a monument of stones; thence South 1500 feet to a monument of stones; thence East 300 feet to place of beginning. This claim is bounded on the North by the Minesoto, on the South by the Delevan, on the West by the Bob & John; on the East by the Des Moines. It lies East of the Disowned (a patented claim) about 800 ft. and runs parallel with it, and shall be known as the Dallas Mine. Located January 1st 1890

Witness: Thos. Higgins.  
 Dan O'Toole.

Filed and recorded at the request of Thos Higgins, February 25th  
 A.D. 1890 at 3:20 P.M.

W.F. Bradley.  
 County Recorder.

Territory of Arizona, )  
                                  : ss  
County of Cochise.    )

I, Frank Hare, County Recorder, in and for said County, do  
hereby certify that the attached instrument is a true and correct copy  
of the Location Notice of the Galena Mine, Recorded in Book 4, Record  
of Mines, Page 67, (Transcribed Records); as the same appears of record  
in my said office.

Witness my hand and seal of office this the 28th day of  
September A.D. 1899.



*Frank Hare*  
County Recorder.

NOTICE OF LOCATION. In pursuance of an Act of Congress dated May 10th 1872 the undersigned has this day located and claimed 1500 hundred linear feet along the course of this ledge, lode or deposit of mineral bearing rock or quartz being situated and described as follows, to-wit: Commencing at this notice and monument of stones and running 1200 twelve hundred feet in an easterly direction to a monument of stones and from this notice 300 three hundred feet in a westerly direction to a monument of stones together with 300 three hundred linear feet in width on each side thereof, the boundary lines being fully designated by monuments of stones as required by law. Said claim is situated directly west of the Excelsior Mine and about one mile in a Southerly direction from the Iron Spring in Mule Pass Mountains Pima County, Arizona Ty. Dated on the ground this the 3rd day of Feby. 1879. This claim shall be known as the Galena Mine.

Witness: W.S.Salmon

John F.Bland

Filed and recorded at request of J.F.Bland, March 31st 1879 at 10:30 A.M.

S.W.Carpenter,

County Recorder.

Book 4, Record of Mines, Page 67, Transcribed Records, Pima County, Arizona. Refer to Book F. page 152, Pima County Records.



territory of Arizona, )  
:ss  
County of Cochise. )

I, Frank Hare, County Recorder in and for said County, do  
reby certify that the attached instrument is a true and correct copy  
the Location Notice of the Des Moines Mine, Recorded in Book 12, Record  
Mines, Page 152; as the same appears of record in my said office.

Witness my hand and seal of office this the 28th day of  
September A.D. 1899.

*Frank Hare*  
County Recorder.



Location Notice.

Notice is hereby given that the undersigned, in compliance with the requirements of the mining Act of Congress, approved May 10, 1872, has this day located and claim fifteen hundred linear feet along the course of this lead, lode or vein of mineral bearing quartz and three hundred feet in width on each side of the middle of said lead, lode or vein, situate in the Warren Mining District, County of Cochise, Arizona, and more particularly described as follows, to-wit: Commencing at this monument of stones, being the center of the North end of claim, and upon which this notice is posted; thence West 300 feet to a monument of stones thence South 1500 feet to a monument of stones; thence East 300 feet to a monument of stones; being the center of the south end of claim; thence West 300 feet to a monument of stones; thence North 1500 feet to a monument of stones; thence West 300 feet to place of beginning. This claim is the first Southern extension of the Auburn Mine, its side lines is a continuation of the Auburn side lines. It is bounded on the South by the ...ville, on the West by the Minesoto & Dallas claims, on the East by the ...lmar and Harrison, and shall be known as the Des Moines Mine.

located January 1st 1890.

Witness: Thos. Higgins.  
Dan O'Toole.

Filed and recorded at the request of Thos Higgins, February 25th 1890 at 2 P.M.

W.F. Bradley,  
 County Recorder.

Territory of Arizona, )  
:ss  
County of Cochise. )

I, Frank Hare, County Recorder in and for said County, do hereby certify that the attached instrument is a true and correct copy of the Location Notice of the Desplain Mine, Recorded in Book 12, Record of Mines, page 155; as the same appears of record in my said office.

Witness my hand and seal of office this the 28th day of September, A.D. 1899.

*Frank Hare*

County Recorder.



Location Notice.

Notice is hereby given that the undersigned, in compliance with the requirements of the mining Act of Congress, approved May 10, 1872, has this day located and claim fifteen hundred linear feet along the course of this lead, lode or vein of mineral bearing quartz, and three hundred feet in width on each side of the middle of said lead, lode or vein, situate in the Warren Mining District, County of Cochise, Arizona, and more particularly described as follows, to-wit: Commencing at this monument of stones, being the center of the South end of claim and upon which this notice is posted; thence West 300 feet to a monument of stones; thence North 1500 feet to a monument of stones; thence East 300 feet to a monument of stones; being the center of the North end of claim; thence East 500 feet to a monument of stones; thence South 1500 feet to a monument of stones; thence West 300 feet to place of beginning. This claim butts against the Galena on the S.W. end and runs South to the Saddle where it joins the Minesoto on its north end. It is about 2000 ft South of the Marmoth, a patented claim. It is bounded on the East by the Auburn, and shall be known as the Desplain mine. Located January 1st 1890.

Witness:

Thos. Higgins.

Dan O'Toole.

Filed and recorded at the request of Thos Higgins, February 25th

D. 1890 at 3:20 P.M.

W.F. Bradley, County Recorder.

Book 12, Record of Mines, Page 155.

92

Territory of Arizona, )  
                                   : ss  
 County of Cochise.    )

I, Frank Hare, County Recorder in and for said County, do hereby certify, that the attached instrument is a true and correct copy of the Location Notice of the Harrison Mine, Recorded in Book 12, Record of Mines, Page 156; as the same appears of record in my said office.

Witness my hand and seal of office, this the 28th day of  
 September A.D. 1899.



*Frank Hare*

County Recorder.



Location Notice.

Notice is hereby given that the undersigned, in compliance with the requirements of the mining Act of Congress, approved May 10, 1872, has this day located and claim fifteen hundred linear feet along the course of this lead, lode or vein of mineral bearing quartz, and three hundred feet in width on each side of the middle of said lead, lode or vein, situate in the Warren Mining District, County of Cochise, Arizona, and more particularly described as follows, to-wit: Commencing at this monument of stones, being the center of the North West end of claim, and upon which this notice is posted; thence South West 300 feet to a monument of stones; thence S.E. 1500 feet to a monument of stones; thence North East 300 feet to a monument of stones, being the center of the South East end of claim thence North East 300 feet to a monument of stones; thence North West 1500 feet to a monument of stones; thence South West 300 feet to place of beginning. This claim is bounded on the North West by the Delmar, on the S.W. by the Des Moines, on the North East partly by the Snow Flake, its South East end extends within about 700 ft of the R.R. where a stake is marked two miles from Bisbee, and shall be known as the Harrison Mine. Located January 1st 1890.

Witness:

Locator:

Thos. Higgins

Dan O'Toole

Filed and recorded at the request of Thos Higgins, February 25th A.D. 1890 at 3:20 P.M.

W.F. Bradley, County Recorder.

Amended Notice of Location.

Notice is hereby given, That the "Desplaines" lode and mining claim, has been located, by Lowell Arizona Copper Mining and Smelting Co on the 10<sup>th</sup> day of April 1890 being three hundred feet in length and six hundred feet wide; that is three hundred feet on each side of the center of the claim, lode and discovery shaft, length-wise of the claim, and the general course of the lode and claim is North East and South West and is described as follows, to-wit:

Commencing at the Eastern center end of the Claim a monument of stones on which this notice is posted, and running thence in a North westerly direction three hundred (300) feet to a monument of stones being the North West corner of the claim, thence in a southerly direction nine hundred feet, to a monument of stones being the South West corner of the claim; thence in a South easterly direction six hundred feet to a monument of stones being the South East corner of the claim, Thence in a North easterly direction nine hundred feet to a monument of stones being the North East corner of the claim, and thence in a westerly direction three hundred feet to the place of beginning.

This claim is situated in the Warren Mining District, Cochise County, Territory of Arizona, and the "Galena" location joins it on the North east for about three hundred feet. The Desplaines is bounded on the West by the "Senator No 2" and the "Buckeye" two patented claims. The end lines of the "Senator No 2" and "Buckeye" constituting the North West side line of the Desplaines.

This is an Amended Location Notice of the Desplaines Mining Claim Located by Thomas Higgins on the 12<sup>th</sup> day of January 1890 and recorded in Book 12 of Records of mines at page 155 in the Office of the County Recorder of the aforesaid county of Cochise to which reference is hereby made, and this Amended Location Notice is made and posted to correct errors in the description in the said Original Location Notice.

Posted on the ground this 10 day of April 1890

Witness

Lowell Arizona Co. & S. Co  
 for J. B. Fenner Supt

Recorded April 12<sup>th</sup> A.D. 1890  
 Book 15, page 213,  
 Record of mines

Amended Notice of Location.

Notice is hereby given, That the "Dallas" lode and mining claim, has been located, by Howell Co Arizona Copper Mining Co Smelting Co on the 10<sup>th</sup> day of April 1890 being Three Hundred feet in length and six Hundred feet wide; that is three Hundred feet on each side of the center of the claim, lode and discovery shaft, length-wise of the claim, and the general course of the lode and claim is North westerly and South Easterly and it is described as follows, to-wit:

Commencing at the South center end of the Claim a monument of stones on which this notice is posted, and running thence in a westerly direction three hundred feet to a monument of stones being the South west corner of the claim, thence in a North westerly direction Three Hundred feet, to a monument of stones being the North west corner of the claim; thence in a Easterly direction two hundred and fifty feet to a monument of stones being the North east corner of the claim, Thence in a Southerly direction Fifteen hundred feet to a monument of stones being the South east corner of the claim, and thence in a westerly direction three hundred feet to the place of beginning.

This claim is situated in the Warren Mining District, Cochise County, Territory of Arizona, and the "Bob and John" a patented claim bounds it on the West. The East side line of the "Bob and John" being the west side line of the "Dallas" It is bounded on the South by a claim known as the "Delevin" the North end line of the Delevin being the South end line of the "Dallas"

This is an Amended Location Notice of the Dallas Mining Claim Located by Thomas Higgins on the 12<sup>th</sup> day of January 1890 and recorded in Book 12 of Records of mines at page 153 in the Office of the County Recorder of the aforesaid county of Cochise to which reference is hereby made, and this Amended Location Notice is made and posted to correct errors in the description in the said Original Location Notice.

Posted on the ground this 10<sup>th</sup> day of April 1890

Witness

Howell Co Arizona, Am. S. Co  
per J. B. Fenner Supt

Recorded April 12 A.D. 1890  
Book 14 Records of  
Mines. page 798.

Amended Notice of Location.

Notice is hereby given, That the Des Moines lode and mining claim, has been located, by the Lowell Arizona Copper Mining Co. Trusting Co. on the 10<sup>th</sup> day of April 1899 being Fifteen hundred feet in length and Six hundred feet wide; that is three hundred feet on each side of the center of the claim, lode and discovery shaft, length-wise of the claim, and the general course of the lode and claim is North westerly and South Easterly and it is described as follows, to-wit:

Commencing at the South center end of the Claim a monument of stones on which this notice is posted, and running thence in a westerly direction three hundred feet to a monument of stones being the South West corner of the claim, thence in a North West direction fifteen hundred feet, to a monument of stones being the North West corner of the claim; thence in a Easterly direction six hundred feet to a monument of stones being the North East corner of the claim, Thence in a South Easterly direction fifteen hundred feet to a monument of stones being the South East corner of the claim, and thence in a westerly direction three hundred feet to the place of beginning.

This claim is situated in the Maricopa Mining District, Cochise County, Territory of Arizona, and the claim is bounded on the east by a claim known as the "Harrison", on the south it is bounded by a claim known as the "Dallas", on the west it is bounded by a claim known as the "Dallas" and on the North it is bounded by a claim known as the "Delmar". It is situated about four hundred feet to the west of the "Bob & John" patented claim.

This is an Amended Location Notice of the "Des Moines" Mining Claim Located by Thomas Higgins on the 10<sup>th</sup> day of January 1899 and recorded in Book 12 of Records of mines at page 132 in the Office of the County Recorder of the aforesaid county of Cochise to which reference is hereby made, and this Amended Location Notice is made and posted to correct errors in the description in the said Original Location Notice.

Posted on the ground this 10<sup>th</sup> day of April 1899

Witness

Lowell Arizona C.M. & S. Co.  
per J.C. Jenner Supt

Recorded April 12<sup>th</sup> A.D. 1899  
Book 14 Records of  
mines. page 779-

Amended Notice of Location.

Notice is hereby given, That the Delmar lode and mining claim, has been located, by Lorrell and Arizona Copper Mining & Smelting Co on the 10<sup>th</sup> day of April 1899 being Nine hundred feet in length and six hundred feet wide; that is three hundred feet on each side of the center of the claim, lode and discovery shaft, length-wise of the claim, and the general course of the lode and claim is Easterly, and Westwardly, and it is described as follows, to-wit:

Commencing at the Easterly center end of the Claim a monument of stones on which this notice is posted, and running thence in a Northwardly direction three hundred feet to a monument of stones being the North East corner of the claim, thence in a Westwardly direction three hundred feet, to a monument of stones being the North West corner of the claim; thence in a Southwardly direction four hundred feet to a monument of stones being the South West corner of the claim, Thence in a Easterly direction three hundred feet to a monument of stones being the South East corner of the claim, and thence in a Northwardly direction three hundred feet to the place of beginning.

This claim is situated in the Maricopa Mining District, Cochise County, Territory of Arizona, and the claim is bounded, on the East by a claim known as the "Del Norte". On the South by the "Harrison" and "Des Moines" claims. On the West by the "Boston" and on the North by the "Auburn". This claim is situated about six hundred feet to the west of the "Hardscrabble" a patented claim, and about twelve hundred feet west of the Rail Road.

This is an Amended Location Notice of the Delmar Mining Claim Located by Thomas Higgins on the 12<sup>th</sup> day of

January 1899 and recorded in Book 12 of Records of mines at page 54 in the Office of the County Recorder of the aforesaid county of Cochise to which reference is hereby made, and this Amended Location Notice is made and posted to correct errors in the description in the said Original Location Notice.

Posted on the ground this 10<sup>th</sup> day of April 1899

Witness

Lorrell & Arizona C.M. & S. Co

Geo. J. Fenner Supt

Recorded April 12<sup>th</sup> a.p. 1899  
Book 14 Records of  
mines. page 797.

Amended Notice of Location.

Notice is hereby given, That the Galena lode and mining claim, has been located, by Lowell and Arizona Copper Mining and Smelting Company on the 10<sup>th</sup> day of April, 1899 being twelve hundred feet in length and six hundred feet wide; that is three hundred feet on each side of the center of the claim, lode and discovery shaft, length-wise of the claim, and the general course of the lode and claim is North easterly and South westerly, and is described as follows, to-wit:

Commencing at the base center end of the Claim a monument of stones on which this notice is posted, and running thence in a Northwesterly direction three hundred feet to a monument of stones being the North East corner of the claim, thence in a Westerly direction twelve hundred feet, to a monument of stones being the North West corner of the claim; thence in a South easterly direction six hundred feet to a monument of stones being the South west corner of the claim, Thence in a North easterly direction twelve hundred feet to a monument of stones being the South East corner of the claim, and thence in a Northwesterly direction three hundred feet to the place of beginning.

This claim is situated in the Warren Mining District, Cochise County, Territory of Arizona, and the A.T. & P.R. runs to the East of it about six hundred feet. The easterly end line of the Galena location joins the "Morning Star" a patented claim for about three hundred feet. On the North west the Galena is bounded by the "Block Joe's" location and also by the "Senator" a patented claim a portion of the S. E. end line of the "Senator" forming a portion of the N.W. side line of the "Galena"

This is an Amended Location Notice of the Galena Mining Claim Located by John T. Blount on the 3<sup>rd</sup> day of December 1879 and recorded in Book transcribed of Records of mines at page 67 in the Office of the County Recorder of the aforesaid county of Cochise to which reference is hereby made, and this Amended Location Notice is made and posted to correct errors in the description in the said Original Location Notice.

Posted on the ground this 10<sup>th</sup> day of April 1899

Witness

Lowell & Arizona Copper Mts. Co  
per J. O. Fenner Supt

Recorded April 12<sup>th</sup> 1899  
Book 15-Records of  
mines, page 3+4.

Amended Notice of Location.

Notice is hereby given, That the Auburn lode and mining claim, has been located, by Lowell & Arizona Copper Mining & Smelting Company on the 10<sup>th</sup> day of April 1899 being eleven hundred feet in length and six hundred feet wide; that is three hundred feet on each side of the center of the claim, lode and discovery shaft, length-wise of the claim, and the general course of the lode and claim is North east and South west and it is described as follows, to-wit:

Commencing at the North east center end of the Claim a monument of stones on which this notice is posted, and running thence in a northerly direction three hundred feet to a monument of stones being the North East corner of the claim, thence in a South westerly direction eleven hundred feet, to a monument of stones being the North West corner of the claim; thence in a South easterly direction six hundred feet to a monument of stones being the South West corner of the claim, Thence in a North Easterly direction eleven hundred feet to a monument of stones being the South East corner of the claim, and thence in a North westerly direction three hundred feet to the place of beginning.

This claim is situated in the Maricopa Mining District, Cochise County, Territory of Arizona, and the claim is bounded on the east by a claim known as the "Del Norte" On the North west side it joins two claims known as the "Galena" and the "Desplaines". On the southern side it joins a claim known as the "Delmar". The North side line of the "Delmar" being the South side line of the "Auburn". The Auburn location lies about five hundred feet in a westerly direction from the Arizona & South Eastern Rail Road.

This is an Amended Location Notice of the Auburn Mining Claim Located by Thomas Higgins

on the 24 day of April 1899 and recorded in Book 11 of Records of mines at page 548 in the Office of the County Recorder of the aforesaid county of Cochise to which reference is hereby made, and this Amended Location Notice is made and posted to correct errors in the description in the said Original Location Notice.

Posted on the ground this 10 day of April 1899

Witness

Lowell & Arizona C. M. & S. Co

per J. C. Fenner Supt

Recorded April 12<sup>th</sup> A. D. 1899. Book 15, Record of mines page 1 + 2

COUNTY RECORDERS OFFICE,  
Tombstone, Arizona.

I, Frank Hare, County Recorder of Cochise County, Arizona, hereby certify that the foregoing are true and correct copies of the amended location notices of the following mining claims, located in Warren Mining District, Cochise County, Arizona; now on record in my office:

- The "Desplaines" Mining Claim,
- The "Dallas" Mining Claim,
- The "Des Moines" Mining Claim,
- The "Delmar" Mining Claim,
- The "Galena" Mining Claim,
- The "Auburn" Mining Claim,
- The "Harrison" Mining Claim.

Given under my hand and seal of office, this 17<sup>th</sup> day of April

A.D. 1899.

*Frank Hare*  
.....

County Recorder.



6

Rc



Notice is hereby given, That the Harrison lode and mining claim, has been located, by Lowell and Arizona Copper Mining & Smelting Co on the 10<sup>th</sup> day of April 1899 being fifteen hundred feet in length and six hundred feet wide; that is three hundred feet on each side of the center of the claim, lode and discovery shaft, length-wise of the claim, and the general course of the lode and claim is North westerly and South Easterly, and it is described as follows, to-wit:

Commencing at the Northwesterly center end of the Claim a monument of Stones on which this notice is posted, and running thence in a westerly direction three hundred feet to a monument of Stones being the North West corner of the claim, thence in a Southerly direction fifteen hundred feet, to a monument of Stones being the South West corner of the claim; thence in a Easterly direction six hundred feet to a monument of Stones being the South East corner of the claim, Thence in a Northwesterly direction fifteen hundred feet to a monument of Stones being the North East corner of the claim, and thence in a Westerly direction three hundred feet to the place of beginning.

This claim is situated in the Harrison Mining District, Cochise County, Territory of Arizona, and the claim is bounded on the North by a claim known as the "Delmar". On the West it is bounded by a claim known as the "Des Moines" and on the South it is bounded by a claim known as the "Hanchet". It lies about one thousand feet east of the "Bob and John" a patented claim and about twelve hundred feet west of the Arizona and Southern R.R.

This is an Amended Location Notice of the Harrison Mining Claim Located by Thomas Higgins on the 12<sup>th</sup> day of January 1890 and recorded in Book 12 of Records of mines at page 156 in the Office of the County Recorder of the aforesaid county of Cochise to which reference is hereby made, and this Amended Location Notice is made and posted to correct errors in the description in the said Original Location Notice.

Posted on the ground this 10<sup>th</sup> day of April 1899

Witness

Lowell and Arizona C.M. & S. Co  
per J. L. Fenner Supt

Sur. No. 1410.

Sur. No. 1120.

Triangle.



## MINERAL SURVEY NO. 1410

Claims	B& M Des. Page No.	Imps. Page No.	Loc. Notices Page No.
Auburn	9	33	4-15-27
Boston	13	34	12
Dallas	15	35	6-17-23
Danville	24	36	10
Delevin	19	36	11
Delmar	11	34	5-16-25
Des Moines	25	35	4-19-24
Desplain	7	33	3-20-22
Galena	5	32	2-18-26
Hanchett	21	36	13
Harrison	27	35	8-21-28
Helen	2	33	2 <sup>a</sup>
Higgins	22	37	14
Lowell	1	32	1
Minnesota	17	34	9