

MS.

0

1

4

1

9

(4-683.)

Mineral Survey No. 1419

Lot No.

Prescott Land District.

FIELD NOTES

OF THE SURVEY OF THE MINING CLAIM OF

The Val Verde Copper Company Ltd.
Cecil G. Fennell Genl Mng'r Prescott, Ariz.

KNOWN AS THE

Copper Queen, Copper Queen No 3 Halliday and Halliday No 3

Francis (unformed) Mining District,

Cochise County, Arizona

Section Unsurveyed Lands Township Range

Surveyed under instructions dated March 8th, 18 1900

by James Bull Girard
U. S. Deputy Mineral Surveyor

Claim located....., 18 .

Survey commenced March 24th, 1890

Survey completed March 31st, 1890.

Address of Claimants,
The Val Verde Copper Co Ltd.
Prescott, Arizona.

brs S.77° 34' W. 76 feet, a pinon tree 8" in dia. blazed and marked B.T. 3-1-4-1-1419 brs N.44° 25'E . 192 feet.

Thence North 3° 28' East.
Variation 14° 37' East.

- 172 To top of hill,
- 750 Begin descent of hill,
- 994 To bottom of hill,
- 1183 Cross road,
- 1500 To corner No.4. Identical with Amended Location Corner and corner No.4 of Copper Queen No.3.
A surface limestone rock in place marked 4-4-1419.
A pinon tree 20" in dia. blazed and marked B.T. 4-4-1419 brs S.45° 04' W. 38.7 feet, another 12" in dia. blazed and marked B.T. 4-4-1419 brs S.17° 45'W. 48.2 feet, another 18" in dia. blazed and marked B.T. 4-4-1419 brs N.77° 47' E. 107.5 feet. Identical with Amended Location Corners of Chicago and Chicago No.2 claims, unsurveyed. Thence S.86° 32' E.
Variation 14° 39' East.
- 125 To bottom of draw,
- 342 Cross road,
- 600 To corner No.1, the place of beginning of exterior boundary lines of this survey.

-COPPER QUEEN NO.3-

Beginning at corner No.1. Identical with Amended Location Corner and with corner No.3 of Copper Queen this survey, before described. From which U.S.L.M. No.1419 brs N.37° 30'E. 1223 feet.

Thence North 86° 32' West.
Variation 14° 39' East.

- 600 To corner No.2, Identical with Amended Location Corner and with corner No.4 of Halliday No.3 claim. A limestone rock 6"x8"x30", set 15" in the ground, marked 2-4-1419, a stump of pinon tree 6" in dia. and 4 feet high blazed and marked B.T. 2-4-1419,

brs N.3° 42' E. 193 feet, a cedar 14" in dia.
blazed and marked B.T. 2-4-1419 brs N.46° 01' W.119 ft.
no other bearings available.

Thence North 3° 28' East.

Variation 14° 37' East.

- 345 To summit of hill,
750 To bottom of draw,
809 Cross road,
1360 To top of hill,
1500 To corner No.3. Identical with Amended Location
Corner. A rock 8"x8"x24", set 12" in the ground,
marked 3-1419, a pinon tree 15" in dia. blazed
and marked B.T. 3-1419 brs S.79° 28' W. 33 feet,
another 12" in dia. blazed and marked B.T. 3-1419
brs S. 38° 12' E. 113.5 feet, another 16" in dia.
blazed and marked B.T. 3-1419 brs S.55° 25' E.
119.5 feet. Identical with Amended Location Corner of
Chicago and Chicago No.3 claims, unsurveyed.
Thence South 86° 32' East.

Variation 14° 39' East.

- 135 Begin descent of hill,
410 To bottom of hill,
474 Cross road,
600 To corner No.4. Identical with Amended Location
Corner and with corner No.4 of Copper Queen claim
this survey, before described.

Thence South 3° 28' West.

Variation 14° 37' East.

With West boundary line of Copper Queen claim,
before described.

- 1500 To corner No.1, the place of beginning the exterior
boundary lines of this claim.

~~-HALLIDAY-~~

Beginning at corner No.1. Identical with Amended
Location Corner and with corner No.2 of Copper
Queen claim this survey, before described.

From which U.S.L.M. No.1419 brs N.8° 14' E. 1017.4 feet.

Thence South 3° 28' West.

Variation 14° 37' East.

70 To bottom of hill,
 200 To bottom of draw,
 610 To top of ridge,
 1220 To bottom of same,
 1500 To corner No.2. Identical with Amended Location Corner. A limestone rock 4"x6"x26", set 12" in the ground, marked 2-1419, a cedar 20" in dia. blazed and marked B.T. 2-1419 brs N. 69° 05' W. 100.1 feet, another 30" in dia. blazed and marked B.T. 2-1419 brs S.46° 38' W. 202.5 feet, another 8" in dia. blazed and marked B.T. 2-1419 brs S.78° 24' E. 230.2 feet. Identical with Amended Location Corner of Echo, Echo No.2 and Halliday No.2 claims, unsurveyed. Thence North 86° 32' West.

Variation 14° 40' East.

600 To corner No.3. Identical with Amended Location Corner and corner No.2 of Halliday No.3 claim. A limestone rock 7"x9"x30", set 16" in the ground, marked 3-2-1419, a cedar 14" in dia. blazed and marked B.T. 3-2-1419 brs N.83° 14' E. 117.7 feet, another 10" in dia. blazed and marked B.T. 3-2-1419 brs S.62° 15' E. 155.5 feet, another 8" in dia. blazed and marked B.T. 3-2-1419 brs S.47° 55' W. 31 feet. Identical with Amended Location Corner of Echo and Echo No.3 claims, unsurveyed. Thence North 3° 28' East.

Variation 14° 37' East.

765 Begin descent of ridge,
 1320 To bottom of draw,
 1500 To corner No.4. Identical with Amended Location Corner and with corners No.3 of Copper Queen claim this survey, No.1 of Copper Queen No.3 claim this survey, and No.1 of Halliday No.3 claim this survey, before described.

Thence South $86^{\circ} 32'$ East.

Variation $14^{\circ} 39'$ East.

With South boundary line of Copper Queen claim this survey.

600 To corner No.1 the place of beginning of exterior boundary lines of this claim.

-HALLIDAY NO.3-

Beginning at corner No.1. Identical with Amended Location Corner and with corners No.3 of Copper Queen claim, No.1 of Copper Queen No.3 claim and No.4 of Halliday claim this survey, before described.

Thence South $3^{\circ} 28'$ West.

Variation $14^{\circ} 37'$ East.

With West boundary line of Halliday claim this survey, before described.

1500 To corner No.2. Identical with Amended Location Corner and corner No.3 of Halliday claim this survey, before described.

Thence North $86^{\circ} 32'$ West.

Variation $14^{\circ} 40'$ East.

600 To corner No.3. Identical with Amended Location Corner. A limestone rock 6"x10"x24", set 12" in the ground, marked 3-1419, a pinon tree 8" in dia. blazed and marked B.T. 3-1419 brs N. $51^{\circ} 54'$ W. 29.2 feet, another 15" in dia. blazed and marked B.T. 3-1419 brs N. $79^{\circ} 15'$ E. 100.1 feet, another 12" in dia. blazed and marked B.T. 3-1419 brs S. $78^{\circ} 20'$ E. 137.2 feet. Identical with Amended Location Corner of Echo No.3 claim, unsurveyed.

Thence North $3^{\circ} 28'$ East.

Variation $14^{\circ} 37'$ East.

355 Begin descent of ridge,
1150 To bottom of draw,
1500 To corner No.4. Identical with Amended Location Corner and corner No.2 of Copper Queen No.3 claim

this survey, before described.

Thence South 86° 32' East.

Variation 14° 39' East.

With South boundary line of Copper Queen No.3 claim.

600 To corner No.1, the place of beginning exterior boundary lines of this survey.

All corners are of rock and have a X chiseled on them for exact corner point. All blazed trees have nails driven in for point. Bearing rocks have X chiseled on them for point. All corners have 2 1/2 to 3 foot mound of stone along side.

Area, Copper Queen,	20,663 acres
" Copper Queen No.3	20,663 "
" Halliday,	20,663 "
" Halliday No.3,	<u>20,663</u> "
Net Area of Survey	82,652 acres.

-LOCATION-

This survey is situated in the Francis (unformed) mining district, on unsurveyed lands, the approximate location is T.30 N.R.2 E. Gila and Salt River Base & Meridian, Coconino County, Arizona Territory.

-EXPENDITURE OF FIVE HUNDRED DOLLARS-

I certify that the value of the labor and improvements upon these claims, placed thereon by the claimants and their grantors, is not less than five hundred dollars for each lode: and that said improvements consist of the following.

-COPPER QUEEN-

- | | | | |
|------|--|-------|-----------|
| No.1 | The discovery shaft which bears from corner No.2 this claim N.23° 09' W. 556.4 feet, 6'x8'x175' deep and timbered. | Value | \$2500.00 |
| No.2 | Open Cut 6'x96' x2 feet deep which bears from E.S.C. N. | | |

	74° W. 253 feet. Course of cut N.80° W.	Value,	\$ 150.00
No.3	Shaft 4x6x10 feet, which bears from E.S.C. S.44° W. 158 feet.	Value,	100.00
No.4	Shaft 4x6x10 feet, which bears from E.S.C. S.56° 40' W. 353 feet.	Value,	100.00
No.5	Open cut 90 feet long 6'x8'. Course N. 1° W. with tunnel in North end 37 feet long 7'x7', course West. Open drift intersects 90 foot cut 35 feet from North end, 6x8x57 feet, course N.47° 30' E. Bears S.43° W. from E.S.C. 313 feet.	Value,	700.00
No.6	Shaft 4x6x10 feet, which bears from W.S.C. S.44° 30' E. 408 feet.	Value,	100.00
No.7	Open cut 16 feet long 6'x10', course of cut N.50° W. Drift from cut toward S.W. 22 feet 7'x10', bears from W.S.C. S.39° E. 400 feet.	Value,	200.00
No.8	Open cut 37 feet long, 13' wide and 8' deep, course N.50° W. Bears from W.S.C. S.30° 50' E. 390 feet.	Value,	750.00
No.9	Open cut 16 feet long, 6'x11', course N.48° W. Drift at right angle in N.W. end 6x7x17 feet. One in S.E. end 5x6x12 feet. Bears from W.S.C. S.24° E. 390 feet.	Value,	650.00
No.10	Shaft 6x8x11 feet, which bears from W.S.C. S.18° 30' E. 396 feet. Has three drifts, one toward East 5x6x15 feet, one toward S.W. 5x6x19 feet, one toward N.W. 5x6x22 feet.	Value,	500.00
No.11	Consists of strippings covering an area of 90x100 feet and an average depth of 2 1/2 feet. Bears from W.S.C. S.13° 15' E. 350 feet.	Value,	500.00
No.12	Shaft 4x6x10 feet, which bears from W.S.C. S.8° 45' E. 440 feet.	Value,	100.00
No.13	Shaft 4x6x10 feet, which bears from W.S.C. S.5° E. 484 feet.	Value,	100.00
No.14	Open drift in side hill 30 feet long, 6 feet wide, average depth of 6 feet, course of which is North. Bears N.31° 11' E. from corner No.3, 90 feet.		

		Value,	\$250.00
No.15	Open drift in side hill 30 feet long, 7 feet wide, average depth of 3 feet, with 11 foot shaft in North end, course North. Bears from corner No.3 N.72° 09' E. 125 feet.	Value,	250.00
No.16	Open cut which bears from corner No.3 N.5° 42' E. 165 feet. Course of one prong N.35° W. other N.49° E. 4x6x78 feet.	Value,	300.00
	Frame house 12x20 feet, bears S.5° E. 92 feet from N.E.C. of claim.		
	Log dugout, 14x16 feet, bears S.21° 30'E. 161 feet from N.E.C. of claim.		
-COPPER QUEEN NO.3-			
No.1	Discovery cut, 35 feet long, 6 feet wide, average depth of 6 feet. Course of cut N. 4° E. At South end of cut is drift 6x6x13 feet. Bears N.76° 30' W. from E.S.C. 347 feet.	Value,	375.00
No.2	Open cut 4x4x31 feet, course of cut N.10° E. bears from corner No.1 this claim N.27° 38' W. 50 feet.	Value,	150.00
No.3	Open cut 100 feet long 4'x4', course N.40° E. bears from corner No.1 this claim N.41° 42' W. 100 feet.	Value,	300.00
No.4	Shaft 4x6x10 feet, which bears from E.S.C. S.46° W. 152 feet.	Value,	100.00
No.5	Shaft 4x7x10 feet, which bears from E.S.C. N.87° 30' W. 314 feet.	Value,	100.00
No.6	Open cut 12x12 feet, average depth of 4 feet, bears from corner No.1 N.41° 42' W. 125 feet.	Value,	125.00

-HALLIDAY-

No.1	Discovery shaft 6x8x10 feet, timbered, which bears from W.S.C. S.51° 30' E. 260 feet.	Value,	100.00
No.2	Open cut, cross cut on each end, course of cut S.80° E. 26 feet long, 5 feet wide, and 4 feet deep. Cross cut on East end 5 1/2x20x4 feet deep. One on West 5x19x5 1/2 feet deep. Bearing from corner No.4		

	this claim S. 0° 40' E. 762 feet.	Value,	\$300.00
No.3	Shaft 5x6x8 1/2 feet, bears from Corner No.4 S.1° 35' W. 774 feet.	Value,	75.00
No.4	Open cut which bears from corner No.4 S.4° 15' E. 838 feet. Course of cut N. 27° W. and N. 62° E. 6x11x5 feet deep and 6x30x5 feet deep.	Value,	250.00
No.5	Shaft 4x8x10 feet which bears from corner No.4 S.9° 32' E. 902 feet.	Value,	100.00
No.6	Shaft 6x7x10 feet which bears from corner No.4 S.6° E. 944 feet.	Value,	100.00
No.7	Open cut which bears from corner No.4 S.9° 26' E. 974 feet. Course of cut N. 27° E. 8x10x28 feet long.	Value,	300.00
No.8	Open cut which bears from corner No.4 S. 10° 12' E. 1010 feet. Course of cut N. 38° E. 5x6x25 feet long.	Value,	200.00
No.9	Shaft 4x8x10 feet which bears from corner No.4 S. 9° 26' E. 1054 feet.	Value,	100.00
No.10	Shaft 5x8x10 feet which bears from corner No.4 S.6° 30' E. 980 feet.	Value,	100.00
No.11	Shaft 4x6x10 feet, which bears from corner No.3 S. 87° 15' E. 165 feet.	Value,	100.00
-HALLIDAY NO.3-			
No.1	Discovery shaft 4x6x10 feet, which bears from E.S.C. N. 79° W. 368 feet.	Value,	100.00
No.2	Open cut which bears from corner No.1 this claim S. 11° 08' W. 700 feet. Course of cut N.42° W. with room drifted in S.E. end. Cut 5x6x38 feet long. Room 6x10x12 feet.	Value,	350.00
No.3	Open cut, which bears from E.S.C. N.64° W. 20 feet. Course of cut S.80° W. 5x5x27 feet long. Cross cut on S.W. end by cut, course of which is N. 26° W. 5x5x34 feet long.	Value,	350.00
No.4	Shaft 5x7x8 feet, which bears from E.S.C. N. 39° W. 70 feet.	Value,	75.00

-ADJOINING CLAIMS-

The Copper Queen claim is bounded on the North by the Chicago No.2 claim, on the East by Copper Queen No.2 claim.

The Copper Queen No.3 claim is bounded on the North by the Chicago claim, on the West by U.S.land.

The Halliday claim is bounded on the East by the Halliday No.2 claim, on the South by the Echo claim.

The Halliday No.3 claim is bounded on the South by the Echo No.3 claim, on the West by U.S.Land.

All adjoining claims and lands are unsurveyed.

These adjoining claims are located and held by The Val Verde Copper Company Limited.

-VEINS-

The course of the ledges on these claims are from North to South and extend the full length throughout the center of the claims. The ore being in a blanket deposit and appears to be over the entire surface of the four claims, but the general trend of the deposit is from the North to the South.

-INSTRUMENT-

This survey was made with an A.Lietz Compound Mining Transit No.902, with Saegmuller Solar attachment. All courses were deflected from the true Meridian as determined by direct solar observations. The distances were measured with 50 ft. and 200 ft. Steel Tapes.

Note:

The disagreement between the variation of the needle in these field notes and former survey, is due to inaccuracy of needle on instrument of first survey.

James Bell Girard
U.S. Deputy Mineral Surveyor.

DESCRIPTION OF U.S.L.M. NO. 1419

These mining claims being on unsurveyed lands, and there being no United States Location Monument, nor any corner of the public surveys within the limits prescribed by law; I proceeded to establish U.S. Location Monument in the most favorable and conspicuous place. This I found to be just East of the Copper Queen claim on a very prominent hill which commands a good view of the country adjacent.

Said monument consists of a sawed pine post 6"x6"x8', set 3 feet in the ground with conical mound of stone 3 1/2 feet high with 6 foot base around it. Nail in center of top of post for point, post marked U.S.L.M. No. 1419.

From which a pinon tree 10 inches in dia. blazed and marked U.S.L.M., B.T. 1419. Brs N. 49° 27' W. 29.5 feet.

A cedar 10 inches in dia. blazed and marked U.S.L.M., B.T. 1419. Brs N. 81° 59' W. 59.2 feet.

Another 6 inches in dia. blazed and marked U.S.L.M., B.T. 1419. Brs N. 39° 48' East 8.4 feet.

Agassiz Peak, the most prominent one of the San Francisco Mountains brs S. 37° 41' E. about 42 miles.

The South perpendicular wall of Red Butte brs S. 88° 12' E. about 7 1/2 miles.

The most prominent peak of the Floyd Mountains brs S. 44° 26' W. about 70 miles.

Williams, A.T. which is the nearest town is almost due South about 42 miles.

See 7 28 22 E

James Bell Girard.
U.S. Deputy Mineral Surveyor.

FINAL OATHS FOR SURVEYS.

LIST OF NAMES.

A list of the names of the individuals employed by James Bill Girard
 United States Deputy Mineral Surveyor, to assist in running, measuring, and marking the lines
 corners and boundaries described in the foregoing field notes of the survey of the mining claim
 of The Val Verde Copper Company Ltd
 known as the Copper Queen Copper Queen No 3 Halliday and Halliday No 3
 and showing the respective capacities in which they acted.

Amos Adams, Chainman.
William Slaughter, Chainman.
 _____, Axman.
 _____, Flagman.

FINAL OATHS OF ASSISTANTS.

We, Amos Adams
 and William Slaughter, do solemnly swear that we assisted James Bill
Girard, United States Deputy Mineral Surveyor, in marking the corners and
 surveying the boundaries of the mining claims of The Val Verde Copper
Company Ltd
 known as the Copper Queen
Copper Queen No 3, Halliday and Halliday No 3, represented
 in the foregoing field notes as having been surveyed by said deputy mineral surveyor and under
 his direction; and that said survey has been in all respects, to the best of our knowledge and
 belief, faithfully and correctly executed, and the corner and boundary monuments established
 according to law and the instructions furnished by the United States Surveyor-General for
Arizona.

Amos Adams, Chainman.
William Slaughter, Chainman.
 _____, Axman.
 _____, Flagman.

Subscribed and sworn to by the above-named persons before me
 this 31st day of March, 1900

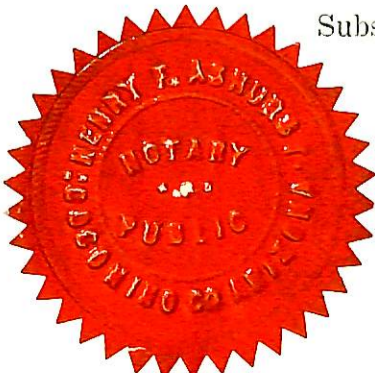

Henry F. Ashurst
 Notary Public
 Commission expires June 1, 1901

(4-686.)

FINAL OATH OF U. S. DEPUTY MINERAL SURVEYOR

I, James Bree Girard, U. S. Deputy Mineral Surveyor, do solemnly swear that, in pursuance of instructions received from the United States Surveyor General for Arizona, dated March 8th 1900, I have, in strict conformity to the laws of the United States, the official regulations and instructions thereunder, and the instructions of said Surveyor General, faithfully and correctly executed the survey of the Mining Claim of The Val Verde Copper Company Ltd, known as the Copper Queen, Copper Queen No 3, Halliday and Halliday No 3, situate in Francis (Unformed) Mining District, Cocconino County, Arizona in Section , Township No. , Range No. Unsurveyed Lands and designated as Survey No. 1419, as represented in the foregoing field notes, which accurately show the boundaries of said mining claim as distinctly marked by monuments on the ground, and described in the attached copy of the location certificate, which was received by me from the Surveyor General with said instructions, and that all the corners of said survey have been established and perpetuated in strict accordance with the law, official regulations and instructions thereunder; and I do further solemnly swear that the foregoing are the true and original field notes of said survey and my report therein, and that the labor expended and improvements made upon said mining claim by claimant or this grantors are as therein fully stated, and that the character, extent, location and itemized value thereof are specified therein with particularity and full detail, and that no portion of said labor or improvements so credited to this claim has been included in the estimate of expenditures upon any other claim.

James Bree Girard
U. S. Deputy Mineral Surveyor.

Subscribed and sworn to by the said James Bree Girard

U. S. Deputy Mineral Surveyor, before me Henry F. Ashurst

a Notary Public this 31st day of March 1900

Henry F. Ashurst
Notary Public

Commission expires June 1, 1901.



Affidavit of Five Hundred Dollars Improvements.

we, George W. Young, and Max Salzman

of lawful age, being first duly sworn according to law, depose and say: that we are acquainted with the *Copper Queen Copper Queen #3 Holiday and Holiday #3* mining claims situate in *Paria (Unformed)* Mining district, *Cocoino* County, Arizona Territory, for which *The Val Verde Copper Company Ltd* per *Cecil G. Fennell General Manager* has made application for survey prior to application for patent under the provisions of the Act of Congress, approved May 10, 1872; and that the labor done and improvements made thereon by the applicant and their grantors exceed Five Hundred Dollars in value, and further that we are not personally interested in said mine.

George W. Young
Max Salzman

TERRITORY OF ARIZONA,

County of *Cocoino*

} ss:



Sworn to and subscribed before me, this *31st* day of *March*, ~~189~~ *1900*

New F. Shurst
Notary Public

My Commission expires June 1, 1901.

Amended Location Certificate

Territory of Arizona }
 County of Coconino } ss.

Know All Men By These Presents that Cecil
 G. Finell the undersigned has this
 1st day of January 1900 amended located
 and claimed and by these presents do
 amend locate and claim by right of
 discovery and amended location in
 compliance with the mining acts of
 Congress approved May 10th 1872 and all
 subsequent acts and with Sec 7 of the
 General laws of Arizona approved Mch
 20 1895 and with local customs laws and
 regulations 1500 linear feet and horizon
 tal measurement on the Copper Queen lode
 vein or deposit along the vein thereof
 with all its dips angles variations as
 allowed by law. together with 300 feet
 on each side of the middle of said vein
 at the surface so far as can be determined
 from present developments, and all vein
 lodes, ledges or deposits and surface
 ground within the lines of said claim
 800 feet running northerly from the
 discovery shaft and 700 feet running
 southerly from discovery shaft, said
 discovery shaft being situated upon
 said lode, vein ledge or deposit and
 within the lines of said claim in
 Francis Mining District County of

Coconino and Territory of Arizona described by metes and bounds as follows, to wit, Beginning at Cor No 1 Thence South $3^{\circ}28'$ West 1500 ft to Corner No 2 Thence North $86^{\circ}32'$ West 600 ft to Corner No 3. Thence N $3^{\circ}28'$ East 1500 ft to Corner No 4 Thence S $86^{\circ}32'$ E 600 ft to Corner No 1 the place of beginning. This being the same lode originally located on the 1st day of December A.D. 1896 and recorded on the 15th day of March 1897 in Book 1 of Mines, Page 447 & 448 in the office of the Recorder of Coconino County. This further and amended certificate of location is made without waiver of any previously acquired rights, but for the purpose of correcting any errors in the original location, discription or record.

C. G. Finnell

For Val Verde Copper Co.

Recorded at request of
C. G. Finnell Feb 3rd A. D. 1900 at 2³³ P. M.

J. E. Pulliam

County Recorder

By H. C. Hibben Depty

Territory of Arizona, :
 : SS.
 County of Coconino. :

I, T. E. Pulliam, County Recorder in and for the County of Coconino, Territory of Arizona, and custodian of the records thereof, do hereby certify, that the above and foregoing is a full, true and correct copy of the Amended Certificate of Location of the Copper Queen Mining Claim, as the same appears of record in Book 3 of Mines at page 55, Records of Coconino County, Arizona.

IN WITNESS WHEREOF, I have hereunto set my hand and affixed my seal of office, this 9th day of February, A.D. 1900

T. E. Pulliam
 Recorder of Coconino County, Arizona.



Amended Location Certificate

Territory of Arizona }
 County of Coconino } ss

Know all Men by These Presents, that
 Cecil G. Fennell the undersigned has
 this 1st day of January 1900 Amended
 located and claimed and by these
 presents do amend locate and claim
 by right of discovery and amended
 location in compliance with the
 Mining acts of Congress approved May
 10th 1872 and all subsequent acts and
 with Sec. 7 of the General laws of Arizona
 approved Mch 20 1895 and with local
 customs laws and regulations 1500
 linear feet and horizontal measurements
 on the Copper Queen No³ lode vein ledge
 or deposit along the vein thereof with
 all its dips angles and variations as
 allowed by law together with 300
 feet on each side of the middle of
 said vein at the surface so far as
 can be determined from present devel-
 opments and all veins lodes ledges or
 deposits and surface ground within
 the lines of said claim 750 feet run-
 ning northerly from the discovery
 shaft and 750 feet running southerly
 from the discovery shaft said discovery
 shaft being situated upon said lode,
 vein, ledge or deposit and within the

lines of said claim in Francis Mining District County of Coconino, and Territory of Arizona described by metes and bounds as follows to wit; Beginning at Cor No 1 identical with Corner No 3 of Copper Queen. Thence N $86^{\circ} 32'$ W 600 ft to Cor. No 2 Thence N. $3^{\circ} 28'$ E 1500 ft to Cor No 3 Thence S $86^{\circ} 32'$ E. 600 ft to Cor. No 4. Thence S $3^{\circ} 28'$ W with west line of Copper Queen claim 1500 ft to Cor No. 1 the place of beginning.

This being the same lode originally located on the 1st day of June 1897 and recorded on the 4th day of Aug 1897 in Book No 2 of Mines page 23. in the office of the Recorder of Coconino County. This further amended certificate is made without waiver of any previously acquired rights but for the purpose of correcting any errors in the original location, description or record.

Lucil G. Finnell
For. Val Verde Copper Co.

Recorded at request of
L. G. Finnell, Feb. 3 A. D. 1900 at 2:31 P. M.

J. E. Pulliam
County Recorder

By H. Hibben Depty.

Territory of Arizona, :
 : SS.
 County of Coconino.:

I, T. E. Pulliam, County Recorder in and for the County of Coconino, Territory aforesaid and custodian of the records thereof do hereby certify, that I have compared the above and foregoing with, and that the same is a full, true and complete copy of the Amended Certificate of Location of the Copper Queen No 3 Mining Claim, as the same appears of record in Book 3 of Mines, at page 53, records of said Coconino County, Arizona.

IN WITNESS WHEREOF, I have hereunto set my hand and affixed my seal of Office, this 9th day of February, A.D. 1900

T. E. Pulliam

 County Recorder of Coconino County, Arizona.



Amended Location Certificate

Territory of Arizona } ss.
 County of Coconino }

Know all Men by these Presents, that,
 Cecil G. Fennell the undersigned has this
 1st day of January 1900 amended, located
 and claimed and by these presents do
 amend, locate and claim by right of
 discovery and amended location in
 compliance with the mining acts of
 Congress approved May 10th 1872 and all
 subsequent acts and with Sec. 7 of the
 General laws of Arizona approved Mch. 20
 1895 and with local customs laws and
 regulations 1500 linear feet and horizontal
 measurement on the Huldiday lode vein
 ledge or deposit along the vein thereof
 with all its dips angles and variations as
 allowed by law; together with 300 feet
 on each side of the middle of said vein
 at the surface so far as can be determined
 from present developments and all veins
 lode ledges or deposits and surface
 ground within the lines of said claim
 800 ft running northerly from the
 discovery shaft and 700 ft. running
 southerly from discovery shaft, said
 discovery shaft being situated upon
 said lode, vein, ledge or deposit and
 within the lines of said claim in
 Francis Mining District, County of

Coconino and Territory of Arizona
 described by metes and bounds, as
 follow to wit. Beginning at Cor. No. 1.
 Identical with Cor. No. 2 of Copper Queen
 Claim, Thence $S 3^{\circ} 28' W$ 1500 ft to Cor. No. 2.
 Thence $N 86^{\circ} 32' W$ 600 ft to Cor. No. 3. Thence
 $N 3^{\circ} 28' E$ 1500 ft to Cor. No. 4. Identical
 with Cor. No. 3 of Copper Queen & Cor. No. 1 of
 Copper Queen No. 3. Thence South $86^{\circ} 32' E$
 along the South boundary line of the Copper
 Queen Claim 600 ft to Cor. No. 1 the place of
 beginning. This being the same lode
 originally located on the 25th day of Dec. 1896
 and recorded on the 15th day of March 1897
 in Book 1 of Mines page 448 & 449 in the
 office of the Recorder of Coconino County.
 This further and amended certificate
 of location is made without waiver of
 any previously acquired rights but for
 the purpose of correcting any error in
 the original location description or record.

Cecil G. Finnell

For Tal Verde Copper Co.

Recorded at the request of
 C. G. Finnell Feb. 3 A. D. 1900
 at 2³⁴ P. M.

J. E. Pulliam

County Recorder

By H. Hibber Deputy

TERRITORY OF ARIZONA, :
 : SS.
 County of Coconino.:

I, T. E. Pulliam, County Recorder in and for the County of Coconino, Territory of Arizona and custodian of the records thereof, do hereby certify that the above and foregoing is a full, true and correct copy of the Amended Certificate of Location of the Holliday Mining Claim as the same appears of record in Book 3 of Mines at page 56, Records of Coconino County, Arizona.

IN WITNESS WHEREOF, I have hereunto set my hand and affixed my seal of office, this 9th day of February, A.D.1900.

T. E. Pulliam
 Recorder of Coconino County, Arizona.

By H. H. Hubbs Deputy



Amended Certificate of Location.

Territory of Arizona } ss.
 County of Coconino }

Know all men by these presents, that Cecil G. Finnell, the undersigned has this 1st day of January 1900 amended, located and claimed by these presents, do amend, locate and claim by right of discovery and amended location in compliance with the Mining acts of Congress approved May 10th 1872 and all subsequent acts and with Sec. 7 of the General Laws of Arizona approved Feb. 20 - 1895 and with local custom laws and regulations 1500 linear feet and horizontal measurement on the Skilleday No. 3 lode vein ledge or deposit along the vein thereof with all its dips angles and variations as allowed by law together with 300 ft on each side of the middle of said vein at the surface so far as can be determined from present developments and all veins lodes ledges or deposits and surface ground within the lines of said claim 700 ft running northerly from the discovery shaft, and 800 ft running southerly from the discovery shaft, said discovery shaft being situated upon said lode, ledge, vein, or deposit and within the lines of said claim in Francis Mining District, County of Coconino and Territory of Arizona described by miles and bounds as follows. Beginning at cor. No. 1 identical with cor. No. 3 of Copper Queen claim and

Cor. No. 1 of Copper Queen No. 3 and Cor. No. 5 of
Halliday claim. Thence S. $3^{\circ} 28' W$ with the
West boundary of Halliday claim 1500 ft.
to Cor. No. 2 identical with Cor. No. 3 of
Halliday claim. Thence Nor. $86^{\circ} 32' W$ 600 ft.
to Cor. No. 3. Thence north $3^{\circ} 28' E$ 1500 ft. to
Cor. No. 4 identical with Cor. No. 3 of
Copper Queen No. 3 claim. Thence South $86^{\circ} 32' E$
with the South boundary line of Copper Queen
No. 3 claim, 600 ft. to Cor. No. 1 the place of
beginning - This being the same lode origin-
ally located on the 1st day of June 1897 and
recorded on the 4th day of August 1897,
in Book 2 of Mines page 15 in the office of
the Recorder of Coconino County. This
further and amended certificate of
location is made without waiver of any
previously acquired rights, but for the purpose
of correcting any error in the original
location description or record

Cecil G. Finnell

For Val. Verde Copper Co.

Recorded at the request of
C. G. Finnell July 3rd A. D. 1900
at 2³³ P. M.

J. E. Pulliam

County Recorder

By H. C. Hibben Deputy

Territory of Arizona, :
: SS.
County of Coconino.:

I, T. E. Pulliam, County Recorder in and for the County of Coconino, Territory of Arizona and custodian of the records thereof, do hereby certify that the above and foregoing is a full, true and correct copy of the Amended Certificate of Location of the Holliday No 3 Mining Claim as the same appears of record in Book 3 of Mines at page 54, Records of Coconino County, Arizona.

IN WITNESS WHEREOF, I have hereunto set my hand and affixed my seal of Office, this 9th day of February, A.D. 1900

T. E. Pulliam
Recorder of Coconino County, Arizona.



Notice of Mining Location.

27

LODE CLAIM.

To All Whom It May Concern:

This mining claim, the name of which is the *Halliday No 3*, Mining Claim, situate on lands belonging to the United States of America, and in which there are valuable mineral deposits, was entered upon and located for the purpose of exploration and purchase by *William Nellis, Gerald M. Fennell*

the undersigned, on the *1st* day of *June* 1897

The length of this claim is *1500* feet,
and *2* claim *750* feet
in a *Northerly* direction, and *750*
feet in a *Southerly* direction from

the center of the discovery shaft, at which this notice is posted, lengthwise of the claim, together with *300* feet in width of the surface grounds, on each side of the center of said claim. The general course of the lode deposit and premises is from the *North* to the *South*

The claim is situated and located in the *Francis* Mining District, in *Cocconino* County, in the Territory of Arizona, about *7 miles* in a *Westerly* direction from *Red Butte* and is bounded on the *North* by *Copper Queen No 3*, on the *South* by *Bako No 3*.

The surface boundaries of the claim are marked upon the ground as follows: Beginning at *Centre Stake at which Discovery shaft is located*

at a point in a *Northerly* direction *750* feet from the discovery shaft (at which this notice is posted), being in the center of the *North* end line of said claim; thence *Easterly 300* feet to a *post*, being the *North East* corner of said claim; thence *Southerly 750* feet to a *post* at the center of the *East* side line of said claim; thence *Southerly 750* feet to a *post* being at the *South East* corner of said claim; thence *Westerly 300* feet to a *post* at the center of the *South* end of said claim; thence *Westerly 300* feet to a *post*, being at the *South West* corner of said claim; thence *Northerly 750* feet to a *post* being at the center of the *West* side line of said claim; thence *Northerly 750* feet to a *post* at the *North West* corner of said claim; thence *Easterly 300* feet to the place of beginning.

All done under the provisions of Chapter Six, of Title XXXII, of the Revised Statutes of the United States, and of an Act of the General Assembly of Arizona, entitled "An Act Concerning Mines," approved March 20th, 1895, and amended ~~March 20, 1897~~

Dated and posted on the ground this *1st* day of *June* 1897

(Sgd.) *Wm Nellis*
(Sgd.) *Gerald M Fennell*

Recorded at request of *Gerald M Fennell* this *4th* day of *August* A.D. 1897. at 12 O'clock A.M. *J. E. Pulliam* Recorder.

TERRITORY OF ARIZONA, :
 : SS.
 County of Coconino.:

I, T.E.Pulliam, County Recorder in and for the County and Territory aforesaid, and custodian of the records thereof, do hereby certify, that I have compared the foregoing with, and that the same is a full, true and correct copy of the Location Notice of the Holliday No. 3 Mining Claim, as the same appears of record in Book 2 of Mines, at page 15, records of Coconino County, Arizona.

IN WITNESS WHEREOF, I have hereunto set my hand and affixed my official seal, this 9th, day of October, A.D. 1899.



T. E. Pulliam

 County Recorder.



Chicago N^o 3
(Unsurveyed)

Chicago
(Unsurveyed)

Chicago N^o 2
(Unsurveyed)

Cor 3-1419
S 86° 32' E 600 ft.
Cor 4-4-1419
S 86° 32' E 600 ft.
Cor 1-1419



Williams
Road

Copper Queen N^o 3
Dis. Shaft
Shaft

Copper Queen
cut
Shaft

Copper Queen N^o 2
(Unsurveyed)

Preliminary Plat
of
Survey N^o 1419

Surveyed Mch 24-31, 1900

By J. B. Girard
U.S. Dep. Min. Surveyor

Scale 300 ft to 1 inch.

Cor 2-4-1419
N 86° 32' W 600 ft.
S 86° 32' E 600 ft.
Cor 3-1-4-1-1419
N 86° 32' W 600 ft.
S 86° 32' E 600 ft.
Cor 2-1-1419

U.S. Lands
(Unsurveyed)

Halliday N^o 3
Dis. Shaft
Shaft

Halliday
Shaft

Halliday N^o 2
(Unsurveyed)

N 3° 28' E 1500 ft.
S 3° 28' W 1500 ft.
N 3° 28' E 1500 ft.
S 3° 28' W 1500 ft.
N 3° 28' E 1500 ft.
S 3° 28' W 1500 ft.

Cor 3-1419
N 86° 32' W 600 ft.
Cor 3-2-1419
N 86° 32' W 600 ft.
Cor 2-1419

Echo N^o 3
(Unsurveyed)

Echo
(Unsurveyed)

Echo N^o 2
(Unsurveyed)

Beginning at corner No.1 identical with Amended Location Corner. A limestone rock 4"x8"x24", set 12" in the ground, marked 1 - 1419, with mound of stone along side. From which U.S.L.M. No.1419 brs S.6° 24' E. 493.4 feet; a cedar 9" in dia. blazed and marked B.T. 1-1419 brs N.60° 32' W. 83.2 feet, another 12" in dia. blazed and marked B.T. 1-1419 brs N.47° 15' W. 98.2 feet, a pinon tree 6" in dia. blazed and marked B.T. 1-1419 brs S.36° 02' W. 119 feet. Identical with Amended Location Corner of Copper Queen No.2 and Chicago No.2 claims, unsurveyed. Thence South 3° 28' West.

Variation 14° 39' East.

- 6 Cross road,
- 190 Begin ascent of hill,
- 280 Top of same,
- 1300 Begin descent of same,
- 1500 To corner No.2. Identical with Amended Location Corner and corner No.1. Of the Halliday, this survey and with Amended Location Corner of Copper Queen No.2 and Halliday No.2 claims, unsurveyed.

A limestone rock 3"x10"x30", set 15" in the ground, marked 2-1-1419, a pinon tree 12" in dia. blazed and marked B.T.2-1-1419 brs N.77° 57' E. 112.5 feet, another 12" in dia. blazed and marked B.T. 2-1-1419 brs N.64° 30' E. 142.7 feet, another 12" in dia. blazed and marked B.T. 2-1-1419 brs N.33° 57' E. 129 feet.

Thence North 86° 32' West.

Variation 14° 39' East.

- 600 To corner No.3. Identical with Amended Location Corner and corner No.1 of Copper Queen No.3 and corner No.4 of Halliday and corner No.1 of Halliday No.3. A limestone rock 5"x7"x24", set 12" in the ground, marked 3-1-4-1-1419. A X chiseled 2 feet above ground on a limestone ledge marked B.R. 3-1-4-1-1419 brs N.39° 56' W. 31.6 feet. A limestone rock in place marked B.R. 3-1-4-1-1419

PRELIMINARY OATHS OF ASSISTANTS IN SURVEY OF MINING CLAIM.

We, Amos Adam and William Slaughter do solemnly swear that we will well and faithfully execute the duties of chain carriers; that we will level the chain upon even and uneven ground and plumb the tally-pins, either by sticking or dropping the same; that we will report the true distance to all notable objects, and the true length of all lines that we assist in measuring, to the best of our skill and ability, and in accordance with instructions given us, in the survey of the Mining Claim of The Val Verde Copper

....., known as the Copper Queen Copper Queen No. 3 Halliday and Halliday No. 3 situate in Francis (Unformed) mining district, Coconino County, Arizona, in Section _____, Township No. _____, Range No. Unsurveyed Lands,

Amos Adam, Chainman.

William Slaughter, Chainman.



Subscribed and sworn to by the above-named persons before me this 24th day of March, 1900

Henry P. Shurst
Notary Public
My Commission expires June 1, 1901.

I, _____, do solemnly swear that I will well and truly perform the duties of axeman, in the establishment of corners and other duties, according to instructions given me and to the best of my skill and ability, in the survey of the Mining Claim of _____

known as the _____, more fully described in the preceding affidavit.

_____, Axeman.

Subscribed and sworn to by the said _____ before me this _____ day of _____, 18 _____.

I, _____, do solemnly swear that I will well and truly perform the duties of flagman, in the establishment of corners and other duties, according to instructions given me and to the best of my skill and ability, in the survey of the Mining Claim of _____

known as the _____, more fully described in the preceding affidavit.

_____, Flagman.

Subscribed and sworn to by the said _____ before me this _____ day of _____, 18 _____.

POOR QUALITY

The following pages are scanned at the best possible quality setting. The original pages are of poor quality and this is the best possible reproduction.

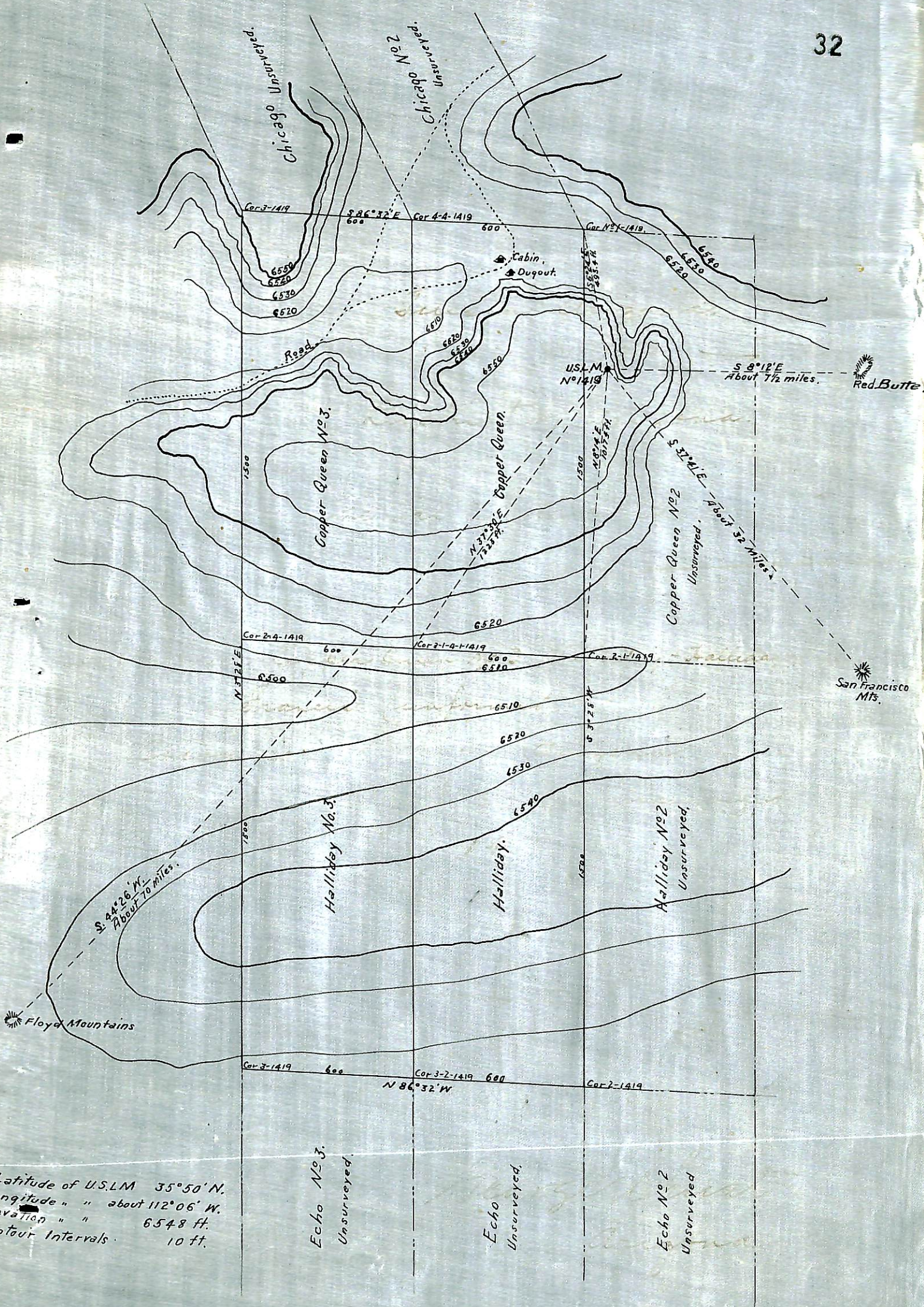

Latitude of U.S.L.M. $35^{\circ} 50' N$.
 Longitude " " about $112^{\circ} 06' W$.
 Elevation " " 6548 ft.
 Contour Intervals 10 ft.

Topographical Map of U.S.L.M. No 1419.
 scale 400ft to 1inch.

(4-687.)

Surveyor General's Certificate of Approval of Field Notes and Survey of Mining Claim.

Department of the Interior,

Office of U. S. Surveyor General,

Tucson, Arizona.

June 29-1900. 18→

I, U. S. Surveyor General for District of Arizona.,

do hereby certify that the foregoing and hereto attached Field Notes and Return of the Survey of the Mining Claim of The Val Verde Copper Company, Ltd.

....., known as the Copper Queen, Copper Queen No. 3, Halliday & Halliday No. 3. situate in Francis (unformed.) mining district,

Cocconino County, Arizona, in Section ~, Township No. ~, Range No. (unsurveyed.)

....., designated as Survey No. 1419.

executed by James Bell Girard, U. S. Deputy Mineral Surveyor, March 24-31st, 1900. 18→, under my instructions dated

March 8-1900. 18→, have been critically examined and the necessary corrections and explanations made, and the said Field Notes and Return, and

the Survey they describe, are hereby approved. A true copy of the copy of the location certificate filed by the applicant for survey is included in the field notes.

George Christ

U. S. Surveyor General for Arizona.

UNITED STATES DEPARTMENT OF AGRICULTURE
FOREST SERVICE

Arizona Zone - R-3
Phoenix, Arizona 85025

Bto

34

REPLY TO: 7150 - Cadastral Engineering

April 2, 1970

SUBJECT: Mining and Millsite Claims - Copper Queen and
Halliday (MS 1419), T. 28 N., R. 2 E., G&SR&M



TO: Charles Bazan, Chief
Branch of Titles and Records
Bureau of Land Management

Attached are copies of a plat prepared by Matkin and Sons,
Engineers.

The plat shows the location of MS 1419 with respect to the
section and $\frac{1}{4}$ corners in the SE $\frac{1}{4}$ of section 7, T. 28 N.,
R. 2 E., G&SR&M. It has been recorded in Coconino County.

The information is considered reliable. Mr. Matkin is duly
licensed by the State of Arizona and has a cooperative
agreement with the U.S.F.S. to furnish private survey
information.

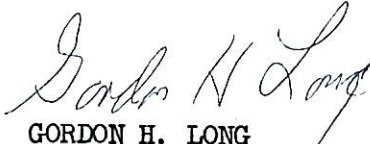
GORDON H. LONG
Zone Cadastral Surveyor

Attachments: 2

LAND OFFICE
PHOENIX, ARIZONA

1970 APR 2 AM 11 36 J

RECEIVED
BUREAU OF
LAND MANAGEMENT

MANO