

**MS**

**0**

**1**

**4**

**2**

**6**

*Rec'd Dec 1/99*

(4-683.)

Mineral Survey No. 1426

Lot No. \_\_\_\_\_

Prescott Land District.

### FIELD NOTES

OF THE SURVEY OF THE MINING CLAIM OF

E. Gary

Phoenix, Maricopa Co. Ariz.

KNOWN AS THE

Graphic Lode

Humburg Mining District,

Yavapai County, Arizona

Section Unsurveyed, Township 9<sup>th</sup> N., Range 1<sup>st</sup> W.

Surveyed under instructions dated Nov. 16<sup>th</sup>, 1899

by James C. Lobbins  
U. S. Deputy Mineral Surveyor.

Claim located Oct. 15<sup>th</sup> 1892 + Am. Oct. 15, 1899

Survey commenced Nov 23, 1899.

Survey completed Nov 25, 1899.

# PRELIMINARY OATHS OF ASSISTANTS IN SURVEY OF MINING CLAIM.

WE, Dennis Welsh and E. W. North, do solemnly swear that we will well and faithfully execute the duties of chain carriers; that we will level the chain upon even and uneven ground and plumb the tally-pins, either by sticking or dropping the same; that we will report the true distance to all notable objects, and the true length of all lines that we assist in measuring, to the best of our skill and ability, and in accordance with instructions given us, in the survey of the Mining Claim of E. Lang

....., known as the Graphi Lodge situate in Humburg mining district, Yavapai County, Arizona, in Section 11 Township No. 9 N., Range No. 1 W. Gr. S. R. 3 M.

Dennis Welsh, Chainman.  
E. W. North, Chainman.

Subscribed and sworn to by the above-named persons before me this 23rd day of November, 1899.

*My Commission expires Oct 2nd 1905*

J. C. Robbins  
Natary Public.

I, ....., do solemnly swear that I will well and truly perform the duties of axeman, in the establishment of corners and other duties, according to instructions given me and to the best of my skill and ability, in the survey of the Mining Claim of .....

known as the ..... more fully described in the preceding affidavit.

....., Axeman.

Subscribed and sworn to by the said ..... before me this ..... day of ....., 18 ..

I, ....., do solemnly swear that I will well and truly perform the duties of flagman, in the establishment of corners and other duties, according to instructions given me and to the best of my skill and ability, in the survey of the Mining Claim of .....

known as the ..... more fully described in the preceding affidavit.

....., Flagman.

Subscribed and sworn to by the said ..... before me this ..... day of ....., 18 ..

Survey No 1426 The Graphic Lodge

Feet

- Beginning at corner No 1. Identical with location. A granite rock 6x12x28 ins. set 12 ins. in the ground. With mound of stone. Chiseled Cor. No. 1. 1426.  
 Thence bears N 28° 15' W 553 ft. U. S. L. M. No 1396. No bearings available.  
 Thence N 82° 50' E  
 Va 13° 40' E
- 750 To North Side Center. Identical with location. A granite rock 6x10x24 ins. set 12 ins. in the ground. With mound of stone. Chiseled N. S. C. 1426.  
 No bearings available.  
 Thence N 82° 50' E  
 Va. 13° 40' E
- 1500 To Corner No. 2. Identical with location. A granite rock 4x12x28 ins. set 12 ins. in the ground. With mound of stone. Chiseled Cor. No. 2. 1426  
 No bearings available.  
 Thence 57° 10' E  
 Va 13° 40' E
- 300 To East End Center. Identical with location. A granite boulders in place 20 ins. in diameters and 8 ins. above ground. With mound of stone. Chiseled E. E. C. 1426.  
 No bearings available.
- 480 To top of Gold Hill
- 600 To Corner No 3. Identical with location. On point of Granite Cliff. 18 ft high. Bench 2 ft. wide. Cliff 6 ft high facing South. Mound of stone on upper cliff. Chiseled x Cor. No 3. 1426  
 Thence bears S 36° 00' E 1/2 mile, Montgomery's Spring on Tule Creek.  
 No bearings available.  
 Thence S 82° 50' W  
 Va 13° 40' E

Survey No 1426 The Graphic Lode.

Feet

- 300 To Top of Gold Hill.
- 750 To South Side Center. Identical with location. Granite boulder 24 x 30 ins. 6 ins above ground. With mound of stones. Chiseled S.S.C. 1426  
No bearings available.
- 1500 To Corner No 4. Identical with location. A Granite boulder 6 x 8 x 28 ins set 12 ins. in the ground. With mound of stones. Chiseled Cor No 4 1426  
No bearings available.  
Thence N 7° 10' W  
Va 13° 40' E
- 300 To West Center End. Identical with location. A Granite rock 6 x 16 x 24 ins. set 12 ins. in the ground. With mound of stone. Chiseled W.C.E. 1426  
Thence bears N 86° 15' E 120 ft, a tunnel 4 x 6 x 18. No bearings available.
- 600 To Cor No 1. The place of beginning.

Areas.

Total area of Graphic Lode	20.66 acres
No conflicts	—
Net area of Graphic Lode	20.66 acres.

Survey No 1426

The Graphic Lode.

## Location.

This claim is located on unsurveyed ground in Township 9 N. R. 1 W. G. & S. R. M. In Humburg Mining District, Yavapai County, Arizona on the East Spur of Gold Hill. There are no adjoining claims.

## Expenditure of Five Hundred Dollars.

I certify that the value of labor and improvements on the claim, placed there by the claimant and his grantors is not less than Five Hundred Dollars and said improvements consist of

The discovery shaft of the Graphic, a shaft 6x8 ft. 50 ft. deep in Granite which bears from North Side Center, S 28°15' E 325 feet. Mineral in place and 1 claim S. 82°50' W 866 feet on the Ledge and N 82°50' E 634 feet on said Ledge. Value \$750.00

From North Side Center bears S 39°15' E 175 feet Approach 6 ft wide 16 ft face, a tunnel 4x6x6 ft. in Granite. Course S 76°00' E Value \$150.00

From West End Center bears N 86°15' E 60 feet cut 4 ft wide 62 ft long 20 ft face. Tunnel 4x6x18 ft Kinge 4x6x5 ft. course N 87°00' E. Mineral in place Value \$350.00

Respectfully submitted,

Phoenix Nov 28 '99

JAMES C. DOBBINS  
U.S. Dep Min Surv.  
Instrument.

This survey was made with a Gurley Complete Engineer's Transit. The courses were deflected from the true meridian as determined by solar observations. The distances were measured with a 100 ft. steel chain.

Respectfully submitted,

# FINAL OATHS FOR SURVEYS.

## LIST OF NAMES.

A list of the names of the individuals employed by James C. Dobbin's  
 United States Deputy Mineral Surveyor, to assist in running, measuring, and marking the lines  
 corners and boundaries described in the foregoing field notes of the survey of the mining claim  
 of E. Ganz  
 known as the Graphie Lode  
 and showing the respective capacities in which they acted.

Dennis Welch, Chairman.  
C. W. North, Chairman.  
 \_\_\_\_\_, Axman.  
 \_\_\_\_\_, Flagman.

## FINAL OATHS OF ASSISTANTS.

We, Dennis Welch  
 and C. W. North do solemnly swear that we assisted James C. Dobbin's  
Dobbin's, United States Deputy Mineral Surveyor, in marking the corners and  
 surveying the boundaries of the mining claim of E. Ganz

See, known as the Graphie  
See represented  
 in the foregoing field notes as having been surveyed by said deputy mineral surveyor and under  
 his direction; and that said survey has been in all respects, to the best of our knowledge and  
 belief, faithfully and correctly executed, and the corner and boundary monuments established  
 according to law and the instructions furnished by the United States Surveyor-General for  
Arizona

Dennis Welch, Chairman.  
C. W. North, Chairman.  
 \_\_\_\_\_, Axman.  
 \_\_\_\_\_, Flagman.

Subscribed and sworn to by the above-named persons before me  
 this 25<sup>th</sup> day of November, 1899

My Commission expires  
Oct 2<sup>nd</sup> 1903.

J. C. Hobbin's  
 Notary Public.

FINAL OATH OF U. S. DEPUTY MINERAL SURVEYOR

I, James C. Robbins, U. S. Deputy Mineral Surveyor, do solemnly swear that, in pursuance of instructions received from the United States Surveyor General for ~~November 16<sup>th</sup> Arizona~~, dated November 16<sup>th</sup>, 1899, I have, in strict conformity to the laws of the United States, the official regulations and instructions thereunder, and the instructions of said Surveyor General, faithfully and correctly executed the survey of the Mining Claim of E. Gang, known as the Graphic Lode, situate in Humburg Mining District, Yavapai County, Arizona, in Section unsurveyed, Township No. 9<sup>th</sup>, Range No. 1<sup>st</sup> W. 4<sup>th</sup> S. R. 3<sup>rd</sup> E. and designated as Survey No. 1426, as represented in the foregoing field notes, which accurately show the boundaries of said mining claim as distinctly marked by monuments on the ground, and described in the attached copy of the location certificate, which was received by me from the Surveyor General with said instructions, and that all the corners of said survey have been established and perpetuated in strict accordance with the law, official regulations and instructions thereunder; and I do further solemnly swear that the foregoing are the true and original field notes of said survey and my report therein, and that the labor expended and improvements made upon said mining claim by claimant or his grantors are as therein fully stated, and that the character, extent, location and itemized value thereof are specified therein with particularity and full detail, and that no portion of said labor or improvements so credited to this claim has been included in the estimate of expenditures upon any other claim.

James C. Robbins  
U. S. Deputy Mineral Surveyor.

Subscribed and sworn to by the said James C. Robbins  
U. S. Deputy Mineral Surveyor, before me Lavinia M. Andrews a Notary  
Public and of the County of Yavapai, Arizona, this 21<sup>st</sup>  
day of December, 18 99.

My Commission  
expires July 15, 1900.

Lavinia M. Andrews,  
Notary Public



Affidavit of Five Hundred Dollars Improvements.

We, Dennis Welsh, and E. W. North

of lawful age, being first duly sworn according to law, depose and say: that we are acquainted with the Lupine Lode mining claim, situate in Humbug Mining district, Yavapai County, Arizona Territory, for which E. Ganz

has made application for survey prior to application for patent under the provisions of the Act of Congress, approved May 10, 1872; and that the labor done and improvements made thereon by the applicant and grantor exceed Five Hundred Dollars in value, and further that we are not personally interested in said mine.

Dennis Welsh  
E W North

TERRITORY OF ARIZONA,  
County of Yavapai } ss:

Sworn to and subscribed before me, this 25<sup>th</sup> day of November, 1899.

J. C. Robbins  
Notary Public

My Commission expires  
Oct 27<sup>th</sup> 903

## AMENDED LOCATION CERTIFICATE.

KNOW ALL MEN BY THESE PRESENTS, that I, Emil Ganz of the County of Maricopa, Territory of Arizona, do hereby make this my amended certificate of location upon the "Graphic" lode mining claim situate in the Humbug Mining District County of Yavapai Territory of Arizona, claiming three hundred feet in width of each side of the center of said lode at the surface and all veins, lodes and ledges within the lines of said claim with their dips, variations and angles. Eight hundred and eighty-three feet on said lode running south 82 degrees and fifty minutes West from the center of the discovery shaft and six hundred and seventy<sup>8</sup> feet north 82 degrees and 50 minutes East from said center of discovery shaft. Said lode Mining Claim is bounded and described as follows to-wit: Beginning at the west end center monument of stone of said claim, thence north three hundred feet 7 degrees and 10 minutes west to the north-west corner monument of stone, thence north seven hundred and fifty feet 82 degrees and 50 minutes East to the north side center monument of stone, thence north seven hundred and fifty feet 82 degrees and 50 minutes East to the north-east corner monument of stone, thence south three hundred feet 7 degrees and 10 minutes East to east end center monument of stone, thence south three hundred feet 7 degrees and 10 minutes East to the south-east corner monument of stone, thence south Seven hundred and fifty feet 82 degrees and 50 minutes West to the south side center monument of stone, thence south seven hundred and fifty feet 82 degrees and 50 minutes west to the south-west corner monument of stone, thence north three hundred feet 7 degrees and 10 minutes west to the place of beginning. Said lode mining claim being about three hundred feet north from the summit of Gold Hill and about one-half mile south from Willow Spring in said County and Territory, and being the same lode of which the original location certificate made by R.D. Cole is filed and recorded in book 35 of Mining Claims at page 112 in the Office of the County Recorder of said Yavapai County. This amended certificate is filed without waiver of any previous rights for the purpose of correcting and making



(4-687.)

# Surveyor General's Certificate of Approval of Field Notes and Survey of Mining Claim.

Department of the Interior,

Office of U. S. Surveyor General,

*Tucson, Arizona.*

*January 5" , 1900.*

I, U. S. Surveyor General for *District of Arizona*,  
do hereby certify that the foregoing and hereto attached Field Notes and Return of the  
Survey of the Mining Claim of *E. Ganz*

....., known as the  
*Graphic lode*,

situate in *Humburg* mining district,

*Yavapai* County, *Arizona*,

in Section *—*, Township No. *—*, Range No. *(unsurveyed.)*

*—*, designated as Survey No. *1426*.

executed by *James C. Erbine*, U. S. Deputy Mineral

Surveyor, *Nov. 23 - 25"*, 1899, under my instructions dated

*Nov. 16"*, 1899, have been critically examined and the

necessary corrections and explanations made, and the said Field Notes and Return, and

the Survey they describe, are hereby approved. A true copy of the copy of the location

certificate filed by the applicant for survey is included in the field notes.

*George Christ*

U. S. Surveyor General for *Arizona*.

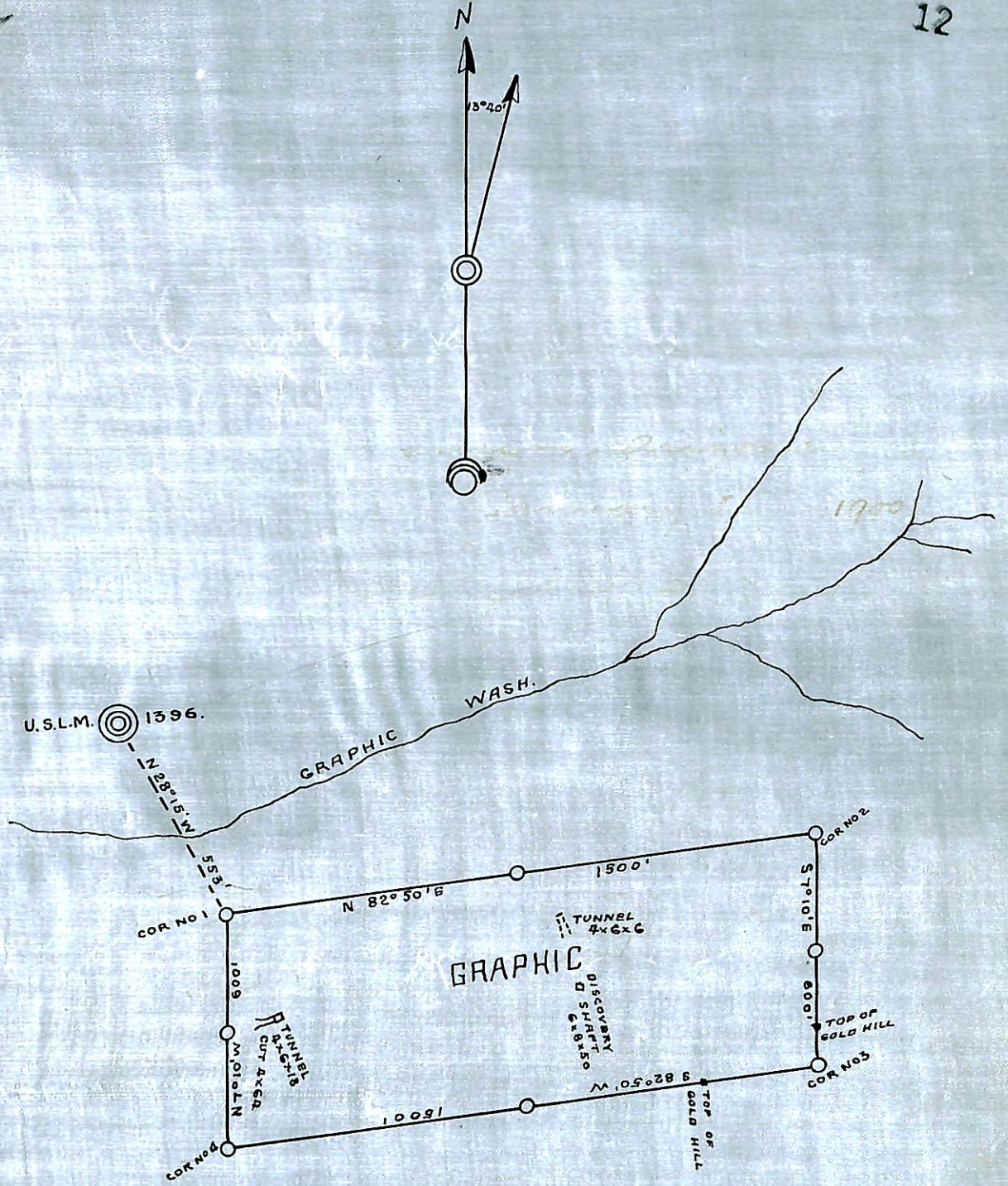

Survey No 1426

GRAPHIC LODE

SURVEYED Nov. 23-25-1899.

By J. C. DOBBINS,

U. S. DEPT. MIN. SUR.

SCALE 400 FT. TO 1 INCH.