

**MS**

**0**

**1**

**5**

**4**

**6**

## MINERAL SURVEY NO. 1546

Claims	M & B Desc.	Improvements	Loc. Notices
Copper Cliff	4	15	2
Denver No. 1	7	15	3
Denver No. 2	11	16	4
Pittsburgh	1	14	1

Rec'd April 15-1901

Form 683

(4-683.)

Mineral Survey No. 1546.

Lot No. \_\_\_\_\_

Gila

Land District.

FIELD NOTES

OF THE SURVEY OF THE MINING CLAIMS OF

Edwin Scott (J. D. Coplen Agent)

KNOWN AS THE

Pittsburgh, Copper Cliff, Denver No 1 & Denver No 2.

in Cañon del Oro Mining District,

Pinal County, Arizona

Section 5, 6, 7 & 8 Township 10 South, Range 15 East

Surveyed under instructions dated March 15<sup>th</sup>, 1901,

by Charles von Exleben

U. S. Deputy Mineral Surveyor

Claims located (amended) February 1<sup>st</sup>, 1901.

Survey commenced March 22<sup>nd</sup>, 1901.

Survey completed March 25<sup>th</sup>, 1901.

6-160

Address:

Edwin Scott

per J. D. Coplen, Agent

Tucson, A. S.

P. O. Box 68.

PRELIMINARY OATHS OF ASSISTANTS IN 2 SURVEY OF MINING CLAIM.

We, Jacob Schreck and George Mc Williams

do solemnly swear that we will well and faithfully execute the duties of chain carriers; that we will level the chain upon even and uneven ground and plumb the tally-pins, either by sticking or dropping the same; that we will report the true distance to all notable objects, and the true length of all lines that we assist in measuring, to the best of our skill and ability, and in accordance with instructions given us, in the survey of the Mining Claims of Edwin Scott, per J. J. Copley

Copley Agent, known as the Pittsburgh, Copper Cliff, Denver No 1 and Denver No 2 situate in Canon del Oro mining district, Siual County, Arizona in Sections 5, 6, 7 & 8, Township No. 10 South, Range No. 15 East

Jacob Schreck, Chairman.  
Geo Mc Williams, Chairman.

Subscribed and sworn to by the above-named persons before me this 22<sup>nd</sup> day of March, 1901.

Charles von Esleben  
Notary Public.

I, John G. Hall, do solemnly swear that I will well and truly perform the duties of axeman, in the establishment of corners and other duties, according to instructions given me and to the best of my skill and ability, in the survey of the Mining Claims of Edwin Scott, per J. J. Copley

Copley Agent known as the Pittsburgh, Copper Cliff, Denver No 1 and Denver No 2 more fully described in the preceding affidavit.

John G. Hall, Axeman.

Subscribed and sworn to by the said John G. Hall before me this 22<sup>nd</sup> day of

March, 1901.

Charles von Esleben  
Notary Public.

I, Thomas Mc Kinney, do solemnly swear that I will well and truly perform the duties of flagman, in the establishment of corners and other duties, according to instructions given me and to the best of my skill and ability, in the survey of the Mining Claim of Edwin Scott, per J. J. Copley

Copley Agent known as the Pittsburgh, Copper Cliff, Denver No 1 and Denver No 2 more fully described in the preceding affidavit.

Thomas Mc Kinney, Flagman.

Subscribed and sworn to by the said Thomas Mc Kinney before me this 22<sup>nd</sup> day of

March, 1901.

Charles von Esleben  
Notary Public.

My commission expires January 10<sup>th</sup> 1905.

Mineral Survey No 1546.

Pittsburgh Lode.

Beginning at Cor No 1 identical with the S.W. Corner of the location and - with the S.E. Cor of The Copper Hill Mining Claim. - Survey No. 1547.

Cor of sections 7, 6, 7 and 12. T. 10 S. Range 14 and 15 East bears 26 - 73° 53' W. 3363<sup>±</sup> feet. -

A pine post 4½ feet long - 4 inches square set 18 inches in the ground Scribed C. T. P. 1546, with mound of stone 5 ft base 2½ ft high alongside.

Thence 2621° 15' E.

Variation 12° 58' East

Along the East End line of The Copper Hill Mining Claim and ascending small hill.

200. top of hill and descend

300. to West End Center of the Claim - identical with the Corner of the location and with the East End Center of the Copper Hill Mining Claim. - This point falls on a small saddle sloping Easterly and westerly. -

A pine post 4½ feet long 4 inches square set 18 inches in the ground Scribed W. E. C. T. P. 1546 with mound of stone 5 feet base 2½ feet high - alongside.

Ascending the Southern slope of a big hill.

600. to Corner No 2 identical with the location and with the NE Corner of The Copper Hill Mining Claim.

Feet

Pittsburgh Code (Continued)

A pine post  $4\frac{1}{2}$  feet long 4 inches square set 18 inches in the ground - Scribed C. 2. P. 1546, with mound of stone 5 ft base and  $2\frac{1}{2}$  feet high alongside

Thence S.  $73^{\circ} 53' E.$  -

Variation  $13^{\circ} 02' East$

Along the southern slope of steep-side hill

- 375 Gulch 10 ft wide Course Southerly
- 635 Gulch 8 ft wide Course Southerly
- 1030 Gulch 10 ft wide Course Southerly
- 1440 Gulch 15 ft wide Course Southwesterly
- 1500 to Corner no 3 identical with the location -

A pine post  $4\frac{1}{2}$  feet long 4 inches square set 18 inches in the ground Scribed C. 3. P. 1546, with mound of stone 5 ft base and  $2\frac{1}{2}$  feet high alongside

Thence S.  $21^{\circ} 15' West$

Variation  $13^{\circ} East$

Over level slightly broken ground

- 250. Descend into Canon. -
- 300 East End Center of the Claim identical with the location -
- A pine post  $4\frac{1}{2}$  feet long 4 inches square set 18 inches in the ground Scribed E.E.C. P. 1546 with mound of stone 5 feet base  $2\frac{1}{2}$  feet high alongside
- 350 North Bank of Canon Course Westerly

Feet Pittsburgh Lode (Continued)

400. South Bank of Cañon, Course Westerly ascend Ridge

600. to Corner No 4 identical with the location

A Pine post 4 1/2 feet long 4 inches square set 18 inches in the ground Scribed C. H. P. 1846. - with mound of stone 5 feet base 2 1/2 feet high alongside -

Thence N. 73° 53' W.

Variation 13° East

Descending into Cañon

290 South Bank of Cañon Course Westerly

360 North Bank of Cañon Course westerly along side hill sloping southerly - into the Cañon. -

830 Gulch 10 ft Wide Course Southerly ascending ridge sloping - southerly and easterly

1500 to Corner No 1 the place of beginning



Feet

Mineral Survey No 1546.

Copper Cliff Lode.

Beginning at Corner no 1. identical with the South West Corner of the location and with Corner no 4 of The Pittsburgh Lode - Corners of Sections 1, 6, 7, and 12 T. 10. S. Range 14 and 15 East. bears north  $75^{\circ} 53' W.$  4863  $\frac{1}{2}$  feet.

A pine post  $4\frac{1}{2}$  feet long 4 inches square set 18 inches in the ground - scribed C. T. C. C. 1546 with mound of stone 5 ft base and  $2\frac{1}{2}$  feet high alongside

Thence N.  $21^{\circ} 15' E.$

Variation  $15^{\circ}$  East

Along the East End line of The Pittsburgh Mining Claim.

- 200 Descend into Canon Course Westerly
- 250 South Bank of Canon Course westerly
- 300 North Bank of Canon Course westerly
- 300 West End Centre of the Claim -

identical with the location and with the East End Centre of The Pittsburgh Lode.

A pine post  $4\frac{1}{2}$  feet long 4 inches square set 18 inches in the ground scribed W. E. C. C. 1546 with mound of stone 5 ft base  $2\frac{1}{2}$  feet high alongside.

- 350 Ascending small flat top of flat, thence over slightly broken ground

600 to Corner no 2 identical with the location and with Corner no 3 of The Pittsburgh Lode



Trail Copper Cliff Lode (Continued)

A pine post 4 1/2 feet long 4 inches square set 18 inches in the ground - Scribed C. N. C. C. 1546 with mound of stone 5 feet base and 2 1/2 feet high alongside

Thence S 67° 51' E.  
Variation 13° East

Ascending and along side till sloping southerly

- 300. Top of ascend and descent
- 600. Gravel 10 ft wide course southerly ascend ridge sloping southerly
- 1050 Top of ridge and descend along - steep rocky side till sloping southerly
- 1500 to corner No 3 identical with the location.

A pine post 4 1/2 ft long 4 inches square set 18 inches in the ground, scribed - C. N. C. C. 1546. with mound of stone 5 feet base and 2 1/2 feet high alongside.

Thence S 21° 15' W.  
Variation 13° East.

- 235 Descending into Canon Course westerly
- 280 North Bank of Canon Course westerly
- 280 South Bank of Canon Course westerly

Ascend steep high ridge

- 300 East End Center of the claim and identical with the location

A pine post 4 1/2 ft long 4 inches square set 18 inches in the ground scribed E. E. C. C. 1546. with mound of stone 5 feet base 2 1/2 feet high alongside -

- 600 to corner No 4 identical with the location.

Feet

Copper Cliff Lode (Continued)

A fine post 4 1/2 feet long 4 inches square  
Set 18 inches in the ground, scribed  
C. H. C. C. 1546. with mound of stone  
5 feet base and 2 1/2 feet high  
Along side

Thence N 67° 51' W. -  
Variation 13° East. -

530 Along steep high ridge sloping northerly  
1500 Gulch 10 feet wide Course northerly  
to corner 20-1 The place of beginning.



Feet.

Mineral Survey No 1546.

Denver No. 1 Lode.

Beginning at Corner No 1 identical with the S.W. Corner of the location and with Corner No 4 of The Copper Cliff Lode - Corner of Section No 1, 6, 7, and 12 T. 10 South, Range 14 and 15 East bears north  $72^{\circ} 27'$  West - 635 feet.

A pine post  $4\frac{1}{2}$  feet long 4 inches square set 18 inches in the ground scribed C. I. D. 1. 1546 with mound of stone 5 feet base  $2\frac{1}{2}$  feet high alongside -

Thence N.  $21^{\circ} 15'$  East.  
Variation  $13^{\circ}$  East

300 Along the East End line of The Copper Cliff Lode. descending steep rocky ridge sloping northerly, West End Center of the claim identical with the location and with the East End Center of The Copper Cliff Lode

A pine post  $4\frac{1}{2}$  feet long 4 inches square set 18 inches in the ground scribed W. E. C. D. 1. 1546 with mound of stone 5 ft base and  $2\frac{1}{2}$  feet high alongside.

320 South Bank of Canon Course westerly  
365 North Bank of Canon Course westerly ascending steep side hill sloping southerly.

Feet Denver No 1 Code (Continued)

600 to Corner No 2 identical with the location and with Corner No 3 of the Copper Cliff Code.

A pine post  $4\frac{1}{2}$  feet long 4 inches square set 18 inches in the ground. Scribed C. S. D. 1. 1546. with mound of stone 5 feet base  $2\frac{1}{2}$  feet high alongside

Thence S.  $67^{\circ} 51'$  East. -  
Variation  $13^{\circ}$  East

Descending into Cañon over rough rocky ground

730. West Bank of Cañon Course Southwesterly

775. East Bank of Cañon Course Southwesterly ascend along southern slope of Big Ridge

800. top of ridge and descend small steep Cañon.

1280 West Bank of Cañon Course Southwesterly

1300 East Bank of Cañon Course Southwesterly ascend

1500 to Corner No 3 identical with the location

A pine post  $4\frac{1}{2}$  feet long 4 inches square set 18 inches in the ground Scribed C. S. D. 1. - 1546. with mound of stone 5 feet base  $2\frac{1}{2}$  feet high - alongside -

Thence

Denver No. 1. Lead (Continued)

Thence S. 21° 15' W

Variation 13° East

Descending into Cañon

235. North Bank of Cañon Course Westerly -  
thence Southwesterly

300. East End Center of Claim identical  
with the location. -

A pine post 4 1/2 feet long 4 inches  
square set 2 feet in the ground.

Scribed E. E. C. D. 1. 1546: with  
mound of stone 7 feet base and 2 1/2  
feet high alongside. -

This monument is exceptionally -  
strong built.

305. South Bank of Cañon Course -

Westerly thence Southwesterly -  
Ascending steep rocky ridge -  
along East Bank of steep gulch.

As the East End Center monument  
is situated in the Cañon and as in case  
of an exceptional big flood it might be  
washed away. I establish at -

320. besides the aforesaid monument, a  
Witness Corner.

A pine post 4 1/2 feet long 4 inches -  
square set 18 inches in the ground -

Scribed E. E. C. D. 1. 1546 W. C.  
with mound of stone 5 feet base 2 1/2 feet  
high alongside

600 to Corner No 4 identical with the  
location - A pine post 4 1/2 feet long 4 inches  
square set 18 inches in the ground Scribed C. 4 D. 1. 1546,  
with mound of stone 5 feet base 2 1/2 feet high  
alongside.

Feet  
Lewis No 1 Lode (Continued)

Thence N. 67° 51' W

Variation 13° East

along steep rocky side hill of big ridge -  
sloping northerly

- 10. Gulch - 10 feet wide Course northerly
- 180. Gulch - 15 feet wide Course northerly
- 380 Gulch - 15 feet wide Course northerly
- 700 Gulch 10 feet wide Course northerly
- 1300 Gulch 10 feet wide Course northerly
- 1500 to corner 2nd the place of beginning

Feet  
Denver No 2 Code

Beginning at Corner 2001 identical with the S.W. Corner of the location and with Corner 2004 of The Denver No 1 Mining Claim. -

Corner of Sections 1, 6, 7 and 12 T. 10 South Range 14 and 15 East, bears N 71° 34' W. 7853 feet. -

A Pine Post 4 1/2 feet long 4 inches square set 18 inches in the ground Scribed C. I. D. 2, 1546. with mound of stone 5 ft base 2 1/2 feet high - Alongside

Thence N. 21° 15' East

Variation 13° East

Descending steep rocky ridge along East side of side of steep gulch into Cañon.

280 Witness Corner for the East End Center of The Denver No 1 Mining Claim.

A Pine Post 4 1/2 feet long 4 inches square Scribed W. E. C. D. 2, 1546. W. C. set 18 inches in the ground with mound of stone 5 ft base 2 1/2 feet high alongside.

295 South Bank of Cañon Course westerly Thence Southwesterly.

300 West End Center of the Claim, identical with the location and with the East End Center of the Denver No 1 Mining Claim. -

A Pine post 4 1/2 feet long 4 inches square set 2 feet in the ground - Scribed W. E. C. D. 2, - 1546. with mound of stone 7 feet base 2 1/2 feet high alongside. -

365 North Bank of Cañon, ascending 600 to Corner No 2 identical with the location

Feet

# Denver No 2 Lode Continued

And with Corner nos of the Denver  
200 / Mining Claim.

A pine post 4 1/2 feet long 4 inches  
square set 8 inches in the ground  
with mound of stone 5 feet -  
base 2 1/2 feet high alongside.

Thence S. 64° 18' E. -

Variation 13° East. -

640 Along side hill sloping southerly  
1500 Cañon 35 feet wide Course South-westerly.  
to Corner No 3 identical with the  
location.

A pine post 4 1/2 feet long 4 inches  
square set 8 inches in the ground.  
Scribed C. J. D. N. 1546, with mound  
of stone 5 feet base 2 1/2 feet high -  
alongside.

Thence S. 21° 15' W.

Variation 13° East

Gently descending into Cañon  
200 North Bank of Cañon, Course N. W. by.  
250 South Bank of Cañon, Course Northwestly. -  
300 East End Center of the Claim -  
identical with the location.

A pine post 4 1/2 feet long 4 inches  
square set 8 inches in the ground -  
Scribed E. E. C. D. N. 1546 with -  
mound of stone 5 feet base 2 1/2 feet -  
high alongside.

Ascending steep ridge sloping -  
northerly



Feet

Denver No 2 Lode (Continued)

600 To Corner No 4 identical with the location  
 A Pine Post  $4\frac{1}{2}$  feet long 4 inches  
 square set 18 inches in the ground -  
 Scribed C. F. D. R. 1546. with  
 Morand of Stone 5 ft base  $2\frac{1}{2}$  feet  
 high alongside

Thence North  $64^{\circ} 18'$  West

Variation  $13^{\circ}$  East

Along the side hill of a steep rocky-  
 ridge sloping northerly. -

100. Gulch 10 feet wide Course northerly  
 200 Gulch 15 feet wide Course northerly  
 450 Gulch 12 feet wide Course northerly  
 900 Gulch 15 feet wide Course northerly  
 1500 To Corner No 1 The place of beginning.

AREA:

Total and Net area:

Pittsburgh Lode - 20.57 acres  
 Copper Cliff " - 20.66 "  
 Denver No 1. " - 20.66 "  
 Denver No 2. " - 20.60 "

Total and net area of all

Claims: 82, 49 acres

The surveys of the Pittsburgh, Copper Cliff,  
 Denver No 1, and Denver No 2, Lodes are  
 identical with the respective locations. -

## Location.

These claims are located on unsurveyed land approximate in sections - 5, 6, 8 and 9. Township 10 South Range 15 East, Gila and Salt River Meridian in Canon del Oro Mining District Pinal County Territory of Arizona about 30 miles northeasterly from Tucson. - The nearest Post Office is Oracle Pinal County Arizona about 6 miles distant. -

Expenditure of Five Hundred Dollars. I Certify that the value of the labor and improvements upon these claims placed thereon by the Claimant and his Grantors is not less than five hundred dollars for each claim and that said - improvements consist of:

### A. Pittsburgh Lode

- |  |                 |
|--|-----------------|
| No. 1. Discovery Shaft 5x6 feet 12 feet deep which bears from west End Center of the Claim S. - 73° 53' E. 65 feet dist:             | Value \$ 100.00 |
| No 2. A Cut - 6 feet deep - 4 feet wide - 30 feet long all in rock which bears from west End Center S 73° 53' East 100 feet distant: | Value \$ 300.00 |
| No 3. A Shaft 4x6 feet 11 feet deep, which bears from west End Center S. 76° 30' East 405 feet distant:                              | Value \$ 100.00 |
| Total Value  | \$ 500.00       |

# Copper Cliff Lode

No 1 Discovery Cut 4x6 feet - 25 feet long -  
 The Center of which bears from the West  
 End Center of the Claim, S. 67° 51' East  
 80 feet distant Value - \$ 200.00

No 2 A Tunnel The northerly Extension  
 of the Discovery Cut 4x6 feet 15 feet  
 long all in rock The mouth of which  
 bears from the West End Center of the  
 Claim, S. 76° 50' East 80 feet dist:  
 Course of Tunnel and Cut N 12° 15' East.  
 Value \$ 150.00

No 3 A Shaft 5x6 feet 14 feet deep at the  
 Southerly End of the Cut. The Center of  
 which bears from the West End  
 Center of the Claim South 58° 50' East  
 80 feet distant. Value \$ 100.00

No 4 A Shaft 8x6 feet, 16 feet deep -  
 which bears from the West End  
 Center of the Claim, S. 62° 15' East  
 560 feet dist: Value \$ 125.00

Total Value \$ 575.00

# Denver No. 1 Lode

No 1 Discovery Tunnel 4x6 feet 30 feet long all in rock  
 The mouth of which bears from the West End Center  
 of the Claim, S. 71° 15' East - 295<sup>ft</sup> dist:  
 Course of Tunnel S. 6° 30' W. Value \$ 500.00

No 2 A Shaft 5x6 feet 11 feet deep all in  
 rock which bears from West End Center  
 of the Claim South 85° 30' East. 125 feet dist. Value \$ 100.00 -  
Total Value \$ 600.00

Plover No. 2. Lode

No 1. Discovery Tunnel 4 x 6 feet 35 feet long, all in Rock, The mouth of which bears from the West End Center of the Claim S 64° 18 East 53 feet dist: Course of Tunnel S 4° 40 East

Value \$ 350.00

No 2. An open cut 6 x 6 feet with extending Tunnel 5 x 6 feet the cut 10 feet and the Tunnel 12 feet long all in Rock, course of cut and Tunnel South 6° 15' West The Mouth of the Tunnel bears from West End Center S 64° 18 E. 213 feet dist:

Value \$ 200.00  
Total Value 550.00

With the exception of the Copper Hill Lode for No. 1547, which is the <sup>entirely</sup> ~~partly~~ extension of the Pittsburgh Mining Claim there are no other claims adjoining the Lodes of this Property

The courses and the lengths of the ledges of the different lodes between the West and East End Centers are as follows

Pittsburgh Lode

South 43° 53 East 150 feet.

Copper Cliff Lode.

South  $67^{\circ} 51'$  East 1500 feet

Denver No. 1. Lode.

South  $67^{\circ} 51'$  East 1500 feet

Denver No. 2. Lode

South  $64^{\circ} 18'$  East 1500 feet

Instrument.

This Survey was made with a Gurley Engineer Transit with Saegemuller's Patent Solar Attachment.

The courses were deflected from the true Meridian as determined by the survey of Township 10 South 14 East compared with Polar and Solar observations.

The distances were measured with 100 feet steel Tapes.

Tueson A. S. April 15<sup>th</sup> 1901

Charles W. Walker

U. S. Deputy Mineral Surveyor.

# FINAL OATHS FOR SURVEYS.

## LIST OF NAMES.

A list of the names of the individuals employed by Charles von Meleben  
 United States Deputy Mineral Surveyor, to assist in running, measuring, and marking the lines  
 corners and boundaries described in the foregoing field notes of the survey of the mining claims  
 of Edwin Scott per J. D. Copley Agent  
 known as the Pittsburgh, Copper Cliff, Lumber No 1 and Lumber No 2  
 and showing the respective capacities in which they acted:

- Jacob Schreck, Chairman.
- Geo. McWilliams, Chairman.
- John G. Hall, Axman.
- Thomas McTinney, Flagman.

## FINAL OATHS OF ASSISTANTS.

We Jacob Schreck, Geo. McWilliams, John G. Hall  
 and Thomas McTinney, do solemnly swear that we assisted Charles von  
Meleben, United States Deputy Mineral Surveyor, in marking the corners and  
 surveying the boundaries of the mining claims of Edwin Scott per  
J. D. Copley, Agent  
 known as the Pittsburgh,  
Copper Cliff, Lumber No 1 and Lumber No 2, represented  
 in the foregoing field notes as having been surveyed by said deputy mineral surveyor and under  
 his direction; and that said survey has been in all respects, to the best of our knowledge and  
 belief, faithfully and correctly executed, and the corner and boundary monuments established  
 according to law and the instructions furnished by the United States Surveyor-General for  
Arizona.

- Jacob Schreck, Chairman.
- Geo. McWilliams, Chairman.
- John G. Hall, Axman.
- Thomas McTinney, Flagman.

Subscribed and sworn to by the above-named persons before me  
 this 25<sup>th</sup> day of March, 1905.

Charles von Meleben  
 Notary Public.

My commission expires  
 January 10<sup>th</sup> 1905.

(4-686.)

FINAL OATH OF U. S. DEPUTY MINERAL SURVEYOR

I, Charles von Döhlen, U. S. Deputy Mineral Surveyor, do solemnly swear that, in pursuance of instructions received from the United States Surveyor General for Arizona, dated March 15<sup>th</sup> 1901, I have, in strict conformity to the laws of the United States, the official regulations and instructions thereunder, and the instructions of said Surveyor General, faithfully and correctly executed the survey of the Mining Claims of Edwin Scott per J. J. Caplan Agent, known as the Pittsburgh Copper Cliff Lumber No 1 and Lumber No 2, situate in Canon del Oro Mining District, Sinal County, Arizona, in Section 5, 6, 7 & 8, Township No. 10 South, Range No. 15 East E. to S. R. Meridian, and designated as Survey No. 1540, as represented in the foregoing field notes, which accurately show the boundaries of said mining claim as distinctly marked by monuments on the ground, and described in the attached copy of the location certificate, which was received by me from the Surveyor General with said instructions, and that all the corners of said survey have been established and perpetuated in strict accordance with the law, official regulations and instructions thereunder; and I do further solemnly swear that the foregoing are the true and original field notes of said survey and my report therein, and that the labor expended and improvements made upon said mining claims by claimant or his grantors are as therein fully stated, and that the character, extent, location and itemized value thereof are specified therein with particularity and full detail, and that no portion of said labor or improvements so credited to this claim has been included in the estimate of expenditures upon any other claim.

Charles von Döhlen  
U. S. Deputy Mineral Surveyor.

Subscribed and sworn to by the said Charles von Döhlen  
U. S. Deputy Mineral Surveyor, before me F. K. Miller  
Notary Public this 15<sup>th</sup>  
day of April 1901

My Commission Expires  
April 19<sup>th</sup> 1902.

F. K. Miller, Notary Public  
Pima County, Arizona

Affidavit of Five Hundred Dollars Improvements.

We, Jacob Schreck, and Geo. M<sup>r</sup> Williams

of lawful age, being first duly sworn according to law, depose and say: That we are acquainted with the Pittsburgh, Copper Cliff, Denver No. 1 & Denver No. 2 mining claims, situate in Cañon del Oro Mining District, Pinal County, Arizona Territory, for which Edwin Scott per S. D. Coyle Agent

has made application for survey prior to application for patent under the provisions of the Act of Congress, approved May 10, 1872; and that the labor done and improvements made thereon by the applicant and his grantor exceed Five Hundred each claim Dollars in value, and further, that we are not personally interested in said mines.

Jacob Schreck  
Geo M<sup>r</sup> Williams

TERRITORY OF ARIZONA,  
County of Pima } ss:

Sworn to and subscribed before me, this 29<sup>th</sup> day of March, 1901.

Charles von Doleben  
Notary Public.

15967b200-10-1900

My commission expires  
January 10<sup>th</sup> 1905.



Notice is hereby given that we the undersigned have located and claim 1500 feet linear and along the course of this lead lode vein or deposit of mineral bearing quartz in place together with 300 feet on each side of the middle of vein and claim

Commencing at this monument of stones erected at the west end of claim upon which this notice is posted thence running 300 feet south to south west corner monument thence running 1500 feet east to south east corner monument thence running North 300 feet to East end center thence running North 300 feet to North east corner monument thence running west 1500 feet to north west corner monument thence running South 300 feet to west end center or place of beginning. This claim is situated in Catalena mts in North west Part of same is about 1 mile North of Canada Del Oro is the East extension of Quail mine is about 1600 feet East of Bachman west to west end of claim is in Canada Del Oro mining District county of Pinal Territory of Arizona and shall be known as the Pittsburgh mine Located this 15th day July 1895

Locators. J. Floran  
E. Baird

Territory of Arizona, } ss. 24  
County of Pinal.

I, F. A. Chamberlain, Recorder,  
in and for the County of Pinal, Territory  
above said, do hereby certify that the  
aforesaid instrument was filed and  
recorded at request of Frank

Joran

on the 27<sup>th</sup> day of August

A. D., 1897, at — minutes past

4 o'clock, P. M. in book No. 15

of Meers Page 60

WITNESS my hand and official

Seal, this 27<sup>th</sup> day of Aug 1897

F. A. Chamberlain  
Recorder

J. A. Joran

an unrecorded

# Notice of Mining Location.

## LODE CLAIM.

To All Whom It May Concern:

This Mining claim, the name of which is the Pittsburgh Mining Claim, situate on lands belonging to the United States of America, and in which there are valuable mineral deposits, was entered upon and located for the purpose of exploration and purchase by D. Joran

the undersigned, on the 24<sup>th</sup> day of February 1900. <sup>Original July 15<sup>th</sup> 1897</sup>

The length of this claim is Fifteen Hundred (1500) feet, and 3 claim Three Hundred and fifty (350) feet in a Westerly direction, and Eleven hundred and fifty (1150) feet in a Easterly direction from the center of the discovery shaft, at which this notice is posted, lengthwise of the claim, together with Three Hundred (300) feet in width of the surface grounds, on each side of the center of said claim. The general course of the lode deposit and premises is from the East to the West

The claim is situated and located in the Coumad del Oro Mining District, in Pinal County, in the Territory of Arizona, about 2 1/4 miles in a N. Easterly direction from Samanyagoes Ranch used on the East side of main road leading from Tucson to Oracle about 2 miles from Road. The surface boundaries of the claim are marked upon the ground as follows: Beginning at a stake

at a point in a Westerly direction Three hundred and fifty feet from the discovery shaft (at which this notice is posted), being in the center of the West end line of said claim; thence Southerly 300 feet to a Monument of Stone, being the S. West corner of said claim; thence Easterly 750 feet to a Monument of Stone at the center of the South side line of said claim; thence Easterly 750 feet to a Monument of Stone, being at the S. East corner of said claim; thence Northerly 300 feet to a Monument of Stone at the center of the East end of said claim; thence Northerly 300 feet to a Monument of Stone, being at the N. East corner of said claim; thence Westerly 750 feet to a Monument of Stone being at the center of the North side line of said claim; thence Westerly 750 feet to a Monument of Stone at the N. West corner of said claim; thence Southerly 300 feet to the place of beginning.

All done under the provisions of Chapter Six, or Title XXXII, of the Revised Statutes of the United States, and of an Act of the General Assembly of Arizona, entitled "An Act Concerning Mines," approved March 20th, 1895, and amended March 2d, 1899.

Dated and posted on the ground this 24<sup>th</sup> day of February 1900.

Frank Joran

Frank Swan  
Crack  
Arizona  
Vol. 156

TERRITORY OF ARIZONA }  
County of Pinal } ss.

I, J. A. Chamberlin County Recorder in and for the County and

Territory aforesaid, do hereby certify that the within instrument was filed for record at.....1.....o'clock, P.....M.,

on this 27 day of February 1900, and duly recorded in Book No. 17

of Minus Records of Pinal County, Arizona, at pages 174

WITNESS my hand and official seal the day and year first above written.

J. A. Chamberlin  
County Recorder  
By Thos. G. Peyton Deputy

*amended*  
**Notice of Location.**  
LODE CLAIM.  
Pittsburgh

Dated ..... 1900.

Filed and recorded at request of

..... A. D. 1900,

at ..... M.

Book .....

Pages .....

County Recorder.

By ..... Deputy Recorder.

THE H. H. MC NEIL CO., PRINTERS, PHOENIX, ARIZONA.

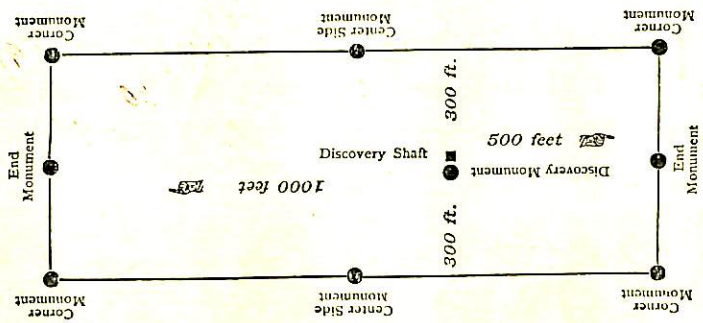

This diagram is to give locator a general idea of plan of location under the new law. The Discovery Shaft can be in the center of claim or any distance from either end desired. In the diagram it is placed 500 feet from one end and 1000 feet from the other. Commence description of claim at a center end monument, giving its distance and direction from center of Discovery Shaft; thence bound the claim in either direction. In description be careful to state locality of claim with reference to some natural object, or permanent monument, as will identify the claim.

# Additional and Amended Location Certificate.

Law of 1895.

TERRITORY OF ARIZONA,

County of Sinal. - } ss.

Know all Men by these Presents, That

I, Edwin Scott

the undersigned, have this 1 day of February 1901, amended, located and claimed and by these presents do amend, locate and claim by right of the original discovery and this additional and amended location certificate in compliance with the Mining Acts of Congress, approved May 10th, 1872, and all subsequent acts and with an act concerning mines, enacted by the Legislative Assembly of the Territory of Arizona, approved March 5th, 1895, amended March 2nd, 1899, and with local customs, laws and regulations, 1500 linear feet and horizontal measurement on the "Pittsburgh" Lode, vein, ledge, or deposit, along the vein thereof, with all its dips, angles and variations as allowed by law, together with 300 feet on each side of the middle of said vein at the surface so far as can be determined from present developments, and all veins, lodes, ledges or deposits and surface ground within the lines of said claim 65 feet running N. 73° 53' W from center of discovery Shaft and 1435 feet, running S. 73° 53' E from center of discovery point said discovery point being situate upon said lode, vein, ledge or deposit, and within the lines of said claim, in Cañon del Oro Mining District, County of Sinal, Territory of Arizona, described by metes and bounds as follows, to-wit:

Beginning at corner No. 1, whence Corner of Sections 1, 6, 7 and 12 of Township 10 South, Range 14 and 15 East bears:  
South 73° 53' East 3303.5 feet  
 thence N. 21° 15' E. 300 feet to the West end center, thence N. 21° 15' E. 300 feet to corner No. 2, thence S. 73° 53' E. 750 feet to North side line center, thence S. 73° 53' E. 750 feet to corner No. 3, thence N. 21° 15' W 300 feet to East end center, thence N. 21° 15' W 300 feet to corner No. 4, thence N. 73° 53' W. 750 feet to South side line center, thence N. 73° 53' W. 750 feet to the place of beginning.

This being the same lode originally located on the 15<sup>th</sup> day of July 1897, and recorded on the 27<sup>th</sup> day of August 1897, in Book 15 of Mines, page 60, and amended on the 24<sup>th</sup> day of February 1900 and recorded on the 27 day of February 1900 in Book 17 of Mines, page 174 in the office of the Recorder of Sinal County.

This further additional and amended certificate of location is made without waiver of any previously acquired rights, but for the purpose of correcting any errors in the original and amended location, description or record, and of taking in and acquiring all forfeited or abandoned overlapping ground and of taking in any part of any overlapping claim, which has been abandoned and of receiving all the benefits of said act concerning mines of the Legislative Assembly of the Territory of Arizona.

The "Pittsburgh" is adjoined in the East by the "Copper Cliff" and in the West by the "Copper Hill" Mining Claim. -

Edwin Scott

by J. D. Copple  
 Agent

E. A. Smith  
Successor

Bar 88

28



Territory of Arizona, } ss.

County of Pinal

I, Thos. Peyton Recorder,  
in and for the County of Pinal, Territory  
aforesaid, do hereby certify that the  
annexed instrument was filed and  
recorded at request of E. A.

Smith

on the 7<sup>th</sup> day of Mar

A. D., 1901 at — minutes past

1 o'clock, P M., in book No. 18

of Mines Page 274

WITNESS my hand and official

Seal, this 7<sup>th</sup> day of March 1901

Thos. Peyton  
Recorder.

by T. H. Longgan  
Deputy.

Notice is hereby given that we the undersigned have hereby located and claim 1500 feet linear on and along the course of this lead lode vein or deposit of minerals bearing quartz in place with 300 feet on each side of the middle of vein or claim

Commencing at this the Discovery shaft erected at center of claim and running 750 feet west to west end center stake thence running south 300 feet to south west corner stake thence running east 1800 feet to south east corner stake thence running North 300 feet to East end center <sup>stake</sup> thence running North 300 feet to North east corner thence running west 1500 feet to North west corner <sup>stake</sup> thence running South 300 feet to west end center stake

This claim is situated about 3 miles in North East direction from Sanenagers Ranch in Canada Del Oro is about 1 mile north of Canon is about 3000 feet east of Boushman wash in Canada Del Oro Mining Dist Pinal Co Arizona Territory and shall be known as the Copper Cliff mine located this 10<sup>th</sup> of June 1892

## Locators

Frank Floran  $\frac{1}{2}$

D. Baird  $\frac{1}{4}$

E. Baird  $\frac{1}{4}$

an amended

# Notice of Mining Location.

LODE CLAIM.

To All Whom It May Concern:

This Mining claim, the name of which is the Copper Cluff Mining Claim, situate on lands belonging to the United States of America, and in which there are valuable mineral deposits, was entered upon and located for the purpose of exploration and purchase by Frank Moran

the undersigned, on the 24<sup>th</sup> day of February 1900. <sup>Original from 10<sup>th</sup> 1897</sup>

The length of this claim is Fifteen Hundred (1500) feet, and 750 claim Seven Hundred and fifty (750) feet in a Westerly direction, and Seven Hundred and fifty (750) feet in a Easterly direction from the center of the discovery shaft, at which this notice is posted, lengthwise of the claim, together with Three Hundred (300) feet in width of the surface grounds, on each side of the center of said claim. The general course of the lode deposit and premises is from the East to the West

The claim is situated and located in the Canada del Oro Mining District, in Pinal County, in the Territory of Arizona, about 2 1/4 miles in a N. Easterly direction from Sansbury's Ranch and about 2 miles in a Easterly direction from the main road leading from Tucson to Oracle. The surface boundaries of the claim are marked upon the ground as follows: Beginning at a Monument of Stone

at a point in a Westerly direction 750 feet from the discovery shaft (at which this notice is posted), being in the center of the West end line of said claim; thence Southerly 300 feet to a Monument of Stone, being the S West corner of said claim; thence Easterly 750 feet to a Monument of Stone at the center of the South side line of said claim; thence Easterly 750 feet to a Monument of Stone, being at the S East corner of said claim; thence Northerly 300 feet to a Monument of Stone at the center of the East end of said claim; thence Northerly 300 feet to a Monument of Stone, being at the N East corner of said claim; thence Westerly 750 feet to a Monument of Stone being at the center of the North side line of said claim; thence Westerly 750 feet to a Monument of Stone at the N West corner of said claim; thence Southerly 300 feet to the place of beginning.

All done under the provisions of Chapter Six, of Title XXXII, of the Revised Statutes of the United States, and of an Act of the General Assembly of Arizona, entitled "An Act Concerning Mines," approved March 20th, 1895, and amended March 2d, 1899.

Dated and posted on the ground this 24<sup>th</sup> day of February 1900.

Frank Moran



Trans. from  
Crack  
Anybar

TERRITORY OF ARIZONA

County of Pinal ss.

I, J. A. Chamberlain County Recorder in and for the County and

Territory aforesaid, do hereby certify that the within instrument was filed for record at 1 o'clock, P M.,

on this 27 day of February 1900 and duly recorded in Book No. 17

of Miner Records of Pinal County, Arizona, at pages 170

WITNESS my hand and official seal the day and year first above written.

J. A. Chamberlain  
County Recorder  
By Thos. G. Teylan Deputy

*amended*  
**Notice of Location.**

LODE CLAIM.  
Copper Cliff

Dated 1900.

Filed and recorded at request of

A. D. 1900,

at M.

Book

Pages

County Recorder.

Deputy Recorder.

THE H. H. MC NEIL CO., PRINTERS, PHOENIX, ARIZONA.

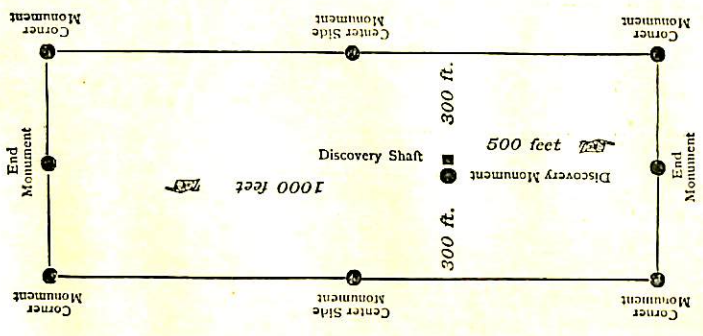

This diagram is to give locator a general idea of plan of location under the new law. The Discovery Shaft can be in the center of claim or any distance from either end desired. In the diagram it is placed 500 feet from one end and 1000 feet from the other. Commence description of claim at a center end monument, giving its distance and direction from center of Discovery Shaft; thence bound the claim in either direction. In description be careful to state locality of claim with reference to some natural object, or permanent monument, as will identify the claim.

# Additional and Amended Location Certificate.

Law of 1895.

TERRITORY OF ARIZONA,  
County of Sinal. - } ss.

Know all Men by these Presents, That J. - Edwin Scott -  
the undersigned, have this 1 day of February 1901, amended, located and  
claimed and by these presents do amend, locate and claim by right of the original discovery  
and this additional and amended location certificate in compliance with the Mining Acts of  
Congress, approved May 10th, 1872, and all subsequent acts and with an act concerning mines, enacted by  
the Legislative Assembly of the Territory of Arizona, approved March 5th, 1895, amended March 2nd,  
1899, and with local customs, laws and regulations, 1500 linear feet and horizontal measurement on the  
"Copper Cliff" Lode, vein, ledge, or deposit, along the vein thereof, with  
all its dips, angles and variations as allowed by law, together with 300 feet on each side of the middle of  
said vein at the surface so far as can be determined from present developments, and all veins, lodes, ledges  
or deposits and surface ground within the lines of said claim 80 feet running N. 67° 51' W from center of  
discovery Cut and 1420 feet, running S. 67° 51' E. - from center of discovery point  
said discovery point being situate upon said lode, vein, ledge or deposit, and within the lines of said claim,  
in Cañon del Oro Mining District, County of - Sinal -, Territory of Arizona, de-  
scribed by metes and bounds as follows, to-wit:

Beginning at corner No. 1, whence Corner of Sections 1, 6, 7, and 12  
of Township 10 South Range 14 and 15 East bears  
South 73° 53' East 4863.5 feet  
thence N. 21° 15' E. 300 feet to the West end center, thence N. 21° 15' E. 300 feet to corner No.  
2, thence S. 67° 51' E. - 750 feet to North side line center, thence S. 67° 51' E. 750 feet to cor-  
ner No. 3, thence S. 21° 15' W 300 feet to East end center, thence S. 21° 15' W 300 feet to corner No. 4,  
thence N. 67° 51' W. 750 feet to South side line center, thence N. 67° 51' W 750 feet to  
the place of beginning.

This being the same lode originally located on the 10<sup>th</sup> day of June 1897, and  
recorded on the 27<sup>th</sup> day of August 1897, in Book 15 of Mines, page 58, and amended  
on the 24<sup>th</sup> day of February 1900 and recorded on the 27<sup>th</sup> day of February 1900 in Book 17 of Mines,  
page 170 in the office of the Recorder of - Sinal - County.

This further additional and amended certificate of location is made without waiver of any previously  
acquired rights, but for the purpose of correcting any errors in the original and amended location, descrip-  
tion or record, and of taking in and acquiring all forfeited or abandoned overlapping ground and of taking  
in any part of any overlapping claim, which has been abandoned and of receiving all the benefits of said  
act concerning mines of the Legislative Assembly of the Territory of Arizona.

The Copper Cliff is adjoined in the East by the Denver No 1  
and in the West by the Pittsburgh Mining Claim. -

Edwin Scott  
by J. D. Coplin  
Agent

E. A. Smith  
Successor  
Ariz.

Box 68

Territory of Arizona, } ss.  
County of Pinal  
I, Thos. Peyton Recorder,  
in and for the County of Pinal, Territory  
aforesaid, do hereby certify that the  
annexed instrument was filed and  
recorded at request of EAS

Smith  
on the 7<sup>th</sup> day of Mar

A. D., 1901, at — minutes past  
1 o'clock, P M, in book No. 18  
of Minutes Page 222

WITNESS my hand and official  
Seal, this 7<sup>th</sup> day of March 1901  
Thos. Peyton Recorder

by T. A. Linsagan Deputy

34



*[Faint, mostly illegible handwritten text and bleed-through from the reverse side of the page.]*

# Notice of Mining Location.

QUARTZ CLAIM.

To All Whom It May Concern:

This mining claim, the name of which is the Denver No 1 Mining Claim, situate on lands belonging to the United States of America, and in which there are valuable mineral deposits, was entered upon and located for the purpose of exploration and purchase by me Edwin Scott

the undersigned, on the 24<sup>th</sup> day of April 1899

The length of this claim is 1500 feet, and 1 claim 500 feet in a westerly direction and 1000 feet in an easterly direction from the center of the discovery shaft, at which this notice is posted, lengthwise of the claim, together with 300 feet in width of the surface grounds, on each side of the center of said claim. The general course of the lode deposit and premises is from the East to the West

The claim is situated and located in the Canada del Oro Mining District, in Pinal County, in the Territory of Arizona, about 2 1/2 miles in a westerly direction from Samanago's Ranch

and is the immediate easterly extension of the Copper Cliff Mining Claim  
The surface boundaries of the claim are marked upon the ground as follows: Beginning at A monument

at a point in a westerly direction 500 feet from the discovery shaft (at which this notice is posted), being in the center of the west end line of said claim; thence 300 feet to a monument, being the N.W. corner of said claim; thence Easterly 750 feet to a monument at the center of the North side line of said claim; thence Easterly 750 feet to a monument being at the N.E. corner of said claim; thence Southerly 300 feet to a monument at the center of the East end of said claim; thence Southerly 300 feet to a monument, being at the S.E. corner of said claim; thence westerly 750 feet to a monument being at the center of the South side line of said claim; thence westerly 750 feet to a monument at the S.W. corner of said claim; thence Northerly 300 feet to the place of beginning.

All done under the provisions of Chapter Six, of Title XXXII, of the Revised Statutes of the United States, and of an Act of the General Assembly of Arizona, entitled "An Act Concerning Mines," approved March 20th, 1895.

Dated and posted on the ground this 24<sup>th</sup> day of April 1899

Edwin Scott





# Amended Location Certificate.

Law of 1895.

TERRITORY OF ARIZONA,  
County of Pinal - } ss.

Know all Men by these Presents, That I, - Edwin Scott -  
the undersigned, have this 1 day of February 1901, amended, located and claimed and by  
these presents do amend, locate and claim by right of discovery and amended location in compliance with  
the Mining Acts of Congress, approved May 10th, 1872, and all subsequent acts and with an act concern-  
ing mines, enacted by the Legislative Assembly of the Territory of Arizona, approved March 5th, 1895,  
amended March 2nd, 1899, and with local customs, laws and regulations, 1500 linear feet and horizontal  
measurement on the Denver No 1 Lode, vein, ledge, or deposit, along the vein thereof, with  
all its dips, angles and variations as allowed by law, together with 300 feet on each side of the middle of  
said vein at the surface so far as can be determined from present developments, and all veins, lodes, ledges  
or deposits and surface ground within the lines of said claim 1205 feet running S. 67° 51' E from center of  
discovery - Tunnel - and 295 feet, running N. 67° 51' W from center of discovery point  
said discovery point being situate upon said lode, vein, ledge or deposit, and within the lines of said claim,  
in Cañon del Oro Mining District, County of - Pinal - , Territory of Arizona, de-  
scribed by metes and bounds as follows, to-wit:

Beginning at corner No. 1, whence Corner of Sections 1, 6, 7 & 12 of  
Township 10 South - Range 14 and 15 East bear:  
South 72° 27' East 635.7 feet  
thence N. 21° 15' E. 300 feet to the West end center, thence N. 21° 15' E. 300 feet to corner No.  
2, thence S. 67° 51' E. 750 feet to North side line center, thence S. 67° 51' E. 750 feet to cor-  
ner No. 3, thence N. 21° 15' W. 300 feet to East end center, thence N. 21° 15' W. 300 feet to corner No. 4,  
thence N. 67° 51' W. 750 feet to South side line center, thence N. 67° 51' W. 750 feet to  
the place of beginning.

This being the same lode originally located on the 24<sup>th</sup> day of April - 1899, and  
recorded on the 28<sup>th</sup> day of July 1899, in Book 16 of Mines, page 261, in the office  
of the Recorder of Pinal County.

This further and amended certificate of location is made without waiver of any previously acquired  
rights, but for the purpose of correcting any errors in the original location, description or record.

The "Denver No 1" is adjoined in the East by the Denver  
No 2 and in the West by the "Copper Cliff" Mining  
Claim.

Edwin Scott  
by J. D. Cooper  
Agent

E. A. Smith  
Tucson  
Ariz.  
Dec 68.



Territory of Arizona, } ss.  
County of Pinal

I, Thos J. Peyton Recorder,  
in and for the County of Pinal, Territory  
aforesaid, do hereby certify that the  
annexed instrument was filed and  
recorded at request of ES

Smith  
on the 7<sup>th</sup> day of Mar

A. D., 1901 at — minutes past  
1 o'clock, P M, in book No. 18  
of Miner Page 226

WITNESS my hand and official  
Seal, this 7<sup>th</sup> day of March 1901.  
Thos J. Peyton  
Recorder.

by T. H. Longgan  
Deputy.

# Notice of Mining Location.

QUARTZ CLAIM.

To All Whom It May Concern:

This mining claim, the name of which is the Denver No 2 Mining Claim, situate on lands belonging to the United States of America, and in which there are valuable mineral deposits, was entered upon and located for the purpose of exploration and purchase by Me Edwin Scott

the undersigned, on the 24<sup>th</sup> day of April 1899

The length of this claim is 1500 feet, and 5 claim 200 feet in a westerly direction and 1300 feet in a easterly direction from the center of the discovery shaft, at which this notice is posted, lengthwise of the claim, together with 300 feet in width of the surface grounds, on each side of the center of said claim. The general course of the lode deposit and premises is from the East to the West

The claim is situated and located in the Canada Del Oro Mining District, in Pinal County, in the Territory of Arizona, about 2 1/2 miles in an Easterly direction from Sauvages Ranch

and is the immediate extension of the Denver No 1 mining claim

The surface boundaries of the claim are marked upon the ground as follows: Beginning at a monument

at a point in a westerly direction 200 feet from the discovery shaft (at which this notice is posted), being in the center of the west end line of said claim; thence 300 feet to a monument, being the n.w. corner of said claim; thence Easterly 750 feet to a monument at the center of the north side line of said claim; thence Easterly 750 feet to a monument being at the n.e. corner of said claim; thence Southerly 300 feet to a monument at the center of the East end of said claim; thence Southerly 300 feet to a monument, being at the s.e. corner of said claim; thence westerly 750 feet to a monument being at the center of the South side line of said claim; thence westerly 750 feet to a monument at the S.W. corner of said claim; thence Westerly 300 feet to the place of beginning.

All done under the provisions of Chapter Six, of Title XXXII, of the Revised Statutes of the United States, and of an Act of the General Assembly of Arizona, entitled "An Act Concerning Mines," approved March 20th, 1895.

Dated and posted on the ground this 24<sup>th</sup> day of April 1899

Edwin Scott





# An Act Concerning Mines.

*Be it Enacted by the Legislative Assembly of the Territory of Arizona:*

SECTION 1. Every notice of location of a mining claim shall contain: First, the name of the claim located; second, the name of the locator; third, the date of location; fourth, the number of feet in length of said claim and the number of feet claimed on each side of the center of the discovery shaft, lengthwise of the claim; fifth, the general course of the lode deposit of premises located; sixth, the locality of the claim with reference to some natural object, or permanent monument, as will identify the claim.

SEC. 2. All mining locations hereafter located, the certificate of location of which shall not contain: First, the name of the lode, or premises; second, the name of the locator, or locators; third, the date of location; fourth, the number of feet in length of said claim and the number of feet claimed on each side of the center of the discovery shaft, lengthwise of the claim; fifth, the general course of the lode, or premises, as near as may be; sixth, the locality of the claim with reference to some natural object, or permanent monument, as will identify the claim, shall be void.

SEC. 3. Before filing such location certificate with the County Recorder of the proper County, the discoverer shall locate his claim by: First, sinking a discovery shaft upon the premises so claimed, to a depth of at least ten feet from the lowest part of the rim of such shaft at the surface, and deeper if necessary, until there is shown by such work a lode deposit of mineral in place; second, by posting at the point of discovery, on the surface, a plain sign or notice substantially conforming to the location certificate; third, by marking such claim or premises on the ground, so that its boundaries can be readily traced.

Such surface boundaries shall be marked by **EIGHT** substantial **POSTS**, projecting at least **THREE FEET ABOVE THE SURFACE OF THE GROUND**, or by substantial **STONE MONUMENTS**, at least **THREE FEET HIGH**, to-wit: One at each corner of said claim, and one at the center of each end and side line thereof.

SEC. 4. Any open-cut, cross-cut, adit or tunnel which shall be made as above provided for, as a part of the location of a mining claim, and which shall be equal in amount of work to a shaft ten feet deep and four feet wide by six feet long, and which shall cut a lode or mineral in place at the depth of ten feet from the surface, shall be equivalent, as a discovery work, to a shaft sunk from the surface.

SEC. 5. The discoverer shall have ninety days from the date of discovering the lode and the posting of the notice thereon, to perform said discovery work thereon.

SEC. 6. If at any time the locator of any mining claim heretofore or hereafter located, or his assigns, shall learn that his original certificate was defective, or that the requirements of the law had not been complied with before filing, or shall be desirous of changing his surface boundaries, or of taking in any additional ground which is subject to location, or in case the original certificate was made prior to the passage of this law, and he shall be desirous of securing the benefits of this Act, such locator, or his assigns, may file an amended certificate of location subject to the provisions of this Act, regarding the making of new locations.

SEC. 7. The amount of assessment, or representation, work or improvements to be done or made during each year, after the completion of the location as heretofore provided, and the time for doing the same, shall be as provided by the laws of the United States.

SEC. 8. Within three months after the expiration of the period of time fixed for the performance of annual labor or the making of improvements upon any mining claim or premises, the person on whose behalf such work or improvement was made, or some person for him, knowing the facts, may make and record in the office of the County Recorder of the county wherein such claim is situate an affidavit in substance as follows:

TERRITORY OF ARIZONA, }  
County, } ss.

..... being duly sworn deposes and says, that he is a citizen of the United States, and more than 21 years of age, and resides at....., in..... County, Arizona Territory, and is personally acquainted with the mining claim and premises located and known as..... mining claim or lode, situate in..... Mining District, County of..... Arizona Territory, the notice of location of which premises is recorded in the office of the County Recorder of said county, in Book..... of Records of Mines, at page.....; that between the..... day of..... A. D. 189....., and the..... day of..... A. D. 189....., at least..... dollars worth of work and improvements were done and performed upon said premises or lode, not including the location work of said claim. Such work and improvements were made by and at the expense of..... owners of said premises for the purpose of complying with the law of the United States pertaining to assessment, or annual work, and (here name the miners or men who worked upon the claim in doing the work) were the men employed by said owner and who labored upon said premises, and who did said work and improvements, and said work so done upon said premises is described as follows, to-wit: (Here describe the work done.)

Subscribed and sworn to before me..... this..... day of..... 189.....

[SEAL]

SEC. 10. Such affidavit when so recorded shall be *prima facie* evidence of the performance of such labor or the making of such improvements, and said original affidavit after it has been recorded, or a certified copy of record of same, shall be received as evidence accordingly by all the Courts of this Territory.

SEC. 11. The relocation of forfeited or abandoned lode claims shall only be made by sinking a new discovery shaft and fixing new boundaries in the same manner and to same extent as is required in making a new location; or the relocator may sink the original discovery shaft ten feet deeper than it was at date of commencement of such relocation, and shall erect new or make the old monuments the same as originally required. In either case a new location monument shall be erected, and the location certificate shall state if the whole or any part of the new location is located as abandoned property.

SEC. 12. This Act shall take effect and be in force from and after July 1st, 1895.  
SEC. 13. All Acts and parts of Acts in conflict with this Act are hereby repealed.

This diagram is to give locator a general idea of plan of location under the new law. The Discovery Shaft can be in the center of claim or any distance from either end and side. In the diagram it is placed 500 feet from one end and 1000 feet from the other. Commence description of claim at a center end monument, giving its distance and direction from center of Discovery Shaft; thence bound the claim in either direction. In description be careful to state locality of claim with reference to some natural object, or permanent monument, as will identify the claim.

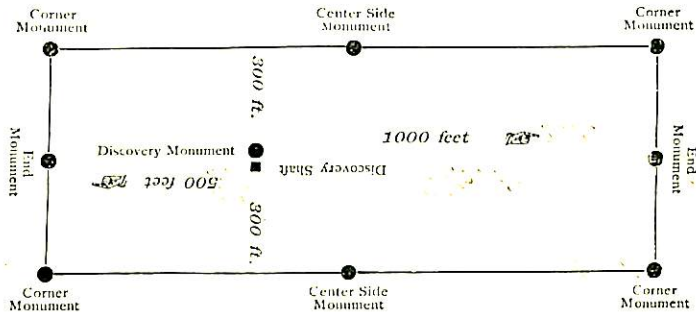

## Notice of Location.

QUARTZ CLAIM.

Denver Co 2

Dated..... 189.....

Filed and recorded at request of

July 28 A. D. 1899

at 1 P. M.

Book 16 of Mines

Pages 262.

County Recorder.

Deputy Recorder.

WITNESS my hand and official seal the day and year first above written.

J. A. Chamberlain  
 County Recorder in and for the County and  
 Territory aforesaid, do hereby certify that the within instrument was filed for record at..... o'clock,..... M.,  
 on this..... day of..... 189....., and duly recorded in Book No. 16  
 of..... County, Arizona, at pages.....  
J. A. Chamberlain  
 County Recorder

Denver Co 2  
 1899  
 Quartz Claim

# Amended Location Certificate.

41

Law of 1895.

TERRITORY OF ARIZONA,

County of - Sinal. -

ss.

Know all Men by these Presents, That

I, Edwin Scott

the undersigned, have this 1 day of February 1901, amended, located and claimed and by these presents do amend, locate and claim by right of discovery and amended location in compliance with the Mining Acts of Congress, approved May 10th, 1872, and all subsequent acts and with an act concerning mines, enacted by the Legislative Assembly of the Territory of Arizona, approved March 5th, 1895, amended March 2nd, 1899, and with local customs, laws and regulations, 1500 linear feet and horizontal measurement on the Denver No 2 Lode, vein, ledge, or deposit, along the vein thereof, with all its dips, angles and variations as allowed by law, together with 300 feet on each side of the middle of said vein at the surface so far as can be determined from present developments, and all veins, lodes, ledges or deposits and surface ground within the lines of said claim 50 feet running N. 64° 18' W from center of discovery Tunnel and 1447 feet, running N. 64° 18' E. - from center of discovery point said discovery point being situate upon said lode, vein, ledge or deposit, and within the lines of said claim, in Cañon del Oro Mining District, County of Sinal, Territory of Arizona, described by metes and bounds as follows, to-wit:

Beginning at corner No. 1, whence Corner of Sections 1, 6, 7 and 12 of Township 10 South, Range 14 and 15 East bears:  
South 71° 34' East 7853 feet  
thence N. 21° 15' E. 300 feet to the West end center, thence N. 21° 15' E. - 300 feet to corner No. 2, thence S. 64° 18' E. - 750 feet to North side line center, thence S. 64° 18' E. 750 feet to corner No. 3, thence S. 21° 15' W 300 feet to East end center, thence S. 21° 15' W 300 feet to corner No. 4, thence N. 64° 18' W 750 feet to South side line center, thence N. 64° 18' W 750 feet to the place of beginning.

This being the same lode originally located on the 24<sup>th</sup> day of April 1899, and recorded on the 28<sup>th</sup> day of July 1899, in Book 16 of Mines, page 262, in the office of the Recorder of Sinal County.

This further and amended certificate of location is made without waiver of any previously acquired rights, but for the purpose of correcting any errors in the original location, description or record.

The Denver No 2 is the Eastern Extension of the Denver No 1 Mining Claim.

Edwin Scott  
By J. D. Copley  
Agent

E. N. Smith  
Successor  
Book 68. Ariz.

Territory of Arizona, } ss.  
County of Pinal }

I, Thos J Peyton Recorder,  
in and for the County of Pinal, Territory  
aforesaid, do hereby certify that the  
annexed instrument was filed and  
recorded at request of E N

Smith  
on the 7<sup>th</sup> day of Mar

A. D., 1901 at - minutes past  
1 o'clock, P M. in book No. 18  
of Mones Page 227

WITNESS my hand and official

Seal, this 7<sup>th</sup> day of March 1901  
Thos J Peyton  
Recorder.

by T H Lanyon  
Deputy.



(4-687.)

# Surveyor General's Certificate of Approval of Field Notes and Survey of Mining Claim.

Department of the Interior,

Office of U. S. Surveyor General,

*Tucson, Arizona.*

*August 27, 1901,* ~~18~~

I, U. S. Surveyor General for *District of Arizona*,

do hereby certify that the foregoing and hereto attached Field Notes and Return of the

Survey of the Mining Claim of *Edwin Scott, per J. D.*

*Coplen, Agent*

....., known as the

*Pittsburgh, Copper Cliff, Denver No. 1 & Denver No. 2,*

situate in *Canon del Oro* mining district,

*Pinal* County, *Arizona*,

in Sections *5-6-7 & 8*, Township No. *10 South*, Range No. *15 East*, *G. S. R.*

*10 & Mer. (unsurveyed)*, designated as Survey No. *1546*.

executed by *Charles von Erleben*, U. S. Deputy Mineral

Surveyor, *March 22-25, 1901,* ~~18~~, under my instructions dated

*March 15, 1901,* ~~18~~, have been critically examined and the

necessary corrections and explanations made, and the said Field Notes and Return, and

the Survey they describe, are hereby approved. A true copy of the copy of the location

certificate filed by the applicant for survey is included in the field notes.

*George Christ*

U. S. Surveyor General for *Arizona*

Mineral Survey No 1546.  
Gila Land District.

Surveyed March 22-25 1901.

by Charles von Exleben

U. S. Dep<sup>y</sup> Min<sup>l</sup> Surveyor.

Scale: 600 Feet = 1 inch.

