

MS.

0

1

5

9

7

Filed Sept. 5, 1901.

U. S. L. M. No 1597 A+B

(4-683.)

Mineral Survey No. 1597 A+B

Lot No. _____

Prescott

Land District.

FIELD NOTES

OF THE SURVEY OF THE MINING CLAIM OF

Wm H. Barnes

KNOWN AS THE

Silverton "Yankee Girl", Inman, American Flag & Trinity, Gold Claims

& Amalia Mills.

Big Bug

Mining District.

Yavapai

County,

Arizona

Section

approx. 34

Township

13 N. R. 1

Range

1 East.

Surveyed under instructions dated

July 20th

1901,

by

J. J. Fisher

U. S. Deputy Mineral Surveyor.

Claim located

Various dates

Survey commenced

July 26th

1901

Survey completed

July 28th

1901

6-160

Address,

Col. J. F. Wilson, Atty

Prescott

Arizona

PRELIMINARY OATHS OF ASSISTANTS IN SURVEY OF MINING CLAIM.

WE, Wm Crocker and W H Daily,
do solemnly swear that we will well and faithfully execute the duties of chain carriers;
that we will level the chain upon even and uneven ground and plumb the tally-pins,
either by sticking or dropping the same; that we will report the true distance to all
notable objects, and the true length of all lines that we assist in measuring, to the best
of our skill and ability, and in accordance with instructions given us, in the survey of
the Mining Claim of W H Barnes, known as the
Silverton Yankee Girl, American Flag, Invincible, Trinity & ~~Germania~~ ^{Hemphill} ~~Gold~~ ^{Lead} claims
~~of Hemphill~~ ^{Big} ~~Lead~~ ^{Big} ~~Gold~~ ^{Lead} ~~claims~~ ^{mining district,}
Yavapai County, Arizona,
in Section _____, Township No. _____, Range No. _____.

Wm Crocker, Chainman.
W. H. Daily, Chainman.

Subscribed and sworn to by the above-named persons before
me this 26th day of August, 1901.
My commission expires May 19, 1904

J. J. Fisher
Notary Public

I, W. H. Daily, do solemnly swear that I will well and
truly perform the duties of axeman, in the establishment of corners and other duties,
according to instructions given me and to the best of my skill and ability, in the survey
of the Mining Claim of W H Barnes
known as the Silverton, Yankee Girl, American Flag
known as the Invincible, Trinity & ~~Germania~~ & Hemphill ~~Lead~~ ^{Lead} ~~claims~~
more fully described in the preceding affidavit.

W. H. Daily, Axeman.

Subscribed and sworn to by the said W H Daily
before me this 26th day of
August, 1901.
My commission expires May 19, 1904

J. J. Fisher
Notary Public

I, Wm Crocker, do solemnly swear that I will
well and truly perform the duties of flagman, in the establishment of corners and other
duties, according to instructions given me and to the best of my skill and ability, in the
survey of the Mining Claim of W H Barnes
known as the Silverton, Yankee Girl, American Flag, Invincible
known as the Trinity & ~~Germania~~, & Hemphill ~~Lead~~ ^{Lead} ~~claims~~
more fully described in the preceding affidavit.

Wm Crocker, Flagman.

Subscribed and sworn to by the said Wm Crocker
before me this 26th day of
August, 1901.
My commission expires May 19, 1904

J. J. Fisher
Notary Public

Survey No. 1597 A

Feet

SILVERTON LODE

Beginning at cor. No. 1 the S.W. cor of claim identical with cor. of location, which is also N.W. cor. of Yanke Girl Lode of this survey.

A porphyry stone 10x1x2x24 ins. set one ft. in ground alongside mon. of stone 3x3 ft. Stone marked S.No. 1-1597 A. Same stone marked Y.G.No. 1-1597 A.

A + on porphyry rock in place marked B.R.S.No. 1-1597 A brs. N. 37° 38' E. 10.6 ft.

A + on porphyry rock in place marked B.R.Y.G.No. 1-1597 A brs. S. 8° 12' W. 38.2 ft.

U.S.L.M.No. 1597 brs. N. 3° 45' W. 75 ft.

Thence N. 0° 35' W.

Var. 17° E.

1480.3 To cor. No. 2 identical with cor. of location.

A porphyry stone 6x10x24 ins. set one ft. in ground alongside mon. of stone 3x3 ft. Stone marked S.No. 2-1597 A.

A + on granite rock in place marked B.R.S.No. 2 - 1597 A brs. S. 89° 25' W. 70.3 ft.

Thence N. 82° E.

Var. 15° E.

300 To N.C.E. identical with N.C.E. of location.

A granite stone 8x10x24 ins. set one ft. in ground alongside mon. of stone 3x3 ft. Stone marked N.C.E.S. No. 1597 A.

Cor. No. 2 Gopher Lode Lot No. 37 brs. N 67° 10' W
50 ft.

Survey No. 1597 A

Feet	
500	<p>To cor.No.3 identical with N.E.cor.of location. A granite stone 8x15x30 ins. set oneft. in ground alongside mon.of stone 3x3 ft. Stone Marked S.No.3- 1597 A.</p> <p>A + on granite rock in place marked B.R.S.No.3- 1597 A brs N.43°47'W. 30.8 ft.</p> <p>A + on granite rock in place marked B.R.S.No.3- 1597 A. brs.S.73°40'W. 53.5 ft.</p> <p style="text-align: center;">Thence S.0°12'E. Var.15° E.</p>
1482	<p>To cor.No.4 which is also cor.No.4 of Yanke Girll Lode of this survey, identical with cor of location. A granite stone 8x10x24 inst. set one ft. in ground alongside mon.of stone 3x3 ft. Stone marked S.No.4- 1597 A . Same stone marked Y.G.No.4-1597 A. No brs. available.</p> <p style="text-align: center;">Thence S.82°W. Var.17°E.</p>
300	<p>To S.C.E. which is also N.C.E.of Yanke Girll Lode of this survey, identical with S.C.E. of locati on. A granite stone 6x12x24 ins. set one ft. in ground alongside mon.of stone 3x3 ft. Stone marked N.C.E. Y.G.No.1597 A, and S.C.E.S.No.1597 A.</p>
590	<p>To cor.No.1 place of beginning survey of exterior boundaries.</p>

* * *

Survey No.1597 A.

Feet

YANKE GIRLL LODE.

Beginning at cor.No.1 which is also cor.No.1 of Silverton Lode of this survey. Cor. described above.

U.S.L.M.No.1597 hrs.N.3°45'W. 75 ft.

Thence S.26°55'W.

Var.17° E.

996.1 To cor.No.2, which is also cor.No.1 of the Invincible Lode of this survey, identical with cor.of location.

Cut a + on porphyry rock in place 4x6 ft. 3 ft . above ground marked Y.G.No.2-1597 A, and I.No.1-1597 A. Alongside mon.of stone 3x3 ft. No brs.available.

Thence N.82° E.

Var.15°30'E.

300 To S.C.E. which is also N.C.E. of Invincible Lode of this survey, identical with S.C.E. of location.

A porphyry stone 5x8x24 ins. set one ft. in ground alongside mon.of stone 3x3 ft. Stone marked S.C.E.Y.G.No.

1597 A and N.C.E.I.No.1597 A.

378.5 ft.
To intersect line 1-2 of American Flag lode of this survey at N.2°30'W.
225.8 ft. from cor. No. 1 of said lode

600 To cor.No.3 which is also cor.No.4 of Invincible Lode of this survey, indential with cor.of location.

A porphyry stone 6x16x30 instset one ft. in ground alonside mon.of stone 3x3 ft. Stone marked Y.G.No.3-1597 A and I.No.4-1597A.

A + on porphyry rock in place marked B.R.Y.G.No.3-1597 A hrs.N.17°35'E.36.4 ft.

A + on porphyry rock in place marked B.R.I.No.4-1597 A hrs.N.89°W.48.6 ft.

Survey No. 1597 A

Feet

Thence N. 26° 27' E. Var. 16° 30' E.

203

To intersect line 4-1., American ^{Lode} of this survey at 787° 30' W.
300 ft. from cor. No. 4, of said lode.

990

To cor. No. 4 which is also cor. No. 4 of Silverton Lode of this survey. Cor. described above.

Thence S. 82° W.

Var. 17° E.

300

To N.C.E. which is also S.C.E. Silverton Lode of this survey. Mon. described above.

590

To cor. No. 1 place of beginning survey of exterior boundaries.

* * *

INVINCIBLE LODE.

Beginning at cor. No. 1 which is also cor. No. 2 of Yanke Girl Lode of this survey. Identical with cor. of location. Cor. described above.

U.S.L.M. No. 1597 brs. N. 24° 51' E. 1061.3 ft.

Thence S. 37° 30' W.

Var. 15° 30' E.

765

To West side mon. whence Initial Mon. of location, a mon. of stone 2x2 1/2 ft. brs. N. 82° E. 300 ft.

1265

To cor. No. 2 identical with S.W. cor. of location.

Cut a + on granite rock in place alongside of mon. of stone 3x3 ft. Rock marked I. No. 2-1597 A. No brs. available.

Thence N. 82° E.

Var. 15° E.

300

To S.C.E. identical with S.C.E. of location.

A porphyry stone 4x10x24 ins. set one ft. in ground alongside mon. of stone 3 x3 ft. Stone marked S.C.E. I. No.

Survey No. 1597 A

Feet

1597 A.

600

To cor. No. 3 identical with cor. of location.

A porphyry stone 6x10x24 ins. set one ft. in ground alongside mon. of stone 3x3 ft. Stone marked I. No. 3-1597 A

A + on granite boulder 6x10 ft 4 ft. above ground marked B. R. I. No. 3-1597 A brs. S. 82° W. 36 ft.

Thence N. 37° 30' E. *Var. 15° E.*

885.7

To intersect line 1-2, of the American Flag lode at D. 2° 30' W. 496.2 ft. from cor. No. 1, of said lode of this survey.

1030

To car track, course N. E. and SW.

1265

To cor. No. 4 which is also cor. No. 3 of Yanke Girl

Lode of this survey. Cor. described above.

Thence S. 82° W. *Var. 16° 30' E.*

221.2

To intersect line 1-2, of the American Flag lode of this survey at D. 2° 30' W. 225.8 ft. from cor. No. 1, of said lode.

300

To N. C. E. which is also S. C. E of Yanke Girl

of this survey. Mon. described above.

600

To cor. No. 1 place of beginning survey of exterior boundaries.

* * *

AMERICAN FLAG LODE.

Beginning at cor. No. 1 from whence original N. W. cor. of location, a mon. of stone 3x3 ft. brs. N. 30° W. 315 ft.

Cut a + on granite boulder 6x8 ft. 6 ft. above ground marked A. F. No. 1-1597 A. Alongside built a mon. of stone 3x3 ft.

U. S. L. M. No. 1597 brs. N 5° 7' E. 687.4 ft.

No other brs. available.

Survey No. 1597 A

	Thence S. 2° 30' W. Var. 16° 30' E.
85	To West side location mon.
225.8	To intersect line 2-3 Yanke Girl Lode of this survey at N. 82° E. 378.8 ft. from cor. No. 2
496.2	To intersect line 3-4 Invincible Lode of this survey at N. 37° 30' E. 885.7 ft. from cor. No. 3.
1302	To cor. No. 2 which is also cor. No. 1 of the Trinity Lode of this survey, identical with cor. of location. A granite stone 8x8x24 ins. set one ft. in ground alongside mon. of stone 3x3 ft. Stone marked A.F. No. 2-1597 A, and T. No. 1-1597 A. A + on granite rock in place marked B.R.A.F. No. 2-1597 A brs. N. 44° 47' E. 20.1 ft. A + on granite rock in place marked B.R.T. No. 1-1597 A brs. N. 83° 45' W. 15.7 ft.
	Thence S. 87° 30' E. Var. 13° 30' E.
300	To S.C.E. which is also N.C.E. Trinity Lode of this survey. Identical with location. A granite stone 6x8x24 ins. set one ft. in ground alongside mon. of stone 3x3 ft. Stone marked S.C.E.A.F. No. 1597 A, and N.C.E.T. No. 1597 A.
535 600	<i>Intersect tram way, course N.W.</i> To cor. No. 3 which is also cor. No. 4 Trinity Lode of this survey, and cor. No. 1 Henrietta Millsite Survey No. 1597 B, identical with cor. of location. A granite stone 8x10x24 ins. set one ft. in ground alongside mon. of stone 3x3 ft. Stone marked A.F. No. 3-1597 A, and T. No. 4-1597 A, and H. No. 1-1597 B. A + on porphyry rock in place marked B.R.H. No. 1-1597 B brs. S. 48° 10' E. 11.8 ft.

Survey No.1597 A

Feet

Thence N.2°30'E.

Var.13°30'E.

1302 To cor.No.4, original location mon. brs.N.2°30' E.
315 ft. a mon.of stone 3x3 ft.
A porphyry stone 6x10x24 ins. set one ft. in ground
alongside mon.of stone 3x3 ft. Stone marked A.F.No.4-
1597 A. No brs. available.

Thence N.87°30'W.

Var.15° E.

300 To N.C.E. at intersection of line 3-4 Yanke Girl
Lode of this survey at N.26°27'E.203 ft. from cor.
No.3
A porphyry stone 6x8x24 ins. set one ft. in ground
alongside mon.of stone 3x3 ft. Stone marked N.C.E.
A.F.No.1597 A.

Initial Mon.of location, a mon.of stone 3x3 ft brs.
S.2°30'W, 85 ft.

600 to Cor.No.1 place of beginning survey of exterior
boundaries.

* * *

TRINITY LODE.

Beginning at cor.No.1 which is also cor.No.2 of American
Flag Lode of this survey, identical with cor. of
location. Cor.described above.

U.S.L.M.No.1597 brs.N.3°24'E.1989.1 ft.

Thence S.32°20'W.

Var.13° 30' E.

1485 To cor.No.2, identical with S.W.cor.of Location.
A granite stone 5x8x24 ins. set one ft. in ground

Survey No. 1597 A

Feet

alongside mon. of stone 3x3 ft. Stone marked T.No.2-1597 A.

A + on granite rock in place marked B.R.T.No.2-1597 A. brs. S. 49° E. 31.3 ft.

Thence S. 87° 30' E.

Var. 14° 15' E.

300 to To S.C.E. identical with S.C.E. of location.

A granite stone 8x10x24 ins. set one ft. in ground alongside mon. of stone 3x3ft. Stone marked S.C.E.T. No. 1597 A.

600 To cor. No. 3 identical with cor. of location.

A granite stone 8x8x24 ins. set one ft. in ground alongside mon. of stone 3x3 ft. Stone marked T.No.3-1597 A.

A + on granite rock in place marked B.R.T.No.3-1597 A brs. N. 57° 25' E. 207 ft.

Thence N. 32° 20' E.

Var. 14° 35' E.

1018.5 To cor. No. 2 Henrietta Mill site, Survey No. 1597 B.

1388.5 To tramway, course N.W.

1485 To cor. No. 4 which is also cor. No. 3 American Flag Lode, and cor. No. 1 Henrietta Mill site. Cor. described above.

Thence N. 87° 30' W.

Var. 13° 30' E.

⁶⁵ 300 *Intersect tram-way course N.W.*
To N.C.E. which is also S.C.E. American Flag Lode of this survey. Mon. described above.

600 To cor. No. 1 place of beginning survey of exterior boundaries.

Survey No. 1597 B

Feet

HENRIETTA MILLSITE.

Beginning at cor.No.1 which is also cor.No.3 American Flag, and cor.No.4 of Trinity Lode of Survey No.

1597 A. Cor.described above.

U.S.L.M.No.1597 brs.N.13°27'W.2068.8 ft.

Thence S.32°20'W.

Var.13°30'E.

- 96.5 To tramway, course N.W.
- 466.5 To cor.No.2 identical with cor. of location.
A granite stone 6x8x24 ins. set one ft. in ground alongside mon.of stone 3x3 ft. Stone marked H.No.2 1597 B.
A + on granite rock in place marked B.R.H.No.2-1597 B brs.N.42°E.105 ft.

Thence S.57°40'E.

Var.13°30'E.

- 466.5 To cor.No.3 identical with cor. of location.
stone
A granite 5x8x 24 ins. set one ft. in ground alongside mon.of stone 3x3 ft. Stone marked H.No.3-1597 B.
A + on granite rock in place marked B.R.H.No.3-1597 B brs.N.2°25' E. 108 ft.
- A + on granite rock in place marked B.R.H.No.3-1597 B brs.N.51°10' E.107.5 ft.

Thence N.32°20'E.

Var. 13°30'E.

- 466.5 To cor.No.4 identical with cor.of location.
A grainte stone 8x10x24 ins. set one ft. in ground alongside mon.of stone 3x3 ft. Stone marked

Survey No.1597 B

Feet H.No.4-1597 B. No Brs.available.

Thence N.57°40'W.

Var. 13°30'E.

466.5 To cor.No.1 place of beginning survey of exterior boundaries.

* * *

AREA

Silverton Lode	-	20.054 acres
Yanke Girll Lode	-	11.157 "
Invincible Lode	-	12.241 "
American Flag Lode		
Gross Area		17.936 acres
Less conflict with		
Invincible Lode	.675	
Yanke Girll	<u>1.203</u> <u>1.878</u>	"
Net Area American Flag Lode	-	16.058 "
Trinity Lode	-	17.745 "
Henrietta Millsite	-	<u>4.995</u> "
Total area Survey No.1597 A & B		82.250 "

* * *

LOCATION.

This claim is located on unsurveyed land approximately in T.12 N., R.1 E., G.& S.R.M. in Big Bug Mining District, Yavapai County, Arizona, Territory.

And is bounded on the north by the Gopher Lode Lot No. 37; on the east by government land; and on the south and west by government lands.

* * *

VEIN.

Silverton Lode

Vein extends N.85 ft. and S.1397 ft. from the discovery shaft.

Yanke Girll Vein

Extends N.E. 221 ft. and S.W.769 ft. from the discovery shaft.

Invincible Vein

Extends S.W.500 ft. and N.E.765 ft. from the initial monument of location.

American Flag Vein

Extends N.85 ft. and S.1217 ft. from the initial mon. of location.

Trinity Vein

Extends in N.E.100 ft. and S.W.1385 ft. from the discovery shaft.

* * *

EXPENDITURE OF FIVE HUNDRED DOLLARS.

I certify that the labor and improvements upon this claim, placed thereon by the claimant and his grantors, is not less than Five Hundred Dollars for each location in this claim, and said improvements consist of:

Silverton Lode:

Discovery shaft No.1 which brs. from N.C.E.mon. S.0°12'E.85 ft. Shaft 4x6 ft. 80 ft.deep.

Value \$800.00

Tunnel No.2 which brs.from N.C.E.mon.S.3°15'W. 580 ft. course S.4x6 ft. 125 ft.long.

Value \$1250.00

Tunnel No.3 which brs.from N.C.E.mon.S.1°30'W. 700 ft. course S. 4x6 ft. 150 ft.long.

Value \$1500.00

Tunnel No.4 which brs.from N.C.E.mon.S.0°30'W. 835 ft.course S. 4x6 ft. 150 ft.long.

Value \$1500.00

Survey No. 1597 A & B

Shaft No. 5 which brs. from S.C.E. mon. N. $0^{\circ}12'E$. 75 ft. Shaft 4x7, timbered, 495 ft. deep. At 260 ft. tunnel from American Flag Lode intersects shaft. Below tunnel level 100 ft. level run north 4x6 ft. 160 ft. and south 4x6 ft. 80 ft. At 175 ft. level run north 200 ft. and south 30 ft. At 200 ft. level run north 80 ft.

Value \$15400.00

Yanke Girll Lode.

Discovery shaft No. 1 which brs. from N.C.E. mon. S. $26^{\circ}27'W$. 221 ft. Shaft 4x6 ft. 60 ft. deep.

Value \$600.00

Invincible Lode

Discovery tunnel No. 1 which brs. from S.C.E. mon. N. $37^{\circ}30'E$. 570 ft. Course N. $37^{\circ}30'E$. 4x6 ft. 180 ft. long.

Value \$1800.00

Tunnel No. 2 which brs. from N.C.E. Mon. S. $37^{\circ}31'W$. 177 ft. Course N. $31^{\circ}E$. 4x6 ft. 300 ft. long.

Value \$3000.00

American Flag Lode.

Discovery tunnel No. 1 which brs. from N.C.E. mon. S. $2^{\circ}30'W$. 153 ft. Course N. $3^{\circ}E$. 4x6 ft. 100 ft. long.

Value \$10000.00

American Flag vein intersects the Yanke Girll vein at N.C.E. of Yank Girll Lode, and level is run S.W. on Yanke Girll vein 4x6 ft. 110 ft. long.

Value \$1100.00

Trinity Lode.

Discovery shaft No. 1 which brs. from N.C.E. mon. S. $32^{\circ}20'W$. 100 ft. shaft 4x6 ft. 10 ft. deep.

Value \$100.00

Survey No. 1597 A & B

\$400 of the improvements of discovery tunnel No. 1 of American Flag Lode is to be applied to the Trinity Lode.

OTHER IMPROVEMENTS.

A car track from Tunnel No. 2 Invincible Lode to Tunnel No. 1 American Flag Lode.

A tram way from Tunnel No. 1 American Flag Lode to Quartz Mill on Henrietta Millsite.

Value	\$1000.00
-------	-----------

20-stamp mill on Henrietta Millsite, the N.E. cor. of which bears S. 6° 15' W. 125 ft. from cor. No. 1.

Value	\$10000.00
-------	------------

Total value of improvements on Survey

No. 1597A & B	\$48050.00
---------------	------------

* * *

INSTRUMENT

This survey was made with a Gurley Light Mountain Solar Transit. The courses were deflected from the true meridian as determined by direct solar observation. The distances were measured with a 50-foot steel tape and a 100-foot steel chain.

Prescott, Arizona,

August 30, 1901



U.S.D.M.S.

Note:- I omitted to survey the Germania lode for the reason that the claimant could not find the location monuments, and in his opinion the ground was covered by other locations, and he informed me that he wished to abandon that location.

J. J. Fisher,

U. S. Dep. Minl. Surveyor.

Prescott, Arizona, August 30, 1901.

Survey No. 1597 A & B

U.S.L.M.No.1597.

Gopher Lode Lot No.37 being tied to Freeport Butte and there being no monument and not even a cross cut upon rock to indicate tie point, I cut a + on porphyry rock in place marked U.S.L.M.No.1597, and alongside built a mon.of stone 4x4 ft. 5 ft. high.

A + on porphyry rock in place marked ^{B.R.}U.S.L.M.No.1597
brs.S.64°40'W.17.7 ft.

A + on porphyry rock in place marked B.R.U.S.L.M.No.
1597 brs.N.30°5'E.10.7 ft.

Elliott's Peak brs.N.84°30'W.about 2 1/2 miles.

Hoist, Little Jessie Mine, brs.N.56°30'W.about one
mile.

McCabe brs.N.10°E.about one mile.

Hoist on Gopher Mine brs.N.6°20'E.about 2000 ft.

Huron, the nearest railroad station and postoffice,
brs.S.85°30'E.about one mile.

Prescott, Arizona,
August 30th, 1901

J. J. Fisher

U.S.D.M.S.

Survey No 1597 A + B
 Prescott Land District.

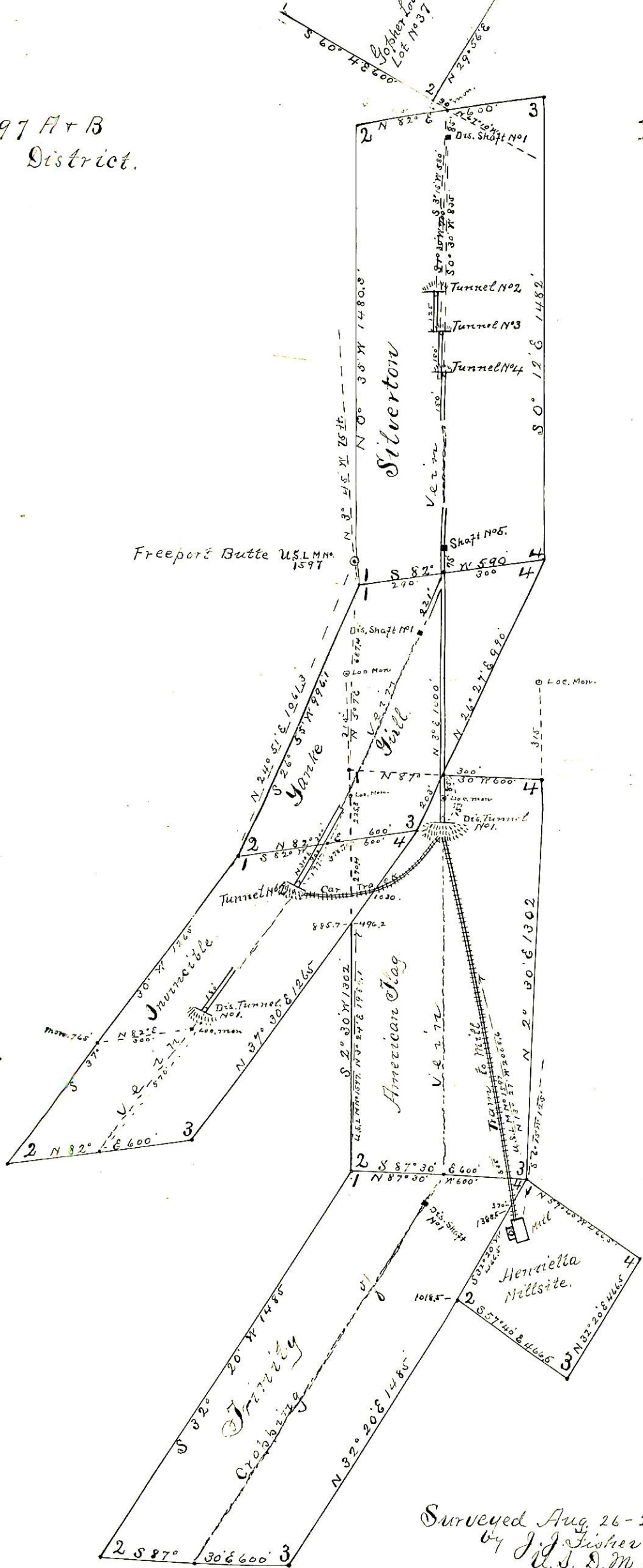

Surveyed Aug. 26-28-1901
 by J. J. Fisher
 U. S. D. M. S.

FINAL OATHS FOR SURVEYS.

LIST OF NAMES.

A list of the names of the individuals employed by J. J. Fisher
 United States Deputy Mineral Surveyor, to assist in running, measuring, and marking the lines
 corners and boundaries described in the foregoing field notes of the survey of the mining claim
 of W. H. Barnes
 known as the Silverton, "Yankee Girl", American Flag, Invincible Family and Herratta Mile Silt
 and showing the respective capacities in which they acted.

- Wm Crocker , Chairman.
- W. H. Daily , Chainman.
- W. H. Daily , Arman.
- Wm Crocker , Flagman.

FINAL OATHS OF ASSISTANTS.

We, Wm Crocker
 and W. H. Daily do solemnly swear that we assisted J. J. Fisher
 United States Deputy Mineral Surveyor, in marking the corners and
 surveying the boundaries of the mining claim of W. H. Barnes
 known as the Silverton, Yankee Girl, American Flag, Invincible Family Silt, known as the claims and Herratta Mile Silt
 represented
 in the foregoing field notes as having been surveyed by said deputy mineral surveyor and under
 his direction; and that said survey has been in all respects, to the best of our knowledge and
 belief, faithfully and correctly executed, and the corner and boundary monuments established
 according to law and the instructions furnished by the United States Surveyor-General for
Arizona

- W. H. Daily , Chairman.
- Wm Crocker , Chainman.
- W. H. Daily , Arman .
- Wm Crocker , Flagman.

Subscribed and sworn to by the above-named persons before me
 this 29th day of August, 1901

My commission expires
 May 19, 1904

J. J. Fisher
 Notary Public

FINAL OATH OF U. S. DEPUTY MINERAL SURVEYOR

I, J. J. Fisher, U. S. Deputy Mineral Surveyor, do solemnly swear that, in pursuance of instructions received from the United States Surveyor General for Arizona, dated Aug 20th 1901, I have, in strict conformity to the laws of the United States, the official regulations and instructions thereunder, and the instructions of said Surveyor General, faithfully and correctly executed the survey of the Mining Claim of Wm. H. Barnes known as the Silver, "Yankee Girl" Invariable, known as the American Flag & Trinity Ind. Claims & Henrietta Millite, situate in Big Bay Mining District, Yavapai County, Arizona, in Section —, Township No. —, Range No. — and designated as Survey No. 1597 A + B, as represented in the foregoing field notes, which accurately show the boundaries of said mining claim as distinctly marked by monuments on the ground, and described in the attached copy of the location certificate, which was received by me from the Surveyor General with said instructions, and that all the corners of said survey have been established and perpetuated in strict accordance with the law, official regulations and instructions thereunder; and I do further solemnly swear that the foregoing are the true and original field notes of said survey and my report therein, and that the labor expended and improvements made upon said mining claim by claimant or his grantors are as therein fully stated, and that the character, extent, location and itemized value thereof are specified therein with particularity and full detail, and that no portion of said labor or improvements so credited to this claim has been included in the estimate of expenditures upon any other claim.

J. J. Fisher
U. S. Deputy Mineral Surveyor.

Subscribed and sworn to by the said J. J. Fisher
U. S. Deputy Mineral Surveyor, before me Allen Hill,
this 22
day of September, 1901

My Commission Expires June 23, 1903
Allen Hill

Notary Public

Affidavit of Five Hundred Dollars Improvements.

We, Wm Crocker, and W H Daily

of lawful age, being first duly sworn according to law, depose and say: That we are acquainted with the Silverton Yuma Arizona Summit Unity Side claims mining claim, situate in Big Bend Mining District, Yavapai County, Arizona Territory, for which W H Barnes

has made application for survey prior to application for patent under the provisions of the Act of Congress, approved May 10, 1872; and that the labor done and improvements made thereon by the applicant and his grantor exceed Five Hundred Dollars in value, and further, that we are not personally interested in said mine.

Wm Crocker
W H Daily

TERRITORY OF ARIZONA,
County of Yavapai } ss:

Sworn to and subscribed before me, this 29th day of August, 1901

J. J. Fisher
Notary Public

159671.200-10-1903

My commission expires
May 10, 1901

NON-MINERAL AFFIDAVIT.

TERRITORY OF ARIZONA,

County of Yavapai } ss.

Wm Crocker and W H Daily of said

County and Territory, being first duly sworn, each for himself and not one for the other, deposes and says; that he is well acquainted with the land of the Henrietta

mill-site claim, situated in Big Bay Mining

District, Gila and Salt River Meridian, in the County of

and Territory of Arizona, claimed by W. H.

Yavapai
Barnes

applicant for United States patent therefor; that he is well acquainted with the character of said described land included within the boundary lines as officially surveyed by J. J. Fisher United States Deputy Mineral Surveyor, having frequently passed over the same; that his knowledge of such land is such as to enable him to testify understandingly with regard thereto; that there is not to his knowledge, within the limits thereof, any vein or lode of quartz or other rock in place bearing gold, silver, cinnabar, lead, tin or copper, or any deposit of coal; that there is not within the limits of said land, within his knowledge, any placer, cement, gravel or other valuable mineral deposit; that no portion of said land is claimed under the local customs or rules of miners or otherwise; that no portion of said land is worked for minerals during any part of the year by any person or persons; that said land is essentially non-mineral land, and that there is within the boundaries of said claim

improvements, to-wit: One Windy Stamp Quartz mill &

pipe line

and that he has no interest whatever in said described mill-site claim.

Wm. Crocker
W. H. Daily.

Subscribed and Sworn to before me this 29th day of August A. D. 1801, and I hereby certify that the foregoing affidavit was read to the said Wm Crocker and W H Daily

previous to their names being subscribed thereto, and that deponents are reputable persons to whose affidavits full faith and credit should be given.

My commission expires
May 10, 1900.

J. J. Fisher
Notary Public

SILVERTON.

NOTICE OF LOCATION.

The undersigned clame for mining purposes fifteen hundred feet in length & three hundred feet on each side of the vain or ledge according to the mineing laws of the United States & Territory of Arizona.

This claim commences at this notice & runs fifteen hundred feet in a Southerly direction along the ledge to a monument of stone. Better described as joining the southeast corner of the mine Pat.by Gen Cortes Big Bug Mineing District North of Big Bug Creek one mile & shall be known as the Silverton Mineing Clame.

Dated on the ground this the 1 day of Jan.1887.

Located by,

John R.Wells.

Witness by,

G.M.Whitson.

Jan.1st 1887.

Recorded at request of W.Z.Curtis,Jan.31st A.D.1887,at 9 o'clock a.m.in Book 23 of Mines,page 346,Records of Yavapai County Arizona.

E.J.F.Horne,

County Recorder.

SILVERTON.AMENDED NOTICE OF MINING LOCATION.
Lode Claim.

To all whom it may concern:

This mining claim, the name of which is the SILVERTON Mining Claim, situate on lands belonging to the United States of America, and in which there are valuable mineral deposits, was entered upon, amended and located for the purpose of exploration and purchase by William H. Barnes, the undersigned, on the 10th day of July, 1901.

The length of this claim is 1500 feet and I claim 80 feet, in a northerly direction and 1415 feet in a southerly direction from the center of the discovery shaft, at which this notice is posted, lengthwise of the claim, together with three hundred (300) feet in width of the surface grounds, on each side of the center of said ~~xxxx~~ vein. The general course of the lode deposit and premises is from the northerly to the southerly.

This claim is situated and located in the Big Bug Mining District, in Yavapai County, in the Territory of Arizona, about one mile in a northerly direction from Big Bug Creek and is the southerly extension of the Gopher Group of mines.

The surface boundaries of the claim are marked upon the ground as follows: Beginning at a monument of stones at a point in a northerly direction 85 feet from the discovery shaft (at which this notice is posted) being in the center of the north end line of said claim; thence easterly 300 feet to a monument of stones, being the northeast corner of said claim; thence southerly 1500 feet to a monument of stones, being at the southeast corner of said claim; thence westerly 300 feet to a monument of stones at the center of the south end of said claim; thence westerly 300 feet to a monument of stones, being at the southwest corner of said claim; thence northerly 1500 feet to a monument of stones, being the northwest corner of said claim; thence easterly 300 feet to the place of beginning.

All done under the provisions of Chapter Six, of Title

YANKE GIRLL.

NOTICE OF LOCATION.

Know all men by these presents:

That, we the undersigned, have this day located Fifteen Hundred(1500)linear feet of this vein or lode bearing precious metals with all dips, spurs, angles and variations, with surface ground Three Hundred(300)feet on each side of the centre of vein with all mineral deposits contained therein, and all timber growing within the limits of said claim, and all water and water privileges thereon or appurtenant thereto, under and according to the provisions of the Mining Laws of the United States, under which it is located.

This claim commences at this monument and notice placed upon the ledge and runs Fifteen hundred 1000 feet in a Southerly direction along the ledge.

The Exterior boundaries are as follows, viz:-

Commencing at this monument and notice and running Three Hundred(300)feet in an easterly direction to monument of stone at N.E. corner of claim; thence in a southerly direction parallel with the ledge..... hundred 1000 feet to monument at S.E. corner of claim; thence at right angles across the ledge in a westerly direction Six Hundred(300)feet to monument at S.W. corner of claim; thence parallel with the lode in a northerly direction.... Hundred 1000 feet to monument at N.W. corner of claim; thence at right angles across the ledge in an easterly direction Three Hundred(300)feet to monument upon the ledge and place of beginning.

This ledge may be more generally described as situated about one and half miles northwest of Boggs Ranch on Big Bug Creek and is located as a fraction of a claim layiang between maggie mine on south owned by Boggs and J. Burke on the north by name of rob rawr mine in Big Bug Mining District Yavapai Yavapia County, Arizona Territory, and shall be known as the YANKE GIRLL Mining claim.

Dated on the ground this twenty-seventh 27 day of April 1893.

James H. Slack

J. R. Slack

Recorded at request of J. R. Slack June 25th A. D. 1893, at 9:10 o'clock a. m. in Book 34 of Mines, pages 413 & 419, Records of Yavapai County, Arizona.

By F. A. Tritle Jr.,
Deputy.
(L.S.) Charles H. Akers,
County Recorder.



AMERICAN FLAG.

NOTICE OF LOCATION.

Know all men by these presents:

That the undersigned have this day located 1500 feet of this lode bearing precious metals with all dips, spurs, angles and variations with surface ground 300 feet on each side of vein, with all mineral deposits contained therein and all timber and water thereon or appurtenant thereto, according to the provisions of the United States Mining Laws.

The exterior boundaries are as follows:

Commencing at a monument of stone on west boundary line distant 300 feet in a westerly direction from Discovery Monument; thence in a northerly direction parallel with the ledge 750 feet to monument at N.W. corner; thence in an easterly direction at right angles across the ledge 300 feet to monument at N.E. corner; thence in a southerly direction parallel with the ledge 1500 feet to monument at S.E. corner; thence at right angles across the ledge in a westerly direction 300 feet to monument on west boundary and place of beginning.

This claim is in Big Bug Mining District, Yavapai County, Arizona, and may be more generally described as situated about one mile from Boggs Post Office in a north westerly direction and upon side of hill in Big Bug Mining District and shall be known as the AMERICAN FLAG and shall be known as the AMERICAN FLAG Mining Claim.

Dated on the ground this 5 day of June, 1893.

A. T. Butler

Frank Bliss

John Kelly

Recorded at request of John Kelly June 29th A.D. 1893, at 2:30 o'clock p.m. in Book 34 of Mines, pages 425, Records of Yavapai County, Arizona.

(L.S)

Charles H. Akers,
County Recorder.

By F. A. Tritle Jr.,
Deputy.

AMERICAN FLAG.

AMENDED NOTICE OF LOCATION.

Know all men by these presents:

That we, the undersigned, have this day located 1500 feet of this vein or lode, bearing precious metals, with all dips, spurs, angles and variations, with surface ground 300 feet on each side of vein with all mineral deposits contained therein, and all timber and water thereon or appurtenant thereto, according to the provisions of the United States Mining Laws.

The exterior boundaries are as follows:

Commencing at a monument of stone on west boundary line, distant 300 feet in a westerly direction from discovery monument; thence in a northerly direction parallel with the ledge 750 feet to monument at N.W. corner; thence in an easterly direction at right angles across the ledge 300 feet to monument at N.E. corner; thence in a southerly direction parallel with the ledge 1500 feet to monument at S.E. corner; thence at right angles across the ledge in a westerly direction 300 feet to monument at S.W. corner; thence in a northerly direction parallel with the ledge 750 feet to monument on west boundary and place of beginning.

This claim is in Big Bug Mining District, Yavapai County, Arizona, and may be more generally described as situated about one mile from Boggs Post Office in a Northerly direction and upon the south side of a mountain sloping towards Big Bug Creek, and shall be known as the AMERICAN FLAG Mining Claim.

This amended notice of location is filed for record for the purpose of correcting an imperfect description of said Mining Claim set forth in the original notice of location recorded in Book 34 of Mines at page 425, Records of Yavapai County, Arizona.

Dated on the ground this 2nd day of May 1893.

A.L. Butler.

A.L. Butler

John Kelly

Frank Bliss

Recorded at request of John Kelly May 2nd A.D. 1893, at 3:55 o'clock p.m. in Book 33 of Mines, pages 337-338, Records of Yavapai County, Arizona.

(L.S.) Alex O. Brodie,

By E.E. Kirkland,

County Recorder.

Deputy.

ERVINCIBLE Lode.

This claim is in Big Bug Mining District, Yavapai County, Arizona and may be generally described as situated 1 one mile from Roggs Post Office and on the North side of Big Bug Creek on the southeast end of north high mountain and we claim 500 feet south and 1000 feet north on this ledge and shall be known as the ERVIN-CIRCLE lode.

Dated on the ground this 23day of June, 1893.

A. T. Butler
John Kelly
Frank Bliss

Recorded at request of John Kelly June 29 A.D. 1893, at 3:30 o'clock p.m. in Book 34 of Mines, pages 423, Records of Yavapai County, Arizona.

(L.S) Charles H. Akers,
County Recorder.
By F.A. Tritle Jr.,
Deputy.

INVINCIBLE.

AMENDED NOTICE OF LOCATION.

Know all men by these presents:

That we, the undersigned, have this day located 1500 feet of this vein or lode, bearing precious metals, with all dips, spurs, angles and variations, with surface ground 300 feet on each side of vein, with all mineral deposits contained therein, and all timber and water thereon or appurtenant thereto, according to the provisions of the United States Mining Laws.

The exterior boundaries are as follows:

Commencing at a monument of stone on west boundary line distant 300 feet in a westerly direction from discovery monument; thence in a northerly direction, parallel with the ledge 1000 feet to monument at N.W. corner; thence in an easterly direction at right angles across the ledge 300 feet to monument at N.E. corner; thence in a southerly direction parallel with the ledge 1500 feet to monument at S.E. corner; thence at right angles across the ledge in a westerly direction 300 feet to monument at S.W. corner; thence in a northerly direction parallel with the ledge 500 feet to monument on west boundary and place of beginning.

This claim is in Big Bug Mining District, Yavapai County, Arizona, and may be more generally described as situated about one mile from Boggs Post Office in a Northwesterly direction and upon the south east side of a mountain sloping toward Big Bug Creek and shall be known as the INVINCIBLE Mining Claim.

This amended notice of location is filed for record for the purpose of correcting an in-sufficient description of said Mining Claim set for in the original notice of location recorded in Book 34 of Mines, at page 426, Records of Yavapai County, Arizona, as the ENVENCIBLE Mining Claim.

Dated on the ground this 2nd day of May 1893.

A. J. Butler

A. L. Butler

John Kelly

Frank Bliss

Recorded at request of John Kelly May 2nd A.D. 1893, at 3:55 o'clock p.m. in Book 36 of Mines, pages 336-337, Records of Yavapai County, Arizona.

(L.S.) Alex O. Brodie,

By E. E. Kirkland,

County Recorder.

Deputy.

TRINITY.

NOTICE OF LOCATION.

Know all men by these presents:

That we the undersigned have this day located 1500 feet of this vein or lode, bearing precious metals, with all dips, spurs, angles and variations, with surface ground 300 feet on each side of vein, with all mineral deposits contained therein, and all timber and water thereon or appurtenant thereto, according to the provisions of the United States Mining Laws.

The exterior boundaries are as follows:

Commencing at this monument and notice, and running 300 feet in an easterly direction to monument at N.E. corner; thence in a southerly direction parallel with the ledge 1500 feet to monument at S.E. corner; thence at right angles across the ledge in a westerly direction 300 feet to monument at S.W. corner; thence parallel with the ledge in a northerly direction 1500 feet to monument at N.W. corner; thence at right angles across the ledge in an easterly direction 300 feet to the place of beginning.

This claim is in Big Bug Mining District, Yavapai County, Arizona, and may be more generally described as situated about 1 mile in a N. Westerly direction from the Big Bug P.O. and is the 1st South Extension of the American Flag Mine and about 1 mile South of McCabe's Sink to Rise Mine and shall be known as the TRINITY Mining Claim.

Dated on the ground, this 8th day of June, 1892.

R. L. Weaver

R. C. Heuston

M. Houston

Recorded at request of Dick Heuston, June 13th A.D. 1892, at 10:40 o'clock a.m. in Book 34 of Mines, pages 372, Records of Yavapai County, Arizona.

(L.S) Charles H. Akers,

By F. A. Tritle Jr.,

County Recorder.

Deputy.

HENRIETTA.

LOCATION NOTICE OF THE MILL-SITE CLAIM AND WATER RIGHT.

Know all men by these presents:

That I, the undersigned, have this day located a Mill-Site for the purpose of erecting suitable works for reducing the ores of the Yanky, Silverton, American Flag & Invincible Mining Claims situated in Big Bug Mining District, Yavapai County, Arizona Territory.

The exterior boundaries of said Henrietta Mill-Site claim, are as follows, viz:

Commencing at a monument of stone at N.E. corner of claim, and running thence in a westerly direction, 466-1/2 feet to monument of stone at N.W. corner of claim; thence in a southerly direction 466-1/2 feet to monument of stone at S.W. corner of claim; thence in an easterly direction, 466-1/2 feet to monument of stone at S.E. corner of claim; thence in a northerly direction, 466-1/2 feet to monument of stone at N.E. corner of claim and place of beginning.

This location may be more generally described as being situated in Big Bug Mining District about one mile north west of Big Bug Post Office, and immediately south of the American Flag Mining Claim.

That we have also located in connection with the said Mill-site claim-----inches miners measure of the water of this----- under and in accordance with the laws of the Territory of Arizona, regulating the location and possession of water rights.

The dimensions of the ditch for diverting the water from its natural course at the head, being as follows:-----wide at top, -----wide at bottom, -----in depth, with a uniform grade of-----to the rod.

Dated on the ground, this ninth day of July 1893.

James Shirley

Witness: J.J. Coleman.
T. Martin.

Recorded at request of Geo. S. Porter Jr., July 25th A.D. 1893, at 10:30 o'clock a.m. in Book 2 M.S. & W.R., pages 358 & 359, Records of Yavapai County, Arizona.

(L.S) Alex O. Brodie,
County Recorder.

Territory of Arizona,))
County of Yavapai.) ss:

I, P. J. FARLEY, County Recorder in and for the County of Yavapai, in the Territory of Arizona, and custodian of the records thereof, do hereby certify that I have compared the above and foregoing with, and the same is a full, true and correct copy of the notice of location of the "HENRIETTA" Mill-Site Claim and Water Right, as the same appears of record in Book 2, Mill-sites and Water Rights, pages 358 and 359, records of Yavapai County, Arizona.

IN WITNESS WHEREOF, I have hereunto set my hand and affixed my official seal, this 12th day of July A.D. 1893.



J. Shirley
County Recorder.

TERRITORY OF ARIZONA,)
) ss:
 COUNTY OF YAVAPAI.)

I, P. J. FARLEY, County Recorder in and for the County of Yavapai, in the Territory of Arizona, and custodian of the Records thereof, do hereby certify that I have compared the above and foregoing pages numbered from one to eight, inclusive, with the original records in my office and said pages contain a full, true and correct copy of the notice of location of each of the following described mining claims, and also a full, true and correct copy of the Amended notice of location of two of said mining claims (AMERICAN FLAG and INVINCIBLE):

The SILVERTON mining claim, the notice of location whereof being of record in Book 23 of Mines, page 346, records of Yavapai County, Arizona:

The YANKE GIRLL mining claim, the notice of location whereof being of record in Book 34 of Mines, pages 418 and 419, said records:

The AMERICAN FLAG mining claim, the notice of location whereof being of record in Book 34 of Mines, page 425; the amended notice of location whereof being of record in Book 36 of Mines, pages 337-338, said records:

The ENVINCIBLE mining claim, the notice of location whereof being of record in Book 34 of Mines, page 426; and the amended notice of location whereof being of record in Book 36 of Mines, pages 336-337, said records:

The TRINITY mining claim, the notice of location whereof being of record in Book 34 of Mines, page 378, said records: and

The GERMANIA mining claim, the notice of location whereof being of record in Book 38 of Mines, page 6, said records.

IN WITNESS WHEREOF, I have hereunto set my hand and affixed my Official Seal, this 12th day of July, A. D. 1901.

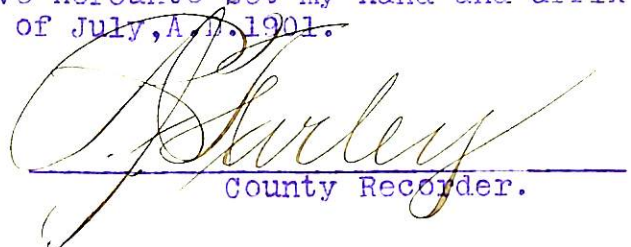

 County Recorder.



(4-687.)

Surveyor General's Certificate of Approval of Field Notes and Survey of Mining Claim.

Department of the Interior,

Office of U. S. Surveyor General,

Tucson, Arizona

October 3rd 1901.

I, U. S. Surveyor General for *Dist. of Arizona*,

do hereby certify that the foregoing and hereto attached Field Notes and Return of the

Survey of the Mining Claim of *W. A. Barnes*

known as the, Silverton, Yankee Girl, Invincible,

American Flag and Trinity, known as the

and Henrietta mill-site

situate in *Big Bug* mining district,

Yavapai County, *Arizona*,

in Section *Approx.*, Township No. *12 N.*, Range No. *1 East (uncurveyed.)*

designated as Survey No. *1597 A. + B.*

executed by *J. J. Fisher*, U. S. Deputy Mineral

Surveyor, *Aug. 26-28, 1901*, 18th, under my instructions dated

Aug. 20, 1901, 18th, have been critically examined and the

necessary corrections and explanations made, and the said Field Notes and Return, and

the Survey they describe, are hereby approved. A true copy of the copy of the location

certificate filed by the applicant for survey is included in the field notes.

Night H. Rice

U. S. Surveyor General for *Arizona*

Freeport Butte
U.S. L.M. No 1597.
Big Bug Mining District
Yavapai County
Arizona

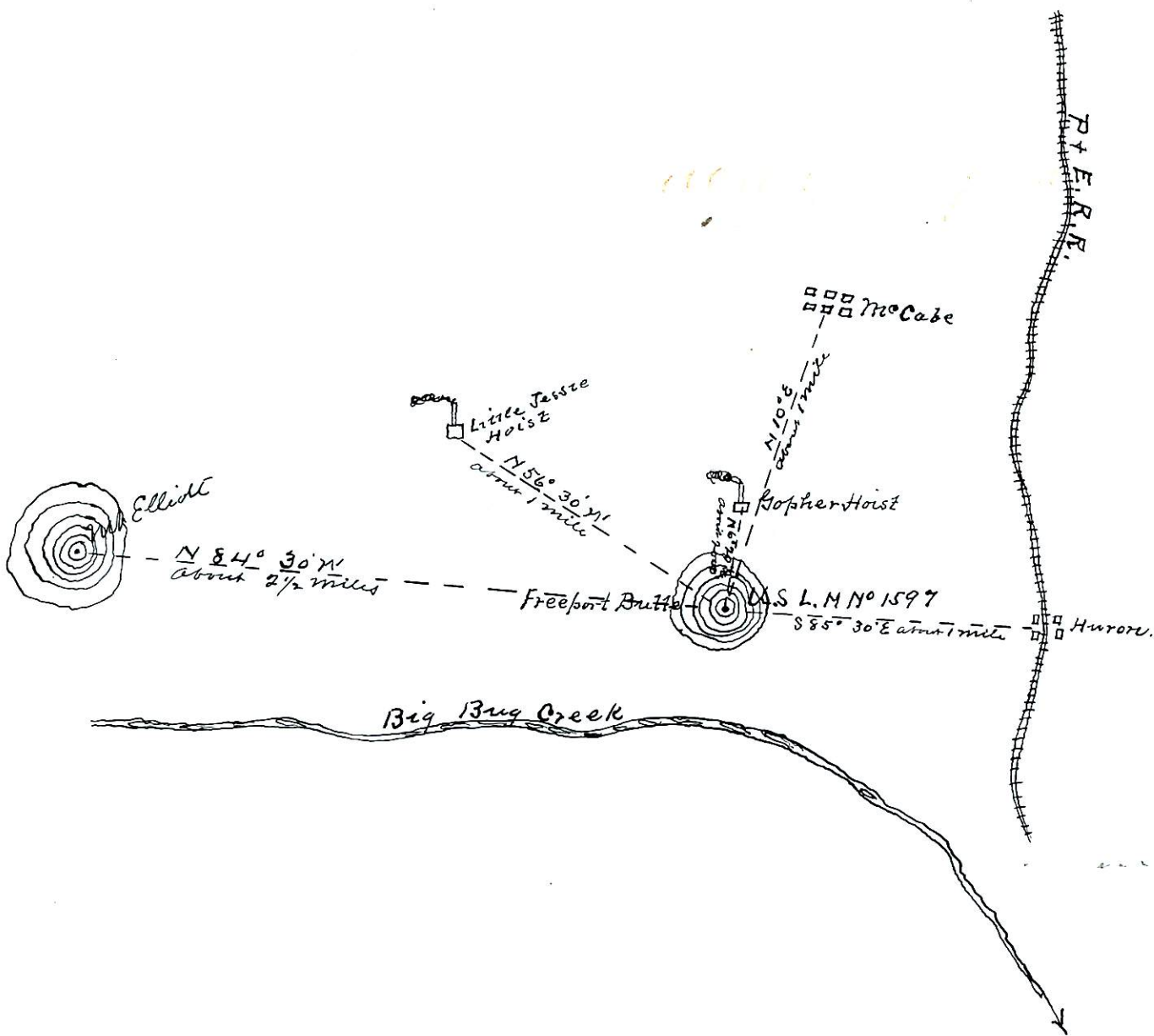

J. J. Fisher
U.S. G. M. S.
Scale 2 ins. to one mile

Aug 31st 1906.