

**MS**

**0**

**1**

**6**

**0**

**6**

(4-683.)

Mineral Survey No. 1606

Lot No.

Gila Land District.

FIELD NOTES

OF THE SURVEY OF THE MINING CLAIM OF

The Bisbee West Copper Mining Company

KNOWN AS THE

West Bisbee N<sup>o</sup> 1, West Bisbee N<sup>o</sup> 13, West Bisbee N<sup>o</sup> 14, West Bisbee N<sup>o</sup> 15, West Bisbee N<sup>o</sup> 16, and Opham Fe. Co.

Warren Mining District,

Cochise County, Arizona, Territory

Section Approximately Township 23, South, Range 24, E. 1/4

Gila and Salt River Base and Meridian,

Surveyed under instructions dated October 5<sup>th</sup>, 1901,

by Geo. C. Clark

U. S. Deputy Mineral Surveyor.

Claim located June 15<sup>th</sup>, 1900 (Amended)

Survey commenced October 17<sup>th</sup>, 1901.

Survey completed October 24<sup>th</sup>, 1901.

6-180

Claimants Address: Bisbee, Cochise County, Arizona, Territory.

# PRELIMINARY OATHS OF ASSISTANTS IN SURVEY OF MINING CLAIM.

We, R. C. Prentiss and J. O. Kelly, do solemnly swear that we will well and faithfully execute the duties of chain carriers; that we will level the chain upon even and uneven ground and plumb the tally-pins, either by sticking or dropping the same; that we will report the true distance to all notable objects, and the true length of all lines that we assist in measuring, to the best of our skill and ability, and in accordance with instructions given us, in the survey of the Mining Claim of Bisbee East Co. and Indian Co. known as the

West Bisbee No. 15-Bisbee No. 14-Bisbee No. 13, known as the Indian

situate in Warren mining district, Cochise County, Arizona Territory, in Section 23, Township No. 33, Range No. 31 E (unsurveyed) of the Salto & Salt River B.M.

X R. C. Prentiss, Chainman.  
X J. O. Kelly, Chainman.

Subscribed and sworn to by the above-named persons before me this 15th day of September, 1894.

S. K. Williams  
NOTARY PUBLIC  
COCHISE COUNTY, ARIZONA TERR.  
MY COMMISSION EXPIRES NOV. 30 1904

I, \_\_\_\_\_, do solemnly swear that I will well and truly perform the duties of axeman, in the establishment of corners and other duties, according to instructions given me and to the best of my skill and ability, in the survey of the Mining Claim of \_\_\_\_\_

known as the \_\_\_\_\_, more fully described in the preceding affidavit.

\_\_\_\_\_, Axeman.

Subscribed and sworn to by the said \_\_\_\_\_ before me this \_\_\_\_\_ day of \_\_\_\_\_, 18 \_\_\_\_\_.

I, \_\_\_\_\_, do solemnly swear that I will well and truly perform the duties of flagman, in the establishment of corners and other duties, according to instructions given me and to the best of my skill and ability, in the survey of the Mining Claim of \_\_\_\_\_

known as the \_\_\_\_\_, more fully described in the preceding affidavit.

\_\_\_\_\_, Flagman.

Subscribed and sworn to by the said \_\_\_\_\_ before me this \_\_\_\_\_ day of \_\_\_\_\_, 18 \_\_\_\_\_.

## ORPHAN BOY LODE

No. 1606

FEET

3

- Beginning at cor. No. 1, the S.E. cor. identical with location and with cor. No. 1 <sup>W.</sup>Bisbee ~~West~~ No. 14 of this survey,  
 A pine post 4 ft. long, 4 ins. sq. set 1 ft. in the ground in a mound of stones & scribed 1-1606-O.B.L.  
 Whence junction of wagon roads bears N 67° 17' W 370 ft. and a rock in place 2 ft. sq. & level with the surface, chiseled x-1-1606-B.R. bears N 72° 28' W 215.8 ft., & U.S.M.M. No. 3 bears S 68° 35' E 4853.4 ft.  
 Thence N 35° 10' E
- 101.00 To S.W. & N.W. cors. Sunny Slope & Contact Lodes No. 1605  
 300.00 Same bearing to E end center identical with location, A pine post 4 ft. long, 4 ins. sq. set in a mound of stones & scribed 1606-O.B.L.  
 401.00 Same bearing to W end center Sunny Slope Lode No. 1605  
 411.00 Same bearing to wagon road running N.E. & S.W.  
 600.00 Same bearing to cor. No. 2, the W.E. cor. identical with location & with the S.E. cor. unsurveyed Orphan Boy No. 2,  
 A pine post 4 ft. long, 4 ins. sq. set 1 ft. in the ground in a mound of stones & scribed 2-1606-O.B.L.  
 Whence the N.W. cor. Sunny Slope Lode No. 1605 bears N 35° 10' E 101 ft. & a rock in place 4x2.7x5.1 ft. chiseled x-2-1606-B.R. bears S 56° 19' W 116.1 ft. & U.S.M.M. No. 3 bears S 61° 32' E 4747 ft.  
 Thence N 54° 51' W
- 750.00 To N side center, a mound of stones identical with location,  
 1500.00 Same bearing to cor. No. 3, identical with location & with S.W. cor. unsurveyed Orphan Boy No. 2, & with S.E. cor. Saddle No. 1 & with cor. No. 2 <sup>W.</sup>Bisbee ~~West~~ No. 1 of this group  
 A pine post 4 ft. long, 4 ins. sq. set in a mound of stones over a cross (x) CHISELED IN BED ROCK & scribed 3-1606-O.B.L., whence an outcrop 8 ft. high & 15 ft. long & chiseled on top x-3-1606-B.R. bears S 48° 50' E 82 ft.  
 Thence S 35° 10' W
- 300.00 To W end center, identical with location & with E end center <sup>W.</sup>Bisbee ~~West~~ No. 1 of this survey,  
 A pine post 4 ft. long, 4 ins. sq. set in a mound of stones & scribed 1606-O.B.L.  
 600.00 Same bearing to cor. No. 4, the S.W. cor. identical with location & with cors. No. 1 of the <sup>W.</sup>Bisbee ~~West~~ No. 1 & <sup>W.</sup>Bisbee ~~West~~ No. 13, & cor. No. 4 <sup>W.</sup>Bisbee ~~West~~ No. 14, claims of this survey,  
 A pine post & scribed 4-1606-O.B.L.

(cont.)

FEET

- Thence S 54°51'E
- 750.00 To S side center, identical with location & with N side center <sup>N</sup> Bisbee ~~West~~ No.14 of this survey, a mound of stones identical with location.
- 1250.00 Same bearing to center of road running N.E.& S.W.
- 1500.00 Same bearing to cor.No.1, the place of beginning.

## ----- --LEDGE-----

The presumable course of the mineral bearing ledge on this claim, as nearly as can be determined from present development work is from W end center of location S 54°51'E 1500ft.

West BISBEE ~~West~~ No. 15 LODE

FEET

No. 1606

Beginning at cor. No. 1, the N.E. cor. identical with location and with cor. No. 2 <sup>W.</sup> Bisbee ~~West~~ No. 14, claim of this survey,

A pine post 4 ft. long, 4 ins. sq. set 1 ft. in the ground in a mound of stones and scribed 1-1606- No. 15

Thence a rock in place 1.2x1.9x2.3 ft. chiseled x-1-1606 B.R. bears S 60°20'E 103.1 ft. & U.S.M.M. No. 3 bears S 75°14'E 5030 ft.

Thence S 55°10'W

100.00 To W end center Loyalty Lode No. 1605

300.00 Same bearing to E end center, identical with location,

A pine post 4 ft. long, 4 ins. sq. set in a mound of stones and scribed 1606 - No. 15

385.00 Same bearing to center of road running N.E. & S.W.

499.00 Same bearing to S.W. & N.W. corners Loyalty & Thordenshall Lodes No. 1605

600.00 Same bearing to cor. No. 2, the S.E. cor. identical with location & with N.E. cor. unsurveyed Rose Lode,

A pine post 4 ft. long, 4 ins. sq. set 1 ft. in the ground in a mound of stones & scribed 2-1606-No. 15

Thence a rock in place level with the surface, & chiseled x-2-1606-B.R. bears N 65°48'W 98.7 ft.

Thence N 54°51'W

750.00 To S. side center, a mound of stones identical with location.

1500.00 Same bearing to cor. No. 3, identical with location & with cor. No. 2 <sup>W.</sup> Bisbee ~~West~~ No. 16 of this group & with N.W. & N.E. cors. of the unsurveyed Rose & Augusta Lodes

A pine post 4 ft. long, 4 ins. sq. set 1 ft. in the ground in a mound of stones & scribed 3-1606-No. 15.

Thence a rock in place 3 ft. high 3x4 ft. chiseled on top x-3-1606-B.R. bears N 34°49'E 76.5 ft.

Thence N 55°10'E

300.00 To W end center, identical with location & with E end center <sup>W.</sup> Bisbee ~~West~~ No. 16 of this group,

A pine post 4 ft. long, 4 ins. sq. set in a mound of stones & scribed 1606-No. 15

600.00 Same bearing to cor. No. 4, identical with location & with cors. No. 1, 2 & 3, respectively of <sup>W.</sup> Bisbee ~~West~~ No. 16,

<sup>W.</sup> Bisbee ~~West~~ No. 13 & <sup>W.</sup> Bisbee ~~West~~ No. 14, claims of this survey,

A pine post & scribed 4-1606-No. 15.

(cont.)

EIGHT

Thence S 54°51'E	
750.00	To N side center, a round of stones identical with location & with S. side center of Bisbee <del>West</del> No. 14 of this survey,
1405.00	Same bearing to center of road running N.E. & S.W.
1500.00	Same bearing to cor. No. 1, the place of beginning.

-----LEDGE-----

The presumable course of the mineral bearing vein on this claim, as nearly as can be determined from the present development, is from W end center of location S 54°51'E 1500 ft.

FEET

No.1606

	Beginning at cor.No.1,the N.E.cor.identical with location & with cors.No.1 <sup>W.</sup> Bisbee <del>West</del> No.1, No.4 <sup>W.</sup> Bisbee <del>West</del> No.14 & No.4 Orphan Boy, Claims of this survey, A pine post 4 ft.long,4 ins.sq.set 1 ft.in the ground in a mound of stones & scribed 1-1606-No.13 Whence a rock in place 2.5x2.5x2.9 ft.chiseled x-1-1606-B.R. bears N 65°15'W 87.3ft & U.S.M.M.No.5 bears S 65°21'E 6320 FT.± Thence S 35°10'W
290.00	To center of road running N.W.& S.E.
300.00	Same bearing to E. end center identical with location & with W. end center <sup>W.</sup> Bisbee <del>West</del> No.14,a claim of this survey, A pine post &c scribed 1606-No.15
600.00	Same bearing to cor.No.2,the S.E.cor.identical with location & with corners No.1 <sup>W.</sup> Bisbee <del>West</del> No.13, No.3 <sup>W.</sup> Bisbee <del>West</del> No.14, No.4 <sup>W.</sup> Bisbee <del>West</del> No.15, claims of this survey, A pine post 4 ft.long,4 ins.sq.set 1 ft.in the ground & scribed 2-1606-No.13 Thence N 57°9'45"W
570.00	To center of road running N.E.& S.W,
750.00	Same bearing to S side center ,a mound of stones identical with location & with N side center <sup>W.</sup> Bisbee <del>West</del> No.16,of this survey.
1500.00	Same bearing to cor.No.5,the S.W.cor.identical with location & with cor.No.4 <sup>W.</sup> Bisbee <del>West</del> No.16 of this group & with the S.E.& N.E. corners unsurveyed Bisbee <del>West</del> No.6 & Bisbee <del>West</del> No.10 Lodes, A pine post &c, scribed 3-1606-No.13 Thence N 35°10'E
300.00	To W end center identical with location & with E end center unsurveyed <sup>W.</sup> Bisbee <del>West</del> No.6 claim. A pine post 4 ft.long 4 ins.sq.set in a mound of stones & scribed 1606 NO.13



(cont.)

FEET

- 600.00 Same bearing to cor. No. 4, the N. W. cor. identical with location, & with cor. No. 4<sup>Y</sup> Bisbee ~~West~~ No. 1 of this survey & with N. E. & S. E. cors. <sup>Y</sup> Bisbee ~~West~~ No. 6 & <sup>Y</sup> Bisbee West No. 2, unsurveyed claims,  
 A pine post 4 ft. long, 4 ins. sq. set 1 ft. in the ground in a mound of stones & scribed 4-1606-No. 13  
 Thence a rock in place level with the surface chiseled x-4-1606-B.R. bears N 53° 16' E 57.5 ft.  
 Thence S 57° 2' 45" E
- 750.00 To W side center, a mound of stones identical with location & with S side center <sup>Y</sup> Bisbee ~~West~~ No. 1 of this group
- 1500.00 Same bearing to cor. No. 1, the place of beginning.

-----LEDGE-----

The presumable course of the mineral bearing vein on this claim as nearly as can be determined from the present development, is from the W end center of location, S 57° 2' 45" E 1500 feet.

West BISBEE WEST No.1 LODE

No. 1606

FEET

	<p>Beginning at cor.No.1,the S.E.cor.identical with location &amp; with cors.No.1 <sup>W</sup> Bisbee <del>West</del> No.13, No.4 <sup>W</sup> Bisbee West No.14, No.4 Orphan Boy, Claims of this survey,  A pine post &amp;c scribed 1-1606-No.1.  Whence a rock in place 2.5x2.5x2.9 ft.chiseled x-1-1606-B.R. bears N 65°15'W 87.3 ft.&amp; U.S.M.M.No.5 bears S 65°21'E 6320 ft.</p> <p style="text-align: center;">Thence N 55°10'E</p>
300.00	<p>To E end center, identical with location &amp; with W end center Orphan Boy Lode of this group,  A pine post &amp;c scribed 1606-No.1</p>
600.00	<p>Same bearing to cor.No.2,the N.E.cor.identical with location &amp; with cor.No.3 Orphan Boy Lode of this survey &amp; with SW &amp; SE cors. of the unsurveyed Orphan Boy No.2 &amp; Saddle No.1 Lodes.  A pine post &amp; c scribed 2-1606-No.1</p> <p style="text-align: center;">Thence N 57°0'45"W</p>
750.00	<p>To N side center, a mound of stones identical with location,</p>
1500.00	<p>Same bearing to cor.No.5,the NW cor.identical with location &amp; with S.W.,S.E.,&amp; N.E.cors.respectively of the unsurveyed Saddle No.1, Saddle No.2, &amp; <sup>W</sup> Bisbee <del>West</del> No.2 Claims,  A pine post 4 ft.long, 4 ins.sq.set 1 ft.in the ground in a mound of stones &amp; scribed 3-1606-No.1  Whence a rock in place 2.5x2.5x2.8 ft.chiseled x-3-1606-B.R. bears S 42°25'W 45.8 ft.</p> <p style="text-align: center;">Thence S 55°10'W</p>
500.00	<p>To W end center identical with location &amp; with E end center unsurveyed <sup>W</sup> Bisbee <del>West</del> No.2  A pine post 4 ft.long 4 ins.sq.set in a mound of stones &amp; scribed 1606-No.1</p>
600.00	<p>Same bearing to cor.No.4,the S.W.cor.identical with location &amp; with cor No.4 <sup>W</sup> Bisbee West No.15 of this group &amp; with S.E.&amp; N.E. corners of <sup>W</sup> Bisbee <del>West</del> No.2 &amp; <sup>W</sup> Bisbee <del>West</del> No.6, unsurveyed claims,  A pine post &amp;c scribed 4-1606-No.1.</p>

*West* BISBEE ~~WEST~~ No. 1 LODE No. 1606  
(cont.)

FEET

	Thence S 57° 9' 45" E
750.00	To S side center, a mound of stones identical with location & with N side center <sup>W</sup> <del>West</del> Bisbee <del>West</del> No. 13 of this group,
1500.00	Same bearing to cor. No. 1, the place of beginning.

-----LEDGE-----

The presumable course of the mineral bearing vein on this claim, as nearly as can be determined from the present development, is from the E end center of location N 57° 9' 45" W, 1500 feet.

*West* BISBEE ~~WEST~~ NO 16 LODE  
No. 1606

FEET

- Beginning at cor. No. 1, the N.E. cor. identical with location and with cors. No. 2, 3 & 4 respectively of <sup>W</sup> Bisbee ~~West~~ No. 13, <sup>W</sup> Bisbee ~~West~~ No. 14 & <sup>W</sup> Bisbee ~~West~~ No. 15, claims of this survey,  
A pine post 4 ft. long, 4 ins. sq. set 1 ft. in the ground in a mound of stones & scribed 1-1606 -No. 16  
Thence a rock in place 1.8x2.8x 3.1 ft chiseled x-1-1606 -B.R. bears S  $30^{\circ}58'17''$  W 76.4 ft. & U.S.M.M. No. 3 bears S  $70^{\circ}35'30''$  E 6456.4 ft  
Thence S.  $35^{\circ}10'17''$
- 300.00 To E end center, identical with location & with W end center <sup>W</sup> Bisbee ~~West~~ No. 15 of this survey,  
A pine post &c scribed 1606-No. 16
- 600.00 Same bearing to cor. No. 2, the S.E. cor. identical with location & with cor No. 3 <sup>W</sup> Bisbee ~~West~~ No. 15 & with N.E. & N.W. cors. unsurveyed Augusta & Rose Lodes,  
A pine post &c scribed 2-1606-No. 16  
Thence N  $57^{\circ}9'45''$  W
- 750.00 To S. side center, a mound of stones identical with location  
1500.00 Same bearing to cor. No. 3, the S.W. cor. identical with location and with N.W. cor. unsurveyed Augusta Lode & with S.E. & N.E. cors. of the unsurveyed claims, <sup>W</sup> Bisbee ~~West~~ No. 10 & <sup>W</sup> Bisbee ~~West~~ No. 5,  
A pine post 4 ft. long, 4 ins. sq. set 1 ft. in the ground in a mound of stones & scribed 3-1606-No. 16  
Thence a limestone outcrop, course N.E. & S.W. 4 ft. high & 5 ft. thick chiseled on top x-3-1606-B.R. bears S  $53^{\circ}31'11''$  E 36.5 ft.  
Thence N  $35^{\circ}10'11''$  E
- 300.00 To W end center, identical with location & with E end center <sup>W</sup> Bisbee ~~West~~ No. 10,  
A pine post 4 ft. long, 4 ins. sq. set in a mound of stones & scribed 1606-No. 16
- 600.00 Same bearing to cor. No. 4, the N.W. cor. identical with location and with cor. No. 3 <sup>W</sup> Bisbee ~~West~~ No. 13 of this group & with the S.E. & N.E. cors. of the <sup>W</sup> Bisbee ~~West~~ No. 6 & <sup>W</sup> Bisbee ~~West~~ No. 10, unsurveyed lodes,  
A pine post 4 ft. long, 4 ins. sq set 1 ft. in the ground in a mound of stones & scribed 4-1606-No. 16  
Thence a stump 6 ft. high & 14 ins. in diameter scribed x-4- 1606-B.S. bears N  $40^{\circ}23'11''$  E 117.2 ft.

BISBEE WEST NO 16 LODE  
(cont.)

FEET

	Thence S. 57° 01' 45" E
750.00	To N side center identical with location marked by a mound of stones, & identical with S side center <sup>Y</sup> Bisbee <sub>A</sub>
	West No 13,
930.00	Same bearing to center of road running N.E. & S.W.
1500.00	Same bearing to cor. No. 1, the place of beginning.

-----LEDGE-----

The presumable course of the mineral bearing ledge on this claim as nearly as can be determined from development work done & outcrop of vein, is, from W end center of location S 57° 01' 45" E 1500 feet.

FEET

No. 1606

- Beginning with cor.No.1,the N.E.cor.identical with location and with cor.No.1 Orphan Boy Lode of this group, whence U.S.M. No.5 bears S 68°35'E 4953.4 ft.  
A pine post &c scribed 1-1606-No.14
- Thence S 35°10'W
- 199.00 To W end center Contact Lode No.1605,
- 300.00 Same bearing to E end center,identical with location,  
A pine post 4 ft.Long,4 ins.sq.set in a mound of stones & scribed 1606-No.14
- 400.00 Same bearing to S.W.cor.Contact & N.W.cor.Loyalty Lodes No.1605
- 500.00 Same bearing to cor.No.2,the S.E.cor.identical with location and with cor.No.1 <sup>W.</sup> Bisbee ~~West~~ No.15 of this group,  
A pine post &c,scribed 2-1606-No.14
- Thence N 54°51'W
- 95.00 to center of road running N.E.& S.W.
- 750.00 Same bearing to S side center a mound of stones identical with location & with N side center <sup>W.</sup> Bisbee ~~West~~ No.15 of this survey
- 1500.00 same bearing to cor.No.3,the S.W.cor.identical with location & with cors.No.1,2 & 4 respectively of <sup>W.</sup> Bisbee ~~West~~ No.16  
<sup>W.</sup> Bisbee ~~West~~ No.13, & <sup>W.</sup> Bisbee ~~West~~ No.15,claims of this survey  
A pine post &c scribed 3-1606-No.14
- Thence N 35°10'E
- 300.00 to W end center identical with location & with E end center <sup>W.</sup> Bisbee West No.13,of this group  
A pine post 4 ft.long,4 ins.sq.set in a mound of stones & scribed 1606-No.14
- 510.00 Same bearing to center road running S.E.& N.W.
- 600.00 Same bearing to cor.No.4,identical with location and with corners No.1 <sup>W.</sup> Bisbee ~~West~~ No.1 & <sup>W.</sup> Bisbee West No.13 & cor.No.4 Orphan Boy,claims of this group,  
A pine post &c scribed 4-1606-No.14
- Thence S 54°51'E
- 750.00 To N side center,a mound of stones identical with location & with S side center Orphan Boy Lode of this group.
- 1500.00 Same bearing to cor.No.1,the place of beginning.

-----LEDGE-----

The presumable course of the mineral bearing vein on this claim as nearly as can be determined from present development and outcrop,is from W end center of location,S 54°51'E 1500 feet.

AREAS

Total & Net Area	<del>W.</del> Bisbee West No.14 Lode	20.661 Acres
" " "	<del>W.</del> Bisbee West No.15 "	20.661 "
" " "	<del>W.</del> Bisbee West No.13 "	20.644 "
" " "	<del>W.</del> Bisbee West No.16 "	20.644 "
" " "	<del>W.</del> Bisbee West No. 1 "	20.644 "
" " "	Orphan Boy "	20.661 "

*Total are lode Claims 123.915*

IMPROVEMENTS

I certify that the value of the labor & improvements on each claim of this group, placed thereon by the claimants or their grantors is not less than five hundred dollars (\$500.00) <sup>for each location</sup> & that said improvements consist of:-----

~~W.~~ BISBEE ~~WEST~~ No.16-----

		VALUE
No.1	Discovery Shaft 4x6x10 ft. bears from W end center S 57°10'E 300. ft.	3100.00
No.2	Open Cut & Tunnel, course N 74°E , bears from E end center N 73°6'W 495 ft. Open cut 4x10x25 ft. Tunnel 4x6x15ft	300.00
No.3	Shaft 4.5x7 ft. in the clear, 710 ft. deep bears from E end center N 52°7'45"W 599.4 ft, shaft timbered all the way down	Value 315000.00
	Drift 4x7x20 ft. at 200 ft. level, course N 5°10'W	320.00
	" 4x7x340ft. at 300ft. level, course N1°E	5120.00
	" 4x7x50 ft. at 400 ft. level " North	480.00
	" 4x7x200ft. at 600. ft level " N 5°E	3200.00
	" 4x7x4 ft. at 700 ft level " North	50.00

Total value of drifts \$ 9170.00

Shaft No.3 is centrally located with reference to a block of claims, twenty two in number, at present owned by applicants herein, & it is a recognized fact that the valuable mineral in this district tends to form deposits rather than veins, hence it is the universal custom here for the most economical development of mines & the extraction of ore, to work from a shaft more or less centrally located & from which drifts & cross-cuts are driven for the purposes above stated. This method is used by the following named companies.— Copper Queen Con. Mining Co, working about 75 patented claims, the South Bisbee Copper Mining & Townsite Improvement Co. operating about 40 claims, Surveys No. 1392, 1393 & 1394, The Lowell & Arizona Copper Mining Co. working 15 claims survey No. 1410 & others of less importance.

The shaft No.3 tends to develop all the claims owned

IMPROVEMENTS (cont.)

VALUE

by the Bisbee West Copper Mining Co. & its value will be applied to the claims not named in this group & for which application for patent will be made later. The drifts driven from the said Shaft No. 3 & enumerated above are plainly for the development of the claims for which application is herein made, as well as others lying in that direction & for which a four-tenths interest has been reserved. The remaining six-tenths is set aside for the claims of this group.

A 1/10th interest in drifts from shaft No. 3 \$ 917.00  
 Total improvements for <sup>W.</sup> Bisbee ~~West~~ No. 13 \$1317.00

-----ORPHAN BOY-----

No. 1 Discovery shaft 4x6x10 ft. bears from E end center N 54°51'W 600 ft. 100.00  
 No. 2 Shaft 4x6x10 ft. same bearing from same point 300 ft. 100.00  
 A 1/10th interest in drifts from shaft No. 3 <sup>W.</sup> Bisbee ~~West~~ No. 13 Lode 917.00  
 Total improvements for Orphan Boy Lode \$1117.00

-----<sup>W.</sup>BISBEE ~~WEST~~ No. 14-----

No. 1 Discovery Shaft 4x6x10 ft. bears from E end center N 54°48'W 600 ft. 100.00  
 A 1/10th interest in drifts from Shaft No. 3 <sup>W.</sup> Bisbee ~~West~~ No. 13 Lode 917.00  
 Total Improvements for <sup>W.</sup> Bisbee ~~West~~ No. 14 Lode \$1017.00

-----<sup>W.</sup>BISBEE ~~WEST~~ No. 15-----

No. 1 Discovery Shaft 4x6x10 ft. bears from E end center N 54°51'W 600 ft. 100.00  
 A 1/10th interest in drifts from shaft No. 3 <sup>W.</sup> Bisbee ~~West~~ No. 13 Lode 917.00  
 Total Improvements for <sup>W.</sup> Bisbee ~~West~~ No. 15 Lode \$1017.00

-----<sup>W.</sup>BISBEE ~~WEST~~ No. 13-----

No. 1 Discovery shaft 4x6x10 ft. bears from W end center S 57°11'E 300 ft. 100.0  
 No. 2 Tunnel 4x6x10 ft. course N 70°E bears from same point S 69°35'E 1003 ft. 100.0  
 No. 3 Tunnel 4x6x10 ft. course N 70°45'E bears from same point S 68°E 1029 ft. 100.0  
 No. 4 Tunnel 4x6x10 ft. course N 88°E bears from same point S 58°15'E 1098 ft. 100.0  
 A 1/10th interest in drifts from shaft No. 3 <sup>W.</sup> Bisbee ~~West~~ No. 13 Lode, 917.0  
 Total Improvements <sup>W.</sup> Bisbee ~~West~~ No. 13 Lode \$1317.0



IMPROVEMENTS (cont.)

----- <del>W.</del> BISBEE <del>WEST</del> No. 1 -----		VALUE
No. 1	Discovery shaft 4x3x10ft. bears from W end center S 57° 31' E 301 ft.	\$ 100.00
No. 2	Shaft 4x3x50 ft. bears from E end center N 78° 46' W 679ft	600.00
	A 1/10th interest in drifts from shaft No. 3 <sup>W.</sup> Bisbee <sub>A</sub>	
	<del>West</del> No. 16 Lode	917.00
	Total improvements <sup>W.</sup> Bisbee <del>West</del> No. 1 Lode	\$1617.00
	Total improvements on group	\$7400.00

----- OTHER IMPROVEMENTS -----

----- ~~W.~~ BISBEE ~~WEST~~ No. 13 -----

From E end center,  
 SE cor. Bunk House 20x50 ft. facing N 54° E, bears N 32° 11' W 440 ft.  
 House 25x50ft. facing N 20° E, NE cor. bears N 52° 6' W 284ft.  
 House 15x20 ft. facing S 15° W, center bears N 32° 11' W 120 ft.  
 House 20x30 ft. facing N 70° W, NW cor. bears N 79° W 218 ft.  
 House 12x12 ft. facing S 60° E, NW cor. bears N 74° 38' W 375ft.

<sup>W.</sup> Bisbee ~~West~~ No. 16: Shaft House 55x60 ft. facing South SE cor. bears from E end center N 47° 22' W 560 ft.

All the above improvements were placed on these claims by the owners thereof or their grantors.

----- ADJOINING CLAIMS -----

These claims are bounded or touched on the NORTH

Orphan Boy No. 2 *(unsurveyed)*  
 Saddle No. 2 Fred Hedberg, Owner  
 Saddle No. 1

EAST

Sunny Slope  
 Contact (Survey No. 1805)  
 Loyalty Peter Johnson, Owner.  
 Thordenshall

SOUTH

Rose  
 Augusta Owned by applicants herein  
<sup>W.</sup> Bisbee ~~West~~ No. 5 *(unsurveyed)*

WEST

<sup>W.</sup> Bisbee West No. 5  
<sup>W.</sup> Bisbee West No. 10 Owned by applicants herein  
<sup>W.</sup> Bisbee West No. 6 *(unsurveyed)*  
<sup>W.</sup> Bisbee West No. 2

-----LOCATION-----

This claim is located about 2 miles in a southerly direction from Bisbee, in the Warren Mining District, Cochise County, Arizona Territory, on unsurveyed lands approximately in Township No. 25 South, Range No. 24 East, Gila & Salt River Base & Meridian.

-----INSTRUMENT-----

The Survey was made with a Gurley Light Mountain Transit. All courses were deflected from the true meridian as determined by direct solar observations, checked by an observation on Polaris.

All distances were measured with a 300 ft. steel tape.

Magnetic Variation      11°52'E

Geo. C. Clark

U.S. Deputy Mineral Surveyor.

Bisbee, Cochise Co. Arizona.

October 24, 1901.

# POOR QUALITY

**The following pages are scanned at the best possible quality setting. The original pages are of poor quality and this is the best possible reproduction.**

# FINAL OATHS FOR SURVEYS.

## LIST OF NAMES.

A list of the names of the individuals employed by Geo. C. Clark

United States Deputy Mineral Surveyor, to assist in running, measuring, and marking the lines corners and boundaries described in the foregoing field notes of the survey of the mining claim

of The Bisbee West Copper Mining Co. known as Bisbee ~~No. 13~~

~~No. 14~~ known as the ~~Bisbee ~~No. 13~~~~ ~~Bisbee ~~No. 13~~~~ ~~Bisbee ~~No. 13~~~~ ~~Bisbee ~~No. 13~~~~ ~~No. 1 & Orphan Bay~~

and showing the respective capacities in which they acted.

R. C. Prentiss, Chairman.  
J. O. Kelly, Chairman.  
\_\_\_\_\_, Assn.  
\_\_\_\_\_, Flagman.

## FINAL OATHS OF ASSISTANTS.

We, R. C. Prentiss

and J. O. Kelly, do solemnly swear that we assisted

Geo. C. Clark, United States Deputy Mineral Surveyor, in marking the corners and

surveying the boundaries of the mining claim of The Bisbee West Copper Mining Co.

~~known as Bisbee ~~No. 13~~~~ ~~Bisbee ~~No. 13~~~~ ~~Bisbee ~~No. 13~~~~ ~~Bisbee ~~No. 13~~~~ ~~Bisbee ~~No. 13~~~~  
~~No. 13-Bisbee ~~No. 13~~~~ ~~No. 1 and Orphan Bay~~, known as the

\_\_\_\_\_, represented in the foregoing field notes as having been surveyed by said deputy mineral surveyor and under his direction; and that said survey has been in all respects, to the best of our knowledge and belief, faithfully and correctly executed, and the corner and boundary monuments established according to law and the instructions furnished by the United States Surveyor-General for Arizona Territory.

R. C. Prentiss, Chairman.  
J. O. Kelly, Chairman.  
\_\_\_\_\_, Assn.  
\_\_\_\_\_, Flagman.

Subscribed and sworn to by the above-named persons before me

this 24th day of October 1901, 1

S. K. Williams

NOTARY PUBLIC  
COCHISE COUNTY, ARIZONA TERR.  
MY COMMISSION EXPIRES NOV 28 1901

FINAL OATH OF U. S. DEPUTY MINERAL SURVEYOR

I, Geo. C. Clark, U. S. Deputy Mineral Surveyor, do solemnly swear that, in pursuance of instructions received from the United States Surveyor General for Arizona, dated October 5th. 1901, I have, in strict conformity to the laws of the United States, the official regulations and instructions thereunder, and the instructions of said Surveyor General, faithfully and correctly executed the survey of the Mining Claim of The Bisbee West Canon Mining Co. Known as Bisbee West No. 15-<sup>W.</sup> Bisbee West No. 14-<sup>W.</sup> Bisbee West No. 15-<sup>W.</sup> Bisbee West No. 16, known as the West Bisbee West No. 1 and Orphan Bay. situate in Warren Mining District, Cochise County, Arizona Territory, in Section 1 approximately Township No. 23 S., Range No. 24 E. (unrecovered) T110 S. R. 234. and designated as Survey No. 1303, as represented in the foregoing field notes, which accurately show the boundaries of said mining claim as distinctly marked by monuments on the ground, and described in the attached copy of the location certificate, which was received by me from the Surveyor General with said instructions, and that all the corners of said survey have been established and perpetuated in strict accordance with the law, official regulations and instructions thereunder; and I do further solemnly swear that the foregoing are the true and original field notes of said survey and my report therein, and that the labor expended and improvements made upon said mining claim by claimant or his grantors are as therein fully stated, and that the character, extent, location and itemized value thereof are specified therein with particularity and full detail, and that no portion of said labor or improvements so credited to this claim has been included in the estimate of expenditures upon any other claim.

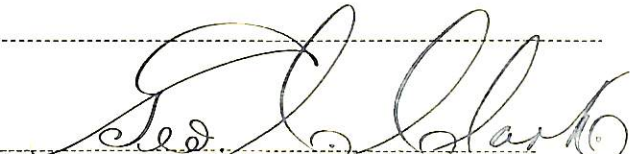
  
 U. S. Deputy Mineral Surveyor.

Subscribed and sworn to by the said Geo. C. Clark  
 U. S. Deputy Mineral Surveyor, before me  
In my Office this 2th.  
 day of October 1901

  
 NOTARY PUBLIC  
 COCHISE COUNTY, ARIZONA TERR.  
 MY COMMISSION EXPIRES NOV. 29 1904

Affidavit of Five Hundred Dollars Improvements.

We, R. O. Prentiss, and J. O. Kelly

of lawful age, being first duly sworn according to law, depose and say: That we are acquainted with the ... mining claims, situate in ... Mining District, ... County, Arizona Territory, for which ...

have made application for survey prior to application for patent under the provisions of the Act of Congress, approved May 10, 1872; and that the labor done and improvements made thereon by the applicants and their grantor exceed Five Hundred Dollars in value, and further, that we are not personally interested in said mine.

R. O. Prentiss
J. O. Kelly

TERRITORY OF ARIZONA,
County of ... ss:

Sworn to and subscribed before me, this 24th.

day of October, 1901.

J. N. Williams
Notary Public
my commission expires
Nov. 30, 1904.

761

AMENDED NOTICE OF LOCATION.

21

Notice is hereby given that the West Bisbee No 1 lode  
 and mining claim has been located by Bisbee West Copper Mining  
 a Corporation on the 24<sup>th</sup> March day of 1900 being 1500 Fifteen hundred feet in  
 length Six hundred feet wide, that is (300) Three hundred  
 feet on each side of the center of the claim, lode and discovery shaft,  
 lengthwise of the claim and the general course of the lode and claim is  
 $N54^{\circ}39'W$  and  $S54^{\circ}39'E$  and the ground claimed  
 is described as follows, to-wit:

Commencing at the Northward center side of the claim at a Monument  
 $4" \times 2"$  post set in a monument of stone on which this notice is  
 posted, and running thence Northward  $N54^{\circ}39'W$  750 feet  
 to a  $4" \times 4"$  post set in a monument of stone being  
 the Northwest corner of the claim; thence in Southward  $S35^{\circ}21'W$  300 feet  
to west end Center 600 feet to a monument a  $4" \times 4"$  post  
 being the Southwest corner of the claim; thence in Southward  $S54^{\circ}39'E$   
750 feet to South side Center 1500 feet to a monument a  $4" \times 4"$  post  
 being the South East corner of the claim; thence in Northward  $N35^{\circ}21'E$   
300 feet to East end Center 600 feet to a monument a  $4" \times 4"$  post  
 being the North East corner of the claim and thence in Northward  $N54^{\circ}39'W$   
750 feet to North side Center the place of beginning.

This claim is situated in the Warren Mining District Cochise  
 County, Territory of Arizona, and is bounded on the East by the "Orphan  
 Boy" lode. On the South by the West Bisbee No 13 lode and on  
 the West by the "West Bisbee No 2" lode.

This is an Amended Location Notice of the West Bisbee No 1  
 Mining Claim located by F. L. Dwight and A. K. Waddell  
 on the 17<sup>th</sup> June 1899 day of 1900 and recorded in Book 17 of Records of Mines  
 at page 136 in the office of the County Recorder of the aforesaid  
 County of Cochise to which reference is hereby made, and this Amended  
 Location Notice is made and posted to correct errors in the description  
 in the said original Location Notice.

Posted on the ground this 15<sup>th</sup> day of June 1900.

Nancy Henderson  
 Secretary

Bisbee West Copper Mining Company  
A. S. Robbins Pres

Filed and recorded at request of F. L. Dwight June 28th A. D. 1900, at P. M.

Territory of Arizona, )  
 ) SS.  
 County of Cochise. )

I Frank Hare County Recorder in and for  
 said county, do hereby Certify the foregoing, amended location  
 notice of the West Bisbee No. / , recorded Book 15 page 119-20,  
 Record of Mines, situated in the Warren Mining District, Cochise  
 county, Arizona Territory; is a full, true and correct copy as the  
 same appears of record in my said office .

Witness my hand and official seal, this 17th day of September,

A D 1901 .

*Frank Hare*

County Recorder .



*Orphan Bay*

AMENDED NOTICE OF LOCATION

Notice is hereby given that the *Orphan Bay* lode and mining claim has been located by *Bisbee West Copper Mining Company* a Corporation *24<sup>th</sup> March* on the *24<sup>th</sup> March* day of *1900* being *1500 Fifteen hundred* feet in length and *600 Six hundred* feet wide, that is *300 Three hundred* feet on each side of the center of the claim, lode and discovery shaft lengthwise of the claim and the general course of the lode and claim is *N54° 39' W* and *S54° 39' E* and the ground

claimed is described as follows, to-wit;

Commencing at the *Northwesterly* center ~~side~~ <sup>end</sup> of the claim at a ~~monument~~ *Monument a 2" X 4" post set in mound of stones* on which this notice is posted, and running thence ~~in a~~ *N54° 39' W 750 feet* to a *4" X 4" Pine post set in a mound of stones* direction ~~feet to a monument~~ being the *Northwest* corner of the claim; thence ~~in~~ *S35° 21' W 300 feet* to ~~West~~ *West* ~~Center~~ *Center 600* feet to a monument *a 4" by post* being the *Southwest* corner of the claim; thence ~~in a~~ *S54° 39' E* *750 feet* to ~~South~~ *South* ~~S Center~~ *Center 1500* feet to a monument *a 4" X 4" post* being the *South East* corner of the claim; thence ~~in~~ *N35° 21' E* *300 feet* to ~~E end~~ *E end* ~~Center~~ *Center 600* feet to a monument *a 4" X 4" post* being the *North East* corner of the claim and thence ~~in~~ *N54° 39' W* *750 feet* to ~~West~~ *West* ~~side~~ *side* ~~Center~~ *Center* the place of beginning. This claim is situated in the *Warren* Mining District

*Cochise* County, Territory of Arizona, and is bounded on the South by *West Bisbee No 14* lode and on the West by *West Bisbee No 1* Mining Claim

This is an Amended Location Notice of the *Orphan Bay* Mining Claim located by *A. L. Luterich and Fred Hedberg* on the *15<sup>th</sup> April 1899* day of ~~1900~~ and recorded in Book *17* of Records of Mines at page *11* in the office of the County Recorder of the aforesaid *Cochise* County of ~~to~~ which reference is hereby made, and this Amended Location Notice is made and posted to correct errors in the description in the said original Location Notice.

Posted on the ground this *15<sup>th</sup>* day of *June* 1900.

*Harry Shindman*

*Bisbee West Copper Mining Co*  
*A. S. Robbins Pres*

Territory of Arizona, )  
County of Cochise. ) SS.

24

I, Frank Hare County Recorder in and for  
said County, do hereby certify that the foregoing, Amended  
location notice of "Orphan Boy" mining claim, recorded in book  
15 page 142, situated in the Warren Mining District, Cochise  
County, Arizona territory; is a full, true and correct copy as  
the same appears of record in my said office.

Witness my hand and official, seal this 17th day of September  
A. D. 1901.

*Frank Hare*

County Recorder.

AMENDED NOTICE OF LOCATION.

Notice is hereby given that the Met Bisher No 13 lode  
 and mining claim has been located by Bisbee Met Copper Mining Company  
a Corporation on the 24<sup>th</sup> day of March 1900, being 1500 Fifteen hundred feet in length,  
 and 600 Six hundred feet wide; that is 300 Three hundred  
 feet on each side of the center of the claim, lode and discovery shaft,  
 lengthwise of the claim, and the general course of the lode and claim  
 is N54° 39' W and S54° 39' E and the ground claimed is described  
 as follows, to-wit;

Commencing at the Northwesterly center side of the claim at a monument  
 a 2" x 4" post set in a mound of stones on which this notice is posted, and  
 running thence in a N54° 39' W 750 ft direction to a 4" x 4" post set in a  
mound of stones feet to a monument being the  
North West corner of the claim; thence in a S35° 21' W 300 feet  
to N End Center direction 600 feet, to a monument a 4" x 4" post being  
being the South West corner of the claim; thence in a S54° 39' E 750 ft  
to South End Center direction 1500 feet to a monument a 4" x 4" post being the  
South East corner of the claim; thence in a N35° 21' E 300 feet to  
E End Center 600 feet to a monument a 4" x 4" post  
 being the North East corner of the claim, and thence in a N54° 39' W  
750 feet to North side Center direction feet to the place of beginning.

This claim is situated in the Maricopa Mining District..  
Cochise County, Territory of Arizona, and It is bounded north by  
Met Bisher No 1 Mining Claim on the East by Met Bisher No 14 Mining Claim  
On the South by Met Bisher No 16 Mining Claim On the West by  
Met Bisher No 6 Mining Claim

This is an Amended Location Notice of the Met Bisher No 13  
 Mining Claim, located by F. L. Dwight and A. K. Maddrell on the  
 day of 17<sup>th</sup> 1899., and recorded in Book 17 of Records of Mines at page 141  
 in the office of the county Recorder of the aforesaid County of Cochise  
 to which reference is hereby made and this Amended Location Notice is made  
 and posted to correct errors in the description in the said original  
 Location Notice.

Posted on the ground this 15<sup>th</sup> day of June 1900.

Bisbee Met Copper Mining Company  
A. D. Robbins Pres

Territory of Arizona, )  
 ) :SS.  
 County of Cochise. )

I Frank Hare County Recorder in and for  
 said County, do hereby Certify the foregoing, amended location  
 notice of the "West Bisbee Co. /<sup>3</sup>, recorded Book 15 page 133, -<sup>4</sup>  
 Record of Mines, situated in the Warren Mining District, Cochise  
 county, Arizona Territory; is a full, true and correct copy as the  
 same appears of record in my said office.

Witness my hand and official seal, this 17th day of September,  
 A D 1901 .

*Frank Hare*

County Recorder .

No 16.

AMENDED NOTICE OF LOCATION.

Notice is hereby given that the Mat Bisbee No 16 lode

and mining claim has been located by Bisbee West Copper Mining Company

A Corporation on the 24<sup>th</sup> day of March 1900 being (1500) Fifteen hundred feet in

length and (600) Six hundred feet wide, that is 300 Three hundred

feet on each side of the center of the claim, lode and discovery shaft,

lengthwise of the claim and the general course of the lode and claim is

N54° 39' N ..... and S54° 39' E ..... and the ground claimed is

described as follows; to-wit;

Commencing at the Rockery ..... center side of the claim

Monument ~~to~~ a 2" X 4" post set in mound of stone ..... on which this notice is posted.

and running thence N54° 39' N 750 feet to a 4" X 4" post set in a

mound of stone ..... being

Northwest the ..... corner of the claim; thence S 35° 21' W 300 feet to

W End Center 600 feet to a monument a 4" sq post

being the Southwest corner of the claim; thence S 54° 39' E

750 feet to South Side Center 1500 feet to a monument a 4" X 4" post

being the South East corner of the claim; thence N 35° 21' E

300 feet to East End Center 600 feet to a monument a 4" X 4" post

being the North East corner of the claim and thence N 54° 39' W

750 feet to N Side Center ..... the place of beginning.

This claim is situated in the Maricopa Mining District Cochise

County, Territory of Arizona, and ..... It is bounded on the north by the Mat Bisbee

No 13 lode, on the East by West Bisbee No 15 lode, on the

South by "Ross" lode & on the West by Mat Bisbee No 10 lode

This is an Amended Location Notice of the Mat Bisbee No 16

Mining Claim located by F. J. Swright and A. K. Maddrell

on the 17<sup>th</sup> day of June 1899 and recorded in Book 17 of Records of Mines

at page 133 in the office of the County Recorder of the aforesaid

County of Cochise to which reference is hereby made, and this Amended

Location Notice is made and posted to correct errors in the description

in the said original Location Notice.

Posted on the ground this 15 day of June 1900.

Harry Shudman

Bisbee West Copper Mining Company  
A. S. Robbins Pres

Territory of Arizona, )  
 :SS.  
 County of Cochise. )

I, Frank here County Recorder in and for  
 said County do hereby certify that the foregoing, Amended location  
 notice of the "West Bisbee 10. <sup>1</sup>/<sub>6</sub> mining claim, located in the  
 Warren Mining District, recorded in Book 15 pages <sup>57-8</sup>, Record of  
 Mines, Cochise county, Arizona Territory; is a full, true and correct  
 copy as the same appears of record in my said office .  
 Witness my hand and official seal, this 17th day of September  
 A. D. 1901 .

*Frank here*  
 County Recorder .

AMENDED NOTICE OF LOCATION.

Notice is hereby given that the West Bisbee No 15 lode and mining claim has been located by Bisbee West Copper Mining Company a Corporation on the 24<sup>th</sup> day of March 1900 being (1000) Fifteen hundred feet in length, and (600) Six hundred feet wide, that is 300 feet on each side of the center of the claim lode and discovery shaft, lengthwise of the claim, and the general course of the lode and claim is North 54° 39' W and S 54° 39' E and the ground claimed is described as follows, to-wit;

Commencing at the Northwesterly ~~center~~ side of the claim at a monument of a 2"x4" post set in a mound of stone on which this notice is posted, and running thence ~~in a N 54° 39' W~~ 750 ft to a 4"x4" ~~Sq~~ Sq post set in a mound of stone ~~feet to a monument~~ being the North West corner of the claim; thence ~~in a S 35° 21' W~~ 300 ft to West End Center ~~direction~~ 600 feet, to a monument a 4" Sq post being the South West corner of the claim; thence ~~in a S 54° 39' E~~ 750 feet to South Side Center ~~direction~~ 1700 feet to a monument a 4" Sq post being the South East corner of the claim; thence ~~in a N 35° 21' E~~ 300 ft to East End Center ~~direction~~ 600 feet to a monument a 4" Sq post being the North East corner of the claim, and thence ~~in a N 54° 39' W~~ 750 ft to North Side Center ~~direction~~ 750 feet to the place of beginning.

This claim is situated in the Narran Mining District Cochise County, Territory of Arizona, ~~and~~ This claim is bounded on the

North by West Bisbee No 14, Bound partly on the East by the "White" Claim, On the South by the Agusta lode and on the West by West Bisbee No 16 lode

This is an Amended Location Notice of the West Bisbee No 15 Mining Claim, located by F L Swig W and A K Waddell on the 17 day of June 1899 and recorded in Book 17 of Records of Mines at page 142 in the office of the County Recorder of the aforesaid County of Cochise to which reference is hereby made, and this Amended Location Notice is made and posted to correct errors in the description in the said original Location Notice. Posted on the ground this 15 day of June 1900.

Harry Stewart

Bisbee West Copper Mining Company  
A S Robbins Pres

Territory of Arizona, )  
 ) :SS.  
 County of Cochise. )

I, Frank here County Recorder in and for  
 said County do hereby certify that the foregoing, Amended location  
 notice of the "West Bisbee No. 75" mining claim, located in the  
 Warren Mining District, recorded in Book 15 page 36, Record of  
 Mines, Cochise county, Arizona Territory; is a full, true and correct  
 copy as the same appears of record in my said office .

Witness my hand and official seal, this 17th day of September

A D .1901 .

*Frank here*

County Recorder .



AMENDED NOTICE OF LOCATION.

Notice is hereby given that the West Bisbee No 14 lode and mining claim has been located by Bisbee West Copper Mining Company a Corporation on the 24<sup>th</sup> day of March 1900, being (1500) Fifteen hundred feet in length, and (600) Six hundred feet wide: that is, (300) Three hundred feet on each side of the center of the claim, lode and discovery

shaft, lengthwise of the claim, and the general course of the lode and claim is N54° 39' W and S54° 39' E and the ground claimed is described as follows, to-wit:

Commencing at the North East center side of the claim at a monument of a 2" X 4" post set in North East side of Mount of Stone on which this notice is posted, and running thence N54° 39' W 750 feet to a 4" X 4" pine post set in a Mount of Stone direction North West feet to a monument being the North West End Center corner of the claim: thence in a S35° 21' W 300 ft to North West End Center direction 600 feet, to a monument a 4" Sq. pine post being the South West corner of the claim: thence in a S54° 39' E 750 ft to S Side Center direction 1500 feet to a monument a 4" X 4" post being the South East corner of the claim; thence in a N35° 21' E 300 ft to East End Center direction 600 feet to a monument a 4" post being the North East corner of the claim, and thence in a N54° 39' W 750 feet to Side Center direction feet to the place of beginning.

This claim is situated in the Marion Mining District Cochise County, Territory of Arizona, and is bounded on the north by Orphan Boy Lode On the South by West Bisbee No 14 lode On the West by West Bisbee No 13 lode

This is an Amended Location Notice of the West Bisbee No 14 Mining Claim, located by F. L. Dwight F. L. Dwight & A. K. Wadsworth on the 17<sup>th</sup> day of June 1899, and recorded in Book 17 of Records of Mines at page 138, in the office of the county Recorder of the aforesaid County of Cochise to which reference is hereby made, and this Amended Location Notice is made and posted to correct errors in the description in the said original Location Notice.

Posted on the ground this 15<sup>th</sup> day of June 1900, A. S. Robbins

Territory of Arizona, )  
  :SS.  
County of Cochise.      )

I Frank Hare County Recorder in and for  
said County, do hereby Certify the foregoing, amended location  
notice of the "West Bisbee Co. / 2", recorded Book 15 page 135,  
Record of Mines, situated in the Warren Mining District, Cochise  
county, Arizona Territory; is a full, true and correct copy as the  
same appears of record in my said office.

Witness my hand and official seal, this 17th day of September,  
A. D. 1901.

*Frank Hare*  
County Recorder.

(4-687.)

# Surveyor General's Certificate of Approval of Field Notes and Survey of Mining Claim.

Department of the Interior,

Office of U. S. Surveyor General,

Tucson, Arizona

January 18<sup>th</sup>, 1902.

I, U. S. Surveyor General for the district of Arizona, do hereby certify that the foregoing and hereto attached Field Notes and Return of the Survey of the Mining Claim of the Bisbee West Copper Mining Company, known as the West Bisbee No. 13, West Bisbee No. 14, West Bisbee No. 10, West Bisbee No. 16, West Bisbee No. 1 and Orphan Boy lode claims, situate in the Warren mining district, Cochise County, Arizona, Territory, approximately in Township No. 23, Range No. 24 E. (unsurveyed) of the Gila and Salt River Base and Meridian, Arizona, designated as Survey No. 1606, executed by Geo. C. Clark, U. S. Deputy Mineral Surveyor, October 17<sup>th</sup> to 24<sup>th</sup>, 1901, under my instructions dated October 5<sup>th</sup>, 1901, have been critically examined and the necessary corrections and explanations made, and the said Field Notes and Return, and the Survey they describe, are hereby approved. A true copy of the copy of the location certificate filed by the applicant for survey is included in the field notes.

Mugh H. Rice

U. S. Surveyor General for Arizona Territory

# BISBEE WEST 1606

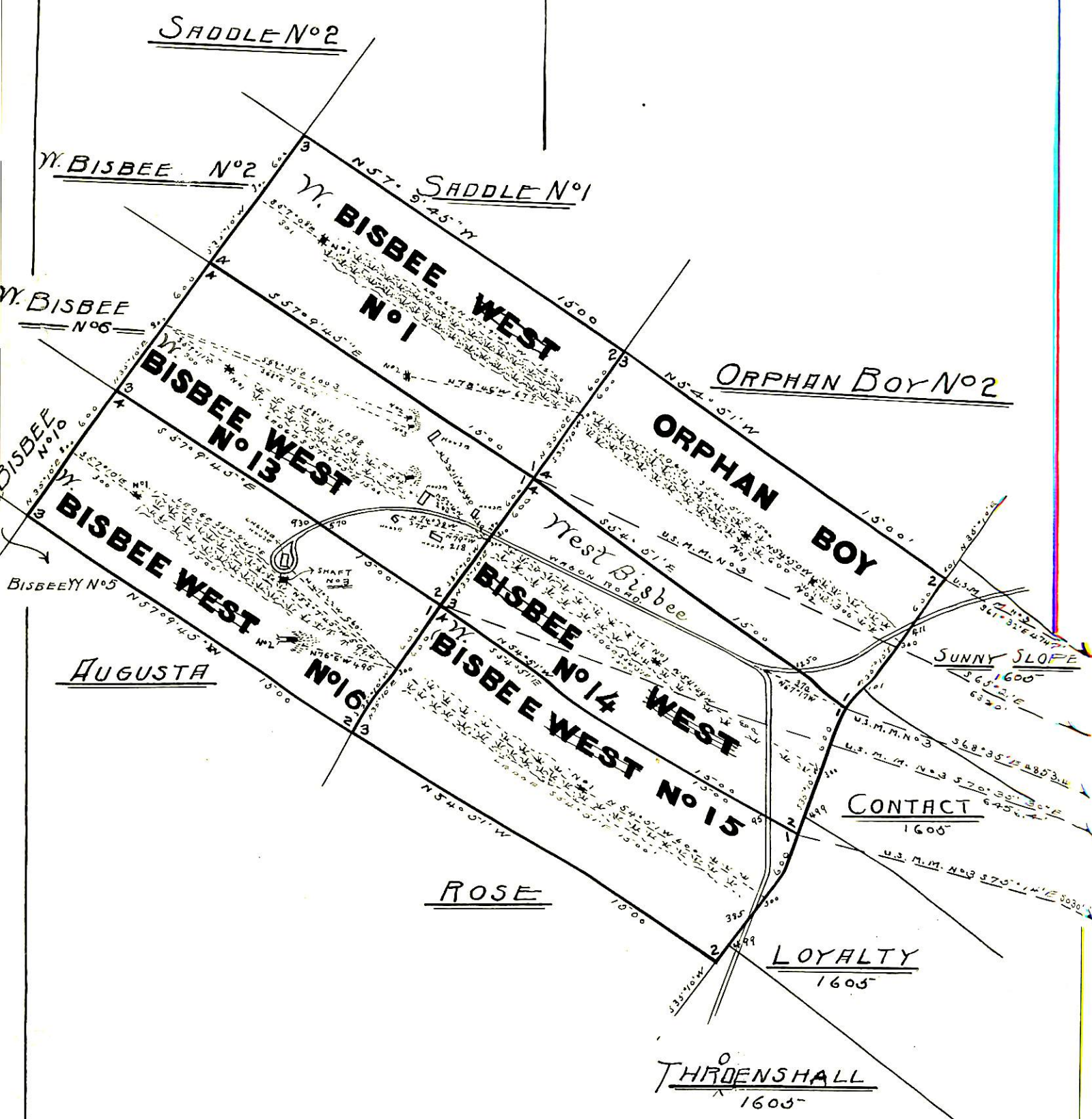
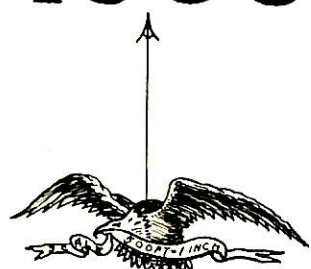

*Geo. C. Clark*  
U.S. Deputy Mineral Surveyor.