

MS.

0

1

6

3

5

*Recd. March 1st, 1902
Printed 1902*

Name made on Taylor's

(4-683.)

Mineral Survey No. 1635

Lot No. _____

Prescott

Land District.

FIELD NOTES

OF THE SURVEY OF THE MINING CLAIM OF

John J. Hawkins, Sarah Foran
and Henry Stoddard

KNOWN AS THE

Columbus

Big Bay

Mining District,

Yavapai County, Arizona

Section Approx Township 13 North, Range 1 East.

Surveyed under instructions dated Feb 1st, 1902

by J. J. Furber

U. S. Deputy Mineral Surveyor.

Claim located December 12th, 1892

Survey commenced March 12th, 1902

Survey completed " 12, 1902

o 6-100

Address,

John J. Hawkins,

Prescott,

Arizona

PRELIMINARY OATHS OF ASSISTANTS IN SURVEY OF MINING CLAIM.

WE, E. H. Draper and H. H. Larue,

do solemnly swear that we will well and faithfully execute the duties of chain carriers; that we will level the chain upon even and uneven ground and plumb the tally-pins, either by sticking or dropping the same; that we will report the true distance to all notable objects, and the true length of all lines that we assist in measuring, to the best of our skill and ability, and in accordance with instructions given us, in the survey of

the Mining Claim of John J. Hawkins, Sarah Doran,
and Henry E. Toddard, known as the
Columbus

situate in Big Bay mining district,

Yavapai County, Arizona,

in Section Approx., Township No. 13-N, Range No. 1-E.

E. H. Draper, Chainman.

H. H. La Rue, Chainman.

Subscribed and sworn to by the above-named persons before

me this 12 day of March, 1902
9 4

J. J. Fisher
Notary Public

I, H. H. Larue, do solemnly swear that I will well and

truly perform the duties of axeman, in the establishment of corners and other duties, according to instructions given me and to the best of my skill and ability, in the survey

of the Mining Claim of John J. Hawkins, Sarah Doran,
and Henry E. Toddard,

known as the Columbus,

more fully described in the preceding affidavit.

H. H. La Rue, Axeman.

Subscribed and sworn to by the said H. H. La Rue

before me this 12th day of
March, 1902
9 4

J. J. Fisher
Notary Public

I, E. H. Draper, do solemnly swear that I will

well and truly perform the duties of flagman, in the establishment of corners and other duties, according to instructions given me and to the best of my skill and ability, in the

survey of the Mining Claim of John J. Hawkins, Sarah Doran,
and Henry E. Toddard,

known as the Columbus,

more fully described in the preceding affidavit.

E. H. Draper, Flagman.

Subscribed and sworn to by the said E. H. Draper

before me this 12th day of
March, 1902
9 4

J. J. Fisher
Notary Public

SURVEY NO.1635.

Columbus Lode.

Feet

Beginning at cor. No.1, the n.w. cor. of claim, identical with cor. of location, which is also cor. No. 5 of the Jim Crow lode, Survey No.1265.

A porphyry stone 8 x 15 x 36 ins. set 1 ft. in ground surrounded by mon. of stones. Stone marked C No.1-1635. Same stone marked J.C.No.5-1265.

A X on a porphyry rock in place marked B.R.C.No.1-1635 brs. S. 14° E. 41.1 ft.

A X on a porphyry rock in place marked B.R.C.No.1-1635, brs. S. 55° 15' E. 22.7 ft.

U.S.M.M.No.1 B.V.D. brs.N.38° 52' E. 7079.5 ft.

Thence S.38° 47'W.

Var.14° E.

653.9

To cor.No.2 which is also cor.No.4 Jim Crow Lode, Survey No.1265, and cor.No.4 McCabe Lode Survey No.1158 Identical with cor. of location.

A porphyry stone 5 x 10 x 18 ins.. set 1 ft. in ground alongside a mon. of stones 3 x 3 ft. Stone marked C No.2-1635.

A X on a porphyry rock in place, marked B.R.C.No.2-1635 brs.S.3° 15'E. 79.5 ft.

Thence S. 45° 9' E.

Var.14° E.

188

To cor.No.3. Location cor. destroyed.

A granite stone 8 x 10 x 30 ins. set 1 ft in ground surrounded by mon. of stones. Stone marked C No.3-1635.

A X on a porphyry rock in place marked B.R.C.No.3-1635. Brs.S.6° 45'E. 43.8 ft.

SURVEY NO.1635.

Feet

A X on a porphyry rock in place marked B.R.C.No.3-1635, brs. S.73° 35'E. 58.1 ft.

Thence N.50° 46' E.

Var.14° E.

650.6

To, cor.No 4, identical with cor.of location.

A porphyry stone 6 x 12 x 24 ins. set 1 ft. in ground and surrounded by mon. of stones. Stone marked C No. 4-1635.

A X on a porphyry rock in place marked B.R.C.No.4-1635 brs.N.27° 17' E. 41.7 ft.

A X on a porphyry rock in place marked B.R.C.No.4-1635, brs.N.31° 38' W. 49.9 ft.

Thence N.45° 9' W.

Var.14° E.

205

To N.C.E. and vein.

A porphyry stone 10 x 10 x 24 ins. set 1 ft. in the ground and surrounded by mon. of stones. Stone marked N.C.E.C.No.1635.

321

To Cor.No.1, the place of beginning survey of exterior boundaries.

* * *

AREA.

Area Columbus Lode 3.754 Acres

* * *

LOCATION.

This claim is located approximately in Tp.13 N.R.1 S. in Big Bug Mining District, Yavapai County, Arizona Territory, and is bounded on the N.by the Jim Crow Lode Survey No.1265; on the E. by government land, and the McCabe Extension Company's ground; on the west and south by the McCabe, Survey No.1158, and the McCabe Extension,

SURVEY NO.1635.

VEIN

The Columbus vein extends 375 ft. in a N.E. direction, and 275 ft. in a S.W. direction from the discovery shaft.

* * *

EXPENDITURE OF FIVE HUNDRED DOLLARS.

I certify that the value of the labor and improvements upon this claim, placed thereon by the claimants and their grantors, is not less than five hundred dollars and that said improvements consist of:

Discovery Shaft No.1; which hrs. from cor.No.1 S. 30° 45' W. 387 ft. Shaft 4 x 6 ft. 30 ft. deep.

Value \$300.00

Shaft No. 2, which hrs. from cor.No.1 S.5° 45' E. 175 ft. Shaft 4 x 6 ft. 25 ft. deep. At bottom of shaft level run S. 4 x 6 ft. 12 ft. long and N.E. 4 x 6 ft. 13 ft. long.

Value \$500.00

* * *

INSTRUMENT.

This survey was made with a Gurley Light Mountain Solar Transit. The courses were deflected from the true meridian as determined by direct solar observation. The distances were measured with a 75 ft. steel tape.

Prescott, Arizona,

March 13, 1902.

J. J. Fisher
U.S. Dep. Min. Surveyor.

FINAL OATHS FOR SURVEYS.

LIST OF NAMES.

A list of the names of the individuals employed by J. J. Fisher
 United States Deputy Mineral Surveyor, to assist in running, measuring, and marking the lines
 corners and boundaries described in the foregoing field notes of the survey of the mining claim
 of John J. Hawkins, Sarah Poran, & Henry Stoddard
 known as the Columbus
 and showing the respective capacities in which they acted.

- E. H. Draper , Chainman.
- H. H. Larue , Chainman.
- H. H. Larue , Axman.
- E. H. Draper , Flagman.

FINAL OATHS OF ASSISTANTS.

We, E. H. Draper
 and H. H. Larue , do solemnly swear that we assisted J. J. Fisher
Fisher , United States Deputy Mineral Surveyor, in marking the corners and
 surveying the boundaries of the mining claim of John J. Hawkins,
Sarah Poran and Henry Stoddard,
 known as the Columbus , represented
 in the foregoing field notes as having been surveyed by said deputy mineral surveyor and under
 his direction; and that said survey has been in all respects, to the best of our knowledge and
 belief, faithfully and correctly executed, and the corner and boundary monuments established
 according to law and the instructions furnished by the United States Surveyor-General for
Oregon

- E. H. Draper , Chainman.
- H. H. La Rue , Chainman.
- H. H. La Rue , Axman .
- E. H. Draper , Flagman.

9 ~~7~~ Subscribed and sworn to by the above-named persons before me
 this 12th day of March , 1902

J. J. Fisher
 Notary Public

FINAL OATH OF U. S. DEPUTY MINERAL SURVEYOR

I, J. J. Fisher, U. S. Deputy Mineral Surveyor, do solemnly swear that, in pursuance of instructions received from the United States Surveyor General for Arizona, dated Feb. 1-1902, I have, in strict conformity to the laws of the United States, the official regulations and instructions thereunder, and the instructions of said Surveyor General, faithfully and correctly executed the survey of the Mining Claim of John J. Hawkins, Sarah Foran and Henry Stoddard, known as the Columbus, situate in Big Bay Mining District, Yavapai County, Arizona, in Section 24, Township No. 13 N., Range No. 1 East and designated as Survey No. 1635, as represented in the foregoing field notes, which accurately show the boundaries of said mining claim as distinctly marked by monuments on the ground, and described in the attached copy of the location certificate, which was received by me from the Surveyor General with said instructions, and that all the corners of said survey have been established and perpetuated in strict accordance with the law, official regulations and instructions thereunder; and I do further solemnly swear that the foregoing are the true and original field notes of said survey and my report therein, and that the labor expended and improvements made upon said mining claim by claimant or theirs grantors are as therein fully stated, and that the character, extent, location and itemized value thereof are specified therein with particularity and full detail, and that no portion of said labor or improvements so credited to this claim has been included in the estimate of expenditures upon any other claim.

J. J. Fisher
U. S. Deputy Mineral Surveyor.

Subscribed and sworn to by the said J. J. Fisher
U. S. Deputy Mineral Surveyor, before me a Notary Public in and for Yavapai County Arizona Territory this 13th
day of March 1902.

Thomas C. Job
Notary Public.

Thomas C. Job. My Commission Expires July 7, 1903.

Affidavit of Five Hundred Dollars Improvements.

We, E. H. Draper, and W. H. Lane

of lawful age, being first duly sworn according to law, depose and say: that we are acquainted with the Columbus mining claim, situate in Big Bay Mining district, Yavapai County, Arizona Territory, for which John J. Hawkins, Sarah Poran, and Henry Stoddard have made application for survey prior to application for patent under the provisions of the Act of Congress, approved May 10, 1872; and that the labor done and improvements made thereon by the applicants and their grantors exceed Five Hundred Dollars in value, and further that we are not personally interested in said mine.

E. H. Draper
W. H. Lane

TERRITORY OF ARIZONA,
County of Yavapai } ss:

Sworn to and subscribed before me, this 12th day of March, 1892

J. J. Feihu
Notary Public

COLUMBUS.

NOTICE OF LOCATION.

Know all men by these presents, That we the undersigned, have this day located 700 feet seven hundred feet of this vein or lode, bearing precious metals, with all dips, spurs, angles and variations, with surface ground 300 three hundred feet on each side of vein, with all mineral deposits contained therein, and all timber and water thereon or appurtenant thereto, according to the provisions of the United States Mining Laws:

The exterior boundaries are as follows

Commencing at monument of stone on west boundary line a distant 300 feet in a westerly direction from discovery monument thence in a northerly direction parallel with the ledge 350 three hundred fifty feet to monument at N.W. corner; thence in an easterly direction at right angle, across the ledge 300 six hundred feet to monument at N.E. corner; thence in a southerly direction parallel with the ledge 700 seven hundred feet to monument at S.E. corner; thence at right angles across the ledge in a westerly direction 300 six hundred feet to monument at S.W. corner; thence in a northerly direction parallel with the ledge 350 three hundred fifty feet to monument on the west boundary and place of beginning.

This claim is in Big Bug Mining District Yavapai County, Arizona, and may be more generally described as situated it lies between the Henry Clay and Jim Crow mining claims and joins on the sink to rise mine and five (500) hundred feet north east of Frank McCabe house and shall be known as the (COLUMBUS) Mining Claim, dated on the ground this (12) twelve day of December 1892.

Locator,
Sam Foran.

Frank McCabe.

Henry Lang.

Witness: J. Heidelebaugh.

Recorded at request of J.D. Sellers Feby 7th A.D. 1893 at 9:15 o'clock a.m. in Book 35 of Mines, pages 527 & 528, Records of Yavapai County, Arizona.

(U.S.) Alex O. Brodie,
County Recorder.

by E.E. Kirkland,
Deputy.

TERRITORY OF ARIZONA,)
: ss:
COUNTY OF YAVAPAI.)

I, P.J. FARLEY, County Recorder in and for the County of Yavapai, in the Territory of Arizona, and custodian of the records thereof, do hereby certify that I have compared the above and foregoing with, and the same is a full, true and correct copy of the notice of location of the "COLUMBUS" mining claim, as the same appears of record in Book 35 of Mines, pages 527 and 528, records of Yavapai County, Arizona.

IN WITNESS WHEREOF, I have hereunto set my hand and affixed my Official Seal, this 25th day of January 1903.

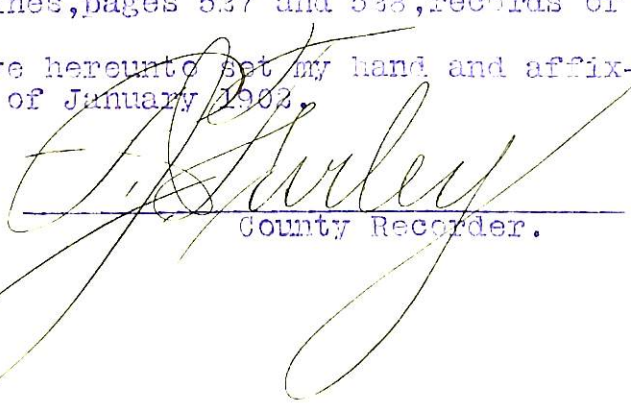

County Recorder.

(4-687.)

Surveyor General's Certificate of Approval of Field Notes and Survey of Mining Claim.

Department of the Interior,

Office of U. S. Surveyor General,

Phoenix, Arizona

May 8 - , 1902

I, U. S. Surveyor General for *the District of Arizona*,
do hereby certify that the foregoing and hereto attached Field Notes and Return of the
Survey of the Mining Claim of *John J. Hawkins, Sarah Fran*
and Henry Stoddard
....., known as the
Columbus
.....
situate in *Big Bug* mining district,
Yavapai County, *Arizona*
.....
in Section *Approx*, Township No. *13-N*, Range No. *1 East*
....., designated as Survey No. *1635-*
executed by *J. J. Fisher*....., U. S. Deputy Mineral
Surveyor, *March 12-to 12-*....., 1902, under my instructions dated
Feb. 1st....., 1902, have been critically examined and the
necessary corrections and explanations made, and the said Field Notes and Return, and
the Survey they describe, are hereby approved. A true copy of the copy of the location
certificate filed by the applicant for survey is included in the field notes.

Hugh H. Price

U. S. Surveyor General for *Arizona*.....

Survey No 1635
Prescott Land District

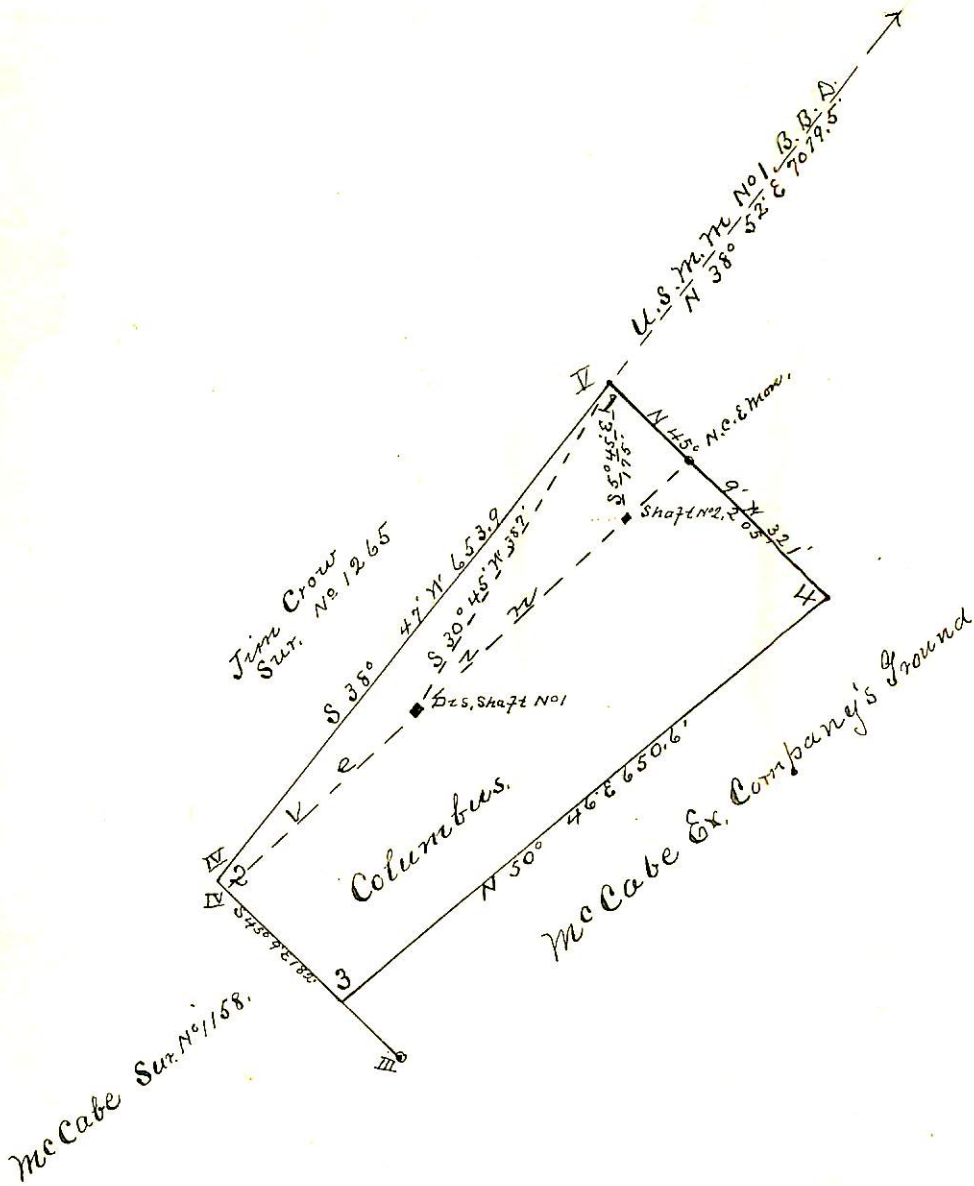

Surveyed March 12-'09
by J. J. Fisher
U.S. S. M. S.