

**M
S
-**

0

1

7

3

5

R 5/14/03

C

(4-683.)

Mineral Survey No. 1735.

Lot No.

GILA LAND DIST. Land District.

FIELD NOTES

OF THE SURVEY OF THE MINING CLAIM OF Shannon Copper Company,

KNOWN AS THE

Hector, Trinidad No. 4 and Carter Lode Claims.

Copper Mountain or Greenlee Gold Mountain Mining District,

Graham County, Arizona.

Approximate

Section s 29-30, Township 3 S., Range 29 East.

Surveyed under instructions dated Dec. 3, 1902,

by Lorenzo D. Chillson, U. S. Deputy Mineral Surveyor.

Claim located See Location Notices, 1

Survey commenced Jan, 2nd, 1903

Survey completed Jan, 13th, 1903

o 6-100

Address of claimant,

H. S. Anderson, Attorney,

Clifton, Arizona.

PRELIMINARY OATHS OF ASSISTANTS IN SURVEY OF MINING CLAIM.

WE, C. Arandes and Bruno Duran, do solemnly swear that we will well and faithfully execute the duties of chain carriers; that we will level the chain upon even and uneven ground and plumb the tally-pins, either by sticking or dropping the same; that we will report the true distance to all notable objects, and the true length of all lines that we assist in measuring, to the best of our skill and ability, and in accordance with instructions given us, in the survey of the Mining Claim of the Shannon Copper

Company known as the Hectar, Trinidad No. 4 and Carter situate in Greenlee Gold Mountain mining district Graham County, approximately in Section, Township No. 3 S., Range No. 2 E. T.

Witness his mark [Signature] Chainman. [Signature] Chainman.

Subscribed and sworn to by the above-named persons before me this 2nd day of January, 1903.

J. D. Chilson - Notary Public My Commission expires Feb. 24th 1906

I, Jose M. Perez, do solemnly swear that I will well and truly perform the duties of axman, in the establishment of corners and other duties, according to instructions given me and to the best of my skill and ability, in the survey of the Mining Claim of the Shannon Copper Company

known as the Hectar, Trinidad No. 4 and Carter more fully described in the preceding affidavit.

[Signature] Axman.

Subscribed and sworn to by the said Jose M. Perez before me this 2nd day of January, 1903.

J. D. Chilson - Notary Public My Commission expires Feb. 24th 1906

I, Jose M. Perez, do solemnly swear that I will well and truly perform the duties of flagman, in the establishment of corners and other duties, according to instructions given me and to the best of my skill and ability, in the survey of the Mining Claim of the Shannon Copper Company

known as the Hectar, Trinidad No. 4 and Carter more fully described in the preceding affidavit.

[Signature] Flagman.

Subscribed and sworn to by the said Jose M. Perez before me this 2nd day of January, 1903.

J. D. Chilson - Notary Public My Commission expires Feb. 24th 1906

3
MINERAL SURVEY NO. 1745.

Trinidad No. 4.

Beginning at the N. W. Cor.

Set a 4 x 4 inch pine post, 4 ft. long, 20 ins., in the ground, scribed T. 1, 1735, and raised a mound of stone ~~alongside~~ ^{around post}, Whence, Cor. 4 of the Trinidad No. ~~4~~ ⁵, Brs. N72 10 W. 383. *ff*

U. S. M. M. No. 2, bears N. 37° 20' W., 1064.9 ft.

No other bearings available.

Thence S. 72° 10' E.

Along the South Side Line of the Trinidad No. 5, Sur. No. 1751.

300. A post and mound of stone at the N. E. C. of the Claim.
600. To Cor. No. 2,

Set a 4 x 4 inch pine post, 4 ft. long 20 ins., in the ground, scribed T. 2=1735, Whence,

A live oak tree 8 ins., in diam. bears S. 85° 33' E., 9 ft. dist., scribed T. 2=1735 B. T., and raised a mound of stone around Cor.

No other bearings available.

Thence S. 17° 50' W.

Along the East Side Line of this Claim.

1500. To Cor. No. 3,

Identical with Cor. No. 2 of the Hector Claim of this survey, Set a 4 x 4 inch pine post, 4 ft. long, 20 ins., in the ground, scribed T. 3= 1735 and H. 2=1735, and raised a mound of stone ~~alongside~~ ^{around post}.

No bearings available.

Thence N. 72° 10' W.

Along the South End Line of this Claim, and the North End Line of the Hector Claim of this Survey.

300. A post and mound of stone at the S. E. C. of the Claim and the N. E. C. of the Hector Lode Claim.
600. To Cor. No. 4, Identical with Cor. No. 1 of the Hector Claim,

Set a pine post, 4 ft. long 4 x 4 ins. square, set 20 ins., in the ground, post scribed T. 4= and H. 1=1735, and raised a mound of stone ~~alongside~~ ^{around post}.

= 2 =

U. S. M. M. No. 2 bears N. 4° 41' W., 2282.2 ft. Dist.

No other bearings available.

Thence N. 17° 50' E.

Along the West Side Line of this Claim and the East Side Line of the Trinidad No. 3, Unsurveyed Claim.

1500. To Cor. No. 1, and the place of beginning.

Survey of Exterior Boundaries.

Mean Var. at all Cors. 14° 50' E.

The Survey is identical with the Location.

H E C T O R L O D E .

Beginning at Cor. No. 1, the N. W. Cor. of the Claim Cor.

heretofore Described.

U. S. M. M. No. 2 bears N. 4° 41' W., 2282.2 ft. dist.

A Quartzite rock 4 x 2 x 2 ft. brs. N 54 15 W., 16.5 ft. Scr. B. R.

Thence S. 72° 10' E., ~~-~~ & * H-1, 1735. + T. 4. 1735.

Var. 12° 35' E.

300. A post and mound of stones the N. E. C. of this Claim.

600. To Cor. No. 2, Identical with Cor. No. 3 of the Trinidad No. 4 Claim of this Survey.

Set a 4 x 4 inch pine post, 4 ft. long 20 ins. m in the ground, scribed H. 2- 1735, and raised a mound of stones ^{around post} ~~along-~~ ~~side.~~ Whence,

A red quartzite rock, 8 x 8) x 6 ft. scribed with a * & T3-1735 ^{+ H. 2-1735.}
B. R. bears N. 12° 30' W. 14.6 ft. dist.

Thence S. 17 50 W.,

Var. 12 30 E.

Along the East Side Line of this Claim.

1198. N. W. Cor. No. 5 of the Northern Point Patented Claim., Lot No. ^{and cor. No. IV Sig Bond No. 1, Sur. No. 1740} 67, a 4 x 4 inch pine post, marked N. P. M. C. N. V.

= 3 =

1500' To Cor. No 3,

Identical with the S. E. Cor. of the location, Set a 4 x 4 inch pine post, 4 ft. long, 20 ins., in the ground, Scribed H. 3=1735 Whence,

A Sinite rock, marked with a ^X cross and 1682 bears N. 70 W 6 ft. dist.

No other bearings available.

Thence N. 72° 10' W.

Var. 12° 20' E.

Along the South End Line of this Claim.

300. The S. E. C. a post and mound of stones.

600. To Cor. No. 4,

Set a 4 x 4 inch pine post, 4 ft. long 20 ins., in the ground, scribed H. 4-1735, and raised a mound of stone ^{around post} ~~along-~~ ~~side.~~

No bearings available..

Thence N. 17° 50' E.

Var. 12° 20' E.

1500. To Cor. No. 1 and the place of beginning.

Survey of Exterior Boundaries.

The Survey is identical with the location.

C A R T E R C L A I M .

Beginning at Cor. No. 1, the N. E. Cor. of the Claim, identical with Cor. No. 2, of the Trinidad No. 4, a Claim of this Sur.

at S. 72° 10' E., 983 ft. dist. from Cor. No. 1V, of the

Trinidad No. 5, Min. Sur. No. 1751, and on the South Side Line of said Claim.

Post Scribed C. 1=1735, and heretofore described in survey of Trinidad No. 4 Claim of this survey.

U. S. M. M. No. 2 bears N. 49° 44' W. 1594.2 ft. dist.

Thence S. 72° 10' E.

Var. 12° 45' E.

= 4 =

Along the North End line of this claim^a and the S. S. Line of the Trinidad No. 5 Claim of this Survey.

300. To the N. E. C. of the Claim a post and a mound of stones.

332. To Cor. No. 2, on the S. W. End line of the Sharpshooter, Uns. Claim., at S. 24° 30' E., 45 ft. from the N. W. Cor. of that Claim

Set a 4 x 6 inch pine post, 4 ft. long, 20 ins., in the ground, marked C. 2=1735, and raised a mound of stones ^{around post.} ~~along-~~ ~~side.~~ Whence,

An iron capped quartzite rock being an outcropping dike chiseled ^{B.R.} * 2=1735 Cart. bears N. 29° 15' W., 15.6 ft. Dist. No other bearings available.

Thence S. 24° 30' E.

Var. 12° 40' E.

Along the Southwesterly ^{and} ~~Side~~ Line of the Sharpshooter Claim Unsurveyed.

398. To Cor. No. 3, identical with Cor. No. 2 of the Virginia Queen Min. Sur. No. 1731.

Set a 4 x 4 inch pine post, 4 ft. long 20 ins. in the grd. marked 3=1735 and raised a mound of stone 2 ft. base 2 ft. high ^{around post} ~~alongside.~~ No bearings available.

Thence S. 17° 50' W.

Var. 12° 35' E.

Along the East Side line of this Claim and the West Side line of the Virginia Queen Lode Claim Min. Sur. No. 1731.

905. To Cor. No. 4, the S. E. Cor. of this Claim. *identical with cor. II of the Big Bend No. 1, Sur. No. 1740*
Set a pine post, 4 x 4 inches, 4 ft. long 20 ins. in the ground marked C. 4-1735 and raised a mound of stone 2 ft. base ² ft. high ^{around post} ~~alongside.~~

Whence,

A live oak tree, 8 ins., in diam. bears N. 34° 15' W., 29 ft. dist. scribed with a 4 B. T. & C. 4-1735. No other bearings available.

Thence N. 72° 10' W,

Var. 12° 30' E.

Along the South End Line of this Claim.

FEET.

= 5 =

300. A post surrounded by a mound of stones the S. E. C. of this Claim
600. To Cor. No. 5, *identical with Cor. No. 1, Big Bend No. 1, Sur. No. 1740.*

Set a 4 x 4 inch pine post, 4 ft. long, set 20 ins., in the ground, marked C. 5=1735, and raised a mound of stone 2 ft. base $2\frac{1}{2}$ ft. high ^{around post} alongside., Whence

A granite rock 6 x 4 x 4 ft. chiseled ^{B.R.} # 5=1735 C. bears N, 37°45W!, 44.6 ft. dist.

No other bearings available.

Thence N.17° 50' E.

Var. *12°30'* E.

Along the Westerly side line of this claim and the East Side Line of the Trinidad No. 4 Claim of this survey.

1198. To Cor. No. 1, and the place of beginning. Survey of Exterior boundaries.

The survey is identical with the location.

A R E A .

| | |
|---|-------------------------------------|
| Total and Net Area of the Trinidad No. 4, | 20.66 Acs ⁹ |
| Total and Net Area of the Hector, | 20.66 " |
| Total and Net Area of the Carter, | 15.66 12.124 " |
| Net area of Lode Claim, | <hr/> 53.544 36.920 " |

L O C A T I O N .

These Claims are located on Unsurveyed Public Lands of the United States in approximate Secs. 29 and 30, T. 3 S., R. 29 East of the Gila and Salt River Base and Meridian Arizona.

In Greenlee Gold Mt. or Copper Mt. Mining Dist Graham, Arizona

= 6 =

L E D G E S.

The presumed courses of the several ledges throughout these claims as near as can be traced on the ground, is as follows:

Trinidad No. 4, N. 17 50' E. 1398 ft. and S. 17 50' W., 102 ft.

from the Discovery Shaft No. 1. ¹³⁷¹

Hector Claim, N. 17 50' E. ~~129~~ ¹²⁹ ft. and S. 17 50' W. ~~1361~~ ¹²⁶¹, from the Discovery Shaft No. 1.

Carter Claim. N. 17 50 E., 900 ft. & S. 17 50' W., 298 ft. from the Discovery Shaft No. 1.

I M P R O V E M E N T S.

I certify that the value of the labor and improvements upon these claims, placed thereon by the claimants, is not less than Five hundred Dollars and that said improvements consist of, on the

Trinidad No. 4,

No. 1 From the S. E. C., N. 17 50' E., 102 ft. ^{DIS.} a shaft 4 x 6 x 18 ft. deep, cost, \$175.00

No. 2 A shaft 6 x 10 x 65 ft., all timbered in workmanlike manner, with a drift at the bottom extending easterly bears N. 46 30' E., 60ft is for the development and working of the Big Bend No. 1, Claim adjoining on the East, 1/2 of which is to be accredited to the said Big Bend No. 1,

Value, \$1170.00

Credited to this claim, \$585.00

No. 3 A shaft 6 x 8 x 10 ft. bears N. 43° E., 90 ft.

Value, \$120.00

~~No. 4 A shaft 5 x 8 x 10 ft. bears N. 31° 30' E,~~

~~value, \$50.00~~

No. 4 A shaft 6 x 8 x 10 ft. bears N. 31° deg. 3. 415 ft.

Value, \$ 150.00

= 7 =

No. 5 A tunnel 5 ft. wide, 6 1/2 ft. high, running 16 ft., with a shaft 6 x 8 x 20 ft. deep at entrance of said tunnel bears N. 40° E., 487 ft.

Value, \$300.00
Total amount of improvements upon this claim, \$1380.00

Hector Claim,

No. 1 From the S. E. C. of the Claim N. 17° 50' E., 129 ft., a shaft 5 x 6 x 39 ft., DIS.

Value, \$250.00

No. 2 From the N. E. C., a shaft 5 x 6 x 10 ft. brs. S. 41° W., 56 ft.

Value, \$190.00

No. 3 A shaft 4 x 6 x 19 ft., bears S. 40° deg. W., 146 ft.

Value, \$100.00

No. 4 A shaft 5 x 7 x 10 ft., bears S. 68° deg. W., 52 ft.

Value, \$129.00

No. 5 A shaft 5 x 7) x 8 ft. deep bears S. 3° deg. E., 134 ft.

Value, \$75.00

Total value of improvements upon this Claim, \$745.00

Carter Claim.

No. 1 From the S. E. C. of the Claim, N. 17° deg. 50' E., 298 ft. a shaft 4 x 6 x 12 ft., DIS.

Value \$100.00

No. 2 1/2 Half the cost of a tunnel located and fully described on the Virginia Queen Lode Claim Sur. No. 1731, owned by these claimants, Value of 1/2 Interest,

Total value of improvements upon this claim, \$780.00

A D J O I N I N G C L A I M S .

On the North, Trinidad No. 5, Sur. No. 1751, and the Sharp-shooter Unsurveyed.

On the East, the Virginia Queen Sur. No. 1731, and Big Bend No. 1 and Northern Point Lot no 67.

= 8 =

On the South by the Big Bend No. 1, Sur. No. 1740 and unsurvd.
public lands.

On the West by the Keystone, Unsurveyed. and the Trinidad
No. 3 Claim., Unsurveyed.

I N S T R U M E N T.

This survey was executed by a Gurleys Light Mountain
Engineers Transit, the courses were deflected from the true
meridian as determined from direct Solar observations ckecked
on Polaris. The distances were measured with a 50 foot steel
tape.

& *Lorenzo D. Chilson*
U. S. Deputy Mineral Surveyor

Tucson Arizona April 28th 1903.

NOTE. The difference of 29 ft. in measurement, from the Dis.
Shaft No. 1, ^{to the end line,} in this survey, and in the location notice
_{HECTOR.}
is due to errors in the latter.
Also applies to small difference in measuremnt, bet Dis.
and end line of the Trinidad No. 4.

FINAL OATHS FOR SURVEYS.

LIST OF NAMES.

A list of the names of the individuals employed by Francisco D. Chilson
 United States Deputy Mineral Surveyor, to assist in running, measuring, and marking the lines
 corners and boundaries described in the foregoing field notes of the survey of the mining claim
 of The Shannon Copper Company
 known as the Hector, Trinidad No 4 and Carter
 and showing the respective capacities in which they acted.

- Crespino Ananda, Chairman.
- Bruno Duran, Chairman.
- Jose M. Perez, Axman.
- Jose M. Perez, Flagman.

FINAL OATHS OF ASSISTANTS.

We, Crespino Ananda, Bruno Duran
 and Jose M. Perez, do solemnly swear that we assisted Francisco D. Chilson,
 United States Deputy Mineral Surveyor, in marking the corners and
 surveying the boundaries of the mining claim of The Shannon Copper
Company, known as the Hector, Trinidad
No 4 and Carter, represented

in the foregoing field notes as having been surveyed by said deputy mineral surveyor and under
 his direction; and that said survey has been in all respects, to the best of our knowledge and
 belief, faithfully and correctly executed, and the corner and boundary monuments established
 according to law and the instructions furnished by the United States Surveyor-General for
The District of Arizona

Witness his oaths }
Crespino Ananda }
Crespino Ananda, Chairman.
Bruno Duran, Chairman.
Jose M. Perez, Axman.
Jose M. Perez, Flagman.

Subscribed and sworn to by the above-named persons before me
 this 13th day of January, 1903.

F. D. Chilson - Notary Public
My Commission expires Feb. 24th 1906

(4-686.)

FINAL OATH OF U. S. DEPUTY MINERAL SURVEYOR

I, Lorenzo D. Chillson, U. S. Deputy Mineral Surveyor, do solemnly swear that, in pursuance of instructions received from the United States Surveyor General for Arizona, dated Dec. 5, 1902, I have, in strict conformity to the laws of the United States, the official regulations and instructions thereunder, and the instructions of said Surveyor General, faithfully and correctly executed the survey of the Mining Claim of The Shannon Copper Company, known as the Hector, Trinidad No. 4, an XXXXXX Carter, Greenlee Gold or Copper Co. situate in Graham County, Arizona, Mining District, Approx. 29 and 30, Township No. 3 S., Range No. 29 E. Unsd. and designated as Survey No. 1735, as represented in the foregoing field notes, which accurately show the boundaries of said mining claim as distinctly marked by monuments on the ground, and described in the attached copy of the location certificate, which was received by me from the Surveyor General with said instructions, and that all the corners of said survey have been established and perpetuated in strict accordance with the law, official regulations and instructions thereunder; and I do further solemnly swear that the foregoing are the true and original field notes of said survey and my report therein, and that the labor expended and improvements made upon said mining claim by claimant or its grantors are as therein fully stated, and that the character, extent, location and itemized value thereof are specified therein with particularity and full detail, and that no portion of said labor or improvements so credited to this claim has been included in the estimate of expenditures upon any other claim.

Lorenzo D. Chillson
U. S. Deputy Mineral Surveyor.

Subscribed and sworn to by the said Lorenzo D. Chillson
U. S. Deputy Mineral Surveyor, before me A. M. Franklin a
Notary Public this Five
day of May 1903, My Commission Expires Sept. 19, 1906

A. M. Franklin
Notary Public

Affidavit of Five Hundred Dollars Improvements.

we, W. E. Watson, and M. Blumenthal

of lawful age, being first duly sworn according to law, depose and say: That we are acquainted with the Hector, Trinitad No. 1 and Carter mining claims situate in Coculac Gold Mountain Mining district, Chraham County, Arizona Territory, for which The Shannon Copper Company

has made application for survey prior to application for patent under the provisions of the Act of Congress, approved May 10, 1872; and that the labor done and improvements made thereon by the applicant and ^{its} ~~their~~ grantors exceed Five Hundred Dollars in value, and further that we are not personally interested in said mine.

W. E. Watson

M. Blumenthal

TERRITORY OF ARIZONA, }
County of Chraham } ss:

Sworn to and subscribed before me, this 5th

day of January, 1903



J. D. Chilson - Notary Public
My Commission expires Feb. 24th 1906

AMENDED LOCATION NOTICE.

TO ALL WHOM IT MAY CONCERN:

This Mining Claim the name of which is the Hector Mining Claim situated on lands belonging to the United States of America, and in which there are valuable mineral deposits, was entered upon and originally located for the purpose of exploration, by the Arizona Copper Co. a corporation organized under laws of Arizona, (by James Colquhoun its Agent) the undersigned on the 1st day of December 1896, said Arizona Copper Company being the persons who makes and posts this Amended Location Notice.

The length of this claim is 1500 feet and the undersigned claims 1400 feet in a N. $17^{\circ}50'$ E. direction and 100 feet in a S. $17^{\circ}50'$ W. direction from the center of the discovery shaft at which this notice is posted, lengthwise of the claim, and to each of its respective ends, together with 300 feet in width of the surface grounds on each side of the center of the claim. The general course of the lode, deposit and premises is from the South west to the North east.

The claim is situated and located in the Greenlee Gold Mountain Mining District, in Graham County, in the Territory of Arizona, about one mile in a North easterly direction from the town of Metcalf.

The claim is described particularly, and the surface boundaries thereof are marked upon the ground as follows;

Beginning at a stone monument from which the discovery shaft bears N. $17^{\circ}50'$ E. 100 feet, being the center of the South westerly end line of this claim, thence N. $72^{\circ}10'$ W. 300 feet to a post, marked Cor. No. 1, being the S.W. Cor. of this claim, thence N. $17^{\circ}50'$ E. 1500 feet to a post marked Cor. No. 2, being the N.W. Cor. of this claim, thence S. $72^{\circ}10'$ E. 300 feet to a stone monument, being the center of the North easterly end line of this claim, thence S. $72^{\circ}10'$ E. 300 feet

to a stake marked Cor.No.3, being the N.E.Cor.of this claim,thence S.17°50' W.1500 feet to a post marked Cor.No.4, being the S.E.Cor.of this claim,thence N.72°10' W.300 feet to the place of beginning.

All done under the provisions of Chapter Six,of Title XXVII, of the Revised Statutesof the United States,and of an Act of the General Assembly of Arizona, entitled An Act to codify and Revise the laws of the Territory of Arizona,approved March 16,1901.

Dated and posted on the ground this 17 day of August 1901.

Witness. The Arizona Copper Co. Locators.

W.J.Atkinson.- A.D.McLean.

Recorded at request of A.C.Co. August 22nd,1901,at 9 o'clock A.M.

Thomas Smith,County Recorder.

Territory of Arizona,)
)ss.
County of Graham.)

I, Thomas Smith, County Recorder, in and for the County and Territory aforesaid, do hereby certify the foregoing to be a full, true, and complete copy of the HECTOR MINING Amended, CLAIM, as the same appears upon the Records of Graham County, in Book 13, pages 347 & 348. Records of Mines.

In Witness Whereof, I have hereunto set my hand and affixed my official seal at my office in Solonoville, said County and Territory, this 14th day of October. A.D. 1902.

County Recorder, Graham County,
Territory of Arizona.

AMENDED LOCATION NOTICE.

TO ALL WHOM IT MAY CONCERN:

This mining claim the name of which is the TRINIDAD NO.4 Mining Claim situated on lands belonging to the United States of America, and in which there are valuable mineral deposits was entered upon and originally located for the purpose of exploration and purchase by the Arizona Copper Company, a corporation organized under laws of Arizona, (by James Colquhoun its Agent), the undersigned on the 15th day of November 1897, said Arizona Copper Company being the person who makes and posts this Amended Location Notice.

The length of this claim is 1500 feet and the undersigned claims 100 feet in a S. $17^{\circ}19'$ W. direction and 1400 feet in a N. $17^{\circ}19'$ E. direction from the center of the discovery shaft, at which this notice is posted, lengthwise of the claim, and to each of its respective ends, together with 300 feet in width of the surface grounds on each side of the center of the claim.

The general course of the lode deposit and premises is from the Southwest to the Northeast.

The claim is situated and located in the Greenlee Gold Mountain Mining District, in Graham County, in the Territory of Arizona, about one mile in a North easterly direction from the town of Metcalf.

The claim is described particularly and the surface boundaries thereof are marked upon the ground as follows:

Beginning at a stone monument from which the discovery shaft bears N. $17^{\circ}19'$ E. 100 feet, being the center of the South westerly end line of this claim, thence N. $72^{\circ}41'$ W. 300 feet to a post marked Cor. No. 1, being the S.W. Cor. of this claim, thence N. $17^{\circ}19'$ E. 1500 feet to a post marked Cor. No. 2, being the N.W. Cor. of this claim, thence S. $72^{\circ}41'$ E. 300 feet to a stone monument being the

center of the North easterly end line of this claim, thence S. $72^{\circ}41'$ E. 300 feet to a stake being the N.E. Cor. of this claim, marked Cor. No. 3, thence S. $17^{\circ}19'$ W. 1500 feet to a post marked Cor. No. 4 being the S.E. Cor. of this claim, thence N. $72^{\circ}41'$ W. 300 feet to the place of beginning.

All done under the provisions of Chapter Six, of Title XXXII, of the Revised Statutes of the United States, and of an Act of the General Assembly of Arizona, entitled, "An Act to codify and Revise the Laws of the Territory of Arizona" approved March 16, 1901.

Dated and posted on the ground this 17th day of August 1901.

Witness.

The Arizona Copper Co.

W.J. Atkinson.- A.D. McLean.

Locators.

Recorded at request of A.C. Co. August 22nd, 1901, at 9 o'clock A.M.

Thomas Smith, County Recorder.

Territory of Arizona,))
) ss.
 County of Graham.)

I, Thomas Smith, County Recorder, in and for the County and Territory aforesaid, do hereby certify the foregoing of the Amended Location Notice to be a full, true, correct and complete copy of the TRINIDAD NO. 4 MINING CLAIM, as the same appears upon the Records of Graham County, in Book 13, page 348. Records of Mines.

In Witness Whereof, I have hereunto set my hand and affixed my official seal at my office in Solomonville, said County and Territory, this 14th day of October A.D. 1902.

 County Recorder, Graham County,
 Territory of Arizona.

AMENDED-AMENDED NOTICE OF MINING LOCATION.
LODE CLAIM.

TO ALL WHOM IT MAY CONCERN:

This mining claim, the name of which is the "CARTER" Mining Claim situate on lands belonging to the United States of America, and in which there are valuable mineral deposits, was entered upon and located for the purpose of exploration and purchase by H.S. Anderson, Mgr. for the Shannon Copper Co. a corporation duly organized and existing under the laws of the State of Delaware the undersigned, on the first day of October 1902.

The length of this claim is twelve hundred feet, and we claim nine hundred feet in a Northerly direction, and three hundred feet in a Southerly direction from the center of the discovery shaft, at which this notice is posted, lengthwise of the claim, together with three hundred feet in width of the surface grounds, on each side of the center of said claim. The general course of the lode deposit and premises is from the North to the South.

The claim is situated and located in the Greenlee Gold Mountain Mining District, in Graham County, in the Territory of Arizona, about 5000 feet in a South-easterly direction from United States Location Monument.

The surface boundaries of the claim are marked upon the ground as follows: Beginning at a post and monument of stones at a point in a South-westerly direction three hundred feet from the discovery shaft (at which this notice is posted), being in the center of the Southerly end line of said claim; thence N. $72^{\circ}10'$ W. 300 feet to a post and monument of stones, being the South-west corner of said claim; thence N. $17^{\circ}50'$ E. 1200 more or less feet to a post and monument of stones being at the North-west corner of said claim; thence S. $72^{\circ}10'$ E.

300 feet to a post and monument of stones being the center of the Northerly end of said claim;thence S.72° 10' E.32 more or less feet to a post and monument of stones being at the North-east No.1 corner of said claim;thence S.25° 00' E.380 more or less feet to a post and monument of stones at the North-east No.2 corner of said claim; thence S.17° 50' W.950 more or less feet to post and monument of stones at the S.E.cor.of said claim;thence N.72° 10' W.300 feet to the place of beginning.

All done under the provisions of Chapter Six,of Title XXXII,of the Revised Statutes of the United States,and of an Act of the General Assembly of Arizona,entitled" An Act to Codify and Revise the Laws of the Territory of Arizona",approved March 16th,1901.

Dated and posted on the ground this 1st day of October 1902.

Witness.

Shannon Copper Co.

John G.Kirchen.

By H.S.Anderson. *Mgr.*

Filed and recorded at request of H.S.Anderson October 13th, 1902, at 9 o'clock A.M.

Thomas Smith,County Recorder.

Territory of Arizona,)
)ss.
County of Graham.)

I, Thomas Smith,County Recorder,in and for the County and Territory aforesaid,do hereby certify the foregoing to be a full, true, correct and complete copy of the AMENDED-AMENDED NOTICE OF LOCATION,of the CARTER MINING CLAIM,as the same appears upon the Records of Graham County,in Book 15 page 186 Records of Mines.

In Witness Whereof,I have hereunto set my hand and affixed my official seal at my office in Solomonville,said County and Territory, this 14th day of October A.D.1902.

Thomas Smith
County Recorder,Graham County,Ariz.

4-687.

SURVEYOR-GENERAL'S CERTIFICATE OF APPROVAL OF FIELD
NOTES AND SURVEY OF MINING CLAIM.

Department of the Interior.

Office of U. S. Surveyor-General,

Phoenix, Arizona,

July 16 - , 190³

I, U. S. Surveyor-General for District of Arizona,

do hereby certify that the foregoing and hereto attached Field Notes and Return of the Survey of the
Mining Claim of the Shannon Copper Company,

known as the

Hector, Trinidad No. 4 and Carter lodes *claims*

situate in Greenlee Gold Mountain or Copper Mountain mining district,

Graham County, Arizona,

in Section 29 & 30, Township No. 3 S., Range No. 29 E., (unsur).

designated as Survey No. 1735.

executed by Lorenzo D. Chillson, U. S. Deputy Mineral

Surveyor, January 2nd-13th, 190³, under my instructions dated

December 3, 190³, have been critically examined and the necessary cor-

rections and explanations made, and the said Field Notes and Return, and the Survey they describe,

are hereby approved. A true copy of the copy of the location certificate filed by the applicant for

survey is included in the field notes.

Hugh H. Price

U. S. Surveyor-General for District of Arizona.

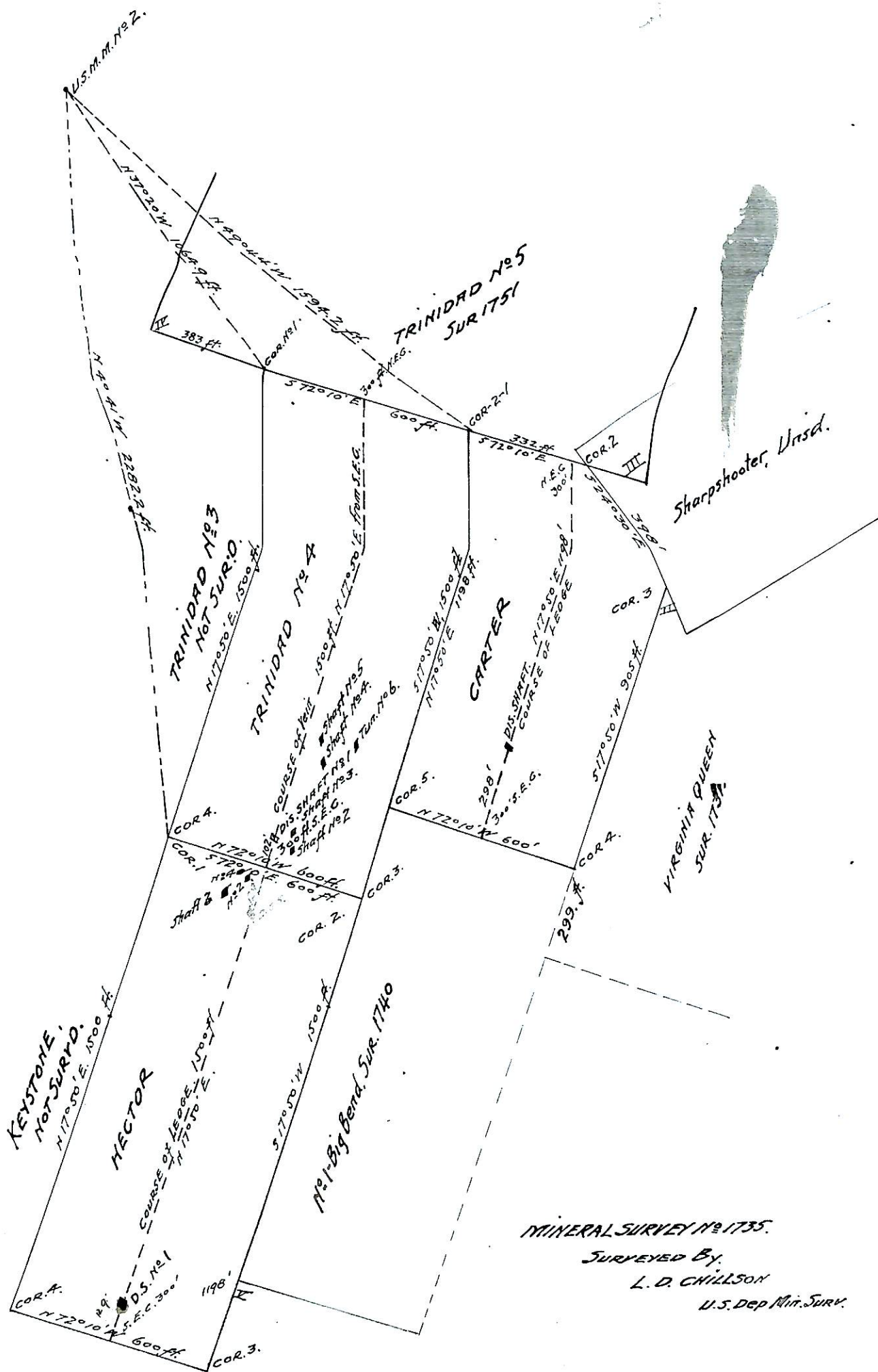

MINERAL SURVEY No 1735.
 SURVEYED BY
 L. D. CHILLSON
 U.S. Dep. Min. Surv.

Northern Point.
 SUR No 67 A