

M  
S  
.

0

1

7

8

2

MINERAL SURVEY NO. 1782

Claims	M & B Desc.	Improvements	Loc. Notices
Home	1	14 - 19	7
Regular	6	15 - 20	6
Surplus	9	16 - 22	1
Union	3	14 - 19	3
Wallace	11	16 - 22	2
Wayland	New York 5	15 - 20	4
Well	9	16 - 21	5

Recd 9/20/03

217

(4-683.)

Mineral Survey No. 1782

Lot No. \_\_\_\_\_

Gila

Land District.

FIELD NOTES

OF THE SURVEY OF THE MINING CLAIM OF

Jacob Pirrung

KNOWN AS THE

Regular-Union-Wayland New York-Home  
-Well-Surplus+Wallace in the Warren Mining District.

Cochise

County,

Arizona

Section Approximately Township 23S, Range 24 (Lumero way)  
65. S. R. B & M.

Surveyed under instructions dated Sept 10<sup>th</sup>, 1903

by Geo. C. Clark,

U. S. Deputy Mineral Surveyor

Claim located See location certificates, 1

Survey commenced September 11<sup>th</sup> 1903, 1

Survey completed September 17<sup>th</sup> 1903, 1

Claimants Address: Bisbee, Cochise Co. Arizona

# PRELIMINARY OATHS OF ASSISTANTS IN SURVEY OF MINING CLAIM.

WE, W. B. Dent and Frank Rafoth,

do solemnly swear that we will well and faithfully execute the duties of chain carriers; that we will level the chain upon even and uneven ground and plumb the tally-pins, either by sticking or dropping the same; that we will report the true distance to all notable objects, and the true length of all lines that we assist in measuring, to the best of our skill and ability, and in accordance with instructions

given us, in the survey of the Mining Claim of Jacob Pirrung

known as the Regular Union; Wayland New York - Home-Well-Surplus & Wallace situate in Warren mining district

Cochise County, Arizona

in Section \_\_\_\_\_, Township No. \_\_\_\_\_, Range No. unsurveyed

Frank Rafoth, Chairman.

W B Dent, Chairman.

Subscribed and sworn to by the above-named persons before me this

11th day of September, 1903

My commission expires, Feb. 24, 1906, S. J. Merritt  
Notary Pub. in and for Cochise County Territory of Arizona

I, \_\_\_\_\_, do solemnly swear that I will well and truly perform the duties of axman, in the establishment of corners and other duties, according to instructions given me and to the best of my skill and ability, in the survey of the Mining Claim of

known as the \_\_\_\_\_ more fully described in the preceding affidavit.

\_\_\_\_\_, Axman.

Subscribed and sworn to by the said \_\_\_\_\_

\_\_\_\_\_ before me this \_\_\_\_\_ day of

\_\_\_\_\_, 190\_\_\_\_

I, \_\_\_\_\_, do solemnly swear that I will well and truly perform the duties of flagman, in the establishment of corners and other duties, according to instructions given me and to the best of my skill and ability, in the survey of the Mining Claim of

known as the \_\_\_\_\_ more fully described in the preceding affidavit.

\_\_\_\_\_, Flagman.

Subscribed and sworn to by the said \_\_\_\_\_

\_\_\_\_\_ before me this \_\_\_\_\_ day of

\_\_\_\_\_, 190\_\_\_\_

Feet

Survey No. 1782.

Beginning at cor No 1, the N. W. cor, identical with cor No. 2, Baras, Survey No. 1663, a pine post 4 ft long 4 ins square set 1 ft in the ground in a mound of stones and scribed 1-1782 H. L., whence U. S. M. M. No. 4 brs N. 63° 43' W. 4719 ft, and original location brs N. 20° 30' E. 110 ft, and a pine post of same dimensions scribed W. C. 1-1782 brs N. 20° 34' E. 50 ft, and a second post of same dimensions and scribing brs S. 20° 34' W. 50 ft.

Thence S. 20° 34' W.

27.2 to intersection line <sup>1-1</sup>~~4-1~~ Last Rose of Summer, Survey No. 1561 at N. 53° 10' W. 107.94 ft from cor No. 4

210.0 same bearing to original location W. end center

419.6 same bearing to cor No. 2, the S. W. cor, identical with location and with cors No. 1. 2. 3 and 3, New Castle, No. 1762, Comet, No. 1563, Waddell, No. 1562, and Last Rose of Summer, No. 1561, a pine post 3 ft high and 4 ins square set in the ground in a mound of stones and scribed 2-1782, whence a conglomerate cropping 4 ft high 4 ins square chiseled X 2-1782 B. R., brs N. 35° E. 60 ft.

Thence S. 74° 54' E.

194.9 to intersection line ~~1-2~~ Junction, Survey No. 1563 and <sup>4-5</sup>~~4-5~~ New Castle, Survey No. 1762, at S. 49° 03' W. 251.74 ft. and 54.63 ft. from cors. 2-5 respectively.

643.4 same bearing to intersection line <sup>3-4</sup>~~2-4~~ Junction, Survey No. 1563, and ~~1-2~~ Union Lode of this survey, at S. 12° 30' W. 186.3 and 131.32 ft from cors No. 3 and 1, respectively.

1500 same bearing to cor No. 3, the S. E. cor, identical with location, a pine post 4 ft long and 4 ins

Feet.

Survey No. 1782.

4

square set 1 ft in the ground in a mound of stones and scribed 3-1782 H. L., whence a pine post of same dimensions and scribed W. C. 3-6-5-1782 brs S. 20° 34' W. 21.8 ft, and a second post of same dimensions and scribing brs N. 20° 34' E 50 ft.

No other bearing monuments available.

Thence N. 20° 34' E.

14.00 to cor No. 6 Union Lode of this survey. identical with E. end center.

28.2 same bearing to cor No. 4, the N. E. cor. identical with location and with cor No. 5 Union Lode of this survey, a pine post 4 ft long 4 ins square set 1 ft in the ground in a mound of stones and scribed 4-1782 H. L., whence a pine post of same dimensions scribed W. C. 3-4-5-1782 brs S. 20° 34' W. 50 ft, and a second post of same dimensions and scribing brs N. 20° 34' E. 21.8 ft. and cor No. 3 Reindeer Lode, No. 1585 brs S. 59° 24' E. 104.7 ft.  
No other bearing monuments available.

Thence N. 59° 24' W.

1395.3 to cor No. 5. identical with cor No. 2 Reindeer Lode Survey No. 1585, a pine post 4 ft long 4 ins square set 1 ft in the ground in a mound of stones and scribed 5-1782 H. L., whence a pine post of same dimensions scribed W. C. 5-6-1782 brs N. 36° 47' E' 50 ft, and a second post of same dimensions and scribing brs S. 36° 47' W. 24 ft.

No other bearing monuments available.

Thence N. 36° 47' E.

26.0 to cor No. 6, identical with cor No. 3 Baras, Survey No. 1663, a pine post 4 ft long 4 ins square set 1 ft in the ground in a mound of stones and scribed 6-1782 H. L., whence a pine post of same dimensions scribed W. C. 5-6-1782 brs N. 36° 47' E. 24 ft and S. 36° 47' W. 50 ft.

Feet

Survey No. 1782.

No other bearing monuments available.

Thence N. 78° 09' W.

128.35 to cor. No. 1, the place of beginning.

--- LEDGE ---

The presumed course of the vein on this claim is from the E. end center of location N. 66° 52' W. 1495 ft.

-----0000000-----

- - - - U N I O N - - - -

Beginning at cor. No. 1, the N. W. cor., identical with location, a pine post 4 ft. long 4 ins. square set 1 ft. in the ground in a mound of stones and scribed 1-1782 U. L., whence a rock in place 1 X 2 ft., scribed X-1782 E. R., hrs N. 85° 22' E. 71.3 ft., and cor. No. 2, Junction Lode, Survey No. 1568, hrs. N. 12° 30' E. 55 ft., and U. S. M. M. No. 4 hrs. N. 61° 57' W. 5363 ft,

Thence S. 12° 30' W.

131.32 to intersection line 2-3, *Home* Lode of this survey at S. 74° 54' E. 643.4 ft. from cor. No. 2.

300 same bearing to original location for W. end center

600 same bearing to cor. No. 2, the S. W. cor., identical with location and with cors. No. 1, 3 and 4 respectively, Wayland New York of this survey, Pay Day and Junction, Surveys No. 1568, a pine post etc., scribed 2-1782 U. L.

Thence N. 78° 36' E.

1049.3 to cor. No. 2, the S. E. cor., identical with location and with cors. No. 4 and 5, respectively, Wayland New York and Regular claims of this survey, *and Cor. No. 3 Reindur Lode Sur. No. 1585* a pine post 4 ft. long 4 ins square set 1 ft. in the ground in a mound of stones and scribed 3-1782 U. L., whence a pine post of same dimensions and scribed

Feet Survey No. 1782.

W. C. 3-4-5-1782, brs. N. 12° 30' E. 50 ft., and a second post of same dimensions and scribing brs. S. 12° 30' W. 20 ft., and cor. No. 1 Judeah Lode, Survey No. 1535, brs S. 36° 47' W. 300 ft.

No other bearing monuments available.

Thence N. 12° 30' E.

- 15. to original location for E. end center
- 30. same bearing to cor. No. 4, the N. E. cor., identical with location, a pine post 4 ft. long 4 ins. square set 1 ft. in the ground in a mound of stones and scribed 4-1782 U. L., whence a pine post of same dimensions and scribed W. C. 3-4-5-1782 brs. N. 12° 30' E. 20 ft., and a second post of same dimensions and scribing brs. S. 12° 30' W. 50 ft.

No other bearing monuments available.

Thence N. 76° 03' W.

- 99.54 to cor. No. 5, identical with cor. No. 4 Home Lode of this survey, *on line 2-3 Remblee Lode Sur No. 1585, 1041.7 ft from Cor. No. 3*, a pine post etc., scribed 5-1782 U. L.

Thence S. 20° 34' W.

- 14.2 to cor. No. 6. identical with the E. end center Home Lode of this survey, a pine post 4 ft. long 4 ins. square set 1 ft. in the ground in a mound of stones and scribed 6-1782 U. L., whence a pine post of same dimensions and scribed W. C. 6-1782 brs. N. 67° 10' W. 40 ft., and a second post of same dimensions and scribing brs. S. 67° 10' E. 40 ft.

Thence N. 67° 10' W.

- 871.8 to cor. No. 1, the place of beginning.

--- LEDGE ---

The presumed course of the vein on this claim is from cor. No. 3 N. 84° 56' W. 967.4 ft.



Feet

Survey No. 1782.

Beginning at cor. No. 1, the N. W. cor., identical with location and with cors. No. 2, 4 and 6, respectively, of the Union Lode of this survey, Junction and Pay Day Lodes, Surveys No. 1583, a pine post 4 ft. long 4 ins. square set 1 ft. in the ground in a mound of stones and scribed 1-1782 W. N. Y., whence conglomerate bedrock chiseled X 1-2-1782 B. R. brs. N. 31° 30' E. 90.3 ft., and U. S. M. M. No. 4 brs. N. 55° 58' 30" W. 555 1/4 ft.

Thence S. 19° 10' E.

270 . . . to original location for W. end center

529.9 same bearing to cor. No. 2, the S. W. cor., identical with location, *on line 5-1 Regular Lode of this Survey at S 50° 21' W. 1107.8 from Cor No. 6* a pine post 4 ft. long 4 ins.

square set 1 ft. in the ground in a mound of stones and scribed 2-1782 W. N. Y., whence a rock in place 6 ins. high 1 X 3 ft. chiseled X 2-1782 B. R. brs. N. 70° E. 49.5 ft.

Thence N. 55° 16' 15" E.

821.1 to cor. No. 1 Judeah Lode, Survey No. 1585

1079.1 same bearing to cor. No. 3, the S. E. cor., identical with location, a pine post 4 ft. long 4 ins.

square set 1 ft. in the ground in a mound of stones and scribed 3-1782 W. Y. N., whence a pine post of same dimensions and scribed W. C. 3-1782 brs. N. 55° 16' E. 50 ft., and a second post of same dimensions and scribing brs. S. 55° 16' W. 50 ft.

No other bearing monuments available.

Thence N. 19° 10' W.

49. to original location for E. end center.

98.74 same bearing to cor. No. 4, the N. E. cor., identical with location and with cors. No. 3, 4 and 5, respectively, Union, Wayland New York and Regular Lodes of this survey, a pine post etc., scribed 4-1782

W. N. Y.

Feet

Survey No. 1782.

1049.3 Thence S. 78° 36' W.  
to cor. No. 1, the place of beginning.

--- LEDGE ---

The presumed course of the vein on this claim  
is from cor. No. 4 S. 64° 20' W. 1046 ft.

-----oooOooo-----



- - - - R E G U L A R - - - -

Survey No. 1782.

Beginning at cor No. 1, the N. W. cor., identi-  
cal with location, a pine post 4 ft. long 4 ins.  
square set 1 ft. in the ground in a mound of stones  
and scribed 1-1782 R. L., whence a flat rock 2 X 3  
ft. chiseled X 1-1782 B. R. brs. S. 20° 45' W. 39.5  
ft., and U. S. M. M. No. 4 brs. N. 51° 50' W. 5961  
ft.

290 Thence S. 28° 31' E.  
to original location for W. end center  
580.8 same bearing to cor. No. 2, S. W. cor., identical  
with the N. end center High Card Lode, No. 1648, and  
with cor. No. 4 Pay Day Lode, No. 1563, a pine post  
4 ft. long 4 ins. square set 1 ft. in the ground in  
a mound of stones and scribed 2-1782 R. L., whence a  
limestone cropping 2 ft. high chiseled X 2-1782 B. R.  
brs. S. 47° 30' W. 95 ft.

300 Thence N. 49° 18' E.  
to cor. No. 3, identical with cors. No. 1 and 2 re-  
spectively, Well Lode of this survey, and High Card,  
Survey No. 1648 a pine post etc., scribed 3-1782 R. L.

159 Thence N. 49° 36' E.  
center of shaft No. 1 Well Lode of this survey

Feet.

Survey No. 1782.

297.7	same bearing to cors. No. 4 and 1. respectively, Well Lode of this survey, and Guard Lode, Survey No. 1716
897.7	same bearing to cors. No. 3 and 4. respectively, American and Guard, Surveys No. 1716
930.8	<p>same bearing to cor. No. 4, the S. E. cor., identical with location on line 1-2 Judeah Lode, Survey No. 1585, at S. 60° 27' E. 515.2 ft. from cor. No. 1, a pine post 4 ft. long 4 ins. square set 1 ft. in the ground in a mound of stones and scribed 4-1782 R. L., whence a conglomerate cropping 1 ft. high chiseled X 4-1782 R. E. hrs. N. 37° 15' E. 69 ft.</p> <p style="text-align: center;">Thence N. 28° 31' W.</p>
272.7	to original location for E. end center
562.7	<p>same bearing to cor. No. 5, the N. E. cor., identical with location and with cors. No. 3 and 4, respectively, Union and Wayland New York claims of this survey, a pine post, etc., scribed 5-1782 R. L.</p> <p style="text-align: center;">Thence S 50° 21' W.</p>
1109.8	<p>to cor. No. 2 Wayland New York claim of this survey, on line 5-C Pay Day Lode, Survey No. 1562, at N. 19° 10' W. 303.4 ft. from cor. No. 5</p>
1227.3	<p>same bearing to cor. No. 1, the place of beginning.</p> <p style="text-align: center;">--- LEDGE ---</p> <p>The presumed course of the vein on this claim is from the E. end center of location N. 59° 21' E. 1227.3 ft.</p> <p style="text-align: center;">-----0000000-----</p>

Feet

Survey No. 1782.

Beginning at cor No. 1, the N. W. corner, identical with location and with cors. No. 2 and 3. respectively, High Card, Survey No. 1648, and the Regular Lode of this survey, a pine post 4 ft. long 4 ins. square set 1 ft. in the ground in a mound of stones and scribed 1-1782 W. L., whence X-1-2-1782 B. R. chiseled in limestone bedrock brs. S.  $12^{\circ} 50'$  E. 67 ft., U. S. M. M. No. 4 brs. N.  $53^{\circ} 34'$  W. 65 1/2 ft.

Thence S.  $36^{\circ} 02'$  E.

1487.2 to cor. No. 3 High Card Lode, Survey No. 1648, and cor. No. 7 Surplus Lode of this survey.

1500 same bearing to cor No. 2, the S. W. cor., identical with location and with cor. No. 6 Surplus Lode of this survey, and with the N. W. cor. unsurveyed Fashion Lode, a pine post 4 ft. long 4 ins. square set 1 ft. in the ground in a mound of stones and scribed 2-1782 W. L., whence a pine post of same dimensions and scribed W. C. 2-6-7-1782 brs. N.  $36^{\circ} 02'$  W. 50 ft., and a second post of same dimensions and scribing brs. S.  $36^{\circ} 02'$  E. 50 ft.

No other bearing monuments available.

Thence N.  $49^{\circ} 36'$  E.

170 to original location for S. end center

297.7 same bearing to cor. No. 3, the S. E. cor., identical with location and with cor. No. 2. Guard Lode Survey No. 1716, a pine post 4 ft. long 4 ins. square set 1 ft. in the ground in a mound of stones and scribed 3-1782 W. L., whence a rock in place level with the surface 1 X 2 ft. chiseled X 3-1782 B. R. brs N.  $18^{\circ} 20'$  E. 99.2 ft.

Thence N.  $36^{\circ} 02'$  W.

1500 to cor. No. 4, the N. E. cor., identical with loca-

Feet

Survey No. 1782.

tion and with cor. No. 1 Guard Lode, Survey No. 1716, a pine post 4 ft. long 4 ins. square set 1 ft. in the ground in a mound of stones and scribed 4-1782 W. L., whence a rock in place 1 X 1 X 2 ft. chiseled X 4-1782 B. R. brs. N. 76° 24' E 113.3 ft.

Thence S. 49° 36' W.

138.7 to center shaft No. 1  
 147.7 same bearing to original location, for N. end center  
 297.7 same bearing to cor. No. 1, the place of beginning.

--- LEDGE ---

The presumed course of the vein on this claim of location is from the N. end center N. 36° 02' E. 1500 ft.

-----0000000-----

--- S U R P L U S ---

Beginning at cor. No. 1, the U. W. cor., identical with location, and with cors. No. 3, 4 and 4, respectively, I X L, New Era and High Card, Surveys No. 1648, a pine post 4 ft. long 4 ins. square set 1 ft. in the ground in a mound of stones and scribed 1-1782 S. L., whence a rock in place 1 X 2 X 3 ft. chiseled X 1-1782 B. R. brs. N. 32° 24' W. 114.5 ft. and U. S. M. M. No. 4 brs. N. 45° 06' W. 792.2 ft.

Thence S. 35° 49' E.

750 to original location, for W. **SIDE** center.  
 1494.8 same bearing to cor. No. 2, identical with location, and with cor. No. 4, I X L, Lode, Survey No. 1648,

Feet

Survey No. 1782!

a pine post 4 ft. long 4 ins. square set 1 ft. in the ground in a mound of stones and scribed 2-1782 S. L., whence a rock in place 2 X 2 X 3 ft. chiseled X 2-1782 B. R. brs. N. 85° 53' W. 88.7 ft.

Thence N. 49° 18' E.

260 to original location for S. end center.

268.7 same bearing to cor. No. 3, the S. E. cor., identical with cor. No. 3, Wallace Lode of this survey, a pine post 4 ft. long 4 ins. square set 1 ft. in the ground in a mound of stones and scribed 3-1782 S. L. whence original S. E. cor. brs. N. 49° 18' E. 350 ft., and a pine post 4 ft. long 4 ins. square set 1 ft. in the ground in a mound of stones and scribed W. C. 3-1782 brs. S. 49° 18' E. 50 ft., and a second post of same dimensions and scribing brs. S. 49° 13' W. 50 ft.

No other bearing monuments available.

Thence N. 35° 57' W.

994.8 to cor. No. 4., identical with N. W. cor., unsurveyed Antelope claim, a pine post 4 ft. long 4 ins. square set 1 ft. in the ground in a mound of stones and scribed 4-1782 S. L., whence a rock in place level with the surface 2 X 2 1/2 ft. chiseled X 4-1782 B. R. brs. N. 68° 30' E. 87.5 ft.

Thence N. 49° 11' E

329 to cor. No. 5, identical with the S. W. cor. unsurveyed Fashion Lode, a pine post 4 ft. long 4 ins. square set 1 ft. in the ground in a mound of stones and scribed 5-1782 S. L., whence original E. side center brs. S. 35° 20' E. 250 ft., and a pine post 4 ft. long 4 ins. square set 2 ft. in the ground scribed W. C. 5-1782 brs. S. 49° 11' W. 30 ft., and a

Feet

Survey No. 1782.

and a second post of same dimensions and scribing  
brs. N. 49° 11' E. 50 ft.

No other bearing monuments available.

Thence N. 35° 16' W.

436.7 to cor. No. 6, identical with cor. No. 2, Well Lode  
of this survey, and with the N. W. cor. unsurveyed  
Fashion claim, a pine post, etc., scribed 6-1782  
S. L.

Thence N. 36° 02' W.

12.8 to cor. No. 7, the N. E. cor., identical with loca-  
tion and with cor. No. 3, High Card Lode, Survey No.  
1648, a pine post 4 ft. long 4 ins. square set 1 ft.  
in the ground in a mound of stones and scribed 7-  
1782 S. L., whence a pine post of same dimensions and  
scribing <sup>with w.c.</sup> brs. N. 49° 18' E. 50 ft., and a second post  
of same dimensions and scribing bears S. 49° 18' W.  
50 ft.

Thence S. 49° 18' W.

299 to original location for N. end center.  
600 same bearing to cor. No. 1. the place of beginning.

--- LEDGE ---

The presumed course of the vein on this claim  
is from the N. end center of location S. 35° 16' E.  
436.7 ft., thence S. 33° 53' E. 1012 ft.

-----oooOooo-----

--- W A L L A C E ---

Survey No. 1782.

Beginning at cor. No. 1, the N. W. cor., iden-  
tical with location and with cor No. 4. Ohio Lode,  
Survey No. 1648, a pine post 4 ft. long 4 ins. square

Feet.

Survey No. 1782.

	<p>set 1 ft. in the ground in a mound of stones and scribed 1-1782 W. L., and U. S. M. M. No. 4 brs. N. <math>36^{\circ} 19' W</math> . 9410 ft., whence a rock in place 6 ins. high 2 ft. square chiseled X 1-1782 B. R. brs. <math>S. 86^{\circ} 09' W</math>. 39 ft.</p> <p>Thence N. <math>49^{\circ} 41' E</math>.</p>
600	<p>to cors. No. 3 and 6, respectively, Ohio and I X L, Surveys No. 1648</p>
900	<p>same bearing to cor. No. 2, identical with location for N. side center, and cor. No. 5 I X L Lode, Survey No. 1648, a pine post 4 ft. long 4 ins. square set 1 ft. in the ground in a mound of stones and scribed 2-1782 W. L., whence a rock in place level with the surface 2 X 5 ft. chiseled X 2-1782 B. R. brs. S. <math>16^{\circ} 20' W</math>. 37.5 ft.</p> <p>Thence N. <math>49^{\circ} 18' E</math>.</p>
300	<p>to cors. No. 2 and 4, respectively, Surplus Lode of this survey, and the I X L, Survey No. 1648</p>
568.7	<p>same bearing to cor. No. 3, the N. E. corner, identical with location and with cor. No. 3, Surplus Lode of this group, a pine post etc., scribed 3-1782 W. L.</p> <p>Thence S. <math>35^{\circ} 57' E</math>.</p>
300	<p>to original location for E. end center</p>
505.9	<p>same bearing to cor. No. 4, the S. E. cor., identical with location and with the S. W. cor. unsurveyed Antelope lode, a pine post 4 ft. long 4 ins. square set 1 ft. in the ground in a mound of stones and scribed 4-1782 W. L., whence two posts of same dimensions and scribed W. C. 4-1782 br. S. <math>45^{\circ} 54' W</math>. 50 ft., and N. <math>45^{\circ} 54' E</math>. 50 ft., respectively.</p> <p>No other bearing monuments available.</p> <p>Thence S. <math>45^{\circ} 54' W</math>.</p>
147	<p>to N. W. cor and N. E. cor., respectively, of the unsurveyed Baker and A K Lodes</p>



Feet

Survey No. 1782.

749.8	same bearing to the N. W. and N. E. cors., respectively, unsurveyed A K and Lulu Lodes
750	same bearing to original location for S. side center
1479.1	same bearing to cor. No. 5, the S. W. cor., identical with location, a pine post 4 ft. long 4 ins. square. set 1 ft. in the ground in a mound of stones and scribed 5-1782 W. L., whence a rock in place 6 ins. high 1 X 3 ft. chiseled X 5-1782 B. R. brs. N. 66° 13' E. 91.5 ft.
	Thence N 35° 57' W.
300	to original location for W. end center.
600	same bearing to cor. No. 1, the place of beginning.

--- LEDGE ---

The presumed course of the vein on this claim is from the W. end center of location N. 49° 32' E. 1468.7.

Certificate of \$500.00 improvements will be filed upon completion of the same. The present improvements consist of;

--- HOME ---

No. 1.	Disc. Cut 6 X 20 X 8 ft., course S. 45° W. brs from cor. No. 1 Union Lode of this survey S. 71° 45' E. 260 ft.,	\$150.00
No. 2.	Shaft 8 X 8 X 10 ft. brs. from same point S. 68° 54' E., 260 ft.,	110.00
No. 3.	Open Cut 12 X 20 X 8 ft., course S. 2° W. brs from cor. No. 3 Junction Lode No. 1563 N. 68° 40' W. 40ft.,	200.00
No. 4.	Shaft 4 X 6 X 50 ft., brs from cor. No. 2 N. 49° E. 210 ft.,	<u>600.00</u>
	Total Improvements Home Lode,	\$1060.00

Open Cuts No. 1 and 3 are in close proximity to the Union Lode and directly pointing towards the same as shown in field notes and accompanying plat, and further, lie on N. side of hill upon which said Union Lode is located; shaft No. 3 is within 10 ft. of the Union line; these three workings tend to benefit that claim and their value has been allotted to the same

	\$460.00	
Shaft No. 4. to Home Lode,	\$600.00	\$600.00

--- UNION ---

No. 1.	Disc. Shaft 4 X 6 X 10 ft. brs. from W. end center S. 84° 56' E. 100 ft.,		100.00
No. 2	Shaft 4 X 6 X 10 ft. brs. from cor. No. 3 Home Lode of this survey S. 72° 30' W. 210 ft.,	\$100.00	
No. 3.	Open Cut 5 X 33 X 7 ft., course S. 60° E. brs. from same point S. 69° 28' W. 300 ft.	<u>250.00</u>	
	Value Shaft and Cut,	\$450.00	

- - - - IMPROVEMENTS - - - - (Con.)

	Undivided interest in Open Cuts. No. 1 and 2, and Shaft No. 2 Home Lode of this survey,	\$460.00
	Total,	<u>560.00</u>
	Shaft No. 2 is within 30 ft. of line 4-1 Wayland New York, sinking and drifting from this shaft tend directly for the benefit of that claim.	
	Open Cut No. 3, the breast of which is already on Wayland New York, is strictly for the development as shown in accompanying plat. The value of these two workings have therefore been allotted to said Wayland New York Lode, Value as above shown 320.00	
	-----WAYLAND NEW YORK-----	
No. 1.	Disc. Shaft 4 X 6 X 10 ft., brs. from cor. No. 4 S. 64° 20' W. 310 ft.,	\$100.00
No. 2.	Shaft 10 X 5 X 4 ft. brs. from cor. No. 1 N. 70° 50' E. 250 ft.	30.00
No. 3.	Shaft 4 X 6 X 3 ft. brs. from cor. No 1. N. 82° E. 250 ft.,	20.00
No. 4.	Shaft 4 X 6 X 3 ft. brs. from cor. No. 1 N. 86° 40' E. 245 ft.,	20.00
	Undivided interest shaft No. 2 and Open Cut No. 3 Union Lode of this survey	<u>350.00</u>
	Total,	<u>720.00</u>
	--- REGULAR ---	
No. 1.	Disc. shaft 4 X 6 X 10 ft. brs. from W. end center N. 50° 21' E. 300 ft.,	100.00
No. 2.	Shaft 4 X 6 X 4 ft. brs. from cor. No. 2 Wayland New York S. 21° E. 220 ft.,	20.00
No. 3.	Open Cut 30 X 44 X 4 ft., course S. 36° E. brs. from same point S. 24° E. 345 ft.,	200.00
No. 4.	Shaft 7 X 10 X 1 ft. brs. from same point N 33° 40' E. 135 ft.,	<u>10.00</u>
	Total,	<u>\$340.00</u>

--- W E L L ---		
No. 1.	Disc. Shaft 4 X 6 X 40 ft. brs. from cor. No. 1 N. 49° 36' E. 159 ft., Value,	\$480.00
--- S U R P L U S ---		
No. 1.	Disc. Shaft. 4 X 6 X 10 ft. brs. from cor. No. 1. N. 68° 20' E., 300 ft. Value	100.00
--- W A L L A C E ---		
No. 1.	Disc. Shaft 4 X 6 X 10 ft. brs from point on line 1-2 N. 49° 41' E. 300 ft., and from cor. No. 1 S. 3° 05' W. 440 ft., Value,	100.00
No. 2.	Shaft 5 X 6 X 10 ft. brs. from cor. No. 1 S. 64° 20' E 310 ft., Value,	<u>100.00</u>
	Total Improvements on Group,	2800.00

--- AREAS ---

	Acres
Total area Home Lode,	7.969
Less Last Rose of Summer, No. 1561, conflict,	0.467
Less Junction, No. 1562, conflict,	1.711
Less Union, No. 1782 conflict	1.430
" New Castle No. 1568. "	<u>0.451</u> 4.059
Net area Home Lode,	3.910
Total area Wayland New York,	7.502
Less Regular, No. 1782, conflict	0.908
" Judeah, No. 1585, "	<u>0.282</u> 1.190
Net area Wayland New York,	6.292
Total area Regular,	15.787
Less Pay Day, No. 1563, conflict	0.823
" Judeah, No. 1585. "	<u>1.760</u> 2.583
Net area Regular,	13.204
Total and Net area Surplus,	12.920
Total " " " Well,	10.222
Total " " " Wallace,	18.547
Total area Union,	6.656
Less conflict with Reindeer No. 1585	0.034
Net area of Group	<u>6.622</u>
--- LOCATION ---	<u>71.631</u>
	71.737

These claims are located about 2 mil in a S.E. direction from Bisbee, on unsurveyed lands, in the Warren Mining District, Cochise County, Arizona, and approximately in Tp. 23 S., R. 24 E., G. & S. R. B. & M.

## --- ADJOINING CLAIMS. ---

North Baras, No. 1663, Copper Queen Consolidated Mining Co. owner; Reindeer, No. 1585, L. J. and C. A. Overlock, owners.

East. Judeah and Reindeer, Surveys No. 1585, same owners; Guard, No. 1716, Pirrung & Hanniger, owners; Fashion, unsurveyed, Douglas and Hazel, owners. Antelope, unsurveyed, Star Williams owner.

South Baker, A K and Lulu, M. J. Cunningham, owner.

West Key, unsurveyed, Costello and O'Hare owners; I X L and Chio, High Card and New Era, Surveys No. 1648. Calumet & Pittsburg Mining Co., owner, Pay Day, Junction and Comet, Surveys No. 1563, same owner; Waddell, No. 1562, same owner; New Castle, No. 1762, Hanniger and Hanninger, owners.

## --- INSTRUMENT ---

The survey was made with a Duff Transit; the courses were deflected from the true meridian as determined by solar observations, checked by an observation on Polaris. All distances were measured with a 300-ft. steel tape. Magnetic variation  $12^{\circ}$  E.

*Geo. C. Clark*

U. S. DEPUTY MINERAL SURVEYOR.

Bisbee, Arizona,

September 17<sup>th</sup>, 1903.

IMPROVEMENTS.

APR 11 1904  
21

19

I, certify that the value of the labor and improvements on these claims, placed thereon by the claimant or his grantors, is not less than \$500.00, for each claim thereof; that said improvements were completed before the expiration of the 60 days publication in the newspaper, which first publication first appeared in the Bisbee Evening Miner in its date of February 10, 1904, and that said improvements consist of:

- - - HOME. - - -

No.1	Disc. Cut. 6 x 20 x 8 ft., course S. 45° W. brs. from Cor. No. 1 Union Lode of this survey S. 71° 45' E. 200 ft., Value	\$150.00
No.2	Shaft 8 x 8 x 10 ft. brs. from same point S. 68° 54' E. 260 ft., Value	110.00
No.3	Open Cut 12 x 20 x 8 ft. course S. 2° W. brs. from Cor.No.3 Junction Lode No.1563 N.68° 40' W. 40 ft., Value	200.00
No.4	Shaft 4 x 6 x 50 ft. brs. from cor. No.2 N. 49° E. 210 ft., Value	<u>600.00</u>

Total Improvements Home Lode, \$1060.00

Open cuts No. 1 and 3 are in close proximity to the Union Lode and directly pointing towards the same as shown in field notes and accompanying plat, and further, lies on N. side of hill upon which said Union lode is located, Shaft No. 2 is within 10 ft. of the Union line, these workings tend to benefit that claim and their value has been allotted to the same

	<u>\$460.00</u>
Shaft No. 4 to Home lode,	600

\$600.00

- - - UNION. - - -

No.1	Disc. Shaft 4 x 6 x 10 ft. brs. from W. end center S.84° 56' E. 100 ft., Value	\$100.00
No.2	Shaft 4 x 6 x 10 ft. brs. from Cor. No. 3 Home Lode of this survey S. 72° 30' W. 310 ft., Value	100.00

No.3	Open Cut 5 x 33 x 7 ft., course S. 60° E. brs. from same point S 69° 28' W. 300 ft., Value	\$250.00
	Value shaft and cut	\$350.00
	Undivided interest in open cuts No. 1 and 3 and Shaft No. 2 Home Lode of this survey.	\$460.00
		\$560.00
	<p>Shaft No. 2 is within 30 ft. of line 4-1 Wayland New York, sinking and drifting from this shaft tend directly for the benefit of that claim.</p> <p>Open cut. No. 3, the breast of which is already on Wayland New York, is strictly for the development as shown in accompanying plat. The value of these two workings have therefore been allotted to said Wayland New York Lode, Value as above shown,</p> <p style="text-align: center;">- - - WAYLAND NEW YORK - - -</p>	
No.1	Disc. Shaft 4 x 6 x 10 ft., brs. from Cor. No. 4 S. 64° 20' W. 210 ft., value	\$100.00
No.2	Shaft 10 x 5 x 4 ft. brs. from Cor. No. 1 N. 79° 50'E. 250 ft., Value,	30.00
No.3	Shaft 4 x 6 x 3 ft brs. from Cor. No. 1 N. 82° E. 250 ft.	20.00
No.4	Shaft 4 x 6 x 3 ft. brs. from Cor. No. 1 N.86°40'E.245 ft	20.00
	Undivided interest shaft No. 2 and Open Cut No. 3 Union Lode of this survey	350.00
	Total,	520.00
	- - - REGULAR - - -	
No.1	Disc. Shaft 4 x 6x 10 ft. brs. from W. end center N. 50° 21' E. 300 ft., Value	100.00
No.2	Shaft 4 x 6 x 4 ft. brs. from Cor. No. 2 Wayland New York S. 21° E. 220 ft., Value	30.
No.3	Open Cut 30 x 44 x 4 ft. course S. 36° E. brs. from same point S. 24° E. 345 ft., Value	200.
No.4	Shaft 7 x 10 x 1 ft. brs. from same point N. 83° 40' E. 185 ft., Value	10.



## IMPRIVEMENTS (Con2)

21

	One-fifth interest in Shaft No.1 Well lode of this survey One-half of same being on this claim	<u>\$180.00</u>
	<i>Well</i> Total	<u>\$520.00</u>
No.1	Disc. Shaft 4 x 6 x45 ft. brs. from Cor. No. 1 N. 49° 36' E. 159 ft., This shaft was undervalued in first certificate of improve- ments, thinking it in soft ground, a second inspection shows it to be all hard rock and shooting ground Value <del>\$700.00</del>	<u>\$700.00</u>
No.2	Shaft 4 x 6 x 10 ft. brs. from Cor. No. 2 the SW. cor. N. 26° 30' W. 120 ft. Value	<u>\$100</u>
	Total	<u><del>\$700.00</del></u>

Note.

The whole surface of the Well and Surplus claim are at practically the same elevation. Shaft No. 1 being the nearest and most accessible for transportation and nearer the center of the group. Its location is best adapted for the development of all these claims. This method of developing a group from a centrally located main shaft is universally followed by some thirty companies operating in this camp. In fact, it is without exception the only method used. The operations of the Copper Queen and other big producers have proven the district to be a deposit and not a vein formation, and the only economical method of development and extraction to be From centrally located shafts, from which drifts and cross cuts are run. Shaft No. 1 as shown therefore serves to develop the Surplus lode of this survey and a  $\frac{1}{4}$  interest in the same has been allotted to that claim.

Total improvements Well lode	\$1000,00
1/5 interest Shaft No.1 to Regular	\$180.
1/4 interest Shaft.No. 1 to Surplus	<u>225. 405</u>
Net improvements Well lode	<u>\$595.00</u>

IMPROVEMENTS (Con 4)

24  
22

- - - SURPLUS - - -		
No.1	Disc. Shaft 4 x 6 x 10 ft. brs. from Cor. No. 1 N 68° 20' E. 300 ft. Value	\$100.00
No.2	Shaft 4 x 6 x 10 ft. brs. from N. end center S. 35° 10' E. 410 ft., Value	\$100.00
No.3	Shaft 4 x 6 x 10 ft. brs. from N. end center S 45° 20' E 480 ft., Value	100.00
	$\frac{1}{4}$ interest Shaft No. 1 Well lode	<u>225.00</u>
	Total	\$525.00
- - - WALLACE - - -		
No 1	Disc. shaft 4 x 6 x 10 ft. brs. from point on line 1-2 at 600 ft. from Cor. No. 1 S. 3° 5' W. 440 ft. value	100.00
No.2	Shaft 4 x 6 x 10 ft. brs. from Cor. No. 1 S. 64° 20' E. 310 ft., Value	100.00
No.3	Shaft 4 x 6 x 10 ft. brs. from W. end center N 49° 40' E 600 ft. Value	100.00
No.4	Shaft 4 x 6 x 10 ft. brs. from same point N. 48° E. 590 ft., Value	100.00
No.5	Open Cut. 5 x 8 x 20 course N. 87° 30' W. brs. from cor. No. 2 N ' 74° E. 55 ft., Value	<u>160.00</u>
	Total	\$560.00

Affidavit of Five Hundred Dollars Improvements.

We, H. B. Dent, and E. W. Armstrong

of lawful age, being first duly sworn according to law, depose and say: That we are acquainted with the Home, Union, Hett. Wallace, Wayland N. Y. Surplus, + Regular mining claim, situate in Warren Mining district, Cochise County, Arizona Territory, for which

Jacob Pirrung

has made application for survey prior to application for patent under the provisions of the Act of Congress, approved May 10, 1872; and that the labor done and improvements made thereon on each claim by the applicant and his grantor exceed Five Hundred Dollars in value, and further that we are not personally interested in said mine.

H. B. Dent

E. W. Armstrong

TERRITORY OF ARIZONA, }  
County of Cochise } ss:

Sworn to and subscribed before me, this 7<sup>th</sup>

day of April, 1904

J. M. Conwell



Notary Public in and for Cochise County  
of Cochise, Territory of Arizona.  
My Commission expires April 10th, 1908

FINAL OATH OF U. S. DEPUTY MINERAL SURVEYOR

I, Geo. L. Lark, U. S. Deputy Mineral Surveyor, do solemnly swear that, in pursuance of instructions received from the United States Surveyor General for Arizona, dated September 10<sup>th</sup> 1903, I have, in strict conformity to the laws of the United States, the official regulations and instructions thereunder, and the instructions of said Surveyor General, faithfully and correctly executed the survey of the Mining Claim of Jacob Pirring known as the Regular, Well, Union, Wayland M. Y. known as the Surplus, Wallace + Home, situate in Warren Mining District, Cochise County, Arizona in Section Approximately Township No. 23 S. Range No. 24 E (unsurveyed) 9 + S. R. B. Y. M. and designated as Survey No. 1782, as represented in the foregoing field notes, which accurately show the boundaries of said mining claim as distinctly marked by monuments on the ground, and described in the attached copy of the location certificate, which was received by me from the Surveyor General with said instructions, and that all the corners of said survey have been established and perpetuated in strict accordance with the law, official regulations and instructions thereunder; and I do further solemnly swear that the foregoing are the true and original field notes of said survey and my report therein, and that the labor expended and improvements made upon said mining claim by claimant or his grantors are as therein fully stated, and that the character, extent, location and itemized value thereof are specified therein with particularity and full detail, and that no portion of said labor or improvements so credited to this claim has been included in the estimate of expenditures upon any other claim.

Geo. L. Lark  
U. S. Deputy Mineral Surveyor.

Subscribed and sworn to by the said Geo. L. Lark

U. S. Deputy Mineral Surveyor, before me

this 7<sup>th</sup> day of April 1904

J. M. O'Connell

Notary Public in and for the County of Cochise, Territory of Arizona.  
My Commission expires Jan. 6th, 1908

(4-691.)

# Certificate of U. S. Surveyor General

AS TO

EXPENDITURES REPORTED AFTER RETURN OF SURVEY OF MINING CLAIM.

I, U. S. Surveyor General for Dist. of Arizona,  
do hereby certify that Five Hundred Dollars' worth of labor has been expended or  
improvements made by claimant or his <sup>or for each of</sup> grantors, upon the mining claim of  
Jacob Pirrung

known as the Regular, Well, Union, Wallace, Wayland N.Y., Surplus,  
and Home  
situate in Warren mining district,  
Cochise County, Arizona  
in Section \_\_\_\_\_, Township No. \_\_\_\_\_, Range No. \_\_\_\_\_;  
that said improvements consist of 20 shafts and 5 Cuts, Total  
Value ----- \$3380.00

\_\_\_\_\_, and that no portion of said labor or improvements has been  
included in the estimate of expenditures upon any other claim. A copy of the report of  
Geo. C. Clark, U. S. Deputy Mineral Surveyor, dated  
April 7th, 1904., ~~xxx~~, is hereto attached.

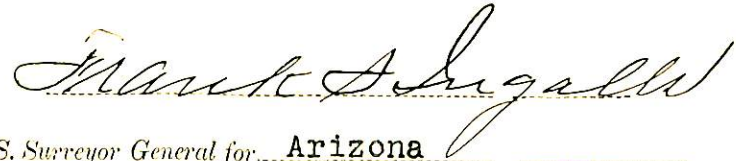
  
U. S. Surveyor General for Arizona

Office of U. S. Surveyor General,  
Phoenix, Arizona

April 13, 1904., ~~xxx~~

# FINAL OATHS FOR SURVEYS.

## LIST OF NAMES.

A list of the names of the individuals employed by Geo. C. Clark  
 United States Deputy Mineral Surveyor, to assist in running, measuring, and marking the lines  
 corners and boundaries described in the foregoing field notes of the survey of the mining claim  
 of Jacob Pirrung  
 known as the Regular, Union, Wayland New York, Home, Well, Surplus & Wallace  
 and showing the respective capacities in which they acted.

- W. B. Deert ..... , Chairman.
- Frank Rafath ..... , Chairman.
- ..... , Arman.
- ..... , Flagman.

## FINAL OATHS OF ASSISTANTS.

We, W. B. Deert  
 and Frank Rafath, do solemnly swear that we assisted  
Geo. C. Clark, United States Deputy Mineral Surveyor, in marking the corners and  
 surveying the boundaries of the mining claim of Jacob Pirrung  
 known as the Regular, Union, Wayland New York -  
Home, Well - Surplus & Wallace, ~~known as the~~  
 ....., represented  
 in the foregoing field notes as having been surveyed by said deputy mineral surveyor and under  
 his direction; and that said survey has been in all respects, to the best of our knowledge and  
 belief, faithfully and correctly executed, and the corner and boundary monuments established  
 according to law and the instructions furnished by the United States Surveyor-General for  
Arizona.

- Frank Rafath ..... , Chairman.
- W. B. Deert ..... , Chairman.
- ..... , Arman .
- ..... , Flagman.

Subscribed and sworn to by the above-named persons before me  
 this 13th day of September, 1903

S. J. Merritt .....

Notary Public in and for  
Cochise County, Territory of Arizona  
My Commission Expires Feb. 24, 1906

(4-686.)

FINAL OATH OF U. S. DEPUTY MINERAL SURVEYOR

I, Geo. C. Clark, U. S. Deputy Mineral Surveyor, do solemnly swear that, in pursuance of instructions received from the United States Surveyor General for Arizona, dated September 10<sup>th</sup> 1903, I have, in strict conformity to the laws of the United States, the official regulations and instructions thereunder, and the instructions of said Surveyor General, faithfully and correctly executed the survey of the Mining Claim of Jacob Pierson known as the Regular, Union, Dayland New York, Home-Well-Surplus + Wallace situate in Warren Mining District, Cochise County, Arizona, in Section Approximately in Township No. 23 S., Range No. 24 E. (unsurveyed) G. & A. R. B. & M and designated as Survey No. 1782, as represented in the foregoing field notes, which accurately show the boundaries of said mining claim as distinctly marked by monuments on the ground, and described in the attached copy of the location certificate, which was received by me from the Surveyor General with said instructions, and that all the corners of said survey have been established and perpetuated in strict accordance with the law, official regulations and instructions thereunder; and I do further solemnly swear that the foregoing are the true and original field notes of said survey and my report therein, and that the labor expended and improvements made upon said mining claim by claimant or grantors are as therein fully stated, and that the character, extent, location and itemized value thereof are specified therein with particularity and full detail, and that no portion of said labor or improvements so credited to this claim has been included in the estimate of expenditures upon any other claim.

Geo. C. Clark  
 U. S. Deputy Mineral Surveyor.

Subscribed and sworn to by the said Geo. C. Clark  
 U. S. Deputy Mineral Surveyor, before me  
 this 21<sup>st</sup>  
 day of September 1903

S. A. Merrill  
 Notary Public, in and for the  
 County of Cochise, Territory of Arizona  
 My Commission Expires Feb. 24, 1906

Notice of Mining Location.  
*Quartz Lode claim.*

To All Whom It may Concern:

This mining claim, the name of which is the *Surplus* Mining claim, situate on lands belonging to the United States of America, and in which there are valuable mineral deposits, was entered upon and located for the purpose of exploration and purchase by *Jacob Pirrung and Charley Strong* the undersigned, on the *27* day of *September* 1899. The length of this claim is *1500* feet and we claim *about 1400* feet in a *easterly* direction and *about 100* feet in a *westerly* direction from the center of the discovery shaft, at which this notice is posted, lengthwise of the claim, together with *300* feet in width of the surface grounds, on each side of the center of said claim, The general course of the lode deposit and premises is from the *N. W. to the S. E.*

The claim is situated and located in the Warren Mining District, in Cochise County, in the Territory of Arizona, about *1500 yards* in a *easterly* direction from *South Bisbee R.P. siding*

The surface boundaries of the claim are marked upon the ground as follows: Beginning at a point in a *westerly* direction *about 100* feet from the discovery shaft (at which this notice is posted), being in the center of the *west* end line of said claim; thence *300* feet to a *post*, being the *N. W.* corner of said claim; thence *750* feet to a *post* at the center of the *north* side line of said claim; thence *750* feet to a *post* being at the *N. E.* corner of said claim, thence *300* feet to a *post* at the center of the *east* end of said claim, thence *300* feet to a *post*, being at the *south east* corner of said claim; thence *750* feet to a *post* being at the center of the *south* side line of said claim; thence *750* feet to a *post* at the *S. W.* corner of said claim; thence *300* feet to the place of beginning.

All done under the provisions of Chapter Six, of Title XXII, of the Revised Statutes of the United States, and of an Act of the General Assembly of Arizona, entitled "An Act concerning Mines" approved March 20, 1895 and amended March 24, 1899. dated and posted on the ground this *27* day of *September* 1899.

*Jacob Pirrung  
Charley Strong.*

Filed and recorded at request of *Charley Strong* Nov 13<sup>th</sup> at 9 A.M. A.D. 1899 Book 17 page 239 Record of Mines



Witness my hand and seal of office at Prescott, Arizona, this 24th day of February 1905.

Territory of Arizona,  
County of Cochise.

I, Frank Hare, County Recorder in and for said county, hereby certify that I have compared the foregoing copy with the original location notice of the "Surplus" mining claim filed and recorded in my office on the 13 day of Nov. 1899 in Book 17 page 239 Record of Mines, and that the same is a full, true and correct copy of such original and of the whole thereof.

Witness my hand and seal of office, at this 24th day of February 1905.

Frank Hare  
County Recorder.

Notice of Mining Location.

~~Under Claim.~~

To All Whom It may Concern:

This mining claim, the name of which is the *Wallace* Mining claim, situate on lands belonging to the United States of America, and in which there are valuable mineral deposits, was entered upon and located for the purpose of exploration and purchase by

*Jacob Pirrung and Charley Strong.*  
the undersigned, on the *27* day of *September* 1899.

The length of this claim is \_\_\_\_\_ feet  
and we claim *about 600* feet in a *southerly*  
direction and *about 700* feet in a *northerly*  
direction from the center of the discovery shaft, at which this notice is posted, lengthwise of the claim, together with *300* feet  
in width of the surface grounds, on each side of the center of said claim,  
The general course of the lode deposit and premises is from the  
*N. W.* to the *S. E.*

The claim is situated and located in the Warren Mining District, in Cochise County, in the Territory of Arizona, about *1 mile*  
in a *S. E.* direction from *Town of Bisbee*

The surface boundaries of the claim are marked upon the ground as follows: Beginning at

at a point in a *northerly* direction *about 700* feet from  
the discovery shaft (at which this notice is posted), being in the corner  
of the *north* end line of said claim; thence *300*  
feet to a *post*, being the *N. E.* corner  
of said claim; thence *750* feet to a *post*  
at the center of the *east*  
side line of said claim; thence *750* feet to a  
*post* being at the *S. East* corner of  
said claim; thence *300* feet to a *post*  
at the center of the *south* end of said claim; thence *300*  
feet to a *post*, being at the  
*south west* corner of said claim; thence  
*750* feet to a *post* being  
at the center of the *west* side line of said claim; thence  
*750* feet to a *post* at the  
*N. W.* corner of said claim; thence *300*  
feet to the place of beginning.

All done under the provisions of Chapter Six, of Title XXXI, of the Revised Statutes of the United States, and of an Act of the General Assembly of Arizona, entitled "An Act concerning Mines" approved March 10, 1895 and amended March 24, 1899.

dated and posted on the ground this *27* day of *September* 1899

*Jacob Pirrung*  
*Charley Strong*

Filed and recorded at request of *C. Strong* Nov. 13th at *9 a.m.* A.D. 1899  
*Book 17 page 235 Record of Mines.*

Frank Hare County Recorder

Territory of Arizona,  
:SS.  
county of Cochise.

I, Frank Hare County Recorder in and for said county, hereby certify that I have compared the foregoing copy with the original location notice of the "Wallace" mining claim filed and recorded in my office on the 13 day of Nov, 1899 in Book 17 page 235 Record of Mines, and that the same is a full, true and correct copy of such original and of the whole thereof.

witness my hand and seal of office, ~~at~~ this 24th day of February 1903.

*Frank Hare*  
County Recorder.

AMENDED

# Notice of Mining Location.

LODE CLAIM.

To All Whom It May Concern:

This mining claim, the name of which is the Union Mining Claim, situate on lands belonging to the United States of America, and in which there are valuable mineral deposits, was entered upon and located for the purpose of exploration and purchase by Jacob Perry

(Locator must insert either "a citizen of the United States," or, "who has declared his intention to become a citizen of the United States.")  
the undersigned, on the 28th day of March 1901 1897

The length of this claim is 1050 feet  
and 100 claim feet  
in a westerly direction, and 950 feet  
feet in a northerly direction from  
the center of the discovery shaft, at which this notice is posted, lengthwise of the claim, together  
with 300 feet in width of the surface grounds, on each  
side of the discovery monument of said claim. The general course of the lode deposit and prem-  
ises is from the East to the West

The claim is situated and located in the Warren Mining District, in  
Cochise County, in the Territory of Arizona, about 2 miles  
in a southeasterly direction from the town of Picher  
one N by Boundary & Home south by Junction  
one S by Wayland, N.Y. one E by Rebel

The surface boundaries of the claim are marked upon the ground as follows: Beginning at  
a monument  
at a point in a westerly direction 100 feet from  
the discovery shaft (at which this notice is posted), being in the center of the W  
end line of said claim; thence southerly 300 feet to a post  
being the S.W corner of said claim; thence  
easterly 1050 feet to a post, being  
at the SE corner of said claim; thence northerly 15 feet  
to a monument at the center of the E end of said  
claim; thence westerly 15 feet to a monument, being  
at the NE corner of said claim; thence westerly 1050  
feet to a post at the NW corner of said  
claim; thence southerly 300 feet to place of beginning.

All done under the provisions of Chapter Six, of Title XXXII, of the Revised Statutes of  
the United States, and an Act of the General Assembly of Arizona, entitled "An Act to Revise  
and Codify the Laws of the Territory of Arizona," approved March 16, 1901.

This is an Amended Location Notice of the Union  
Mining Claim, located by Jacob Perry  
on the 28th day of  
March 1897 1901, and recorded in Book 14 of Records of Mines, at  
page 248, in the office of the County Recorder of the aforesaid County of Cochise  
to which reference is hereby made, and this Amended Location Notice is made and posted to  
correct errors in the description in the said original Location Notice.

Dated and posted on the ground this 8th day of July 1901 3  
Jacob Perry

TERRITORY OF ARIZONA, }  
County of Cochise } ss.

I, Frankston, County Recorder in and for the County and Territory aforesaid, do hereby certify that the within instrument was filed for record at 9 o'clock 9 M., on this 15<sup>th</sup> day of July, 1902, and duly recorded in Book No. 21 of Mining Records of Cochise County, Arizona, at pages 548

WITNESS my hand and official seal the day and year first above written.

Frankston  
County Recorder.

AMENDED  
Notice of Location.  
LODE CLAIM.

Dated 1902

Filed and recorded at the request of

W. C. Clark

July 15<sup>th</sup> A. D., 1902

at 9 M.

Book 21 Rec. of Mining

Page 548-549

Frankston  
County Recorder.

By Frankston  
Deputy Recorder.

THE H. H. MCNEIL CO., PRINTERS, PHOENIX, ARIZ.

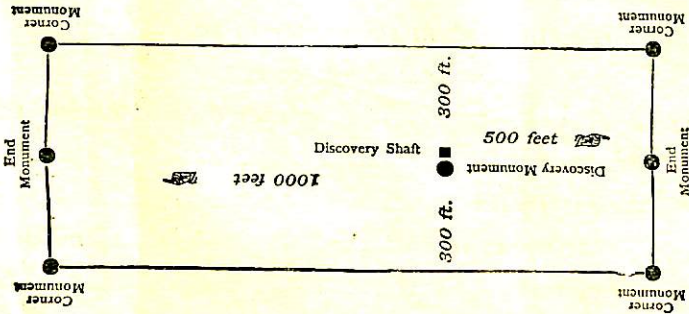

This diagram is to give locator a general idea of plan of location under the new law. The Discovery Shaft can be in the center of claim or any distance from either end desired. In the diagram it is placed 500 feet from one end and 1000 feet from the other. Commence description of claim at a center end monument, giving its distance and direction from center of Discovery Shaft; thence bound the claim in either direction. In description be careful to state locality of claim with reference to some natural object, or permanent monument, as will identify the claim.

AMENDED

# Notice of Mining Location.

LODE CLAIM.

To All Whom It May Concern:

This mining claim, the name of which is the Wayland, New York Mining Claim, situate on lands belonging to the United States of America, and in which there are valuable mineral deposits, was entered upon and located for the purpose of exploration and purchase by Jacob Furrung

(Locator must insert either "a citizen of the United States," or, "who has declared his intention to become a citizen of the United States.")  
the undersigned, on the 16th day of April 1896.

The length of this claim is 1100 feet  
and 9 claim 270 feet  
in a westerly direction, and 730 feet  
in a westerly direction from  
the center of the discovery shaft, at which this notice is posted, lengthwise of the claim, together with 275 feet in width of the surface grounds, on each side of the discovery monument of said claim. The general course of the lode deposit and premises is from the East to the West

The claim is situated and located in the Warren Mining District, in Cochise County, in the Territory of Arizona, about 1/2 mile in a northerly direction from The town of Bisbee and is bounded on N by Union, on E by Judcah, on S by Regular, on W by Pay Day.

The surface boundaries of the claim are marked upon the ground as follows: Beginning at a Monument

at a point in a westerly direction 730 feet from the discovery shaft (at which this notice is posted), being in the center of the West end line of said claim; thence northerly 275 feet to a post, being the NW corner of said claim; thence easterly 1100 feet to a post, being at the NE corner of said claim; thence southerly 50 feet to a monument at the center of the East end of said claim; thence southerly 50 feet to a monument, being at the SE corner of said claim; thence westerly 1100 feet to a post at the SW corner of said claim; thence northerly 275 feet to place of beginning.

All done under the provisions of Chapter Six, of Title XXXII, of the Revised Statutes of the United States, and an Act of the General Assembly of Arizona, entitled "An Act to Revise and Codify the Laws of the Territory of Arizona," approved March 16, 1901.

This is an Amended Location Notice of the Wayland, New York Mining Claim, located by Jacob Furrung on the 16th day of April, 1896, and recorded in Book 14 of Records of Mines, at page 40, in the office of the County Recorder of the aforesaid County of Cochise to which reference is hereby made, and this Amended Location Notice is made and posted to correct errors in the description in the said original Location Notice.

Dated and posted on the ground this 17th day of July 1903.  
Jacob Furrung

TERRITORY OF ARIZONA,  
County of Cochise ss.

I, Frank H. Starnes, County Recorder in and for the County and Territory aforesaid, do hereby certify that the within instrument was filed for record at 9 o'clock 9 M., on this 15<sup>th</sup> day of July, 1903, and duly recorded in Book No. 21 of Mining Records of Cochise County, Arizona, at pages 542

WITNESS my hand and official seal the day and year first above written.

Frank H. Starnes  
County Recorder.

AMENDED  
**Notice of Location.**  
LODE CLAIM.

Dated 1903

Filed and recorded at the request of

Geo. C. Clark

July 16<sup>th</sup> A. D., 1903  
at 9 M.

Book 21 - Record of Mines.

Page 542-543  
Frank H. Starnes

County Recorder.

By Frank H. Starnes  
Deputy Recorder.

THE H. H. MCNEIL CO., PRINTERS, PHOENIX, AR. J.N.A.

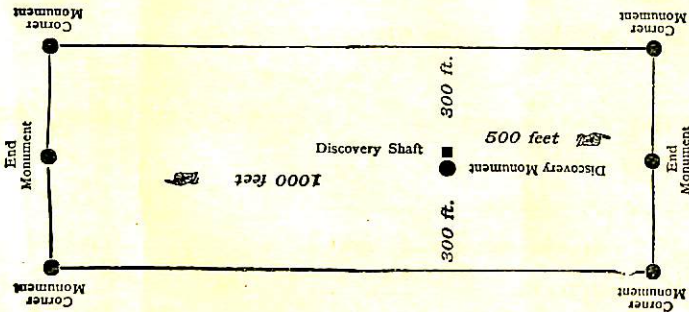

This diagram is to give locator a general idea of plan of location under the new law. The Discovery Shaft can be in the center of claim or any distance from either end desired. In the diagram it is placed 500 feet from one end and 1000 feet from the other. Commence description of claim at a center end monument, giving its distance and direction from center of Discovery Shaft; thence bound the claim in either direction. In description be careful to state locality of claim with reference to some natural object, or permanent monument, as will identify the claim.

AMENDED  
Notice of Mining Location.  
LODE CLAIM.

To All Whom It May Concern:

This mining claim, the name of which is the Well  
Mining Claim, situate on lands belonging to the United States of America, and in which there are  
valuable mineral deposits, was entered upon and located for the purpose of exploration and  
purchase by Jacob Perry

(Locator must insert either "a citizen of the United States," or, "who has declared his intention to become a citizen of the United States.")  
the undersigned, on the 27th day of Nov. 1901 1899

The length of this claim is 1500 feet  
and 9 claim 10 feet  
in a northwesterly direction, and 1490  
feet in a southeasterly direction from  
the center of the discovery shaft, at which this notice is posted, lengthwise of the claim, together  
with 150 feet in width of the surface grounds, on each  
side of the discovery monument of said claim. The general course of the lode deposit and prem-  
ises is from the N.W. to the S.E.

The claim is situated and located in the Warren Mining District, in  
Cochise County, in the Territory of Arizona, about 2 miles  
in a southeasterly direction from the town of Bunker  
on N by Regular, on W by Rich Co. by  
on S by Fashion, on E by General

The surface boundaries of the claim are marked upon the ground as follows: Beginning at

the monument  
at a point in a northwesterly direction 10 feet from  
the discovery shaft (at which this notice is posted), being in the center of the N  
end line of said claim; thence southwesterly 150 feet to a post  
NW, being the NW corner of said claim; thence  
southeasterly 1500 feet to a post, being  
at the SW corner of said claim; thence northwesterly 150 feet  
to a monument at the center of the S end of said  
claim; thence northeasterly 150 feet to a post, being  
at the SE corner of said claim; thence northwesterly 1500  
feet to a post at the NE corner of said  
claim; thence southwesterly 150 feet to place of beginning.

All done under the provisions of Chapter Six, of Title XXXII, of the Revised Statutes of  
the United States, and an Act of the General Assembly of Arizona, entitled "An Act to Revise  
and Codify the Laws of the Territory of Arizona," approved March 16, 1901.

This is an Amended Location Notice of the Well  
Mining Claim, located by Jacob Perry & Charles  
Strom on the 27th day of  
November 1901, and recorded in Book 17 of Records of Mines, at  
page 238, in the office of the County Recorder of the aforesaid County of Cochise  
to which reference is hereby made, and this Amended Location Notice is made and posted to  
correct errors in the description in the said original Location Notice.

Dated and posted on the ground this 5th day of July 1901

Jacob Perry



TERRITORY OF ARIZONA,

County of Cochise ss.

I, Frank Stewart, County Recorder in and for the County and

Territory aforesaid, do hereby certify that the within instrument was filed for record at 9 o'clock A M.,

on this 15<sup>th</sup> day of July 1903, and duly recorded in Book No. 21

of Mining Records of Cochise County, Arizona, at pages 540

WITNESS my hand and official seal the day and year first above written.

Frank Stewart  
County Recorder.

AMENDED

# Notice of Location.

LODE CLAIM.

Dated 1903

Filed and recorded at the request of

Ed Clark

at July 15<sup>th</sup> A. D., 1903

at 9 A M.

Book 21, Record of Mines,

Page 541-541

Frank Stewart  
County Recorder.

By Frank Stewart  
Deputy Recorder.

THE H. H. MCNEIL CO., PRINTERS, PHOENIX, ARIZ.

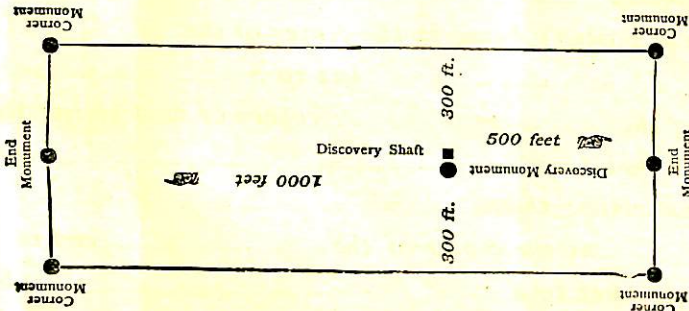

This diagram is to give locator a general idea of plan of location under the new law. The Discovery Shaft can be in the center of claim or any distance from either end desired. In the diagram it is placed 500 feet from one end and 1000 feet from the other. Commence description of claim at a center end monument, giving its distance and direction from center of Discovery Shaft; thence bound the claim in either direction. In description be careful to state locality of claim with reference to some natural object, or permanent monument, as will identify the claim.

AMENDED

# Notice of Mining Location.

LODE CLAIM.

To All Whom It May Concern:

This mining claim, the name of which is the Regular Mining Claim, situate on lands belonging to the United States of America, and in which there are valuable mineral deposits, was entered upon and located for the purpose of exploration and purchase by Jacob Pirrung

(Locator must insert either "a citizen of the United States," or, "who has declared his intention to become a citizen of the United States.") the undersigned, on the 26th day of March 1901.

The length of this claim is 1250 feet and 2 claim 250 feet in a southwesterly direction, and 1000 feet in a northeasterly direction from the center of the discovery shaft, at which this notice is posted, lengthwise of the claim, together with 300 feet in width of the surface grounds, on each side of the discovery monument of said claim. The general course of the lode deposit and premises is from the southwest to the northeast.

The claim is situated and located in the Warren Mining District, in Cochise County, in the Territory of Arizona, about 9 miles in a southeasterly direction from the town of Bisbee on N by Wayland N.Y. on W by Lay Dawson S by Highland Well, Grand American, and by Judeah's

The surface boundaries of the claim are marked upon the ground as follows: Beginning at a monument

at a point in a southwesterly direction 250 feet from the discovery shaft (at which this notice is posted), being in the center of the NW end line of said claim; thence northwesterly 300 feet to a monument, being the NW corner of said claim; thence northeasterly 1250 feet to a post, being at the NE corner of said claim; thence southeasterly 290 feet to a monument at the center of the E end of said claim; thence southeasterly 290 feet to a post, being at the SE corner of said claim; thence southwesterly 1250 feet to a post at the SW corner of said claim; thence northwesterly 300 feet to place of beginning.

All done under the provisions of Chapter Six, of Title XXXII, of the Revised Statutes of the United States, and an Act of the General Assembly of Arizona, entitled "An Act to Revise and Codify the Laws of the Territory of Arizona," approved March 16, 1901.

This is an Amended Location Notice of the Regular Mining Claim, located by Jacob Pirrung on the 26th day of March 1901, and recorded in Book 14 of Records of Mines, at page 247, in the office of the County Recorder of the aforesaid County of Cochise to which reference is hereby made, and this Amended Location Notice is made and posted to correct errors in the description in the said original Location Notice.

Dated and posted on the ground this 8th day of July 1901.

Jacob Pirrung

TERRITORY OF ARIZONA, }  
County of Cochise } ss.

I, Frank H. McNeil, County Recorder in and for the County and Territory aforesaid, do hereby certify that the within instrument was filed for record at 9 o'clock A. M., on this 15<sup>th</sup> day of July 1902, and duly recorded in Book No. 21 of McNeil Records of Cochise County, Arizona, at pages 544

WITNESS my hand and official seal the day and year first above written.

Frank H. McNeil  
County Recorder.

AMENDED  
**Notice of Location.**  
LODE CLAIM.

Dated 1902

Filed and recorded at the request of

George A. Blain

July 15<sup>th</sup>  
A. D., 1902

at 9 M.

Book 21 Record of Mines.

Page 544-545.

Frank H. McNeil

County Recorder.

By Frank H. McNeil  
Deputy Recorder.

THE H. H. MCNEIL CO., PRINTERS, PHOENIX, ARIZ.

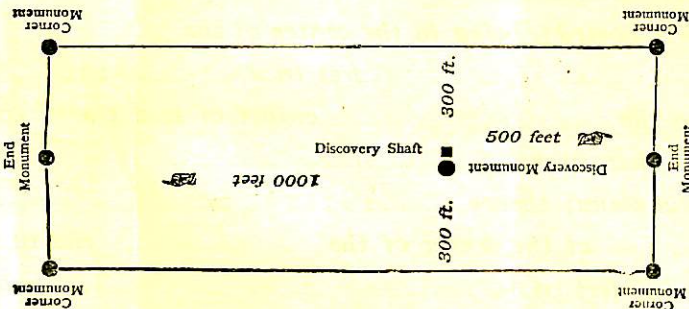

This diagram is to give locator a general idea of plan of location under the new law. The Discovery Shaft can be in the center of claim or any distance from either end desired. In the diagram it is placed 500 feet from one end and 1000 feet from the other. Commence description of claim at a center end monument, giving its distance and direction from center of Discovery Shaft; thence bound the claim in either direction. In description be careful to state locality of claim with reference to some natural object, or permanent monument, as will identify the claim.

AMENDED

# Notice of Mining Location.

LODE CLAIM.

To All Whom It May Concern:

This mining claim, the name of which is the Home Mining Claim, situate on lands belonging to the United States of America, and in which there are valuable mineral deposits, was entered upon and located for the purpose of exploration and purchase by Jacob Curran

(Locator must insert either "a citizen of the United States," or, "who has declared his intention to become a citizen of the United States.") the undersigned, on the 12th day of Nov 1901 1897

The length of this claim is 1500 feet and 9 claim 700 feet in a westerly direction, and 800 feet in a westerly direction from the center of the discovery shaft, at which this notice is posted, lengthwise of the claim, together with 220 feet in width of the surface grounds, on each side of the discovery monument of said claim. The general course of the lode deposit and premises is from the East to the West

The claim is situated and located in the Warren Mining District, in Cochise County, in the Territory of Arizona, about 1 1/2 miles in a southeasterly direction from the town of Bisbee

bounded on N by Baras + Belvidere, on E by East Rose, on S by New Castle + Queen of the Moon, on W by Union

The surface boundaries of the claim are marked upon the ground as follows: Beginning at

a monument at a point in a westerly direction 700 feet from the discovery shaft (at which this notice is posted), being in the center of the E end line of said claim; thence northerly 15 feet to a monument, being the NE corner of said claim; thence westerly 1500 feet to a post, being at the N.W. corner of said claim; thence southerly 220 feet to a monument at the center of the W end of said claim; thence southerly 220 feet to a post, being at the SW corner of said claim; thence easterly 1500 feet to a monument at the SE corner of said claim; thence northerly 15 feet to place of beginning.

All done under the provisions of Chapter Six, of Title XXXII, of the Revised Statutes of the United States, and an Act of the General Assembly of Arizona, entitled "An Act to Revise and Codify the Laws of the Territory of Arizona," approved March 16, 1901.

This is an Amended Location Notice of the Home Mining Claim, located by Jacob Curran on the 12th day of Nov 1897 1901, and recorded in Book 14 of Records of Mines, at page 477, in the office of the County Recorder of the aforesaid County of Cochise to which reference is hereby made, and this Amended Location Notice is made and posted to correct errors in the description in the said original Location Notice.

Dated and posted on the ground this 8th day of July 1903

Jacob Curran

TERRITORY OF ARIZONA,

County of Cochise ss.

I, Frank H. H. [unclear], County Recorder in and for the County and Territory aforesaid, do hereby certify that the within instrument was filed for record at 9 o'clock 9 M., on this 21 day of July, 1903, and duly recorded in Book No. 21 of Murray Records of Cochise County, Arizona, at pages 546

WITNESS my hand and official seal the day and year first above written.

Frank H. H. [unclear]  
County Recorder.

AMENDED  
Notice of Location.  
LODE CLAIM.

Dated 1903

Filed and recorded at the request of

Ed. C. Clark

July 15<sup>th</sup> A. D., 1903

at 9 M.

Book 21-Rec. of Mines-

Page 546-547

Frank H. H. [unclear]  
County Recorder.

By [Signature]  
Deputy Recorder.

THE H. H. WHEEL CO., PRINTERS, PHOENIX, ARIZ.

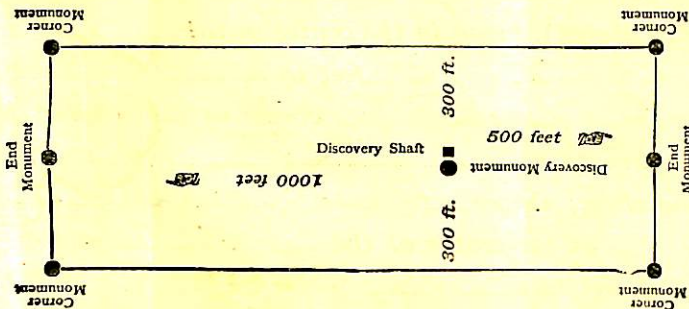

This diagram is to give locator a general idea of plan of location under the new law. The Discovery Shaft can be in the center of claim or any distance from either end desired. In the diagram it is placed 500 feet from one end and 1000 feet from the other. Commence description of claim at a center end monument, giving its distance and direction from center of Discovery Shaft; thence bound the claim in either direction. In description be careful to state locality of claim with reference to some natural object, or permanent monument, as will identify the claim.

SURVEYOR-GENERAL'S CERTIFICATE OF APPROVAL OF FIELD NOTES AND SURVEY OF MINING CLAIM.

Department of the Interior.

Office of U. S. Surveyor-General,

Phoenix, Arizona

Jan. 23, 1903

I, U. S. Surveyor-General for Arizona

do hereby certify that the foregoing and hereto attached Field Notes and Return of the Survey of the Mining Claim of Jacob Pirrung

Regular, Union, Wayland New York, Home, Well, Surplus, & Wallace situate in Warren mining district, Cochise County, Arizona

in Section Approx., Township No. 23 E., Range No. 24 E. (unsurveyed) G & S. R. E. & M., designated as Survey No. 1782

executed by Geo. C. Clark, U. S. Deputy Mineral Surveyor, Sept. 11th-17th, 1903, under my instructions dated

Sept. 10th, 1903, have been critically examined and the necessary corrections and explanations made, and the said Field Notes and Return, and the Survey they describe, are hereby approved. A true copy of the copy of the location certificate filed by the applicant for survey is included in the field notes.

Frank S. Ingalls U. S. Surveyor-General for Arizona

JUL 29 1905

AUG 12 1905

copied by count  
8/31/05

(4-683.)

Mineral Survey No. 1782 Amended

Lot No. \_\_\_\_\_

Gila Land District.

FIELD NOTES

OF THE SURVEY OF THE MINING CLAIM OF

Jacob Pirrung

J.M. O'Connell Atty for Claimant

KNOWN AS THE

Surplus Amended

Warren Mining District,

Cochise County, Arizona

Section Approx., Township 23 S, Range 24 E ~~25 E~~ unsurveyed

Surveyed under instructions dated May 18, 1905.

by Franklin W. Smith  
U. S. Deputy Mineral Surveyor

Claim located see location notice 1 July 27 1905

Survey commenced July 5, 1905

Survey completed " 6, 1905

J. M. O'Connell  
Bisbee, Cochise County Arizona  
Claimants Atty

Field  
Log  
Area

No reference to old survey ✓

MANO