

MS
-

0

1

7

9

4

MINERAL SURVEY NO. 1794			
Claims	M & B Desc.	Improvements	Loc. Notices
Calumet	15	18	10
Cherokee	7	19	8
Congress	2	20	9
Grenfell	14	18	1
Keating	1	18	6
Leland Stanford	3	20	3
Logan	13	19	4
Paymaster	4	20	5
Red Jacket	6	20	2
Senator	12	19	7
Shattuck	11	19	11
Worlds Fair	9	17	12

four copies
of

(4-683.)

Mineral Survey No. 1794

Lot No.

C. T. L.

Land District.

FIELD NOTES

OF THE SURVEY OF THE MINING CLAIM OF

F. C. Shattuck

KNOWN AS THE

Leaning; Congress; Seland Stanford; Paymaster; Red Jacket; Calumet;
Wards Fair; Cherokee; Shattuck; Senator; Bushell and Logan
Warren Mining District,

Cochise County, Arizona

Section Approximately Township N^o 23 S, Range N^o 24 E (un-surveyed)

Surveyed under instructions dated August 29th, 1903

by Geo. C. Clark,
U. S. Deputy Mineral Surveyor.

Claim located See Location Certificate

Survey commenced August 30th, 1903

Survey completed September 6th, 1903

o 6-180

Claimants Address

Bushell, Cochise Co. Arizona

PRELIMINARY OATHS OF ASSISTANTS IN SURVEY OF MINING CLAIM.

We, H. D. Hannah and Geo. Nelson,

do solemnly swear that we will well and faithfully execute the duties of chain carriers; that we will level the chain upon even and uneven ground and plumb the tally-pins, either by sticking or dropping the same; that we will report the true distance to all notable objects, and the true length of all lines that we assist in measuring, to the best of our skill and ability, and in accordance with instructions

given us, in the survey of the Mining Claim of S. C. Shattuck
known as the: Kestig; Coquest; Deland Stanford; Paymaster,
Red Jacket; Calumet; Wards Fair; Cherokee; Shattuck
known as the: Lenata; Grenfell + Logan

situate in Warren mining district

Cochise County, Arizona

in Section , Township No. , Range No. unsurveyed

H. D. Hannah, Chairman.
Geo. E. Nelson Chairman.

Subscribed and sworn to by the above-named persons before me this 30th day of August, 1903

B. H. Williams

NOTARY PUBLIC
COCHISE COUNTY, ARIZONA TERR.
MY COMMISSION EXPIRES NOV. 30 1904

I, , do solemnly swear that I will well and truly perform the duties of axman, in the establishment of corners and other duties, according to instructions given me and to the best of my skill and ability, in the survey of the Mining Claim of

known as the
more fully described in the preceding affidavit.

 , Axman.

Subscribed and sworn to by the said

 before me this day of , 190

I, , do solemnly swear that I will well and truly perform the duties of flagman, in the establishment of corners and other duties, according to instructions given me and to the best of my skill and ability, in the survey of the Mining Claim of

known as the
more fully described in the preceding affidavit.

 , Flagman.

Subscribed and sworn to by the said

 before me this day of , 190

Feet.

Survey No. 1794.

-----KEATING-----

Beginning at cor No.1 the S.W.cor identical with location and with cor No.2 Congress Lode of this survey, a pine post 4 ft long 4 ins square set 1 ft in the ground in a mound of stones and scribed 1-1794 K.L. whence a quartzite cropping 2 ft high chiseled X 1-2-1794 B.R. brs S. 85°40'E. 66.9 ft and U.S.M.M.No.4 brs N.87°34'W. 7191 ft.

Thence N.21°01'E.

300.0 to original location for W. end center.

600.0 same bearing to cor No.2 the N.W. cor identical with location, a pine post 4 ft long 4 ins square set 1 ft in the ground in a mound of stones and scribed 2-1794 K.L., whence a rock in place 1 X 1 X 2 ft chiseled X 2-1794 B.R. brs N. 12°30'E. 49.5 ft.

Thence S.76°03'E

1105.1 to intersection line 1 - 2 Calumet Lode of this survey at S. 01°25'W. 158.1 ft from cor No.2.

1500.0 same bearing to cor No.3 the N.E. cor identical with location, a pine post 4 ft long 4 ins square set 1 ft in the ground in a mound of stones and scribed 3-1794 K.L., whence a rock in place 1 X 2 X 3 ft chiseled X 3-1794 B.R. brs S. 50°20'E. 68 ft.

Thence S. 21°01'W,

300.0 to original location for E. end center.

328.5 same bearing to intersection line 4 - 1 Calumet Lode of this survey at N.81°48'E. 279.3 ft from cor No.1.

600.0 same bearing to cor No.4 the S.E. cor identical with location and with cor No.3 Congress Lode of this survey, a pine post 4 ft long 4 ins square set 1 ft in the ground in a mound of stones and scribed 4-1794 K.L. whence a pine post of same dimensions scribed W.C.S-4-1794 brs N.21°01'E. 50 ft, and a pine post of same dimensions and scribing brs S. 21°01'W. 50 ft. No other bearing monuments available.

Thence N.76°03'W.

Feet

Survey No.1794.

1500.0 to cor No.1 the place of beginning.

-----LEDGE-----

The presumed course of the vein on this claim is from the E. end center of location N.76°03'W. 1500 ft.

-----o-----o-----

---CONGRESS LODE---

Survey No.1794.

Beginning at cor No.1 the S.W. cor identical with location and with cor No.2 Leland Stanford a claim of this survey, a pine post 4 ft long 4 ins square set 1ft in the ground in a mound of stones and scribed 1-1794 C.L., whence a pine post of same dimensions scribed W.C.1-1794 brs N. 76°03'W. 50 ft. and a second post of same dimensions and scribing brs S. 76°03'E. 50 ft and U.S.M.M.No.4 brs N.82°55'30"W. 7023 ft.

Thence N.21°01'E.

300.0 to original location for W. end center.

600.0 same bearing to cor No.2 the N.W. cor identical with location and with cor No.1 Keating Lode of this survey a pine post &c scribed 2-1794 C.L.

Thence S. 76°03'E.

1500.0 to cor No.3 the N.E. cor identical with cor No.4 Keating Lode of this survey, a pine post &c scribed 3-1794 C.L.

Thence S.21°01'W.

300.0 to original location for E. end center.

600.0 same bearing to cor No.4 the S.E. cor identical with location and with cor No.3 Leland Stanford Lode of this survey, a pine post 4 ft long 4 ins square set 1 ft in the ground in a mound of stones and scribed 4-1794 C.L., whence a rock in place level with the surface 2 X 3 ft chiseled X 3-4-1794 B.R. brs N.45°30'W 91 ft.

Feet.

Survey No. 1794.

Thence N.76°03'W.

1500.0 to cor No. 1 the place of beginning.

-----LEDGE-----

The presumed course of the ledge on this claim is from the E. end center of location N.76°03'W. 1500 ft.

-----OOO-----

-----LILLAND STANFORD-----

Survey No. 1794.

Beginning at cor No. 1 the S.W. cor identical with location, a pine post 4 ft long 4 ins square set 1 ft in the ground in a mound of stones and scribed 1-1794 L.S.L., whence a pine post of same dimensions scribed W.C. 1-1794 brs N. 76°03'W. 73 ft and a pine post of same dimensions and scribing brs S. 76°03'E. 50 ft, and U.S.M.M.No. 4 brs N.78°05'W. 6902.8 ft. No other bearing monument available.

Thence N.21°01'E.

300.0 to original location for W. end center.

600.0 same bearing to cor No. 2 the N.W. cor identical with location and with cor No. 1 Congress Lode of this survey, a pine post &c scribed 2-1794 L.S.L.

Thence S.76°03'E.

1500.0 to cor No. 3 the N.E. cor identical with location and with cor No. 4 Congress Lode of this survey, a pine post &c scribed 3-1794 L.S.L.

Thence S.21°01'W.

300.0 to original location for E. end center.

542.74 same bearing to intersection line 1-2 Cherokee Lode of this survey at S.84°03'E. 136.15 ft from cor No. 1

600.0 same bearing to cor No. 4 the S.E. cor identical with location, a pine post 4 ft long 4 ins square set 1 ft in the ground in a mound of stones and scribed 4-1794

Feet.

Survey No. 1794.

L.S.L., whence a pine post of same dimensions scribed
W.C. 1-4-1794 brs N. 21° 01' E. 57.3 ft and a pine post of
same dimensions and scribing brs S. 21° 01' W 50 ft. No
other bearing monument available.

Thence N. 76° 03' W.

123.0 to cor No. 2 Paymaster Lode of this survey on line 7-1
Cherokee Lode of this group at S. 6° 52' W. 38.1 ft from
cor No. 1.

1500.0 same bearing to cor No. 1 the place of beginning.

-----LEDGE-----

The presumed course of the vein on this claim
is from the E. end center of location N. 76° 03' W. 1500 ft.

-----OOO-----

-----PAYMASTER-----

Survey No. 1794.

Beginning at cor No. 1 the N.W. cor identical with
location, a pine post 4 ft long 4 ins square set 1 ft
in the ground in a mound of stones and scribed 1-1794
P.L., whence a pine post of same dimensions scribed
W.C. 1-1794 brs S. 76° 03' E. 50 ft, and a pine post of
same dimensions and scribing brs N. 76° 03' W. 50 ft, and
U.S.M.M. No. 4 brs N. 78° 07' W. 6780 ft. No other bearing
monument available.

Thence S. 76° 03' E.

123.0 To cor. No. 1 LELAND STANFORD, CL claim of this survey
1500.0 to cor No. 2 identical with location, a pine post 4 ft

long 4 ins square set 1 ft in the ground in a mound of
stones and scribed 2-1794 P.L., whence a pine post of
same dimensions scribed W.C. 1-2-1794 brs N. 6° 52' E.

50 ft and a second post of same dimensions and scribing
brs S. 6° 52' W. 50 ft. No other bearing monument avail-
able.

Thence S. 6° 52' W.

Feet.

Survey No. 1794.

300.0 to original location for E. end center.

600.0 same bearing to cor No. 3 the S.E. cor identical with location and with cor No. 7 Cherokee Lode of this survey and the N.E. cor unsurveyed William Lode, a pine post 4 ft long 4 ins square set 1 ft in the ground in a mound of stones and scribed 3-1794 P.L., whence a rock in place 1 ft high 2 ft square chiseled X 3-7-1794 B.R. brs N. 8°25'W. 39.5 ft.

Thence N. 78°03'W.

1500.0 to cor No. 4 the S.W. cor identical with location, a pine post 4 ft long 4 ins square set 1 ft in the ground in a mound of stones and scribed 4-1794 P.L., whence a conglomerate cropping chiseled X 4-1794 B.R. brs N. 74°36'E. 37.9 ft.

Thence N. 6°52'E.

300.0 to original location for W. end center.

600.0 same bearing to cor No. 1 the place of beginning.

-----LEDGE-----

The presumed course of the ledge on this claim is from the E. end center of location N. 78°03'W. 1500 ft.

-----000-----

Feet

Survey No. 1794.

-----RED JACKET-----

Beginning at cor No. 1 the N.W. cor identical with location a pine post 4 ft long 4 ins. square, set 1 ft in the ground in a mound of stones and scribed 1 - 1794 R. J. L., whence a rock in place level with the surface 2 ft square chiseled X 1 - 1794 B.R. brs S. $32^{\circ}54'E$. 72.8 ft and U. S. M.M. No. 4 brs N. $69^{\circ}17'W$. 7063 ft.

Thence S. $82^{\circ}33'E$.

41.8 to intersection line 3 - 4 Judeah Lode No. 1585 at S. $29^{\circ}35'W$. 343.8 ft from cor No. 4.

1490.8 same bearing to cor No. 3 the N.E. cor identical with location and with cor No. 6 Cherokee Lode of this survey and with the S.E. cor unsurveyed William Lode, a pine post 4 ft long 4 ins square set 1 ft in the ground in a mound of stones and scribed 2 - 1794 R.J.L., whence a rock in place 1 X 2 X 2 ft chiseled X 2 - 6 - 1794 B.R. brs N. $84^{\circ}25'E$. 91.7 ft.

Thence S. $19^{\circ}10'W$.

216.2 to original location for E. end center.

454.12 same bearing to intersection line 4 - 1 Bodey Lode survey No. 1793 at S. $75^{\circ}04'6''E$. 217.86 ft from cor No. 1.

513.2 same bearing to cor. No 3 the S.E. cor identical with location and with cor No. 5 Cherokee Lode of this survey, a pine post 4 ft long 4 ins square set 1 ft in the ground in a mound of stones and scribed 3 - 1794 R.J.L. whence a conglomerate cropping 6 ins high 2 X 3 ft scribed 3 - 5 - 1794 B.R. brs N. $15^{\circ}25'E$. 75 ft.

Thence N. $84^{\circ}08'W$.

232.56 to intersection line 1 - 2 Bodey survey No. 1793 at S. $24^{\circ}39'W$. 97.27 ft from cor No. 1, intersection is identical with cor No. 4 William J. Bryan Lode survey No. 1793.

366.22 same bearing to intersection line 1 - 2 William J. Bryan

Feet

Survey No. 1794.

Lode survey No. 1793 at S. $24^{\circ}39'$ W. 93.65 ft from cor No.1, intersection is identical with N.E. cor unsurveyed Sophy Lode.

1500.0 same bearing to cor No.4 the S.W. cor identical with location and with the N.W. cor unsurveyed Sophy Lode, a pine post 4 ft long 4 ins square set 1 ft in the ground in a mound of stones and scribed 4-1794 R.J.L. whence a rock in place 1 X 2 X 2 ft chiseled X4 -1794 B.R. brs N. $40^{\circ}35'E$. 97.6 ft.

Thence N. $19^{\circ}10'E$.

300.0 to original location for W. end center.

385.34 to intersection line 3 - 4 Judeah survey No.1585 at N. $29^{\circ}35'E$. 29.33 ft from cor No.3.

558.5 same bearing to cor No.1 the place of beginning.

-----LEDGE-----

The presumed course of the vein on this claim is from the E. end center of location N. $84^{\circ}08'W$. 1500 ft.

-----OOO-----

-----CHEROKEE-----

Survey No. 1794.

Beginning at cor No.1 the N.W. cor identical with location a pine post 4 ft long 4 ins square set 1 ft in the ground in a mound of stones and scribed 1 - 1794 C.L., whence a pine post of same dimensions scribed W.C. 1-2-1794 brs N. $6^{\circ}52'E$. 11.9 ft and a pine post of same dimensions and scribing brs S. $6^{\circ}52'W$. 88.1 ft and U.S.M.M. No.4 brs N. $73^{\circ}01'W$. 8276 ft. No other bearing monument available.

Thence S. $84^{\circ}08'E$.

136.15 to intersection line 3-4 Leland Stanford Lode of this survey, at N. $21^{\circ}01'E$. 57.33 ft from cor No.4 to intersection line 1-2 Worlds Fair Lode of this survey at N. $21^{\circ}01'E$. 85.50 ft from cor No.1.

Feet

Survey No. 1794.

240.0 same bearing to original location for N. end center.

448.4 same bearing to cor No.2 the N.E. cor identical with location and with the S. end center Worlds Fair Lode of this survey, a pine post 4 ft long 4 ins square set 1 ft in the ground in a mound of stones and scribed 2-1794 C.L., whence a pine post of same dimensions scribed W. C. 1-2-1794 brs N. 9°55'E. 50 ft and a pine post of same dimensions scribed W.C.2-1794 brs S.9°55'W. 50 ft. No other bearing monuments available.

Thence S. 9°55'W.

902.1 to cor No.3 identical with cor No.1 Rabbit Lode No.1795 a pine post 4 ft long 4 ins square set 1 ft in the ground in a mound of stones and scribed 3-1794 C.L., whence a rock in place level with the surface 3 X 5 ft chiseled X 3 - 4 - 1794 B.R. brs N. 9°55'E. 66.5 ft.

Thence S. 12°47'W.

562.67 to intersection line 4-1 Bodey Lode survey No.1793 at N.75°46' W. 60.62 ft from cor No.4.

575.0 same bearing to cor No.4 the S.E. cor identical with cor No.2 Rabbit Lode survey No.1795, a pine post 4 ft long 4 ins square set 1 ft in the ground in a mound of stones and scribed 4-1794 C.L., whence original location identical with cor No.4 Bodey survey No.1793 brs S. 87°19'E. 61.56 ft. and a rock in place 1 X 1 X 4 ft chiseled X4-1794 B.R. brs N. 36°55'W. 201.3 ft.

Thence N. 84°08'W.

200.0 to original location for S. end center.

340.3 same bearing to cor No.5 the S.W. cor identical with location and with cor No.3 Red Jacket Lode of this survey, a pine post &c scribed 5-1794 C.L.

Thence N. 19°10'E.

62.08 to intersection line 4-1 Bodey survey No.1793 at S. 75°46' E. 217.86 ft from cor No.1.

Feet Survey No. 1794.

516.2 same bearing to cor No.6 identical with cor No.2 Red Jacket Lode of this survey and with the S.E. cor un-surveyed William claim, a pine post &c scribed 6-1794 C.L.

Thence $N10^{\circ}54'W$.

345.0 to cor No.7 identical with cor No.3 Paymaster Lode of this survey and with the N.E. cor un-surveyed William Lode, a pine post &c scribed 7-1794 C.L.

Thence $N.6^{\circ}52'E$.

600.0 to cor No.2 Paymaster Lode of this survey on line 4-1 Leland Stanford of this group at $N. 76^{\circ}03'W$. 128 ft from cor No.4.

638.1 same bearing to cor No.1 the place of beginning.

-----LEDGE-----

The presumed course of the vein on this claim is from the S. end center of location $N.9^{\circ}55'E$. 1477 ft.

-----oOo-----

---WORLDS FAIR---

Survey No. 1794.

Beginning with cor No.1 the S.W. cor identical with location, a pine post 4 ft long 4 ins square set 1 ft in the ground in a mound of stones and scribed 1-1794 W.F.L., and a pine post of same dimensions scribed W.C. 1-4-1794 brs $N. 21^{\circ}01'E$. 85.6 ft and a pine post of same dimensions and scribing brs $S. 21^{\circ}01'W$. 21.7 ft. and U.S.M.M. No.4 brs $N.77^{\circ}32'30"W$. 8398 ft. No other bearing monument available.

Thence $N.21^{\circ}01'E$.

28.3 to cor No.4 Leland Stanford Lode of this survey.

85.56 same bearing to intersection line 1-2 Cherokee Lode of this survey at $S.84^{\circ}08'E$. 136.15 from cor No.1.

628.3 same bearing to corners No.3 and 4 respectively of the Leland Stanford and Congress claims of this survey.

Feet

Survey No. 1794.

- 1228.8 same bearing to corners No. 3 and 4 respectively of the Congress and Keating Lodes of this group.
- 1500.0 same bearing to cor No. 3 the N.W. cor identical with location, a pine post 4 ft long 4 ins square set 1 ft in the ground in a mound of stones and scribed 2-1794 W.F.L., whence a quartzite cropping 18 ins high chiseled X2-1794 E.P. brs N. $81^{\circ}48'E$. 84.3 ft.
Thence N. $81^{\circ}48'E$.
- 340.0 to original location for N. end center.
- 680.0 same bearing to cor No. 3 the N.E. cor identical with location and with cor No. 3 Grenfell Lode of this survey, a pine post 4 ft long 4 ins square set 1 ft in the ground in a mound of stones and scribed 3-1794 W.F.L. whence a quartzite bed rock 3 X 5 ft chiseled X2-3-1794 E.P. brs N. $2^{\circ}12'W$. 53 ft.
Thence S. $21^{\circ}01'W$.
- 680.8 to corners no. 1 and 2 respectively of the Grenfell and Logan Claims of this survey.
- 1360.6 same bearing to cor No. 1 Logan Lode of this group on line 1-2 Shattuck claim of this survey at S. $81^{\circ}48'W$. 139.5 ft from cor N. 2.
- 1500.0 same bearing to cor No. 4 the S.E. cor identical with location a pine post 4 ft long 4 ins square set 1 ft in the ground in a mound of stones and scribed 4-1794 W.F.L., whence a pine post of same dimensions scribed W.C. 4-1-1794 brs N. $21^{\circ}01'E$. 69.7 ft and a pine post of same dimensions scribed W.C. 4-1794 brs S. $21^{\circ}01'W$. 50 ft. No other bearing monuments available.
Thence S. $81^{\circ}48'W$.
- 340.2 to original location for S. end center identical with cor No. 2 Cherokee Lode of this survey on line 4-1 Shattuck claim of this group at S. $9^{\circ}55'W$ 128 ft from cor No. 1.
- 680.0 same bearing to cor No. 1 the place of beginning.

-----LEDGE-----

The presumed course of the vein on this claim is from the S. end center of location N. $21^{\circ}01'E$. 1500 ft.

Feet

survey No. 1794.

-----Shattuck Lode-----

Survey No. 1794.

Beginning at cor No.1 the N.W. cor identical with location, a pine post 4 ft long 4 ins square set 1 ft in the ground in a mound of stones and scribed 1-1794 Sh L., whence a pine post of same dimensions scribed W.C.1-1794 brs S. 9°55'W. 50 ft and a second post of same dimensions and scribing brs N. 81°48'E. 50 ft. and U.S.M.M. No.4 brs N. 79°10'W 8714 ft. No other bearing monuments available.

Thence N. 81°48'E.

202.0 to original location for N. end center.

368.4 same bearing to intersection line 3-4- Worlds Fair Lode of this survey at N. 21°01'E. 139.4 ft from cor No.4 identical with cor No.1 Logan Lode of this survey.

507.9 same bearing to cor No.2 the N.W. cor identical with location and with cor No.1 Senator Lode of this survey a pine post &c scribed 2-1794 Sh L.

Thence S. 4°10'W.

1104.6 to cor No.3 the S.E. cor identical with location, a pine post 4 ft long 4 ins square set 1 ft in the ground in a mound of stones and scribed 3-1794 Sh L., whence a pine post of same dimensions scribed W.C. 3-4-1794 brs S. 4°10'W. 51.1 ft and a pine post of same dimensions and scribed W. C. 3-1794 brs N. 4°10'E. 50 ft. No other bearing monuments available.

Thence S. 81°48'W.

300.0 to original location for S. end center.

624.3 same bearing to cor No.4 the S.W. cor identical with location a pine post 4 ft long 4 ins square set 1 ft in the ground in a mound of stones and scribed 4-Sh L., whence a rock in place 3 X 5 ft chiseled X3-4-1794 B.R. brs N. 9°55'E. 171.6 ft.

Thence N. 9°55'E.

105.1 to corners No.1 and 3 respectively of the Rabbit sur-

Feet

Survey No. 1794.

vey No. 1795 and Cherokee, a claim of this survey.
 1007.2 same bearing to cor No. 2 Cherokee Lode of this survey
 on line 1-4 Worlds Fair Lode of this group, at N. 81° 48' E
 339.8 ft from cor No. 1.
 1135.2 same bearing to cor No. 1 the place of beginning.

-----LEDGE-----

The presumed course of the vein on this claim is
 from the S. end center of location N. 4° 10' E. 1104.6 ft.

-----OOO-----

-----SENATOR LODGE-----

Survey No. 1794.

Beginning at cor No. 1 the N.W. cor identical with
 location and with cor No. 2 Shattuck Lode of this survey
 a pine post 4 ft long 4 ins square set 1 ft in the
 ground in a mound of stones and scribed -1-1794 S.L.
 whence a pine post of same dimensions scribed W.C. 1-2-
 1794 brs S. 81° 48' W. 69.7 ft and a pine post of same
 dimensions and scribing brs N. 81° 48' E. 50 ft. and U.S.
 M.M. No. 4 brs N. 80° 12' W. 9196 ft. No other bearing mon-
 uments available.

Thence N. 81° 48' E.

300.0 to original location for N. end center.

300.0 same bearing to cor No. 2 the N.E. cor identical with
 location, a pine post 4 ft long 4 ins square set 1 ft
 in the ground in a mound of stones and scribed 2-1794
 S.L., whence a pine post of same dimensions scribed W.C.
 2-1794 brs N. 3° 32' E. 50 ft and a pine post of same
 dimensions and scribing brs S. 8° 32' W. 35 ft. No other
 bearing monuments available.

Thence S. 3° 32' W.

1204.0 to cor No. 3 the S.E. cor identical with location, a pine
 post 4 ft long 4 ins square set 1 ft in the ground in
 a mound of stones and scribed 3-1794 S.L., whence a
 flat rock in place 2 X 3 ft chiseled X 3-1794 B.R. brs

Feet

Survey No. 1794.

N. 54°13'E. 91.5 ft.

Thence S. 81°48'W.

300.0 to original location for S. end center.

613.5 same bearing to cor No.4 the S.W. cor identical with location, a pine post 4 ft long 4 ins square set 1 ft in the ground in a mound of stones and scribed 4-1794 S.L., whence a pine post of same dimensions scribed W.C 4-3-1794 brs N. 4°10'E. 51.6 ft, and a pine post of same dimensions scribed W.C. 4-1794 brs S. 4°10'W. 46.7 ft.

Thence N. 4°10'E.

102.3 to cor No.3 Shattuck Lode of this survey on line 4-1 Rabbit Lode survey No.1795 at S.88°37'E. 600 ft from cor No.1.

1206.9 same bearing to cor No.1 the place of beginning.

-----LEDGE-----

The presumed course of the ledge on this claim is from the S. end center of location N.3°33'E. 1204 ft.

-----600-----

-----LOGAN LODGE-----

Survey No. 1794!

Beginning at cor No.1 the S.W. cor identical with location, a pine post 4 ft long 4 ins square set 1 ft in the ground in a mound of stones and scribed 1-1794 L.L., whence a pine post of same dimensions scribed W.C. -1-2-1794 brs N. 81°48'E 69.7 ft and a pine post of same dimensions scribed W.C. 1-4-1794 brs S. 21°01'W. 69.7 ft and U.S.M.M. No.4 brs N. 79°56'W. 9063 ft. No other bearing monuments available.

Thence N. 21°01'E.

340.0 to original location for W. end center.

680.3 same bearing to cor No.2 the N.W. cor identical with location and with cor No.7 Grenfell Lode of this survey. a pine post &c scribed 2-1794 L.L.

Feet

Survey No. 1794.

- Thence N. 81°48'E.
- 1500.0 to cor No. 3 the N.E. cor identical with location and with cor No. 4 Grenfell Lode of this survey, a pine post 4 ft long 4 ins square set 1 ft in the ground in a mound of stones and scribed 3-1794 L.L., whence a pine post of same dimensions scribed W.C. 3-4-1794 brs S. 81°48'W 50 ft and a pine post of same dimensions and scribing brs N. 81°01'E. 50 ft. No other bearing monuments available.
- Thence S. 81°01'W.
- 340.3 to original location for E. end center.
- 680.3 to cor No. 4 the S.W. cor identical with location, a pine post 4 ft long 4 ins square set 1 ft in the ground in a mound of stones and scribed 4-1794 LL, whence a rock in place 1 X 2 X 2 ft chiseled X 4-1794 B.R. brs S. 13°50'E. 68.3 ft.
- Thence S. 81°48'W.
- 760.5 to cor No. 2 Senator Lode of this survey and the N.W. cor unurveyed Welcome claim.
- 1360.5 same bearing to cor No. 1 Senator Lode of this group.
- 1500.0 same bearing to cor No. 1 the place of beginning.

-----LEDGE-----

The presumed course of the vein on this claim is from the W. end center of location N. 81°48'E. 1500 ft.

-----oOo-----

-----GRENFELL, LODGE-----

Survey No. 1794.

Beginning at cor No. 1 the S.W. cor identical with location and with cor No. 3 Logan, a claim of this survey, a pine post 4 ft long 4 ins square set 1 ft in the ground in a mound of stones and scribed 1-1794 G.L., whence a pine post of same dimensions scribed W.C. 1-2-1794 brs N. 81°01'E. 50 ft and a pine post of same dimensions and scribing brs S 81°01'W 50 ft and

Feet

U.S.M.M. No.4 brs N. 84°05'30"W. 8218 ft. No other bearing monuments available.

Thence N. 21°01'E.

840.0 to original location for W. end center.

680.3 same bearing to cor No.2 the N.W. cor identical with location and with cor No.3 Worlds Fair Lode of this survey, a pine post &c scribed 2-1794 G.L.

Thence N. 81°48'E.

540.7 to cor No.4 Calumet Lode of this survey.

1500.0 same bearing to cor No.3 the N.E. cor identical with location, a pine post 4 ft long 4 ins square set 1 ft in the ground in a mound of stones and scribed 3-1794 G.L., whence a pine post of same dimensions scribed W.C. 3-1794 brs S. 81°48'W. 50 ft and a second post of same dimensions and scribing brs N.81°48'E. 50 ft. No other bearing monuments available.

Thence S. 21°01'W.

840.3 to original location for E. end center.

680.3 same bearing to cor No.4 the S.E. cor identical with location and with cor No.3 Logan Lode of this survey. a pine post &c scribed 4-1794 G.L.

Thence S. 81°48'W.

1500.0 to cor No.1 the place of beginning.

-----LEDGE-----

The presumed course of the vein on this claim is from the W. end center of location N.81°48'E. 1500 ft.

-----oOo-----

-----CALUMET LODGE-----

Survey No. 1794.

Beginning at cor No.1 the S.W. cor identical with location, a pine post 4 ft long 4 ins square set 1 ft in the ground in a mound of stones and scribed 1-1794 Ct L., whence a pine post of same dimensions scribed

Feet

Survey No. 1794.

W. C. 1-1794 brs N. 1°25'E. 38.7 ft and a pine post of same dimensions and scribing brs S.1°25'W. 50 ft and U.S.M.M. No.4 brs N. 86°57'W. 8474 ft. No other bearing monuments available.

Thence N. 1°25'E.

300.0 to original location for W. end center.

441.9 same bearing to intersection line 2-3- Keating Lode of this survey at N. 76°03'W. 394.9 ft from cor No.3

600.0 same bearing to cor No.2 the N.W. cor identical with location, a pine post 4 ft long 4 ins square set 1 ft in the ground in a mound of stones and scribed 2-1794 Ct L., whence a quartzite cropping 1 ft high and 3 ft thick chiseled X 2-1794 B.R. brs N. 15°34'E. 80.9 ft.

Thence N. 81°48'E.

1500.0 to cor No.3, the N.E. cor identical with location, a pine post 4 ft long 4 ins square set 1 ft in the ground in a mound of stones and scribed 3-1794 Ct L., whence a rock in place 1 X 3 X 3 ft chiseled X 3-1794 B.R. brs N. 74°03'W. 105.6 ft

Thence S. 1°25'W.

300.0 to original location for E. end center.

600.0 same bearing to cor No.4 the S.E. cor identical with location, a pine post 4 ft long 4 ins square set 1 ft in the ground in a mound of stones and scribed 4-1794 Ct L., whence a pine post of same dimensions scribed W.C. 4-1794 brs S.81°48'W. 50 ft, and a second post of same dimensions and scribing brs N.81°48'E. 50 ft. No other bearing monuments available.

Thence S. 81°48'W.

540.7 to corners No. 3 and 2 respectively of the Worlds Fair and Grenfell Lodes of this survey.

1220.7 same bearing to cor No.2 Worlds Fair of this group on line 3 - 4 Keating Lode of this survey at S.21°01'W. 328.5 ft from cor No.3.

1500.0 same bearing to cor No.1 the place of beginning.

-----LEDGE-----

The presumed course of the vein on this claim is from the W. end center of location N.81°48'E. 1500 ft.

Survey No. 1794.

I certify that the value of the labor and improvements on this group, placed thereon by the claimant or his grantors, is not less than \$500.00 for each claim thereof and that said improvements consist of:-

No.1 Disc. Shaft 6 X 8 X 500 ft brs from cor No.1
 N30°20'E. 584 ft. Total value \$12500.00

This shaft is located on the S. slope of the hill upon which these claims are situated and at about 100 ft in elevation above its base and above the lowest point of the group - the ground rising on all sides, except to the S.E. from which direction shaft No.1 is easily accessible by wagon road, joining it with the main road into Bisbee, which runs about 2000ft to the S.E. of the shaft. From its central location as seen by reference to the map, the whole group can be developed to the best possible advantage by drifts or cross cuts, and the ore removed at a point accessible for transportation. This district, like that of Leadville, is one of deposits and not of veins, and this method of development from deep centrally located shafts is universally followed, and has been proven to be the only practical method of development and extraction, and is followed strictly by every company operating in the district, notably the Copper Queen Consolidated Mining Company, working some 150 claims, from 8 shafts. The Calumet & Arizona about 15 claims from one shaft. The Calumet and Pittsburg about 25 claims from 1 shaft. The Copper Glance the same number from 1 shaft. The Lake Superior and Pittsburg about 60 claims from 2 shafts and some twenty other companies could be cited following this method of development and extraction. That shaft No.1 tends strictly to develop every claim of this group there is no question. The undivided interests in said shaft No.1 have been allotted to the claims of this group as follows:-

---WORLD'S FAIR GROUP-improvements.

Survey No. 1794.

Calumet \$300.00; Keating \$500.00; Grenfell \$600.00;
 Logan \$600.00; Senator \$600.00; Cherokee \$100.00;
 Red Jacket \$600.00; Paymaster \$100.00; Leland Stan-
 ford \$500.00; Congress \$600.00; Worlds Fair \$500.00;
 a total of \$5000.00 leaving an undivided interest of
 \$7500.00 which the claimant reserves to be applied
 upon other claims owned ^{OR} that may be acquired by him-
 self and upon which he will shortly make application
 for patent.

	Value of undivided interest in shaft No.1	\$500.00
No.2	Shaft 4 X 6 X 10 ft brs from cor No.1	
	N.22°E. 625 ft	<u>100.00</u>
	Total improvements Worlds Fair Lode	\$600.00

-----CALUMET-----

No.1	Disc. shaft 4 X 6 X 10 ft brs from cor No.4	
	N.85°54'W. 1050 ft	Value \$100.00
No.2	Shaft 4 X 6 X 10 ft brs from cor No. 4,	
	N.89°30'W. 520 ft	100.00
No.3	Shaft 4 X 6 X 10 ft brs from cor No.4	
	N.86°50'W. 680 ft	100.00
No.4	Shaft 4 X 6 X 10 ft brs from cor No.2	
	S.55°10'E. 875 ft	100.00
	Undivided interest in Shaft No.1 Worlds Fair	<u>300.00</u>
	Total improvements Calumet Claim	\$700.00

-----KEATING-----

No.1	Disc. Shaft 10 X 10 X 20 ft brs from cor No.4	
	N.31°25'W. 650 ft	\$200.00
	Undivided interest in shaft No.1 Worlds Fair	<u>500.00</u>
	Total improvements Keating Lode	\$700.00

-----GRENFELL-----

No.1	Disc. Shaft 4 X 6 X 10 ft brs from cor No.2	
	S. 62° E. 450 ft.	100.00
	Undivided interest in Shaft No.1 Worlds Fair	<u>600.00</u>
	Total improvement Grenfell Lode	\$700.00

-----LOGAN-----

No.1	Disc. Cut 4 X 12 X 14 ft course W. brs from cor No.3 S.77°30'W. 725 ft	\$100.00
	Undivided interest in shaft No.1 Worlds Fair	600.00
	Total improvements Logan Lode	\$700.00

-----SENATOR-----

No.1	Disc shaft 4 X 6 X 10 ft brs from cor No.1 S.2°40'W 320 ft	100.00
	Undivided interest in Shaft No.1 Worlds Fair	600.00
	Total value improvements Senator Lode	\$700.00

-----SHATTUCK-----

No.1	Disc. Shaft 4 X 6 X 10 ft brs from cor No.2 S.45°W. 350 ft	100.00
No.2	Shaft 4 X 6 X 10 ft brs from cor No.2 S.43°30'W. 380 ft	100.00
No.3	Shaft 4 X 6 X 10 ft " " " " S.44°W. 320 ft	100.00
No.4	Shaft 4 X 6 X 10 ft " " " " S.42°W. 300 ft	100.00
No.5	Shaft 4 X 6 X 10 ft " " " " S.39°W. 380 ft	100.00
No.6	Shaft 4 X 6 X 10 ft " " " " S.34°50'W. 395 ft	100.00
No.7	Shaft 4 X 6 X 10 ft " " " " S.20°W. 400 ft	100.00
No.8	Shaft 4 X 6 X 10 ft " " " " S.17°30'W 380 ft	100.00
	Total improvements Shattuck Lode	\$800.00

-----CHEROKEE-----

No.1	Disc. Shaft 4 X 6 X 10 ft brs from cor No.6 S.25°00'E. 260 ft	100.00
No.2	Shaft 4 X 6 X 10 ft " " " " S.18°40'E. 245 ft	100.00

-----WORLD'S FAIR GROUP--improvements.

20

Survey No. 1794.

---Cherokee---con.

No. 3	Shaft 4 X 6 X 10 ft brs from cor No. 3 S. 11° 35' E. 230 ft	100.00
No. 4	Shaft 4 X 6 X 10 ft " " " " S. 00° 50' W. 215 ft	100.00
No. 5	Shaft 4 X 6 X 10 ft " " " " S. 3° 50' W 220 ft	100.00
	Undivided interest in shaft No. 1 Worlds Fair	<u>100.00</u>
	Total improvements Cherokee Lode.	\$600.00

-----RED JACKET-----

No. 1	Disc. Shaft 4 X 6 X 10 ft brs from cor No. 2 S. 22° W. 230 ft	100.00
	Undivided interest in Shaft No. 1 Worlds Fair	<u>600.00</u>
	Total improvements Red Jacket Lode	\$700.00

-----PAYMASTER-----

No. 1	Disc Shaft 4 X 6 X 10 ft brs from cor No. 1 S. 61° E. 300 ft	100.00
No. 2	Shaft 4 X 6 X 10 ft " " " " S. 57° 30' E. 553 ft	100.00
No. 3	Shaft 4 X 6 X 10 ft " " " " S. 56° 27' E. 298 ft	100.00
No. 4	Shaft 4 X 6 X 10 ft " " " " S. 44° E. 473 ft	100.00
No. 5	Shaft 4 X 6 X 10 ft " " " " S. 28° 40' E. 373 ft	100.00
	Undivided interest in Shaft No. 1 Worlds Fair	<u>100.00</u>
	Total improvements Paymaster Lode.	\$600.00

-----LELAND STANFORD-----

No. 1	Disc. Cut 4 X 10 X 30 ft course N. 75° W. brs from cor No. 4 N. 4° 55' W. 543 ft	250.00
	Undivided interest in Shaft No. 1 Worlds Fair	<u>-500.00</u>
	Total improvements Leland Stanford	\$750.00

-----CONGRESS-----

No. 1	Disc. Shaft 4 X 6 X 10 ft brs from cor No. 4 N. 37° W. 300 ft	100.00
	Undivided interest in Shaft No. 1 Worlds Fair	<u>600.00</u>
	Total improvements Congress Lode	\$700.00
	Total improvements on Group	<u>\$9250.00</u>

-----WORLDS FAIR GROUP----- AREAS.

Survey No. 1794.

21

	Acres.
Total and net area Congress Lode	20.505
" " " " Leland Stanford	20.505
" " " " Paymaster	20.508
" " " " Calumet	20.378
" " " " Grenfell	20.438
" " " " Logan	20.438
" " " " Worlds Fair	20.437
Total area of the Senator	16.485
Less area in conflict with Rabbit, Survey No. 1795	<u>0.704</u>
Net area Senator Lode	15.781
Total area Shattuck Lode	14.040
Less area in conflict Worlds Fair	0.994
" " " " Rabbit	
Survey No. 1795	<u>0.718 1.710</u>
Net area Shattuck Lode	12.330
Total area Cherokee Lode	12.477
Less area in conflict with Worlds Fair	0.291
Less area in conflict Leland Stanford	<u>0.140 0.481</u>
Net area Cherokee Lode	12.046
Total area Red Jacket	18.007
Less area in conflict Judeah sur- vey No. 1585	<u>0.100</u>
Net area Red Jacket Lode	17.907
Total area Keating Lode	20.563
Less area in conflict Calumet	<u>2.873</u>
Net area Keating Lode	<u>17.690</u>
Net area for Group	218.845 acres

Feet.

Survey No. 1794.

-----LOCATION-----

These claims are located about two and one-half miles in a Southeasterly direction from Bisbee, in the Warren Mining District, Cochise County, Arizona, on unsurveyed lands approximately in Township 23 S. Range 24 E., G.&S.R.B.&M.

-----ADJOINING CLAIMS-----

NORTH; Claims and owners unknown.

WEST; Maurice Denn Group. names of claims unknown. Maurice Denn, owner.
William claims unsurveyed. Same owner.
Judeah, survey No. 1585. L.J. and C.A. Overlock, owners.

SOUTH; Sophy, unsurveyed; William J. Bryan and Bodey surveys No. 1793; all owned by Joseph Chisholm.
Rabbit survey No. 1795, Joseph Muhelm, owner.

EAST; Welcome Lode. M. Goldstein, owner.
Shattuck No. 2 Lode. L.C. Shattuck, owner.
Both unsurveyed Claims

-----INSTRUMENT-----

Survey was made with a Buff Transit. The courses were deflected from the true meridian as determined by solar observations, with a Saegmuller attachment, checked by an observation on Polaris. The distances were measured with a 300 ft steel tape. Magnetic variation 12° 30' E.

Bisbee, Arizona,
August 30, 1903.

Geo. C. Reed
U.S. Deputy Mineral Surveyor.

FINAL OATHS FOR SURVEYS.

LIST OF NAMES.

A list of the names of the individuals employed by

Geo. C. Clark

United States Deputy Mineral Surveyor, to assist in running, measuring, and marking the lines corners and boundaries described in the foregoing field notes of the survey of the mining claim of *L. C. Shattuck*

known as the *Keating; Congress; Deland Blueford; Paymaster; Red Jacket Calumet Woods Fair; Cherokee; Shattuck; Senator; Grenfell & Logan* and showing the respective capacities in which they acted.

Geo. Nelson, Chairman.

H. D. Hannah, Chairman.

....., Assman.

....., Flagman.

FINAL OATHS OF ASSISTANTS.

We,

Geo Nelson

and

H. D. Hannah

do solemnly swear that we assisted

Geo. C. Clark,

United States Deputy Mineral Surveyor, in marking the corners and

surveying the boundaries of the mining claim of *L. C. Shattuck, known as*

Keating; Congress; Deland Blueford, Paymaster, Red Jacket; Calumet; Woods Fair, Cherokee Shattuck known as the *Senator, Grenfell & Logan*

....., represented

in the foregoing field notes as having been surveyed by said deputy mineral surveyor and under his direction; and that said survey has been in all respects, to the best of our knowledge and belief, faithfully and correctly executed, and the corner and boundary monuments established according to law and the instructions furnished by the United States Surveyor-General for

Arizona

H. D. Hannah, Chairman.

Geo. E. Nelson, Chairman.

....., Assman .

....., Flagman.

Subscribed and sworn to by the above-named persons before me

this *7th* day of *September*, 1903

S. B. Williams

NOTARY PUBLIC
COCHISE COUNTY, ARIZONA TERR.
MY COMMISSION EXPIRES NOV. 30 1904

FINAL OATH OF U. S. DEPUTY MINERAL SURVEYOR

I, Geo. C. Clark, U. S. Deputy Mineral

Surveyor, do solemnly swear that, in pursuance of instructions received from the United States Surveyor General for Arizona, dated

August 29th 1903, I have, in strict conformity to the laws of the

United States, the official regulations and instructions thereunder, and the instructions of said Surveyor General, faithfully and correctly executed the survey of the Mining Claim of L. C. Shattuck, known as the Keating;

Congress: Deland Stanford, Paymaster: Red Jacket, Calumet, known as the
Wards Drain, Cherokee, Shattuck; Senator: Greiffell & Logan,

situate in Warren Mining District,

Cochise County, Arizona, in Section

Approximately Township No. 23S, Range No. 24 E. (unsub.) G & S. R. B & M

and designated as Survey No. 1794, as represented in the foregoing field notes, which accurately show the boundaries of said mining claim as distinctly marked by monuments on the ground, and described in the attached copy of the location certificate, which was received by me from the Surveyor General with said instructions, and that all the corners of said survey have been established and perpetuated in strict accordance with the law, official regulations and instructions thereunder; and I do further solemnly swear that the foregoing are the true and original field notes of said survey and my report therein, and that the labor expended and improvements made upon said mining claim by claimant or his grantors are as therein fully stated, and that the character, extent, location and itemized value thereof are specified therein with particularity and full detail, and that no portion of said labor or improvements so credited to this claim has been included in the estimate of expenditures upon any other claim.

Geo. C. Clark
U. S. Deputy Mineral Surveyor.

Subscribed and sworn to by the said Geo. C. Clark

U. S. Deputy Mineral Surveyor, before me

this 7th day of September 1903

J. H. Williams

NOTARY PUBLIC
COCHISE COUNTY, ARIZONA TERR.
MY COMMISSION EXPIRES 1904

Affidavit of Five Hundred Dollars Improvements.

We, Geo. Nelson, and H. D. Hannah

of lawful age, being first duly sworn according to law, depose and say: That we are acquainted with the ^{Heating; Congress; Island Blufford; Paymaster Red Jacket} Mrsnell & Logans ^{Calumet; Wards Fair; Cherokee; Shattuck, Seneca} mining claim,

situate in Warren Mining district, Cochise County,

Arizona Territory, for which L. C. Shattuck

has made application for survey prior to application for patent under the provisions of the Act of Congress, approved May 10, 1872; and that the labor done and improvements made thereon by the applicant and his grantor exceed Five Hundred Dollars in value, and further that we are not personally interested in said mine.

H. D. Hannah

Geo. E. Nelson

TERRITORY OF ARIZONA,
County of Cochise } ss:

Sworn to and subscribed before me, this 5th

day of September, 1903



J. H. Williams

NOTARY PUBLIC
COCHISE COUNTY, ARIZONA TERR.
MY COMMISSION EXPIRES MAY 21, 1911

Location Notice.

Notice is hereby given that the undersigned, in compliance with the requirements of the mining Act of Congress, approved May 10, 1872, ----- have this day located and claim 1500 hundred linear feet along the course of this lead, lode or vein of mineral bearing quartz, and 300 feet in width on each side of the middle of said lead, lode or vein, situate in the Warren Mining District, County of Cochise Arizona, and more particularly described as follows; to-wit:

Commencing at this monument of stones, being the center of the westerly end of claim, and upon which this notice is posted; thence southerly 300 feet to a monument of stones; thence easterly 1500 feet to a monument of stones; thence northerly 300 feet to a monument of stones; being the center of the eastern end of claim; thence north 300 feet to a monument of stones; thence west 1500 feet to a monument of stones; thence southerly 300 feet to a monument of stones to place of beginning.

This claim is situated in Warren Mining District about 2 miles in easterly direction from Rippee situated directly east of Worlds Fair mining claim and north by the Logan claims and about 1 mile north of what is known as Dubacher Ranch

and shall be known as the Grenfell Mine. Located May 11th 1895 Elizabeth Grenfell Belle Shattuck

Witness: Edward Grenfell

at 1 P.M. Filed and recorded at request of W. Grenfell May 24th A.D. 1895 Book 13 Record of mines page 211 Territory of Arizona,

County of Cochise.) I, Frank Hare County Recorder in and for said County, hereby certify that I have compared the foregoing copy with the original location notice of the "Grenfell" mining claim, filed and recorded in my office on 24 day of May 1895, in book 13 page 211 Record of Mines, and that the same is a full, true and correct copy of such original and of the whole thereof Witness my hand and seal of office, this 26 day of February 1903.

Frank Hare County Recorder.

Location Notice.

Notice is hereby given that the undersigned, in compliance with the requirements of the Mining Act of Congress, approved May 10, 1872, has this day located my claim *1500* hundred linear feet along the course of the lode, ledge or vein of mineral bearing quartz, and *300* feet in width on each side of the side of said lode, ledge or vein, situated in the Warren Mining District, County of Cochise, Arizona, and more particularly described as follows, to wit:

- Commencing at the monument of stones, being the center of the *easterly end* of claim, and upon which this notice is located; thence *northerly 300* feet to a monument of stones; thence *westerly 1500* feet to a monument of stones; thence *southerly 300* feet to a monument of stones; thence *westerly* end of claim; thence *southerly 300* feet to a monument of stones; thence *easterly 1500* feet to a monument of stones; thence *northerly 300*

2000 ft. place of location.
This claim is in the Warren Mining District, about two miles in an easterly direction from the town of Bisbee, about one half mile east of Lindsey's Milk Ranch and the wagon road from Bisbee to Ross Saw Mill passes through the claim. The initial monument is about 200 feet south of a fork in the main wagon road, the road that makes the fork is a wagon road going from main wagon road to the Worlds Fair Mining Claim.

and shall be known as the *Red Jacket* lode. Witness my hand and seal of office, this *22nd* day of *March* 1894.
Wm Grenfell
Clarence Grenfell

Witness:
L. C. Shattuck

Filed and recorded as a part of *L. C. Shattuck* April 5th A.D. 1894 at 4.30 P.M. Book 17 page 45 County of Cochise, Territory of Arizona.
County of Cochise.

I, Frank Ware County Recorder in and for said County, hereby certify that I have compared the foregoing copy with the original location notice of the *Red Jacket* mining claim filed and recorded in my office on the *5* day of *April* 1894, in Book 17 page 45 Record of Mines, and that the same is a full, true and correct copy of such original and the same thereof.
Witness my hand and seal of office, this *5th* day of *February* 1903.

Frank Ware
County Recorder.

Location Notice.

Notice is hereby given that the undersigned, in compliance with the requirements of the Act of Congress, approved July 1, 1893, has this day located for claim fifteen hundred five feet along the corner of the land, along or near the natural bearing north, and three hundred feet in width on each side of the middle of the line, to be situated in the Fourth Mining District, County of Lincoln, Arizona, and more particularly described as follows to-wit:

western end

three hundred

fifteen hundred

three hundred

Eastern end

three hundred

fifteen hundred

fifteen hundred

This claim is situated about 1/4 of a mile in a northerly direction from Kanee Ranch and about 1/2 mile in a Easterly - from Duffeys Slaughter House.

Selands Stanford June 26th 1893

George H. Hill

Levi Shattuck

Edward Grenfell

Allen Walker July 21st

1893 at 5 P.M.

12 615

Francis H. Gore
County Recorder.

Location Notice.

Notice is hereby given that the undersigned, in compliance with the requirements of the Act of Congress, approved May 10, 1872, have this day located an claim *fifteen* hundred linear feet along the course of the line, line or vein of mineral bearing quartz, on *three hundred* feet in width on each side of the middle of said line, line or vein, situate in the Warren Mining District, County of *Yavapai* Arizona, and more particularly described as follows, to-wit:

Commencing at this monument of stone, being the center of the *western end* of claim, on upon which this notice is published *three hundred*

feet to a monument of stone; thence *fifteen hundred*

feet to a monument of stone; thence *three hundred*

feet to a monument of stone; thence being the center of the

eastern end of said claim, *three hundred*

feet to a monument of stone; thence *fifteen hundred*

feet to a monument of stone; thence *three hundred*

feet to a monument of stone; thence *three hundred*
 This claim is situated about 1/2 mile in a northerly direction from Dubachers Ranch and on the northerly slope of Bisbee Canyon

and shall be known as the Logan Mine, created June 26th. 1893
 George H. Hill
 Lem Shattuck
 Edward Greenfell

Filed for record in the office of Allen Walker July 21st 1893 at 5 P.
 Book 12 page 616
 territory of Arizona,

County of *Yavapai*.
 I, Frank Ware County Recorder in and for said County, hereby certify that I have compared the foregoing copy with the original location notice of the Logan Mine and recorded in my office on the *21st* day of *July* 1893, in Book 12 page 616 Record of Mines, and that a true and correct copy of such original notice is on file in my office.
 Witness my hand and seal of office, this *21st* day of *July* 1893.

Francis Ware
 County Recorder.

Location Notice.

Notice is hereby given that the undersigned, in compliance with the requirements of the Mining Act of Congress, approved May 10, 1872, have this day located and claim *1500* hundred linear feet along the course of the lode or vein of mineral bearing quartz, and *300* feet in width on each side of the middle of said lode or vein, situated in the Maricopa Mining District, County of Maricopa, Arizona, and more particularly described as follows, to wit:

Commencing at this monument of stones, being the center of the *eastern end* of claim, and upon which this notice is recorded; thence *300*

feet to a monument of stones; thence *1500*

feet to a monument of stones; thence *300*

feet to a monument of stones; thence being the center of the *western* end of claim; thence *300*

feet to a monument of stones; thence *1500*

feet to a monument of stones; thence *300*

feet to place of beginning.
 This claim is situated about three hundred yards in a northerly direction from Dubachers Ranch and north from the Bisbee Canyon Road.

and shall be done as the Paymaster in and for said County
 October 10th, 1893
 George H. Hill
 Lem Shattuck
 Belle Shattuck

Filed and duly recorded in and for said County, Arizona, at 1 P.M. on the 16th day of October 1893, at 1 P.M. 1893, at 1 P.M.

Book 2, page 2 - Record of Mines, territory of Arizona, County of Maricopa, I, Frank Hare County Recorder in and for said County, hereby certify that I have compared the foregoing copy with the original location notice of the "Paymaster" mining claim filed and recorded in my office on the 16 day of October 1893, in Book 2 page 2 - Record of Mines, and that the same is a full, true and correct copy of such original copy of the whole thereof.
 Witness my hand and seal of office, this 16th day of February 1903.

Frank Hare
 County Recorder.

Location Notice.

Notice is hereby given that the undersigned, in compliance with the requirements of the Mining Act of Congress, approved May 10, 1872, ----- have this day located and claim 1500 hundred linear feet along the course of this lode, ledge or vein of mineral bearing quartz, and 300 feet in width on each side of the middle of said lode, ledge or vein, situate in the Warren Mining District, County of Cochise Arizona, and more particularly described as follows; to-wit:

Commencing at this monument of stones, being the center of the easterly end of claim, and upon which this notice is posted; thence northerly 300 feet to a monument of stones; thence westerly 1500 feet to a monument of stones; thence southerly 300 feet to a monument of stones; being the center of the westerly end of claim; thence southerly 300 feet to a monument of stones; thence easterly 1500 feet to a monument of stones; thence northerly 300 feet to a monument of stones to place of beginning.

This claim is situated about two miles in a easterly direction from the Town of Bisbee + about one half mile from what is known as the Dubacher Ranch + runs parallel with what is known as the Senate Mining Claim

and shall be known as the Keating Mine. Witness my hand and seal this 27th day of June 1895
E. Grenfell
L. C. Shattuck
John Keating

Filed and recorded at request of Shattuck + Keating June 28th A.D. 1895 at 1 P.M. Book 13 Record of Mines page 235
(Territory of Arizona,)

County of Cochise.)
(, Frank Hare County Recorder in and for said County, hereby certify that I have compared the foregoing copy with the original location notice of the Keating mining claim, filed and recorded in my office on 28 day of June 1895, in Book 13 page 235 Record of Mines, and that the same is a full, true and correct copy of such original and of the whole thereof
Witness my hand and seal of office, this 26 day of February 1903.

Frank Hare
County Recorder.

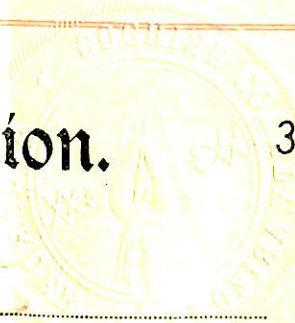

AMENDED
Notice of Mining Location.
LODE CLAIM.

To All Whom It May Concern:

This mining claim, the name of which is the Senator
Mining Claim, situate on lands belonging to the United States of America, and in which there are
valuable mineral deposits, was entered upon and located for the purpose of exploration and
purchase by S. C. Shattuck

(Locator must insert either "a citizen of the United States," or, "who has declared his intention to become a citizen of the United States.")
the undersigned, on the 2nd day of Aug 1903

The length of this claim is 1250 feet
and 320 feet
in a northwesterly direction, and 930
feet in a southerly direction from
the center of the discovery shaft, at which this notice is posted, lengthwise of the claim, together
with 300 feet in width of the surface grounds, on each
side of the discovery monument of said claim. The general course of the lode deposit and prem-
ises is from the S to the N

The claim is situated and located in the Warren Mining District, in
Cochise County, in the Territory of Arizona, about 9 miles
in a southeasterly direction from the town of Bisbee as
measured N by Logan road E by Welcome
S by Rabbit and W by Shattuck

The surface boundaries of the claim are marked upon the ground as follows: Beginning at
a monument

at a point in a northwesterly direction 475 feet from
the discovery shaft (at which this notice is posted), being in the center of the N
end line of said claim; thence easterly 300 feet to a post
NE, being the NE corner of said claim; thence
southerly 1250 feet to a monument, being
at the SE corner of said claim; thence westerly 900 feet
to a monument at the center of the SE end of said
claim; thence westerly 300 feet to a monument, being
at the SW corner of said claim; thence northwesterly 1250
feet to a post at the NW corner of said
claim; thence easterly 300 feet to place of beginning.

All done under the provisions of Chapter Six, of Title XXXII, of the Revised Statutes of
the United States, and an Act of the General Assembly of Arizona, entitled "An Act to Revise
and Codify the Laws of the Territory of Arizona," approved March 16, 1901.

This is an Amended Location Notice of the Senator
Mining Claim, located by S. C. Shattuck
S. C. Shattuck on the 7th day of
Aug 1903, and recorded in Book 23 of Records of Mines, at
page 269 in the office of the County Recorder of the aforesaid County of Cochise
to which reference is hereby made, and this Amended Location Notice is made and posted to
correct errors in the description in the said original Location Notice.

Dated and posted on the ground this 2nd day of Aug 1903
S. C. Shattuck

TERRITORY OF ARIZONA, } ss.
County of Cochise

I, James H. Hall, County Recorder in and for the County and Territory aforesaid, do hereby certify that the within instrument was filed for record at 9 o'clock, 9 M., on this 10th day of Aug., 1903 and duly recorded in Book No. 28 of Mining Records of Cochise County, Arizona, at pages 65

WITNESS my hand and official seal the day and year first above written.

James H. Hall
County Recorder.

AMENDED
Notice of Location.

LODE CLAIM.

Dated 1903

Filed and recorded at the request of

L. C. Shattuck

at Aug. 10 A. D., 1903.
9 M.

Book 28 Record of Mining

Page 65

By Frank Hall
County Recorder.

Deputy Recorder.

THE H. H. MCNEIL CO., PRINTERS, PHOENIX, ARIZ.

pd

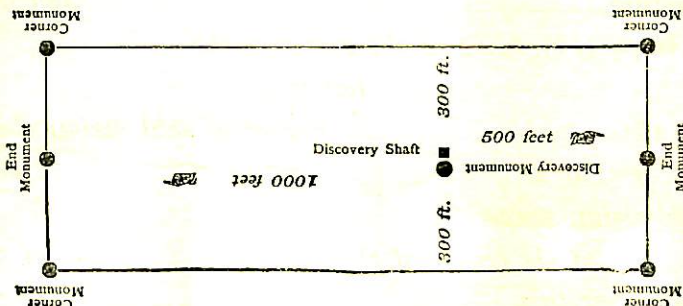

This diagram is to give locator a general idea of plan of location under the new law. The Discovery Shaft can be in the center of claim or any distance from either end desired. In the diagram it is placed 500 feet from one end and 1000 feet from the other. Commence description of claim at a center end monument, giving its distance and direction from center of Discovery Shaft; thence bound the claim in either direction. In description be careful to state locality of claim with reference to some natural object, or permanent monument, as will identify the claim.

AMENDED
Notice of Mining Location.
LODE CLAIM.

To All Whom It May Concern:

This mining claim, the name of which is the Cherokee
Mining Claim, situate on lands belonging to the United States of America, and in which there are
valuable mineral deposits, was entered upon and located for the purpose of exploration and
purchase by J. P. Shattuck

a citizen of the United States
(Locator must insert either "a citizen of the United States," or, "who has declared his intention to become a citizen of the United States.")

the undersigned, on the 2nd day of Aug 1903

The length of this claim is 1500 feet
and 950 claim 950 feet
in a south direction, and 1250
feet in a north direction from
the center of the discovery shaft, at which this notice is posted, lengthwise of the claim, together
with 995 feet in width of the surface grounds, on each
side of the discovery monument of said claim. The general course of the lode deposit and prem-
ises is from the S to the N.

The claim is situated and located in the Warren Mining District, in
Cochise County, in the Territory of Arizona, about 2 miles
in a south direction from the town of Bisbee, is bounded
on N by Edward Stanton & World's Fair
on E by Shattuck & Robert, on S by Boddy
on W by Red Jacket, Williams & Shattuck

The surface boundaries of the claim are marked upon the ground as follows: Beginning at
a monument

at a point in a south direction 950 feet from
the discovery shaft (at which this notice is posted), being in the center of the S
end line of said claim; thence easterly 200 feet to a post
, being the SE corner of said claim; thence
south 1500 feet to a monument, being
at the SW corner of said claim; thence westerly 225 feet
to a monument at the center of the N end of said
claim; thence westerly 225 feet to a monument, being
at the NW corner of said claim; thence southerly 1500
feet to a monument at the SW corner of said
claim; thence easterly 200 feet to place of beginning.

All done under the provisions of Chapter Six, of Title XXXII, of the Revised Statutes of
the United States, and an Act of the General Assembly of Arizona, entitled "An Act to Revise
and Codify the Laws of the Territory of Arizona," approved March 16, 1901.

This is ^{2nd} an Amended Location Notice of the Cherokee
Mining Claim, located by Geo. H. Hill, J. P. Shattuck & Belle
Shattuck on the 22nd day of
Sept 1893 1903, and recorded in Book 23 of Records of Mines, at
page 268 in the office of the County Recorder of the aforesaid County of Cochise
to which reference is hereby made, and this Amended Location Notice is made and posted to
correct errors in the description in the said original Location Notice.

Dated and posted on the ground this 2nd day of Aug 1903

J. P. Shattuck

TERRITORY OF ARIZONA,

County of Cochise } ss.

I, Frank Hall, County Recorder in and for the County and

Territory aforesaid, do hereby certify that the within instrument was filed for record at 9 o'clock, A. M.,

on this 10th day of Aug. 1903 and duly recorded in Book No. 28

of Mining Records of Cochise County, Arizona, at pages 64

WITNESS my hand and official seal the day and year first above written.

Frank Hall
County Recorder

AMENDED
Notice of Location.

LODE CLAIM.

Dated 1903

Filed and recorded at the request of

L. C. Shattuck

Aug. 10 A. D., 1903

at 9 A. M.

Book 28 Mining

Page 64

Frank Hall
County Recorder.

Deputy Recorder.

THE H. H. MERRILL CO., PRINTERS, PHOENIX, ARIZ.

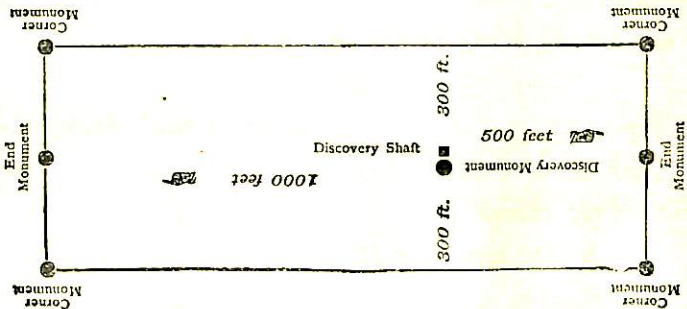

This diagram is to give locator a general idea of plan of location under the new law. The Discovery Shaft can be in the center of claim or any distance from either end desired. In the diagram it is placed 500 feet from one end and 1000 feet from the other. Commence description of claim at a center end monument, giving its distance and direction from center of Discovery Shaft; thence bound the claim in either direction. In description be careful to state locality of claim with reference to some natural object, or permanent monument, as will identify the claim.

AMENDED

Notice of Mining Location.

LODE CLAIM.

To All Whom It May Concern:

This mining claim, the name of which is the Congress Mining Claim, situate on lands belonging to the United States of America, and in which there are valuable mineral deposits, was entered upon and located for the purpose of exploration and purchase by L. C. Shattuck

(Locator must insert either "a citizen of the United States," or, "who has declared his intention to become a citizen of the United States.") the undersigned, on the 2nd day of Aug 1903

The length of this claim is 1500 feet and 250 feet in a east direction, and 1250 feet in a west direction from the center of the discovery shaft, at which this notice is posted, lengthwise of the claim, together with 300 feet in width of the surface grounds, on each side of the discovery monument of said claim. The general course of the lode deposit and premises is from the E to the W

The claim is situated and located in the Warren Mining District, in Cochise County, in the Territory of Arizona, about 2 miles in a westwardly direction from the town of Bisbee is bounded N by Healy on F by World's Fair, S by Leland Stanford

The surface boundaries of the claim are marked upon the ground as follows: Beginning at monument at a point in a east direction 250 feet from the discovery shaft (at which this notice is posted), being in the center of the E end line of said claim; thence north 300 feet to a post, being the NE corner of said claim; thence west 1500 feet to a post, being at the NW corner of said claim; thence south 300 feet to a post at the center of the W end of said claim; thence west 300 feet to a post, being at the SW corner of said claim; thence east 1500 feet to a post at the SE corner of said claim; thence north 1500 feet to place of beginning.

All done under the provisions of Chapter Six, of Title XXXII, of the Revised Statutes of the United States, and an Act of the General Assembly of Arizona, entitled "An Act to Revise and Codify the Laws of the Territory of Arizona," approved March 16, 1901.

This is an Amended Location Notice of the Congress Mining Claim, located by George V. Hill, Lewis Shattuck & Charles Shattuck on the 7th day of Oct 1893 1903, and recorded in Book 13 of Records of Mines, at page 3, in the office of the County Recorder of the aforesaid County of Cochise to which reference is hereby made, and this Amended Location Notice is made and posted to correct errors in the description in the said original Location Notice.

Dated and posted on the ground this 2nd day of Aug 1903
L. C. Shattuck

TERRITORY OF ARIZONA,
County of Cochise } ss.

I, Frank H. Hare, County Recorder in and for the County and

Territory aforesaid, do hereby certify that the within instrument was filed for record at 9 o'clock A M.,

on this 10th day of Aug, 1903, and duly recorded in Book No. 28

of Missing Records of Cochise County, Arizona, at pages 67

WITNESS my hand and official seal the day and year first above written.

Frank H. Hare
County Recorder.

AMENDED
Notice of Location.
LODE CLAIM.

Dated 1903

Filed and recorded at the request of
L. C. Shattuck

at Aug. 10 A. D., 1903
9 A M.

Book 28 Record of Missing
Page 67

By Frank Hare
County Recorder.
R
Deputy Recorder.

THE H. H. MCNEIL CO., PRINTERS, PHOENIX, ARIZ.

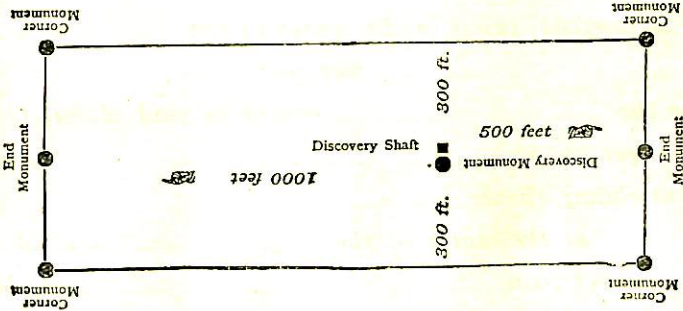

This diagram is to give locator a general idea of plan of location under the new law. The Discovery Shaft can be in the center of claim or any distance from either end desired. In the diagram it is placed 500 feet from one end and 1000 feet from the other. Commence description of claim at a center end monument, giving its distance and direction from center of Discovery Shaft; thence bound the claim in either direction. In description be careful to state locality of claim with reference to some natural object, or permanent monument, as will identify the claim.

pd

AMENDED

Notice of Mining Location.

LODE CLAIM.

To All Whom It May Concern:

This mining claim, the name of which is the Calumet Mining Claim, situate on lands belonging to the United States of America, and in which there are valuable mineral deposits, was entered upon and located for the purpose of exploration and purchase by L. C. Shattuck

(Locator must insert either "a citizen of the United States," or, "who has declared his intention to become a citizen of the United States.")
the undersigned, on the 2nd day of Aug 1903

The length of this claim is 1500 feet
and 5 claim 450 feet
in a westerly direction, and 1050
feet in a westerly direction from
the center of the discovery shaft, at which this notice is posted, lengthwise of the claim, together
with 300 feet in width of the surface grounds, on each
side of the discovery monument of said claim. The general course of the lode deposit and prem-
ises is from the W to the E

The claim is situated and located in the Warren Mining District, in
Cochise County, in the Territory of Arizona, about 9 miles
in a westerly direction from the town of Bisbee and is
bounded on W by Keating, on S by Keating
Woods Fair & Greenfall

The surface boundaries of the claim are marked upon the ground as follows: Beginning at

a monument
at a point in a westerly direction 450 feet from
the discovery shaft (at which this notice is posted), being in the center of the W
end line of said claim; thence northerly 300 feet to a post
NW, being the NW corner of said claim; thence
easterly 1500 feet to a post, being
at the NE corner of said claim; thence southerly 300 feet
to a monument at the center of the E end of said
claim; thence southerly 300 feet to a post, being
at the SE corner of said claim; thence westerly 1500
feet to a post at the SW corner of said
claim; thence northerly 300 feet to place of beginning.

All done under the provisions of Chapter Six, of Title XXXII, of the Revised Statutes of
the United States, and an Act of the General Assembly of Arizona, entitled "An Act to Revise
and Codify the Laws of the Territory of Arizona," approved March 16, 1901.

This is an Amended Location Notice of the Calumet
Mining Claim, located by William Greenfall
on the 1st day of
Nov 1893 1903, and recorded in Book 13 of Records of Mines, at
page 10, in the office of the County Recorder of the aforesaid County of Cochise
to which reference is hereby made, and this Amended Location Notice is made and posted to
correct errors in the description in the said original Location Notice.

Dated and posted on the ground this 2nd day of August 1903
L. C. Shattuck

TERRITORY OF ARIZONA,

County of

Piochise } ss.
Frank Hare

I, County Recorder in and for the County and

Territory aforesaid, do hereby certify that the within instrument was filed for record at o'clock, M.,

on this *10th* day of *Aug.* 190*3*, and duly recorded in Book No. *28*

of *Missing* Records of *Piochise* County, Arizona, at pages *68*

WITNESS my hand and official seal the day and year first above written.

Frank Hare
County Recorder.

AMENDED
Notice of Location.

LODE CLAIM.

Dated 190.....

Filed and recorded at the request of

L. S. Shattuck

at *Aug. 10 A. D., 1903*

at *9 A. M.*

Book *28 Record of Miner*

Page *68*

By *Frank Hare*
County Recorder.

By *R*
Deputy Recorder.

THE H. H. MCNEIL CO., PRINTERS, PHOENIX, ARIZ.

pd

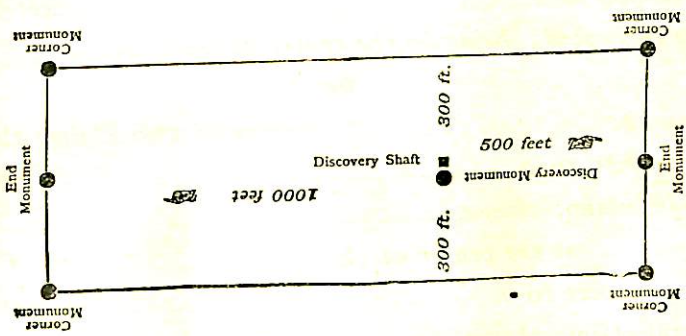

This diagram is to give locator a general idea of plan of location under the new law. The Discovery Shaft can be in the center of claim or any distance from either end desired. In the diagram it is placed 500 feet from one end and 1000 feet from the other. Commence description of claim at a center end monument, giving its distance and direction from center of Discovery Shaft; thence bound the claim in either direction. In description be careful to state locality of claim with reference to some natural object, or permanent monument, as will identify the claim.

AMENDED

Notice of Mining Location.

LODE CLAIM.

To All Whom It May Concern:

This mining claim, the name of which is the Shattuck Mining Claim, situate on lands belonging to the United States of America, and in which there are valuable mineral deposits, was entered upon and located for the purpose of exploration and purchase by L. C. Shattuck

(Locator must insert either "a citizen of the United States," or, "who has declared his intention to become a citizen of the United States.") the undersigned, on the 2nd day of Aug 1903

The length of this claim is 1150 feet, and 225 feet in a westerly direction, and 925 feet in a southerly direction from the center of the discovery shaft, at which this notice is posted, lengthwise of the claim, together with 300 feet in width of the surface grounds, on each side of the discovery monument of said claim. The general course of the lode deposit and premises is from the S to the N

The claim is situated and located in the Warren Mining District, in Coconino County, in the Territory of Arizona, about 1/2 mile in a southerly direction from Debadier Ranch - 1 mile from the center of the same - bounded N by the line of the Warren Mining District, E by the line of the Warren Mining District, S by the line of the Warren Mining District, and W by the line of the Warren Mining District.

The surface boundaries of the claim are marked upon the ground as follows: Beginning at a monument

at a point in a southerly direction 225 feet from the discovery shaft (at which this notice is posted), being in the center of the end line of said claim; thence easterly 300 feet to a post, being the NE corner of said claim; thence southerly 1150 feet to a post, being at the SE corner of said claim; thence westerly 300 feet to a monument at the center of the S end of said claim; thence easterly 300 feet to a monument, being at the SE corner of said claim; thence southerly 1150 feet to a monument at the SW corner of said claim; thence easterly 225 feet to the place of beginning.

All done under the provisions of Chapter Six, of Title XXXII, of the Revised Statutes of the United States, and of an Act of the General Assembly of Arizona, entitled "An Act to Revise and Codify the Laws of the Territory of Arizona," approved March 16, 1901.

This is an Amended Location Notice of the Shattuck Mining Claim, located by L. C. Shattuck on the 26th day of August 1903, and recorded in Book 12 of Records of Mines, at page 44, in the office of the County Recorder of the aforesaid County of Coconino to which reference is hereby made, and this Amended Location Notice is made and posted to correct errors in the description in the said original Location Notice.

Dated and posted on the ground this 2nd day of August 1903

L. C. Shattuck

TERRITORY OF ARIZONA, }
County of Cochise } ss

I,, County Recorder in and for the County and Territory aforesaid, do hereby certify that the within instrument was filed for record at 9 o'clock, 9 A. M., on this 10th day of Aug 1903 and duly recorded in Book No. 28 of Missing Records of Cochise County, Arizona, at pages 69

WITNESS my hand and official seal the day and year first above written.

.....
County Recorder.

AMENDED
Notice of Location.
LODE CLAIM.

Dated 190.....

Filed and recorded at request of

H. C. Whittick

Aug. 10 A. D. 1903

at 9 A. M.

Book 28 Records of Mine

Page 69

Frank Hain
County Recorder.

By
Deputy Recorder.

The H. H. McNeil Co., Printers, Phoenix, Arizona.

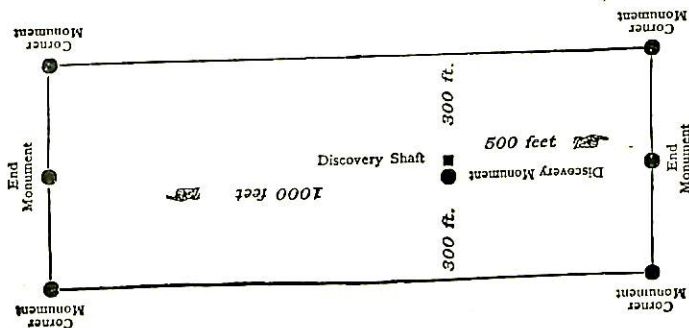

This diagram is to give locator a general idea of plan of location under the new law. The Discovery Shaft can be in the center of claim or any distance from either end desired. In the diagram it is placed 500 feet from one end and 1000 feet from the other. Commence description of claim at a center end monument, giving its distance and direction from center of Discovery Shaft; thence bound the claim in either direction. In description be careful to state locality of claim with reference to some natural object, or permanent monument, as will identify the claim.

AMENDED

Notice of Mining Location.

LODE CLAIM.

To All Whom It May Concern:

This mining claim, the name of which is the World's Fair Mining Claim, situate on lands belonging to the United States of America, and in which there are valuable mineral deposits, was entered upon and located for the purpose of exploration and purchase by J. P. Shattuck

(Locator must insert either "a citizen of the United States," or, "who has declared his intention to become a citizen of the United States.")

the undersigned, on the 3rd day of Aug 1903

The length of this claim is 1500 feet and 3 claim 400 feet in a southerly direction, and 100 feet in a northerly direction from the center of the discovery shaft, at which this notice is posted, lengthwise of the claim, together with 300 feet in width of the surface grounds, on each side of the discovery monument of said claim. The general course of the lode deposit and premises is from the S to the N

The claim is situated and located in the Warren Mining District, in Cochise County, in the Territory of Arizona, about 1/2 mile in a southerly direction from Debacher Ranch & 1 mi in an east direction from Stans Ranch & is bounded on N by Colony on E by Greenhill, Logan & Shattuck or Shattuck & Cherokee on W by Cherokee & Island & Conroy & Keating

The surface boundaries of the claim are marked upon the ground as follows: Beginning at monument

at a point in a southerly direction 400 feet from the discovery shaft (at which this notice is posted), being in the center of the 3 end line of said claim; thence easterly 340 feet to a post, being the SE corner of said claim; thence northerly 1500 feet to a post, being at the NE corner of said claim; thence westerly 340 feet to a monument at the center of the N end of said claim; thence westerly 340 feet to a post, being at the NW corner of said claim; thence southerly 1500 feet to a post at the SW corner of said claim; thence easterly 340 feet to place of beginning.

All done under the provisions of Chapter Six, of Title XXXII, of the Revised Statutes of the United States, and an Act of the General Assembly of Arizona, entitled "An Act to Revise and Codify the Laws of the Territory of Arizona," approved March 16, 1901.

This is an Amended Location Notice of the World's Fair Mining Claim, located by George H. Bell & C. H. Slinkard on the 18th day of March 1893 1903, and recorded in Book 12 of Records of Mines, at page 600, in the office of the County Recorder of the aforesaid County of Cochise to which reference is hereby made, and this Amended Location Notice is made and posted to correct errors in the description in the said original Location Notice.

Dated and posted on the ground this 3rd day of Aug 1903

J. P. Shattuck

TERRITORY OF ARIZONA,

County of Cochise ss.

I, Francis Star, County Recorder in and for the County and

Territory aforesaid, do hereby certify that the within instrument was filed for record at 9 o'clock, 9 A. M.

on this 10th day of Aug, 1903, and duly recorded in Book No. 28

of Mining Records of Cochise County, Arizona, at pages 66.

WITNESS my hand and official seal the day and year first above written.

Francis Star
County Recorder.

AMENDED
Notice of Location.

LODE CLAIM.

Dated 1903

Filed and recorded at the request of

L. L. Shattuck

Aug. 10 A. D., 1903

at 9 A. M.

Book 28 Geordy Mine

Page 66

By Frank H. Hite
County Recorder.

Deputy Recorder.

THE H. H. MCNEIL CO., PRINTERS, PHOENIX, ARIZ.

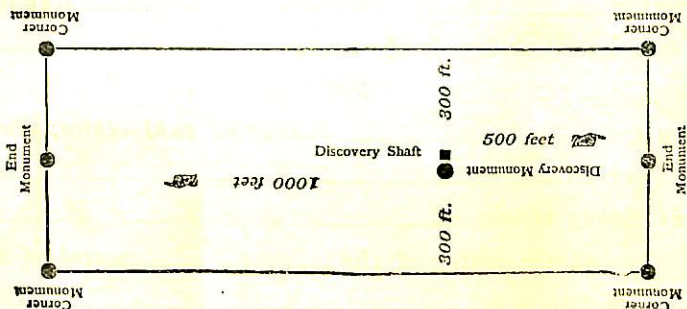

This diagram is to give locator a general idea of plan of location under the new law. The Discovery Shaft can be in the center of claim or any distance from either end desired. In the diagram it is placed 500 feet from one end and 1000 feet from the other. Commence description of claim at a center end monument, giving its distance and direction from center of Discovery Shaft; thence bound the claim in either direction. In description be careful to state locality of claim with reference to some natural object, or permanent monument, as will identify the claim.

4-687.

SURVEYOR-GENERAL'S CERTIFICATE OF APPROVAL OF FIELD NOTES AND SURVEY OF MINING CLAIM.

Department of the Interior.

Office of U. S. Surveyor-General,

Phoenix, Arizona.

Oct. 28, 1903.

I, U. S. Surveyor-General for Dist. of Arizona.

do hereby certify that the foregoing and hereto attached Field Notes and Return of the Survey of the Mining Claim of L. C. Shattuck

Known as Keating, Congress, Leland Stanford, Paymaster, Red Jacket, Calumet, Worlds Fair, Cherokee, Shattuck, Senator, Grenfell and Logan

situate in Warren mining district, Cochise County, Arizona

in Section APPROX., Township No. 23 S., Range No. 24 E. unsvd.

G. & S. R. B. & M., designated as Survey No. 1794

executed by Geo. C. Clark, U. S. Deputy Mineral Surveyor, Aug. 30th, Sept. 6th, 1903, under my instructions dated Aug. 29th, 1903, have been critically examined and the necessary corrections and explanations made, and the said Field Notes and Return, and the Survey they describe, are hereby approved. A true copy of the copy of the location certificate filed by the applicant for survey is included in the field notes.

Frank S. Ingalls

U. S. Surveyor-General for Arizona.

MAP