

**MS**

**0**

**2**

**0**

**2**

**8**

APR 22 1905

1

Copied by *amt*  
4/29/05

(4-683.)

Mineral Survey No. 2028

Lot No. \_\_\_\_\_

Sila Land District.

### FIELD NOTES

OF THE SURVEY OF THE MINING CLAIM OF

George Henninger, et al

KNOWN AS THE

"McKinney" "Logan" and "Gowen"  
Sitab Mining District,

Cochise County, Arizona

Section: Approx, Township 23 S, Range 24 E

Surveyed under instructions dated February 15<sup>th</sup>, 1905

by Franklin H. Smith  
U. S. Deputy Mineral Surveyor.

Claim located See Location Notices, 1

Survey commenced March 1<sup>st</sup>, 1905

Survey completed March 3<sup>rd</sup>, 1905

Post Office Address of  
Clumants, Bisbee, Cochise County  
Arizona

*This OK  
area OK  
ledges OK  
4/28-95*

Survey No. 2028.  
McKinley.

Feet

Beginning at Cor.No.1 the NE cor identical with location and with Cor.No.4 Grover lode of this survey a pine post 4 ft long 4 ins sq set 1 ft in the ground in a mound of stones and scribed 1-2028 McK L whence a pine post of same dimensions and scribed 1-3-2028 W C brs N.  $25^{\circ} 32' E$ . 50 ft and a second pine post of same dimensions and scribing brs. S.  $25^{\circ} 32' W$ . 50ft., and NW cor Sec 30 Tp 23 S R 25 E G & S R B&M brs. S.  $64^{\circ} 47' E$  3411.6 ft.

Thence S.  $25^{\circ} 32' 30" W$ .

300.0 along line 4-3 Grover lode of this survey to original location for E B C location,

600.0 same bearing to Cor.No.2 the SE cor identical with location and with Cors.No.3 and 4 respectively of Grover and Logan lodes of this survey, a pine post 4 ft long 4 ins sq set 1 ft in the ground in a mound of stones and scribed 2-2028 McKX whence a pine post of same dimensions and scribed W. C 3-2-4-2028 brs. S.  $25^{\circ} 32' W$ . 50 ft and a second pine post of same dimensions and scribing brs. N.  $25^{\circ} 32' E$ . 50 ft.,

Thence N  $86^{\circ} 37' W$

524.2 to the intersection of line 1-4 New York lode, Survey No 1962 at S.  $48^{\circ} 50' E$ . 1006.4 ft from Cor.No.4.

1467.4 same bearing to Cor.No.3, the SW cor identical with location a pine post 4 ft long 4 ins sq set 1 ft in the ground in a mound of stones and scribed 3-2028 McK L whence a pine post of same dimensions and scribed W. C. 3\_2028 brs N.  $25^{\circ} 32' E$ . 50 ft and a second pine post of same dimensions and scribing brs. S.  $25^{\circ} 32' W$ . 50 ft

Thence N.  $25^{\circ} 32' 30" E$

300 ft to original location for W B C

600 same bearing to Cor.No.4 the NW cor identical with location and situated on line 1-4 New York lode survey No.1962 S.  $48^{\circ} 50' E$ . 99.4 ft from Cor.No.4

Deet

a pine post 4 ft long 4 ins sq set 1 ft in the ground in a mound of stones and scribed 4-2028 McK L whence a pine post of same dimensions and scribed W. C. 4-2028 brs N 25° 32' E. 50 ft and a second pine post of same dimensions and scribing brs. S. 25° 32' W. 50 ft

Thence S 86° 37' E. 146

1467.4 to Cor.No.1 the place of beginning.

Ledge.

The presumed course of the vein on this claim is from the W end center of location S. 86° 37' E. 1467.4 ft

#### G R O V E R

Beginning at Cor.No.1 the NE cor identical with location a pine post 4 ft long 4 ins sq set 1 ft in the ground in a mound of stones and scribed 1-2028 G L whence a pine post of same dimensions and scribed W C. 1-2028 brs S. 25° 32' W 50 ft and a second pine post of same dimensions and scribing brs. N. 25° 32' E. 50 ft and NW cor Sec 30 Tp 23 S R 25 E G & S R B & M brs. S. 54° 10' E. 1491.2 ft.

Thence S. 25° 32' 30" W.

300.0 to original location for E E C

600.0 same bearing to Cor.No.2 the SE cor identical with location and with Cor.No.1 Logan lode of this survey a pine post etc and scribed 2-2028 G L.

Thence N. 78° 58' W

1500.0 along line 1-4 Logan lode of this survey to Cor.No.3 the SW cor, identical with location and with Cors.No.2 and 4 respectively of McKinley and Logan lodes of this survey a pine post etc scribed 3-2028 G L

Thence N. 25° 32' 30" E

300.0 to original location for W E C

600.0 same bearing along line 2-1 McKinley lode of this survey to Cor.No.4 the NW cor identical with location and with Cor.No.1 McKinley lode of this survey a pine post etc scribed 4-2028 G L

Feet

1500.0 Thence S. 78° 56' E.  
to Cor.No.1 the place of beginning.

Ledge.

The presumed course of the vein on this claim is  
from the W end center of location S. 78° 56' E. 1500.ft.

L O G A N

Beginning at Cor.No.1 the NE cor identical with lo-  
cation and with Cor.No.2 Grover lode of this survey a  
pine post 4 ft long 4 ins sq set 1 ft in the ground in  
a mound of stones and scribed 1-2028 L L. whence a  
pine post of same dimensions and scribed W. C. 1-2-2028  
brs. S. 25° 32' W. 50 ft and a second pine post of same  
dimensions and scribed ing brs, N. 25° 32' E 50 ft and  
NW cor Sec 30 Tp 23 S R 25 E G & S R B & M brs. S. 71°  
34' E. 1974.4 ft.

Thence S. 25° 32' 30" W.

300.0 to original location for E E C

600.0 same bearing to Cor.No.2 the SE cor identical with lo-  
cation a pine post 4 ft long 4 ins sq set 1 ft in the  
ground in a mound of stones and scribed 2-2028 L L whence  
a pine post of same dimensions and scribed W. C. 2-2028  
brs N. 25° 32' E 50 ft and a second pine post of same di-  
mensions and scribing brs. S. 25° 32' W 50 ft

Thence N. 78° 56' W

1500.0 to Cor.No.3 the SW cor identical with location a pine  
post 4 ft long 4 ins sq set 1 ft in the ground in a  
mound of stones and scribed ~~3-2028~~ L L whence a pine post  
of same dimensions and scribed W. C. 3-2028 brs ~~brs.~~  
N 25° 32' E 50 ft and a second pine post of same dimensions  
and scribing brs. S. 25° 32' W. 50 ft ,

Thence N. 25° 32' 30 " E.

300.0 to original location for W end center

600.0 same bearing to Cor.No.4 the NW cor identical with lo-  
cation and with Cors.No.2 and 3 respectively of McKinley  
and Grover lodes of this survey and with a cor of McKinley

fraction lode unsurveyed, a pine post etc scribed  
4-2028 L L,

Thence S. 78° 56' E.

1500.0 along line 3-2 Grover lode of this survey to Cor.No.1  
the place of beginning.

Ledge

The presumed course of the ledge on this claim is  
from the W end center location S. 78° 56' E. 1500 ft.

IMPROVEMENTS.

I hereby certify that the value of the labor and  
improvements on this group placed thereon by the claimants  
or their grantors is as follows:

Mc KINLEY

No.1 Discovery shaft 4x6x10 ft brs from the point of intersec-  
tion of line 2-3 McKinley lode with line 1-4 New York lode  
Survey No.1962 which point being N. 86° 37' W. 524.3 ft from  
Cor.No.2 McKinley lode N. <sup>46° 20'</sup> 22° 23' E. <sup>180.0</sup> 208 ft., Value \$100 \$100

LOGAN

No.1 Discovery open cut 4 x10x18 ft brs from Cor.No.4 S.60°  
33' E. 770 ft., Value 100

GROVER

No.1 Discovery shaft 4x6x10 ft brs from Cor.No.2 N.3 22°23' E  
208 ft , Value 100

Note Complete affidavit of \$500 improvements on each claim will  
be filed before the expiration of publication.

AREA.

Total area McKinley lode	18.719 acres
Less area in conflict with New York lode, Survey No.1962,	<u>6.016</u>
Net area McKinley lode	12.703 acres.
Total and net area Logan lode,	20.005
Total and net area Grover lode	<u>20.005</u>
Total and net area group	52.713 acres.

ADJOINING CLAIMS.

North Omega and Morning Star lodes, unsurveyed owned by applicants.  
 East William Penn and Stevenson lodes, unsurveyed, same owner  
 South Blaine and McKinley fraction lodes, unsurveyed, same  
 owners.  
 West. New York lode, Survey No 1962 G.J. McCabe et al owner.

LOCATION

This claim is located about  $3 \frac{1}{2}$  mi in an E direction from the City of Bisbee on unsurveyed lands in the Warren Mining District, Cochise County, Territory of Arizona approximately in Tp 23 S R 24 E G & S R E & M

INSTRUMENT.

This survey was made with a Leitz mountain and mining transit the courses were deflected from the true meridian as determined by solar observation checked by a n observation on Polaris. The distances were measured with a 300 ft steel tape.

Magnetic variation.  $12^{\circ} 30' E$ .

*Franklin W Smith*

U.S. Deputy Mineral Surveyor.

Date at Bisbee, Arizona,

Dated the 10th day of March, 1905.

# FINAL OATHS FOR SURVEYS.

## LIST OF NAMES.

A list of the names of the individuals employed by Franklin W. Smith  
 United States Deputy Mineral Surveyor, to assist in running, measuring, and marking the lines  
 corners and boundaries described in the foregoing field notes of the survey of the mining claim  
 of George Henninger et al  
 known as the McKinley, Grover, Logan  
 and showing the respective capacities in which they acted.

Peter Chiado ..... , Chairman.  
R. W. Story ..... , Chairman.  
 ..... , Axman.  
 ..... , Flagman.

## FINAL OATHS OF ASSISTANTS.

We, Peter Chiado  
 and R. W. Story ..... , do solemnly swear that we assisted Franklin W. Smith  
W. Smith ..... , United States Deputy Mineral Surveyor, in marking the corners and  
 surveying the boundaries of the mining claim of George Henninger, et al  
Logan, "Grover" ..... , known as the "McKinley"  
 represented  
 in the foregoing field notes as having been surveyed by said deputy mineral surveyor and under  
 his direction; and that said survey has been in all respects, to the best of our knowledge and  
 belief, faithfully and correctly executed, and the corner and boundary monuments established  
 according to law and the instructions furnished by the United States Surveyor-General for  
Arizona .....

Peter Chiado ..... , Chairman.  
R. W. Story ..... , Chairman.  
 ..... , Axman .  
 ..... , Flagman.

Subscribed and sworn to by the above-named persons before me  
 this 10<sup>th</sup> day of March, 1903

Coro Smith  
 NOTARY PUBLIC  
 In and for the County of Cochise, Territory of Arizona.  
 My Commission Expires March 21, 1903.



FINAL OATH OF U. S. DEPUTY MINERAL SURVEYOR

I, Franklin W. Smith, U. S. Deputy Mineral Surveyor, do solemnly swear that, in pursuance of instructions received from the United States Surveyor General for Arizona, dated February 15<sup>th</sup> 1905 I have, in strict conformity to the laws of the United States, the official regulations and instructions thereunder, and the instructions of said Surveyor General, faithfully and correctly executed the survey of the Mining Claim of George Henningel, et al, known as the "The Kinley Logan" Grove, situate in Marathon Mining District, Cochise County, Arizona, in Section Approx., Township No. 23 S, Range No. 24 E and designated as Survey No. 2028, as represented in the foregoing field notes, which accurately show the boundaries of said mining claim as distinctly marked by monuments on the ground, and described in the attached copy of the location certificate, which was received by me from the Surveyor General with said instructions, and that all the corners of said survey have been established and perpetuated in strict accordance with the law, official regulations and instructions thereunder; and I do further solemnly swear that the foregoing are the true and original field notes of said survey and my report therein, and that the labor expended and improvements made upon said mining claim by claimant or their grantors are as therein fully stated, and that the character, extent, location and itemized value thereof are specified therein with particularity and full detail, and that no portion of said labor or improvements so credited to this claim has been included in the estimate of expenditures upon any other claim.

Franklin W. Smith  
U. S. Deputy Mineral Surveyor.

Subscribed and sworn to by the said Franklin W. Smith  
U. S. Deputy Mineral Surveyor, before me  
this 10<sup>th</sup>  
day of March, 1905

Carroll Smith  
NOTARY PUBLIC  
In and for the County of Cochise, T  
My Commission Expires March 24, 1908

# Notice of Mining Location.

## QUARTZ CLAIM.

TO ALL WHOM IT MAY CONCERN:

This mining claim, the name of which is the McKinley

Mining Claim, situate on lands belonging to the United States of America, and in which there are valuable mineral deposits, was entered upon and located for the purpose of exploration and purchase by

J. G. Pritchard, Harry Kreimeier, Geo. Henninger, H. C. Landau, L. C. Shattuck and D. O. Williams.

By the undersigned, on the 9th. day of June, 190 2.

The length of this claim is Fifteen hundred feet and 1 claim 100

feet in a northwest direction and 1400 feet in a southeast direction from

the center of the discovery shaft, at which this notice is posted, lengthwise of the claim, together with three hundred feet in width of the surface grounds, on each side of the center of said claim. The general course of the lode deposit and premises is from the Northwest to the southeast.

The claim is situated and located in the Warren Mining District, in Cochise County, in the Territory of Arizona, about three miles in a Southeasterly direction from the City of Bisbee in said County of Cochise and Territory of Arizona.

The surface boundaries of the claim are marked upon the ground as follows: Beginning at the northwest center end of claim at a monument of stone, at a point in a northwesterly direction one hundred feet from the discovery shaft (at which this notice is posted), being in the center of the northwest end line of said claim; thence westerly 300 feet to a stone monument being the northwest corner of said claim; thence southeasterly 1500 feet to a stone monument being at the southwest corner of said claim; thence easterly 300 feet to a stone monument being the center of the southeast end of said claim; thence easterly 300 feet to a stone monument, being at the southeast corner of said claim; thence northwesterly 1500 feet to a stone monument at the northeasterly corner of said claim; thence westerly 300 feet to the place of beginning.

All done under the provisions of Chapter Six of Title XXXII, of the Revised Statutes of the United States, and of an Act of the General Assembly of Arizona, entitled "An Act to Codify and Revise the Laws of the Territory of Arizona," approved March 16th, 1901.

Dated and posted on the ground this 28 day of August, 190 2

Witnesses to location

<p>.....</p> <p>.....</p> <p><u>J. R. Butler</u></p>	}	<p><u>H. C. Landau</u></p> <p><u>George Henninger</u></p> <p><u>D. O. Williams</u></p> <p><u>H. Kreimeier</u></p> <p><u>J. G. Pritchard</u></p> <p><u>L. C. Shattuck</u></p>
--	---	--

# An Act to Codify and Revise the Laws of the Territory of Arizona

## SECTIONS 1-11.—INC. LOCATION OF CLAIMS

Be it enacted by the Legislative Assembly of the Territory of Arizona:

SECTION 1. On the discovery of mineral in places on the public domain of the United States, the same may be located as a mineral claim by the discoverer for himself, for himself and others, or for others.

SECTION 2. Such location shall be made by erecting at or contiguous to the point of discovery, a conspicuous monument of stones not less than three (3) feet in height, or an upright post securely fixed, projecting at least four (4) feet above the ground, in which monument of stones or on which post, there shall be posted a location notice, which shall be signed by the name or names of the locator or locators. The location notice must contain: First, the name of the claim located; second, the name or names of the locators; third, the date of the location; fourth, the length and width of the claim in feet and the distance in feet from the point of discovery to each end of the claim; fifth, the general course of the claim; sixth, the locality of the claim with reference to some natural object or permanent monument whereby the claim can be identified.

SECTION 3. Until each and all of the above specified things shall have been done no right thereto shall be acquired.

SECTION 4. From the time of the location of a mining claim as above specified, the locator shall be allowed ninety (90) days within which to do or cause to be done, the following things: First, to cause to be recorded in the office of the County Recorder of the county in which the claim is situated, a copy of the location notice; second, to sink a discovery shaft in the claim to the depth of at least ten (10) feet from the lowest part of the rim of the shaft at the surface, and deeper if necessary, until there is discovered in said shaft mineral in place; third, to monument the claim on the ground so that its boundaries can be readily traced.

SECTION 5. A failure to do all the things enumerated in this section in the time and place specified shall be construed into an abandoning of the claim, and all right thereto of the discoverer and locator shall be forfeited.

SECTION 6. Such surface boundaries shall be marked by six (6) substantial posts, projecting at least four (4) feet above the surface of the ground, or by substantial stone monuments at least three (3) feet high, to-wit: One at each corner of said claim, and one at the center of each end line thereof.

SECTION 7. Any open-cut, adit or tunnel which shall be made as above provided for as a part of the location of a lode mineral claim, and which shall be equal in amount of work to a shaft ten (10) feet deep and four (4) feet wide by six (6) feet long, and which shall cut the lode or mineral in place at a depth of ten (10) feet from the surface, shall be equivalent as a discovery work to a shaft sunk from the surface.

SECTION 8. Location notice may be amended at any time, and the monument changed to correspond with the amended location; provided, that no change shall be made that will interfere with the rights of others.

SECTION 9. The amount of assessment or representation work or improvements to be done or made during each year, after the completion of the location as heretofore provided, and the time for doing the same shall be as provided by the laws of the United States.

SECTION 10. Within three (3) months after the expiration of the period of the time fixed for the performance of annual labor, or the making of such improvements upon any mining claim, the person on whose behalf such work or improvement was made, or some person for him knowing the facts, may make a record in the office of the County Recorder of the county wherein such claim is situated, an affidavit in substance as follows:

TERRITORY OF ARIZONA, } ss.

I, Frank Hare, being duly sworn, deposes and says that he is a citizen of the United States and more than twenty-one years of age, resides at Phoenix, in Maricopa County, Arizona Territory, and is personally acquainted with the mining claim known as Quartz Mining District, Arizona Territory, the location notice of which is recorded in the office of the County Recorder of said County, in Book 20 of Records of Mines, at page 564.

That between the 1st day of Sept, A. D. 1902, and the 1st day of Sept, A. D. 1902, at least 1000 dollars worth of work and improvements were done and performed upon said claim, not including the location work of said claim. Such work and improvements were made by and at the expense of Frank Hare, owners of said claim, for the purpose of complying with the laws of the United States, pertaining to assessments of annual work, and (here name the owners or men who worked upon the claim in doing the work) were the men employed by said owner, and who labored upon said claim, did said work and improvements, the same being as follows, to-wit: (Here describe the work done.)

Subscribed and sworn to before me, this 1st day of Sept, A. D. 1902. (Signature.)

My commission as Notary Public expires on the 1st day of Sept, A. D. 1902.

(Notary Seal) \_\_\_\_\_ Notary Public.

SECTION 11. Such affidavit, when so recorded, shall be prima facie evidence of the performance of such labor or the making of such improvements, and said original affidavit, after it has been recorded, or a certified copy of record of same, or the record of same, shall be received as evidence accordingly by the Courts of this Territory. The relocation of forfeited or abandoned lode claims shall only be made by sinking a new discovery shaft and fixing the boundary in the same manner and to the same extent as is required in making an original location; or the locator may sink the original discovery shaft ten (10) feet deeper than it was at the date of the commencement of such location, and shall erect new, or make the old monuments the same as originally required. In either case a new location monument shall be erected, and the location notice shall state if the whole or any part of the new location is located as abandoned property, else it shall be void.

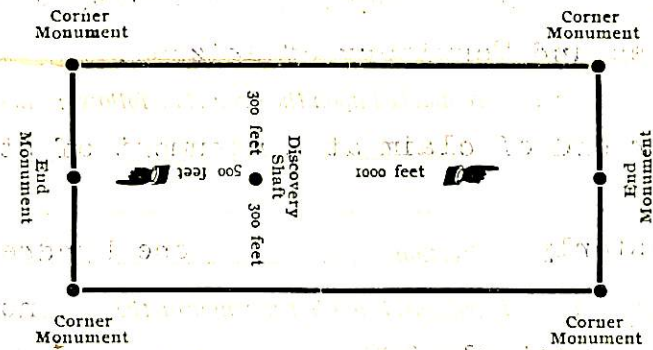

The above diagram is to give the locator a general idea of the plan of location under the new law. Your discovery shaft may be in the center of claim, or any distance from either end you desire. In the diagram we have placed it 300 feet from one end and 1000 feet from the other. In description be careful to state locality of claim with reference to some natural object, or permanent monument, so as to identify the claim.

TERRITORY OF ARIZONA, } ss.

County of Maricopa, I, Frank Hare, County Recorder in and for the County and Territory aforesaid, do hereby certify that the within instrument was filed for record at 9 o'clock A. M., on this 1st day of Sept, 1902, and duly recorded in Book No. 20 of Mining Records of Maricopa County, Arizona, at pages 564.

WITNESS my hand and official seal the day and year first above written. Frank Hare County Recorder.

Notice of Location  
QUARTZ CLAIM

Dated 1st 1902

Filed and recorded at request of Frank Hare

SEP 1 1902 A. D. 1902

at 9 M.

Book 20 Records of Mines

Pages 564

Frank Hare County Recorder.

By Frank Hare Deputy Recorder.

NO. 110.—HEERMANS STATIONERY COMPANY, TUCSON, ARIZ.

# Notice of Mining Location.

## QUARTZ CLAIM.

TO ALL WHOM IT MAY CONCERN:

This mining claim, the name of which is the Grover,

Mining Claim, situate on lands belonging to the United States of America, and in which there are valuable mineral deposits, was entered upon and located for the purpose of exploration and purchase by

J. G. Pritchard, Harry Kreimeier, Geo. Henninger, H. C. Landau, L. C. Shattuck, and D. O. Williams,

~~By~~ the undersigned, on the 9 day of June 1902

The length of this claim is fifteen hundred feet and 1 claim three hundred feet in a southeasterly direction and 1200 feet in a northwesterly direction from the center of the discovery shaft, at which this notice is posted, lengthwise of the claim, together with 300 feet in width of the surface grounds, on each side of the center of said claim. The general course of the lode deposit and premises is from the northwest to the southeast.

The claim is situated and located in the Warren Mining District, in Cochise County, in the Territory of Arizona, about three miles in a southeasterly direction from the City of Bisbee in said County of Cochise and Territory of Arizona.

The surface boundaries of the claim are marked upon the ground as follows: Beginning at the southeast end of claim at a monument of stone, southeasterly at a point in a direction 300 feet from the discovery shaft (at which this notice is posted), being in the center of the southeast end line of said claim; thence easterly 300 feet to a stone monument being the southeasterly corner of said claim; thence northwesterly 1500 feet to a stone monument being at the northeasterly corner of said claim; thence westerly 300 feet to a stone monument being the center of the northwesterly end of said claim; thence westerly 300 feet to a stone monument, being at the northwesterly corner of said claim; thence southeasterly 1500 feet to a stone monument at the southwesterly corner of said claim; thence easterly 300 feet to the place of beginning.

All done under the provisions of Chapter Six of Title XXXII, of the Revised Statutes of the United States, and of an Act of the General Assembly of Arizona, entitled "An Act to Codify and Revise the Laws of the Territory of Arizona," approved March 16th, 1901.

Dated and posted on the ground this 28 day of August 1902

Witnesses to location

J. R. Butler

H. C. Landau  
George Henninger  
D. O. Williams  
H. Kreimeier  
J. G. Pritchard  
L. C. Shattuck

# An Act to Codify and Revise the Laws of the Territory of Arizona

## SECTIONS 1-11.—INC. LOCATION OF CLAIMS

Be it enacted by the Legislative Assembly of the Territory of Arizona:

SECTION 1. On the discovery of mineral in places on the public domain of the United States, the same may be located as a mineral claim by the discoverer for himself, for himself and others, or for others.

SECTION 2. Such location shall be made by erecting at or contiguous to the point of discovery, a conspicuous monument of stones not less than three (3) feet in height, or an upright post securely fixed, projecting at least four (4) feet above the ground, in which monument of stones or on which post, there shall be posted a location notice, which shall be signed by the name or names of the locator or locators. The location notice must contain: First, the name of the claim located; second, the name or names of the locators; third, the date of the location; fourth, the length and width of the claim in feet and the distance in feet from the point of discovery to each end of the claim; fifth, the general course of the claim; sixth, the locality of the claim with reference to some natural object or permanent monument whereby the claim can be identified.

SECTION 3. Until each and all of the above specified things shall have been done no right thereto shall be acquired.

SECTION 4. From the time of the location of a mining claim as above specified, the locator shall be allowed ninety (90) days within which to do or cause to be done, the following things: First, to cause to be recorded in the office of the County Recorder of the county in which the claim is situated, a copy of the location notice; second, to sink a discovery shaft in the claim to the depth of at least ten (10) feet from the lowest part of the rim of the shaft at the surface, and deeper if necessary, until there is discovered in said shaft mineral in place; third, to monument the claim on the ground so that its boundaries can be readily traced.

SECTION 5. A failure to do all the things enumerated in this section in the time and place specified shall be construed into an abandoning of the claim, and all right thereto of the discoverer and locator shall be forfeited.

SECTION 6. Such surface boundaries shall be marked by six (6) substantial posts, projecting at least four (4) feet above the surface of the ground, or by substantial stone monuments at least three (3) feet high, to-wit: One at each corner of said claim, and one at the center of each end line thereof.

SECTION 7. Any open-cut, adit or tunnel which shall be made as above provided for as a part of the location of a lode mineral claim, and which shall be equal in amount of work to a shaft ten (10) feet deep and four (4) feet wide by six (6) feet long; and which shall cut the lode or mineral in place at a depth of ten (10) feet from the surface, shall be equivalent as a discovery work to a shaft sunk from the surface.

SECTION 8. Location notice may be amended at any time, and the monument changed to correspond with the amended location; provided, that no change shall be made that will interfere with the rights of others.

SECTION 9. The amount of assessment work or representation work or improvements to be done or made during each year, after the completion of the location as heretofore provided, and the time for doing the same shall be as provided by the laws of the United States.

SECTION 10. Within three (3) months after the expiration of the period of the time fixed for the performance of annual labor, or the making of such improvements upon any mining claim, the person on whose behalf such work or improvement was made, or some person for him knowing the facts, may make a record in the office of the County Recorder of the county wherein such claim is situated, an affidavit in substance as follows:

TERRITORY OF ARIZONA,

ss.

..... being duly sworn, deposes and says that he is a citizen of the United States and more than twenty-one years of age, resides at ..... County, Arizona Territory, and is personally acquainted with the mining claim known as ..... Mining District, Arizona Territory, the location notice of which is recorded in the office of the County Recorder of said County, in Book ..... of Records of Mines, at page .....

That between the ..... day of ..... A. D. ...., and the ..... day of ..... A. D. .... at least ..... dollars worth of work and improvements were done and performed upon said claim, not including the location work of said claim. Such work and improvements were made by and at the expense of ..... owners of said claim, for the purpose of complying with the laws of the United States, pertaining to assessments of annual work, and (here name the owners or men who worked upon the claim in doing the work) were the men employed by said owner, and who labored upon said claim, did said work and improvements, the same being as follows, to-wit: (Here describe the work done.)

Subscribed and sworn to before me, this ..... day of ..... A. D. .... (Signature.)

My commission as Notary Public expires on the ..... day of ..... A. D. ....

(Notary Seal.)

Notary Public.

SECTION 11. Such affidavit, when so recorded, shall be prima facie evidence of the performance of such labor or the making of such improvements, and said original affidavit, after it has been recorded, or a certified copy of record of same, or the record of same, shall be received as evidence accordingly by the Courts in this Territory. The relocation of forfeited or abandoned lode claims shall only be made by sinking a new discovery shaft and fixing the boundary in the same manner and to the same extent as is required in making an original location; or the relocater may sink the original discovery shaft ten (10) feet deeper than it was at the date of the commencement of such location, and shall erect new, or make the old monuments the same as originally required. In either case a new location monument shall be erected, and the location notice shall state if the whole or any part of the new location is located as abandoned property, else it shall be void.

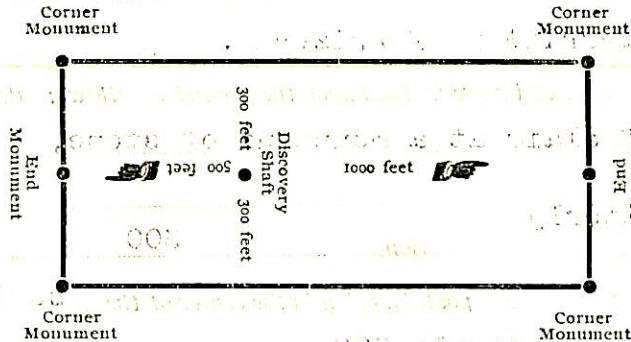

The above diagram is to give the locator a general idea of the plan of location under the new law. Your discovery shaft may be in the center of claim, or any distance from either end, you desire. In the diagram we have placed it 300 feet from one end and 1000 feet from the other. In description be careful to state locality of claim with reference to some natural object, or permanent monument, so as to identify the claim.

TERRITORY OF ARIZONA,

ss.

County of Cochise

*Franklin*

County Recorder in and for the County and Territory aforesaid,

do hereby certify that the within instrument was filed for record at ..... o'clock ..... M., on this ..... day of ..... 190....., and duly recorded in Book No. .... of ..... Records of ..... County, Arizona, at pages .....

WITNESS my hand and official seal the day and year first above written.

*Franklin*  
County Recorder.

### Notice of Location

QUARTZ CLAIM

*Franklin*

Dated ..... 190.....

Filed and recorded at request of

*Franklin*

at ..... A. D. 190.....

Book 22 Record of Mines

Pages 4

*Franklin*  
County Recorder.

*Franklin*  
Deputy Recorder.

By *Franklin*

# Notice of Mining Location.

## QUARTZ CLAIM.

TO ALL WHOM IT MAY CONCERN:

This mining claim, the name of which is the Logan,

Mining Claim, situate on lands belonging to the United States of America, and in which there are valuable mineral deposits, was entered upon and located for the purpose of exploration and purchase by.....

J. C. Britchard, Harry Kreimeier, Geo. Henninger, H. C. Landau, L. C. Shattuck and D. O. Williams,

by the undersigned, on the 9th. day of June, 1902.

The length of this claim is Fifteen hundred feet  
feet and 1 claim Seventy-five

feet in a northwesterly direction and Fourteen hundred  
and twenty-five feet in a Southeasterly direction from

the center of the discovery shaft, at which this notice is posted, lengthwise of the claim, together with three hundred

feet in width of the surface grounds, on each side of the center of said claim. The general course of the lode deposit and premises is from the northwesterly to the southeasterly.

The claim is situated and located in the Warren Mining District, in Cochise County, in the Territory of Arizona, about three miles

in a southeasterly direction from City of Bisbee in said County of Cochise and Territory of Arizona.

The surface boundaries of the claim are marked upon the ground as follows: Beginning at the northwesterly end of claim at the center stone monument thereof

at a point in a northwesterly direction seventy-five feet from the discovery shaft (at which this notice is posted), being in the center of the northwesterly end line of said claim; thence westerly 300 feet to a stone monument being the northwesterly corner of said claim; thence southeasterly 1500 feet to a stone monument being at the southwesterly corner of said claim; thence easterly 300 feet to a stone monument being the center of the southeasterly end of said claim; thence easterly 300 feet to a stone monument, being at the southeasterly corner of said claim; thence northwesterly 1500 feet to a stone monument at the northeasterly corner of said claim; thence westerly 300 feet to the place of beginning.

All done under the provisions of Chapter Six of Title XXXII, of the Revised Statutes of the United States, and of an Act of the General Assembly of Arizona, entitled "An Act to Codify and Revise the Laws of the Territory of Arizona," approved March 16th, 1901.

Dated and posted on the ground this 28 day of August 1902

Witnesses to location

J. R. Butler }  
H. C. Landau  
George Henninger  
D. O. Williams  
H. Kreimeier  
J. C. Britchard  
L. C. Shattuck

# An Act to Codify and Revise the Laws of the Territory of Arizona

## SECTIONS 1-11.—INC. LOCATION OF CLAIMS

Be it enacted by the Legislative Assembly of the Territory of Arizona:

- SECTION 1. On the discovery of mineral in places on the public domain of the United States, the same may be located as a mineral claim by the discoverer for himself, for himself and others, or for others.
- SECTION 2. Such location shall be made by erecting at or contiguous to the point of discovery, a conspicuous monument of stones not less than three (3) feet in height, or an upright post securely fixed, projecting at least four (4) feet above the ground, in which monument of stones or on which post, there shall be posted a location notice, which shall be signed by the name or names of the locator or locators. The location notice must contain: First, the name of the claim located; second, the name or names of the locators; third, the date of the location; fourth, the length and width of the claim in feet and the distance in feet from the point of discovery to each end of the claim; fifth, the general course of the claim; sixth, the locality of the claim with reference to some natural object or permanent monument whereby the claim can be identified.
- SECTION 3. Until each and all of the above specified things shall have been done no right thereto shall be acquired.
- SECTION 4. From the time of the location of a mining claim as above specified, the locator shall be allowed ninety (90) days within which to do or cause to be done, the following things: First, to cause to be recorded in the office of the County Recorder of the county in which the claim is situated, a copy of the location notice; second, to sink a discovery shaft in the claim to the depth of at least ten (10) feet from the lowest part of the rim of the shaft at the surface, and deeper if necessary, until there is discovered in said shaft mineral in place; third, to monument the claim on the ground so that its boundaries can be readily traced.
- SECTION 5. A failure to do all the things enumerated in this section in the time and place specified shall be construed into an abandoning of the claim, and all right thereto of the discoverer and locator shall be forfeited.
- SECTION 6. Such surface boundaries shall be marked by six (6) substantial posts, projecting at least four (4) feet above the surface of the ground, or by substantial stone monuments at least three (3) feet high, to-wit: One at each corner of said claim, and one at the center of each end line thereof.
- SECTION 7. Any open-cut, adit or tunnel which shall be made as above provided for as a part of the location of a lode mineral claim, and which shall be equal in amount of work to a shaft ten (10) feet deep and four (4) feet wide by six (6) feet long, and which shall cut the lode or mineral in place at a depth of ten (10) feet from the surface, shall be equivalent as a discovery work to a shaft sunk from the surface.
- SECTION 8. Location notice may be amended at any time, and the monument changed to correspond with the amended location; provided, that no change shall be made that will interfere with the rights of others.
- SECTION 9. The amount of assessment or representation work or improvements to be done or made during each year, after the completion of the location as heretofore provided, and the time for doing the same shall be as provided by the laws of the United States.
- SECTION 10. Within three (3) months after the expiration of the period of the time fixed for the performance of annual labor, or the making of such improvements upon any mining claim, the person on whose behalf such work or improvement was made, or some person for him knowing the facts, may make a record in the office of the County Recorder of the county wherein such claim is situated, an affidavit in substance as follows:

TERRITORY OF ARIZONA, } ss.

.....being duly sworn, deposes and says that he is a citizen of the United States and more than twenty-one years of age, resides at.....in.....County, Arizona Territory, and is personally acquainted with the mining claim known as.....Mining District, Arizona Territory, the location notice of which is recorded in the office of the County Recorder of said County, in Book.....of Records of Mines, at page.....

That between the.....day of.....A. D.....and the.....day of.....A. D.....at least.....dollars worth of work and improvements were done and performed upon said claim, not including the location work of said claim. Such work and improvements were made by and at the expense of.....owners of said claim, for the purpose of complying with the laws of the United States, pertaining to assessments of annual work, and (here name the owners or men who worked upon the claim in doing the work) were the men employed by said owner, and who labored upon said claim, did said work and improvements, the same being as follows, to-wit: (Here describe the work done.)

Subscribed and sworn to before me, this.....day of.....A. D.....(Signature.)

My commission as Notary Public expires on the.....day of.....A. D.....

(Notary Seal.)

Notary Public.

SECTION 11. Such affidavit, when so recorded, shall be prima facie evidence of the performance of such labor or the making of such improvements, and said original affidavit, after it has been recorded, or a certified copy of record of same, or the record of same, shall be received as evidence accordingly by the Courts of this Territory. The relocation of forfeited or abandoned lode claims shall only be made by sinking a new discovery shaft and fixing the boundary in the same manner and to the same extent as is required in making an original location; or the locator may sink the original discovery shaft ten (10) feet deeper than it was at the date of the commencement of such location, and shall erect new, or make the old monuments the same as originally required. In either case a new location monument shall be erected, and the location notice shall state if the whole or any part of the new location is located as abandoned property, else it shall be void.

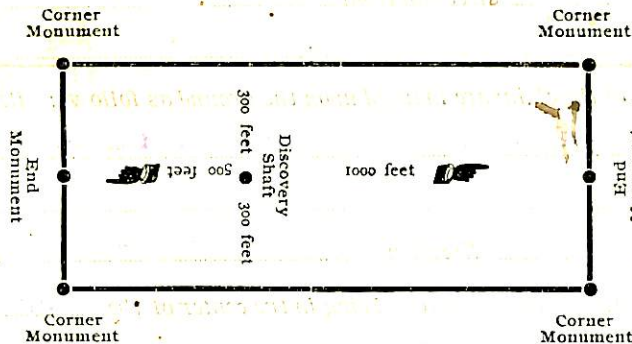

The above diagram is to give the locator a general idea of the plan of location under the new law. Your discovery shaft may be in the center of claim, or any distance from either end you desire. In the diagram we have placed it 300 feet from one end and 1000 feet from the other. In description be careful to state locality of claim with reference to some natural object, or permanent monument, so as to identify the claim.

TERRITORY OF ARIZONA, } ss.

County of Coconino }  
Frank Dare County Recorder in and for the County and Territory aforesaid, do hereby certify that the within instrument was filed for record at 9 o'clock P. M., on this 20 day of Sept, 1902, and duly recorded in Book No. 30 of Quartz Records of Coconino County, Arizona, at pages 567.

WITNESS my hand and official seal the day and year first above written.

Frank Dare  
County Recorder.

### Notice of Location

QUARTZ CLAIM

Frank Dare

Dated 20 Sept 1902

Filed and recorded at request of Frank Dare

SEP 1 1902 A. D. 1902

at 9 P. M.

Book 30 Record of Mines

Pages 567

Frank Dare  
County Recorder.

Frank Dare  
Deputy Recorder.

4-687.

SURVEYOR-GENERAL'S CERTIFICATE OF APPROVAL OF FIELD NOTES AND SURVEY OF MINING CLAIM.

Department of the Interior,

Office of U. S. Surveyor-General,

Phoenix, Arizona.

June 9, 1905

I, U. S. Surveyor-General for the district of Arizona.

do hereby certify that the foregoing and hereto attached Field Notes and Return of the Survey of the Mining Claim of George Henninger et al.

known as the McKinley, Logan, Grover.

situate in Warren Mining District, Cochise County, Arizona.

in Section approx., Township No. 23 S., Range No. 24 E. unsurveyed, designated as Survey No. 2028

executed by Franklin W. Smith, U. S. Deputy Mineral Surveyor, March 1st to 3rd 1905, 190, under my instructions dated Feb. 15th 1905, 190, have been critically examined and the necessary cor-

rections and explanations made, and the said Field Notes and Return, and the Survey they describe, are hereby approved. A true copy of the copy of the location certificate filed by the applicant. for survey is included in the field notes.

Frank S. Sigall

U. S. Surveyor-General for Arizona.



4-688.

## U. S. SURVEYOR-GENERAL'S FINAL CERTIFICATE ON FIELD NOTES.

**Department of the Interior,**

OFFICE OF U. S. SURVEYOR-GENERAL,

.....Phoenix, Arizona.....

.....June 9, 1905....., 190.....

I, U. S. Surveyor-General for .....the district of Arizona.....  
do hereby certify that the foregoing transcript of the Field Notes, return and approval of the survey  
of the mining claim of .....George Henninger et al.....

known as the.....McKinley, Logan & Grover.....

situate in.....Warren.....

Mining District,.....Cochise.....County,.....Arizona.....

in Section approx....., Township No. 23 S....., Range No. 24 E. (unsurveyed) and

designated as Survey No. 2028....., has been correctly copied from the originals on file in

this office; that said Field Notes furnish such an accurate description of said mining claim as will, if

incorporated into a patent, serve fully to identify the premises, and that such reference is made therein

to natural objects or permanent monuments as will perpetuate and fix the *locus* thereof.

And I further certify that <sup>less than</sup> five hundred dollars' worth of labor has been expended or improve-  
each of  
ments made upon said mining claims by claimant or their grantors, and that said improvements  
consist of at time of survey, McKinley lode Dis. shaft value \$100.

Logan lode Dis. open cut value \$100., Grover lode Dis. shaft  
value \$100.

and that no portion of said labor or improvements has been included in the estimate of expenditures  
upon any other claim.

I further certify that the plat thereof, filed in the U. S. Land Office at Tucson, Arizona.

..... is correct and in conformity with the foregoing Field Notes.

(Signed) Frank S. Sigalls.

United States Surveyor-General for Arizona.....

Improvements.

I hereby certify that the value of the labor and improvements on this group placed thereon by claimants or their grantors, is not less than \$500 for each location thereof, and that said improvements were made before the first day of August, 1905, and prior to the expiration of the period of publication of the application for patent:

*said improvements are as follows:*

"McKinley"

No. 1	Discovery shaft 4x6x10 ft brs from point of intersection of line 2-3 McKinley lode with line 1-4 New York lode Survey No. 1968, which point of intersection being N. 86° 37' W. 524.3 ft from Cor. No 2 McKinley lode, N. 46° 20' E. 180 ft. Value,	\$100.00
No. 2	Shaft 4x6x10 ft open cut 4x5x8 ft brs from same point N. 75° 40' E. 140 ft., Value,	150.00
No. 3	Shaft 6x10x7.5 ft. brs from same point N. 60° 40' E. 350 ft Value,	75.00
No. 4	Shaft 5x10x9 ft. and open cut 5x4x8 ft. brs from same point N. 47° 40' E. 350 ft Value,	100.00
No. 5	Open cut 8x10x12 ft. center of mouth of which brs from same point N. 42° 40' E. 165 ft., Value,	<u>100.00</u>
No. 6	Shaft 4x6x10 ft brs from W E C location N. 86° 37' W 416 ft on ledge, Value,	<u>100.00</u>

Total improvements McKinley lode,

\$625.00

"Grover"

No. 1	Discovery shaft 4x6x10 ft brs from Cor. No. 2, N. 22° 23' E. 280 ft., Value,	100.00
No. 2.	Shaft 4x6x10 ft brs from Cor. No. 2 N. 0° 26' E. 295 ft., Value,	100.00
No. 3	Shaft 4x6x10 ft brs from W E C location S. 78° 56' E. 120 ft., Value,	100.00
No. 4	Shaft 4x6x10 ft brs from W E C location S. 78° 56' E. 214 ft., Value,	100.00
No. 5	Shaft 4x6x10 ft brs from W E C location S. 78° 56' E. 337 ft., Value,	<u>100.00</u>

Total improvements on Grover lode,

500.00

Logan.

No.1	Discovery open cut 4x10x18 ft brs from Cor.No.4, S.60° 23' E. 770 ft., Value,	\$100.00
No.2	Shaft 4x12x7.5 ft <i>brs</i> from same point S.61° 27' E 783 ft., Value,	100.00
No.3	Shaft 6x10x7.5 ft brs from Cor.No.4, S 59° 46' E. 756 ft Value	100.00
No.4	Shaft 4x6x10 ft brs from " E C location S. 78° 56' E. 600 ft., Value,	100.00
No.5	Shaft 4x6x10 ft brs from " E C location, S.78° 56' E. 122 ft., Value,	<u>100.00</u>
	Total Improvements on Logan lode,	<u>\$500.00</u>
	Total improvements on group	\$1625.00

*Franklin W. Smith*

U. S. Deputy Mineral Surveyor

Dated at Bisbee, Arizona,

August 20, 1905.

Affidavit of Five Hundred Dollars Improvements.

We, R. A. Ziesemer, and F. C. Severens

of lawful age, being first duly sworn according to law, depose and say: That we are acquainted with the McFuey, Lager, Groves mining claim, situate in Warren Mining district, Cochise County, Arizona Territory, for which George Hennings et al

have made application for survey prior to application for patent under the provisions of the Act of Congress, approved May 10, 1872; and that the labor done and improvements made thereon by the applicant s. and the grantor s. exceed Five Hundred Dollars in value, for each location thereof and further that we are not personally interested in said mine.

R. A. Ziesemer  
F. C. Severens

TERRITORY OF ARIZONA, }  
County of Cochise } ss:

Sworn to and subscribed before me, this 20<sup>th</sup>

day of August, 1905



Corra E. Smith

NOTARY PUBLIC  
In and for the County of Cochise, Territory of Arizona,  
My Commission Expires March 21, 1908.

(4-691.)

# Certificate of U. S. Surveyor General

AS TO

EXPENDITURES REPORTED AFTER RETURN OF SURVEY OF MINING CLAIM.

I, U. S. Surveyor General for Dist. of Arizona,  
do hereby certify that Five Hundred Dollars' worth of labor has been expended or  
improvements made by claimant or their grantors, upon the mining claim of  
George Henninger et al

known as the McKinley, Grover and Logan,  
situate in Warren mining district,  
Cochise County, Arizona  
in Section \_\_\_\_\_, Township No. \_\_\_\_\_, Range No. \_\_\_\_\_;  
that said improvements consist of 14 shafts, and 4 cuts, total value  
\$1625.00

\_\_\_\_\_, and that no portion of said labor or improvements has been  
included in the estimate of expenditures upon any other claim. A copy of the report of  
Franklin W. Smith, U. S. Deputy Mineral Surveyor, dated  
August 20, 1905, 18\_\_\_\_, is hereto attached.



U. S. Surveyor General for Arizona.

Office of U. S. Surveyor General,

\_\_\_\_\_, 1 \_\_\_\_\_

