

MS

0

2

0

6

3

JUN. 16 1905

JUL 5 - 1905

revised by [unclear] 7/20/05

(4-683.)

Mineral Survey No. 2063A^{2d}/B

Lot No.

Gila Land District.

FIELD NOTES

OF THE SURVEY OF THE MINING CLAIM OF

Pentana Mining Co.

KNOWN AS THE

Enterprise - Nineteen - Orndorff and Colorado
and Orndorff Mill-site
Pentana Mining District,

Pima County, Arizona

Section 11, Township 20 S., Range 7 E (unsurveyed)

Surveyed under instructions dated May 20th, 1905

by Philip Couzner
U.S. Deputy Mineral Surveyor

Claim located see location notices

Survey commenced June 12th, 1905

Survey completed June 14th, 1905

U 6-100

*195
Emergency treated
OK*

*E. L. Vail,
Manager
Tucson, Ariz*

Surv. No 2063 A and B.

Enterprise lode
 Beginning at Cor. No 1
 Identical with the location,
 which is a mound of stone
 2 ft. base, 2 ft high
 A porphyry 24x8x2 ins., set
 12 ins. in the ground with
 mound of stone, chiseled E-1-2063A,
 whence
 U. S. S. M. No 2063, bears S 29° 5' E
 520.9 ft

A cross (X) and B. R. - 1 - 2063 A
 chiseled on a porphyry boulder
 showing 2x2x2 ft, above ground
 bears S 51° 15' E 11 ft

A cross (X) and B. R. - 1 - 2063 A
 chiseled on a porphyry stone
 2x2x2 ft, above ground, bears
 North 29 ft.

Thence S 51° 42' W
 74 13° E

285 Gulch, course N. W

300 S. E. end center monument,
 Identical with the location
 which is a mound of stone
 2 1/2 ft base, 2 1/2 ft high

550 Gulch, course N. W

600 To Cor. No 2,

Identical with the location,
 which is a mound of stone
 2 1/2 ft. base, 2 1/2 ft high

A porphyry stone 24x12x4
 ins., set 12 ins. in the ground
 with mound of stone, chiseled
 E-2-2063A, whence

A cross (X) and B. R. - 2 - 2 - 2 - 2063A,
 chiseled on a portland stone
 2x2x1 ft, bears N 36° W - 51 ft

A cross (X) and B. R. - 2 - 2 - 2 - 2063A,
 chiseled on a porphyry stone
 1x1x1 ft, above ground, bears

$N 82^{\circ} 30' E$ 30 ft

Thence $N 46^{\circ} 36' W$

$N 4$ $13^{\circ} E$

- 50 Gulch, course $N. W$
 225 Gulch, course $S. W$
 700 Gulch, course $N.$
 1105 Gulch, course $N 40^{\circ} W$
 1300 Gulch, course $N. W$
 1500 To Cor. No 3

Identical with the location,
 which is a mound of stone
 $2\frac{1}{2}$ ft. base, $2\frac{1}{2}$ ft. high
 A porphyry stone $24 \times 15 \times 12$ ins.
 set 12 ins. in the ground with
 mound of stone, chiseled
 E-3-2063A, whence

A mesquite, 6 ins. diam., scribed
 and blazed E-3-2063A-B.T. bears
 $N 11^{\circ} E$ 64 ft

A mesquite, 10 ins. diam., scribed
 and blazed E-3-2063A-B.T. bears
 $N 58^{\circ} W$ - 54 ft.

Thence $N 51^{\circ} 42' E$

$N 4$ $13^{\circ} E$

- 205 Gulch, course $N. W$
 300 $N. W$ end center monument,
 identical with the location,
 which is a mound of stone
 $2\frac{1}{2}$ ft. base, $2\frac{1}{2}$ ft. high
 400 Gulch, course $N. W$
 600 To Cor. No 4.

Identical with the location,
 which is a mound of stone
 $2\frac{1}{2}$ ft. base, $2\frac{1}{2}$ ft. high
 A porphyry stone $24 \times 12 \times 12$
 ins., set 12 ins. in the ground
 with mound of stone, chiseled
 E-3-2063A, whence

A palo verde, 4 ins. diam., scribed
 and blazed E-4-2063A-B.T.
 bears $S 53^{\circ} E$ 33 ft

A mesquite 4 ins. diam., scribed
and blazed E 4 - 2063 A - B.T.,
bears $N 2^{\circ} W - 30 \text{ ft}$
Thence $S 46^{\circ} 36' E$
 $\frac{1}{4} 13^{\circ} E$

- 305 Gulch, course S.W
- 410 Gulch, course westerly
- 1500 To Cor. No 1 the place of
beginning.

Ninety-nine rods
Beginning at Cor. No 1
Identical with the location,
which is a mound of stone,
 $2\frac{1}{2} \text{ ft. base, } 2\frac{1}{2} \text{ ft high,}$
A porphyry stone $24 \times 12 \times 12$
ins., set 12 ins. in the ground
with mound of stone,
chiseled N-1-2063 A, whence
U. S. Lve. Mon. No 2063, bears
 $N 40^{\circ} 28' E \ 440.7 \text{ ft}$

A cross (x) and B. R. 1-1-2063A,
chiseled on a porphyry stone
 $2 \times 1 \times 1 \text{ ft. above the ground,}$
bears $N 52^{\circ} 45' E \ 15 \text{ ft}$

A cross (x) and B. R. 1-1-2063A
chiseled on a porphyry stone
 $2 \times 1 \times 1 \text{ ft. above the ground,}$
bears $N 15^{\circ} W - 28 \text{ ft}$
Thence $N 46^{\circ} 36' W$
 $\frac{1}{4} 13^{\circ} E$

- 28 Gulch, course N.
- 302.9 N.E. end center monument
Identical with the location
which is a mound of stone
 $2\frac{1}{2} \text{ ft. base, } 2\frac{1}{2} \text{ ft high,}$
- 353 Gulch, course westerly
- 536 Road bears westerly
- 605.8 To Cor. No 2
Identical with the location
and Cor. No 2, Enterprise hole
of this survey, I mark

stone N-2-2063A

Thence $S 51^{\circ} 42' W$

- 65 Road, bears E. and W
 185 Gulch, course W
 300 Ridge, bears N.W. and S.E.
 500 Gulch, course N.W.
 600 Gulch, course N.W.
 900 Gulch, course North
 1500 To Cor. #03,

Identical with the location,
 which is a mound of stone
 $2\frac{1}{2}$ ft base, $2\frac{1}{2}$ ft high
 A porphyry stone, $24 \times 12 \times 12$ ins,
 set 12 ins. in the ground
 with mound of stone, chiseled
 N-3-2063A, whence

A cross (X) and B.R. N-3-2063A
 chiseled on a porphyry ledge
 $7 \times 1 \times 1$ ft above the ground,
 bears $S 66^{\circ} E$, 7 ft

A cross (X) and B.R. N-3-2063A
 chiseled on a porphyry ledge
 $1 \times 1 \times 20$ ft above the ground,
 bears $N 22^{\circ} 30' E$ 40 ft

Thence $S 46^{\circ} 36' E$

$N 13^{\circ} E$

- 150 Gulch, course N.E.
 3029 S.W. end center monument
 Identical with the location,
 which is a mound of stone
 $2\frac{1}{2}$ ft. base, $2\frac{1}{2}$ ft high
 605.8 To Cor. #04
 Identical with the location
 which is a mound of stone
 $2\frac{1}{2}$ ft. base, $2\frac{1}{2}$ ft. high
 A porphyry stone $24 \times 12 \times 12$ ins,
 set 12 ins. in the ground
 with mound of stone, chiseled
 N-4-2063A, whence
 A cross (X) and B.R. N-4-2063A
 chiseled on a porphyry stone
 $3 \times 2 \times 2$ above the ground.

bears $N 85^{\circ} E$ 20.7 ft.

A mesquite, 5 ins. diam., blazed and scribbled N-4-2063 A. B.T.

bears $N 10^{\circ} E$ 30 ft.

Thence $N 51^{\circ} 42' E$

$\frac{1}{4}$ $13^{\circ} E$

- 200 Gulch, course North
 700 Gulch, course N.W.
 900 Ridge, bears N and S.
 1110 Gulch, course N.
 1450 Gulch, course N.
 1500 To Cor. No. 1, the place of beginning

Orndorff lode

Beginning at Cor. No. 1

Identical with the location and Cor. No. 1 of the Ninety Nine lode of this survey.

I mark stone O-1-2063 A, whence U. S. Loc. Mon. No

2063, bears $N 40^{\circ} 28' E$ 440.7 ft

Thence $N 46^{\circ} 36' W$

$\frac{1}{4}$ $13^{\circ} E$

- 302.9 S. W. end center monument
 Identical with the location and the N. E. end center monument of the Ninety Nine lode of this survey
 605.8 To Cor. No. 2,
 Identical with the location and Cor. No. 2 of the Enterprise lode and Nine by Nine lode of this survey. I mark stone O-2-2063 A

Thence $N 51^{\circ} 42' E$

$\frac{1}{4}$ $13^{\circ} E$

- 300 S. E. end center monument of the Enterprise lode of this survey
 600 Cor. No. 1 of the Enterprise lode of this survey.

- 780 Gulch, course N. W
- 1050 Gulch, course N. W
- 1175 Gulch, course N. W
- 1500 To Cor. No 3,
 Identical with the location,
 which is a mound of
 stone, 2½ ft. base, 2½ ft
 high
 A porphyry stone, 24 x 24 x 12
 ins., set 12 ins. in the
 ground, with mound of
 stone, whence
 A cross (x) and B.R. 0-3-2063A
 chiseled on a porphyry
 stone 3 x 3 x 3 ft above the
 ground, bears S 37° 30' W - 10 ft
 A cross (x) and B.R. 0-3-2063A
 chiseled on a porphyry stone
 1 x 1 x 1 ft above the ground,
 bears N 33° E 50 ft.
 Thence S 46° 36' E
 N 13° E
- 302.9 M. E. end center monument,
 identical with the location,
 which is a mound of stone
 2½ ft. base, 2½ ft. high
- 363 Gulch, course S. W
- 605.8 To Cor. No 4,
 Identical with the location,
 which is a mound of stone,
 2½ ft. base, 2½ ft high
 A cross (x) and 0-4-2063A,
 chiseled on a porphyry
 ledge, with mound of stone,
 whence
 A cross (x) and B.R-0-4-2063A
 chiseled on a porphyry stone
 2 x 1 x 1 above ground, bears
 S 85° W - 22 ft.
 A cross (x) and B.R-0-4-2063A
 3 x 3 x 3 ft above ground, bears
 N 79° E - 34 ft

Thence $N51^{\circ}42'W$

$\frac{7}{8}$ $13^{\circ}E$

- 203.5 Gulch, course N.W.
 290 Gulch, course N.W.
 640 Gulch, course N.W.
 1310 Gulch, course N.W.
 1385 Gulch, course N.W.
 1500 To Cor. No 1, the place

of beginning
 Colorado lode
 Beginning at Cor. No 1
 Identical with the location,
 which is a mound of stone
 $2\frac{1}{2}$ ft. base, $2\frac{1}{2}$ ft. high
 of porphyry stone, $24 \times 12 \times 10$ ins.,
 set 12 ins. in the ground with
 mound of stone, chiseled
 C-1-2063 A, whence
 U. S. Loc. Mon. No 2063, bears
 $S57^{\circ}36'W$ 833.6 ft.

A cross (X) and B. R. C-1-2063 A,
 chiseled on a porphyry ledge
 bears $N5^{\circ}30'W$ 40 ft.

A cross (X) and B. R. C-1-2063 A
 chiseled on a porphyry stone
 $1 \times 2 \times 2$ ft above ground, bears
 $S26^{\circ}W$ 40 ft.

Thence $N51^{\circ}42'E$

$\frac{7}{8}$ $13^{\circ}E$

- 238.5 Cor. No 4 of the Crandorff lode,
 of this survey.
 260 Gulch, course N.W.
 300 N. W. end center monument,
 Identical with the location,
 which is a mound of stone
 $2\frac{1}{2}$ ft. base, $2\frac{1}{2}$ ft. high
 475 Gulch, course N.W.
 600 To Cor. No 2

Identical with the location
 which is a mound of stone
 $2\frac{1}{2}$ ft. base, $2\frac{1}{2}$ ft. high

A limestone $24 \times 12 \times 12$ ins.,
set 12 ins. in the ground
with mound of stone, chiseled
C-2-2063A, whence
A cross (X) and B.R. C-2-2063A chiseled on a
A porphyry stone $2 \times 2 \times 1$ ft
above the ground, bears $S20^{\circ}15'W$
33 ft.

A cross (X) and B.R. C-2-2063A
chiseled on a porphyry stone
 $1 \times 2 \times 2$ ft. above the ground,
bears $S59^{\circ}E$ 11 ft.

Thence $S67^{\circ}01'E$
 $N4^{\circ}13'E$

- 320 Ridge, bears N. and S.
1005 Gulch, course E.
1300 Gulch, course N.
1500 To Cor. No 3,

Identical with the location,
which is a mound of stone
 $2\frac{1}{2}$ ft. base, $2\frac{1}{2}$ ft. high
A porphyry stone $24 \times 8 \times 6$ ins.
set 12 ins. in the ground,
with mound of stone, chiseled
C-3-2063A, whence

A cross (X) and B.R. C-3-2063A
chiseled on a porphyry stone
 $2 \times 2 \times 1$ ft. above ground, bears
 $N56^{\circ}45'W$ 48 ft.

A cross (X) and B.R. C-3-2063A,
chiseled on a porphyry stone
 $1 \times 2 \times 3$ ft above the ground, bears
 $N31^{\circ}45'E$ 71 ft.

Thence $S51^{\circ}42'W$
 $N4^{\circ}13'E$

- 280 Gulch, course N.
300 S.E. end center monument
Identical with the location,
which is a mound of stone
 $2\frac{1}{2}$ ft. base, $2\frac{1}{2}$ ft. high
600 To Cor. No 4
Identical with the location
which is a mound of stone

2½ ft. base, 2½ ft. high
 A porphyry stone 24 x 12 x 12 ins.,
 set 12 ins. in the ground
 with mound of stone, chiseled

C 4-2063 A, whence
 A cross (X) and B. R. C 4-2063 A
 chiseled on a porphyry boulder
 2 x 2 x 2 ft above the ground, bears
 S 67° 15' W, 39 ft

A cross (X) and B. R. C 4-2063 A
 chiseled on a porphyry boulder
 2 x 2 x 2 ft above the ground, bears
 N 85° 15' E 29 ft.

Thence N 67° 11' W
 1/4 13° E

150 Gulch ^{course} North
 700 Ridge bears N. W. and S. E
 1500 To Cor. 1101, the place of
 beginning
 Area

Enterprise	20.445	A ^S
Ninety-Nine	20.658	"
Orridorff	20.658	"
Colorado	18.091	"
Net area	79.852	A ^S

Survey No 2063 B

Orridorff Mill-site
 Beginning at Cor. 1101,
 identical with the location,
 which is a mound of stone
 2½ ft. base, 2½ ft high
 A porphyry stone 24 x 12 x 12 ins.
 set 12 ins. in the ground, with
 mound of stone, chiseled
 M. S. - 1-2063, B, whence

Cor. 1101. Orridorff loc. Sur.
 No 2063 A, bears N 81° 14' W
 2301.8 ft. U. S. Loc. Mon. No 2063 bears N 71° W 2103.6 ft.

A mesquite, 16 ins. diam., blazed
 and scribed M. S. - 1-2063 B - BT,
 bears S 54° 30' W 93 ft

A mesquite 8 ins. diam., blazed
and scribed M. S. - 1-2063 B. B.T.
bears $S 78^{\circ} 30' E$ 115.7 ft

Thence $N 74^{\circ} 48' E$

$\frac{1}{4} 13^{\circ} E$

230 Gulch, course North

330 To Cor. No. 2

Identical with the location,
which is a mound of stone
 $2\frac{1}{2}$ ft. base, $2\frac{1}{2}$ ft. high

A cross (x) and M. S. - 2-2063 B
chiseled on a porphyry stone
 $4 \times 4 \times 2$ ft. in place, with mound
of stone, whence

A cross (x) and B.R.M.S. - 2-2063 B
chiseled on a porphyry
stone $2 \times 4 \times 2$ above ground,
bears $S 88^{\circ} E$, 10.5 ft

A cross (x) and B.R.M.S. - 2-2063 B,
bears $S 20^{\circ} E$, 15 ft

Thence $S 29^{\circ} 56' E$

$\frac{1}{4} 13^{\circ} E$

660 To Cor. No. 3

Identical with the location
which is a mound of stone
 $2\frac{1}{2}$ ft. base, $2\frac{1}{2}$ ft. high

A porphyry stone $24 \times 10 \times 8$ ins.,
set 12 ins. in the ground
chiseled - M. S. - 3-2063 B,
with mound of stone, whence

A cross (x) and B. R. - M. S. - 3-2063 B
chiseled on a porphyry stone
 $3 \times 3 \times 2$ ft above the ground,
bears $S 71^{\circ} 30' E$ 27 ft

A cross (x) and B. R. - M. S. -
3-2063 B, chiseled on a por-
phyry stone $3 \times 2 \times 2$ ft above
the ground, bears $S 71^{\circ} 30' E$ 6 ft.

Thence $S 74^{\circ} 48' W$

$\frac{1}{4} 13^{\circ} E$

20 Gulch, course N. W

250 Gulch, course N. W

330

To Cor. No 4

Identical with the location,
which is a mound of stone
2½ ft. base, 2½ ft. high
A porphyry stone 24x10x10 ins,
set 12 ins. in the ground, with
a mound of stone, chiseled
M.S - 4 - 2063 B, whence

A cross (x) and B.R. - M. S. -
4 - 2063 B, chiseled on a lime
stone 6x3x3 ft. above ground
bears S 3°36' W 41 ft

A cross (x) and B.R. - M. S. -
2063 B, chiseled on a lime-
stone 6x3x3 ft., above ground,
bears S 79° E 70 ft

Thence N 29°56' W

79 13° E

605 Gulch, course N.E.

660 Cor. No 1, the place of beginning
Containing 4.836 Acres ✓

Location

This claim is located in
the Western portion of
T 20 S. R. 7 E (unsurveyed),
Ventana Mining District
Pima Co. Arizona

adjoining claims

The Colorado Lode is bounded
on the north by the "Black
Prince" lode unsurveyed

Course of Veins

The presumed course of vein of
the Enterprise lode is from
the S.E. end center monument
N 46°36' W 1500 ft to the
N.W. end center monument

The presumed course of vein
of the Ninety-Nine and Cundoff
lodes is from their respective
S.W. end center monuments

N 51°42' E 1500 ft. to their respective

N. E. end center monument
 The presumed course of vein
 of the Colorado lode is
 from S. E. end center monument
 $74^{\circ} 27' 11''$ W 1500 ft
 to the N. W. end center monument

Expenditure of

Five Hundred Dollars
 I certify that the value of the
 labor and improvements
 upon this claim, placed thereon
 by the claimants and their
 grantors is not less
 than five hundred dollars
 and that said improve-
 ments consist of:

Enterprise:

From N. W. end Center:

Discovery shaft ²⁰¹ 4×6 ft, 10 ft deep
 bears $S 46^{\circ} 36'$ E 750 ft

Value \$ 50.⁰⁰

Cut No 2, 4×6 ft, 12 ft long,
 bears $S 64^{\circ} 15'$ E 647 ft

Value \$ 50.⁰⁰

Ninety-Nine:

From N. E. end Center:

Discovery Shaft No 1, 4×6 ft, 10 ft
 deep, bears $S 53^{\circ}$ W, 65 ft

Value \$ 50.⁰⁰

Cut No 2, 4×6 ft, 24 ft long, bears
 269° W, 15 ft

Value \$ 100.⁰⁰

Shaft No 3, 4×6 ft 44 ft deep, bears
 $S 17^{\circ} 30'$ W, 25 ft

Value \$ 440.⁰⁰

Orrdorff:

From Cor. No 1

Discovery Tunnel No 1, 4×6 ft, 80 ft
 long, course S. W., bears $N 33^{\circ} 30'$ E
 740 ft

Value \$ 800.⁰⁰

40 ft of this tunnel are credited to
 the development of the Enterprise lode

Cut No 2, 24 x 36 ft, 12 ft. deep,
bears N 30° 30' E, 50 1/2 ft
Value \$ 200.00

Cut No 3 2 x 6 ft, 8 ft long, bears
N 34° 30' E, 493 ft
Value \$ 50.00

Cut No 4 4 x 6 ft, 12 ft. long, bears
N 36° E, 450 ft
Value \$ 50.00

Colorado:

From N. W. end center:
Discovery Shaft No 1 4 x 6 ft, 10 ft
deep, bears S 67° 11' E, 450 ft
Value \$ 100.00

Shaft No 2, 4 x 6 ft, 10 ft deep, bears
S 34° W, 140 ft
Value \$ 100.00

Tunnel No 3, 4 x 6 ft, 62 ft long,
course S 20° W, bears S 21° 20' W, 66 ft
Value \$ 400.00

From Cor. No 4
Cut No 4, 4 x 10 ft, 10 ft long, bears
N 32° W, 588 ft
Value \$ 100.00

Instrument

The survey was made with a Young
and Sons Light Mountain Transit.
The courses were deflected from
the true meridian as determined
by direct solar observations and
checked on meridian as determined
by direct observation on Polaris
June 15th made in connection with
the establishment of the U. S.
Location Monument No 2063.

The distances were measured
with a 50 ft and 100 ft. steel tapes

Philip Coulter
U. S. Deputy Mineral Surveyor

Establishment of the U. S. Location
Monument No 2063 - Ventana Mining
District, Pima Co. Arizona

There being no public land survey,
nor any U. S. Location Monument
within 2 miles of the Enterprise
Ninety-nine - Crudorff and Colorado
lodes, I proceeded to establish
one, as follows: I selected a
prominent point on the Crudorff
lode which is visible for many
miles, I set a porphyroxy
rock 30 x 12 x 10 ins., 12 ins. in
the ground, which I chiseled
with a (X) cross on top and
U. S. L. M. No 2063 and raised a
mound of stone 4 ft base, 3 ft
high along side.

On June 12th 2^h 1st A. M. L. M. T., I
observed Polaris at eastern elongation
at the U. S. L. M. No 2063 and at
7^h 15th A. M. L. M. T., I deflected
10 24' to the West from the line
determined by Polaris, which
line I marked by a cross (X)
chiseled on a rock 415 ft North
of monument. $\text{N } 130^{\circ} \text{ E}$

From the monument and meridian
thus established, I observed the
following bearings, viz:

- Baboquivari Peak, bears $\text{S } 3026^{\circ} \text{ E}$
- South Peak, Quisotoa Range, bears $\text{N } 54^{\circ} 40' \text{ W}$
- Square butte, Sierra Mexico, bears $\text{S } 68^{\circ} \text{ W}$
- Round Hill, bears $\text{N } 64^{\circ} 30' \text{ W}$
- Cor. No 1 Crudorff lode, bears $\text{N } 40^{\circ} 38' \text{ E}$

Philip Contzen
U. S. Dep. Mineral Surveyor

FINAL OATHS FOR SURVEYS.

LIST OF NAMES.

A list of the names of the individuals employed by Philip Coutzen
 United States Deputy Mineral Surveyor, to assist in running, measuring, and marking the lines
 corners and boundaries described in the foregoing field notes of the survey of the mining claim
 of the Pentana Mining Co.
 known as the Enterprise-Ninety-Nine-Orndorff-Colorado
and Orndorff mill-site
 and showing the respective capacities in which they acted.

- W. S. Kengla , Chairman.
- Arthur Pogue , Chairman.
- Fred Tagles , Arman.
- Fred Tagles , Flagman.

FINAL OATHS OF ASSISTANTS.

We, W. S. Kengla, Arthur Pogue
 and Fred Tagles , do solemnly swear that we assisted Philip
Coutzen , United States Deputy Mineral Surveyor, in marking the corners and
 surveying the boundaries of the mining claim of the Pentana
Mining Co
Orndorff-Colorado and Orndorff Mill Site , known as the Enterprise-Ninety-Nine
Orndorff-Colorado and Orndorff Mill Site , represented
 in the foregoing field notes as having been surveyed by said deputy mineral surveyor and under
 his direction; and that said survey has been in all respects, to the best of our knowledge and
 belief, faithfully and correctly executed, and the corner and boundary monuments established
 according to law and the instructions furnished by the United States Surveyor-General for
Arizona .

- W. S. Kengla , Chairman.
- Arthur Pogue , Chairman.
- Fred Tagles , Arman .
- Fred Tagles , Flagman.

Subscribed and sworn to by the above-named persons before me
 this 17th day of June , 1905

H. G. Power

(4-686.)

FINAL OATH OF U. S. DEPUTY MINERAL SURVEYOR

I, Philip Coutzen, U. S. Deputy Mineral Surveyor, do solemnly swear that, in pursuance of instructions received from the United States Surveyor General for Arizona, dated May 20th 1905, I have, in strict conformity to the laws of the United States, the official regulations and instructions thereunder, and the instructions of said Surveyor General, faithfully and correctly executed the survey of the Mining Claim of the Ventana Mining Co.

known as the Enterprise - Ninety-Nine - Orndorff and Colorado and Orndorff wife of J. G. Orndorff Mining District, situate in Ventana

Pima County, Arizona, in Section —, Township No. 20 N., Range No. 7 E (unsurveyed) and designated as Survey No. 2063 A and B, as represented

in the foregoing field notes, which accurately show the boundaries of said mining claim as distinctly marked by monuments on the ground, and described in the attached copy of the location certificate, which was received by me from the Surveyor General with said instructions, and that all the corners of said survey have been established and perpetuated in strict accordance with the law, official regulations and instructions thereunder; and I do further solemnly swear that the foregoing are the true and original field notes of said survey and my report therein, and that the labor expended and improvements made upon said mining claim by claimant or its grantors are as therein fully stated, and that the character, extent, location and itemized value thereof are specified therein with particularity and full detail, and that no portion of said labor or improvements so credited to this claim has been included in the estimate of expenditures upon any other claim.

Philip Coutzen
U. S. Deputy Mineral Surveyor.

Subscribed and sworn to by the said Philip Coutzen
U. S. Deputy Mineral Surveyor, before me

this 17th
day of June 1905

H. G. Power
Notary Public
My Commission Expires April 27th 1908

Affidavit of Five Hundred Dollars Improvements.

We, W. S. Keugla and Fred Tagles

of lawful age, being first duly sworn according to law, depose and say: That we are acquainted with the Enterprise - Ninety-Nine - Orudorff - Colorado and Orudorff Mill - etc mining claim, situate in the Puntana

mining district, Pima County, Arizona Territory, for which the

Puntana Mining Co.

has made application for survey prior to application for patent under the provisions of the Act of Congress

approved May 10, 1872; and that the labor done and improvements made thereon by the applicant and

its grantors for each lode exceed five hundred dollars in value, and further that we are not personally interested

in said mine.

W. S. Keugla
Fred Tagles

TERRITORY OF ARIZONA,

COUNTY OF Pima } ss:

Sworn to and subscribed before me this 17th day

[SEAL.]

of June, 1908

W. G. Power
Notary Public
my commission expires
April 27th 1908

Amended
Notice of Mining Location.

LODE CLAIM.

To All Whom It May Concern:

This Mining Claim, the name of which is the Enterprise
Mining Claim, situate on lands belonging to the United States of America, and in which there are valuable
mineral deposits, was entered upon and located for the purposes of exploration and purchase by

Charles De Groff, Ed. Vail and Charles Elddall
Ventana Mining Company,

(Locator must insert either "a citizen of the United States," or, "who has declared his intention to become a citizen of the United States.")

the undersigned, on the second day of May 1905.

The length of this claim is fifteen hundred feet,
and we claim seven hundred and fifty feet
in a northwesterly direction, and seven hundred
and fifty feet in a southeasterly direction from
the center of the discovery shaft, at which this notice is posted, lengthwise of the claim, together with
three hundred feet in width of the surface grounds; on each side of the center of said
claim. The general course of the lode deposit and premises is from the northwest
to the southeast

The claim is situated and located in the Ventana Mining
District, in Pima County, in the Territory of Arizona, about seven
miles in a southwesterly direction from Baboquivari
Peak and on the west side of Baboquivari or Ventana
Mountains and is bounded on the southeast
by the Orndorff Mining Claim

The surface boundaries of the claim are marked upon the ground as follows: Beginning at a
stone monument

at a point in a northwesterly direction seven hundred & fifty feet
from the discovery shaft; at which this notice is posted, being in the center of the northwesterly
end line of said claim; thence southwesterly 300 feet to a stone monument
, being the northwest corner of said claim; thence
southeasterly 1500 feet to a stone monument, being at the southwest
corner of said claim; thence northeasterly 300 feet to a stone monument
at the center of the southeasterly end of said claim; thence northeasterly 300 feet to a
stone monument being at the southeast corner of said claim; thence northwesterly
1500 feet to a stone monument at the northeast corner of said
claim; thence southwesterly 300 feet to the place of beginning.

All done under the provisions of Chapter Six, of Title XXXII, of the Revised Statutes of the United
States, and of an Act of the General Assembly of Arizona entitled "An Act to Revise and Codify the
Laws of the Territory of Arizona," approved March 16, 1901.

This is an Amended Location Notice of the Enterprise
Mining Claim, located by Charles De Groff, Ed. Vail & Charles Elddall
Charles Elddall on the tenth day of
March 1899, and recorded in Book 66 of Record of Mines, at pages 306 and 307
in the office of the County Recorder of the aforesaid County of Pima
to which reference is hereby made, and this Amended Location Notice is made and posted to correct errors
in the description in the said original Location Notice.

Dated and posted on the ground this second day of May 1905.

Charles De Groff
E. L. Vail
Ventana Mining Co.
By E. L. Vail
Manager

TERRITORY OF ARIZONA,
County of

} ss.

I,, County Recorder in and for the County and Territory aforesaid, do hereby certify that the within instrument was filed for record at, on this day of, 190.., and duly recorded in Book No. of, on Records of, County, Arizona, at pages

WITNESS my hand and official seal the day and year first above written.

County Recorder.

Amended
Notice of Location.

LODE CLAIM.

Enterprise
Mining Claim
Ventana Dist.

Dated *May 7th* 190*5*

Filed and recorded at the request of

E. L. Vail

May 17 A. D., 190*5*

at *3-35* P. M.

Book *K. K. Record of Mines*

Page *141*

Chas. A. Chibell

County Recorder.

By

Deputy Recorder.

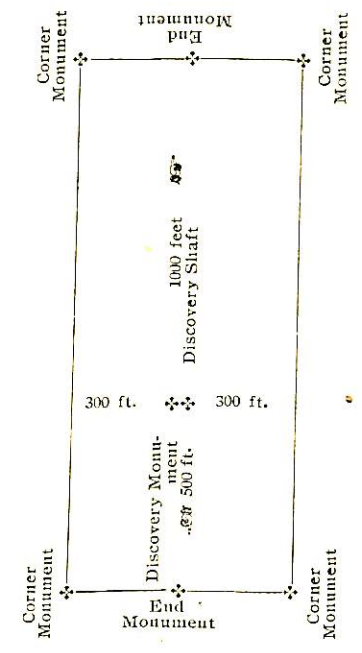

This diagram is to give locator a general idea of plan of location under the new law. The Discovery Shaft can be in the center of claim or any distance from either end desired. In the diagram it is placed 500 feet from one end and 1000 feet from the other. Commence description of claim at a center end monument, giving its distance and direction from center of Discovery Shaft; thence bound the claim in either direction. In description be careful to state locality of claim with reference to some natural object, or permanent monument, as will identify the claim.

Notice of Mining Location.

QUARTZ CLAIM.

To All Whom It May Concern:

This mining claim, the name of which is the Ondorff Mining Claim, situate on lands belonging to the United States of America, and in which there are valuable mineral mineral deposits, was entered upon and located for the purpose of exploration and purchase by

Chas De Groff Chas C Udall and C L Vail

the undersigned, on the 10th day of March 1899

The length of this claim is Fifteen Hundred (1500) feet,

and no claim Eight Hundred Seventy feet

in a North Easterly direction and Six Hundred

thirty feet in a SWesterly direction from

the center of the discovery shaft, at which this notice is posted, lengthwise of the claim, together with

Three Hundred feet in width of the surface grounds, on each side of the center of said

claim. The general course of the lode deposit and premises is from the North East

to the South West

The claim is situated and located in the Yuma or Baboquivari Mining District, in

Yuma County, in the Territory of Arizona, about Seven Miles

in a South Westerly direction from the Barberaquere

Peak, and is on the West side of said range

of Mountains

The surface boundaries of the claim are marked upon the ground as follows: Beginning at

a Monument of Stones

at a point in a South Westerly direction about 630 feet from

the discovery shaft (at which this notice is posted), being in the center of the South West

end line of said claim; thence South Easterly 300 feet to a Monument

of Stones, being the South corner of said claim; thence

North Easterly 750 feet to a Monument of Stones at the center of

the South East side line of said claim; thence North Easterly 750

feet to a Monument being at the East corner of said

claim; thence North Westerly 300 feet to a Monument

at the center of the North East end of said claim; thence North Westerly 300

feet to a Monument, being at the North

corner of said claim; thence South Westerly 750 feet to a Monument

of Stones being at the center of the North West side line of said claim;

thence South Westerly 750 feet to a Monument at

the West corner of said claim; thence South Easterly 300

feet to the place of beginning.

All done under the provisions of Chapter Six, of Title XXXII, of the Revised Statutes of the United States, and of an Act of the General Assembly of Arizona, entitled "An Act Concerning Mines," approved March 20th, 1895.

Dated and posted on the ground this 10th day of March 1899

Chas De Groff
Chas C Udall
C. L. Vail

An Act Concerning Mines.

Be it Enacted by the Legislative Assembly of the Territory of Arizona:

SECTION 1. Every notice of location of a mining claim shall contain: First, the name of the claim located; second, the name of the locator; third, the date of location; fourth, the number of feet in length of said claim and the number of feet claimed on each side of the center of the discovery shaft, lengthwise of the claim; fifth, the general course of the lode deposit or premises located; sixth, the locality of the claim with reference to some natural object, or permanent monument, as will identify the claim.

SECTION 2. All mining locations hereafter located, the certificate of location of which shall not contain: First, the name of the lode or premises; second, the name of the locator or locators; third, the date of location; fourth, the number of feet in length of said claim and the number of feet claimed on each side of the center of the discovery shaft, lengthwise of the claim; fifth, the general course of the lode or premises, as near as may be; sixth, the locality of the claim with reference to some natural object, or permanent monument, as will identify the claim, shall be void.

SECTION 3. Before filing such location certificate with the County Recorder of the proper County, the discoverer shall locate his claim by: First, sinking a discovery shaft upon the premises so claimed, to a depth of at least ten feet from the lowest part of the rim of such shaft at the surface and deeper if necessary, until there is shown by such work a lode deposit of mineral in place; second, by posting at the point of discovery, on the surface, a plain sign or notice substantially conforming to the location certificate; third, by marking such claim or premises on the ground so that its boundaries can be readily traced.

SECTION 4. Such surface boundaries shall be marked by **Eight substantial Posts projecting at least Three Feet Above the Surface of the Ground**, or by substantial Stone Monuments at least **Three Feet High**, to wit: One at each corner of said claim, and one at the center of each end and side line thereof.

SECTION 5. Any open-cut, cross-cut, adit or tunnel which shall be made as above provided for, as a part of the location of a mining claim, and which shall be equal in amount of work to a shaft ten feet deep and four feet wide by six feet long, and which shall cut a lode or mineral in place at the depth of ten feet from the surface, shall be equivalent, as a discovery work, to a shaft sunk from the surface.

SECTION 6. The discoverer shall have ninety days from the date of discovering the lode and the posting of the notice thereon, to perform said discovery work thereon.

SECTION 7. If at any time the locator of any mining claim heretofore or hereafter located, or his assigns, shall learn that his original certificate was defective, or that the requirements of the law had not been complied with before filing, or shall be desirous of changing his surface boundaries, or of taking in any additional ground which is subject to location, or in case the original certificate was made prior to the passage of this law, and he shall be desirous of securing the benefits of this Act, such locator or his assigns, may file an amended certificate of location subject to the provisions of this Act, regarding the making of new locations.

SECTION 8. The amount of assessment, or representation, work or improvements to be done or made during each year, after the completion of the location as heretofore provided, and the time for doing the same, shall be as provided by the laws of the United States.

SECTION 9. Within three months after the expiration of the period of time fixed for the performance of annual labor or the making of improvements upon any mining claims or premises, the person on whose behalf such work or improvement was made, or some person for him knowing the facts, may make and record in the office of the County Recorder of the county wherein such claim is situated an affidavit in substance as follows:

TERRITORY OF ARIZONA, }
 County, } ss
 being duly sworn deposes and says, that he is a citizen of the United States and more than 21 years of age, and resides at County, Arizona Territory, and is personally acquainted with the mining claim and premises located and known as Mining District, County of Arizona Territory, the notice of location of which premises is recorded in the office of the County Recorder of said county, in Book of Records of Mines, at page; that between the day of A. D. 189..... and the day of A. D. 189..... at least dollars worth of work and improvements were done and performed upon said premises or lode, not including the location work of said claim. Such work and improvements were made by and at the expense of owners of said premises for the purpose of complying with the law of the United States pertaining to assessments or annual work, and (here name the miners or men who worked upon the claim in doing the work) were the men employed by said owner and who labored upon said premises and who did said work and improvements, and said work so done upon said premises is described as follows, to-wit: (Here describe the work done.)
 (Signature)
 Subscribed and sworn to before me this day of 189.....
 Notary Public.

[SEAL]
SECTION 10. Such affidavit when so recorded shall be prima facie evidence of the performance of such labor or the making of such improvements, and said original affidavit after it has been recorded, or a certified copy of record of same, shall be received as evidence accordingly by all the Courts of this Territory.

SECTION 11. The relocation of forfeited or abandoned lode claims shall only be made by sinking a new discovery shaft and fixing new boundaries in the same manner and to same extent as is required in making a new location; or the locator may sink the original discovery shaft ten feet deeper than it was at date of commencement of such relocation, and shall erect new or make the old monuments the same as originally required. In either case a new location monument shall be erected, and the location certificate shall state if the whole or any part of the new location is located as abandoned property.

SECTION 12. This Act shall take effect and be in force from and after July 1st. 1895.

SECTION 13. All Acts and parts of Acts in conflict with this Act are hereby repealed.

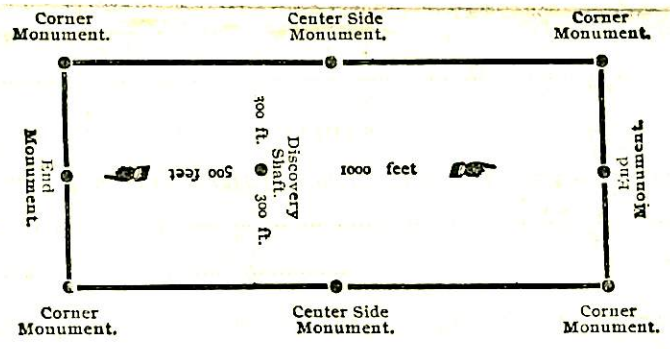

The above diagram is to give the locator a general idea of plan of location under the new law. Your discovery shaft can be in the center of claim or any distance from from either end you desire. In the diagram we have placed it 500 feet from one end and 1000 feet from the other. In description be careful to state locality of claim with reference to some natural object, or permanent monument, as will identify the claim.

TERRITORY OF ARIZONA, }
 County of } ss
 County Recorder in and for the County and Territory aforesaid, do hereby certify that the within instrument was filed for record at o'clock, M. on this day of 1....., and duly recorded in Book No. of Records of County, Arizona, at pages.....
 WITNESS my hand and official seal the day and year first above written.

County Recorder.

Notice of Location.
 QUARTZ CLAIM.
Omdorff
 Dated 1.....
 Filed and recorded at request of
Ed Vail
 at A. D. 1899
 at P. M.
 Book of Records of Mines
 Pages 217, Ex. 107
Chas. A. Shibell
 County Recorder.
 Deputy Recorder.
 NO. 110, HEERMANS STATIONERY COMPANY, TUCSON.

Notice of Mining Location.

QUARTZ CLAIM.

To All Whom It May Concern:

This mining claim, the name of which is the Colorado
Mining Claim, situate on lands belonging to the United States of America, and in which there are valuable mineral
mineral deposits, was entered upon and located for the purpose of exploration and purchase by Chas
de Groff - Chas E. Udall & Ed.
L. Vail.

the undersigned, on the 10th day of March 1899,

The length of this claim is 1500 feet,
and 750 feet

in a Eastwardly direction and 1050
feet in a Westwardly direction from

the center of the discovery shaft, at which this notice is posted, lengthwise of the claim, together with
300 feet in width of the surface grounds, on each side of the center of said

claim. The general course of the lode deposit and premises is from the East
to the West

The claim is situated and located in the Ventana or Baboquivari Mining District, in
Pima County, in the Territory of Arizona, about 7 miles

in a SW direction from Baboquivari Peak
on the West Side of the Baboquivari Mts.

The surface boundaries of the claim are marked upon the ground as follows: Beginning at a Stone
Monument

at a point in a Eastwardly direction 450 feet from
the discovery shaft (at which this notice is posted), being in the center of the East

end line of said claim; thence North 300 feet to a Stone Monument

~~at the center of the~~ North 750 feet to a Stone Monument at the center of
the North side line of said claim; thence West 750

feet to a Stone Monument being at the SW corner of said
claim; thence South 300 feet to a Stone Monument

at the center of the West end of said claim; thence South 300
feet to a Stone Monument being at the SW

corner of said claim; thence East 750 feet to a Stone Monument

being at the center of the South side line of said claim;
thence East 750 feet to a Stone Monument at
the SE corner of said claim; thence North 300

feet to the place of beginning.

All done under the provisions of Chapter Six, of Title XXXII, of the Revised Statutes of the United States, and of
an Act of the General Assembly of Arizona, entitled "An Act Concerning Mines," approved March 20th, 1895.

Dated and posted on the ground this 10th day of March 1899.

Chas. de Groff
Chas. E. Udall
Ed. L. Vail

An Act Concerning Mines.

Be it Enacted by the Legislative Assembly of the Territory of Arizona:

SECTION 1. Every notice of location of a mining claim shall contain: First, the name of the claim located; second, the name of the locator; third, the date of location; fourth, the number of feet in length of said claim and the number of feet claimed on each side of the center of the discovery shaft, lengthwise of the claim; fifth, the general course of the lode deposit or premises located; sixth, the locality of the claim with reference to some natural object, or permanent monument, as will identify the claim.

SECTION 2. All mining locations hereafter located, the certificate of location of which shall not contain: First, the name of the lode or premises; second, the name of the locator or locators; third, the date of location; fourth, the number of feet in length of said claim and the number of feet claimed on each side of the center of the discovery shaft, lengthwise of the claim; fifth, the general course of the lode or premises, as near as may be; sixth, the locality of the claim with reference to some natural object, or permanent monument, as will identify the claim, shall be void.

SECTION 3. Before filing such location certificate with the County Recorder of the proper County, the discoverer shall locate his claim by: First, sinking a discovery shaft upon the premises so claimed, to a depth of at least ten feet from the lowest part of the rim of such shaft at the surface and deeper if necessary, until there is shown by such work a lode deposit of mineral in place; second, by posting at the point of discovery, on the surface, a plain sign or notice substantially conforming to the location certificate; third, by marking such claim or premises on the ground so that its boundaries can be readily traced.

SECTION 4. Such surface boundaries shall be marked by Eight substantial Posts projecting at least Three Feet Above the Surface of the Ground, or by substantial Stone Monuments at least Three Feet High, to wit: One at each corner of said claim, and one at the center of each end and side line thereof.

SECTION 5. Any open-cut, cross-cut, adit or tunnel which shall be made as above provided for, as a part of the location of a mining claim, and which shall be equal in amount of work to a shaft ten feet deep and four feet wide by six feet long, and which shall cut a lode or mineral in place at the depth of ten feet from the surface, shall be equivalent, as a discovery work, to a shaft sunk from the surface.

SECTION 6. The discoverer shall have ninety days from the date of discovering the lode and the posting of the notice thereon, to perform said discovery work thereon.

SECTION 7. If at any time the locator of any mining claim heretofore or hereafter located, or his assigns, shall learn that his original certificate was defective, or that the requirements of the law had not been complied with before filing, or shall be desirous of changing his surface boundaries, or of taking in any additional ground which is subject to location, or in case the original certificate was made prior to the passage of this law, and he shall be desirous of securing the benefits of this Act, such locator or his assigns, may file an amended certificate of location subject to the provisions of this Act, regarding the making of new locations.

SECTION 8. The amount of assessment, or representation, work or improvements to be done or made during each year, after the completion of the location as heretofore provided, and the time for doing the same, shall be as provided by the laws of the United States.

SECTION 9. Within three months after the expiration of the period of time fixed for the performance of annual labor or the making of improvements upon any mining claims or premises, the person on whose behalf such work or improvement was made, or some person for him knowing the facts, may make and record in the office of the County Recorder of the county wherein such claim is situated an affidavit in substance as follows:

TERRITORY OF ARIZONA, }
 County of } ss
 being duly sworn deposes and says, that he is a citizen of the United States and more than 21 years of age, and resides at County, Arizona Territory, and is personally acquainted with the mining claim and premises located and known as mining claim or lode, situated in Mining District, County of Arizona Territory, the notice of location of which premises is recorded in the office of the County Recorder of said county, in Book of Records of Mines, at page; that between the day of A. D. 189..... and the day of A. D. 189..... at least dollars worth of work and improvements were done and performed upon said premises or lode, not including the location work of said claim. Such work and improvements were made by and at the expense of owners of said premises for the purpose of complying with the law of the United States pertaining to assessments or annual work, and (here name the miners or men who worked upon the claim in doing the work) were the men employed by said owner and who labored upon said premises and who did said work and improvements, and said work so done upon said premises is described as follows, to-wit: (Here describe the work done.)
 (Signature)
 Subscribed and sworn to before me..... this..... day of 189.....
 Notary Public.

SECTION 10. Such affidavit when so recorded shall be prima facie evidence of the performance of such labor or the making of such improvements, and said original affidavit after it has been recorded, or a certified copy of record of same, shall be received as evidence accordingly by all the Courts of this Territory.

SECTION 11. The relocation of forfeited or abandoned lode claims shall only be made by sinking a new discovery shaft and fixing new boundaries in the same manner and to same extent as is required in making a new location; or the locator may sink the original discovery shaft ten feet deeper than it was at date of commencement of such relocation, and shall erect new or make the old monuments the same as originally required. In either case a new location monument shall be erected, and the location certificate shall state if the whole or any part of the new location is located as abandoned property.

SECTION 12. This Act shall take effect and be in force from and after July 1st, 1895.
SECTION 13. All Acts and parts of Acts in conflict with this Act are hereby repealed.

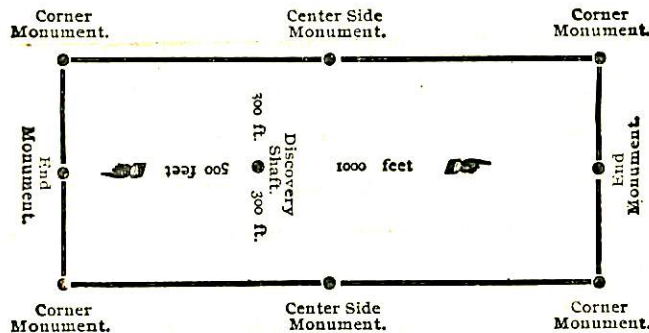

The above diagram is to give the locator a general idea of plan of location under the new law. Your discovery shaft can be in the center of claim or any distance from either end you desire. In the diagram we have placed it 500 feet from one end and 1000 feet from the other. In description be careful to state locality of claim with reference to some natural object, or permanent monument, as will identify the claim.

TERRITORY OF ARIZONA, }
 County of } ss
 County Recorder in and for the County and Territory aforesaid, do hereby certify that the within instrument was filed for record at o'clock, M. on this day of 189....., and duly recorded in Book No. of Records of County, Arizona, at pages
 WITNESS my hand and official seal the day and year first above written.

County Recorder.

Notice of Location.

QUARTZ CLAIM.

Colorado

Dated..... 1.....

Filed and recorded at request of
Ed Paul

at
April 5th A. D. 1899

Book
G. G. Records of Mineral

Pages
216. Ed Paul

By
Chas. A. Chubbell County Recorder.

Deputy Recorder.

477

Notice of Mining Location.

QUARTZ CLAIM.

To All Whom It May Concern:

This mining claim, the name of which is the Ninety Nine Mining Claim, situate on lands belonging to the United States of America, and in which there are valuable mineral mineral deposits, was entered upon and located for the purpose of exploration and purchase by

Chas De Graft, Chas E Udall and E L Vail

the undersigned, on the 10th day of March, 1899

The length of this claim is 1500 fifteen Hundred feet, and we claim (10) Ten feet in a N. Eastern direction and 1490 feet in a Westerly direction from

the center of the discovery shaft, at which this notice is posted, lengthwise of the claim, together with (300) Three hundred feet in width of the surface grounds, on each side of the center of said claim. The general course of the lode deposit and premises is from the North East to the South West

The claim is situated and located in the Ventura or Baboquivari Mining District, in Pima County, in the Territory of Arizona, about Seven Miles in a South Westerly direction from Barboursville

Peak and West side of the Barboursville Mountains

The surface boundaries of the claim are marked upon the ground as follows: Beginning at a Monument of stones to the Center of North East End of Claim at a point in a North Easterly direction

feet from the discovery shaft (at which this notice is posted), being in the center of the North East end line of said claim; thence North West 300 feet to a Monument of stones

being the North corner of said claim; thence South West 750 feet to a Monument at the center of the North West side line of said claim; thence South West 750 feet to a Monument being at the West corner of said claim; thence South East 300 feet to a Monument at the center of the South West end of said claim; thence South East 300 feet to a Monument being at the South corner of said claim; thence North East 750 feet to a Monument being at the center of the South East side line of said claim; thence North East 750 feet to a Monument at the East corner of said claim; thence North West 300 feet to the place of beginning.

All done under the provisions of Chapter Six, of Title XXXII, of the Revised Statutes of the United States, and of an Act of the General Assembly of Arizona, entitled "An Act Concerning Mines," approved March 29th, 1895.

Dated and posted on the ground this 10th day of March, 1899

Chas De Graft
Chas E Udall
E L Vail

An Act Concerning Mines.

Be it Enacted by the Legislative Assembly of the Territory of Arizona:

SECTION 1. Every notice of location of a mining claim shall contain: First, the name of the claim located; second, the name of the locator; third, the date of location; fourth, the number of feet in length of said claim and the number of feet claimed on each side of the center of the discovery shaft, lengthwise of the claim; fifth, the general course of the lode deposit or premises located; sixth, the locality of the claim with reference to some natural object, or permanent monument, as will identify the claim.

SECTION 2. All mining locations hereafter located, the certificate of location of which shall not contain: First, the name of the lode or premises; second, the name of the locator or locators; third, the date of location; fourth, the number of feet in length of said claim and the number of feet claimed on each side of the center of the discovery shaft, lengthwise of the claim; fifth, the general course of the lode or premises, as near as may be; sixth, the locality of the claim with reference to some natural object, or permanent monument, as will identify the claim, shall be void.

SECTION 3. Before filing such location certificate with the County Recorder of the proper County, the discoverer shall locate his claim by First, sinking a discovery shaft upon the premises so claimed, to a depth of at least ten feet from the lowest part of the rim of such shaft at the surface and deeper if necessary, until there is shown by such work a lode deposit of mineral in place; second, by posting at the point of discovery, on the surface, a plain sign or notice substantially conforming to the location certificate; third, by marking such claim or premises on the ground so that its boundaries can be readily traced.

SECTION 4. Such surface boundaries shall be marked by Eight substantial Posts projecting at least Three Feet Above the Surface of the Ground, or by substantial Stone Monuments at least Three Feet High, to wit: One at each corner of said claim, and one at the center of each end and side line thereof.

SECTION 5. Any open-cut, cross-cut, adit or tunnel which shall be made as above provided for, as a part of the location of a mining claim, and which shall be equal in amount of work to a shaft ten feet deep and four feet wide by six feet long, and which shall cut a lode or mineral in place at the depth of ten feet from the surface, shall be equivalent, as a discovery work, to a shaft sunk from the surface.

SECTION 6. The discoverer shall have ninety days from the date of discovering the lode and the posting of the notice thereon, to perform said discovery work thereon.

SECTION 7. If at any time the locator of any mining claim heretofore or hereafter located, or his assigns, shall learn that his original certificate was defective, or that the requirements of the law had not been complied with before filing, or shall be desirous of changing his surface boundaries, or of taking in any additional ground which is subject to location, or in case the original certificate was made prior to the passage of this law, and he shall be desirous of securing the benefits of this Act, such locator or his assigns, may file an amended certificate of location subject to the provisions of this Act, regarding the making of new locations.

SECTION 8. The amount of assessment, or representation, work or improvements to be done or made during each year, after the completion of the location as heretofore provided, and the time for doing the same, shall be as provided by the laws of the United States.

SECTION 9. Within three months after the expiration of the period of time fixed for the performance of annual labor or the making of improvements upon any mining claims or premises, the person on whose behalf such work or improvement was made, or some person for him knowing the facts, may make and record in the office of the County Recorder of the county wherein such claim is situated an affidavit in substance as follows:

TERRITORY OF ARIZONA, }
 County, } ss
 and more than 21 years of age, and resides at _____ being duly sworn deposes and says, that he is a citizen of the United States
 personally acquainted with the mining claim and premises located and known as _____ County, Arizona Territory, and is per-
 sonally acquainted with the mining claim and premises located and known as _____ Mining District, County of _____ Arizona Territory, the notice of
 location of which premises is recorded in the office of the County Recorder of said county, in Book _____ of Records of Mines, at
 page _____ that between the _____ day of _____ A. D. 189____ and the _____ day of _____ A. D. 189____
 day of _____ done and performed upon said premises or lode, not including the location work of said claim. Such work and improvements were
 made by and at the expense of _____ dollars worth of work and improvements were
 purpose of complying with the law of the United States pertaining to assessments or annual work, and (here name the miners or men who worked
 upon the claim in doing the work) were the men employed by said owner and who labored upon said premises and who did said work and improve-
 ments, and said work so done upon said premises is described as follows, to-wit: (Here describe the work done.)

 Subscribed and sworn to before me _____ this _____ day of _____ 189____ (Signature)
 _____ Notary Public.

SECTION 10. Such affidavit when so recorded shall be prima facie evidence of the performance of such labor or the making of such improve-
 ments, and said original affidavit after it has been recorded, or a certified copy of record of same, shall be received as evidence accordingly by all
 the Courts of this Territory.

SECTION 11. The relocation of forfeited or abandoned lode claims shall only be made by sinking a new discovery shaft and fixing new bound-
 aries in the same manner and to same extent as is required in making a new location; or the relocater may sink the original discovery shaft ten
 feet deeper than it was at date of commencement of such relocation, and shall erect new or make the old monuments the same as originally re-
 quired. In either case a new location monument shall be erected, and the location certificate shall state if the whole or any part of the new location
 is located as abandoned property.

SECTION 12. This Act shall take effect and be in force from and after July 1st, 1895.

SECTION 13. All Acts and parts of Acts in conflict with this Act are hereby repealed.

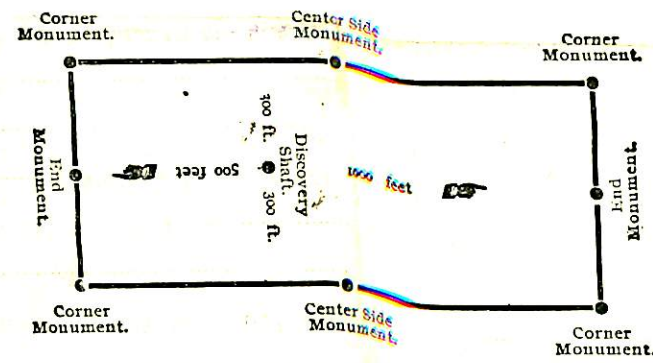

The above diagram is to give the locator a general idea of plan of location under the new law. Your discovery shaft can be in the center of
 claim or any distance from from either end you desire. In the diagram we have placed it 500 feet from one end and 1000 feet from the other. In
 description be careful to state locality of claim with reference to some natural object, or permanent monument, as will identify the claim.

TERRITORY OF ARIZONA, }
 County of _____ } ss
 Territory aforesaid, do hereby certify that the within instrument _____ County Recorder in and for the County and
 on this _____ day of _____ at _____ o'clock, _____ M.
 of _____ Records of _____ I _____, and duly recorded in Book No. _____
 _____ County, Arizona, at pages _____
 WITNESS my hand and official seal the day and year first above written.

Notice of Location.
 QUARTZ CLAIM.
 Findy Mine
 Dated _____
 Filed and recorded at request of
 Ed Vair
 April 15th 1899 A. D. 1899
 at _____ P. M.
 Book _____
 Pages _____
 Charles A. Ghibbell
 County Recorder.
 Deputy Recorder.
 NO. 110, HEERMANS STATIONERY COMPANY, TUCSON.

An Act Concerning Mines.

Be it Enacted by the Legislative Assembly of the Territory of Arizona:

SECTION 1. Every notice of location of a mining claim shall contain: First, the name of the claim located; second, the name of the locator; third, the date of location; fourth, the number of feet in length of said claim and the number of feet claimed on each side of the center of the discovery shaft, lengthwise of the claim; fifth, the general course of the lode deposit or premises located; sixth, the locality of the claim with reference to some natural object, or permanent monument, as will identify the claim.

SECTION 2. All mining locations hereafter located, the certificate of location of which shall not contain: First, the name of the lode or premises; second, the name of the locator or locators; third, the date of location; fourth, the number of feet in length of said claim and the number of feet claimed on each side of the center of the discovery shaft, lengthwise of the claim; fifth, the general course of the lode or premises, as near as may be; sixth, the locality of the claim with reference to some natural object, or permanent monument, as will identify the claim, shall be void.

SECTION 3. Before filing such location certificate with the County Recorder of the proper County, the discoverer shall locate his claim by: First, sinking a discovery shaft upon the premises so claimed, to a depth of at least ten feet from the lowest part of the rim of such shaft at the surface and deeper if necessary, until there is shown by such work a lode deposit of mineral in place; second, by posting at the point of discovery, on the surface, a plain sign or notice substantially conforming to the location certificate; third, by marking such claim or premises on the ground so that its boundaries can be readily traced.

SECTION 4. Such surface boundaries shall be marked by **Eight substantial Posts** projecting at least **Three Feet Above the Surface of the Ground**, or by substantial **Stone Monuments** at least **Three Feet High**, to wit: One at each corner of said claim, and one at the center of each end and side line thereof.

SECTION 5. Any open-cut, cross-cut, adit or tunnel which shall be made as above provided for, as a part of the location of a mining claim, and which shall be equal in amount of work to a shaft ten feet deep and four feet wide by six feet long, and which shall cut a lode or mineral in place at the depth of ten feet from the surface, shall be equivalent, as a discovery work, to a shaft sunk from the surface.

SECTION 6. The discoverer shall have ninety days from the date of discovering the lode and the posting of the notice thereon, to perform said discovery work thereon.

SECTION 7. If at any time the locator of any mining claim heretofore or hereafter located, or his assigns, shall learn that his original certificate was defective, or that the requirements of the law had not been complied with before filing, or shall be desirous of changing his surface boundaries, or of taking in any additional ground which is subject to location, or in case the original certificate was made prior to the passage of this law, and he shall be desirous of securing the benefits of this Act, such locator or his assigns, may file an amended certificate of location subject to the provisions of this Act, regarding the making of new locations.

SECTION 8. The amount of assessment, or representation, work or improvements to be done or made during each year, after the completion of the location as heretofore provided, and the time for doing the same, shall be as provided by the laws of the United States.

SECTION 9. Within three months after the expiration of the period of time fixed for the performance of annual labor or the making of improvements upon any mining claims or premises, the person on whose behalf such work or improvement was made, or some person for him knowing the facts, may make and record in the office of the County Recorder of the county wherein such claim is situated an affidavit in substance as follows:

TERRITORY OF ARIZONA, }
 County, } ss
 being duly sworn deposes and says, that he is a citizen of the United States and more than 21 years of age, and resides at County, Arizona Territory, and is personally acquainted with the mining claim and premises located and known as Mining District, County of Arizona Territory, the notice of location of which premises is recorded in the office of the County Recorder of said county, in Book of Records of Mines, at page that between the day of A. D. 189..... and the day of A. D. 189..... at least dollars worth of work and improvements were done and performed upon said premises or lode, not including the location work of said claim. Such work and improvements were made by and at the expense of owners of said premises for the purpose of complying with the law of the United States pertaining to assessments or annual work, and (here name the miners or men who worked upon the claim in doing the work) were the men employed by said owner and who labored upon said premises and who did said work and improvements, and said work so done upon said premises is described as follows, to-wit: (Here describe the work done.)
 (Signature)
 Subscribed and sworn to before me this day of 189.....
 Notary Public.

[SEAL]
SECTION 10. Such affidavit when so recorded shall be prima facie evidence of the performance of such labor or the making of such improvements, and said original affidavit after it has been recorded, or a certified copy of record of same, shall be received as evidence accordingly by all the Courts of this Territory.

SECTION 11. The relocation of forfeited or abandoned lode claims shall only be made by sinking a new discovery shaft and fixing new boundaries in the same manner and to same extent as is required in making a new location; or the relocater may sink the original discovery shaft ten feet deeper than it was at date of commencement of such relocation, and shall erect new or make the old monuments the same as originally required. In either case a new location monument shall be erected, and the location certificate shall state if the whole or any part of the new location is located as abandoned property.

SECTION 12. This Act shall take effect and be in force from and after July 1st, 1895.

SECTION 13. All Acts and parts of Acts in conflict with this Act are hereby repealed.

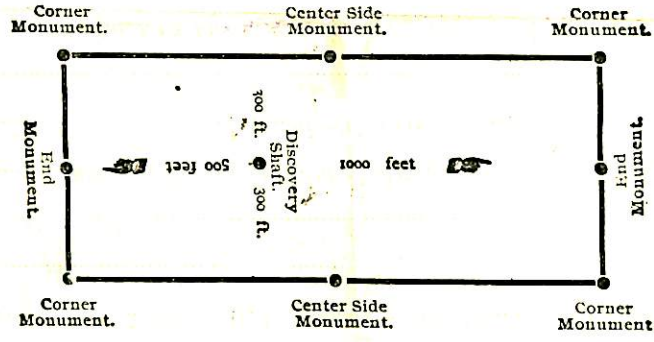

The above diagram is to give the locator a general idea of plan of location under the new law. Your discovery shaft can be in the center of claim or any distance from from either end you desire. In the diagram we have placed it 500 feet from one end and 1000 feet from the other. In description be careful to state locality of claim with reference to some natural object, or permanent monument, as will identify the claim.

TERRITORY OF ARIZONA, }
 County of } ss
 County Recorder in and for the County and Territory aforesaid, do hereby certify that the within instrument was filed for record at o'clock, M. on this day of 189....., and duly recorded in Book No. of Records of County, Arizona, at pages
 WITNESS my hand and official seal the day and year first above written.

County Recorder.

Notice of Location.
 QUARTZ CLAIM.
Pinky Mine
 Dated
 Filed and recorded at request of
Ed Vail
 April 5th 1899 A. D. 1899
 at M.
 Book of G. J. Records of Mines
 Pages 278, 279
 by *Chas. A. Ghibell*
 County Recorder.
 Deputy Recorder.
 NO. 110, HEERMANS STATIONERY COMPANY, TUCSON.

Location Notice

OF THE Ondorff
Mill-Site Claim and Water Right.

KNOW ALL MEN BY THESE PRESENTS, That we the undersigned, have this day located a Mill-Site for the purpose of erecting suitable works for reducing the ores of the

Ondorff Mining Claim,
situated in Verluda Mining
District, Pima County, Arizona
Territory. The exterior boundaries of said Ondorff
Mill-Site Claim, are as follows, viz:

COMMENCING at a monument of stone at N. E. corner of claim, and running thence in a westerly direction, ³³⁰~~466~~ feet to a monument of stone at N. W. corner of claim, thence in a southerly direction ⁶⁶⁰~~466~~ feet to a monument of stone at S. W. corner of claim, thence in an easterly direction, ³³⁰~~466~~ feet to a monument of stone at S. E. corner of claim, thence in a northerly direction, ⁶⁶⁰~~466~~ feet to a monument of stone at N. E. corner of claim and place of beginning.

This location may be more generally described as being situated

On the West Side of the Baboquivere Mountains and about seven miles South Westward from the highest Peak in said Mountains and about seven miles South Easterly direction from the Ondorff Mines

That we have also located in connection with the said Mill-Site Claim _____ inches miners' measure of the water of this _____ under and in accordance with the laws of the Territory of Arizona, regulating the location and possession of water rights.

The dimensions of the ditch for diverting the water from its natural course at the head, being as follows:
_____ wide at top, _____ wide at bottom, _____ in depth, with a uniform grade of _____ to the rod.

Dated on the ground, this 25th day of March 1905
Witness: Chas De Graff Verluda Mining Co
by E L Paul

TERRITORY OF ARIZONA, }
County of } ss

I, County Recorder in and for the County and Territory aforesaid, do hereby certify that the within instrument was filed for record at o'clock M., on this day of 190....., and duly recorded in Book No. of Records of County, Arizona, at pages

WITNESS my hand and official seal the day and year first above written.

.....
County Recorder

678

Location Notice

OF

Mill-Site Claim and Water Right.

Orndorff

Dated *March 23-* 190.....

Filed and recorded at request of

E. P. Bail

April 21 A. D. 190*5-*

at *- 12* M.

Book *2 Mill-Sites*

Pages *94*

.....
County Recorder.

BY
Deputy Recorder.

No. 178, HEERMANS STATIONERY COMPANY, TUCSON.

4-688.

U. S. SURVEYOR-GENERAL'S FINAL CERTIFICATE ON FIELD NOTES.

Department of the Interior,

OFFICE OF U. S. SURVEYOR-GENERAL,

Phoenix, Arizona.

Aug 7, 1905

I, U. S. Surveyor-General for the district of Arizona. do hereby certify that the foregoing transcript of the Field Notes, return and approval of the survey of the mining claim of Ventana Mining Co.

known as the Enterprise, Ninety-nine, Orndorff, Colorado lodes, and situate in Orndorff Mill-site.

Ventana Mining District, Pima County, Arizona.

in Section -----, Township No. 20 S., Range No. 7 E. unsurveyed., and

designated as Survey No 2063 A & B, has been correctly copied from the originals on file in

this office; that said Field Notes furnish such an accurate description of said mining claim as will, if incorporated into a patent, serve fully to identify the premises, and that such reference is made therein to natural objects or permanent monuments as will perpetuate and fix the locus thereof.

And I further certify that five hundred dollars' worth of labor has been expended or improvements made upon said mining claim by claimant or its grantors, and that said improvements consist of 5 shafts, 6 cuts and 2 tunnels, total value \$2490.00

and that no portion of said labor or improvements has been included in the estimate of expenditures upon any other claim.

I further certify that the plat thereof, filed in the U. S. Land Office at Tucson, Arizona. is correct and in conformity with the foregoing Field Notes.

(Signed) Frank S. Ingalls,

United States Surveyor-General for Arizona.

4-687.

SURVEYOR-GENERAL'S CERTIFICATE OF APPROVAL OF FIELD NOTES AND SURVEY OF MINING CLAIM.

Department of the Interior,

Office of U. S. Surveyor-General,

Phoenix, Arizona.

Aug 7, 1905

I, U. S. Surveyor-General for the district of Arizona.

do hereby certify that the foregoing and hereto attached Field Notes and Return of the Survey of the Mining Claim of Ventana Mining Co.

Enterprise, Ninety-nine, Orndorff, Colodaro lodes, and Orndorff, Mill-site. situate in Ventana Mining District, Pima County, Arizona.

in Section, Township No. 20 S., Range No. 7 E. unsurveyed, designated as Survey No. 2063 A & B

executed by Philip Contzen, U. S. Deputy Mineral Surveyor, June 13th to 14th 1905, 1905, under my instructions dated May 20th 1905, 1905, have been critically examined and the necessary corrections and explanations made, and the said Field Notes and Return, and the Survey they describe, are hereby approved. A true copy of the copy of the location certificate filed by the applicant. for survey is included in the field notes.

Frank S. Sigbee

U. S. Surveyor-General for Arizona.

SURVEYED JUNE 12-14-1905
 By PHILIP GONTZEN
 U.S. DEPT. MIN. SURVEYOR
 SCALE: 1 INCH = 500 FT.

SURVEYS 2063 A AND B.
 GILA LAND DISTRICT

