

M
S
-

0
2
0
7
5

1
JUN 15 1905

*Copy of by
Cmt 8/22/05*

(4-683.)

Mineral Survey No. 2075

Lot No. _____

Gila

Land District.

FIELD NOTES

OF THE SURVEY OF THE MINING CLAIM OF

Howard W. Smith

KNOWN AS THE

Nagasaki

Situate Mining District,

County, Coconino

Arizona

Section Approx, Township 23 S., Range 24 E. ~~44 S. R. 24~~

Surveyed under instructions dated May 29th, 1905.

by Franklin W. Smith

U. S. Deputy Mineral Surveyor.

Claim located see location notice, 1

Survey commenced May 31st, 1905

Survey completed June 1st, 1905

o 6-180

Post Office Address of claimant:

Bisbee, Coconino County
Arizona

*Tie Hook OK
Lease OK
Area OK*

200

NAGASAKI LODE,
 situated in the Warren Mining District, Cochise County,
 Arizona; Hoval A. Smith, claimant.

AFFIDAVIT OF \$500 IMPROVEMENTS.

I hereby certify that the value of the labor and
 improvements placed on this claim by claimant or his
 grantors is not less than \$500 and that said improvements
 consist of:

No.1	Discovery shaft 4x6x10 ft brs from E E C location N. 52° 11' W. 300 ft., Value,	\$100.00
No.2	Shaft 4x6x10 ft brs from Cor.No.1 S. 78° 30' W. 90 ft , Value,	100.00
No.3	Shaft 4x6x10 ft brs from Cor.No.5 S. 13° W. 28 ft Value,	100.00
No.4	Shaft 4x6x10 ft brs from same point S. 62°W 26 ft., Value,	100.00
No.5	Shaft 4x6x10 ft brs from same point N. 75° ^E N. 60 ft., Value	<u>100.00</u>
Total improvements Nagasaki lode,		\$500.00

Franklin W. Smith

U. S. Deputy Mineral Surveyor.

Dated at Bisbee, Arizona,

J u l y 25, 1905.

Affidavit of Five Hundred Dollars Improvements.

We, J. A. Sherwood and J. T. Toland

of lawful age, being first duly sworn according to law, depose and say: That we are acquainted with the

Nagasaki mining claim, situate in Warren mining district, Cochise County, Arizona Territory, for which

Hoval A. Smith

has made application for survey prior to application for patent under the provisions of the Act of Congress approved May 10, 1872; and that the labor done and improvements made thereon by the applicant and his grantors exceed five hundred dollars in value, and further that we are not personally interested in said mine.

J. T. Toland
J. A. Sherwood

TERRITORY OF ARIZONA,
COUNTY OF Cochise } ss:

Sworn to and subscribed before me this 20th day

[SEAL.]

of July, 1901

Corra E. Smith

(4-691.)

Certificate of U. S. Surveyor General

AS TO

EXPENDITURES REPORTED AFTER RETURN OF SURVEY OF MINING CLAIM.

I, U. S. Surveyor General for the district of Arizona.,
do hereby certify that Five Hundred Dollars' worth of labor has been expended or
improvements made by claimant or his grantors, upon the mining claim of
Hoval A. Smith,

known as the Nagasaki,
situate in Warren mining district,
Cochise County, Arizona.

in Section _____, Township No. _____, Range No. _____;

that said improvements consist of 5 shafts, value \$500.00

_____, and that no portion of said labor or improvements has been
included in the estimate of expenditures upon any other claim. A copy of the report of
Franklin W. Smith, U. S. Deputy Mineral Surveyor, dated
July 25, 1905., 18____, is hereto attached.

U. S. Surveyor General for Arizona.

Office of U. S. Surveyor General,
Phoenix, Arizona.

July 28 1905. 18

Feet

Nagasaki,
Survey No. 2075

Beginning at Cor.No.1 the NE cor identical with location, with Cor.No.4 Columbia lode, Survey No.1795, and situated on the N side line of Lone Jack lode, unsurveyed a pine post 4 ft long 4 ins sq set 1 ft in the ground in a mound of stones and scribed 1-2075 N L whence a pine post of same dimensions and scribed B.P. 1-2075 brs. S. $69^{\circ} 09' W$. 25 ft and a second pine post of same dimensions and scribing brs. N $87^{\circ} 01' W$. 25 ft., no bearing monuments available, and NW cor Sec 30 Tp 23 S R 25 E G & S R B & M brs. S. $59^{\circ} 17' E$. 9261.76 ft.,

Thence S. $69^{\circ} 09' W$.

276.8 along the N side line of Lone Jack lode unsurveyed, to original location for E E C,

451.8 same bearing to Cor.No.2, the SE cor identical with location, and at the point of intersection of line 2-3 Eagle Eye lode Survey No.1860 with the N side line of Lone Jack lode unsurveyed. a pine post 4 ft long 4 ins sq set 1 ft in the ground in a mound of stones and scribed 2-2075 N L whence a pine post of same dimensions and scribed B P 2-2075 brs. N. $41^{\circ} 31' W$. 25 ft and a second pine post of same dimensions and scribing brs. N. $69^{\circ} 09' E$ 25 ft., no bearing monuments available, and Cor.No.3 Eagle Eye lode, Survey No.1860 brs. N. $36^{\circ} 55' E$. 43.5 ft.,

Thence N. $41^{\circ} 31' W$.

690.1 to the intersection of the side line of Bayonne lode, unsurveyed, at S. $36^{\circ} 55' W$. 43.5 ft., from the NE cor., (NE cor Bayonne lode, unsurveyed is identical with Cor.No 4 Eagle Eye lode, Survey No.1860) and the E side line of the Bayonne lode has a course in common with line 1-4 Eagle Eye lode

624.9 same bearing to Cor.No.3 the SW cor., identical with location, a pine post 4 ft long 4 ins sq set 1 ft in the ground in a mound of stones and scribed 3-2075 N L., whence a pine post of same dimensions and ^{scribed} B. P. 3-2075

Feet

brs. S. $41^{\circ} 31'$ E. 5 ft and a second pine post of same dimensions and scribing brs. N. $69^{\circ} 09'$ E. 5 ft., no bearing monuments available,

Thence N. $69^{\circ} 09'$ E.

10.0 to original location for W end center,

45.55 same bearing to Cor.No4 the NW cor identical with location and with the NE, Cor.No.3, Cor.No.5, & Cor.No.4 respectively Bayonne, lode, unsurveyed, Friday lode, Survey No.1795. Muhelm lode Survey No.1795, and Eagle Eye lode, Survey No.1860, a pine post 4 ft long 4 ins sq set 1 ft in the ground in a mound of stones and scribed 4-2075 N L whence a pine post of same dimensions and scribed B.P.4-2075 brs. S. $36^{\circ} 55'$ W. 10 ft and a second pine post of same dimensions and scribing brs. S. $54^{\circ} 10'$ E. 10 ft., no bearing monuments available,
Cor. No. 3, Eagle Eye Lode, Sur. 1860 - brs. S. $41^{\circ} 31'$ E. 600.1 ft.

Thence S. $54^{\circ} 10'$ E

243.9 to Cors.No.4 and 6 respectively of Muhelm and Columbia lodes, Survey No.1795,

518.9 same bearing to Cor.No.5, identical with Cor.No.5 Columbia lode, Survey No.1795, a pine post 4 ft long 4 ins sq set 1 ft in the ground in a mound of stones and scribed 5-2075 N L. whence a pinepost of same dimensions and scribed B.P 5-2075 brs. N. $54^{\circ} 10'$ W. 25 ft and a second pine post of same dimensions and scribing brs. S. $87^{\circ} 01'$ E. 25 ft., no bearing monuments available.

Thence S. $87^{\circ} 01'$ E.

373.6 along line 5-4 Columbia lode Survey No.1795 to Cor.No.1 the place of beginning.

Ledge.

The presumed course of the vein on this claim is from the E end center of location N. $54^{\circ} 15'$ W. ~~700.4~~
^{54 15 700.4}

Improvements.

I hereby certify that the value of the labor and improvements on this claim placed thereon by claimants or their grantors is less than \$500 and that said improvements consist of:

N .1	Discovery shaft 4x6x10 ft brs from E E C N.52° 11' W 300 ft., Value	\$100.00
No.2	Shaft 4x6x10 ft brs from Cor.No1 S. 78° 30' W. 90 ft., Value	<u>100.00</u>
	Total improvements Nagasaki lode,	\$200.00

Note

Complete affidavit of \$500 improvements on this claim will be filed before the expiration of publication.



U. S. Deputy Mineral Surveyor.

Dated at Bisbee, Arizona,

June th 26, 1905.

IMPROVEMENTS.

~~I hereby certify that the value of the labor and improvements on this claim placed thereon by claimants or their grantors is less than \$500, and that ^{said} ~~said~~ improvements consist of:~~

No.1 Discover shaft 4x6x10 ft. hrs from Cor.No.1 S. 78° 30' W. 90 ft., Value \$100

Note Complete affidavit of \$500 improvements on this claim will be furnished before the expiration of publication.

Corrected improvements inserted further

AREA.

Total area Nagasaki lode,	2.131 acres
Less area in conflict with Eagle Eye lode, Survey No.1860	0.587
Less area in conflict with Bayonne lode, unsurveyed	<u>0.012</u> 0.599
Net area Nagasaki	1.532 acres.

ADJOINING CLAIMS.

North Friday, Muhlein and Columbia lodes, Survey No.1795, Suginay Development Co. owner,

East Lone Jack lode, unsurveyed, J. D. Snodderly, owner;

South Eagle Eye lode, Survey No.1860, Charley Strong, et al. owners;

West, Bayonne lode, unsurveyed, Jos. F. Chisholm, et al. owners;

LOCATION.

This claim is located about 3 mi in a SE direction from the City of Bisbee, on unsurveyed lands in the Warren Mining District in Cochise County, Arizona, approximately in T₂₃ S R 2 4 E G & S R B & M.

INSTRUMENT.

THIS SURVEY WAS MADE with a C.L. Berger & Sons No.1 C transit; the courses were deflected from the true meridian as determined by a Solar observation checked by an observation on Polaris, the distances were measured with a 300-ft Steel tape. Magnetic variation 12° 40' E.

Francis A. Smith

U.S. Deputy Mineral Surveyor.

Dated at Bisbee, Arizona, June 3, 1905.

Note

This survey being within the 2 mi. limit of an established corner of the Public Land Survey, it has therefore been tied to the NW cor of Sec. 30 T. 23 S.R. 25 E. G. & S.R. B. & N. instead of U.S.M.M. No. 4.

Any discrepancies between the courses and distances of this survey and those of the following, adjoining and conflicting approved surveys, are due to errors in the latter:

Egle Eye lode, Survey No. 1860, lines 1-4; 2-3; and 3-4;

Muhlen lode, Survey No. 1795, line 4-5;

Columbin lode, Survey No. 1795, line 5-6 and line 4-5;

FINAL OATHS FOR SURVEYS.

LIST OF NAMES.

A list of the names of the individuals employed by Franklin W Smith

United States Deputy Mineral Surveyor, to assist in running, measuring, and marking the lines, corners, and boundaries described in the foregoing field notes of the survey of the mining claim of.....

Howal A Smith

known as the Nagasaki

and showing the respective capacities in which they acted.

E G Minder....., Chainman.

R R Boyd....., Chainman.

....., Arman.

....., Flagman.

FINAL OATHS OF ASSISTANTS.

We, E G Minder

and R R Boyd, do solemnly swear that we assisted Franklin

W Smith, United States Deputy Mineral Surveyor, in marking the corners and surveying

the boundaries of the mining claim of Howal A Smith

known as the Nagasaki

represented in the foregoing field notes as having been surveyed by said deputy mineral surveyor and under his

direction; and that said survey has been in all respects, to the best of our knowledge and belief, faithfully and

correctly executed, and the corner and boundary monuments established according to law and the instructions

furnished by the United States Surveyor-General for Arizona

E. G. Minder....., Chainman.

R. R. Boyd....., Chainman.

....., Arman.

....., Flagman.

Subscribed and sworn to by the above-named persons before me this 2nd

day of June, 1905.

Caro Smith

NOTARY PUBLIC
In and for the County of Cochise, Arizona
My Commission Expires Jan 1, 1907

Notice of Mining Location

LODE CLAIM

To All Whom it May Concern:

NAGASAKI

This Mining Claim, the name of which is the Mining Claim, situate on lands belonging to the United States of America, and in which there are valuable mineral deposits, was entered upon and located for the purposes of exploration and purchase by

Raymond Chisholm

A Citizen of the United States

(Locator must insert either "a citizen of the United States," or "who has declared his intention to become a citizen of the United States.")

the undersigned, on the 8 day of March 1904

The length of this claim is 1500 feet, and 9 claim Fifty (50) feet,

in an Easterly direction and Fourteen Hundred & Fifty (1450) feet in a Westerly direction from the center of the discovery shaft, at which this notice is posted, lengthwise of the claim, together with 300 feet in width of the surface grounds, on each side of the center of said claim. The general course of the lode deposit and premises is from the East to the West

The claim is situated and located in the Warren Mining District, in Cochise County, in the Territory of Arizona, about 2 1/4 miles in a Southeastly direction from the City of Bisbee, and about 2,500 feet in an easterly direction from the house formerly owned and occupied by J.C. Chisholm. The eastern portion of this claim was located by Joseph F. Chisholm as the Hazel and was abandoned by said Joseph F. Chisholm, its west end line is identical with the side line of the Bode

The surface boundaries of the claim are marked upon the ground as follows: Beginning at A monument containing a stake

at a point in an easterly direction (Fifty) 50 feet from the discovery shaft (at which this notice is posted), being in the center of the east end line of said claim; thence 300 feet to a monument, being the Southeast corner of said claim; thence 1500 feet to a monument, being at the Southwest corner of said claim; thence 300 feet to a monument at the center of the West end of said claim; thence 300 feet to a monument, being at the Northwest corner of said claim; thence 1500 feet to a monument at the Northeast corner of said claim; thence 300 feet to the place of beginning.

All done under the provisions of Chapter Six, of Title XXXII, of the Revised Statutes of the United States, and of an Act of the General Assembly of Arizona, entitled "An Act to Revise and Codify the Laws of the Territory of Arizona," approved March 16, 1901.

This is an Amended Location Notice of the Mining Claim, located by _____ on the _____ day of _____ 190____, and recorded in Book _____ of Record of Mines, at page _____, in the office of the County Recorder of the aforesaid County of _____ to which reference is hereby made, and this amended Location Notice is made and posted to correct errors in the description in the said original Location Notice.

Dated and posted on the ground this 8 day of March 1904

Raymond Chisholm

Witnessed by Thos F. Quinn

No. 109. AMENDED NOTICE OF LOCATION OF LODE CLAIM. The H. H. McNeil Company's Red Line Blanks, Phoenix, Arizona.

TERRITORY OF ARIZONA,
County of *Yavapai* ss

I, *Frank R. Carr* County Recorder in and for the County and Territory aforesaid, do hereby certify that the *mining* instrument was filed for record at *9* o'clock *4* M., on this *14th* day of *Sept* 190*4*, and duly recorded in Book No. *30* of *Warrington* Records of *Frank R. Carr* County, Arizona, at pages *240*.

WITNESS my hand and official seal the day and year first above written.

Frank R. Carr
County Recorder.

~~AMENDED~~
Notice of Location.
LODE CLAIM.

Dated *1904*

Filed and recorded at the request of
Raymond Chisholm

Sept 14th A. D. 190*4*

at *9 4* M.

Book *30* Records of Mines

Page *240*

Frank R. Carr
County Recorder.

By _____
Deputy Recorder.

PC

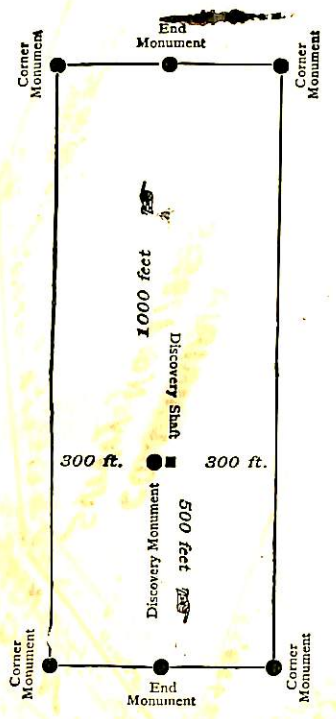

This diagram is to give locator a general idea of plan of location under the new law. The Discovery Shaft can be in the center of claim or any distance from either end desired. In the diagram it is placed 500 feet from one end and 1000 feet from the other. Commence description of claim at a center end monument, giving its distance and direction from center of Discovery Shaft; thence bound the claim in either direction. In description be careful to state locality of claim with reference to some natural object, or permanent monument, as will identify the claim.

4-688.

U. S. SURVEYOR-GENERAL'S FINAL CERTIFICATE ON FIELD NOTES.

Department of the Interior,

OFFICE OF U. S. SURVEYOR-GENERAL,

Phoenix, Arizona.

July 3, 1905

I, U. S. Surveyor-General for ~~the district of Arizona.~~

do hereby certify that the foregoing transcript of the Field Notes, return and approval of the survey of the mining claim of Howal A. Smith,

known as the Nagasaki

situate in Warren

Mining District, Cochise County, Arizona.

in Section approx., Township No. 23 S., Range No. 24 E. unsurveyed, and designated as Survey No. 2075, has been correctly copied from the originals on file in this office; that said Field Notes furnish such an accurate description of said mining claim as will, if incorporated into a patent, serve fully to identify the premises, and that such reference is made therein to natural objects or permanent monuments as will perpetuate and fix the locus thereof.

And I further certify that ^{less than} five hundred dollars' worth of labor has been expended or improvements made upon said mining claim by claimant or his grantors, and that said improvements consist of, at time of survey, 7 shafts, total value \$900.00

and that no portion of said labor or improvements has been included in the estimate of expenditures upon any other claim.

I further certify that the plat thereof, filed in the U. S. Land Office at Tucson, Arizona. is correct and in conformity with the foregoing Field Notes.

(Signed) Frank S. Ingalls,

United States Surveyor-General for Arizona.

SURVEYOR-GENERAL'S CERTIFICATE OF APPROVAL OF FIELD NOTES AND SURVEY OF MINING CLAIM.

Department of the Interior,

Office of U. S. Surveyor-General,

Phoenix, Arizona.

July 3, 1905

I, U. S. Surveyor-General for the district of Arizona.

do hereby certify that the foregoing and hereto attached Field Notes and Return of the Survey of the Mining Claim of Hoyal A. Smith,

known as the Nagasaki

situate in Warren Mining District, Cochise County, Arizona.

in Section approx., Township No. 33 S., Range No. 24 E. unsurveyed, designated as Survey No. 3075

executed by Franklin W. Smith, U. S. Deputy Mineral Surveyor, May 31st to June 1st 1905, 190, under my instructions dated May 29th 1905, 190, have been critically examined and the necessary cor-

rections and explanations made, and the said Field Notes and Return, and the Survey they describe, are hereby approved. A true copy of the copy of the location certificate filed by the applicant. for survey is included in the field notes.

Frank S. Ingalls

U. S. Surveyor-General for Arizona.

SURVEY NO. 2075 SCALE 200 FT = 1 IN

