

**M  
S  
.**

**0**

**2**

**0**

**8**

**7**

1  
JUN 29 1905

*Copied by amt  
2/6/05*

(4-683.)

Mineral Survey No. 2087

Lot No. \_\_\_\_\_

Gila Land District.

### FIELD NOTES

OF THE SURVEY OF THE MINING CLAIM OF

Novel A. Smith

KNOWN AS THE

Saturday, Sherwood and Ness Extension  
Subdivision Warner Mining District.

Cochise County, Arizona

Section Approx, Township 23 S., Range 24 E. ~~11 N.~~

Surveyed under instructions dated May 31<sup>st</sup>, 1905

by Franklin W. Smith

U. S. Deputy Mineral Surveyor

Claim located See Notices ..... 1 9

Survey commenced June 3<sup>rd</sup> ..... 1 905

Survey completed June 4<sup>th</sup> ..... 1 905

Post Office address of Claimant:  
Bisbee, Cochise County, Arizona

*Tier ✓  
Leases ✓  
areas  
misc. ✓*

# Certificate of U. S. Surveyor General

AS TO

EXPENDITURES REPORTED AFTER RETURN OF SURVEY OF MINING CLAIM.

I, U. S. Surveyor General for the district of Arizona.,  
do hereby certify that Five Hundred Dollars' worth of labor has been expended or  
improvements made by claimant or his grantors, upon the mining claim of

Hoval A. Smith,

known as the Saturday, Sherwood, Keno Extension.

situate in Warren mining district.

Cochise County, Arizona.

in Section \_\_\_\_\_, Township No. \_\_\_\_\_, Range No. \_\_\_\_\_;

that said improvements consist of On Saturday, 5 shafts, value \$500.

On the Sherwood, 6 shafts, value \$650. On Keno Extension,  
6 shafts, value, \$600.

\_\_\_\_\_, and that no portion of said labor or improvements has been  
included in the estimate of expenditures upon any other claim. A copy of the report of  
Franklin W. Smith, U. S. Deputy Mineral Surveyor, dated  
August, 4, 1905., 18 \_\_\_\_\_, is hereto attached.

U. S. Surveyor General for Arizona.

Office of U. S. Surveyor General,  
Phoenix, Arizona,

August 10<sup>th</sup> 1905., 18 \_\_\_\_\_

Affidavit of Five Hundred Dollars Improvements.

We, A. J. Giesemer and T. F. Field

of lawful age, being first duly sworn according to law, depose and say: That we are acquainted with the

Saturday Sheward Vens Extension mining claim, situate in Maricopa

mining district, Cochise County, Arizona Territory, for which

Horat A. Smith

has made application for survey prior to application for patent under the provisions of the Act of Congress

approved May 10, 1872; and that the labor done and improvements made thereon by the applicant... and

his grantor... exceed five hundred dollars in value, and further that we are not personally interested

in said mine.

A. J. Giesemer  
T. F. Field

TERRITORY OF ARIZONA,

COUNTY OF Cochise

} ss:

Sworn to and subscribed before me this 14th day

[SEAL.]

of August, 1905

17171b400-3-05

Corra Smith

NOTARY PUBLIC  
and for the County of Cochise, Territory of Arizona  
My Commission Expires March 21, 1909.

3  
4

Feet

Beginning at Cor.No.1 at the point of intersection of the W side line of Livingstone lode, unsurvey, with line 1-4 No.10 lode, Survey No.2044, a pine post 4 ft long 4 ins sq set 1 ft in the ground in a mound of stones and scribed 1-2087 S L, whence a pine post of same dimensions and scribed B. P. 1-2087 brs. N. 41° 16' W. 25 ft and a second pine post of same dimensions and scribing brs N. 13° 9' E. 25 ft., no bearing monuments available, and NW cor Sec 30 Tp 23 S R 25 E G & S R B & M brs S. 68° 36' 30" E. 9121.9 ft.

Thence N.41° 16' W.

51.3 along line 1-4 No.10 lode, Survey No.2044 to Cor.No.2, identical with Cor.No.4 No.10 lode, A pine post 4 ft long 4 ins sq set 1 ft in the ground in a mound of stones and scribed 2-2087 S.L., whence a pine post of same dimensions and scribed B. P. 2-2087 brs. S.41° 16' E. 26.3 ft., and a second pine post of same dimensions and scribing brs. S. ~~152-15~~<sup>52° 15'</sup> W. 25 ft., no bearing monuments available,

Thence S. 52° 15' W.

766.9 to Cor.No.3, the SE cor., identical with Cor.No.1 Sherwood lode of this survey, a pine post etc, scribed 3-2087 S L., whence original location for SE cor brs: N. 69° 09' E. 650 ft.,

Thence S. 69° 09' W.

45.04 to original location for S E C.,

90.99 same bearing to Cor.No.4 the SW cor., identical with location, with Cor.No.6 Sherwood lode of this survey, and situated on line 2-3 Early Morning lode, Survey No. 1860, a pine post 4 ft long 4 ins sq set 1 ft in the ground in a mound of stones and scribed 4-2087 S L., whence a pine post of same dimensions and scribed B. P. 4-6-2087 brs S. 50° 08' W. 25 ft and a second pine post of same dimensions and scribing brs. N. 50° 8' E. 25 ft., no bearing monuments available,

Feet

Thence N. 50° 08' E.

336.4 along line 2-3 Early Morning lode, Survey No.1860, to Cor No5, a pine post 4 ft long 4 ins sq set 1 ft in the ground in a mound of stones and scribed 5-2087 S L whence a pine post of same dimensions and scribed B. P 5-2087 brs S. 50° 08' W. 25 ft, and a second pine post of same dimensions and scribing brs. N. 13° 09' E. 25 ft., no bearing monuments available, and Cor.No.3 Early Morning lode, Survey No.1860 brs. N. 50° 08' E. 663.6,

Thence N. 13° 09' E.

813.1 to Cor.No.6, the NW cor., identical with location, with Cor.No.2 Lone Jack lode, Survey No.2072, and situated on line 3-4 Early Morning lode, Survey No.1860, N. 41° 31' W. <sup>489.35</sup> ~~491.22~~ ft. from Cor.No.3, a pine post 4 ft long 4 ins sq set 1 ft in the ground in a mound of stones and scribed 6-2087 S L whence a pine post of same dimensions and scribed B. P. 6-2087 brs. S. 13° 09' W.25 ft and a second pine post of same dimensions and scribing brs. N. 69° 09' E. 25 ft., no bearing monuments available.

Thence N. 69° 09' E.

355.83 to original location for N E C.,  
479.7 same bearing to Cor.No.7, the NE cor identical with location, and at the point of intersection of line 1-2 Lone Jack lode, Survey No.2072 with the W side line of Livingstone lode, unsurveyed, a pine post 4 ft long 4 ins sq set 1 ft in the ground in a mound of stones and scribed 7-2087 S L. whence a pine post of same dimensions and scribed B. P. 7-2087 brs. S. 69° 09' W. 25 ft., and a second pine post of same dimensions and scribing brs, S. 13° 09' W. 25 ft., no bearing monuments available,

Thence S. 13° 09' W.

550.2 to the intersection of line 3-4 Early Morning lode, Survey No.1860 at N. 41° 31' W. 1.87 ft from Cor.No.3,

## Feet

553.32 same bearing to the intersection of line 2-3 Early Morning lode, Survey No.1860 at S.  $50^{\circ} 08' W$ . 2.54 ft from Cor. No 3,

734.4 same bearing to Cor.No.1 the place of beginning.  
Ledge.

The presumed course of the vein on this claim is from the S E C location N  $52^{\circ} 15' E$ . 729.4 ft thence N.  $13^{\circ} 09' E$ . 689.5 ft.,

-----

S h e r w o o d.

Beginning at Cor.No1, the E cor identical with location and with Cor.No.3 *Saturday* lode of this survey and situated on line 3-4 No.10 lode, Survey No. 2044, a pine post 4 ft long 4 ins sq set 1 ft in the ground in a mound of stones and scribed 1-2087 S H.L., whence a pine post of same dimensions and scribed B. P. 1-~~8~~ 2087 brs. N.  $52^{\circ} 15' E$ . 25 ft, and a second pine post of same dimensions and scribing brs. S.  $53^{\circ} 15' W$ . 25 ft., no bearing monuments available, and NW cor Sec 30 Tp 23 S R 25 E G & S R B & M brs. S.  $72^{\circ} 24' 30'' E$ . 9582.0 ft.,

Thence S.  $52^{\circ} 15' W$ .

733.1 along line 4-3 No.10 lode, Survey No.2044 to Cor.No.2 identical with Cor.No.3 No.10 lode, Survey No.2044 and with Cor No.4 Keno Extension lode of this survey, a pine post 4 ft long 4 ins sq set 1 ft in the ground in a mound of stones and scribed 2-2087 Sh L whence a pine post of same dimensions and scribed B. P. #2-2087 brs. S.  $49^{\circ} 42' W$ . 25 ft and a second pine post of same dimensions and scribing brs. N.  $52^{\circ} 15' E$ . 25 ft no bearing monuments available,

Sherwood (Con)

62

Thence S. 49° 42' W.

30.4 to Cors. No. 3 and 3 respectively of Keno Extension lode of this survey and Baker lode of Survey No. 1872,

452.5 same bearing to Cor. No. 3, the S cor identical with location with Cors No. 4 of Baker lode, Survey No. 1872 Wallace lode

117  
2574

Survey No. 1782 and Antelope lode Survey No. 1960, and a corner of Lucky lode, ~~Survey No. 2084~~ *Sur. No 2084* from which point Cor. No. 3 Antelope lode, Survey No. 1960

brs. N. 49° 34' E. 600 ft., a pine post 4 ft long 4 ins sq set 1 ft in the ground in a mound of stones and scribed Sh. L. 3-2087 and a pine post of same dimensions and scribed E. P. 3-2087 brs N. 49° 42' E. 25 ft and a second pine post

of same dimensions and scribed S H 3-2087 brs S. 49° 42' W 25 ft no bearing monuments available,

(It is found that upon measuring line 3-4 Wallace lode, Survey No. ~~1782~~ 1782 that it falls .7 ft. short of the distance reported in the patent survey, thus making it identical with Cor. No. 4 Antelope lode, Survey No. 1960.

I also find that Cors. No. 4 of the Baker lode, Survey No. 1872, Wallace lode Survey No. 1782 and Antelope Survey No. 1960 are identical,

Thence S. 69° 09' W.

2.0 to original location for SW E C

4.19 same bearing to Cor. No. 4, the W cor identical with location a pine post 4 ft long 4 ins sq set 1 ft in the ground in a mound of stones and scribed 4-2087 Sh L

whence a pine post of same dimensions and scribed E. P. 4-2087 brs. N. 49° 42' E. 25 ft, and a second pine post of same dimensions and scribed Sh 4-2087 brs S. 49° 42' W 25 ft., no bearing monuments available,

Thence N. 49° 42' E.

4.05 to the intersection of line 3-4 Wallace lode Survey No. 1782 at N. 35° 37' W. 1.4 ft from Cor. No. 4, this point is also the intersection of line 1-4 Antelope lode, Survey No. 1960 N. 35° 37' W. 1.4 ft from Cor. No. 4



8 Feet

603.95 same bearing to Cor.No.5 identical with Cors.No.3 and 2 respectively of Antelope lodes, Survey No.1860, and Early Morning lode, Survey No.1860. a pine post 4 ft long 4 ins sq set 1 ft in the ground in a mound of stones and scribed 5-2087 Sh L whence a pine post of same dimensions and scribed B.P. 5-2087 brs. S. 49° 42' W. 25 ft and a second pine post of same dimensions and scribing brs. N. 50° 08' E. 25 ft., no bearing monuments available,  
 Thence N. 50° 08' E.

500.0 along line 2-3 Early Morning lode, Survey No.1860 to Cor No.6 the N cor., identical with location and with Cor No. 4 Saturday lode of this survey, a pine post etc scribed 6-2087 Sh L., and original location for Cor.No.6 brs. S. 69° 09' W. 15 ft.,  
 Thence N. 69° 09' E.

88.09 to original location for NE E C.

90.09 same bearing to Cor.No.1 the place of beginning.  
 Ledge.

The presumed course of the vein on this claim is from the SW E C location N. 49° 42' E. 454.64 ft thence N . 52° 15' E. 731.0 ft.,

-----  
 KENO EXTENSION.

Beginning at Cor.No.1, the NE cor., identical with location, a pine post 4 ft long 4 ins sq set 1 ft in the ground in a mound of stones and scribed 1-2087 K E L whence a pine post of same dimensions and scribed B P 1-2087 brs. N. 41° 16' W. 25 ft., and a second pine post of same dimensions and scribing brs. S. 49° 42' W. 5 ft., no bearing monuments available, and NW cor Sec 30 Tp 23' S R 25 E G & S R B & M brs S. 81° 22' 30" E. 8828.05 ft  
 Thence S. 49° 42' W.

10.0 to original location for S E E C

19.3 same bearing to Cor.No.2, the SE cor., identical with

Feet

location with Cor.No.2 Baker lode, Survey No. 1872,  
*and with cor No E Keno Lode Sur No 1872 from which point*  
~~and situated on line 4-5 Keno lode, Survey No. 1872,~~  
~~cor No E Keno Lode brs N 47° 29' E 19.3 ft., a pine post~~  
~~S. 47° 29' W. 19.3 ft. from Cor.No.4, a pine post~~

4 ft long 4 ins sq set 1 ft in the ground in a mound of  
 stones and scribed 2-2087 K E L whence a pine post of  
 same dimensions and scribed B. P. 2-2087 brs. N. 49° 42' E  
 25.00 ft., an and a second pine post of same dimen-  
 sions and scribing brs. N. 41° 42' W. 25 ft, no bearing  
 monuments available,

Thence N. 41° 42' W

1494.1 along the NE side line of Baker lode, Survey No. 1872  
 to Cor.No.3, the SW cor identical with location and  
 with cor No.3 Baker lode, Survey No. 1872, a pine post  
 4 ft long 4 ins sq set 1 ft in the ground in a mound of  
 stones and scribed 3-2087 K E L whence a pine post of same  
 dimensions and scribed <sup>ing</sup> brs. S. 41° 42' E. 25 ft., and  
 a second pine post of same dimensions and scribing brs  
 N. 49° 42' E. 5 ft., no bearing monuments available,

Thence N. 49° 42' E.

20.4 along line 3-2 Sherwood lode of this survey to original  
 location for NW E C

30.4 same bearing to Cor.No.4, the NW cor identical with lo-  
 cation with Cor.No.2, Sherwood lode of this survey and  
 with Cor.No.3 No.10 lode, Survey No. 2044, a pine post 4  
 ft long 4 ins sq set 1 ft in the ground in a mound of  
 stones and scribed 4-2087 K E. L., whence a pine post of  
 same dimensions and scribed B. P. 4-2087 brs. S. 4° 42' W  
 5 ft and a second pine post of same dimensions and scribing  
 brs. S. 41° 16' E. 25 ft., no bearing monuments available,

Thence S. 4° 16' E.

600.0 to Cors No.2 and 3 respectively of No.10 and No.9 lodes  
 Survey Nos. 2044 and 2043 respectively

1200.0 same bearing to Cors No.2 and 3 respectively of No.9  
 lode, Survey No. 2043 and No.8 lode, Survey No. 2049,

Feet

1493.1 same bearing along line 4-2 No.8 lode, Survey No.2049 to  
Cor.No.4 Keno lode, Survey No.1872,

1493.85 same bearing to Cor.No.1, the place of beginning  
Ledge.

The presumed course of the vein on this claim is  
from the SE E C locati on N. 41° 16' W. 1493.85 ft.

A R E A.

Total area Saturday lode,	7.215 ac
Less area in conflict with Early Morning lode, Survey No.1860	<u>3.726</u>
Net area Saturday lode	3.489 ac

Total area Sherwood lode,	0.251
Less area in conflict with Antelope lode, Survey No.1960	0.010
Less area in conflict with Wallace lode, Survey No.1782 nominal	0.000 0.010
Net area Sherwood lode,	0.241

Total area Keno Extension lode	0.852
Less area in conflict with Keno lode Survey No.1872 nominal	<u>0.000</u>
Net area Keno Extension	<u>0.852</u>

Net area Group 4.582 ac

IMPROVEMENTS.

I hereby certify that the value of the labor and  
improvements on this group placed thereon by the claimant  
or his grantors is as follows:

Saturday.

No.1	Discovery shaft 4x6x10 ft brs from <del>Cor.No.7</del> N.E.C.	
	513° 09' W 350' Value	\$100.00
No.2	shaft 4x6x10, brs from S.W.E.C. N 52° 15' E 310.0'	100.00
	Sherwood.	\$200.00

No.1	Discovery shaft 4x6x15 ft brs from Cor.No.1	
	S. 58° W. 50 ft., Value	150.00

Keno Extension.

No.1	Discovery shaft 4x6x10 ft. brs from Cor.No.2	
	N. 39° W. 260 ft. Value	100.00
No.2	Shaft 4x6x10 ft brs from same point N. 00° W. 15 ft.,	
	Value	100.00

No.3 Shaft 4x6x10 ft brs from Cor.No.3 N. 75° E. 15 ft.,

Value \$100.00

Total improvements on Keno Estension \$300.00

Total improvements on group \$600.00

ADJOINING CLAIMS.

North Lone Jack lode, Survey No.2072, J. D. Snodderly, owner;

East Livingstone lode, unsurveyed, G. J. McCabe, et al owners;

No.10 lode, Survy No.2044, No.9 lode Survey No.2043, No.8 lode, Survey No.2049, H. A. Smith, owner.

South Kenc lode, Survey No.1872, M. J. Cunningham, et al owners;

West Baker lode, Survey No.1872, sameowner;

Lucky lode, ~~unsurveyed~~ <sup>Sur. No. 2084</sup>, Wallace lode, Survey No.1782,

Jacob Pirrung, et al owners. Antelope lode, Survey No.1960

L. C. Shattuck et al owners. Early Morning lode, Survey No

1860 Charles Strong et al owners.

LOCATION.

This group is located about 3½ mi in a SE direction from the City of Bisbee, on unsurveyed lands in the Warren mining district, in Cochise County, Arizona, approximately in tp 23 S R 24 E G & S R B & M.,

INSTRUMENT.

This survey was made with a C. L. Berger & Sons No.1 C transit; the courses were deflected from the true meridian as determined by a Solar observation checked by an observation on Polaris; the distances were measured with a 300-ft steel tape. Magnetic variation 12° 30' E.

*Franklin W. Smith*

United States Deputy Mineral Surveyor.

Dated at Bisbee, Arizona,

June 4<sup>th</sup> 1905.

Note.

Complete affidavit of \$500 improvements for each location hereof will be furnished before the expiration of publication.

Note 2. Any discrepancies between the courses and distances of this survey, and those of the adjoining and conflicting approved surveys are due to errors in the latter.

Survey No. 2087  
Saturday, et al mining claims  
situated in Warren Mining District, Cochise County, Arizona.  
Royal A. Smith, owner.

AFFIDAVIT OF \$500 IMPROVEMENTS.

I hereby certify that the value of labor and  
improvements placed upon each location of this survey  
is not less than \$500 and that said improvements consist of:

SATURDAY.

No.1	Discovery shaft 4x6x10 ft hrs from N E C S. 15° 0' W. 350 ft., Value	\$100.00
No.2	Shaft 4x6x10 ft hrs from S. E C N. 52° 15' E. 310 ft Value	100.00
No.3	Shaft 6x8x10 ft hrs from Cor.No.3 EarlyMorning lode Survey No.1860 N 4° 30' W. 306 ft., Value	100.00
No.4	Shaft 6x8x10 ft hrs from same point N. 5° W.347 ft Value	100.00
No.5	Shaft 4x6x10 ft hrs from same point N. 3° 30' W 359 ft., Value	<u>100.00</u>

Total improvements Saturday lode, \$500.00

SHERWOOD.

No.1	Discovery shaft 4x6x15 ft hrs from Cor.No.1 S. 58° W. 50 ft., Value	\$150.00
No.2	Shaft 4x6x10 ft hrs from N E C S. 51° W. 137 ft., Value	100.00
No.3	Shaft 4x6x10 ft hrs from N E C., S. 51° W. 160 ft Value	100.00
No.4	Shaft 4x6x10 ft hrs from N E C S. 51° W. 187 ft., Value \$100	100.00
No.5	Shaft 4x6x10 ft hrs from N E C S. 51° W. 202 ft Value	100.00
No.6	Shaft 4x6x10 ft hrs from <del>C</del> N E C S. 54° W. 220 ft., Value,	<u>100.00</u>

Total improvements on Sherwood lode, \$650.00

KENO EXTENSION.

No.1	Discovery shaft 4x6x10 ft brs from Cor.No.2 N. 39° W 260 ft., Value	\$100.00
No.2	Shaft 4x6x10 ft brs from Cor.No.2 N.15 ft., Value	100.00
No.3	Shaft 4x6x10 ft brs from Cor.No.3 N. 75° E. 15 ft Value	100.00
No.4	Shaft 5x7x10 ft brs from SE E C N. <sup>14°</sup> <del>15°</del> W. 27 ft., Value	100.00
No.5	Shaft 5x7x10 ft brs from SE E C N 14° W. 58 ft., Value	100.00
No.6	Shaft 5x7x10 ft brs from S E E C N. 14° W. 79 ft., Value	<u>100.00</u>

Total improvements on Keno Extension

600.00

Total improvement on group

1750.00  
2350.00

U. S. Deputy Mineral Surveyor,

Office at Bisbee, Arizona,

August 4, 1905.

# FINAL OATHS FOR SURVEYS.

## LIST OF NAMES.

A list of the names of the individuals employed by Franklin W. Smith

United States Deputy Mineral Surveyor, to assist in running, measuring, and marking the lines, corners, and boundaries described in the foregoing field notes of the survey of the mining claim of.....

Novel A. Smith.

known as the Sherwood, Kens Extension, Saturday

and showing the respective capacities in which they acted.

R. G. Zeisemer....., Chairman.

D. C. Curry....., Chairman.

....., Axman.

....., Flagman.

## FINAL OATHS OF ASSISTANTS.

We, R. G. Zeisemer

and D. C. Curry....., do solemnly swear that we assisted Franklin W. Smith....., United States Deputy Mineral Surveyor, in marking the corners and surveying

the boundaries of the mining claim of Novel A. Smith

known as the Saturday, Sherwood, Kens Extension

represented in the foregoing field notes as having been surveyed by said deputy mineral surveyor and under his direction; and that said survey has been in all respects, to the best of our knowledge and belief, faithfully and correctly executed, and the corner and boundary monuments established according to law and the instructions furnished by the United States Surveyor-General for Arizona.....

R. G. Zeisemer....., Chairman.

D. C. Curry....., Chairman.

....., Axman.

....., Flagman.

Subscribed and sworn to by the above-named persons before me this 4<sup>th</sup>

day of June....., 1905.

Novel A. Smith

(4-686.)

FINAL OATH OF U. S. DEPUTY MINERAL SURVEYOR

I, Franklin W. Smith, U. S. Deputy Mineral Surveyor, do solemnly swear that, in pursuance of instructions received from the United States Surveyor General for Arizona, dated May 31<sup>st</sup> 1905, I have, in strict conformity to the laws of the United States, the official regulations and instructions thereunder, and the instructions of said Surveyor General, faithfully and correctly executed the survey of the Mining Claim of Novala Smith.

Saturday, Sherwood, Kern Extension, known as the situate in Warren Mining District, Cochise County, Arizona, in Section approx, Township No. 23S, Range No. 24E, ~~5E, 6E, 7E, 8E~~ unsurveyed and designated as Survey No. 2087, as represented

in the foregoing field notes, which accurately show the boundaries of said mining claim as distinctly marked by monuments on the ground, and described in the attached copy of the location certificate, which was received by me from the Surveyor General with said instructions, and that all the corners of said survey have been established and perpetuated in strict accordance with the law, official regulations and instructions thereunder; and I do further solemnly swear that the foregoing are the true and original field notes of said survey and my report therein, and that the labor expended and improvements made upon said mining claim by claimant or his grantors are as therein fully stated, and that the character, extent, location and itemized value thereof are specified therein with particularity and full detail, and that no portion of said labor or improvements so credited to this claim has been included in the estimate of expenditures upon any other claim.

Franklin W. Smith  
U. S. Deputy Mineral Surveyor.

Subscribed and sworn to by the said Franklin W. Smith  
U. S. Deputy Mineral Surveyor, before me

this 4<sup>th</sup> day of June, 1905.

Corra E. Smith



# Notice of Mining Location

## LODE CLAIM

To All Whom It May Concern:

This Mining Claim, the name of which is the Shannon Mining Claim, situate on lands belonging to the United States of America, and in which there are valuable mineral deposits, was entered upon and located for the purposes of exploration and purchase by H. A. Smith

(Locator must insert either "a citizen of the United States," or, "who has declared his intention to become a citizen of the United States.")

the undersigned, on the 17 day of April 1905

The length of this claim is 1500 feet, and 50 claim 50 feet,

in a northwesterly direction and 1450 feet in a northwesterly direction from the center of the discovery shaft, at which this notice is posted, lengthwise of the claim, together with 300 feet in width of the surface grounds, on each side of the center of said claim.

The general course of the lode deposit and premises is from the northwest to the southeast

The claim is situated and located in the Warren Mining District, in Cochise County, in the Territory of Arizona, about 5500 feet

in a northwesterly direction from U.S. M.M. No. 1872

and is bounded on North by Section 36, Union No. 10, on West by Section 36

and is bounded on South by Section 36. East by Section 36. mineral ground remaining this claim is located as described

The surface boundaries of the claim are marked upon the ground as follows: Beginning at

at a point in a northwesterly direction 50 feet from

the discovery shaft (at which this notice is posted), being in the center of the N.E.

end line of said claim; thence southwesterly 300 feet to a monument

, being the N.E. corner of said claim; thence

northwesterly 1500 feet to a monument, being at the

South corner of said claim; thence northwesterly 50 feet

to a monument at the center of the S.W. end of said claim;

thence northwesterly 300 feet to a monument, being at the

West corner of said claim; thence northwesterly 1500

feet to a monument at the South corner of said claim;

thence southwesterly 300 feet to the place of beginning.

All done under the provisions of Chapter Six, of Title XXXII, of the Revised Statutes of the United States, and of an Act of the General Assembly of Arizona, entitled "An Act to Revise and Codify the Laws of the Territory of Arizona," approved March 16, 1901.

Dated and posted on the ground this 17 day of April 1905

Witness H. A. Smith

Franklin Smith  
S. W. Grier

TERRITORY OF ARIZONA,  
County of Maricopa } ss.

I, Frank Stewart County Recorder in and for the County and Territory aforesaid, do hereby certify that the within instrument was filed for record at 9 o'clock A.M., on this 20 day of April 1905, and duly recorded in Book No. 33 of Miner Records of Verdeval County, Arizona, at pages 511

WITNESS my hand and official seal the day and year first above written.

Frank Stewart  
County Recorder.

# Notice of Location

## LODE CLAIM

Dated APR 20 1905 1905

Filed and Recorded at request of  
E. W. Armstrong

APR 20 1905 A. D. 1905

at 9. A. M.

Book 33 Records of Mines

Pages 511

Frank Stewart  
County Recorder.

By \_\_\_\_\_  
Deputy Recorder.

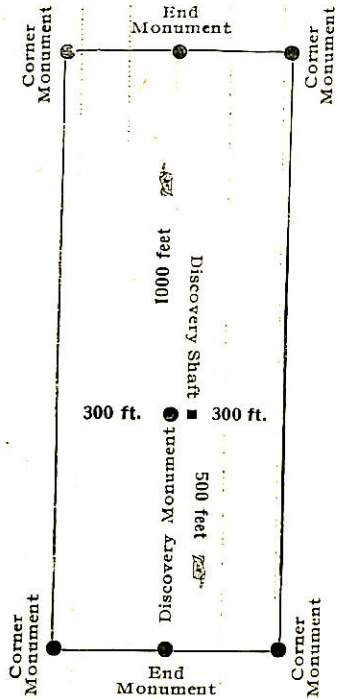

This diagram is to give locator a general idea of plan of location under the new law. The Discovery Shaft can be in the center of claim or any distance from either end desired. In the diagram it is placed 500 feet from one end and 1000 feet from the other. Commence description of claim at a center end monument, giving its distance and direction from center of Discovery Shaft; thence bound the claim in either direction. In description be careful to state locality of claim with reference to some natural object, or permanent monument, as will identify the claim.

# Notice of Mining Location

18

## LODE CLAIM

To All Whom It May Concern:

This Mining Claim, the name of which is the Saturday Mining Claim, situate on lands belonging to the United States of America, and in which there are valuable mineral deposits, was entered upon and located for the purposes of exploration and purchase by John Carretto

a citizen of the United States  
(Locator must insert either "a citizen of the United States," or, "who has declared his intention to become a citizen of the United States.")

the undersigned, on the 16 day of January 1904

The length of this claim is 1500 feet, and 1 claim 300 feet,

in a Northeasterly direction and 1200 feet in a Southwesterly direction from

the center of the discovery shaft, at which this notice is posted, lengthwise of the claim, together with 300 (or less) feet in width of the surface grounds, on each

side of the center of said claim. The general course of the lode deposit and premises is from the Northeast to the Southwest

The claim is situated and located in the Warren Mining District, in Cochise County, in the Territory of Arizona, about 2 1/4

in a Southeasterly direction from the city of Bisbee, and was formerly located by Joseph F. Leisholm as the Livingstone extension lode and was abandoned by said Joseph F. Leisholm. It is bounded on the east by the Union Group, on the west by the Early Morning survey (No. 1860).  
The surface boundaries of the claim are marked upon the ground as follows: Beginning at

a monument of stone

at a point in a Northeasterly direction 300 feet from

the discovery shaft (at which this notice is posted), being in the center of the Northeast end line of said claim; thence 300 (or less) feet to a monument of stones, being the northeast corner of said claim; thence

1500 feet to a monument, being at the Southeast corner of said claim; thence 300 (or less) feet

to a monument at the center of the Southwest end of said claim; thence 300 (or less) feet to a monument, being at the

Southwest corner of said claim; thence 1500 feet to a monument at the Northwest corner of said claim; thence 300 (or less) feet to the place of beginning.

All done under the provisions of Chapter Six, of Title XXXII, of the Revised Statutes of the United States, and of an Act of the General Assembly of Arizona, entitled "An Act to Revise and Codify the Laws of the Territory of Arizona," approved March 16, 1901.

Dated and posted on the ground this 16 day of January 1904

Witnesses { Raymond Leisholm John Carretto  
Jasper Bowman

Filed and recorded at request of John Carretto, Feb'y. 2nd 1904 at 9

A. M. Book 30, page 137, Record of Mines.

TERRITORY OF ARIZONA,  
 County of ..... } ss.

I, ..... County Recorder in and for the County and Territory aforesaid, do hereby certify that the within instrument was filed for record at ..... o'clock, ..... M., on this ..... day of ..... 190..., and duly recorded in Book No. .... of ..... Records of ..... County, Arizona, at pages.....

WITNESS my hand and official seal the day and year first above written.

County Recorder.

# Notice of Location

## LODE CLAIM

Dated ..... 190.....

Filed and Recorded at request of

..... A. D. 190.....

at ..... M.

Book .....

Pages: .....

..... County Recorder.

By ..... Deputy Recorder.

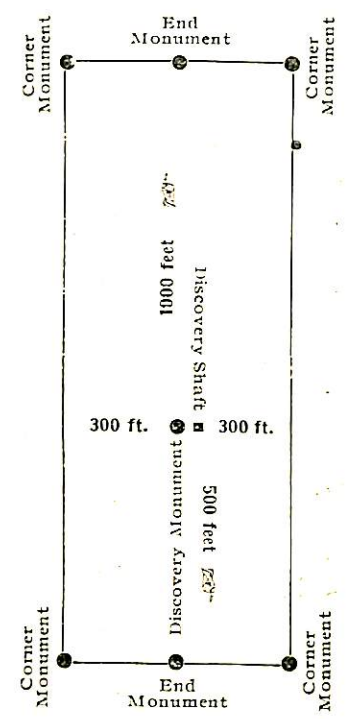

This diagram is to give locator a general idea of plan of location under the new law. The Discovery Shaft can be in the center of claim or any distance from either end desired. In the diagram it is placed 500 feet from one end and 1000 feet from the other. Commence description of claim at a center end monument, giving its distance and direction from center of Discovery Shaft; thence bound the claim in either direction. In description be careful to state locality of claim with reference to some natural object, or permanent monument, as will identify the claim.

Territory of Arizona, {  
 {ss.  
 County of Cochise. {

I, Frank Hare, County Recorder in and for said County, hereby certify that I have compared the foregoing copy with the original Location Notice of the Saturday Mining ~~XXXX~~ Claim, filed and recorded in my office on the 2nd day of Feb. 1904, in Book 30 at page 137, Record of Mines, and that the same is a full, true and correct copy of such original and of the whole thereof.

Witness my hand and seal of office this 23rd day of May, 1905.

  
 County Recorder.

AMENDED

# Notice of Mining Location

20

LODE CLAIM

To All Whom it May Concern:

This Mining Claim, the name of which is the Keno Extension Mining Claim, situate on lands belonging to the United States of America, and in which there are valuable mineral deposits, was entered upon and located for the purposes of exploration and purchase by M. J. Cunningham & J. A. Merritt

citizens of the U.S.  
(Locator must insert either "a citizen of the United States," or, "who has declared his intention to become a citizen of the United States.")

the undersigned, on the 19<sup>th</sup> day of May 1905

The length of this claim is 1500 feet,  
and we claim 1450 feet,  
in a northwesterly direction and 50  
feet in a S. easterly direction from  
the center of the discovery shaft, at which this notice is posted, lengthwise of the claim, together  
with 15 feet in width of the surface grounds, on each

side of the center of said claim. The general course of the lode deposit and premises is from the  
N. West to the S. East

The claim is situated and located in the Warren Mining District, in  
Cochise County, in the Territory of Arizona, about 2800 ft.  
in a northeasterly direction from U.S. M. M. 1872 and is  
bounded N.W. by Sherwood, N.E. by No. 10, No. 9,  
No. 8, S.E. by Keno Sur. 1872 S.W. by Baker  
Sur. 1872.

The surface boundaries of the claim are marked upon the ground as follows: Beginning at  
a monument

at a point in a S. easterly direction 50 feet from  
the discovery shaft (at which this notice is posted), being in the center of the S. east  
end line of said claim; thence N. Ely 15 feet to a monument  
of stones, being the N.E. corner of said claim; thence  
northwesterly 1500 feet to a mound of stones, being at the  
N.W. corner of said claim; thence S.W. by 15 feet  
to a mound of stones at the center of the N. West end of said claim;  
thence S.W. by 15 feet to a mound of stone, being at the  
S.W. corner of said claim; thence southeasterly 1500  
feet to a mound of stone at the S. E. corner of said claim;  
thence N. easterly 15 feet to the place of beginning.

All done under the provisions of Chapter Six, of Title XXXII, of the Revised Statutes of the United States, and of an Act of the General Assembly of Arizona, entitled "An Act to Revise and Codify the Laws of the Territory of Arizona," approved March 16, 1901.

This is an Amended Location Notice of the Keno Extension Mining Claim, located by Geo. C. Clark & M. J. Cunningham  
on the 18<sup>th</sup> day of August 1903, and recorded in Book 33 of Record of Mines, at page 510, in the office of the County Recorder of the aforesaid County of Cochise to which reference is hereby made, and this amended Location Notice is made and posted to correct errors in the description in the said original Location Notice.

Dated and posted on the ground this 19 day of May 1905  
M. J. Cunningham  
J. A. Merritt

Filed and recorded at request of E. W. Armstrong May 23, 1905 at 9 a.m. Book 34 Record of Mines page 136

TERRITORY OF ARIZONA,  
 County of..... } ss

I,....., County Recorder in and for the County and Territory aforesaid, do hereby certify that the within instrument was filed for record at..... o'clock,..... M., on this..... day of..... 190..., and duly recorded in Book No..... of..... Records of..... County, Arizona, at pages.....

WITNESS my hand and official seal the day and year first above written.

.....  
 County Recorder.

AMENDED  
**Notice of Location.**  
 LODE CLAIM.

.....  
 .....

Dated..... 190.....

Filed and recorded at the request of

.....  
 .....

at..... M.

Book.....

Page.....

County Recorder.

By.....

Deputy Recorder.

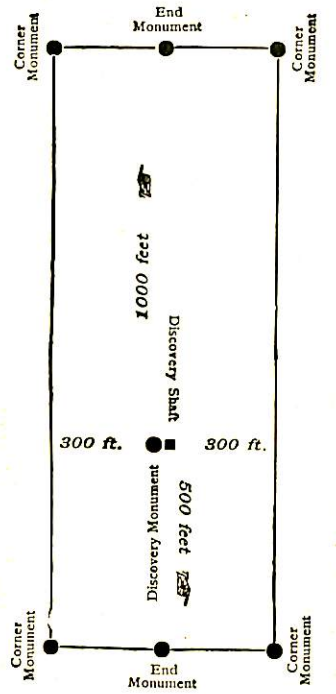

This diagram is to give locator a general idea of plan of location under the new law. The Discovery Shaft can be in the center of claim or any distance from either end desired. In the diagram it is placed 500 feet from one end and 1000 feet from the other. Commence description of claim at a center end monument, giving its distance and direction from center of Discovery Shaft; thence bound the claim in either direction. In description be careful to state locality of claim with reference to some natural object, or permanent monument, as will identify the claim.

Territory of Arizona, (  
 County of Cochise. (ss.  
 )

I, Frank Hare, County Recorder in and for said County, hereby certify that I have compared the foregoing copy with the Amended Location Notice of the Steno Extension Mining Claim, filed and recorded in my office on the 23 day of May 1905, in Book 34, at page 136, Record of Mines, and that the same is a full, true and correct copy of such original and of the whole thereof.

Witness my hand and seal of office this 23rd day of May, 1905.

*Frank Hare*  
 County Recorder



4-688.

## U. S. SURVEYOR-GENERAL'S FINAL CERTIFICATE ON FIELD NOTES.

## Department of the Interior,

OFFICE OF U. S. SURVEYOR-GENERAL,

Phoenix, Arizona.

July 21", 1905

I, U. S. Surveyor-General for the district of Arizona.

do hereby certify that the foregoing transcript of the Field Notes, return and approval of the survey of the mining claim of Hoval A. Smith,

known as the Saturday, Sherwood, Keno Extension.

situate in Warren

Mining District, Cochise County, ARIZONA.

in Section approx., Township No. 23 S., Range No. 34 E. unsurveyed, and

designated as Survey No. 2087, has been correctly copied from the originals on file in

this office; that said Field Notes furnish such an accurate description of said mining claim as will, if incorporated into a patent, serve fully to identify the premises, and that such reference is made therein to natural objects or permanent monuments as will perpetuate and fix the locus thereof.

And I further certify that <sup>less than</sup> five hundred dollars' worth of labor has been expended or improvements made upon said mining claim by claimant or <sup>or for each of</sup> his grantors, and that said improvements consist of, <sup>at time of survey,</sup> 6 shafts total value \$650.00

and that no portion of said labor or improvements has been included in the estimate of expenditures upon any other claim.

I further certify that the plat thereof, filed in the U. S. Land Office at Tucson, Arizona.

is correct and in conformity with the foregoing Field Notes.

(Signed) Frank S. Ingalls,

United States Surveyor-General for Arizona.

4-687.

**SURVEYOR-GENERAL'S CERTIFICATE OF APPROVAL OF FIELD  
NOTES AND SURVEY OF MINING CLAIM.**

**Department of the Interior,**

*Office of U. S. Surveyor-General,*

Phoenix, Arizona.

*July 21*, 1905

I, U. S. Surveyor-General for the district of Arizona.

do hereby certify that the foregoing and hereto attached Field Notes and Return of the Survey of the Mining Claim of HOVAL A. Smith,

....., known as the Saturday, Sherwood, and Keno Extension.

situate in Warren Mining District,  
Cochise County, Arizona.

in Section approx., Township No. 23 S., Range No. 24 E. unsurveyed  
....., designated as Survey No. 2087

executed by Franklin W. Smith., U. S. Deputy Mineral  
Surveyor, June 3rd to 4th 1905., 190...., under my instructions dated

May 31st 1905., 190...., have been critically examined and the necessary corrections and explanations made, and the said Field Notes and Return, and the Survey they describe, are hereby approved. A true copy of the copy of the location certificate filed by the applicant.. for survey is included in the field notes.

*Frank A. Sargent*

U. S. Surveyor-General for Arizona.

Large  
map