

**M  
S  
-**

**0**

**2**

**1**

**1**

**1**

Recd. July 19, 1905

copied by amt  
7/22/05-

(4-683.)

Mineral Survey No. 2111

Lot No. \_\_\_\_\_

Delaware Land District.

### FIELD NOTES

OF THE SURVEY OF THE MINING CLAIM OF

Noval A. Smith

KNOWN AS THE

Don Francisco, Don Carlos San Juan,  
Franklin Warren Mining District.

Cochise County, Arizona

Section Approx., Township 23 S, Range 24 E

Surveyed under instructions dated July 3rd, 1905

by Franklin W. Smith

U. S. Deputy Mineral Surveyor

Claim located	<u>See notices</u>	1
Survey commenced	<u>July 5th</u>	19 <u>05</u>
Survey completed	<u>July 11th</u>	19 <u>05</u>

o 6-103

Postoffice address of claimant:-  
Bisbee, Cochise County Arizona

Files ✓  
Ledges ✓  
Dike ✓  
Areas ✓

San Juan.

Feet

Beginning <sup>at</sup> ~~to~~ Cor. No. 1 the SW cor identical with location a pine post 4 ft long 4 ins sq set 1 ft in the ground in a mound of stones and scribed 1-2111 S J L, whence a pine post of same dimensions and scribed B.P. 1-2111 brs N. 85° 58' E. 50 ft and a second pine post of same dimensions and scribing brs. N. 3° 28' W. 50 ft, no bearing monuments available, and NW cor Sec 2 Tp 24 S R 24 E G & S R B & M brs. S. 35° 01' 30" W. 5625.7 ft.

Thence N. 3° 28' E.

- 259.4 to Cor. No. 1 Franklin lode of this survey, situate on line 2-3 Don Carlos lode, of this survey at N. 56° 50' W. 429.1 ft from Cor. No. 3, from which point Cor. No. 4 Franklin lode of this survey brs. N. 30° 54' E. 506.3 ft
- 889.8 same bearing to the intersection of line 3-4 Franklin lode of this survey at N. 56° 50' W. & 356.1 ft <sup>from Cor No 4</sup>, and the intersection of line 4-5 Bolivar lode, Survey No. 1918 at S. 44° 15' 11.4 ft from Cor. No. 4,
- 1430.1 same bearing to Cor. No. 2, the NW cor identical with location a pine post 4 ft long 4 ins sq set 1 ft in the ground in a mound of stones and scribed 2-2111 S J L, whence a pine post of same dimensions and scribed B.P. 2-2111 brs. S 3° 28' E. 50 ft and a second pine post of same dimensions and scribing brs. N. 85° 58' E. 50 ft., no bearing monuments available,
- 300.0 to original location for N E Centre
- 600.0 same bearing to Cor. No. 3, the NE cor identical with location, and with Cor. No. 4, Bolivar lode, Survey No. 1918 a pine post 4 ft long 4 in s sq set 1 ft in the ground in a mound of stones and scribed 3-2111 S K L, whence a pine post of same dimensions and scribed B.P. 3-2111 brs S. 85° 58' W. 50 ft., and a second pine post of same dimensions and scribing brs. S. 3° 24' E. 50 ft., no bearing monuments available,

Thence S. 3° 24' E.

Feet

- 529.6 along the W end ~~line~~<sup>a</sup> of The<sup>a</sup>odore lode unsurveyed, to the SW and NW ~~corners~~<sup>a</sup> respectively of The<sup>a</sup>odore and Great Southern lodes ~~unsurveyed~~,
- 1129.6 same bearing to the SW and cor No 3 respectively of Great Southern ~~unsurveyed~~, and Nellie lode, Survey No. 2115,
- 1430.2 same bearing to ~~Cor.~~<sup>a</sup>No.4,, the SE cor identical with location and at the point of intersection of line 3-4 New Era lode, ~~Survey~~<sup>a</sup> No.2115, with line 2-3 Nellie lode of the same survey. a pine post 4 ft long 4 ins sq set 1 ft in the ground ~~in~~<sup>a</sup> a mound of stones and scribed 4-2111 S J L, whence a pine post of same dimensions and scribed B P 4-2111 brs N. <sup>34'</sup> 3° 88' W. 50 ft., and a second pine post of same dimensions and scribing brs. S. 85° 58' W. 50 ft., ~~no~~<sup>a</sup> bearing monuments available,

thence S. 85° 58' W.

- 254.0 along line 4-3 New Era lode, Survey No.2115 to Cors.No. 3 of New Era lode ~~Survey~~<sup>a</sup> No.2115, and Don Carlos lode of this survey
- 300.0 same bearing to ~~original~~<sup>a</sup> location for S E C.,
- 598.3 same bearing to ~~Cor.~~<sup>a</sup>No.1 the place of beginning.

Here.

The presumed course of the vein on this claim is from the N E C location S. 3° 24' E. 1430.2 ft.

#### FRANKLIN

Beginning at Cor.No.1, the SE cor identical with location and at the point of intersection of line 2-3 Don Carlos lode, ~~of~~<sup>a</sup> this Survey, with line 1-2 San Juan lode of this survey, a pine post 4 ft long 4 ins sq set 1 ft in the ground ~~in~~<sup>a</sup> a mound of stones and scribed 1-2111 F L, whence a pine post of same dimensions and scribed B. P.1-2111 brs. N. 30° 54' E. 50 ft., and a second pine post of same dimensions and scribing brs. N. 56° 50' W. 50 ft., ~~no~~<sup>a</sup> bearing monuments available

Feet

and the NW cor Sec 2 Tp 24 S R 24E G & S R B & M brs  
S. 33° 26' 30" W. 5831.0 ft.,

Thence N. 56° 50' W.

- 474.9 to the intersection of line 4-5 Bolivar lode, Survey No. 1918 at N. 44° 13' E. 173.2 ft from Cor.No.5,
- 629.9 same bearing to the intersection of line 5-6 Bolivar lode Survey No.1918 at N. 22° 26' W. 208.9 ft from Cor.No 5,
- 828.3 same bearing to CorsNo.2 and 4<sup>5</sup> respectively of Don Carlos and Don Francisco lodes of this survey
- 897.9 same bearing to Cor.No.2, the SW cor identical with location, *and with cor No 4 Don Francisco Lode of this survey* and ~~at the point of intersection of line 3-4 Don Francisco lode of this survey with line 2-3 Wonder lode Survey No.1976~~, a pinepost 4 ft long 4 ins sq set 1 ft in the ground in a mound of stones and scribed 2-2111 F L whence a pine post of same dimensions and scribed B. P. 4-2-2111 brs. N. 30° 54' E. 50 ft., and a second pine post of same dimensions and scribing brs. S. 56° 50' E. 50 ft., no bearing monuments available,
- Thence N. 50° 54' E.
- 300.0 along line 3-2 Wonder lode, Survey No.1976 to original location for ~~N~~ E C.,
- 396.5 same bearing to Cor.No.6 Bolivar lode, Survey No.1918 at N. 2° 26' W. 696. ft. from Cor. No.5
- 506.3 same bearing to Cor.No.3 the NW cor identical with location and situated on line 6-1 Bolivar lode, Survey No 1918 a pine post 4 ft long 4 ins sq set 1 ft in the ground in a mound of stones and scribed 3-2111 F L whence a pine post of same dimensions and scribed B.P. <sup>3-2111</sup> ~~3-2111~~ brs S. 30° 54' W. 50 ft and a second pine post of same dimensions and scribing brs S. S 56° 50' E. 50 ft., no bearing monuments available,
- Thence S. 56° 50' E.
- 541.8 to the intersection of line 1-2 San Juan lode of this survey with line 4-5 Bolivar lode, Survey No.1918 at N. 44° 13' E. 688.6 ft from Cor.No.5 Bolivar lode,

897.9 same bearing to Cor.No.4 the NE cor identical with location a pine post 4 ft long 4 ins sq set 1 ft in the ground in a mound of stones and scribed <sup>4</sup> 4-2111 F L, whence a pine post of same dimensions and scribed B.P. 4-2111 brs. S. 30° 54' W. 50 ft., and a second pine post of same dimensions and scribing brs. N 56° 50' W. 50 ft., no bearing monuments available,

Thence S. 30° 54' W.

206.3 to original location for W E C.,

506.3 same bearing to Cor.No.1 the place of beginning.

Ledge.

The presumed course of the vein on this claim is from the W E E location S. 56° 50' E. 897.9 ft.,

-----  
DON CARLOS.

Beginning at Cor.No.1, the S W cor., identical with location, with Cors.No.1, 4 and 2 respectively of Don Francisco lode of this survey, Saint Ansgar and Haynes lodes, Survey No.2112, a pine post 4 ft long 4 ins sq set 1 ft in the ground in a mound of stones and scribed 1-2111 D C L, whence a pine post of same dimensions and scribed B. P. 1-2111 brs. N. 55° 55' W. 50 ft and a second pine post of same dimensions and scribing brs. S. 55° 55' E. 50 ft., no bearing monuments available, and NW cor Sec 2 Tp 24 S R 24 E G & S R B & M brs. S. 27° 34' W. 5276.9 ft.,

Thence N. 6° 56' E.

~~334.2~~  
~~511.5~~ to original location for W E C.,

645.7 same bearing to Cor.No.2, the NW cor identical with location and with Cor.No.4 Don Francisco lode of this survey. a pine post 4 ft long 4 ins sq set 1 ft in the ground in a mound of stones and scribed 2-2111 D C L whence a pine post of same dimensions and scribed B. P. 2-<sup>5</sup>2111 brs N. 56° 56' W. 50 ft and a second pine post of same dimensions and scribing brs. S. 56° 56' E. 50 ft., no bearing

Survey No. 2111  
Don Carlos

Feet

- monuments available,  
Thence S. 56° 50' E.
- 198.4 to the intersection of line 5-6 Bolivar lode, Survey No. 1918  
at N. 2° <sup>26'</sup>~~28'~~ W. 208.9 ft from Cor. No. 5,
- 353.4 same bearing to the intersection of line 4-5 Bolivar lode,  
Survey No. 1918 at N. 44° <sup>13'</sup>~~15'~~ E. 173.2 ft from Cor. No. 5,
- 828.3 same bearing to Cor. No. 1 Franklin lode of this survey,  
from which point Cor. No. 1 San Juan lode of this survey bears  
S. 3° 28' E 259.4 ft.,
- 1257.4 same bearing to Cor. No. 3 the NE cor identical with location  
with Cor. No. 3 New Era lode, Survey No. 2115, and situated  
on line 1-4 San Juan lode of this survey at N. 85° 58' E  
344.3 ft from Cor. No. 1, a pine post 4 ft long 4 ins sq  
1 ft in the ground in a mound of stones and scribed 3-2111  
D C L, whence a pine post of same dimensions and scribed  
B P. 3-2111 bears N. 56° 50' W. 50 ft.,  
and a second pine post of same dimensions and scribing  
bears S. 6° 50' W. 50 ft., no bearing monuments available  
Thence S. 6° 56' W.
- 334.2 along line 3-2 New Era lode Survey No. 2115 to original lo-  
cation for E E C'
- 668.4 same bearing to Cor. No. 4 the SE cor identical with lo-  
cation and with Cor. No. 3 Haynes lode, Survey No. 2112,  
a pine post 4 ft long 4 ins sq s<sup>t</sup> 1 ft in the ground in  
a mound of stones and scribed 4-2111 D C L, whence a pine  
post of same dimensions and scribed B P 4-2111 bears N.  
6° 56' E. 50 ft., and a second pine post of same dimen-  
sions and scribing bears N. 55° 55' W. 50 ft no bearing  
monuments available,  
Thence N 55° 55' W.
- 1267.6 to Cor. No. 1 the place of beginning.

Ledge.

The presumed course of the vein on this claim  
is from the E E C location N 55° 55' W. 1267.6 ft.

Don Francisco, Survey No. 2111

Beginning at Cor.No.1 the SW cor identical with location with Cor.No.1 Don Carlos lode of this survey and with Cors.No.2 and 4 respectively of Haynes and Saint Ansgar lodes, Survey No.2112, a pine post 4 ft long 4 ins sq set 1 ft in the ground in a mound of stones and scribed 1-2111 D F L, whence NW cor Sec 2 Tp 24 S R 24 E G & S R B & M brs. S. 27° 34' W. 5276.9 ft.,

Thence N. 55° 55' W.

1500.0 to Cor.No.2, the SW cor identical with location, and with Cor.No.3 Saint Ansgar lode, Survey No.2112, a pine post 4 ft long 4 ins sq set 1 ft in the ground in a mound of stones and scribed 2-2111 D F L whence a pine post of same dimensions and scribed B. P. 2-2111 br S. 55° 55' E. 50 ft and a second pine post of same dimensions and scribing brs. N. 6° 56' E. 50 ft., no bearing monuments available,

Thence N. 6° 56' E.

269.0 to the intersection of line 3-4 Hot Stuff lode, Survey No. 1918 at N. 50° 28' W. 682.8 ft., from Cor.No.2, from which point Cor.No.3 ~~Wonder Lode, Survey No. 2120 brs N. 50°~~

*Wonder Lode, Sur. No. 1976, brs S. 37° 6' E. 600 ft.*

~~22° W. 815.9 ft.~~

*same bearing*

~~Thence N 6° 56' E.~~

311.5 to original location for W E C.,

616.1 same bearing to Cor.No.3 the NW cor identical with location a pine <sup>post</sup> 4 ft long 4 ins sq set 1 ft in the ground in a mound of stones and scribed 3-2111 D F L whence a pine post of same dimensions and scribed B. P. 3-2111, brs. S. 6° 56' W. 50 ft., and a second pine post of same dimensions and scribing brs. S. 56° 56' E. 50 ft., no bearing monuments available,

Thence S. 56° 56' E.

816.5 to the intersection of line 2-3 Hot Stuff lode, Survey No.1918 at N. 30° 54' E. 390 ft from Cor.No.3, and the intersection of line 1-4 Wonder lode, Survey No.1976 at N 30° 54' E. 390 ft from Cor.No.4,

1416.0 same bearing to Cor.No.4, identical with Cor.No.2 Franklin lode of this survey and situate on line 3-2 Wonder lode,



69.6 Survey No. 1976, at N. 30° 54' E. 366.9 ft from Cor.No.3  
 a pinepost etc and scribed, 4-2111 D F L,  
 Thence S. 56° 50' W.  
 to Cor.No.5, the NE cor identic l with Cor.No.2 Don Carlos  
 lode of this survey a pine post etc and scribed 5-2111 D F L  
 and original location for N E cor brs. N. 6° 56' E. 5 ft  
 Thence S. 6° 56' W.  
 to original location for E E C.,  
 645.7 same bearing to Cor.No.1 the place of beginning.

324.2  
~~342.2~~  
 645.7

Ledge.

The presumed course of the vein on this claim is  
 from the EEC location N. 55° 55' W. 1500 ft.

-----  
 A R E A S.

Total area Don Francisco,	✓ 19.330 ✓
Less area in conflict with Hot Stuff lode Survey No.1918	✓ 5.942 ✓
Less area in conflict with Wonder lode Survey No.1976	✓ 5.212 ✓ 11.154 ✓
Net area	8.176 ac.
Total area Don Carlos lode	✓ <sup>17</sup> 17.013 ✓
Less area in conflict with Bolivar lode Survey No.1918,	✓ .302 ✓
Net area Don Carlos	16.711
Total area Franklin	✓ 10.428 ✓
Less area in conflict with Bolivar lode, Survey No. 1918	✓ 4.383 ✓
Less area in conflict with San Juan lode of this survey	✓ 2.068 ✓ 6.451 ✓
Net area Franklin	✓ 3.977 ✓
Total area San Juan	✓ 19.670
Less area in conflict with Don Carlos lode of this survey	✓ 1.025
Less area in conflict with Bolivar lode, Survey No.1918	✓ 3.721 ✓ 4.746 ✓
Net area San Juan	✓ 14.924
Net area group	43.788 ac. ✓

Note The conflict existing between the areas of the Don  
 Carlos and San Juan lodes, is surrendered to the Don  
 Carlos lode, and the conflict between the Franklin and  
 San Juan lodes is surrendered to the San Juan lode.

(7)

Survey No. 2111  
Don Carlos ( et al )

Improvements.

I certify that the value of the labor and improvements on these claims, placed thereon by the claimant or his grantors is as follows:

DON CARLOS, Discovery shaft 4x6x10 ft bns from M E C N. 55° 55' W. 530 ft., Value	\$100.00
San Juan, Discovery shaft 4x6x10 ft bns from S E C lo- cation N. 3° 24' W. 410 ft., Value	100.00
FRANKLIN, Discovery shaft 4x6x10 ft bns from M E C S. 56° 50' <sup>E 511.9</sup> <del>N. 750</del> ft., Value	100.00
DON FRANCISCO, Discovery shaft 4x6x10 ft bns from E E C N. 55° 55' W. 170 ft., Value	<u>100.00</u>
Total improvements on group	\$400.00

Note I hereby certify that complete affidavits of \$500 improvements on each claim hereof will be filed before the expiration of publication.

ADJOINING CLAIMS.

North Hot Stuff lode, Survey No. 1918, I.W.Wallace et al owners;  
Wonder lode, Survey No. 1976, Edward O'Connell et al owners;  
Bolivar lode, Survey No. 1918, I W Wallace, et al owners;

East Theodore and Great Southern lodes, unsurveyed, Portage  
Lake & Bisbe Mining Cos owner; Nellie and New Era lodes  
Survey No. 2115, owned by applicant herein.

South. Haynes and Saint Ansgar lodes, Survey No. 2112 same owner

West California lode unsurveyed, G.B.Wills et al owners;

LOCATION.

This survey is located about 2 mi in an E direction from Don Luis station on the E. P & S W R R on unsurveyed lands in the Warren Mining District, Cochise County, Territory of Arizona, approximately in Tp 23 S R 24 E G & S R B & M.

## INSTRUMENT

This survey was made with a C. L. Berger & Sons No. 1  
C transit, the courses were deflected from the true me-  
ridian as determined by solar observation checked by an  
observation on polaris; the courses were measured with  
a 200 ft steel tape; magnetic variation  $12^{\circ} 30'$  E.

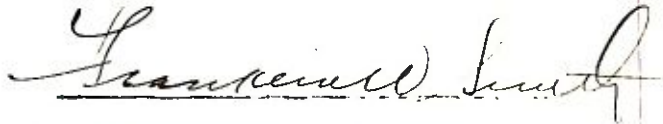

U. S. Deputy Mineral Surveyor.

Dated at Bisbee Arizona

July 14, 1905.

Note.

Any discrepancies between the courses and distances  
of this survey and those of the adjoining <sup>and conflicting</sup> approved surveys  
are due to errors in the latter.

The claims embraced in this survey are related to  
the  $\frac{1}{4}$  Cor which should exist on the N line of Sec 2 Tp  
24 S R 24 E. After diligent search I have been unable to  
locate this cor and have consequently tied this survey  
to the nearest Sec cor namely NW cor sec 2 Tp 24 S R 24  
E. G & S R B & M.

# FINAL OATHS FOR SURVEYS.

## LIST OF NAMES.

A list of the names of the individuals employed by Franklin W. Smith

United States Deputy Mineral Surveyor, to assist in running, measuring, and marking the lines, corners, and boundaries described in the foregoing field notes of the survey of the mining claim of \_\_\_\_\_

Hovae A Smith  
known as the Don Carlos Don Francisco San Juan Franklin

and showing the respective capacities in which they acted

R. A. Zuesmer ..... Chainman.  
D. E. Curry ..... Chainman.  
..... Arman.  
..... Flagman.

## FINAL OATHS OF ASSISTANTS.

We, R. A. Zuesmer

and D. E. Curry ..... do solemnly swear that we assisted Franklin W. Smith

United States Deputy Mineral Surveyor, in marking the corners and surveying the boundaries of the mining claim of Hovae A Smith

known as the Don Carlos Don Francisco San Juan Franklin

represented in the foregoing field notes as having been surveyed by said deputy mineral surveyor and under his direction; and that said survey has been in all respects, to the best of our knowledge and belief, faithfully and correctly executed, and the corner and boundary monuments established according to law and the instructions furnished by the United States Surveyor-General for Arizona

R. A. Zuesmer ..... Chainman.  
D. E. Curry ..... Chainman.  
..... Arman.  
..... Flagman.

Subscribed and sworn to by the above-named persons before me this 14<sup>th</sup>

day of July, 1905.

Coro E. Lind  
NOTARY PUBLIC  
in and for the County of Cochise, Territory of Arizona  
My Commission Expires March 21, 1907

(4-686.)

FINAL OATH OF U. S. DEPUTY MINERAL SURVEYOR

I, Franklin W. Smith, U. S. Deputy Mineral Surveyor, do solemnly swear that, in pursuance of instructions received from the United States Surveyor General for Arizona, dated July 3<sup>rd</sup>, 1905, I have, in strict conformity to the laws of the United States, the official regulations and instructions thereunder, and the instructions of said Surveyor General, faithfully and correctly executed the survey of the Mining Claim of Donac A Smith, known as the San Francisco, Don Carlos San Juan, Franklin situate in Warren Mining District, Cochise County, Arizona, in Section approx, Township No. 23 S, Range No. 24 E 5th S 3rd E and designated as Survey No. 2111, as represented in the foregoing field notes, which accurately show the boundaries of said mining claim as distinctly marked by monuments on the ground, and described in the attached copy of the location certificate, which was received by me from the Surveyor General with said instructions, and that all the corners of said survey have been established and perpetuated in strict accordance with the law, official regulations and instructions thereunder; and I do further solemnly swear that the foregoing are the true and original field notes of said survey and my report therein, and that the labor expended and improvements made upon said mining claim by claimant or his grantors are as therein fully stated, and that the character, extent, location and itemized value thereof are specified therein with particularity and full detail, and that no portion of said labor or improvements so credited to this claim has been included in the estimate of expenditures upon any other claim.

Franklin W. Smith  
U. S. Deputy Mineral Surveyor.

Subscribed and sworn to by the said Franklin W. Smith  
U. S. Deputy Mineral Surveyor, before me Coro E. Smith  
this 14<sup>th</sup>  
day of July, 1905.  
Coro E. Smith

o 3-154

NOTARY PUBLIC  
in and for the County of Cochise, Territory of Arizona,  
My Commission Expires March 21, 1908.

# Notice of Mining Location

13

## LODE CLAIM

To All Whom It May Concern:

This Mining Claim, the name of which is the Dora Carlos Mining Claim, situate on lands belonging to the United States of America, and in which there are valuable mineral deposits, was entered upon and located for the purposes of exploration and purchase by H. A. Smith, F. W. Putnam

(Locator must insert either "a citizen of the United States," or, "who has declared his intention to become a citizen of the United States.")

the undersigned, on the 28th day of January 1903

The length of this claim is 1500 feet,

and 750 claim 750 feet,

in a easterly direction and 750

750 feet in a westerly direction from

the center of the discovery shaft, at which this notice is posted, lengthwise of the claim, together with 300 feet in width of the surface grounds, on each

side of the center of said claim. The general course of the lode deposit and premises is from the

east to the west

The claim is situated and located in the Warren Mining District, in

Cochise County, in the Territory of Arizona, about 4 1/2 miles

in a South easterly direction from the town of Bisbee

joins the Holmes Blaine on the north side, also  
joins the San Francisco mine on the easterly end.

The surface boundaries of the claim are marked upon the ground as follows: Beginning at

a monument of stone

at a point in a easterly direction 750 feet from

the discovery shaft (at which this notice is posted), being in the center of the easterly

end line of said claim; thence 300 feet to a monument

or stake, being the N. E. corner of said claim; thence

1500 feet to a stake, being at the

N. W. corner of said claim; thence 300 feet

to a stake at the center of the westerly end of said claim;

thence 300 feet to a stake, being at the

S. W. corner of said claim; thence 1500

feet to a stake at the S. E. corner of said claim;

thence 300 feet to the place of beginning.

All done under the provisions of Chapter Six, of Title XXXII, of the Revised Statutes of the United States, and of an Act of the General Assembly of Arizona, entitled "An Act to Revise and Codify the Laws of the Territory of Arizona," approved March 16, 1901.

Dated and posted on the ground this 28 day of January 1903

Witness  
J. A. Shewood

H. A. Smith

F. W. Putnam

Filed and recorded at request of H. A. Smith, April 22, 1903 at 9 a. m.  
Book 24 page 181, Record of Mines



Territory of Arizona, {  
County of Cochise. {ss.

I, Frank Hare, County Recorder in and for said County, hereby certify that I have compared the foregoing copy with the original Location Notice of the Don Carlos Mining Claim, filed and recorded in my office on the 22 day of April 1903, in Book 24, at page 181, Record of Mines, and that the same is a full, true and correct copy of such original and of the whole thereof.

Witness my hand and seal of office this 9th day of June, 1905.

*Frank Hare*  
County Recorder.



# Notice of Mining Location

## LODE CLAIM

To All Whom It May Concern:

This Mining Claim, the name of which is the Son Francisco Mining Claim, situate on lands belonging to the United States of America, and in which there are valuable mineral deposits, was entered upon and located for the purposes of exploration and purchase by H. A. Smith, F. D. W. Putnam and G. H. Rea

Citizens of the U. S.  
(Locator must insert either "a citizen of the United States," or, "who has declared his intention to become a citizen of the United States.")

the undersigned, on the 28 day of January 1903.

The length of this claim is 1500 feet,

and we claim 100 feet,

in a westerly direction and 1400

feet in a easterly direction from

the monument ~~center of the discovery shaft~~, at which this notice is posted, lengthwise of the claim, together

with 270 feet in width of the surface grounds, ~~on each~~

~~side of the center of said claim.~~ The general course of the lode deposit and premises is from the

east to the west

The claim is situated and located in the Warren Mining District, in

Cochise County, in the Territory of Arizona, about four miles

in a south easterly direction from the city of Bisbee

and about two miles east of Son Lewis Station.

This claim is located as a fraction, 1500 feet

long by 270 feet wide.

The surface boundaries of the claim are marked upon the ground as follows: Beginning at

Bounded on the North by the Hot Stuff and Wonder

Mining claims, on the east by the

at a point in a Son Carlos direction Mining claim feet from

the discovery shaft (at which this notice is posted), being in the center of the on the

end line of said claim; thence south by the feet to a St Anzor

Mining claim, being the and on the corner of said claim; thence

west by the California feet to a M. claim, being at the

corner of said claim; thence feet

to a at the center of the end of said claim;

thence feet to a being at the

corner of said claim; thence

feet to a at the corner of said claim;

thence feet to the place of beginning.

All done under the provisions of Chapter Six, of Title XXXII, of the Revised Statutes of the United States, and of an Act of the General Assembly of Arizona, entitled "An Act to Revise and Codify the Laws of the Territory of Arizona," approved March 16, 1901.

Dated and posted on the ground this 28 day of January 1903,

H. A. Smith

F. D. W. Putnam

G. H. Rea

No. 110.—NOTICE OF LOCATION OF LODE CLAIM.—The H. H. McNeil Company's Red Line Blanks, Phoenix, Arizona.  
Filed and recorded at request of G. H. Rea, April 16, 1903 at 9 A. M.  
in Book 241 Record of Mines at page 82.

TERRITORY OF ARIZONA,  
County of..... } ss.

I,....., County Recorder in and for the County and Territory aforesaid, do hereby certify that the within instrument was filed for record at..... o'clock,..... M., on this..... day of..... 190... and duly recorded in Book No..... of..... Records of..... County, Arizona, at pages.....

WITNESS my hand and official seal the day and year first above written.

.....  
County Recorder.

# Notice of Location

## LODE CLAIM

Dated..... 190.....

Filed and Recorded at request of.....

A. D. 190.....

at..... M.

Book.....

Pages.....

County Recorder.

By.....

Deputy Recorder.

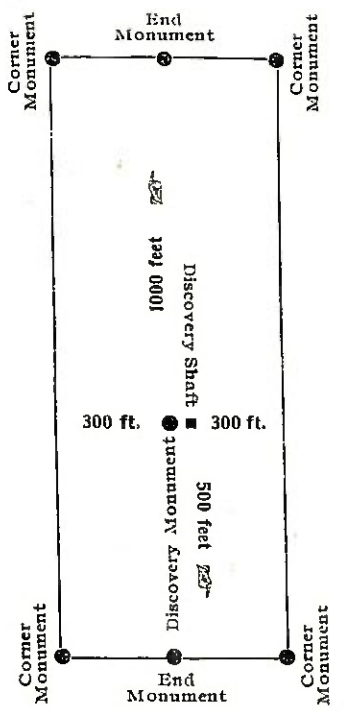

This diagram is to give locator a general idea of plan of location under the new law. The Discovery Shaft can be in the center of claim or any distance from either end desired. In the diagram it is placed 500 feet from one end and 1000 feet from the other. Commence description of claim at a center end monument, giving its distance and direction from center of Discovery Shaft; thence bound the claim in either direction. In description be careful to state locality of claim with reference to some natural object, or permanent monument, as will identify the claim.

Territory of Arizona, {  
 County of Cochise. {ss.

I, Frank Hare, County Recorder in and for said County, hereby certify that I have compared the foregoing copy with the original Location Notice of the San Francisco Mining Claim, filed and recorded in my office on the 16 day of April 1903 in Book 24 at page 82, Record of Mines, and that the same is a full, true and correct copy of such original and of the whole thereof.

Witness my hand and seal of office this 26th day of May, 1905.

*Frank Hare*  
 County Recorder.

# Notice of Mining Location

## LODE CLAIM

To All Whom It May Concern:

This Mining Claim, the name of which is the San Juan Mining Claim, situate on lands belonging to the United States of America, and in which there are valuable mineral deposits, was entered upon and located for the purposes of exploration and purchase by John A. Garris, J. S. Merrill, J. E. De Rhodes and Geo. R. Pemberton citizens of the U. S., (Locator must insert either "a citizen of the United States," or, "who has declared his intention to become a citizen of the United States.")

the undersigned, on the 25 day of April 1902  
 The length of this claim is 1500 feet long by 600 feet wide, and the claim One thousand (1000) feet in a North Easterly direction and Five hundred (500) feet in a South Westerly direction from the center of the discovery shaft, at which this notice is posted, lengthwise of the claim, together with Three hundred feet in width of the surface grounds, on each side of the center of said claim. The general course of the lode deposit and premises is from the North East to the South West

The claim is situated and located in the Warren Mining District, in Cochise County, in the Territory of Arizona, about 4 1/2 miles in a southern direction from The Town of Bisbee

The surface boundaries of the claim are marked upon the ground as follows: Beginning at a 4 x 4 Post and rock monument 300 feet in a North Westerly direction from the N. W. Corner of the Theodore M. Claim at a point in a Northern direction One thousand feet from the discovery shaft (at which this notice is posted), being in the center of the North end line of said claim; thence Three hundred (300) feet to a Monument, being the North West corner of said claim; thence Fifteen hundred (1500) feet to a Monument, being at the South West corner of said claim; thence Three hundred (300) feet to a Monument at the center of the south end of said claim; thence Three hundred (300) feet to a monument, being at the South East corner of said claim; thence Fifteen hundred (1500) feet to a Monument at the North East corner of said claim; thence \_\_\_\_\_ feet to the place of beginning.

All done under the provisions of Chapter Six, of Title XXXII, of the Revised Statutes of the United States, and of an Act of the General Assembly of Arizona, entitled "An Act to Revise and Codify the Laws of the Territory of Arizona," approved March 16, 1901.

Dated and posted on the ground this \_\_\_\_\_ day of \_\_\_\_\_ 1902  
J. A. Garris,  
J. S. Merrill,  
J. E. De Rhodes,  
Geo. R. Pemberton

Filed and recorded, at request of Geo Pemberton July 17th 1902 at 1 P.M. Book 29 Record of Mines, page 435.

TERRITORY OF ARIZONA,  
 County of ..... } ss.

I, ..... County Recorder in and for the County and Territory aforesaid, do hereby certify that the within instrument was filed for record at ..... o'clock, ..... M., on this ..... day of ..... 190..., and duly recorded in Book No. .... of ..... Records of ..... County, Arizona, at pages .....  
 WITNESS my hand and official seal the day and year first above written.

County Recorder.

# Notice of Location

## LODE CLAIM

Dated ..... 190...

Filed and Recorded at request of

A. D. 190...

at ..... M.

Book .....

Pages .....

County Recorder.

By ..... Deputy Recorder.

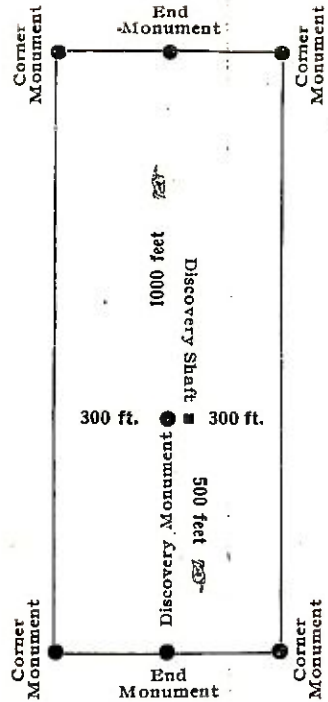

This diagram is to give locator a general idea of plan of location under the new law. The Discovery Shaft can be in the center of claim or any distance from either end desired. In the diagram it is placed 500 feet from one end and 1000 feet from the other. Commence description of claim at a center end monument, giving its distance and direction from center of Discovery Shaft; thence bound the claim in either direction. In description be careful to state locality of claim with reference to some natural object, or permanent monument, as will identify the claim.

Territory of Arizona, {  
 County of Cochise. {ss.

I, Frank Hare, County recorder in and for said County, hereby certify that I have compared the foregoing copy with the original location Notice of the San Juan Mining Claim, filed and recorded in my office on the 17 day of July 1902 in Book 20 at page 435, Record of Mines, and that the same is a full, true and correct copy of such original and of the whole thereof.

Witness my hand and seal of office this 26th day of May, 1905.

*Frank Hare*  
 County recorder.

# Notice of Mining Location

19

## LODE CLAIM

To All Whom It May Concern:

This Mining Claim, the name of which is the Franklin Mining Claim, situate on lands belonging to the United States of America, and in which there are valuable mineral deposits, was entered upon and located for the purposes of exploration and purchase by H. A. Smith

(Locator must insert either "a citizen of the United States," or, "who has declared his intention to become a citizen of the United States.")

the undersigned, on the 1<sup>st</sup> day of January 1905

The length of this claim is 1500 feet, and 600 claim 600 feet,

in a westerly direction and 900

feet in a easterly direction from

the center of the discovery shaft, at which this notice is posted, lengthwise of the claim, together with 300 feet in width of the surface grounds, on each

side of the center of said claim. The general course of the lode deposit and premises is from the

East to the West

The claim is situated and located in the Marrem Mining District, in

Cochise County, in the Territory of Arizona, about 4 miles

in a S. E. direction from the town of Bisbee

and about 2 miles from Orsburn in a northerly direction.

The surface boundaries of the claim are marked upon the ground as follows: Beginning at

monument

at a point in a westerly direction 600 feet from

the discovery shaft (at which this notice is posted), being in the center of the westerly end line of said claim; thence 300 feet to a monument

, being the N. W. corner of said claim; thence

1500 feet to a monument, being at the

N. E. corner of said claim; thence 300 feet

to a monument at the center of the Easterly end of said claim;

thence 300 feet to a monument, being at the

S. E. corner of said claim; thence 1500

feet to a monument at the S. W. corner of said claim;

thence 300 feet to the place of beginning.

All done under the provisions of Chapter Six, of Title XXXII, of the Revised Statutes of the United States, and of an Act of the General Assembly of Arizona, entitled "An Act to Revise and Codify the Laws of the Territory of Arizona," approved March 16, 1901.

Dated and posted on the ground this 1<sup>st</sup> day of January 1905

Witness: J. T. Toland  
J. A. Sherwood

Locator: H. A. Smith

Filed and recorded at request of J. A. Sherwood  
Jan'y, 13<sup>th</sup> 1905 at 9 A. M. Book 35 Record of Mines page 332.

TERRITORY OF ARIZONA,  
 County of..... } ss.

I,..... County Recorder in and for the County and  
 Territory aforesaid, do hereby certify that the within instrument was filed for record at..... o'clock,..... M.,  
 on this..... day of..... 190..., and duly recorded in Book No.....  
 of..... Records of..... County, Arizona, at pages.....  
 WITNESS my hand and official seal the day and year first above written.

.....  
 County Recorder.

# Notice of Location

## LODE CLAIM

.....  
 .....

Dated..... 190.....

Filed and Recorded at request of.....

..... A. D. 190.....

at..... M.

Book.....

Pages.....

County Recorder.

By.....

Deputy Recorder.

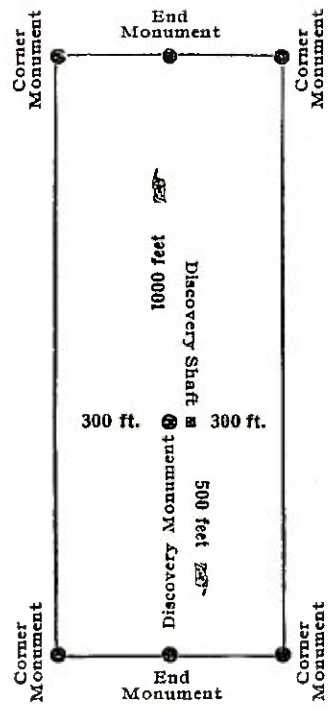

This diagram is to give locator a general idea of plan of location under the new law. The Discovery Shaft can be in the center of claim or any distance from either end desired. In the diagram it is placed 500 feet from one end and 1000 feet from the other. Commence description of claim at a center end monument, giving its distance and direction from center of Discovery Shaft; thence bound the claim in either direction. In description be careful to state locality of claim with reference to some natural object, or permanent monument, as will identify the claim.



Territory of Arizona, ( )  
(ss.

County of Cochise. ( )

I, Frank Hare, County Recorder in and for said County, hereby certify that I have compared the foregoing copy with the original Location Notice of the Franklin Mining Claim, filed and recorded in my office on the 13th day of January, 1905, in Book 32, at page 332, Record of Mines, and that the same is a full, true and correct copy of such original and of the whole thereof.

Witness my hand and seal of office this 30th day of June, 1905.

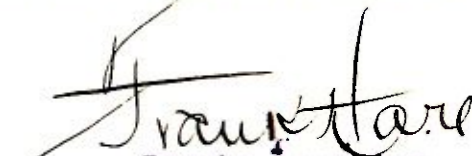
  
County Recorder.

4-688.

U. S. SURVEYOR-GENERAL'S FINAL CERTIFICATE ON FIELD NOTES.

Department of the Interior,

OFFICE OF U. S. SURVEYOR-GENERAL,

Phoenix, Arizona.

Aug 10 - 1905

I, U. S. Surveyor-General for the district of Arizona.

do hereby certify that the foregoing transcript of the Field Notes, return and approval of the survey of the mining claim of Novel A. Smith,

known as the Don Francisco, Don Carlos, San Juan, Franklin situate in Warren

Mining District, Cochise County, Arizona.

in Section APPROX., Township No. 23 S., Range No. 24 E. unsurveyed and designated as Survey No. 2111, has been correctly copied from the originals on file in this office; that said Field Notes furnish such an accurate description of said mining claim as will, if incorporated into a patent, serve fully to identify the premises, and that such reference is made therein to natural objects or permanent monuments as will perpetuate and fix the locus thereof.

And I further certify that <sup>less than</sup> five hundred dollars' worth of labor has been expended or improvements made upon <sup>each of</sup> said mining claim by claimant or his grantors, and that said improvements consist of, at time of survey, 4 shafts, total value \$400.00.

and that no portion of said labor or improvements has been included in the estimate of expenditures upon any other claim.

I further certify that the plat thereof, filed in the U. S. Land Office at Tucson, Arizona.

is correct and in conformity with the foregoing Field Notes.

( Signed ) Frank. S. Ingalls,

United States Surveyor-General for Arizona.

4-687.

SURVEYOR-GENERAL'S CERTIFICATE OF APPROVAL OF FIELD  
NOTES AND SURVEY OF MINING CLAIM.

**Department of the Interior,**

*Office of U. S. Surveyor-General,*

Phoenix, Arizona.....

..... *Aug 10* ....., 1905.

I, U. S. Surveyor-General for the district of Arizona.....

do hereby certify that the foregoing and hereto attached Field Notes and Return of the Survey of the  
Mining Claim of Hoval A. Smith,.....

....., known as the  
Don Francisco, Don Carlos, San Juan, Franklin.....

situate in Warren..... Mining District,  
Cochise County, Arizona.....

in Section 33....., Township No. 33 S......, Range No. 24 E...... unsurveyed  
....., designated as Survey No. 2111.....

executed by Franklin W. Smith,..... U. S. Deputy Mineral  
Surveyor, July 5th to 11th 1905......, 190....., under my instructions dated  
June 3rd 1905......, 190....., have been critically examined and the necessary cor-  
rections and explanations made, and the said Field Notes and Return, and the Survey they describe,  
are hereby approved. A true copy of the copy of the location certificate filed by the applicant.. for  
survey is included in the field notes.

*Frank A. Lyman*

U. S. Surveyor-General for Arizona.....

# POOR QUALITY

**The following pages are scanned at the best possible quality setting. The original pages are of poor quality and this is the best possible reproduction.**

Survey No. 2111, Don Francisco, et al lode,  
 situated in the Warner Mining District, Cochise County,  
 Arizona, and owned by Hoy I. Smith.

AFFIDAVIT OF \$500 IMPROVEMENTS.

I hereby certify that the value of the labor and improve-  
 ments on this *group* placed thereon by <sup>the</sup> claimant or his  
 grantors is not less than \$500 for each location thereof  
 and said improvements were placed on the claim between the  
 1st day of September, 1905, and prior to the publication of  
 the notice of publication of the application for patent,  
 and I am a competent person to depose:

DON CARLOS

- No. 1 Discovery shaft  
 8x10 ft brs from cor. No. 1 E 3 location N. 79°  
 W. on ledge, 570 ft., Value, 100.00
- No. 2 Shaft 4x6 10 ft brs from cor. No. 1 S. 79° 40' E. 200 ft  
 Value, 100.00
- No. 3 Shaft 4x6x10 ft brs from cor. No. 1 S. 78° 20' E. 200 ft  
 Value, 100.00
- No. 4 Shaft 4x6 10 ft brs from cor. No. 1 S. 61° E. 650 ft  
 Value, 100.00
- No. 5 Shaft 4x6x10 ft brs from cor. No. 1 S. 55° 55' E.  
 on ledge 200 ft. Value, 100.00

Total Improvements Don Carlos

500.00

SAN JUAN.

- No. 1 Discovery shaft 4x6x10 ft brs from cor. No. 1 S. 3° 22' W.  
 410 ft Value, 100.00
- No. 2 Shaft 4x6x10 ft brs from cor. No. 3 Don Carlos lode  
 of this survey, N. 3° 30' E. 510 ft Value, 100.00
- No. 3 Shaft 4x6x10 ft brs from cor. No. 3 Don Carlos lode of this  
 survey N. 7° W. 430 ft. Value, 100.00
- No. 4 Shaft 4x6x10 ft brs from cor. No. 3 Don Carlos lode  
 of this survey, N. 6° W. 400 ft Value, 100.00
- No. 5 Shaft 4x6x10 ft brs from S E C N. 3° 22' W. on ledge  
 400 ft Value, 100.00

Total Improvements San Juan lode,

500.00

FRANKLIN.

No. 1	Discovery shaft 4x6x10 ft bps from " " " " N. 56° 50' E. 577.9 ft., Value,	100.00
No. 2	Shaft 4x6 10 ft bps from Cor No. 1 N. 88° 10' W. 574 ft Value,	100.00
No. 3	Shaft 4x6x10 ft bps from " " " " N. 56° 50' E. 428 ft on ledge Value,	100.00
No. 4	Shaft 4x6x10 ft bps from " " " " N. 56° 50' E. 578 ft on ledge Value	100.00
No. 5	Shaft 4x6x10 ft bps from " " " " N. 56° 50' E. 58 ft Value,	<u>100.00</u>
Total improvements Franklin lode,		500.00

DOM FRANCISCO

No. 1	Discovery shaft 4x6x10 ft bps from " " " " N. 45° 40' W. 170 ft. Value	100.00
No. 2	Shaft 4x6x10 ft bps from Cor. No. 1 N. 45° 40' W. 941 ft. Value,	100.00
No. 3	Shaft 4x6x10 ft bps from Cor. No. 1 N. 45° 55' W. 930 ft Value ,	100.00
No. 4	Shaft 4x6x10 ft bps from " " " " N. 55° 55' W on ledge 97 ft Value,	100.00
No. 5	Shaft 4x6x 10 ft bps from " " " " N. 55° 55' W 572 ft on ledge, Value	<u>100.00</u>
Total improvements for Francisco lode		<u>500.00</u>

Total improvements on group \$8000.00

*Franklin W. Smith*

U. S. Deputy Mineral Surveyor.

Dated at Bisbee, Arizona, September 21, 1905.

Survey No. 2111, Don Francisco, et al lode, situated in the Warren Mining District, Cochise County, Arizona, and owned by Hov L A. Smith.

AFIDAVIT OF \$500 IMPROVEMENTS.

I hereby certify that the value of the labor and improvements on this *group* placed thereon by <sup>the</sup> *Grantors* is not less than \$500 for each location thereof and said improvements were placed on the claim before the 1st day of September, 1905, and prior to the publication of the period of publication of the application for patent,

DON CARLOS

No. 1	Discovery shaft 4x6x10 ft bps from top of location N. 79° W. on ledge, 550 ft., Value,	100.00
No. 2	Shaft 4x6 10 ft bps from top. No. 1 S. 79° W. 10' N. 550 ft. Value,	100.00
No. 3	Shaft 4x6x10 ft bps from top. No. 1 S. 78° W. 10' N. 550 ft. Value,	100.00
No. 4	Shaft 4x6x10 ft bps from top. No. 1 S. 61° W. 650 ft. Value,	100.00
No. 5	Shaft 4x6x10 ft bps from top. No. 1 S. 55° W. 55' N. on ledge 250 ft. Value,	100.00
Total Improvements Don Carlos		500.00
SAN JUAN.		
No. 1	Discovery shaft 4x6x10 ft bps from top. No. 1 S. 3° 25' W. 410 ft. Value,	100.00
No. 2	Shaft 4x6x10 ft bps from top. No. 3 Don Carlos lode of this survey, N. 3° 30' W. 510 ft. Value,	100.00
No. 3	Shaft 4x6x10 ft bps from top. No. 3 Don Carlos lode of this survey N. 7° W. 400 ft. Value,	100.00
No. 4	Shaft 4x6x10 ft bps from top. No. 3 Don Carlos lode of this survey, N. 6° W. 400 ft. Value,	100.00
No. 5	Shaft 4x6x10 ft bps from top. No. 3 S. E. C. N. 3° 25' W. on ledge 400 ft. Value,	100.00
Total Improvements San Juan Lode,		500.00

# Affidavit of Five Hundred Dollars Improvements.

We, A. T. Rissmer and J. P. Hancock

of lawful age, being first duly sworn according to law, depose and say: That we are acquainted with the  
"Don Carlos," "San Juan" "Franklin"  
"Don Francisco" mining claim, situate in Yuma

mining district, Yochise County, Arizona Territory, for which

Howard C. Smith

has made application for survey prior to application for patent under the provisions of the Act of Congress

approved May 10, 1872; and that the labor done and improvements made thereon by the applicant and

his grantor exceed five hundred dollars in value, for each claim, and further that we are not personally interested

in said mine.

A. T. Rissmer

J. P. Hancock

TERRITORY OF ARIZONA,  
COUNTY OF Yochise } ss:

Sworn to and subscribed before me this 21<sup>st</sup> day

[SEAL.]

of September, 1905.

Corra C. Smith



(4-691.)

# Certificate of U. S. Surveyor General

AS TO

EXPENDITURES REPORTED AFTER RETURN OF SURVEY OF MINING CLAIM.

I, U. S. Surveyor General for the district of Arizona.  
do hereby certify that Five Hundred Dollars' worth of labor has been expended or  
improvements made by claimant or his grantors, upon the mining claim of  
Howal A. Smith,  
known as the Don Carlos, San Juan, Franklin, Don Francisco.  
situate in Warren mining district,  
Cochise County, Arizona.  
in Section \_\_\_\_\_, Township No. \_\_\_\_\_, Range No. \_\_\_\_\_;  
that said improvements consist of on Don Carlos, 5 shafts, value \$500.00  
On San Juan, 5 shafts, value \$500.00 On Franklin, 5 shafts,  
value \$500.00 On Don Francisco, 5 shafts, value \$500.00

\_\_\_\_\_, and that no portion of said labor or improvements has been  
included in the estimate of expenditures upon any other claim. A copy of the report of  
Franklin W. Smith, U. S. Deputy Mineral Surveyor, dated  
Sept. 21, 1905., 18 \_\_\_\_\_, is hereto attached.

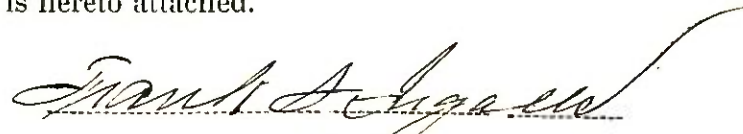
  
U. S. Surveyor General for Arizona.

Office of U. S. Surveyor General,  
Phoenix, Arizona.

\_\_\_\_\_, 1

Large  
maps