

MS -

0

2

1

2

1

Claims	MINERAL SURVEY NO. 2121 M & B Desc.	Improvements	Loc. Notices
A	1	16 $\frac{1}{2}$	5
B	7	18	4
C	6	18	3
D	2	16 $\frac{1}{2}$	2
Dubacher	13	19	8
E	5	17	11
H	9	17	1
Helvetia	14	19	10
I	10	19	6
J	3	17	7
K	4	17	9
Pig Iron No. 3	3	11	12

(4-683.)

Mineral Survey No. 2121

Lot No. \_\_\_\_\_

Gila Land District.

### FIELD NOTES

OF THE SURVEY OF THE MINING CLAIM OF

J.B. Anderson and J.M. Machien,  
Administrators, Estate Anton Machien, deceased.

KNOWN AS THE

A, B, C, D, E, H, I, J, K, Pig Iron No. 3, Helvetic, Subacher  
Warren Mining District.

Cochise County, Territory of Arizona.

Section \_\_\_\_\_, Township 23 S., Range 24 E Unsurveyed.

Surveyed under instructions dated June 22, 1905

by H.N. Jorgensen  
U. S. Deputy Mineral Surveyor

Claim located See Notices, 1

Survey commenced June 26, 1905

Survey completed July 14, 1905

6-121

Claims Located:

H.	-	May 4, 1905
E.	-	" 4, 1905
D.	-	March 23, 1903
C.	-	May 4, 1905
B.	-	March 23, 1903
H.	-	" 23, 1903
I.	-	May 4, 1905
J.	-	March 23, 1903
Subacher	-	May 4, 1905
K.	-	" 4, 1905
Helvetic	-	" 4, 1905
Pig Iron No. 3	-	" 4, 1905

*address*  
P.O. Address,  
J. M. O'Connell, atty,  
Bisbee, Ariz.

*not  
ledger  
sic  
areas*

Fect

Beginning at Cor. No. 1, the SE cor identical with location and with Cor. No. 4 B lode of this survey, and with Cor. No. 2 Northern Light lode, Survey No. 1812, a pine post 4 ft long 4 ins sq set 1 ft in the ground in a mound of stones and scribed 1-2121 A L, whence a quartzite cropping 1x1 ft and level with the ground, scribed X-1-2121 A L brs. S. 17° 32' E. 17.06 ft., and a second quartzite cropping 1x1 ft and 4 ins high brs. N. 17° 29' E. 12.28 ft., and U. S. M. M. No. 4 brs. S. 1° 0' W. 6198.4 ft.,

Thence N. 24° 02' E.

300.0 to original location for B E C., and Cors. No. 3 and 4 respectively of B and C lodes of this survey

601.1 same bearing to Cor. No. 2, the NE cor, identical with location and with Cor. No. 1 D lode of this survey, a pine post 4 ft long 4 ins sq set 1 ft in the ground in a mound of stones and scribed 2-2121 A L,

Thence N. 62° 30' E.  
with lode B and

1500.0 to Cor. No. 3, identical with Cor. No. 4 B lode of this survey a pine post 4 ft long 4 ins sq set 1 ft in the ground in a mound of stones and scribed 3-2121 A L, whence a quartzite cropping 2x1 ft level with the surface, chiseled X-3-2121 A L, brs. N. 26° 30' E. 17.27 ft., and a second quartzite cropping 1x1 ft 6 ins. high, <sup>or same chiseling</sup> brs. S. 89° 30' W. 14.28 ft.,

Thence S. 24° 02' W.

300.5 to original location for W E C.,

601.1 same bearing to Cor. No. 4, the SW cor, identical with location and with Cor. No. 3 Northern Light lode, Survey No. 1812, a pine post 4 ft long 4 ins sq set 1 ft in the ground in a mound of stones and scribed 4-2121 A L, whence a quartzite cropping 2x2 ft level with the surface, chiseled X-4-2121 A L, brs. S. 2° 10' E. 15.20 ft., and a second cropping 1x1 ft 6 ins. high, <sup>with same chiseling</sup> brs. N. 73° 25' W. 10.12 ft.,

Thence S. 62° 32' E.

1500.0 to Cor.No.1 the place of beginning.

Ledge.

The presumed course of the vein on this claim is from the W E C location S. 62° 28' E. 1500 ft.

D.

Beginning at Cor.No.1 the SE cor, identical with location and with Cor.No.2 A lode of this survey, a pine post 4 ft long 4 ins sq set 1 ft in the ground in a mound of stones and scribed 1-2121 D L, whence a quartzite cropping 2x1x 6 ins high scribed X-1-2121 DL brs. S. 2° 10' W. 22.13 ft., and a second quartzite cropping 2x2x1 ft with same scribing brs. N. 62° 35' E. 19.73 ft., and U. S. M. No. 4. brs. S. 3° 0' W. 6755.4 ft.,

Thence N. 24° 2' E.

300.6 to original location for D E C., and 301 D E C. respectively of C&E lodes of this survey,

601.1 same bearing to Cor.No.2, the NE cor, identical with location and with Cor.No.1 J lode, a pine post etc scribed 2-1-2121 D L,

Thence N. 62° 28' W.

1500.0 to Cor.No.3 the NW cor identical with location and with Cor.No.4 J. lode of this survey, a pine post 4 ft long 4 ins sq set 1 ft in the ground in a mound of stones and scribed 3-2121 D L, whence a quartzite cropping 1x2x1 ft chiseled X-3-2121 D L, brs. S. 42° 46' E. 18.02 ft., and a second quartzite cropping 1x1x6 ins high with same scribing brs. N. 2° 20' E. 1330 ft.,

Thence S. 24° 02' W.

300.5 to original location for W E C.,

601.1 same bearing to Cor.No.4, the SW cor identical with location and with Cor.No.3 A lode of this survey, a pine post etc and scribed 4-3-2121 D L,

Thence S. 62° 28' E.

1500.0 to Cor.No.1 the place of beginning.

Feet

Ledge.

The presumed course of the ledge on this claim is from the W E C., S. 62° 28' E. 1500 ft.

----- "J" -----

Beginning at Cor.No.1. the SW cor., identical with location, and with Cor.No.2 "D" lode of this survey a pine post 4 ft long 4 ins sq set 1 ft in the ground in a mound of stones and scribed 1-2121 J L, whence a limestone cropping 1x1x4 ins high scribed X-1-2121 J L brs N. 3° 22' W. 15.3 ft., and a second limestone cropping with the same scribing brs. N. 88° E. 22 ft., and U S M M No 4 brs S. 4° 41' W. 7319.9 ft..

Thence N. 24° 02' E.

300.6 to original location for E E C., identical with Core No 4 and 3 respectively of "K" and "E" lodes of this survey

601.1 same bearing to Cor.No.2 identical with location a pine post 4 ft long 4 ins sq set 1 ft in the ground in a mound of stones and scribed 22121 J L, whence a quartzite cropping 1x1x 2 ft high and chiseled X-2-2121 <sup>J L</sup> brs N 23° 52' E. 12.98 ft., and a second quartzite cropping 1x3 x12 ins high of the same scribing brs. N. 54° W. 33.2 ft.,

Thence N. 6 2° 28' W

1500.0 to Cor.No.3, the NW cor and identical with location a pine post 4 ft long 4 ins sq set 1 ft in the ground in a mound of stones and scribed 3-2121 J L, whence a conglomerate cropping 2x1 ft level with the ground brs. S. 57° 50' W 7.55 ft., and a second cropping of the same dimension and scribing brs. N. 47° 58' W. 48.22 ft.,

Thence S. 24° 02' E.

300.5 to original location for W E C.

601.1 same bearing to Cor.No.4 the SW cor., identical with location and with Cor.No.3 "D" lode of this survey a pine post etc scribed 4-2121 J L,

Thence S. 62° 28' E

1500.0 to Cor.No.1 the place of beginning.

Ledge.

The presumed course of the vein on this claim is from the W E C S. 62° 28' E. 1500 ft.,

----- "K" -----

Beginning at Cor.No.1 the SE cor., identical with location ~~and with Cor.No.4 "I" lode of this survey~~ a pine post 4 ft long 4 ins sq sec 1 ft in the ground in amount of stones and scribed 1-2121 K L, whence a quartzite cropping 1x1x1 ft high and scribed X-1-2121 K L brs. N. 62° 20' W. 11.2 ft., and a second quartzite cropping 2x2 ft 4 ins high of same scribing brs. N. 32° E. 15.2 ft., and U S M M No.4 brs. S. 15° 21' W. 15.1 ft.,

Thence N. 24° 02' E.

500.5 to original location for E E C.

601.1 same bearing to Cor.No.2, the NW cor., identical with location and with Cor.No.3 "I" lode of this survey, a pine post 4 ft long 4 ins sq sec 1 ft in the ground in amount of stones and scribed 2-2121 K L, whence a quartzite cropping 2x3x 1 ft high scribed X-2-2121 K L brs. N. 34.2 ft., and a second cropping 1x1x 6 ins high of the same scribing brs. N. 28° E. 21.2 ft.,

Thence N. 62° 28' W.

1325.0 to Cor.No. 3 the NW cor identical with location a pine post 4 ft long 4 ins sq sec 1 ft in the ground in amount of stones and scribed 3-2121 K L, whence a porphyry cropping 1 ft x15x18 ins. scribed X-3-2121 K L brs. N. 69° 02' W. 60.5 ft., and a quartzite cropping 1x1x18 ins high with the same scribing brs. N. 4° 28' W. 84.3 ft.,

feet

with the ground chiseled X-2-2121 E L brs N. 3° W.  
3032.1 ft.,

Thence N. 62° 28' W.

144.0

to Cor. No. 1 "K" lode of this survey,

282.2

same bearing to Cor. No. 4 "I" lode of this survey

1500.0

same bearing to Cor. No. 3, the SW cor identical with location and with Cor. No. 4 "K" lode of this survey, a pine post etc., scribed 3-2121 E L, thence

Thence S. 24° 02' W.

300.6

to original location for W E C., identical with Cor. No. 1 and 3 respectively of "J" and "D" lodes of this survey

601.1

same bearing to Cor. No. 4 the SW cor identical with location and with Cor. No. 3 "C" lode of this survey a pine post 4 ft long 4 ins sq set 1 ft in the ground in a round of stone and scribed 4-2121 E L, whence a quartzite cropping 1x1x2 ft chiseled X-4-2121 E L brs. S. 50° 50' E 20.2 ft., and a second quartzite cropping of same dimensions and chiseling brs. N. 22° E. 17.93 ft.,

Thence S. 62° 28' E.

1500

to Cor. No. 1 the place of beginning

beginning

The proposed course of the vein on this claim is from the W E C S. 62° 28' E. 1500 ft

"C"

Beginning at Cor. No. 1 the SW cor identical with location and with Cor. No. 4 "H" lode of this survey, a pine post 4 ft long 4 ins sq set 1 ft in the ground in a round of stone and scribed 1-2121 C L, whence a quartzite cropping 2x2'4 ins high and chiseled X-1-2121 C L brs N. 32° 20' E. 50.4 ft., and a second quartzite cropping 2x2 ft. level with the surface with same chiseling brs N. 48° 20' W. 25'3 ft., and U S M L No. 4 brs S. 15° 07' W. 3985.8 ft.,

Thence N. 24° 02' E



Feet

"C" Con. and "B"

- 300.5 to original location for E E C.,
- 601.1 same bearing to Cor.No.2, the NE cor identical with location and with Cor.No.1 "B" lode of this survey, a pine post etc scribed 2-2121 C L,  
 Thence N. 62° 28' W.
- 1500.0 to Cor.No.3, the NW cor identical with location and with Cor.No.4 "B" lode of this survey a pine post etc scribed 3-2121 C L,  
 Thence S. 24° 02' W.
- 300.6 to original location for "E" E C., identical with Cors No.1 and 2 respectively of "B" lode of this survey
- 601.1 same bearing to Cor.No.4 the SW cor identical with location and with Cor.No.3 "B" lode of this survey a pine post 4 ft long 4 ins sq set 1 ft in the ground in a mound of stones and scribed 4-2121 C L, thence a quartzite cropping 2x2 ft level with the surface chiseled X-4-2121 C L brs. S. 80° W. 8.2 ft and a second quartzite cropping 1x1 ft high of same chiseling brs. N. 31° 30' E. 19.4 ft  
 Thence S. 62° 28' E.
- 1325 to Cors No 2 and 5 respectively of "B" and "H" lodes of this survey,
- 1500.0 same bearing to Cor.No.1 the place of beginning.

Ledge.

The presumed course of the vein on this ledge is from the  
 "E" C S. 62° 28' E. 1500 ft.

----- "B" -----

Beginning at Cor.No.1 the SE cor identical with location and with Cor.No.6 Pig Iron No.3 lode of this survey, a pine post 4 ft long 4 ins sq set 1 ft in the ground in a mound of stones and scribed 1-2121 B L, thence a quartzite cropping 1x1x2 ft chiseled X-1-2121 B L brs  
 (7) N. 44° 20' E. 31.2 ft., and a second quartzite cropping

of same dimensions and chiseling brs. S.  $83^{\circ} 50' W$ . 2715 ft  
and S. M. M. No, 4 brs S.  $12^{\circ} 19' W$ . 5435.9 ft.,

Thence N.  $24^{\circ} 08' E$ .

300.5 to original location for W E C.,

310.8 same bearing to Cors No. 5 and 6 respectively of Big  
Iron No. 3 and "H" lodes of this survey,

601.1 same bearing to Cor. No. 2, the NE cor identical with loca-  
tion and with Cor. No. 5 "H" lode of this survey, a pine  
post 4 ft long 4 ins sq set 1 ft in the ground in a round  
of stones and scribed 2-2121 B L whence a quartzite crop-  
ping 2x1x1 ft. chiseled X-2-2121 brs. N.  $73^{\circ} 28' E$ . 17.3  
ft and a second quartzite cropping 2x3 ft level with the  
surface brs. S.  $34^{\circ} E$ . 10.8 ft.,

Thence N.  $62^{\circ} 28' W$ .

1325.0 to Cor. No. 3 the NW cor identical with location and with  
Cor. No. 4 "C" lode of this survey a pine post etc scribed  
3-2121 B L,

Thence S.  $24^{\circ} 08' W$ .  
original location for

300.0 to Cor. No. 4, identical with W E C and with Cor. No. 1  
"H" lode of this survey, and Cor. No. 2 Northern Hill of this  
survey No. 1812, a pine post 4 ft long etc scribed 4-2121  
B L,

Thence S.  $13^{\circ} 36' W$

309.1 to Cor. No. 5 the SW cor identical with location and with  
Cor. No. 3 Helvetia lode of this survey a pine post 4 ft  
long 4 ins sq set 1 ft in the ground in a round of stones  
and scribed 5-2121 B L, whence a quartzite cropping  
2x2 ft 4 ins high chiseled X-5-2121 B L brs N.  $82^{\circ} 20' E$   
15.5 ft and a second quartzite cropping of same chiseling  
and dimensions brs N.  $14^{\circ} 57' W$ . 16.6 ft.,

Thence S.  $62^{\circ} 28' E$ .

600.0 to Cors No. 2 and 3 respectively of Helvetia and Dubacher  
lodes of this survey,

1200.0 same bearing to Cors. No. 2 and 7 respectively of Dubacher

Survey No. 281 "B" con. "H" Feet

1262.9 lode and P13 Iron No. 3 lode of this survey, same bearing to cor. No. 1 the place of beginning.

Ledge.

The presumed course of the vein on the surface is from the  
N 20° E. 62° 28' E. 1325 ft.

----- "H" -----

Beginning at cor. No. 1 the SE corner of the

location, and with cor. No. 4 P13 Iron No. 3 lode of this  
survey, a pine post 4 ft long 4 ins sq set 1 ft in the  
ground in a mound of stones and scribbled 1-2121 H T,

thence a quartzite cropping 1x1ft and level with the  
ground and chiseled X-1-2121 H T. P13. H. 72° 30' W.

8.25 ft., and a second quartzite cropping 2x3x1 ft. of  
same dipping P13. H. 78° 05' W. 6.6 ft., and a 3rd P13  
No. 4 P13. S. 17° 53' E. 5625.3 ft.,

Thence N. 24° 14' W.

1500.0 to cor. No. 2 the NE corner identical with location and with  
cor. No. 1 "I" lode of this survey a pine post etc and  
scribbled 2-2121 H T

Thence N. 62° 28' W.

300.0 to original location for N E C.,

592.3 same bearing to cor. No. 3 the NW corner identical with location  
and with cor. No. 2 "E" lode of this survey a pine post  
etc scribbled 3-2121 H T,

Thence E. 24° 02' W.

601.1 to cor. No. 1 and 2 respectively of "E" and "C" lodes of this  
survey

1202.2 same bearing to cor. No. 4, identical with location and with  
cor. No. 1 "C" lode of this survey a pine post etc  
scribbled 4-2121 H T

Thence N. 62° 28' W.

175.0 to cor. No. 5 identical with location and with cor. No. 2 "B"  
lode of this survey, a pine post etc scribbled 5-2121 H T,

Survey No. 2121

Part

"H" lode (con)

290.3 to Cor. No. 4 the SE cor identical with location and with Cor. No. 5, of Pig Iron No. 3 lode of this survey a pine post 4 ft long 4 ins sq set 1 ft in the ground in a mound of stones and scribed 6-2121 HL whence a quartzite cropping 2x2 ft level with the surface chiseled X-6-2121 H L brs N. 75° 20' E. 31.5 ft and a second quartzite cropping 1x2ft x 4 ins high brs. S. 24° 10' E 24.2 ft.,

Thence S. 62° 28' E

201.2 to original location for S E C.,  
 501.2 same bearing to Cor. No. 1 the place of beginning.

Ledge.

The present course of the vein on this claim is from the S E C N. 34° 14' E. 1500 ft.

----- "I" -----  
 Beginning at Cor. No. 1 the SE cor identical with location and with Cor. No. 2 "H" lode of this survey a pine post 4 ft long 4 ins sq set 1 ft in the ground in a mound of stones and scribed 1-2121 I L, whence a limestone cropping 2 x 2 ft and level with the surface and chiseled X-1-2121 I L brs N. 89° 10' E. 48.2 ft., and a second quartzite cropping of same dimensions and chiseling brs N. 10° 31' W. 27.2 ft., and U S M No. 4 brs. S. 21° 10' W. 7087.3 ft.

Thence N 34° 14' E

302.0 to original location for S E C.,  
 604.1 same bearing to Cor. No. 2 the NE cor identical with location a pine post 4 ft long 4 ins sq set 1 ft in the ground in a mound of stones and scribed 2-2121 I. L. whence a quartzite cropping 2x2x1 ft chiseled X-2-2121 I L brs N. 40° E. 22.75 ft., and second quartzite cropping 8x1 x 1 ft high of same scribing brs. N. 11° 7' W. 31.05 ft.,

Thence N. 62° 28' W.

Survey No. 221  
"I" Con and Pig Iron No.3 lodes

Feet

874.5 to Cor.No 3 the NW cor identical with location and  
with Cor.No 2 "K" lode of this survey a pine post etc  
scribed 3-2121 I L,

Thence S. 34° 14' W.

302.1 to original location for "E C.",

604.1 same bearing to Cor.No.4 the SW cor identical with loca-  
tion, a pine post 4 ft long 4 ins sq set 1 ft in the  
ground in a mound of stones and scribed 4-2121 I L, whence  
a quartzite cropping 13x7 ft brs.N.10°W, 23.2 ft., and a  
second quartzite cropping of same dimensions and scribing  
brs N. 48° E. 10.3 ft.,

Thence S. 62° 28' E.

107.2 to Cor.No.1 "K" lode of this survey

282.2 to Cor.No.2 and 3 respectively of "E" and "K" lodes of  
this survey

874.5 same bearing to Cor.No.1 the place of beginning.

Ledge.

The presumed course of the vein on this claim is from the  
W E C S. 62° 28' N. 874.5 ft.

----- Pig Iron No.3-----

Beginning at Cor.No.1, the SW cor identical with loca-  
tion on line 1-2 Paragon lode Survey No.1715, a pine  
post 4 ft long 4 ins sq set 1 ft in the ground in a mound  
of stones and scribed 1-2121 P I No.3 L, whence a  
quartzite cropping 2x2x 1 ft brs N. 82° 29' E. 9.1 ft. and  
a second quartzite cropping of same dimensions and chisel-  
ing brs N. 87° 30' W. 10.22 ft., and U.S.M.N.No. 1 brs  
S. 15° 54' W. 4701.2 ft.,

Thence N. 31° 08' E

302.1 to Cor.No.2 Paragon lode, Survey No.1715,

415.9 same bearing to Cor.No.2, identical with location and  
with Cor.No.3 Baltimore lode Survey No.2071, a pine  
post 4 ft long 4 ins sq set 1 ft in the ground in a mound  
of stones and scribed 2-2121 P I No.3 L, whence a quart-  
zite cropping 1x1 ft 6 ins high chiseled X-2-2121 P I No  
3 L brs. S. 86° 50' E. 11.76 ft.. and a second quart-  
zite cropping 1x1 ft level with the surface of same

Feet

Pig Iron No. 3 L, (30m)

- chiseling brs N. 29° 30' W. 20.8 ft.,  
 Thence N. 4° 49' E
- 170.6 to Cor.No.3 identical with location and with Cor.No.1  
 4 ins sq set 1 ft in the ground in a mound of stones  
 and scribed 3-2121 P I No.3 whence a quartzite cropping  
 2x2x1 ft. high chiseled ~~X-3-2121~~<sup>X-3-2121</sup> P I No.3 L brs N. 56°  
 20' W. 5.0 ft., and a second quartzite cropping of the  
 same dimensions and chiseling brs. S. 50° 55' E. 6.5 ft  
 Thence N. 34° 14' E
- 381.3 to Cor.No.4, identical with location and with Cor.No.1  
 "H" lode of this survey a pine post etc scribed 4-2121  
 P I No.3 L,  
 Thence N. 62° 28' W.
- 265.1 to original location for N E C.,
- 501.2 to Cor.No.5 the NW cor identical with location and with  
 Cor.No.6 "H" lode of this survey a pine post etc scribed  
 5-2121 P I No.3 L,  
 Thence S. 24° 02' W
- 310.8 to Cor.No 6 identical with location and with Cor.No.1  
 "B" lode of this survey, a pine post etc scribed  
 6-2121 P I No.3 L,  
 Thence N. 68° 30' E.
- 881.5 to Cor.No.7 identical with location and with Cor.No.3  
 "D" lode of this survey, a pine post 4 ft long 4  
 ins sq set 1 ft in the ground in a mound of stones and  
 scribed 7-2121 P I No 3 L, whence a quartzite cropping  
 2x2x1 ft chiseled X-7-2121 P I No.3 L brs N. 20° 13' E  
 14.5 ft., and a second quartzite cropping 2x2 ft level  
 with the surface of same chiseling brs. S. 88° 20' W.  
 7.3ft.,  
 Thence S. 27° 32' W.
- 640.9 to Cor.No.8 the SW cor identical with location, on line  
 S W 640.8  
 2-3 Paragon lode, Survey No.1715 at ~~63.8~~<sup>640.8</sup> 89° 28' E. 63.8  
 ft from Cor.No.2, a pine post 4 ft long 4 ins sq set 1ft

in the ground in a mound of stones and scribed 3-2121  
P I No. 3 L, whence an oak tree 4 ins in diameter and  
scribed X-8-2121 B T P I No. 3 L brs. S 15° 32' E. 15.95  
ft and a quartzite cropping 1x1x½ ft chiseled X-8-2121  
P I No. 3 L, brs N. 47° 35' E. 7.65 ft.,

Thence S. 62° 23' E.

286.0

to original location for H E C.,

540.3

same bearing to Cor. No. 1 the place of beginning.

Ledge

The presumed course of the vein on this claim is from the  
S E C N 27° 32' E. 951.1 ft.,

----- DUBACHER -----

Beginning at Cor. No. 1 the <sup>cut</sup> NE cor identical with location  
a pine post 4 ft long 4 ins sq set 1 ft in the ground  
in a mound of stones and scribed 1-2121 Du L whence a  
porphyry cropping 2x2½ ft high chiseled X-1-2121 D L brs  
S. 11° 8' W. 14.74 ft., and a second porphyry cropping  
2x2x2 ft of same chiseling brs. S. 57° 30' W. 10.2 ft.,  
and U S M M No. 4 brs. S. 6° 17' W. 4120.1 ft..

Thence N. 27° 32' E.

782.8

to Cor. No. 8 Pig Iron No. 3 lode of this survey, on the  
1-2 Paragon lode, Survey No. 1715, at N. 39° 28' E.  
63.8 ft from Cor. No. 3,

1403.7

same bearing to Cor. No. 2 the NE cor identical with lo-  
cation and with Cor. No. 7 Pig Iron No. 3 lode of this survey  
a pine post etc scribed 2-2121 Du L,

Thence N. 62° 23' E

300.0

to original location for H E C.,

600.0

same bearing to Cor. No. 3, the NW cor identical with  
location and with Cor. No. 2 Helvitia lode of this survey  
a pine post 4 ft long 4 ins sq set 1 ft in the ground  
in a mound of stones and scribed 3-2121 Du L, whence a  
quartzite cropping 2x2 ft level with the surface and  
chiseled X-3-2121 D L brs S. 60° 28' E. 14.2 ft and a  
second quartzite cropping of same dimensions and chiseling

Survey No. 2121  
Dubacher (Con)

Feet

brs. N. 8° 02' W. 17.4 ft.,

Thence S. 27° 32' W.

1403.7 to Cor.No.4, the SW cor identical with location and on line 2-3 Carolina lode, Survey No.1715, at N. 88° 20' ~~W~~<sup>W</sup> ~~29.7~~<sup>572.9</sup> ft from Cor.No.2, a pine post 4 ft long 4 ins sq set 1 ft in the ground in a mound of stones described 4-2121 Du L, whence a quartzite cropping 2x2 ft level with the surface chiseled X-4-2121 D L brs N. 42° E. 8.2 ft., and a second quartzite cropping 2x2x1 ft high of same chiseling brs S. 31° 20' E 14.8 ft.

Thence S. 62° 28' E.

300.0 to original location for S E C.,

499.7 to intersection with line 1-2 Carolina lode, Survey No.1715 identical with line 3-4 Paragon lode, Survey No.1715 at S 30° 58' W. 251.7 ft and 734.1 ft respectively from Cor.No.2 Carolina lode and 3 Paragon lode.

600. same bearing to Cor.No.1 the place of beginning.

Ledge.

The presumed course of the vein on this claim is from the S E C. N. 27° 32' E. 1403.7 ft.

-----HELVETIA-----

Beginning at Cor.No.1 the SE cor identical with location a pine post 4 ft long 4 ins sq set 1 ft in the ground in a mound of stones and scribed 1-2121 HeL, whence a quartzite cropping 2x2 ft 1 ft high, chiseled X-1-2121 H L brs. S. 89° 50' E. 13. ft., and a second quartzite cropping of same dimensions and chiseling brs W. 1° 22' W. 7.9 ft., and U S M M N1.4 brs. S. 1° 40' E 4290.9 ft.,

Thence N. 27° 32' E.

96.0 to intersection with line 2-3 Carolina lode Survey No. 1715 at S. 88° 20' E. 29.7 ft from Cor.No3, which point is identical with Cor.No.4 Dubacher lode of this survey

1499.7 same bearing to Cor.No.2 the NE cor identical with location



Survey No. 2121  
Helvetia lode (con)

Feet

- and with Cor.No.3 Dubacher lode of this survey a pine post etc and scribed 2-2121 He L,
- Thence N. 62° 28' W.
- 300.0 to original location for N E C.,
- 600.0 same bearing to Cor.No. 3 identical with location and with Cor.No.5, "B" lode of this survey, on line 1-2 Northern Light lode, Survey No.1312, at N. 13° 36' E. 290.9 ft from Cor.No.1, a pine post etc scribed 3-2121 He L,
- Thence S. 26° 24' W
- 282.4 to intersection with line 4-1 Northern Light lode Survey No.1312, which line is identical with line 2-3 High Flyer lode, Survey No. 1631, at N. 62° 28' W. 64.5 ft and 16.3 ft respectively from Cors.No.1 Northern Light lode and No.2 High Flyer lode,
- 862.9 same bearing to intersection of line 4-1 High Flyer lode Survey No.1631, which line is identical with line 1-7 Red Hill lode, Survey No.1715 at N. 62° 45' W. 143.6 ft and 204.4 ft respectively from Cors No.1 High Flyer lode and No.2 Red Hill lode, *From Cor No.1 High Flyer lode and No.2 Red Hill lode, Cor. No.2 brz. N. 13° 36' E 297.3 ft.*
- 1500.0 same bearing to Cor.No.4 the SW cor identical with location a pine post 4 ft long 4 ins sq set 1 ft in the ground in a mound of stones and scribed 4-2121 H e L whence a quartzite cropping 2x3x1 ft high chiseled X-4-2121 H e L brs N. 18° 22' W. 47.2 ft., and a second quartzite cropping 2x2 ft level with the surface of the same chiseling br . S. 1° W. 14.1 ft.,
- Thence S. 62° 28' E
- 700.0 to original location for S E C, on line 1-2 Red Hill lode Survey No.1715 at S. 21° 04' W. 642.2 ft from Cor.No.2
- 373.7 same bearing to intersection with line 2-3 Key to the Situation lode, Survey No. 1715, at <sup>N</sup> ~~S.~~ 88° 22' <sup>W 189.7</sup> ~~ft~~ ft from Cor.No. <sup>2</sup> ~~3~~
- 538.7 same bearing to intersection with line 1-2 Key to the

West

Situation lode, identical with the E-4 Carolina lode, No. 1715 at S 30° 58' W. 83.1 ft from Cors No. 2 and 3 respectively of Key to the Situation and Carolina lodes, 570.3 same bearing to Cor. No. 1 the place of beginning.

Lode.

The presumed course of the vein in this claim is from the S E C N. 26° 24' E. 1500 ft.

AREA

Total and net area "A" lode		20.660
"D"		20.660
"J"		20.660
"K"		18.250
"E"		20.000
"G"		20.800
"B"		18.070
"I"		18.800
Total area "I" lode,	12.044	
"K" lode conflict	<u>0.738</u>	
Net area "I" lode,		11.306
Total area Pig Iron No. 3	11.455	
Less area in conflict with Paragon lode Survey No. 1715,	<u>1.891</u>	9.564
Total area Dubacher lode,	19.335	
Less area in conflict with Paragon lode Survey No. 1715,	1.337	
Less area in conflict with Carolina lode, Survey No. 1715	<u>1.41</u>	<u>2.778</u>
Net area Dubacher lode,		16.857
Total area Helvetia lode,	20.146	
Less area in conflict with Carolina lode, Survey No. 1715	0.060	
Less area in conflict with Key to the Situation lode, Survey No. 1715,	0.157	
Less area in conflict with Red Hill lode Survey No. 1715	3.955	
Less area in conflict with High Flyer lode, Survey No. 1821	1.099	
Less area in conflict with Northern Light lode Survey No. 1812	<u>0.209</u>	<u>5.480</u>
Net area Helvetia lode,		<u>14.666</u>
Net area group		

## Improvements.

I hereby certify that the value of the labor and improvements on this claim placed thereon by claimants or their grantors is not less than \$500 and that said improvements consist of:

## "A" Lode

No. 1	Discovery cut 4x15x10 ft brs from Cor. No. 1 N. 22° E. 304 ft., Value,	\$100.00
No. 2	Open cut 4x14x10 ft brs from Cor. No. 1 N 18° 6' E 317 ft Value	100.00
No. 3	Open Cut 4x15 x10 ft brs from Cor. No. 2 S. 32° W. 262 ft., Value,	100.00
No. 4	Open Cut 4x12x10 ft brs from Cor. No. 2 S. 34° 20' W 235 ft., Value,	100.00
No. 5	Open Cut 4x15x10 ft brs from Cor. No. 2 S. 44° 45' W. 311 ft., Value,	<u>100.00</u>
	Total improvements on "A" lode,	\$500.00

## "D"

No. 1	Discovery cut 4x14x10 ft brs from Cor. No. 1 N. 19° E. 304 ft., Value,	100.00
No. 2	Open Cut 4x14x10 ft brs from Cor. No. 2, S. 36° 24' W. 180 ft., Value,	100.00
No. 3	Open Cut 4x15x10 ft brs from Cor. No. 1 N. 17° 20' E 260 ft., Value,	100.00
No. 4	Open Cut 4x 14 x 10 ft brs from Cor. No. 1 N. 18° 10' E 274 ft., Value,	100.00
No. 5	Open Cut 4x15x10 ft brs from Cor. No. 2 S. 31° 50' W 275 ft., Value,	<u>100.00</u>
	Total improvements on "D" lode,	500.00

## Survey No. 2121

## Improvements (Con)

		"J" lode.	
No.1	Discovery cut 4x14x10 ft brs from Cor.No.1 N. 20° E	305 ft., Value,	100.00
No.2	Open Cut 4 x14 x10 ft brs from Cor.No.1 N. 23° 10' W	110 ft., Value,	100.00
No.3	Open Cut 4x16x10 ft brs from Cor.No.1 N. 18° E.	200 ft., Value,	100.00
No.4	Open Cut 4x12x10 ft brs from Cor.No.2 S. 26° 14' W	230 ft., Value,	100.00
No.5	Shaft 4x6x10 ft brs from Cor.No.3 S. 10° 50' E. 260	ft., Value,	100.00
Total improvements on "J" lode,			\$500.00
		"K" Lode	
No.1	Discovery cut 4x12x10 ft brs from Cor.No.4, N. 33°	50' W. 304 ft value,	\$100.00
No.2	Open Cut brs from Cor.No.2 S. 38° W. 136 ft	dimension s 4x12x10 ft., Value	100.00
No.3	Open Cut 4x12x10 brs from Cor.No.2 S. 28° 44' W, 102 ft	Value,	100.00
No.4	Open Cut 4x12x10 ft brs from Cor.No.2 S. 42° 52' W	217 ft., Value,	100.00
No.5	Open Cut 4x12x10 ft brs from Cor.No.2, S. 49° 45' W.	230 ft., Value,	100.00
Total improvements "K" lode,			500.00
		"E" lode.	
No.1	Discovery <sup>cut</sup> 4x12x10 ft brs from Cor.No.1 N. 3° 10' W.	308 ft., Value,	100.00
No.2	Open Cut 4x12x10 ft brs from Cor.No.1 N. 7° 36' W. 398 ft	Value,	100.00
No.3	Open Cut 4x12x10 ft brs from Cor.No.1 N. 2° 8' W. 410 ft.	Value,	100.00
No.4	Open Cut 4x15 x10 ft brs from Cor.No.1 N. 15° 10' E	440 ft., Value,	100.00
No.5	Open Cut 4x12x10 ft brs from Cor.No.3 S. 17° 40' E.	304 ft., Value.	100.00
(17)	Total improvements "E" lode,		\$500.00

Survey No. 2121  
Improvements (Con)

"C" lode.

No. 1	Discovery cut 4x12x10 ft brs from Cor. No. 1 N. 3° 15' W 378 ft., Value,	\$100.00
No. 2	Open Cut 4x15x10 fr brs from Cor. No. 1 N. 4° W. 395 ft., Value,	100.00
No. 3	Open Cut 4x12x10 ft brs from Cor. No. 3, S. 19° 40' W 300 ft., Value,	100.00
No. 4	Open Cut 4x12x10 ft brs from Cor. No. 3 S. 12° 30' W. 350 ft., Value,	100.00
No. 5	Open Cut 4x12x10 ft brs from Cor. No. 3 S. 11° 50' W. 280 ft., Value,	100.00
Total improvements "C" lode		\$500.00

"B" lode

No. 1	Discovery cut 4x12x10 ft brs from Cor. No. 4 S. 70° E 15 ft., Value,	100.00
No. 2	Open Cut 4x12x10 ft brs from Cor. No. 1 N. 10° E. 452 ft., Value,	100.00
No. 3	Open Cut 4x12x10 ft brs from Cor. No. 1 N. 61° 30' W. 600 ft Value,	100.00
No. 4	Open Cut 4x7x10 ft and tunnel <sup>course 80° W.</sup> 4x7x19 ft. center of mouth of open cut of which brs. N. 64° 30' W. 354 ft from Cor. No. 2 Value	250.00
Total improvements "B" lode,		550.00

"H" lode,

No. 1	Discovery cut 4x12x10 ft brs from Cor. No. 1 N. 43° 12' W 304 ft Value	100.00
No. 2	Open Cut 4x12 x10 ft brs from Cor. No. 6 N. 29° 20' E. 208 ft., Value ,	100.00
No. 3	Open Cut 4x12x10 ft brs from Cor. No. 3 S. 11° 45' W. 482 ft., Value,	100.00
No. 4	Open Cut 4x12x10 ft brs from Cor. No. 3, S. 12° 20' W 510 ft., Value,	100.00

Survey No. 21  
Improvements Con

"I" lode.		
No. 1	Discovery cut 4x12x10 ft brs from Cor. No. 4 N. 79° 50' E. 493 ft., Value,	\$100.00
No. 2	Open cut 4x12x10 ft brs from Cor. No. 4, N. 82° 22' E. 500 ft., Value,	100.00
No. 3	Open cut 4x12x10 ft brs from Cor. No. 3, S. 30° 40' E. 370 ft., Value,	100.00
No. 4	Open cut 4x12x10 brs from Cor. No. 3 S. 32° 30' E. 364 ft Value	100.00
No. 5	Open Cut 4x12x10 ft brs from Cor. No. 3, S. 33° 40' E. 360 ft. Value,	<u>100.00</u>
Total improvements "I" lode.		\$500.00
"Pig Iron No. 3" lode.		
No. 1	Discovery shaft 4x6x36 ft brs from Cor. No. 2 S. 87° 30' W. 330 ft., Value	\$400.00
No. 2	Open Cut 4x12x10 ft brs from Cor. No. 2 S. 86° 22' W. 342 ft., Value,	100.00
No. 3	Open Cut 4x12x10 ft brs from Cor. No. 2, N. 16° 42' W. 445 ft Value	<u>100.00</u>
No. 4	Total improvements Pig Iron No. 3 lode, 600.00	
"Dubacher,"		
No. 1	Discovery cut and tunnel open cut 4x8x8 ft and tunnel 4x6x32 ft brs N 30° W center of mouth of open cut brs from Cor. No. 3 S 24° 25' E. 388 ft., Value	\$370.00
No. 2	Open Cut and tunnel, open cut 4x6x12 ft and tunnel 4x6x24 ft bearing S. 70° E. center of mouth of open cut brs from Cor. No. 4 N. 30° 22' E. 408 ft Value	<u>1040.00</u>
Total improvements Dubacher lode		1410.00
"Helvetia"		
No. 1	Discovery cut 4x12x10 ft brs from Cor. No. 1 N. 6° 45' E. 800 ft., Value,	100.00
No. 2	shaft 4x6x17 ft brs from Cor. No. 1 N. 7° 15' E 480 ft Value,	170.00

Improvements (Con)

Helvetia (Con)

No. 3	Open Cut 4x12x9 ft brs from Cor.No.1 N. 6° 30' E 475 ft., Value,	\$100.00
No. 4	Shaft and drift, shaft 4x6x70 ft from bottom of which runs a drift 4x6x30 ft brg. N. 50° W. shaft brs from Cor.No.1 N. 15° 40' E 437 ft Value,	1100.00
No. 5	Open Cut 4x12x10 ft brs from Cor.No.1 N. 9° E. 164 ft., Value,	100.00
No. 6	Open Cut 4x12x10 ft brs from Cor.No.1 N. 15° 15' E. 112 ft Value,	<u>100.00</u>
	Total improvements Helvetia lode,	<u>1670.00</u>
	Total improvements on group	\$8230.00

ADJACENT CLAIMS.

- North Unsurveyed claims and owners unknown
- East Paragon lode, Survey No. 1715, Cochise Copper Co. owner,  
Balfinore Survey No. 2071. James H. Bell owner;  
Unsurveyed claims, Winwood, et al owners;
- South Paragon, Carolina, Key to the citation and Red Hill lodes  
Survey No. 1715, Cochise Copper Co owners.  
Northern Light lode, Survey No. 1812, Donald MacPhun  
owner;
- West Red Hill Survey No. 1715, Cochise Copper Co owners  
High Flyer, Survey No. 1681, Donald MacPhun owner.  
Survey No  
Northern Light 1812, Donald MacPhun owner.  
Unsurveyed ground, claims and owners unknown.

LOCATION.

This survey is located about 2 mi in a NE direction from the City of Bisbee in Dubacher canyon on unsurveyed lands in the Warren Mining District, Cochise County, Arizona, in approximate T<sub>23</sub> S R 24 E C & S E E &

## INSTRUMENT.

This survey was made with a Buff and Buff mining transit; the courses were deflected from the true Meridian as determined by a solar observation checked by <sup>direct</sup> observations with a Saegmuller solar attachment, the distances were measured with a 500 ft and 100 ft steel tape. MAGNETIC variation 12° 30' E.

*H. N. Jorgensen*  
U S Deputy Mineral Surveyor.

Dated at Bisbee, Arizona,

August 10, 1905.

## Note.

The discrepancies which occur between the courses and distances of this survey and those of the adjoining, or conflicting approved surveys, are due to the fact that the latter.



Survey No. 2121  
Improvements (con)

"C" lode.		
No. 1	Discovery cut 4x12x10 ft brs from Cor. No. 1 N. 3° 35' W 325 ft., Value,	\$100.00
No. 2	Open Cut 4x15x10 fr brs from Cor. No. 1 N. 4° W. 395 ft., Value,	100.00
No. 3	Open Cut 4x12x10 ft brs from Cor. No. 3, S. 19° 40' W 300 ft., Value,	100.00
No. 4	Open Cut 4x12x10 ft brs from Cor. No. 3 S. 12° 30' W. 350 ft., Value,	100.00
No. 5	Open Cut 4x12x10 ft brs from Cor. No. 3 S. 11° 50' W. 320 ft., Value,	100.00
Total improvements "C" lode		\$500.00
"B" lode		
No. 1	Discovery cut 4x12x10 ft brs from Cor. No. 4 S. 70° E 15 ft., Value,	100.00
No. 2	Open Cut 4x12x10 ft brs from Cor. No. 1 N. 10° E. 452 ft., Value,	100.00
No. 3	Open Cut 4x12x10 ft brs from Cor. No. 1 N. 61° 30' W. 600 ft Value,	100.00
No. 4	Open Cut 4x7x10 ft and tunnel <sup>course 80° W.</sup> 4x7x19 ft. center of mouth of open cut of which brs. N. 64° 30' W. 354 ft from Cor. No. 2 Value	250.00
Total improvements "B" lode,		550.00
"H" lode,		
No. 1	Discovery cut 4x12x10 ft brs from Cor. No. 1 N. 43° 12' W 304 ft Value	100.00
No. 2	Open Cut 4x12 x10 ft brs from Cor. No. 6 N. 29° 20' E. 208 ft., Value ,	100.00
No. 3	Open Cut 4x12x10 ft brs from Cor. No. 3 S. 11° 45' W. 482 ft., Value,	100.00
No. 4	Open Cut 4x12x10 ft brs from Cor. No. 3, S. 12° 20' W 510 ft., Value,	100.00
No. 5	Open Cut 4 x12x10 ft brs from Cor. No. 3, S. 14° W. 560 ft., Value,	100.00
(18)	Total improvements "H" lode,	500.00

Survey No. 21  
Improvements Con

"I" lode.		
No. 1	Discovery cut 4x12x10 ft brs from Cor. No. 4 N. 79° 50' E. 493 ft., Value,	\$100.00
No. 2	Open cut 4x12x10 ft brs from Cor. No. 4, N. 82° 22' E. 500 ft., Value,	100.00
No. 3	Open Cut 4x12x10 ft brs from Cor. No. 3, S. 30° 40' E. 370 ft., Value,	100.00
No. 4	Open Cut 4x12x10 brs from Cor. No. 3 S. 32° 30' E. 364 ft Value	100.00
No. 5	Open Cut 4x12x10 ft brs from Cor. No. 3, S. 33° 40' E. 360 ft. Value,	<u>100.00</u>
Total improvements "I" lode.		\$500.00
"Pig Iron No. 3" lode.		
No. 1	Discovery shaft 4x6x36 ft brs from Cor. No. 2 S. 87° 30' W. 370 ft., Value,	400.00
No. 2	Open Cut 4x12x10 ft brs from Cor. No. 2 S. 86° 22' W. 342 ft., Value,	100.00
No. 3	Open Cut 4x12x10 ft brs from Cor. No. 2, N. 16° 42' W. 445 ft Value	<u>100.00</u>
No. 4	Total improvements Pig Iron No. 3 lode, 600.00	
"Dubacher,"		
No. 1	Discovery cut and tunnel. open cut 4x8x8 ft and tunnel 4x6x32 ft brs N. 30° W center of mouth of open cut brs from Cor. No. 3 S 24° 25' E. 388 ft., Value	\$370.00
No. 2	Open Cut and tunnel, open cut 4x6x12 ft and tunnel 4x6x24 ft bearing S. 70° E. center of mouth of open cut brs from Cor. No. 4 N. 30° 22' E. 408 ft Value	<u>1040.00</u>
Total improvements Dubacher lode		1410.00
"Helvetia"		
No. 1	Discovery cut 4x12x10 ft brs from Cor. No. 1 N. 6° 45' E. 800 ft., Value,	100.00
No. 2	shaft 4x6x17 ft brs from Cor. No. 1 N. 7° 15' E 480 ft Value,	170.00

*cut*

*cut*

Improvements (Con)

Helvetia (Con)

No. 3	Open Cut 4x12x9 ft brs from Cor.No.1 N. 6° 20' E 475 ft., Value,	\$100.00
No. 4	Shaft and drift, shaft 4x6x70 ft from bottom of which runs a drift 4x6x30 ft brg. N. 50° W. shaft brs from Cor.No.1 N. 15° 40' E 437 ft Value,	1100.00
No. 5	Open Cut 4x12x10 ft brs from Cor.No.1 N. 9° E. 164 ft., Value,	100.00
No. 6	Open Cut 4x12x10 ft brs from Cor.No.1 N. 15° 15' E. 112 ft Value,	<u>100.00</u>
Total improvements Helvetia lode,		<u>1670.00</u>
Total improvements on group		<u>\$8230.00</u>

Unsurveyed ADJOINING CLAIMS.

North claims and owners unknown

East Paragon lode, Survey No. 1715, Cochise Copper Co. owner,  
Baltimore Survey No. 2071. James H. Bell owner;  
Unsurveyed claims, Winwood, et al owners;

South Paragon, Carolina, Key to the Sitation and Red Hill lodes  
Survey No. 1715, Cochise Copper Co owners.  
Northern Light lode, Survey No. 1812, Donald MacPhun  
owner;

West Red Hill Survey No. 1715, Cochise Copper Co owners  
High Flyer, Survey No. 1681, Donald MacPhun owner.  
Survey No  
Northern Light 1812, Donald MacPhun owner.  
Unsurveyed ground, claims and owners unknown.

LOCATION.

This survey is located about 2 mi in a NE direction  
from the City of Bisbee in Dubacher canyon on unsurveyed  
lands in the Warren Mining District, Cochise County, Arizo-  
na, in approximate T<sub>23</sub> S R 24 E G & S R E &

# FINAL OATHS FOR SURVEYS.

## LIST OF NAMES.

A list of the names of the individuals employed by H.N. Jorgensen

United States Deputy Mineral Surveyor, to assist in running, measuring, and marking the lines, corners, and boundaries described in the foregoing field notes of the survey of the mining claim of.....

J.B. Anderson and J.M. Muhlem  
known as the A, B, C, D, E, H, I, J, K, Pig Iron #3, Helvetia, Dubacher.  
and showing the respective capacities in which they acted.

Frank Rafath ..... Chairman.  
....., Chairman.  
....., Axman.  
....., Flagman.

## FINAL OATHS OF ASSISTANTS.

Frank Rafath.....

and..... do solemnly swear that we assisted.....

H.N. Jorgensen, United States Deputy Mineral Surveyor, in marking the corners and surveying the boundaries of the mining claim of J.B. Anderson and J.M. Muhlem

known as the A, B, C, D, E, H, I, J, K, Pig Iron #3, Helvetia Dubacher.

represented in the foregoing field notes as having been surveyed by said deputy mineral surveyor and under his direction; and that said survey has been in all respects, to the best of ~~my~~ knowledge and belief, faithfully and correctly executed, and the corner and boundary monuments established according to law and the instructions furnished by the United States Surveyor-General for Arizona

Frank Rafath ..... Chairman.  
....., Chairman.  
....., Axman.  
....., Flagman.

Subscribed and sworn to by the above-named persons before me this 1st

day of August, 1905.

Wm. Smith  
NOTARY PUBLIC  
In and for the County of Cochise, Territory of Arizona  
My Commission Expires March 21, 1906.

FINAL OATH OF U. S. DEPUTY MINERAL SURVEYOR

I, H. N. Jorgensen, U. S. Deputy Mineral Surveyor, do solemnly swear that, in pursuance of instructions received from the United States Surveyor General for Arizona, dated

June 22 1905, I have, in strict conformity to the laws of the United States, the official regulations and instructions thereunder, and the instructions of said Surveyor General, faithfully and correctly executed the survey of the Mining Claim of J. B. Anderson and J. M. Muehler

, known as the A, B, C, D, E, H, I, J, K. Peg Iron #3, Helvetia, Dubacher situate in Warren Mining District,

Cochise County, Arizona, in Section unsurveyed, Township No. 23 S, Range No. 24 E, S & S R. B & M. and designated as Survey No. 2121

, as represented in the foregoing field notes, which accurately show the boundaries of said mining claim as distinctly marked by monuments on the ground, and described in the attached copy of the location certificate, which was received by me from the Surveyor General with said instructions, and that all the corners of said survey have been established and perpetuated in strict accordance with the law, official regulations and instructions thereunder; and I do further solemnly swear that the foregoing are the true and original field notes of said survey and my report therein, and that the labor expended and improvements made upon said mining claim by claimants or their grantors are as therein fully stated, and that the character, extent, location and itemized value thereof are specified therein with particularity and full detail, and that no portion of said labor or improvements so credited to this claim has been included in the estimate of expenditures upon any other claim.

H. N. Jorgensen  
U. S. Deputy Mineral Surveyor.

Subscribed and sworn to by the said H. N. Jorgensen  
U. S. Deputy Mineral Surveyor, before me Caro E. Smith  
this 16<sup>th</sup>  
day of August 1905,

Caro E. Smith  
Notary Public.  
I am and for the County of Cochise, Territory of Ariz.  
My Commission Expires March 21, 1906.

Affidavit of Five Hundred Dollars Improvements.

We, J.A. Sherwood and J.T. Toland

of lawful age, being first duly sworn according to law, depose and say: That we are acquainted with the A, B, C, D, E, H, I, J, K, Pig Iron #3, Helvetic, Disbacher mining claim, situate in Wannan mining district, Cochise County, Arizona Territory, for which

J.M. Muhlem and J.B. Anderson

have made application for survey prior to application for patent under the provisions of the Act of Congress approved May 10, 1872; and that the labor done and improvements made thereon by the applicant and the grantor exceed five hundred dollars in value, <sup>for each claim</sup> and further that we are not personally interested in said mine.

J.A. Sherwood  
J.T. Toland

TERRITORY OF ARIZONA,  
COUNTY OF \_\_\_\_\_ } ss:

Sworn to and subscribed before me this 16 day

[SEAL.]

of August, 1905.

Coro E. Smith

17171b400-3-05

NOTARY PUBLIC  
My Commission Expires March 21, 1908.

AMENDED  
Notice of Mining Location

LODE CLAIM

27

To All Whom it May Concern:

This Mining Claim, the name of which is the H  
Mining Claim, situate on lands belonging to the United States of America, and in which there  
are valuable mineral deposits, was entered upon and located for the purposes of exploration and

purchase by John B. Anderson and Joseph M. Muheim administrators  
of the estate of A. Muheim, deceased, citizens of the United States.  
(Locator must insert either "a citizen of the United States," or, "who has declared his intention to become a citizen of the United States.")

the undersigned, on the 4th day of May 1905.

The length of this claim is 1500 feet,  
and we claim 100 feet,

in a southerly direction and 1400

feet in a northerly direction from  
the center of the discovery shaft, at which this notice is posted, lengthwise of the claim, together  
with 300 feet in width of the surface grounds, on each

side of the center of said claim. The general course of the lode deposit and premises is from the  
north to the south

The claim is situated and located in the Warren Mining District, in  
Cochise County, in the Territory of Arizona, about 1 1/4 miles  
in a northeasterly direction from the Holbrook shaft of  
the Copper Queen Co., and is bounded on the west  
side by the B. C. and E. claims.

The surface boundaries of the claim are marked upon the ground as follows: Beginning at  
a monument of stones

at a point in a Southerly direction 100 feet from  
the discovery shaft (at which this notice is posted), being in the center of the south  
end line of said claim; thence easterly 300 feet to a monument  
of stones, being the Southeast corner of said claim; thence  
northerly 1500 feet to a monument of stones, being at the  
northeast corner of said claim; thence westly 300 feet  
to a monument of stones at the center of the north end of said claim;  
thence westly 300 feet to a monument of stones being at the  
northwest corner of said claim; thence southerly 1500  
feet to a monument of stones at the Southwest corner of said claim;  
thence easterly 300 feet to the place of beginning.

All done under the provisions of Chapter Six, of Title XXXII, of the Revised Statutes of  
the United States, and of an Act of the General Assembly of Arizona, entitled "An Act to  
Revise and Codify the Laws of the Territory of Arizona," approved March 16, 1901.

This is an Amended Location Notice of the H  
Mining Claim, located by John B. Anderson and A. Muheim  
March 1903, and recorded in Book 23 of Record of Mines, at  
pages 571, in the office of the County Recorder of the aforesaid County of Cochise  
to which reference is hereby made, and this amended Location Notice is made and posted to  
correct errors in the description in the said original Location Notice.

Dated and posted on the ground this 4th day of May 1905.

John B. Anderson  
Joseph M. Muheim as administrator of the estate of Antonio Muheim, deceased

TERRITORY OF ARIZONA,  
County of..... } ss

I,..... County Recorder in and for the County and  
Territory aforesaid, do hereby certify that the within instrument was filed for record at..... o'clock,..... M.,  
on this..... day of..... 190..., and duly recorded in Book No.....  
of..... Records of..... County, Arizona, at pages.....  
WITNESS my hand and official seal the day and year first above written.

County Recorder.

AMENDED  
Notice of Location.  
LODE CLAIM.

.....  
.....  
.....  
.....

Dated..... 190.....

Filed and recorded at the request of

.....  
.....

A. D. 190.....

at..... M.

Book.....

Page.....

County Recorder.

By.....

Deputy Recorder.

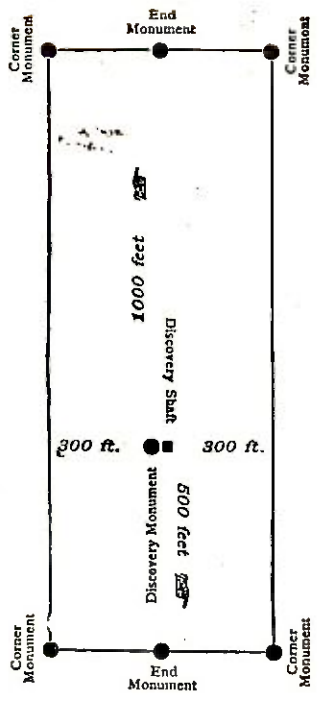

This diagram is to give locator a general idea of plan of location under the new law. The Discovery Shaft can be in the center of claim or any distance from either end desired. In the diagram it is placed 500 feet from one end and 1000 feet from the other. Commence description of claim at a center end monument, giving its distance and direction from center of Discovery Shaft; thence bound the claim in either direction. In description be careful to state locality of claim with reference to some natural object, or permanent monument, as will identify the claim.



Territory of Arizona, {  
County of Cochise, { ss.

I, Frank Hara, County Recorder in and for said county, hereby certify that I have compared the foregoing copy with the Amended Location Notice of the H Mining Claim, filed and recorded in my office on the 3rd day of June, 1905, in Book 34, at page 165, Record of Mines, and that the same is a full, true and correct copy of such original and of the whole thereof.

Witness my hand and seal of office this 5th day of June, 1905.

*Frank Hara*  
County Recorder.

# Notice of Mining Location

## LODE CLAIM

To All Whom It May Concern:

This Mining Claim, the name of which is the D  
Mining Claim, situate on lands belonging to the United States of America, and in which there  
are valuable mineral deposits, was entered upon and located for the purposes of exploration and  
purchase by John B. Anderson, A. Muhlem

(Locator must insert either "a citizen of the United States," or, "who has declared his intention to become a citizen of the United States.")

the undersigned, on the 23 day of March 1903.

The length of this claim is 1500 feet,  
and we claim 25 feet,

in a easterly direction and 1475  
feet in a westerly direction from

the center of the discovery shaft, at which this notice is posted, lengthwise of the claim, together  
with 300 feet in width of the surface grounds, on each

side of the center of said claim. The general course of the lode deposit and premises is from the  
east to the west

The claim is situated and located in the Warren Mining District, in  
Cochise County, in the Territory of Arizona, about 1 1/2 miles  
in a northeasterly direction from the Hol Brook Shaft  
in the Dubacher Canyon on the north east side  
of No. 1.

The surface boundaries of the claim are marked upon the ground as follows: Beginning at

a monument of stone.

at a point in a easterly direction 25 feet from  
the discovery shaft (at which this notice is posted), being in the center of the east  
end line of said claim; thence southerly 300 feet to a monument  
of stone, being the southeast corner of said claim; thence  
westerly 1500 feet to a monument of stone, being at the  
southwest corner of said claim; thence northerly 300 feet  
to a monument of stone at the center of the west end of said claim;  
thence northerly 300 feet to a monument of stone, being at the  
north west corner of said claim; thence easterly 1500  
feet to a monument of stone at the north east corner of said claim;  
thence 300 feet to the place of beginning.

All done under the provisions of Chapter Six, of Title XXXII, of the Revised Statutes on  
the United States, and of an Act of the General Assembly of Arizona, entitled "An Act to  
Revise and Codify the Laws of the Territory of Arizona," approved March 16, 1901.

Dated and posted on the ground this 23 day of March 1903

John B. Anderson  
A. Muhlem

Filed and recorded at request of John B. Anderson, Mch. 27, 1903  
at 9 a.m. Book 23, page 507, Record of Mines

TERRITORY OF ARIZONA,  
County of..... } ss.

I..... County Recorder in and for the County and Territory aforesaid, do hereby certify that the within instrument was filed for record at..... o'clock..... M., on this..... day of..... 190..., and duly recorded in Book No..... of..... Records of..... County, Arizona, at pages.....  
WITNESS my hand and official seal the day and year first above written.

County Recorder.

# Notice of Location

## LODE CLAIM

Dated..... 190.....

Filed and Recorded at request of.....

A. D. 190.....

at..... M.

Book.....

Pages.....

County Recorder.

By.....

Deputy Recorder.

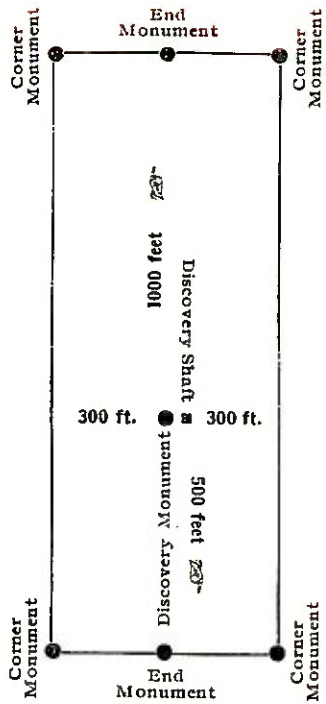

This diagram is to give locator a general idea of plan of location under the new law. The Discovery Shaft can be in the center of claim or any distance from either end desired. In the diagram it is placed 500 feet from one end and 1000 feet from the other. Commence description of claim at a center end monument, giving its distance and direction from center of Discovery Shaft; thence bound the claim in either direction. In description be careful to state locality of claim with reference to some natural object, or permanent monument, as will identify the claim.

Territory of Arizona, (   
 County of Cochise. ( ss. )

I, Frank Haro, County Recorder in and for said County, hereby certify that I have compared the foregoing copy with the original Location Notice of the D Mining Claim, filed and recorded in my office on the 27 day of March 1903, in Book 23, at page 507, Record of Mines, and that the same is a full, true and correct copy of such original and of the whole thereof.

Witness my hand and seal of office this 5th day of June, 1905.

Frank Haro  
 County Recorder.

# Notice of Mining Location

## LODE CLAIM

To All Whom it May Concern:

This Mining Claim, the name of which is the C  
Mining Claim, situate on lands belonging to the United States of America, and in which there are valuable mineral deposits, was entered upon and located for the purposes of exploration and purchase by John B. Anderson and Joseph M. Muhlem administrator of estate of A. Muhlem deceased Citizens of the United States  
(Locator must insert either "a citizen of the United States," or, "who has declared his intention to become a citizen of the United States.")

the undersigned, on the 4th day of May 1905

The length of this claim is 1500 feet,  
and we claim 200 feet,

in a n. easterly direction and 1300  
8 feet in a westerly direction from  
the center of the discovery shaft, at which this notice is posted, lengthwise of the claim, together  
with 300 feet in width of the surface grounds, on each  
side of the center of said claim. The general course of the lode deposit and premises is from the  
east to the west

The claim is situated and located in the Warren Mining District, in  
Cochise County, in the Territory of Arizona, about 1 1/4 miles  
in a northeasterly direction from the Holbrook shaft of  
the Copper Queen Co. It lies in Dubacher Canyon  
and is bounded on the south side by the B claim

The surface boundaries of the claim are marked upon the ground as follows: Beginning at  
a monument of stones

at a point in a n. easterly direction 200 feet from  
the discovery shaft (at which this notice is posted), being in the center of the east  
end line of said claim; thence northerly 300 feet to a monument  
of stones, being the northeast corner of said claim; thence  
westerly 1500 feet to a monument of stones, being at the  
northwest corner of said claim; thence southerly 300 feet  
to a monument of stones at the center of the west end of said claim;  
thence southerly 300 feet to a monument of stones being at the  
southwest corner of said claim; thence easterly 1500  
feet to a monument of stones at the southeast corner of said claim;  
thence northerly 300 feet to the place of beginning.

All done under the provisions of Chapter Six, of Title XXXII, of the Revised Statutes of the United States, and of an Act of the General Assembly of Arizona, entitled "An Act to Revise and Codify the Laws of the Territory of Arizona," approved March 16, 1901.

This is an Amended Location Notice of the C  
Mining Claim, located by John B. Anderson and A. Muhlem  
on the 23rd day of  
March 1903, and recorded in Book 23 of Record of Mines, at  
page 506, in the office of the County Recorder of the aforesaid County of Cochise  
to which reference is hereby made, and this amended Location Notice is made and posted to  
correct errors in the description in the said original Location Notice.

Dated and posted on the ground this 4th day of May 1905

John B. Anderson  
Joseph M. Muhlem administrator of estate of Anton Muhlem, deceased.

Filed and recorded at request of J. M. O'Connell Jan. 3, 1905 at  
2 P. M. Book 34 page 163, Record of Mines.

TERRITORY OF ARIZONA,  
County of..... } ss

I,..... County Recorder in and for the County and Territory aforesaid, do hereby certify that the within instrument was filed for record at..... o'clock,..... M., on this..... day of..... 190..., and duly recorded in Book No..... of..... Records of..... County, Arizona, at pages.....

WITNESS my hand and official seal the day and year first above written.

County Recorder.

AMENDED  
Notice of Location.  
LODE CLAIM.

.....  
.....  
.....  
.....

Dated..... 190.....

Filed and recorded at the request of

.....  
.....

..... A. D. 190.....

at..... M.

Book.....

Page.....

..... County Recorder.

By..... Deputy Recorder.

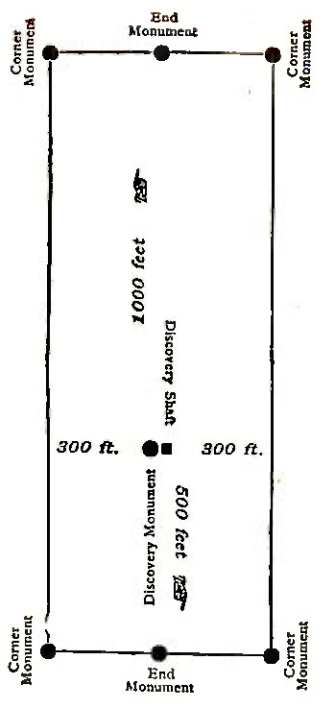

This diagram is to give locator a general idea of plan of location under the new law. The Discovery Shaft can be in the center of claim or any distance from either end desired. In the diagram it is placed 500 feet from one end and 1000 feet from the other. Commence description of claim at a center end monument, giving its distance and direction from center of Discovery Shaft; thence bound the claim in either direction. In description be careful to state locality of claim with reference to some natural object, or permanent monument, as will identify the claim.

Territory of Arizona, {  
 Court of Cochise, {ss.

I, Frank Hare, County Recorder in and for said county, hereby certify that I have compared the foregoing copy with the Amended Location Notice of the \_\_\_\_\_ C Mining Claim, filed and recorded in my office on the 3rd day of June, 1905, in Book 34, at page 163, Record of Mines, and that the same is a full, true and correct copy of such original and of the said records.

Witness my hand and seal of office this 8th day of June, 1905.

*Frank Hare*

County Recorder.

# Notice of Mining Location

4  
33

## LODE CLAIM

To All Whom It May Concern:

This Mining Claim, the name of which is the B  
Mining Claim, situate on lands belonging to the United States of America, and in which there are valuable mineral deposits, was entered upon and located for the purposes of exploration and purchase by John B. Anderson, A. Muhlem

(Locator must insert either "a citizen of the United States," or, "who has declared his intention to become a citizen of the United States.")

the undersigned, on the 23 day of March 1903.

The length of this claim is 1500 feet,  
and we claim 1490 feet,  
in a easterly direction and 10

7 feet in a westerly direction from  
the center of the discovery shaft, at which this notice is posted, lengthwise of the claim, together  
with 300 feet in width of the surface grounds, on each

side of the center of said claim. The general course of the lode deposit and premises is from the  
easterly to the westerly

The claim is situated and located in the Warren Mining District, in  
Cochise County, in the Territory of Arizona, about 1 1/2 miles  
in a northeasterly direction from the Hol Brook Shaft in  
the Dubachert Canyon over west end is at the  
patented stake of Mr Phouns Claim

The surface boundaries of the claim are marked upon the ground as follows: Beginning at

a monument of stones

at a point in a westerly direction 10 feet from  
the discovery shaft (at which this notice is posted), being in the center of the west  
end line of said claim; thence southerly 300 feet to a monument  
of stone, being the south west corner of said claim; thence  
easterly 1500 feet to a monument, being at the  
south east corner of said claim; thence northerly 300 feet  
to a monument of stone at the center of the east end of said claim;  
thence northerly 300 feet to a monument, being at the  
north east corner of said claim; thence westerly 1500  
feet to a monument of stone at the north west corner of said claim;  
thence 300 feet to the place of beginning.

All done under the provisions of Chapter Six, of Title XXXII, of the Revised Statutes of  
the United States, and of an Act of the General Assembly of Arizona, entitled "An Act to  
Revise and Codify the Laws of the Territory of Arizona," approved March 16, 1901.

Dated and posted on the ground this 23 day of March 1903

John B. Anderson  
A. Muhlem

Filed and recorded at request of John B. Anderson, Mch. 27, 1903,  
at 9 A. M. Book 23, page 505, Record of Mines.





Territory of Arizona, {  
 County of Cochise. {ss.

I, Frank Hare, County Recorder in and for said County, hereby certify that I have compared the foregoing copy with the original Location Notice of the B Mining Claim, filed and recorded in my office on the 27 day of March 1903, in Book 23, at page 505, Record of Mines, and that the same is a full, true and correct copy of such original and of the whole thereof.

Witness my hand and seal of office this 6th day of June, 1905.

*Frank Hare*  
 County Recorder.

# Notice of Mining Location

35

## LODE CLAIM

To All Whom It May Concern:

This Mining Claim, the name of which is the A  
Mining Claim, situate on lands belonging to the United States of America, and in which there  
are valuable mineral deposits, was entered upon and located for the purposes of exploration and  
purchase by John B. Anderson, A. Muhleisen

(Locator must insert either "a citizen of the United States," or, "who has declared his intention to become a citizen of the United States.")  
the undersigned, on the 23 day of March 1903.

The length of this claim is 1500 feet,  
and we claim 10 feet,  
in a easterly direction and 1490  
7 feet in a westerly direction from  
the center of the discovery shaft, at which this notice is posted, lengthwise of the claim, together  
with 300 feet in width of the surface grounds, on each  
side of the center of said claim. The general course of the lode deposit and premises is from the

easterly to the Westerly  
The claim is situated and located in the Warren Mining District, in  
Cochise County, in the Territory of Arizona, about 1 1/2 mile  
in a north easterly direction from the Holbrook shaft in  
the Dubachet Canyon about 300 feet from the  
patented claim of McPherson

The surface boundaries of the claim are marked upon the ground as follows: Beginning at

a monument of stone  
at a point in a easterly direction 10 feet from  
the discovery shaft (at which this notice is posted), being in the center of the east  
end line of said claim; thence 300 feet to a monument  
of stone, being the north east corner of said claim; thence  
westerly 1500 feet to a monument of stone, being at the  
northwest corner of said claim; thence southerly 300 feet  
to a monument of stone at the center of the west end of said claim;  
thence Southerly 300 feet to a monument of stone, being at the  
south west corner of said claim; thence easterly 1500  
feet to a monument of stone at the southeast corner of said claim;  
thence northerly 300 feet to the place of beginning.

All done under the provisions of Chapter Six, of Title XXXII, of the Revised Statutes of  
the United States, and of an Act of the General Assembly of Arizona, entitled "An Act to  
Revise and Codify the Laws of the Territory of Arizona," approved March 16, 1901.

Dated and posted on the ground this 23 day of March 1903.

John B. Anderson  
A. Muhleisen

Filed and recorded at request of John B. Anderson, March 27, 1903 at  
9 a.m. Book 23, Page 504, Record of Mines.

TERRITORY OF ARIZONA,  
 County of..... } ss.

I,..... County Recorder in and for the County and Territory aforesaid, do hereby certify that the within instrument was filed for record at..... o'clock,..... M., on this..... day of..... 190... and duly recorded in Book No..... of..... Records of..... County, Arizona, at pages.....

WITNESS my hand and official seal the day and year first above written.

County Recorder.

# Notice of Location

## LODE CLAIM

Dated..... 190.....

Filed and Recorded at request of.....

A. D. 190.....

at..... M.

Book.....

Pages.....

County Recorder.

By.....

Deputy Recorder.

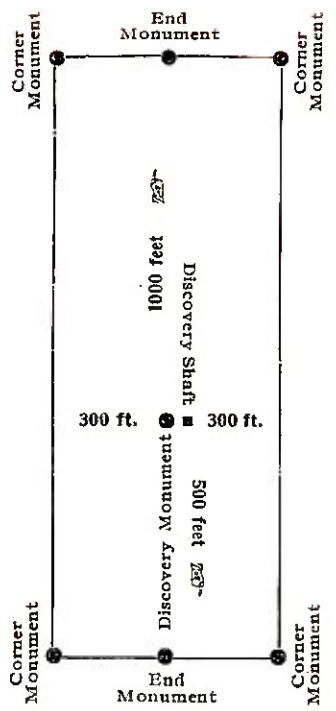

This diagram is to give locator a general idea of plan of location under the new law. The Discovery Shaft can be in the center of claim or any distance from either end desired. In the diagram it is placed 500 feet from one end and 1000 feet from the other. Commence description of claim at a center end monument, giving its distance and direction from center of Discovery Shaft; thence bound the claim in either direction. In description be careful to state locality of claim with reference to some natural object, or permanent monument, as will identify the claim.

Territory of Arizona, (  
County of Cochise. (ss.

I, Frank Hare, County Recorder in and for said County, hereby certify that I have compared the foregoing copy with the \_\_\_\_\_ Location Notice of the A Mining Claim, filed and recorded in my office on the 27 day of March 1903, in Book 23 at page 504, Record of Mines, and that the same is a full, true and correct copy of such original and of the whole thereof.

Witness my hand and seal of office this 5th day of June, 1905.

*Frank Hare*  
County Recorder.

AMENDED

# Notice of Mining Location

LODE CLAIM

37

To All Whom it May Concern:

This Mining Claim, the name of which is the I  
 Mining Claim, situate on lands belonging to the United States of America, and in which there  
 are valuable mineral deposits, was entered upon and located for the purposes of exploration and  
 purchase by John B. Anderson and Joseph M. Muhlem, administrator  
 of the estate of A. Muhlem, deceased, Citizens of the United States.  
(Locator must insert either "a citizen of the United States," or, "who has declared his intention to become a citizen of the United States.")

the undersigned, on the 4th day of May 1905.

The length of this claim is 1500 feet,  
 and we claim 400 feet,  
 in a westerly direction and 1100  
feet in a n easterly direction from  
 the center of the discovery shaft, at which this notice is posted, lengthwise of the claim, together  
 with 300 feet in width of the surface grounds, on each  
 side of the center of said claim. The general course of the lode deposit and premises is from the  
east to the west

The claim is situated and located in the Warren Mining District, in  
Cochise County, in the Territory of Arizona, about 2 miles  
 in a northeasterly direction from the Holbrook shaft of  
the Copper Queen Co., It lies near the head of  
Dubacher Canyon and is bounded on the south side  
by the H. claim.

The surface boundaries of the claim are marked upon the ground as follows: Beginning at  
a monument of stones

at a point in a westerly direction 400 feet from  
 the discovery shaft (at which this notice is posted), being in the center of the west  
 end line of said claim; thence southerly 300 feet to a monument  
of stones, being the southwest corner of said claim; thence  
easterly 1500 feet to a monument of stones, being at the  
southeast corner of said claim; thence northerly 300 feet  
 to a monument of stones at the center of the east end of said claim;  
 thence northerly 300 feet to a monument of stones being at the  
northeast corner of said claim; thence westerly 1500  
 feet to a monument of stones at the northwest corner of said claim;  
 thence southerly 300 feet to the place of beginning.

All done under the provisions of Chapter Six, of Title XXXII, of the Revised Statutes of the United States, and of an Act of the General Assembly of Arizona, entitled "An Act to Revise and Codify the Laws of the Territory of Arizona," approved March 16, 1901.

This is an Amended Location Notice of the I  
 Mining Claim, located by John B. Anderson and A. Muhlem  
March 1903, on the 25th day of  
March 1903, and recorded in Book 23 of Record of Mines, at  
 page 512, in the office of the County Recorder of the aforesaid County of Cochise  
 to which reference is hereby made, and this amended Location Notice is made and posted to  
 correct errors in the description in the said original Location Notice.

Dated and posted on the ground this 4th day of May 1905.

John B. Anderson  
Joseph M. Muhlem, administrator of the estate of Anton Muhlem, deceased.

Filed and recorded at request of J. M. O'Connell Jan. 3, 1905 at 2 P. M.  
 Book 34, page 166 Record of Mines

TERRITORY OF ARIZONA,  
County of..... } ss

I,....., County Recorder in and for the County and Territory aforesaid, do hereby certify that the within instrument was filed for record at..... o'clock,..... M., on this..... day of..... 190..., and duly recorded in Book No..... of..... Records of..... County, Arizona, at pages.....

WITNESS my hand and official seal the day and year first above written.

County Recorder.

AMENDED  
**Notice of Location.**  
LODE CLAIM.

.....  
.....  
.....  
.....  
.....

Dated..... 190.....

Filed and recorded at the request of.....

.....  
.....

A. D. 190.....

at..... M.

Book.....

Page.....

County Recorder.

By.....

Deputy Recorder.

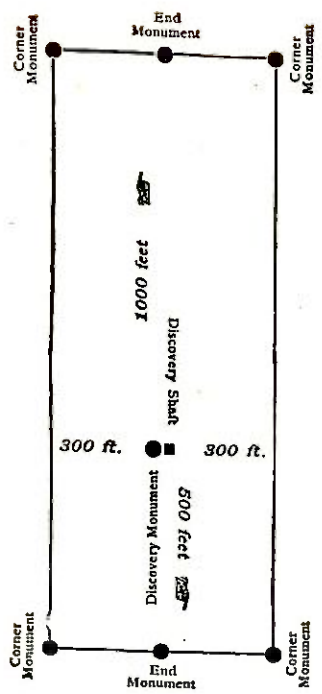

This diagram is to give locator a general idea of plan of location under the new law. The Discovery Shaft can be in the center of claim or any distance from either end desired. In the diagram it is placed 500 feet from one end and 1000 feet from the other. Commence description of claim at a center end monument, giving its distance and direction from center of Discovery Shaft; thence bound the claim in either direction. In description be careful to state locality of claim with reference to some natural object, or permanent monument, as will identify the claim.

Territory of Arizona, {  
County of Coconino. {ss.

I, Frank Hare, County Recorder in and for said County, hereby certify that I have compared the foregoing copy with the Amended Location Notice of the           I           Mining Claim, filed and recorded in my office on the 3rd day of June, 1905, in Book 34 at page, 166, Record of Mines, and that the same is a full, true and correct copy of such original and of the whole thereof.

Witness my hand and seal of office this 5th day of June, 1905.

*Frank Hare*  
County Recorder.



# Notice of Mining Location

7  
39

## LODE CLAIM

To All Whom It May Concern:

This Mining Claim, the name of which is the J  
Mining Claim, situate on lands belonging to the United States of America, and in which there  
are valuable mineral deposits, was entered upon and located for the purposes of exploration and  
purchase by John B. Anderson, A. Muhheim

(Locator must insert either "a citizen of the United States," or, "who has declared his intention to become a citizen of the United States.")

the undersigned, on the 25 day of March 1903.

The length of this claim is 1500 feet,  
and no claim 20 feet,

in a easterly direction and 1480  
feet in a westerly direction from

the center of the discovery shaft, at which this notice is posted, lengthwise of the claim, together  
with 300 feet in width of the surface grounds, on each

side of the center of said claim. The general course of the lode deposit and premises is from the  
east to the west

The claim is situated and located in the Warren Mining District, in  
Cochise County, in the Territory of Arizona, about 1 1/3 miles

in a northeasterly direction from Holbrook Shaft in  
the Dubachet Canyon running parallel with D.

The surface boundaries of the claim are marked upon the ground as follows: Beginning at

a monument of stone

at a point in a easterly direction 20 feet from  
the discovery shaft (at which this notice is posted), being in the center of the east

end line of said claim; thence southerly 300 feet to a monument  
of stone, being the southeast corner of said claim; thence

westerly 1500 feet to a monument of stone, being at the  
southwest corner of said claim; thence northerly 300 feet

to a monument of stone at the center of the west end of said claim;

thence northerly 300 feet to a monument of stone, being at the  
northwest corner of said claim; thence easterly 1500

feet to a monument of stone at the northeast corner of said claim;  
thence 300 feet to the place of beginning.

All done under the provisions of Chapter Six, of Title XXXII, of the Revised Statutes on  
the United States, and of an Act of the General Assembly of Arizona, entitled "An Act to  
Revise and Codify the Laws of the Territory of Arizona," approved March 16, 1901.

Dated and posted on the ground this 25 day of March 1903.

John B. Anderson

A. Muhheim

Filed and recorded at request of John B. Anderson, Mch. 27, 1903  
at 9 a. m. Book 23, page 513, Record of Mines.

TERRITORY OF ARIZONA,  
 County of..... } ss.

I,..... County Recorder in and for the County and  
 Territory aforesaid, do hereby certify that the within instrument was filed for record at..... o'clock,..... M.,  
 on this..... day of..... 190..., and duly recorded in Book No.....  
 of..... Records of..... County, Arizona, at pages.....  
 WITNESS my hand and official seal the day and year first above written.

County Recorder.

# Notice of Location

## LODE CLAIM

Dated..... 190.....

Filed and Recorded at request of

..... A. D. 190.....

at..... M.

Book.....

Pages.....

County Recorder.

By..... Deputy Recorder.

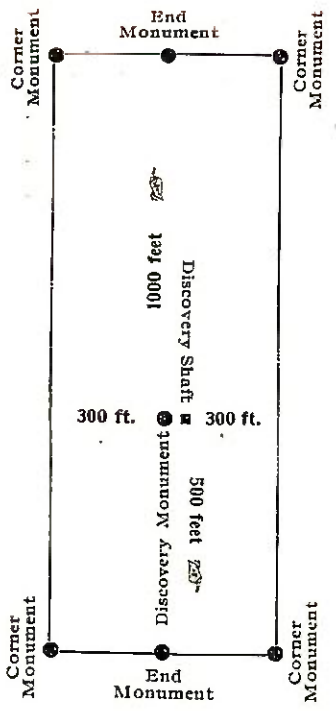

This diagram is to give locator a general idea of plan of location under the new law. The Discovery Shaft can be in the center of claim or any distance from either end desired. In the diagram it is placed 500 feet from one end and 1000 feet from the other. Commence description of claim at a center end monument, giving its distance and direction from center of Discovery Shaft; thence bound the claim in either direction. In description be careful to state locality of claim with reference to some natural object, or permanent monument, as will identify the claim.

Territory of Arizona, (   
 County of Cochise. ( ss.   
 (

I, Frank Hare, County Recorder in and for said County, hereby certify that I have compared the foregoing copy with the original Location Notice of the J Mining Claim, filed and recorded in my office on the 27 day of March 1903, in Book 23, at page 573, Record of Mines, and that the same is a full, true and correct copy of such original and of the whole thereof.

Witness my hand and seal of office this 5th day of June, 1905.

*Frank Hare*  
 County Recorder.

# Notice of Mining Location

## LODE CLAIM

### To All Whom it May Concern:

This Mining Claim, the name of which is the Dubacher Mining Claim, situate on lands belonging to the United States of America, and in which there are valuable mineral deposits, was entered upon and located for the purposes of exploration and purchase by Joseph M. Muheim administrator of the estate of Anton Muheim, deceased, and John B. Anderson, Citizens of the United States.  
(Locator must insert either "a citizen of the United States," or, "who has declared his intention to become a citizen of the United States.")

the undersigned, on the 4th day of May 1905

The length of this claim is 1500 feet,  
 and we claim 300 feet,  
 in a northerly direction and 1200

feet in a southerly direction from  
 the center of the discovery shaft, at which this notice is posted, lengthwise of the claim, together  
 with 300 feet in width of the surface grounds, on each

side of the center of said claim. The general course of the lode deposit and premises is from the  
north to the south

The claim is situated and located in the Warren Mining District, in  
Cochise County, in the Territory of Arizona, about 1 mile  
 in a northeasterly direction from the Holbrook shaft of  
the Copper Queen Co., It lies in Dubacher Canyon and  
adjoins the patented claims "Paragon" and "Carolina"

The surface boundaries of the claim are marked upon the ground as follows: Beginning at  
a monument of stones

at a point in a northerly direction 300 feet from  
 the discovery shaft (at which this notice is posted), being in the center of the north  
 end line of said claim; thence westerly 300 feet to a monument of  
stones, being the northwest corner of said claim; thence  
southerly 1500 feet to a monument of stones being at the  
southwest corner of said claim; thence easterly 300 feet  
 to a monument of stones at the center of the south end of said claim;  
 thence easterly 300 feet to a monument of stones being at the  
southeast corner of said claim; thence northerly 1500  
 feet to a monument of stones at the northeast corner of said claim;  
 thence westerly 300 feet to the place of beginning.

All done under the provisions of Chapter Six, of Title XXXII, of the Revised Statutes of the United States, and of an Act of the General Assembly of Arizona, entitled "An Act to Revise and Codify the Laws of the Territory of Arizona," approved March 16, 1901.

This is an Amended Location Notice of the Dubacher Mining Claim, located by Frank Dubacher and A. Muheim on the 1st day of November 1897, and recorded in Book 14 of Record of Mines, at page 470, in the office of the County Recorder of the aforesaid County of Cochise to which reference is hereby made, and this amended Location Notice is made and posted to correct errors in the description in the said original Location Notice.

Dated and posted on the ground this 4th day of May 1905

Joseph M. Muheim administrator of the estate of Anton Muheim, deceased.  
John B. Anderson

Filed and recorded at request of J. M. O'Connell June 3, 1905 at 2 P.M.  
 Book 34, page 168 Record of Mines.

I, ....., County Recorder in and for the County and Territory aforesaid, do hereby certify that the within instrument was filed for record at ..... o'clock, ..... M., on this ..... day of ..... 190..., and duly recorded in Book No. .... of ..... Records of ..... County, Arizona, at pages .....

WITNESS my hand and official seal the day and year first above written.

.....  
 County Recorder.

AMENDED  
**Notice of Location.**  
 LODE CLAIM.

.....  
 .....

Dated ..... 190.....

Filed and recorded at the request of .....

..... A. D. 190.....

at ..... M.

Book .....

Page .....

.....  
 County Recorder.

By .....  
 Deputy Recorder.

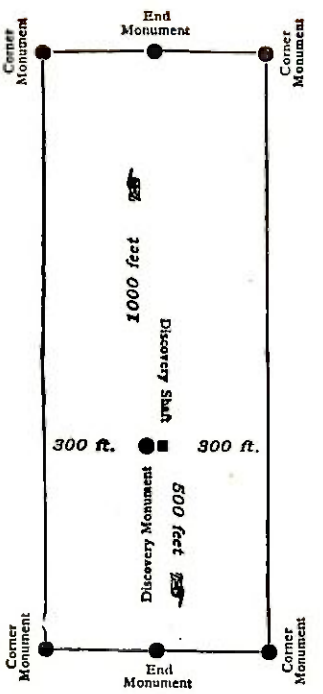

This diagram is to give locator a general idea of plan of location under the new law. The Discovery Shaft can be in the center of claim or any distance from either end desired. In the diagram it is placed 500 feet from one end and 1000 feet from the other. Commence description of claim at a center end monument, giving its distance and direction from center of Discovery Shaft; thence bound the claim in either direction. In description be careful to state locality of claim with reference to some natural object, or permanent monument, as will identify the claim.

# Notice of Mining Location

## LODE CLAIM

To All Whom it May Concern:

This Mining Claim, the name of which is the Dubacher Mining Claim, situate on lands belonging to the United States of America, and in which there are valuable mineral deposits, was entered upon and located for the purposes of exploration and purchase by Joseph M. Muhlem administrator of the estate of Anton Muhlem, deceased, and John B. Anderson, Citizens of the United States.  
(Locator must insert either "a citizen of the United States," or, "who has declared his intention to become a citizen of the United States.")

the undersigned, on the 4th day of May 1905.

The length of this claim is 1500 feet, and we claim 300 feet,

in a northerly direction and 1200

feet in a southerly direction from

the center of the discovery shaft, at which this notice is posted, lengthwise of the claim, together

with 300 feet in width of the surface grounds, on each

side of the center of said claim. The general course of the lode deposit and premises is from the

north to the south

The claim is situated and located in the Warren Mining District, in

Cochise County, in the Territory of Arizona, about 1 mile

in a northeasterly direction from the Holbrook shaft of the Copper Queen Co., it lies in Dubacher Canyon and adjoins the patented claims "Paragon" and "Carolina"

The surface boundaries of the claim are marked upon the ground as follows: Beginning at

a monument of stones

at a point in a northerly direction 300 feet from

the discovery shaft (at which this notice is posted), being in the center of the north

end line of said claim; thence westerly 300 feet to a monument of stones,

being the northwest corner of said claim; thence

southerly 1500 feet to a monument of stones being at the

southwest corner of said claim; thence easterly 300 feet

to a monument of stones at the center of the south end of said claim;

thence easterly 300 feet to a monument of stones being at the

southeast corner of said claim; thence northerly 1500

feet to a monument of stones at the northeast corner of said claim;

thence westerly 300 feet to the place of beginning.

All done under the provisions of Chapter Six, of Title XXXII, of the Revised Statutes of the United States, and of an Act of the General Assembly of Arizona, entitled "An Act to Revise and Codify the Laws of the Territory of Arizona," approved March 16, 1901.

This is an Amended Location Notice of the Dubacher Mining Claim, located by Frank Dubacher and A. Muhlem

on the 1st day of November <sup>1897</sup>/<sub>190</sub>, and recorded in Book 14 of Record of Mines, at page #70, in the office of the County Recorder of the aforesaid County of Cochise to which reference is hereby made, and this amended Location Notice is made and posted to correct errors in the description in the said original Location Notice.

Dated and posted on the ground this 4th day of May 1905.  
Joseph M. Muhlem administrator of the estate of Anton Muhlem, deceased.  
John B. Anderson

*Filed and recorded at request of J. M. O'Connell Jun. 3, 1905 at 2 P.M. Book 34, page 168. Record of Mines.*

TERRITORY OF ARIZONA,  
County of \_\_\_\_\_ } ss

I, \_\_\_\_\_, County Recorder in and for the County and Territory aforesaid, do hereby certify that the within instrument was filed for record at \_\_\_\_\_ o'clock, \_\_\_\_\_ M., on this \_\_\_\_\_ day of \_\_\_\_\_ 190..., and duly recorded in Book No. \_\_\_\_\_ of \_\_\_\_\_ County, Arizona, at pages \_\_\_\_\_

WITNESS my hand and official seal the day and year first above written.  
\_\_\_\_\_  
County Recorder.

AMENDED  
**Notice of Location.**  
LODE CLAIM.

\_\_\_\_\_  
\_\_\_\_\_  
\_\_\_\_\_

Dated \_\_\_\_\_ 190.....

Filed and recorded at the request of \_\_\_\_\_

\_\_\_\_\_  
\_\_\_\_\_ A. D. 190.....

at \_\_\_\_\_ M.

Book \_\_\_\_\_

Page \_\_\_\_\_

County Recorder.

By \_\_\_\_\_

Deputy Recorder.

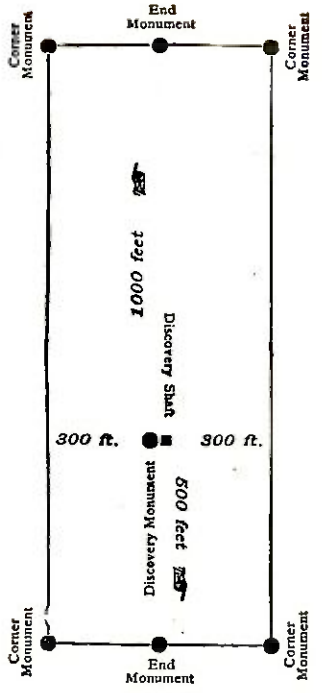

This diagram is to give locator a general idea of plan of location under the new law. The Discovery Shaft can be in the center of claim or any distance from either end desired. In the diagram it is placed 500 feet from one end and 1000 feet from the other. Commence description of claim at a center end monument, giving its distance and direction from center of Discovery Shaft; thence bound the claim in either direction. In description be careful to state locality of claim with reference to some natural object, or permanent monument, as will identify the claim.

Territory of Arizona, {  
County of Cochise. {ss.

I, Frank Hare, County Recorder in and for said County hereby certify that I have compared the foregoing copy with the Amended Location Notice of the Dubacher Mining Claim, filed and recorded in my office on the 3rd day of June, 1905, in Book 34 at page, 168, Record of Mines, and that the same is a full, true and correct copy of such original and of the whole thereof.

Witness my hand and seal of office this 5th day of June, 1905.

*Frank Hare*  
County Recorder.



AMENDED

# Notice of Mining Location

43

LODE CLAIM

To All Whom it May Concern:

This Mining Claim, the name of which is the K  
Mining Claim, situate on lands belonging to the United States of America, and in which there  
are valuable mineral deposits, was entered upon and located for the purposes of exploration and  
purchase by John B. Anderson and Joseph M. Muhlem  
Administrators of the estate of Anton Muhlem, deceased,  
(Locator must insert either "a citizen of the United States," or, "who has declared his intention to become a citizen of the United States.")

the undersigned, on the 4<sup>th</sup> day of May 1905

The length of this claim is 1500 feet,  
and 474 claim 100 feet,

in an Westerly direction and 1400 feet in a Easterly direction from  
the center of the discovery shaft, at which this notice is posted, lengthwise of the claim, together  
with 300 feet in width of the surface grounds, on each  
side of the center of said claim. The general course of the lode deposit and premises is from the  
East to the West

The claim is situated and located in the Warren Mining District, in  
Cochise County, in the Territory of Arizona, about 2 miles  
in a Northeasterly direction from the Coalbrook Shaft of the  
Copper Queen Con Mining Company and is bounded  
on the South side by the G. Mining Claim

The surface boundaries of the claim are marked upon the ground as follows: Beginning at  
Mound of Stones

at a point in a Westerly direction 100 feet from  
the discovery shaft (at which this notice is posted), being in the center of the West  
end line of said claim; thence Southerly 300 feet to a Monument  
of Stones, being the Southeast corner of said claim; thence  
Easterly 1500 feet to a Monument of Stones, being at the  
South East corner of said claim; thence Northerly 300 feet  
to a Monument of Stones at the center of the East end of said claim;  
thence Northerly 300 feet to a Monument of Stones, being at the  
Northeast corner of said claim; thence Westerly 1500  
feet to a Monument of Stones at the Northeast corner of said claim;  
thence Southerly 300 feet to the place of beginning.

All done under the provisions of Chapter Six, of Title XXXII, of the Revised Statutes of  
the United States, and of an Act of the General Assembly of Arizona, entitled "An Act to  
Revise and Codify the Laws of the Territory of Arizona," approved March 16, 1901.

This is an Amended Location Notice of the K  
Mining Claim, located by John B. Anderson and A. Muhlem  
March 1903, and recorded in Book 23 of Record of Mines, at  
page 574, in the office of the County Recorder of the aforesaid County of Cochise  
to which reference is hereby made, and this amended Location Notice is made and posted to  
correct errors in the description in the said original Location Notice.

Dated and posted on the ground this 4<sup>th</sup> day of May 1905

John B. Anderson  
Joseph M. Muhlem  
Administrators of the estate  
of Anton Muhlem, deceased

44

TERRITORY OF ARIZONA,

County of COCHISE

*Frank Star* ss

County Recorder in and for the County and Territory aforesaid,

do hereby certify that the within instrument was filed for record at 4 o'clock P.M.

on this day of JUN 5 1905 190... and duly recorded in Book No.

of MINING Records of COCHISE County, Arizona, at pages

WITNESS my hand and official seal the day and year first above written.

*Frank Star*  
County Recorder.

*Copy -*

AMENDED  
Notice of Location.  
LODE CLAIM.

.....  
.....  
.....  
.....

Dated JUN 5 1905

Filed and Recorded at request of

*Frank Star*  
JUN 5 1905

A. D. 190

at H.P. M

Book

Pages

*Frank Star*

County Recorder.

By Deputy Recorder.

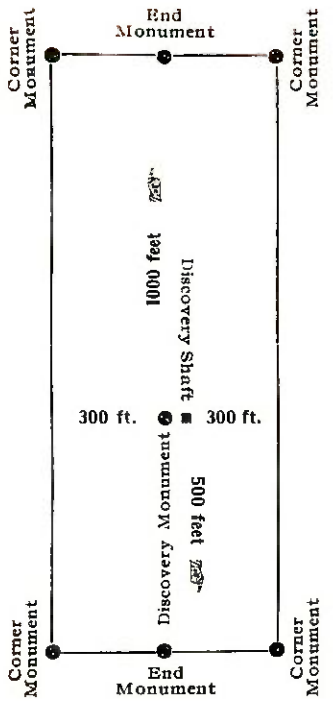

This diagram is to give locator a general idea of plan of location under the new law. The Discovery Shaft can be in the center of claim or any distance from either end desired. In the diagram it is placed 500 feet from one end and 1000 feet from the other. Commence description of claim at a center end monument, giving its distance and direction from center of Discovery Shaft; thence bound the claim in either direction. In description be careful to state locality of claim with reference to some natural object, or permanent monument, as will identify the claim.

Filed and recorded at request of J. M. O'Connell, Jun. 5, 1905 at  
4 P. M. Book 34, page 180, Record of Mines.

Territory of Arizona, (  
County of Cochise. (ss.  
(

I, Frank Hare, County Recorder in and for said County, hereby  
certify that I have compared the foregoing copy with the Amended  
Location Notice of the K Mining Claim, filed and recorded in my office  
on the 5th day of June, 1905, in Book 34, at page 180, Record of  
Mines, and that the same is a full, true and correct copy of such  
original and of the whole thereof.

Witness my hand and seal of office this 6th day of June, 1905.

  
County Recorder.

AMENDED

# Notice of Mining Location

LODE CLAIM

To All Whom it May Concern:

This Mining Claim, the name of which is the Helvetia Mining Claim, situate on lands belonging to the United States of America, and in which there are valuable mineral deposits, was entered upon and located for the purposes of exploration and purchase by Joseph M. Muhlein, administrator of the estate of Anton Muhlein and John B. Anderson, a citizen of the United States.  
(Locator must insert either "a citizen of the United States," or, "who has declared his intention to become a citizen of the United States.")

the undersigned, on the 4th day of May 1905

The length of this claim is 1500 feet, and 1 claim 750 feet, in a northerly direction and 750

feet in a Southerly direction from the center of the discovery shaft, at which this notice is posted, lengthwise of the claim, together with 300 feet in width of the surface grounds, on each

side of the center of said claim. The general course of the lode deposit and premises is from the north to the South

The claim is situated and located in the Warren Mining District, in \_\_\_\_\_ County, in the Territory of Arizona, about 1 mile

in a northeasterly direction from the Helbrook shaft of the Copper Queen Co., It lies in Dubacher Canyon and adjoins the patented claims, Red Hill, Key to the Situation and Highlier

The surface boundaries of the claim are marked upon the ground as follows: Beginning at monument of stones

at a point in a northerly direction 750 feet from the discovery shaft (at which this notice is posted), being in the center of the north end line of said claim; thence westerly 300 feet to a monument of stones, being the Northwest corner of said claim; thence southerly 1500 feet to a monument of stones, being at the southwest corner of said claim; thence easterly 300 feet to a monument of stones at the center of the south end of said claim; thence easterly 300 feet to a monument of stones being at the Southeast corner of said claim; thence northerly 1500 feet to a monument of stones at the northeast corner of said claim; thence westerly 300 feet to the place of beginning.

All done under the provisions of Chapter Six, of Title XXXII, of the Revised Statutes of the United States, and of an Act of the General Assembly of Arizona, entitled "An Act to Revise and Codify the Laws of the Territory of Arizona," approved March 16, 1901.

This is an Amended Location Notice of the Helvetia Mining Claim, located by Joseph Muhlein

on the 3rd day of January <sup>1896</sup> ~~190~~, and recorded in Book 9 of Record of Mines, at page 67-68, in the office of the County Recorder of the aforesaid County of Cochise to which reference is hereby made, and this amended Location Notice is made and posted to correct errors in the description in the said original Location Notice.

Dated and posted on the ground this 4th day of May 1905

Joseph M. Muhlein, administrator of the estate of Anton Muhlein, Deceased.  
John B. Anderson

Filed and recorded at request of J. M. O'Connell Jan. 3, 1905 at 2 P. M.  
Book 34, page 167, Record of Mines.

TERRITORY OF ARIZONA,  
 County of..... } ss

I,..... County Recorder in and for the County and Territory aforesaid, do hereby certify that the within instrument was filed for record at..... o'clock,..... M., on this..... day of..... 190... and duly recorded in Book No..... of..... Records of..... County, Arizona, at pages.....

WITNESS my hand and official seal the day and year first above written.

..... County Recorder.

AMENDED  
**Notice of Location.**  
 LODE CLAIM.

.....  
 .....

Dated..... 190.....

Filed and recorded at the request of

.....

..... A. D. 190.....

at..... M.

Book.....

Page.....

..... County Recorder.

By..... Deputy Recorder.

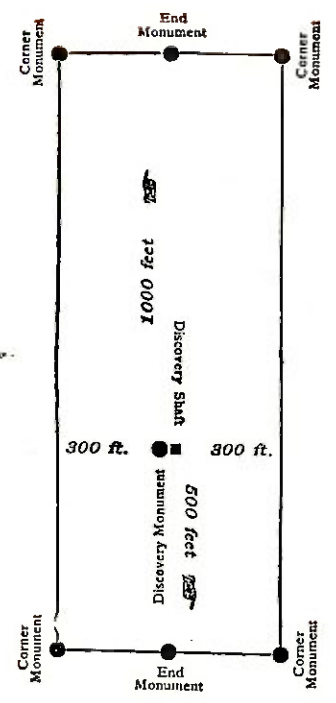

This diagram is to give locator a general idea of plan of location under the new law. The Discovery Shaft can be in the center of claim or any distance from either end desired. In the diagram it is placed 500 feet from one end and 1000 feet from the other. Commence description of claim at a center end monument, giving its distance and direction from center of Discovery Shaft; thence bound the claim in either direction. In description be careful to state locality of claim with reference to some natural object, or permanent monument, as will identify the claim.

Territory of Arizona, (  
County of Cochise. (ss.  
(

I, Frank Hare, County Recorder in and for said County hereby certify that I have compared the foregoing copy with the Amended Location Notice of the Helvetia Mining Claim, filed and recorded in my office on the 3rd day of June, 1905, in Book 34 at page, 167, Record of Mines, and that the same is a full, true and correct copy of such original and of the whole thereof.

Witness my hand and seal of office this 5th day of June, 1905.

*Frank Hare*  
County Recorder.

# Notice of Mining Location

LODE CLAIM

To All Whom it May Concern:

This Mining Claim, the name of which is the E Mining Claim, situate on lands belonging to the United States of America, and in which there are valuable mineral deposits, was entered upon and located for the purposes of exploration and purchase by John B. Anderson and Joseph M. Muheim, administrators of estate of A. Muheim deceased, citizens of the United States. (Locator must insert either "a citizen of the United States," or, "who has declared his intention to become a citizen of the United States.")

the undersigned, on the 4th day of May 1905

The length of this claim is 1500 feet, and we claim 200 feet,

in an easterly direction and 1300

8 feet in a westerly direction from the center of the discovery shaft, at which this notice is posted, lengthwise of the claim, together with 300 feet in width of the surface grounds, on each

side of the center of said claim. The general course of the lode deposit and premises is from the east to the west

The claim is situated and located in the Warren Mining District, in Cochise County, in the Territory of Arizona, about 1 1/4 miles in a northeasterly direction from the Holbrook shaft of the Copper Queen Co. It is in Dubacher Canyon and is bounded on the south by the C. claim.

The surface boundaries of the claim are marked upon the ground as follows: Beginning at a monument of stones

at a point in an easterly direction 200 feet from the discovery shaft (at which this notice is posted), being in the center of the east end line of said claim; thence northerly 300 feet to a monument of stones, being the northeast corner of said claim; thence westerly 1500 feet to a monument of stones, being at the northwest corner of said claim; thence southerly 300 feet to a monument of stones at the center of the west end of said claim; thence southerly 300 feet to a monument of stones, being at the southwest corner of said claim; thence easterly 1500 feet to a monument of stones at the southeast corner of said claim; thence northerly 300 feet to the place of beginning.

All done under the provisions of Chapter Six, of Title XXXII, of the Revised Statutes of the United States, and of an Act of the General Assembly of Arizona, entitled "An Act to Revise and Codify the Laws of the Territory of Arizona," approved March 16, 1901.

This is an Amended Location Notice of the E Mining Claim, located by John B. Anderson and A. Muheim on the 24th day of March 1903, and recorded in Book 23 of Record of Mines, at page 108, in the office of the County Recorder of the aforesaid County of Cochise to which reference is hereby made, and this amended Location Notice is made and posted to correct errors in the description in the said original Location Notice.

Dated and posted on the ground this 4th day of May 1905

John B. Anderson,  
Joseph M. Muheim administrator of the estate of Anton Muheim, deceased.

Filed and recorded at request of J. M. Osbornell, Junr. 3. 1905 at 2 P.M. Book 34 page 164 Record of Mines.

TERRITORY OF ARIZONA,  
 County of..... } ss

I,....., County Recorder in and for the County and  
 Territory aforesaid, do hereby certify that the within instrument was filed for record at..... o'clock,..... M.,  
 on this..... day of..... 190..., and duly recorded in Book No.....  
 of..... Records of..... County, Arizona, at pages.....  
 WITNESS my hand and official seal the day and year first above written.

County Recorder.

AMENDED  
**Notice of Location.**  
 LODE CLAIM.

Dated..... 190.....

Filed and recorded at the request of

..... A. D. 190.....

at..... M.

Book .....

Page.....

County Recorder.

By .....

Deputy Recorder.

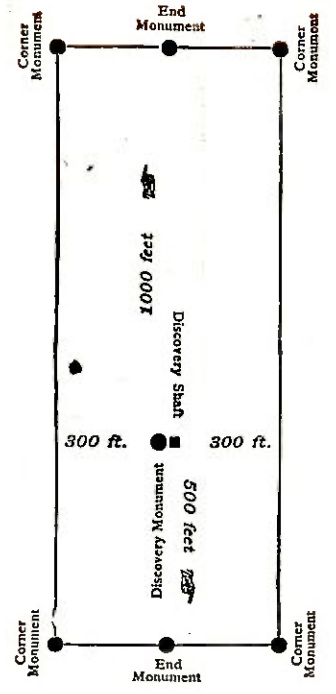

This diagram is to give locator a general idea of plan of location under the new law. The Discovery Shaft can be in the center of claim or any distance from either end desired. In the diagram it is placed 500 feet from one end and 1000 feet from the other. Commence description of claim at a center end monument, giving its distance and direction from center of Discovery Shaft; thence bound the claim in either direction. In description be careful to state locality of claim with reference to some natural object, or permanent monument, as will identify the claim.



Territory of Arizona, {  
County of Cochise, { ss.

I, Frank Hare, County Recorder in and for said county, hereby certify that I have compared the foregoing copy with the Amended Location Notice of the E Mining Claim, filed and recorded in my office on the 3rd day of June, 1905, in Book 34, at page 164, Record of Mines, and that the same is a full, true and correct copy of wuch original and ofthe whole thereof.

Witness my hand and seal of office this 5th day of June, 1905.

*Frank Hare*  
County Recorder.

AMENDED

# Notice of Mining Location

LODE CLAIM

To All Whom it May Concern:

This Mining Claim, the name of which is the Pig Iron # 3 Mining Claim, situate on lands belonging to the United States of America, and in which there are valuable mineral deposits, was entered upon and located for the purposes of exploration and

purchase by John B. Anderson and Joseph M. Muheim, administrators of the estate of Anton Muheim, deceased citizens of the United States.  
(Locator must insert either "a citizen of the United States," or, "who has declared his intention to become a citizen of the United States.")

the undersigned, on the 4th day of May 1905

The length of this claim is 1500 feet, and we claim 300 feet,

in a Southerly direction and 1200

feet in a northerly direction from the center of the discovery shaft, at which this notice is posted, lengthwise of the claim, together with 300 feet in width of the surface grounds, on each

side of the center of said claim. The general course of the lode deposit and premises is from the North to the South.

The claim is situated and located in the Karnes Mining District, in Cochise County, in the Territory of Arizona, about 1 1/2 miles

in a northeasterly direction from the Holbrook shaft of the Copper Queen Co. It adjoins the north end of the "Paragon" claim, patented.

The surface boundaries of the claim are marked upon the ground as follows: Beginning at

monument of stones

at a point in a southerly direction 300 feet from

the discovery shaft (at which this notice is posted), being in the center of the south end line of said claim; thence easterly 300 feet to a monument of stones,

being the southeast corner of said claim; thence northerly 1500 feet to a monument of stones, being at the northeast corner of said claim; thence westerly 300 feet

to a monument of stones at the center of the north end of said claim; thence westerly 300 feet to a monument of stones, being at the

northwest corner of said claim; thence southerly 1500

feet to a monument of stones at the southwest corner of said claim; thence easterly 300 feet to the place of beginning.

All done under the provisions of Chapter Six, of Title XXXII, of the Revised Statutes of the United States, and of an Act of the General Assembly of Arizona, entitled "An Act to Revise and Codify the Laws of the Territory of Arizona," approved March 16, 1901.

This is an Amended Location Notice of the Pig Iron # 3 Mining Claim, located by John B. Anderson, A. Muheim & Frank

Bowman on the 19th day of March 1903, and recorded in Book 23 of Record of Mines, at

page 502, in the office of the County Recorder of the aforesaid County of \_\_\_\_\_ to which reference is hereby made, and this amended Location Notice is made and posted to correct errors in the description in the said original Location Notice.

Dated and posted on the ground this 4th day of May 1905

John B. Anderson  
Joseph M. Muheim, administrator of the estate of Anton Muheim, deceased.

Filed and recorded at request of J. M. O'Connell Jun. 3, 1905 - 2 P. M.  
Book 34, page 169, Record of Mines.

TERRITORY OF ARIZONA,  
 County of..... } ss

I,..... County Recorder in and for the County and  
 Territory aforesaid, do hereby certify that the within instrument was filed for record at..... o'clock,..... M.,  
 on this..... day of..... 190..., and duly recorded in Book No.....  
 of..... Records of..... County, Arizona, at pages.....

WITNESS my hand and official seal the day and year first above written.  
 County Recorder.

AMENDED  
**Notice of Location.**  
 LODE CLAIM.

.....  
 .....

Dated..... 190.....

Filed and recorded at the request of

.....

..... A. D. 190.....

at..... M.

Book.....

Page.....

..... County Recorder.

By..... Deputy Recorder.

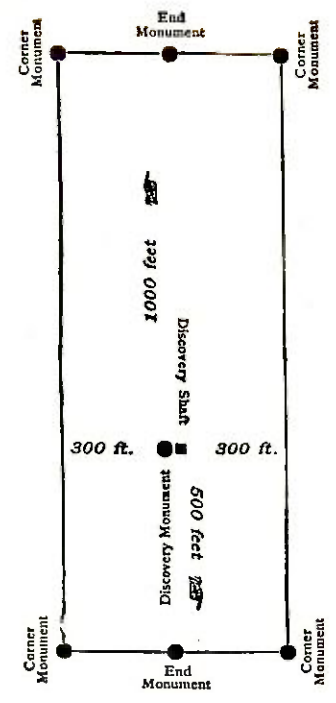

This diagram is to give locator a general idea of plan of location under the new law. The Discovery Shaft can be in the center of claim or any distance from either end desired. In the diagram it is placed 500 feet from one end and 1000 feet from the other. Commence description of claim at a center end monument, giving its distance and direction from center of Discovery Shaft; thence bound the claim in either direction. In description be careful to state locality of claim with reference to some natural object, or permanent monument, as will identify the claim.

Territory of Arizona, {  
 County of Cochise. {ss.

I, Frank Hare, County Recorder in and for said County, hereby certify that I have compared the foregoing copy with the Amended Location Notice of the Pig Iron # 3 Mining Claim, filed and recorded in my office on the 3 day of June 1905, in Book 34 at page 169, Record of Mines, and that the same is a full, true and correct copy of such original and of the whole thereof.

Witness my hand and seal of office this 5th day of June, 1905.

*Frank Hare*  
 County Recorder.

U. S. SURVEYOR-GENERAL'S FINAL CERTIFICATE ON FIELD NOTES.

Department of the Interior,

OFFICE OF U. S. SURVEYOR-GENERAL,

Phoenix, Arizona

Sept 26, 1905

I, U. S. Surveyor-General for Arizona do hereby certify that the foregoing transcript of the Field Notes, return and approval of the survey of the mining claim of J.B. Anderson and J.M. Muheim

known as the A,B,C,D,E,H,I,J,K, Pig Iron No. 3, Helvetia, Dubacher situate in Warren

Mining District, Cochise County, Arizona

in Section, Township No. 23 S., Range No. 24 E. unsurveyed, and designated as Survey No. 2121

has been correctly copied from the originals on file in this office; that said Field Notes furnish such an accurate description of said mining claim as will, if incorporated into a patent, serve fully to identify the premises, and that such reference is made therein to natural objects or permanent monuments as will perpetuate and fix the locus thereof.

And I further certify that five hundred dollars' worth of labor has been expended or improvements made upon each of said mining claims by claimants or their grantors, and that said improvements consist of 4 Shafts, 57 cuts, 3 Tunnels + 1 Drift. Total Value \$8230.00

and that no portion of said labor or improvements has been included in the estimate of expenditures upon any other claim.

I further certify that the plat thereof, filed in the U. S. Land Office at Tucson Arizona is correct and in conformity with the foregoing Field Notes.

( Signed, Frank S. Ingalls,

United States Surveyor-General for Arizona

4-687.

**SURVEYOR-GENERAL'S CERTIFICATE OF APPROVAL OF FIELD  
NOTES AND SURVEY OF MINING CLAIM.**

**Department of the Interior,**

*Office of U. S. Surveyor-General,*

Phoenix, Arizona

Sept. 26 - 1905

I, U. S. Surveyor-General for Arizona

do hereby certify that the foregoing and hereto attached Field Notes and Return of the Survey of the  
Mining Claim of J.B. Anderson and J.M. Muheim

known as the

A, B, C, D, E, H, I, J, K, Pike Iron No. 3, Helvetia, Dubacher

situate in Warren Mining District,

Cochise County, Arizona

in Section , Township No. 23 S., Range No. 24 E. unsurveyed

, designated as Survey No. 2121

executed by H.W. Jorgensen, U. S. Deputy Mineral

Surveyor, June 26 to July 14, 1905, under my instructions dated

June 22, 1905, have been critically examined and the necessary cor-

rections and explanations made, and the said Field Notes and Return, and the Survey they describe,

are hereby approved. A true copy of the copy of the location certificate filed by the applicant for

survey is included in the field notes.

*Frank J. Jorgensen*

U. S. Surveyor-General for Arizona

Feet

Beginning at Cor.No.1, the SE cor identical with location and with Cor.No.4 B lode of this survey, and with Cor.No.2 Northern Light lode, Survey No.1812, a pine post 4 ft long 4 ins sq set 1 ft in the ground in a mound of stones and scribed 1-2121 A L, whence a quartzite cropping 1x1 ft and level with the ground, scribed X-1-2121 A L brs. S. 17° 32' E. 17.06 ft., and a second quartzite cropping 1x1 ft and 4 ins high brs. N. 17° 29' E. 12.28 ft., and U. S. M. M. No.4 brs. S. 1° 0' W. 6198.4 ft.,

Thence N. 24° 02' E.

300.6 to original location for W E C., and Cors.No.3 and 4 respectively of B and C lodes of this survey.

601.1 same bearing to Cor.No.2, the NE cor, identical with location and with Cor.No.1 D lode of this survey, a pine post 4 ft long 4 ins sq set 1 ft in the ground in a mound of stones and scribed 2-2121 A L,

Thence N. 62° 28' W.  
with location and

1500.0 to Cor.No.3, identical with Cor.No.4 B lode of this survey a pine post 4 ft long 4 ins sq set 1 ft in the ground in a mound of stones and scribed 3-2121 A L, whence a quartzite cropping 2x1 ft level with the surface, chiseled X-3-2121 A L, brs N. 26° 30' E. 17.27 ft., and a second quartzite cropping 1x1 ft 6 ins. high, or same chiseling brs. S. 89° 30' W. 14.22 ft.,

Thence S. 34° 02' W.

300.5 to original location for W E C.,

601.1 same bearing to Cor.No.4 the SW cor, identical with location and with Cor.No.3 Northern Light lode, Survey No. 1812, a pine post 4 ft long 4 ins sq set 1 ft in the ground in a mound of stones and scribed 4-2121 A L, whence a a quartzite cropping 2x2 ft level with the surface, chiseled X-4-2121 A L, brs. S. 2° 10' E. 15.20 ft., and a second cropping 1x1 ft 6 ins. high, with same chiseling brs N. 73° 25' W. 10.12 ft.,

Thence S. 62° 28' E.

TRANSCRIBED COPY OF  
ORIGINAL FIELD NOTES

Survey No. 2121

3 Feet

1500.0 to Cor.No.1 the place of beginning.

Ledge.

The presumed course of the vein on this claim is from the W E C location S. 62° 28' E. 1500 ft.

D.

Beginning at Cor.No.1 the SE cor, identical with location and with Cor.No.2 A lode of this survey, a pine post 4 ft long 4 ins sq set 1 ft in the ground in a mound of stones and scribed 1-2121 D L, whence a quartzite cropping 2x1x 6 ins high scribed X-1-2121 DL brs. S. 2° 10' W. 22.13 ft., and a second quartzite cropping 2x2x1 ft with same scribing brs. N. 62° 32' E 19.72 ft., and U. S. M. M. No. 4. brs. S. 3° 0' W. 6755.4

Thence N. 24° 2' E.

300.6 to original location for E E C., and Cors.No.3 and 4 respectively of C&E lodes of this survey,

601.1 same bearing to Cor.No.2, the NE cor, identical with location and with Cor.No.1 J lode, a pine post etc scribed 2-1-2121 D L,

Thence N. 62° 28' W.

1500.0 to Cor.No.3 the NW cor identical with location and with Cor.No.4 J. lode of this survey, a pine post 4 ft long 4 ins sq set 1 ft in the ground in a mound of stones and scribed 3-2121 D.L, whence a quartzite cropping 1x2x1 ft chiseled X-3-2121 D L, brs. S. 42° 46' E. 18.02 ft., and a second quartzite cropping 1x1x6 ins high with same scribing brs. N. 2° 20' E. 1330 ft.,

Thence S. 24° 02' W.

300.5 to original location for W E C.,

601.1 same bearing to Cor.No.4, the SW cor identical with location and with Cor.No.3 A lode of this survey, a pine post etc and scribed 4-3-2121 D L,

Thence S. 62° 28' E.

1500.0 to Cor.No.1 the place of beginning.



TRANSCRIBED COPY OF  
ORIGINAL FIELD NOTES

Survey No 2121

4

Feet

Ledge.

The presumed course of the ledge on this claim is from the W E C., S. 62° 28' E. 1500 ft.

"J"

Beginning at Cor.No.1, the SW cor., identical with location, and with Cor.No.2 "D" lode of this survey a pine post 4 ft long 4 ins sq set 1 ft in the ground in a mound of stones and scribed 1-2121 J L, whence a limestone cropping 1x1x4 ins high scribed X-1-2121 J L brs N. 3° 22' W. 15.3 ft., and a second limestone cropping with the same dimensions and scribing brs. N. 88° E. 22 ft., and U S M M No 4 brs S. 4° 41' W. 7319.9 ft..

Thence N. 24° 02' E.

300.6 to original location for W E C., identical with Cor No 4 and 3 respectively of "K" and "E" lodes of this survey same bearing to Cor.No.2 identical with location a pine post 4 ft long 4 ins sq set 1 ft in the ground in a mound of stones and scribed 2-2121 J L, whence a quartzite cropping 1x1x2 ft high and chiseled X-2-2121 J L brs N 23° 52' E. 12.92 ft., and a second quartzite cropping 1x3 x18 ins high of the same scribing brs. N. 54° W. 33.2 ft.,

Thence N. 6 2° 28' W

1500.0 to Cor.No.3, the NW cor and identical with location a pine post 4 ft long 4 ins sq set 1 ft in the ground in a mound of stones and scribed 3-2121 J L, whence a conglomerate cropping 2x1 ft level with the ground brs. S. 57° 50' W 7.55 ft., and a second cropping of the same dimension and scribing brs. N. 47° 58' W. 48.22 ft.,

Thence S. 24° 02' W.

300.5 to original location for W E C.

601.1 same bearing to Cor.No.4 the SW cor., identical with location and with Cor.No.3 "D" lode of this survey a pine post etc scribed 4-2121 J L,

TRANSCRIBED COPY OF  
ORIGINAL FIELD NOTES

Survey No. 2121

5

Feet

1500.0 Thence S. 62° 28' E  
to Cor.No.1 the place of beginning.

Ledge.

The presumed course of the vein on this claim is  
from the W E C S. 62° 28' E. 1500' ft.,

----- "K" -----

Beginning at Cor.No.1 the SE cor., identical  
with location and with Cor.No.4 "I" lode of this survey  
a pine post 4 ft long 4 ins sq set 1 ft in the ground in  
amound of stones and scribed 1-2121 K L, whence a  
quartzite cropping 1x1x1 ft high and scribed X-1-2121  
K L brs. N. 62° 20' W. 11.2 ft., and a second quartzite  
cropping 2x2 ft 4 ins high of same scribing brs. N.  
32° E 15.2 ft., and U S M M No.4 brs. S. 15° 14' W.  
7211 ft.,

Thence N. 24° 02' E.

300.5 to original location for E E C.,

601.1 same bearing to Cor.No.2, the NE cor., identical with  
location and with Cor.No.3 "I" lode of this survey, a  
pine post 4 ft long 4 ins sq set 1 ft in the ground in a  
mound of stones and scribed 2-2121 K L, whence a limestone  
cropping 2x3x 1 ft high scribed X-2-2121 K L brs N.  
22 ° W. 34.2 ft., and a second cropping 1x1x 6 ins high  
of the same scribing brs. N. 88° E. 21.2 ft.,

Thence N. 62° 28' W.

1325.0 to CorNo 3 the NW cor identical with location a pine  
post 4 ft long 4 ins sq set 1 ft in the ground in a  
mound of stones and scribed 3-2121 K L, whence a  
porphyry cropping 1 ft x15x18 ins. scribed X-3-2121  
K L brs. N. 69° 02' W. 60.5 ft., and a quartzite cropping  
1x1x18 ins high with the same scribing brs. N. 14° 38' W  
84.3 ft.,

TRANSCRIBED COPY OF  
ORIGINAL FIELD NOTES

Survey No. 2121

6

Feet

300.6 Thence S. 24° 02' W.  
to original location for W E C., identical with Cor.No. 2  
"J" lode of this survey,  
601.1 same bearing to Cor.No. 4, the SW cor., identical with  
location and with Cor.No. 3 "E" lode of this survey,  
a pine post 4 ft long 4 ins sq set 1 ft in the ground  
in a mound of stones and scribed 4-2121 K L whence a  
quartzite cropping 2x2x1 ft and chiseled X-4-2121 K L  
brs. S. 60° 10' E. 31.5 ft., and a second quartzite  
cropping of the same dimensions and scribing brs. N. 82°  
3' W 10.2 ft., Thence S. 62° 28' E.  
1217.8 to Cor.No. 4 "I" lode of this survey.  
1325 ft. <sup>same bearing</sup> to Cor.No. 1 the place of beginning.

Ledge

The presumed course of the ledge on this claim is  
from the W E C S 62° 28' E. 1325 ft.

----- E -----

Beginning at Cor.No. 1, the SE cor identical with  
location and with Cor.No. 2 "G" lode of this survey, a  
pine post 4 ft long 4 ins sq set 1 ft in the ground in  
a mound of stones and scribed 1-2121 E L, whence a quartzite  
cropping 2x2 ft 4 ins high and chiseled X-1-2121  
E L brs. N. 2° W. 12.2 ft., and a second quartzite cropping  
1x1x1 ft ft brs S. 62° 28' E. 12 ft., and U.S.M.M.  
No. 4 brs, S. 15° 55' W. 6580.3 ft.,

Thence N. 24° 02' E.

300.5 to original location for E E C.,  
601.1 same bearing to Cor.No. 2 the NE cor identical with location  
and with Cor.No. 3 "H" lode of this survey, a pine  
post 4 ft long 4 ins sq set 1 ft in the ground in a mound  
of stones and scribed 2-2121 E L whence a quartzite cropping  
2x2x1 ft and chiseled X-2-2121 E L brs S. 50° 22' W  
24.3 ft., and a second quartzite cropping 2x2 ft level

TRANSCRIBED COPY OF  
ORIGINAL FIELD NOTES

Survey No. 2121

"E" Con

Feet

with the ground chiseled X-2-2121 E L brs N. 2° W.  
3032.1 ft.,

Thence N. 62° 28' W.

175.0 to Cor No.1 "K" lode of this survey,  
282.2 same bearing to Cor No.4 "I" lode of this survey  
1500.0 same bearing to Cor.No.3, the NW cor identical with lo-  
cation and with CorNo.4 "K" lode of this survey, a pine  
post etc., scribed 3-2121 E L, thence

Thence S. 24° 02' W.

300.6 to original location for W E C., identical with Cor.No  
1 and 2 respectively of "J" and "D" lodes of this survey  
601.1 same bearing to Cor.No.4 the SW cor identical with lo-  
cation and with Cor.No.3 "C" lode of this survey a pine  
post 4 ft long 4 ins sq set 1 ft in the ground in a mound  
of stones and scribed 4-2121 E L, whence a quartzite  
cropping 1x1x2 ft chiseled X-4-2121 E L brs. S. 50° 50' E  
20.2 ft., and a second quartzite cropping of same  
dimensions and chiseling brs. N. 22° E. 17.93 ft.,

Thence S. 62° 28' E.

1500 to Cor.No.1 the place of beginning  
Ledge

The presumed course of the vein on this claim is from the  
W E C S.62° 28' E. 1500 ft

-----"G"-----

Beginning at Cor.No.1 the SE cor identical with lo-  
cation and with Cor.No.4 "H" lode of this survey, a pine  
post 4 ft long 4 ins sq set 1 ft in the ground in a mound  
of stones and scribed 1-2121 C L, whence a quartzite  
cropping 2x2'4 ins high and chiseled X-1-2121 C L brs  
N. 32° 20' E. 50.4 ft., and a second quartzite cropping  
2x2 ft. level with the surface with same chiseling brs  
N. 48° 20' W. 25'3 ft., and U S M M No.4 brs S. 15° 07' W  
5985.8 ft.,

Thence N. 24° 02' E

TRANSCRIBED COPY OF  
ORIGINAL FIELD NOTES

Survey No. 2121

8

Feet

"C" Con. and "B"

300.5 to original location for E E C.,  
601.1 same bearing to Cor.No.2, the NE cor identical with location and with Cor.No.1 "E" lode of this survey, a pine post etc scribed 2-2121 C L,  
Thence N. 62° 28' W.  
1500.0 to Cor.No.3, the NW cor identical with location and with Cor.No.4 "E" lode of this survey a pine post etc scribed 3-2121 C L,  
Thence S. 24° 02' W.  
300.6 to original location for W E C., identical with Cors No.1 and 2 respectively of "D" and "A" lodes of this survey,  
601.1 same bearing to Cor.No.4 the SW cor identical with location and with Cor.No.3 "B" lode of this survey a pine post 4 ft long 4 ins sq set 1 ft in the ground in a mound of stones and scribed 4-2121 C L, whence a quartzite cropping 2x2 ft level with the surface chiseled X-4-2121 C L brs. S. 80° W. 8.2 ft and a second quartzite cropping 1x1 ft high of same chiseling brs. N. 31° 30' E. 19.4 ft  
Thence S. 62° 28' E.  
1325 to Cors No 2 and 5 respectively of "B" and "H" lodes of this survey,  
1500.0 same bearing to Cor.No.1 the place of beginning.  
Ledge.  
The presumed course of the vein on this claim is from the WE C S. 62° 28' E. 1500 ft.  
----- "B" -----  
Beginning at Cor.No.1 the SE cor identical with location and with Cor.No.6 Pig Iron No.3 lode of this survey, a pine post 4 ft long 4 ins sq set 1 ft in the ground in a mound of stones and scribed 1-2121 B L, whence a quartzite cropping 1x1x2 ft chiseled X-1-2121 B L brs  
(7) N. 44° 20' E. 31.2 ft., and a second quartzite cropping

TRANSCRIBED COPY OF  
ORIGINAL FIELD NOTES

Survey No. 2121

9

Feet

"B" con

of same dimensions and chiseling brs. S. 83° 50' W. 27.5 ft  
and U S M M No, 4 brs S. 12° 19' W. 5435.9 ft.,  
Thence N. 24° 02' E.  
300.5 to original location for E E C.,  
310.8 same bearing to Cors No. 5 and 6 respectively of Pig  
Iron No. 3 and "H" lodes of this survey,  
601.1 same bearing to Cor. No. 2, the NE cor identical with loca-  
tion and with Cor. No. 5 "H" lode of this survey, a pine  
post 4 ft long 4 ins sq set 1 ft in the ground in a mound  
of stones and scribed 2-2121 B L whence a quartzite crop-  
ping 2x1x1 ft. chiseled X-2-2121 brs. N. 73° 22' E. 17.3  
ft and a second quartzite cropping 2x3 ft level with the  
surface brs. S. 34° E. 10.8 ft.,  
Thence N. 62° 28' W.  
1325.0 to Cor. No. 3 the NW cor identical with location and with  
Cor. No. 4 "C" lode of this survey a pine post etc scribed  
3-2121 B L,  
Thence S. 24° 02' W.  
500.6 to Cor. No. 4, identical with original location for  
W E C and with Cor. No. 1  
"W" lode of this survey, and Cor. No. 2 Northern Light lode  
Survey No. 1812, a pine post 4 ft long etc scribed 4-2121  
B L,  
Thence S. 13° 36' W  
309.1 to Cor. No. 5 the SW cor identical with location and with  
Cor. No. 3 Helvetia lode of this survey a pine post 4 ft  
long 4 ins sq set 1 ft in the ground in a mound of stones  
and scribed 5-2121 B L, whence a quartzite cropping  
2x2 ft 4 ins high chiseled X-5-2121 B L brs N. 82° 20' E  
15.5 ft and a second quartzite cropping of same chiseling  
and dimensions brs N. 14° 57' W. 16.6 ft.,  
Thence S. 62° 28' E.  
600.0 to Cors No. 2 and 3 respectively of Helvetia and Dubacher  
lodes of this survey,  
1200.0 same bearing to Cors. No. 2 and 7 respectively of Dubacher

TRANSCRIBED COPY OF  
ORIGINAL FIELD NOTES

Survey No. 221

Feet

"B" con. "H"

1268.9 lode and Pig Iron No. 3 lode of this survey,  
same bearing to Cor. No. 1 the place of beginning.  
Ledge.  
The presumed course of the vein on this claim is from the  
W E C S. 62° 28' E. 1325 ft.  
----- "H" -----  
Beginning at Cor. No. 1 the SE cor identical with  
location, and with Cor. No. 4 Pig Iron No. 3 lode of this  
survey, a pine post 4 ft long 4 ins sq set 1 ft in the  
ground in a mound of stones and scribed 1-2121 H L,  
whence a quartzite cropping 1x1 ft and level with the  
ground and chiseled X-1-2121 H L brs. N. 72° 30' W.  
6.35 ft., and a second quartzite cropping 2x3x1 ft of  
same chiseling brs. N. 78° 05' E. 6.6 ft., and U S M M  
No. 4 brs. S. 17° 53' W. 5635.3 ft.,  
Thence N. 34° 14' E.  
1500.0 to Cor. No. 2 the NE cor identical with location and with  
Cor. No. 1 "I" lode of this survey a pine post etc and  
scribed 2-2121 H L  
Thence N. 62° 28' W.  
300.0 to original location for N E C.,  
592.3 same bearing to Cor. No. 3 the NW cor identical with location  
and with Cor. No. 2 "E" lode of this survey a pine post  
etc scribed 3-221 H L,  
Thence S. 24° 02' W.  
601.1 to Cors. No. 1 and 2 respectively of "E" and "C" lodes of this  
survey  
1202.2 same bearing to Cor. No. 4, identical with location and with  
Cor. No. 1 "C" lode of this survey a pine post etc  
scribed 4-2121 H L  
Thence N. 62° 33' W.  
175.0 to Cor. No. 5 identical with location and with Cor. No. 2 "B"  
lode of this survey, a pine post etc scribed 5-2121 H L,  
(9) Thence S. 24° 02' W.

TRANSCRIBED COPY OF  
ORIGINAL FIELD NOTES

Survey No. 2121

11

Feet

"H" lode (con)

Feet

290.3 to Cor. No. 6 the SW cor identical with location and with Cor. No. 5, of Pig Iron No. 3 lode of this survey a pine post 4 ft long 4 ins sq set 1 ft in the ground in a mound of stones and scribed 6-2121 HL whence a quartzite cropping 2x2 ft level with the surface chiseled X-6-2121 H L brs N. 75° 20' E. 31.5 ft and a second quartzite cropping 1x2ft x 4 ins high brs. S. 24° 10' E 24.2 ft.,

Thence S. 62° 28' E

201.2 to original location for S E C.,

501.2 same bearing to Cor. No. 1 the place of beginning.

Ledge.

The presumed course of the vein on this claim is from the S E C N. 34° 14' E. 1500 ft.

----- "I" -----

Beginning at Cor. No. 1 the SE cor identical with location and with Cor. No. 2 "H" lode of this survey a pine post 4 ft long 4 ins sq set 1 ft in the ground in a mound of stones and scribed 1-2121 I L, whence a limestone cropping 2 x2 ft and level with the surface and chiseled X-1-2121 I L brs N. 89° 10' E. 48.2 ft., and a second quartzite cropping of same dimensions and schiseling brs N. 10° 31' W. 27.2 ft., and U. S. M. M. No. 4 brs. S. 21° 18' W. 7087.3 ft.

Thence N 34° 14' E

302.0 to original location for E E C.,

604.1 same bearing to Cor. No. 2 the NE cor identical with location a pine post 4 ft long 4 ins sq set 1 ft in the ground in a mound of stones and scribed 2-2121 I. L, whence a quartzite cropping 2x2x1 ft chiseled X-2-2121 I L brs N. 40° E. 22.75 ft., and second quartzite cropping 8x1x1 ft high of same scribing brs. N. 11° 7' W.

874

302

604

107

282

874

302.1

415.9



Feet

874.5 to Cor.No 3 the NW cor identical with location and with Cor.No 2 "K" lode of this survey a pine post etc scribed 3-2121 I L,  
Thence S. 34° 14' W.

302.1 to original location for W E C.,

604.1 same bearing to Cor.No.4 the SW cor identical with location, a pine post 4 ft long 4 ins sq set 1 ft in the ground in a mound of stones and scribed 4-2121 I L, whence a quartzite cropping 1x3x7 ft brs. N.10°W, 23.2 ft., and a second quartzite cropping of same dimensions and scribing brs N. 48° E. 10.3 ft.,  
Thence S. 62° 28' E.

107.2 to Cor.No.1 "K" lode of this survey

282.2 to Cor.No.2 and 3 respectively of "E" and "H" lodes of this survey

874.5 same bearing to Cor.No.1 the place of beginning.  
Ledge.

The presumed course of the vein on this claim is from the W E C S. 62° 28' E. 874.5 ft.

----- Pig Iron No.3 -----

Beginning at Cor.No.1, the SE cor identical with location on line 1-2 Paragon lode Survey No.1715, a pine post 4 ft long 4 ins sq set 1 ft in the ground in a mound of stones and scribed 1-2121 P I No.3 L, whence a quartzite cropping 2x2x 1ft brs N. 82° 29' E. 9.1 ft, and a second quartzite cropping of same dimensions and chiseling brs N. 87° 30' W. 10.82 ft., and U S M M No. 4 brs S. 15° 54' W. 4701.2 ft.,  
Thence N. 31° 08' E

302.1 to Cor.No.2 Paragon lode, Survey No.1715,

415.9 same bearing to Cor.No.2, identical with location and with Cor.No.3 Baltimore lode Survey No.2071, a pine post 4 ft long 4 ins sq set 1 ft in the ground in a mound of stones and scribed 2-2121 P I No.3 L, whence a quartzite cropping 1x1ft 6 ins high, chiseled X-2-2121 P I No 3 L brs. S. 86° 50' E. 11.76 ft., and a second quartzite cropping 1x1 ft level with the surface of same

(11)

TRANSCRIBED COPY OF  
ORIGINAL FIELD NOTES

13

Survey No. 2121

Fee

Feet

Pig Iron No. 3 L, (Jon)

chiseling brs N. 29° 30' W. 20.8 ft.,  
Thence N. 4° 49' E  
170.6 to Cor. No. 3 identical with location a pine post 4 ft  
long 4 ins sq set 1 ft in the ground in a mound of stones  
and scribed 3-2121 P I No. 3 whence a quartzite cropping  
2x2x1 ft. high chiseled ~~X-3-2121~~<sup>X-3-2121</sup> P I No. 3 L brs N. 56°  
20' W. 5.0 ft., and a second quartzite cropping of the  
same dimensions and schiseling brs. S. 50° 55' E. 6.5 ft  
Thence N. 34° 14' E  
381.3 to Cor. No. 4, identical with location and with Cor. No. 1  
"H" lode of this survey a pine post etc scribed 4-2121  
P I No. 3 L,  
Thence N. 62° 28' W.  
265.1 to original location for N E C.,  
501.2 to Cor. No. 5 the NW cor identical with location and with  
Cor. No. 6 "H" lode of this survey a pine post etc scribed  
5-2121 P I No. 3 L,  
Thence S. 24° 02' W  
310.8 to Cor. No 6 identical with location and with Cor. No. 1  
"B" lode of this survey, a pine post etc scribed  
6-2121 P I No. 3 L,  
Thence N. 62° 28' W.  
68.9 to Cor. No. 7 identical with location and with Cor. No. 2  
Dubacher lode of this survey, a pine post 4 ft long 4  
ins sq set 1 ft in the ground in a mound of stones and  
scribed 7-2121 P I No 3 L, whence a quartzite cropping  
2x2x1 ft bhiseled X-7-2121 P I No. 3 L brs N. 20° 12' E  
14.3 ft., and a second quartzite cropping 2x2 ft level  
with the surface of same chiseling brs. S. 88° 20' W.  
7.3ft.,  
Thence S. 27° 32' W.  
640.9 to Cor. No. 8 the SW cor identical with location, on line  
2-3 Paragon lode, Survey No. 1715 at <sup>S E W 640.8</sup> ~~63.8~~  
ft from Cor. No. 2, a pine post 4 ft long 4 ins sq set 1ft  
(12)

28

54

76

14

3

6

TRANSCRIBED COPY OF  
ORIGINAL FIELD NOTES

Survey No. 2121

Pig Iron No. 3 lode con

14

Feet

stones  
being  
56°  
the  
6.5 ft  
No. 1  
2121  
with  
scribed  
1  
2  
4  
and  
ing  
B  
vel  
r.  
line  
40.8  
18  
1ft

in the ground in a mound of stones and scribed 8-2121  
P I No. 3 L, whence an oak tree 4 ins in diameter and  
scribed X-8-2121 B T P I No. 3 L brs. S 15° 32' E. 15.95  
ft and a quartzite cropping 1x1x½ ft chiseled X-8-2121  
P I No. 3 L, brs N. 47° 35' E. 7.65 ft.  
Thence S. 62° 28' E.  
286.0 to original location for S E C.,  
540.5 same bearing to Cor. No. 1 the place of beginning.  
Ledge  
The presumed course of the vein on this claim is from the  
S E C N 27° 32' E. 951.1 ft.,  
----- DUBACHER -----  
Beginning at Cor. No. 1 the <sup>cor</sup> SE identical with location  
a pine post 4 ft long 4 ins sq set 1 ft in the ground  
in a mound of stones and scribed 1-2121 Du L whence a  
porphyry cropping 2x2½ ft high chiseled X-1-2121 D L brs  
S. 11° 8' E. 14.74 ft., and a second porphyry cropping  
2x2x2 ft of same chiseling brs. S. 57° 30' W. 10.2 ft.,  
and U S M M No. 4 brs. S. 6° 17' W. 4122.1 ft.,  
Thence N 27° 32' E.  
762.8 to Cor. No. 8 Pig Iron No. 3 lode of this survey, on line  
2-3 Paragon lode, Survey No. 1715, at N. 89° 28' E.  
63.8 ft from Cor. No. 3,  
1403.7 same bearing to Cor. No. 2 the NE cor identical with loc-  
ation and with Cor. No. 7 Pig Iron No. 3 lode of this survey  
a pine post etc scribed 2-2121 Du L,  
Thence N. 62° 28' W  
300.0 to original location for N E C.,  
600.0 same bearing to Cor. No. 3, the NW cor identical with  
location and with Cor. No. 2 Helvitia lode of this survey  
a pine post 4 ft long 4 ins sq set 1 ft in the ground  
in a mound of stones and scribed 3-2121 Du L, whence a  
quartzite cropping 2x2 ft level with the surface and  
chiseled X-3-2121 D L brs S. 60° 28' E. 14.2 ft and a  
second quartzite cropping of same dimensions and chiseling

# TRANSCRIBED COPY OF ORIGINAL FIELD NOTES

Survey No. 2121  
Dubacher (con)

15

Feet

Feet

1403.7  
 300.0  
 499.7  
 600.

brs. N. 8° 02' W. 17.4 ft.,  
 Thence S. 27° 32' W.  
 to Cor.No.4; the SW cor identical with location and  
 on line 2-3 Carolina lode, Survey No.1715, at N. 88°  
 29' 11. ~~29~~<sup>57.9</sup> ft from Cor.No. <sup>2</sup>3, a pine post 4 ft long 4  
 ins sq set 1 ft in the ground in a mound of stones and  
 scribed 4-2121 Du L, whence a quartzite cropping  
 2x2 ft level with the surface chiseld X-4-2121 D L brs  
 N. 42° E. 8.2 ft., and a second quartzite cropping 2x2x1  
 ft high of same chiseling brs S. 31° 20' E 14.8 ft'.  
 Thence S. 62° 28' E  
 to original location for S E C.,  
 to intersection with line 1-2 Carolina lode, Survey No.1715  
 identical with line 3-4 Paragon lode, Survey No.1715 at  
 S 30° 58' W. 251.7 ft and 734.1 ft respectively from  
 Cors No.2 Carolina lode and 3 Paragon lode.  
 same bearing to Cor.No.1 the place of beginning.  
 Ledge.  
 The presumed course of the vein on this claim is from  
 the S E C. N. 27° 32' E. 1403.7.ft.  
 -----HELVETIA-----  
 Beginning at Cor.No.1 the SE cor identical with  
 location a pine post 4 ft long 4 inssq set 1 ft in the  
 ground in a mound of stones and scribed 1-2121 HeL,  
 whence a quartzite cropping 2x2 ft 1 ft high, chiseled  
 X-1-2121 H L brs. S. 89° 50' E. 13. ft., and a second  
 quartzite cropping of same dimensions and chiseling brs  
 S. 11° 22' W. 7.9 ft., and U S M M N1.4 brs. S. 1° 40'  
 E 4290.9 ft.,  
 Thence N. 27° 32' E.  
 to intersection with line 2-3 Carolina lode Survey No.  
 1715 at S. 88° 29' E. 29.7 ft from Cor.No3, which point  
 is identical with Cor.No.4 Dubacher lode of this survey  
 same bearing to Cor.No.2 the NE cor identical with location

300

600

282.

862

1500

300.0

373.5

538.

15

14

# TRANSCRIBED COPY OF ORIGINAL FIELD NOTES

16  
C.I.

Survey No. 2121  
Helvetia lode (Con)

Feet

and with Cor.No.3 Dubaucher lode of this survey a pine  
post etc and scribed 2-2121 He L,

Thence N. 62° 28' W.

300.0 to original location for N E C.,

600.0 same bearing to Cor.No. 3 identical with location  
and with Cor.No.5, "B" lode of this survey, on line 1-2  
Northern Light lode, Survey No.1812, at N. 13° 56' E.  
290.9 ft from Cor.No.1, a pine post etc scribed 3-2121  
He L,

Thence S. 26° 24' W

282.4 to intersection with line 4-1 Northern Light lode  
Survey No.1812, which line is identical with line 2-3  
High Flyer lode, Survey No. 1681, at N. 62° 28' W. 64.5  
ft and 16.3 ft respectively from Cors.No.1 Northern Light  
lode and No.2 High Flyer lode,

862.9 same bearing to intersection of line 4-1 High Flyer lode  
Survey No.1681, which line is identical with line 2-3  
Red Hill lode, Survey No.1715 at N. 62° 45' W. 148.6 ft  
and 204.4 ft respectively from Cors No.1 High Flyer lode  
and No.2 Red Hill lode, *From cor No.1 High Flyer lode  
Cor. No.2 by N. 13° 36' E 97.9 ft.*

1500.0 same bearing to Cor.No.4, the SW cor identical with lo-  
cation a pine post 4 ft long 4 ins sq set 1 ft in the  
ground in a mound of stones and scribed 4-2121 H e L whence  
a quartzite cropping 2x3x1 ft high chiseled X-4-2121 H e L  
brs N. 18° 22' W. 47.2 ft., and a second quartzite crop-  
ping 2x2 ft level with the surface of the same chiseling  
br . S. 1° E. 14.1 ft.,

Thence S. 62°28' E

300.0 to original location for S E C, on line 1-2 Red Hill lode  
Survey No.1715 at S. 21° 04' W. 642.2 ft from Cor.No.2

373.7 same bearing to intersection with line 2-3 Key to the  
Situation lode, Survey No. 1715, at <sup>N</sup> S. 88° 29' <sup>W 189.7</sup> ~~ft~~ ft  
from Cor.No. <sup>2</sup>/<sub>3</sub>

538.7 same bearing to intersection with line 1-2 Key to the  
15

TRANSCRIBED COPY OF  
ORIGINAL FIELD NOTES

Survey No. 2121

23

INSTRUMENT.

This survey was made with a Buff and Buff mining transit; the courses were deflected from the true meridian as determined by a solar observation checked by observations with a Saegmuller solar attachment, the distances were measured with a 500 ft and 100 ft steel tape. Magnetic variation  $12^{\circ} 30' E$ .

*H. N. Jorgensen*  
U S Deputy Mineral Surveyor.

Dated at Bisbee, Arizona,

August 10, 1905.

Note.

The discrepancies which occur between the courses and distances of this survey and those of the adjoining, conflicting approved surveys are due to errors in the latter.

(21)

A list  
United States  
boundaries  
known as the  
and showing  
and  
the boundary  
known as the  
represented  
direction; a  
correctly ex  
established by