

MS.

0

2

1

3

8

AUG 23 1905 1

*Copied by
Sept 15 1906*

(4-683.)

Mineral Survey No. 2138

Lot No.

Prescott Arizona Land District.

FIELD NOTES

OF THE SURVEY OF THE MINING CLAIM OF

Yavapai Development Co.

Ernest A. Haggott, Supt.

KNOWN AS THE
Copper Age, Pickaway, Lookout, Sylvia P., Ildia, Virgo, Grey Rock,
Midway Fraction, Quail & Palo Verde, Number Two and Number Three.

Lower Turkey Creek & Black Canon Mining District,

Yavapai County, Arizona

Section _____, Township ^{10 N} 11 N., Range ² 1 E. (Unsur)

Surveyed under instructions dated July 27, 1905.

by Charles H. Richards
U. S. Deputy Mineral Surveyor

Claim located See location notices 1

Survey commenced July 30 1905

Survey completed August 10 1 "

6-123

Address of applicant,

Ernest A. Haggott, Supt.,

Yavapai Development Co.,

Turkey, Arizona.

*First
Ledger
is in
area*

~~Var. 14° E.~~

Thence S6° 47' W,
 200. ft. To gulch running N.E. & S.W.
 1283. ft. To gulch bearing E. & W.
 1458.1 ft. To Cor. No. 1, the place of beginning.

"VIRGO" Lode.

Beginning at Cor. No. 1, identical with loc. mon. and with Cor. No. 2 of the Ildia lode, this survey.
 A granite rock 8 x 10 x 20" chiselled V. 1-2138 & I. 2-2138, set in the ground 12" alongside a post 4ft. long & 4" sq., in a mon. of stones 2.5 x 2ft., whence,
 U.S. Loc. mon. No. 1913 bears N78° 8' W - 3389.34 ft.
 An x on slate rock in place, chiselled B. R. V. 1-2138-bears N77° 30' W - 69. ft.

Var. 14° E.
 Thence S84° 13' E,

300. ft. To S. end loc. mon.
 600. ft. To Cor. No. 2, identical with loc. mon. and with Cor. No. 1 of the Number Three lode, this survey.
 A granite rock 12 x 14 x 24" chiselled V. 2-2138 & N. T. 1-2138, set in ground 12" alongside a post 4ft. long & 4" sq., in a mon. of stones 2.5 x 2ft.
 No local bearings available.

Var. 14° E.
 Thence N6° 47' E,

120. ft. To gulch bearing E. & W.
 700. ft. To gulch running E. & W.
 1414.56 ft. To intersection of line 1-2 of the Number Two lode of this survey, at a point N86° 11' E - 253.19 ft. from Cor. No. 1 of the Number Two lode.
 1432.03 ft. To Cor. No. 4 of the Number Three lode of this sur.
 1436.3 ft. To Cor. No. 3, identical with loc. mon. and
 A slate rock 9 x 13 x 24", chiselled V. 3-2138, set in ground 12" alongside a post 4ft. long & 4" sq., in a mon. of stones 2.5 x 2 ft., whence,
 An x on schist in place, marked B. R. V. 3.-2138, bears S63° 30' E - 59.8 ft.

Var. 14° E.
 Thence N84° 13' W,

250.35 ft. To intersection of line 2-3 of the Pickaway lode of this survey, at a point N50° 29' E - 705.16 ft. from Cor. No. 2 of the Pickaway.
 300. ft. To N. end cen. loc. mon.
 600. ft. To cor No. 4, identical with loc. mon. and on line 2-3 of the Ildia lode of, this survey, at a point S6° 47' W - 21.8 ft. from Cor. No. 3 of the Ildia.
 A slate rock 7 x 9 x 27" chiselled V. 4-2138, set in ground 13" alongside a post 4ft. long & 4" sq., in a mon. of stones 2.5 x 2. ft.

No local bearings available.
 Var. 14° E.

Thence S 6° 47' W,

707.12 ft. To intersection of line 1-2 of the Pickaway lode, this survey, at a point N84° 31' W - 354.35 ft. from Cor. No. 2 of the Pickaway lode. 365.65
 1186.3 ft. To gulch running E. & W.
 1436.3 ft. To Cor. No. 1, the place of beginning.

in a mon. of rocks 2.5 x 2ft., whence,
An x on slate in place marked B.R.M.F.4-2138, bears
N79°W - 24.7ft.

Var. 14° E.

Thence S3°59'W,

*81 To intersect line 3-4 Copper age lode, this survey at
127.81 N. 84° 31' W. 598.91 ft. from Cor. No. 3, Copper age*
182.9.ft To Cor. No.1, the place of beginning.

"QUAIL AND PALO VERDE" Lode.

Beginning at Cor. No.1, identical with loc. mon.

A brown slate rock 12 x 13 x 22" chiselled Q.P.1-2138, set in ground 12" alongside a post 4ft. long "4" sq. in a mon. of rocks 2.5 x 2ft., whence,

U.S. Loc. mon. No.1913 bears S63° 10'W - 2180.77 ft.

An x on slate in place marked B.R.Q.P.1-2138 bears
N21°E - 57.ft.

Var. 14°E.

Thence S. 83° 43' E,

315.ft. To Cor. No.2, ~~xxxxxxxxxxxx xxx xxx xxx~~

A brown slate rock 6 x 10 x 24" chiselled Q.P.2-2138, set in a mound of stones alongside a post 4ft. long & 4" sq. in a mon. of rocks 2.5 x 2ft., whence,

An x on slate in place marked B.R.Q.P.2-2138, bears
S1° 30' E - 12.3ft.

Var. 14°E.

Thence S73° 31' E,

400.ft. To Cor. No.3, identical with loc. mon., and with Cor. No.1 of the Sylvia P lode of this survey, xx

A slate rock 10 x 12 x 24" chiselled Q.P.3-2138 & S.P.1-2138 set in ground 12" alongside a post 4ft. long & 4" sq. in a mound of stones 2.5 x 2ft., whence,

An x on slate rock in place marked B.R.Q.P.3-2138, bears
N47°W - 58.5 ft.

Var. 14°E.

Thence N5° 29' E,

250.ft. to To E. end cen. loc. mon.

500 ft. To Cor. No.4, identical with loc. mon. and on line 4-1 of the Sylvia P lode of this surv.

A grey slate rock 8 x 10 x 24" chiselled Q.P.4-2138 set in ground 12" alongside a post 4ft. long & 4" sq., in a mound of rocks 2.5 x 2ft.,

No local bearings at hand.

Var. 14°E.

Thence N73° 31' W,

400.ft. To Cor. No.5, ~~xxxxxxxxxxxx xxx xxx xxx~~

A black slate rock 6 x 14 x 26" chiselled Q.P.5-2138 set in the ground 10" alongside a post 4ft. long & 4" sq., whence,

An x on slate in place marked B.R.Q.P.5-2138, bears
N64° 30' E - 15ft.

Var. 14°E.

Thence N83° 43' W,

40.ft. To bed of creek running N. & S.

315.ft. To Cor No.6, in bed of creek bearing N.E. & S.W., and on line 2-3 of the Grey Rock lode of this survey, at a point N9° 2'W; - 428.8 ft. from Cor. No.2 of the Grey Rock.

Witness Cor. bears S39° E - 54.ft.

Slate in place chiselled B.R.W.C.Q.P.6-2138, bears
N85° 45' E - 48.ft.

Witness Cor. - slate in place marked W.C.Q.P.6-2138,

beside a post 4ft. long & 4" sq. in a mon. of stones 2.5 x 2ft.
 Var. 14° 7.

Thence S5° 29' W,

- 100. ft. To well 35ft deep with 27ft. drift at bottom, bearing West.
- 250. ft To W. end cen. loc. mon.
- 442.95 ft. To intersection of line 1-2 of the Grey Rock lode of this survey, at a point S80° 53' W 111.03ft. from Cor. No 2 of the Grey Rock.
- 500. ft. To Cor. No. 1, the place of beginning.

AREAS.

Copper Age -----	20.661A
Pickaway -----	20.661"
Lookout -----	20.454"
Sylvia P -----	20.124"
Ildia -----	20.081A
Ildia in Conflict with Pickaway lode of this survey -----	4.063"
Ildia, net area -----	16.018
Virgo -----	19.781
Virgo in conflict with Pickaway lode of this survey -----	5.800
Virgo net area -----	13.981
Number Three -----	3.122"
Number Two -----	1.570
Number Two in conflict with Virgo lode of this survey -----	.246
Number Two in conflict with Number Three lode of this survey -----	.021
Number Two, net area -----	1.303"
Grey Rock -----	20.661"
Midway Fraction -----	2.514
Midway Fraction in conflict with Copper Age lode of this survey -----	.379
Midway Fraction, net area -----	2.135"
Quail And Palo Verde -----	8.122
Quail And Palo Verde, in conflict with Grey Rock lode of tis survey -----	.547
Quail And Palo Verde, net area -----	7.575"
Total area -----	146.695 A

LOCATION OF CLAIM.

This claim is located, in approximately, T_p. 11. N- R. 1. E-G. & S. R. B. & M. (unsurveyed), in the Black Canyon and Lower Turkey Creek Mining Districts; Yavapai County, Arizona; and is bounded on the North by the Cobre lode, sur. No. 1913, the Quail claim and the Palo Verde claim S. A. Parker claimant; ^{unsurveyed} on the East by the Palo Christi and Rubiayat claims, S. A. Parker Claimant; ^{unsurveyed} on the South by the Venus, Venus No. 3, Hussar, Hussar No. 3, Wm. Theising, claimant; ^{unsurveyed} on the West by U. S. public lands, and by the Necessity and Quail claims, S. A. Parker claimant, ^{unsurveyed} and by the Vulcan ^{unsurveyed} & Vulcan No. 1 Wm Theising and John Riley claimants. ^{unsurveyed}

to crosscut and drift to the above claims.

Shaft No.3 S50° 29'W - 655.ft.from N.end cen,
 " 4 x 8 x 10 - - - - - Value \$100.00
 Shaft No.4 S50° 29'W - 655.ft.from Cor.No.4,
 " 4 x 6 x 30 - - - - - Value 300.00

Other improvements.

1 hoist house 30 x 40 ft., containing machinery
 to the value of - - - - - 4000.00
 1 blacksmith shop 14 x 16ft.-Value 150.00

Lookout.

Shaft No.1 bears N50° 29'E - 738.ft from S .end cen.
 4 x 6 x 10 - - - - - Value 100.00

Sylvia P.

Shaft No.1 bears S50° 29'W - 500.ft.from N.end cen'
 4 x 6 x 10 - - - - - Value 100.00

Ildia.

Shaft No.1 bears N60° 47'E - 250.ft.from S.end cen.
 4 x 6 x 10 - - - - - Value 100.00

Virgo.

Shaft No.1 bears N60° 47'E - 675.ft.from S.end cen.
 4 x 6 x 10 - - - - - Value 100.00

Number Three.

his Shaft No.1 bears N⁷⁰ 4⁶'E - 750.ft.from S.end cen.
 4 x 6 x 11 - - - - - Value 75.00

Number Two.

his Shaft No.1 bears S89° 21'E 300.ft. from W.end cen.
 4 x 6 x 10 - - - - - Value 100.00

Grey Rock.

his Shaft No.1 bears N90° 2'W - 650.ft.from S.end cen.
 4 x 6 x 10 - - - - - Value 100.00

Shaft No.2 bears N90° 48'W - 400.ft.from Cor.No.2,
 5 x 7 x 35 - - - - - Value 400.00

Crosscut West

4 x 6 x 27 - - - - - Value 200.00

Other improvements.

Mining machinery - - - - - Value 150.00

Midway Fraction.

his Shaft No.1 bears N30° 59'E - 91.9ft.from S.end cen.
 4 x 6 x 10 - - - - - Value 100.00

Quail And Palo Verde.

his Shaft No.1 bears N73° 31'W - 400.ft.from E.end cen.
 4 x 6 x 10 - - - - - Value 100.00

Shaft No.2 bears N60° 10'W - 435.ft.from E.end cen.
 4 x 6 x 20 - - - - - Value 200.00

-INSTRUMENTS USED.

A Gurley Mountain Transit with solar attachment,
 and steel chain 100.ft.long.

All courses determined by use of the solar.

Address of applicant-

Earnest A.Haggott,
 Supt.Yavapai Development Co.
 Turkey,
 Arizona.

FINAL OATHS FOR SURVEYS.

LIST OF NAMES.

A list of the names of the individuals employed by Chas H Richards

United States Deputy Mineral Surveyor, to assist in running, measuring, and marking the lines, corners, and boundaries described in the foregoing field notes of the survey of the mining claim of Yavapai

Development Company
Copper Age, Pickaway, Lookout, Sylvia P., Ildia, Virgo,
known as the Grey Rock, Midway Fraction, Quail & Palo Verde, No. 2, & No. 3.

and showing the respective capacities in which they acted.

- Joseph Groves , Chainman.
- Ted. Theising , Chainman.
- , Axman.
- , Flagman.

FINAL OATHS OF ASSISTANTS.

We, Joseph Groves and Ted. Theising

and do solemnly swear that we assisted

Chas. H. Richards, United States Deputy Mineral Surveyor, in marking the corners and surveying the boundaries of the mining claim of Yavapai Development Company

known as the See above

represented in the foregoing field notes as having been surveyed by said deputy mineral surveyor and under his direction; and that said survey has been in all respects, to the best of our knowledge and belief, faithfully and correctly executed, and the corner and boundary monuments established according to law and the instructions furnished by the United States Surveyor-General for ARIZONA

- Joseph Groves , Chainman.
- Ted Theising , Chainman.
- , Axman.
- , Flagman.

Subscribed and sworn to by the above-named persons before me this 23

day of August, 1905

L P Phellis

May 16 1907

FINAL OATH OF U. S. DEPUTY MINERAL SURVEYOR

I, Charles H. Richards, U. S. Deputy Mineral Surveyor, do solemnly swear that, in pursuance of instructions received from the United States Surveyor General for Arizona, dated July 27 1905, I have, in strict conformity to the laws of the United States, the official regulations and instructions thereunder, and the instructions of said Surveyor General, faithfully and correctly executed the survey of the Mining Claim of Yavapai Development Company

Copper Age, Pickaway, Lookout, Sylvia P., India, known as the Virgo, Grey Rock, Midway Fraction, Quail & Palo Verde, Number Two, and Number Three, situate in Black Canon & Lower Turkey Creek Mining District, S

Yavapai County, in Section Township No. 11, Range No. 1 E (unsurveyed) and designated as Survey No. 2138

as represented in the foregoing field notes, which accurately show the boundaries of said mining claim as distinctly marked by monuments on the ground, and described in the attached copy of the location certificate, which was received by me from the Surveyor General with said instructions, and that all the corners of said survey have been established and perpetuated in strict accordance with the law, official regulations and instructions thereunder; and I do further solemnly swear that the foregoing are the true and original field notes of said survey and my report therein, and that the labor expended and improvements made upon said mining claim by claimant or its grantors are as therein fully stated, and that the character, extent, location and itemized value thereof are specified therein with particularity and full detail, and that no portion of said labor or improvements so credited to this claim has been included in the estimate of expenditures upon any other claim.

Charles H. Richards U. S. Deputy Mineral Surveyor.

Subscribed and sworn to by the said Charles H. Richards

U. S. Deputy Mineral Surveyor, before me L. P. Nellis

this 23

day of August 1905

L P Nellis

My commission expires May 16 1907

Affidavit of Five Hundred Dollars Improvements.

We, Gideon B. Skull, and Jas. T. Tregarthen

of lawful age, being first duly sworn according to law, depose and say: That we are acquainted with the Yavapai Development Company mining claim, situate in Black Canon & Turkey Creek Mining district, Yavapai County, Arizona Territory, for which Ernest A. Haggott, Supt.

Yavapai Development Company has made application for survey prior to application for patent under the provisions of the Act of Congress, approved May 10, 1872; and that the labor done and improvements made thereon by the applicant and its grantor exceed Five Hundred Dollars in value, ^{upon or for each claim} and further that we are not personally interested in said mine.

Gideon B. Skull
Jas. T. Tregarthen

TERRITORY OF ARIZONA, }
County of Yavapai } ss:

Sworn to and subscribed before me, this 23

day of August, 1905



J.P. Pellis

6986b500-2-03

My commission expires May 16 1907

POOR QUALITY

The following pages are scanned at the best possible quality setting. The original pages are of poor quality and this is the best possible reproduction.

HURPER ETC.

NOTICE OF MINING LOCATION,
SILVER CLAIM.

TO ALL WHOM IT MAY CONCERN:

This silver claim, the name of which is the Number Two Mining Claim, situate on lands belonging to the United States of America, and in which there are valuable mineral deposits, was entered upon and located for the purposes of exploration and purchase by Charles H. Richards the undersigned, on the 17th day of January 1904.

The length of this claim is six hundred one feet, and its width two hundred thirty-six feet in a westerly direction, and three hundred and 65 feet in a westerly direction from the center of the discovery shaft, at which this notice is posted, lengthwise of the claim, together with a 40-foot wide strip in width of the surface grounds, on each side of the center of said claim. The general course of the line lengthwise and premises is from the easterly to the westerly.

Said claim is situated and located in the Black Canyon of the Colorado, in Pinal County, Arizona, Territory of Arizona, about 3 miles in a westerly direction from Phoenix Butte.

The surface boundaries of the claim are marked upon the ground as follows: Beginning at a monument and 4" x 4" post set at a point in a westerly direction two hundred 65 feet from the discovery shaft (at which this notice is posted), being in the center of the center line of said claim; thence forty (northward) feet to a 4" x 4" post, being the northeast corner of said claim; thence westerly 301 feet to a 4" x 4" post, being at the northwest corner of said claim; thence southerly 70 feet to a 4" x 4" post at the center of the west end of said claim; thence southerly 70 feet to a 4" x 4" post, being at the southwest corner of said claim; thence easterly 301 feet to a 4" x 4" post at the southeast corner of said claim; thence northerly 40 feet to the place of beginning.

All land under the provisions of Chapter Six, of Title XXXII, of the Revised Statutes of the United States, and of an Act of the General Assembly of Arizona, entitled "An Act to provide for locating the lands of the Territory of Arizona", approved March 18, 1901.

Dated and posted on the ground this 17th day of January, 1904.

Charles H. Richards.

Witness Alfred Wagner.

Filed and recorded at Request of F. J. Faggett April 19 A. D. 1904 at 2:00 o'clock A. M., Book 71 of Mines, page 496, Records of Pinal County, Arizona.

(Seal) F. J. Faggett,

County Recorder.

By R. E. Butler,

Deputy Recorder.

NUMBER THREE.

NOTICE OF MINING LOCATION.
Lode claim.

To all whom it may concern:

This mining claim, the name of which is the Dryden Three Lining claim, situate on lands belonging to the United States of America, and in which there are valuable mineral deposits, has been taken and located for the purposes of exploration and purchase by Charles E. Richards the undersigned, on the 27 day of January 1904.

The length of this claim is fifteen hundred feet, and it shall have a width of thirty feet in a northerly direction, and seven hundred fifty feet in a southerly direction from the center of the discovery shaft, at which this notice is posted, lengthwise of the claim, together with ----- feet in width of the surface ground, on each side of the center of said claim. The general course of the lode in soil and rock is from the Northerly to the Southerly.

The claim is situated and located in the Black Canyon Mining District, in Yavapai County, in the Territory of Arizona, about 1 1/2 mile in a westerly direction from Townsend's Mine.

The surface boundaries of the claim are marked upon the ground as follows: Beginning at a monument and 4" x 4" post at a point in a northerly direction 200 feet from the discovery shaft (at which this notice is posted), being in the center of the north end line of said claim; thence forty-three feet to a 4" x 4" post, being the northeast corner of said claim; thence 1000 feet to a 4" x 4" post, being at the southeast corner of said claim; thence forty-three feet to a 4" x 4" post at the center of the south end of said claim; thence forty-three feet to a 4" x 4" post, being at the southwest corner of said claim; thence 1500 feet to a 4" x 4" post at the northeast corner of said claim; thence 43 feet to the place of beginning.

All in accordance with the provisions of Chapter 216, of Title 2327, of the Revised Statutes of the United States, and also in accordance with the General Act of Congress, entitled "An Act to Revise and Codify the Laws of the Territory of Arizona", approved March 3, 1891.

Witness my hand and seal on the ground this 27 day of January, 1904.

Charles E. Richards.

Witness Alfred Wagner.

Filed and recorded at request of C. E. Richards, and 18 A. B. Book at 9:00 o'clock A. M., Book 71 of Mines, page 439, Records of Yavapai County, Arizona.

(Seal) F. J. Parker.

By H. E. Butler,

County Recorder.

Deputy Recorder.

MIDWAY FRACTURE.

NOTICE OF MINING LOCATION.
Lead claim.

To ALL WHOM IT MAY CONCERN:

This mining claim, the name of which is the Midway Fracture Mining claim, situate on lands belonging in the United States of America, and in which there are valuable mineral deposits, was entered upon and located for the purposes of exploration and purchase by W. A. Parker and Charles E. Richards, citizens of the U. S., the undersigned, on the 1st day of February, 1904.

The length of this claim is 100 feet, and the claim 25 feet in a northerly direction, and 5 feet in a southerly direction from the center of the discovery shaft, at which this notice is posted, lengthwise of the claim, together with 300 feet in width of the surface grounds, on each side of the center of said claim. The general course of the lead deposit and premises is from the Northerly to the Southerly.

The claim is situated and located in the Black Canyon Mining District, in Yavapai County, in the Territory of Arizona, about 5 1/2 miles in a north easterly direction from Townsend mine.

The surface boundaries of the claim are marked upon the ground as follows: Beginning at a monument of stones at a point in a southerly direction 25 feet from the discovery shaft (at which this notice is posted), being in the center of the north end line of said claim; thence easterly 100 feet to a monument, being the N. East corner of said claim; thence southerly 5 feet to a monument, being at the S. East corner of said claim; thence westerly 100 feet to a monument at the center of the south end of said claim; thence westerly 300 feet to a monument, being at the S. West corner of said claim; thence northerly 100 feet to a monument at the S. West corner of said claim; thence easterly 300 feet to the place of beginning.

All acts under the provisions of Chapter 201, of Title 2312, of the Revised Statutes of the United States, and of an Act of the General Assembly of the Terr. entitled "An Act to Revise and Codify the laws of the Territory of Arizona", approved March 15, 1902.

Dated and posted on this small claim 1st day of February, 1904.

W. A. Parker
Charles E. Richards.

Witnessed by P. H. Smith,
W. A. Parker.

Filed and recorded at request of W. A. Parker April 25 A. M. 1904 at 9:00 o'clock A. M., Book 71 of Mines, page 506, Records of Yavapai County, Arizona.

(Seal) P. J. Farley,
County Recorder.
By R. E. Putler,
Deputy Recorder.

AMENDED LOCATION NOTICE.
Of Lode Claim.

Know all men by these presents:

That The Yavapai Development Company of the County of Yavapai and Territory of Arizona do hereby make, post and file this amended location notice upon the Quail and Palo Verde lode claim, situate in the Black Canyon Mining District, County of Yavapai, Territory of Arizona.

The length of this claim, linear and horizontal measurement is 900 feet along the ledge, 350 feet running Easterly from the discovery shaft, and 550 feet running Westerly from the discovery shaft, together with surface ground 300 feet on the South side of the center of the ledge, and 300 feet on the North side of the ledge.

The boundaries are marked upon the ground as follows: Beginning at a point 500 ft. N. of the S. East cor. of the Quail claim of which this is a portion from which the discovery shaft bears S. W. about 350 feet and is also a portion of the Palo Verde claim thence Westerly nine hundred feet to corner No. 2 the N. W. corner of said lode; thence Southerly 600 feet to corner No. 3 the S. W. corner of said claim; thence Easterly 900 feet to corner No. 4 the S. E. corner of said claim, thence Northerly 500 to cor. No. 1 the place of beginning.

Monuments are also placed at the center of the end lines.

This amended location notice is made under the provisions of the Revised Statutes of the United States relating to Mineral Lands, and an Act of the General Assembly of Arizona, approved March 16th, 1901, without waiver of previous rights, to correct errors in the description of the said Quail and Palo Verde lode claims in the Location Notice of the same recorded in Book 71, Page 55-56 of "Records of Mines", in the office of the County Recorder of the aforesaid County of Yavapai Territory of Arizona, to which reference is hereby made.

Dated and posted on the ground this 14 day of July, 1905.

Ernest A. Haggott Supt.

Yav. Dev. Co.

Witness: Wilbur Merritt.

Recorded at request of E. A. Haggott, July 15th A. D. 1905, at 12:50 o'clock P. M., in Book 74 of Mines, pages _____, records of Yavapai County, Arizona.

(Seal) Roland Mosher,
By _____, Deputy. County Recorder.

TERRITORY OF ARIZONA,))
County of Yavapai.) SS.

I, ROLAND MOSHER, County Recorder in and for the County of Yavapai, in the Territory of Arizona, and custodian of the records thereof, do hereby certify that I have compared the above and foregoing with, and the same is a full, true and correct copy of the Amended Location Notice of the "Quail and Palo Verde" mining claim, as the same appears from the original instrument recorded in my said office on the 15th day of July, A. D. 1905, at 12:50 o'clock p. m.

IN WITNESS WHEREOF, I have hereunto set my hand and affixed my official seal, this 15th day of July, A. D. 1905.

Roland Mosher
County Recorder.

"ROBBY ROSS".

NOTICE OF MINING LOCATION.
Lode Claim.

To all whom it may concern:

This mining claim, the name of which is the Gray Rock Mining Claim, situate on lands belonging to the United States of America, and in which there are valuable mineral deposits, was entered upon and located for the purpose of exploration and purchase by E. Preston Jones, a citizen of the United States, the undersigned, on the 17th day of September, 1903.

The length of this claim is 1500 feet, and it claim 300 feet in a westerly direction, and 100 feet in a westerly direction from the center of the discovery shaft, at which this notice is posted, throughout the claim, together with three hundred (300) feet in each of the surface grounds, on each side of the center of ^{said} claim. The general course of the lode deposit and vein is from the northerly to the southerly.

The claim is situated and located in the Black Canyon Mining District, in Yavapai County, in the Territory of Arizona, about three miles in a westerly direction from Coyles Station and at the eastern base of Torrey's Peak and embracing the foot of Turkey Creek.

The corners boundaries of the claim are marked upon the ground as follows: Beginning at a monument of stones at a point in a westerly direction - - - feet from the discovery shaft (at which this notice is posted), being in the center of the north end line of said claim; thence easterly 300 feet to a monument of stones, being the northeast corner of said claim; thence southerly 1500 feet to a monument of stones, being at the southeast corner of said claim; thence westerly 300 feet to a monument of stones at the center of the south end of said claim; thence westerly 300 feet to a monument of stones, being at the south west corner of said claim; thence northerly 1500 feet to a monument of stones being the northwest corner of said claim; thence easterly 300 feet to the place of beginning.

All done under the provision of Chapter 322, of Title 2321, of the Revised Statutes of the United States, and of an Act of the General Assembly of Arizona, entitled "An Act Concerning Mines", approved March 30th, 1893, and amended March 21, 1897, and March 10th, 1901.

Posted and located on the ground this 17th day of September, 1903.

E. Preston Jones

Locator.

Witness: H. A. Parker.

Recorded at request of E. Preston Jones, Nov. 5, A. D. 1903, at 4:30 o'clock P. M., in Book 39 of Mines, page 489, Records of Yavapai County, Arizona.

(Seal)

P. J. Farley.

County Recorder.

By R. E. Butler,
Deputy Recorder.

1903.

NOTICE OF MINING LOCATION.
Lead claim.

To all Whom it may concern:

This mining claim, the name of which is the Vierz leading claim, situate on land belonging to the United States of America, and in which there are valuable mineral deposits, was entered upon and located for the purpose of exploration and purchase by S. A. Parker, a citizen of the United States, the undersigned, on the 28th day of August, 1903.

The length of this claim is 11,750 by 100 feet, and 1 claim 385 feet in a northerly direction and 1275 feet in a southerly direction from the center of the discovery shaft, at which this notice is posted, lengthwise of the claim, together with three hundred (300) feet in width of the surface grounds on each side of the center of said vein. The general course of the ledge deposit and premises is from the northerly to the southerly.

The claim is situated and located in the Black Canyon Mining District in Yavapai County, in the Territory of Arizona, about one mile in an easterly direction from Townsend Peak and is the south extension of the Tidestrom mining claim.

The surface boundaries of the claim are marked upon the ground as follows: Beginning at a monument of stones at a point in a northerly direction 385 feet from the discovery shaft (at which this notice is posted), being in the center of the northern end line of said claim; thence easterly 300 feet to a monument of stones being the north east corner of said claim; thence southerly 1500 feet to a monument of stones being at the south east corner of said claim; thence westerly 300 feet to a monument of stones at the center of the south end of said claim; thence westerly 300 feet to a monument of stones being at the southwest corner of said claim; thence northerly 1500 feet to a monument of stones being the north west corner of said claim; thence easterly 300 feet to the place of beginning.

All done under the provisions of Chapter Six, of Title XXXIII, of the revised Statutes of the United States and of an Act of the General Assembly of Arizona, entitled "An Act concerning mines", approved March 21, 1901, and amended March 21, 1902, and March 13th, 1901.

Given and posted on the ground, this 28th day of August 1903.

S. A. Parker, locator.

Recorded at request of S. A. Parker Mgt. of A. D. 1903, at 4 o'clock P. M. Book 3d of Mines, page 54, Records of Yavapai County, Arizona.

(Seal) W. J. Farley,

By W. D. Baldwin,

County Recorder.

Deputy Recorder.

LEBIA.

NOTICE OF MINING LOCATION.
Lode Claim.

To All Whom it May Concern:

This mining claim, the name of which is the Lebia Mining Claim, situate on lands belonging to the United States of America, and in which there are valuable mineral deposits, was entered upon and located for the purpose of exploration and purchase by G. A. Parker, a citizen of the United States, the undersigned, on the 2nd day of July, 1903.

The length of this claim is fifteen hundred feet, and it shall extend 1500 feet in a northerly direction and 300 feet in a southerly direction from the center of the discovery shaft, at which this notice is posted, lengthwise of the claim, together with three hundred (300) feet on both sides of the surface grounds, on each side of the center of said vein. The general course of the lode deposit and premises is from the northerly to the southerly.

The claim is situated and located in the Black Canyon Mining District in the First Territory, in the Territory of Arizona, about one and one-half miles in an easterly direction from Camp Verde Peak and on the east side of Turkey Creek and adjoins the Rickaway mining claim.

The surface boundaries of the claim are marked upon the ground as follows: Beginning at a monument of stones at a point in a northerly direction 1500 feet from the discovery shaft (at which this notice is posted), being on the center of the north end line of said claim; thence northerly 300 feet to a monument of stones being the north east corner of said claim; thence southerly 1500 feet to a monument of stones being at the south east corner of said claim; thence westerly 300 feet to a monument of stones at the center of the south end of said claim; thence westerly 300 feet to a monument of stones being at the south west corner of said claim; thence northerly 1500 feet to a monument of stones being the northwest corner of said claim; thence easterly 300 feet to the place of beginning.

All done under the provisions of Chapter Six, of Title XXXIII, of the Revised Statutes of the United States, and of an Act of the General Assembly of Arizona, entitled "An Act Concerning Mines", approved March 20, 1890, and amended March 21, 1892, and March 15th, 1901.

Dated and posted on the ground this 2nd day of July, 1903.

G. A. Parker Locator.

Recorded at request of G. A. Parker Sept. 30, A. D. 1903, at 4 o'clock P. M., Book 63 of Mines, page 53, Records of Yavapai County, Arizona.

(Seal) P. J. Farley,

By F. H. Baldwin,

County Recorder.

Deputy Recorder.

SYNOPSIS

NOTICE OF MINING LOCATION
Lode Claim.

To all whom it may concern;

This mining claim, the name of which is the "Cyclops" lode claim, situate on lands belonging to the United States of America, and in which there are valuable mineral deposits, was entered upon and located for the purpose of exploration and purchase by E. A. Parker, a claimer of the United States, the undersigned, on the 2nd day of July, 1893.

The length of this claim is 1500 feet, and I claim three hundred feet in a northerly direction and twelve hundred feet in a southerly direction from the center of the discovery shaft, at which this notice is posted, lengthwise of the claim, together with three hundred (300) feet in width of the surface grounds, on each side of the center of said vein. The general course of the lode deposit and premises is from the Northerly to the Southerly.

The claim is situated and located in the Black Canyon Mining District in Yavapai County, in the Territory of Arizona, about one half mile in an easterly direction from Burned Peak, and lies on the west side of and adjoins the Copper Age Mining Claim.

The surface boundaries of the claim are marked upon the ground as follows: Beginning at a monument of stones at a point in a northerly direction ----- feet from the discovery shaft (at which this notice is posted), going to the center of the shaft and line of said claim; thence Easterly 300 feet to a monument of stones being the northeast corner of said claim; thence southerly 1500 feet to a monument of stones being at the Southeast corner of said claim; thence westerly 300 feet to a monument of stones at the center of the shaft and line of said claim; thence westerly 300 feet to a monument of stones being at the South west corner of said claim; thence Northerly 1500 feet to a monument of stones being the Northwest corner of said claim; thence Easterly 300 feet to the place of beginning.

All done under the provisions of Chapter Six, of Title THREE, of the revised Statutes of the United States and of an Act of the General Assembly of Arizona, entitled "An Act Concerning Mines", approved March 20, 1893, and amended March 23, 1893, and March 13th, 1891.

Dated and posted on the ground this 2nd day of July, 1893.

E. A. Parker Locater.

Recorded at Request of E. A. Parker Sept. 26, A. D. 1893, at 4 o'clock P. M., Book 36 of Mines, page 21, Records of Yavapai County, Arizona.

(Seal) P. J. Dyer,

County Recorder.

By W. B. Baldwin,

Deputy Recorder.

LOOK OUT.

NOTICE OF MINING LOCATION.
Lode Claim.

To all whom it may concern:

This mining claim, the name of which is the Look Out Mining claim, situate on lands belonging to the United States of America, and in which there are valuable mineral deposits, was discovered and located for the purpose of exploration and purchase by C. A. Parker, a citizen of the United States the 22nd day of July, 1903.

The length of this claim is Fifteen hundred feet, and its width is 750 feet in a Northerly direction and 750 feet in a Southerly direction from the center of the discovery shaft, at which this notice is posted, Southwise of the claim, together with three hundred (300) feet in width of the surface grounds, on each side of the center of vein. The general course of the lode is said to be from the Northerly to the Southerly.

The claim is situated and located in the Black Canyon Mining District in Yavapai County, in the Territory of Arizona, about one mile to the Easterly direction from Townsend Peak and lies on the south side of and adjacent to the Copper and Pickaway Mining Claims.

The corners and boundaries of the claim are marked upon the ground as follows: Beginning at a monument of stones at a point in a northerly direction 483 feet from the discovery shaft (at which this notice is posted), thence Easterly 300 feet to a monument of stones being the North east corner of said claim; thence Southerly 1500 feet to a monument of stones being at the South East corner of said claim; thence Westerly 500 feet to a monument of stones at the center of the South end of said claim; thence Westerly 300 feet to a monument of stones being at the Southwest corner of said claim; thence Northerly 1500 feet to a monument of stones being the North west corner of said claim; thence Easterly 300 feet to the place of beginning.

All done under the provisions of Chapter Six, of Title XXXII, of the Revised Statutes of the United States and of an Act of the General Assembly of Arizona, entitled "An Act Concerning Mines", approved March 20, 1895, and amended March 21, 1897, and March 13th, 1903.

Dated and posted on the ground this 2nd day of July, 1903.

C. A. Parker, Locator.

Recorded at request of C. A. Parker, Sept. 30, A. D. 1903, at 4 o'clock p. m., in Book 33 of Mines, page 50, records of Yavapai County, Arizona.

(Seal) P. J. Farley,

By F. H. Sullivan, Deputy Recorder.

Deputy Recorder.

"PICKAWAY".

HOWING OF LOCATION.

Know all men by these presents:

That we the undersigned, have this day located fifteen hundred (1500) linear feet of this vein or lode, bearing various metals, with all dips, spurs, angles and variations, with surface ground three hundred (300) feet on each side of the center of vein, with all mineral deposits contained therein, and all other property within the limits of said claim, and all water and water privileges thereon or appurtenant thereto, under and according to the provisions of the United States Mining Laws, under which it is located.

This claim commences at this monument and notice placed upon the ledge, and runs 1500 feet in a southerly direction along the ledge from notice.

The exterior boundaries are as follows, viz:-

Commence at a monument of stone at North West corner, distant three hundred (300) feet in a westerly direction from Discovery monument; thence in a southerly direction parallel with the ledge 1500 feet to monument of stone at S. W. corner of claim; thence in a easterly direction at right angles across the ledge six hundred (600) feet to monument of stone at N. E. corner of claim; thence in a northerly direction parallel with the ledge fifteen hundred (1500) feet to monument of stone at N. W. corner of claim; thence at right angles across the ledge in a westerly direction six hundred (600) feet to monument of stone at S. W. corner of claim; and place of beginning.

This ledge may be more generally described as situated about one mile in an easterly direction from Townsall's Well, on a slope one half mile east of Turkey Creek and about three miles in a westerly direction from Townsall's Station of Post Office in Lower Turkey Creek Range, District of Nevada, Territory, and shall be known as the Pickaway Mining Claim.

Witness the ground this 31st day of July, 1890.

J. A. Parker,

J. S. Jagger,

Recorded at request of J. A. Parker, Oct. 27, A. D. 1890, at 2 o'clock P. M., in Book 40 of line 115, page 115, Records of Nevada County, Nevada.

W. H. Walker,
Deputy.

(Seal) J. T. Johnson,
County Recorder.

"COPIER AGE".

NOTICE OF LOCATION.

Know all men by these presents:

That we the undersigned, have this day located fifteen hundred (1500) linear feet of this vein or lode, bearing precious metals, with all dips, spurs, angles and variations, with surface ground Three hundred (300) feet on each side of the center of vein, with all mineral deposits contained therein, and all timber growing within the limits of said claim, and all water and water privileges thereon or appurtenant thereto, under and according to the provisions of the United States Mining Acts, under which it is located.

This claim commences at this monument and thence started from the S. E. cor., and runs 1500 feet in a Northerly direction from the discovery shaft.

The exterior boundaries are as follows, viz:

Commencing at a monument of stone at ^{South} West corner, distant three hundred (300) feet in a westerly direction from Discovery Monument; thence in a Northerly direction parallel with the ledge 1500 feet to monument of stone at N. W. corner of claim; thence in a Easterly direction at right angles across the ledge Six hundred (600) feet to monument of stone at E. E. corner of claim; thence in a southerly direction parallel with the ledge Fifteen hundred (1500) feet to monument of stone at S. E. corner of claim; thence at right angles across the ledge in a westerly direction Six hundred (600) feet to monument of stone at S. W. corner of claim; and place of beginning.

This ledge may be more generally described as situated about one mile in an easterly direction from Townsend's Peak and about one-half mile east of Turkey creek and about three miles in a southerly direction from James Station, in Lower Taylor creek Mining District, Yavapai County, Arizona Territory, and shall be known as the COPIER AGE Mining Claim.

Dated on the ground this 31st day of July 1899.

S. A. Parker.

T. W. Glasgow.

Recorded at request of S. A. Parker Oct. 27. A. D. 1899, at 9 o'clock A. M., in Book 48 of Mines, page 532, Records of Yavapai County, Arizona.

(Seal) T. S. Johnson,

W. E. Walker,
Deputy.

County Recorder.

TERRITORY OF ARIZONA,)
County of Yavapai.) ss.

I, ROLAND MOSHER, County Recorder in and for the County of Yavapai, in the Territory of Arizona, and custodian of the records of said office, do hereby certify that I have compared the above and foregoing with, and the same contains a full, true and correct copy of the notice of location of each of the following described lode mining claims, as the same appear from the original records of said notices of location in the said office, to-wit:-

- Copper Age mining claim, notice of location whereof is of record in Book 49 of Mines, page 41, records of Yavapai County, Arizona;
- Pickering mining claim, notice of location whereof is of record in Book 49 of Mines, page 513, said records;
- Look Out mine, claim, notice of location whereof is of record in Book 38 of Mines, page 50, said records;
- Sylvia P mining claim, notice of location whereof is of record in Book 38 of Mines, page 51, said records;
- Ildis mining claim, notice of location whereof is of record in Book 38 of Mines, page 53, said records;
- Virge mining claim, notice of location whereof is of record in Book 38 of Mines, page 54, said records;
- Grey Rock mining claim, notice of location whereof is of record in Book 38 of Mines, page 43, said records;
- Edo Verde mining claim, notice of location whereof is of record in Book 71 of Mines, page 55, said records;
- Quail mining claim, notice of location whereof is of record in Book 71 of Mines, page 56, said records;
- Shaver Two mining claim, notice of location whereof is of record in Book 71 of Mines, page 490, said records;
- Walker Three mining claim, notice of location whereof is of record in Book 71 of Mines, page 492, said records;
- Maday Fraction mining claim, notice of location whereof is of record in Book 71 of Mines, page 506, said records.

IN WITNESS WHEREOF, I have hereunto set my hand and affixed my official seal, this 26th day of July, A. D. 1908.



Roland Mosher
County Recorder.

4-688.

U. S. SURVEYOR-GENERAL'S FINAL CERTIFICATE ON FIELD NOTES.

Department of the Interior,

OFFICE OF U. S. SURVEYOR-GENERAL,

Phoenix, Arizona

Oct. 10, 1905. 190

I, U. S. Surveyor-General for Arizona

do hereby certify that the foregoing transcript of the Field Notes, return and approval of the survey of the mining claim of Yavapai Development Company

Copper Age, Pickaway, Lookout, Sylvia P. Ildia, Virgo, Grey Rock, known as the Midway Fraction, Quail & Palo Verde, Number Two and Number Three.

situate in Lower Turkey Creek & Black Canon

Mining District, Yavapai County, Arizona

in Section , Township No. 11 N., Range No. 1 E. (unsur) and

designated as Survey No. 2138, has been correctly copied from the originals on file in

this office; that said Field Notes furnish such an accurate description of said mining claim as will, if incorporated into a patent, serve fully to identify the premises, and that such reference is made therein to natural objects or permanent monuments as will perpetuate and fix the *locus* thereof.

And I further certify that five hundred dollars' worth of labor has been expended or improved for each location
 or for each location
 improvements made upon said mining claim by claimantS or its grantors, and that said improvements consist of 16 shafts with cross cuts, drifts, etc. Total value \$23,625.00 \$1500.00 of the value of shaft No. 2, on Pickaway lode if credited to each of the following claims, Lookout, Sylvia P. Ildia, Virgo, Number Three, Number Two, and \$400.00 of the value of shaft No. 1, on Copper Age is credited to Midway Fraction claim and \$300.00 of the value of cross cut in tunnel No. 2 Pickaway lode is credited to Quail and Palo Verde lode.

and that no portion of said labor or improvements has been included in the estimate of expenditures upon any other claim.

I further certify that the plat thereof, filed in the U. S. Land Office at Phoenix, Arizona is correct and in conformity with the foregoing Field Notes.

(Signed) Frank S. Ingalls

United States Surveyor-General for Arizona

4-687.

SURVEYOR-GENERAL'S CERTIFICATE OF APPROVAL OF FIELD
NOTES AND SURVEY OF MINING CLAIM.

Department of the Interior,

Office of U. S. Surveyor-General,

Phoenix, Arizona

Oct. 10, 1905, 190

I, U. S. Surveyor-General for Arizona

do hereby certify that the foregoing and hereto attached Field Notes and Return of the Survey of the
Mining Claim of Yavapai Development Company

known as the
Copper Age, Pickaway, Lookout, Sylvia P., Ildia, Virgo, Grey
Rock, Midway Fraction, Quail & Palo Verde, Number two and
Number Three.

situate in Lower Turkey Creek & Black Canon Mining District,
Yavapai County, Arizona

in Section , Township No. 11 N., Range No. 1 E. (unsur)
designated as Survey No. 2138

executed by Chas. H. Richards, U. S. Deputy Mineral

Surveyor, July 30 to August 10, 1905, under my instructions dated

July 27, 1905, have been critically examined and the necessary cor-

rections and explanations made, and the said Field Notes and Return, and the Survey they describe,

are hereby approved. A true copy of the copy of the location certificate filed by the applicant for

survey is included in the field notes.

Frank J. Ingalls

U. S. Surveyor-General for Arizona.

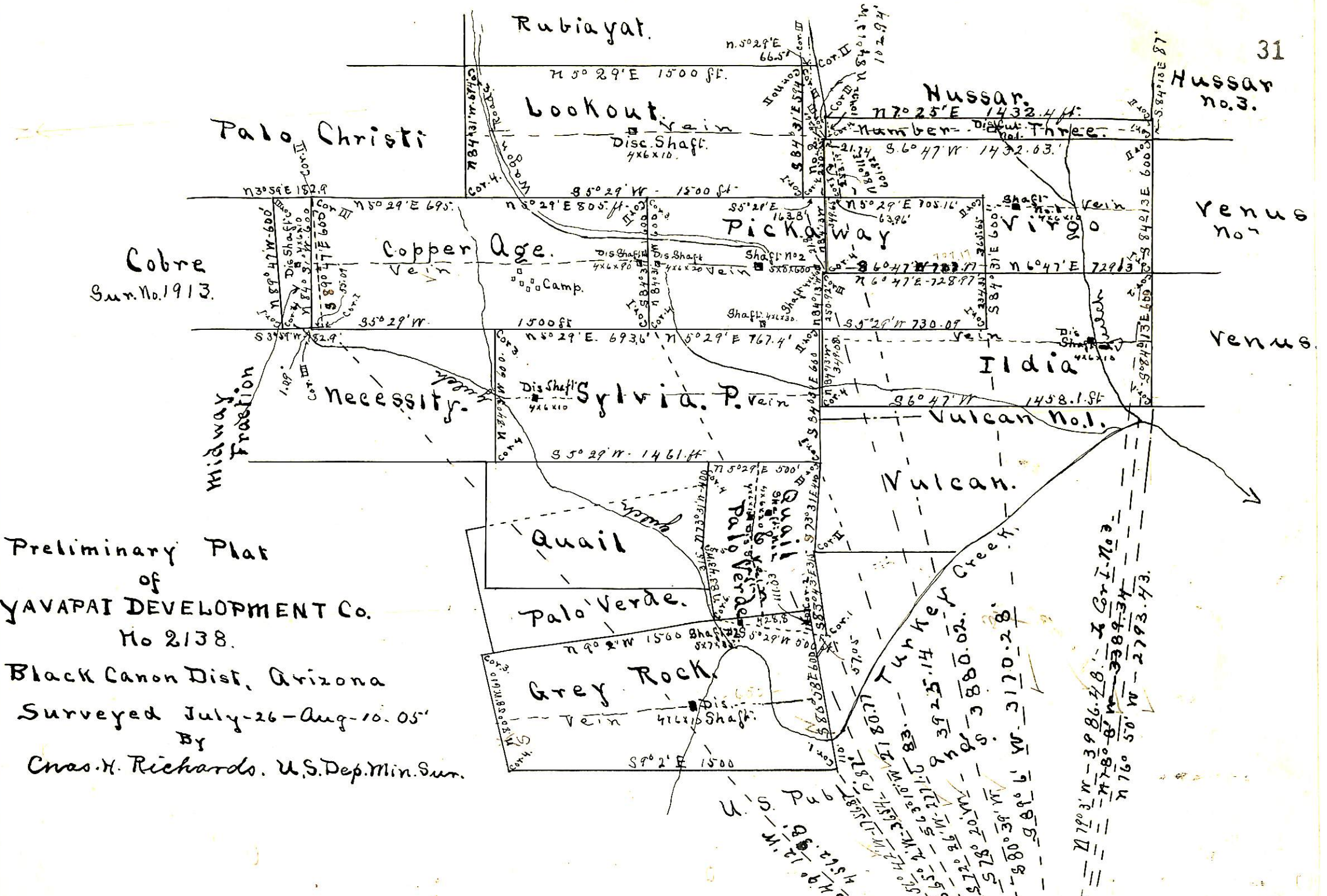

Preliminary Plat
of
YAVAPAI DEVELOPMENT Co.
No 2138.
Black Canon Dist, Arizona
Surveyed July-26-Aug-10. 05'
By
Chas. H. Richards. U.S. Dep. Min. Sur.

Hussar no. 3.

Venus no. 1

Venus

Vulcan.

Tulker Creek

Rubiayat.

Nussar.

Palo Christi

Lookout vein

Copper Age.

Pickaway

Cobre
Sum. No. 1913.

Necessity.

Sylvania. P. vein

Idia

Vulcan No. 1.

Quail

Palo Verde.

Grey Rock.

U.S. P.M.
N 78° 50' W - 3986.48.
N 78° 08' W - 3389.34
N 76° 50' W - 2793.43
S 78° 20' W - 3880.02.
S 78° 34' W - 3170.28
S 78° 20' W - 3880.02.
S 78° 20' W - 3170.28
S 78° 20' W - 3880.02.
S 78° 20' W - 3170.28
S 78° 20' W - 3880.02.
S 78° 20' W - 3170.28

Cor. I. No. 3
N 78° 08' W - 3389.34
N 76° 50' W - 2793.43