

**M  
S  
-**

**0**

**2**

**1**

**6**

**5**

1  
1905

Copy to E.K.  
Jan. 20/06

Jan. 11, 06

(4-683.)

Mineral Survey No. 2165

Lot No. \_\_\_\_\_

Arizona

Land District.

### FIELD NOTES

OF THE SURVEY OF THE MINING CLAIM OF

Palmer and Pittsburg Mining Co.  
J. M. O'Connell atty.

KNOWN AS THE

Boer  
Narren

Mining District.

Cochise

County,

Arizona

Section approx

Township 22 S

Range 26 E 9th N B and M

Surveyed under instructions dated Sept 19, 1905

by Franklin D. Smith

U. S. Deputy Mineral Surveyor

Claim located see location notice, 1

Survey commenced September 25, 1905

Survey completed September 25, 1905

6-10

Post office address of claimants attorney  
Bisbee Cochise County Arizona

See  
Page 4  
and  
area

Survey No. 2165,  
B O R

Feet

- Beginning at Cor.No.1 identical with Cor.No.6 Virginia lode, Survey No. 1347, and situated on line 3-4 Morning Star lode, Survey No.1331, N.  $33^{\circ} 21' W$ . 161 ft from Cor No.4 a pine post 4 ft long 4 ins sq set 1 ft in the ground in a mound of stones and scribed B L whence a pine post of same dimensions and scribed B. P. 1-2165 brs S.  $30^{\circ} 28' W$ . 25 ft., and a second pine post of same dimensions and scribing brs N.  $83^{\circ} 4' E$ . 25 ft., and U S M M To 4 Warren Mining District brs N.  $40^{\circ} 23' W$ . 3008.7 ft.,
- Thence N.  $83^{\circ} 4' E$
- 83.5 along line C-5 Virginia lode, Survey No.1347 to Cor.No.2 the NE cor identical with Cor No 1 Baton Rouge lode, Survey No.1398<sup>amended</sup>; pine post 4 ft long 4 ins sq set 1 ft in the ground in a mound of stones and scribed 2-2165 B L whence a pine post of same dimensions and scribed P.P. 2-2165 brs S.  $83^{\circ} 4' W$ . 25 ft and a second pine post of same dimensions and scribing brs S.  $11^{\circ} 48' E$ . 25 ft and original location for NE cor brs N.  $11^{\circ} 48' W$ . 110 ft.,
- Thence S.  $11^{\circ} 48' E$ .
- 140.9 along line 1-4 Baton Rouge lode, Survey No.1398<sup>amended</sup>, to original location for W E C.,
- 205.9 same bearing to Cor.No.3, the SE cor identical with location and with Cor.No. 5 Hard Scrabble lode, Survey No.1026 a pine post 4 ft long 4 ins sq set 1 ft in the ground in a mound of stones and scribed 3-2165 B L whence a pine post of same dimensions and scribed B. P. 3-2165 brs S.  $64^{\circ} 54' W$ . 25 ft and a second pine post of same dimensions and scribing brs. N.  $11^{\circ} 48' W$ . 25 ft.,
- Thence S.  $64^{\circ} 54' W$ .
- 232.2 ft to Cor.No.4 Hard Scrabble lode Survey No.1026 which cor being the N E C monument of Hard Scrabble lode
- 278.9 same bearing to Cor.No.4, the SW cor identical with location and with cor.No.5 Morning Star lode, Survey No.1331 a pine post 4 ft long 4 ins sq set 1 ft in the ground in a mound of stones and scribed 4-2165 B L whence a pine

Feet

post of same dimensions and scribed B. P. 4-2165 hrs N 11° 48' W. 25 ft., and a second pine post of same dimensions and scribing hrs. N. 64° 54' E. 25ft., and Cor No.4 Morning Star lode, Survey No. <sup>3</sup>1331 hrs N. 50° 58' E. 278.2 ft.,

Thence N. 11° 48' W.

65.0 to original location for W E C.,

70.0 same bearing to Cor.No.5, the NW cor identical with location a pine post 4 ft long 4 ins sq set 1 ft in the ground in a mound of stones and scribed 5-2165 B L, whence a pine post of same dimensions and scribed B. P. 5-2165 hrs. N. 30° 28' E. 25 ft and a second pine post of same dimensions and scribing hrs. S. 11° 48' E. 25 ft.,

Thence N. 30° 28' E.

279.8 to Cor.No.1 the place of beginning.

Ledge.

The presumed course of the vein on this claim is from W E C location S. ~~64° 54'~~<sup>64° 54'</sup> W. 278.9 ft.,

A R E A

Total area Boer lode	1.072 ac ✓
Less area in conflict with Morning Star lode Survey No.1331	<u>0.663</u> ✓
Net area Boer lode,	0.409 acres ✓

IMPROVEMENTS.

I certify that the value of the labor and improvements on this survey placed thereon by the claimant or its grantors is as follows:

No.1 Discovery shaft 4x6x10 ft hrs from W E C location S. 64° 54' W. 25 ft., Value, \$100.00

Note Complete affidavit of \$500 improvements will be filed prior to the expiration of the period of publication.

## ADJOINING CLAIMS.

North Virginia lode, Survey No. 1347, Copper Queen Cons.  
 Min Co owner.

West Morning Star lode Survey No. 1331 same owner.

South Hardscrabble lode, Survey No. 10<sup>2</sup>/<sub>8</sub>, same owner

East Baton Rouge lode, Survey No. 1398, Calumet & Pitts  
 burg Min Co. owner.

## LOCATION.

This claim is located about 600 ft in an E di-  
 rection from the Hoatson shaft of the Calumet & Pitts-  
 burg Mining Co on unsurveyed lands in the Warren Mining  
 District, Cochise County, Arizona, approximately in T<sub>23</sub>-S R 24 E Q & S R E & M.

## INSTRUMENT.

This survey was made with a C. L. Berger & Son  
 No. 1 C transit, the courses were deflected from the true  
 meridian as determined by solar observation checked by an  
 observation on Polaris. The distances were measured with a  
 300 ft steel tape. Magnetic variations 12° 30' E.

*Franklin W. Smith*  
 U. S. Deputy Mineral Surveyor.

Dated at Bisbee, Arizona.

*Oct 10 1905*

Note Any discrepancies between the courses and distances  
 of this survey and those of the adjoining or conflict-  
 ing approved surveys are due to errors in the latter.

Note After noting the discrepancies between this survey  
 and former surveys the posts were again fully identi-  
 fied, the distances carefully measured, and the bearings  
 determined by direct measurement and checked by tri-  
 angulation. The following discrepancies between this  
 survey and former surveys are reported:

Note.

Course 1-2 brs. N 83° 04' E 83.5 ft. instead of N 82° 40' E 80.06 ft. as reported in Survey No. 1347.

Course 2-3 brs. S 11° 48' E 205.9 ft. instead of S 13° 5' E 204.<sup>3</sup> ft. as reported in Survey No. 1398 am.

Course and distance from Cor. 3 of this survey to Cor. 4 of Hard Scrabble lode Survey No. 1026 brs. S 64° 54' W 232.2 ft. instead of S 63° 2<sup>3</sup>~~8~~' W 233 ft as reported in Survey No. 1026.

Course and distance from Cor. 4 Hard Scrabble lode Survey No. 1026 to Cor. 4 of this survey brs. S 64° 54' W 46.7 ft. instead of S 64° 10' W 45.6 ft .

Course 5-4 Morning Star lode Survey No. 1331 brs. N 50° 58' E 278.2 ft instead of N 50 ° 39' E 278.2 ft.

Course from Cor. 1 of this survey to Cor. 4 Morn-  
ing Star lode, Survey No. 1331, brs. S 33° 21' <sup>S</sup>~~W~~ 161.0 ft.  
instead of S. 33° 37' <sup>E</sup>~~W~~ 161.0 ft.

# FINAL OATHS FOR SURVEYS.

## LIST OF NAMES.

A list of the names of the individuals employed by Franklin W. Smith

United States Deputy Mineral Surveyor, to assist in running, measuring, and marking the lines, corners, and boundaries described in the foregoing field notes of the survey of the mining claim of

Palmer and Pittsburg Mining Co.  
known as the Boer

and showing the respective capacities in which they acted.

- J. S. Severaux, Chainman.
- A. F. Giesemer, Chainman.
- ....., Axman.
- ....., Flagman.

## FINAL OATHS OF ASSISTANTS.

We, J. S. Severaux

and A. F. Giesemer, do solemnly swear that we assisted Franklin W. Smith, United States Deputy Mineral Surveyor, in marking the corners and surveying

the boundaries of the mining claim of Palmer and Pittsburg Mining Co.  
known as the Boer

represented in the foregoing field notes as having been surveyed by said deputy mineral surveyor and under his direction; and that said survey has been in all respects, to the best of our knowledge and belief, faithfully and correctly executed, and the corner and boundary monuments established according to law and the instructions furnished by the United States Surveyor-General for Arizona

- J. S. Severaux, Chainman.
- A. F. Giesemer, Chainman.
- ....., Axman.
- ....., Flagman.

Subscribed and sworn to by the above-named persons before me this 10<sup>th</sup> day of October, 1905

Corra Smith

FINAL OATH OF U. S. DEPUTY MINERAL SURVEYOR

I, Franklin W. Smith, U. S. Deputy Mineral Surveyor, do solemnly swear that, in pursuance of instructions received from the United States Surveyor General for Arizona, dated September 19-1905, I have, in strict conformity to the laws of the United States, the official regulations and instructions thereunder, and the instructions of said Surveyor General, faithfully and correctly, executed the survey of the Mining Claim of Belcher and Pittsburg Mining Co., known as the Boer, situate in Yavapai Mining District, Pachia County, Arizona, in Section 14, Township No. 23N, Range No. 4E T20N R40W and designated as Survey No. 2165, as represented in the foregoing field notes, which accurately show the boundaries of said mining claim as distinctly marked by monuments on the ground, and described in the attached copy of the location certificate, which was received by me from the Surveyor General with said instructions, and that all the corners of said survey have been established and perpetuated in strict accordance with the law, official regulations and instructions thereunder; and I do further solemnly swear that the foregoing are the true and original field notes of said survey and my report therein, and that the labor expended and improvements made upon said mining claim by claimant or its grantors are as therein fully stated, and that the character, extent, location and itemized value thereof are specified therein with particularity and full detail, and that no portion of said labor or improvements so credited to this claim has been included in the estimate of expenditures upon any other claim.

Franklin W. Smith  
U. S. Deputy Mineral Surveyor.

Subscribed and sworn to by the said Franklin W. Smith  
U. S. Deputy Mineral Surveyor, before me Sora E. Smith  
this 10<sup>th</sup>  
day of October 1905,

Sora E. Smith

In and for the County of Cochise, Territory of Arizona  
My Commission Expires November 1, 1905.



AMENDED

# Notice of Mining Location

LODE CLAIM

To All Whom it May Concern:

This Mining Claim, the name of which is the Boer Mining Claim, situate on lands belonging to the United States of America, and in which there are valuable mineral deposits, was entered upon and located for the purposes of exploration and purchase by Calumet and Pittsburg Mining Company, a corporation

(Locator must insert either "a citizen of the United States," or, "who has declared his intention to become a citizen of the United States.")

the undersigned, on the 15th day of December 1904

The length of this claim is about 300 feet, and we claim 15 feet, in a n Easterly direction and 285

feet in a Westerly direction from the center of the discovery ~~mark~~ monument at which this notice is posted, lengthwise of the claim, together with 120 feet in width of the surface grounds, on each side of the center of said claim. The general course of the lode deposit and premises is from the East to the West

The claim is situated and located in the Warren Mining District, in Cochise County, in the Territory of Arizona, about 1 1/2 miles in a southeasterly direction from Bisbee and is bounded on the North by the Virginia, on the East by the Baten Rouge, on the South by the Hard Scrabble and on the West by the Morning Star all patented Mining Claims.

The surface boundaries of the claim are marked upon the ground as follows: Beginning at monument of stones

Territory of Arizona, {  
County of Cochise {ss.

I, Frank Hare, County Recorder in and for said County, hereby certify that I have compared the foregoing copy with the Amended Location Notice of the Boer Mining Claim, filed and recorded in my office on the 19 day of December 1904, in Book 32 at page 203, Records of Mines, and that the same is a full, true and correct copy of such original and of the whole thereof.

Witness my hand and seal of office this 2nd day of September, A. D. 1905.

*Frank Hare*  
County Recorder.

correct errors in the description in the said original Location Notice. and to include the ground formerly covered by the Greer Mining Claim which was located by Jesse Greer and J.R. Tate Dated and posted on the ground this 15 day of December 1904  
Witnesses E.F. Whiteley, Calumet and Pittsburg Mining Company,  
L.K. Houlton by it agent S.A. Parnell.

Filed and recorded at request of H.B. Paull Dec. 19th A.D. 1904 at 9 A. M. Book 32, page 203. Record of Mines.

TERRITORY OF ARIZONA, } ss.  
 County of.....

I,....., County Recorder in and for the County and Territory aforesaid, do hereby certify that the within instrument was filed for record at.....o'clock,.....M., on this.....day of.....190..., and duly recorded in Book No..... of.....Records of.....County, Arizona, at pages.....

WITNESS my hand and official seal the day and year first above written.

..... County Recorder.

AMENDED  
**Notice of Location.**  
 LODGE CLAIM.

*Beach*  
*C. P.*

Dated.....190.....

Filed and Recorded at request of

A. D. 190.....

at.....M.

Book.....

Pages.....

County Recorder.

By.....Deputy Recorder.

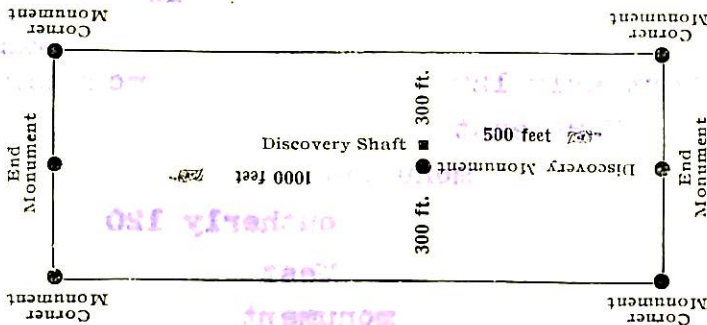

This diagram is to give locator a general idea of plan of location under the new law. The Discovery Shaft can be in the center of claim or any distance from either end desired. In the diagram it is placed 500 feet from one end and 1000 feet from the other. Commence description of claim at a center end monument, giving its distance and direction from center of Discovery Shaft; thence bound the claim in either direction. In description be careful to state locality of claim with reference to some natural object, or permanent monument, as will identify the claim.

and to include the  
 December 1900  
 and to include the  
 December 1900  
 and to include the  
 December 1900

4-688.

U. S. SURVEYOR-GENERAL'S FINAL CERTIFICATE ON FIELD NOTES.

Department of the Interior,

OFFICE OF U. S. SURVEYOR-GENERAL,

Phoenix, Arizona,

Jan. 23, 1906

I, U. S. Surveyor-General for Arizona, do hereby certify that the foregoing transcript of the Field Notes, return and approval of the survey of the mining claim of Calumet and Pittsburg Mining Co.

known as the Boer situate in Warren

Mining District, Cochise County, Arizona, & M. in Section approx., Township No. 23 S., Range No. 24 E., G. & S. R. B., and designated as Survey No. 2165,

has been correctly copied from the originals on file in this office; that said Field Notes furnish such an accurate description of said mining claim as will, if incorporated into a patent, serve fully to identify the premises, and that such reference is made therein to natural objects or permanent monuments as will perpetuate and fix the locus thereof.

And I further certify that less than five hundred dollars' worth of labor has been expended or improvements made upon said mining claim by claimant or its grantors, and that said improvements consist of, at time of survey, 1 shaft, value \$100.00

and that no portion of said labor or improvements has been included in the estimate of expenditures upon any other claim.

I further certify that the plat thereof, filed in the U. S. Land Office at Phoenix, Arizona, is correct and in conformity with the foregoing Field Notes.

(Signed) Frank A. Ingalls

United States Surveyor-General for Arizona.

(4-687.)

# Surveyor General's Certificate of Approval of Field Notes and Survey of Mining Claim.

Department of the Interior,

Office of U. S. Surveyor General,

Phoenix, Arizona,

Jan. 23, 1906

I, U. S. Surveyor General for Arizona,

do hereby certify that the foregoing and hereto attached Field Notes and Return of the

Survey of the Mining Claim of Calumet and Pittsburg Mining Co.,

J. M. O'Connell, Atty.

, known as the

Boer

situate in Warren mining district,

Cochise County, Arizona,

in Section approx., Township No. 23 S., Range No. 24 E., G. & S. R. B. & M.

, designated as Survey No. 2165,

executed by Franklin W. Smith, U. S. Deputy Mineral

Surveyor, September 25, 1905, 18, under my instructions dated

September 19, 1905, 18, have been critically examined and the

necessary corrections and explanations made, and the said Field Notes and Return, and

the Survey they describe, are hereby approved. A true copy of the copy of the location

certificate filed by the applicant for survey is included in the field notes.

Frank J. Fitzgerald

U. S. Surveyor General for Arizona.

## Boer Lode

situated in Warren Mining District, Cochise County, Territory of Arizona, and owned by Calumet & Pittsburg Mining Company:

## AFFIDAVIT OF \$500.00

I hereby certify that the value of the labor and improvements on this claim placed thereon by the claimant or its grantors is not less than \$500.00 and that said improvements were placed on said claim before the 15th day of April, 1906, and prior to the expiration of the period of publication of the application for patent and that said improvements are as follows:

No. 1	Discovery shaft 4 x 6 x 10 feet deep brs from E E C location S 64° 54' W 25.0 ft value	100.00
No. 2	Open cut 5 x 9 x 15 feet brs from Cor. No. 2 S 45° W 42 ft value	130.00
No. 3	Shaft 5 x 7 x 10 feet deep brs. from E E C, S 64° 54' W 12 ft value	100.00
No. 4	Open cut 5 x 9 x 18 feet with tunnel at face 4 x 6 x 6 ft long bearing S 88° W, the mouth of open cut brs from Cor. No. 3 N 54° 53' W 37.5 ft value	220.00
No. 5	Open cut 8 x 12 x 65 feet long in rock bearing N 11° W, the mouth of which brs from Cor. No. 3 S 65° 02' W 20 ft value	<u>2500.00</u>
Total Improvements		\$ 3050.00

  
U. S. Dep. Mineral Surveyor

Dated at Bisbee, Ariz.,

April 16 - 1906.

# Affidavit of Five Hundred Dollars Improvements.

We, J. P. Chiado and Harry Locke

of lawful age, being first duly sworn according to law, depose and say: That we are acquainted with the

Boer mining claim, situate in Warren

mining district, Cochise County, Arizona Territory, for which the Calumet &

Pittsburg Mining Co. by J. M. O'Connell attorney

has made application for survey prior to application for patent under the provisions of the Act of Congress approved May 10, 1872; and that the labor done and improvements made thereon by the applicant and its grantor exceed five hundred dollars in value, and further that we are not personally interested in said mine.

*J. P. Chiado*  
*Harry Locke*

TERRITORY OF ARIZONA, }  
COUNTY OF Cochise } ss:

Sworn to and subscribed before me this 17 day

[SEAL.]

of April, 1906.

*John Petee*

NOTARY PUBLIC  
In and for the County of Cochise, Territory of Arizona,  
My Commission Expires March 12, 1910.

(4-691.)

# Certificate of U. S. Surveyor General

AS TO

EXPENDITURES REPORTED AFTER RETURN OF SURVEY OF MINING CLAIM.

I, U. S. Surveyor General for Dist. of Arizona,  
do hereby certify that Five Hundred Dollars' worth of labor has been expended or  
improvements made by claimant or its grantors, upon the mining claim of  
Calumet & Pittsburg Mining Company

known as the Boer  
situate in Warren mining district,  
Cochise County, Arizona,  
in Section \_\_\_\_\_, Township No. \_\_\_\_\_, Range No. \_\_\_\_\_;  
that said improvements consist of 2 shafts and 3 open cuts, total  
Value--\$3050.00

\_\_\_\_\_ and that no portion of said labor or improvements has been  
included in the estimate of expenditures upon any other claim. A copy of the report of  
Franklin W. Smith, U. S. Deputy Mineral Surveyor, dated  
April 16, 1906, 18\_\_\_\_, is hereto attached.

*Frank S Ingalls*

U. S. Surveyor General for Arizona.

Office of U. S. Surveyor General,

Phoenix, Arizona,

April 20, 1906. 1

# SURVEY N° 2165

## BOER

SCALE 1" = 50'

N  
VIRGINIA  
SUR. No. 1347

Orig Loc.

U.S.M.M. No. 4  
E 1/2 N 40° 23' W 3008.7'

MORNING STAR  
SUR. No. 1331

N 83° 04' E 835.5'

N 33° 21' W 1611.0'

BATON ROUGE  
SUR. No. 1398

N 30° 28' E 279.8'

Presumed Course of Vein S 64° 54' W 278.9'

N 11° 48' W 70.0'

N 50° 58' E 278.2'

S 64° 54' W 278.9'

278.9'

S 11° 48' E

140.9'

205.9'

HARPO SCRABBLE  
SUR. No. 1026

TOTAL AREA OF BOER	-----	1.072 Acres
LESS AREA IN CONFLICT WITH MORNING STAR	-----	0.663 "
NET AREA OF BOER	-----	0.409 "

