

MS
-

0

2

3

4

7

1900
Copied
Oct. 1, E.A.S.

(4-683.)

Mineral Survey No. 2347

Lot No. _____

Arizona Land District.

FIELD NOTES

OF THE SURVEY OF THE MINING CLAIM OF

Gold + Copper Consolidated
Mining + Milling Co

KNOWN AS THE

Cincinnati
Hessayumpee Mining District,
Yavapai County, Arizona

Section _____, Township _____, Range _____

Surveyed under instructions dated Sep. 13, 1906
by J. J. Fisher,
U. S. Deputy Mineral Surveyor.

Claim located see the certificates, 1
Survey commenced sep. 20, 1906
Survey completed " 21, 1906

o 6-180
Address

Norris + Ross
attorneys for Agent
Prescott
Arizona

K.R.B.

POOR QUALITY

The following pages are scanned at the best possible quality setting. The original pages are of poor quality and this is the best possible reproduction.

SURVEY LOG SHEET.

1000

CHICAGO ILL.

1000

1000

Chicago Ill. 700

1000

1000

Chicago Ill. 700

1000

1000

Chicago Ill. 700

1000

1000

Chicago Ill. 700

1000

1000

MISSING

PAGE(S)

INCORPORATED.

THAT Tracy was with said survey light about 11
and the light was not visible from the boat
which was about 1/2 mile from the light at that time
with the aid of a telescope.

J. J. Fisher

FINAL OATHS FOR SURVEYS.

LIST OF NAMES.

A list of the names of the individuals employed by

J. J. Fisher

United States Deputy Mineral Surveyor, to assist in running, measuring, and marking the lines, corners, and boundaries described in the foregoing field notes of the survey of the mining claim of

Gold & Copper

Consolidated Mining & Milling Co

known as the

Cincinnati

and showing the respective capacities in which they acted.

A. N. Oliver

Chainman.

James A. Humphreys

Chainman.

James A. Humphreys

Axman.

A. N. Oliver

Flagman.

FINAL OATHS OF ASSISTANTS.

We,

A. N. Oliver

and

James A. Humphreys

do solemnly swear that we assisted

J. J. Fisher

United States Deputy Mineral Surveyor, in marking the corners and surveying

the boundaries of the mining claim of

Gold & Copper Consolidated

Mining & Milling Co

known as the

Cincinnati

represented in the foregoing field notes as having been surveyed by said deputy mineral surveyor and under his direction; and that said survey has been in all respects, to the best of our knowledge and belief, faithfully and correctly executed, and the corner and boundary monuments established according to law and the instructions furnished by the United States Surveyor-General for

A. N. Oliver

Chainman.

James A. Humphreys

Chainman.

James A. Humphreys

Axman.

A. N. Oliver

Flagman.

Subscribed and sworn to by the above-named persons before me this

23rd

day of

September

190

My commission expires

May 19, 1908

J. J. Fisher

Notary Public

FINAL OATH OF U. S. DEPUTY MINERAL SURVEYOR

I, J. J. Fisher, U. S. Deputy Mineral Surveyor do solemnly swear that, in pursuance of instructions received from the United States Surveyor General for Arizona, dated September 13th 1906, I have, in strict conformity to the laws of the United States, the official regulations and instructions thereunder, and the instructions of said Surveyor General, faithfully and correctly executed the survey of the Mining Claim of Gold & Copper Consolidated Mining & Milling Co., known as the Cincinnati, situate in Hessleyville Mining District, Yavapai County, Arizona, in Section _____, Township No. _____, Range No. _____, and designated as Survey No. 2347, as represented in the foregoing field notes, which accurately show the boundaries of said mining claim as distinctly marked by monuments on the ground, and described in the attached copy of the location certificate, which was received by me from the Surveyor General with said instructions, and that all the corners of said survey have been established and perpetuated in strict accordance with the law, official regulations and instructions thereunder; and I do further solemnly swear that the foregoing are the true and original field notes of said survey and my report therein, and that the labor expended and improvements made upon said mining claim by claimant or his grantors are as therein fully stated, and that the character, extent, location and itemized value thereof are specified therein with particularity and full detail, and that no portion of said labor or improvements so credited to this claim has been included in the estimate of expenditures upon any other claim.

J. J. Fisher
U. S. Deputy Mineral Surveyor.

Subscribed and sworn to by the said J. J. Fisher
U. S. Deputy Mineral Surveyor, before me a Notary Public in and for Yavapai County Arizona this 29th
day of September 1906.

Thomas C. Job
Notary Public

My Commission Expires July 9, 1907.

Affidavit of Five Hundred Dollars Improvements.

We, A. N. Olin and James A. Humphreys

of lawful age, being first duly sworn according to law, depose and say: That we are acquainted with the

Cincinatti mining claim, situate in Hessayampa

mining district, Yavapai County, Arizona Territory, for which Gold & Copper

Consolidated Mining & Milling Co.

has made application for survey prior to application for patent under the provisions of the Act of Congress

approved May 10, 1872; and that the labor done and improvements made thereon by the applicant and

It grantor exceed five hundred dollars in value, and further that we are not personally interested

in said mine.

A. N. Olin

James A. Humphreys

TERRITORY OF ARIZONA,

COUNTY OF

Yavapai

} ss:

Sworn to and subscribed before me this 23rd day

of September, 1906

[SEAL.]

J. J. Fisher
Notary Public

17171b400-3-05

My commission expires
May 10, 1908

CINCINNATTI.

NOTICE OF LOCATION.

Know all men by these presents:

That we the undersigned have this day located fifteen hundred (1500) linear feet of this vein or lode, bearing precious metals, with all dips, spurs, angles and variations, with surface ground three hundred (300) feet on each side of the center of vein, with all mineral deposits contained therein, and all timber growing within the limits of said claim, and all water and water privileges thereon or appurtenant thereto, under and according to the provisions of the United States Mining Laws, under which it is located.

This claim commences at this monument and notice placed upon the ledge, and runs 750 feet in a Northerly direction and 750 feet in a Southerly direction along the ledge, from discovery shaft.

The exterior boundaries are as follows, viz:

Commencing at a monument of stone on west boundary line, distant three hundred (300) feet in a westerly direction from Discovery Monument; thence in a Northerly direction parallel with the ledge 750 feet to monument of stone at N. W. corner of claim; thence in an Easterly direction at right angles across the ledge six hundred (600) feet to monument of stone at N. E. corner of claim; thence in a Southerly direction parallel with the ledge fifteen hundred (1500) feet to monument of stone at S. E. corner of claim; thence at right angles across the ledge in a Westerly direction six hundred (600) feet to monument of stone at S. W. corner of claim; thence in a Northerly direction parallel with the ledge 750 feet to monument on west boundary and place of beginning.

This ledge may be more generally described as situated about three quarters (3/4) of a mile north east of the Jeff Davis Ranch, and one and one half miles east of Senaton Mill on the divide between the Hassayampa and Lynx Creeks, in Hassayampa Mining District, Yavapai County, Arizona Territory; and shall be known as the Cincinnati Mining Claim.

Dated on the ground this Eight...day of February 1897.

The Chicago Gold Mining Co.
A. J. Pickrell, Supt.

Recorded at request of S. P. Hulbert, April 20th A. D. 1897, at 3:30 o'clock P. M., in Book 43 of Mines, page 489, Records of Yavapai County, Arizona.

By E. C. Averyt, Deputy. (Seal) W. I. Johnson, County Recorder.

TERRITORY OF ARIZONA,)
County of Yavapai.) SS.

I, ROLAND MOSHER, County Recorder in and for the County of Yavapai, in the Territory of Arizona, and custodian of the records of said office, do hereby certify that I have compared the above and foregoing with, and the same is a full, true and correct copy of the Notice of Location of the "CINCINNATTI" Mining Claim, as the same appears from the records of my said office in Book 43 of Mines, page 489, records of Yavapai County, Arizona.

IN WITNESS WHEREOF, I have hereunto set my hand and affixed my official seal, this 13th day of September, A. D. 1906.

Roland Mosher
County Recorder.

U. S. SURVEYOR-GENERAL'S FINAL CERTIFICATE ON FIELD NOTES.

Department of the Interior,

OFFICE OF U. S. SURVEYOR-GENERAL,

Phoenix, Arizona,

Oct. 17, 1906

I, U. S. Surveyor-General for District of Arizona
do hereby certify that the foregoing transcript of the Field Notes, return and approval of the survey
of the mining claim of
Gold & Copper Consolidated Mining & Milling Co.
known as the C I N C I N N A T T I
situate in Hassayampa
Mining District, Yavapai County, Arizona
in Section , Township No. , Range No. , and
designated as Survey No. 2347, has been correctly copied from the originals on file in
this office; that said Field Notes furnish such an accurate description of said mining claim as will, if
incorporated into a patent, serve fully to identify the premises, and that such reference is made therein
to natural objects or permanent monuments as will perpetuate and fix the locus thereof.

And I further certify that five hundred dollars' worth of labor has been expended or improve-
ments made upon said mining claim by claimant or its grantors, and that said improvements
consist of 2 shafts, total value \$700.00

and that no portion of said labor or improvements has been included in the estimate of expenditures
upon any other claim.

I further certify that the plat thereof, filed in the U. S. Land Office at Phoenix,
Arizona is correct and in conformity with the foregoing Field Notes.

Frank S. Ingalls

United States Surveyor-General for Arizona

4-687.

SURVEYOR-GENERAL'S CERTIFICATE OF APPROVAL OF FIELD NOTES AND SURVEY OF MINING CLAIM.

Department of the Interior,

Office of U. S. Surveyor-General,

Phoenix, Arizona.

Oct. 17, 1906

I, U. S. Surveyor-General for District of Arizona

do hereby certify that the foregoing and hereto attached Field Notes and Return of the Survey of the Mining Claim of

Gold & Copper Consolidated Mining & Milling Co.

, known as the

C I N C I N N A T T I

situate in Hassavampa Mining District,

Yavapai County, Arizona

in Section, Township No., Range No.

, designated as Survey No. 2347

executed by J. J. Fisher, U. S. Deputy Mineral

Surveyor, Sep. 20-21, 1906, under my instructions dated

Sep. 13, 1906, have been critically examined and the necessary cor-

rections and explanations made, and the said Field Notes and Return, and the Survey they describe,

are hereby approved. A true copy of the copy of the location certificate filed by the applicant.. for

survey is included in the field notes.

Frank A. Sigall

U. S. Surveyor-General for Arizona

Survey No. 2347
 Arizona Land District

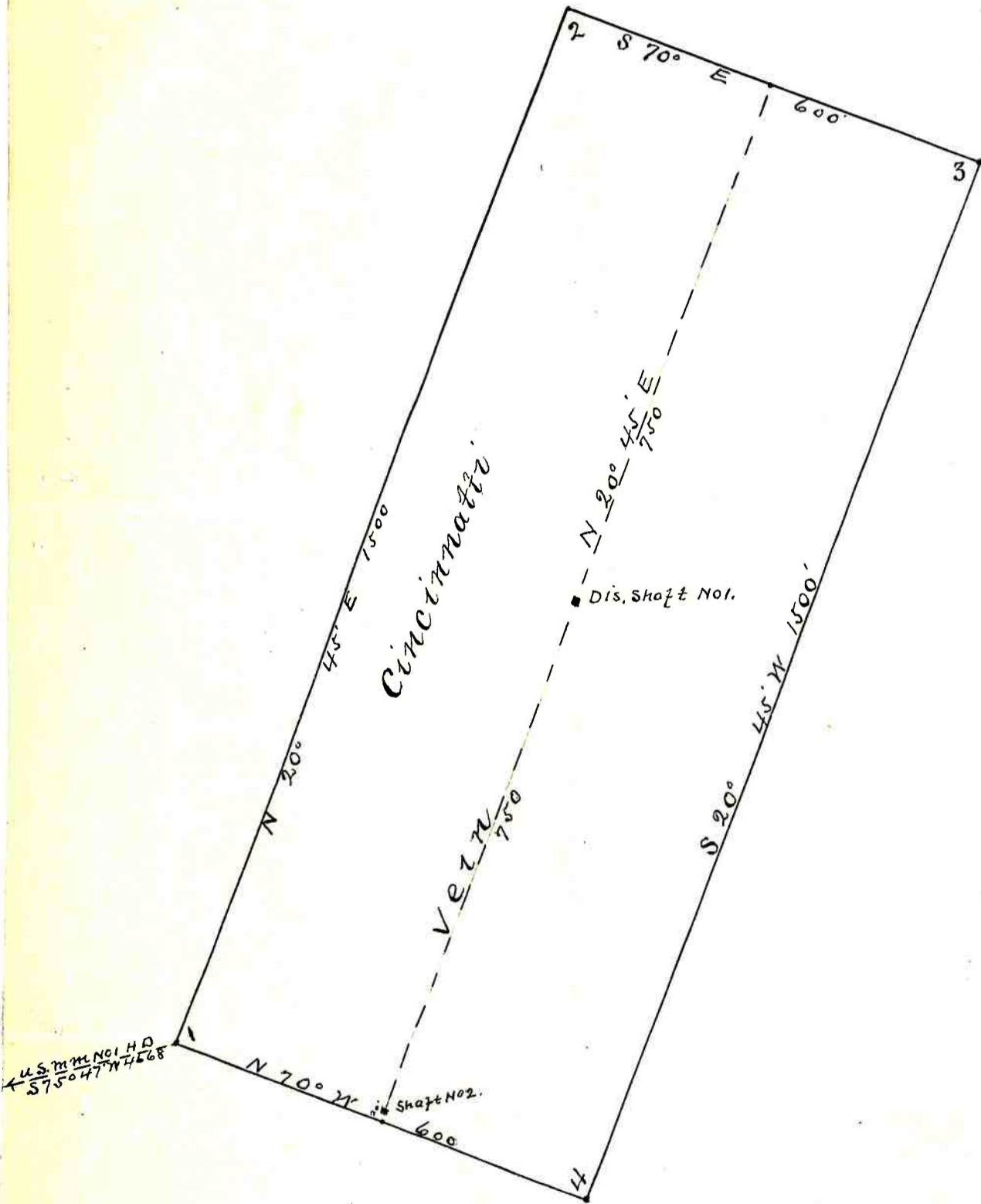

Lode Cincinnati
 Unsurveyed, G. F. Reed
 Claim No. 2

Surveyed Sep. 20-21-1906
 by J. J. Fisher
 U.S. D.M.S.