

MS

0

2

3

5

9

DEC 3-1906
JAN 17 1907

(4-683.)

Mineral Survey No. 2359

Lot No. _____

Arizona

Land District.

FIELD NOTES

OF THE SURVEY OF THE MINING CLAIM OF

Rosalie Copper Company

KNOWN AS, THE

Rosalie, Mannock, Silver King, Arslough, Blue Creek, Ceece, Black Lake, Humming Bird, Deposit + Key

Copper Creek

Mining District.

Yavapai

County,

Arizona

Section approx, Township 10N, Range 4E

Surveyed under instructions dated Nov-19th, 1906.

by William H. Merritt

U.S. Deputy Mineral Surveyor

Claim located See location on plat, 1

Survey commenced Nov 21st, 1906

Survey completed " 27th, 1906

Address of Claimants
Norris & Ross, Atty's.
Prescott Arizona

Filed
Register
502
2002

Feet Beginning at Cor.No.1
 Identical with the loc.and with Cor.No.3. Deposit and Cor.
 No.4 Mammoth lodes of this sur.
 A-X-H.B-1,D-3.M-4-2359 chiseled on granite rock in place
 18X18X8 ins.above the ground,with mound of stones.Whence:
 U.S.L.M.No.2359 Brs. S 37°.34'W 1931.14 feet.
 No bearings available.Loc.cor.post 4X4 ins.3 ft.above ground
 in mound of stones.
 Thence N 19°.05'E
 Va. 14°E

1500 To Cor.No.2.
 Identical with the loc.
 Granite stone 6X8X24 ins.set 12 ins.in the ground,with
 mound of stones,chiseled ~~B-H~~^B2-2359.
 No bearings available.Loc.cor.post 4X4 ins.X 3 ft.above
 the ground in mound of stones.
 Thence S 70°.55'E
 Va. 14°E

300 N.O.End.

600 To Cor.No.3.
 Identical with the loc.
 Malpai stone 10X10X26 ins.set 14 ins.in the ground with
 mound of stones,chiseled ~~B-H~~^B3-2359.Whence:
 X-E-R-H-~~B~~^B3-2359 chiseled on rock in place.brs.N 85°.20'E
 11.8 feet.No other bearings available.
 Loc.cor.Post 4X4 ins.by 3 ft.above the ground in mound
 of stones.
 Thence S 19°.05'W
 Va. 14°E

950 Cor.No.2 Key lode of this sur.

1500 To Cor.No.4.
 Identical with the loc.and with Cor.No.3 Mammoth and Cor.
 No.4. Blue Coat ^{cu #1 Key} lodes of this sur.
 X-H-E-4,M-3.B-C-4-^{K1}2359 Chiseled on granite rock in place
 3X3 ft.X 14 ins.above the ground,With mound of stones.
 Whence: X-E-R-H-E-4,M-3.B-C-4-^{K1}2359 chiseled on rock in
 place brs.S 82°10'E 14.7 feet.No other brs.available.

(2)

Feet.	Thence N $70^{\circ}.55'W$ Va, $14^{\circ}.E$
300	S.C.End.
600	To Cor.No.1 the place of beginning.
	KEY LODGE.
	Beginning at Cor.No.1
	Identical with the loc.and with Cors.No.4 Humming Bird, 3 Mammoth and No.4 Blue Coat lodes of this sur.hereinbefore described. whence:
	U.S.L.M.No.2359,brs.S $52^{\circ}.35'W$ 2196.93 feet.
	Thence N $19^{\circ}.05'E$ Va, $14^{\circ}.E$
550	To Cor.No.2.
	Identical with the loc.
	A Granite stone 6X10X24 ins.set 12 ins.in the ground,with mound of stones, chiseled 2-K-2359.No bearings available. Loc.cor.mon.of stones 3X3 ft.
	Thence S $70^{\circ}.55'W$ Va, $14^{\circ}.E$
300	N.C.End.
600	To Cor.No.3.
	Identical with the loc.
	X-K-3-2359 chiseled on malpai stone in place 10X10X12 ins. above the ground,with mound of stones.No brs.available. Loc.cor.mon.of stones.3X3 ft.
	Thence S $19^{\circ}.05'W$ Va, $14^{\circ}.E$
550	To Cor.No.4.
	Identical with the loc.and with Cor.No.3 Blue Coat lode of this sur. Malpai stone 6X6X24 ins.set 12 ins.in the ground,with mound of stones, chiseled K-4.B-C-3-2359. Loc.cor.mon.of stones 3X3 ft. <i>as above</i>
	X-B-R-K-4.B-C-3-2359 chiseled on rock in place brs.S $4^{\circ}.50'E$ 14.8ft. No other bearings available.
	Thence N $70^{\circ}.55'W$ Va, $14^{\circ}.E$
300	S.C.End.
600	To Cor.No.1 the place of beginning.

Survey No. 2359 BLUE COAT LODE.

Feet Beginning at Cor. No. 1
 Identical with the Cor. of loc. and with Cor. No. 1 Soil and
 No. 2² of Rosalie and Mammoth lodes of this sur.
~~X-P-C-1.C-1. R-2.~~ *Chiseled on Granite Rock in place 3X4X4 ft along ground* M-2-2359 with mound of
 stones. Whence.
 U.S.L.M. No. 2359 brs. S 85° 24' W 951.94 feet.
 X-B-R-B-C-1.C-1. R-2. M-2. 2359 chiseled on rock in place brs.
 N 22° 15' E 3.8' ft. No other bearings available.
 Loc. cor. mon. of stones. 3X3 ft.

Thence S 70° 55' E
Va. 14° E

300 S.C. End.

600 To Cor. No. 2.

Identical with the loc. and with Cor. No. 2 Soil lode of this
 sur.
 Granite stone 4X6X22 ins. set 12 ins. in the ground with
 mound of stones chiseled E-C-2, C-2-2359.
 No bearings available. Loc. cor. mon. of stones 3X3 ft.

Thence N 82° 30' E
Va. 14° E

1488 To Cor. No. 3.

Identical with the loc. and with cor. No. 4 Key lode of this
 sur. hereinafore described.

Thence N 70° 55' W
Va. 14° E

300 S.C. End.

600 To Cor. No. 4.

Identical with the loc. and with cor. 5 Mammoth & Humming
 Bird and No. 1 Key lodes of this sur. hereinafore described.

Thence S 32° 20' W
Va. 14° E

1488 To Cor. No. 1 the place of beginning.

MAMMOTH LODE.

Beginning at cor. No. 1.

Identical with the loc., and with Cor. 1 Rosalie and ^{Cor. 4} 4² of
 Silver Reef and Deposit lodes of this sur.

Granite stone 8X8X24 ins. set 12 ins. in the ground with
 mound of stones, chiseled M-1, R-1, S-R-4-D-4-2359. Whence:

(4)

SUBVEY No. 2359

U.S.L.M.No.2359 hrs. S 54° 24' W 469.47 feet.
No bearings available. Loc. cor. mon. of stones. 3X3 ft.

Thence S 70° 55' E
Va. 14° E

300
595
800

S.C. End.
Cr. Work 5' wide on S 78° W
To Cor. No. 2.

Identical with the loc. and with Cor. No. 2 Rosalie, 1 of Cecil and Blue Coat lodes of this sur. herein before described.

Thence N 32° 20' E
Va. 14° E

1488

To Cor. No. 3.

Identical with the loc. and with Cors. No. 3 Humming Bird, 1 Key and 4 of Blue Coat lodes of this sur. hereinbefore described.

Thence N 70° 55' W
Va. 14° E

300

N.S. End.

600

To Cor. No. 4.

Identical with the loc. and with Cors. No. 3 Deposit and No 1 Humming Bird lodes of this sur. hereinbefore described.

Thence S 32° 20' W
Va. 14° E

1488

To Cor. No. 1 the place of beginning.

DEPOSIT LODGE.

Beginning at Cor. No. 1

Identical with the loc. and with Cor. No. 1 of Silver Reef, Arlington and ^{Lode} Black lodes of this sur.

Granite stone 10X10X24 ins. set 12 ins. in the ground, with mound of stones, chiseled 1-D, 1-S-R, 1-A, 1-B-~~L~~ 2359. Whence:

U.S.L.M. No. 2359 hrs. S 16° 33' E 557 feet.

No bearings available. Loc. cor. mon. of stones 3X3 feet.

Thence N 32° 20' E
Va. 14° E

1488

To Cor. No. 2.

Identical with the loc. and with cor. No. 2 of Black ^{Lode} Lode of this sur.

A Granite ^{Stone} 10X10X24 ins. set 12 ins. in the ground, with mound of stones, chiseled. D-2, B-1-2-2359.

No bearings available. Loc. cor. mon. of stones 3X3 feet.

Thence S 64° 16' E.
Va. 14° E

500 N.C. End.

600 To Cor. No. 3.

Identical with the loc. and with Cor. No. 1 Humming Bird and 4 Mammoth lodes of this sur. hereinbefore described.

Thence S 32° 20' W
Va. 14° E

1488 To Cor. No. 4

Identical with the loc. and with cor. No. 1 of Mammoth and Rosalie and 4 of Silver Reef lodes of this sur. hereinbefore described.

Thence N 64° 16' W
Va. 14° E

300 S.C. End.

600 To Cor. No. 1 the place of beginning.

BLACK LODE, *Lode*

Beginning at Cor. No. 1.

Identical with the loc. and with cor. No. 1 of Deposit, Silver Reef and Arlington lodes of this sur. hereinbefore described. Whence.

U.S.L.M. No. 2359 brs. S 16° 33' E 557 feet.

Thence N 32° 20' E.
Va. 14° E

1488 To Cor. No. 2.

Identical with the loc. and with Cor. No. 1 Deposit lode of this sur. hereinbefore described.

Thence N 64° 16' W
Va. 14° E

300 N.C. End.

600 To Cor. No. 3.

Identical with the loc. and with Cor. No. 1 Deposit lode of this sur. hereinbefore described.

Granite Stone *10x12x24* ins. set 12 ins in the ground, with mound of stones, chiseled B.L-3-2359. Whence:

X-B-R-B-1-5-2359, chiseled on rock in place brs. S 12° 30' W

11.1 ft. Loc. cor. mon. of stones. 3X3 feet. *No Min. has available*

- Thence S $32^{\circ}20'W$.
Va. $14^{\circ}.E$
- 1488 To Cor. No. 4.
Identical with the loc. and with Cor. No. 4. Arlington lode of this sur.
Granite stone $8 \times 10 \times 24$ ins. set 12 ins. in the ground with mound of stones chiseled F-L-4, A-4-2359.
No bearings available. Loc. cor. mon. of stones 3×5 feet.
- Thence S $64^{\circ}.16'E$
Va. $14^{\circ}.E$
- 300 S. C. End.
- 600 To Cor. No. 1 the place of beginning.
- ARLINGTON. *Lode*
- Beginning at Cor. No. 1.
- 11
- Identical with the loc. and with Cor. No. 1 Black Lode Deposit and Silver Reef lodes of this sur. hereinbefore described.
Whence: U.S. LM, No. 2359 hrs. S $16^{\circ}33'W$ 557 feet.
- Thence S $11^{\circ}.01'W$
Va. $14^{\circ}.E$
- 1500 To Cor. No. 2.
Identical with the loc. and with Cor. No. 2 Silver Reef lode of this sur.
Granite stone $6 \times 10 \times 24$ ins. set 12 ins. in the ground with mound of stones, chiseled A-2, S-R-2-2359.
No bearings available. Loc. cor. mon. of stones 2×3 ft.
- Thence N $64^{\circ}16'W$
Va. $14^{\circ}.E$
- 300 S. C. End.
- 600 To Cor. No. 3.
Identical with the loc.
Granite stone $3 \times 7 \times 22$ ins. set 12 ins. in the ground with mound of stones, chiseled A-3-2359.
No bearings available. Loc. cor. mon. of stones 3×3 ft.
- Thence N $11^{\circ}.01'E$
Va. $14^{\circ}.E$
- 1500 To Cor. No. 4. Identical with the loc. and with Cor. No. 4 *Lode* Black Lode of this sur. hereinbefore described.

Survey No. 2359

300 N-C-End.
 600 To Cor.No.1 the place of beginning.

SILVER REEF LODGE.

Beginning at cor.No.1
 Identical with the loc. and with Cor.No.1 of Arlington,
 Black Lode and Deposit lodes of this sur hereinbefore de-
 scribed. Whence: U.S.L.M.No.2359 brs. S-16°.33'E 557 ft.

1500 To Cor.No.2.
 Identical with the loc. and with cor.No.2 Arlington lode of
 this sur. hereinbefore described.

300 S.C-End.
 600 To Cor.No.3.
 Identical with the loc. and with cor.No.3 Rosalie lode of this
 sur.
 Granite stone 3X3X34 ins. set 12 ins. in the ground with
 mound of stones, chiseled S-R-3, P-4-2359.
 No bearings available. Loc. cor. mon. of stones. 3X5 feet.

1500 To Cor.No.4.
 Identical with the loc. and with Cor.No.1 of Rosalie and
 Mammoth and 4 of Deposit lodes of this sur. hereinbefore
 described.

300 N.C-End.
 600 To Cor.No.1 the place of beginning.

ROSALIE LODGE.

Beginning at Cor.No.1.
 Identical with the loc. and with Cor.No.1 Mammoth of
 Silver Reef and Deposit lodes of this survey hereinbefore
 described. Whence: U.S.L.M.No.2359 brs. S54°24'W 469.47 ft.

300 To N.C. End.
 595 Cr. wash course S 70° .55' E
 600 To Cor. No. 2
 Va. 14° .E

Identical with the loc. and with Cor. No. 2 Mammoth and cor. No. 1 Cecil and Blue Coat lodes of this sur. hereinbefore described.

1500 To Cor. No. 3.
 Thence S 11° .01' W
 Va. 14° .E

Identical with the loc. and with Cor. No. 4 Cecil lode of this ^{Granite 9 loc.} sur. 4x10 ins. set 18 ins. in the ground, with mound of stones chiseled S-R. 4-0-2359.
 No. bearings available. Loc. cor. mon. of stones 3x3 ft.

300 S.C. End.
 510 Cr. wash course S 70° .55' W
 600 To Cor. No. 4
 Va. 14° .E

Identical with the loc. and with Cor. No. 3 Silver Reef lode of this sur. hereinbefore described.

1500 To Cor. No. 1 the place of beginning.
 Thence N 11° .01' W
 Va. 14° .E

CECIL LODE.

Beginning at Cor. No. 1.

Identical with the loc. and with Cor. No. 1 Blue Coat and Ros. of Mammoth and Rosalie lodes of this sur. hereinbefore described. Thence: U.S.L.M. No. 2359 bes. 85° 24' 951.7/ ft.

300 N.C. End.
 600 To Cor. No. 2
 Thence S 70° .55' E
 Va. 14° .E

Identical with the loc. and with Cor. No. 2 Blue Coat lode of this sur. hereinbefore described.

1500 To Cor. No. 3.
 Thence S 11° .01' W
 Va. 14° .E

Identical with the loc.

Granite stone 8x8x24 ins. set 12 ins. in the ground with mound of stones, chiseled 2-3-2359. *Whence*
 X-3-R-3-3-2359 chiseled on rock in place obs. N 47°.34'E
 24 feet. No other bearings available.
 Loc. approx. of stones 3x5 ft.

Whence N 70°.55'W
 Va. 14°.E

300 S.C. End.

600 To Cor. No. 4.

Identical with the loc. and with cor. No. 3 Rosalie lode of this survey hereinbefore described.

Thence N 11°.01'E
 Va. 14°.E

1500 To Cor. No. 1 the place of beginning.

AREA.

Humming Bird lode total and net area.....20.681 Acres. ✓

Key	"	"	"	"	"	7.575	"
Blue Coat	"	"	"	"	"	19.35	"
Mammoth	"	"	"	"	"	19.950	" ✓
Deposit	"	"	"	"	"	20.359	" ✓
Black Lode	"	"	"	"	"	20.359	" ✓
Arlington	"	"	"	"	"	19.983	"
Silver Reef	"	"	"	"	"	19.983	"
Rosalie	"	"	"	"	"	20.456	" ✓
Cecil	"	"	"	"	"	20.456	" ✓

Total net area of lode claim189.⁷³²~~33~~ acres.

Location -

This claim is located on unsurveyed land approximately in Twp. 10. N. R. 4 E. Copper Creek Mining District, Yavapai County Arizona.

Adjoining Claims -

This claim is bounded on the North by Copper King No. 3, Copper Queen Nos. 9, 10 and 11, ^{Lodes} unsurveyed, on the East by Yellow Astor Nos. 17, 18 and 19, ^{Lodes} surveyed on the South by New York, Olive and Look lodes unsurveyed and on the West by U.S. Land.

Ledge -

Humming Bird ledge hrs N19° 05' E 1500 ft. from S.C. End.
 Key " hrs. N 49° 05' E 550 ft. from S.C. End.
 Blue Coat " hrs. N 32° 20' E 1488 ft. from S.C. End.
 Mammoth " hrs. N 32° 20' E 1488 ft. from S.C. End.
 Deposit " hrs. N 32° 20' E 1488 ft. from S.C. End.
 Black Lode " hrs N 32° 20' E 1488 ft. from S.C. End.
 Arlington " hrs. S 11° 01' W 1500 ft. from N.C. End.
 Silver Reef " hrs S 11° 01' W 1500 ft. from N.C. End.
 Rosalie " hrs. S 11° 01' W 1500 ft. from N.C. End.
 Cecil " hrs. S 11° 01' W 1500 ft. from N.C. End.

Improvements -

I certify that the value of the labor and improvements upon this claim, placed thereon by the claimants and their heirs - grantors, is not less than five hundred dollars for each and every lode, and that said improvements consist of:

KEY LODE:

No. 1 Dis. Cut hrs. S 84° 30' E 265 feet from Cor. No. 1
 4X30X18 ft. face Value..... \$50.00

\$450.00 of the work in No. 3 Tunnel Rosalie lode is credited to this lode..... 450.00

HUMMING BIRD LODE.

No. 1 Dis. Cut hrs. N 19° 05' E 120 ft. from S.C. End.
 4X20X10 ft. value. \$50.00

\$450.00 of the work in No. 3 Tunnel Rosalie lode is credited to this lode..... 450.00

BLUE COAT LODE

No. 1 Dis. Shaft hrs N 32° 20' E 40' from S.C. End 4x6x10 ft. Value \$100.00
 No. 2 shaft hrs. S 0° 45' E 712 feet from Cor. No. 4
 4X6X10 ft. value \$100.00

\$400.00 of the work in No. 3 Tunnel Rosalie lode is credited to this lode..... 400.00

MAMMOTH LODE

No. 1 Dis. shaft hrs. N 32° 20' E 255 ft. from S.C. End.
 4X6X10 ft. Value..... \$100.00

" 2 shaft hrs. N 68° 10' E 459 ft. from Cor. No. 1
 4X8X50 ft. value..... \$500.00

" 3 shaft which hrs. N 60° 05' E 480 ft. from cor. No. 1
 4X6X10 ft. value..... \$100.00

- No. 4 shaft which brs. N 59° E 692 ft. from cor. No. 1
4X6X25 ft. value..... \$250.00
- " 5 shaft which brs. S 12° 25' W 575 ft. from Cor. No. 4
4X6X25 ft..... Value \$250.00
- " 6 shaft which brs. S 8° E 450 ft. from Cor. No. 4
4X6X10 ft..... Value \$100.00
189 ft
- " 7 Shaft which brs. N 62° 45' E from cor. No. 1
4X6X75 ft..... value \$750.00 \$300.00 credited to
Rosalia lode, and \$400.00 to Black Lode lode, \$100.00 to this lode. Value \$30.00

DEPOSIT LODE.

- No. 1 dis. shaft which brs. N 33° 00' E from S. Cr. End 75 ft.
4X6X10 ft..... value..... \$100.00
- " 2 shaft which brs. S 5° ^{20'} W 604 ft. from Cor. No. 3
4X6X10 ft..... value..... \$100.00
\$300.00 of the work in shaft No. 7 ^{Mammoth} Rosalia lode is
credited to this lode. \$300.00

BLACK LODE LODE.

- No. 1 dis. shaft brs. N 32° 20' E 325 ft. from S. C. End.
4X6X10 ft..... Value..... \$100.00
\$400.00 of the work in No. 7 shaft Mammoth lode is
credited to this lode.

ARLINGTON LODE.

- No. 1 dis. shaft which brs. N 11° 01' E 50 ft. from S. C. End.
4X6X10 ft..... value..... \$100.00
- No. 2 shaft which brs. S 21° 30' W 820 ft. from Cor. No. 1
4X6X10 ft... value..... \$100.00
- " 3 Cut which brs. S 18° 30' W 760 ft. from cor. No. 1
4X7X40 ft..... value..... \$100.00
- " 4 shaft which brs. S 36° 45' W 440 ft. from Cor. No. 1
4X6X10 ft..... value..... \$100.00
\$100.00 of the work in shaft No. 3 Rosalie lode is
credited to this lode.

SILVER REEF LODE.

- No. 1 dis. shaft brs. N 11° 01' E 550 ft. from S. C. End.
4X6X10 ft..... value..... \$100.00
- " 2 shaft brs. S 5° E 420 ft. from Cor. No. 1
4X6X10 ft..... value..... \$100.00
- " 3 shaft brs. S 29° E 260 ft. from cor. No. 1
4X6X20 ft..... value \$200.00
\$100.00 of the work in No. 2 shaft Rosalie lode is
credited to this lode.

ROSALIE LODE.

- No. 1 dis. shaft which brs. S 11° 01' W 30 ft. from
N. C. End. 4X6X10 ft..... value..... \$100.00
- " 2 shaft which brs. S 45° 10' W 432 ft. from cor. No. 2
4X8X97 ft. timbered value \$2425.00
- " 3 tunnel which brs. S 38° 30' W 500 ft. from cor. No. 2
5X7X 285 ft. course W 11° E 100 ft. thence N 14° W
185 ft..... value..... \$2850.00
value to be credited to Key lode; \$450.00 to the Humming Bird; \$450.00 to Blue Bear lode; \$1500.00 to this lode

CECIL LODE

- No. 1 dis. shaft which brs. S 11° 01' W 60 ft. from N. C. End.
4X6X10 ft..... value..... \$100.00
- " 2 cut which brs. S 80° 45' W 105 ft. from Cor. No. 2
4X25X18 ft..... value... \$100.00
- " 3 shaft which brs. S 48° 15' W 448 ft. from cor. No. 2
4X6X10 ft..... value..... \$100.00
\$200.00 of the work in No. 2 shaft Rosalie lode is
credited to this lode.

Value of 20 shafts

(12)

Note: ~~NOTE~~ The ledges are tracable on the surface.

This survey was made with a Gurley light mountain solar transit. The courses were deflected from the true meridian as determined from direct solar observations. The distances were measured with 100-ft. and 500 ft. steel tapes.

Note. The claimants intend to work these lodes as a group connecting the deep workings, in depth they intend to cross-out from No. 3 shaft on Rosalie lode, into Cecil ~~KA~~ lode on the East and cross out West into Silver Reef and Arlington lodes; they intend extending No. 3 Tunnel Rosalie lode through Mammoth lode into Humming Bird lode, and cross out into Key and Blue Coat lodes, also cross-out West from No. 7 shaft Mammoth lode across Deposit lode into Black Lode lode.

.....
William H. Merritt
 U.S. Dep. Mineral Surveyor.

DEC 3-1908 144

U.S.L.M.No.2359.

As there are no corners of the public survey and no monuments within the prescribed limits, I established U.S.L.M.No.2359 by chiseling U.S.L.M.No.2359 on a Granite stone in place 16 X 18 X 36 ins.above the ground,with mound of stones 6 ft.base by 6 ft high. Whence:

West edge of bluff brs. N 54°.57'E

X-B.R-U-S-L-M-No.2359 chiseled on rock in place
brs. N 79°.32'E 9.1 feet.

East edge of bluff brs. S 80°.10'E

X-B.R.-U-S-L-M-No.2359 chiseled on rock in place brs.
S 20°.39'E 12.1 feet.

A Rocky peak brs. S 2°.22'W!

East edge of square top peak brs. S 8°.02'W

A sharp peak brs.S 31°.01'W

X-B.R.-U-S-L-M-No.2359 chiseled on rock in place brs
S 66°38'W 33.4 feet.

Highest point in Bradshaw Mts.brs.N 88°.36'W

This monument is located on the North point of a high ridge on unsurveyed land approximately in T.10 N.R.4 E.

Copper Creek Mining District, Yavapai County Arizona.

About 9 miles East of Richbar and about 25 miles South Easterly from Mayer.

William H. Nesbit,
U.S. Dep. Mineral Surveyor.

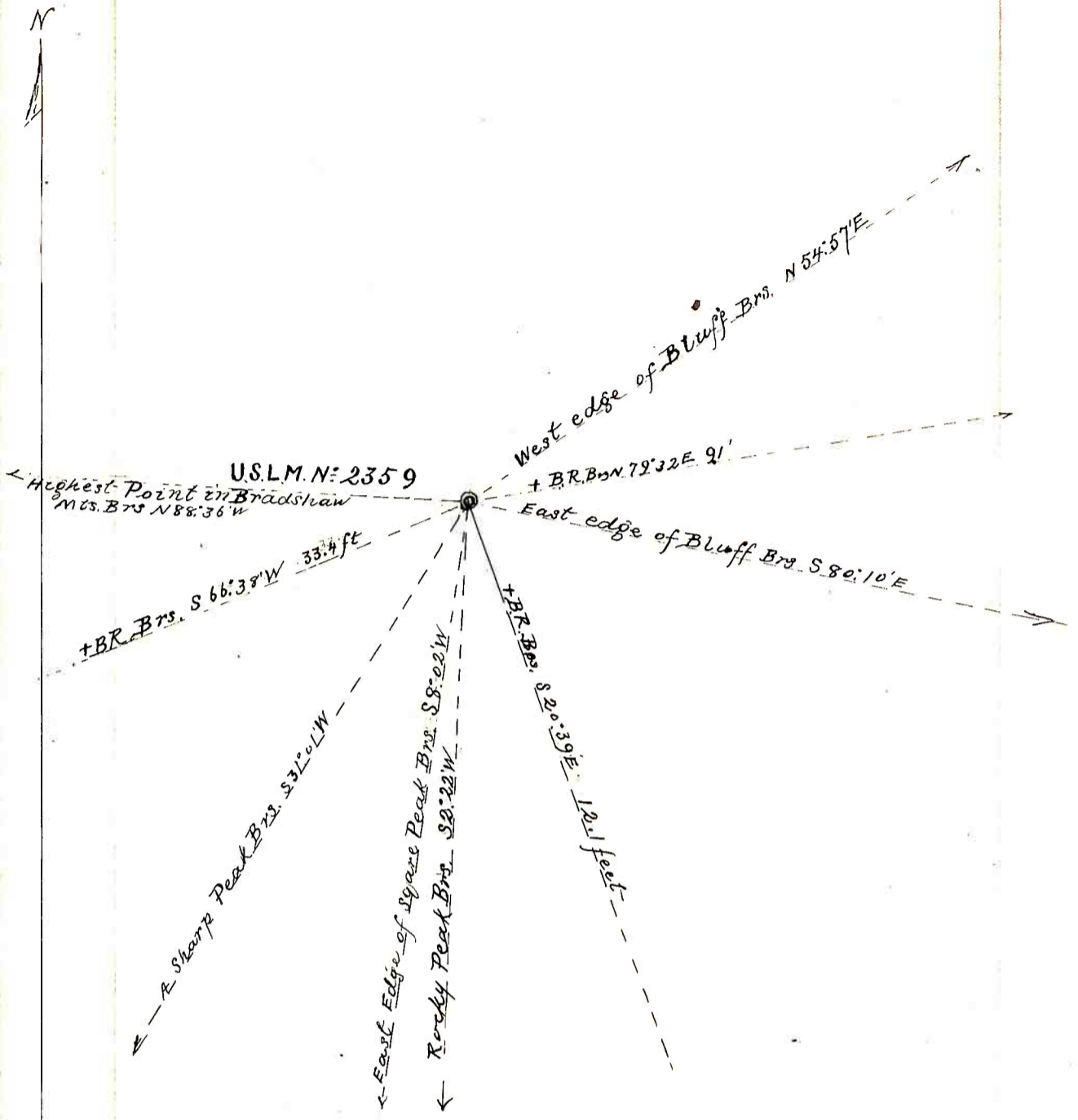

N

S

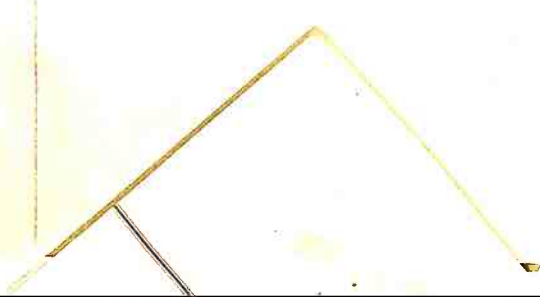

FINAL OATHS FOR SURVEYS.

LIST OF NAMES.

A list of the names of the individuals employed by William H. Merritt

United States Deputy Mineral Surveyor, to assist in running, measuring, and marking the lines, corners, and boundaries described in the foregoing field notes of the survey of the mining claim of.....

known as the Rosalie, Mammoth, Silver Reef, Arlington, Blue Court, Cecil, Black Sand, Hummit and, + Deposit + Key

and showing the respective capacities in which they acted.

W. H. Merritt, Chainman.

....., Chainman.

....., Axman.

....., Flagman.

FINAL OATHS OF ASSISTANTS.

W. H. Merritt

and....., do solemnly swear that we assisted.....

William H. Merritt, United States Deputy Mineral Surveyor, in marking the corners and surveying

the boundaries of the mining claim of Rosalie Copper Company

known as the Rosalie, Mammoth, Silver Reef, Arlington, Blue Court, Cecil, Black Sand, Hummit and, + Deposit + Key

represented in the foregoing field notes as having been surveyed by said deputy mineral surveyor and under his direction; and that said survey has been in all respects, to the best of our knowledge and belief, faithfully and correctly executed, and the corner and boundary monuments established according to law and the instructions furnished by the United States Surveyor-General for Arizona

W. H. Merritt, Chainman.

....., Chainman.

....., Axman.

....., Flagman.

Subscribed and sworn to by the above-named persons before me this 18th

day of December, 1906

W. H. Merritt

Notary Public

14224b5m8-04
My Commission Expires July 7th 1909

(4-686.)

FINAL OATH OF U. S. DEPUTY MINERAL SURVEYOR

I, William H. Merritt, U. S. Deputy Mineral Surveyor, do solemnly swear that, in pursuance of instructions received from the United States Surveyor General for Arizona, dated Nov 19th 1906, I have, in strict conformity to the laws of the United States, the official regulations and instructions thereunder, and the instructions of said Surveyor General, faithfully and correctly executed the survey of the Mining Claim of Rosalie Copper Company known as the Rosalie, Mammoth, Silver Reef, Arlington, Blue Creek, Cecil, Black Lodge, Humming Bird, Dephant, + Key, situate in Copper Creek Mining District, Yavapai County, Arizona, in Section _____, Township No. _____, Range No. _____, and designated as Survey No. 2359, as represented in the foregoing field notes, which accurately show the boundaries of said mining claim as distinctly marked by monuments on the ground, and described in the attached copy of the location certificate, which was received by me from the Surveyor General with said instructions, and that all the corners of said survey have been established and perpetuated in strict accordance with the law, official regulations and instructions thereunder; and I do further solemnly swear that the foregoing are the true and original field notes of said survey and my report therein, and that the labor expended and improvements made upon said mining claim by claimant or these its grantors are as therein fully stated, and that the character, extent, location and itemized value thereof are specified therein with particularity and full detail, and that no portion of said labor or improvements so credited to this claim has been included in the estimate of expenditures upon any other claim.

William H. Merritt
U. S. Deputy Mineral Surveyor.

Subscribed and sworn to by the said William H. Merritt,
U. S. Deputy Mineral Surveyor, before me a notary Public in and for
Yavapai County, Arizona this first
day of December 1906,

my Commission
Expires Nov 1-1909

Ziba O. Brown, Notary Public
Yavapai County, Arizona

Affidavit of Five Hundred Dollars Improvements.

We, R. L. Hogue and F. M. Merritt

of lawful age, being first duly sworn according to law, depose and say: That we are acquainted with the Rosalie Mammoth Silver Rock Arbuckle Blue Creek Cecil Blair Nebraska Delaware 410 mining claim, situate in Copper Creek

mining district, Yavapai County, Arizona Territory, for which

Rosalie Copper Company

has made application for survey prior to application for patent under the provisions of the Act of Congress

approved May 10, 1872; and that the labor done and improvements made thereon by the applicant... and

has its grantors... exceed five hundred dollars in value, for each and every block and further that we are not personally interested

in said mine.

R. L. Hogue
F. M. Merritt

TERRITORY OF ARIZONA,
COUNTY OF Yavapai } ss:

Sworn to and subscribed before me this 18th day

of December, 1904.

[SEAL.]

W. B. Merritt
Notary Public

17171b400-3-05

My Commission Expires
July 7th 1909

"ROSALIE."

NOTICE OF MINING LOCATION.
Lode Claim.

To all whom it may concern:

This Mining Claim, the name of which is the Rosalie Mining Claim, situate on lands belonging to the United States of America, and in which there are valuable mineral deposits, was entered upon and located for the purpose of exploration and purchase by John A. McCracken, a citizen of the United States of America, the undersigned, on the First day of January, 19001.

The length of this claim is (1500) fifteen hundred feet, and I claim (600) Six hundred feet in a South direction and (900) nine hundred feet in a North direction from the center of the discovery shaft, at which this notice is posted, lengthwise of the claim, together with (300) three hundred feet in width of the surface grounds, on each side of the center of said claim. The general course of the lode deposit and premises is from the North to the South.

The claim is situated and located in the Copper Creek Mining District, in Yavapai County, in the Territory of Arizona, about one mile in a Eastern direction from Lary Hesters Ranch and is a relocation and was formally called the New Eldorado, formally owned by Olive M. Nellis and Maude M. Clifford no work having been done in the year Nineteen hundred. I locate the claim.

The surface boundaries of the claim are marked upon the ground as follows: Beginning at post at a point in a Southern direction (600) Six hundred feet from the discovery shaft (at which this notice is posted), being in the center of the South end line of said claim; thence (300) three hundred feet to a Post being the Southwest corner of said claim; thence North 750 Seven hundred & fifty feet to a Post at the center of the west side line of said claim; thence North (750) Seven hundred & fifty feet to a Post being at the Northwest corner of said claim; thence East (300) three hundred feet to a Post at the center of the North end of said claim; thence East (300) three hundred feet to a Post, being at the Northeast corner of said claim; thence South (750) Seven hundred & fifty feet to a Post being at the center of the East side line of said claim; thence South (750) Seven hundred & fifty feet to a Post at the South East corner of said claim; thence West (300) three hundred feet to the place of beginning.

All done under the provisions of Chapter Six, of Title XXXII, of the Revised Statutes of the United States, and of an Act of the General Assembly of Arizona, entitled "An Act Concerning Mines", approved March 20th, 1895, and amended March 2d, 1899.

Dated and posted on the ground this First day of January, 19001.

John A. McCracken.

Witness C. W. Hardy.
Witness James Grace.

Filed and recorded at request of John A. McCracken March 18th A. D. 1901, at 9 o'clock A. M., Book 57 of Mines, page 258, Records of Yavapai County, Arizona.

By F. J. Gibbons, Deputy Recorder. (Seal) P. J. Farley, County Recorder.

"MAMMOTH".

NOTICE OF MINING LOCATION.
Lode Claim.

To all whom it may concern:

This Mining Claim, the name of which is the Mammoth Mining Claim, situate on lands belonging to the United States of America, and in which there are valuable mineral deposits, was entered upon and located for the purpose of exploration and purchase by John A. McCracken, a citizen of the United States of America, the undersigned, on the First day of January, 1901.

The length of this claim is (1500) fifteen hundred feet, and I claim (300) three hundred feet in a Southern direction and (1200) Twelve hundred feet in a northern direction from the center of the discovery shaft, at which this notice is posted, lengthwise of the claim, together with (300) Three hundred feet in width of the surface grounds, on each side of the center of said claim. The general course of the lode deposit and premises is from the North to the South.

The claim is situated and located in the Copper Creek Mining District, in Yavapai County, in the Territory of Arizona, about one mile in a Northeastern direction from Larry Heslers Ranch and is a re-location and was formally called the Antler formally owned by Olive M. Nellis and Maude M. Clifford no work having been done in year Nineteen hundred. I locate the claim.

The surface boundaries of the claim are marked upon the ground as follows: Beginning at a post at a point in a Southern direction (300) Three hundred feet from the discovery shaft (at which this notice is posted), being in the center of the South end line of said claim; thence West (300) Three hundred feet to a post being the Southwest corner of said claim; thence north (750) Seven hundred & fifty feet to a post at the center of the west side line of said claim; thence North (750) Seven hundred & fifty feet to a post being at the Northwest corner of said claim; thence East (300) Three hundred feet to a post at the center of the north end of said claim; thence East (300) Three hundred feet to a post, being at the Northeast corner of said claim; thence South (750) Seven hundred & fifty feet to a post being at the center of the East side line of said claim; thence South (750) Seven hundred & fifty feet to a post at the Southeast corner of said claim; thence West (300) Three hundred feet to the place of beginning.

All done under the provisions of Chapter Six, of Title XXXII, of the Revised Statutes of the United States, and of an Act of the General Assembly of Arizona, entitled "An Act Concerning Mines", approved March 20th, 1895, and amended March 2d, 1899.

Dated and posted on the ground this First day of January, 1901.

John A. McCracken.

Witness C. W. Hardy.

Witness James Grace.

Filed and recorded at request of John A. McCracken March 18th A. D. 1901, at 9 o'clock A. M., Book 57 of Mines, page 259, Records of Yavapai County, Arizona.

By F. J. Gibbons,
Deputy Recorder.

(Seal) P. J. Farley,
County Recorder.

"SILVER REEF."

NOTICE OF MINING LOCATION.
Lode Claim.

To all whom it may concern:

This Mining Claim, the name of which is the Silver Reef Mining Claim, situate on lands belonging to the United States of America, and in which there are valuable mineral deposits, was entered upon and located for the purpose of exploration and purchase by Olive M. Nellis, a citizen of the United States, the undersigned, on the 6th day of January, 1901.

The length of this claim is 1500 feet, and I claim 750 feet in a South direction and 750 feet in a north direction from the center of the discovery shaft, at which this notice is posted, lengthwise of the claim, together with 300 feet in width of the surface grounds, on each side of the center of said claim. The general course of the lode deposit and premises is from the North to the South.

The claim is situated and located in the Copper Creek Mining District, in Yavapai County, in the Territory of Arizona, about $3\frac{1}{4}$ mile in a northeast direction from Larry Hesners Ranch and lays on the west side of the "Rosalie" claim and is joined on the north end by the Crazy Horse claim.

The surface boundaries of the claim are marked upon the ground as follows: Beginning at post at a point in a South direction 750 feet from the discovery shaft (at which this notice is posted), being in the center of the South end line of said claim; thence 300 feet to a monument being the Southwest corner of said claim; thence 750 feet to a monument at the center of the West side line of said claim; thence 750 feet to a monument being at the Northwest corner of said claim; thence 750 feet to a monument at the center of the North end of said claim; thence 300 feet to a monument, being at the Northeast corner of said claim; thence 750 feet to a monument being at the center of the East side line of said claim; thence 750 feet to a monument at the Southeast corner of said claim; thence 300 feet to the place of beginning.

All done under the provisions of Chapter Six, of Title XXXII, of the Revised Statutes of the United States, and of an Act of the General Assembly of Arizona, entitled "An Act Concerning Mines", approved March 20th, 1895, and amended March 2d, 1899.

Dated and posted on the ground this 6th day of January, 1901.

Olive M. Nellis.

Witnesses: Merrit Shelton.
Wm. Nellis, Agent.

Filed and recorded at request of A. D. Shultz March 30th A. D. 1901, at 1:50 o'clock P. M., Book 57 of Mines, page 368, Records of Yavapai County, Arizona.

By F. J. Gibbons, (Seal) P. J. Farley,
Deputy Recorder. County Recorder.

"DEPOSIT."

NOTICE OF MINING LOCATION.
Lode Claim.

To all whom it may concern:

This Mining Claim, the name of which is the Deposit Mining Claim, situate on lands belonging to the United States of America, and in which there are valuable mineral deposits, was entered upon and located for the purposes of exploration and purchase by Joe Mayer and D. N. Bartholdi we are citizens the undersigned, on the 1st day of June, 1903.

The length of this claim is 1500 fifteen hundred feet, and we claim 750 feet in a North direction and 750 feet in a South direction from the center of the discovery shaft, at which this notice is posted, lengthwise of the claim, together with 300 feet in width of the surface grounds, on each side of the center of said claim. The general course of the lode deposit and premises is from the North to the South.

The claim is situated and located in the Copper Creek Mining District, in Yavapai County, in the Territory of Arizona, about 23 miles in a South east direction from Mayer and about 7 miles east of Richenbar and 6 miles north of the Fuller property.

The surface boundaries of the claim are marked upon the ground as follows: Beginning at Post at a point in a South direction 750 feet from the discovery shaft (at which this notice is posted), being in the center of the South end line of said claim; thence West 300 feet to a Post, being the S. W. corner of said claim; thence North 1500 feet to a Post, being at the N. W. corner of said claim; thence East 300 feet to a Post at the center of the North end of said claim; thence East 300 feet to a Post, being at the N. E. corner of said claim; thence South 1500 feet to a Post at the S. E. corner of said claim; thence West 300 feet to the place of beginning.

All done under the provisions of Chapter Six, of Title XXXII, of the Revised Statutes of the United States, and of an Act of the General Assembly of Arizona, entitled "An Act to Revise and Codify the Laws of the Territory of Arizona", approved March 16, 1901.

Dated and posted on the ground this 1st day of June, 1903.

Joe Mayer.

D. N. Bartholdi.

Witness:)
Wm. Nellis.)

Filed and recorded at request of D. N. Bartholdi Aug. 4" A. D. 1903, at 4:15 o'clock P. M., Book 69 of Mines, page 230, Records of Yavapai County, Arizona.

By M. A. Lawler, (Seal) P. J. Farley,
Deputy Recorder. County Recorder.

"ARLINGTON".

NOTICE OF MINING LOCATION.
Lode Claim.

To all whom it may concern:

This mining claim, the name of which is the Arlington Mining Claim, situate on lands belonging to the United States of America, and in which there are valuable mineral deposits, was entered upon and located for the purposes of exploration and purchase by Joe Mayer and D. N. Bartholdi the undersigned, on the 1st day of June 1903.

The length of this claim is 1500 Fifteen hundred feet, and we claim 240 feet in a Northerly direction, and 1260 feet in a South direction from the center of the discovery shaft, at which this notice is posted, lengthwise of the claim, together with 300 feet in width of the surface grounds, on each side of the center of said claim. The general course of the lode deposit and premises is from the North to the South.

The claim is situated and located in the Copper Creek Mining District, in Yavapai County, in the Territory of Arizona, about 23 miles in a South East direction from Mayer Station and about 7 miles East of Richenbar and about 6 miles North of the Fuller property.

The surface boundaries of the claim are marked upon the ground as follows: Beginning at a Post at a point in a North direction 240 feet from the discovery shaft (at which this notice is posted), being in the center of the North end line of said claim; thence East 300 feet to a Post, being the N. E. corner of said claim; thence South 1500 feet to a Post, being at the South east corner of said claim; thence West 300 feet to a Post at the center of the South end of said claim; thence West 300 feet to a Post, being at the S. W. corner of said claim; thence North 1500 feet to a Post at the N. W. corner of said claim; thence East 300 feet to the place of beginning.

All done under the provisions of Chapter Six, of Title XXXII, of the Revised Statutes of the United States, and of an Act of the General Assembly of Arizona, entitled "An Act to Revise and Codify the Laws of the Territory of Arizona", approved March 16, 1901.

Dated and posted on the ground this 1st day of June 1903.

Joe Mayer.

D. N. Bartholdi.

Witness:)
 Wm. Nellis.)

Filed and recorded at request of D. N. Bartholdi Aug. 4th A. D. 1903, at 4:15 o'clock P. M., Book 39 of Mines, page 231, Records of Yavapai County, Arizona.

By M. A. Lawler,
Deputy Recorder.

(Seal) P. J. Farley,
County Recorder.

BLACK LODE.

NOTICE OF MINING LOCATION.
Lode Claim.

To all whom it may concern:

This mining claim, the name of which is the Black Lode Mining Claim, situate on lands belonging to the United States of America, and in which there are valuable mineral deposits, was entered upon and located for the purpose of exploration and purchase by Joe Mayer and D. N. Bartholdi the undersigned, on the 1st day of June, 1903.

The length of this claim is 1500 feet, and we claim 950 feet in a Northerly direction, and 550 feet in a Southerly direction from the center of the discovery shaft, at which this notice is posted, lengthwise of the claim, together with Three Hundred (300) feet in width of the surface grounds, on each side of the center of said claim. The general course of the lode deposit and premises is from the Northerly to the Southerly.

The claim is situated and located in the Copper Creek Mining District, in Yavapai County, in the Territory of Arizona, about 23 miles in a East direction from Mayer and is one of the Rosalie group.

The surface boundaries of the claim are marked upon the ground as follows: Beginning at a monument of stones at a point in a Northerly direction 950 feet from the discovery shaft (at which this notice is posted), being in the center of the North end line of said claim; thence Easterly 300 feet to a monument of stones, being the North east corner of said claim; thence Southerly 750 feet to a monument at the center of the East side line of said claim; thence Southerly 750 feet to a monument of stones, being at the Southeast corner of said claim; thence Westerly 300 feet to a monument of stones at the center of the South end of said claim; thence Westerly 300 feet to a monument of stones, being at the Southwest corner of said claim; thence Northerly 750 feet to a monument of stones being at the center of the West side line of said claim; thence Northerly 750 feet to a monument of stones at the Northwest corner of said claim; thence Easterly 300 feet to the place of beginning.

All done under the provisions of Chapter Six, of Title XXXII, of the Revised Statutes of the United States, and of an Act of the General Assembly of Arizona, entitled "An Act Concerning Mines", approved March 20th, 1895, and amended March 2d, 1899.

Dated and posted on the ground this 1st day of June 1903.

Joe Mayer.

D. N. Bartholdi.

Witness:)
Wm. Nellis.)

Recorded at request of D. N. Bartholdi Aug. 4th A. D. 1903, at 4:15 o'clock P. M., Book 69 of Mines, page 234, Records of Yavapai County, Arizona.

By M. A. Lawler, (Seal) P. J. Farley,
Deputy Recorder. County Recorder.

* * * * *

HUMMING BIRD.

NOTICE OF MINING LOCATION.
Lode Claim.

To all whom it may concern: The name of this claim was Sister Mary now called

This mining claim, the name of which is the The Humming Bird Mining Claim, situate on lands belonging to the United States of America, and in which there are valuable mineral deposits, was entered upon and located for the purposes of exploration and purchase by William Nellis, a citizen of the U. S. the undersigned, on the 1st day of January, 1904.

The length of this claim is 1500 feet, and I claim 125 feet in a south direction, and 1375 feet in a northerly direction from the center of the discovery shaft, at which this notice is posted, lengthwise of the claim, together with 300 feet in width of the surface grounds, on each side of the center of said claim. The general course of the lode deposit and premises is from the north to the south.

The claim is situated and located in the Copper Creek Mining District, in Yavapai County, in the Territory of Arizona, about 24 miles in a Southeast direction from Mayer Station and is a north extension of the Mammoth claim and is about 1200 feet north of the Rosalie claim.

The surface boundaries of the claim are marked upon the ground as follows: Beginning at This is an abandoned claim which formerly belonged to L. P. Nellis) Post at a point in a south direction 125 feet from the discovery shaft (at which this notice is posted), being in the center of the south end line of said claim; thence west 300 feet to a post, being the southwest corner of said claim; thence north 1500 feet to a post, being at the northwest corner of said claim; thence east 300 feet to a post at the center of the north end of said claim; thence east 300 feet to a post, being at the northeast corner of said claim; thence South 1500 feet to a post at the southeast corner of said claim; thence west 300 feet to the place of beginning.

All done under the provisions of Chapter Six, of Title XXXII, of the Revised Statutes of the United States, and of an Act of the General Assembly of Arizona, entitled "An Act to Revise and Codify the Laws of the Territory of Arizona", approved March 16, 1901.

Dated and posted on the ground this 1st day of January, 1904.

William Nellis.

Witnesses: G. Scholey.
John Nellis.

Filed and recorded at request of Joe Mayer March 31, A. D. 1904, at 9:00 o'clock A. M., Book 71 of Mines, page 382, Records of Yavapai County, Arizona.

By R. E. Butler,
Deputy Recorder.

(Seal) P. J. Farley,
County Recorder.

"BLUE COAT".

NOTICE OF MINING LOCATION.
Lode Claim.

To all whom it may concern:

This mining claim, the name of which is the Blue Coat Mining Claim, situate on lands belonging to the United States of America, and in which there are valuable mineral deposits, was entered upon and located for the purposes of exploration and purchase by D. N. Bartholdi and Joe Mayer we are citizens the undersigned, on the 1st day of June, 1903.

The length of this claim is 1500 feet, and we claim 600 feet in a North direction and 900 feet in a South direction from the center of the discovery shaft, at which this notice is posted, lengthwise of the claim, together with 300 feet in width of the surface grounds, on each side of the center of said claim. The general course of the lode deposit and premises is from the North to the South.

The claim is situated and located in the Copper Creek Mining District, in Yavapai County, in the Territory of Arizona, about 23 miles in a South east direction from Mayer and about 7 miles east of Richenbar and joins the Mammoth claim on the east and the Cecil on the South.

The surface boundaries of the claim are marked upon the ground as follows: Beginning at Post at a point in a South direction 900 feet from the discovery shaft (at which this notice is posted), being in the center of the South end line of said claim; thence West 300 feet to a Post, being the S. W. corner of said claim; thence North 1500 feet to a Post, being at the N. W. corner of said claim; thence East 300 feet to a Post at the center of the North end of said claim; thence East 300 feet to a Post, being at the N. E. corner of said claim; thence South 1500 feet to a Post at the S. E. corner of said claim; thence East 300 feet to the place of beginning.

All done under the provisions of Chapter Six, of Title XXXII, of the Revised Statutes of the United States, and of an Act of the General Assembly of Arizona, entitled "An Act to Revise and Codify the Laws of the Territory of Arizona", approved March 16, 1901.

Dated and posted on the ground this 1st day of June 1903.

Joe Mayer.

D. N. Bartholdi.

Witness:)
Wm. Nellis.)

Filed and recorded at request of D. N. Bartholdi Aug. 4" A. D. 1903, at 4:15 o'clock P. M., Book 69 of Mines, page 232, Records of Yavapai County, Arizona.

By M. A. Lawler,
Deputy Recorder.

(Seal) P. J. Farley,
County Recorder.

"CECIL".

NOTICE OF MINING LOCATION.
Lode Claim.

To all whom it may concern:

This mining claim, the name of which is the "Cecil" Mining Claim, situate on lands belonging to the United States of America, and in which there are valuable mineral deposits, was entered upon and located for the purposes of exploration and purchase by D. N. Bartholdi and Joe Mayer we are citizens the undersigned, on the 1st day of June, 1903.

The length of this claim is 1500 feet, and we claim 750 feet in a North direction, and 750 feet in a South direction from the center of the discovery shaft, at which this notice is posted, lengthwise of the claim, together with 300 feet in width of the surface grounds, on each side of the center of said claim. The general course of the lode deposit and premises is from the North to the South.

The claim is situated and located in the Copper Creek Mining District, in Yavapai County, in the Territory of Arizona, about 23 miles in a South East direction from Mayer and about 6 miles North of the Fuller Mine on Squaw Creek and is one of the Rosalie group.

The surface boundaries of the claim are marked upon the ground as follows: Beginning at Post at a point in a South direction 750 feet from the discovery shaft (at which this notice is posted), being in the center of the South end line of said claim; thence East 300 feet to a Post, being the S. W. corner of said claim; thence North 1500 feet to a Post, being at the N. W. corner of said claim; thence East 300 feet to a Post at the center of the North end of said claim; thence East 300 feet to a Post, being at the N. E. corner of said claim; thence South 1500 feet to a Post at the S. E. corner of said claim; thence West 300 feet to the place of beginning.

All done under the provisions of Chapter Six, of Title XXXII, of the Revised Statutes of the United States, and of an Act of the General Assembly of Arizona, entitled "An Act to Revise and Codify the Laws of the Territory of Arizona", approved March 16, 1901.

Dated and posted on the ground this 1st day of June 1903.

D. N. Bartholdi.

Joe Mayer.

Witness:)
Wm. Nellis.)

Filed and recorded at request of D. N. Bartholdi Aug. 4" A. D. 1903, at 4:15 o'clock P. M., Book 69 of Mines, page 233, Records of Yavapai County, Arizona.

By M. A. Lawler,
Deputy Recorder.

(Seal) P. J. Farley,
County Recorder.

* * * * *

TERRITORY OF ARIZONA,)
 County of Yavapai.) ss.

I, ROLAND MOSHER, County Recorder in and for the County of Yavapai, in the Territory of Arizona, and custodian of the records of said office, do hereby certify that I have compared the above and foregoing with, and the same contains a full, true and correct copy of the Notice of Location of each of the following described mining claims, as the same appear from the original record thereof in my said office, viz:

ROSALIE Mining Claim, notice of location whereof is of record in Book 57 of Mines, page 258, records of Yavapai County, Arizona;

MAMMOTH Mining Claim, notice of location whereof is of record in Book 57 of Mines, page 259, said records;

SILVER REEF Mining Claim, notice of location whereof is of record in Book 57 of Mines, page 368, said records;

DEPOSIT Mining Claim, notice of location whereof is of record in Book 69 of Mines, page 230, said records;

ARLINGTON Mining Claim, notice of location whereof is of record in Book 69 of Mines, page 231, said records;

BLUE COAT Mining Claim, notice of location whereof is of record in Book 69 of Mines, page 232, said records;

CECIL Mining Claim, notice of location whereof is of record in Book 69 of Mines, page 233, said records;

BLACK LODGE Mining Claim, notice of location whereof is of record in Book 69 of Mines, page 234, said records;

HUMMING BIRD Mining Claim, notice of location whereof is of record in Book 71 of Mines, page 382, said records.

IN WITNESS WHEREOF, I have hereunto set my hand and affixed my official seal, this 12th day of September, A. D. 1906.



Roland Mosher
 County Recorder.

**NOTICE OF MINING LOCATION.
LODE CLAIM.**

TO ALL WHOM IT MAY CONCERN:

This Mining Claim, the name of which is the "Key" Mining Claim, situate on lands belonging to the United States of America, and in which there are valuable mineral deposits, was entered upon and located for the purposes of exploration and purchase by Rosalie Copper Company, a corporation, and Located as abandoned lands the undersigned, on the 30th day of October 1906.

The length of this claim is 1500 feet, and we claim two hundred feet, in a Southerly direction and thirteen hundred feet in a Northerly direction from the center of the discovery cut, at which this notice is posted, lengthwise of the claim, together with Three hundred feet in width of the surface grounds, on each side of the center of said claim. The general course of the lode deposit and premises is from the Southerly to the Northerly.

The claim is situated and located in the Copper Creek Mining District, in Yavapai County, in the Territory of Arizona, about Eight Miles in a Easterly direction from The Richinbar Mines on bank of Agua Fria River.

The surface boundaries of the claim are marked upon the ground as follows: Beginning at this monument at a point in a Southerly direction about 200 feet from the discovery cut (at which this notice is posted), being in the center of the South end line of said claim, which is identical with N. E. center Blue Coat claim; thence 300 feet to a Monument, being the South East corner of said claim; thence Northerly 1500 feet to a Monument being at the North East corner of said claim; thence 300 feet Westerly to a Monument at the center of the North end of said claim; thence 300 feet Westerly to a Monument, being at the North West corner of said claim; thence Southerly 1500 feet to a Monument at the South West corner of said claim; thence Easterly 300 feet to the place of beginning.

All done under the provisions of Chapter Six, of Title XXXII, of the Revised Statutes of the United States, and of an Act of the General Assembly of Arizona, entitled "An Act to Revise and Codify the Laws of the Territory of Arizona," approved March 16, 1901.

Dated and posted on the ground this 30th day of October 1906.

Witness

L. E. Moses.

Rosalie Copper Company,

By W. M. Nellis,

First Vice President.

Filed and recorded at request of W. H. Merritt Nov. 5, A. D. 1906 at 2:20 o'clock P. M., Book 78 of Mines, Pages _____ Records of Yavapai County, Arizona.

(Seal)

Roland Mosher,

County Recorder.

By _____

Deputy Recorder.

TERRITORY OF ARIZONA,)
) SS.
 County of Yavapai.)

I, ROLAND MOSHER, County Recorder in and for the County of Yavapai, in the Territory of Arizona, and custodian of the records of said office, do hereby certify that I have compared the above and foregoing with, and the same is a full, true and correct copy of the Notice of Location of the "KEY" Mining Claim, as the same appears from the original instrument recorded in my said office on the 5th day of November, A. D. 1906, at 2:20 o'clock p. m.

IN WITNESS WHEREOF, I have hereunto set my hand and affixed my official seal, this 7th day of November, A. D. 1906.



Roland Mosher

County Recorder.

By E. B. Avery Deputy.

4-687.

SURVEYOR-GENERAL'S CERTIFICATE OF APPROVAL OF FIELD
NOTES AND SURVEY OF MINING CLAIM.

Department of the Interior,

Office of U. S. Surveyor-General,

Phoenix, Arizona,

February 18, 1907

I, U. S. Surveyor-General for District of Arizona

do hereby certify that the foregoing and hereto attached Field Notes and Return of the Survey of the
Mining Claim of Rosalie Copper Company

....., known as the
Rosalie, Mammoth, Silver Reef, Arlington, Blue Coat, Cecil,
Black Lode, Humming Bird, Deposit, Key
situate in Copper Creek Mining District,
Yavapai County, Arizona

in Section, Township No., Range No.

....., designated as Survey No. 2359

executed by William H. Merritt, U. S. Deputy Mineral

Surveyor, Nov. 21-27, 1906, under my instructions dated

Nov. 19, 1906, have been critically examined and the necessary cor-

rections and explanations made, and the said Field Notes and Return, and the Survey they describe,

are hereby approved. A true copy of the copy of the location certificate filed by the applicant.. for

survey is included in the field notes.



U. S. Surveyor-General for Arizona.

4-688.

U. S. SURVEYOR-GENERAL'S FINAL CERTIFICATE ON FIELD NOTES.

Department of the Interior,

OFFICE OF U. S. SURVEYOR-GENERAL,

Phoenix, Arizona,

February 18, 1907

I, U. S. Surveyor-General for District of Arizona

do hereby certify that the foregoing transcript of the Field Notes, return and approval of the survey of the mining claim of Rosalie Copper Company

known as the Rosalie, Mammoth, Silver Reef, Arlington, Blue Coat, Cecil. Black Lode, Humming Bird, Deposit, Key. Copper Creek situate in

Mining District, Yavapai County, Arizona

in Section, Township No., Range No., and

designated as Survey No. 2359, has been correctly copied from the originals on file in this office; that said Field Notes furnish such an accurate description of said mining claim as will, if incorporated into a patent, serve fully to identify the premises, and that such reference is made therein to natural objects or permanent monuments as will perpetuate and fix the locus thereof.

And I further certify that five hundred dollars' worth of labor has been expended or improvements made upon said mining claim by claimant or its grantors, and that said improvements consist of 22 shafts, 4 cuts, and 1 tunnel, at a total value of \$9125.00

and that no portion of said labor or improvements has been included in the estimate of expenditures upon any other claim.

I further certify that the plat thereof, filed in the U. S. Land Office at Phoenix, Arizona is correct and in conformity with the foregoing Field Notes.

Frank S. Ingalls,

United States Surveyor-General for Arizona.



SURVEY N^o 2359.

scale 500ft to One Inch

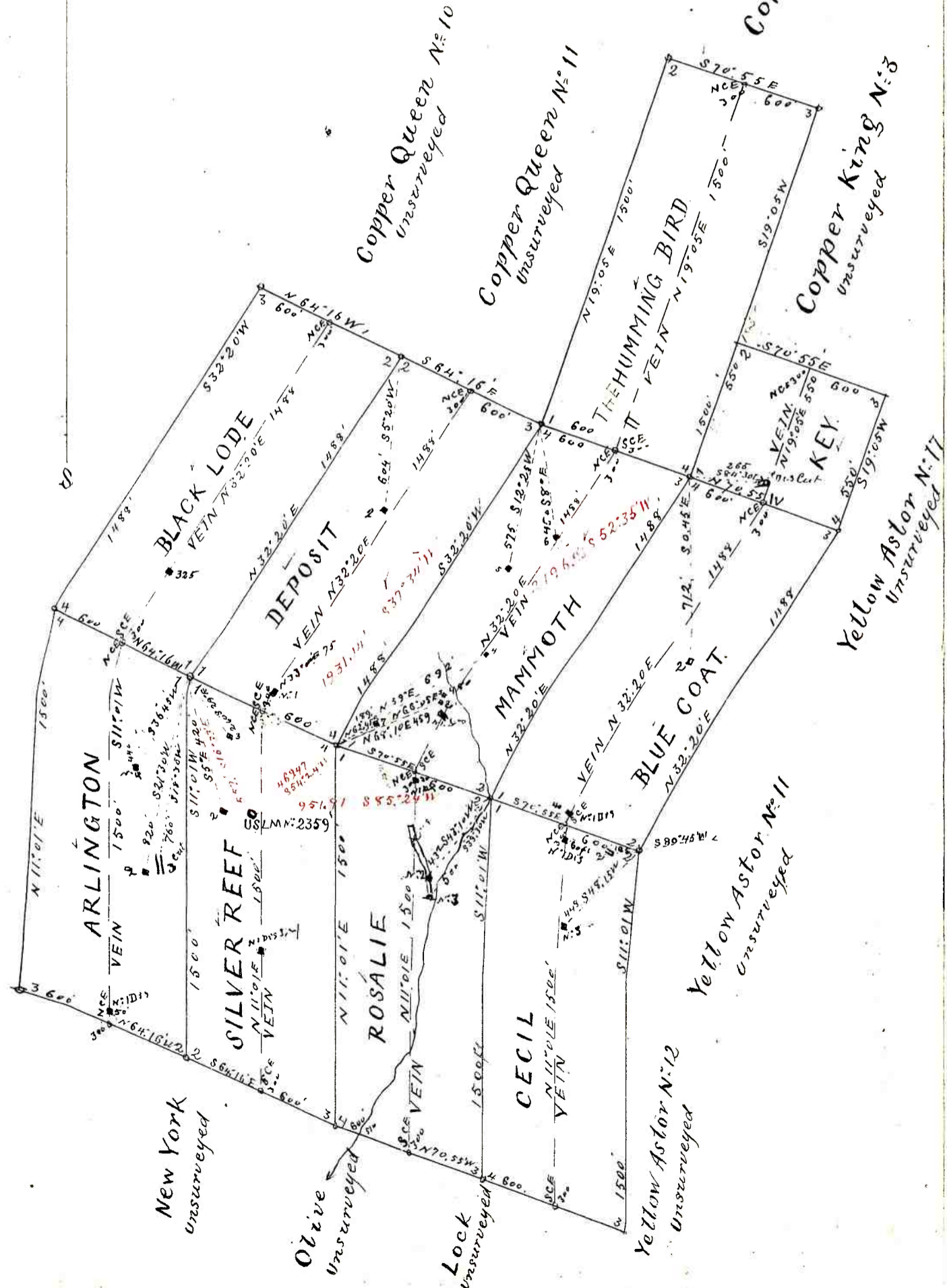

Морф