

MS

0

2

4

4

6

DEC 30 1907

APR 13 1908

(4-683.)

Mineral Survey No. 2446

Lot No. _____

Arizona

Land District.

FIELD NOTES

OF THE SURVEY OF THE MINING CLAIM OF

F. B. Furman

KNOWN AS THE

Newport and Amanda Hill

Pima Riverside Mining District.

Pinal County, Arizona

Section Approx., Township 3 S., Range 14 E. Unsur.

Surveyed under instructions dated July 9, 1907.

by Howard T. Payne,
U. S. Deputy Mineral Surveyor

Claim located Sept 1900 - Jan 1904, 1

Survey commenced Sept 26, 1907.

Survey completed Sept 29, 1907.

o 6-173

Address:

Geo. P. Hill, Attorney
Globe, Ariz.

Feet

SURVEY NO. 2446.

NEWPORT LODE MINING CLAIM.

Beginning with corner No.1, the N.W. corner, identical with location, a pine post 4 ft. long, 4 in. square, set 18 in. in the ground in a mound of stones and scribed 1-2446-N P, whence U.S. Mineral Location Monument No.1 Riverside Mining District, bears S. 68° 08' W., 644.4 ft. and from corner No.2 Homstake Lode, Survey No. 1621, bears S. 29° 49' E., 299.5 ft., whence Rock Croppings, chiseled X-2446-B-R bears S. 28° 35' W., 22.1 ft.

325.0 Thence S. 44° 25' E.
to the S.W.E.C.,
650.0 same course to corner No.2, the S.W. corner, identical with location, a pine post, 4 ft. long, 4 in. square, set 18 in. in the ground in a mound of stones and scribed 2-2446-N P.,
No witness rocks available,

316.4 Thence N. 21° 05' E.
to corner No.1 Amended Well Lode, this survey,
341.4 same course to a shaft 4 x 5 - 30 ft.,
1500.0 same course to corner No.3, the S.E. corner, identical with location, a pine post 4 ft. long, 4 in. square, set 18 in. in the ground in a mound of stones and scribed 3-2446-N P.
No witness rocks available.

325.0 Thence N. 44° 25' W.
to N.E.E.C.,
350.0 same course to open cut,
650.0 same course to corner No.4, the N.E. corner, identical with location. a pine post 4 ft. long, 4 in. square, set 18 in. in the ground in a mound of stones and scribed 4-2446-N P.
No witness rocks available.

1500.0 Thence S. 21° 05' W.
to corner No.1, the point of beginning.

Variation 14° 00' E. at all corners.

LEDGE.

The presumed course of the vein on this claim is from the N.E.E.C. of location S. 21° 05' W., 1500.0 ft.. to S.W.E.C.

AMENDED WELL LODE MINING CLAIM.

Beginning at corner No.1, the N.W. corner, identical with location, and located on line 2-3 Newport Lode, this survey, ^{at N. 21° 05' E. 316.4 ft. from corner No. 2} a pine post 4 ft. long, 4 in. square, set 18 in. in the ground in a mound of stones and scribed 1-2446-A W., whence U.S. Location Monument No.1, Riverside Mining District, bears S. 86° 29' W., 1169.0ft. Rock Croppings, chiseled X-2446-B R bears N. 76° 55' E., 18.2 ft.

300.0 Thence S. 68° 55' E.
to S.W.E.C.,
600.0 same course to corner No.2, the S.W. corner, identical with location, a pine post 4 ft. long, 4 in. square, set 18 in. in the ground in a mound of stones and scribed 2-2446-A W., whence
Rock Croppings, chiseled X-2446-B R., bears N. 48° 10' W., 61.1 ft..

(2)

Feet

1500.0 Thence N. 21° 05' E.
to corner No.3, the S.E. corner, identical with location,
a pine post 4 ft. long, 4 in. square, set 18 in. in the
ground in a mound of stones and scribed 3-2446-A W.,
whence
Rock Croppings, chiseled X-2446-B R., bears N. 56° 30'
E., 52.2 ft.,

300.0 Thence N. 68° 55' W.
600.0 to N.E.E.C.,
same course to corner No.4, the N.E. corner, identical
with location, a pine post 4 ft. long, 4 in. square,
set 18 in. in the ground in a mound of stones and scrib-
ed 4-2446-A W., whence
Rock Croppings, chiseled X-2446-B R., bears N. 2° 35' E.,
14.6 ft.,

316.4 Thence S. 21° 05' W.
1475.0 to corner No.3, Newport Lode, this survey,
1500.0 same course to shaft,
same course to corner No.1, the point of beginning.

Variation 13° 30' E. to 14° E. at all corners.

LEDGE.

The presumed course of the vein on this claim is from
the N.E.E.C. of location S. 21° 05' W., 1500.0 ft..
to S.W.E.C.

ADJOINING CLAIMS.

Unlocated ground on all sides except on the N.W., where
lies an adjacent claim, name unknown, owner R. Hammer.

AREAS.

	acres.
Newport Lode,	
Total and net area	20.367
Amended Well Lode,	
Total and net area	20.661
Total and net area of group	41.028

EXPENDITURES.

I hereby certify that the value of the labor and improve-
ments on these claims, placed thereon by the claimant o
or his grantors, is not less than \$500.00 for each claim
and said improvements consist of the following:-

No.1	Newport Lode, Discovery shaft, 4 x 6 - 10 ft., bears from N.E.E.C. S. 21° 05' W., 205.0 ft.	Value \$ 50.00
No.2	Open Cut, 4 x 6 - 10 ft., bears from N.E.E.C. S. 31° 30' W., 148.0 ft.	Value 25.00
No.3	Shaft, 6 x 6 - 14 ft., bears from N.E.E.C. S. 31° 42' W., 295.0 ft.	Value 100.00
No.4	Shaft, 4 x 5 - 50 ft., bears from corner No.1 N. 29° 04' E., 540.0 ft.	Value 400.00
No.5	Shaft, 4 x 5 - 30 ft., bears from corner No.2 N. 21° 05' E., 341.4 ft.	Value, \$200.00. Being on both the Newport and Amended Well Lodes, 1/2 is credited to each lode.
No.6	Shaft, 5 x 7 - 24 ft., bears from corner No.3 S. 31° 55' W., 210.0 ft.	Value 100.00
No.7	Open Cut, 4 x 10 - 10 ft., bears from N.E.E.C. N. 44° 25' W., 25.0 ft.	Value 250.00
	Total Improvements,	\$925.00

Feet

	Amended Well Lode,	Value
No.1	Discovery shaft, 4 x 6 - 10 ft., bears from N.E.E.C., S. 21° 05' W., 192.0 ft.	\$ 50.00
No.2	Open Cut, 4 x 8 - 10 ft., bears from N.E.E.C., S. 16° 50' W., 260.0 ft.	30.00
No.3	Open Cut, 4 x 6 - 35 ft., bears from corner No.3, S. 58° 37' W., 245.0 ft.	100.00
No.4	Open Cut, 4 x 8 - 18 ft., bears from corner No.3, S. 51° 07' W., 240.0 ft.	100.00
No.5	Shaft, 4 x 6 - 10.0 ft., bears from corner No.3 of Newport Lode, or a point on side line of Amended Well Lode, 316.4 ft. from corner No.4, S. 19° 56' E., 490.0 ft.	40.00
No.6	Shaft, 4 x 5 - 7 ft., bears from point as above described, S. 20° 41' E., 585.0 ft.	25.00
No.7	Shaft, 6 x 6 - 8 ft., bears from point as above described, S. 26° 05' E., 540.0 ft.	50.00
No.8	Shaft, 4 x 6 - 9 ft., bears from a point on line 4-1, 1253.7 ft. from corner No.4, S. 70° 25' E., 150.0 ft.	50.00
No.9	1/2" Newport Lode shaft (No.5), which bears from corner No.1, N. 21° 05' E., 25.0 ft.	100.00
	Total value of improvements	545.00
	Total value of improvements on group	\$1470.00

LOCATION.

These claims are located in the Riverside Mining District, about one quarter of a mile east from the Troy-Manhattan office, in Troy, Arizona, in what will be when surveyed, approximately Tp.3, S.R. 14 E., G. & S. R. B. & M..

INSTRUMENT.

This survey was made with a W. & L. E. Gurley Mountain Transit, fitted with Burt's solar attachment by which the true meridian was obtained, checked on established courses. Measurements were made with a 500 ft. steel tape.

Howard T. Payne
U.S. Deputy Mineral Surveyor,

Dated Globe, Arizona,
March 11th, 1908.

FINAL OATHS FOR SURVEYS.

LIST OF NAMES.

A list of the names of the individuals employed by Howard T. Hayne

United States Deputy Mineral Surveyor, to assist in running, measuring, and marking the lines, corners, and boundaries described in the foregoing field notes of the survey of the mining claim of J. B. Auman

known as the Sawport and Amended Mill

and showing the respective capacities in which they acted.

- Ben Fart, Chainman.
- Richard Hammer, Chainman.
-, Axman.
-, Flagman.

FINAL OATHS OF ASSISTANTS.

We, Ben Fart and Richard Hammer

~~and~~, do solemnly swear that we assisted Howard T. Hayne, United States Deputy Mineral Surveyor, in marking the corners and surveying the boundaries of the mining claim of

known as the Sawport and Amended Mill

represented in the foregoing field notes as having been surveyed by said deputy mineral surveyor and under his direction; and that said survey has been in all respects, to the best of our knowledge and belief, faithfully and correctly executed, and the corner and boundary monuments established according to law and the instructions furnished by the United States Surveyor-General for Arizona.

- Richard Hammer, Chainman.
- Ben Fart, Chainman.
-, Axman.
-, Flagman.

Subscribed and sworn to by the above-named persons before me this 15th

day of October, 1907

John Kavanaugh
Notary Public
in and for Pinal County
Arizona



FINAL OATH OF U. S. DEPUTY MINERAL SURVEYOR

I, Howard T. Haynes, U. S. Deputy Mineral Surveyor, do solemnly swear that, in pursuance of instructions received from the United States Surveyor General for Arizona, dated July 9 1907, I have, in strict conformity to the laws of the United States, the official regulations and instructions thereunder, and the instructions of said Surveyor General, faithfully and correctly executed the survey of the Mining Claim of J. B. Newman, known as the Newport and Amended Hill, situate in Pinal Pinal Mining District, Ariz. County, Ariz. in Section Approx., Township No. 3 S., Range No. 14 E. Unsur., and designated as Survey No. 2446, as represented in the foregoing field notes, which accurately show the boundaries of said mining claim as distinctly marked by monuments on the ground, and described in the attached copy of the location certificate, which was received by me from the Surveyor General with said instructions, and that all the corners of said survey have been established and perpetuated in strict accordance with the law, official regulations and instructions thereunder; and I do further solemnly swear that the foregoing are the true and original field notes of said survey and my report therein, and that the labor expended and improvements made upon said mining claim by claimant or his grantors are as therein fully stated, and that the character, extent, location and itemized value thereof are specified therein with particularity and full detail, and that no portion of said labor or improvements so credited to this claim has been included in the estimate of expenditures upon any other claim.

Howard T. Haynes
U. S. Deputy Mineral Surveyor.

Subscribed and sworn to by the said Howard T. Haynes
U. S. Deputy Mineral Surveyor, before me J. J. Gellies, Notary Public
in & for Gila County, Arizona this 27th
day of December, 1907.

J. J. Gellies
Notary Public
Gila Co. Arizona

Affidavit of Five Hundred Dollars Improvements.

We, Patrick Rose, and Frank Gill

of lawful age, being first duly sworn according to law, depose and say: That we are acquainted with the New post and Amended Well mining claim, situate in Riverside Mining district, Pinal County, Arizona Territory, for which J. B. Newman

has made application for survey prior to application for patent under the provisions of the act of Congress, approved May 10, 1872; and that the labor done and improvements made thereon by the applicant and his grantor exceed Five Hundred Dollars in value, and further that we are not personally interested in said mine.

Patrick Rose

Frank Gill

TERRITORY OF ARIZONA, } ss: County of Gila

Sworn to and subscribed before me, this 26th

day of December, 1907

Geo R. Hill Notary Public



14396b100-8-04

My Commission Expires Jan 25 1910

AMENDED
Notice of Mining Location
LODE CLAIM

To All Whom It May Concern:

This Mining Claim, the name of which is the NEWPORT
Mining Claim, situate on lands belonging to the United States of America, and in which there
are valuable mineral deposits, was entered upon and located for the purpose of exploration and
purchase by J. B. Newman & Al Citizens of the United States,

(Locator must insert either "a citizen of the United States," or, "who has declared his intention to become a citizen of the United States.")

the undersigned, on the Tenth day of June 1907

The length of this claim is 1500 feet,
and We claim Two hundred (200) feet,
in a N. 17deg 30' (True bearing) E. direction and Thirteen hundred
feet in a S. 17deg 30' W. True Bearing direction from
the center of the discovery shaft, at which this notice is posted, lengthwise of the claim, together
with Three hundred (300) feet in width of the surface grounds, on each
side of the center of said claim. The general course of the lode deposit and premises is from the
North East to the South West

The claim is situated and located in the Pioneer Mining District, in
Pinal County, in the Territory of Arizona, about 400 feet
in a North East direction from the Troy Store and is the
North East extension of the Home-stake Mining Claim Patented
(All bearings are True Bearings)

The surface boundaries of the claim are marked upon the ground as follows: Beginning at
a monument of stone with a post in same,

at a point in a N. 17deg-30' E. direction Two hundred (200) feet from
the discovery shaft (at which this notice is posted,) being in the center of the East
end line of said claim; thence N. 45deg-06' W. 300 feet to a Monument of Stone
-----, being the North West corner of said claim; thence
S. 17deg-30' W. 1500 feet to a Monument of Stone, being at the
South West corner of said claim; thence S. 45deg 06' W. 300 feet
to a Monument of Stone at the center of the West end of said claim;
thence S. 45deg-06' W. 300 feet to a Monument of stone, being at the
South East corner of said claim; thence N. 17deg-30' E. 1500
feet to a Monument of stone at the North East corner of said claim;
thence N. 45deg-06' W. feet to the place of beginning.

All done under the provisions of Chapter Six, of Title XXXII, of the Revised Statutes of
the United States, and of an Act of the General Assembly of Arizona, entitled "An Act to Revise
and Codify the Laws of the Territory of Arizona," approved March 16, 1901.

This is an Amended Location Notice of the NEWPORT
Mining Claim, located by Harry Sultan & Claud Batialleur
----- on the Twenty seventh day of
Septmeber 1900, and recorded in Book Eighteen of Records of Mines, at
page 64, in the office of the County Recorder of the aforesaid County of Pinal
to which reference is hereby made, and this amended Location Notice is made and posted to
correct errors in the description in the said original Location Notice.

Dated and posted on the ground this Tenth day of June 1907

J. B. NEWMAN

TER RITORY OF ARIZONA, } ss.
County of -- Pinal

I, G. F. Watson- County Recorder in and for the County and Territory aforesaid, do hereby certify that the within instrument was filed for record at -9- o'clock, A. M., on this --29th day of - June- 1907, and duly recorded in Book No. 1- of Mines Amended Records of - Pinal County, Arizona, at pages

WITNESS my hand and official seal the day and year first above written.

County Recorder.

By Deputy.....

AMENDED
Notice of Location.
LODE CLAIM.

Newport

Dated - June 10th 1907-

Filed and Recorded at Request of

George R Hill

June- 29th A. D. 1907-

at - 9- O'Clock----- A. M.

Book -1- Of Mines Amended

Pages -37

G. F. Watson-

County Recorder.

By N. N. Wells-

Deputy Recorder.

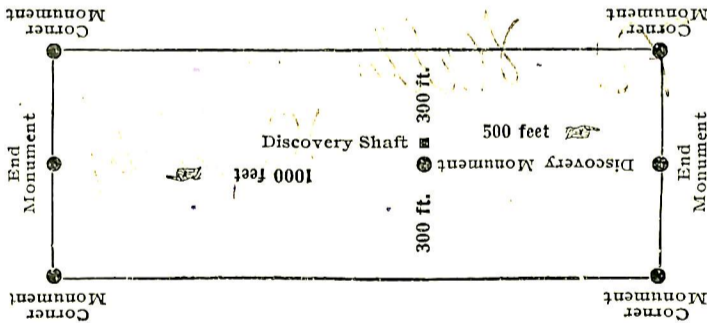

This diagram is to give locator a general idea of plan of location under the new law. The Discovery Shaft can be in the center of claim of any distance from either end desired. In the diagram it is placed 500 feet from one end and 1000 feet from the other. Commence description of claim at a center end monument, giving its distance and direction from center of Discovery Shaft; thence bound the claim in either direction. In description be careful to state locality of claim with reference to some natural object, or permanent monument, as will identify the claim.

Territory of Arizona
County of Pinal ss

I, G. F. Watson,
County Recorder in and for the County
of Pinal, Territory of Arizona, do
hereby certify that the above Location

Notice of the ...New Port.....

Mining Claim, is a full, true, and
correct copy of the original, as
the same appears of record, in the
office of the Recorder, of Pinal
County, Arizona Territory, in Book
1 of Mines Amended at page..377..
thereof

Witness my hand and seal of office
this 29th day of June A. D. 1907

G. F. Watson
.....
Recorder, Pinal County, Arizona.

By *N. N. Kells*
Deputy

AMENDED
Notice of Mining Location
 LODE CLAIM

To All Whom It May Concern:

This Mining Claim, the name of which is the AMENDED WELL
 Mining Claim, situate on lands belonging to the United States of America, and in which there
 are valuable mineral deposits, was entered upon and located for the purpose of exploration and
 purchase by J. B. NEWMAN, THOMAS KAVANOUGH, & CHAS. H. CUTTING, CITIZENS
Of the United States.

(Locator must insert either "a citizen of the United States," or, "who has declared his intention to become a citizen of the United States.")

the undersigned, on the tenth day of June 1907

The length of this claim is Fifteen hundred feet,
 and No claim Two hundred (200) feet,
 in a N. 17deg 30' E. (True Bearing) direction and Thirteen hundred ed
(1300) feet in a South 17deg-30' West direction from
 the center of the discovery shaft, at which this notice is posted, lengthwise of the claim, together
 with Three hundred (300) feet in width of the surface grounds, on each
 side of the center of said claim. The general course of the lode deposit and premises is from the
North East to the South West

The claim is situated and located in the Pioneer Mining District, in
Pinal County, in the Territory of Arizona, about 700 feet
 in a Easterly direction from town of Troy & is the Parallel
to the East side line of the Newport Mining Claim and adjacent
to same.

(All bearings are True Bearings)

The surface boundaries of the claim are marked upon the ground as follows: Beginning at
Monument of stone with a post in same,

at a point in a N. 17deg-30' E. direction Two hundred (200) feet from
 the discovery shaft (at which this notice is posted,) being in the center of the East
 end line of said claim; thence N. 73deg-30' W. 300 feet to Monument of stones
-----, being the North West corner of said claim; thence
S. 17deg-30' W. 1500 feet to a monument of stone, being at the
South West corner of said claim; thence S. 72deg-30' E. 300 feet
 to a Monument of stone at the center of the West end of said claim;
 thence S. 72 deg-30' E. 300 feet to Monument of stones, being at the
South East corner of said claim; thence N. 17deg-30' E. 1500
 feet to a Monument of stones at the North East corner of said claim;
 thence N. 72deg-30' W. 300 feet to the place of beginning.

All done under the provisions of Chapter Six, of Title XXXII, of the Revised Statutes of
 the United States, and of an Act of the General Assembly of Arizona, entitled "An Act to Revise
 and Codify the Laws of the Territory of Arizona," approved March 16, 1901.

This is an Amended Location Notice of the AMENDED WELL
 Mining Claim, located by J. B. Newman, Thomas Kavanough & Chas. H. Cutting,
----- on the First day of
January 1904, and recorded in Book Twenty one of Records of Mines, at
 page 227, in the office of the County Recorder of the aforesaid County of Pinal
 to which reference is hereby made, and this amended Location Notice is made and posted to
 correct errors in the description in the said original Location Notice.

Dated and posted on the ground this Tenth day of June 1907

J. B. NEWMAN

THOMAS KAVANOUGH

CHAS. H. CUTTING

TERRITORY OF ARIZONA, }
County of --Pinal } ss.

I, G. F. Watson-

County Recorder in and for the County and Territory aforesaid, do hereby certify that the within instrument was filed for record at -9- o'clock, A. M.,

on this --29th day of -June- 1907, and duly recorded in Book No. -1-

of Mines- Amended Records of --Pinal County, Arizona, at pages.....

WITNESS my hand and official seal the day and year first above written.

County Recorder.

By Deputy.....

George R. Hill- Globe-

AMENDED
Notice of Location.
LODE CLAIM.

Amended Mine

Dated - June- 10th - 1907 -

Filed and Recorded at Request of

George R. Hill-

June- 29th- A. D. 1907 -

at - (*9 O'Clock- A. M.

Book - 1- Of Mines Amended

Pages - 36-

G. F. Watson-
County Recorder.

By N. N. Wells-
Deputy Recorder.

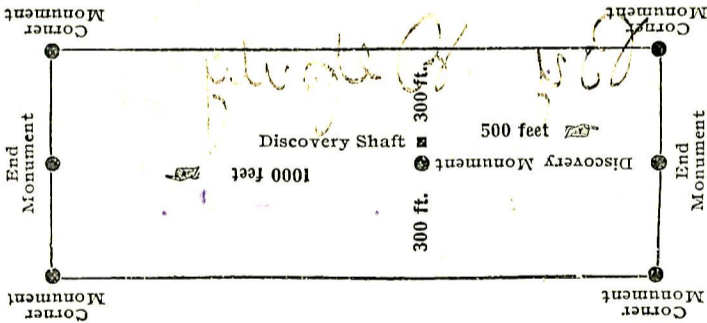

This diagram is to give locator a general idea of plan of location under the new law. The Discovery Shaft can be in the center of claim or any distance from either end desired. In the diagram it is placed 500 feet from one end and 1000 feet from the other. Commence description of claim at a center end monument, giving its distance and direction from center of Discovery Shaft; thence bound the claim in either direction. In description be careful to state locality of claim with reference to some natural object, or permanent monument, as will identify the claim.

Territory of Arizona
County of Pinal ss

I, G. F. Watson,
County Recorder in and for the County
of Pinal, Territory of Arizona, do
hereby certify that the above Location
Notice of the- Amended- Well-....

Mining Claim, is a full, true, and
correct copy of the original, as
the same appears of record, in the
office of the Recorder, of Pinal
County, Arizona Territory, in Book
1 of Mines Amended at page...36-...
thereof

Witness my hand and seal of office
this 29th day of June A. D. 1907

G. F. Watson
.....
Recorder, Pinal County, Arizona.

By Deputy
N. N. Hells.

U. S. SURVEYOR GENERAL'S FINAL CERTIFICATE ON
FIELD NOTES.

DEPARTMENT OF THE INTERIOR,
OFFICE OF U. S. SURVEYOR GENERAL,

Phoenix, Arizona

June 13, 1908.

I, U. S. Surveyor General for District of Arizona,
do hereby certify that the foregoing transcript of the Field Notes, return and approval
of the Survey of the mining claim of

J. B. Newman

, known as the NEWPORT and AMENDED WELL

, situate in Riverside

Mining District, Pinal County,

Arizona, in Section approx., Township No. 3 S.,

Range No. 14 E., Unsur., and designated as Survey

No. 2446, has been correctly copied from the originals on

file in this office; that said Field Notes furnish such an accurate description of said
mining claim as will, if incorporated into a patent, serve fully to identify the premises,
and that such reference is made therein to natural objects or permanent monuments as
will perpetuate and fix the locus thereof.

And I further certify that five hundred dollars' worth of labor has been expended
or improvements made upon said mining claim by claimant or his grantors, and
that said improvements consist of 10 shafts and 5 cuts, total value
\$1470.00

and that no portion of said labor or improvements has been included in the estimate of
expenditures upon any other claim.

I further certify that the plat thereof, filed in the U. S. Land Office at Phoenix,
Arizona is correct and in conformity with the foregoing Field Notes.

Frank S. Ingalls

United States Surveyor General for Arizona.

4-687.

SURVEYOR-GENERAL'S CERTIFICATE OF APPROVAL OF FIELD NOTES AND SURVEY OF MINING CLAIM.

Department of the Interior,

Office of U. S. Surveyor-General,

Phoenix, Arizona

June 13, 1908.

I, U. S. Surveyor-General for District of Arizona

do hereby certify that the foregoing and hereto attached Field Notes and Return of the Survey of the Mining Claim of

J. B. Newman

, known as the

NEWPORT and AMENDED WELL

situate in Riverside Mining District,

Pinal County, Arizona

in Section APPROX., Township No. 3 S., Range No. 14 E., Unsur.

, designated as Survey No. 2446

executed by Howard T. Wayne, U. S. Deputy Mineral

Surveyor, September 26, - 29, 1907, under my instructions dated

July 9, 1907, have been critically examined and the necessary

corrections and explanations made, and the said Field Notes and Return, and the Survey they describe, are hereby approved. A true copy of the copy of the location certificate filed by the applicant for survey is included in the field notes.

Frank S. Ingalls

U. S. Surveyor-General for Arizona.

MAR 19