

**MS**  
-

**0**

**2**

**4**

**8**

**8**

4-683.

MINERAL SURVEY No. 2488

LOT No. ....

Arizona

Land District.

FIELD NOTES

OF THE SURVEY OF THE MINING CLAIM OF

George H. Francis, John Agnew & Frank Williams

KNOWN AS THE

Omaha and Violet

Martinez

Mining District,

Yavapai County, Arizona.

Section 15, Township 10 N, Range 6 W

Surveyed under instructions dated Oct 21, 1907

by J. J. Fisher

U. S. Mineral Surveyor.

Claim located in loc. notices, 1907

Survey commenced Oct 24, 1907

Survey completed Oct 25, 1907

8-822

Address.

George H. Francis  
Humboldt  
Yavapai Co  
Arizona

*See report*

Feet.

OMAHA LODGE

Beginning at E. C. E. identical with E. C. E. of loc. A mon. of stones 2 ft. base 2 ft. high.

Set a granite stone 24 x 20 x 8 ins 12 ins. in ground, alongside raised a mound of stones 3 x 3 ft. Stone marked E. C. E., O 2488.

Thence N. 40° 15' E.

300 To cor. No. 1, identical with cor. of loc. A mon. of stones 2 ft. base 2½ ft. high.

Set a granite stone 24 x 16 x 10 ins. 12 ins. in ground, alongside raised a mound of stones 3 x 3 ft. Stone marked O. 1-2488.

Whence a X on a granite rock in place marked B. R. O. 1-2488 brs. <sup>N</sup> 0° 10' E. 18.6 ft.

A X on a granite rock in place marked B. R. O. 1-2488 brs. N. 42° E. 21 ft.

¼ sec. cor. between secs. 14, and 15, Tp. 10 N., R. 6 W., brs. S. 82° 34' E. 739 ft.

Thence N. 75° W.

1500 To cor. No. 2, identical with cor. of loc. A mon. of stones 2 ft. base 1½ ft. high.

Set a granite stone 24 x 15 x 6 ins. 12 ins. in ground, alongside raised a mound of stones 3 x 3 ft. Stone marked O. 2-2488.

Whence a X on a granite rock in place marked B. R. O. 2-2488 brs. N. 7° 25' W. 15.6 ft.

A X on a granite rock in place marked B. R. O. 2-2488 brs. N. 47° 10' E. 14.8 ft.

3

SURVEY NO. 2488

Feet Thence S. 40° 15' W.

300 To W. C. E. identical with loc. A mon. of stones. 2 ft. base. 1½ ft. high.

Set a granite stone 30 x 15 x 6 ins. 15 ins. in ground, alongside raised a mound of stones 3 x 3 ft. Stone marked W. C. E., O. 2488.

600 To cor. No. 3, identical with cor. of loc. A mon. of stones 2 ft. base 1½ ft. high.

Set a granite stone 24 x 8 x 6 ins. 12 ins. in ground, alongside raised a mound of stones 3 x 3 ft. Stone marked O. 3-2488.

No bearings available.

Thence S. 75° E.

720 To cor. No. 4 Violet <sup>lode</sup> claim of this survey.

1320 To cor. No. 1 Violet lode of this survey.

1500 To cor. No. 4 identical with cor. of loc. A mon. of stones 3 ft. base 3 ft. high.

Set a granite stone 24 x 18 x 6 ins. 12 ins. in ground, alongside raised a mound of stones 3 x 3 ft. Stone marked O. 4-2488.

Whence a X on a granite rock in place marked B. R. O. 4-2488 brs. N. 75° 25' W. 17.6 ft.

A X on a granite rock in place marked B. R., O. 4-2488 brs. N. 42° 30' E. 45.7 ft.

Thence N. 40° 15' E.

300 To E. C. E. the place of beginning survey of exterior boundaries.

\*\*\*\*\*

Feet

VIOLET LODGE

Beginning at N. C. E. identical with loc. A mon. of stones 2 ft. base  $1\frac{1}{2}$  ft. high.

Set a granite stone 24 x 18 x 8 ins. 12 ins. in ground, alongside raised a mound of stones 3 x 3 ft. Stone marked N. C. E., V. 2488.

Thence S. 75° E.

300 To cor. No. 1, whence cor. No. 4 Omaha lode of this survey hrs. S. 75° E. 180 ft., identical with cor. of loc. A mon. of stones 2 ft. base  $1\frac{1}{2}$  ft. high.

Set a granite stone 24 x 12 x 8 ins. 12 ins. in ground, alongside raised a mound of stones 3 x 3 ft. Stone marked V. 1-2488.

Whence a X on a granite rock in place marked B. R. V. 1-2488 hrs. N. 14° E. 7.4 ft.

A X on a granite rock in place marked B. R. V. 1-2488 hrs. N. 64° 15' W. 30 ft.

$\frac{1}{4}$  sec. cor. between secs. 14 and 15, Tp. 10 N., R. 6 W., hrs. N. 76° 17' 22" E. 1332.1 ft.

Thence S. 62° 30' W.

1500 To cor. No. 2, identical with cor. of loc. A mon. of stones 2 ft. base  $1\frac{1}{2}$  ft. high.

Cut a X on a granite rock in place for cor. point, rock marked V. 2-2488, alongside raised a mound of stones 3 x 3 ft.

No bearings available.

Feet

Thence N. 75° W.

300 To S. C. E. identical with loc. A mon. of stones 2 ft. base 1½ ft. high.

Set a granite stone 24 x 8 x 6 ins. 12 ins. in ground, alongside raised a mound of stones 3 x 3 ft. Stone marked S. C. E., V. 2488.

600 To cor. No. 3, identical with cor. of loc. A mon. of stones 2 ft. base 2½ ft. high.

Cut a X on a granite rock in place marked V. 3-2488, alongside raised a mound of stones 3 x 3 ft.

No bearings available.

Thence N. 62° 30' E.

1500 To cor. No. 4, identical with cor. of loc. A mon. of stones 2 ft. base 2½ ft. high.

Whence cor. No. 3 Omaha lode of this survey brs. N. 75° W. 720 ft.

Cut a X on a granite rock in place marked V. 4-2488, alongside raised a mound of stones 3 x 3 ft.

No bearings available.

Thence S. 75° E.

300 To N. C. E., the place of beginning survey of exterior boundaries.

\*\*\*\*\*

Variation at all cors. 14° 30' E.

A R E A

OMAHA LODE	18.687 acres
VIOLET LODE	<u>13.958 acres</u>
Total area	32.645 acres

\*\*\*\*\*

L O C A T I O N

This claim is located on surveyed land in sec. 15, Tp. 10 N., R. 6 W., G. & S. R. B. & M., in Martinez Mining District, Yavapai County, Arizona, and is bounded on the north by the Planet-Myer lode, <sup>surveyed</sup> Granite Reef Gold Mining Company claimant, and on the east by Protection lode, <sup>surveyed</sup> Congress Gold Company claimant. No other adjoining claims.

\*\*\*\*\*

V E I N

OMAHA extends N. 75° W. 835 ft. and S. 75° E. 665 ft. from the discovery shaft.

VIOLET extends N. 62° 30' E. 120 ft. and S. 62° 30' W. 1320 ft. from the discovery.

\*\*\*\*\*

EXPENDITURE OF FIVE HUNDRED DOLLARS

I certify that the value of the labor and improvements on this claim, placed thereon by the claimants and their grantors, is not less than Five Hundred Dollars, and that said improvements consist of:

OMAHA LODE:

Discovery Shaft No. 1, which brs. from cor. No. 1  
 S. <sup>86° 6'</sup>~~85° 30'~~ W. <sup>836.7</sup>~~840~~ ft. Shaft 4 x 6 ft. 100 ft. deep.  
 At 30 ft. drift 4 x 6 ft. 50 ft. long. At 60 ft.  
 drift 4 x 6 ft. 50 ft. long.

VALUE \$2000.00

Tunnel No. 2, which brs. from cor. No. 2 S. 15°  
 15' W. 230 ft. Tunnel 4 x 6 ft. 50 ft. long. Course  
 S.

VALUE \$ 500.00

VIOLET LODE:

Discovery Cut No. 1, which brs. from the N. C. E.  
 S. 62° 30' W. 120 ft. Cut 4 x 15 ft. 10 ft. face.

VALUE \$ 50.00

Shaft No. 2 which brs. from the N. C. E. S. 62°  
 30' W. 580 ft. Shaft 4 x 6 ft. 85 ft. deep.

This vein dips to the N. W. about 20° from the  
 horizontal and shaft No. 2 follows the dip of the vein.

VALUE \$ 350.00

Tunnel No. 3, which brs. from the N. C. E.  
 S. 62° 30' W. 655 ft. Tunnel 4 x 6 ft. 50 ft. long.  
 on vein.

VALUE \$ 500.00

Tunnel No. 4, which brs. from the N. C. E.  
 S. 62° 30' W. 1020 ft. Tunnel 4 x 6 ft. 60 ft. long.  
 Course W.

VALUE \$ 600.00

Total value of improvements \$4500.00

\*\*\*\*\*

I N S T R U M E N T

This survey was made with a Gurley Light Mountain  
 Solar Transit. The courses were deflected from the true  
 meridian as determined by solar observation. The dis-  
 tances were measured with a 50 and 300 ft. steel tape.

Prescott, Arizona, November 2, 1907.

*J. J. Fisher*  
 U.S. Dep. Min. Surveyor.



# FINAL OATHS FOR SURVEYS.

## LIST OF NAMES.

A list of the names of the individuals employed by J. J. Fisher

United States Deputy Mineral Surveyor, to assist in running, measuring, and marking the lines, corners, and boundaries described in the foregoing field notes of the survey of the mining claim of

George H Francis et al  
known as the Omaha and Violet

and showing the respective capacities in which they acted.

E. H. Draper, Chairman.

Julius F. Warlop, Chairman.

....., Axman.

....., Flagman.

## FINAL OATHS OF ASSISTANTS.

We, E. H. Draper

and Julius F. Warlop, do solemnly swear that we assisted J. J. Fisher

....., United States Deputy Mineral Surveyor, in marking the corners and surveying the boundaries of the mining claim of

George H Francis et al  
known as the Omaha and Violet

represented in the foregoing field notes as having been surveyed by said deputy mineral surveyor and under his direction; and that said survey has been in all respects, to the best of our knowledge and belief, faithfully and correctly executed, and the corner and boundary monuments established according to law and the instructions furnished by the United States Surveyor-General for

Arizona  
E. H. Draper, Chairman.

Julius F. Warlop, Chairman.

Julius F. Warlop, Axman.

E. H. Draper, Flagman.

Subscribed and sworn to by the above-named persons before me this 25<sup>th</sup>

day of October, 1907

J. J. Ferber  
Notary Public

FINAL OATH OF U. S. DEPUTY MINERAL SURVEYOR

I, J. J. Fisher, U. S. Deputy Mineral Surveyor do solemnly swear that, in pursuance of instructions received from the United States Surveyor General for Arizona, dated Oct. 21, 1907, I have, in strict conformity to the laws of the United States, the official regulations and instructions thereunder, and the instructions of said Surveyor General, faithfully and correctly executed the survey of the Mining Claim of George H. Fournier, John Agnos and Frank Williams, known as the Onaha and Violet, situate in Martinez Mining District, Yavapai County, Arizona, in Section 15, Township No. 10 N, Range No. 6 W and designated as Survey No. 2488, as represented in the foregoing field notes, which accurately show the boundaries of said mining claim as distinctly marked by monuments on the ground, and described in the attached copy of the location certificate, which was received by me from the Surveyor General with said instructions, and that all the corners of said survey have been established and perpetuated in strict accordance with the law, official regulations and instructions thereunder; and I do further solemnly swear that the foregoing are the true and original field notes of said survey and my report therein, and that the labor expended and improvements made upon said mining claim by claimant or their grantors are as therein fully stated, and that the character, extent, location and itemized value thereof are specified therein with particularity and full detail, and that no portion of said labor or improvements so credited to this claim has been included in the estimate of expenditures upon any other claim.

J. J. Fisher  
U. S. Deputy Mineral Surveyor.

Subscribed and sworn to by the said J. J. Fisher  
U. S. Deputy Mineral Surveyor, before me J. E. Faulkner  
this 2<sup>d</sup>

day of November - 1907,  
My commission expires  
November 29-1910

J. E. Faulkner  
Notary Public

Affidavit of Five Hundred Dollars Improvements.

We, EH Draper, and Julius D Warlop

of lawful age, being first duly sworn according to law, depose and say: That we are acquainted with the Omaha and Violet mining claim, situate in Martinez Mining district, Yavapai County, Arizona Territory, for which Geo. H. Francis et al.

<sup>we</sup> ~~has~~ made application for survey prior to application for patent under the provisions of the act of Congress, approved May 10, 1872; and that the labor done and improvements made thereon by the applicants and ~~his~~ <sup>their</sup> grantors exceed Five Hundred Dollars in value, and further that we are not personally interested in said mine.

EH Draper  
Julius F. Warlop

TERRITORY OF ARIZONA,  
County of Yavapai } ss:

Sworn to and subscribed before me, this 25<sup>th</sup> day of October, 1907



J. J. Fisher  
Notary Public

Omaha.

Notice of Mining Location Quartz Claim.

To all Whom it May Concern:

This mining claim, the name of which is the Omaha Mining Claim, situate on lands belonging to the United States of America, and in which there are valuable mineral deposits, was entered upon and located for the purpose of exploration and purchase by Charles Vincent, Frank Nichols and A. Golder, the undersigned, on the first day of January, 1896.

The length of this claim is 1500 feet and we claim 300 East and 1200 West feet on each side of the discovery shaft (at which this notice is posted) lengthwise of the claim.

The general course of the lode deposit and premises is from the East to the West.

The claim is situated and located in the Martinez Mining District, in Yavapai County, in the Territory of Arizona, about 1500 feet in a from direction from Why not mine West and 300 feet from the Congress Mill.

The surface boundaries of the claim are marked upon the ground as follows: Beginning at  $\checkmark$  at a point in a 300 East direction three hundred (300 feet from the discovery shaft, at which this notice is posted, being in the center of the east end lines of said claim; thence 300 feet to a stone monument being the Northeast corner of said claim; thence 750 " to a stone monent at the center of the North side line of said claim; thence 750 feet to a stone monenet being at the Northwest corner of said claim; thence 300 feet to a stone mouemet at the center of the West end of said claim; thence 300 South feet to a stone monemet S.W. being at the corner of said claim; thence 750 East feet to a stone mon being at the center of the South side line of said claim; thence 750 East feet to a stone mon at the Southeast corner of said claim; thence three hundred 300 feet to the place of beginning.

All done under the provisions of Chapter six of Title XXXII of the Revised Statutes of the United States, and of an act of the General As-

sembly of Arizona, entitled "an act concerning mines", approved March 20" 1895.

Dated and posted on the ground this first day of January, 1895.

C.T.Vincent

Frank Nichols

A.Golden.

Recorded at request of A.L.Butler, Feby. 23" A.D.. 1896, at 3 o'clock P.M., in Book 42 of Mines pages 638-9, Records of Yavapai County, Arizona

(Seal)

F.A.Trittle

By M.O.Archibald

County Recorder.

Deputy.

"Violet"

Certificate of Mining Location.

Quartz Claim.

This Certifies, That the Violet Mining Claim was located by the undersigned, John Agnoll, Frank Williams and George H. Frances on the 22nd day of March 1898.

That said mining claim is Fifteen Hundred feet in length, and 300 feet on each side of the center of the discovery shaft, is claimed by the locators North & South; that the general course of the lode and premises is from the South to the North; that said claim is situated and located in Martinez Mining District, in Yavapai County, in the Territory of Arizona, directly West and adjoining The Omaha Mining Claim. That the undersigned discoverer of said mining claim located the same on the 22nd, day of March 1898, by posting at the point of discovery on the surface a plain notice, of which the following is a copy.

To all whom it may concern:

This mining claim, the name of which is the Violet Mining Claim, situate on lands belonging to the United States of America, and in which there are valuable mineral deposits, was entered upon and located for the purpose of exploration and purchase by Frank Williams, John Agnoll, and George H. Francis, the undersigned, on the 22nd day of March 1898

The length of this claim is Fifteen Hundred feet, and we claim 1400 feet in a Westerly direction and 100 feet in an Easterly direction from the center of the discovery shaft, at which this notice is posted, lengthwise of the claim, together with 300 feet feet in width of the surface grounds, on each side of the center of said claim;

The general course of the lode deposit and premises is from the South to the North.

The claim is situated and located in Martinez Mining District, in Yavapai County, in the Territory of Arizona, directly West and adjoining from the Omaha Mining claim.

The surface boundaries of the claim are marked upon the ground as follows: Beginning at a stone monument erected at a point in a West-erly direction 1400 feet from the dsiccovery shaft (at which this notice is posted), being in the center of the West end line of said claim; thence 300 feet to a monument being the north west corner of said claim; thence 750 feet to a monument at the center of the North side line of said claim; thence 750 feet to a monument at the north east corner of said claim; thence 300 feet to a monument at the center of the East end of said claim; thence 300 feet to a monument, being at the South East corner of said claim; thence 750 feet to a monument, being at the center of the South side line of said claim; thence 750 feet to a monument at the South West corner of said claim; thence 300 feet to the place of beginning.

All done under the provisions of Chapter Six, of Title XXXII, of the Revised Statutes of the United States, and of an Act of the Gener-al-Assembly of Arizona, entitled "An Act Concerning Mines," approved March 20th, 1895.

Dated and posted on the ground this 22<sup>nd</sup> day of March, 1898.

Frank Williams.

Geo.H.Francis.

John Agnoll.

That John Agnoll has sunk a discovery shaft on the premises so claimed to a depth of Eleven (not less than ten) feet from the lowest part of the rim of such shaft at the surface, showing a lode deposit and mineral in place.

That the boundaries of said claim are designated and marked as in said notice mentioned.

In Witness Whereof, he has hereunto set his hand, this 8th day of April, 1898.

John Agnoll.

Filed and recorded at request of G.H.Francis, April 9<sup>th</sup> 1898, At 9:00 o'clock A.M. In Book 48 of Mines, pages 587 to 589, Records of Yavapai County, Arizona.

By E.C.Averyt  
Deputy.

(Seal) W.I.Johnson,  
County Recorder.

TERRITORY OF ARIZONA, )  
   : ss.  
 County of Yavapai.       )

I, J.C. Bradbury, County Recorder in and for the County of Yavapai, Territory of Arizona, and Custodian of the files and records of such office do hereby certify that I have compared the foregoing copies with, and that the same are full, true and correct copies of the following named lode mining claims, located in the Martinez Mining District, Yavapai County, Arizona Territory, as the same appear of record in my said office at the books and pages as follows:-

"OMAHA" mining claim, notice of location whereof is of record in Book 42 of Mines, at pages 538-9.

"VIOLET" mining claim, notice of location whereof is of record in Book 43 of Mines, at pages 537-539.

IN WITNESS WHEREOF, I have hereunto set my hand and affixed my official seal, this 13th day of October, A.D. 1907.



*J.C. Bradbury*  
 County Recorder.



4-688.

U. S. SURVEYOR-GENERAL'S FINAL CERTIFICATE ON FIELD NOTES.

Department of the Interior,

OFFICE OF U. S. SURVEYOR-GENERAL,

Phoenix, Arizona,

December 5, 1907.

I, U. S. Surveyor-General for District of Arizona  
do hereby certify that the foregoing transcript of the Field Notes, return and approval of the survey  
of the mining claim of  
George E. Francis et al  
known as the OMAHA and VIOLET  
situate in Martinez  
Mining District, Yavapai County, Arizona  
in Section 15, Township No. 10 N., Range No. 6 W., and  
designated as Survey No. 2488, has been correctly copied from the originals on file in  
this office; that said Field Notes furnish such an accurate description of said mining claim as will, if  
incorporated into a patent, serve fully to identify the premises, and that such reference is made therein  
to natural objects or permanent monuments as will perpetuate and fix the locus thereof.

And I further certify that five hundred dollars' worth of labor has been expended or improve-  
ments made upon said mining claim by claimant or their grantors, and that said improvements  
consist of 2 shafts, 3 tunnels, 1 cut and 100 ft. of drift,  
total value \$4500.

and that no portion of said labor or improvements has been included in the estimate of expenditures  
upon any other claim.

I further certify that the plat thereof, filed in the U. S. Land Office at Phoenix,  
Arizona is correct and in conformity with the foregoing Field Notes.

Frank S. Ingalls,

United States Surveyor-General for Arizona.

4-687.

**SURVEYOR-GENERAL'S CERTIFICATE OF APPROVAL OF FIELD  
NOTES AND SURVEY OF MINING CLAIM.**

**Department of the Interior,**

*Office of U. S. Surveyor-General,*

.....Phoenix, Arizona,.....

December 5, 1907.

I, U. S. Surveyor-General for.....District of Arizona.....

do hereby certify that the foregoing and hereto attached Field Notes and Return of the Survey of the  
Mining Claim of.....

.....George H. Francis et al.....

....., known as the

.....OMAHA and VIOLET.....

situate in.....Martinez.....Mining District,

.....Yavapai.....County,.....Arizona.....

in Section.....15....., Township No.....10 N....., Range No.....6 W.....

....., designated as Survey No.....2488.....

executed by.....J. J. Fisher....., U. S. Deputy Mineral

Surveyor,.....Oct. 24 - 25....., 1907, under my instructions dated

.....Oct. 21,....., 1907, have been critically examined and the necessary  
corrections and explanations made, and the said Field Notes and Return, and the Survey they describe,

are hereby approved. A true copy of the copy of the location certificate filed by the applicant for  
survey is included in the field notes.

  
.....

U. S. Surveyor-General for.....Arizona.....

SURVEY No. 2488.  
ARIZONA LAND DISTRICT.

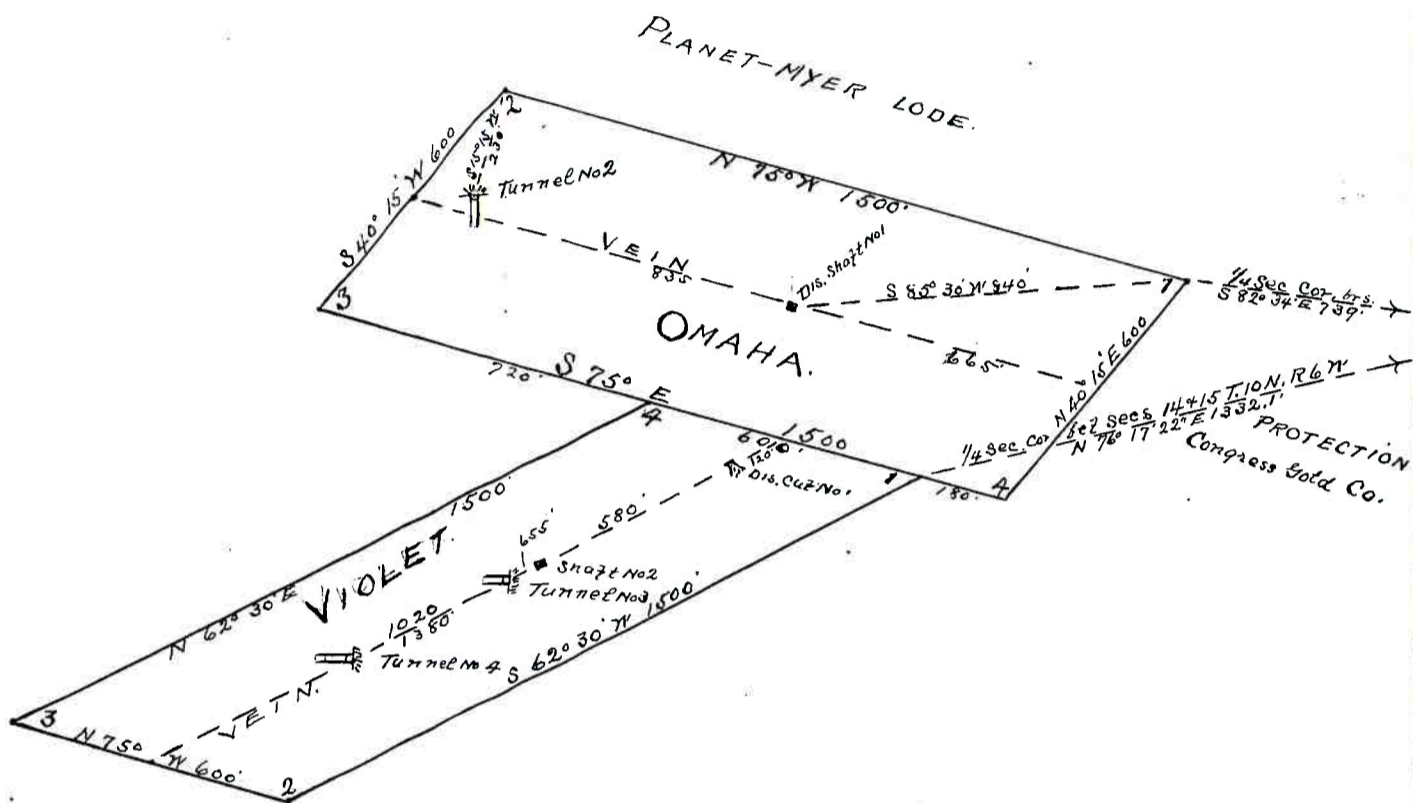

Sec. 15 T. 10 N. R. 6 W. G. + S. R. B + M.

SURVEYED OCT. 24-25-07  
by J. J. Fisher  
U.S.D.M.S.