

MS -

0

2

5

5

1

Jul 2-1908

4-683.

MINERAL SURVEY No. 2551

LOT No. _____

Arizona Land District.

FIELD NOTES

OF THE SURVEY OF THE MINING CLAIM OF

R. H. Burnister

KNOWN AS THE

1896

Weaver

Mining District,

Yavapai County, Arizona Territory

Section Approx., Township 10 N., Range R. H. N. Unsur.

Surveyed under instructions dated May 23rd, 1908

by William H. Muritt

U. S. Mineral Surveyor.

Claim located January 1st 1896, ~~19~~

Survey commenced May 28 —, 1908

Survey completed May 28 —, 1908

6-822

Address of Claimant
R. H. Burnister
Prescott Arizona.

Feet Beginning at Cor.No.1 identical with the loc.
 A granite stone 6X6X24 ins.set 12 ins.in the ground,with
 mound of stones, chiseled 1896-1-2551 Whence:-
 U.S.L.M.No.2551 brs. S 74°.47'W 726.9 feet.
 X-B-R-chiseled on granite rock in place brs.N 58°.30'E 10.5 ft.
 X-B-R-chiseled on granite rock in place brs.S 22°.30'E 8.8 ft.
 Loc.cor.mound of stones 2X3 ft.

Thence S 4°.50'E
 Va.14°.E

300. E.C.End.

600 To Cor.No.2, identical with the loc.
 A granite stone 6X8X24 ins.set 12 ins.in the ground,with
 mound of stones, chiseled 1896-2-2551.No bearings available.
 Loc.cor.mon.of stones 3X3 ft.

Thence S 85°.10'W
 Va.14°.E

1500 Cor.No.3
 Identical with the loc.
 A Granite rock in place 6X24X24 ins.above the ground,with
 mound of stones, chiseled X-1896-3-2551.No bearings available.
 Loc.cor.mon.of stones 3X3 ft.

Thence N 4°.50'W
 Va.14°.E

150 Cr.wash 30 ft.wide, course N 56°.E

300 W.C.End.

600 To Cor.No.4. Identical with the loc.
 X-1896-4-2551 chiseled on granite bluff 3 ft.above the
 ground with mound of stones.No bearings available.Loc.cor.
 mon.of stones 3X3 ft.

Thence N 85°.10'E
 Va.14°.E

1450 *A wash 40 ft wide course N 42 E*
 1500 To Cor.No.1 the place of beginning.

AREA.

Total and net area of claim 20,661 acres

ADJOINING CLAIMS.

This claim is bounded on all sides by U.S.Land.

LOCATION.

This claim is located on unsurveyed land approximately in
 T 10.N R.4.W.Weaver Mining District Yavapai Co.Arizona.

LEDGE

The ledge brs. from W.C. End N 85°10'E 1500 ft. to E.C. End.

EXPENDITURE OF FIVE HUNDRED DOLLARS

I certify that the value of the labor and improvements upon this claim, placed thereon by the claimant and his grantors, is not less than five hundred dollars, and that said improvements consist of:

No. 1 dis. cut which brs. N 85°10'E 760 ft. from W.C. End.

4X20X 10 ft. ... Value \$50.00

No. 2 Tunnel which brs. from W.C. End N 85°10'E 680 ft. 5X7 X

300 ft. course N 30°E value \$2400.00

No. 3 Tunnel which brs. from cor. No. 2 N 59°45'W 682 ft. 5X7X

100 ft. course N 40°W value \$800.00

No. 4 Cut which brs from cor. No. 2 N 64°W 675 ft. 4X25X12 ft.

value.....\$50.00

No. 5 Tunnel which brs. from cor. No. 2 N 75°45'W 657 ft. 5X6X20

ft. course North. value.....\$140.00

No. 6 shaft which brs. from Cor. No. 2. N 64°50'W 394 ft.

4X6X100 ft. ... value \$800.00

Instrument

This survey was made with a Gurley light mountain solar transit. The courses were deflected from the true meridian as determined by direct solar observations. The distances were measured with 100-ft. and 500-ft. steel tapes.

William H. Merrill
U.S. Dep. Mineral Sur.

As there are no corners of the public survey and no monuments within the prescribed limits, I established U.S.L.M.No.2551 by chiselling X-U.S.L.M.No.2551 on granite rock in place 3 X 4 X 6 ft. on the South point of rocky peak, with monument 6 ft. base and 5 feet high. Whence
 U.S.L.M.No.
 X-B-R-2551 chiseled on granite rock in place brs.S 58°30'W 5 ft
 X-B-R-U.S.L.M.No.2551 chiseled on granite rock in place
 brs.N.74°50'E 4.5 ft.

South point of Malpai Mt. brs.N 68°54'E
 Highest point in granite Mt. brs.N 75°19'E
 North edge of flat top Mt. brs.S 85°15'E
 Sharp point in Mt. brs. S 54°48'W

Situated on unsurveyed land approximately in T.10.N
 R.4.W. Weaver Mining District, Yavapai Co., Arizona.

William H. Merritt
 U.S. Dep. Mineral Surveyor.

N 26° 40' W 1/4 19-30

From map 19-24-04-30 of 2°E 1013' 1924.

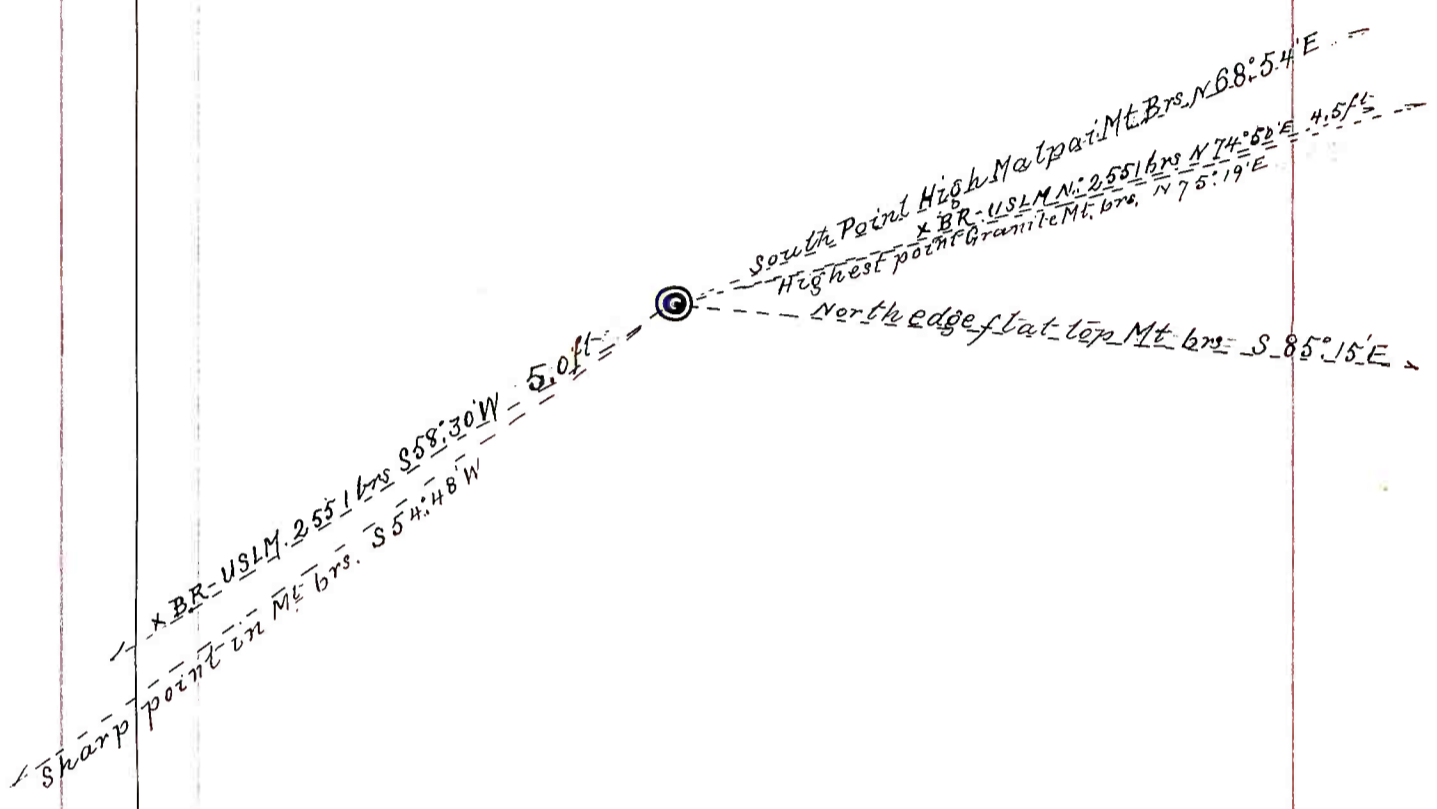

U.S.L.M. N^o 2551.



FINAL OATHS FOR SURVEYS.

LIST OF NAMES.

A list of the names of the individuals employed by William H. Merritt
 United States Deputy Mineral Surveyor, to assist in running, measuring, and marking the lines, corners, and
 boundaries described in the foregoing field notes of the survey of the mining claim of _____
R H Burmister
 known as the _____ 1896 _____
 and showing the respective capacities in which they acted.

W H Merritt, Chainman.
 _____, Chainman.
 _____, Axman.
 _____, Flagman.

FINAL OATHS OF ASSISTANTS.

W H Merritt
 and _____, do solemnly swear that we assisted William
H Merritt, United States Deputy Mineral Surveyor, in marking the corners and surveying
 the boundaries of the mining claim of _____
R H Burmister
 known as the _____ 1896 _____
 represented in the foregoing field notes as having been surveyed by said deputy mineral surveyor and under his
 direction; and that said survey has been in all respects, to the best of our knowledge and belief, faithfully and
 correctly executed, and the corner and boundary monuments established according to law and the instructions
 furnished by the United States Surveyor-General for Arizona _____

W H Merritt, Chainman.
 _____, Chainman.
 _____, Axman.
 _____, Flagman.

Subscribed and sworn to by the above-named persons before me this 29th

day of May, 1908.

My Commission Expires
July 7th 1909

W H Merritt
 Notary Public

FINAL OATH OF U. S. MINERAL SURVEYOR.

I, William H. Merritt, U. S. Mineral Surveyor,
do solemnly swear that, in pursuance of instructions received from the United States
Surveyor General for Arizona, dated
May 23rd 1908, I have, in strict conformity to the laws of the
United States, the official regulations and instructions thereunder, and the instructions
of said Surveyor General, faithfully and correctly executed the survey of the Mining
Claim of R. H. Burrister
, known as the
"1896"
situate in Weaver Mining District,
Yavapai County, Arizona, in Section
Approx, Township No. 10 N., Range No. 4 W. Uacuc
and designated as Survey No. 2551, as represented
in the foregoing field notes, which accurately show the boundaries of said mining claim
as distinctly marked by monuments on the ground, and described in the attached copy
of the location certificate, which was received by me from the Surveyor General with
said instructions, and that all the corners of said survey have been established and per-
petuated in strict accordance with the law, official regulations and instructions there-
under; and I do further solemnly swear that the foregoing are the true and original
field notes of said survey and my report therein, and that the labor expended and
improvements made upon said mining claim by claimant or his grantors
are as therein fully stated, and that the character, extent, location, and itemized value
thereof are specified therein with particularity and full detail, and that no portion of
said labor or improvements so credited to this claim has been included in the estimate
of expenditures upon any other claim.

William H. Merritt
U. S. Mineral Surveyor.

Subscribed and sworn to by the said William H. Merritt
U. S. Mineral Surveyor, before me W. N. Kelly
a Notary Public this 29th
day of May, 1908

My Commission Expires
June 8th 1911
6-1044

W. N. Kelly
Notary Public

Affidavit of Five Hundred Dollars Improvements.

We, W. H. Ferguson and F. M. Merritt

of lawful age, being first duly sworn according to law, depose and say: That we are

acquainted with the 1896 mining claim,

situate in Weaver Mining district, Yavapai County,

Arizona Territory, for which R. H. Bunnister

has made application for survey prior to application for patent under the provisions of the act of Congress, approved May 10, 1872; and that the labor done and improvements made thereon by the applicant and his grantor exceed Five Hundred Dollars in value, and further that we are not personally interested in said mine.

W. H. Ferguson
F. M. Merritt

TERRITORY OF ARIZONA, }
County of Yavapai } ss:

Sworn to and subscribed before me, this 29th

day of May, 1908



Commission Expires July 7th 1909
27089b1m2-01

W. H. Merritt
Notary Public

"1896"

Notice of Location.

Know all Men by these Presents:

That we the undersigned have this day Located Fifteen Hundred (1,500) linear feet of this vein or lode, bearing precious metals, with all dips, spurs, angles and variations, with surface ground Three Hundred (300) feet on each side of the center of vein, with all Mineral Deposits contained therein, and all Timber growing within the limits of said claim, and all Water and Water privileges thereon or appurtenant thereto, under and according to the provisions of the United States Mining Laws, under which it is Located.

This claim commences at this Monument and Notice placed upon the ledge, and runs 750 feet in a Northerly direction and 750 feet in a Southerly direction along the ledge from discovery shaft.

The Exterior boundaries are as follows, viz:

Commencing at a Monument of Stone on West boundary line, distant Three Hundred (300) feet in a Westerly direction from Discovery Monument; thence in a Northerly direction parallel with the ledge 750 feet to Monument of stone at N.W. corner of claim; thence in an Easterly direction at right angles across the ledge Six Hundred (600) feet to Monument of Stone At N.E. corner of claim; thence in a Southerly direction parallel with the ledge Fifteen Hundred (1,500) feet to Monument of Stone at S.E. corner of claim; thence at right angles across the ledge in a Westerly direction Six Hundred (600) feet to Monument of Stone at S.W. corner of claim; thence in a Northerly direction parallel with the ledge 750 feet to Monument on West boundary and place of beginning.

This ledge may be more generally described as situated about five miles W. Walnut Grove Dam sight and about one half mile N. of Walnut Grove and Weaver trail and was formerly known as the Texas located Jany 1st 1839 by H. Waterman Jno White Ed J Johnson (afterwards ^{owned} and worked by the Rich Hill Mining Co. in Weaver Mining District. Yavapai County. Arizona Territory; and shall be known as the 1896 Mining Claim.

DATED ON THE GROUND this First day of January 1896

Witness

Henry P. Bradshaw

Tom Carter

Geo B Scammell

Henry T. Andrews

Recorded at request of Geo B Scammell March 9th A.D. 1896, at 1:55 o'clock P.M., in Book 45 of Mines, page 173 Records of Yavapai County, Arizona.

(SEAL)

F.A. Tritle
County Recorder.

By H.R. Tritle
Deputy.

Territory of Arizona,)
 :ss.
 County of Yavapai.)

I, J.C. Bradbury, County Recorder in and for the County of Yavapai, Territory of Arizona, and custodian of the records and files of such office, do hereby certify that I have compared the foregoing copy with and that the same is a full, true and correct copy of the Notice of Location of the following named lode mining claim, located in the Weaver Mining District, Yavapai County, Arizona Territory, as the same appears of record in my said office in the book and pages as follows:-

"1896" mining claim, notice of location whereof is of record in Book 43 of Mines, at page 173.

IN WITNESS WHEREOF, I have hereunto set my hand and affixed the seal of my office this 27th day of August, A.D. 1907.



J. C. Bradbury
 County Recorder.

U. S. SURVEYOR GENERAL'S FINAL CERTIFICATE ON
FIELD NOTES.

DEPARTMENT OF THE INTERIOR,

OFFICE OF U. S. SURVEYOR GENERAL,

Phoenix, Arizona,

Sept. 5, 1908.

I, U. S. Surveyor General for District of Arizona,
do hereby certify that the foregoing transcript of the Field Notes, return and approval
of the Survey of the mining claim of

R. H. Burmister

, known as the 1896

, situate in Weaver

Mining District, Yavapai County,

Arizona, in Section Approx., Township No. 10 N.,

Range No. 4 W., Unsur., and designated as Survey

No. 2551, has been correctly copied from the originals on

file in this office; that said Field Notes furnish such an accurate description of said
mining claim as will, if incorporated into a patent, serve fully to identify the premises,
and that such reference is made therein to natural objects or permanent monuments as
will perpetuate and fix the locus thereof.

And I further certify that five hundred dollars' worth of labor has been expended
or improvements made upon said mining claim by claimant or his grantors, and
that said improvements consist of 3 tunnels, 2 cuts and 1 shaft,
total value \$4240.00

and that no portion of said labor or improvements has been included in the estimate of
expenditures upon any other claim.

I further certify that the plat thereof, filed in the U. S. Land Office at Phoenix,
Arizona is correct and in conformity with the foregoing Field Notes.

Frank S. Ingalls,

United States Surveyor General for Arizona.

4-687.

SURVEYOR-GENERAL'S CERTIFICATE OF APPROVAL OF FIELD NOTES AND SURVEY OF MINING CLAIM.

Department of the Interior,

Office of U. S. Surveyor-General,

Phoenix, Arizona,

Sept. 5, 1908.

I, U. S. Surveyor-General for District of Arizona

do hereby certify that the foregoing and hereto attached Field Notes and Return of the Survey of the Mining Claim of

R. H. Burnister

, known as the

1896

situate in Weaver Mining District,

Yavapai County, Arizona

in Section Approx., Township No. 10 N., Range No. 4 W., Unsur.

, designated as Survey No. 2551

executed by William H. Merritt, U. S. Deputy Mineral

Surveyor, May 28, 1908, under my instructions dated

May 23, 1908, have been critically examined and the necessary

corrections and explanations made, and the said Field Notes and Return, and the Survey they describe,

are hereby approved. A true copy of the copy of the location certificate filed by the applicant for

survey is included in the field notes.

Frank A. Segan

U. S. Surveyor-General for Arizona.

