

Copied Jan. 17, 1910.

A. L. H.

*Platted  
W.M.A.*

OCT 27 1909

4-683.

MINERAL SURVEY No. 2689

LOT No.

Arizona Land District.

# FIELD NOTES

OF THE SURVEY OF THE MINING CLAIM OF

Paul B. Warnekros.

KNOWN AS THE

Poor Man

Turquoise Mining District,

Cochise County, Territory of Arizona.

Section approx., Township 19 S., Range 25 E G. & S. R. B. & M. Unsur.

Surveyed under instructions dated July 1, 1909.19

by Franklin W. Smith.  
U. S. Mineral Surveyor.

Claim located See Location Notice., 19

Survey commenced Sept. 2, 1909., 19

Survey completed Sept. 2, 1909., 19

6-822

Postoffice address of claimants attorney,

J. M. O'Connell, Bisbee, Arizona.

## Poor Man lode.

Beginning at Cor. No. 1, the S. W. Cor., identical with the N. W. Cor. of the King Solomon lode unsurveyed, and situated on line 3-4 Sur. No. 1319 George lode, a pine post 4 ft. long 4 ins. sq. set 18 ins. in the ground in a mound of stones and scribed 1-2689 P.M.L, whence a limestone rock in place 12 x 12 x 8 ins. high chiselled X BR 1-2689 brs. S 48° 21' E 31.4 ft. and a second limestone rock 12 x 24 x 12 ins. high with same scribing brs. N 20° 16' W 26.4 ft., and original location for the S. W. Cor. brs. S 34° 26' E 0.85 ft. and U. S. L. M. No. 1319 Turquoise Mining District brs. S 34° 26' W 398.8 ft.

Thence N 34° 26' W

352.75 along line 3-4 Sur. No. 1319 George lode to original location for W. E. C. being a mound of stones 3 ft. high with a 3 ft. base.

705.5 same bearing to Cor. No. 2, the N. W. Cor., identical with location and situated on line 3-4 Sur. No. 1319 George lode at S 34° 26' E 112.4 ft. from Cor. No. 3, a pine post 4 ft. long 4 ins. sq. set 18 ins. in the ground in amount of stones and scribed 2-2689 P.M.L. whence a limestone rock in place 12 x 18 x 10 ins. high chiselled X BR 2-2689 brs. N 83° E 141.4 ft. and a second limestone rock in place 14 x 16 x 12 ins. high with same scribing brs. S 45° 40' E 26.2 ft.

Thence N 87° 19' E

199.5 to a Cor. of the Octopus and <sup>S.W. Cor.</sup> Miami lodes unsurveyed.  
454.3 same brg. intersect road leading to Miami shaft.

525.7 same brg. to the end center of the Miami lode unsurveyed.

774.0 same brg. to original <sup>N.</sup> side center location.

843.0 same brg. to the S. W. and S. E. Cors. respectively of Wonder and Miami lodes unsurveyed.

1500.0 same brg. to Cor. No. 3, the N. E. Cor., a pine post 4 ft. long 4 ins. sq. set 18 ins. in the ground in a mound of stones and scribed 3-2689 P.M.L. whence a limestone cropping 3 ft. high chiselled X BR 3-2689 brs. N 59° 43' E 58.0 ft. and a second limestone ledge 3 ft. high with

scribing brs. N 15° 27' E 74.6 ft., and original location for the N. E. Cor. brs. N 87° 19' E 4.6 ft.

Thence S 34° 26' E

352.75 to E. E. C. a mound of stones 3 ft. high with a 3 ft. base  
Original location for E. E. C. brs. S 83° 19' E 4.6 ft.

704.2 same brg. to Cor. No. 4, the S. E. Cor., a pine post 4 ft. long 4 ins. sq. set 18 ins. in the ground in a mound of stones and scribed 4-2689 P.M.L, whence a limestone cropping 5 ft. high chiselled X BR 4-2689 brs. N 89° 02' W 154.3 ft. and a second limestone cropping 7 ft. high with same scribings brs. N 33° 59' E 276.2 ft. and original location for the S. E. Cor. brs. N 87° 16' 30" E 5.0 ft.

Thence S 87° 16' 30" W

750.0 to original location for S. side center.

824.3 same brg. to N. W. and N.E. Cors. respectively of the Moro and King Solomon lodes unsurveyed.

1259.3 same brg. intersect wagon road leading to Miami shaft.

1499.3 same brg. to Cor. No. 1 the place of the beginning.

#### LEDGE

The presumed course of the vein on this claim is from the E. E. C. S 87° 19' W 1500.0 ft.

#### AREA

Total and net area of Poor Man Lode 20.639 a. ✓

#### IMPROVEMENTS.

No.1. Dis. Shaft 5 x 6 x 104 ft. deep untimbered  
brs. from W. E. C. N 87° 19' E 350 ft. Value \$2080.00

No.2. Drift 4 x 6 x 10 ft. long running north from  
the 30 ft. level of above shaft Value 50.00

No. 3. Drift 4 x 5 x 10 ft. long running north from  
the 50 ft. level of the above shaft. Value 50.00

No. 4. Drift 4 x 6 x 20 ft. long running east from  
the 50 ft. level of above shaft, and an incline raise  
4 x 5 x 20 ft. long running south from end of drift.  
Value 100.00

No.5. Open cut 5 x 10 x 19 ft. long with tunnel at face  
5 x 7 x 11 ft. long brg. S 70° E the mouth of open cut  
brs. from Cor. No.2 S 81°32' E 334.4ft. value \$100.00

Total value of improvements on this claim \$2380.00

I hereby certify that the value of the labor and im-  
provements on this claim, placed thereon by the claimant  
or his grantors is not less than \$50000 and that said  
improvements are as listed above.

OTHER IMPROVEMENTS.

Frame house, the S.E.Cor. of which brs. from Cor. No.  
4 N55° 18' W 159.9 ft.

ADJOINING CLAIMS.

North; Octopus, Miami and Wonder claims unsur. owned  
by the Calumet & Arizona Mining Co.

East; Sure Thing lode unsur. owned by the Calumet  
& Arizona Mining Co.

South; Moro and King Solomon <sup>lodes</sup> unsur. owned by the  
Calumet & Arizona Mining Co.

West; Sur. No. 1319 George Lode owned by the Calumet  
and Arizona Mining Co.

LOCATION.

This claim is located about  $\frac{1}{2}$  mile northwest from the  
postoffice at Courtland, in the Turquoise Mining District  
Cochise County, Territory of Arizona, approximately in  
Tp. 19 S. R. 25 E. G. & S.R.B. & M. unsurveyed.

INSTRUMENT.

This survey was made with a C.L.Berger & Sons No. 1  
C transit. The courses ~~were~~ deflected from the true mer-  
idian as determined by a Solar observation checked by  
an observation on Polaris. The distances were measured  
with a 300 ft. steel tape. Magnetic variation 13° E  
at all corners.

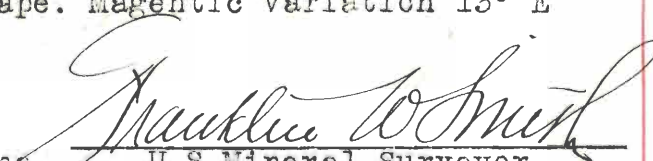
Dated at Bisbee, Arizona.   
Sept. 6th 1909. U.S. Mineral Surveyor.

Note; The tie of this survey does not check with the tie  
of Survey No. 1319 George Lode. After noting the differ-  
ence I rechecked my tie and find it correct.

The North and South Side Centers, the original loca-  
tions for the N. E., the S. E., and the S.W.Cors., and  
the East End Center, are monuments of stone 3 feet high  
with a 3 foot base.

# FINAL OATHS FOR SURVEYS.

## LIST OF NAMES.

A list of the names of the individuals employed by Franklin W. Smith.

United States Mineral Surveyor, to assist in running, measuring, and marking the lines, corners, and boundaries described in the foregoing field notes of the survey of the mining claim of \_\_\_\_\_

Paul Warnekros

known as the Poor Man

and showing the respective capacities in which they acted.

R. L. Motz. \_\_\_\_\_, *Chainman.*

S. A. Spellmeyer \_\_\_\_\_, *Chainman.*

\_\_\_\_\_, *Arman.*

\_\_\_\_\_, *Flagman.*

## FINAL OATHS OF ASSISTANTS.

We, R. L. Motz

and S. A. Spellmeyer

do solemnly swear that we assisted \_\_\_\_\_

Franklin W. Smith \_\_\_\_\_, United States Mineral Surveyor, in marking the corners and surveying the boundaries of the mining claim of \_\_\_\_\_

Paul Warnekros

known as the Poor Man

represented in the foregoing field notes as having been surveyed by said mineral surveyor and under his direction; and that said survey has been in all respects, to the best of our knowledge and belief, faithfully and correctly executed, and the corner and boundary monuments established according to law and the instructions furnished by the United States Surveyor-General for Arizona

R. L. Motz \_\_\_\_\_, *Chainman.*

S. A. Spellmeyer \_\_\_\_\_, *Chainman.*

\_\_\_\_\_, *Arman.*

\_\_\_\_\_, *Flagman.*

Subscribed and sworn to by the above-named persons before me this 6th.

day of September \_\_\_\_\_, 1909

Charles R. Moffatt

Notary Public in and for the County  
of Cochise, Territory of Arizona. 6-1093  
My Commission expires Jan. 10th, 1912

# FINAL OATH OF U. S. MINERAL SURVEYOR.

I, Franklin W. Smith, U. S. Mineral Surveyor, do solemnly swear that, in pursuance of instructions received from the United States Surveyor General for Arizona, dated July 1st. 1909., I have, in strict conformity to the laws of the United States, the official regulations and instructions thereunder, and the instructions of said Surveyor General, faithfully and correctly executed the survey of the Mining Claim of Paul B. Warnekros, known as the Poor Man, situate in Turquoise Mining District, Cochise County, ~~Territory of Arizona~~ Section approx., Township No. 19 S, Range No. 25 E. G. & S. R. B. & M. Unsur. and designated as Survey No. 2689, as represented in the foregoing field notes, which accurately show the boundaries of said mining claim as distinctly marked by monuments on the ground, and described in the attached copy of the location certificate, which was received by me from the Surveyor General with said instructions, and that all the corners of said survey have been established and perpetuated in strict accordance with the law, official regulations and instructions thereunder; and I do further solemnly swear that the foregoing are the true and original field notes of said survey and my report therein, and that the labor expended and improvements made upon said mining claim by claimant or his grantors are as therein fully stated, and that the character, extent, location, and itemized value thereof are specified therein with particularity and full detail, and that no portion of said labor or improvements so credited to this claim has been included in the estimate of expenditures upon any other claim.

*Franklin W. Smith*  
U. S. Mineral Surveyor.

Subscribed and sworn to by the said Franklin W. Smith  
U. S. Mineral Surveyor, before me Charles R. Morfoot,  
Notary Public this 6th.  
day of September, 190 9

*Charles R. Morfoot*  
Notary Public in and for the County  
of Cochise, Territory of Arizona.  
My Commission expires Jan. 10th, 1912

# Affidavit of Five Hundred Dollars Improvements.

We, G. A. Arnold and Wm. J. Simonton

of lawful age, being first duly sworn according to law, depose and say: That we are acquainted with the Poor Man mining claim, situate in Turquoise Mining district, Cochise County, Arizona Territory, for which

Paul B. Warnekros

has made application for survey prior to application for patent under the provisions of the act of Congress, approved May 10, 1872; and that the labor done and improvements made thereon by the applicant and his grantors exceed Five Hundred Dollars in value, and further that we are not personally interested in said mine.

G. A. Arnold

Wm. J. Simonton

TERRITORY OF ARIZONA,

County of Cochise

} ss:

Sworn to and subscribed before me, this 3rd

day of September, 1909



MY COMMISSION EXPIRES SEPT. 10TH, 1912

27669b1m2-07

J. M. Cabell  
Notary Public  
In and for Cochise County, Territory of Arizona.

AMENDED

# Notice of Mining Location

## LODE CLAIM

To All Whom It May Concern:

This Mining Claim, the name of which is the Poor Man Mining Claim, situate on lands belonging to the United States of America, and in which there are valuable mineral deposits, was entered upon and located for the purposes of exploration and purchase by Wm. Holmes

a citizen of the United States  
(Locator must insert either "a citizen of the United States," or, "who has declared his intention to become a citizen of the United States.")

the undersigned, on the 1st day of January ~~1897~~ 1897

The length of this claim is Fifteen hundred (1500.) feet, and I claim Three hundred and fifty (350) feet, in a Westerly direction and Eleven hundred and fifty (1150) feet in a Easterly direction from the center of the discovery shaft, at which this notice is posted, lengthwise of the claim, together with Three hundred (300) feet in width of the surface grounds, on each side of the center of said claim. The general course of the lode deposit and premises is from the Easterly to the Westerly

The claim is situated and located in the Turquoise Mining District, in Cochise County, in the Territory of Arizona, about 3000 feet in a Northwesterly direction from the Germania Shaft and joins the George Mine on the West; The King Solomon and Mack Mine on the South; The McMillan and Wolf and Sure Thing on the East.

The surface boundaries of the claim are marked upon the ground as follows: Beginning at A monument of stones

at a point in a Westerly direction 350 feet from the discovery shaft (at which this notice is posted), being in the center of the Westerly end line of said claim; thence Southerly 300 feet to a monument of stones, being the South West corner of said claim; thence Easterly 1500 feet to a monument of stones, being at the South East corner of said claim; thence Northerly 300 feet to a monument of stones at the center of the Easterly end of said claim; thence Northerly 300 feet to a monument of stones, being at the North East corner of said claim; thence Westerly 1500 feet to a monument of stones at the North West corner of said claim; thence Southerly 300 feet to the place of beginning.

All done under the provisions of Chapter Six, of Title XXXII, of the Revised Statutes of the United States, and of an Act of the General Assembly of Arizona, entitled "An Act to Revise and Codify the Laws of the Territory of Arizona," approved March 16, 1901.

This is an Amended Location Notice of the Poor Man Mining Claim, located by Wm. Holmes

on the First day of January 1897 ~~1897~~, and recorded in Book 14 of Records of Mines, at page 138 in the office of the County Recorder of the aforesaid County of Cochise to which reference is hereby made, and this Amended Location Notice is made and posted to correct errors in the description in the said original Location Notice.

Dated and posted on the ground this 9th day of November 1908

Paul B. Warnekros

Filed and recorded at request of P. B. Warnekros Nov. 17 1908 at 1 P M. Book 42 Redord of Mines page 395.



TERRITORY OF ARIZONA, }  
County of Cochise. } SS.

I, C. A. McDonald, County Recorder in and for said County, DO HEREBY CERTIFY that I have compared the annexed and foregoing copy with the original Amended Location Certificate of the "POOR MAN" mining claim filed for record in my office on the 17th day of November 1908, and Recorded in Book 42 Record of Mines at Page 395, and that the same is a full, true and correct copy of said original amended notice and of the whole thereof.

Given under my hand and official seal this 26th day of June, A. D. 1909.

*C. McDonald*  
County Recorder.

This diagram is to give locator a general idea of plan of location under the new law. The Discovery Shaft can be in the center of claim or any distance from either end desired. In the diagram it is placed 500 feet from one end and 1000 feet from the other. Commence description of claim at a center end monument, giving its distance and direction from center of Discovery Shaft; thence bound the claim in either direction. In description be careful to state locality of claim with reference to some natural object, or permanent monument, as will identify the claim.

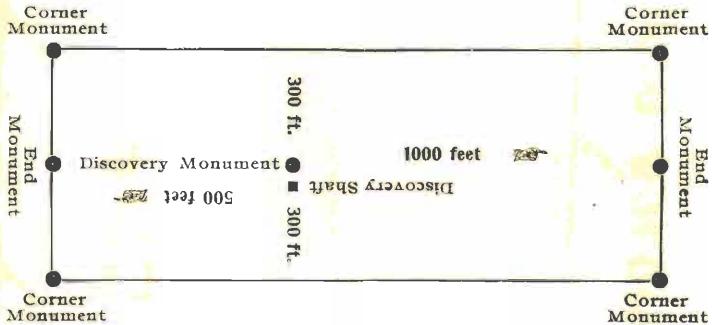

AMENDED  
**Notice of Location.**  
LODE CLAIM.

Jul 1 - 1909

Dated..... 1909

Filed and Recorded at request of

A. D. 1909

at..... M.

Book.....

Pages.....

County Recorder.

Deputy Recorder.

The H. H. McNeil Co., Printers, Phoenix

TERRITORY OF ARIZONA, }  
County of..... } ss.  
I,....., County Recorder in and for the County and Territory aforesaid, do hereby certify that the within instrument was filed for record at..... o'clock, M., on this..... day of..... 1909, and duly recorded in Book No..... Records of..... County, Arizona, at pages.....  
WITNESS my hand and official seal the day and year first above written.  
..... County Recorder.

U. S. SURVEYOR GENERAL'S FINAL CERTIFICATE ON  
FIELD NOTES.

DEPARTMENT OF THE INTERIOR,  
OFFICE OF U. S. SURVEYOR GENERAL,

Phoenix, Arizona,

March 5, 1910, 1 .

I, U. S. Surveyor General for District of Arizona,  
do hereby certify that the foregoing transcript of the Field Notes, return and approval  
of the Survey of the mining claim of

Paul B. Warnekros

, known as the POOR MAN

, situate in Turquoise

Mining District, Cochise County,

, in Section Approx., Township No. 19 S.,

Range No. 25 E., G & S R B & M., Unsur., and designated as Survey  
No. 2689

, has been correctly copied from the originals on  
file in this office; that said Field Notes furnish such an accurate description of said  
mining claim as will, if incorporated into a patent, serve fully to identify the premises,  
and that such reference is made therein to natural objects or permanent monuments as  
will perpetuate and fix the locus thereof.

And I further certify that five hundred dollars' worth of labor has been expended  
or improvements made upon said mining claim by claimant or his grantors, and  
that said improvements consist of 1 shaft, 3 drifts, 1 raise and 1 cut  
and tunnel, total value \$2380.00

and that no portion of said labor or improvements has been included in the estimate of  
expenditures upon any other claim.

I further certify that the plat thereof, filed in the U. S. Land Office at Phoenix,  
Arizona is correct and in conformity with the foregoing Field Notes.

Frank S. Ingalls,

United States Surveyor General for Arizona.

4-687.

SURVEYOR-GENERAL'S CERTIFICATE OF APPROVAL OF FIELD  
NOTES AND SURVEY OF MINING CLAIM.

**Department of the Interior,**

*Office of U. S. Surveyor-General,*

Phoenix, Arizona,

March 5, 1910, 190

I, U. S. Surveyor-General for District of Arizona,

do hereby certify that the foregoing and hereto attached Field Notes and Return of the Survey of the  
Mining Claim of Paul B. Warnekros

....., known as the

POOR MAN

situate in Turquoise Mining District,  
Cochise County, Arizona

in Section Approx., Township No. 19 S., Range No. 25 E., G&SRB&M,  
Unsur., designated as Survey No. 2689

executed by Franklin W. Smith, U. S. Deputy Mineral

Surveyor, Sept. 2, 1909, 190, under my instructions dated

July 1, 1909, 190, have been critically examined and the necessary cor-

rections and explanations made, and the said Field Notes and Return, and the Survey they describe,

are hereby approved. A true copy of the copy of the location certificate filed by the applicant for

survey is included in the field notes.

*Frank S. Lyzack*

U. S. Surveyor-General for Arizona.