

9-23-10.

F. L.

1

JUL 13 1910

4-683.

MINERAL SURVEY No. 2822

LOT No. _____

Arizona Land District.

FIELD NOTES

OF THE SURVEY OF THE MINING CLAIM OF

Boundary Cone Gold Mines Co.

KNOWN AS THE

Great Eastern, Great Eastern Extension, Surprise West Extension
Surprise, Surprise East Extension, Boer and Apex.
San Francisco Mining District,

Mohave County, Arizona

Section approx, Township 19 N, Range 20. W. unsurveyed.

Surveyed under instructions dated June 23, 1910

by H. G. Schader

U. S. Mineral Surveyor.

Claim located see location notices, 19

Survey commenced July 1st, 1910

Survey completed July 9th, 1910

6-322

Address

C. W. Herndon, Atty.,
Kingman Ariz.

Feet. Mineral Survey No 2822.

Surprise East Extension Lode.

Beginning at Cr. No 1 - identical with location
no Cr no 3 Apex Lode no Cr no 4. Surprise
Lode, both of this survey, a pine post 4x4x
36 ins, set 18" in the ground scribed S.E.E.1 -
54 - 93 - 2822. - Shaft no 4 Surprise Lode,
this survey, bears S45° 06' W. 346. ft. U.S.L.M.
no 1602. bears N 12° 09' 40" W. 560.2 ft distant.
Thence S 22° 36' W. Var 15° E.

300 west end center, identical with location, a mound
of stones.

310 Cross road

600 Cr. no 2. identical with location no Cr. no 3
Surprise lode, this survey; a pine post 4x4x36
ins, set 18 ins in the ground, scribed S.E.E.2.
9.3 - 2822 - Shaft no 4. Surprise lode, this
survey bears N 2° 41' W. 310 ft distant.
Thence S 80° 10' E. Var 15° E.

530 Cr no 3, identical with location, a pine post
4x4x36 ins. set 18 ins in the ground scribed
S.E.E.3 - 2822. - Shaft no 3. bears N 62° 07' E.
483.8 ft distant.
Thence. S 73° 10' E. Var 15° E.

80 Foot of slope

194 Road No Needles

673.3 intersect line 1-2. Alice lode Survey no 2775,
Alice Cr no 1 bears N 11° 15' E. 140.2 ft distant.

741.7 Cr no 4, identical with location and Cr no 2
Boston Lode, Survey no 2775, a pine post
4x4x36 ins set 18 ins in the ground, scribed
S.E.E.4 - 2822 - 132 - 2775. Shaft no 3 - bears
N 32° 39' W. 516.1 ft distant.
Thence N 22° 36' E. Var 15° E.

156.3 intersect line 5-1. Alice lode Survey no
2775. Alice Cr no 1 - bears N 82° 09' W. 98.1 ft
distant.

300. East end center, identical with location, no
west end center of Boston lode, Sur. no 2775,
a mound of stones.

517.5 intersect Dutch side line York lode unsurveyed.
South Cr of York bears S 52° 39' E. 269 ft distant.

600 Cr no 5 - identical with location no Cr no 1

- Feed Boston lode Sur no 2775, a pine post 4x4x36 ins, set 18 ins in the ground, scribed S.E.F. 5-2822 - B1-2775. Shaft no 3 bears S76°48'N 522.8 ft distant.
- 200.6¹ Intersect south side line York lode. unsurveyed. South Cr. York. bears S52°39'E 474.09 ft distant.
- 475.3⁹ Intersect line 3-4. Beer lode - this survey - Cr no 3 Beer lode bears S22°55'N. 178.5 ft distant.
- 572. Road to Needles.
- 976.3 Intersect line 2-3. Beer lode this survey, identical with Cr 4 apex lode this survey, a pine post 4x4x36 ins, set 18 ins in the ground scribed Q-4-2822. No bearings available. Cr no 3 Beer lode bears S56°23'E. 523 ft distant.
- 1244 Cross Road.
- 1268. Cr no 1 - Place of beginning.

Surprise Lode

Beginning at Cr no 1. identical with location of Cr East Surprise West Extension lode this survey, a pine post 4x4x36 ins, set 18 ins in the ground. Scribed S. 1. S.W.E. 4-2822. Discovering Shaft no 1. Surprise West Extension lode this survey bears S24°30'N 299.6 ft distant. U.S.L.M.M. 602 bears N 33° 58' 20" W 476.2 ft distant.

Thence S22°36'N - Var 15° E.

- 30. West end Center identical with location and east end Center Surprise West Extension lode this survey, a pine post. 4x4x36 ins in ground of Stones. Scribed N.E.C.S. - E.E.C.S.W.E.
- 600. Cr no 2. identical with location, Cr no 3 Surprise West Extension lode, this survey, a pine post 4x4x36 ins set 18 ins in the ground, scribed S2 - S.W.E. 3-2822. Disc. Shaft no 1 Surprise West Extension lode, this survey, bears N20°42'E. 300.7 ft distant. Thence S79°28'E Var 15° E
- 1120 Cr no 3 - identical with location, ^{and with Cr No. 2 Surprise East Extension lode of this survey.} previously described. Thence N 22°36'E. Var 15° E.
- 300 East end Center, identical with location, and west end center Surprise East Extension ^{of this survey.} previously described.
- 600 Cr no 1 Surprise East Extension lode of this survey and Cr no 1 Surprise East Extension lode of this survey, previously described.

Feet.

Thence $N 79^{\circ} 21' W$ var $15^{\circ} E$.

500.5 Cr no 5. identical with location, ^{no Cr 102} apex lode, this survey, a pine post $4 \times 4 \times 36$ ins, set 18 ins in the ground scribed S. 5-9. 2. 2822. Discovery shaft, apex lode, this survey bears $S 85^{\circ} 45' E$. 268 ft. distant.

Thence $S 43^{\circ} 45' W$. var $15^{\circ} E$.

161.7 Cr no 6. identical with location, a pine post $4 \times 4 \times 36$ ins. set 18 ins in the ground. No bearings available.

Scribed 56-2822

Thence $N 65^{\circ} 16' W$ var $15^{\circ} E$

150 Top of ridge
547.6 Cr no 11 - Place of beginning.

Surprise West Extension Lode.

Beginning at Cr no 1 - identical with location ^{no Cr no 5} Great Eastern lode this survey a pine post $4 \times 4 \times 36$ ins. set 18 ins in the ground, scribed. S.W.E 1 - J.B. 57822.

Shaft no 2 Great Eastern lode, this survey bears $S 48^{\circ} W$ 278 ft distant. U.S.L. M. 76 1602. bears $N 23^{\circ} 00' 20'' W$. 3705. 68 ft distant.

Thence $S 22^{\circ} 36' W$. var $15^{\circ} E$.

300 west end Center identical with location to east end Center Great Eastern lode, this survey, a pine post $4 \times 4 \times 36$ ins, set 18 ins in the ground scribed. W.E.C. - S.W.E. - E.E.C. - E.E.

598 Cr no 2. identical with location, ^{no Cr no 1} Great Eastern lode, this survey, a pine post $4 \times 4 \times 36$ ins, set 18 ins in the ground scribed S.W.E. 2 - J.E. A - 2822. Discovery shaft. Great Eastern lode - this survey, bears $N 0^{\circ} 14' E$ 368.1 ft distant.

Thence $S 64^{\circ} 08' E$. var $15^{\circ} E$.

325 Top of ridge
790 bottom of slope

870 Cross wagon road
1294.5 Cr no 3 - identical with location, ^{and with Cor. No 2 Surprise lode of this survey} previously described.

Thence $N 22^{\circ} 36' E$ var $15^{\circ} E$

300 East end Center, identical with location, ^{and with W.E.C. Surprise lode of this survey} previously described.

600 Cr no 1. identical with location, ^{and with Cor. No 1 Surprise lode of this survey} previously described.

Thence $N 64^{\circ} 13' W$. var $15^{\circ} E$.

370 Bottom small gulch

-4-

- 500 Top of low ridge
 720 Cross wagon road
 810 Top of ridge
 965 Bottom of gulch
 1294.5 Cr no 1 - place of beginning.

Great Eastern Lode.

Beginning at Cr no 1 - identical with location, Cr no 6 Great Eastern Extension Lode, this survey, a pine post $4 \times 4 \times 36$ ins. set 18" in the ground, scribed G.E. 1 - G.E.E. 6 - 2822. Shaft no 7 bears $S 22^{\circ} 12' N$ 91 ft distant. U.S.L.M. no 1602 - bears $N 90^{\circ} 11' 50'' W$. 2741.67 ft distant.

Thence $S 22^{\circ} 36' W$. Var $14^{\circ} 30' E$.

140. West end Center, identical with location West end Center Great Eastern Extension Lode, this survey, a pine post $4 \times 4 \times 36$ ins. set 18 ins in the ground scribed W.E.C. G.E.E.C. G.E.E.

360 Bottom of slope

400 Cross wagon road

- 440 Cr no 2. identical with location, Cr no 5 Great Eastern Extension Lode this survey, a pine post $4 \times 4 \times 36$ ins. set 18 ins in the ground scribed G.E. 2 - G.E.E. 5 - 2822.

Shaft no 7 - bears $N 22^{\circ} 42' E$. 349 ft dist.

Thence $S 56^{\circ} 50' E$. Var $15^{\circ} E$.

200 Edge of large wash

230 Cross wagon road

700 East side large wash

950 Top of ridge

- 1170.5 Cr no 3. identical with location and N.E. Cr. Selden Gate Lode unsurveyed. a pine post $4 \times 4 \times 36$ ins, set 18 ins in the ground scribed G.E. 3 - 2822. Discovery Shaft. bears $N 6^{\circ} 32' E$. 181.7 ft distant.

Thence $S 50^{\circ} 47' E$. Var $15^{\circ} E$

- 1896 Cr no 4 identical with location ^{and Cr. No. 2 Surprise West Extension Lode of this survey} ~~described.~~ ^{prev. loc.}

Thence $N 22^{\circ} 36' E$ Var $15^{\circ} E$.

298. East end Center, identical with location ^{and with W.E.C. Surprise West Extension Lode of this survey} ~~described.~~ ^{previous}

- 598 Cr no 5. identical with location ^{and with Cr. No. 1 Surprise West Extension Lode of this survey} ~~described.~~ ^{previous}

-5-

- Feet. Thence $N57^{\circ}11'N$. var $15^{\circ}E$.
 460 Bottom of slope and edge of wash
 955 cross wagon road.
 1010 west side large wash
 1260.7 Cr no 1 - place of beginning.

Great Eastern Extension Lode:

Beginning at Cr no 1 - identical with location, a pine post $4 \times 4 \times 36$ ins. set 18 ins in the ground, described G.E.E. 1-2822 - no bearings available.
 U.S.L. M.N. 1602 bears $N2^{\circ}49'10''N$.
 2417.83 ft distant.

- Thence $S22^{\circ}36'N$. var $15^{\circ}E$.
 130.87 Intersect west end line Gold Hill lode unsurveyed. S.W. Cr. Gold Hill lode unsurveyed, bears $S18^{\circ}37'E$. 72.65 ft distant.

- 166 Cr No 2 - identical with location on line 5-6 - Bradwell Lode. Sur No 1639 a pine post $4 \times 4 \times 36$ ins. set 18 ins in the ground, described G.E.E. 2 - 2822 - Cr No 6 Bradwell Lode Survey No 1639 bears $N8^{\circ}27'N$. 131.6 ft distant.

Thence $S8^{\circ}27'E$ var $15^{\circ}E$
 on line 5-6 - Bradwell lode Sur No 1639

290. Bottom gulch

425 cross road.

- 445.7 Cr No 3 - identical with location, a pine post $4 \times 4 \times 36$ ins, set 18 ins in the ground, described G.E.E. 3 - 2822 - no bearings available.

Thence $S66^{\circ}05'E$ var $15^{\circ}E$.

- 49.1 Cr no 4 identical with location at N.W. Corner Golden Gate Lode - unsurveyed a pine post $4 \times 4 \times 36$ ins, set 18 ins in the ground, described G.E.E. 4 - 2822.
 no bearings available.

- 135.2 Cr. No 5 - identical with location, previously described.
 Thence $S48^{\circ}42'E$ var $15^{\circ}E$.
 and with Cr No 2 Great Eastern lode of this survey

Thence $N22^{\circ}36'E$ var $15^{\circ}E$.

Feet.

300 East end Center, identical with location and with W.E.C. Great Eastern lode of this survey previously described.

440 Cr. no 6 - identical with location ^{and Cor. N. of Great Eastern lode of this survey} ~~to~~ ^{the} Cr. of Gold Hill lode, unsurveyed, previously described. S.W. Cor. Gold Hill lode, unsurveyed bears $N 73^{\circ} 32' W$. 361.2 ft distant.

Thence $N 47^{\circ} 33' W$. var $14^{\circ} 30' E$.

432.7 Cr. no 1 - Place of beginning.

Beer lode.

Beginning at corner 1167. identical with location on line 2-3 - Victor lode survey no 2243 - a pine post $4 \times 4 \times 36$ ins. set 18 ins in the ground, scribed B-1-2822 - U.S.L.M. no 1602 bears $N 45^{\circ} 56' 00'' W$ 4805.7 ft distant.

Cr. no 3 - Victor lode pin no 2243 bears $S 50^{\circ} 06' E$. 818.0 ft distant. S.W. of Victor Yanide plant bears $N 16^{\circ} 12' E$. Corner of Victor bunk house bears $S 50^{\circ} 06' E$.

Thence $S 22^{\circ} 55' W$.

variation at all corners $N 15^{\circ} E$.

191.5 West end Center, identical with location, a pine post $4 \times 4 \times 36$ ins, set 18 ins in ground scribed W.E.C.B.

423 Cr. no 2. identical with location to Cr. no 6 - apex lode this survey, a pine post $4 \times 4 \times 36$ ins set 18 ins in ground of stones scribed B-2-96-2822 - no bearings available.

Thence $S 56^{\circ} 23' E$.

575 Cross wagon road

888.2 Intersect line 5-1 - Surprise East Extension lode this survey, identical with Cr. no 1 Apex lode this survey previously described.

1366 Cross road to Needles.

1411.2 Cr. no 3 - identical with location a pine post $4 \times 4 \times 36$ ins, set 18 ins in the ground scribed B-3-2822 - Shaft No 3 Surprise East Extension lode, this survey bears $S 17^{\circ} 55' E$. 72.9 ft distant.

-7-

- Feet. Thence N. 22° 55' E.
- 178.5 Intersect line 5-1 - Surprise East Extension lode this survey.
 - 276.6 East end Center, identical with location, a pine post 4x4x36 ins. set 18 ins in the ground scribed E. & C. B.
 - 289.8 Intersect south side line York lode - unsurveyed. West corner York lode bears N 52° 39' W. 478 ft distant.
 - 460 Cross road to Needles.
 - 535.6 Cr. No. 1. identical with location, a pine post 4x4x36 ins, set 18 ins in the ground scribed 12 ft. - 2822. no bearings available. Thence N 60° 56' W
 - 70 Cross Road.
 - 470.2 Intersect west end line York lode unsurveyed. West Cr. York lode bears S 21° 16' W. 177.25 ft distant.
 - 557.9 Intersect line 3-4 - Victor lode Sur No 2343. Cr No 3 Victor lode. bears S 40° 37' W 156.95 ft distant.
 - 1394.76 Cr. No. 1 Place of beginning.

Apex Lode. N.W. Cor. of location, a mound of stones brs. N. 19° 26' W 101 ft.
 Beginning at Cr. No 1. ~~identical with location~~
 a pine post 4x4x36 ins set 18 ins in the ground, scribed 91-2822. Whence U.S.L.M. No 1602 - bears N 40° 11' 30" west 496.96 ft. distant. no bearings available.
 Thence S 18° 30' E.

Variation at all corners 15° E.

- 18. Top of Ridge.
- 201.3 West end center, identical with location, a mound of stones
- 333.6 Cr No 2. identical with location and Cr No 5 Surprise lode this survey to east end center of Treasure Key lode unsurveyed previously described. Thence S 79° 21' E
- 500.5 Cr No 3. identical with location ^{and Cr. No 1 Surprise East Extension} Cr No 1 - Surprise lode, this survey - previously described. Thence S 76° 05' E.
- 272.6 Cr No 4 identical with location on line 2-3 - Beer lode this survey - previously described. Whence S.E. Cor. of location a mound of stone brs. S. 5° 36' W. 130 ft. and N.E. Cor. of location a mound of stone brs. N. 20° 42' E. 266 ft.

Feet

- 10. ~~Co. no 5 identical with location~~, a pine post 4x4x36 ins set 18 ins in ground of Stones, scribed 95-2822. No bearings available. Thence $N 18^{\circ} 30' E$.
- 310 880.³³ Cross wagon road. Co. no 6 - identical with location ~~402~~ 402 Beer lode this survey previously described. Thence $N 56^{\circ} 47' W$.
- 123.9 Co. no 1. place of beginning. Thence $S 81^{\circ} 58' W$.

Lode lines.

The presumed course of the veins of the several locations embraced in this claim extend as follows:-

Surprise East Extension lode, from East End Center $N 73^{\circ} 10' W$ 741.7 ft to discovery cut; thence $N 80^{\circ} 10' W$ 530. ft to west end center.

Surprise lode, from East End Center $N 79^{\circ} 28' W$ 327 ft to face of discovery tunnel; thence $N 79^{\circ} 28' W$ 793 ft to west end center.

Surprise west extension lode, from East End Center $N 64^{\circ} 13' W$ 10 ft. to discovery shaft; thence, $N 64^{\circ} 13' W$ 1284.5 ft to west end center.

Great Eastern lode, from East End Center $N 50^{\circ} 13' W$ 147 ft to center of discovery shaft; thence $N 50^{\circ} 13' W$ 1151.7 ft to west end center.

Great Eastern Extension lode, from East End Center $N 50^{\circ} 10' W$ 156 ft to center of entrance to discovery cut; thence $N 50^{\circ} 10' W$ 270.3 ft. to west end center being Co. no 2.

Beer lode, from East End Center $N 58^{\circ} 12' W$ ~~1284~~ ⁷⁸⁴ ft. to ~~location monument~~ ^{Discovery shaft}; thence $N 58^{\circ} 12' W$ 909.5 ft to west end center.

Apex lode, from Beer lode, being East End Center, $N 74^{\circ} 23' W$ 515.42 ft. to discovery shaft; thence $N 64^{\circ} 26' W$ 335.75 feet to west end center.

-9-

Area.	Acres
Total area - Surprise East Extension lode	16.727 ✓
Area in conflict with Alice lode Sur. No 2775	.279 ✓
Total area Surprise lode	14.137 ✓
" " Surprise West Extension lode	17.772 ✓
" " Great Eastern lode	12.801 ✓
" " Great Eastern Extension lode	3.442 ✓
Conflict with Gold Hill lode - unsurveyed	.857 ✓
Total area Beer lode	15.258 ✓
Conflict Surprise East Extension	1.052 ✓
" Victor lode Sur. No 2243	1.473 ✓
Total area Apex lode	3.367 ✓
Conflict with Beer lode	.062 ✓

Location.

This survey is located in San Francisco Mining District, Mohave County, Arizona on unsurveyed land of the U.S. in approximately T 19 N. - R. 20 W.

Expenditure of Five Hundred Dollars.

I certify that the value of labor and improvements made upon, or for the benefit of each of the locations embraced in said mining claim, by the claimant or its grantors is not less than five hundred dollars so that said improvements consist of:-

- On Surprise East Extension lode
- 101 Discovery cut 3 1/2 x 13 x 10 ft face - East End lode bears S 73° 10' E. 741.17 ft Location monument bears N 73° 10' W. 20 ft. Value \$ 50.00
102. Cut 4 x 4 x 7 ft. long. Discovery cut bears S 80° 10' E 150 ft. Value 10.00
103. Shaft 4 x 6 x 20 ft deep on 5 bears N 76° 48' E. 522.5 ft. Value - 300.00
- 104 Shaft 4 x 7 x 4 ft deep on 101 bears N 16° 39' W. 310 ft. Value 20.00
- 105 Cut 12 x 4 x 6 ft face - West end lode bears N 89° 10' W. 36 ft. Value 30.00
- One seventh of common improvement, shaft No 4 Surprise lode of this survey 950.00

- On Surprise Lode:-
- no1- Discoring tunnel 5x6x9 ft long
East End Center bears S 79° 28' E. 327 ft
Location Monument bears N 12° E. 13 ft.
Value - 50.00
 - no2. Cut 4x4x4 ft. On nos bears
N 4° 28' W. 281 ft. value 10.00
 - no3 Cut 8x8x4 ft. - On nos bears
N 4° 18' E. 265 ft. value 30.00
 - no4 Shaft 5x9x19 ft deep, timbered and
equipped with a head frame and
Hoisting Engine. On nos bears
N 45° 06' E 346 ft. - This shaft is
a common improvement for the
entire seven locations. Five
of them are on the same vein end
to end, and drifts from the lower
levels will develop these five
locations from one end of the
property to the other. This shaft
would be the main haulage way
for extraction of ore from these
five. - Two locations - the
Beer and Apex - are on veins
nearly parallel to this vein. A
rescut from this shaft in a
northerly direction would develop
both these side veins and this shaft
would be the main haulage way for
the extraction of ore from these two
locations. - value of shaft not
counting head frame or Hoist
= 6650.00 On Seventh of Common Improvement 950.00
drift on 150 ft level 19 ft long extends 312.00
 - no5 Cut 7x7x32 ft long - East End Center
bears S 79° 28' E. 65 ft. value 320.00
 - no6 Shaft 4x4x3 ft deep on nos bears
N 46° 58' W 340 ft. value 10.00
 - no7 Shaft 4x4x3 ft on nos bears
N 46° 58' W 330 ft. value 10.00
 - no8 Cut 6x6x8 ft far - on nos bears
N 40° 19' W 191 ft. value 30.00
 - no9 Shaft 5x5x8 ft deep on nos bears
N 51° 28' W. 76 ft. value 40.00

and el. 80° E. 9 1/2 ft. from the center of the station,
the station being a cut into the hanging
wall to the south to get clear of shaft.

2010 Cut 20 x 4 x 10 ft fac West End
Center bears N 86° W 435 ft value \$ 60.00

On Surprise West Extension Lode

201- Win Corny Shaft & Cut 3 x 6 x 8 ft
deep East end Center bears S 64° 13' E 10 ft value 150.00

202 Shaft 4 x 6 x 10 ft deep East end Center
bears S 64° 13' E 80 ft value 50.00

203. Shaft 4 x 6 x 7 ft deep. On 202 bears
N 87° 30' W 618 ft value 35.00

204 Cut 3 1/2 x 6 x 75 ft long to 202 bears.
S 89° W 493 ft. value 60.00

205 Cut 4 x 8 x 12 ft long on 202 bears
S 80° W. 352 ft. value 40.00

206 Shaft 4 x 6 x 9 ft deep. West end Center
bears N 37° 48' W 215 ft. value 50.00

207 Cut 4 x 25 x 7 ft. fac. On 201 bears
N 19° 40' W 313 ft. value 60.00

One Seventh of Common Improvement
Loc. Mon. bears N 86° 53' W 13 ft from East End Center 950.00

On Great Eastern Lode.

201- Win Corny Shaft 3 x 10 x 10 ft deep. East end.
Center bears S 50° 13' E. 147 ft. Loc. Mon.
bears S 15 ft value 60.00

202 Shaft. 4 x 5 x 5 ft deep. On 205 bears
N 48° E. 278 ft. value 25.00

203 Shaft 4 x 6 x 10 ft deep East end Center
bears S 67° 40' E. 197 ft. value 50.00

204 Cut 3 x 15 x 5 ft fac. East end Center
bears S 69° 54' E. 150 ft. 25.00

205 Cut 3 x 15 x 7 ft fac. East end Center bears
S 77° 40' E. 217 ft. value. 35.00

206 Shaft 4 x 6 x 10 ft. deep On 204
bears S 28° 02' E. 610 ft. value 50.00

207 Shaft 6 x 5 x 7 ft deep. On 201 bears
N 22° 12' E. 9 ft. value 35.00

208 Shaft 6 x 5 x 7 ft deep West end Center bears
S 44° 30' West 58 ft. value 35.00

209 Cut 5 x 10 x 8 ft fac On 201 bears
North 20 ft. value 40.00

2010 Shaft 3 x 6 x 3 ft deep West end Center
bears S 59° 30' W 140 ft. value 15.00

One Seventh Common Improvement 950.00

- 12 -

~~On~~ Great Eastern Extension Lode:-

- no1 Discovery Cut 5 x 18 x 8 ft fac. East end Center bears S 50° 10' E. 156 ft. value 40.00
 - no2 Shaft 4 x 6 x 5 ft deep East end Center bears S 31° 40' E 220 ft. value 25.00
 - no3 Cut 4 x 15 x 9 ft fac East end Center bears S 41° 23' E. 291 ft. value 50.00
- On Seventh Common Improvement 950.00
Loc. Mon. is alongside side. Cut 4 ft. North

~~On~~ Apex Lode:-

- no1 Discovery shaft 6 x 6 x 8 ft deep. On N 4 bears S 74° 23' E. 575.42 ft value 50.00
 - no2 Shaft 4 x 6 x 1 ft deep On N 2 bears N 87° 12' W. 186 ft. value 10.00
 - no3 Shaft 6 x 6 x 14 ft deep. On N 2 bears N 85° 27' W. 20 ft value 75.00
- On Seventh Common Improvement. 950.00
Location monument bears S 83° 55' E 179 ft from On N 2.

~~On~~ Beer Lode:-

- no1 Discovery shaft 4 x 6 x 25 ft deep. P.E.E.C. bears S 58° 12' E. 494 ft. value 250.00
 - no2 Shaft. 7 x 5 x 9 ft deep. Loc. Mon. bears N 66° 15' W. 38 ft value 30.00
 - no3 Shaft 4 x 6 x 4 ft deep Cut 4 x 21 x 4 ft deep. Entrance to cut. bears N 58° 12' W. 28 ft from Loc. Mon value 40.00
 - no4 Tunnel 3 1/2 x 6 x 30 ft long. Loc Mon bears S 55° E. 514 ft from entrance. value 100.00
 - no5 Cut 3 1/2 x 13 x 9 1/2 ft fac. On N 1 - bears N 27° 45' W. 333 ft. value 45.00
 - no6 Shaft 7 x 6 x 6 ft deep. West end Center bears N 62° 32' W. 285 ft value 30.00
 - no7 Cut 3 1/2 x 30 x 6 ft fac. West end Center bears N 58° 12' W 25 ft from entrance 255.00
- On Seventh Common Improvement 950.00
Loc. Mon. is S 58° 12' E. 10 ft. from discovery shaft.

Other Improvements.

Went house on Surprise^{Lode} 14 x 16 ft. East end Center bears S 87° 30' E 140 ft. from Center of North Side.
Frame & Went house on Beer^{Lode} 12 x 36 ft with ell. Course of long side is N 7 1/2° W. Loc Mon of Beer lode bears S 61° 22' E. 280 ft from N.E. Co.

Instrument.

This survey was made with a Leitz mining transit. The courses were deflected from the meridian as determined by solar observation.

The distances were measured with 100 ft. & 300 ft. steel tapes.

Adjoining Claims & Conflicts.

Gold Hill lode, unsurveyed, Treasure Key Mining & Milling Co., Claimant lies on north side of Great Eastern & Great Eastern Extension lodes. This survey, & conflicts with Great Eastern Extension lode from Cor. No 6 - nearly to Cor. No 2.

Treasure Key lode, unsurveyed, Treasure Key Mining & Milling Co., Claimant lies on north side of Surprise West Extension lode this survey.

Treasure Key Extension lode, unsurveyed, Treasure Key Mining & Milling Co., Claimant lies on north side of Surprise lode to west end of Apex lode. This survey.

Victor lode. Survey No 2213 - conflicts on north side of Beer lode this survey.

York lode unsurveyed, Emma Kemple, Ada Kemple, Effie Kemple & J.C. Kemple claimants, conflicts with N.E. Cor. of Beer lode & N.E. Cor. of Surprise East Extension lode this survey.

Preston lode. Sur. No 2775. lies on east end of Surprise East Extension lode this survey.

Alic lode Sur. No 2775 conflicts with Cor. rest Surprise East Extension lode this survey.

Pig Moly lode unsurveyed, claimant unknown lies south of Surprise East Extension lode this survey.

- 14 -

Foot.

Golden Gate lode, unsurveyed, Pioneer Cons. Mines Co. claimant, lies on south side of Great Eastern to Great Eastern Extension lodes, this survey.

Treadwell lode - Sur. No 1639 - lies on west end of Great Eastern Extension lode this survey.

I checked from Cr No 1 - Surprise East Extension lode this survey to U.S.L.M. No 1602 as follows:-

Beginning at Cr No 1 - Surprise East Extension lode this survey

Thence S 76° 05' E.

1268.5 Cr No 5 - Surprise East Extension lode, identical with Cr No 1 - Boston lode Survey No 2775

Thence S 84° 38' W

533.8 Cr No 3 - Bear lode this survey

Thence N 22° 55' E.

535.6 Cr rest - Bear lode this survey

Thence N 75° 31' W.

611. Cr No 3 - Victor lode Sur. No 2243

Thence N 40° 37' E.

595.2 Cr rest - Victor lode Sur. No 2243

Thence N 49° 16' W.

1207.2 Cr No 1 - Victor lode. Survey No 2243

Thence N 53° 32' W.

4419.4 U.S.L.M. No 1602.

The corners on Victor lode Sur. No 2243 are iron posts, properly set & described with the number of the corner in survey.

I checked from Cr No 1. Great Eastern Extension lode, this survey to U.S.L.M. No 1602 as follows:-

Beginning at Cr No 1. Great Eastern Extension lode this survey to U.S.L.M. No 1602 as follows:-

Thence S 22° 36' W

166. Cr No 2. Great Eastern Extension lode

Thence N 8° 27' W.

131.6 Cr No 6 Treadwell lode, Survey No 1639

Thence N 18° 37' W

544.5 Cr No 1 - Treadwell lode Survey No 1639

- 15 -

Feb.
1920.Thence $N4^{\circ}02'E$.
U. S. L. M. No 1602.

The corners on Survey No 1639 are pine posts properly set and scribed. -

The discrepancies between this survey courses and distances in surveys No 1639 No 2243 are due to errors in surveys No 1639 No 2243.

The discrepancies between courses and distances of this survey and the description in the location notices are due to errors in the location notices

*(see below)

H. G. Schader

U. S. Mineral Surveyor

* The corners of Survey No. 2775 which are connected with this survey are pine posts properly set and scribed. The corners of York lode unsurveyed that are connected with this survey are mounds of stone. The corners of Gold Hill lode unsurveyed that are connected with this survey are 4x4" pine posts set in mound of stones

SEP. 30. 1910

TERRITORY OF ARIZONA

County of Mohave.

SS

Bassett, H. G. Schader and E. A.
 , being first duly sworn, depose and say, that they
 are familiar with the Surprise, Great Eastern & Boer
 lode mining claims, situate in the San Francisco Mining District,
 Mohave County, Arizona, for which Boundary Cone Gold Mines Co. has
 made application to the Surveyor General for the District of Ariz-
 ona for an official survey, as a basis for an application for
 patent to said claims; that they have actually been on this min-
 ing claim and have seen all the monuments of location defining
 the boundaries thereof, as are described in the location notice
 of said lode claim on which this survey is based; that the origi-
 nal side center monuments of location were not in place when
 the patent survey was made on July 1-9, 1910, and that
 said side center monuments of location were not situate within
 the boundaries of said lode claim, as defined by straight lines
 connecting the respective corner monuments; and furthermore that
 they are not interested in said claims in any manner whatsoever.

H. G. Schader
E. A. Bassett

Subscribed and sworn to before me
 this 22nd day of September, 1910

W. H. Hudson
 Notary Public.

My commission expires March 26, 1914

FINAL OATHS FOR SURVEYS.

LIST OF NAMES.

A list of the names of the individuals employed by H. G. Schader

United States Deputy Mineral Surveyor, to assist in running, measuring, and marking the lines, corners, and

boundaries described in the foregoing field notes of the survey of the mining claim of

Boundary Cone Gold Mines Co

known as the Great Eastern, Great Eastern Extension, Surprise West Extension, Surprise, Surprise East Extension, Boer and Apex and showing the respective capacities in which they acted.

E. A. Bassett, Chairman.

....., Chairman.

....., Axman.

....., Flagman.

FINAL OATHS OF ASSISTANTS.

We, E. A. Bassett

and, do solemnly swear that we assisted

H. G. Schader, United States Deputy Mineral Surveyor, in marking the corners and surveying

the boundaries of the mining claim of Boundary Cone Gold Mines Co

known as the Great Eastern, Great Eastern Extension, Surprise West Extension, Surprise, Surprise East Extension, Boer and Apex represented in the foregoing field notes as having been surveyed by said deputy mineral surveyor and under his

direction; and that said survey has been in all respects, to the best of our knowledge and belief, faithfully and

correctly executed, and the corner and boundary monuments established according to law and the instructions

furnished by the United States Surveyor-General for Arizona

E. A. Bassett, Chairman.

....., Chairman.

....., Axman.

....., Flagman.

Subscribed and sworn to by the above-named persons before me this 15th

day of July, 1900

Wm H. W. ...

Notary Public

My Commission Expires Apr 15 1912

FINAL OATH OF U. S. MINERAL SURVEYOR.

I, H. G. Schader, U. S. Mineral Surveyor,
do solemnly swear that, in pursuance of instructions received from the United States
Surveyor General for Arizona, dated
June 23/1910, I have, in strict conformity to the laws of the
United States, the official regulations and instructions thereunder, and the instructions
of said Surveyor General, faithfully and correctly executed the survey of the Mining
Claim of Boundary Cone Gold Mines Co.
, known as the
Great Eastern, Great Eastern Extension, Surprise, Surprise West Extension, Surprise East Extension, Boen and Apex,
situate in San Francisco Mining District,
Mohave County, Arizona, in Section
approx, Township No. 19 N., Range No. 20. N. unsurveyed,
and designated as Survey No. 2822, as represented
in the foregoing field notes, which accurately show the boundaries of said mining claim
as distinctly marked by monuments on the ground, and described in the attached copy
of the location certificate, which was received by me from the Surveyor General with
said instructions, and that all the corners of said survey have been established and per-
petuated in strict accordance with the law, official regulations and instructions there-
under; and I do further solemnly swear that the foregoing are the true and original
field notes of said survey and my report therein, and that the labor expended and
improvements made upon said mining claim by claimant or its grantors
are as therein fully stated, and that the character, extent, location, and itemized value
thereof are specified therein with particularity and full detail, and that no portion of
said labor or improvements so credited to this claim has been included in the estimate
of expenditures upon any other claim.

H. G. Schader
U. S. Mineral Surveyor.

Subscribed and sworn to by the said H. G. Schader
U. S. Mineral Surveyor, before me Wm H. W. [unclear]
this 15
day of July, 1910

Wm H. W. [unclear]
Notary Public
Commission Expires Apr 15 1912.

My

Notice of Mining Location, Lode Claim

To all Whom it may concern; This Mining Claim, the name of which is the Great Eastern Mining Claim, situate on lands belonging to the United States of America, and in which there are valuable mineral deposits, was entered upon and located for the purpose of exploration and purchase by Carl Tanner, John Bindshaedler & Sam Klopfenstein, Citizens of the United States the undersigned, on the 9th. day of November 1901.

The length of this claim is Fifteen hundred feet and we claim 1350 feet in in a Westerly direction and 150 feet in an Easterly direction from the center of the discovery shaft, at which this notice is posted, lengthwise of the claim, together with 300 feet in width of the surface grounds on each side of the center of said Claim, the general course of the lode deposit and premises is from the West to the East.

The claim is situated and located in the San Francisco Mining District, in Mohave County, in the Territory of Arizona, about 2 miles in a Northerly direction from Boundary Cone and is adjoining the Treadwell ledge.

The surface boundaries of the claim are marked upon the ground as follows; Beginning at a monument of stone, at a point in an Easterly direction 150 feet from the discovery shaft (at which this notice is posted) being in the center of last end line of said claim; thence 300 feet to a monument of stone being the South East corner of said claim; thence 750 feet to a monument of stone at the center of the south side line of said claim; thence 750 feet to a monument of stone being at the South West corner of said claim; thence 300 feet to a monument of stone, at the center of the West end line of said claim; thence 300 hundred feet to a monument of stone, being at the North west corner of said claim; thence 750 feet to a monument of stone being at the center of the North side line of said claim; thence 750 feet to a monument of stone, at the north east corner of said claim; thence 300 feet to the place of beginning.

All done under the provisions of Chapter Six. of Title XXXII of the Revised Statutes of the United States, and of an Act of the General Assembly of Arizona, entitled "An Act Concerning Mines" approved March 20th. 1895. and amended March 2nd. 1899 and March 16th. 1901.

Dated and posted on the ground this 9th. day of November 1901.

Carl Tanner.
John Bindshaedler
Sam Klopfenstein.

Filed and recorded at request of Carl Tanner Jan. 31st. A.D. 1902 at 10 min. past 10 clock P.M. Book P page 285.

Jno. P. Feeny.

County Recorder.

AMENDED

Notice of Mining Location

21

LODE CLAIM

To All Whom It May Concern:

This Mining Claim, the name of which is the Great Eastern Extension, Mining Claim, situate on lands belonging to the United States of America, and in which there are valuable mineral deposits, was entered upon and located for the purposes of exploration and purchase by Boundary Cone Gold Mines Co. a corporation organized under the laws of the Territory of Arizona U.S.A. a citizen of U.S. Locator.
(Locator must insert either "a citizen of the United States," or, "who has declared his intention to become a citizen of the United States.")

the undersigned, on the 29th day of January 1910

The length of this claim is 427 feet,
and I claim 171 feet,
in a Southeasterly direction and 256
feet in a Northwesterly direction from
the center of the discovery shaft, at which this notice is posted, lengthwise of the claim, together
with 300 feet in width of the surface grounds, on each
side of the center of said claim. The general course of the lode deposit and premises is from the

South East to the North West
The claim is situated and located in the San Francisco Mining District, in
Mohave County, in the Territory of Arizona, about 2700 ft.
in a Southerly direction from U.S.L.M. No1602

The surface boundaries of the claim are marked upon the ground as follows: Beginning at
a pine post

at a point in a Southeasterly direction 171 feet from
the discovery shaft (at which this notice is posted), being in the center of the Southeast
end line of said claim; thence Northeasterly 140 feet to a pine post
, being the Northeast corner of said claim; thence
Northwesterly 435 feet to a pine post, being at the
North west corner of said claim; thence South westerly 166 feet
to a pine post at the center of the North west end of said claim;
thence Southerly 445.5 feet to a pine post, being at the
South west corner of said claim; thence South easterly 180
feet to a pine post at the South east corner of said claim;
thence North easterly 300 feet to the place of beginning.

All done under the provisions of Chapter Six, of Title XXXII, of the Revised Statutes of the United States, and of an Act of the General Assembly of Arizona, entitled "An Act to Revise and Codify the Laws of the Territory of Arizona," approved March 16, 1901 an act ammendatory thereof.

This is an Amended Location Notice of the Great Eastern Extension
Mining Claim, located by August Just Harry Anderson
on the 8th day of
February 1909, and recorded in Book EE of Records of Mines, at
page 589, in the office of the County Recorder of the aforesaid County of Mohave Ariz.
to which reference is hereby made, and this Amended Location Notice is made and posted to
correct errors in the description in the said original Location Notice.

Dated and posted on the ground this 29 day of January 1910

Boundary Cone Gold Mines Co.

J.M.Vassar Supt.

Book DD Page 88

I,....., County Recorder in and for the County and Territory aforesaid, do hereby certify that the within instrument was filed for record at.....o'clock,.....M., on this.....day of.....190..., and duly recorded in Book No..... of.....Records of.....County, Arizona, at pages.....

WITNESS my hand and official seal the day and year first above written.

County Recorder.

Great E. EX

AMENDED Notice of Location. LODE CLAIM.

Dated.....190.....

Filed and Recorded at request of

J. M. Nassau

July 26th A. D. 1900

at Gro Ochock A. M.

Book D. D.

Pages 88

J. M. Nassau County Recorder.

By Deputy Recorder.

The H. H. McNeil Co., Printers, Phoenix

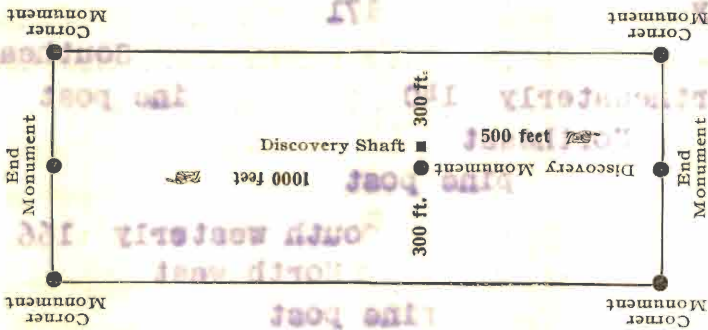

This diagram is to give locator a general idea of plan of location under the new law. The Discovery Shaft can be in the center of claim or any distance from either end desired. In the diagram it is placed 500 feet from one end and 1000 feet from the other. Commence description of claim at a center end monument, giving its distance and direction from center of Discovery Shaft; thence bound the claim in either direction. In description be careful to state locality of claim with reference to some natural object, or permanent monument, as will identify the claim.

Notice of Mining Location, Mineral Lode.

To All Whom it May Concern; This mining claim, the name of which is Surprise Mining Claim, situate on lands belonging to the United States of America, and in which there are valuable mineral deposits, was entered upon and located for the purpose of exploration and purchase by John Bindschaedler, Sam Klopfenstein and Carl Tanner, the undersigned Citizens of the United States of America, on the Nineth day of September, 1901. The length of this claim is fifteen hundred (1500) feet and we claim Eleven hundred & Twenty five feet in a westerly direction and Three hundred & 75 feet in a easterly direction, from the center of the discovery cut, at which this notice is posted, lengthwise of the claim, together with three hundred (300) feet in width of the surface grounds, on each side of the center of said claim, The General course of the lode deposit and premises is from the West to the east.

The claim is situated and located in the San Francisco Mining District, in Mohave County, in the Territory of Arizona, about 2 1/2 miles in a Northeasterly direction from Boundary Cone. The Surface boundaries of the claim are marked upon the ground as follows; Beginning at a monument of stone at a point in a westerly direction eleven hundred and twenty five feet from the discovery cut (at which this notice is posted), being in the center of the west end line of said claim; thence Northerly three hundred (300) feet to a monument of stone, being at the North westerly corner of said claim, thence easterly, seven hundred and fifty (750), feet to a monument of stone, center of the Northerly side line of said claim; thence Easterly, seven hundred and fifty (750), feet to a monument of stone, being at the Northeasterly corner of said claim, thence Southerly three hundred (300), feet to a monument of stone, at the center of the easterly end of said claim; thence Southerly, three hundred (300) feet to a monument of stone, being the South easterly corner of said claim; thence Westerly seven hundred and fifty (750), feet to a monument of stone, being at the center of the Southerly side line of said claim; thence Westerly, seven hundred and fifty (750) feet to a monument of stone at the South westerly corner of said claim; thence Northerly three hundred (300) feet to the place of beginning.

All done under the provisions of Chapter XXXII of the Revised Statutes of the United States, and of an Act of the General Assembly of Arizona, entitled "An Act Concerning Mines" approved March 2, 1899.

Dated and posted on the ground this 9th. day of September, 1901.

John Bindschaedler .

Sam Klopfenstein .

Carl Tanner .

Filed and recorded at request of Carl Tanner Nov 25th. A.D. 1901 at Eleventh O'clock A.M. Book P. pages 249 et seq, of Mining Records.

John P. Feeny ,

County Recorder.

Copy

Notice of Mining Location

LODE CLAIM

To All Whom It May Concern:

This Mining Claim, the name of which is the Surprise West Extension Mining Claim, situate on lands belonging to the United States of America, and in which there are valuable mineral deposits, was entered upon and located for the purposes of exploration and purchase by August Just & Harry Anderson

(Locator must insert either "a citizen of the United States," or, "who has declared his intention to become a citizen of the United States.")

the undersigned, on the 8th day of February 1909

The length of this claim is Fifteen Hundred feet,

and the claim Fifty feet, in a South Easterly direction and Fourteen Hundred feet in a North Westely direction from

the center of the discovery shaft, at which this notice is posted, lengthwise of the claim, together with 300 feet in width of the surface grounds, on each

side of the center of said claim. The general course of the lode deposit and premises is from the

South east to the North west

The claim is situated and located in the San Francisco Mining District, in Mohave County, in the Territory of Arizona, about 2 1/2 Miles in a North Westely direction from Boundary Line

The surface boundaries of the claim are marked upon the ground as follows: Beginning at

at a point in a S Easterly direction 50 feet from

the discovery shaft (at which this notice is posted), being in the center of the S East end line of said claim; thence 300 feet to a Monument

of stone, being the S East corner of said claim; thence 300 feet to a Monument of stone, being at the

N East corner of said claim; thence 1500 feet to a Monument at the center of the N W end of said claim;

thence 300 feet to a Monument, being at the S W corner of said claim; thence 300

feet to a Monument at the N W corner of said claim;

thence 1500 feet to the place of beginning.

All done under the provisions of Chapter Six, of Title XXXII, of the Revised Statutes on the United States, and of an Act of the General Assembly of Arizona, entitled "An Act to Revise and Codify the Laws of the Territory of Arizona," approved March 16, 1901.

Dated and posted on the ground this 8 day of Febr 1909

August Just
Harry Anderson

Notice of Location

LODE CLAIM

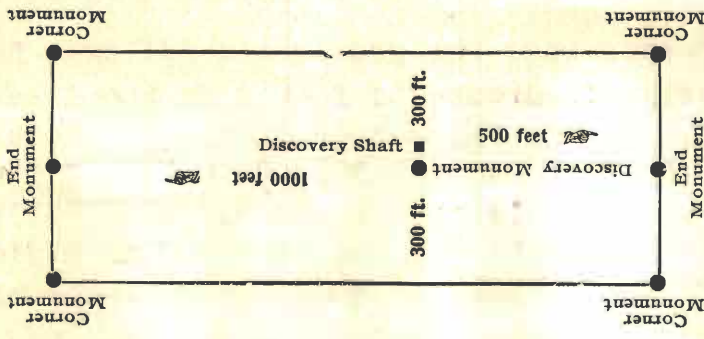

This diagram is to give locator a general idea of plan of location under the new law. The Discovery Shaft can be in the center of claim or any distance from either end desired. In the diagram it is placed 500 feet from one end and 1000 feet from the other. Commence description of claim at a center end monument, giving its distance and direction from center of Discovery Shaft; thence bound the claim in either direction. In description be careful to state locality of claim with reference to some natural object, or permanent monument, as will identify the claim.

Dated 19

Filed and Recorded at request of

August Just
March 18th A. D. 1909
 at *9 O'clock* *A.M.*

Book *A.A.*

Pages *782.*

R. A. Robertson
 County Recorder.

By
 Deputy Recorder.

Amended Notice of Mining Location Mineral Claim.

To All Whom It May Concern: This Mining Claim , the name of which is the Surprise East Extension Mining Claim , situate on lands belonging to the United States of America, and in which there are valuable, mineral deposits was entered upon and located for the purpose of exploration and purchase by C.E. Woods and August Just, the undersigned Citizens of the United States of America, over 21 years of age, on the 24th. day of March 1909. The length of this claim is 1424.4 feet, and we claim 674.4 feet in an Northwesterly direction and 750 feet in a South Easterly direction from the center of the discovery shaft, at which this notice is posted, lengthwise of the claim , together with three hundred (300) feet in width of the surface grounds, on each side of the center of said claim, including all dips, variations, spurs, angles and all veins, ledges lodes or deposits, within the lines of said claim , together with all water and timber appurtenant allowed by law. The general course of the lode deposit and premises is from the North West to the South East. The Amended claim is situated and located in the San Francisco Mining District, in Mohave County, in the Territory of Arizona , about one mile in a south westerly direction from Oatman P.O. Arizona Territory and patent. This Amended location is made in conformity with the original location, Made January 1st. 1905, Recorded Mch. 6th. in Book V page 191 of quartz location in the office of the Recorder of said County and it is made for the purpose of appropriating all ground within the boundaries hereinbefore described and more definitely, describing the situation and boundaries of said lode , correcting any irregularities, supplying omissions and correcting defects in original location hereby waiving no right acquired under and by virtue of said original location. The surface boundaries ^{of the claim} are marked upon the ground as follows: Beginning at - at a point in a North westerly direction 750 feet from the discovery shaft at which this notice is posted), being in the center of the South East end line of said claim ; thence S 22° 51' W three hundred (300) feet to a post monument of stone, being the S.E. corner of said claim; thence 1424.4 ft. N 75° 53' W. feet to a post or mound of stones , being at the S.W. corner of said claim; thence N. 22° 51' E three hundred (300) feet to a post or mound of stone at the center of the Westerly end of said claim ; thence N. 22° 51' E. three hundred (300) feet to a post or mound of stones , being at the W.W. corner of said claim ; thence 1424.4 ft. S. 75° 53' E. feet to a post or mound of stones at the N.E. corner of said claim; thence S. 22° 51' W. three hundred (300) feet to the place of beginning. All done under the provisions of chapter Six, of Title XXXII, of the Revised Statutes of the United States , and of an "Act of the General Assembly of Arizona , "An Act to revise and Codify the Laws of the Territory of Arizona " approved March 16th. 1901.

Dated and posted on the ground this 24th. day of March 1909.

C.E. Woods.
August Just.

Date original Discovery January 1st. 1905 Date Amended Location Mch. 24 1909.

Filed and recorded at request of H.E. Woods May 12th. A.D. 1909, at 10 clock P.M. in Book EE at page 208

R.A. Robertson
County Recorder

By Marie Carrow , Deputy.

Notice of Mining Location Mineral Lode.

To All Whom It May Concern: This Mining Claim the name of which is the Beer Mining Claim, situate on lands belonging to the United States of America, and in which there are valuable mineral deposits, was entered upon and located for the purpose of exploration and purchase by C. Goodchild the undersigned, citizen of the United States^{America}, on the First day of March 1903. The length of this claim is Fifteen hundred (1500) feet, and I claim 500 feet in a Easterly direction and 1000 feet in a Westerly direction from the center of the discovery shaft at which this notice is posted, lengthwise of the claim, together with three hundred (300) feet in width of the surface grounds, on each side of the center of said claim. The general course of the lode deposit and premises is from the East to the West.

The claim is situated and located in the San Francisco Mining district in Mohave County, in the Territory of Arizona, about 3 miles in a North East direction from Boundary Cone, and running parallel with the Victor Mining Claim and running Easterly from the East end line of the Beehive Mining Claim

The surface boundaries of the claim are marked upon the ground as follows: Beginning at a monument of stone at a point in an Easterly direction Five hundred feet from the discovery shaft (at which this notice is posted) being in the center of the East end line of said claim; thence South Three hundred (300), feet to a monument of stone, being the Southeast corner of said claim thence West seven hundred and fifty (750) feet to a monument of stone at the center of the South side line of said claim; thence West seven hundred (700), and fifty (750) feet to a monument of stone, being at the Southwest corner of said claim; thence North, three hundred (300) feet to a monument of stone at the center of the West end of said claim; thence North three hundred (300) feet to a monument of stone, being at the Northwest corner of said claim; thence East seven hundred and fifty (750) feet, to a monument of stone, being at the center of the North side line of said claim; thence East, seven hundred and fifty (750) feet to a monument of stone at the northeast corner of said claim; thence South three hundred (300) feet to the place of beginning,

All done under the provisions of Chapter Six, of Title XXXII, of the Revised Statutes of the United States, and of an Act of the General Assembly of Arizona, entitled "An Act Concerning Mines" approved March 2, 1899.

Dated and posted on the ground this First day of March 1903, at -min. past. 0 clock-M.

W

C. Goodchild.

Filed and recorded at request of C. Goodchild May 4th. A.D. 1903 9 0 clock A.M. in Book S page 158 Records of Mohave County, Arizona Territory.

Jno. P. Feeny.

County Recorder.

Notice of Mining Location

28

LODE CLAIM

To All Whom It May Concern:

This Mining Claim, the name of which is the Apex
Mining Claim, situate on lands belonging to the United States of America, and in which there
are valuable mineral deposits, was entered upon and located for the purposes of exploration and
purchase by Boundary Cone Gold Mines Co. a corporation organized under
the laws of the Territory of Arizona U.S.A.

(Locator must insert either "a citizen of the United States," or, "who has declared his intention to become a citizen of the United States.")

the undersigned, on the 2nd. day of January 1910.

The length of this claim is 1500 Fifteen hundred feet,
and I claim 750 feet,

in a Westerly direction and 750
feet in a Easterly direction from

the center of the discovery shaft, at which this notice is posted, lengthwise of the claim, together
with 300 feet in width of the surface grounds, on each
side of the center of said claim. The general course of the lode deposit and premises is from the

Easterly to the Westerly

The claim is situated and located in the San Francisco Mining District, in
Mohave County, in the Territory of Arizona, about 600 ft.

in a Southerly direction from Victor & Virgin Property.

The surface boundaries of the claim are marked upon the ground as follows: Beginning at
Mon of Stone.

at a point in a Westerly direction 750 feet from
the discovery shaft (at which this notice is posted), being in the center of the West
end line of said claim; thence Northerly 300 feet to a Mon. of stone
, being the North West corner of said claim; thence
Easterly 1500 feet to a Mon of stone, being at the
North East corner of said claim; thence Southerly 300 feet
to a Mon of stone at the center of the East end of said claim;
thence Southerly 300 feet to a mon of stone, being at the
South East corner of said claim; thence Westerly 1500
feet to a Mon of stone at the South West corner of said claim;
thence Northerly 300 feet to the place of beginning.

All done under the provisions of Chapter Six, of Title XXXII, of the Revised Statutes on
the United States, and of an Act of the General Assembly of Arizona, entitled "An Act to
Revise and Codify the Laws of the Territory of Arizona," approved March 16, 1901.

Dated and posted on the ground this 2 nd. day of January 1910

Witness

F.M. Drescher

J.M. Vasser

W.W. Elliott

Boundary Cone Gold Mines Co.

a corporation organized under the laws of

Territory of Arizona U.S.A. - J.M. Vasser -Supt.

Apex

Notice of Location

LODE CLAIM

Dated _____ 19__

Filed and Recorded at request of

C. M. Neundorfer

March 24 A. D. 19*10*

at *1¹⁰ Ochoa* P. M.

Book *87*

Pages *140*

By *J. M. Morgan*
County Recorder.

Deputy Recorder.

The McNeil Co., Phoenix

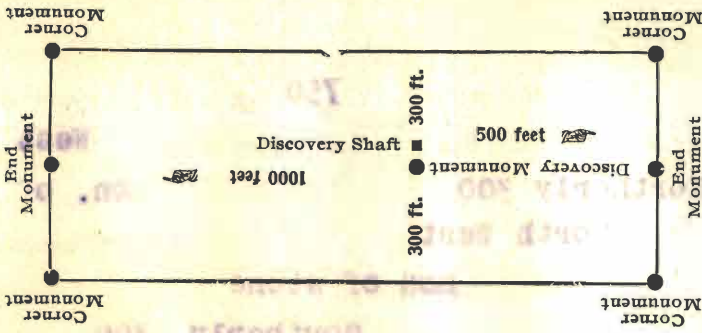

This diagram is to give locator a general idea of plan of location under the new law. The Discovery Shaft can be in the center of claim or any distance from either end desired. In the diagram it is placed 500 feet from one end and 1000 feet from the other. Commence description of claim at a center end monument, giving its distance and direction from center of Discovery Shaft; thence bound the claim in either direction. In description be careful to state locality of claim with reference to some natural object, or permanent monument, as will identify the claim.

U. S. SURVEYOR-GENERAL'S FINAL CERTIFICATE ON FIELD NOTES.

Department of the Interior,

OFFICE OF U. S. SURVEYOR-GENERAL,

Phoenix, Arizona,

October 1, 1910, 190

I, U. S. Surveyor-General for Arizona,

do hereby certify that the foregoing transcript of the Field Notes, return and approval of the survey of the mining claim of Boundary Cone Gold Mines Co.

known as the GREAT EASTERN, GREAT EASTERN EXTENSION, SURPRISE, SURPRISE WEST EXTENSION, SURPRISE EAST EXTENSION, BOER and APEX, situate in San Francisco.

Mining District, Mohave County, Arizona,

in Section Approx., Township No. 19 N., Range No. 20 W. Unsurveyed, and designated as Survey No. 2822, has been correctly copied from the originals on file in this office; that said Field Notes furnish such an accurate description of said mining claim as will, if incorporated into a patent, serve fully to identify the premises, and that such reference is made therein to natural objects or permanent monuments as will perpetuate and fix the locus thereof.

And I further certify that five hundred dollars' worth of labor has been expended or improvements made upon said mining claim^s by claimant or its grantors, and that said improvements consist of 20 cuts, 25 shafts, 2 tunnels and 2 drifts, total value \$9472.00. Shaft No. 4 on the Surprise lode being a common improvement for the benefit and development of this entire group of claims, an undivided one-seventh interest therein, value \$950.00, is properly credited to each of the seven claims in this survey.

and that no portion of said labor or improvements has been included in the estimate of expenditures upon any other claim.

I further certify that the plat thereof, filed in the U. S. Land Office at Phoenix, Arizona,

is correct and in conformity with the foregoing Field Notes.

Frank S. Ingalls.

United States Surveyor-General for Arizona.

4-687.

SURVEYOR-GENERAL'S CERTIFICATE OF APPROVAL OF FIELD NOTES AND SURVEY OF MINING CLAIM.

Department of the Interior,

Office of U. S. Surveyor-General,

Phoenix, Arizona.

October 1, 1910, 190

I, U. S. Surveyor-General for Arizona,

do hereby certify that the foregoing and hereto attached Field Notes and Return of the Survey of the Mining Claim of Boundary Cone Gold Mines Co.

known as the GREAT EASTERN, GREAT EASTERN EXTENSION, SURPRISE, SURPRISE WEST EXTENSION, SURPRISE EAST EXTENSION, BOER and APEX, situate in San Francisco, Mining District, Mohave County, Arizona.

in Section Approx., Township No. 19 N., Range No. 20 W. Unsurveyed, designated as Survey No. 2822.

executed by H. G. Schader, U. S. Deputy Mineral Surveyor, July 1 - 9, 1910, under my instructions dated June 23, 1910, have been critically examined and the necessary corrections and explanations made, and the said Field Notes and Return, and the Survey they describe, are hereby approved. A true copy of the copy of the location certificate filed by the applicant for survey is included in the field notes.

Handwritten signature of Frank D. Ingalls

U. S. Surveyor-General for Arizona.